



STATE OF NORTH CAROLINA
DEPARTMENT OF TRANSPORTATION

MICHAEL F. EASLEY
GOVERNOR

LYNDO TIPPETT
SECRETARY

June 5, 2002

Addendum No. 1

RE: State Project: 6.549007T
Lee County (R-2417BA)
US-421 and NC-87 (Sanford Bypass)
From East of US-1 and US-15/501
To East of SR-1521.

JUNE 18, 2002 Letting

To Whom It May Concern:

Reference is made to the proposal form recently furnished to you on the above project.

Then following revisions have been made to the proposal form:

Page no. 142 has been revised. Please void page no. 142 in your proposal form and staple the revised page no. 142 thereto. New page nos. 143 thru 205 are being added. Please staple new page nos. 143 thru 205 after page no. 142 in your proposal.

The table of contents has been revised to reflect the above noted changes. Please void your table of contents and staple the revised table of contents thereto.

Please be advised that the Department has available upon request, a printout of the -L-Line Geopak alignment and coordinates along the -L-Line at 100 foot stations. Please contact the Department at (919)-250-4124 to obtain a copy of this printout.

Sincerely,

R. A. Garris, P.E.
Contract Officer

RAG/jag/pa
(Attachments)

cc: Mr. J. D. Goins, P.E.
Mr. S. D. DeWitt, P.E.
Mr. W. F. Rosser, PE (2)
Ms. D. M. Barbour, P. E.
Mr. J. V. Barbour, P.E.

Mr. R. E. Davenport, Jr., P.E.
Ms. Kim Canady
Ms. Yang-Ju Lin ✓
Project File (2)

MAILING ADDRESS:
NC DEPARTMENT OF TRANSPORTATION
CONTRACTS & PROPOSALS
1591 MAIL SERVICE CENTER
RALEIGH NC 27699-1591

TELEPHONE: 919-250-4124
FAX: 919-250-4127

WEBSITE: WWW.DOH.DOT.STATE.NC.US

LOCATION:
CENTURY CENTER COMPLEX
BUILDING B - ENTRANCE B15
1020 BIRCH RIDGE DRIVE
RALEIGH NC

PROJECT: 6.549007T
LEE COUNTY

TABLE OF CONTENTS

COVER SHEET

PROPOSAL SHEETS

PROJECT SPECIAL PROVISIONS (GREEN SHEETS)

PAGE NO.

Contract Time and Liquidated Damages.....	1
Intermediate Contract Time (s).....	1 - 2
Safety Index Rating.....	2
Major Contract Items.....	2
Specialty Items.....	2 - 3
Fuel Price Adjustment.....	3
Execution of Signature Sheets and Debarment Certification.....	3
Schedule of Estimated Completion Progress.....	4
On-line Electronic Bidding.....	4 - 5
Minority and Women Business.....	5 - 13
Retainage and Prompt Payment.....	14
Partial Payments.....	14
Domestic Steel Products.....	14 - 15
Subsurface Information.....	15
Plant Pest Quarantines.....	15 - 16
Cooperation Between Contractors.....	16
Construction Access.....	16
Safety Vests.....	16
Roadway.....	17 - 49
Signing.....	50
Utility Construction.....	51 - 52
Utility Conflicts.....	53 - 55
Erosion Control.....	56 - 73
Structures and Culverts.....	74 - 129
Railroad Special Provisions (Structures).....	130 - 136
Railroad Insurance Special Provisions-Structure.....	137 - 140
Railroad Site Data.....	141
Permits (WHITE SHEETS).....	142 - 205

STANDARD SPECIAL PROVISIONS (YELLOW SHEETS)

Availability of Funds.....	1
Seed Quality Requirements.....	2 - 4
Errata.....	5 - 6
Minimum Wages.....	7

PROPOSAL FORM ITEM SHEETS, ETC.

Item Sheets
Award Limits
Signature

PROJECT SPECIAL PROVISIONS
PERMITS

The Contractor's attention is directed to the following permits which have been issued to the Department of Transportation by the authority granting the permit.

PERMIT

AUTHORITY GRANTING THE PERMIT

Dredge and Fill and/or
Work in Navigable Waters

U. S. Army Corps of Engineers

Water Quality

Division of Environmental Management, DEHNR
State of North Carolina

The Contractor shall comply with all applicable permit conditions during construction of this project. Those conditions marked by * are the responsibility of the department and the Contractor has no responsibility in accomplishing those conditions.

Agents of the permitting authority will periodically inspect the project for adherence to the permits.

The Contractor's attention is also directed to Articles 107-10 and 107-14 of the Standard Specifications and the following:

Should the Contractor propose to utilize construction methods (such as temporary structures or fill in waters and/or wetlands for haul roads, work platforms, cofferdams, etc.) not specifically identified in the permit (individual, general, or nationwide) authorizing the project it shall be the Contractor's responsibility to coordinate with the appropriate permit agency to determine what, if any, additional permit action is required. The Contractor shall also be responsible for initiating the request for the authorization of such construction method by the permitting agency. The request shall be submitted through the Engineer. The Contractor shall not utilize the construction method until it is approved by the permitting agency. The request normally takes approximately 60 days to process; however, no extensions of time or additional compensation will be granted for delays resulting from the Contractor's request for approval of construction methods not specifically identified in the permit.

Where construction moratoriums are contained in a permit condition which restricts the Contractor's activities to certain times of the year, those moratoriums will apply only to the portions of the work taking place in the waters or wetlands provided that activities outside those areas is done in such a manner as to not affect the waters or wetlands.

Revised 6-5-02

143



DEPARTMENT OF THE ARMY
WILMINGTON DISTRICT, CORPS OF ENGINEERS
P.O. BOX 1890
WILMINGTON, NORTH CAROLINA 28402-1890

IN REPLY REFER TO

May 28, 2002

Regulatory Division

SUBJECT: Action ID 2002-2-0899, TIP No. R-2417

Mr. William D. Gilmore, P.E., Manager
Project Development and Environmental Analysis Branch
North Carolina Department of Transportation
Division of Highways
1548 Mail Service Center
Raleigh, North Carolina 27699-1548

Dear Mr. Gilmore:

In accordance with your written request of June 11, 2001, subsequently modified on June 22, 2001, and September 28, 2001, and the resulting administrative record, enclosed are two copies of a Department of the Army permit to authorize the discharge of dredged and fill material into waters of the United States, for construction of the US 421-NC 87 Sanford Bypass (T.I.P. No. R-2417), in the Cape Fear River Basin, in Lee County, North Carolina.

You should acknowledge that you accept the terms and conditions of the enclosed permit by signing and dating each copy in the spaces provided ("Permittee" on page 3). Your signature, as permittee, shows that, as consideration for the issuance of this permit, you voluntarily accept and agree to comply with all of the terms and conditions of this permit. All pages of both copies of the signed permit with drawings should then be returned to this office for final authorization. A self-addressed envelope is enclosed for your convenience.

After the permit is authorized in this office, the original copy will be returned to you; the duplicate copy will be permanently retained in this office. Should you have questions, contact Mr. Eric Alsmeyer of my Raleigh Field Office regulatory staff at telephone (919) 876-8441, extension 23.

Sincerely,

A handwritten signature in cursive script that reads "E. David Franklin".

E. David Franklin
Chief, NCDOT Team

Enclosures

Revised 6-5-02

144

Blind Copies Furnished:

CESAW-RG-R/Alsmeyer

CESAW-RG-R/Manuele

CESAW-RG-R/COMPLIANCE FILE (with Permit and Conditions)

SUSPENSE

NOTIFICATION OF ADMINISTRATIVE APPEAL OPTIONS AND PROCESS AND REQUEST FOR APPEAL

Applicant: NCDOT/TIP R-2417 (Sanford Bypass)	File Number: 2002-2-0899	Date: May 28, 2002
Attached is:		See Section below
X	INITIAL PROFFERED PERMIT (Standard Permit or Letter of permission)	A
	PROFFERED PERMIT (Standard Permit or Letter of permission)	B
	PERMIT DENIAL	C
	APPROVED JURISDICTIONAL DETERMINATION	D
	PRELIMINARY JURISDICTIONAL DETERMINATION	E

SECTION I: The following identifies your rights and options regarding an administrative appeal of the above decision. Additional information may be found at <http://www.usace.army.mil/inet/functions/cw/cecwo/reg> or Corps regulations at 33 CFR Part 33.1

A: INITIAL PROFFERED PERMIT: You may accept or object to the permit.

- **ACCEPT:** If you received a Standard Permit, you may sign the permit document and return it to the district engineer for final authorization. If you received a Letter of Permission (LOP), you may accept the LOP and your work is authorized. Your signature on the Standard Permit or acceptance of the LOP means that you accept the permit in its entirety, and waive all rights to appeal the permit, including its terms and conditions, and approved jurisdictional determinations associated with the permit.
- **OBJECT:** If you object to the permit (Standard or LOP) because of certain terms and conditions therein, you may request that the permit be modified accordingly. You must complete Section II of this form and return the form to the district engineer. Your objections must be received by the district engineer within 60 days of the date of this notice, or you will forfeit your right to appeal the permit in the future. Upon receipt of your letter, the district engineer will evaluate your objections and may: (a) modify the permit to address all of your concerns, (b) modify the permit to address some of your objections, or (c) not modify the permit having determined that the permit should be issued as previously written. After evaluating your objections, the district engineer will send you a proffered permit for your reconsideration, as indicated in Section B below.

B: PROFFERED PERMIT: You may accept or appeal the permit

- **ACCEPT:** If you received a Standard Permit, you may sign the permit document and return it to the district engineer for final authorization. If you received a Letter of Permission (LOP), you may accept the LOP and your work is authorized. Your signature on the Standard Permit or acceptance of the LOP means that you accept the permit in its entirety, and waive all rights to appeal the permit, including its terms and conditions, and approved jurisdictional determinations associated with the permit.
- **APPEAL:** If you choose to decline the proffered permit (Standard or LOP) because of certain terms and conditions therein, you may appeal the declined permit under the Corps of Engineers Administrative Appeal Process by completing Section II of this form and sending the form to the division engineer. This form must be received by the division engineer within 60 days of the date of this notice.

C: PERMIT DENIAL: You may appeal the denial of a permit under the Corps of Engineers Administrative Appeal Process by completing Section II of this form and sending the form to the division engineer. This form must be received by the division engineer within 60 days of the date of this notice.

D: APPROVED JURISDICTIONAL DETERMINATION: You may accept or appeal the approved JD or provide new information.

- **ACCEPT:** You do not need to notify the Corps to accept an approved JD. Failure to notify the Corps within 60 days of the date of this notice, means that you accept the approved JD in its entirety, and waive all rights to appeal the approved JD.
- **APPEAL:** If you disagree with the approved JD, you may appeal the approved JD under the Corps of Engineers Administrative Appeal Process by completing Section II of this form and sending the form to the division engineer. This form must be received by the division engineer within 60 days of the date of this notice.

E: PRELIMINARY JURISDICTIONAL DETERMINATION: You do not need to respond to the Corps regarding the preliminary JD. The Preliminary JD is not appealable. If you wish, you may request an approved JD (which may be appealed), by contacting the Corps district for further instruction. Also you may provide new information for further consideration by the Corps to reevaluate the JD.

SECTION II - REQUEST FOR APPEAL or OBJECTIONS TO AN INITIAL PROFFERED PERMIT

REASONS FOR APPEAL OR OBJECTIONS: (Describe your reasons for appealing the decision or your objections to an initial proffered permit in clear concise statements. You may attach additional information to this form to clarify where your reasons or objections are addressed in the administrative record.)

ADDITIONAL INFORMATION: The appeal is limited to a review of the administrative record, the Corps memorandum for the record of the appeal conference or meeting, and any supplemental information that the review officer has determined is needed to clarify the administrative record. Neither the appellant nor the Corps may add new information or analyses to the record. However, you may provide additional information to clarify the location of information that is already in the administrative record.

POINT OF CONTACT FOR QUESTIONS OR INFORMATION

If you have questions regarding this decision and/or the appeal process you may contact:

Mr. Eric C. Alsmeyer, Regulatory Project Manager
 U.S. Army Corps of Engineers, Wilmington District
 Raleigh Regulatory Field Office
 6508 Falls of Neuse Road, Suite 120
 Raleigh, North Carolina 27615-6814

If you only have questions regarding the appeal process you may also contact:

Mr. Arthur Middleton, Administrative Appeal Review Officer
 CESAD-ET-CO-R
 U.S. Army Corps of Engineers, South Atlantic Division
 60 Forsyth Street, Room 9M15
 Atlanta, Georgia 30303-8801

RIGHT OF ENTRY: Your signature below grants the right of entry to Corps of Engineers personnel, and any government consultants, to conduct investigations of the project site during the course of the appeal process. You will be provided a 15 day notice of any site investigation, and will have the opportunity to participate in all site investigations.

_____ Signature of appellant or agent.	Date:	Telephone number:
---	-------	-------------------

DIVISION ENGINEER:
 Commander
 U.S. Army Engineer Division, South Atlantic
 60 Forsyth Street, Room 9M15
 Atlanta, Georgia 30303-3490

DEPARTMENT OF THE ARMY PERMIT

NC Department of Transportation

Permittee _____

200220899

Permit No. _____

CESAW-RG-R

Issuing Office _____

NOTE: The term "you" and its derivatives, as used in this permit, means the permittee or any future transferee. The term "this office" refers to the appropriate district or division office of the Corps of Engineers having jurisdiction over the permitted activity or the appropriate official of that office acting under the authority of the commanding officer.

You are authorized to perform work in accordance with the terms and conditions specified below.

Project Description:

Place fill material impacting a total of 11.06 acres of wetlands, 23,640 linear feet of stream, and 6.32 acres of ponds, for construction of the US 421-NC 87 Sanford bypass (T.I.P. No. R-2417).

In the upper and middle Cape Fear River basins, from existing US 421 northwest of Sanford to existing NC 87, southeast of Sanford, in Lee County, North Carolina.

Project Location:

Permit Conditions:

General Conditions:

1. The time limit for completing the work authorized ends on December 31, 2009. If you find that you need more time to complete the authorized activity, submit your request for a time extension to this office for consideration at least one month before the above date is reached.
2. You must maintain the activity authorized by this permit in good condition and in conformance with the terms and conditions of this permit. You are not relieved of this requirement if you abandon the permitted activity, although you may make a good faith transfer to a third party in compliance with General Condition 4 below. Should you wish to cease to maintain the authorized activity or should you desire to abandon it without a good faith transfer, you must obtain a modification of this permit from this office, which may require restoration of the area.
3. If you discover any previously unknown historic or archeological remains while accomplishing the activity authorized by this permit, you must immediately notify this office of what you have found. We will initiate the Federal and state coordination required to determine if the remains warrant a recovery effort or if the site is eligible for listing in the National Register of Historic Places.

4. If you sell the property associated with this permit, you must obtain the signature of the new owner in the space provided and forward a copy of the permit to this office to validate the transfer of this authorization.
5. If a conditioned water quality certification has been issued for your project, you must comply with the conditions specified in the certification as special conditions to this permit. For your convenience, a copy of the certification is attached if it contains such conditions.
6. You must allow representatives from this office to inspect the authorized activity at any time deemed necessary to ensure that it is being or has been accomplished in accordance with the terms and conditions of your permit.

Special Conditions:

See enclosed sheet.

Further Information:

1. **Congressional Authorities:** You have been authorized to undertake the activity described above pursuant to:
 - () Section 10 of the Rivers and Harbors Act of 1899 (33 U.S.C. 403).
 - (X) Section 404 of the Clean Water Act (33 U.S.C. 1344).
 - () Section 103 of the Marine Protection, Research and Sanctuaries Act of 1972 (33 U.S.C. 1413).
2. **Limits of this authorization.**
 - a. This permit does not obviate the need to obtain other Federal, state, or local authorizations required by law.
 - b. This permit does not grant any property rights or exclusive privileges.
 - c. This permit does not authorize any injury to the property or rights of others.
 - d. This permit does not authorize interference with any existing or proposed Federal project.
3. **Limits of Federal Liability.** In issuing this permit, the Federal Government does not assume any liability for the following:
 - a. Damages to the permitted project or uses thereof as a result of other permitted or unpermitted activities or from natural causes.
 - b. Damages to the permitted project or uses thereof as a result of current or future activities undertaken by or on behalf of the United States in the public interest.
 - c. Damages to persons, property, or to other permitted or unpermitted activities or structures caused by the activity authorized by this permit.
 - d. Design or construction deficiencies associated with the permitted work.

e. Damage claims associated with any future modification, suspension, or revocation of this permit.

4. Reliance on Applicant's Data: The determination of this office that issuance of this permit is not contrary to the public interest was made in reliance on the information you provided.

5. Reevaluation of Permit Decision. This office may reevaluate its decision on this permit at any time the circumstances warrant. Circumstances that could require a reevaluation include, but are not limited to, the following:

a. You fail to comply with the terms and conditions of this permit.

b. The information provided by you in support of your permit application proves to have been false, incomplete, or inaccurate (See 4 above).

c. Significant new information surfaces which this office did not consider in reaching the original public interest decision.

Such a reevaluation may result in a determination that it is appropriate to use the suspension, modification, and revocation procedures contained in 33 CFR 325.7 or enforcement procedures such as those contained in 33 CFR 326.4 and 326.5. The referenced enforcement procedures provide for the issuance of an administrative order requiring you to comply with the terms and conditions of your permit and for the initiation of legal action where appropriate. You will be required to pay for any corrective measures ordered by this office, and if you fail to comply with such directive, this office may in certain situations (such as those specified in 33 CFR 209.170) accomplish the corrective measures by contract or otherwise and bill you for the cost.

6. Extensions. General condition 1 establishes a time limit for the completion of the activity authorized by this permit. Unless there are circumstances requiring either a prompt completion of the authorized activity or a reevaluation of the public interest decision, the Corps will normally give favorable consideration to a request for an extension of this time limit.

Your signature below, as permittee, indicates that you accept and agree to comply with the terms and conditions of this permit.

William D. Stueve
(PERMITTEE)
NC DEPARTMENT OF TRANSPORTATION

28 May 2007
(DATE)

This permit becomes effective when the Federal official, designated to act for the Secretary of the Army, has signed below.

(DISTRICT ENGINEER)
JAMES W. DELONY, COLONEL

(DATE)

When the structures or work authorized by this permit are still in existence at the time the property is transferred, the terms and conditions of this permit will continue to be binding on the new owner(s) of the property. To validate the transfer of this permit and the associated liabilities associated with compliance with its terms and conditions, have the transferee sign and date below.

(TRANSFEREE)

(DATE)



150

Revised 6-5-02

DEPARTMENT OF THE ARMY
WILMINGTON DISTRICT, CORPS OF ENGINEERS

P.O. BOX 1890
WILMINGTON, NORTH CAROLINA 28402-1890

IN REPLY REFER TO

May 28, 2002

Regulatory Division

SUBJECT: Action ID 2002-2-0899, TIP No. R-2417

Mr. William D. Gilmore, P.E., Manager
Project Development and Environmental Analysis Branch
North Carolina Department of Transportation
Division of Highways
1548 Mail Service Center
Raleigh, North Carolina 27699-1548

Dear Mr. Gilmore:

In accordance with your written request of June 11, 2001, subsequently modified on June 22, 2001, and September 28, 2001, and the resulting administrative record, enclosed are two copies of a Department of the Army permit to authorize the discharge of dredged and fill material into waters of the United States, for construction of the US 421-NC 87 Sanford Bypass (T.I.P. No. R-2417), in the Cape Fear River Basin, in Lee County, North Carolina.

You should acknowledge that you accept the terms and conditions of the enclosed permit by signing and dating each copy in the spaces provided ("Permittee" on page 3). Your signature, as permittee, shows that, as consideration for the issuance of this permit, you voluntarily accept and agree to comply with all of the terms and conditions of this permit. All pages of both copies of the signed permit with drawings should then be returned to this office for final authorization. A self-addressed envelope is enclosed for your convenience.

After the permit is authorized in this office, the original copy will be returned to you; the duplicate copy will be permanently retained in this office. Should you have questions, contact Mr. Eric Alsmeyer of my Raleigh Field Office regulatory staff at telephone (919) 876-8441, extension 23.

Sincerely,

E. David Franklin
Chief, NCDOT Team

Enclosures

Blind Copies Furnished:

CESAW-RG-R/Alsmeyer

CESAW-RG-R/Manuele

CESAW-RG-R/COMPLIANCE FILE (with Permit and Conditions)

SUSPENSE

SPECIAL CONDITIONS (Action ID. 2002-2-0899; NCDOT/TIP R-2417)

a. All work authorized by this permit must be prepared in strict compliance with the attached plans, which are a part of this permit.

b. The permittee shall mitigate for 11.06 acres of unavoidable impacts to wetlands, and for 19,222 linear feet of impact to important streams, for the project, as described below (2.21 acres of wetland restoration at the Sandy Creek mitigation site, 11.05 acres of wetlands preservation, along with upland buffer and stream preservation, at the Blue Tract mitigation site, 2,084 linear feet of onsite stream relocation, 4,545 linear feet of stream restoration/enhancement at the Deaton mitigation site, and 25,186 linear feet of stream mitigation and 17.7 acres of wetland mitigation through the North Carolina Wetlands Restoration Program (NCWRP), in the Middle Cape Fear basin (Cataloging Unit 03030004)).

SANDY CREEK WETLANDS RESTORATION

* c. The permittee shall provide the restoration described in condition d. below through implementation of the compensatory wetland mitigation plan "Wetland Mitigation Plan – Sandy Creek Site", dated April, 1999.

* d. The permittee shall mitigate for 1.105 acres of unavoidable impacts to wetlands associated with this project with 2.21 acres of wetland restoration at the Sandy Creek Mitigation Site.

* e. NCDOT will do a boundary survey of the 2.21 acres of wetland restoration at the Sandy Creek Mitigation Site, and submit a copy of the survey to the District Engineer within 90 days after the permit is issued.

* f. The permittee will monitor the site vegetation between June 1 and November 30, inclusively, of each year, and document plant mortality and stress. A minimum of three 0.05 acre sample plots will be used (placed randomly within representative positions in the restoration area). The permittee will continue monitoring of the planting areas annually until the respective performance criteria are met, as described below.

SANDY CREEK MITIGATION MONITORING

* g. Performance criteria for tree planting areas will be met if sample plots demonstrate that for each of the first three complete years of monitoring, at least 320 target-species trees per acre have survived, such that at the end of three years, at least 320 three-year old target-species trees per acre have survived on the site, and, in years four and five, at least 288 and 260 trees per acre, respectively, have survived on the site, such that at the end of year five, at least 260 five-year old target-species trees per acre have survived on the site.

* h. If for any monitoring year, vegetation survival is not favorable, as determined by the Corps of Engineers, any remedial action required by the Corps of Engineers will be performed, the required restoration areas will be replanted, and the five-year monitoring period will begin again with year one.

* i. Hydrology in the restoration areas will be monitored through the use of monitoring gauges during each growing season for the first five years of the vegetative monitoring, or until performance criteria have been met, whichever occurs later. A minimum of six groundwater gauges will be used within the total wetland restoration area at Sandy Creek.

* j. To meet the hydrology success criteria, the monitoring data must show that for each normal precipitation year within the monitoring period, the site has been inundated or saturated within the upper 12 inches of the soil for a minimum of 12.5% of the growing season (29 consecutive days for Randolph County). WETS tables for Randolph County will be utilized as appropriate to determine normal precipitation years.

* k. If there are no normal precipitation years during the first five years of monitoring, to meet performance criteria, the permittee will continue to monitor hydrology on the site until it shows that the site has been inundated or saturated as described above during a normal precipitation year.

* l. In the alternative, and at the Corps' discretion, a site may be found to meet the hydrology performance criteria on the basis of comparison of monitoring data taken from the site with monitoring data taken from an established jurisdictional mitigation reference site approved by the Corps. The Corps retains the discretion to find that the hydrology criteria are met if such monitoring data from the mitigation site and the reference site are substantially the same. This finding by the Corps may be made during years with or without normal rainfall.

* m. In the event there are years of normal precipitation during the monitoring period, and the data for those years do not show that the site has been inundated or saturated within the upper 12 inches of the soil for a minimum of 12.5 % of the growing season (29 consecutive days) during a normal precipitation year, the Corps may require remedial action. The permittee shall perform such required remedial action, and continue to monitor hydrology on the site until it displays that the site has been inundated or saturated as described above, during a normal precipitation year. If the Corps determines that further remediation is not appropriate, other options will be considered, including use of a different site to mitigate for project impacts.

* n. The permittee will submit yearly mitigation monitoring reports by the first day of February after each assessment period, for five years following final site manipulation. These reports will include, at a minimum, sample plot, well and rainfall data; number of individuals of each tree species within each sample plot; photographs, including a location key; and problems/resolution, and will be provided to both the Corps and the North Carolina Division of Water Quality.

BLUE TRACT WETLANDS PRESERVATION

* o. The permittee shall implement the compensatory wetland mitigation plan entitled "Blue Tract Mitigation Planning Document", dated June 11, 2001, to provide the preservation described in condition p. below.

* p. The permittee shall mitigate for 1.105 acres of unavoidable impacts to wetlands associated with this project with 11.05 acres of wetland preservation, and additional upland buffer and stream preservation, at the Blue Tract Mitigation Site.

* q. NCDOT will submit a copy of a boundary survey of the 11.05 acres of wetland preservation at the Blue Tract Mitigation Site, to the District Engineer within 90 days after this permit is issued.

ONSITE STREAM RELOCATION

r. The permittee shall mitigate for 2,084 linear feet of unavoidable impacts to important stream channel associated with this project by completing 2,084 linear feet of onsite stream relocation, as described in the permit application. The stream relocation shall be constructed in accordance with the North Carolina Wildlife Resources Commission's (NCWRC) "Stream Relocation Guidelines", and with the attached permit drawings. NCDOT shall consult with NCWRC on all stream relocations and implement all practicable recommendations in the design of specific site requirements for re-establishment of bank vegetation, and placement of meanders and habitat structures. Vegetation shall be used to the maximum extent practicable to stabilize banks, and riprap and other man-made structural measures shall be minimized.

s. The permittee shall construct all channel relocations in a dry work area. The permittee shall stabilize the relocated channel before stream flows are turned into the new channel. Whenever possible, channel relocations shall be allowed to stabilize for an entire growing season. Vegetation used to stabilize banks shall be limited to native woody species, and should include establishment of a 30 foot wide wooded buffer and an adjacent 20 foot wide vegetated buffer on both sides of the relocated channel to the maximum extent practical.

* t. The permittee shall visually monitor the vegetative plantings on all mitigation stream banks to assess and insure complete stabilization of the mitigation stream segments. This monitoring shall include adequate visual monitoring of planted vegetation quarterly for a minimum of two years after final planting, and appropriate remedial actions (e.g., replanting, streambank grading, etc.). If within any monitoring year, bank stabilization is not acceptable as determined by the Corps of Engineers, and remedial action required by the Corps of Engineers is performed, the two year monitoring of the affected portions of the stream will begin again. The permittee will coordinate

stream mitigation activities with the Corps of Engineers, Raleigh Regulatory Field Office Project Manager, and will report verbally on the status of the stream mitigation within thirty days of the quarterly monitoring. The permittee will submit a brief written report with representative photographs within 90 days after the monitoring year is completed.

DEATON SITE STREAM MITIGATION

* u. The permittee shall mitigate for 4,545 linear feet of unavoidable impacts to stream channel associated with this project with 4,545 linear feet of stream restoration at the Deaton Mitigation Site, as described in the Deaton Site stream mitigation plan.

* v. The permittee shall visually monitor the vegetative plantings on the mitigation stream banks to assess and insure complete stabilization of the mitigation stream segments. This monitoring shall include adequate visual monitoring of planted vegetation quarterly for a minimum of two years after final planting, and appropriate remedial actions (e.g., replanting, streambank grading, etc.). The permittee will coordinate with the Corps of Engineers, Raleigh Regulatory Field Office NCDOT Regulatory Project Manager, and will report verbally on the status of the stream mitigation, within thirty days of the quarterly monitoring. The permittee will submit a brief report with representative photographs within 90 days after the monitoring year is completed.

* w. All site preparation activities at the Deaton Mitigation Site shall be completed before October 1, 2003. An "as built" plan, which describes the completed mitigation project, including variations from the original plan, final structure locations, and photographs, including a location key, shall be submitted to the District Engineer within 60 days of completion of the mitigation. NCDOT shall submit the first monitoring report to both the Corps and the North Carolina Division of Water Quality before February 1, 2003.

GENERAL MITIGATION

* x. The permittee and/or current and subsequent property owners shall maintain the Sandy Creek, Blue Tract, and Deaton Mitigation Sites in their natural condition, as altered by work in the mitigation plans, in perpetuity. Prohibited activities within the mitigation sites specifically include, but are not limited to: the construction or placement of roads, walkways, buildings, signs, or structures of any kind (i.e., billboards, interior fences, etc.); filling, grading, excavation, leveling, or any other earth moving activity or activity that may alter the drainage patterns on the property; the cutting, mowing, destruction, removal, or other damage of any vegetation; disposal or storage of any debris, trash, garbage, or other waste material; except as may be authorized by the mitigation plans, or subsequent modifications that are approved by the Corps of Engineers. In addition, the permittee shall take no action, whether on or off the mitigation properties, which will adversely impact the wetlands or streams on the mitigation properties, except as specifically authorized by this permit, or subsequent modifications that are approved by the Corps of Engineers.

*y. The permittee shall make every effort to convey the Sandy Creek, and Blue Tract Mitigation Site properties to a nonprofit conservation organization or a natural resource agency, which is willing to hold the areas in perpetuity for conservation purposes, and which is acceptable to the Corps of Engineers. The annual monitoring reports, as required, will include the status of the conveyance efforts.

*z. The permittee shall not sell or otherwise convey any interest in the wetland mitigation properties used to satisfy mitigation requirements for this permit, to any third party, without written approval from the Wilmington Corps of Engineers.

*aa. Any sale, lease, or other conveyance of the wetland mitigation site properties shall include restrictions on the use of the properties as described in condition y. above, which conditions shall be enforced by the North Carolina Department of Transportation. Such restrictions shall include language providing for third party enforcement rights in favor of the Corps of Engineers. Such restrictions must be approved by the Corps of Engineers prior to conveyance.

NCWRP WETLANDS MITIGATION

*bb. The permittee shall mitigate for 8.85 acres of unavoidable impacts to wetlands associated with this project by payment to the North Carolina Wetlands Restoration Program (NCWRP) in an amount determined by the NCWRP sufficient to perform 17.7 acres of riparian, palustrine forested wetland mitigation in the middle Cape Fear River basin (Cataloging Unit 03030004). Construction within wetlands on the permitted highway project shall begin only after the permittee has made full payment to the NCWRP, and the NCWRP has made written confirmation to the District Engineer, that it agrees to accept responsibility for the mitigation work required, pursuant to Paragraph IV.D. of the Memorandum of Understanding between the North Carolina Department of Environment and Natural Resources and the U.S. Army Corps of Engineers, Wilmington District, dated November 4, 1998.

NCWRP STREAM MITIGATION

*cc. The permittee shall mitigate for 12,593 linear feet of unavoidable impacts to important stream channel associated with this project by payment to the North Carolina Wetlands Restoration Program (NCWRP) in an amount determined by the NCWRP sufficient to perform 25,186 linear feet of warm water stream mitigation, or the equivalent water quality improvement projects, as approved by the Corps of Engineers, in the middle Cape Fear River basin (Cataloging Unit 03030004). Construction within streams on the permitted highway project shall begin only after the permittee has made full payment to the NCWRP, and the NCWRP has made written confirmation to the District Engineer, that it agrees to accept responsibility for the mitigation work required, pursuant to Paragraph IV.D. of the Memorandum of Understanding between the North Carolina Department of Environment and Natural Resources and the U.S. Army Corps of Engineers, Wilmington District, dated November 4, 1998.

GENERAL MITIGATION

* dd. The permittee shall contact the Corps of Engineers, Raleigh Regulatory Field Office NCDOT Regulatory Project Manager for this project, to provide that individual with the opportunity to attend the yearly mitigation monitoring efforts.

* ee. Failure to institute and carry out the details of special conditions a. - dd, above, will result in a directive to cease all ongoing and permitted work within waters and/or wetlands associated with the permitted project, or such other remedy as the District Engineer or his authorized representatives may seek.

OTHER CONDITIONS

* ff. When final design plans are completed for Sections AA and C of TIP R-2417, any necessary permit modifications shall be submitted to the District Engineer and the North Carolina Division of Water Quality (NCDWQ). If necessary, a public notice will be circulated for review. Final designs shall reflect all appropriate avoidance, minimization, and a compensatory mitigation plan for additional impacts within streams and wetlands. Construction within streams and wetlands on TIP R-2417 shall begin only after approval by the District Engineer of the modified impacts.

gg. NCDOT shall use "High Quality Waters" sedimentation and erosion control measures for all portions of the project west of SR 1415.

* hh. Prior to commencing construction within jurisdictional waters of the United States for any section, the permittee shall forward the latest version of project construction drawings for that section to the Corps of Engineers, Raleigh Regulatory Field Office NCDOT Regulatory Project Manager. Half-size drawings are acceptable.

* ii. The permittee shall schedule a meeting between its representatives, the contractor's representatives, and the Corps of Engineers, Raleigh Regulatory Field Office NCDOT Regulatory Project Manager, prior to any work within jurisdictional waters and wetlands in each section, to ensure that there is a mutual understanding of all of the terms and conditions contained within this Department of the Army Permit. The permittee shall notify the Corps of Engineers Project Manager a minimum of thirty (30) days in advance of the scheduled meetings in order to provide that individual with ample opportunity to schedule and participate in the required meetings.

jj. The permittee and its contractors and/or agents shall not excavate, fill, or perform mechanized landclearing at any time in the construction or maintenance of this project within waters and/or wetlands, except as authorized by this permit, or any modification to this permit. There shall be no excavation from, or waste disposal into,

jurisdictional wetlands or waters associated with this permit without appropriate modification of this permit, including appropriate compensatory mitigation. This prohibition applies to all borrow and fill activities connected with this project.

kk. To ensure that all borrow and waste activities occur on high ground, except as authorized by this permit, the permittee shall require its contractors and/or agents to identify all areas to be used to borrow material, or to dispose of dredged, fill, or waste material. The permittee shall ensure that all such areas comply with the preceding condition (jj.) of this permit, and shall require and maintain documentation of the location and characteristics of all borrow and disposal sites associated with this project. This information will include data regarding soils, vegetation and hydrology sufficient to clearly demonstrate compliance with the preceding condition (jj.). All information will be available to the Corps of Engineers upon request.

ll. The permittee shall comply with the conditions specified in the water quality certification, No. 3378, issued by the North Carolina Division of Water Quality on April 10, 2002.

mm. The permittee shall place culverts and other structures in waters, streams, and wetlands below the elevation of the streambed to allow low flow passage of water and aquatic life, unless providing passage would be impractical. Design and placement of culverts and other structures including temporary erosion control measures shall not be conducted in a manner that may result in dis-equilibrium of wetlands or streambeds or banks, adjacent to, or upstream and downstream of the structures.

nn. The permittee shall use appropriate sediment and erosion control practices which equal or exceed those outlined in the most recent version of the "North Carolina Sediment and Erosion Control Planning and Design Manual" to assure compliance with the appropriate turbidity water quality standard (50 NTU's in all streams and rivers, and 25 NTU's in all lakes).

oo. The permittee shall remove all sediment and erosion control measures placed in wetlands or waters, and shall restore natural grades in those areas, prior to project completion.

pp. The permittee shall take measures to prevent live or fresh concrete from coming into contact with any surface waters until the concrete has hardened.

qq. If the permittee discovers any previously unknown historic or archeological remains while accomplishing the authorized work, he will immediately notify the Wilmington District Engineer who will initiate the required State/Federal coordination.

rr. No excavated or fill material will be placed at any time in waters or wetlands outside the permitted construction areas, nor will it be placed in any location or in any manner so as to impair surface water flow into or out of any wetland area.

ss. The permittee will maintain the authorized work in good condition and in conformance with the terms and conditions of this permit. The permittee is not relieved of this requirement if he abandons the permitted activity without transferring it to a third party.

tt. All fill material will be clean and free of any pollutants except in trace quantities. Metal products, organic materials, or unsightly debris will not be used.

uu. This Department of the Army permit does not obviate the need to obtain other Federal, State, or local authorizations required by law.

vv. This permit does not grant any property rights or exclusive privileges.

ww. In issuing this permit, the Federal Government does not assume any liability for:

1. Damages to the permitted project or uses thereof as a result of other permitted or unpermitted activities or from natural causes.
2. Damages to the permitted project or uses thereof as a result of current or future Federal activities initiated on behalf of the general public.
3. Damages to other permitted or unpermitted activities or structures caused by the authorized activity.
4. Design and construction deficiencies associated with the permitted work.
5. Damage claims associated with any future modification, suspension, or revocation of this permit.

State of North Carolina
Department of Environment
and Natural Resources
Division of Water Quality

160



NORTH CAROLINA DEPARTMENT OF
ENVIRONMENT AND NATURAL RESOURCES

Michael F. Easley, Governor
William G. Ross, Jr., Secretary
Gregory J. Thorpe, Ph.D., Acting Director

April 10, 2002

Mr. William D. Gilmore, P.E., Manager
Planning and Environmental Branch
North Carolina Department of Transportation
1548 Mail Service Center
Raleigh, North Carolina, 27699-1548

Dear Mr. Gilmore:

Re: 401 Water Quality Certification Pursuant to Section 401 of the Federal Clean Water Act,
Proposed US 421-NC 87 Sanford Bypass from existing US 421 northwest of Sanford to existing NC
87 southeast of Sanford in Lee County (TIP R-2417).
WQC Project No. 001432

Attached hereto is a copy of Certification No. 3378 issued to The North Carolina Department of Transportation dated April 9, 2002. You have our approval, in accordance with the attached conditions and those listed below, to place fill material in 11.06 acres of jurisdictional wetlands, 23,640 linear feet of streams, and 6.32 acres of other surface waters (ponds). In addition, 0.1 acres of temporary impacts to jurisdictional wetlands at Section BB Site 2 are authorized. The project shall be constructed in accordance with your application dated June 11, 2001, and the subsequent addendums dated June 22, 2001, August 31, 2001, and September 28, 2001. Any proposed site plans submitted in the June 11, 2001 application that have a subsequent revised site plan submitted in the June 22, 2001, August 31, 2001, or September 28, 2001 addendums are not authorized by this certification. Instead, for all impacts where a proposed site design as provided in the original June 11, 2001 application was revised and submitted in the the June 22, 2001, August 31, 2001, or September 28, 2001 addendums, the drawings with the latest date of revision are authorized. The purpose of the authorized impacts is the construction of the US 421-NC 87 Sanford Bypass from existing US 421 northwest of Sanford to existing NC 87 southeast of Sanford in Lee County (TIP R-2417).

If we can be of further assistance, do not hesitate to contact us.

Sincerely,

Gregory J. Thorpe, Ph.D.
Acting Director

Wetlands/401 Unit

1650 Mail Service Center
Telephone 919-733-1786
An Equal Opportunity Affirmative Action Employer

Raleigh, North Carolina 27699-1621
FAX 733-6893
50% recycled/10% post consumer paper

State of North Carolina
Department of Environment
and Natural Resources
Division of Water Quality

161



Michael F. Easley, Governor
William G. Ross, Jr., Secretary
Gregory J. Thorpe, Ph.D., Acting Director

Attachments

cc: Wilmington District Corps of Engineers
Corps of Engineers Raleigh Field Office
DWQ Raleigh Regional Office
Ron Ferrell, Wetlands Restoration Program
Central Files
File Copy

Wetlands/401 Unit

1650 Mail Service Center

Raleigh, North Carolina 27699-1621

Telephone 919-733-1786

FAX 733-6893

An Equal Opportunity Affirmative Action Employer

50% recycled/10% post consumer paper

State of North Carolina
 Department of Environment
 and Natural Resources
 Division of Water Quality



Michael F. Easley, Governor
 William G. Ross, Jr., Secretary
 Gregory J. Thorpe, Ph.D., Acting Director

APPROVAL OF 401 Water Quality Certification

THIS CERTIFICATION is issued in conformity with the requirements of Section 401 Public Laws 92-500 and 95-217 of the United States and subject to the North Carolina Division of Water Quality (DWQ) Regulations in 15A NCAC 2H. Section .0500, and 15A NCAC 2B .0233. You have our approval, in accordance with the attached conditions and those listed below, to place fill material in 11.06 acres of jurisdictional wetlands, 23,640 linear feet of streams, and 6.32 acres of other surface waters (ponds). In addition, 0.1 acres of temporary impacts to jurisdictional wetlands at Section BB Site 2 are authorized. The project shall be constructed in accordance with your application dated June 11, 2001, and the subsequent addendums dated June 22, 2001, August 31, 2001, and September 28, 2001. Any proposed site plans submitted in the June 11, 2001 application that have a subsequent revised site plan submitted in the June 22, 2001, August 31, 2001, or September 28, 2001 addendums are not authorized by this certification. Instead, for all impacts where a proposed site design as provided in the original June 11, 2001 application was revised and submitted in the the June 22, 2001, August 31, 2001, or September 28, 2001 addendums, the drawings with the latest date of revision are authorized. The purpose of the authorized impacts is the construction of the US 421-NC 87 Sanford Bypass from existing US 421 northwest of Sanford to existing NC 87 southeast of Sanford in Lee County (TIP R-2417).

The application provides adequate assurance that the discharges of fill material into the waters of the Cape Fear River Basin in conjunction with the proposed development will not result in a violation of applicable Water Quality Standards and discharge guidelines. Therefore, the State of North Carolina certifies that this activity will not violate the applicable portions of Sections 301, 302, 303, 306, 307 of PL 92-500 and PL 95-217 if conducted in accordance with the application and conditions hereinafter set forth.

This approval is only valid for the purpose and design that you submitted in your application, as described in the Public Notice. Should your project change, you are required to notify the DWQ and submit a new application. If the property is sold, the new owner must be given a copy of this Certification and approval letter, and is thereby responsible for complying with all the conditions. Any additional impacts to wetlands, streams, or buffers, for this project (now or in the future) will require additional compensatory mitigation may be required as described in 15A NCAC 2H .0506 (h) (6) and (7), and 15A NCAC 2B .0233. For this approval to remain valid, you are required to comply with all the conditions listed below. In addition, you should obtain all other federal, state or local permits before proceeding with your project including (but not limited to) Sediment and Erosion control, Coastal Stormwater, Non-discharge and Water Supply watershed regulations. This Certification shall expire three years from the date of the cover letter from DWQ or on the same day as the expiration date of the corresponding Corps of Engineers Permit, whichever is sooner.

Condition(s) of Certification:

1. Appropriate sediment and erosion control practices which equal or exceed those outlined in the most recent version of the "North Carolina Sediment and Erosion Control Planning and Design Manual" or the "North Carolina Surface Mining Manual" whichever is more appropriate (available from the Division of Land Resources (DLR) in the DENR Regional or Central Offices) shall be in full compliance with all specifications governing the proper design, installation and operation and maintenance of such Best Management Practices in order to assure compliance with

Wetlands/401 Unit

1650 Mail Service Center

Raleigh, North Carolina 27699-1621

Telephone 919-733-1786

FAX 733-6893

An Equal Opportunity Affirmative Action Employer

50% recycled/10% post consumer paper

State of North Carolina
Department of Environment
and Natural Resources
Division of Water Quality



Michael F. Easley, Governor
William G. Ross, Jr., Secretary
Gregory J. Thorpe, Ph.D., Acting Director

the appropriate turbidity water quality standard (50 NTUs in all fresh water streams and rivers not designated as trout waters; 25 NTUs in all lakes and reservoirs, and all saltwater classes; and 10 NTUs in trout waters);

2. Sediment and erosion control measures shall not be placed in wetlands or waters to the maximum extent practicable. If placement of sediment and erosion control devices in wetlands and waters is unavoidable, they shall be removed and the natural grade restored after the Division of Land Resources has released the project;
3. If an environmental document is required, this Certification is not valid until a FONSI or ROD is issued by the State Clearinghouse. All water quality-related conditions of the FONSI or ROD shall become conditions of this Certification;
4. Measures shall be taken to prevent live or fresh concrete from coming into contact with waters of the state until the concrete has hardened;
5. There shall be no excavation from or waste disposal into jurisdictional wetlands or waters associated with this permit without appropriate modification of this permit. Should waste or borrow sites be located in wetlands or stream, compensatory mitigation will be required since it is a direct impact from road construction activities.
6. All channel relocations will be constructed in a dry work area, and stabilized before stream flows are diverted. Channel relocations will be completed and stabilized prior to diverting water into the new channel. Whenever possible, channel relocations shall be allowed to stabilize for an entire growing season. Vegetation used for bank stabilization shall be limited to native woody species, and should include establishment of a 30 foot wide wooded and an adjacent 20 foot wide vegetated buffer on both sides of the relocated channel to the maximum extent practical. A transitional phase incorporating coir fiber and seedling establishment is allowable. Also, rip-rap may be allowed if it is necessary to maintain the physical integrity of the stream, but the applicant must provide written justification and any calculations used to determine the extent of rip-rap coverage requested.
7. Compensatory mitigation for impacts to streams shall be done for 17,138 linear feet of stream impact (4,545 linear feet in Hydrologic Unit 03030003 and 12,593 linear feet in Hydrologic Unit 03030004) at a replacement ratio of 1:1. Compensatory mitigation for impacts to jurisdictional streams shall be provided by onsite stream relocations of 144 linear feet of streams on site (in Hydrologic Unit 03030004) as described in the June 11, 2001 application for Sites 14 and 22 in segment BA. In addition, compensatory mitigation for impacts to jurisdictional streams shall be provided by onsite stream relocations of 1930 linear feet of streams on site (in Hydrologic Unit 03030004) as described in the September 28, 2001 addendum for Site 6 in segment BB. All stream relocations shall have 50-foot wooded buffers planted on both sides of the stream. As-Builts for the completed streams shall be submitted to the North Carolina Division of Water Quality 401 Wetlands Unit within 30 days of the completion of the construction of the relocations. If the parameters of this condition are not met, then the NCDOT shall supply additional stream mitigation for the 2074 linear feet of impacts. In addition to the 2,074 linear

Wetlands/401 Unit

1650 Mail Service Center
Telephone 919-733-1786
An Equal Opportunity Affirmative Action Employer

Raleigh, North Carolina 27699-1621
FAX 733-6893
50% recycled/10% post consumer paper

State of North Carolina
 Department of Environment
 and Natural Resources
 Division of Water Quality

164

Revised 6-5-02



NORTH CAROLINA DEPARTMENT OF
 ENVIRONMENT AND NATURAL RESOURCES

Michael F. Easley, Governor
 William G. Ross, Jr., Secretary
 Gregory J. Thorpe, Ph.D., Acting Director

feet of on-site mitigation. compensatory mitigation for an additional 15,064 linear feet of streams is required as described below:

Mitigation Site	Linear Feet Debited from Site	Type of Mitigation	Replacement Ratio	Linear Feet of Mitigation Credited
Hydrologic Unit 03030003				
D Eaton Mitigation Site	4,545	Restoration	1:1	4,545
Hydrologic Unit 03030004				
On-site	2,074	Restoration	1:1	2,074
WRP	10,519	Restoration	1:1	10,519
Total				17,138

We understand that you have chosen to perform compensatory mitigation for some of your impacts to streams through an in lieu payment to the North Carolina Wetland Restoration Program (NCWRP), and that the WRP has agreed to implement the mitigation for the project. Mitigation for unavoidable impacts to 10,519 linear feet of streams shall be provided through an in-lieu payment to the North Carolina Wetlands Restoration Program (NCWRP) at a rate of \$125 per linear foot. Therefore, a total payment of \$ 1,314,875 shall be submitted to the NCWRP to offset the impacts. No construction activities in jurisdictional streams shall begin until payment for stream mitigation is made and the Wetland Restoration Program receives and clears your check (made payable to DENR - Wetland Restoration Program). The payment to NCWRP shall be sent within two months of issuance of the 404 permit. If you have any questions concerning the Wetland Restoration Program please contact them at 919-733-5208.

- Compensatory mitigation for impacts to wetlands shall be done for 11.06 acres of impacts (2.21 in Hydrologic Unit 03030003 and 8.85 in Hydrologic Unit 03030004). Applying a replacement ratio of 2:1 total mitigation for 22.12 acres of riparian wetlands (4.42 in Hydrologic Unit 03030003 and 17.70 acres in Hydrologic Unit 03030004) shall be provided as described below.

Wetlands/401 Unit

1650 Mail Service Center

Raleigh, North Carolina 27699-1621

Telephone 919-733-1786

FAX 733-6893

An Equal Opportunity Affirmative Action Employer

50% recycled/10% post consumer paper

State of North Carolina
 Department of Environment
 and Natural Resources
 Division of Water Quality

165

Revised 6-5-02



Michael F. Easley, Governor
 William G. Ross, Jr., Secretary
 Gregory J. Thorpe, Ph.D., Acting Director

Mitigation Site	Acres of WL Debited from Site	Type of Mitigation	Replacement Ratio	Acres of Mitigation Credited
Hydrologic Unit 03030003				
Sandy Creek Mitigation Site	2.21	Restoration	1:1	2.21
Blue Mitigation Site	11.04	Preservation	5:1	2.21
Hydrologic Unit 03030004				
WRP	17.70	Restoration	1:1	17.70
Total				22.12

- *9. Upon completion of the project, the NCDOT shall complete and return the enclosed "Certification of Completion Form" to notify DWQ when all work included in the 401 Certification has been completed. The responsible party shall complete the attached form and return it to the 401/Wetlands Unit of the Division of Water Quality upon completion of the project.
- 10. Placement of culverts and other structures in waters, streams, and wetlands must be placed below the elevation of the streambed to allow low flow passage of water and aquatic life unless it can be shown to DWQ that providing passage would be impractical. Design and placement of culverts and other structures including temporary erosion control measures shall not be conducted in a manner that may result in dis-equilibrium of wetlands or stream beds or banks, adjacent to or upstream and down stream of the above structures. The applicant is required to provide evidence that the equilibrium shall be maintained if requested in writing by DWQ.
- *11. When final design plans are completed for Sections R-2417 AA, and R-2417 C, a modification to the 401 Water Quality Certification shall be submitted with seven copies and fees to the NC Division of Water Quality. Final designs shall reflect all appropriate avoidance, minimization, and mitigation for impacts to wetlands, streams, and other surface waters. Construction activities that impact any wetlands, streams, and other surface waters located in Sections R-2417 AA or Sections R-2417 C shall begin only after NCDOT applies for and receives a modified 401 Water Quality Certification from the NC Division of Water Quality.
- *12. No construction activities are authorized in Section R-2417 AA or Section R-2417 AB until a final design is approved in writing by the NC Division of Water Quality 401 Wetlands Unit for the Deaton Mitigation Site.

Wetlands/401 Unit

1650 Mail Service Center

Raleigh, North Carolina 27699-1621

Telephone 919-733-1786

FAX 733-6893

An Equal Opportunity Affirmative Action Employer

50% recycled/10% post consumer paper

State of North Carolina
 Department of Environment
 and Natural Resources
 Division of Water Quality



Michael F. Easley, Governor
 William G. Ross, Jr., Secretary
 Gregory J. Thorpe, Ph.D., Acting Director

- *13. Given the multiple set of addendums to the original application, NCDOT shall provide to the NCDWQ a final of site drawings within 2 months of the date of issuance of the 401 Water Quality Certification that reflects the authorized impacts in this certification.

Violations of any condition herein set forth shall result in revocation of this Certification and may result in criminal and/or civil penalties. This Certification shall become null and void unless the above conditions are made conditions of the Federal 404 and/or Coastal Area Management Act Permit. This Certification shall expire upon the expiration of the 404 or CAMA permit.

If this Certification is unacceptable to you have the right to an adjudicatory hearing upon written request within sixty (60) days following receipt of this Certification. This request must be in the form of a written petition conforming to Chapter 150B of the North Carolina General Statutes and filed with the Office of Administrative Hearings, P.O. Box 27447, Raleigh, N.C. 27611-7447. If modifications are made to an original Certification, you have the right to an adjudicatory hearing on the modifications upon written request within sixty (60) days following receipt of the Certification. Unless such demands are made, this Certification shall be final and binding.

This the 10th day of April 2002

DIVISION OF WATER QUALITY

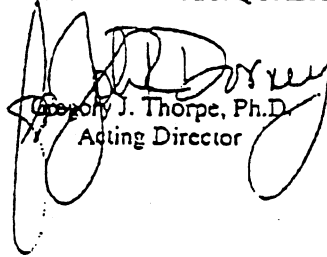
 Gregory J. Thorpe, Ph.D.
 Acting Director

WQC No. 3377

Wetlands/401 Unit

1650 Mail Service Center
 Telephone 919-733-1786
 An Equal Opportunity Affirmative Action Employer

Raleigh, North Carolina 27699-1621
 FAX 733-6893
 50% recycled/10% post consumer paper

State of North Carolina
Department of Environment
and Natural Resources
Division of Water Quality

167

Revised 6-5-02



NORTH CAROLINA DEPARTMENT OF
ENVIRONMENT AND NATURAL RESOURCES

Michael F. Easley, Governor
William G. Ross, Jr., Secretary
Gregory J. Thorpe, Ph.D., Acting Director

DWQ Project No.: _____ County: _____

Applicant: _____

Project Name: _____

Date of Issuance of 401 Water Quality Certification: _____

*** Certificate of Completion**

Upon completion of all work approved within the 401 Water Quality Certification or applicable Buffer Rules, and any subsequent modifications, the applicant is required to return this certificate to the 401/Wetlands Unit, North Carolina Division of Water Quality, 1621 Mail Service Center, Raleigh, NC, 27699-1621. This form may be returned to DWQ by the applicant, the applicant's authorized agent, or the project engineer. It is not necessary to send certificates from all of these.

Applicant's Certification

I, _____, hereby state that, to the best of my abilities, due care and diligence was used in the observation of the construction such that the construction was observed to be built within substantial compliance and intent of the 401 Water Quality Certification and Buffer Rules, the approved plans and specifications, and other supporting materials.

Signature: _____ Date: _____

Agent's Certification

I, _____, hereby state that, to the best of my abilities, due care and diligence was used in the observation of the construction such that the construction was observed to be built within substantial compliance and intent of the 401 Water Quality Certification and Buffer Rules, the approved plans and specifications, and other supporting materials.

Signature: _____ Date: _____

Engineer's Certification

_____ Partial _____ Final

I, _____, as a duly registered Professional Engineer in the State of North Carolina, having been authorized to observe (periodically, weekly, full time) the construction of the project, for the Permittee hereby state that, to the best of my abilities, due care and diligence was used in the observation of the construction such that the construction was observed to be built within substantial compliance and intent of the 401 Water Quality Certification and Buffer Rules, the approved plans and specifications, and other supporting materials.

Signature _____ Registration No. _____

Date _____

Wetlands/401 Unit

1650 Mail Service Center

Raleigh, North Carolina 27699-1621

Telephone 919-733-1786

FAX 733-6893

An Equal Opportunity Affirmative Action Employer

50% recycled/10% post consumer paper

State of North Carolina
Department of Environment
and Natural Resources
Division of Water Quality



Michael F. Easley, Governor
William G. Ross, Jr., Secretary
Gregory J. Thorpe, Ph.D., Acting Director

NORTH CAROLINA - DIVISION OF WATER QUALITY
401 WATER QUALITY CERTIFICATION
SUMMARY OF PERMITTED IMPACTS AND MITIGATION REQUIREMENTS

In accordance with 15A NCAC 2H.0500, the North Carolina Department of Transportation is authorized to impact the waters of the State of North Carolina as indicated below for the purpose of constructing the Proposed US 421-NC 87 Sanford Bypass from existing US 421 northwest of Sanford to existing NC 87 southeast of Sanford in Lee County (TIP R-2417, WQC Project No. 001432). All activities associated with these authorized impacts must be conducted in accordance with the conditions listed in the attached certification transmittal letter. **THIS CERTIFICATION IS NOT VALID WITHOUT THE ATTACHMENTS.**

COMPENSATORY MITIGATION REQUIREMENTS FOR WETLAND RESTORATION:

LOCATION: US 421 Bypass of Sanford
COUNTY: Lee
BASIN/SUBBASIN: Cape Fear, Cataloging Unit 03030003 and 03030004
DWQ No.: 001432

As required by 15A NCAC 2H.0506, and the conditions of this certification, you are required to compensate for the above impacts through the restoration, creation, enhancement or preservation of wetlands and surface waters as outlined below prior to conducting any activities that impact or degrade waters of the state. Note: Acreage requirements proposed to be mitigated through the Wetland Restoration Program must be rounded to one-quarter increments according to 15A 2R.0503(b).

17.70 acres of Class WL wetlands
17.70 acres of riparian wetlands

10.519 linear feet of stream channel

One of the options you have available to satisfy the compensatory mitigation requirements is through payment of a fee to the Wetland Restoration Fund per 15A NCAC 2R.0503. If you choose this option, please sign this form and mail it to the Wetlands Restoration Fund at the address listed below. An invoice for the appropriate amount of payment will be sent to you upon receipt of this form. **PLEASE NOTE, THE ABOVE IMPACTS ARE NOT AUTHORIZED UNTIL YOU RECEIVE NOTIFICATION THAT YOUR PAYMENT HAS BEEN PROCESSED BY THE WETLANDS RESTORATION PROGRAM.**

Signature

Date

WETLANDS RESTORATION PROGRAM
DIVISION OF WATER QUALITY
P.O. BOX 29535
RALEIGH, NC, 27626-0535
(919) 733-5208

Wetlands/401 Unit

1650 Mail Service Center

Raleigh, North Carolina 27699-1621

Telephone 919-733-1786

FAX 733-6893

An Equal Opportunity Affirmative Action Employer

50% recycled/10% post consumer paper

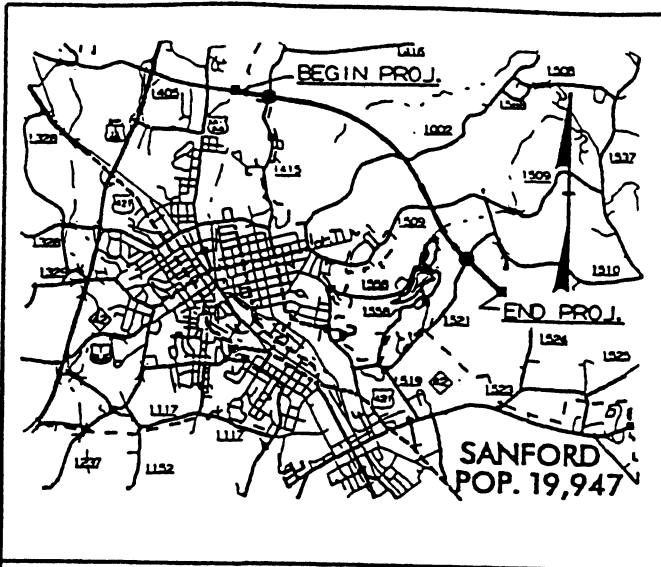

VICINITY MAP

LOCATION: US 42-NC 47 SANFORD BYPASS FROM EAST OF US 1-15-501 TO EAST OF SR 1521

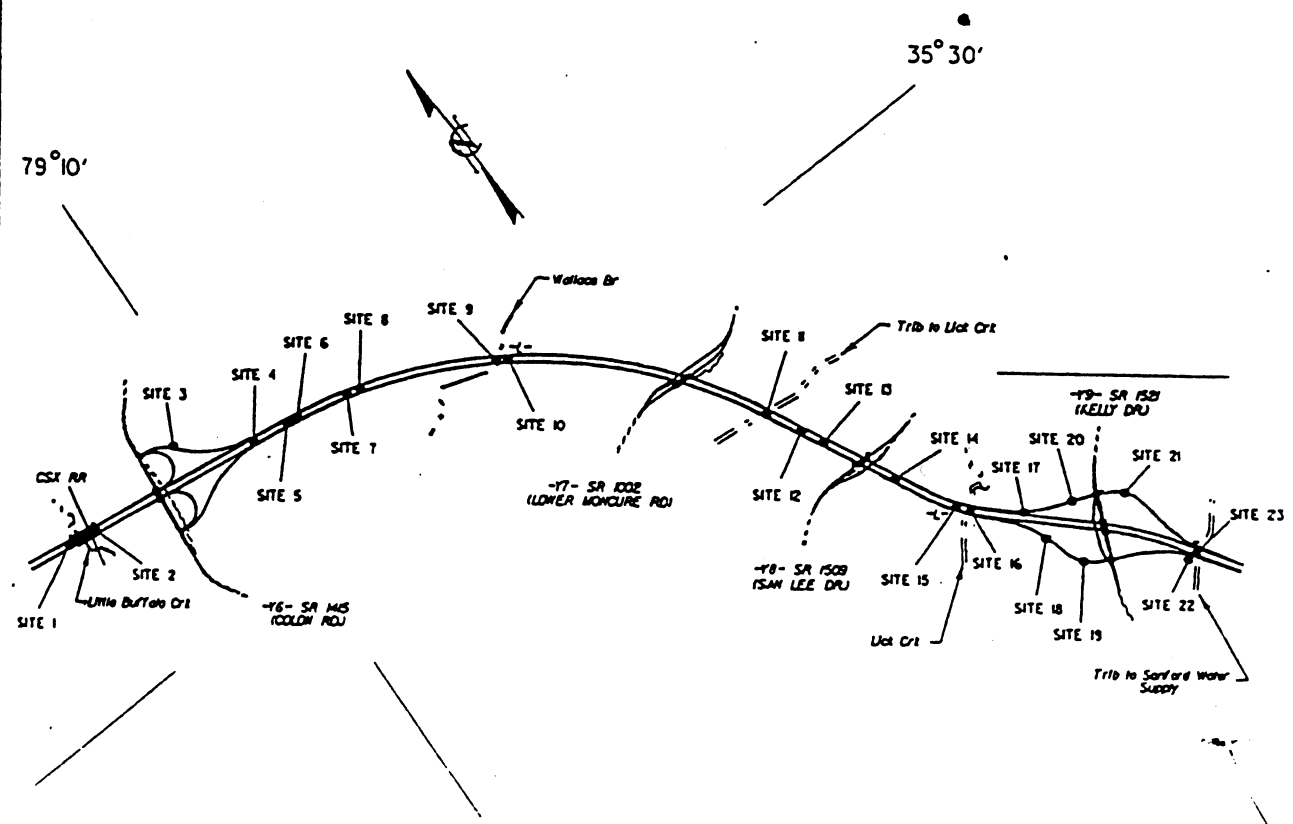

N. C. DEPT. OF TRANSPORTATION
 DIVISION OF HIGHWAYS
 LEE COUNTY
 PROJECT: 8.T540402 (R-2417BA)

SANFORD BYPASS
 October 2000 - 506

SHEET 1 OF 33

LEGEND

	LINE WT		LINE WT
WLB	4-6		6
WLB	4-6		6
F	2		6
S	2	(DASHED LINES DENOTE EXISTING STRUCTURES)	15
P	2	12'-48' PIPES	6
T	2	54' PIPES & ABOVE	6
E	2		2
TS	2		2
	2		2
	2		2
TB	2-4		2
WE	2		2
C	2	5 ADJACENT PROPERTY OWNER OR PARCEL NUMBER IF AVAILABLE	2
F	2		2
	2		2
NG	2		
PL	2		
TDE	2		
PDE	2		
EAB	2		
EPB	2		
	2		
X	2		
	6		

N. C. DEPT. OF TRANSPORTATION
 DIVISION OF HIGHWAYS
 LEE COUNTY
 PROJECT: 8.T540402 (R-2417BA)
 SANFORD BYPASS
 SHEET 2 OF 33

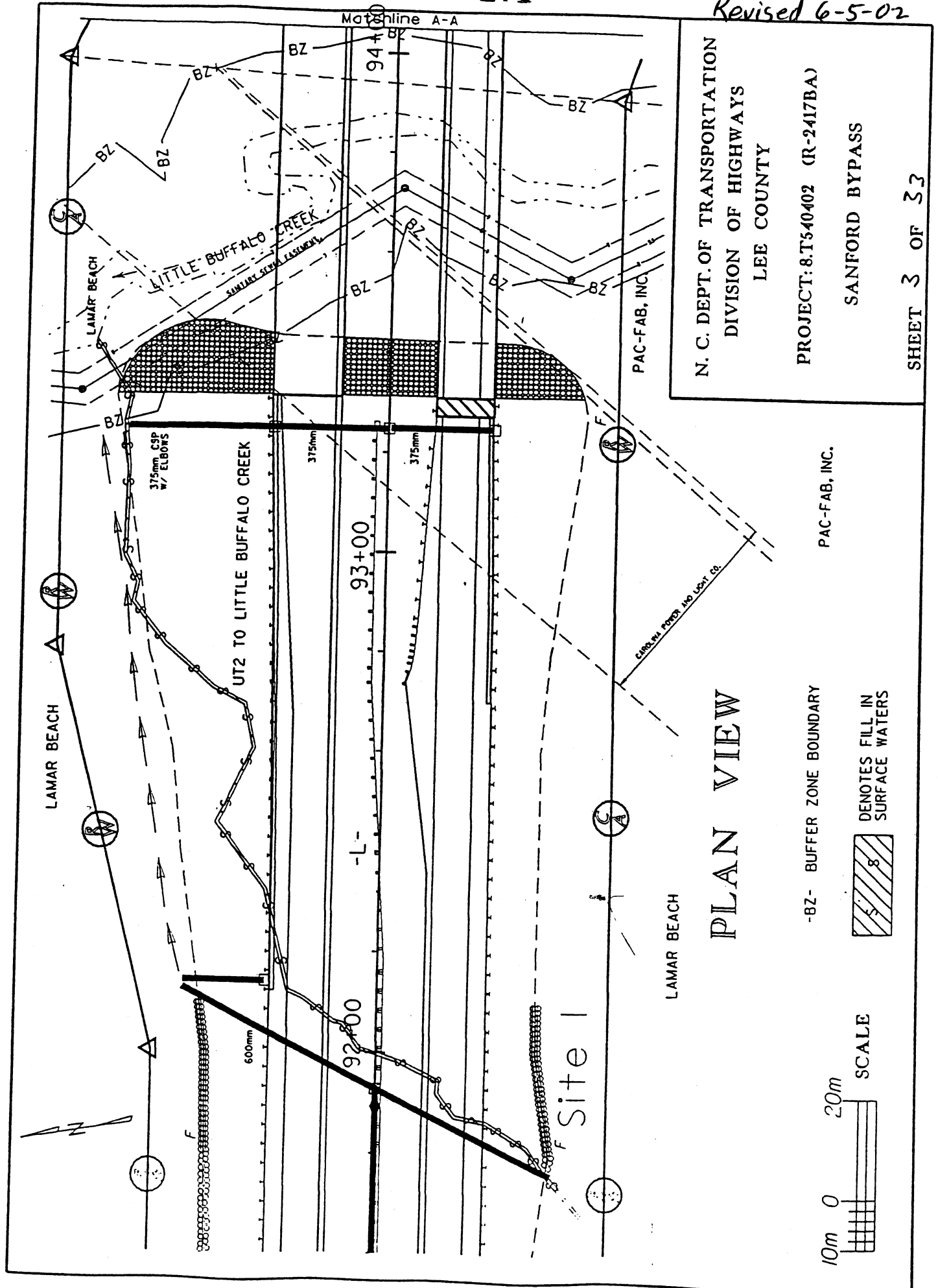

N. C. DEPT. OF TRANSPORTATION
 DIVISION OF HIGHWAYS
 LEE COUNTY

PROJECT: 8.T540402 (R-2417BA)

SANFORD BYPASS

SHEET 3 OF 33

PLAN VIEW

-BZ- BUFFER ZONE BOUNDARY

DENOTES FILL IN SURFACE WATERS

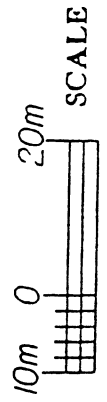

N. C. DEPT. OF TRANSPORTATION
DIVISION OF HIGHWAYS
LEE COUNTY

PROJECT: 8.T540402 (R-2417BA)

SANFORD BYPASS
October 2000-03

SHEET 4 OF 33

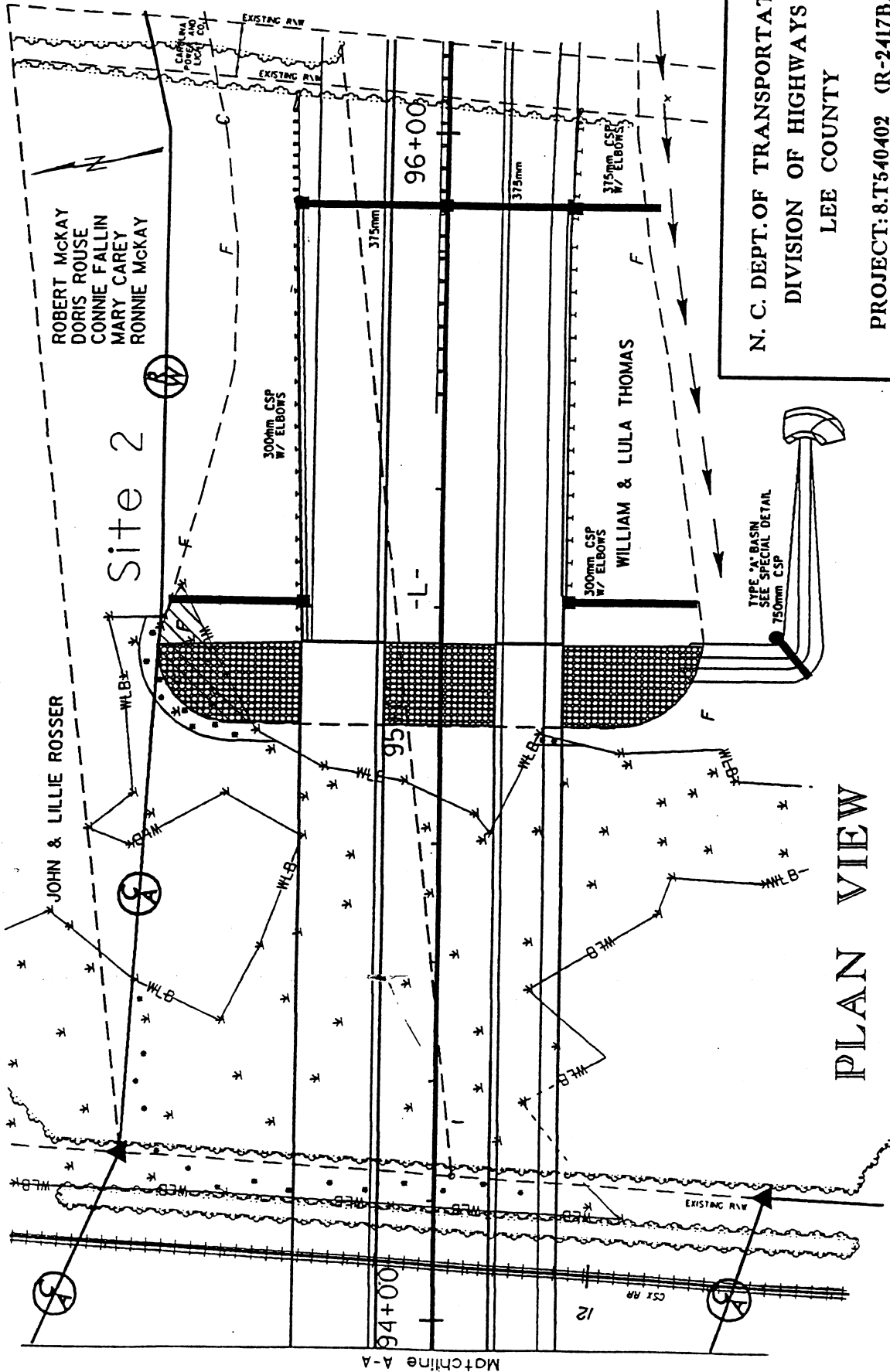

PLAN VIEW

.....
DENOTES MECHANIZED
CLEARING IN WETLANDS

.....
DENOTES FILL
IN WETLANDS

.....
DENOTES FILL
IN WETLANDS

.....
DENOTES FILL
IN WETLANDS

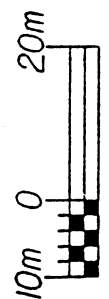

PLAN VIEW

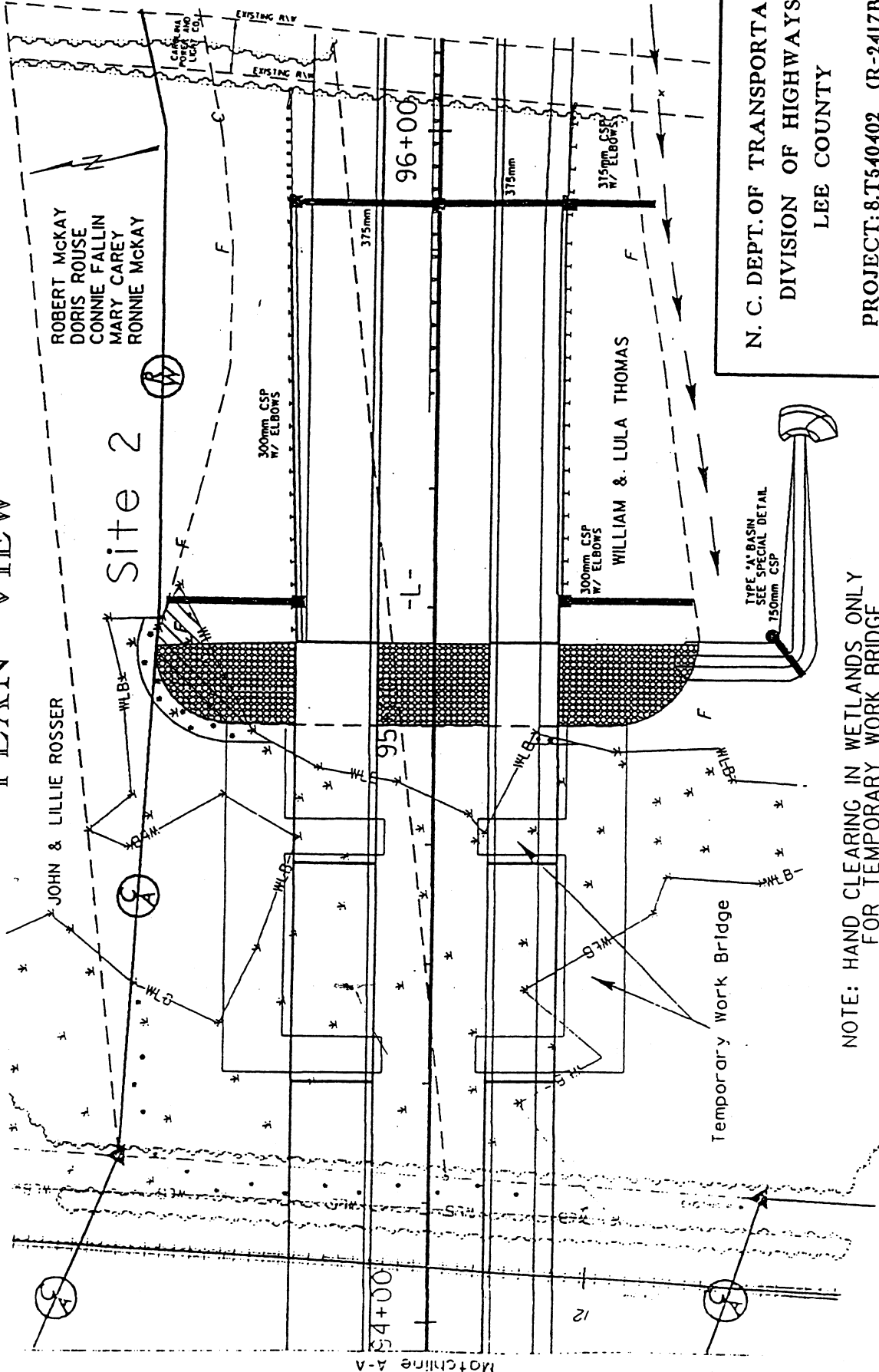

NOTE: HAND CLEARING IN WETLANDS ONLY
FOR TEMPORARY WORK BRIDGE
(NO MECHANIZED CLEARING)

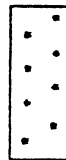
 DENOTES FILL IN WETLANDS
 DENOTES MECHANIZED CLEARING IN WETLANDS

N. C. DEPT. OF TRANSPORTATION
 DIVISION OF HIGHWAYS
 LEE COUNTY
 PROJECT: 8.T540402 (R-2417BA)
 SANFORD BYPASS
 SHEET 41 OF 38

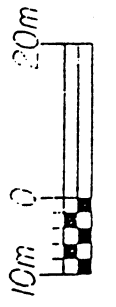

Matchline A-A

TYPICAL SECTION OF BRIDGE

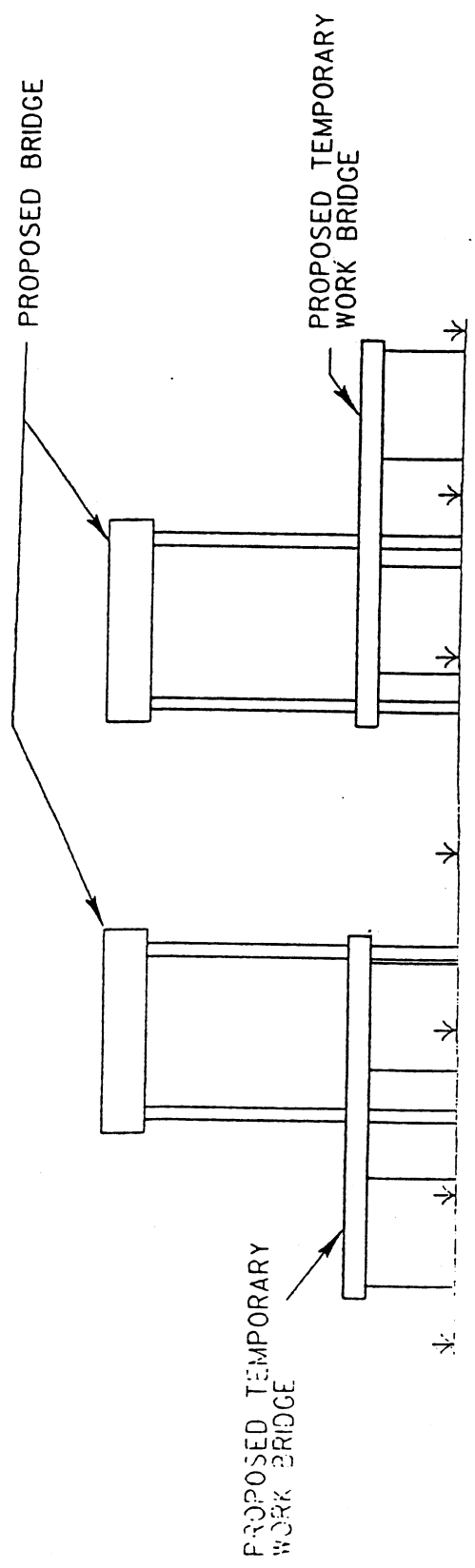

NOTE: HAND CLEARING IN WETLANDS ONLY
(NO MECHANIZED CLEARING)

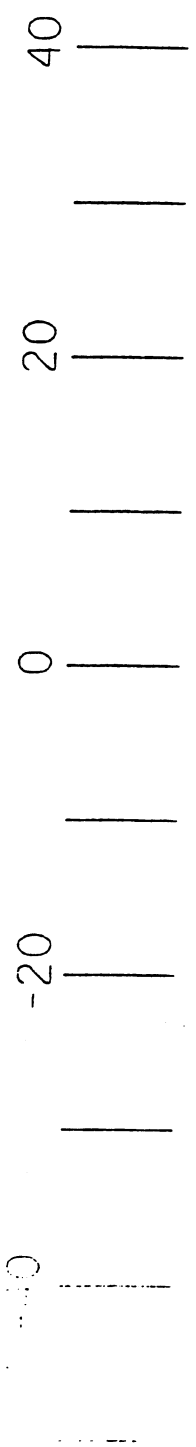

CROSS SECTION

N. C. DEPT. OF TRANSPORTATION
 DIVISION OF HIGHWAYS
 LEE COUNTY
 PROJECT: 8.T540402 (R-2417BA)
 SANFORD BYPASS



HORIZONTAL SCALE



VERTICAL SCALE

NOTE: HAND CLEARING IN WETLANDS ONLY
(NO MECHANIZED CLEARING)

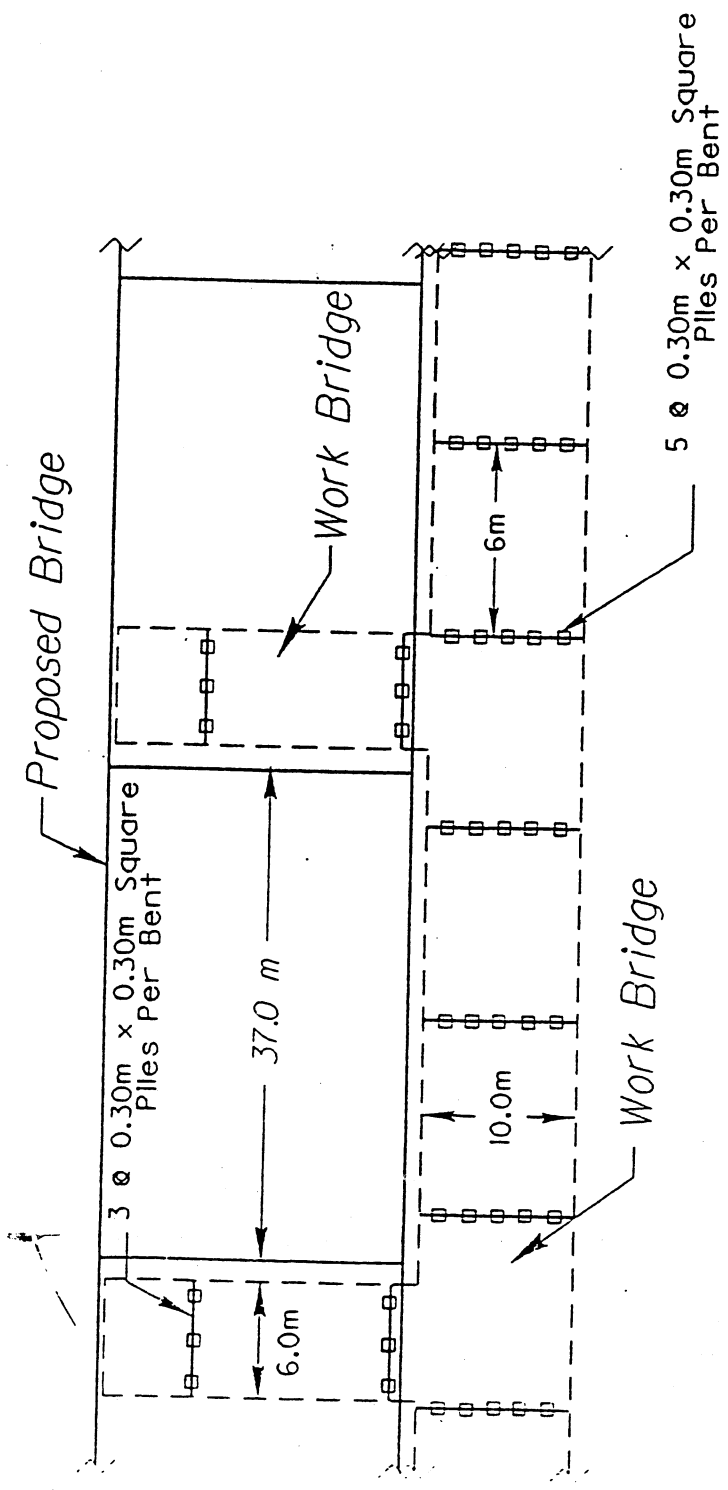

TYPICAL WORK BRIDGE

(NOT TO SCALE)

Permanent Fill In Wetlands (Piles)
= (32 piles)(1.39 sq.m./pile) = 44.4 sq.m.

Temporary Fill In Wetlands (Piles)
(111 piles)(0.30m x 0.30m) = 10.0 sq.m.

N. C. DEPT. OF TRANSPORTATION
DIVISION OF HIGHWAYS
LEE COUNTY

PROJECT: 8.T540402 (R-2417BA)
SANFORD BYPASS

176

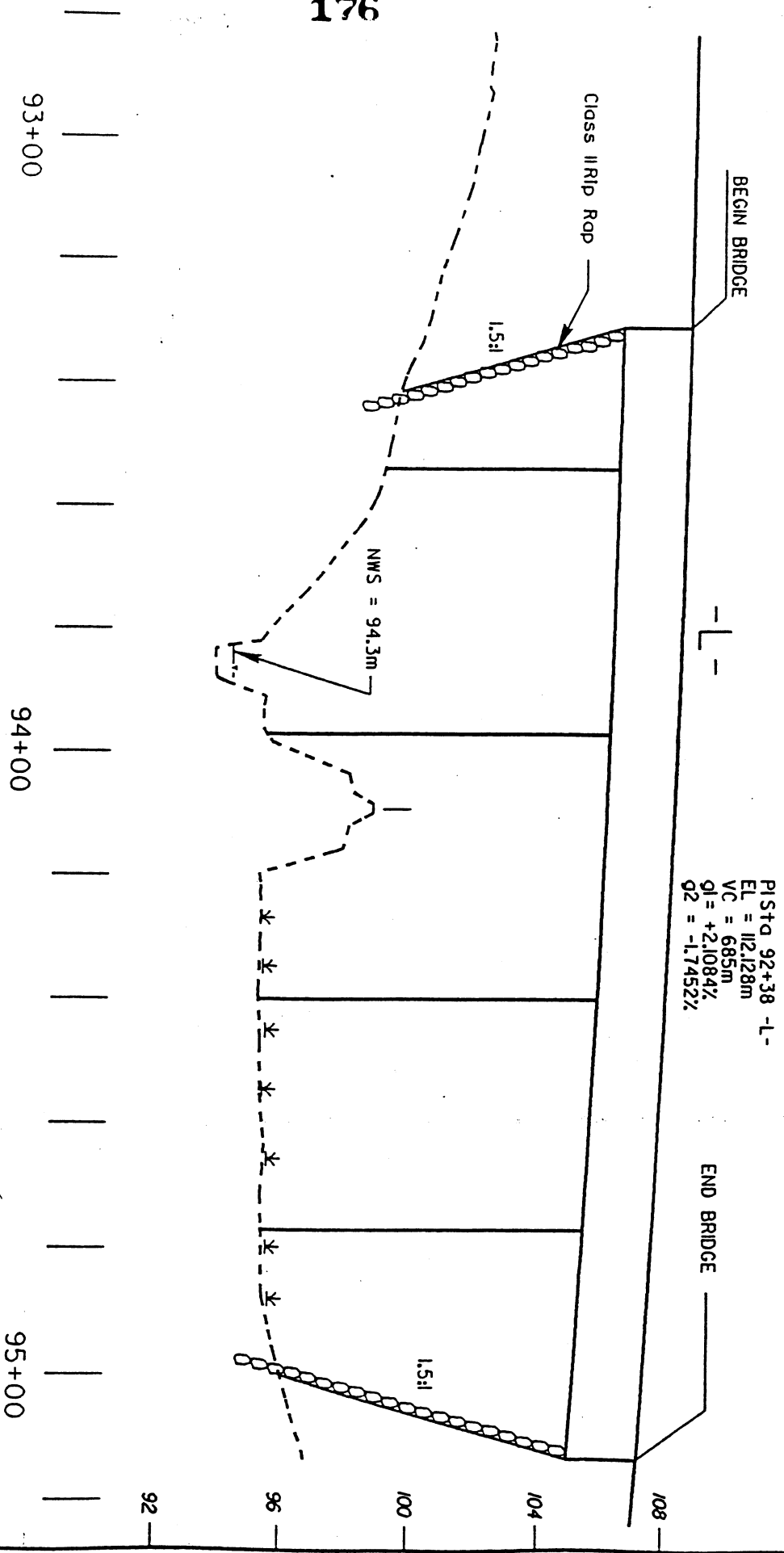

PISTD 92+38 -L-
 EL = 112.128m
 VC = 685m
 g1 = +2.1084%
 g2 = -1.7452%

PROFILE



HORIZONTAL SCALE

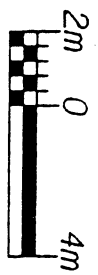

VERTICAL SCALE

SITE 2

N.C. DEPT. OF TRANSPORTATION
 DIVISION OF HIGHWAYS
 LEE COUNTY
 PROJECT: 8.T540402 (R-2417BA)
 SANFORD BYPASS
 Q66 ✓ 2000-08

Typical From Bridge to Sta 147+48.425 -L-

177

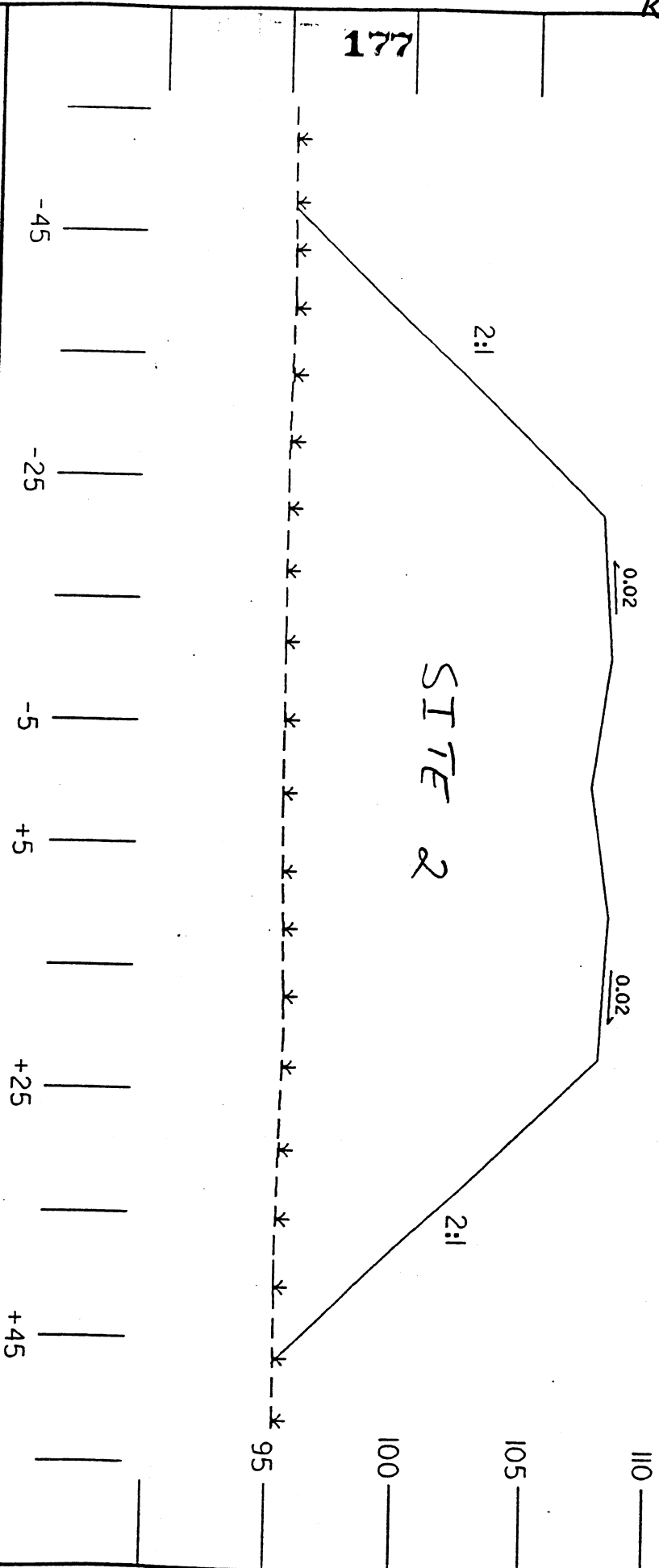

CROSS SECTION

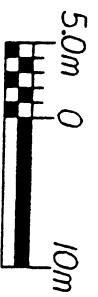

HORIZONTAL SCALE



VERTICAL SCALE

N. C. DEPT. OF TRANSPORTATION
 DIVISION OF HIGHWAYS
 LEE COUNTY
 PROJECT: 8.T540402 (R-2417BA)
 SANFORD BYPASS
Arhdc 2000-02
 SHEET 6 OF 75

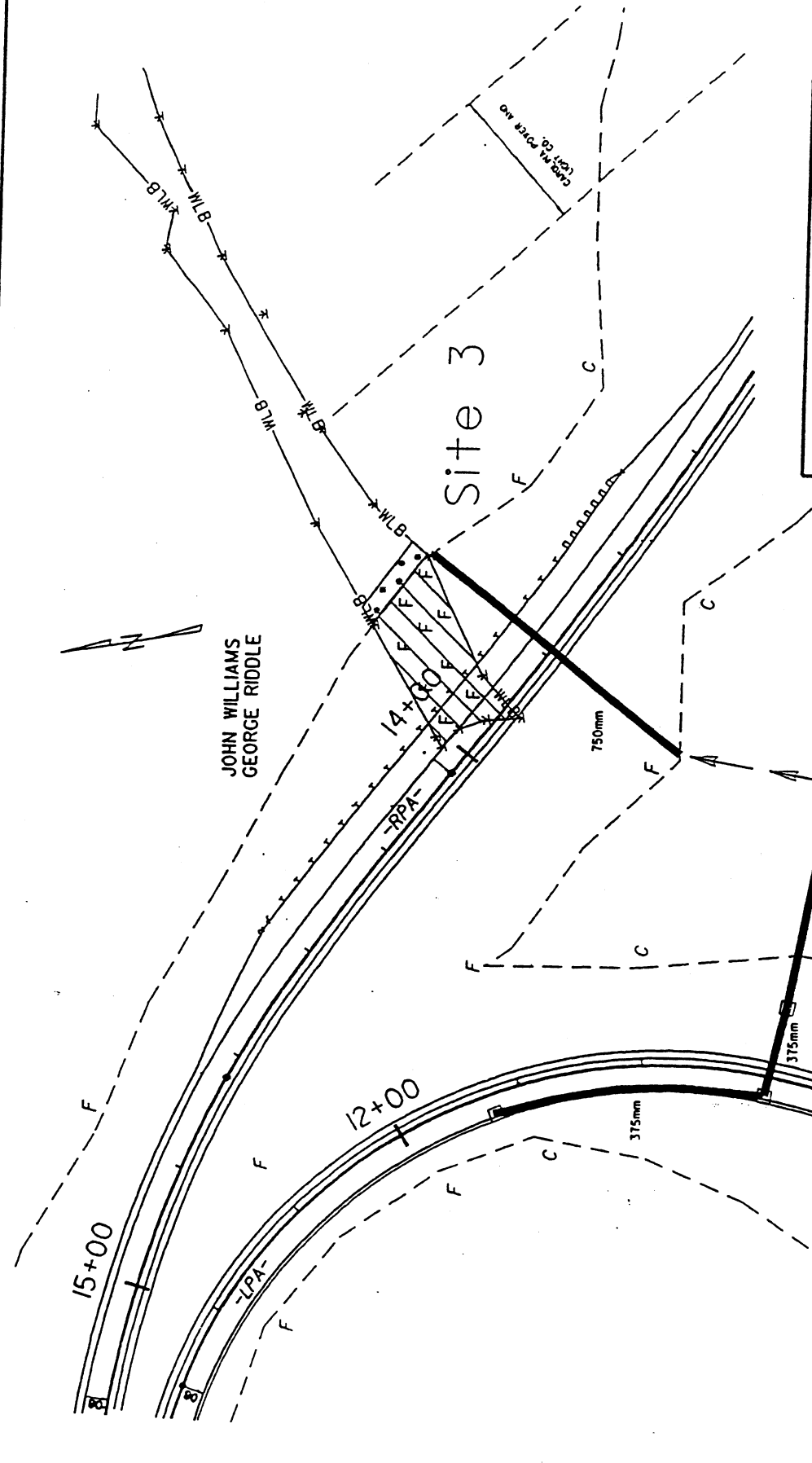

N. C. DEPT. OF TRANSPORTATION
 DIVISION OF HIGHWAYS
 LEE COUNTY

PROJECT: 8.T540402 (R-2417BA)
 SANFORD BYPASS
 October 2000, ET

SHEET 7 OF 33

JOHN WILLIAMS
 GEORGE RIDDLE

PLAN VIEW

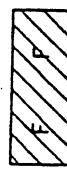
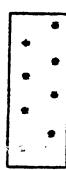
-  DENOTES FILL IN WETLANDS
-  DENOTES MECHANIZED CLEARING IN WETLANDS

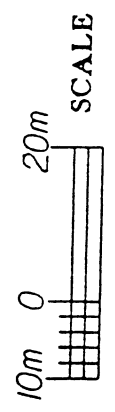

Matchline B-B

N. C. DEPT. OF TRANSPORTATION
DIVISION OF HIGHWAYS

LEE COUNTY

PROJECT: 8.T540402 (R-2417BA)

SANFORD BYPASS

October 2000-EB

SHEET 8 OF 33

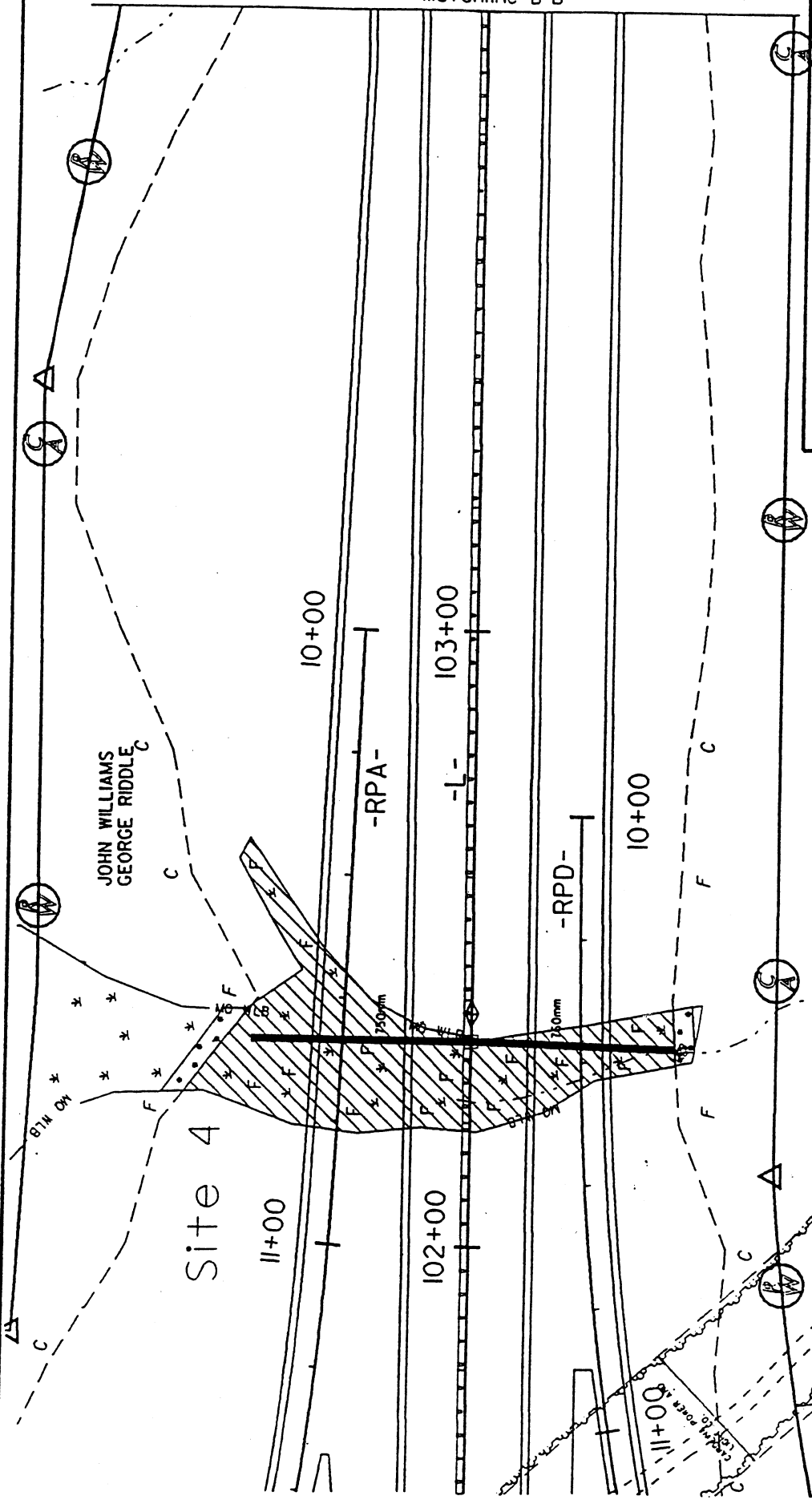

PLAN VIEW

JOHN WILLIAMS
GEORGE RIDDLE

■ DENOTES FILL
IN WETLANDS

● DENOTES MECHANIZED
CLEARING IN WETLANDS

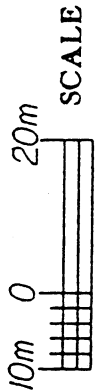

JOHN WILLIAMS
GEORGE RIDDLE

Site 6

UT2 TO WALLACE BRANCH

300mm CSP

600mm CSP

106+00

600mm

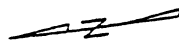

Site 5

600mm CSP

600mm

-L-

105+00

600mm

UT1 TO WALLACE BRANCH

600mm

PLAN VIEW

JOHN WILLIAMS
GEORGE RIDDLE

DENOTES FILL IN
SURFACE WATERS

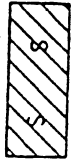

SCALE

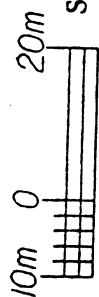

N. C. DEPT. OF TRANSPORTATION
DIVISION OF HIGHWAYS
LEE COUNTY

PROJECT: 8.T540402 (R-2417BA)

SANFORD BYPASS

October 2000-EZ

SHEET 9 OF 33

Matchline B-B

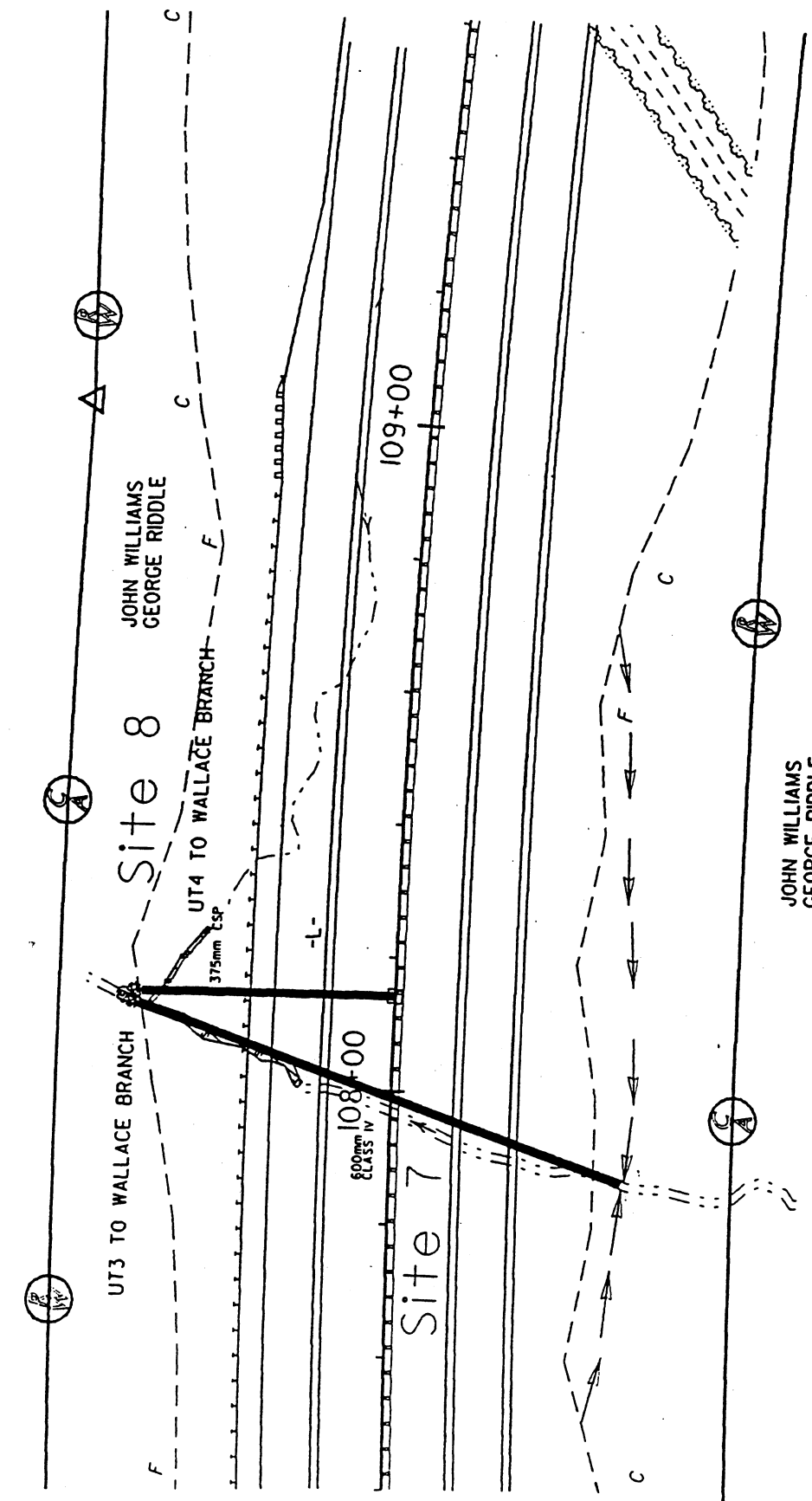

N. C. DEPT. OF TRANSPORTATION
 DIVISION OF HIGHWAYS
 LEE COUNTY
 PROJECT: 8.T540402 (R-2417BA)
 SANFORD BYPASS
 October 2000 - 02
 SHEET 10 OF 33

PLAN VIEW



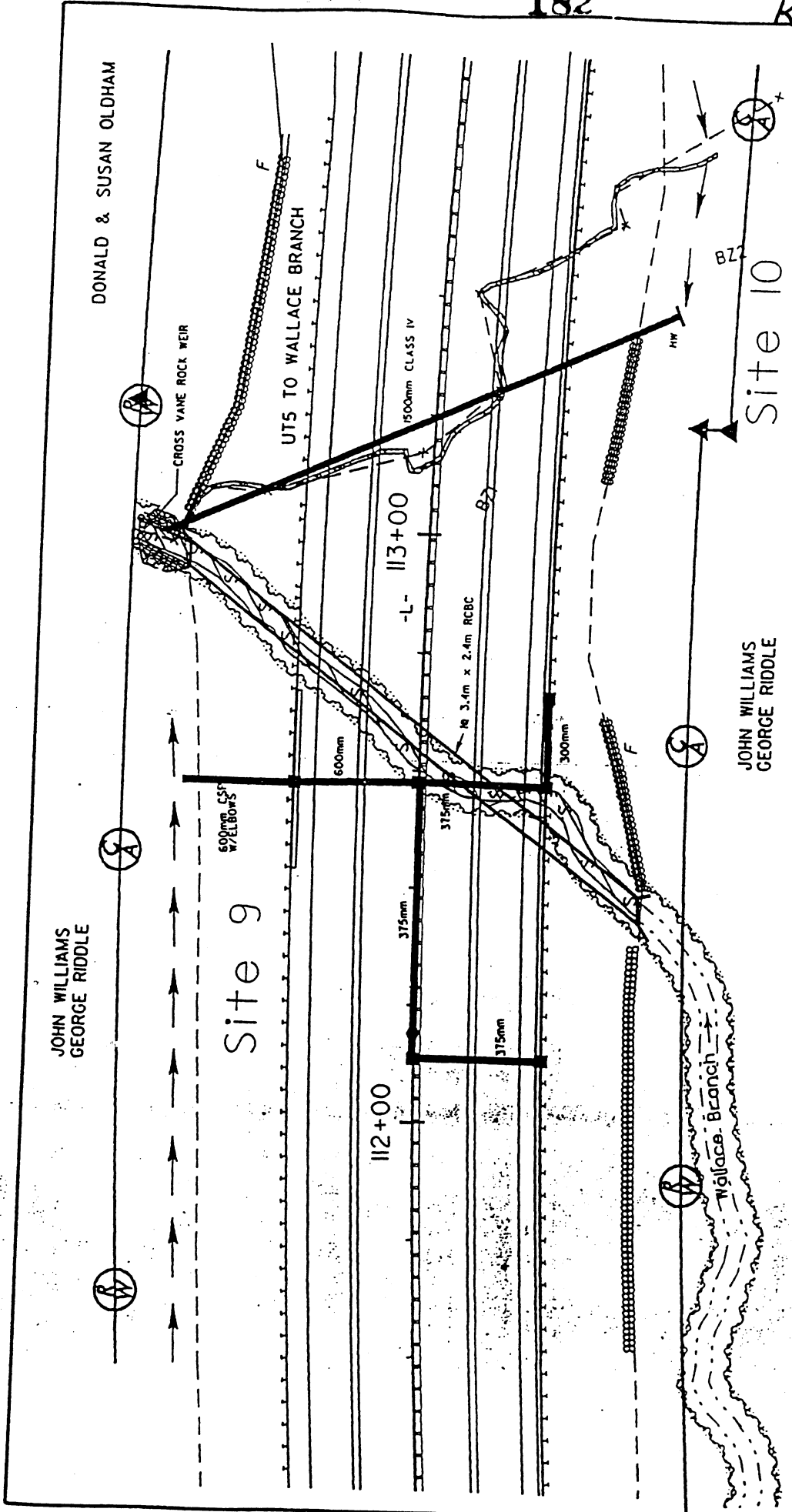

DONALD & SUSAN OLDHAM

JOHN WILLIAMS
GEORGE RIDDLE

Site 9

112+00

113+00

500mm CLASS IV

-L-

3.4m x 2.4m RCBC

JOHN WILLIAMS
GEORGE RIDDLE

Site 10

PLAN VIEW

DENOTES FILL IN
SURFACE WATERS

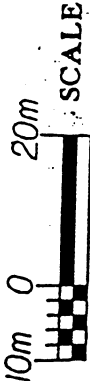

N. C. DEPT. OF TRANSPORTATION
 DIVISION OF HIGHWAYS
 LEE COUNTY
 PROJECT: 8.T540402 (R-2417BA)

SANFORD BYPASS

CROSS VANE ROCK WEIR DETAIL

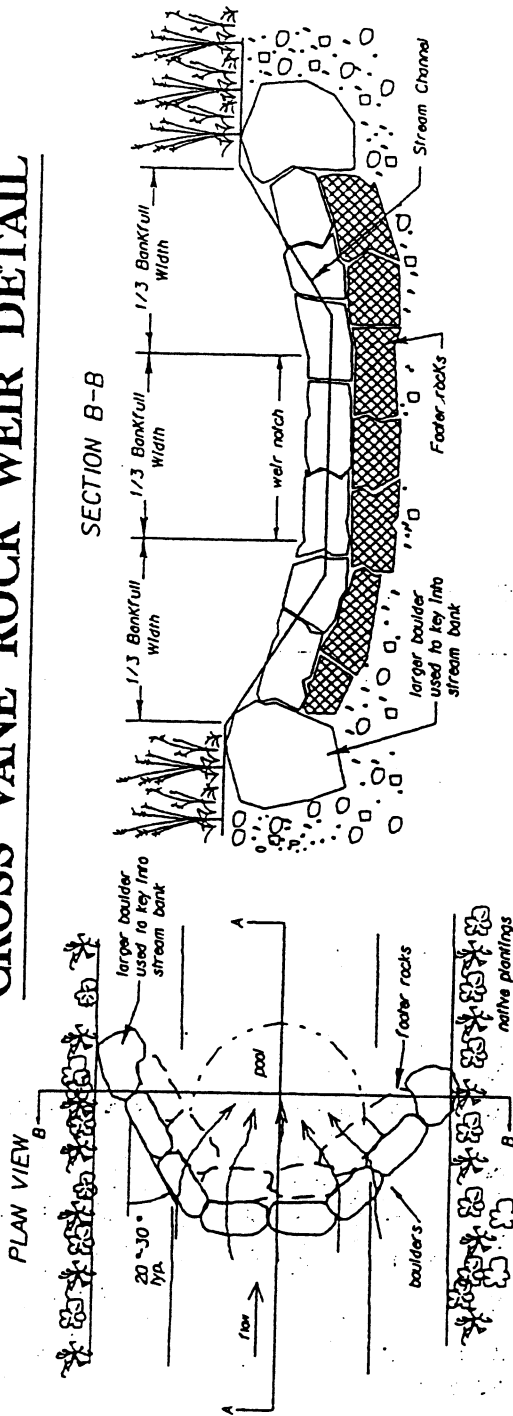

NOTE: Boulders should be native quarried rock or locally shot rock, angular and oblong with approximate dimensions of 1.2m x 0.9m x 0.6m and weighing approximately 4000 lbs)

Note: Rocks should fit tightly with minimal spaces

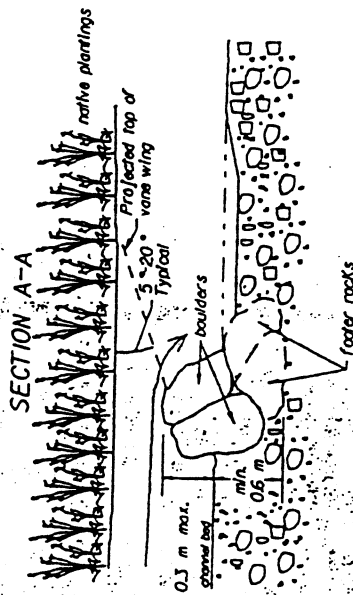

N. C. DEPT. OF TRANSPORTATION
 DIVISION OF HIGHWAYS
 LEE COUNTY
 PROJECT: 8.T540402 (R-2417BA)
 SANFORD BYPASS

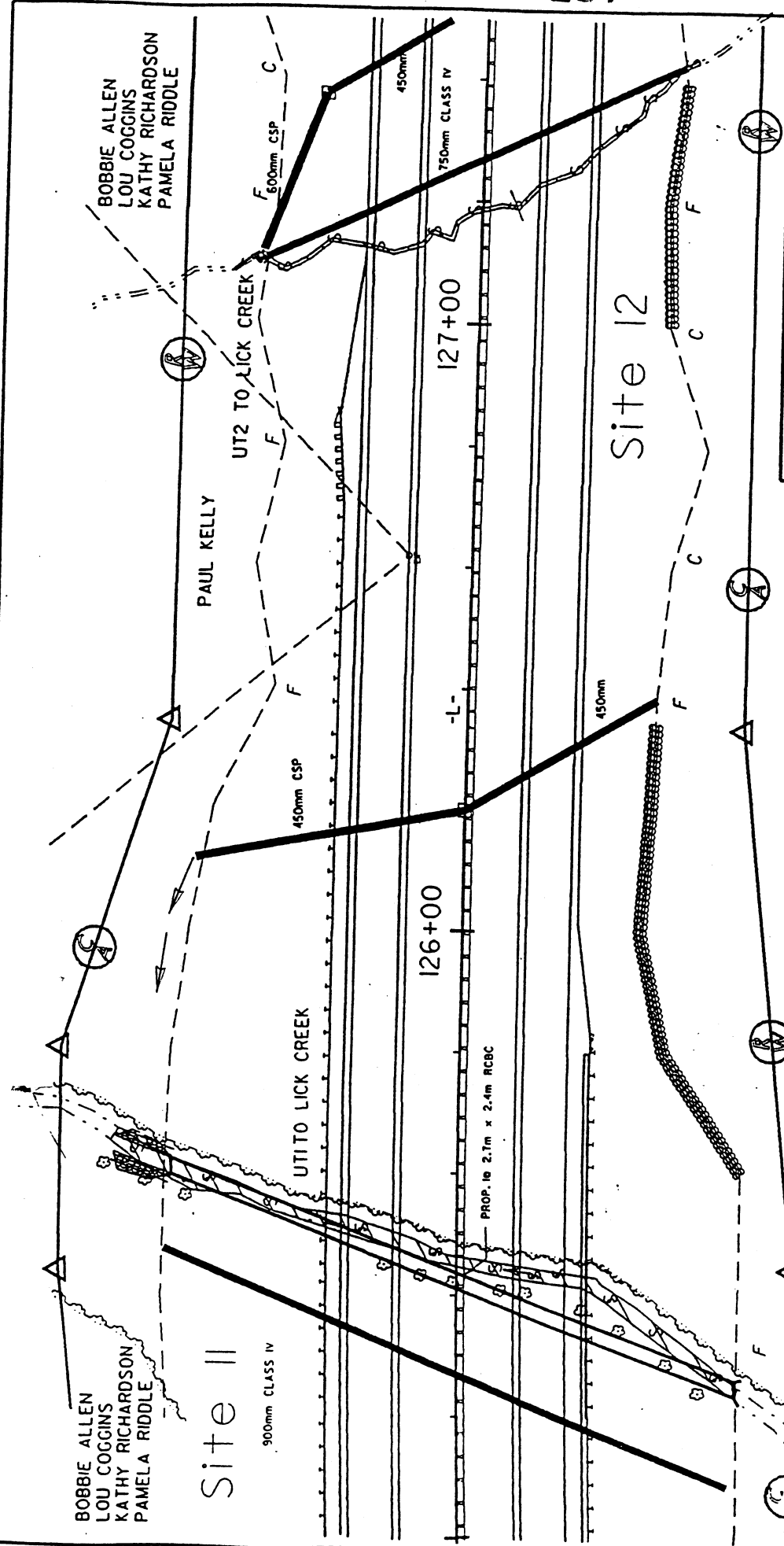

N. C. DEPT. OF TRANSPORTATION
 DIVISION OF HIGHWAYS
 LEE COUNTY

PROJECT: 8.T540402 (R-2417BA)
 SANFORD BYPASS
 October 2000 - EA

SHEET 12 OF 33

BOBBIE ALLEN
 LOU COGGINS
 KATHY RICHARDSON
 PAMELA RIDDLE

PLAN VIEW

DENOTES FILL IN
 SURFACE WATERS



DAN & SARAH LAWRENCE

PAUL KELLY

Site 13

UT3 TO LICK CREEK

129+00

130+00

750mm

-L-

SM L&E 02

14

DAN & SARAH LAWRENCE

PLAN VIEW

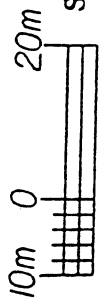

N. C. DEPT. OF TRANSPORTATION
 DIVISION OF HIGHWAYS
 LEE COUNTY

PROJECT: 8.T540402 (R-2417BA)

SANFORD BYPASS

October 2000-EG

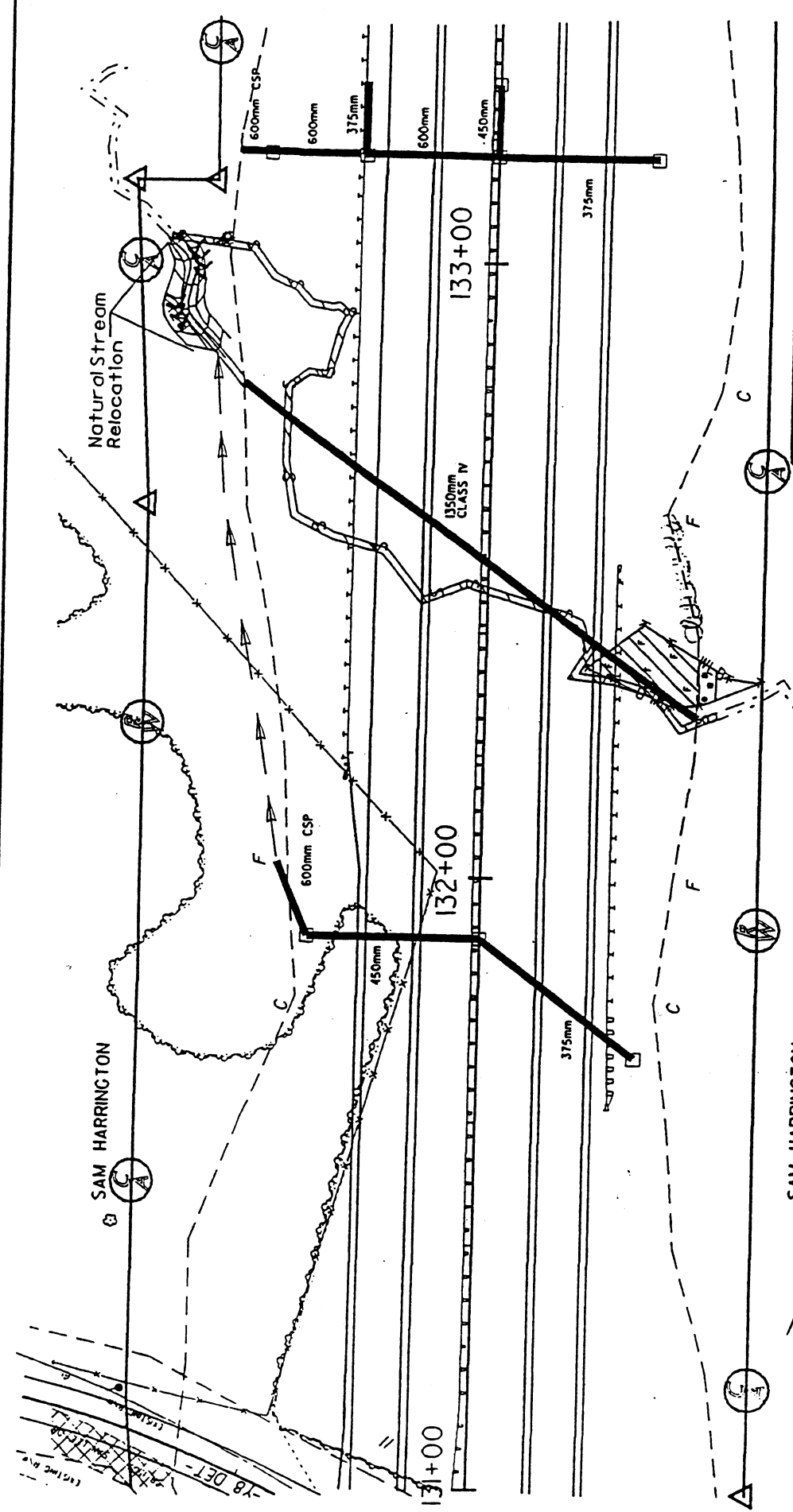

SHEET 13 OF 33



N. C. DEPT. OF TRANSPORTATION
 DIVISION OF HIGHWAYS
 LEE COUNTY
 PROJECT: 8.T540402 (R-2417BA)
 SANFORD BYPASS
 October 2000-02
 SHEET 14 OF 33

UT4 TO LICK CREEK
 Site 14

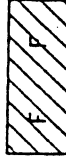
PLAN VIEW

-  DENOTES FILL IN WETLANDS
-  DENOTES FILL IN SURFACE WATERS
-  DENOTES MECHANIZED CLEARING IN WETLANDS

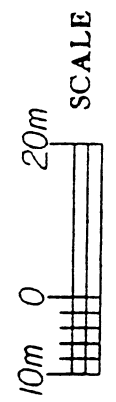

SAM HARRINGTON

SAM HARRINGTON

Y8 DET -
 ENGINEER

STREAM RELOCATION STA 132+85 - 133+03 -L- (LT)

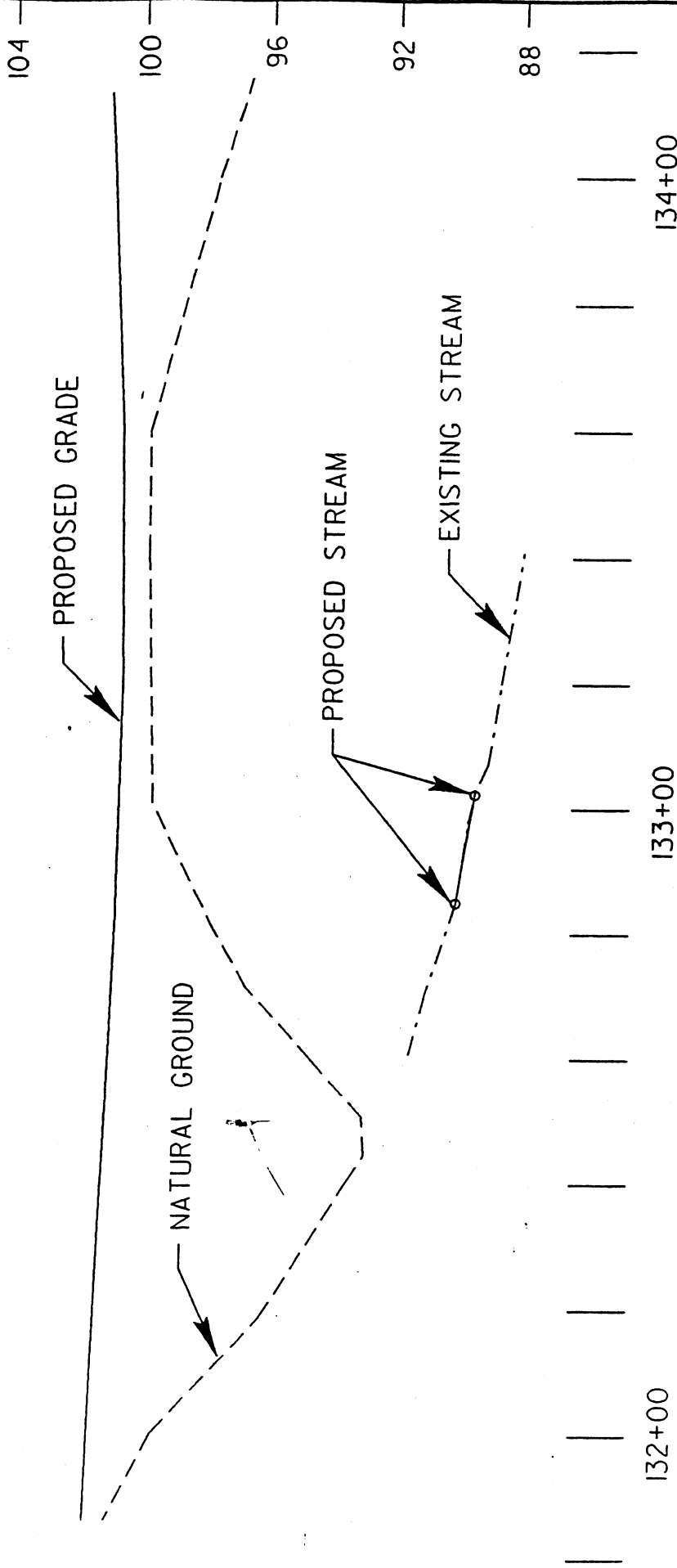

PROFILE



HORIZONTAL SCALE

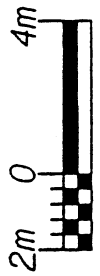

VERTICAL SCALE

SITE 14

N. C. DEPT. OF TRANSPORTATION
 DIVISION OF HIGHWAYS
 LEE COUNTY
 PROJECT: 8.T540402 (R-2417BA)

SANFORD BYPASS
 October 2001-02

SHEET 15 OF 33

STREAM RELOCATION STA 132+85 - 133+03 -L- (LT)

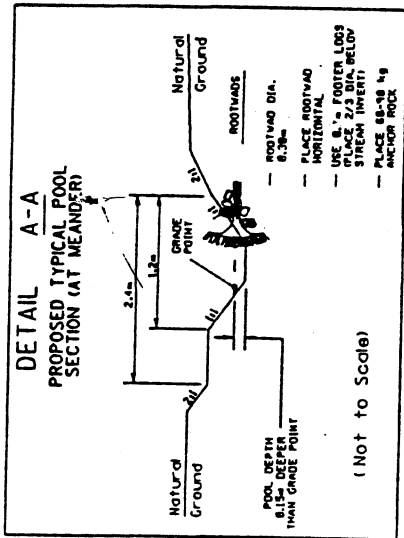

FROM STA 132+90 TO 132+94 -L- (LT)
FROM STA 132+97 TO 133+01-L- (LT)

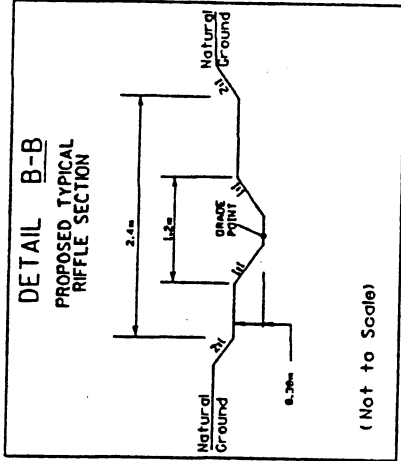

FROM STA 132+85 TO 132+90 -L- (LT)
FROM STA 132+94 TO 132+97 -L- (LT)
FROM STA 133+01 TO 133+03 -L- (LT)

SITE 14

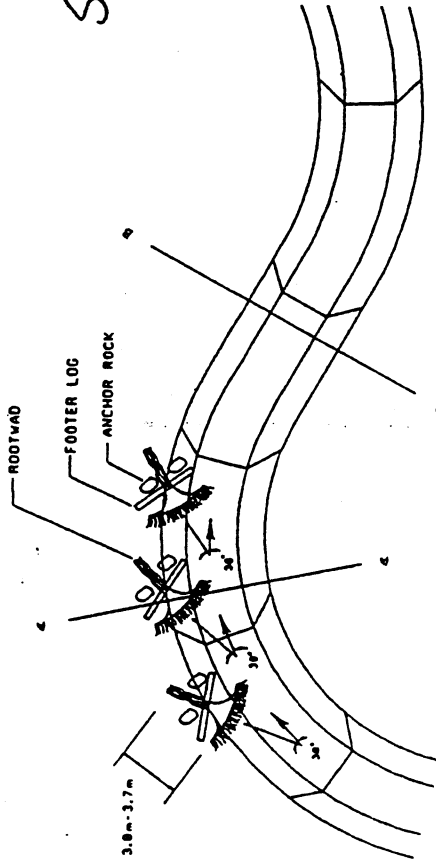

N. C. DEPT. OF TRANSPORTATION
DIVISION OF HIGHWAYS
LEE COUNTY
PROJECT: 8.T540402 (R-2417BA)

SANFORD BYPASS

October 2000 - 02

SHEET 16 OF 33

STREAM RELOCATION STA 132+85 - 133+03 -L- (LT)

189

Revised 6-5-92

ITEM	EXISTING STREAM	REFERENCE STREAM	PROPOSED RELOCATION
STREAM NAME	Tributary to Lick Creek		
DRAINAGE AREA (DA)	17 Ha (42 Ac)	17 Ha (42 Ac)	17 Ha (42 Ac)
CHANNEL SLOPE (S)	2.50%	2.50%	3.00%
BANKFUL WIDTH (W_{bkf})	2.4m	2.4m	2.8m
MEAN DEPTH (d_{bkf})	0.22m	0.22m	0.20m
BANKFUL X-SECTION AREA (A_{bkf})	0.55m ²	0.55m ²	0.55m ²
WIDTH/DEPTH RATIO (W_{bkf}/d_{bkf})	11	11	14
Maximum DEPTH (d_{mbkf})	0.43m	0.43m	0.41m
WIDTH Flood-Prone Area (W_{fpa})	4.0m	4.0m	4.4m
ENTRENCHMENT RATIO (ER)	1.7	1.7	1.6
CHANNEL MATERIALS: D50	Sand; Silt	Sand; Silt	Sand; Silt
SINUOSITY (K)	1.1	1.1	1.1
MEANDERS:			
AVG. LENGTH	10m - 15m	10m - 15m	10m
AVG. AMPLITUDE	5m	5m	5m
AVG. RADIUS	10m	10m	10m
DISCHARGES:			
Q BANKFULL	0.7 cms	0.7 cms	0.7 cms
Q2	0.8 cms	0.8 cms	0.8 cms
Q10	1.9 cms	1.9 cms	1.9 cms
VELOCITY:			
V BANKFULL	1.4 m/s	1.4 m/s	1.3 m/s
V2	1.5 m/s	1.5 m/s	1.4 m/s
V10	1.9 m/s	1.9 m/s	1.9 m/s
CLASSIFICATION	B6	B6	B6

SITE 14

N. C. DEPT. OF TRANSPORTATION
 DIVISION OF HIGHWAYS
 LEE COUNTY
 PROJECT: 8.T540402 (R-2417BA)

SANFORD BYPASS

October 2000 - FD

SHEET 17 OF 33

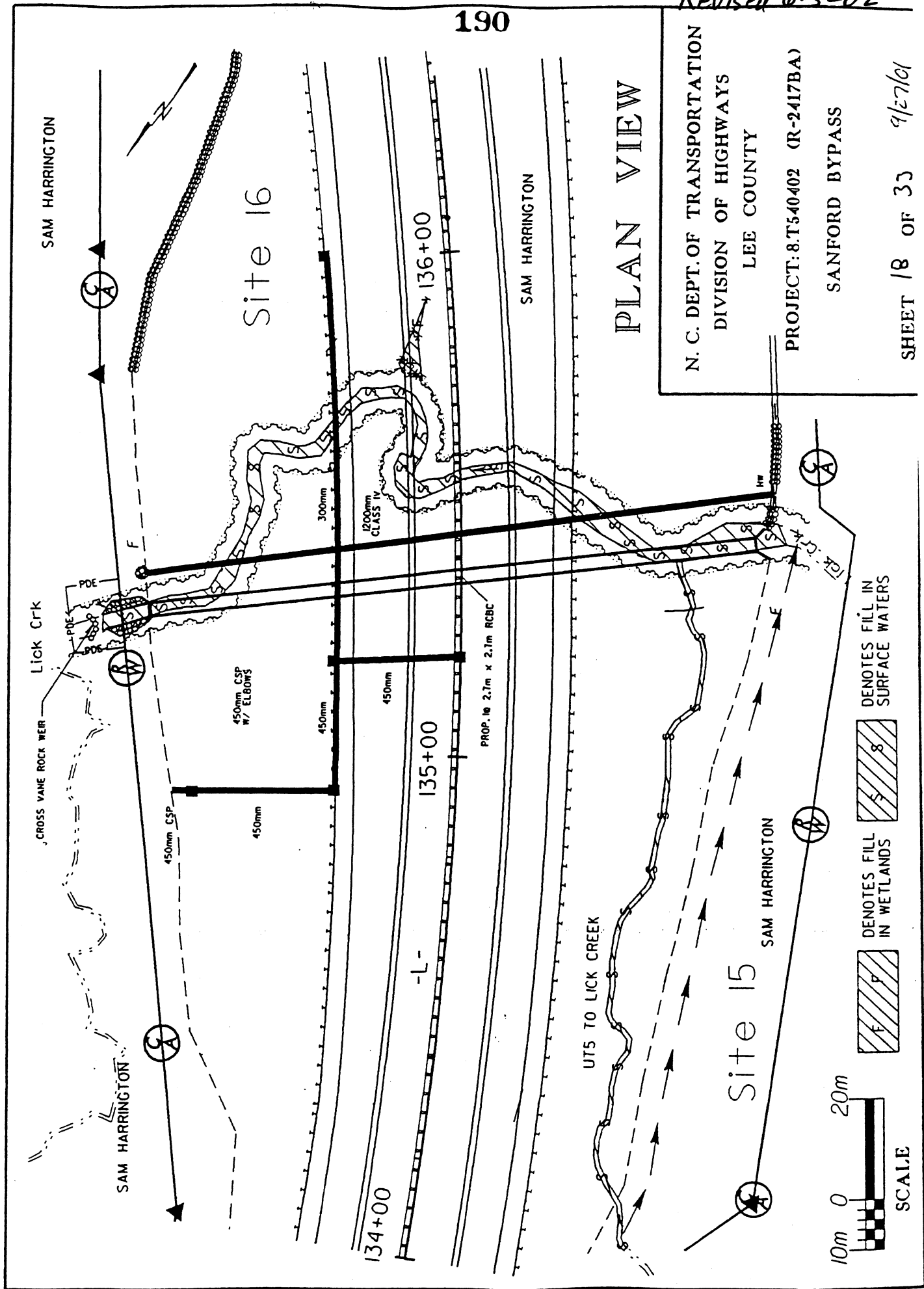

N. C. DEPT. OF TRANSPORTATION
 DIVISION OF HIGHWAYS
 LEE COUNTY
 PROJECT: 8.T540402 (R-2417BA)
 SANFORD BYPASS

 DENOTES FILL IN WETLANDS
 DENOTES FILL IN SURFACE WATERS

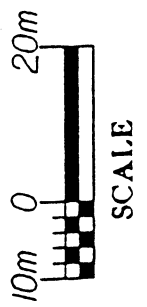

N. C. DEPT. OF TRANSPORTATION
DIVISION OF HIGHWAYS
LEE COUNTY

PROJECT: 8.T540402 (R-2417BA)

SANFORD BYPASS

October 2000-ET

SHEET 19 OF 37

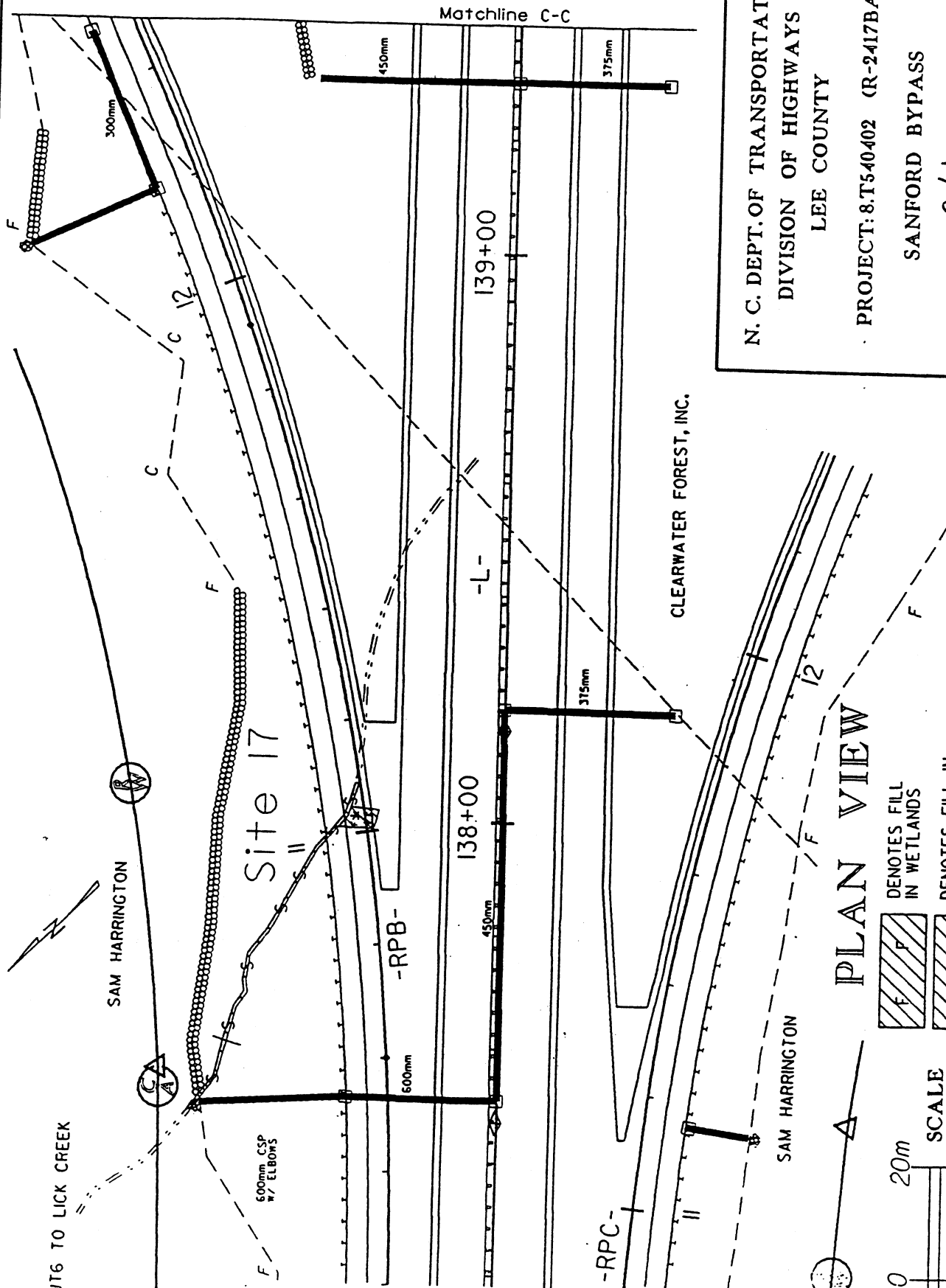

PLAN VIEW

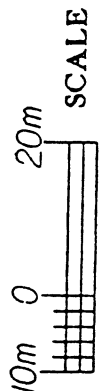
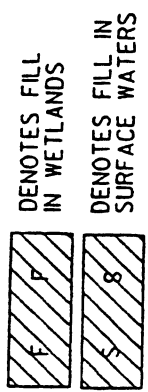

SCALE

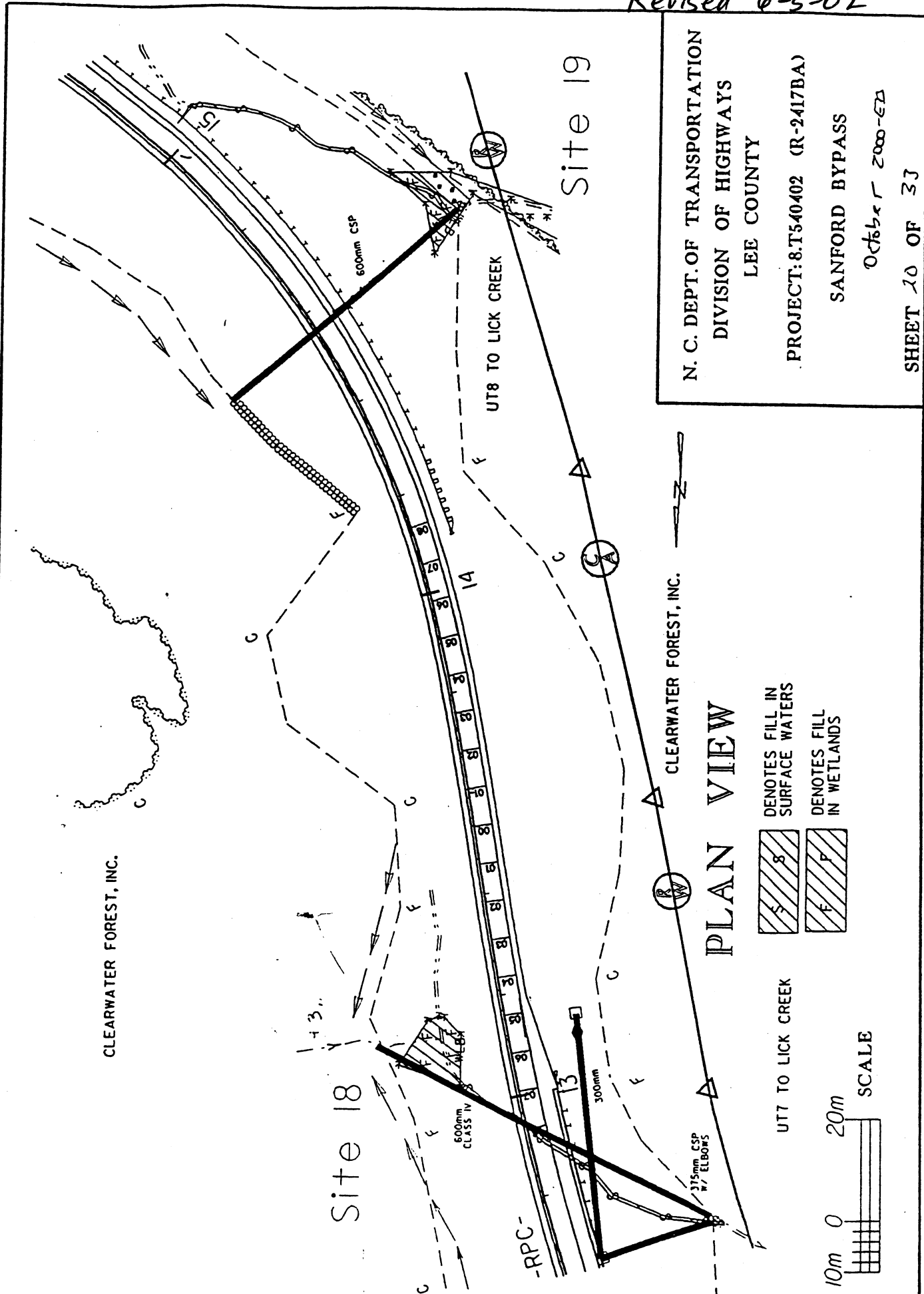



N. C. DEPT. OF TRANSPORTATION
 DIVISION OF HIGHWAYS
 LEE COUNTY

PROJECT: 8.T540402 (R-2417BA)
 SANFORD BYPASS

October 2000-ETD

SHEET 10 OF 33

PLAN VIEW

 DENOTES FILL IN SURFACE WATERS
 DENOTES FILL IN WETLANDS

UT7 TO LICK CREEK
 10m 0 20m SCALE

N. C. DEPT. OF TRANSPORTATION
DIVISION OF HIGHWAYS
LEE COUNTY

PROJECT: 8.T540402 (R-2417BA)



SANFORD BYPASS

October 2000 - 7673

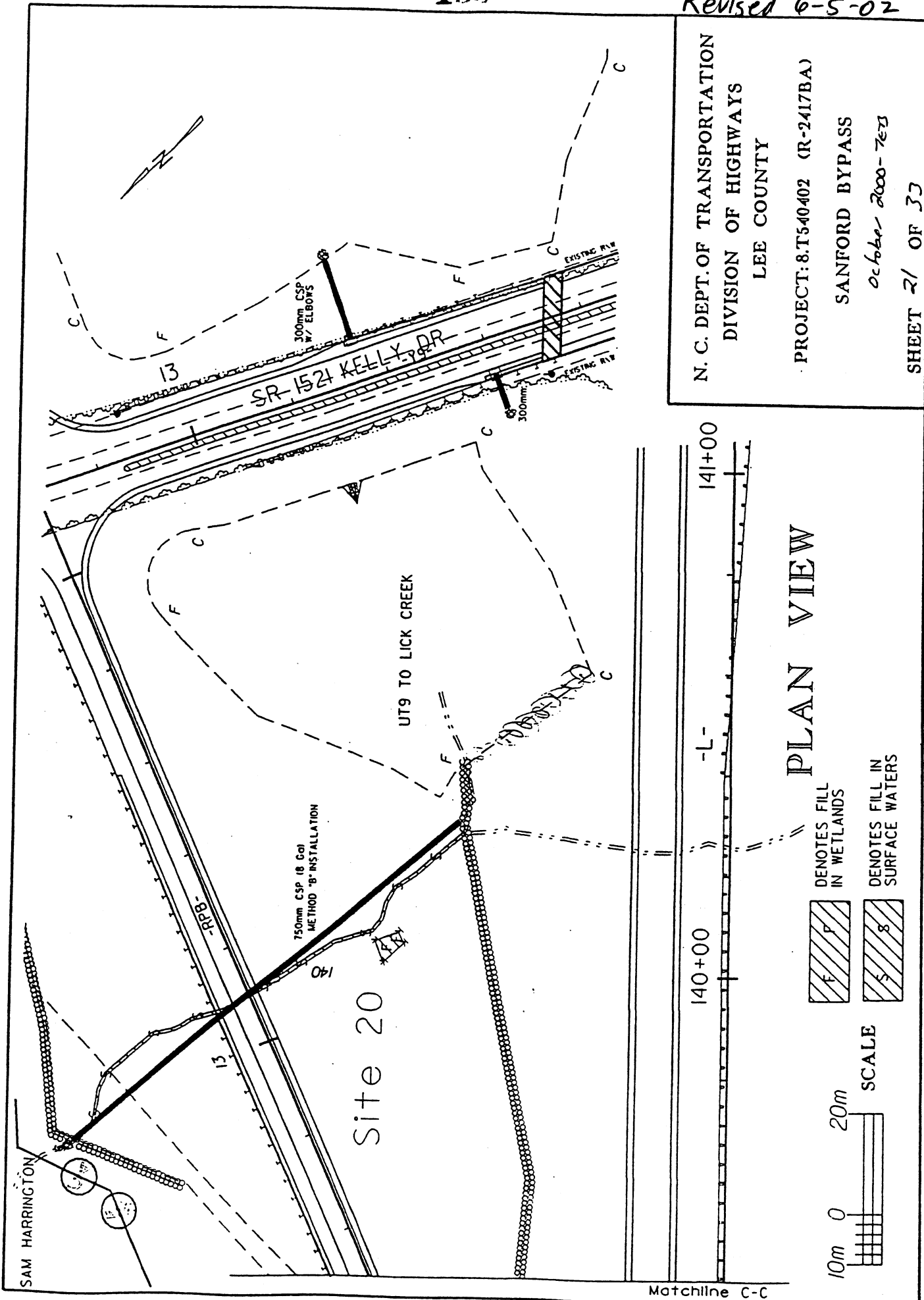
SHEET 21 OF 33



PLAN VIEW

 DENOTES FILL IN WETLANDS
 DENOTES FILL IN SURFACE WATERS

10m 0 20m
 SCALE

Matchline C-C

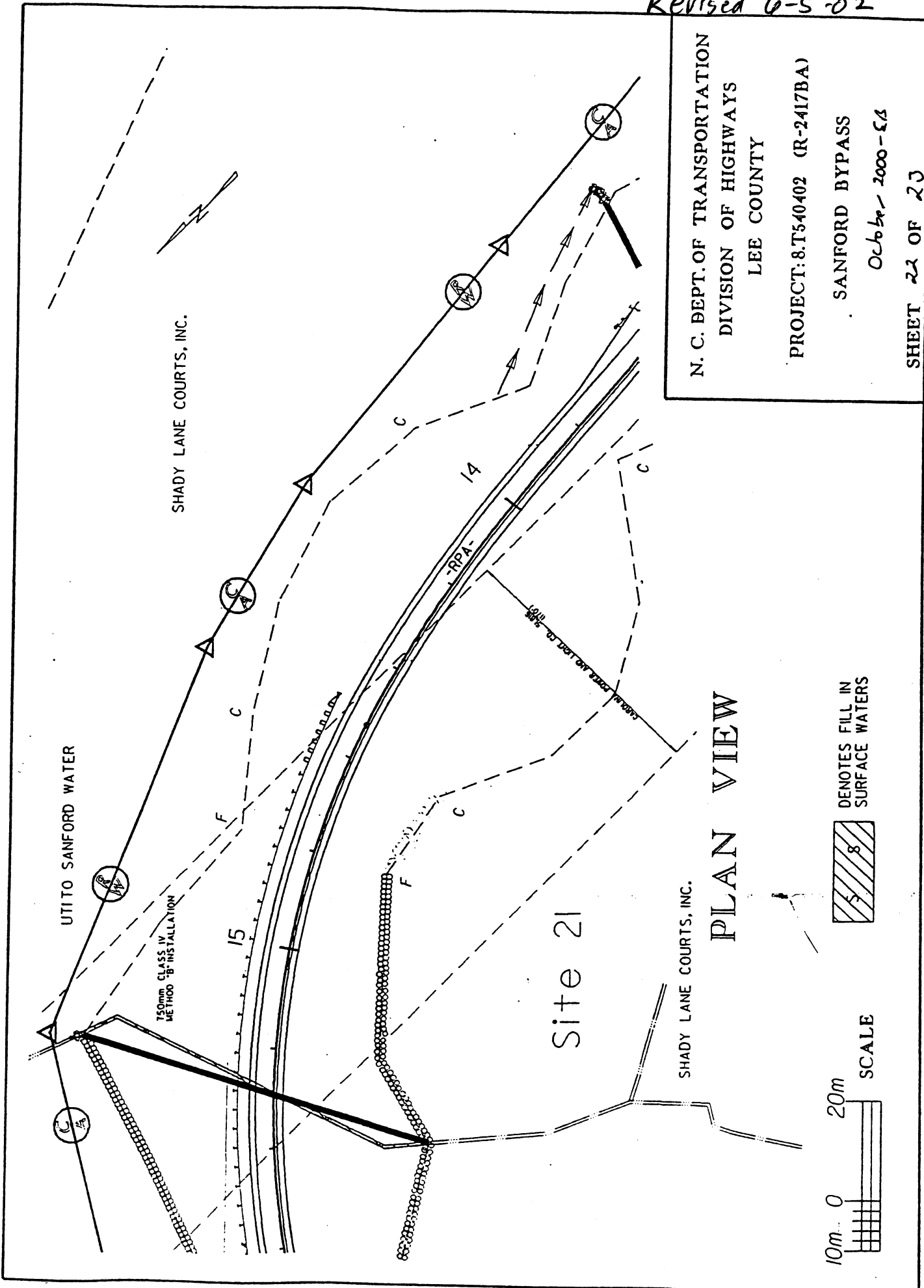

N. C. DEPT. OF TRANSPORTATION
 DIVISION OF HIGHWAYS
 LEE COUNTY

PROJECT: 8.T540402 (R-2417BA)

SANFORD BYPASS

October 2000-01

SHEET 22 OF 23

PLAN VIEW

Site 21

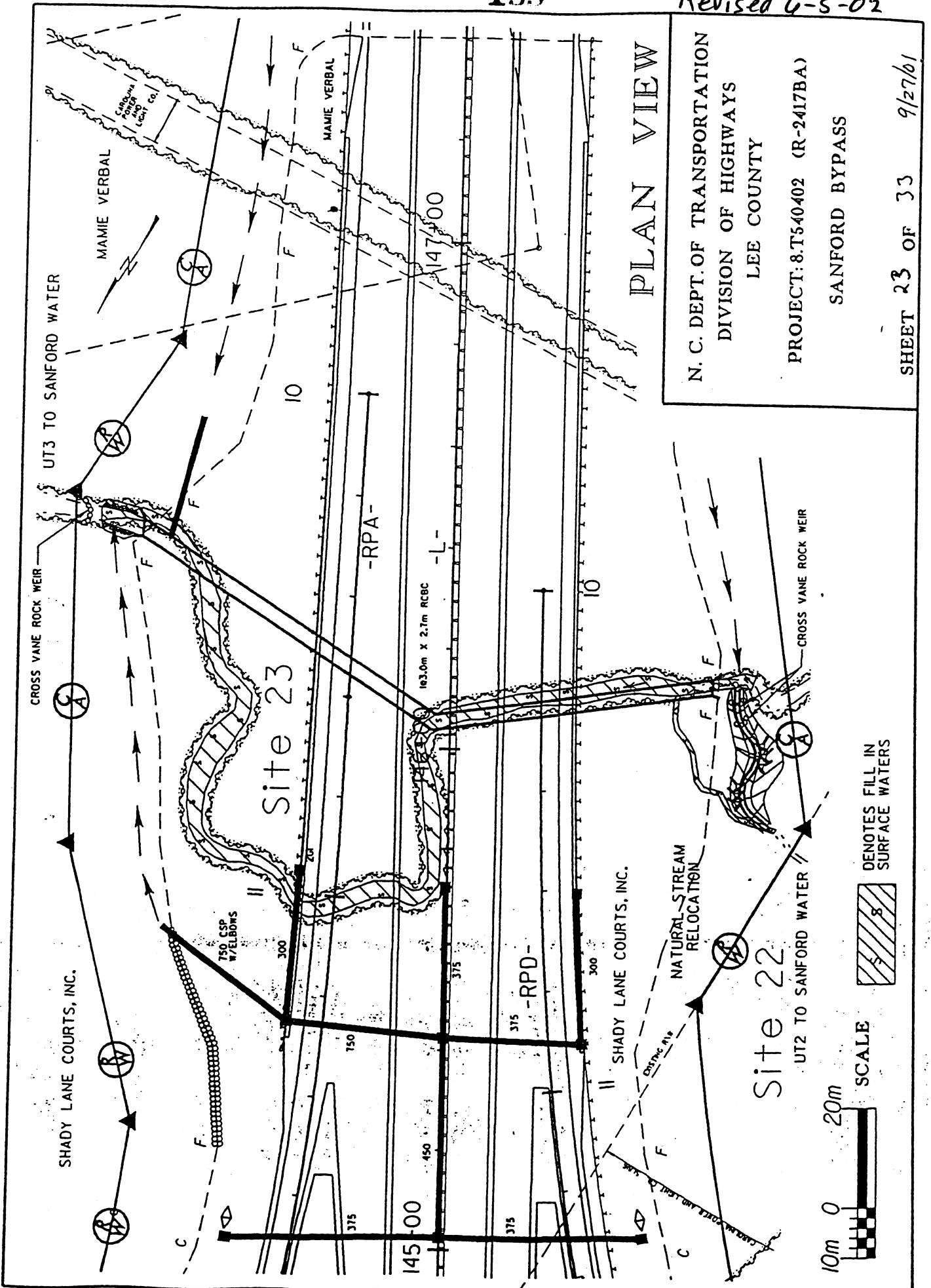

N. C. DEPT. OF TRANSPORTATION
 DIVISION OF HIGHWAYS
 LEE COUNTY
 PROJECT: 8.T540402 (R-2417BA)
 SANFORD BYPASS

SHEET 23 OF 33 9/27/01

DENOTES FILL IN SURFACE WATERS

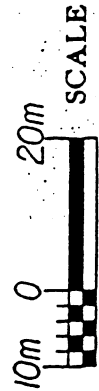

BAFFLE DETAIL (Not to Scale)

Box Culvert Sta 146+05.7 -L-

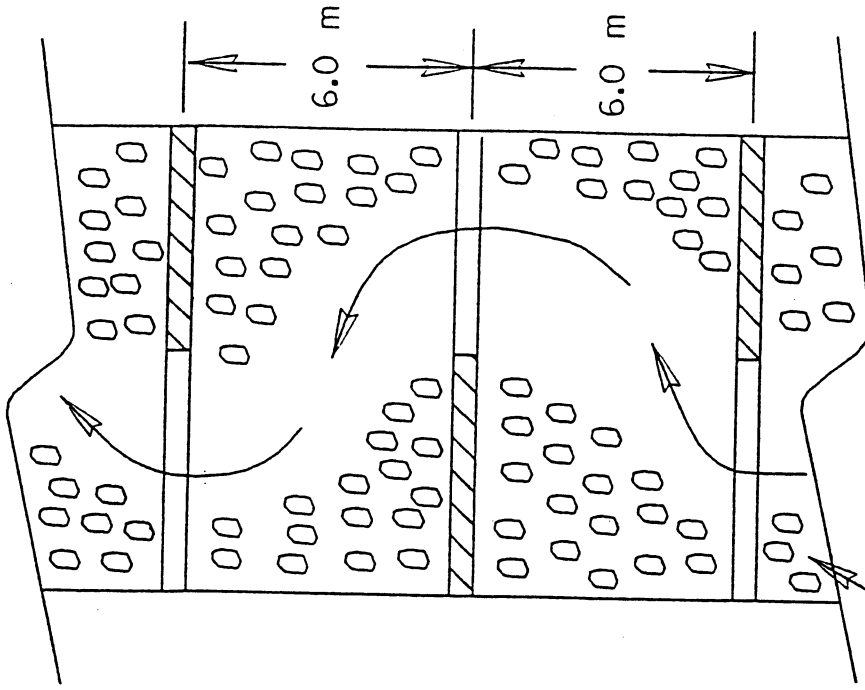
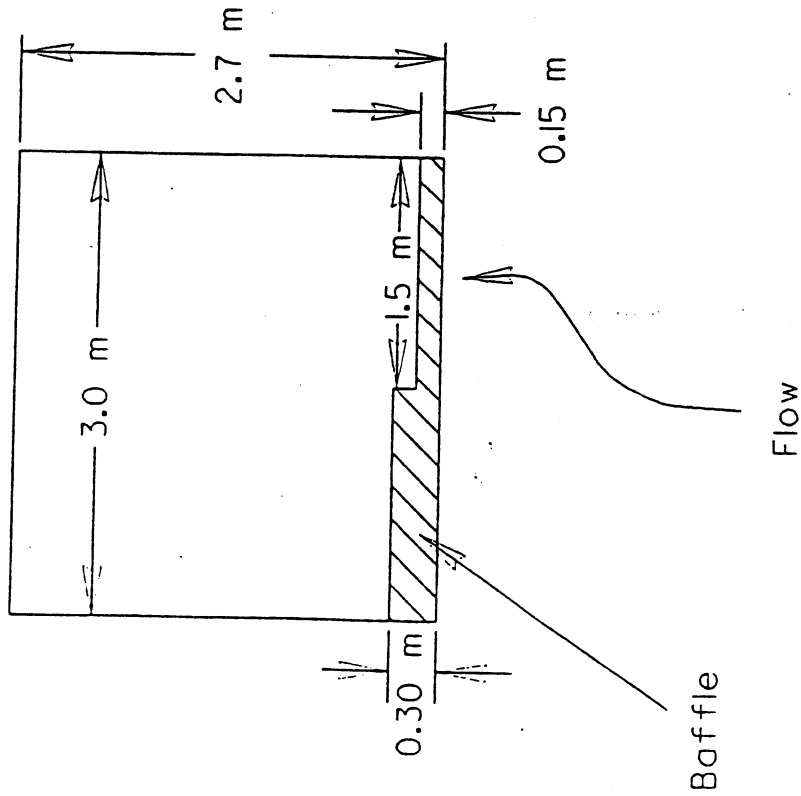

Class B Rip Rap
to Depth = 0.15m

N. C. DEPT. OF TRANSPORTATION
 DIVISION OF HIGHWAYS
 LEE COUNTY
 PROJECT: 8.T540402 (R-2417BA)
 SANFORD BYPASS

STREAM RELOCATION STA 145+84 - 146+13 -L- (RT)

PROPOSED GRADE

NATURAL GROUND

PROPOSED STREAM

EXISTING STREAM

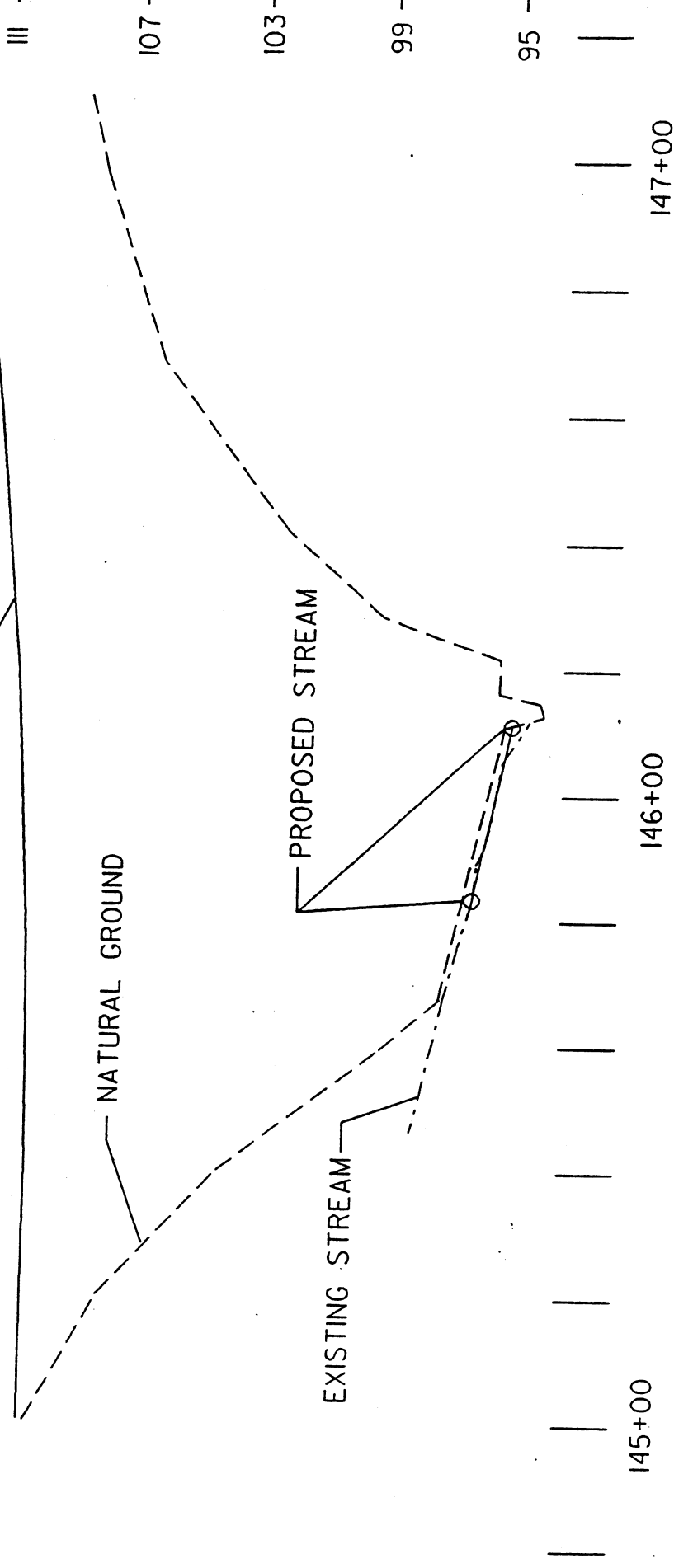

PROFILE

SITE 22



HORIZONTAL SCALE



VERTICAL SCALE

N. C. DEPT. OF TRANSPORTATION

DIVISION OF HIGHWAYS

LEE COUNTY

PROJECT: 8.T540402 (R-2417BA)

SANFORD BYPASS

October 2000-EB

SHEET 25 OF 33

Revised 6-5-02

STREAM RELOCATION STA 145+84 - 146+13 -L- (RT)

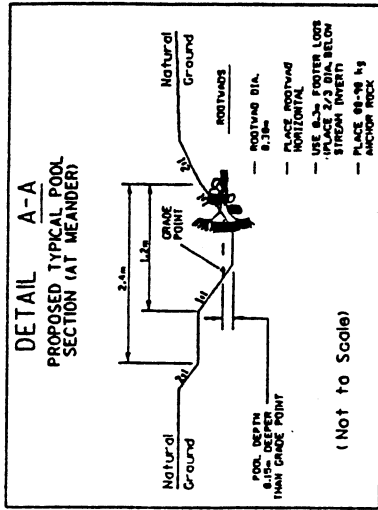

FROM STA 145+89 TO 145+94 -L- (RT)
FROM STA 145+97 TO 146+02 -L- (RT)

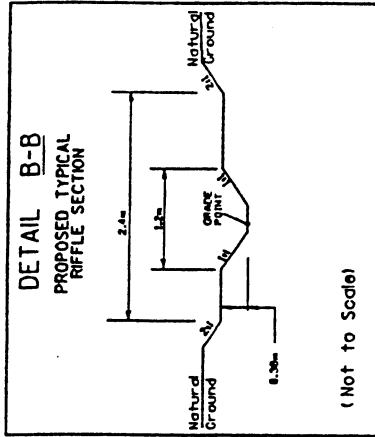

FROM STA 145+84 TO 145+89 -L- (RT)
FROM STA 145+94 TO 145+97 -L- (RT)
FROM STA 146+02 TO 146+13 -L- (RT)

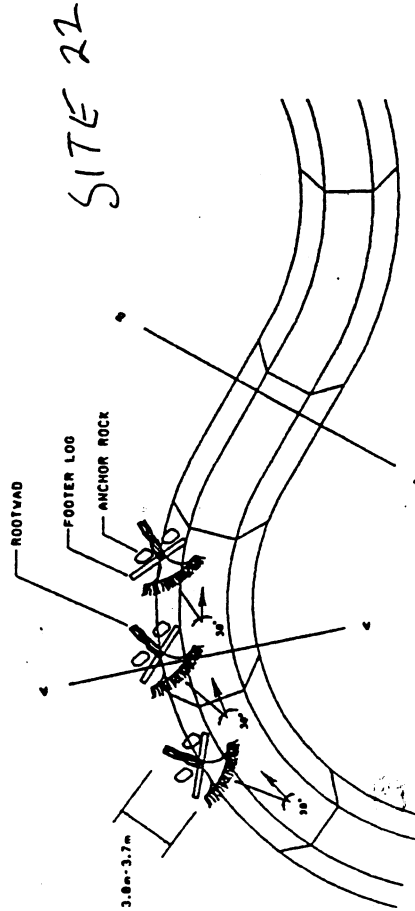

N. C. DEPT. OF TRANSPORTATION
DIVISION OF HIGHWAYS
LEE COUNTY
PROJECT: 8.T540402 (R-2417BA)

SANFORD BYPASS
October 2000-02

STREAM RELOCATION STA 145+84 - 146+13 -L- (RT)

199

Revised 6-5-02

ITEM	EXISTING STREAM	REFERENCE STREAM	PROPOSED RELOCATION
STREAM NAME	Tributary to Sanford Water Supply		
DRAINAGE AREA (DA)	8.5 Ha (21Ac)	8.5 Ha (21Ac)	8.5 Ha (21Ac)
CHANNEL SLOPE (S)	2.90%	2.90%	3.90%
BANKFUL WIDTH (W_{bkr})	4.0m	4.0m	2.8m
MEAN DEPTH (d_{bkr})	0.15m	0.15m	0.18m
BANKFUL X-SECTION AREA (A_{bkr})	0.50m ²	0.50m ²	0.50m ²
WIDTH/DEPTH RATIO (W_{bkr}/d_{bkr})	27	27	16
Maximum DEPTH (d_{mbkr})	0.35m	0.35m	0.39m
WIDTH Flood-Prone Area (W_{fpa})	7.0m	7.0m	4.4m
ENTRENCHMENT RATIO (FR)	1.8	1.8	1.6
CHANNEL MATERIALS: D50	Sand; Silt	Sand; Silt	Sand; Silt
SINUOSITY (K)	1.4	1.4	1.2
MEANDERS:			
AVG. LENGTH	10m - 15m	10m - 15m	10m
AVG. AMPLITUDE	3m	3m	5m
AVG. RADIUS	6m	6m	10m
DISCHARGES:			
Q BANKFULL	0.6 cms	0.6 cms	0.6 cms
Q2	0.7 cms	0.7 cms	0.7 cms
Q10	1.2 cms	1.2 cms	1.2 cms
VELOCITY:			
V BANKFULL	1.3 m/s	1.3 m/s	1.3 m/s
V2	1.4 m/s	1.4 m/s	1.4 m/s
V10	1.5 m/s	1.5 m/s	1.6 m/s
CLASSIFICATION	B6	B6	B6

SITE 22

N. C. DEPT. OF TRANSPORTATION
 DIVISION OF HIGHWAYS
 LEE COUNTY
 PROJECT: 8.T540402 (R-2417BA)

SANFORD BYPASS

OCTOBER 2000 - 52

SHEET 27 OF 33

SUMMARY

Sta. No.	Station (From-To)	Structure Size	WETLAND IMPACTS				SURFACE WATER IMPACTS					BUFFER IMPACTS						
			Fill In Wetlands (ha)	Temp. Fill In Wetlands (ha)	Excavation In Wetlands (ha)	Interchange Isolated Wetland (ha)	Mechanized Clearing (Method -) (ha)	Fill In SW (Natural) (ha)	Fill In SW (Pond) (ha)	Temp. Fill In SW (ha)	Existing Channel Impacted (m)	Relocated Channel (m)	Enclosed Channel (m)	Zone 1 (ha)	Zone 2 (ha)	Mech Clear (ha)		
1	11+75 to 13+40 (C.L.)	600mm									0.014			234		82		
2	13+01 to 14+85 (C.L.)	Bridge	0.018	* 0.004						0.010								
3	13+06 to 13+53 (Sp.A.)	750mm	0.029							0.004								
4	13+19 to 13+34 (C.L.)	750mm	0.129							0.008								
5	14+25 to 14+45 (Sp.L.)	600mm									0.005			61		98		
6	13+05 to 13+35 (C.L.)	600mm									0.002			17		71		
7	13+05 to 13+05 (C.L.)	600mm									0.005			31		76		
8	13+05 to 13+05 (C.L.)	600mm									0.001			15				
9	13+05 to 13+05 (C.L.)	103.4m x 2.4m RCBC									0.031			111		97		
10	13+03 to 13+55 (C.L.)	1500mm									0.01			139		94		
11	13+05 to 13+65 (C.L.)	102.7m x 2.4m RCBC									0.027			112		98		

** Intermittent Stream

* Temporary Impact Due to Work Bridge

N.C. DEPT. OF TRANSPORTATION
DIVISION OF HIGHWAYS
LEE COUNTY

PROJECT: 8-T540402 (R-2417BA)

SHEET 28 OF 37

SUMMARY

Site No.	Station (From/To)	Structure Size	WETLAND IMPACTS				SURFACE WATER IMPACTS				BUFFER IMPACTS							
			Fill In Wetlands (ha)	Temp. Fill In Wetlands (ha)	Excavation In Wetlands (ha)	Interchange Isolated Wetland (ha)	Mechanized Clearing (Method _) (ha)	Fill In SW (Natural) (ha)	Fill In SW (Pond) (ha)	Temp. Fill In SW (ha)	Existing Channel Impacted (m)	Relocated Channel (m)	Enclosed Channel (m)	Zone 1 (ha)	Zone 2 (ha)	Mech Clear. (ha)		
12	127+10(L)/127+20(R)-L	750mm							0.003				50			76		
12**	127+20/127+42(R)-L	750mm							0.002				39					
13**	129+27/129+32(R)-L	750mm							0.002				34					
13	129+32(R)/129+37(L)-L	750mm							0.003				43			62		
14	132+25(R)/133+03(L)-L	1350mm	0.014					0.002	0.019				182	19	81			
15	134+10/135+38(R)-L	1 @ 2.7m x 2.7m RCBC							0.013				150					
16	135+30(L)/135+40(R)-L	1 @ 2.7m x 2.7m RCBC	0.003						0.053				194			119		
17	137+48 (L)-L	600mm	0.002						0.001				14			150		
17**	137+60 (L)-L	600mm							0.003				52					
18**	12+65(R)/13+05(L)-R-PC	600mm	0.011						0.004				58			72		
TOTALS:																		

** Intermittent Stream

N.C. DEPT. OF TRANSPORTATION
DIVISION OF HIGHWAYS

LEE COUNTY

PROJECT: 8.T540402 (R-2417BA)

SHEET 29 OF 33

October 2000-07

Revised 6-5-02

SUMMARY

Sta No.	Station (From To)	Structure Size	WETLAND IMPACTS				SURFACE WATER IMPACTS				BUFFER IMPACTS						
			Fill In Wetlands (ha)	Temp. Fill In Wetlands (ha)	Excavation In Wetlands (ha)	Interchange Isolated Wetland (ha)	Mechanized Clearing (Method...) (ha)	Fill In SW (Natural) (ha)	Fill In SW (Pond) (ha)	Temp. Fill In SW (ha)	Existing Channel Impacted (m)	Relocated Channel (m)	Enclosed Channel (m)	Zone 1 (ha)	Zone 2 (ha)	Mech Clear (ha)	
16	145716-157111 PpC	600mm	0.007				0.003	0.004			70			57			
20	139-23159-27(U)L	750mm	0.002					0.006			105			99			
21	151118M-152117 PpA	750mm						0.005			80			66			
22	151118M-152117 PpA	1 @ 3.0m x 2.7m FCBC						0.003			37			28			
23	151118M-152117 PpA	1 @ 3.0m x 2.7m FCBC						0.065			235						
			0.215	* 0.004			0.036	0.281			2,045			47	1,408		

** Intermittent Stream

* Temporary Impact Due to Work Bridge

PERENNIAL TOTAL: 1503m
INTERMITTENT TOTAL: 524m

N.C. DEPT. OF TRANSPORTATION
DIVISION OF HIGHWAYS
LEE COUNTY

PROJECT: 8.T540402 (R-2417BA)

SHEET 30 OF 33

PROPERTY OWNERS

PARCEL NO.	SITE NO.	NAME	ADDRESS
	1	Lamar Beach	P.O. Box 1144 Sanford, NC 27330
	2	Robert McKay	Route 4 Box 960 Sanford, NC 27330
	2	William Thomas	1109 Colon Road Sanford, NC 27330
	2	CSX Railroad	1-800-327-5405 (Customer Service)
	3	John Williams	Route 1 Box 251 Moncure, NC 27330
	4	John Williams	Route 1 Box 251 Moncure, NC 27330
	5	John Williams	Route 1 Box 251 Moncure, NC 27330
	6	John Williams	Route 1 Box 251 Moncure, NC 27330

N. C. DEPT. OF TRANSPORTATION
DIVISION OF HIGHWAYS

LEE COUNTY

PROJECT: 8.T540402 (R-2417BA)

SANFORD BYPASS

October 2000 - 613

SHEET 31 OF 33

PROPERTY OWNERS

PARCEL NO.	SITE NO.	NAME	ADDRESS
	7	John Williams	Route 1 Box 251 Moncure, NC 27330
	8	John Williams	Route 1 Box 251 Moncure, NC 27330
	9	John Williams	Route 1 Box 251 Moncure, NC 27330
	9	Susan Oldham	713 Lower Moncure Road Sanford, NC 27330
	10	Bobbie Allen	838 Lower Moncure Road Sanford, NC 27330
	11	Bobbie Allen	838 Lower Moncure Road Sanford, NC 27330
	12	Dan Lawrence	P.O. Box 0056 Sanford, NC 27330
	13	Sam Harrington	1412 San Lee Drive Sanford, NC 27330

N. C. DEPT. OF TRANSPORTATION
DIVISION OF HIGHWAYS

LEE COUNTY

PROJECT: 8.T540402 (R-2417BA)

SANFORD BYPASS

October 2000 - ETD.

SHEET 32 OF 33

PROPERTY OWNERS

PARCEL NO.	SITE NO.	NAME	ADDRESS
	14	Sam Harrington	1412 San Lee Drive Sanford, NC 27330
	15	Sam Harrington	1412 San Lee Drive Sanford, NC 27330
	16	Clearwater Forest, Inc.	P.O. Box 518 Sanford, NC 27330
	17	Clearwater Forest, Inc.	P.O. Box 518 Sanford, NC 27330
	18	Clearwater Forest, Inc.	P.O. Box 518 Sanford, NC 27330
	19	Shady Lane Courts	P.O. Box 518 Sanford, NC 27330
	20	Shady Lane Courts	P.O. Box 518 Sanford, NC 27330

**N. C. DEPT. OF TRANSPORTATION
DIVISION OF HIGHWAYS**

LEE COUNTY

PROJECT: 8.T540402 (R-2417BA)

SANFORD BYPASS

October 2001

SHEET 33 OF 33