



STATE OF NORTH CAROLINA
DEPARTMENT OF TRANSPORTATION

ROY COOPER
GOVERNOR

J.R. "JOEY" HOPKINS
SECRETARY

October 08, 2024

Addendum No. 1

RE: Contract # C204339

WBS # 46927.3.1

STATE FUNDED

Wake County (P-5715)

NEW HOPE CHURCH ROAD GRADE SEPARATION OVER CSX RAIL LINE
(CROSSING #630607N AT MILE POST S 152.32)

October 15, 2024 Letting

To Whom It May Concern:

Reference is made to the plans and proposal furnished to you on this project.

The following revisions have been made to the Roadway plans.

Sheet Nos.	Revision
2A-1 thru 2A-8	Revised J2 in the Pavement Schedule
2A-5 and 2A-6	Added C1 and V callouts (milling)

Please void the above listed Sheets in your plans and staple the revised Sheets thereto.

The following revisions have been made to the Traffic Management plans.

Sheet Nos.	Revision
TMP-3	The ICT for Phase II, Steps 2 & 3 revised to 75 consecutive calendar days

Please void the above listed Sheet in your plans and staple the revised Sheet thereto.

The following revisions have been made to the Electrical plans.

Sheet Nos.	Revision
SL03 (SL032)	Corrected Sheet number (was erroneously numbered SL032). Revised Note #1. Added Note #4.

Please void the above listed Sheet in your plans and staple the revised Sheet thereto.

The following revisions have been made to the Utility Construction plans.

Sheet Nos.	Revision
UC-6	“ABANDON WATER SERVICE LINE” note at site of Proposed 129 LF of 1.5” Water Service Line was deleted.

Please void the above listed Sheet in your plans and staple the revised Sheet thereto.

The following revisions have been made to the proposal.

Page No.	Revision
Proposal Cover	Note added that reads “Includes Addendum No. 1 Dated 10-08-2024”.
G-1	2. Definitions A. under the Project Special Provision entitled FEDERAL RAILROAD ADMINISTRATION CONTRACTOR PROVISIONS has been revised.
G-2	2. Definitions K. under the Project Special Provision entitled FEDERAL RAILROAD ADMINISTRATION CONTRACTOR PROVISIONS has been revised.
G-25	38., 39. and 40. under the Project Special Provision entitled FEDERAL RAILROAD ADMINISTRATION CONTRACTOR PROVISIONS have been deleted.
G-35	The Project Special Provision entitled INTERMEDIATE CONTRACT TIME NUMBER 6 AND LIQUIDATED DAMAGES has been revised.
R-1	The Project Special Provision entitled BUILDING REMOVAL has been deleted.
R-4	The Project Special Provision entitled ABC(M) CONSTRUCTION PER TON has been revised
UC-12 (New)	The Unit Project Special Provision entitled UTILITY CONSTRUCTION has been revised to add the special provision entitled NITRILE MANHOLE-TO-PIPE CONNECTORS .
RR-19 (New)	The Unit Project Special Provision entitled SPECIAL PROVISIONS FOR PROTECTION OF RAILROAD INTEREST has been revised to add Train Data.

Please void the above listed existing Pages in your proposal and staple the revised Pages thereto. Staple New Page UC-12 after existing Page UC-11 in your proposal. Staple New Page RR-19 after existing Page RR-18 in your proposal.

On the item sheets the following pay item revisions have been made:

<u>Item</u>	<u>Description</u>	<u>Old Quantity</u>	<u>New Quantity</u>
0049-1297000000-E 607	MILLING ASPHALT PAVEMENT, 1-1/2" DEPTH	1,480 SY	2,040 SY
0050-1330000000-E 607	INCIDENTAL MILLING	1,620 SY	1,060 SY
0056-1880000000-E SP	ABC(M) CONSTRUCTION	677 TON	208 TON
0261-2847000000-N 858	RECONSTRUCT MANHOLE STRUCTURES	NEW	1 EA
0262-5882000000-N SP	8" NITRILE GASKETS	NEW	24 EA
0262-5882000000-N SP	NITRILE MANHOLE TO PIPE CONNECTORS	NEW	8 EA

The Contractor's bid must include these pay item revisions.

The electronic bidding file has been updated to reflect these revisions. Please download the Addendum File and follow the instructions for applying the addendum. Bid Express will not accept your bid unless the addendum has been applied.

The contract will be prepared accordingly.

Sincerely,

Signed by:

52C46046381F443...

Ronald E. Davenport, Jr., PE
 State Contract Officer

RED/jjr
 Attachments

cc: Mr. Wiley W. Jones III, PE
 Mr. Brandon H. Jones, PE
 Mr. Ken Kennedy, PE
 Mr. Malcolm Bell
 Mr. Forrest Dungan, PE
 Ms. Jaci Kincaid
 Mr. Jon Weathersbee, PE
 Project File (2)

STATE OF NORTH CAROLINA
DEPARTMENT OF TRANSPORTATION
RALEIGH, N.C.

PROPOSAL

INCLUDES ADDENDUM No.1 DATED 10-08-2024

DATE AND TIME OF BID OPENING: **Oct 15, 2024 AT 02:00 PM**

CONTRACT ID C204339
WBS 46927.3.1

FEDERAL-AID NO. STATE FUNDED
COUNTY WAKE
T.I.P NO. P-5715
MILES 0.387
ROUTE NO.
LOCATION NEW HOPE CHURCH ROAD GRADE SEPARATION OVER CSX RAIL LINE
(CROSSING #630607N AT MILE POST S 152.32).

TYPE OF WORK GRADING, DRAINAGE, PAVING, SIGNALS, AND STRUCTURES.

NOTICE:

ALL BIDDERS SHALL COMPLY WITH ALL APPLICABLE LAWS REGULATING THE PRACTICE OF GENERAL CONTRACTING AS CONTAINED IN CHAPTER 87 OF THE GENERAL STATUTES OF NORTH CAROLINA WHICH REQUIRES THE BIDDER TO BE LICENSED BY THE N.C. LICENSING BOARD FOR CONTRACTORS WHEN BIDDING ON ANY NON-FEDERAL AID PROJECT WHERE THE BID IS \$30,000 OR MORE, EXCEPT FOR CERTAIN SPECIALTY WORK AS DETERMINED BY THE LICENSING BOARD. BIDDERS SHALL ALSO COMPLY WITH ALL OTHER APPLICABLE LAWS REGULATING THE PRACTICES OF ELECTRICAL, PLUMBING, HEATING AND AIR CONDITIONING AND REFRIGERATION CONTRACTING AS CONTAINED IN CHAPTER 87 OF THE GENERAL STATUTES OF NORTH CAROLINA. NOTWITHSTANDING THESE LIMITATIONS ON BIDDING, THE BIDDER WHO IS AWARDED ANY FEDERAL - AID FUNDED PROJECT SHALL COMPLY WITH CHAPTER 87 OF THE GENERAL STATUTES OF NORTH CAROLINA FOR LICENSING REQUIREMENTS WITHIN 60 CALENDAR DAYS OF BID OPENING.

BIDS WILL BE RECEIVED AS SHOWN BELOW:

THIS IS A ROADWAY & STRUCTURE PROPOSAL

5% BID BOND OR BID DEPOSIT REQUIRED

PROJECT SPECIAL PROVISIONS**GENERAL****FEDERAL RAILROAD ADMINISTRATION CONTRACTOR PROVISIONS***March 2024***1. Introduction**

By entering into this Agreement with the State, the Contractor agrees to comply with these terms and conditions, including applicable federal funding-specific clauses in Section 32 of this Federal Railroad Administration (FRA) Contractor Provisions attachment and all applicable federal and State laws and regulations, including those identified in this FRA Contractor Provision attachment. The Contractor will ensure compliance with all terms of this Agreement and all of its parts for all tiers of subcontracts under this Agreement, as appropriate. Unless otherwise provided, the Department and the Contractor are defined individually as “Party” and collectively as “Parties” in this FRA Contractor Provision attachment.

When the Contractor is required to assist the Department in complying with a regulation, law, or contractual clause, the Department will provide notice of such obligation to the Contractor in writing. Notice of a number of these requirements is set out herein. However, the failure of this Agreement to expressly identify federal law applicable to the Contractor or activities under this Agreement does not make that law inapplicable.

2. Definitions

- A. “Agreement” means this New Hope Church Road Grade Separation Construction and Maintenance Agreement, including all attachments, exhibits, and amendments.
- B. “Approved Project Budget” means the most recently dated written statement, approved in writing by the Department, of the estimated total cost of the Project.
- C. “Authorized Representative” means the persons able and authorized to communicate on behalf of their respective organization, perform the referenced action, or commit the organization to the referenced action, pursuant to the organization’s internal policies, procedures, or reporting structure.
- D. “Department” means the North Carolina Department of Transportation.
- E. “Contractor” means any Party to this Agreement that is not the Department, including all subcontractors.
- F. “Department Project Manager” means the Department employee responsible for leading the planning, executing, monitoring, controlling, or closing for the

Project referenced in this Agreement.

- G. “Effective Date” means the execution date for this Agreement.
- H. “Federal Railroad Administration” or “FRA” means the operating administration of the U.S. Department of Transportation and the Federal Awarding Agency for the monies that either wholly or partially fund this Agreement.
- I. “Grant” as used in this Agreement means funding awarded to the Department for the Project through the Federal FY2023 Federal-State Partnership for Intercity Passenger Rail Program.
- J. “Project” means the task or set of tasks set forth in the Scope of Work for this Agreement.
- K. “Project Agreement Identification Number” means the Project Number (P-5715).
- L. “State Contribution” means the amount of funds that the Department agrees to provide under this Agreement, including any Grant funds.
- M. “State Funding Period” means the period that the Department will provide funds under this Agreement.
- N. “Scope of Work” means a detailed description of the work the Parties will complete with the funding from this Agreement and will be developed completely within each component of this Agreement.
- O. “Subcontract” means a contract entered into by the Contractor, as a pass-through entity, with a subcontractor for the subcontractor to carry out any part of this Project.
- P. “USDOT” means the United States Department of Transportation, including its operating administrations.
- Q. Additional definitions are found in 2 C.F.R. Part 200, Subpart A, and these Subpart A definitions are incorporated herein by reference and made a part of this Agreement. Subpart A definitions incorporated herein are not capitalized in this Agreement.

3. Agreement

This Agreement constitutes the entire agreement between the Department and the Contractor. All prior discussions and understandings concerning such scope and subject matter are superseded by this Agreement. This Agreement is governed by and subject to 2 C.F.R. Part 200, Uniform Administrative Requirements, Cost Principles and Audit Requirements for Federal Awards, and USDOT’s implementing regulations at 2 C.F.R. Part 1201.

4. Amendments

38. RESERVED**39. RESERVED****40. RESERVED****41. Critical Infrastructure Security and Resilience.**

Consistent with Presidential Policy Directive 21, “Critical Infrastructure Security and Resilience” (Feb. 12, 2013), and the National Security Presidential Memorandum on Improving Cybersecurity for Critical Infrastructure Control Systems (July 28, 2021), the Contractor will consider physical and cyber security and resilience in planning, design, and oversight of the Project.

42. Whistleblower Protection.

- A. (a) The Contractor acknowledges that it is a “Contractor” within the scope of 41 U.S.C. § 4712, which prohibits the Contractor from taking certain actions against an employee for certain disclosures of information that the employee reasonably believes are evidence of gross mismanagement of this Agreement, gross waste of Federal funds, or a violation of Federal law related to this Agreement.
- B. The Contractor will inform its employees in writing of the rights and remedies provided under 41 U.S.C. § 4712, in the predominant native language of the workforce.

43. New Restrictions on Lobbying.

- A. The Contractor must comply with 49 C.F.R. Part 20, “New Restrictions on

The liquidated damages are **Two Thousand Five Hundred Dollars (\$ 2,500.00)** per fifteen (15) minute time period.

INTERMEDIATE CONTRACT TIME NUMBER 5 AND LIQUIDATED DAMAGES:

(2-20-07) (Rev. 6-18-13)

108

SPI G14 F

The Contractor shall complete the work required of **Phase I, Step #2C** as shown on Sheet **TMP-3** and shall place and maintain traffic on same.

The time of availability for this intermediate contract time is the **Friday at 11:00 PM** that the Contractor elects to begin the work.

The completion time for this intermediate contract time is the following **Monday at 5:00 AM** after the time of availability.

The liquidated damages are **Two Thousand Five Hundred Dollars (\$ 2,500.00)** per fifteen (15) minute time period.

INTERMEDIATE CONTRACT TIME NUMBER 6 AND LIQUIDATED DAMAGES:

(2-20-07) (Rev. 6-18-13)

108

SPI G14 H

The Contractor shall complete the work required of **Phase II, Steps #2 & #3** as shown on Sheet **TMP-3** and shall place and maintain traffic on same.

The date of availability for this intermediate contract time is the date the Contractor elects to begin the work.

The completion date for this intermediate contract time is the date which is **seventy-five (75)** consecutive calendar days after and including the date the Contractor begins this work.

The liquidated damages are **Three Hundred Fifty Dollars (\$ 350.00)** per calendar day.

PERMANENT VEGETATION ESTABLISHMENT:

(2-16-12)(Rev. 1-16-24)

104

SPI G16

Establish a permanent stand of the vegetation mixture shown in the contract. During the period between initial vegetation planting and final project acceptance, perform all work necessary to establish permanent vegetation on all erodible areas within the project limits, as well as, in borrow and waste pits. This work shall include erosion control device maintenance and installation, repair seeding and mulching, supplemental seeding and mulching, mowing, and fertilizer topdressing, as directed. All work shall be performed in accordance with the applicable section of the *Standard Specifications*. All work required for initial vegetation planting shall be performed as a part of the work necessary for the completion and acceptance of the Intermediate Contract Time (ICT). Between the time of ICT and Final Project acceptance, or otherwise referred to as the vegetation establishment period, the Department will be responsible for preparing the required National Pollutant Discharge Elimination System (NPDES) inspection records.

Once the Engineer has determined that the permanent vegetation establishment requirement has been achieved at an 80% vegetation density (the amount of established vegetation per given area

PROJECT SPECIAL PROVISIONS**ROADWAY****CLEARING AND GRUBBING - METHOD III:**

(4-6-06)(Rev. 3-19-24)

200

SP2 R02B

Perform clearing on this project to the limits established by Method - III shown on Standard Drawing No. 200.03 of the *Roadway Standard Drawings*. Conventional clearing methods may be used except where permit drawings or conditions have been included in the proposal which require certain areas to be cleared by hand methods.

BURNING RESTRICTIONS:

(7-1-95)

200, 210, 215

SP2 R05

Open burning is not permitted on any portion of the right-of-way limits established for this project. Do not burn the clearing, grubbing or demolition debris designated for disposal and generated from the project at locations within the project limits, off the project limits or at any waste or borrow sites in this county. Dispose of the clearing, grubbing and demolition debris by means other than burning, according to state or local rules and regulations.

TEMPORARY DETOURS:

(7-1-95) (Rev. 11-19-13)

1101

SP2 R30B

Construct temporary detours required on this project in accordance with the typical sections in the plans or as directed.

After the detours have served their purpose, remove the portions deemed unsuitable for use as a permanent part of the project as directed by the Engineer. Salvage and stockpile the aggregate base course removed from the detours at locations within the right of way, as directed by the Engineer, for removal by State Forces. Place pavement and earth material removed from the detour in embankments or dispose of in waste areas furnished by the Contractor.

Aggregate base course and earth material that is removed will be measured and will be paid at the contract unit price per cubic yard for *Unclassified Excavation*. Pavement that is removed will be measured and will be paid at the contract unit price per square yard for *Removal of Existing _____ Pavement*. Pipe culverts removed from the detours remain the property of the Contractor. Pipe culverts that are removed will be measured and will be paid at the contract unit price per linear foot for *Pipe Removal*. Payment for the construction of the detours will be made at the contract unit prices for the various items involved.

Construction Methods

Place MQFs in the core of the embankment section with at least 4 feet of earth cover to the outside limits of the embankments or subgrade.

Construct embankments by placing MQFs in level uniform lifts with no more than a lift of 10 inches and compacted to at least a density of 95 percent as determined by test methods in AASHTO T 99, Determination of Maximum Dry Density and Optimum Moisture Content, Method A or C depending upon particle size of the product. Provide a moisture content at the time of compaction of within 4 percent of optimum but not greater than one percent above optimum as determined by AASHTO T 99, Method A or C.

In embankments where MQFs are incorporated, geotextile for subgrade stabilization shall be used. Refer to Article 505-2 of the *Standard Specifications* for geotextile type and Article 505-3 of the *Standard Specifications* for the geotextile construction methods.

Measurement and Payment

Borrow Excavation will be measured by truck volume and paid in cubic yards in accordance with Article 230-5 of the *Standard Specifications*. As an alternate weigh tickets can be provided and payment made by converting weight to cubic yards based on the verifiable unit weight. Where the pay item for *Borrow Excavation* is not included in the original contract then no separate payment will be made for this item and payment will be included in the lump sum price bid for *Grading*.

Geotextile for Subgrade Stabilization will be measured and paid in accordance with Article 505-4 of the *Standard Specifications*. When the pay item for *Geotextile for Subgrade Stabilization* is not included in the original contract then no payment will be made for this item and will be considered incidental to the use of MQFs in embankment.

ABC(M) CONSTRUCTION PER TON:**Description**

The Contractor shall place ABC(M) as shown on the typical sections and/or as directed by the Engineer. The area shall be backfilled and compacted to the satisfaction of the Engineer.

Materials

The ABC(M) shall meet the requirements of Section 1005 in the NCDOT Standard Specifications for Roads and Structures.

Construction Methods

Perform the ABC(M) construction in the following order: scarify the existing to provide the proper bond if directed by the Engineer; add a 4 inches layer of ABC(M); and compact to the satisfaction of the Engineer.

RR-19

Train Data:

Number of Trains – 4

Type of Trains – Freight

Speed – 25 mph

Project: P-5715

UC-12

County: Wake

PROJECT SPECIAL PROVISIONS
Utility Construction



320 S. Academy Street, Cary, NC 27511
(919) 890-3876 / www.cjsconveyance.com
License No.: P-1611



DocuSigned by:
Chris Windley 10/8/2024
53EB9FF683754F4...

NITRILE MANHOLE-TO-PIPE CONNECTORS

Materials

The nitrile manhole-to-pipe connector (“boot”) shall meet and or exceed ASTM C 923, Standard Specification for Resilient Connectors Between Reinforced Concrete Manholes, Structures, Pipes and laterals. All mechanical devices, including castings, bolt assemblies, adjusters shall use non-magnetic 300 series stainless steel with no welds or rivets in its assemblies. Take up clamps shall use non-magnetic 304 series stainless steel and be installed in the field.

Construction Methods

Nitrile manhole-to-pipe connectors shall be installed on sewer manholes where specified in the Drawings and in other areas if contaminated soil and/or groundwater are detected during excavation, or as directed by the Engineer. The use of the nitrile connectors shall extend at least forty (40) feet beyond the limit of petroleum contamination, or the total length as indicated on the Drawings, whichever extends further past the contamination.

The installation of the connector shall be accomplished at one time and shall require no additional adjustments or installation at a later time to insure a watertight seal. Selection of the proper size connector for the pipe requirement, and installation thereof, shall be in strict conformance with the recommendations of the manufacturer. Any testing also shall be conducted in strict conformance with the requirements of the manufacturer.

Measurement and Payment

Nitrile Manhole-to-Pipe Connectors will be measured and paid per each connector installed.

Payment will be made under:

Pay Item

Pay Unit

Nitrile Manhole-to-Pipe Connectors

Each

County: WAKE

Line #	Item Number	Sec #	Description	Quantity	Unit Cost	Amount
ROADWAY ITEMS						
0001	0000100000-N	800	MOBILIZATION	Lump Sum	L.S.	
0002	0000400000-N	801	CONSTRUCTION SURVEYING	Lump Sum	L.S.	
0003	0001000000-E	200	CLEARING & GRUBBING .. ACRE(S)	Lump Sum	L.S.	
0004	0008000000-E	200	SUPPLEMENTARY CLEARING & GRUBBING	1 ACR		
0005	0022000000-E	225	UNCLASSIFIED EXCAVATION	1,400 CY		
0006	0036000000-E	225	UNDERCUT EXCAVATION	1,450 CY		
0007	0106000000-E	230	BORROW EXCAVATION	175,000 CY		
0008	0134000000-E	240	DRAINAGE DITCH EXCAVATION	1,474 CY		
0009	0156000000-E	250	REMOVAL OF EXISTING ASPHALT PAVEMENT	1,280 SY		
0010	0177000000-E	250	BREAKING OF EXISTING ASPHALT PAVEMENT	9,500 SY		
0011	0195000000-E	265	SELECT GRANULAR MATERIAL	950 CY		
0012	0196000000-E	270	GEOTEXTILE FOR SOIL STABILIZATION	1,250 SY		
0013	0199000000-E	SP	TEMPORARY SHORING	18,478 SF		
0014	0234000000-E	SP	GENERIC GRADING ITEM HAULING OF EXISTING PAVEMENT	75 CY		
0015	0248000000-N	SP	GENERIC GRADING ITEM TYPE 1 BRIDGE APPROACH FILL, STA 21+77.88 -L- END BENT 2	Lump Sum	L.S.	
0016	0248000000-N	SP	GENERIC GRADING ITEM TYPE 2 BRIDGE APPROACH FILL, STA 20+48.87 -L- END BENT 1	Lump Sum	L.S.	
0017	0255000000-E	SP	GENERIC GRADING ITEM HAULING AND DISPOSAL OF PETROLEUM CONTAMINATED SOIL	50 TON		

County: WAKE

Line #	Item Number	Sec #	Description	Quantity	Unit Cost	Amount
0018	0318000000-E	300	FOUNDATION CONDITIONING MATERIAL, MINOR STRUCTURES	580 TON		
0019	0321000000-E	300	FOUNDATION CONDITIONING GEOTEXTILE	2,830 SY		
0020	0335200000-E	305	15" DRAINAGE PIPE	464 LF		
0021	0335300000-E	305	18" DRAINAGE PIPE	248 LF		
0022	0335400000-E	305	24" DRAINAGE PIPE	72 LF		
0023	0335850000-E	305	*** DRAINAGE PIPE ELBOWS (15")	8 EA		
0024	0335850000-E	305	*** DRAINAGE PIPE ELBOWS (18")	4 EA		
0025	0372000000-E	310	18" RC PIPE CULVERTS, CLASS III	248 LF		
0026	0448200000-E	310	15" RC PIPE CULVERTS, CLASS IV	1,068 LF		
0027	0448300000-E	310	18" RC PIPE CULVERTS, CLASS IV	264 LF		
0028	0448400000-E	310	24" RC PIPE CULVERTS, CLASS IV	428 LF		
0029	0448600000-E	310	36" RC PIPE CULVERTS, CLASS IV	68 LF		
0030	0539000000-E	310	*** POLYPROPYLENE PIPE CULVERTS (15")	460 LF		
0031	0539000000-E	310	*** POLYPROPYLENE PIPE CULVERTS (18")	308 LF		
0032	0973100000-E	330	*** WELDED STEEL PIPE, ***** THICK, GRADE B IN SOIL (36", 0.500")	66 LF		
0033	0973300000-E	330	*** WELDED STEEL PIPE, ***** THICK, GRADE B NOT IN SOIL (36", 0.500")	66 LF		
0034	0986000000-E	SP	GENERIC PIPE ITEM 15" WELDED STEEL PIPE (CONTRACTOR DESIGNED)	148 LF		

County: WAKE

Line #	Item Number	Sec #	Description	Quantity	Unit Cost	Amount
0035	0986000000-E	SP	GENERIC PIPE ITEM 18" WELDED STEEL PIPE (CONTRACTOR DESIGNED)	36 LF		
0036	0986000000-E	SP	GENERIC PIPE ITEM 36" WELDED STEEL PIPE (CONTRACTOR DESIGNED)	168 LF		
0037	0986000000-E	SP	GENERIC PIPE ITEM MASONRY DRAINAGE STRUCTURE (CONTRACTOR DESIGNED)	28.7 LF		
0038	0986000000-E	SP	GENERIC PIPE ITEM SEALED SYSTEM INSPECTION	1,252 LF		
0039	0992000000-E	SP	GENERIC PIPE ITEM MASONRY DRAINAGE STRUCTURE (CONTRACTOR DESIGNED)	12 EA		
0040	0995000000-E	340	PIPE REMOVAL	1,642 LF		
0041	0996000000-N	350	PIPE CLEAN OUT	1 EA		
0042	1011000000-N	500	FINE GRADING	Lump Sum	L.S.	
0043	1099500000-E	505	SHALLOW UNDERCUT	100 CY		
0044	1099700000-E	505	CLASS IV SUBGRADE STABILIZATION	3,360 TON		
0045	1112000000-E	505	GEOTEXTILE FOR SUBGRADE STABILIZATION	7,290 SY		
0046	1121000000-E	520	AGGREGATE BASE COURSE	80 TON		
0047	1220000000-E	545	INCIDENTAL STONE BASE	100 TON		
0048	1275000000-E	600	PRIME COAT	98 GAL		
0049	1297000000-E	607	MILLING ASPHALT PAVEMENT, **** DEPTH (1-1/2")	2,040 SY		
0050	1330000000-E	607	INCIDENTAL MILLING	1,060 SY		

County: WAKE

Line #	Item Number	Sec #	Description	Quantity	Unit Cost	Amount
0051	1491000000-E	610	ASPHALT CONC BASE COURSE, TYPE B25.0C	4,525 TON		
0052	1503000000-E	610	ASPHALT CONC INTERMEDIATE COURSE, TYPE I19.0C	3,525 TON		
0053	1519000000-E	610	ASPHALT CONC SURFACE COURSE, TYPE S9.5B	4,000 TON		
0054	1575000000-E	620	ASPHALT BINDER FOR PLANT MIX	635 TON		
0055	1693000000-E	654	ASPHALT PLANT MIX, PAVEMENT REPAIR	100 TON		
0056	1880000000-E	SP	GENERIC PAVING ITEM ABC(M) CONSTRUCTION	208 TON		
0057	2000000000-N	806	RIGHT-OF-WAY MARKERS	47 EA		
0058	2209000000-E	838	ENDWALLS	6.8 CY		
0059	2275000000-E	SP	FLOWABLE FILL	83 CY		
0060	2286000000-N	840	MASONRY DRAINAGE STRUCTURES	28 EA		
0061	2308000000-E	840	MASONRY DRAINAGE STRUCTURES	11.7 LF		
0062	2364000000-N	840	FRAME WITH TWO GRATES, STD 840.16	9 EA		
0063	2365000000-N	840	FRAME WITH TWO GRATES, STD 840.22	2 EA		
0064	2366000000-N	840	FRAME WITH TWO GRATES, STD 840.24	2 EA		
0065	2374000000-N	840	FRAME WITH GRATE & HOOD, STD 840.03, TYPE ** (E)	2 EA		
0066	2374000000-N	840	FRAME WITH GRATE & HOOD, STD 840.03, TYPE ** (F)	10 EA		
0067	2374000000-N	840	FRAME WITH GRATE & HOOD, STD 840.03, TYPE ** (G)	10 EA		

County: WAKE

Line #	Item Number	Sec #	Description	Quantity	Unit Cost	Amount
0068	2396000000-N	840	FRAME WITH COVER, STD 840.54	5 EA		
0069	2451000000-N	852	CONCRETE TRANSITIONAL SECTION FOR DROP INLET	2 EA		
0070	2549000000-E	846	2'-6" CONCRETE CURB & GUTTER	5,420 LF		
0071	2570000000-N	SP	MODIFIED CONCRETE FLUME	1 EA		
0072	2591000000-E	848	4" CONCRETE SIDEWALK	2,625 SY		
0073	2605000000-N	848	CONCRETE CURB RAMPS	19 EA		
0074	2612000000-E	848	6" CONCRETE DRIVEWAY	65 SY		
0075	2655000000-E	852	5" MONOLITHIC CONCRETE ISLANDS (KEYED IN)	180 SY		
0076	2738000000-E	SP	GENERIC PAVING ITEM REINFORCED CONCRETE BUS PAD	30 SY		
0077	2752000000-E	SP	GENERIC PAVING ITEM PEDESTRIAN SAFETY RAIL	100 LF		
0078	2800000000-N	858	ADJUSTMENT OF CATCH BASINS	2 EA		
0079	2830000000-N	858	ADJUSTMENT OF MANHOLES	2 EA		
0080	2845000000-N	858	ADJUSTMENT OF METER BOXES OR VALVE BOXES	3 EA		
0081	2860000000-N	859	CONVERT EXISTING CATCH BASIN TO JUNCTION BOX	1 EA		
0082	2950000000-N	859	CONVERT EXISTING JUNCTION BOX TO DROP INLET	1 EA		
0083	3030000000-E	862	STEEL BEAM GUARDRAIL	2,625 LF		
0084	3045000000-E	862	STEEL BEAM GUARDRAIL, SHOP CURVED	625 LF		

County: WAKE

Line #	Item Number	Sec #	Description	Quantity	Unit Cost	Amount
0085	3145000000-E	862	EXTRA LENGTH GUARDRAIL POST (** STEEL) (8')	8 EA		
0086	3150000000-N	862	ADDITIONAL GUARDRAIL POSTS	10 EA		
0087	3195000000-N	862	GUARDRAIL END UNITS, TYPE AT-1	1 EA		
0088	3210000000-N	862	GUARDRAIL END UNITS, TYPE CAT-1	3 EA		
0089	3215000000-N	862	GUARDRAIL ANCHOR UNITS, TYPE III	4 EA		
0090	3288000000-N	862	GUARDRAIL END UNITS, TYPE TL-2	8 EA		
0091	3575000000-E	SP	GENERIC FENCING ITEM BLACK VINYL COATED CHAIN LINK FENCE, 48" FABRIC	1,360 LF		
0092	3578000000-N	SP	GENERIC FENCING ITEM BLACK VINYL COATED METAL LINE POSTS, 48" CHAIN LINK FENCE	114 EA		
0093	3578000000-N	SP	GENERIC FENCING ITEM BLACK VINYL COATED METAL TERMINAL POSTS, 48" CHAIN LINK FENCE	14 EA		
0094	3628000000-E	876	RIP RAP, CLASS I	776 TON		
0095	3649000000-E	876	RIP RAP, CLASS B	120 TON		
0096	3656000000-E	876	GEOTEXTILE FOR DRAINAGE	2,529 SY		
0097	4025000000-E	901	CONTRACTOR FURNISHED, TYPE *** SIGN (D)	3.5 SF		
0098	4025000000-E	901	CONTRACTOR FURNISHED, TYPE *** SIGN (E)	130.84 SF		
0099	4072000000-E	903	SUPPORTS, 3-LB STEEL U-CHANNEL	300 LF		
0100	4096000000-N	904	SIGN ERECTION, TYPE D	1 EA		

County: WAKE

Line #	Item Number	Sec #	Description	Quantity	Unit Cost	Amount
0101	4102000000-N	904	SIGN ERECTION, TYPE E	26 EA		
0102	4116100000-N	904	SIGN ERECTION, RELOCATE TYPE **** (GROUND MOUNTED) (E)	2 EA		
0103	4155000000-N	907	DISPOSAL OF SIGN SYSTEM, U- CHANNEL	15 EA		
0104	4192000000-N	907	DISPOSAL OF SUPPORT, U-CHANNEL	2 EA		
0105	4400000000-E	1110	WORK ZONE SIGNS (STATIONARY)	712 SF		
0106	4405000000-E	1110	WORK ZONE SIGNS (PORTABLE)	207 SF		
0107	4410000000-E	1110	WORK ZONE SIGNS (BARRICADE MOUNTED)	271 SF		
0108	4415000000-N	1115	FLASHING ARROW BOARD	2 EA		
0109	4420000000-N	1120	PORTABLE CHANGEABLE MESSAGE SIGN	4 EA		
0110	4430000000-N	1130	DRUMS	110 EA		
0111	4445000000-E	1145	BARRICADES (TYPE III)	344 LF		
0112	4447000000-E	SP	PEDESTRIAN CHANNELIZING DEVICES	32 LF		
0113	4455000000-N	1150	FLAGGER	40 DAY		
0114	4465000000-N	1160	TEMPORARY CRASH CUSHIONS	6 EA		
0115	4480000000-N	1165	TMA	2 EA		
0116	4485000000-E	1170	PORTABLE CONCRETE BARRIER	3,255 LF		
0117	4490000000-E	1170	PORTABLE CONCRETE BARRIER (ANCHORED)	225 LF		

County: WAKE

Line #	Item Number	Sec #	Description	Quantity	Unit Cost	Amount
0118	4510000000-N	1190	LAW ENFORCEMENT	40 HR		
0119	4650000000-N	1251	TEMPORARY RAISED PAVEMENT MARKERS	146 EA		
0120	4685000000-E	1205	THERMOPLASTIC PAVEMENT MARKING LINES (4", 90 MILS)	15,625 LF		
0121	4695000000-E	1205	THERMOPLASTIC PAVEMENT MARKING LINES (8", 90 MILS)	1,050 LF		
0122	4709000000-E	1205	THERMOPLASTIC PAVEMENT MARKING LINES (24", 90 MILS)	550 LF		
0123	4725000000-E	1205	THERMOPLASTIC PAVEMENT MARKING SYMBOL (90 MILS)	39 EA		
0124	4726100000-E	1205	HEATED-IN-PLACE THERMOPLASTIC PAVEMENT MARKING CHARACTER (120 MILS)	6 EA		
0125	4726110000-E	1205	HEATED-IN-PLACE THERMOPLASTIC PAVEMENT MARKING SYMBOL (90 MILS)	33 EA		
0126	4770000000-E	1205	COLD APPLIED PLASTIC PAVEMENT MARKING LINES, TYPE ** (4") (IV)	720 LF		
0127	4810000000-E	1205	PAINT PAVEMENT MARKING LINES (4")	36,991 LF		
0128	4820000000-E	1205	PAINT PAVEMENT MARKING LINES (8")	2,228 LF		
0129	4830000000-E	1205	PAINT PAVEMENT MARKING LINES (16")	84 LF		
0130	4835000000-E	1205	PAINT PAVEMENT MARKING LINES (24")	114 LF		
0131	4840000000-N	1205	PAINT PAVEMENT MARKING CHARACTER	12 EA		
0132	4845000000-N	1205	PAINT PAVEMENT MARKING SYMBOL	16 EA		
0133	4846000000-E	1205	POLYUREA PAVEMENT MARKING LINES (***, *** MILS) (4", 30 MILS)	1,150 LF		

County: WAKE

Line #	Item Number	Sec #	Description	Quantity	Unit Cost	Amount
0134	4850000000-E	1205	REMOVAL OF PAVEMENT MARKING LINES (4")	3,220 LF		
0135	4860000000-E	1205	REMOVAL OF PAVEMENT MARKING LINES (8")	260 LF		
0136	4890000000-E	SP	GENERIC PAVEMENT MARKING ITEM YIELD LINE THERMOPLASTIC PAVEMENT MARKING, 24", 90 MILS	25 LF		
0137	4900000000-N	1251	PERMANENT RAISED PAVEMENT MARKERS	13 EA		
0138	5155000000-E	1409	ELECTRICAL DUCT, TYPE BD, SIZE ***** (2")	2,600 LF		
0139	5326200000-E	1510	12" WATER LINE	843 LF		
0140	5326600000-E	1510	16" WATER LINE	2,146 LF		
0141	5329000000-E	1510	DUCTILE IRON WATER PIPE FITTINGS	16,580 LB		
0142	5540000000-E	1515	6" VALVE	4 EA		
0143	5558000000-E	1515	12" VALVE	5 EA		
0144	5558600000-E	1515	16" VALVE	4 EA		
0145	5562000000-E	1515	*** INSERTION VALVE (12")	1 EA		
0146	5562000000-E	1515	*** INSERTION VALVE (16")	1 EA		
0147	5574000000-E	1515	30" TAPPING SLEEVE & VALVE	1 EA		
0148	5589300000-E	1515	3" AIR RELEASE VALVE	1 EA		
0149	5589400000-E	1515	4" AIR RELEASE VALVE	1 EA		
0150	5643150000-E	1515	1-1/2" WATER METER	1 EA		

County: WAKE

Line #	Item Number	Sec #	Description	Quantity	Unit Cost	Amount
0151	5648000000-N	1515	RELOCATE WATER METER	2 EA		
0152	5649000000-N	1515	RECONNECT WATER METER	3 EA		
0153	5656100000-E	1515	RELOCATE *** RPZ BACKFLOW PREVENTION ASSEMBLY (1-1/2")	1 EA		
0154	5666000000-N	1515	FIRE HYDRANT	4 EA		
0155	5672000000-N	1515	RELOCATE FIRE HYDRANT	1 EA		
0156	5673000000-E	1515	FIRE HYDRANT LEG	45 LF		
0157	5686000000-E	1515	*** WATER SERVICE LINE (1-1/2")	129 LF		
0158	5691300000-E	1520	8" SANITARY GRAVITY SEWER	1,325.91 LF		
0159	5768000000-N	1520	SANITARY SEWER CLEAN-OUT	8 EA		
0160	5768500000-E	1520	SEWER SERVICE LINE	488 LF		
0161	5775000000-E	1525	4' DIA UTILITY MANHOLE	5 EA		
0162	5781000000-E	1525	UTILITY MANHOLE WALL 4' DIA	42.3 LF		
0163	5801000000-E	1530	ABANDON 8" UTILITY PIPE	1,425 LF		
0164	5804000000-E	1530	ABANDON 12" UTILITY PIPE	1,021 LF		
0165	5810000000-E	1530	ABANDON 16" UTILITY PIPE	1,835 LF		
0166	5815000000-N	1530	REMOVE WATER METER	2 EA		
0167	5815500000-N	1530	REMOVE FIRE HYDRANT	5 EA		

County: WAKE

Line #	Item Number	Sec #	Description	Quantity	Unit Cost	Amount
0168	5816000000-N	1530	ABANDON UTILITY MANHOLE	6 EA		
0169	5828000000-N	1530	REMOVE UTILITY MANHOLE	2 EA		
0170	5835700000-E	1540	16" ENCASEMENT PIPE	150 LF		
0171	5836200000-E	1540	30" ENCASEMENT PIPE	437 LF		
0172	5872500000-E	1550	BORE AND JACK OF *** (16")	150 LF		
0173	5872500000-E	1550	BORE AND JACK OF *** (30")	150 LF		
0174	5882000000-N	SP	GENERIC UTILITY ITEM 16" NITRILE GASKETS	14 EA		
0175	5882000000-N	SP	GENERIC UTILITY ITEM 4' DIA UTILITY MANHOLE WITH EXTENDED BASE	3 EA		
0176	5882000000-N	SP	GENERIC UTILITY ITEM 8" SANITARY SEWER MAIN POINT REPAIR	1 EA		
0177	6000000000-E	1605	TEMPORARY SILT FENCE	14,020 LF		
0178	6006000000-E	1610	STONE FOR EROSION CONTROL, CLASS A	300 TON		
0179	6009000000-E	1610	STONE FOR EROSION CONTROL, CLASS B	2,010 TON		
0180	6012000000-E	1610	SEDIMENT CONTROL STONE	1,405 TON		
0181	6015000000-E	1615	TEMPORARY MULCHING	11 ACR		
0182	6018000000-E	1620	SEED FOR TEMPORARY SEEDING	600 LB		
0183	6021000000-E	1620	FERTILIZER FOR TEMPORARY SEEDING	3.5 TON		
0184	6024000000-E	1622	TEMPORARY SLOPE DRAINS	1,110 LF		

County: WAKE

Line #	Item Number	Sec #	Description	Quantity	Unit Cost	Amount
0185	6029000000-E	SP	SAFETY FENCE	240 LF		
0186	6030000000-E	1630	SILT EXCAVATION	5,460 CY		
0187	6036000000-E	1631	MATTING FOR EROSION CONTROL	12,000 SY		
0188	6037000000-E	1629	COIR FIBER MAT	100 SY		
0189	6038000000-E	SP	PERMANENT SOIL REINFORCEMENT MAT	280 SY		
0190	6042000000-E	1632	1/4" HARDWARE CLOTH	3,945 LF		
0191	6043000000-E	1644	LOW PERMEABILITY GEOTEXTILE	300 SY		
0192	6071002000-E	1642	FLOCCULANT	205 LB		
0193	6071012000-E	1642	COIR FIBER WATTLE	1,240 LF		
0194	6071050000-E	1644	*** SKIMMER (1-1/2")	8 EA		
0195	6084000000-E	1660	SEEDING & MULCHING	18 ACR		
0196	6087000000-E	1660	MOWING	15 ACR		
0197	6090000000-E	1661	SEED FOR REPAIR SEEDING	150 LB		
0198	6093000000-E	1661	FERTILIZER FOR REPAIR SEEDING	1.5 TON		
0199	6096000000-E	1662	SEED FOR SUPPLEMENTAL SEEDING	400 LB		
0200	6108000000-E	1665	FERTILIZER TOPDRESSING	11.5 TON		
0201	6114500000-N	1667	SPECIALIZED HAND MOWING	10 MHR		

County: WAKE

Line #	Item Number	Sec #	Description	Quantity	Unit Cost	Amount
0202	6117000000-N	1675	RESPONSE FOR EROSION CONTROL	100 EA		
0203	6117500000-N	SP	CONCRETE WASHOUT STRUCTURE	4 EA		
0204	6132000000-N	SP	GENERIC EROSION CONTROL ITEM FABRIC INSERT INLET PROTECTION CLEANOUT	120 EA		
0205	6132000000-N	SP	GENERIC EROSION CONTROL ITEM FABRIC INSERT INLET PROTECTION, TYPE 1	40 EA		
0206	7048500000-E	1705	PEDESTRIAN SIGNAL HEAD (16", 1 SECTION W/COUNTDOWN)	5 EA		
0207	7060000000-E	1705	SIGNAL CABLE	2,650 LF		
0208	7120000000-E	1705	VEHICLE SIGNAL HEAD (12", 3 SECTION)	1 EA		
0209	7144000000-E	1705	VEHICLE SIGNAL HEAD (12", 5 SECTION)	2 EA		
0210	7229000000-N	SP	APS DETECTOR STATION	10 EA		
0211	7230000000-N	SP	CENTRAL CONTROL UNIT APS DETECTOR STATION	1 EA		
0212	7252000000-E	1710	MESSENGER CABLE (1/4")	2,250 LF		
0213	7279000000-E	1715	TRACER WIRE	25 LF		
0214	7288000000-E	1715	PAVED TRENCHING (***** (1, 2")	100 LF		
0215	7300000000-E	1715	UNPAVED TRENCHING (***** (1, 1")	100 LF		
0216	7300000000-E	1715	UNPAVED TRENCHING (***** (1, 2")	50 LF		
0217	7301000000-E	1715	DIRECTIONAL DRILL (***** (1, 2")	50 LF		
0218	7324000000-N	1716	JUNCTION BOX (STANDARD SIZE)	3 EA		

County: WAKE

Line #	Item Number	Sec #	Description	Quantity	Unit Cost	Amount
0219	7372000000-N	1721	GUY ASSEMBLY	8 EA		
0220	7396000000-E	1722	1/2" RISER WITH WEATHERHEAD	1 EA		
0221	7420000000-E	1722	2" RISER WITH WEATHERHEAD	1 EA		
0222	7444000000-E	1725	INDUCTIVE LOOP SAWCUT	675 LF		
0223	7456100000-E	1726	LEAD-IN CABLE (14-2)	3,375 LF		
0224	7481000000-N	SP	SITE SURVEY	1 EA		
0225	7481240000-N	SP	CAMERA WITHOUT INTERNAL LOOP EMULATOR PROCESSING UNIT	1 EA		
0226	7481260000-N	SP	EXTERNAL LOOP EMULATOR PROCESSING UNIT	1 EA		
0227	7516000000-E	1730	COMMUNICATIONS CABLE (** FIBER) (12)	2,550 LF		
0228	7528000000-E	1730	DROP CABLE	350 LF		
0229	7540000000-N	1731	SPLICE ENCLOSURE	1 EA		
0230	7541000000-N	1731	MODIFY SPLICE ENCLOSURE	1 EA		
0231	7575160000-E	1734	REMOVE EXISTING COMMUNICATIONS CABLE	2,925 LF		
0232	7636000000-N	1745	SIGN FOR SIGNALS	8 EA		
0233	7642200000-N	1743	TYPE II PEDESTAL WITH FOUNDATION	4 EA		
0234	7696000000-N	1751	CONTROLLERS WITH CABINET (*****) (TYPE 2070LX, BASE MOUNTED)	1 EA		
0235	7744000000-N	1751	DETECTOR CARD (TYPE 170)	12 EA		

County: WAKE

Line #	Item Number	Sec #	Description	Quantity	Unit Cost	Amount
0236	7901000000-N	1753	CABINET BASE EXTENDER	1 EA		
0237	7980000000-N	SP	GENERIC SIGNAL ITEM LUMINAIRE ARM FOR TEMPORARY VIDEO SYSTEM	1 EA		
0261	2847000000-N	858	RECONSTRUCT MANHOLE STRUCTURES	1 EA		
0262	5882000000-N	SP	GENERIC UTILITY ITEM 8" NITRILE GASKETS	24 EA		
0263	5882000000-N	SP	GENERIC UTILITY ITEM NITRILE MANHOLE TO PIPE CONNECTORS	8 EA		

***** BEGIN SCHEDULE AA *****
 ***** (5 ALTERNATES) *****

0238 AA1	4894900000-E	SP	GENERIC PAVEMENT MARKING ITEM 10' INLAID PAVEMENT MARKINGS	214 EA		
-------------	--------------	----	---	-----------	--	--

*** OR ***

0239 AA2	4894900000-E	SP	GENERIC PAVEMENT MARKING ITEM 10' RUMBLE SKIPS	214 EA		
-------------	--------------	----	---	-----------	--	--

*** OR ***

0240 AA3	4895000000-N	SP	GENERIC PAVEMENT MARKING ITEM INLAID CRADLE MARKERS	214 EA		
-------------	--------------	----	--	-----------	--	--

*** OR ***

0241 AA4	4895000000-N	SP	GENERIC PAVEMENT MARKING ITEM INLAID RAISED PAVEMENT MARKERS	214 EA		
-------------	--------------	----	---	-----------	--	--

*** OR ***

0242 AA5	4895000000-N	SP	GENERIC PAVEMENT MARKING ITEM POLYCARBONATE H-SHAPED MARKERS	214 EA		
-------------	--------------	----	--	-----------	--	--

***** END SCHEDULE AA *****

***** BEGIN SCHEDULE BB *****
 ***** (2 ALTERNATES) *****

0243 BB1	2473000000-N	SP	GENERIC DRAINAGE ITEM RESILENT CONNECTOR	25 EA		
-------------	--------------	----	---	----------	--	--

*** OR ***

0244 BB2	2253000000-E	840	PIPE COLLARS	11 CY		
-------------	--------------	-----	--------------	----------	--	--

***** END SCHEDULE BB *****

County: WAKE

Line #	Item Number	Sec #	Description	Quantity	Unit Cost	Amount
WALL ITEMS						
0245	8801000000-E	SP	MSE RETAINING WALL NO **** (W1)	20,070 SF		
0246	8801000000-E	SP	MSE RETAINING WALL NO **** (W2)	21,200 SF		
STRUCTURE ITEMS						
0247	8147000000-E	420	REINFORCED CONCRETE DECK SLAB	10,220 SF		
0248	8161000000-E	420	GROOVING BRIDGE FLOORS	11,318 SF		
0249	8182000000-E	420	CLASS A CONCRETE (BRIDGE)	147.9 CY		
0250	8210000000-N	422	BRIDGE APPROACH SLABS, STATION ***** (20+97.25 -L-)	Lump Sum	L.S.	
0251	8217000000-E	425	REINFORCING STEEL (BRIDGE)	25,729 LB		
0252	8328200000-E	450	PILE DRIVING EQUIPMENT SETUP FOR *** STEEL PILES (HP 14 X 73)	20 EA		
0253	8384000000-E	450	HP 14 X 73 STEEL PILES	1,700 LF		
0254	8393000000-N	450	PILE REDRIVES	10 EA		
0255	8394000000-N	450	DYNAMIC PILE TESTING	2 EA		
0256	8482000000-E	460	THREE BAR METAL RAIL	229 LF		
0257	8531000000-E	462	4" SLOPE PROTECTION	1,397 SY		
0258	8657000000-N	430	ELASTOMERIC BEARINGS	Lump Sum	L.S.	
0259	8867000000-E	SP	GENERIC STRUCTURE ITEM BRIDGE MOUNTED BLACK VINYL COATED CHAIN LINK FENCE	228.14 LF		

County: WAKE

Line #	Item Number	Sec #	Description	Quantity	Unit Cost	Amount
0260	8867000000-E	SP	GENERIC STRUCTURE ITEM MODIFIED 54" PRESTRESSED CONCRETE GIRDERS	1,453 LF		

1017/Oct08/Q516962.29/D1150538584000/E263

Total Amount Of Bid For Entire Project :

6/2/2024

PAVEMENT SCHEDULE

C1	PROP. APPROX. 1.5" ASPHALT CONCRETE SURFACE COURSE TYPE S9.5B, AT AN AVERAGE RATE OF 165 LBS. PER SQ. YD.	K	8" CLASS IV SUBGRADE STABILIZATION.
C2	PROP. APPROX. 2" ASPHALT CONCRETE SURFACE COURSE TYPE S9.5B, AT AN AVERAGE RATE OF 110 LBS. PER SQ. YD. IN EACH OF TWO LAYERS.	N	GEOTEXTILE FOR SUBGRADE STABILIZATION.
C3	PROP. APPROX. 3" ASPHALT CONCRETE SURFACE COURSE TYPE S9.5B, AT AN AVERAGE RATE OF 165 LBS. PER SQ. YD. IN EACH OF TWO LAYERS.	P	PRIME COAT
C4	PROP. VAR. DEPTH ASPHALT CONCRETE SURFACE COURSE, TYPE S9.5B, AT AN AVERAGE RATE OF 110 LBS. PER SQ. YD. PER 1" DEPTH. TO BE PLACED IN LAYERS NOT TO EXCEED 1 1/2" IN DEPTH.	R1	2'-6" CONCRETE CURB AND GUTTER.
D1	PROP. APPROX. 4" ASPHALT CONCRETE INTERMEDIATE COURSE, TYPE I19.0C, AT AN AVERAGE RATE OF 456 LBS. PER SQ. YD.	R2	5" MONOLITHIC CONCRETE ISLAND (KEYED-IN).
D2	PROP. VAR. DEPTH ASPHALT CONCRETE INTERMEDIATE COURSE, TYPE I19.0C, AT AN AVERAGE RATE OF 114 LBS. PER SQ. YD. PER 1" DEPTH, TO BE PLACED IN LAYERS NOT LESS THAN 2 1/2" IN DEPTH OR GREATER THAN 4" IN DEPTH.	S	4" CONCRETE SIDEWALK.
E1	PROP. APPROX. 4" ASPHALT CONCRETE BASE COURSE, TYPE B25.0C, AT AN AVERAGE RATE OF 456 LBS. PER SQ. YD.	T	EARTH MATERIAL.
E2	PROP. VAR. DEPTH ASPHALT CONCRETE BASE COURSE, TYPE B25.0C, AT AN AVERAGE RATE OF 114 LBS. PER SQ. YD. PER 1" DEPTH, TO BE PLACED IN LAYERS NOT LESS THAN 3" IN DEPTH OR GREATER THAN 5 1/2" IN DEPTH.	U	EXISTING PAVEMENT.
J1	PROP. 6" AGGREGATE BASE COURSE	V	MILLING OF EXISTING PAVEMENT 1.5" DEPTH
J2	PROP. 4" AGGREGATE BASE COURSE (M) SHOULDER CONSTRUCTION. SEE SPECIAL PROVISION.	W	VARIABLE DEPTH ASPHALT PAVEMENT (SEE METHOD OF WEDGING DETAIL).

NOTE: PAVEMENT EDGE SLOPES ARE 1:1 UNLESS SHOWN OTHERWISE.

PROJECT REFERENCE NO. <i>P-5715</i>	SHEET NO. <i>2A-1</i>
ROADWAY DESIGN ENGINEER <i>Stephen T. Smallwood</i> 10/2/2024	PAVEMENT DESIGN ENGINEER <i>Andrew D. Wake</i> 10/3/2024
DOCUMENT NOT CONSIDERED FINAL UNLESS ALL SIGNATURES COMPLETED	

Stantec
Stantec Consulting Services Inc.
801 Jones Franklin Road
Suite 300
Raleigh, NC 27606
Tel. (919) 851-6866
Fax. (919) 851-7024
www.stantec.com
License No. F-0672

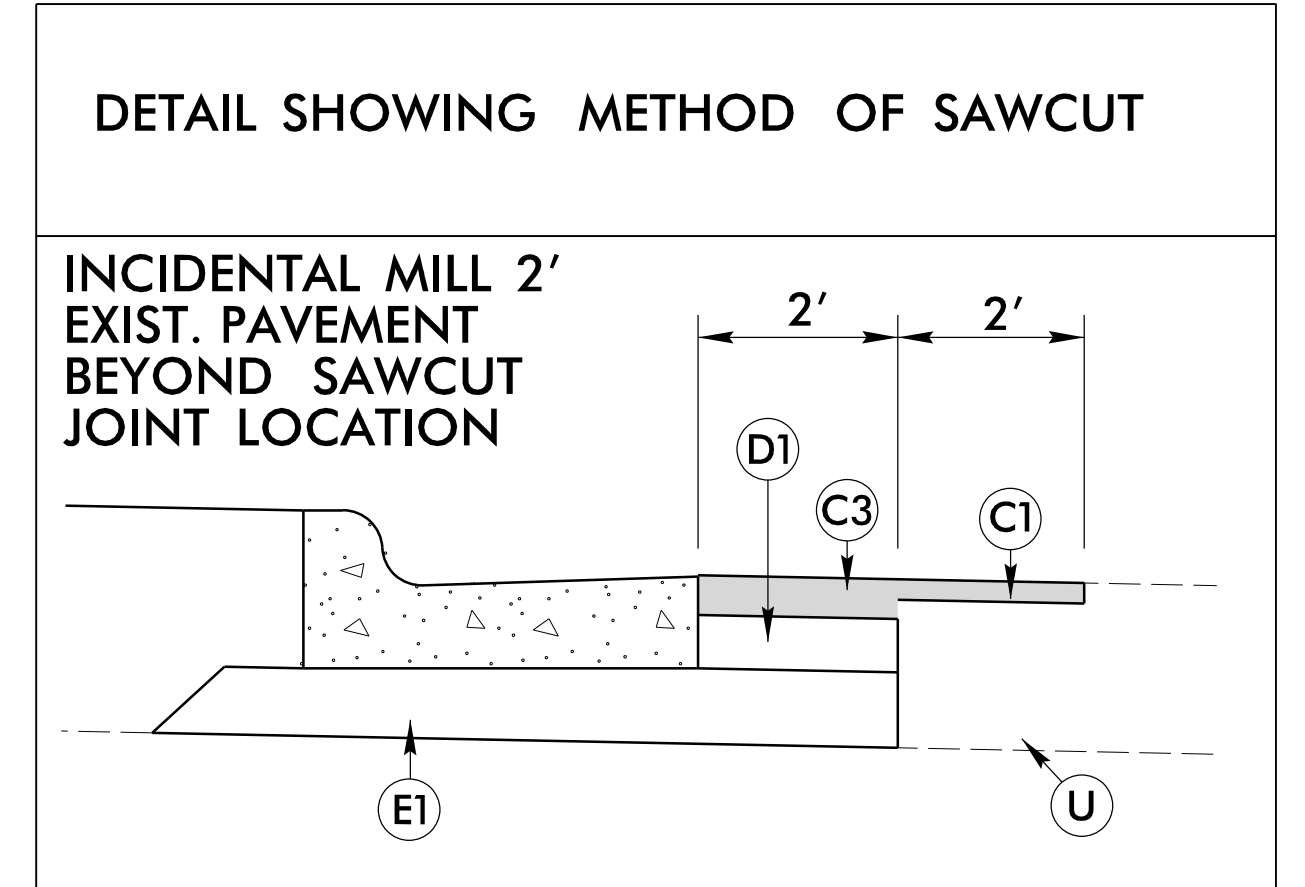
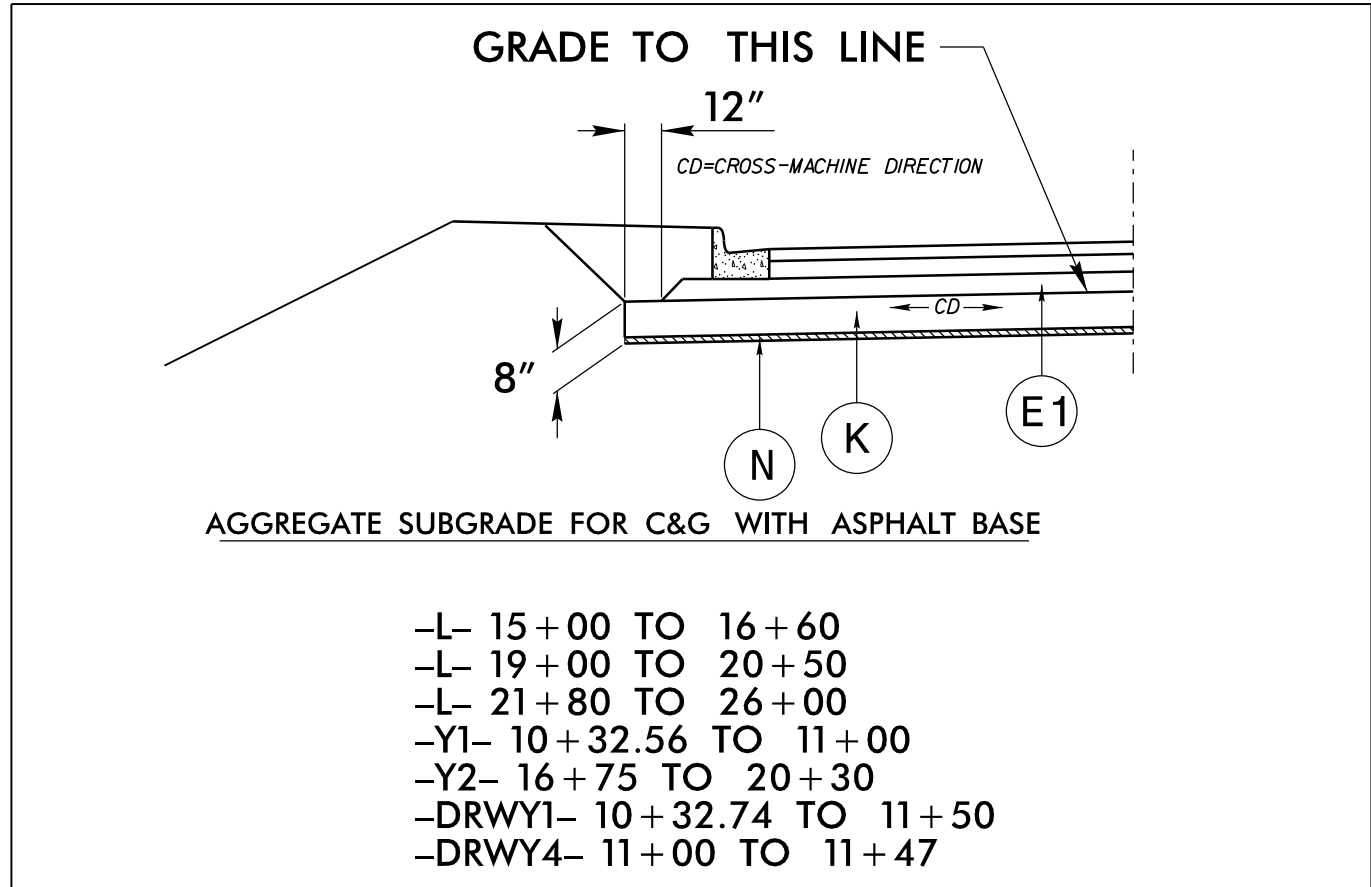
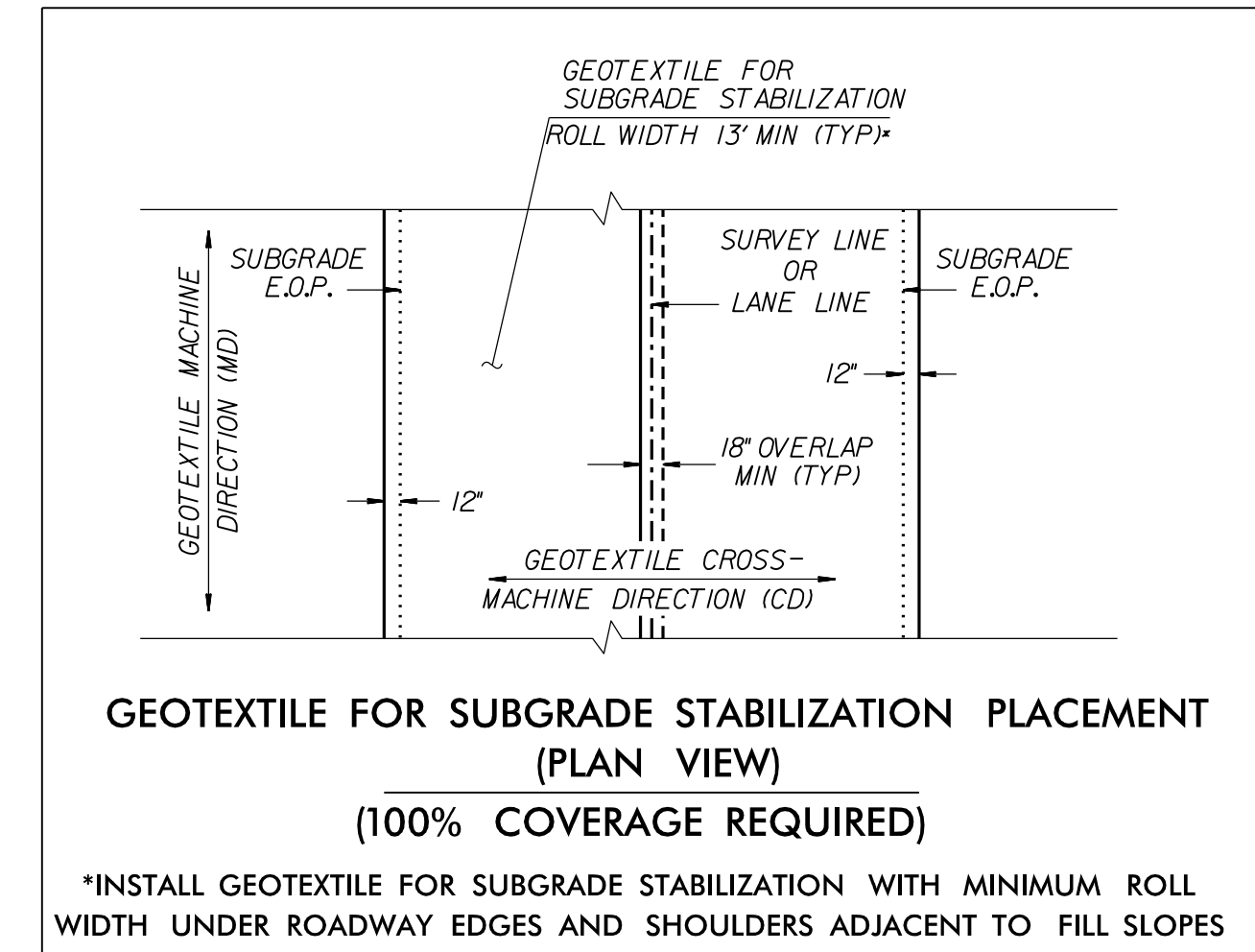
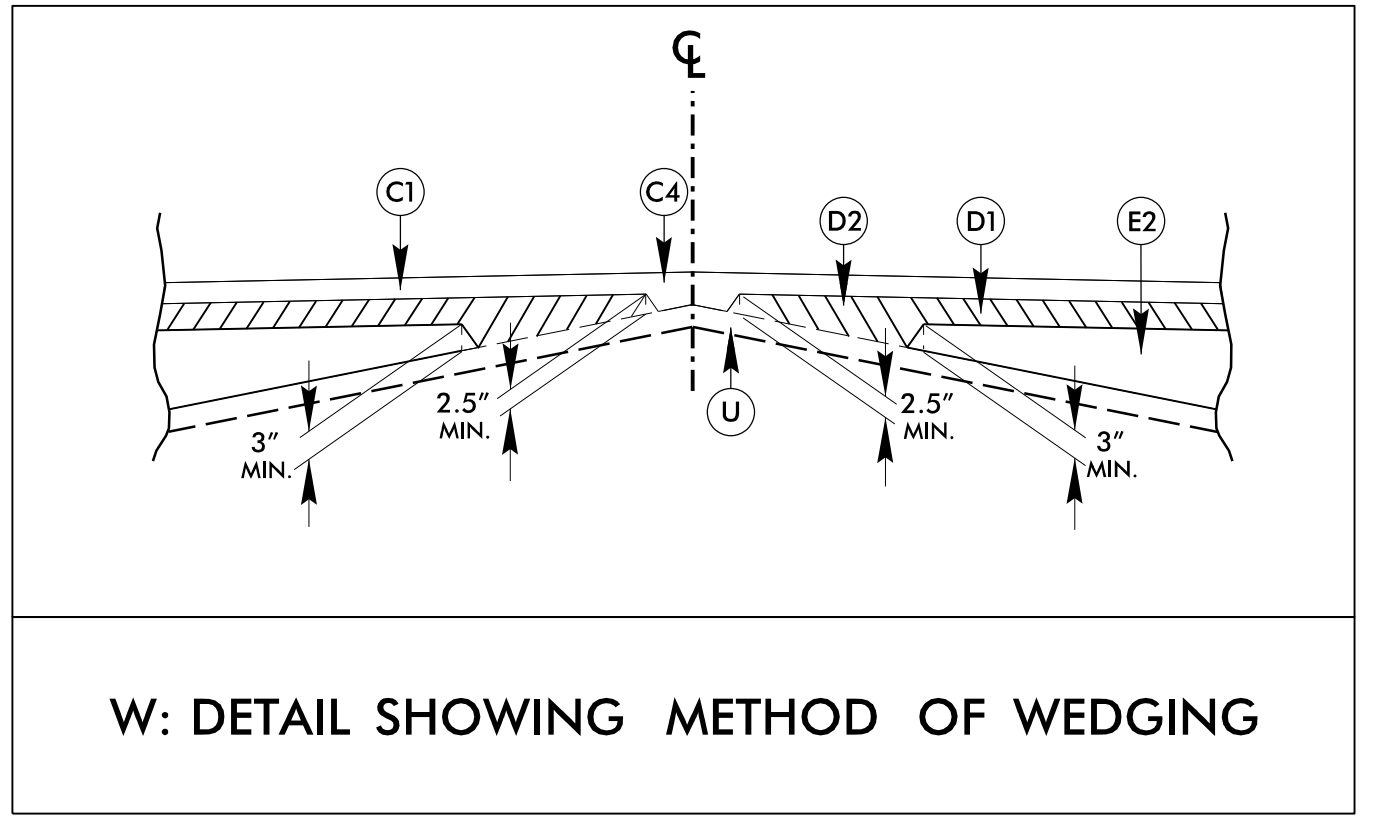
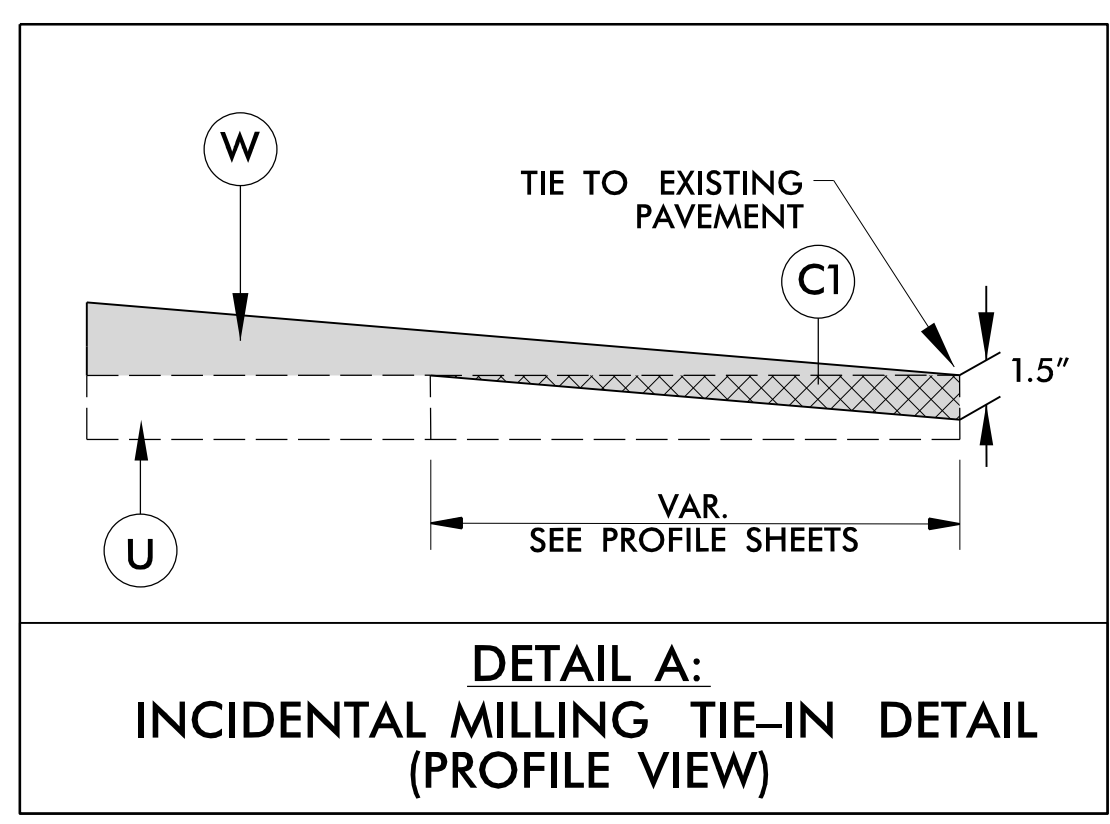

10/1/2024 10:45:04 AM \\P01\proj\105715\rdj_tjip.dgn stam111000

6/2/2024

Stantec
 Stantec Consulting Services Inc.
 801 Jones Franklin Road
 Suite 300
 Raleigh, NC 27606
 Tel. (919) 851-6906
 Fax. (919) 851-7024
 www.stantec.com
 License No. F-0672

PROJECT REFERENCE NO. P-5715	SHEET NO. 2A-2
ROADWAY DESIGN ENGINEER SEAL: [Signature] 022037 STEPHEN T. SMALLWOOD ENGINEER	PAVEMENT DESIGN ENGINEER SEAL: [Signature] 044590 ANDREW D. WAGCO ENGINEER
10/2/2024	10/3/2024

**DOCUMENT NOT CONSIDERED FINAL
UNLESS ALL SIGNATURES COMPLETED**

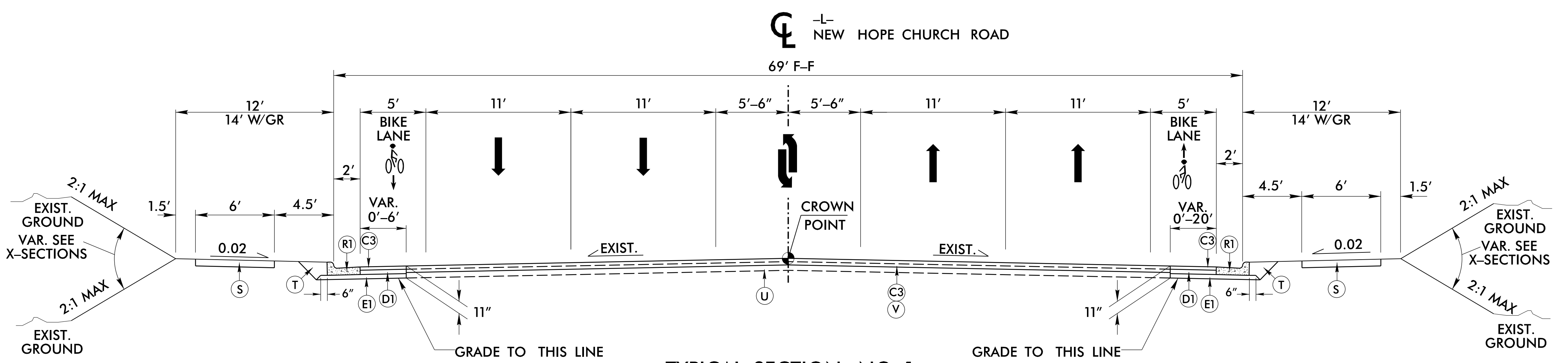

TYPICAL SECTION NO. 1
 -L- STA. 11+10.00 TO 12+40.00

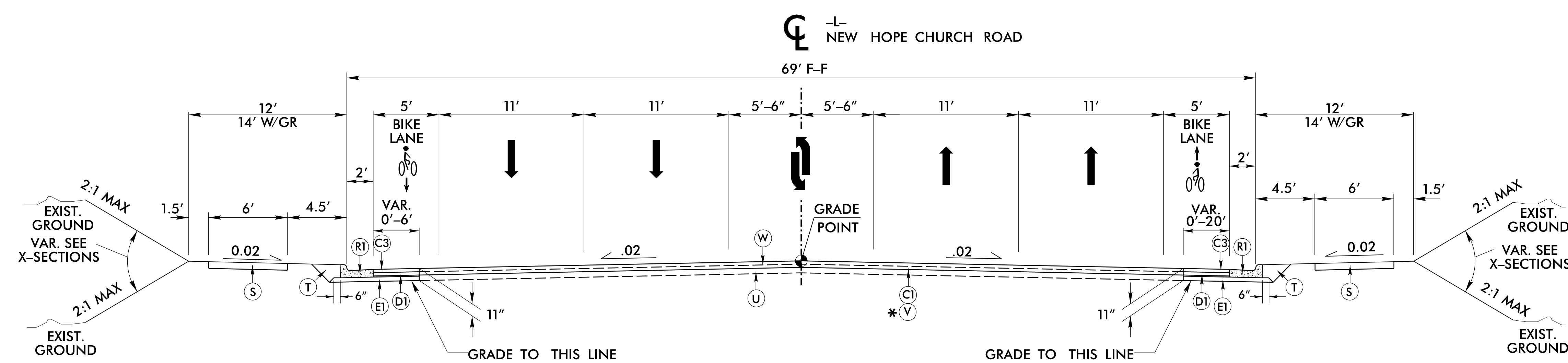

TYPICAL SECTION NO. 2
 * -L- STA. 12+40.00 TO 13+40.00
 -L- STA. 26+75(LT) & 27+15.00(RT) TO 31+55.00

PAVEMENT SCHEDULE	
C1	PROP. APPROX. 1.5", TYPE S9.5B
C2	PROP. APPROX. 2", TYPE S9.5B
C3	PROP. APPROX. 3", TYPE S9.5B
C4	PROP. VAR. DEPTH, TYPE S9.5B
D1	PROP. APPROX. 4", I19.0C
D2	PROP. VAR. DEPTH, TYPE I19.0C
E1	PROP. APPROX. 4", TYPE B25.0C
E2	PROP. VAR. DEPTH, TYPE B25.0C
J1	PROP. 6" AGGREGATE BASE COURSE
J2	PROP. 4" AGGREGATE BASE COURSE (M)
K	CLASS IV SUB. STAB.
N	GEOTEXTILE FOR SUB. STAB.
P	Prime Coat
R1	2'-6" CONCRETE CURB AND GUTTER
R2	5" MONOLITHIC CONCRETE ISLAND
S	4" CONCRETE SIDEWALK
T	EARTH MATERIAL
U	EXISTING PAVEMENT
V	1.5" MILLING
W	VARIABLE DEPTH ASPHALT PAVEMENT (SEE STANDARD WEDGING DETAIL)

NOTE: PAVEMENT EDGE SLOPES ARE 1:1 UNLESS SHOWN OTHERWISE.

10/2/2024
 U:\Projects\2024\New Hope Church Road\Drawings\2A-2.dwg
 stam111000

6/2/2024

Stantec
 Stantec Consulting Services Inc.
 801 Jones Franklin Road
 Suite 300
 Raleigh, NC 27606
 Tel. (919) 851-6906
 Fax. (919) 851-7024
 www.stantec.com
 License No. F-0672

PROJECT REFERENCE NO. P-5715	SHEET NO. 2A-3
ROADWAY DESIGN ENGINEER SEAL 022037 STEPHEN T. SMALLWOOD	PAVEMENT DESIGN ENGINEER SEAL 044590 ANDREW D. WATCO
10/2/2024	10/3/2024

**DOCUMENT NOT CONSIDERED FINAL
UNLESS ALL SIGNATURES COMPLETED**

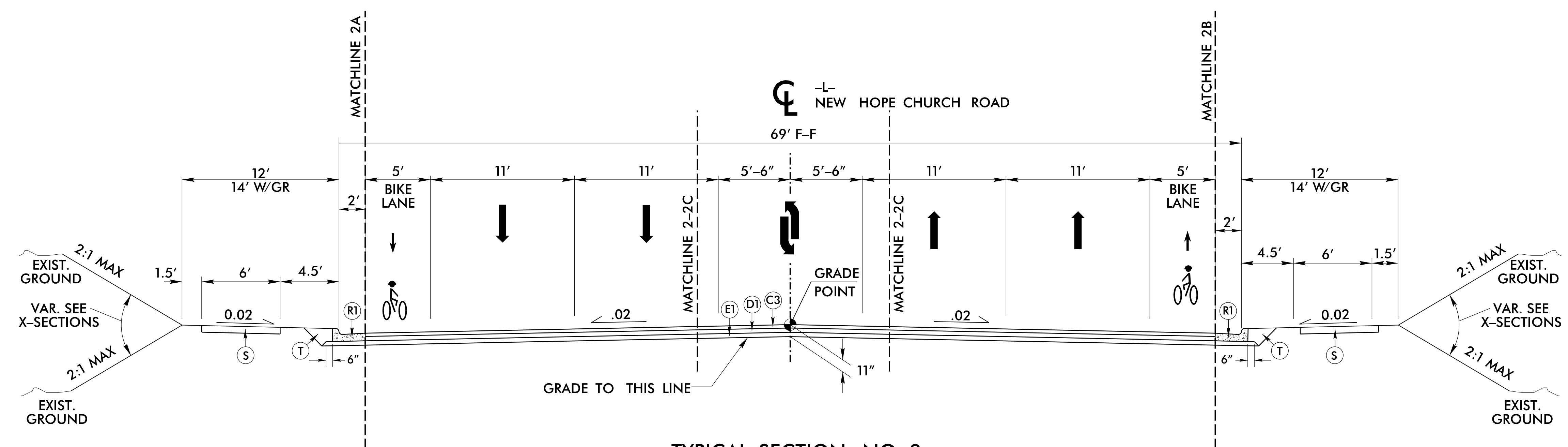

TYPICAL SECTION NO. 3
 -L- STA. 13+40.00 TO 20+48.37 (BEGIN BRIDGE)
 -L- STA. 21+72.12 (END BRIDGE) TO 26+75(LT) & 27+15.00(RT)

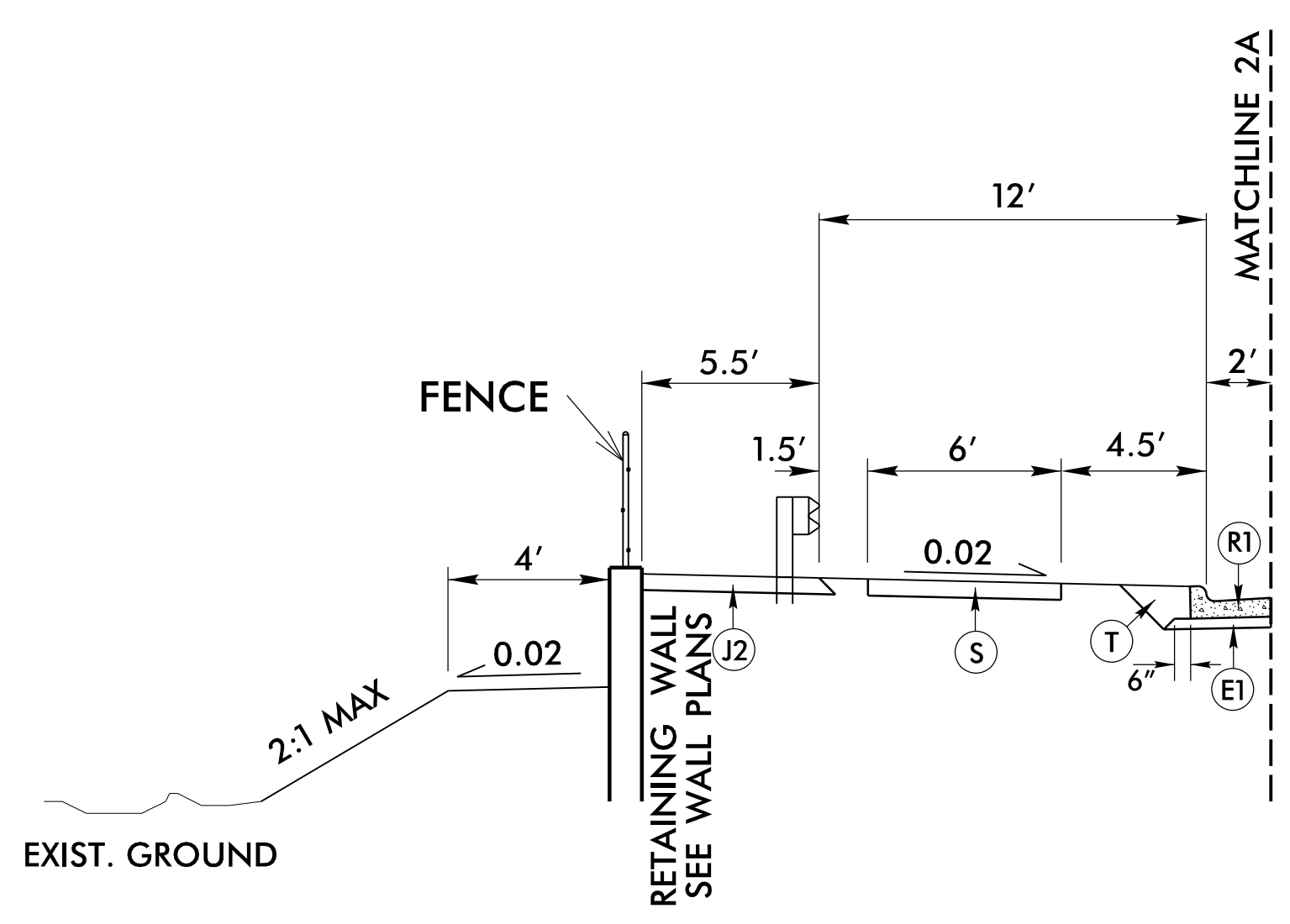

TYPICAL SECTION 3-3A
 USE IN CONJUNCTION WITH
 TYPICAL SECTION 3
 -L- STA. 16+60.00 TO 20+64.24 LT

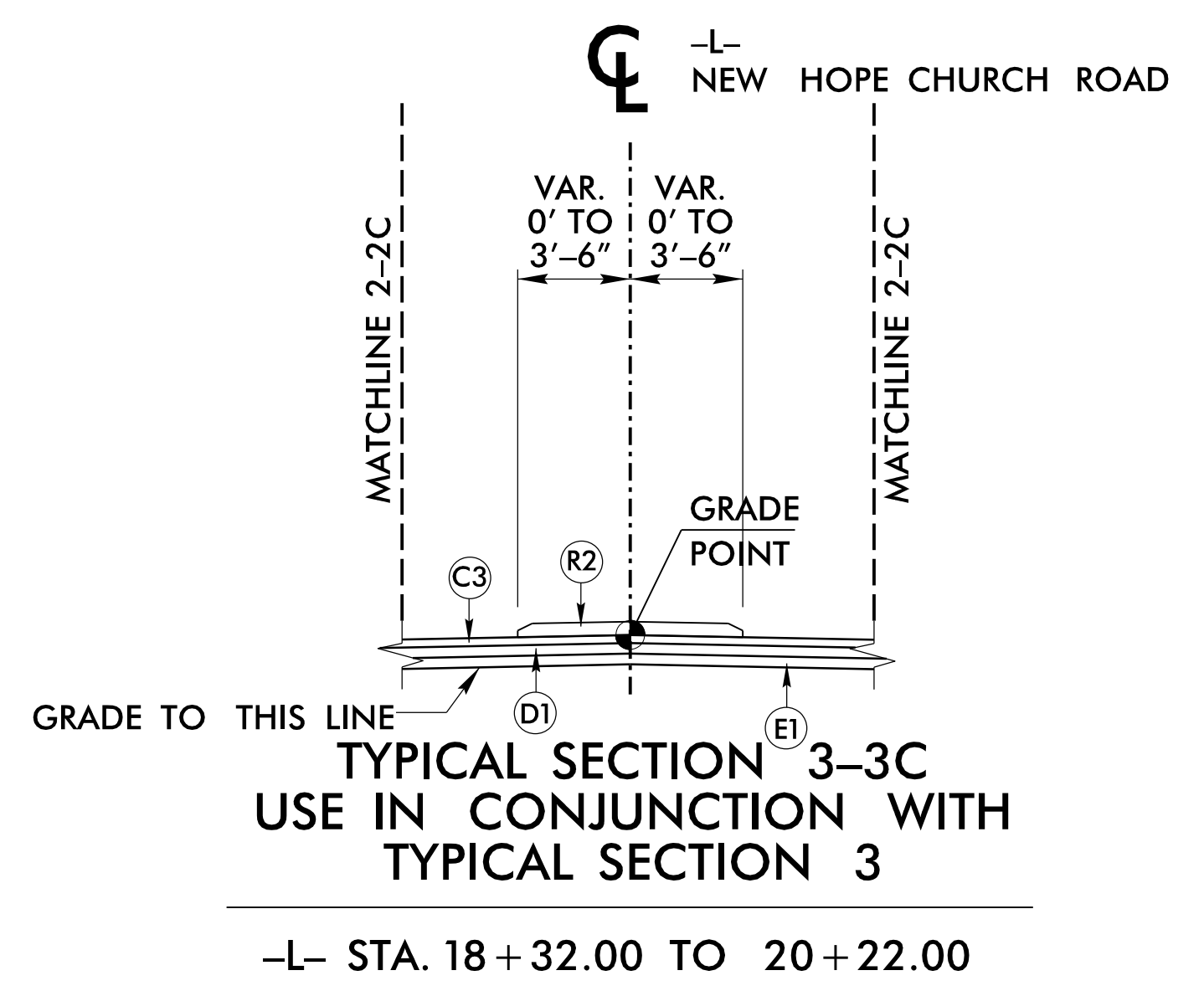

TYPICAL SECTION 3-3C
 USE IN CONJUNCTION WITH
 TYPICAL SECTION 3
 -L- STA. 18+32.00 TO 20+22.00

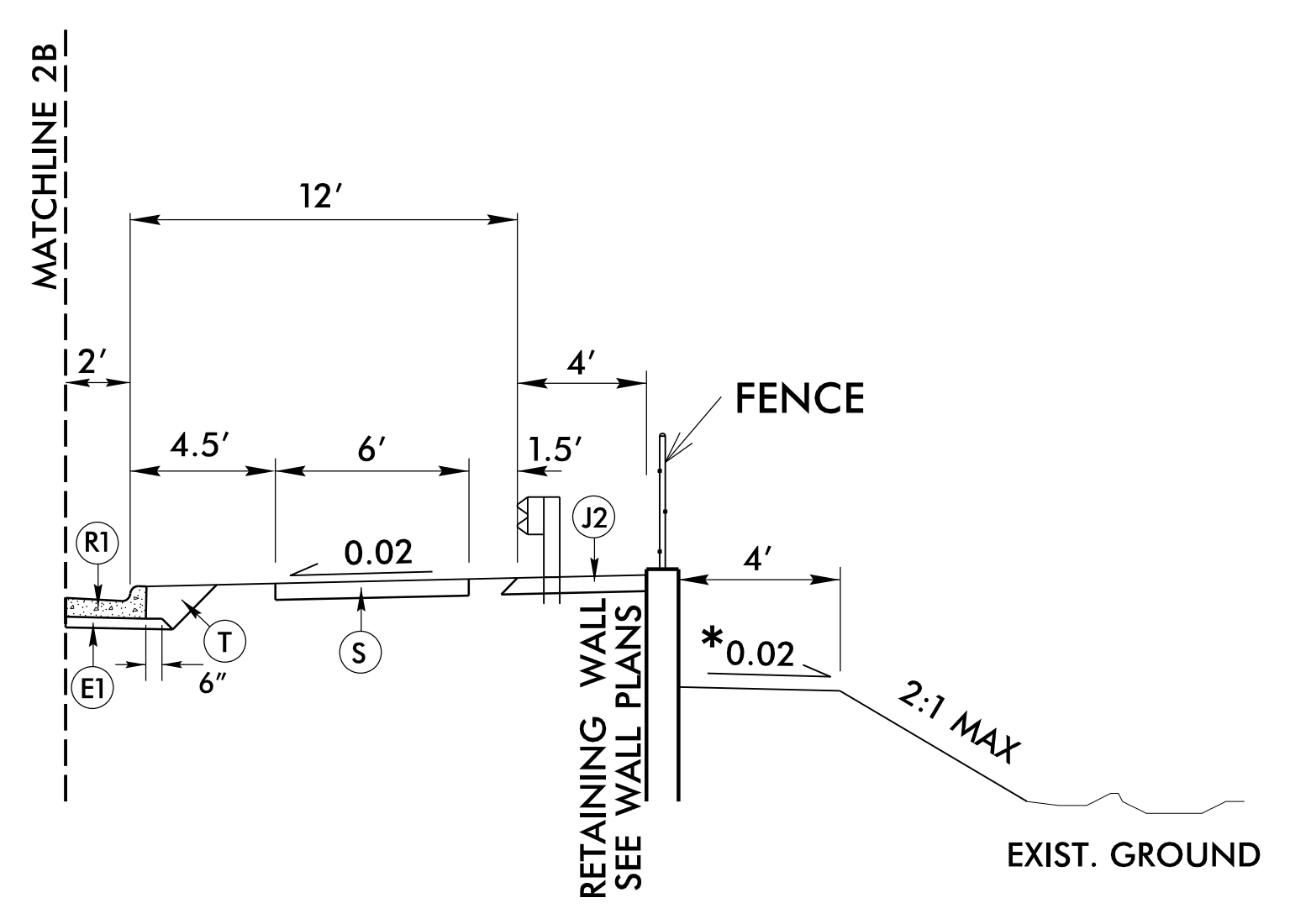

TYPICAL SECTION 3-3B
 USE IN CONJUNCTION WITH
 TYPICAL SECTION 3
 -L- STA. 15+20.00 TO 18+13 RT
 * USE 10:1 OR FLATTER AT G/R LOCATION
 -L- STA. 16+51.00 TO 17+32.00

UTILIZE 8'-0" POSTS FOR GUARDRAIL
 LOCATIONS ADJACENT TO RETAINING WALL

C1	PROP. APPROX. 1.5", TYPE S9.5B
C2	PROP. APPROX. 2", TYPE S9.5B
C3	PROP. APPROX. 3", TYPE S9.5B
C4	PROP. VAR. DEPTH, TYPE S9.5B
D1	PROP. APPROX. 4", I19.0C
D2	PROP. VAR. DEPTH, TYPE I19.0C
E1	PROP. APPROX. 4", TYPE B25.0C
E2	PROP. VAR. DEPTH, TYPE B25.0C
J1	PROP. 6" AGGREGATE BASE COURSE
J2	PROP. 4" AGGREGATE BASE COURSE (M)
K	CLASS IV SUB. STAB.
N	GEOTEXTILE FOR SUB. STAB.
P	Prime Coat
R1	2'-6" CONCRETE CURB AND GUTTER
R2	5" MONOLITHIC CONCRETE ISLAND
S	4" CONCRETE SIDEWALK
T	EARTH MATERIAL
U	EXISTING PAVEMENT
V	1.5" MILLING
W	VARIABLE DEPTH ASPHALT PAVEMENT (SEE STANDARD WEDGING DETAIL)

NOTE: PAVEMENT EDGE SLOPES
 ARE 1:1 UNLESS SHOWN OTHERWISE.

10/1/2024
 I:\Projects\2024\New Hope Church Road\Drawings\Roadway\Roadway.dgn
 stamellwood

6/2/24



Stantec Consulting Services Inc.
801 Jones Franklin Road
Suite 300
Raleigh, NC 27606
Tel. (919) 851-6906
Fax. (919) 851-7024
www.stantec.com
License No. F-0672

PROJECT REFERENCE NO.	SHEET NO.
P-5715	2A-4
ROADWAY DESIGN ENGINEER	PAVEMENT DESIGN ENGINEER
<i>Stephen T. Smallwood</i>	<i>Stephen T. Smallwood</i>
10/2/2024	

**DOCUMENT NOT CONSIDERED FINAL
UNLESS ALL SIGNATURES COMPLETED**

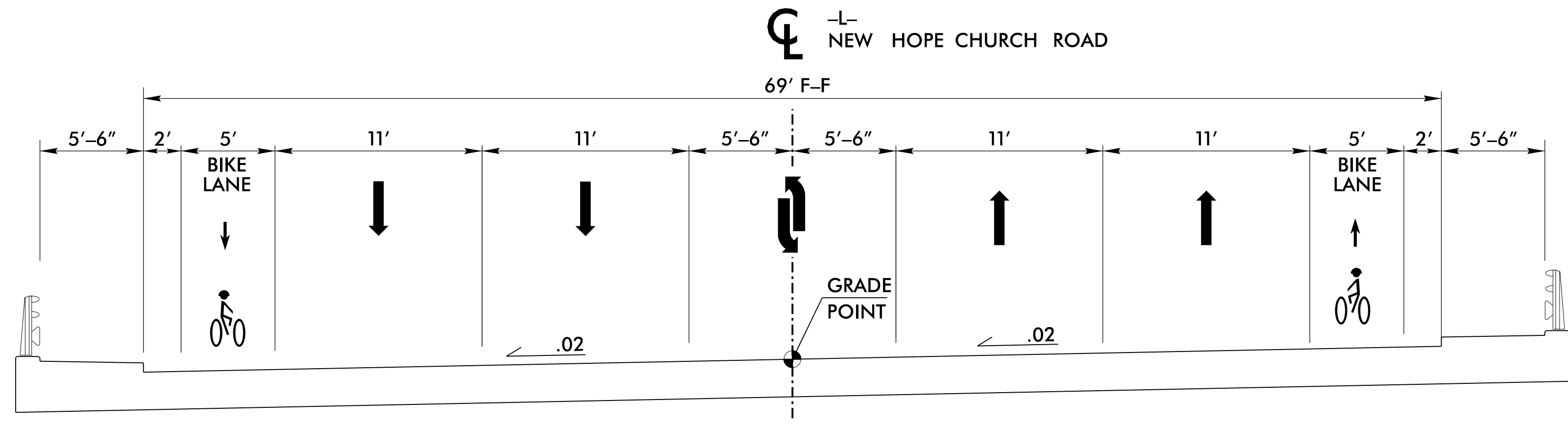

TYPICAL SECTION NO. 4
-L- STA. 20+48.37 (BEGIN BRIDGE) TO 21+72.12 (END BRIDGE)

C1	PROP. APPROX. 1.5", TYPE S9.5B
C2	PROP. APPROX. 2", TYPE S9.5B
C3	PROP. APPROX. 3", TYPE S9.5B
C4	PROP. VAR. DEPTH, TYPE S9.5B
D1	PROP. APPROX. 4", I19.0C
D2	PROP. VAR. DEPTH, TYPE I19.0C
E1	PROP. APPROX. 4", TYPE B25.0C
E2	PROP. VAR. DEPTH, TYPE B25.0C
J1	PROP. 6" AGGREGATE BASE COURSE
J2	PROP. 4" AGGREGATE BASE COURSE (M)
K	CLASS IV SUB. STAB.
N	GEOTEXTILE FOR SUB. STAB.
P	Prime Coat
R1	2'-6" CONCRETE CURB AND GUTTER
R2	5" MONOLITHIC CONCRETE ISLAND
S	4" CONCRETE SIDEWALK
T	EARTH MATERIAL
U	EXISTING PAVEMENT
V	1.5" MILLING
W	VARIABLE DEPTH ASPHALT PAVEMENT (SEE STANDARD WEDGING DETAIL)

NOTE: PAVEMENT EDGE SLOPES ARE 1:1 UNLESS SHOWN OTHERWISE.

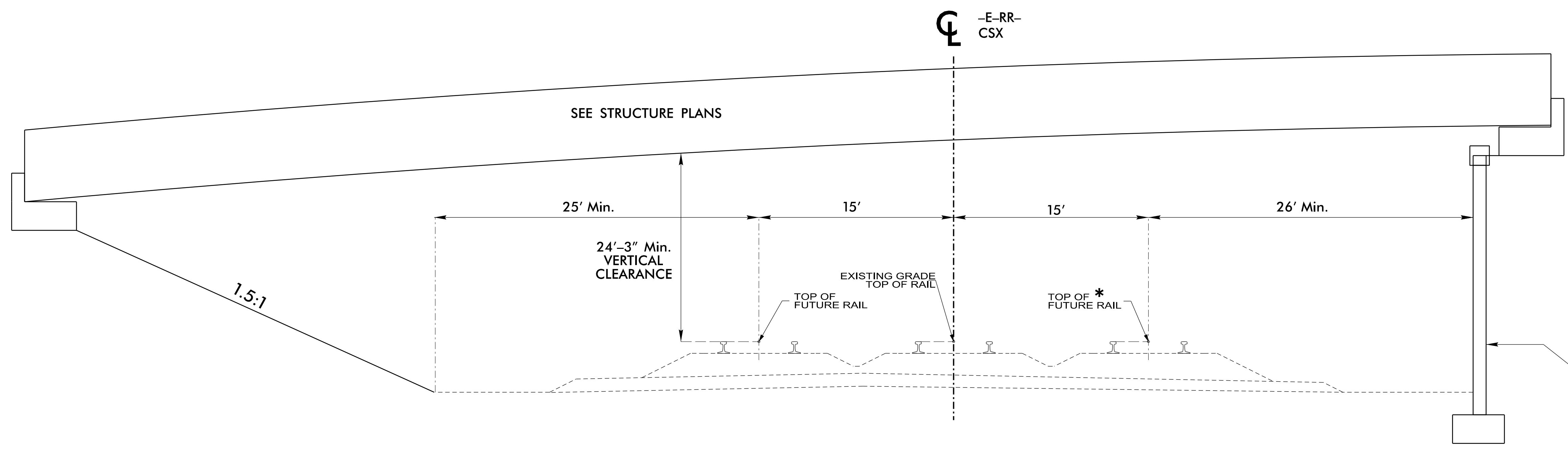

TYPICAL SECTION NO. 5
TYPICAL UNDER BRIDGE VIEW IS UPSTATION

PROP MSE WALL
SEE STRUCTURE AND WALL PLANS

10/2/2024
U:\Projects\2024\New Hope Church Road\Drawings\TSD\TSD.dgn

6/2/2024

Stantec
 Stantec Consulting Services Inc.
 801 Jones Franklin Road
 Suite 300
 Raleigh, NC 27606
 Tel. (919) 851-6906
 Fax. (919) 851-7024
 www.stantec.com
 License No. F-0672

PROJECT REFERENCE NO. P-5715	SHEET NO. 2A-6
ROADWAY DESIGN ENGINEER STEPHEN T. SMALLWOOD 10/2/2024	PAVEMENT DESIGN ENGINEER ANDREW D. WAREO 10/3/2024

**DOCUMENT NOT CONSIDERED FINAL
 UNLESS ALL SIGNATURES COMPLETED**

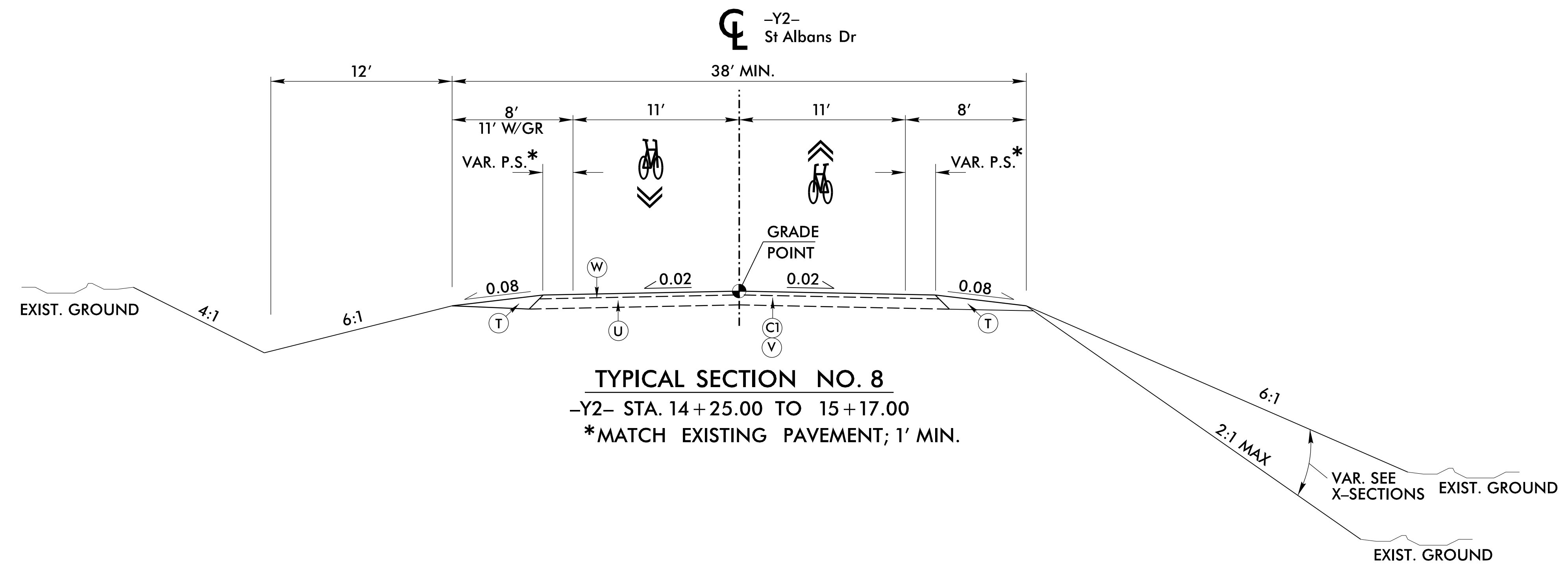

TYPICAL SECTION NO. 8
 -Y2- STA. 14+25.00 TO 15+17.00
 *MATCH EXISTING PAVEMENT; 1' MIN.

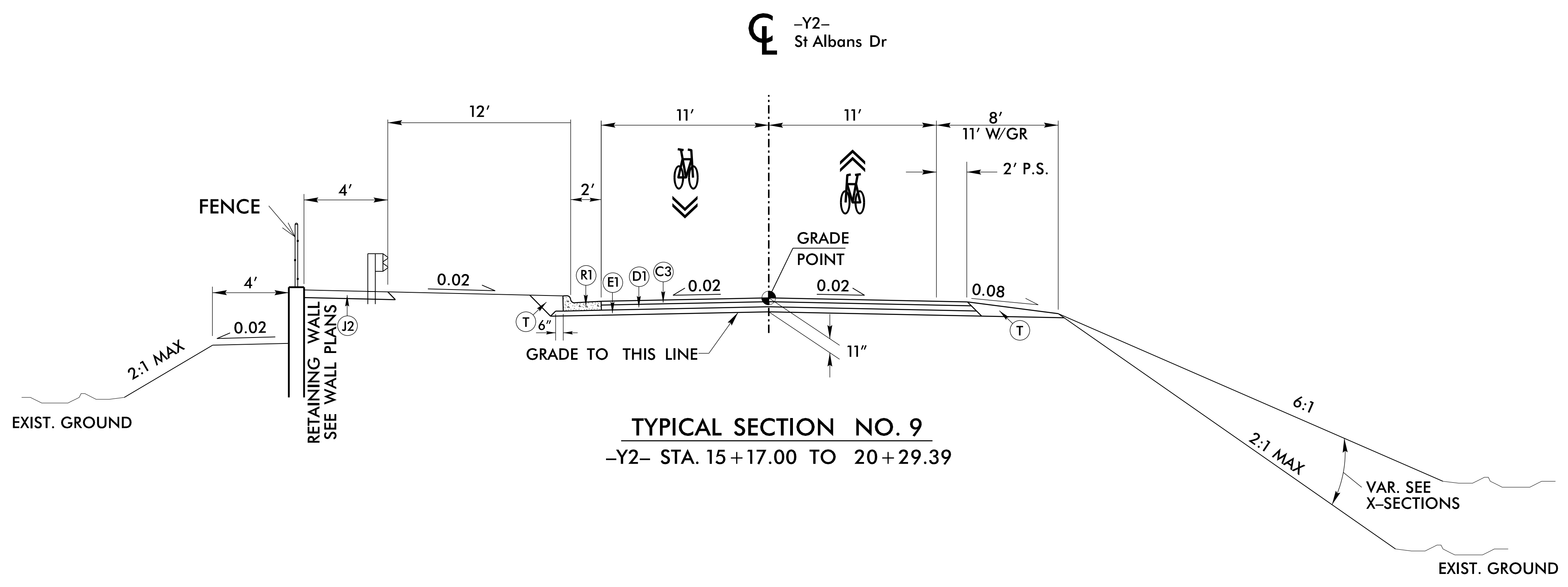

TYPICAL SECTION NO. 9
 -Y2- STA. 15+17.00 TO 20+29.39

UTILIZE 8'-0" POSTS FOR GUARDRAIL
 LOCATIONS ADJACENT TO RETAINING WALL

C1	PROP. APPROX. 1.5", TYPE S9.5B
C2	PROP. APPROX. 2", TYPE S9.5B
C3	PROP. APPROX. 3", TYPE S9.5B
C4	PROP. VAR. DEPTH, TYPE S9.5B
D1	PROP. APPROX. 4", I19.0C
D2	PROP. VAR. DEPTH, TYPE I19.0C
E1	PROP. APPROX. 4", TYPE B25.0C
E2	PROP. VAR. DEPTH, TYPE B25.0C
J1	PROP. 6" AGGREGATE BASE COURSE
J2	PROP. 4" AGGREGATE BASE COURSE (M)
K	CLASS IV SUB. STAB.
N	GEOTEXTILE FOR SUB. STAB.
P	Prime Coat
R1	2'-6" CONCRETE CURB AND GUTTER
R2	5" MONOLITHIC CONCRETE ISLAND
S	4" CONCRETE SIDEWALK
T	EARTH MATERIAL
U	EXISTING PAVEMENT
V	1.5" MILLING
W	VARIABLE DEPTH ASPHALT PAVEMENT (SEE STANDARD WEDGING DETAIL)

NOTE: PAVEMENT EDGE SLOPES
 ARE 1:1 UNLESS SHOWN OTHERWISE.

10/2/2024
 U:\Projects\2024\St Albans\Drawings\Y2\Typical\Typical.dgn
 stam111000

PHASING

PHASE I

STEP 1:

PRIOR TO ANY WORK OPERATIONS, INSTALL WORK ZONE ADVANCE WARNING SIGNS ON -L- (NEW HOPE CHURCH RD.), -Y1- (CRAFTSMAN DR.), -Y2- (ST ALBANS DR.), PER ROADWAY STANDARD DRAWING 1101.01, SHEET 3.

STEP 2A: (NOT SHOWN)

AWAY FROM TRAFFIC, COMPLETE AS MUCH UTILITY CONSTRUCTION AS POSSIBLE.

INTERMEDIATE CONTRACT TIME

NOTE: COMPLETE THE WORK REQUIRED OF PHASE I, STEP 2B BETWEEN FRIDAY AT 11:00 P.M. AND THE FOLLOWING MONDAY AT 5:00 A.M. (SEE SPECIAL PROVISIONS).

STEP 2B:

CLOSE -L- AND PLACE TRAFFIC ON THE OFF-SITE DETOUR SHOWN ON TMP-16. CONSTRUCT ENCASED WATERLINE CROSSING OF -L- AT STA. 18+55±. REPLACE PAVEMENT, AND ANY NEEDED PAVEMENT MARKINGS, AND REOPEN -L- TO TRAFFIC.

INTERMEDIATE CONTRACT TIME

NOTE: COMPLETE THE WORK REQUIRED OF PHASE I, STEP 2C BETWEEN FRIDAY AT 11:00 P.M. AND THE FOLLOWING MONDAY AT 5:00 A.M. (SEE SPECIAL PROVISIONS).

STEP 2C:

CLOSE -L- AND PLACE TRAFFIC ON THE OFF-SITE DETOUR SHOWN ON TMP-16. CONSTRUCT ENCASED WATERLINE CROSSING OF -L- AT STA. 29+65±. REPLACE PAVEMENT, AND ANY NEEDED PAVEMENT MARKINGS, AND REOPEN -L- TO TRAFFIC.

STEP 2D: (NOT SHOWN)

USING NIGHTLY ROAD CLOSURES, CLOSE -L- AND PLACE TRAFFIC ON THE OFF-SITE DETOUR SHOWN ON TMP-16. CONSTRUCT SEWER LINE ON -L- FROM STA. 28+00± TO STA. 29+90±. REPEAT UNTIL SEWER LINE CONSTRUCTION IS COMPLETE.

STEP 2E: (TMP-4,5,6)

USING TEMPORARY LANE CLOSURES PER ROADWAY STANDARD DRAWING 1101.02, SHEET 3 PERFORM THE FOLLOWING:

PLACE TEMPORARY PAVEMENT MARKINGS AND TRAFFIC CONTROL DEVICES ON -L- FROM STA. 8+63+/- TO STA. 31+55+/- AS SHOW ON SHEETS TMP-4, 5, AND 6. TEMPORARY RAILROAD GATE TO BE INSTALLED BY OTHERS PRIOR TO SHIFTING TRAFFIC. SHIFT TRAFFIC TO A TWO LANE TWO WAY PATTERN.

PLACE OFF-SITE DETOUR SIGNS FOR -Y2- (ST ALBANS DR.). USING ROADWAY STANDARD DRAWING 1101.03, SHEET 2, CLOSE -Y2- TO TRAFFIC AND PLACE TRAFFIC ON THE OFF-SITE DETOUR (SEE TMP-14).

OPEN PARCELL 11'S ACCESS TO ATLANTIC DRIVE PRIOR TO CLOSING -DRWY4- AT -L-.

CLOSE -DRWY4- AND -DRWY5- AS SHOWN ON SHEET TMP-5.

PHASE I CONT.

STEP 3: (TMP-4,5,6)

USING A FLAGGING OPERATION AND RSD 1101.02, SHEET 1, CONSTRUCT TEMPORARY DRAINAGE (SEE TMP-4,5).

USING TRENCHLESS METHODS, INSTALL 36" WELDED STEEL PIPE AT -L- STA. 20+20+/- (SEE TMP-5).

AFTER TEMPORARY DRAINAGE IS INSTALLED, USING A FLAGGING OPERATION AND RSD 1101.02, SHEET 1, PLACE PCB ALONG -L- (SEE TMP-4,5,6).

STEP 4: (TMP-5)

CONSTRUCT REMAINDER OF 36" WELDED STEEL PIP AT -L- STA. 20+20+/- (SEE TMP-5).

STEP 5: (TMP-4,5,6)

CONSTRUCT AWAY FROM TRAFFIC THE FOLLOWING UP TO BUT NOT INCLUDING THE FINAL LAYER OF SURFACE COURSE:

- RIGHT HALF OF PROPOSED -L- (INCLUDING TEMPORARY SHORING) FROM STA. 11+10± TO STA. 27+50+/-, -Y2- FROM STA. 14+25+/- TO STA. 20+30+/-, -DRWY4-, -DRWY5-, AND -DRWYTMP2-.

PHASE II

STEP 1:

PRIOR TO SHIFING TRAFFIC USING TEMPORARY LANE CLOSURES PER ROADWAY STANDARD DRAWING 1101.02, SHEET 3 PERFORM THE FOLLOWING:

-L- (NEW HOPE CHURCH RD.), WEDGE UP TO BUT NOT INCLUDING THE FINAL LAYER OF SURFACE COURSE FROM STA. 27+50 TO 31+55.

NOTE: USE INCIDENTAL STONE AS NECESSARY TO MAINTAIN ACCESS TO ALL DRIVEWAYS.

PHASE II CONT.

INTERMEDIATE CONTRACT TIME

COMPLETE THE WORK REQUIRED OF PHASE II-STEP 2 AND 3 IN 75 CONSECUTIVE CALENDAR DAYS. (SEE SPECIAL PROVISIONS)

STEP 2: (TMP-7,8,9)

USING TEMPORARY LANE CLOSURES PER ROADWAY STANDARD DRAWING 1101.02, SHEET 3 PERFORM THE FOLLOWING:

PLACE OFF-SITE DETOUR SIGNS FOR -Y1- (CRAFTSMAN DR.). USING ROADWAY STANDARD DRAWING 1101.03, SHEET 2, CLOSE -Y1- TO TRAFFIC (SEE TMP-7) AND PLACE TRAFFIC ON THE OFF-SITE DETOUR (SEE TMP-15).

-L- (NEW HOPE CHURCH RD.) PLACE TEMPORARY PAVEMENT MARKINGS AND PCB. SHIFT TRAFFIC TO A TWO LANE TWO WAY PATTERN ON THE PROPOSED PAVEMENT. (SEE TMP-7,8,9).

-Y2- (ST ALBANS DR.) PLACE TEMPORARY PAVEMENT MARKINGS, REMOVE OFF-SITE DETOUR, PLACE, AND OPEN TO TRAFFIC.

-DRWY4- AND -DRWY5- OPEN TO TRAFFIC.

-L- CONTRACTOR MAY START STA. 11+10+/- TO STA. 14+00+/- AND STA. 16+50+/- TO STA. 27+50+/- . CONTRACTOR MAY START -DRWY1-, -DRWY2-, -DRWY3-.

STEP 3: (TMP-10)

1) CONSTRUCT -Y1- UP TO BUT NOT INCLUDING THE FINAL LAYER OF SURFACE COURSE FROM STA. 10+00+/- TO STA. 13+50+/-.

2) CONSTRUCT AWAY FROM TRAFFIC LEFT SIDE OF -L- UP TO BUT NOT INCLUDING THE FINAL LAYER OF SURFACE COURSE FROM STA. -L- 14+00 TO STA. -L- 16+50.

3) PLACE PAVEMENT MARKINGS ON -Y1-, REMOVE OFF-SITE DETOUR, AND OPEN -Y1- TO TRAFFIC. (SEE TMP-11)

STEP 4: (TMP-11,12,13)

CONSTRUCT PROPOSED -L- STA. 11+10+/- TO STA. 14+00+/- AND STA. 16+50+/- TO STA 27+50+/-, -DRWY1-, -DRWY2-, AND -DRWY3-, UP TO BUT NOT INCLUDING THE FINAL LAYER OF SURFACE COURSE.

NOTE: CONTRACTOR IS TO MAINTAIN ALL DRIVEWAY ACCESS FOR THE DURATION OF THE PROJECT.

PHASE III (NOT SHOWN)

STEP 1:

USING TEMPORARY LANE CLOSURES PER ROADWAY STANDARD DRAWING 1101.02, SHEET 3 PERFORM THE FOLLOWING:

PLACE THE FINAL LAYER OF SURFACE COURSE ON -L-, -Y1-, -Y2-, -DRWY1-, -DRWY2-, -DRWY3-, -DRWY4-, AND -DRWY5-. PLACE FINAL PAVEMENT MARKINGS AS SHOWN IN THE PAVEMENT MARKING PLAN.

STEP 2:

REMOVE ALL TEMPORARY TRAFFIC CONTROL DEVICES AND PLACE TRAFFIC IN THE FINAL PATTERN.

9/30/2024
U:\Traffic\Transportation Management Plan\TCP\PLAN SHEETS\VP-5715-TMP-03-PHASING.dgn
angood



Stantec Consulting Services Inc.
801 Jones Franklin Road
Suite 300
Raleigh, NC 27606
Tel. 919.851.6866
Fax. 919.851.7024
www.stantec.com
License No. F-0672

Signed by: *J.W. Woolard*
SEAL
19862
ENGINEER
W. WOOLARD, R.
9/30/2024
DOCUMENT NOT CONSIDERED FINAL
UNLESS ALL SIGNATURES COMPLETED

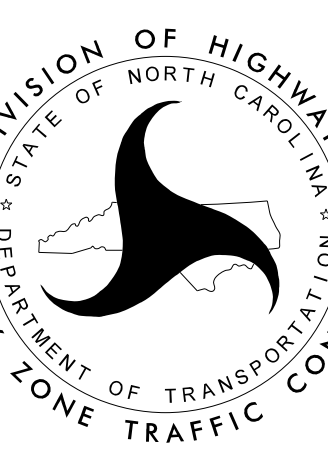

DIVISION OF HIGHWAYS
DEPARTMENT OF TRANSPORTATION
STATE OF NORTH CAROLINA
WORK ZONE TRAFFIC CONTROL

PHASING

STREET LIGHTING CONDUIT LOCATION

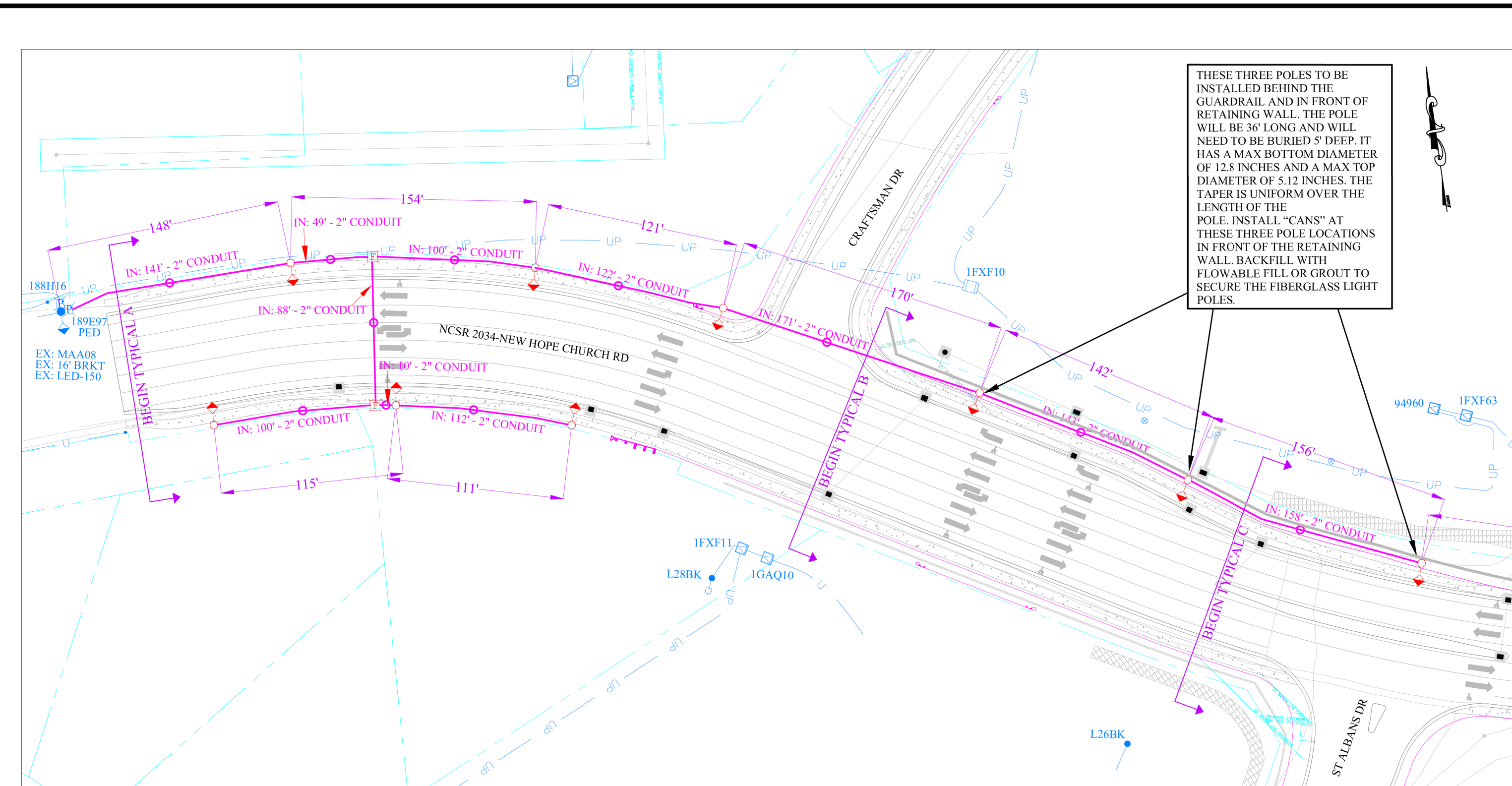

THESE THREE POLES TO BE INSTALLED BEHIND THE GUARDRAIL AND IN FRONT OF RETAINING WALL. THE POLE WILL BE 36' LONG AND WILL NEED TO BE BURIED 5' DEEP. IT HAS A MAX BOTTOM DIAMETER OF 12.8 INCHES AND A MAX TOP DIAMETER OF 5.12 INCHES. THE TAPER IS UNIFORM OVER THE LENGTH OF THE POLE. INSTALL "CANS" AT THESE THREE POLE LOCATIONS IN FRONT OF THE RETAINING WALL. BACKFILL WITH FLOWABLE FILL OR GROUT TO SECURE THE FIBERGLASS LIGHT POLES.

MATCHLINE TO SHEET 2

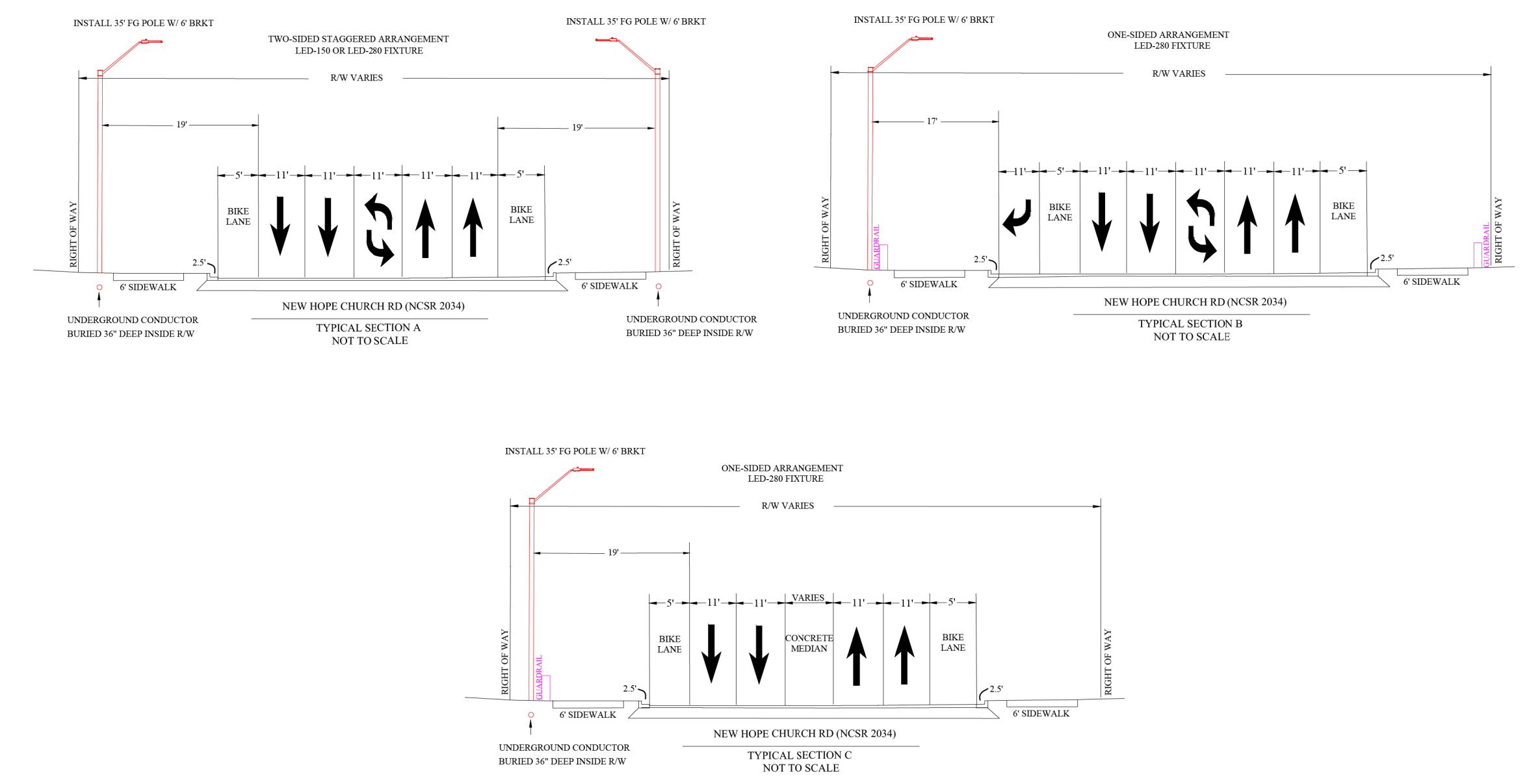

NOTES

1. INSTALL 2" PVC SCHEDULE 40 CONDUIT WHERE INDICATED ON DRAWING. PAID AS "5155000000-E 1409 Street Lighting Conduit Installation (2" PVC)"
2. BURY CONDUIT AT LEAST 36" DEEP WITHIN THE RIGHT OF WAY.
3. INSTALL CONTINUOUS RUN OF CONDUIT AND MARK LIGHT AND PEDESTAL LOCATIONS WITH AN EXTRA PIECE OF VERTICAL CONDUIT. INSTALL PULL STRING IN CONDUIT.
4. PROVIDE AND INSTALL A 20" X 60" CONCRETE TUBE FORM AT THE LOCATIONS INDICATED ABOVE. TURN CONDUIT UP AND TERMINATE AT THE TOP OF THE TUBE. TUBES ARE INTENDED TO BLOCK OUT AN AREA FOR FUTURE LIGHT POLE INSTALLATION BY OTHERS. PLACEMENT OF "CANS" IS INCIDENTAL TO STREET LIGHTING CONDUIT INSTALLATION.

<p>SAFETYFirst PERSONAL ACCOUNTABILITY ACTIVE CARENESS HAZARD RECOGNITION</p>	<p>Safety Reminders / Adverse Conditions</p> <p>REMEMBER: Work zone area conditions may have changed for this job! Everyone is responsible for verifying the above safety information is correct prior to any work being performed each day.</p>	<p>WZS: REMEMBER "YOUR CIRCLE OF SAFETY"</p> <p>WZS: SET PROPER WORK ZONE NEEDED</p> <p>WZS: SET PROPER SIGNS, CONES, AND BARRICADES</p> <p>WZS: REMEMBER WALK AROUNDS AND PRETRIP</p> <p>WZS:</p>	
---	---	---	--

PROPOSED	EXISTING	REMOVE	INSTALL	LEGEND
				LED LUMINAIRE
				2" CONDUIT
				FIBERGLASS/STEEL LIGHTING POLE
				WOOD POLE
				FOREIGN POLE
				TRANSFORMER (POLE MOUNTED)
				STREET LIGHT CIRCUIT UNDERGROUND
				STREET LIGHT CIRCUIT OVERHEAD
				DN PRIMARY CIRCUIT
				REV/PROPERTY LINES
				SECONDARY PEDESTAL
				TRANSFORMER (PAD MOUNTED)

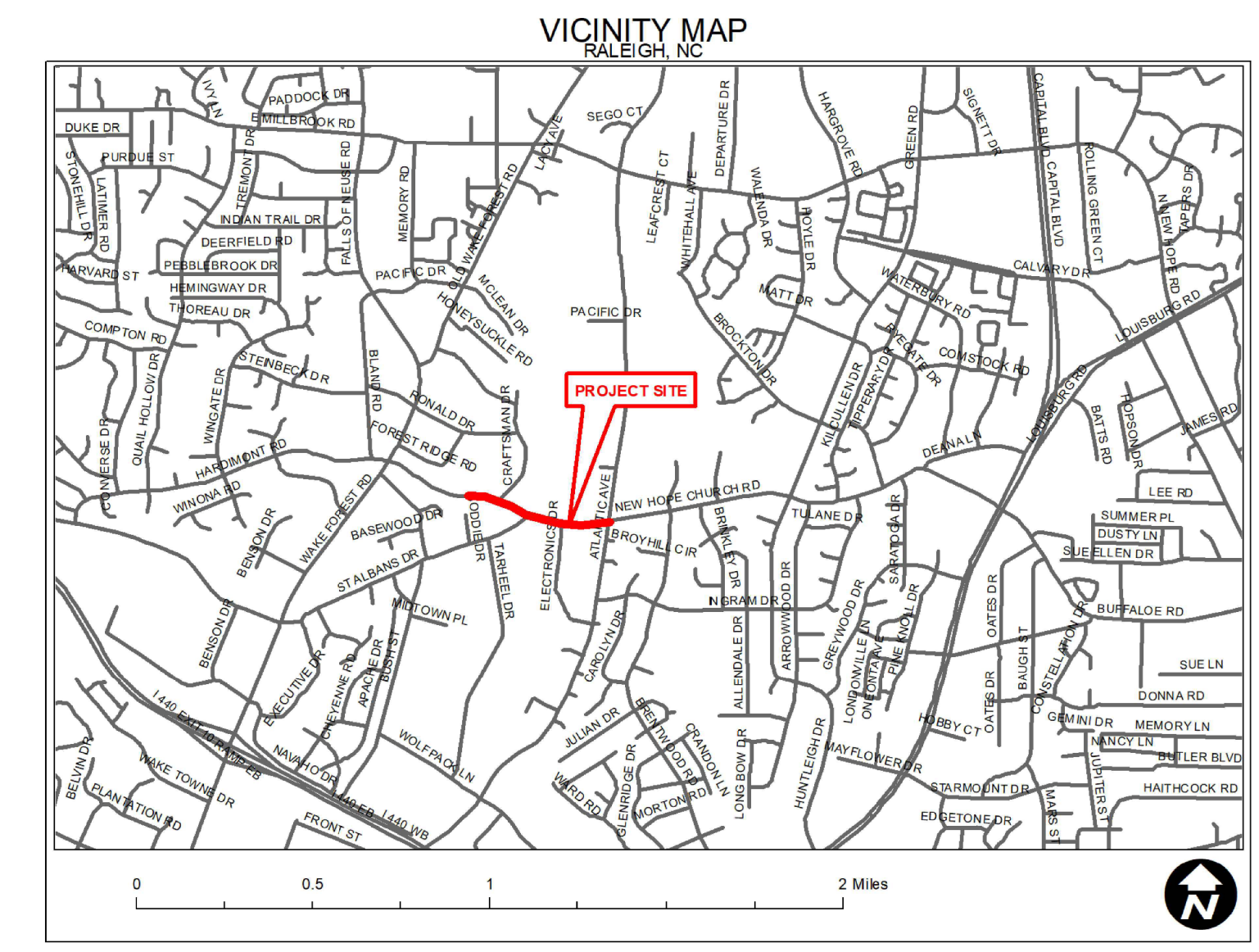

LIGHTING DESIGN TOLERANCE

The calculated footcandle light levels in this lighting design are predicted values and are based on specific information that has been supplied to Duke Energy. Any inaccuracies in the supplied information, differences in luminaire installation, lighted area geometry including elevation differences, reflective properties of surrounding surfaces, obstructions (follage or otherwise) in the lighted area, or lighting from sources other than listed in this design may produce different results from the predicted values. Normal tolerances of voltage, lamp output, and ballast and luminaire manufacture will also affect results.



PROPRIETARY & CONFIDENTIAL

This document together with the concepts and designs presented herein, presented as an instrument of service, is the sole property of Duke Energy, and is intended only for the specific purpose and prospective client as stated in the title block of this drawing. Any use, copying, reproduction or disclosure of the drawing, design or any information contained herein by the prospective customer or other entities, including without limitation, architects, engineers, or equipment manufacturers is hereby expressly prohibited and shall not be permitted absent prior written consent from, and payment of compensation to Duke Energy. Duke Energy disclaims any liability or responsibility for any unauthorized use of or reliance on this document.

CONDUIT ARRANGEMENT FOR NEW HOPE CHURCH RD (NCSR 2034) RALEIGH, NC	
Designed by	DUKE ENERGY PROGRESS LIGHTING SOLUTIONS
Reviewed by	JESSICA WEISS Scale 1" = 50'
Date	2/16/2024 Size Drawing size "D"
Description	
Drawing No.	4304 Sit. 1 OF 2

NO.	DATE	REVISION	BY

8/17/99
03/2024
U:\Roadway\Proj\5715_RdJ_Sl_plans.dgn

PROJECT REFERENCE NO. P-5715	SHEET NO. UC-6
DESIGNED BY: JGB	
DRAWN BY: JGB	
CHECKED BY: CLW	
APPROVED BY: CLW	
REVISED:	
NORTH CAROLINA DEPARTMENT OF TRANSPORTATION UTILITIES ENGINEERING SEC. PHONE: (919) 707-6690 FAX: (919) 250-4151 UTILITY CONSTRUCTION PLANS ONLY	

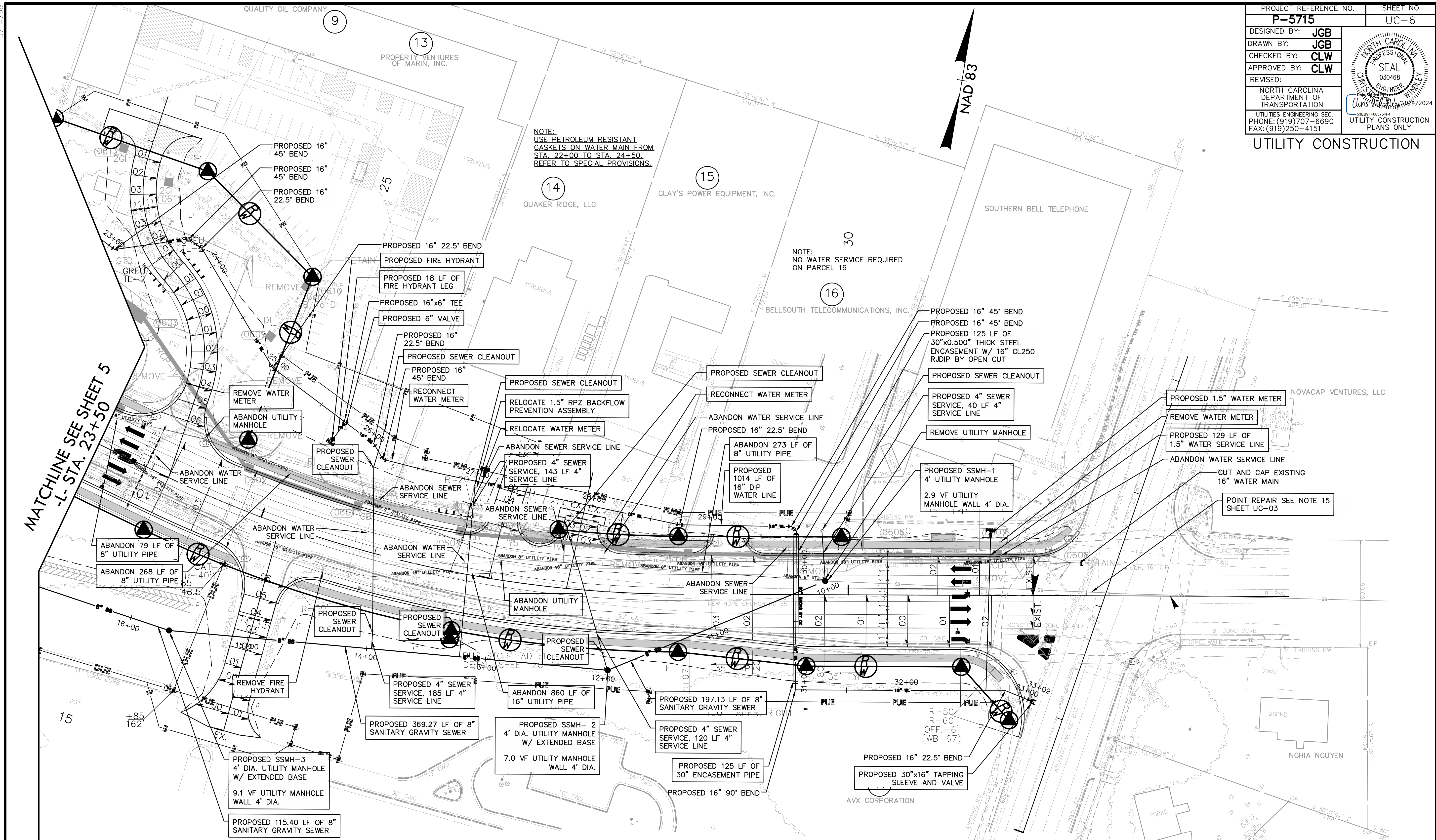

MATCHLINE SEE SHEET 5
-L- STA. 23+50

Public

Water Distribution / Extension System

The City of Raleigh consents to the connection and extension of the City's public water system as shown on this plan. The material and construction methods used for this project shall conform to the standards and specifications of the City's Public Utilities Handbook.

City of Raleigh Public Utilities Department Permit # **W-3606**

Authorization to Construct **Alexander Justel**

Date **5/15/19**

Public

Sewer Collection / Extension System

The City of Raleigh consents to the connection and extension of the City's public sewer system as shown on this plan. The material and construction methods used for this project shall conform to the standards and specifications of the City's Public Utilities Handbook.

City of Raleigh Public Utilities Department Permit # **S-4531**

Authorization to Construct **Alexander Justel**

Date **5/15/19**

