

10/03/13

CONTRACT NO.: DA00280 WBS ELEMENT: 2016CPT.01.17.20151.1, ETC

STATE OF NORTH CAROLINA  
DIVISION OF HIGHWAYS

**CAMDEN COUNTY**

STATE	STATE PROJECT REFERENCE NO.	SHEET NO.	TOTAL SHEETS
N.C.	2016CPT.01.17.20151.1, ETC	1	
STATE PROJ. NO.	F.A. PROJ. NO.	DESCRIPTION	
2016CPT.01.17.20151.1		MAP 1	
2016CPT.01.17.20151.2		MAP 2	

LOCATION: MAP 1 SR 1111 WICKHAM RD. FROM NC 343 TO SR 1112  
MAP 2 SR 1112 NECK RD. FROM SR 1111 TO END OF MAINTENANCE

TYPE OF WORK: RESURFACING & SHOULDER RECONSTRUCTION

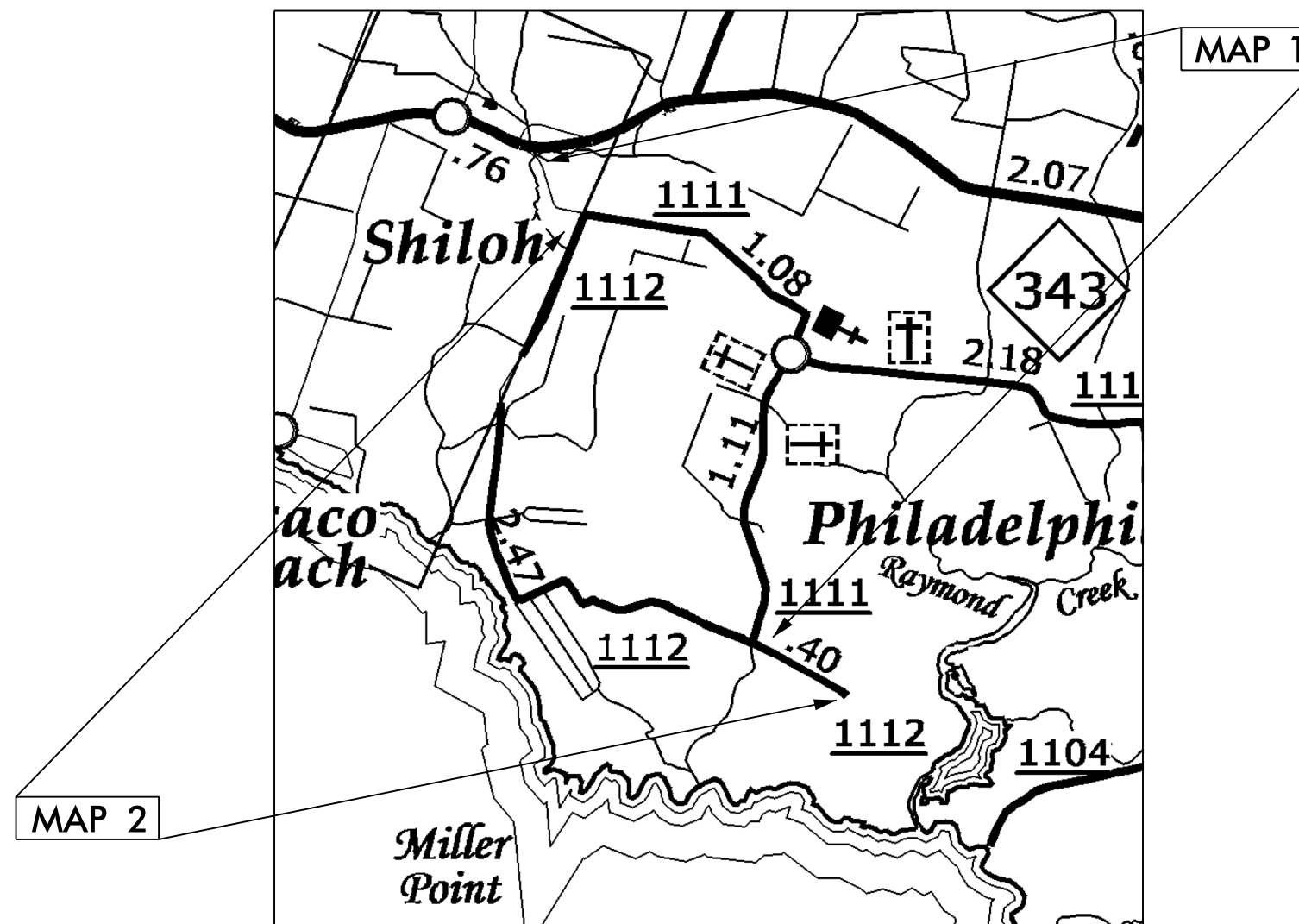

DRAWN BY: JWC

**NTS**

PROJECT LENGTH

LENGTH OF ROADWAY PROJECT MAP 1 = 2.67 MI.  
LENGTH OF ROADWAY PROJECT MAP 2 = 3.26 MI.

Prepared In the Office of:  
**DIVISION OF HIGHWAYS**  
113 Airport Dr., Edenton NC, 27932

2012 STANDARD SPECIFICATIONS

LETTING DATE: \_\_\_\_\_

W.B. HOBBS, P.E.  
DIVISION PROJECT MANAGER

C.E. SLACHTA  
DIVISION PROPOSALS ENGINEER

DIVISION OF HIGHWAYS  
STATE OF NORTH CAROLINA

10/03/13

CONTRACT NO.: DA00280 WBS ELEMENT: 2016CPT.01.17.2015I.1, ETC.

STATE OF NORTH CAROLINA  
DIVISION OF HIGHWAYS

# CURRITUCK COUNTY

STATE	STATE PROJECT REFERENCE NO.	SHEET NO.
N.C.	2016CPT.01.17.2015I.1, ETC.	2
STATE PROJ. NO.	F.A. PROJ. NO.	DESCRIPTION
2016CPT.01.17.20271.1		MAP 3
2016CPT.01.17.20271.1		MAP 4
2016CPT.01.17.20271.1		MAP 5
2016CPT.01.17.20271.1		MAP 6
2016CPT.01.17.20271.1		MAP 7
2016CPT.01.17.20271.1		MAP 8
2016CPT.01.17.20271.1		MAP 9

**LOCATION:** MAP 3 SR 1186 WALNUT ISLAND BLVD FROM US 158 TO END OF MAINTENANCE  
 MAP 4 SR 1190 N KELLER LN FROM SR 1188 TO SR 1186  
 MAP 5 SR 1192 GREGORY CT FROM SR 1188 TO DEAD END  
 MAP 6 SR 1191 PLEASANT POINT DR FROM SR 1188 TO DEAD END  
 MAP 7 SR 1188 HOLLY CRESCENT FROM SR 1186 TO SR 1192  
 MAP 8 SR 1189 FARIS DR FROM SR 1186 TO SR 1188  
 MAP 9 SR 1190 S KELLER LN FROM SR 1186 TO SR 1193

**TYPE OF WORK:** RESURFACING & SHOULDER RECONSTRUCTION

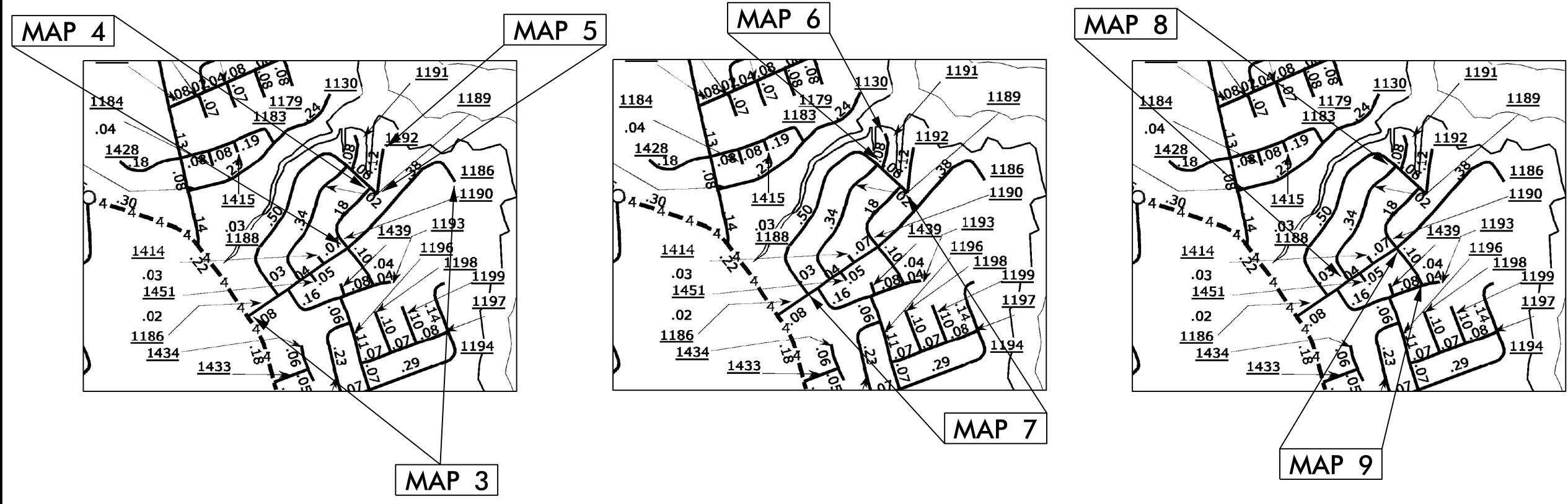

**NTS**

PROJECT LENGTH	
LENGTH OF ROADWAY PROJECT	MAP 3 = 0.67 MI.
LENGTH OF ROADWAY PROJECT	MAP 4 = 0.18 MI.
LENGTH OF ROADWAY PROJECT	MAP 5 = 0.10 MI.
LENGTH OF ROADWAY PROJECT	MAP 6 = 0.11 MI.
LENGTH OF ROADWAY PROJECT	MAP 7 = 0.60 MI.
LENGTH OF ROADWAY PROJECT	MAP 8 = 0.33 MI.
LENGTH OF ROADWAY PROJECT	MAP 9 = 0.11 MI.

Prepared In the Office of:  
**DIVISION OF HIGHWAYS**  
 113 Airport Dr., Edenton NC, 27932

---

2012 STANDARD SPECIFICATIONS

LETTING DATE: \_\_\_\_\_

W.B. HOBBS, P.E.  
DIVISION PROJECT MANAGER

C.E. SLACHTA  
DIVISION PROPOSALS ENGINEER

DIVISION OF HIGHWAYS  
STATE OF NORTH CAROLINA

DRAWN BY: JWC

10/03/13

CONTRACT NO.: DA00280 WBS ELEMENT: 2016CPT.01.17.2015I.1, ETC.

STATE OF NORTH CAROLINA  
DIVISION OF HIGHWAYS

**CURRITUCK COUNTY**

**LOCATION:** MAP 10 SR 1193 MALLARD DR FROM SR 1186 TO END OF MAINTENANCE  
 MAP 11 SR 1439 MALLARD CT FROM SR 1193 TO DEAD END  
 MAP 12 SR 1194 EDGEWATER DR FROM US 158 TO DEAD END  
 MAP 13 SR 1197 MIDWAY DR FROM SR 1196 TO SR 1194  
 MAP 14 SR 1199 CANAL CT FROM SR 1197 TO DEAD END  
 MAP 15 SR 1198 ADMIRALTY CT FROM SR 1197 TO DEAD END  
 MAP 16 SR 1196 EVANS DR FROM SR 1194 TO SR 1193  
 MAP 17 SR 1195 LEEWARD DR FROM SR 1194 TO SR 1196

**TYPE OF WORK:** RESURFACING & SHOULDER RECONSTRUCTION

STATE	STATE PROJECT REFERENCE NO.	SHEET NO.
N.C.	2016CPT.01.17.2015I.1, ETC.	3
STATE PROJ. NO.	F.A. PROJ. NO.	DESCRIPTION
2016CPT.01.17.20271.1		MAP 10
2016CPT.01.17.20271.1		MAP 11
2016CPT.01.17.20271.1		MAP 12
2016CPT.01.17.20271.1		MAP 13
2016CPT.01.17.20271.1		MAP 14
2016CPT.01.17.20271.1		MAP 15
2016CPT.01.17.20271.1		MAP 16
2016CPT.01.17.20271.1		MAP 17

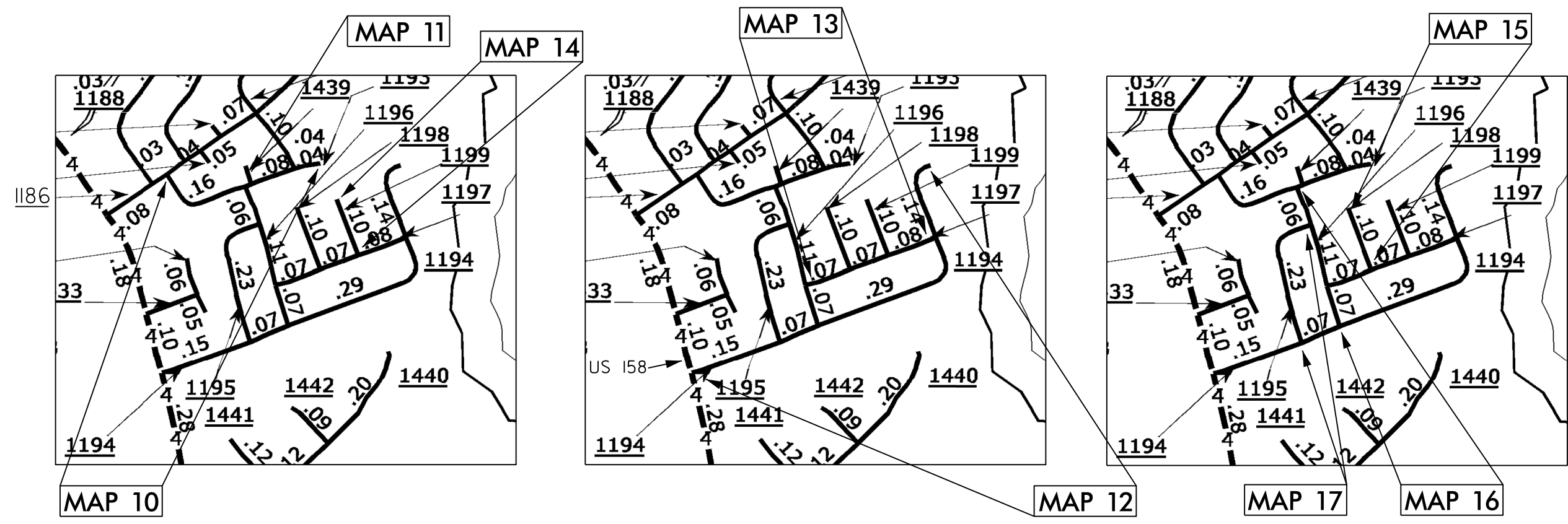

**NTS**

PROJECT LENGTH	
LENGTH OF ROADWAY PROJECT	MAP 10 = 0.28 MI.
LENGTH OF ROADWAY PROJECT	MAP 11 = 0.03 MI.
LENGTH OF ROADWAY PROJECT	MAP 12 = 0.66 MI.
LENGTH OF ROADWAY PROJECT	MAP 13 = 0.23 MI.
LENGTH OF ROADWAY PROJECT	MAP 14 = 0.10 MI.
LENGTH OF ROADWAY PROJECT	MAP 15 = 0.10 MI.
LENGTH OF ROADWAY PROJECT	MAP 16 = 0.24 MI.
LENGTH OF ROADWAY PROJECT	MAP 17 = 0.24 MI.

Prepared In the Office of:  
**DIVISION OF HIGHWAYS**  
 113 Airport Dr., Edenton NC, 27932

2012 STANDARD SPECIFICATIONS

LETTING DATE: \_\_\_\_\_

W.B. HOBBS, P.E.  
 DIVISION PROJECT MANAGER

C.E. SLACHTA  
 DIVISION PROPOSALS ENGINEER

DIVISION OF HIGHWAYS  
STATE OF NORTH CAROLINA

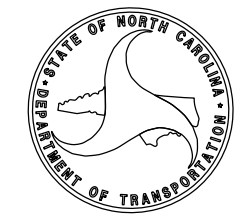

DRAWN BY: JWC

10/03/13

CONTRACT NO.: DA00280 WBS ELEMENT: 2016CPT.01.17.2015I.1, ETC.

STATE OF NORTH CAROLINA  
DIVISION OF HIGHWAYS

**CURRITUCK COUNTY**

STATE	STATE PROJECT REFERENCE NO.	SHEET NO.
N.C.	2016CPT.01.17.2015I.1, ETC.	4
STATE PROJ. NO.	F.A. PROJ. NO.	DESCRIPTION
2016CPT.01.17.20271.2		MAP 18

LOCATION: MAP 18 SR 1371 KINGS WAY FROM SR 1227 TO SR 1371

TYPE OF WORK: RESURFACING & SHOULDER RECONSTRUCTION

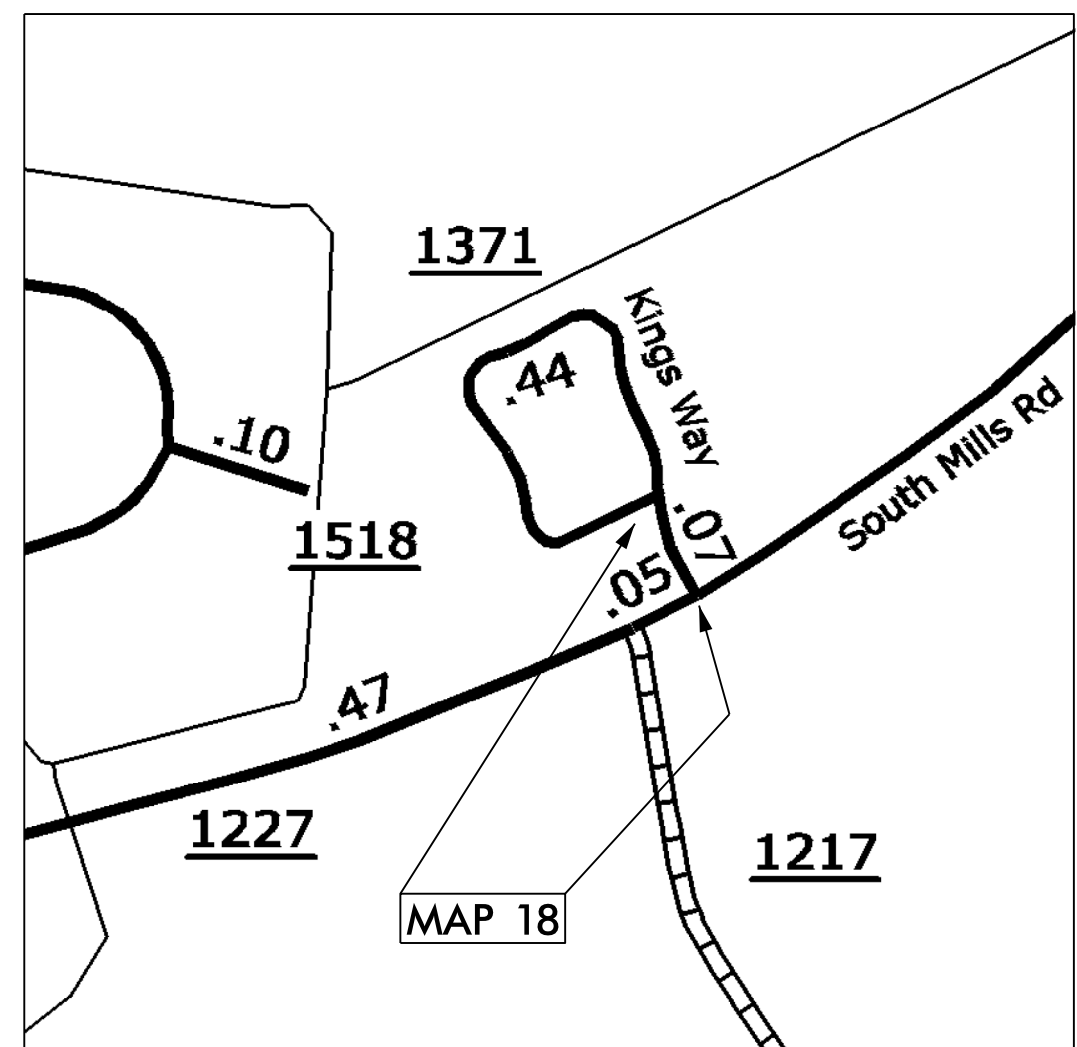

**NTS**

PROJECT LENGTH

LENGTH OF ROADWAY PROJECT MAP 18 = 0.51 MI.

Prepared In the Office of:  
**DIVISION OF HIGHWAYS**  
113 Airport Dr., Edenton NC, 27932

2012 STANDARD SPECIFICATIONS

LETTING DATE: \_\_\_\_\_

W.B. HOBBS, P.E.  
DIVISION PROJECT MANAGER

C.E. SLACHTA  
DIVISION PROPOSALS ENGINEER

DIVISION OF HIGHWAYS  
STATE OF NORTH CAROLINA

DRAWN BY: JWC

10/03/13

CONTRACT NO.: DA00280 WBS ELEMENT: 2016CPT.01.17.20151.1, ETC.

STATE OF NORTH CAROLINA  
DIVISION OF HIGHWAYS

**PASQUOTANK COUNTY**

**LOCATION:** MAP 19 SR 1342 CHICKEN CORNER RD FROM US 17 TO SR 1341  
MAP 20 SR 1341 SCOTT RD FROM SR 1342 TO SR 1332  
MAP 21 SR 1341 SCOTT RD FROM SR 1342 TO CHANGE OF PAVEMENT .82 TO THE NORTHWEST  
MAP 22 SR 1282 ZACK CIRCLE FROM SR 1278 TO SR 1278  
MAP 23 SR 1283 BEAN WAY FROM SR 1282 TO CUL-DE-SAC  
MAP 24 SR 1279 BEAU PKWY FROM SR 1280 TO SR 1278  
MAP 25 SR 1280 BIG DADDY PKWY FROM US 17 TO DEAD END  
MAP 26 SR 1281 TARHEEL CT FROM SR 1279 TO DEAD END  
MAP 27 SR 1278 INTERPATH PKWY FROM US 17 TO SR 1145

**TYPE OF WORK:** RESURFACING, WIDENING & SHOULDER RECONSTRUCTION

STATE	STATE PROJECT REFERENCE NO.	SHEET NO.
N.C.	2016CPT.01.17.20151.1, ETC	5
STATE PROJ. NO.	F.A. PROJ. NO.	DESCRIPTION
2016CPT.01.17.20701.1		MAP 19
2016CPT.01.17.20701.1		MAP 20
2016CPT.01.17.20701.1		MAP 21
2016CPT.01.17.20701.2		MAP 22
2016CPT.01.17.20701.2		MAP 23
2016CPT.01.17.20701.2		MAP 24
2016CPT.01.17.20701.2		MAP 25
2016CPT.01.17.20701.2		MAP 26
2016CPT.01.17.20701.2		MAP 27

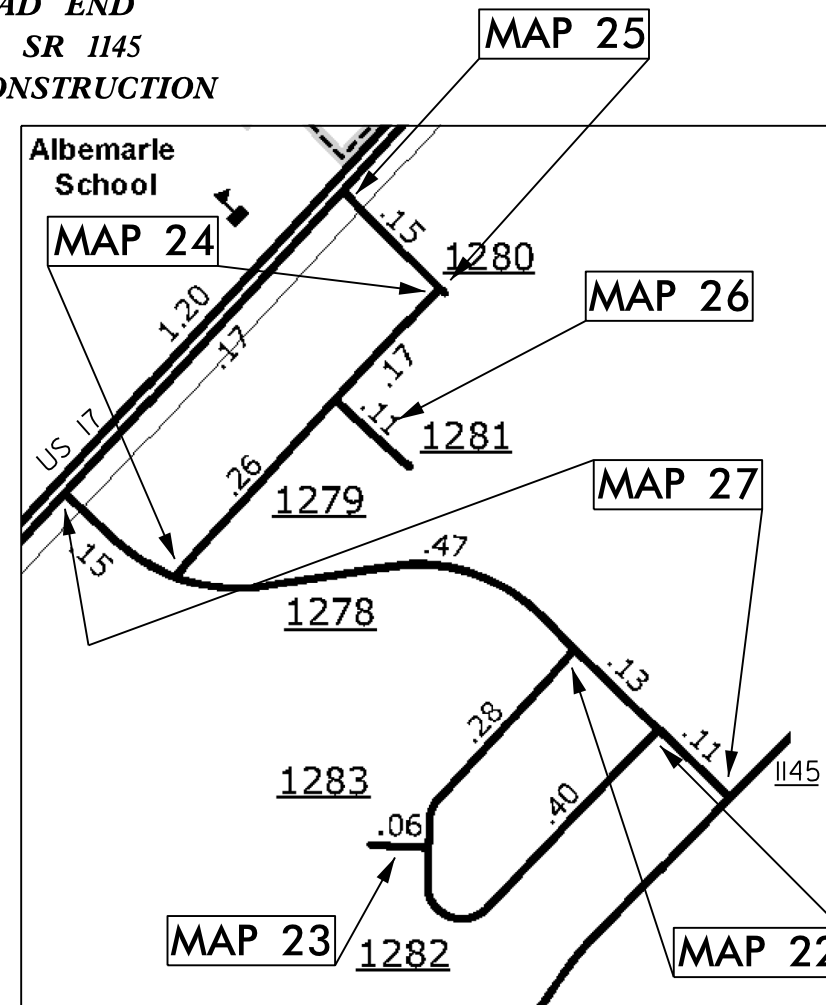
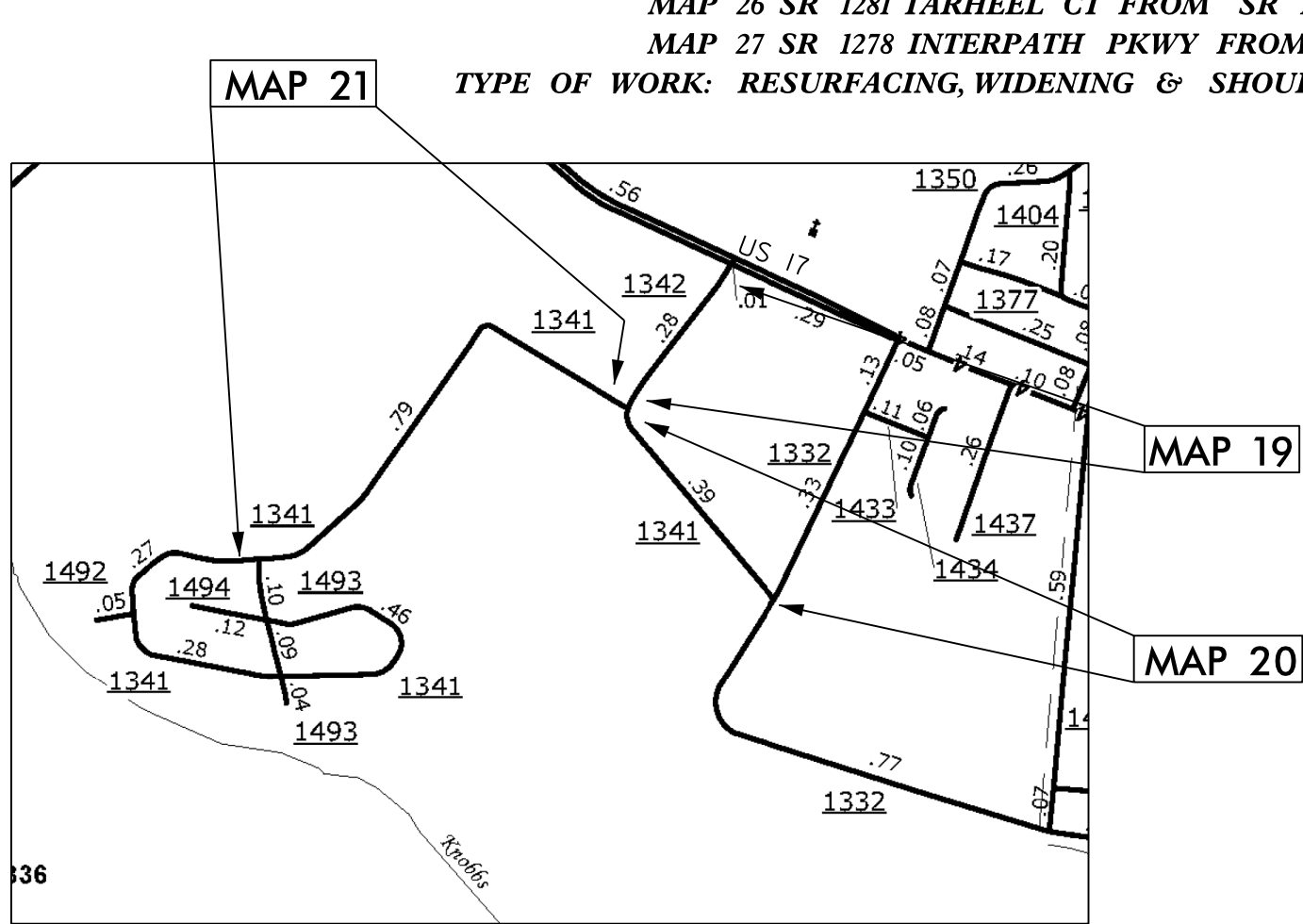

**NTS**

PROJECT LENGTH	
LENGTH OF ROADWAY PROJECT	MAP 19 = 0.29 MI.
LENGTH OF ROADWAY PROJECT	MAP 20 = 0.38 MI.
LENGTH OF ROADWAY PROJECT	MAP 21 = 0.82 MI.
LENGTH OF ROADWAY PROJECT	MAP 22 = 0.69 MI.
LENGTH OF ROADWAY PROJECT	MAP 23 = 0.06 MI.
LENGTH OF ROADWAY PROJECT	MAP 24 = 0.43 MI.
LENGTH OF ROADWAY PROJECT	MAP 25 = 0.16 MI.
LENGTH OF ROADWAY PROJECT	MAP 26 = 0.11 MI.
LENGTH OF ROADWAY PROJECT	MAP 27 = 0.85 MI.

Prepared in the Office of:  
**DIVISION OF HIGHWAYS**  
113 Airport Dr., Edenton NC, 27932

2012 STANDARD SPECIFICATIONS

LETTING DATE: \_\_\_\_\_

W.B. HOBBS, P.E.  
DIVISION PROJECT MANAGER

C.E. SLACHTA  
DIVISION PROPOSALS ENGINEER

**DIVISION OF HIGHWAYS  
STATE OF NORTH CAROLINA**

DRAWN BY: JWC

10/03/13

CONTRACT NO.: DA00280 WBS ELEMENT: 2016CPT.01.17.20151.1, ETC.

STATE OF NORTH CAROLINA  
DIVISION OF HIGHWAYS

**PASQUOTANK COUNTY**

STATE	STATE PROJECT REFERENCE NO.	SHEET NO.
N.C.	2016CPT.01.17.20151.1, ETC	6
STATE PROJ. NO.	F.A. PROJ. NO.	DESCRIPTION
2016CPT.01.17.20701.3		MAP 28
2016CPT.01.17.20701.4		MAP 29
2016CPT.01.17.20701.5		MAP 30
2016CPT.01.17.20701.6		MAP 31
2016CPT.01.17.20701.6		MAP 32

**LOCATION:** MAP 28 SR 1269 SOUTH ROAD ST FROM US 17 TO BRIDGE #18  
 MAP 29 SR 1300 METHODIST CHURCH RD FROM SR 1140 TO END OF PAVEMENT  
 MAP 30 SR 1387 KNOBBS CREEK DR FROM US 17 BUSINESS TO END OF MAINTENANCE  
 MAP 31 SR 1224 KRIS DR FROM SR 1145 TO SR 1224  
 MAP 32 SR 1231 DARIAN DR FROM SR 1224 TO SR 1224

**TYPE OF WORK:** RESURFACING, MILLING & SHOULDER RECONSTRUCTION

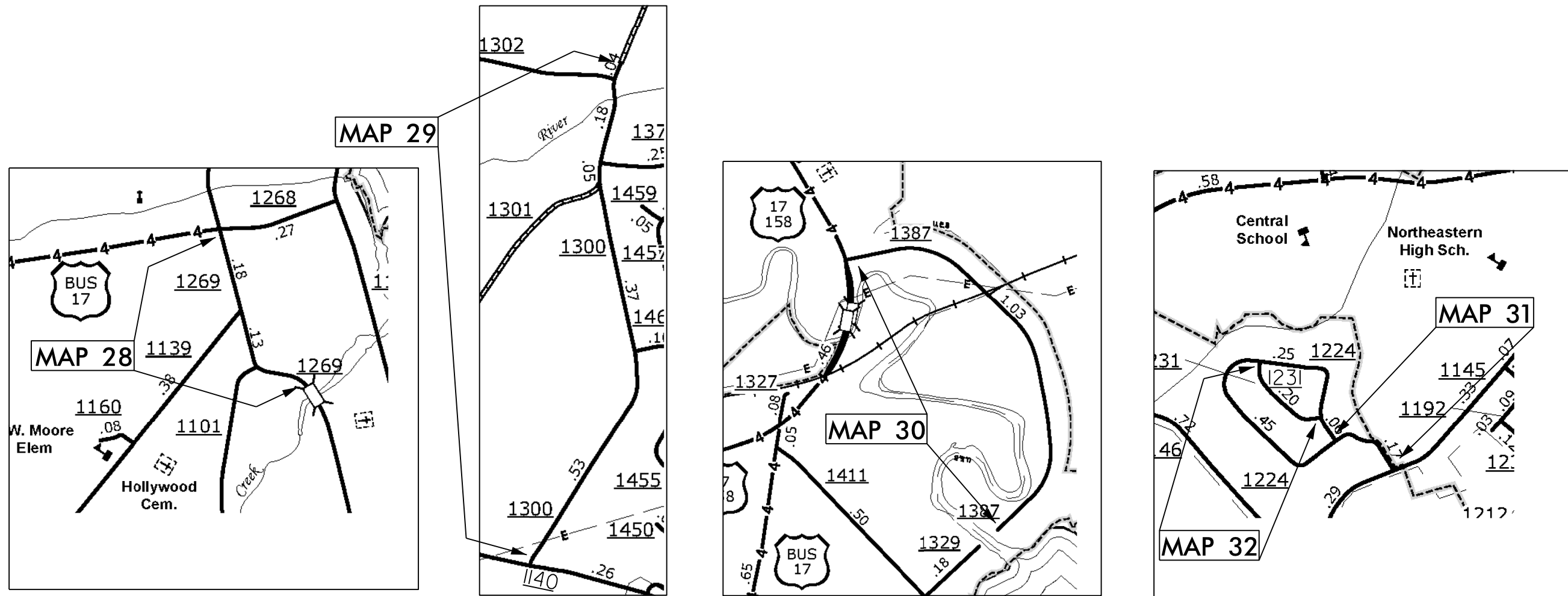

**NTS**

**PROJECT LENGTH**

LENGTH OF ROADWAY PROJECT MAP 28	=	0.49 MI.
LENGTH OF ROADWAY PROJECT MAP 29	=	1.13 MI.
LENGTH OF ROADWAY PROJECT MAP 30	=	0.90 MI.
LENGTH OF ROADWAY PROJECT MAP 31	=	0.93 MI.
LENGTH OF ROADWAY PROJECT MAP 32	=	0.21 MI.

Prepared in the Office of:  
**DIVISION OF HIGHWAYS**  
 113 Airport Dr., Edenton NC, 27932

2012 STANDARD SPECIFICATIONS

LETTING DATE: \_\_\_\_\_

W.B. HOBBS, P.E.  
 DIVISION PROJECT MANAGER

C.E. SLACHTA  
 DIVISION PROPOSALS ENGINEER

**DIVISION OF HIGHWAYS**  
 STATE OF NORTH CAROLINA

DRAWN BY: JWC

# C O N T R A C T P A V E M E N T S C H E D U L E

C1	PROP. APPROX. 1½" ASPHALT CONCRETE SURFACE COURSE, TYPE SF9.5A, AT AN AVERAGE RATE OF 165 LBS. PER SQ. YD.
C2	PROP. APPROX. 1½" ASPHALT CONCRETE SURFACE COURSE, TYPE S9.5B, AT AN AVERAGE RATE OF 168 LBS. PER SQ. YD.
U	EXISTING PAVEMENT.
T	EARTH MATERIAL.
E1	PROP. APPROX. 5½" ASPHALT CONCRETE BASE COURSE, TYPE B25.0B, AT AN AVERAGE RATE OF 627 LBS. PER SQ. YD.
V1	MILLING BITUMINOUS PAVEMENT 1½" DEPTH.

P A V E M E N T S C H E D U L E

C1	PROP. APPROX. 1½" ASPHALT CONCRETE SURFACE COURSE, TYPE SF9.5A, AT AN AVERAGE RATE OF 165 LBS. PER SQ. YD.
U	EXISTING PAVEMENT.
T	EARTH MATERIAL

PROJECT REFERENCE NO.	SHEET NO.
2016CPT.01.17.20151.1, ETC	8

NOTES:

\*ALL PAVED S.R. ROADS TO BE RESURFACED TO THE ENDS OF THE RADII, OR AS DIRECTED BY THE ENGINEER

\*EDGES, PAVEMENT WIDENING, INTERSECTIONS, AND BRIDGE FLARES ARE INCLUDED IN THE TABLE OF QUANTITIES

\*PAVEMENT MARKINGS TO BE INSTALLED BY OTHERS

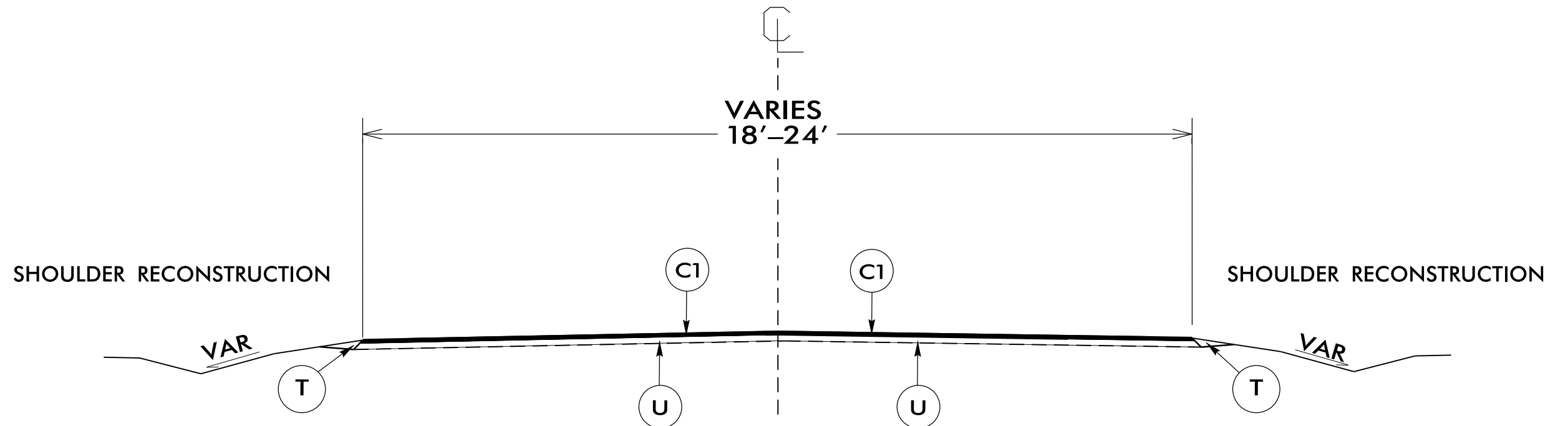

**TYPICAL SECTION NO. 1**

USE WITH MAPS 1 - 18, 21 - 27, 29, 31 & 32

NTS



PAVEMENT SCHEDULE

PROJECT REFERENCE NO.	SHEET NO.
2016CPT.01.17.20151.1, ETC.	9

C2	PROP. APPROX. 1½" ASPHALT CONCRETE SURFACE COURSE, TYPE S9.5B, AT AN AVERAGE RATE OF 168 LBS. PER SQ. YD.
U	EXISTING PAVEMENT.
E1	PROP. APPROX. 5½" ASPHALT CONCRETE BASE COURSE, TYPE B25.0B, AT AN AVERAGE RATE OF 627 LBS. PER SQ. YD.
T	EARTH MATERIAL

NOTES:

\*ALL PAVED S.R. ROADS TO BE RESURFACED TO THE ENDS OF THE RADII, OR AS DIRECTED BY THE ENGINEER

\*EDGES, PAVEMENT WIDENING, INTERSECTIONS, AND BRIDGE FLARES ARE INCLUDED IN THE TABLE OF QUANTITIES

\*PAVEMENT MARKINGS TO BE INSTALLED BY OTHERS

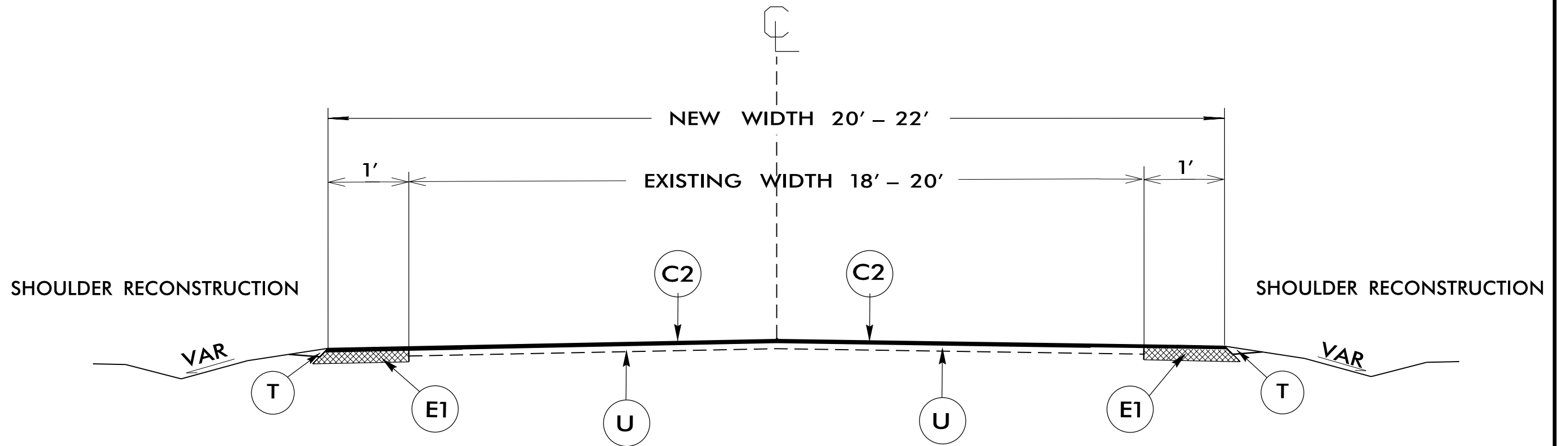

TYPICAL SECTION NO. 2

USE WITH MAPS 19 & 20

NTS

P A V E M E N T S C H E D U L E

C1	PROP. APPROX. 1½" ASPHALT CONCRETE SURFACE COURSE, TYPE SF9.5B, AT AN AVERAGE RATE OF 168 LBS. PER SQ. YD.
U	EXISTING PAVEMENT.
V1	MILLING BITUMINOUS PAVEMENT 1½"DEPTH.

NOTES:

\*ALL PAVED S.R. ROADS TO BE RESURFACED TO THE ENDS OF THE RADII, OR AS DIRECTED BY THE ENGINEER

\*EDGES, PAVEMENT WIDENING, INTERSECTIONS, AND BRIDGE FLARES ARE INCLUDED IN THE TABLE OF QUANTITIES

\*PAVEMENT MARKINGS TO BE INSTALLED BY OTHERS

PROJECT REFERENCE NO.	SHEET NO.
2016CPT.01.17.20151.1, ETC	10

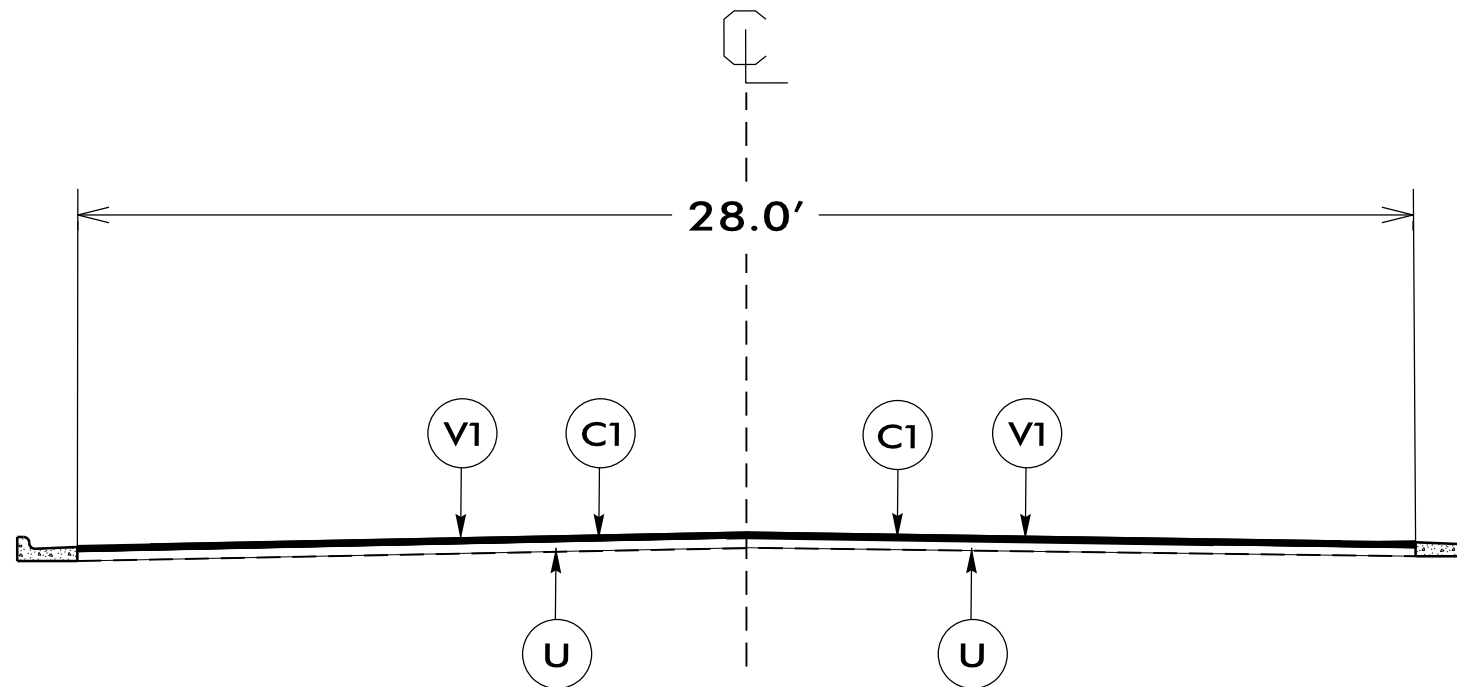

**TYPICAL SECTION NO. 3**

USE WITH MAP 28

NTS

P A V E M E N T S C H E D U L E

C2	PROP. APPROX. 1½" ASPHALT CONCRETE SURFACE COURSE, TYPE S9.5B, AT AN AVERAGE RATE OF 168 LBS. PER SQ. YD.
U	EXISTING PAVEMENT.
T	EARTH MATERIAL

PROJECT REFERENCE NO.	SHEET NO.
2016CPT.01.17.20151.1, ETC	11

NOTES:

\*ALL PAVED S.R. ROADS TO BE RESURFACED TO THE ENDS OF THE RADII, OR AS DIRECTED BY THE ENGINEER

\*EDGES, PAVEMENT WIDENING, INTERSECTIONS, AND BRIDGE FLARES ARE INCLUDED IN THE TABLE OF QUANTITIES

\*PAVEMENT MARKINGS TO BE INSTALLED BY OTHERS

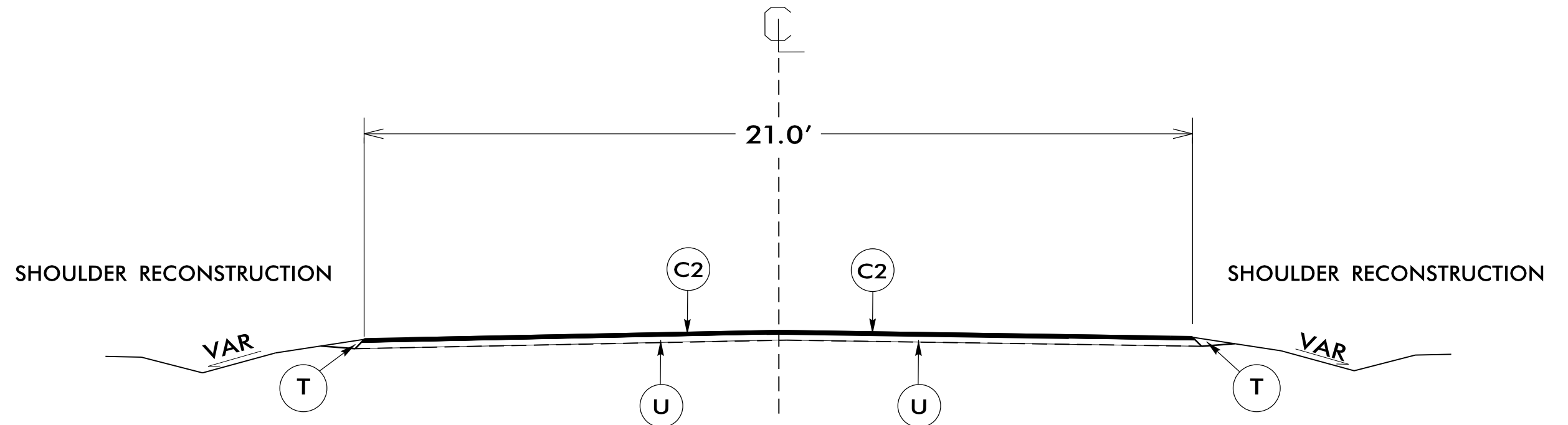

TYPICAL SECTION NO. 4

USE WITH MAP 30

NTS

- NOTES:
- 1) DETAIL DOES NOT APPLY TO OGAFCC AND ULTRA-THIN BONDED WEARING COURSE.
  - 2) BACKFILL SHOULDER WITH APPROVED MATERIAL.
  - 3) THE SHOULDER WEDGE DEVICE MAY BE DISENGAGED AT PAVED DRIVEWAYS AND SIDE STREETS.

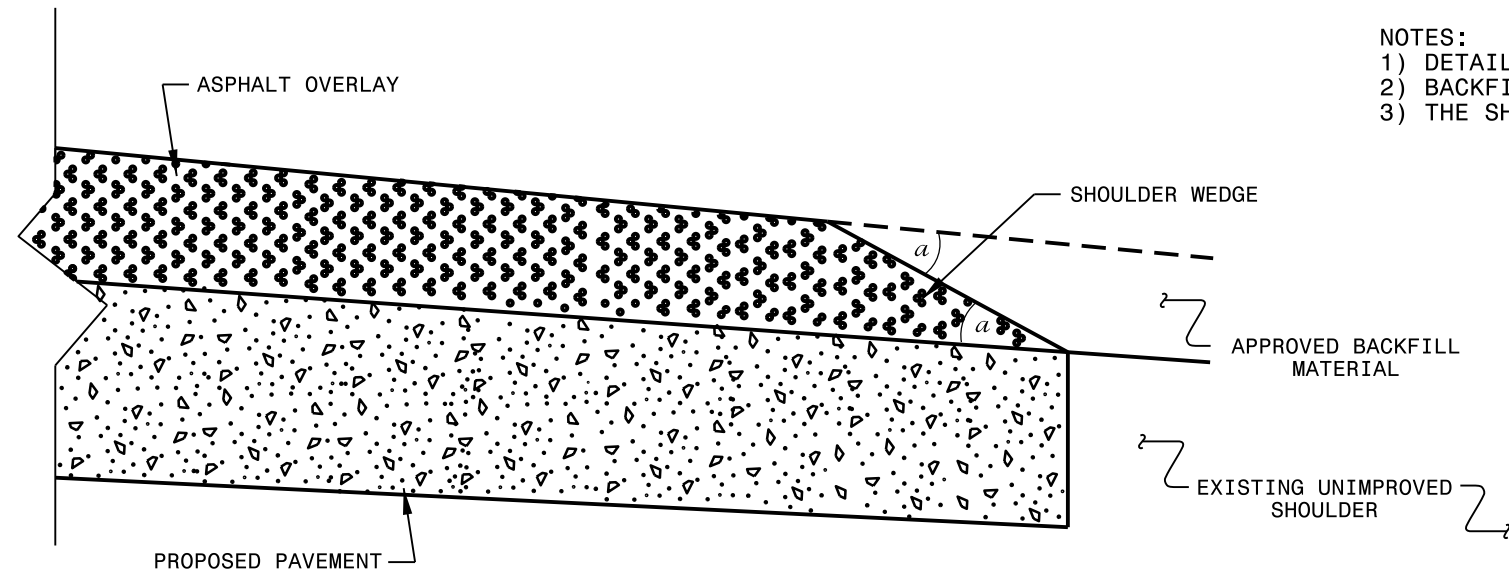

**SHOULDER WEDGE DETAIL**  
(Resurfacing Projects w/ Widening or  
with Existing Paved Shoulder having no dropoffs)

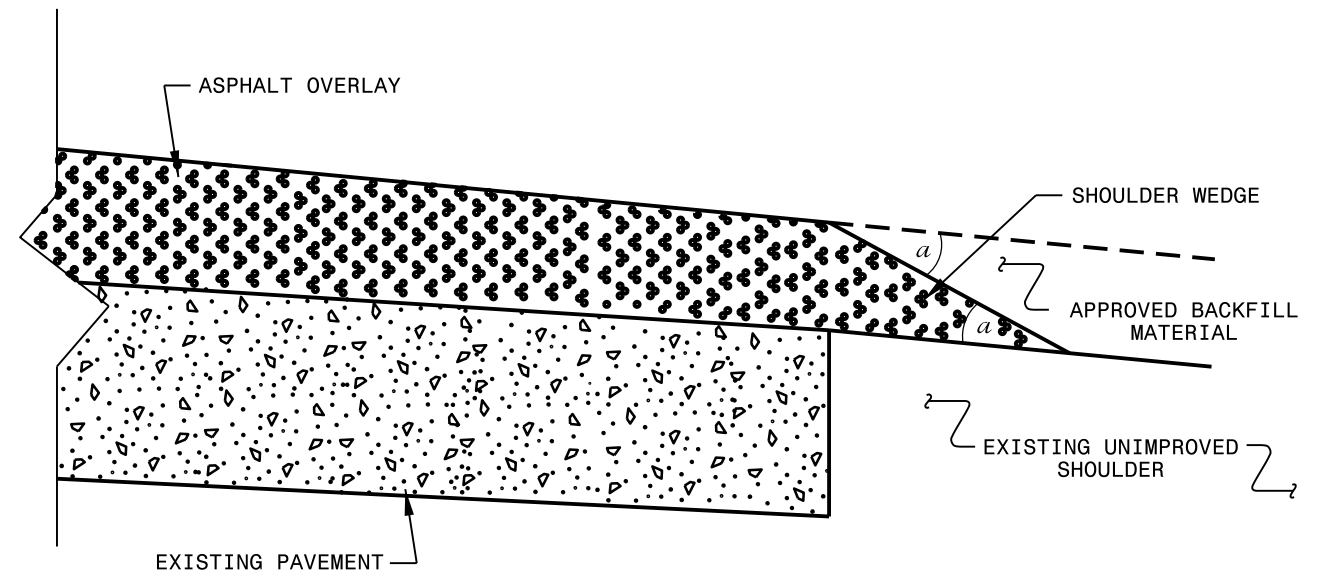

**SHOULDER WEDGE DETAIL**  
(Resurfacing Projects w/ NO Widening)

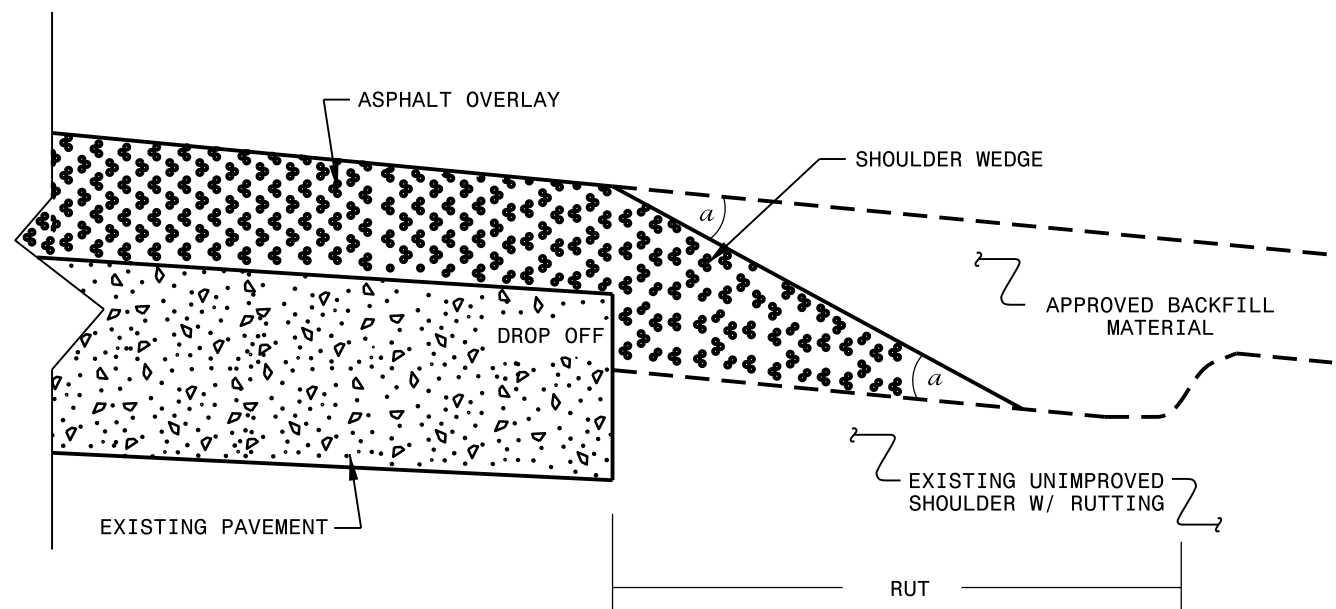

**SHOULDER WEDGE DETAIL**  
(Resurfacing Adjacent to  
Rutted Shoulder)

- SHOULDER WEDGE ANGLE = 30°

<b>CONTRACT STANDARDS AND DEVELOPMENT UNIT</b>			
Office 919-707-6950		FAX 919-250-4119	
<b>SHOULDER WEDGE DETAILS</b>			
ORIGINAL BY: T.SPELL	DATE: 7-19-11	CHECKED BY:	DATE: 10/16/12
FILE SPEC.: s:\usr\details\stand\shoulderwedgedetail.dgn			

## SIGNING FOR RESURFACING PROJECTS

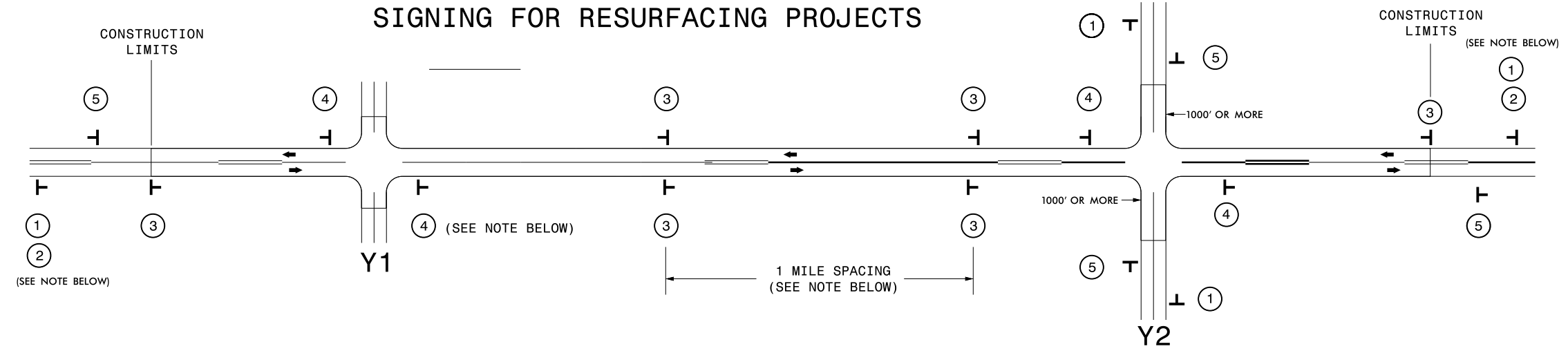

**LEGEND**  
 STATIONARY SIGN  
 DIRECTION OF TRAFFIC FLOW

### MAINLINE (-L-) SIGNING

### -Y- LINE SIGNING

SIGNING NOTES AND PLACEMENT PER DIRECTION	 	<p>PLACE 1000' PRIOR TO BEGINNING OF CONSTRUCTION LIMITS. ONLY USED ON -Y- LINES IF RESURFACING LIMITS EXTEND 1000' ALONG -Y- LINE.</p> <p>#2 SIGN ONLY USED WHEN RESURFACING LIMITS ARE 2 OR MORE MILES IN LENGTH. ROUND UP TO NEXT WHOLE NUMBER. (NO FRACTIONAL OR DECIMAL NUMBERS)</p>	<p><b>NO REQUIRED STATIONARY SIGNING FOR THE FOLLOWING -Y- LINE CONDITIONS:</b></p> <ol style="list-style-type: none"> <li>1) LESS THAN 1000' OF RESURFACING ALONG -Y- LINE</li> <li>2) SUBDIVISION ROADS</li> <li>3) DEAD END ROADS</li> </ol> <p>WHEN PAVING/CONSTRUCTION ACTIVITIES PROCEED ACROSS AN UNSIGNED -Y- LINE, ADVANCE WARNING PORTABLE SIGNS SHALL BE USED ALONG THE -Y- LINE AS SHOWN BELOW. REMOVE UPON COMPLETION OF WORK.</p> <div style="display: flex; justify-content: space-around; align-items: center;"> <div style="text-align: center;">   <small>W20-1 48" X 48"</small> </div> <div style="text-align: center;">   <small>W20-7 A 48" X 48"</small> </div> </div> <p>PLACED 500' IN ADVANCE OF FLAGGER. PLACED 250' IN ADVANCE OF FLAGGER.</p>
		<p>PLACE INITIALLY AT THE CONSTRUCTION LIMITS AND SPACED 1 MILE APART THEREAFTER. IF NO -Y- LINES EXIST, PLACE 2ND SET 1/2 MILE FROM THE CONSTRUCTION LIMITS AND THEN SPACE 1 MILE THEREAFTER.</p>	
		<p>THESE ARE FOR -Y- LINES THAT ARE "THROUGH" ROADWAYS. DEAD END AND SUBDIVISION ROADS ARE NOT "THROUGH" ROADWAYS. INSTALL 500' +/- FROM EACH -Y- LINE APPROACH AS SHOWN ABOVE. FOR MULTIPLE -Y- LINES THAT ARE SEPARATED BY 0.25 MILES OR LESS, TREAT AS A SINGLE UNIT AND INSTALL WITHIN 500' OF EACH APPROACH. A MAXIMUM OF 2 SIGN SETS PER MILE. DO NOT INSTALL WHEN -Y- LINES ARE WITHIN 0.5 MILES FROM "END ROAD WORK" SIGN.</p>	
		<p>PLACE 500' FOLLOWING THE END OF CONSTRUCTION LIMITS.</p>	

DRAWN BY: JWC

DIVISION OF HIGHWAYS  
STATE OF NORTH CAROLINA  
DEPARTMENT OF TRANSPORTATION  
WORK ZONE TRAFFIC CONTROL

**RESURFACING  
ADVANCE WARNING SIGNS  
FOR  
RURAL AND SUBURBAN  
2 LANE ROADWAYS**

PROJECT NO.	SHEET NO.	TOTAL NO.
2016CPT.01.17.20151.1, ETC.	14	

### SUMMARY OF QUANTITIES

PROJECT NO	COUNTY	MAP NO	ROUTE	DESCRIPTION	TYP	LANES	LANE TYPE	FINAL SURFACE TESTING REQUIRED	WARM MIX ASPHALT REQUIRED	LENGTH MI	WIDTH FT	MOBILIZATION LS	BORROW CY	INCIDENTAL STONE BASE TONS	SHOULDER RECONSTRUCTION SMI	1 1/2" MILLING SY	BASE COURSE, B25.0B TONS	SURFACE COURSE, S9.5B TONS	SURFACE COURSE, SF9.5A TONS	ASPHALT BINDER FOR PLANT MIX TONS	CONCRETE CURB RAMPS EA	ADJ. OF MANHOLES EA	ADJ. OF METER OR VALVE BOX EA	SEED & MULCHING AC	TEMPORARY TRAFFIC CONTROL LS	JUNCTION BOX (STANDARD SIZE) EA	INDUCTIVE LOOP SAWCUT LF	LEAD-IN Cable (14-2) LF
2016CPT.01.17.20151.1	Camden	1	SR 1111 WICKHAM RD	FROM NC 343 TO SR 1112	1	2	2WU	NO	NO	2.67	20	1	1,000	35	5.30				2,861	192				2.60	1			
2016CPT.01.17.20151.2	Camden	2	SR 1112 NECK RD	FROM SR 1111 TO END OF MAINTENANCE	1	2	2WU	NO	NO	3.26	21	*	1,000	20	6.50				3,667	246				3.16	*			
2016CPT.01.17.20271.1	Currituck	3	SR 1186 WALNUT ISLAND BLVD	FROM US 158 TO END MAINTENANCE	1	2	2WU	NO	NO	0.67	22	*	200	23	1.30				844	57				0.16	*			
2016CPT.01.17.20271.1	Currituck	4	SR 1190 N KELLER ST	FROM SR 1188 TO SR 1186	1	2	2WU	NO	NO	0.18	20	*	40	16	0.38				193	13				0.20	*			
2016CPT.01.17.20271.1	Currituck	5	SR 1192 GREGORY CT	FROM SR 1188 TO DEAD END	1	2	2WU	NO	NO	0.10	20	*	20	6	0.20				107	7				0.10	*			
2016CPT.01.17.20271.1	Currituck	6	SR 1191 PLEASANT POINT DR	FROM SR 1188 TO DEAD END	1	2	2WU	NO	NO	0.11	20	*	20	6	0.20				118	8				0.10	*			
2016CPT.01.17.20271.1	Currituck	7	SR 1188 HOLLY CRESCENT	FROM SR 1186 TO SR 1192	1	2	2WU	NO	NO	0.60	20	*	200	47	1.20				643	43				0.58	*			
2016CPT.01.17.20271.1	Currituck	8	SR 1189 FARIS DR	FROM SR 1186 TO SR 1188	1	2	2WU	NO	NO	0.33	20	*	150	32	0.68				354	24				0.33	*			
2016CPT.01.17.20271.1	Currituck	9	SR 1190 S. KELLER LN	FROM SR 1186 TO SR 1193	1	2	2WU	NO	NO	0.11	20	*	40	10	0.22				118	8				0.10	*			
2016CPT.01.17.20271.1	Currituck	10	SR 1193 MALLARD DR	FROM SR 1186 TO END OF MAINTENANCE	1	2	2WU	NO	NO	0.28	20	*	100	18	0.56				327	22				0.27	*			
2016CPT.01.17.20271.1	Currituck	11	SR 1439 MALLARD CT	FROM SR 1193 TO DEAD END	1	2	2WU	NO	NO	0.03	20	*	15	4	0.06				76	5				0.02	*			
2016CPT.01.17.20271.1	Currituck	12	SR 1194 EDGEWATER DR	FROM US 158 TO DEAD END	1	2	2WU	NO	NO	0.66	20	*	200	43	1.20				707	47				0.62	*			
2016CPT.01.17.20271.1	Currituck	13	SR 1197 MIDWAY DR	FROM SR 1196 TO SR 1194	1	2	2WU	NO	NO	0.23	20	*	100	10	0.46				246	17				0.25	*			
2016CPT.01.17.20271.1	Currituck	14	SR 1199 CANAL CT	FROM SR 1197 DEAD END	1	2	2WU	NO	NO	0.10	20	*	40	4	0.20				107	7				0.10	*			
2016CPT.01.17.20271.1	Currituck	15	SR 1198 ADMIRALTY CT	FROM SR 1197 TO DEAD END	1	2	2WU	NO	NO	0.10	20	*	40	6	0.20				107	7				0.10	*			
2016CPT.01.17.20271.1	Currituck	16	SR 1196 EVANS DR	FROM SR 1194 TO SR 1193	1	2	2WU	NO	NO	0.24	20	*	100	17	0.50				257	17				0.25	*			
2016CPT.01.17.20271.1	Currituck	17	SR 1195 LEEWARD DR	FROM SR 1194 TO SR 1196	1	2	2WU	NO	NO	0.24	20	*	100	19	0.50				257	17				0.25	*			
2016CPT.01.17.20271.2	Currituck	18	SR 1371 KINGS WAY	FROM SR 1227 TO SR 1371	1	2	2WU	NO	NO	0.51	22	*	200	7	1.00				601	40				0.50	*			
2016CPT.01.17.20701.1	Pasquotank	19	SR 1342 CHICKEN CORNER RD	FROM US 17 TO SR 1341	2	2	2WU	NO	NO	0.29	20	*	100	2	0.50		144	348		27				0.40	*			
2016CPT.01.17.20701.1	Pasquotank	20	SR 1341 SCOTT ROAD	FROM SR 1342 TO SR 1332	2	2	2WU	NO	NO	0.38	18	*	150	2	0.76		189	373		31		1		0.65	*			
2016CPT.01.17.20701.1	Pasquotank	21	SR 1341 SCOTT RD	FROM SR 1342 TO CHANGE OF PAVEMENT .82 TO THE NORHTWEST	1	2	2WU	NO	NO	0.82	18	*	300	10	1.65				791	53		4		1.40	*			
2016CPT.01.17.20701.2	Pasquotank	22	SR 1282 ZACK CIRCLE	FROM SR 1278 TO SR 1278	1	2	2WU	NO	NO	0.69	21	*	200	3	1.30				776	52		5		0.65	*			
2016CPT.01.17.20701.2	Pasquotank	23	SR 1283 BEAN WAY	FROM SR 1282 TO CUL-DE-SAC	1	2	2WU	NO	NO	0.06	21	*	20	2	0.12				67	5				0.01	*			
2016CPT.01.17.20701.2	Pasquotank	24	SR 1279 BEAU PKWY	FROM SR 1280 TO SR 1278	1	2	2WU	NO	NO	0.43	22	*	160	2	0.80				507	34		1		0.40	*			
2016CPT.01.17.20701.2	Pasquotank	25	SR 1280 BIG DADDY PKWY	FROM US 17 TO DEAD END	1	2	2WU	NO	NO	0.16	21	*	60	2	0.30				180	12		1		0.14	*			
2016CPT.01.17.20701.2	Pasquotank	26	SR 1281 TARHEEL CT	FROM SR 1279 DEAD END	1	2	2WU	NO	NO	0.11	21	*	40	2	0.21				124	8				0.18	*			
2016CPT.01.17.20701.2	Pasquotank	27	SR 1278 INTERPATH PKWY	FROM US 17 TO SR 1145	1	2	2WU	NO	NO	0.85	24	*	340	2	1.70				1,092	73		1		1.44	*			
2016CPT.01.17.20701.3	Pasquotank	28	SR 1269 SOUTH ROAD ST	FROM US 17 TO BRIDGE #18	3	2	2WU	NO	NO	0.49	28	*				7,000		600		36	4	11	26		*	1	400	100
2016CPT.01.17.20701.4	Pasquotank	29	SR 1300 METHODIST CHURCH RD	FROM SR 1140 TO END OF PAVEMENT	1	2	2WU	NO	NO	1.13	20	*	200	20	2.25				1,255	84		1		1.91	*			
2016CPT.01.17.20701.5	Pasquotank	30	SR 1387 KNOBBS CREEK ROAD	FROM US 17 BUSINESS TO END OF MAINTENANCE	4	2	2WU	NO	NO	0.90	21	*	300	15	1.60	250		1,031		62				1.40	*			
2016CPT.01.17.20701.6	Pasquotank	31	SR 1224 KRIS DR	FROM SR 1145 TO SR 1224	1	2	2WU	NO	NO	0.93	24	*	300	2	1.82				1,195	80				1.50	*			
2016CPT.01.17.20701.6	Pasquotank	32	SR 1231 DARIAN DR	FROM SR 1224 TO SR 1224	1	2	2WU	NO	NO	0.21	24	*	50	2	0.40				270	18		1		0.34	*			
<b>GRAND TOTAL</b>										<b>17.87</b>		<b>1</b>	<b>5,785</b>	<b>389</b>	<b>34.07</b>	<b>7,250</b>	<b>333</b>	<b>2,352</b>	<b>17,847</b>	<b>1,352</b>	<b>4</b>	<b>11</b>	<b>41</b>	<b>20.11</b>	<b>1</b>	<b>1</b>	<b>400</b>	<b>100</b>