



STATE OF NORTH CAROLINA
DEPARTMENT OF TRANSPORTATION

PAT MCCRORY
GOVERNOR

NICHOLAS J. TENNYSON
SECRETARY

January 12, 2016

Addendum No. 1

Contract No.: DA00284

WBS Element: 2016CPT.01.21.20481.1, ETC.

Milling & Resurfacing on Various Secondary Roads in Hyde, Tyrrell and Washington Counties

To Whom It May Concern:

Reference is made to the proposal and plans previously furnished for this project.

The following revision has been made to the proposal and plans:

Page No. 74, "Bid Form" has been revised to adjust the quantities, due to the fact that the original Map #6 & #7 have been removed from the contract. Please void existing Page No. 74 and staple revised Page No.74 thereto.

Plan Sheets #2 thru #8 have been revised to illustrate the removal of original Map #6 & #7. Please void existing Plan Sheets #2 thru #8 and substitute the revised Plan Sheets #2 thru #8 thereto.

If you elect to prepare your bid electronically, place file DA00284.001 in the same folder with DA00284.EBS, so that Expedite Bid will properly apply the addendum.

Please acknowledge receipt of Addendum #1 in the space provided on the Addendum Acknowledgement Form.

Sincerely,

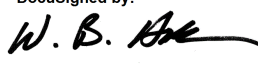
DocuSigned by:

99A5A272ED6A447...

W. B. Hobbs, PE
Division Project Manager

WBH/ces
Attachment

cc: S. D. Baker, PE
C. S. Mebane, PE
D. S. Lee, PE

County : Hyde, Tyrrell, Washington

Line #	Item Number	Sec #	Description	Quantity	Unit Cost	Amount
ROADWAY ITEMS						
0001	0000100000-N	800	MOBILIZATION	Lump Sum	L.S.	
0003	1297000000-E	607	MILLING ASPHALT PAVEMENT, **** DEPTH (1.5")	27,326 SY		
0004	1525000000-E	610	ASPHALT CONC SURFACE COURSE, TYPE SF9.5A	18,024 TON		
0005	1575000000-E	620	ASPHALT BINDER FOR PLANT MIX	1,208 TON		
0006	2549000000-E	846	2'-6" CONCRETE CURB & GUTTER	560 LF		
0007	2759000000-N	SP	GENERIC PAVING ITEM (RETROFIT EXISTING CURB RAMPS)	6 EA		
0008	2830000000-N	858	ADJUSTMENT OF MANHOLES	19 EA		
0009	2845000000-N	858	ADJUSTMENT OF METER BOXES OR VALVE BOXES	13 EA		
0010	4457000000-N	SP	TEMPORARY TRAFFIC CONTROL	Lump Sum	L.S.	
0011	7444000000-E	1725	INDUCTIVE LOOP SAWCUT	1,600 LF		
1029/Jan12/Q48758.0/D27281100000/E10				Total Amount Of Bid For Entire Project :		

12-JAN-2016 08:57 S:\Shared\DA00284 Hyde, Tyrrell & Washington Co. Resurfacing (2016 - 2017)\1 Pre-Bid Documents\IndividualFiles\2016CPT_01_21_L_Rdy.dgn
 F:\west AT DICAD265786

09/08/99

CONTRACT NO.: DA00284 WBS ELEMENT : 2016CPT.01.21.20481.1 ETC.



STATE OF NORTH CAROLINA
 DIVISION OF HIGHWAYS

REVISED 1/12/2016

TYRRELL COUNTY

STATE	STATE PROJECT REFERENCE NO.	SHEET NO.	TOTAL SHEETS
N.C.	2016CPT.01.21.20481.1 ETC.	2	
STATE PROJ. NO.	F.A. PROJ. NO.	DESCRIPTION	

LOCATION: MAP #4 SR-1314 (FROM SR 1310 TO DEAD END) MAP #5 SR-1307 (FROM NC 94 TO 3.0 MI. EAST)
TYPE OF WORK: RESURFACING

MAP # 4 SR 1314

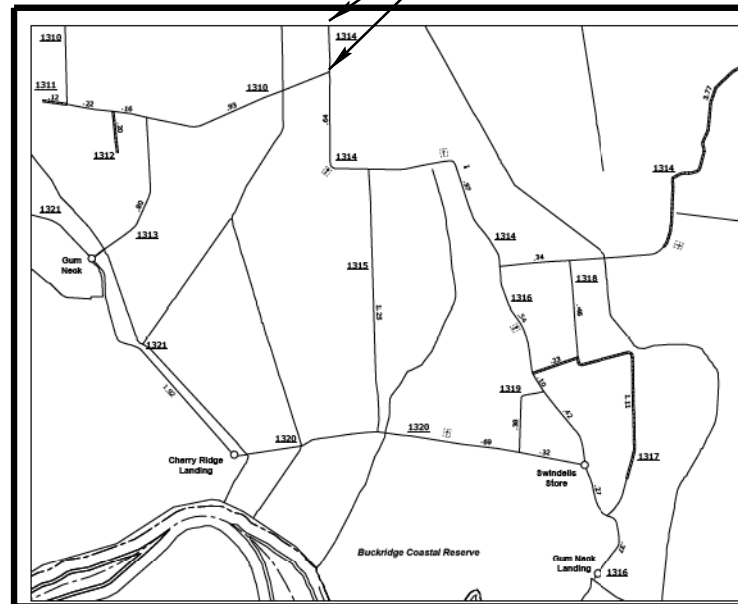

MAP # 5 SR 1307

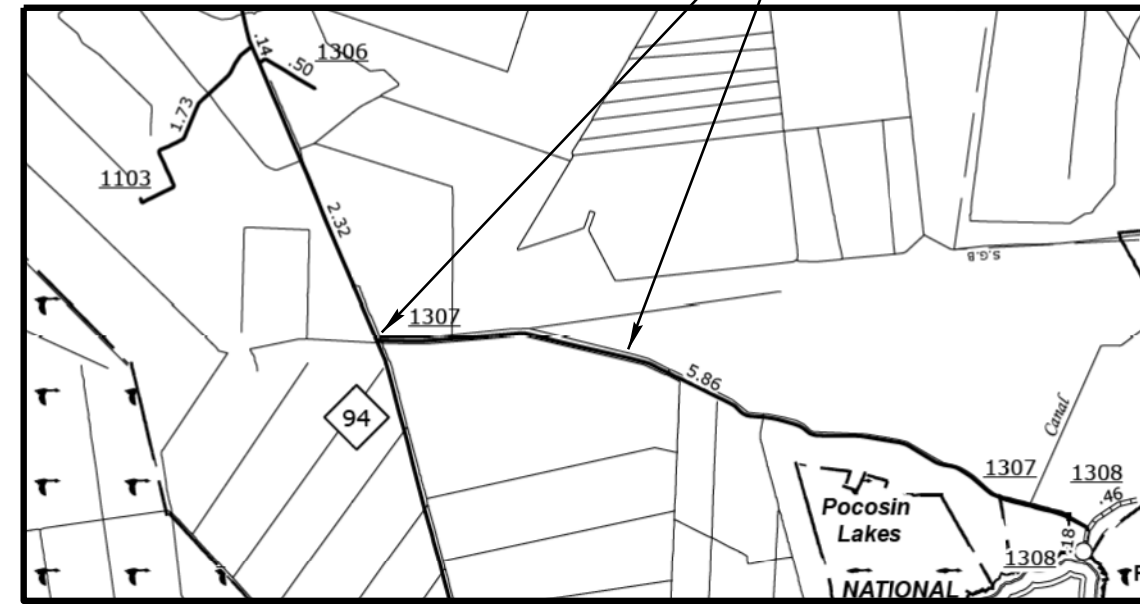

NOT TO SCALE

PROJECT LENGTH

LENGTH OF ROADWAY PROJECT MAP# 4 = 0.50 MILES
 LENGTH OF ROADWAY PROJECT MAP# 5 = 3.00 MILES

Prepared in the Office of:
DIVISION OF HIGHWAYS

2012 STANDARD SPECIFICATIONS

LETTING DATE:

W.B. HOBBS, P.E.
 DIVISION PROJECT MANAGER

C.E. SLACHTA
 DIVISION PROPOSALS ENGINEER

**DIVISION OF HIGHWAYS
 STATE OF NORTH CAROLINA**

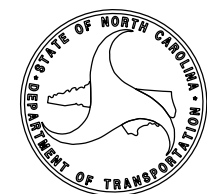

12-JAN-2016 10:39
 S:\Shared\DA00284_Hyde_Tyrrell & Washington Co. Resurfacing (2016 - 2017)\Pre-Bid Documents\IndividualFiles\2016CPT_01_21_L_Rdy.dgn
 rwest AT DICAD265786

09/08/99

CONTRACT NO. : DA00284 WBS ELEMENT : 2016CPT.01.21.20481.1 ETC.



STATE OF NORTH CAROLINA
 DIVISION OF HIGHWAYS

REVISED 1/12/2016

WASHINGTON COUNTY

STATE	STATE PROJECT REFERENCE NO.	SHEET NO.	TOTAL SHEETS
N.C.	2016CPT.01.21.20481.1 ETC.	3	
STATE PROJ. NO.	F.A. PROJ. NO.	DESCRIPTION	

LOCATION: MAP #6 SR-1139 (FROM SR-1136 TO NEW PAVEMENT) MAP #7 - 12 SR-1335 (FROM US 64 TO WASHINGTON STREET)
 MAP #13 SR-1181 (FROM NC 45 TO NC 45)

TYPE OF WORK: MILLING, RESURFACING

MAP # 6 SR 1139

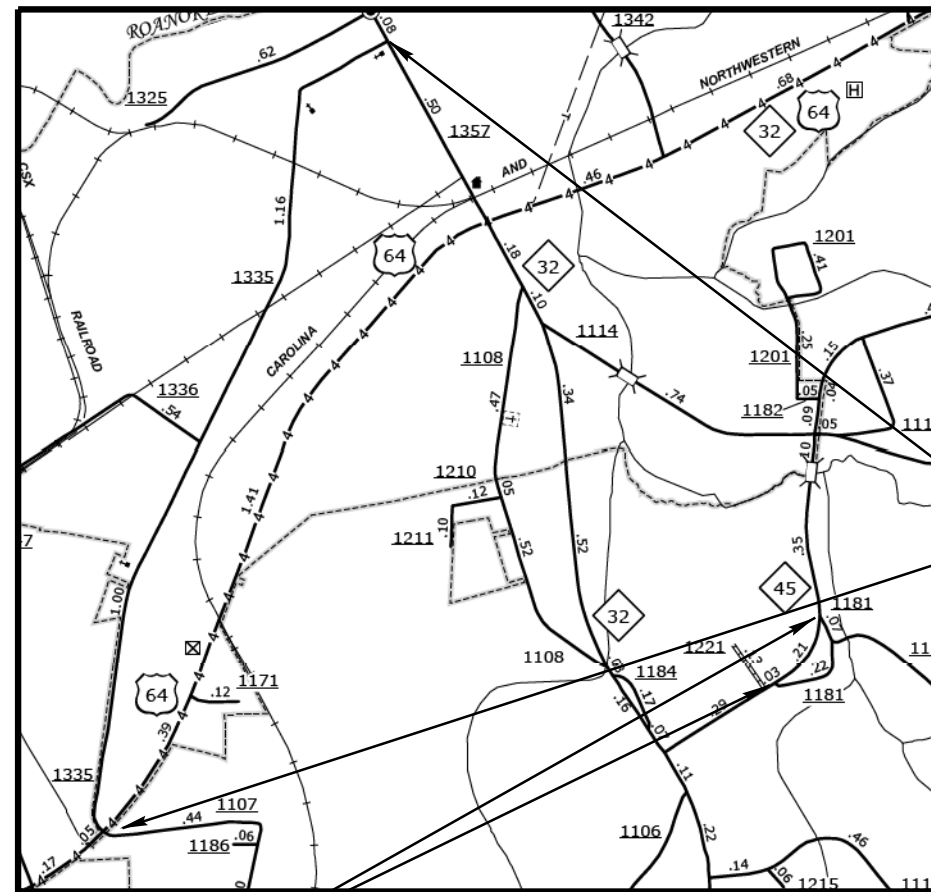
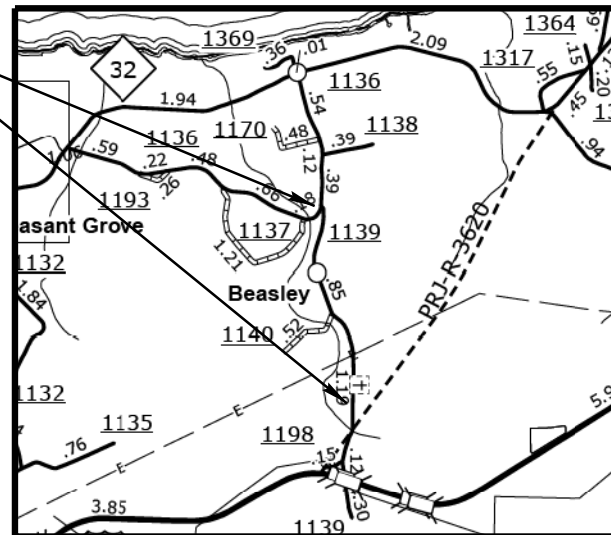

MAP # 7 - 12 SR 1335

MAP # 13 SR 1181

NOT TO SCALE

PROJECT LENGTH

LENGTH OF ROADWAY PROJECT MAP# 6 = 1.10 MILES
 LENGTH OF ROADWAY PROJECT MAP# 7-12 = 1.98 MILES
 LENGTH OF ROADWAY PROJECT MAP# 13 = 0.27 MILES

Prepared in the Office of:
DIVISION OF HIGHWAYS

2012 STANDARD SPECIFICATIONS

LETTING DATE:

W.B. HOBBS, P.E.
 DIVISION PROJECT MANAGER

C.E. SLACHTA
 DIVISION PROPOSALS ENGINEER

DIVISION OF HIGHWAYS
 STATE OF NORTH CAROLINA

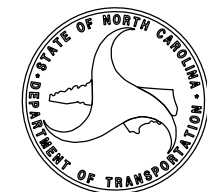

STATE	STATE PROJECT REFERENCE NO.	SHEET NO.	TOTAL SHEETS
N.C.	2016CPT.01.21.20481.1 ETC.	4	
STATE PROJ. NO.	F.A. PROJ. NO.	DESCRIPTION	

STATE OF NORTH CAROLINA REVISED 1/12/2016
 DIVISION OF HIGHWAYS

WASHINGTON COUNTY

LOCATION: MAP #14 - 16 SR-1122 (FROM EAST CL OF ROPER TO PAVEMENT CHANGE)
 MAP #17 SR-1150 (FROM SR 1149 TO SR 1149) MAP #18 SR-1133 (FROM NC 32 TO SR 1132)

TYPE OF WORK: MILLING, RESURFACING

MAP # 14 THRU 16

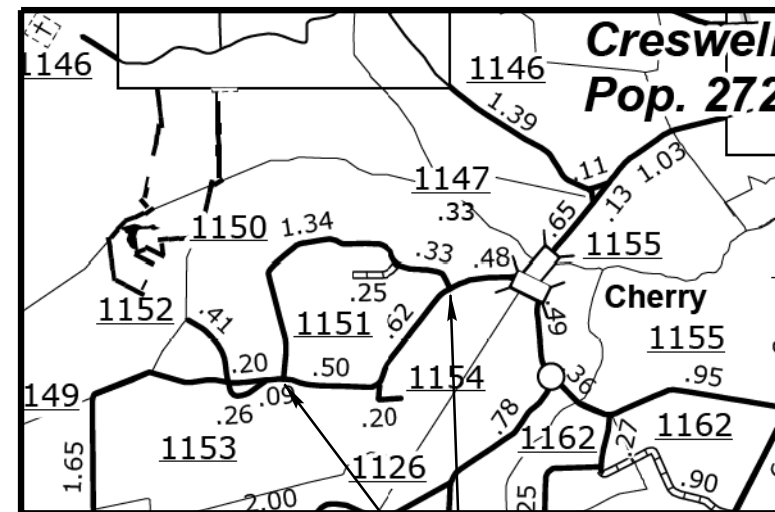
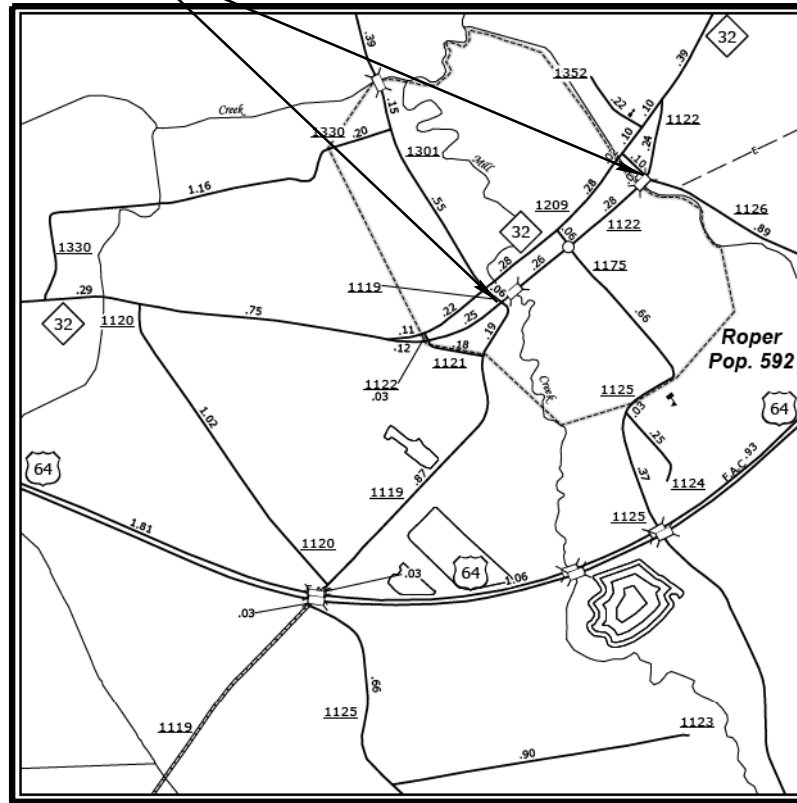

MAP # 17 SR 1150

MAP # 18 SR 1133

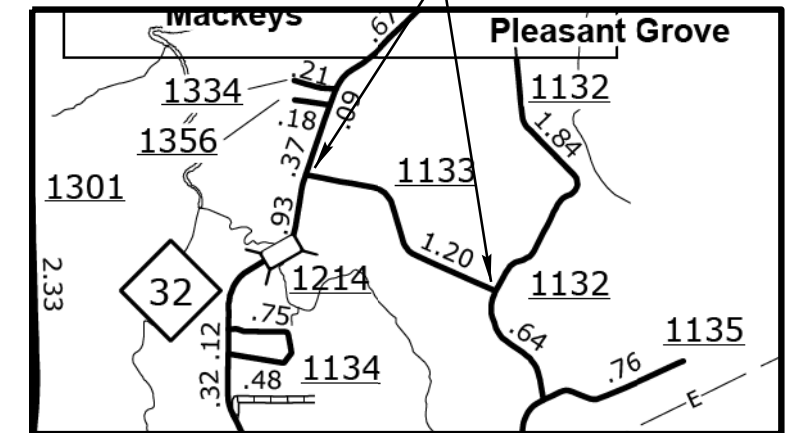

CONTRACT NO.: DA00284 WBS ELEMENT : 2016CPT.01.21.20481.1 ETC.

NOT TO SCALE

PROJECT LENGTH

LENGTH OF ROADWAY PROJECT MAP# 14 - 16 = 0.63 MILES
 LENGTH OF ROADWAY PROJECT MAP# 17 = 1.34 MILES
 LENGTH OF ROADWAY PROJECT MAP# 18 = 1.20 MILES

Prepared in the Office of:
 DIVISION OF HIGHWAYS

2012 STANDARD SPECIFICATIONS

LETTING DATE:

W.B. HOBBS, P.E.
 DIVISION PROJECT MANAGER

C.E. SLACHTA
 DIVISION PROPOSALS ENGINEER

DIVISION OF HIGHWAYS
 STATE OF NORTH CAROLINA

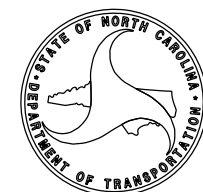

NOTES:

1. ALL PAVED S.R. ROADS TO BE RESURFACED TO THE ENDS OF THE RADII OR AS DIRECTED BY THE ENGINEER
2. EDGES, PAVEMENT WIDENING, INTERSECTIONS, AND BRIDGE FLARES ARE INCLUDED IN THE TABLE OF QUANTITIES
3. SHOULDERS AND DITCHES ARE TO BE CONSTRUCTED BY OTHERS
4. PAVEMENT MARKING TO BE APPLIED BY OTHER

PROJECT REFERENCE NO.	SHEET NO.
2016CPT.01.21.20481.1 ETC.	5

PAVEMENT SCHEDULE	
C1	PROP. APPROX. 1.5" ASPHALT CONCRETE SURFACE COURSE TYPE SF9.5A, AT AN AVERAGE RATE OF 165 LBS. PER SQ.YD.
U	EXISTING PAVEMENT.

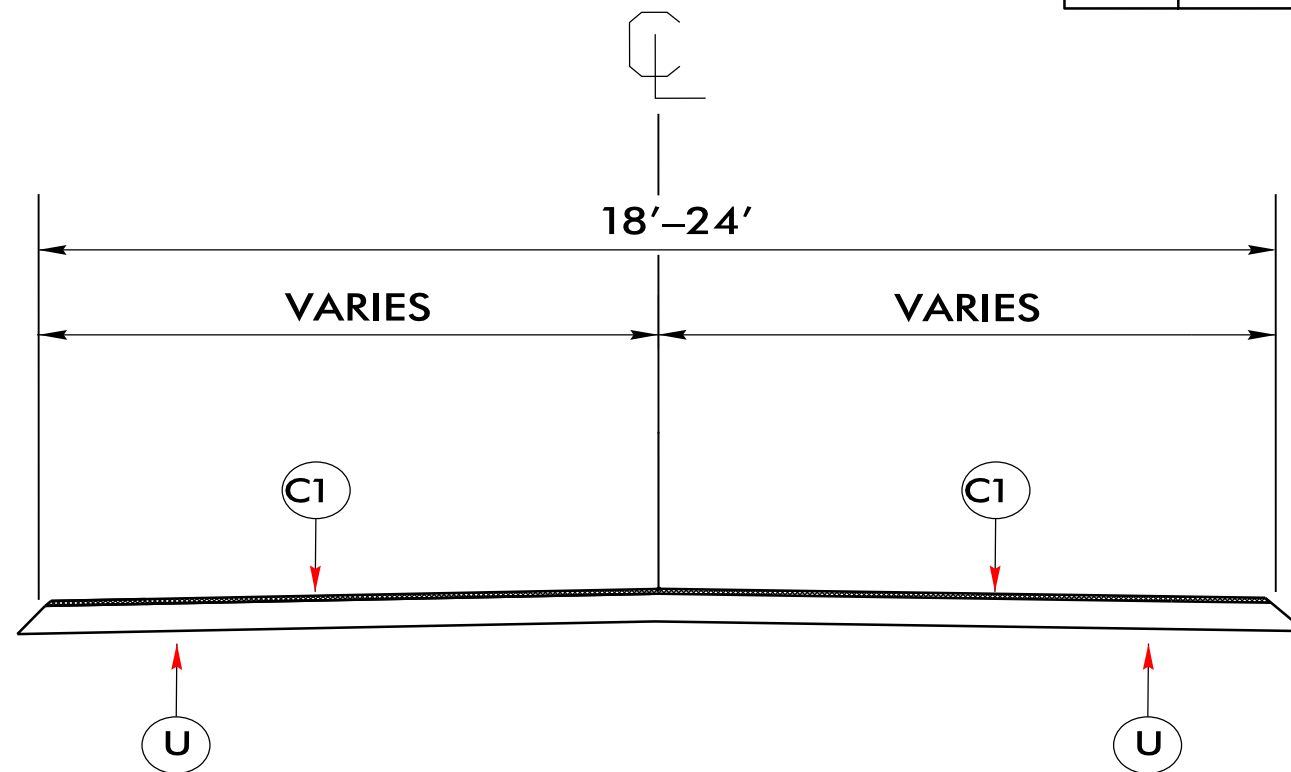

TYPICAL SECTION #1

USE WITH MAP 1, 2, 3, 4, 5, 6, 7, 13, 17 & 18

REVISED 1/12/2016

NOTES:

1. ALL PAVED SERVICE ROADS TO BE MILLED AND RESURFACED TO THE ENDS OF THE RADII OR AS DIRECTED BY THE ENGINEER
2. EDGES, PAVEMENT WIDENING, INTERSECTIONS, AND BRIDGE FLARES ARE INCLUDED IN THE TABLE OF QUANTITIES
3. MILL 1.5" BELOW EXISTING CURB AND GUTTER
4. PAVEMENT MARKING TO BE APPLIED BY OTHERS

PROJECT REFERENCE NO.	SHEET NO.
2016CPT.01.21.20481.1 ETC.	6

PAVEMENT SCHEDULE	
C1	PROP. APPROX. 1.5" ASPHALT CONCRETE SURFACE COURSE TYPE SF9.5A, AT AN AVERAGE RATE OF 165 LBS. PER SQ.YD.
V	MILLING BITUMINOUS PAVEMENT 1.5" DEPTH
U	EXISTING PAVEMENT.

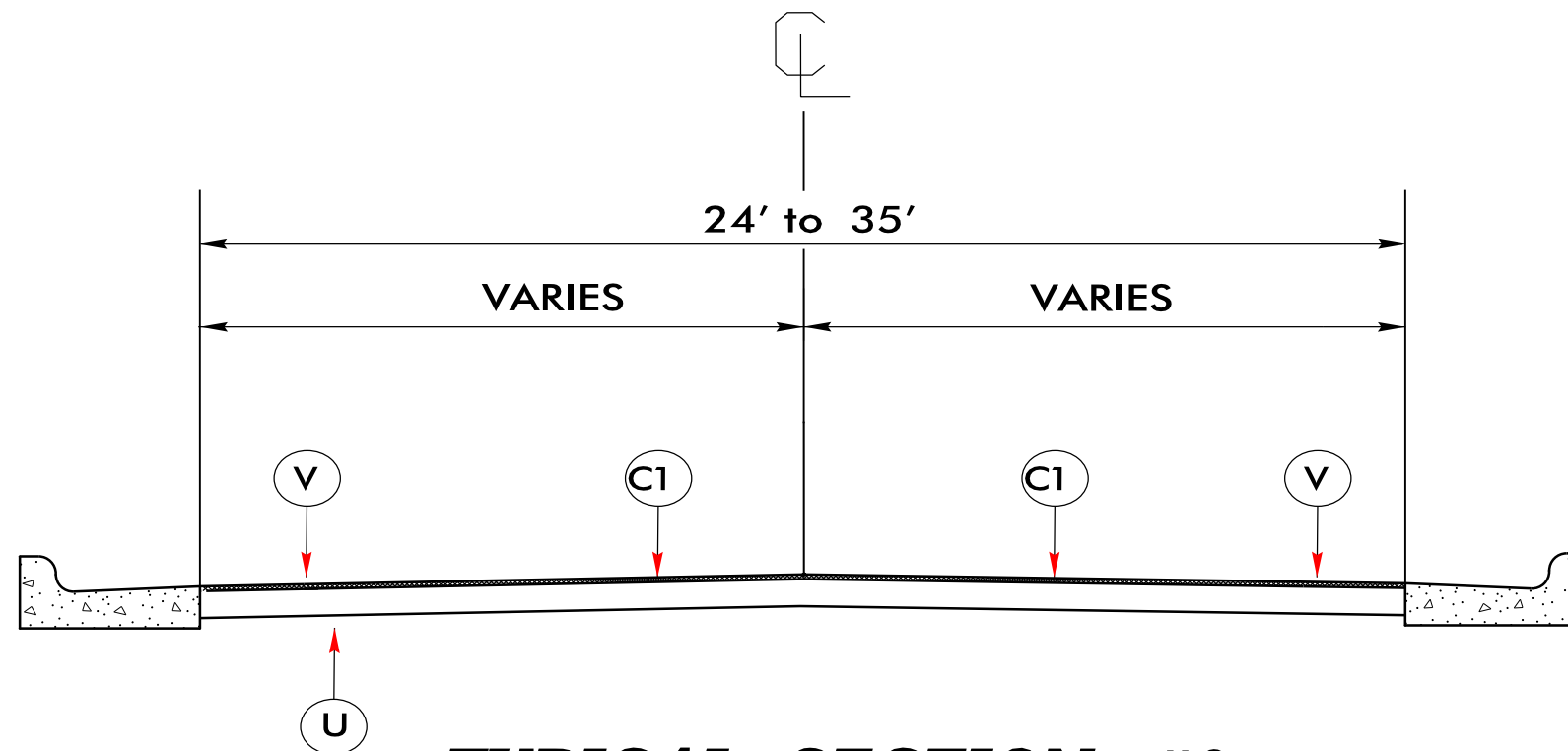

TYPICAL SECTION #2

USE WITH MAP 8, 9, 10, 14, 15 & 16

NOTES:

1. ALL PAVED SERVICE ROADS TO BE MILLED AND RESURFACED TO THE ENDS OF THE RADII OR AS DIRECTED BY THE ENGINEER
2. EDGES, PAVEMENT WIDENING, INTERSECTIONS, AND BRIDGE FLARES ARE INCLUDED IN THE TABLE OF QUANTITIES
3. PAVEMENT EDGE SLOPES ARE 1:1 UNLESS SHOWN OTHERWISE
4. REMOVE ASPHALT FROM EXISTING GUTTER PAN AND REPLACE ASPHALT BACK IN GUTTER
5. PAVEMENT MARKING TO BE APPLIED BY OTHERS

PROJECT REFERENCE NO.	SHEET NO.
2016CPT.01.21.20481.1 ETC.	7

PAVEMENT SCHEDULE	
C1	PROP. APPROX. 1.5" ASPHALT CONCRETE SURFACE COURSE TYPE SF9.5A, AT AN AVERAGE RATE OF 165 LBS. PER SQ.YD.
V	MILLING BITUMINOUS PAVEMENT 1.5" DEPTH
U	EXISTING PAVEMENT.

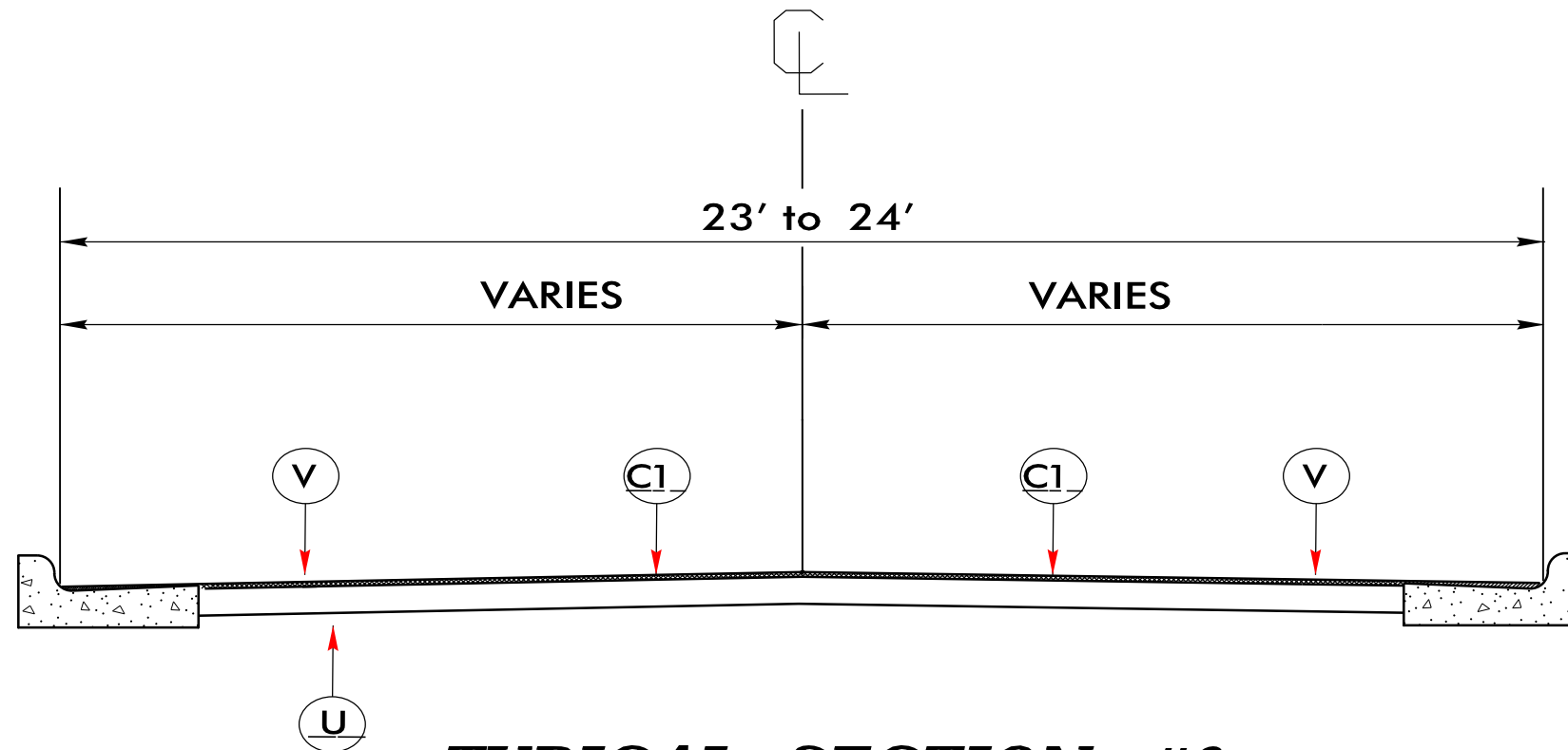

TYPICAL SECTION #3

USE WITH MAP 11 & 12

REVISED 1/12/2016

PROJECT NO.	SHEET NO.	TOTAL NO.
2016CPT.01.21.20481.1, ETC.	8	

SUMMARY OF QUANTITIES

PROJECT NO	COUNTY	MAP	ROUTE	DESCRIPTION	TYP NO	LANES	LANE TYPE	FINAL SURFACE TESTING REQUIRED	WARM MIX ASPHALT REQUIRED	LENGTH MI	WIDTH FT	MOBILIZATION LUMP SUM	1½" MILLING SY	SURFACE COURSE, SF9.5A TONS	ASPHALT BINDER FOR PLANT MIX TONS	2'-6" CURB & GUTTER LF	RETROFIT EXISTING CURB RAMPS EA	ADJ. OF MANHOLES EA	ADJ. OF METER OR VALVE BOX EA	INDUCTIVE LOOP SAWCUT LF	TEMPORARY TRAFFIC CONTROL LUMP SUN
2016CPT.01.21.20481.1	Hyde	1	SR 1139	FROM US 264 TO SR 1141	1	2	2WU	NO	NO	3.88	20	1		4,157	279						1
2016CPT.01.21.20481.1	Hyde	2	SR 1144	FROM SR 1143 TO SR 1145	1	2	2WU	NO	NO	1.13	18	*		1,090	73						*
2016CPT.01.21.20481.1	Hyde	3	SR 1338	FROM NEW PAVEMENT TO DEAD END	1	2	2WU	NO	NO	1.13	20	*		1,211	81						*
2016CPT.01.21.20891.1	Tyrrell	4	SR 1314	FROM SR 1310 TO DEAD END	1	2	2WU	NO	NO	0.5	20	*		536	36						*
2016CPT.01.21.20891.1	Tyrrell	5	SR 1307	FROM NC 94 FOR 3.0 EAST	1	2	2WU	NO	NO	3	20	*		3,214	215						*
2016CPT.01.21.20941.1	Washington	6	SR 1139	FROM SR 1136 TO NEW PAVEMENT	1	2	2WU	NO	NO	1.1	20	*		1,179	79						*
2016CPT.01.21.20941.1	Washington	7	SR 1335 A	FROM US 64 TO BEGIN CURB AND GUTTER	1	2	2WU	NO	NO	1.26	24	*	1,742	1,618	108						*
2016CPT.01.21.20941.1	Washington	8	SR 1335 B	FROM BEGIN CURB AND GUTTER TO RAIL ROAD	2	2	2WU	NO	NO	0.29	32	*	5,988	496	33	150		3	1		*
2016CPT.01.21.20941.1	Washington	9	SR 1335 C	FROM RAIL ROAD TO WEST FOURTH STREET	2	2	2WU	NO	NO	0.09	33	*	1,742	159	11	170		1	1		*
2016CPT.01.21.20941.1	Washington	10	SR 1335 D	FROM WEST FOURTH TO WILSON ST SPUR	2	2	2WU	NO	NO	0.09	28	*	1,596	135	9			1			*
2016CPT.01.21.20941.1	Washington	11	SR 1335 E	FROM WILSON STREET SPUR TO NORTH JEFFERSON ST.	3	2	2WU	NO	NO	0.15	23	*	2,326	185	12			1	3	1,600	*
2016CPT.01.21.20941.1	Washington	12	SR 1335 F	FROM NORTH JEFFERSON STREET TO WASHINGTON STREET	3	2	2WU	NO	NO	0.09	24	*	1,290	116	8			2	1		*
2016CPT.01.21.20941.1	Washington	13	SR 1181	FROM NC 45 TO NC 45	1	2	2WU	NO	NO	0.27	20	*		289	19						*
2016CPT.01.21.20941.1	Washington	14	SR 1122 A	FROM EAST CITY LIMITS OF ROPER TO BRIDGE	2	2	2WU	NO	NO	0.5	31	*	10,000	829	56	240	6	11	6		*
2016CPT.01.21.20941.1	Washington	15	SR 1122 B	FROM BRIDGE TO SR1119	2	2	2WU	NO	NO	0.03	35	*	662	56	4						*
2016CPT.01.21.20941.1	Washington	16	SR 1122 C	FROM SR 1119 TO PAVEMENT CHANGE	2	2	2WU	NO	NO	0.1	30	*	1,980	160	11				1		*
2016CPT.01.21.20941.1	Washington	17	SR 1150	FROM SR 1149 TO SR 1149	1	2	2WU	NO	NO	1.34	20	*		1,436	96						*
2016CPT.01.21.20941.1	Washington	18	SR 1133	FROM NC 32 TO SR 1132	1	2	2WU	NO	NO	1.2	18	*		1,158	78						*
GRAND TOTAL										16.15		1	27,326	18,024	1,208	560	6	19	13	1,600	1