

STATE	STATE PROJECT REFERENCE NO.	SHEET NO.	TOTAL SHEETS
N.C.	2016CPT.01.22.2021I.1 ETC.	1	
STATE PROJ.NO.	F.A.PROJ.NO.	DESCRIPTION	

STATE OF NORTH CAROLINA  
DIVISION OF HIGHWAYS

**CHOWAN COUNTY**

CONTRACT NO.: DA00285 WBS ELEMENT : 2016CPT.01.22.2021I.1 ETC.



LOCATION: MAP #1 SR 1149 ( FROM SR 1148 TO CUL-DE-SAC ) MAP #2 SR 1237 ( FROM SR 1218 TO DEAD END )  
 MAP #3 SR 1205 ( FROM SR 1206 TO SR 1204 ) MAP #4 SR 1211 ( FROM SR 1210 TO SR 1207 ) MAP #5 SR 1315 ( FROM 1303 TO NC 32 )  
 MAP #7 SR 1164 ( FROM SR 1148 TO SR 1149 ) MAP #8 SR 1156 ( FROM SR 1155 TO SR 1159 ) MAP #9 SR 1159 ( FROM SR 1155 TO SR 1155 )  
 SR 1237 MAP # 2 SR 1315 MAP # 5 TYPE OF WORK: RESURFACING

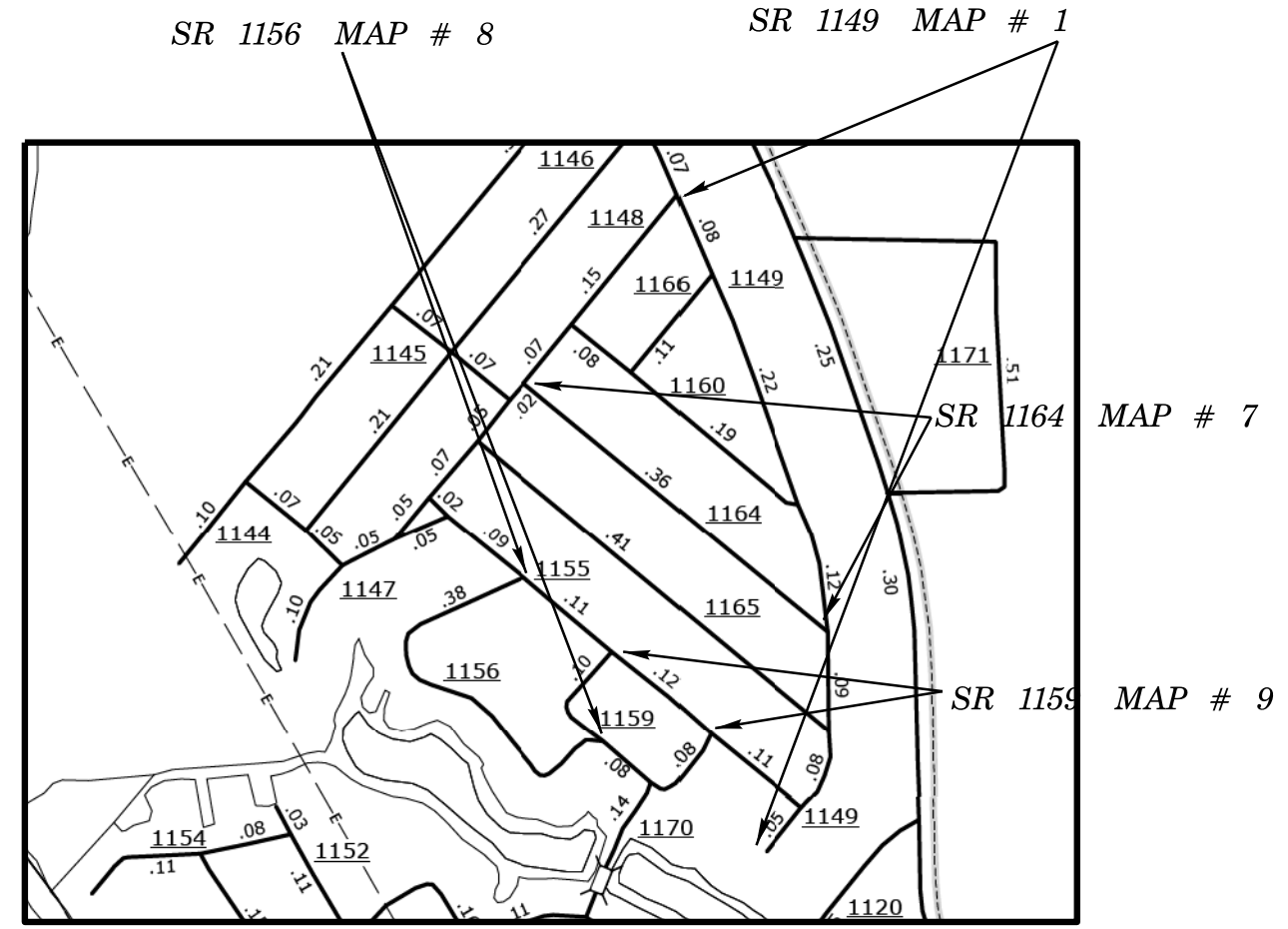
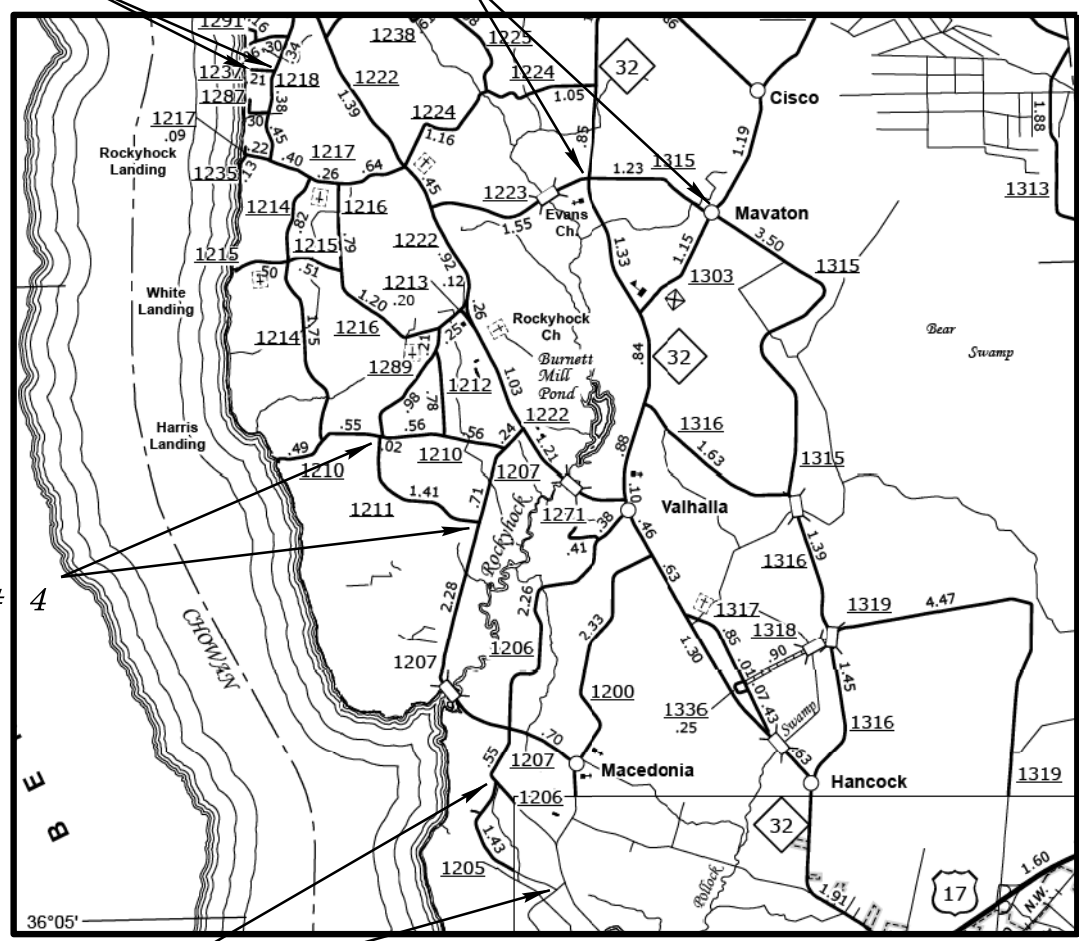

SR 1211 MAP # 4

SR 1205 MAP # 3

NOT TO SCALE

PROJECT LENGTH	
LENGTH OF ROADWAY PROJECT MAP# 1	= 0.64 MILES
LENGTH OF ROADWAY PROJECT MAP# 2	= 0.20 MILES
LENGTH OF ROADWAY PROJECT MAP# 3	= 1.60 MILES
LENGTH OF ROADWAY PROJECT MAP# 4	= 1.40 MILES
LENGTH OF ROADWAY PROJECT MAP# 5	= 1.20 MILES
LENGTH OF ROADWAY PROJECT MAP# 7	= 0.36 MILES
LENGTH OF ROADWAY PROJECT MAP# 8	= 0.38 MILES
LENGTH OF ROADWAY PROJECT MAP# 9	= 0.25 MILES

Prepared in the Office of:  
**DIVISION OF HIGHWAYS**

LETTING DATE:	2012 STANDARD SPECIFICATIONS
	W.B. HOBBS, P.E. DIVISION PROJECT MANAGER
	C.E. SLACHTA DIVISION PROPOSALS ENGINEER

DIVISION OF HIGHWAYS  
STATE OF NORTH CAROLINA

08-DEC-2015 13:31 C:\User\srwest\Desktop\Martin 15-16\16-17 Resurfacing Chowan Martin\2016CPT.01.XX.Rdy\_atn\_Chowan Martin resurfacing.dgn At DICAD265786 srwest

**CONTRACT NO.: DA00285 WBS ELEMENT : 2016CPT.01.22.20211.1 ETC.**



STATE OF NORTH CAROLINA  
DIVISION OF HIGHWAYS

**MARTIN COUNTY**

STATE	STATE PROJECT REFERENCE NO.	SHEET NO.	TOTAL SHEETS
N.C.	2016CPT.01.22.20211.1 ETC.	2	
STATE PROJ. NO.	F.A. PROJ. NO.	DESCRIPTION	

LOCATION: MAP #10 SR 1595 ( FROM SR 1500 TO US 64 ) MAP #11 SR 1556 ( FROM SR 1555 TO DEAD END )  
TYPE OF WORK: RESURFACING

SR 1595 MAP # 10

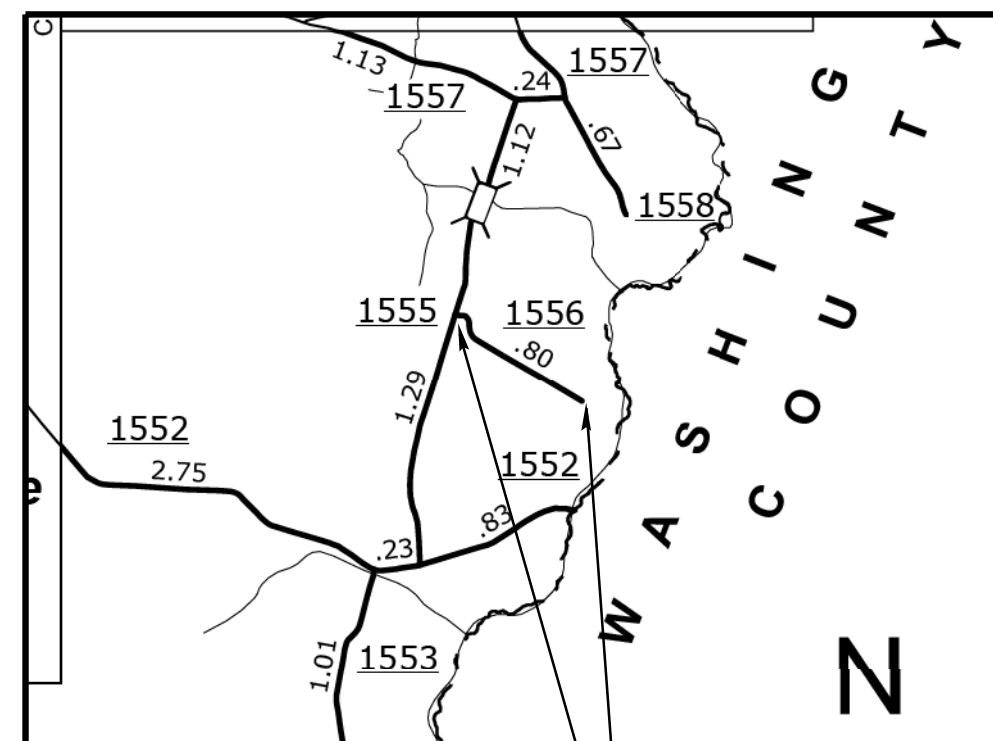
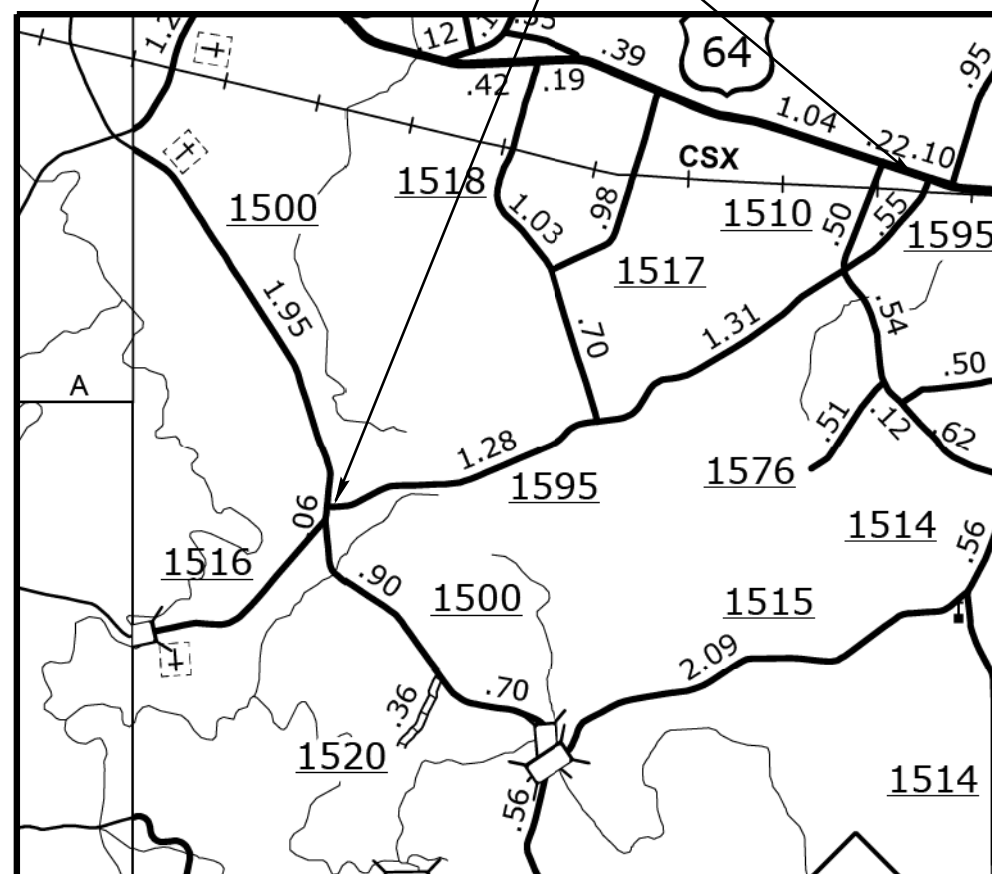

SR 1556 MAP # 11

NOT TO SCALE

**PROJECT LENGTH**

LENGTH OF ROADWAY PROJECT MAP# 10 = 3.15 MILES  
LENGTH OF ROADWAY PROJECT MAP# 11 = 0.18 MILES

Prepared in the Office of:  
**DIVISION OF HIGHWAYS**

2012 STANDARD SPECIFICATIONS

LETTING DATE:

W.B. HOBBS, P.E.  
DIVISION PROJECT MANAGER

C.E. SLACHTA  
DIVISION PROPOSALS ENGINEER

**DIVISION OF HIGHWAYS  
STATE OF NORTH CAROLINA**

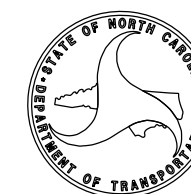

I7-DEC-2015 11:35  
 C:\D\CURRENT\PROJECTS\DIVISION PROJECT WORKING FILES\District Three\DA00285 Chowan & Martin Co. Resurfacing (2016 -2017)\I Pre-Bid Documents\2016CPT.01.XX..Rdy\_atn..Chowan Martin Resurf 09/08/19  
 cslachta AT DICAD28235L

**CONTRACT NO.: DA00285 WBS ELEMENT : 2016CPT.01.22.20211.1 ETC.**



STATE OF NORTH CAROLINA  
 DIVISION OF HIGHWAYS

**MARTIN COUNTY**

**LOCATION: MAP #12 SR 1308 ( FROM SR 1306 TO SR 1305 )**  
**TYPE OF WORK: RESURFACING**

STATE	STATE PROJECT REFERENCE NO.	SHEET NO.	TOTAL SHEETS
N.C.	2016CPT.01.22.20211.1 ETC.	3	
STATE PROJ. NO.	F.A. PROJ. NO.	DESCRIPTION	

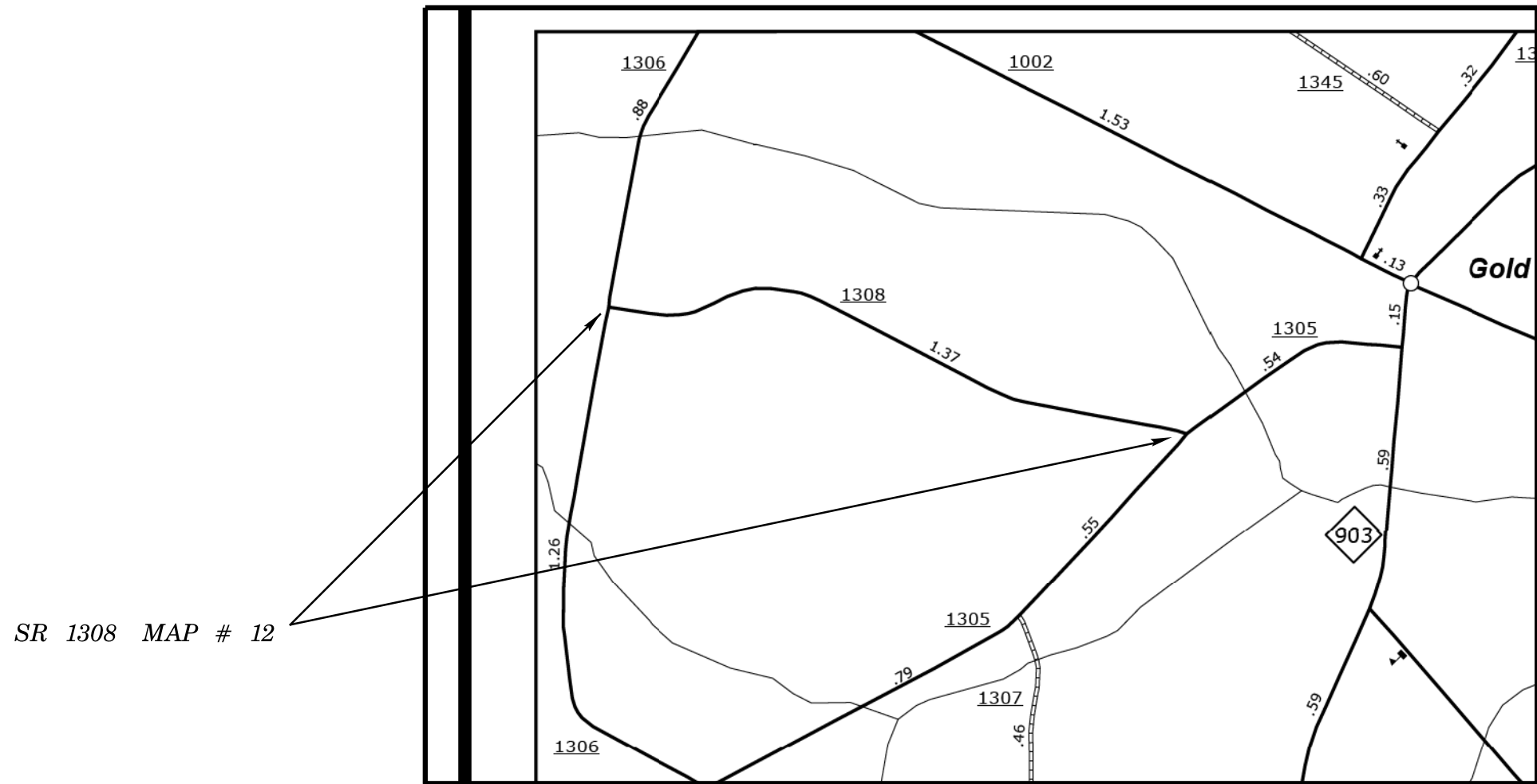

**NOT TO SCALE**

**PROJECT LENGTH**  
 LENGTH OF ROADWAY PROJECT MAP# 12 = 1.35 MILES

Prepared in the Office of:  
**DIVISION OF HIGHWAYS**

2012 STANDARD SPECIFICATIONS	LETTING DATE:
	<div style="text-align: center;"> <p style="font-size: 0.8em;">W.B. HOBBS, P.E. DIVISION PROJECT MANAGER</p> <hr/> <p style="font-size: 0.8em;">C.E. SLACHTA DIVISION PROPOSALS ENGINEER</p> </div>

DIVISION OF HIGHWAYS  
 STATE OF NORTH CAROLINA

I7-DEC-2015 11:39  
 C:\D\CurrrentProjects\DIVISION PROJECT WORKING FILES\District Three\DA00285 Chowan & Martin Co. Resurfacing (2016 -2017)\I Pre-Bid Documents\2016CPT.01.XX..Rdy\_atn..Chowan Martin Resur 09/08/19  
 AT C:\CAD28235L cslachta

**CONTRACT NO. : DA00285 WBS ELEMENT : 2016CPT.01.22.20211.1 ETC.**



STATE OF NORTH CAROLINA  
 DIVISION OF HIGHWAYS  

---

**CHOWAN COUNTY**



---

STATE	STATE PROJECT REFERENCE NO.	SHEET NO.	TOTAL SHEETS
N.C.	2016CPT.01.22.20211.1 ETC.	4	
STATE PROJ. NO.	F.A. PROJ. NO.	DESCRIPTION	

**LOCATION: MAP #6 SR 1101 ( FROM SR 1102 TO NC 37 )**

**TYPE OF WORK: RESURFACING**

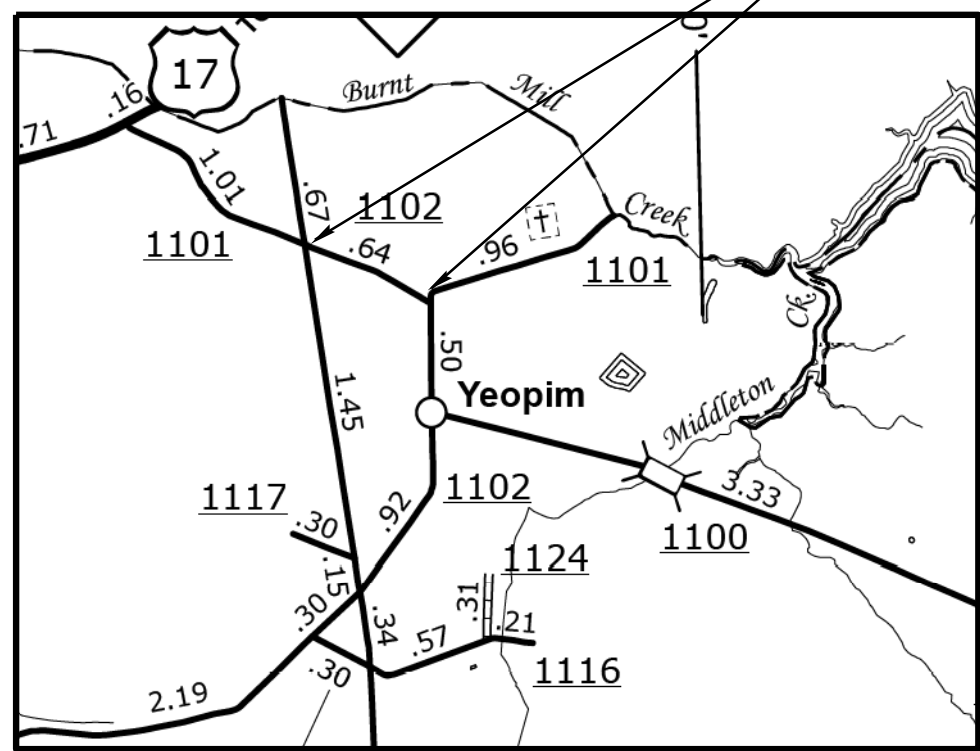
SR 1101 MAP # 6



NOT TO SCALE

**PROJECT LENGTH**  
 LENGTH OF ROADWAY PROJECT MAP# 6 = 0.64 MILES

Prepared in the Office of:  
**DIVISION OF HIGHWAYS**

2012 STANDARD SPECIFICATIONS	
LETTING DATE: _____	W.B. HOBBS, P.E. DIVISION PROJECT MANAGER
	C.E. SLACHTA DIVISION PROPOSALS ENGINEER

DIVISION OF HIGHWAYS  
 STATE OF NORTH CAROLINA

NOTES:

1. ALL PAVED S.R. ROADS TO BE RESURFACED TO THE ENDS OF THE RADII OR AS DIRECTED BY THE ENGINEER
2. EDGES, PAVEMENT WIDENING, INTERSECTIONS, AND BRIDGE FLARES ARE INCLUDED IN THE TABLE OF QUANTITIES
3. SHOULDERS AND DITCHES ARE TO BE CONSTRUCTED BY OTHERS
4. PAVEMENT MARKING TO BE APPLIED BY OTHER

PROJECT REFERENCE NO.	SHEET NO.
2016CPT.01.22.20211.1 ETC.	5

PAVEMENT SCHEDULE	
C1	PROP. APPROX. 1.5" ASPHALT CONCRETE SURFACE COURSE TYPE SF9.5A, AT AN AVERAGE RATE OF 165 LBS. PER SQ.YD.
U	EXISTING PAVEMENT.

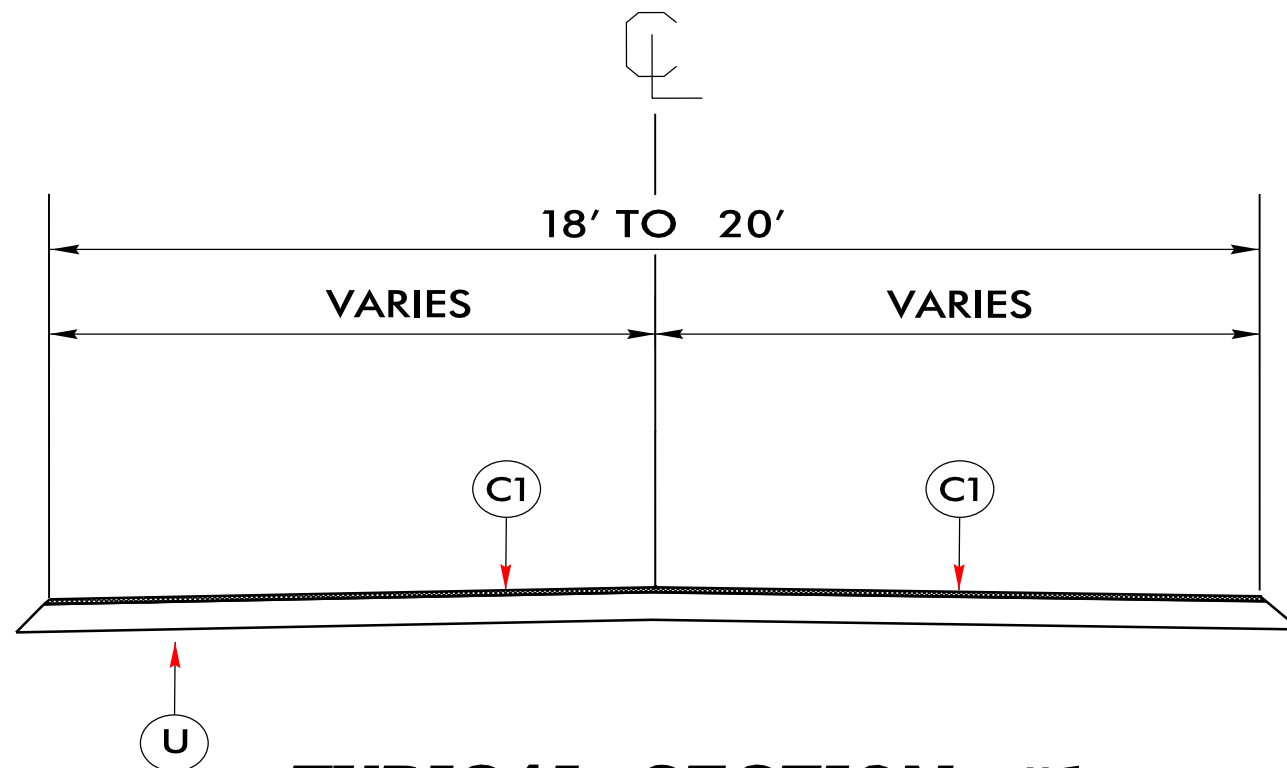

***TYPICAL SECTION #1***

USE WITH MAP 1 - 12

PROJECT NO.	SHEET NO.	TOTAL NO.
2016CPT.01.22.20211.1, ETC.	6	

### SUMMARY OF QUANTITIES

PROJECT NO	COUNTY	MAP NO	ROUTE	DESCRIPTION	TYP NO	LANES	LANE TYPE	FINAL SURFACE TESTING REQUIRED	WARM MIX ASPHALT REQUIRED	LENGTH MI	WIDTH FT	MOBILIZATION LUMP SUM	SURFACE COURSE, SF9.5A TONS	ASPHALT BINDER FOR PLANT MIX TONS	TEMPORARY TRAFFIC CONTROL LUMP SUM
2016CPT.01.22.20211.1	Chowan	1	SR 1149	FROM SR 1148 TO CUL-DE- SAC	1	2	2WU	NO	NO	0.64	20	1	686	46	1
2016CPT.01.22.20211.1	Chowan	2	SR 1237	FROM SR 1218 TO DEAD END	1	2	2WU	NO	NO	0.2	18	*	211	14	*
2016CPT.01.22.20211.1	Chowan	3	SR 1205	FROM SR 1206 TO SR 1204	1	2	2WU	NO	NO	1.6	18	*	1,656	111	*
2016CPT.01.22.20211.1	Chowan	4	SR 1211	FROM SR 1210 TO SR 1207	1	2	2WU	NO	NO	1.4	18	*	1,351	91	*
2016CPT.01.22.20211.1	Chowan	5	SR 1315	FROM SR 1303 TO NC 32	1	2	2WU	NO	NO	1.2	20	*	1,286	86	*
2016CPT.01.22.20211.1	Chowan	6	SR 1101	FROM SR 1102 TO NC 37	1	2	2WU	NO	NO	0.64	20	*	686	46	*
2016CPT.01.22.20211.1	Chowan	7	SR 1164	FROM SR 1148 TO SR 1149	1	2	2WU	NO	NO	0.36	20	*	386	26	*
2016CPT.01.22.20211.1	Chowan	8	SR 1156	FROM SR 1155 TO SR 1159	1	2	2WU	NO	NO	0.38	18	*	367	25	*
2016CPT.01.22.20211.1	Chowan	9	SR 1159	FROM SR 1155 TO 1155	1	2	2WU	NO	NO	0.25	20	*	268	18	*
2016CPT.01.22.20581.1	Martin	10	SR 1595	FROM US 64 TO SR 1500	1	2	2WU	NO	NO	3.15	20	*	3,375	226	*
2016CPT.01.22.20581.1	Martin	11	SR 1556	FROM SR 1555 TO DEAD END	1	2	2WU	NO	NO	0.18	18	*	174	12	*
2016CPT.01.22.20581.1	Martin	12	SR 1308	FROM SR 1306 TO SR 1305	1	2	2WU	NO	NO	1.35	20	*	1,446	97	*
GRAND TOTAL										11.35		1	11,892	798	1

- NOTES:
- 1) DETAIL DOES NOT APPLY TO OGAFD AND ULTRA-THIN BONDED WEARING COURSE.
  - 2) BACKFILL SHOULDER WITH APPROVED MATERIAL.
  - 3) THE SHOULDER WEDGE DEVICE MAY BE DISENGAGED AT PAVED DRIVEWAYS AND SIDE STREETS.

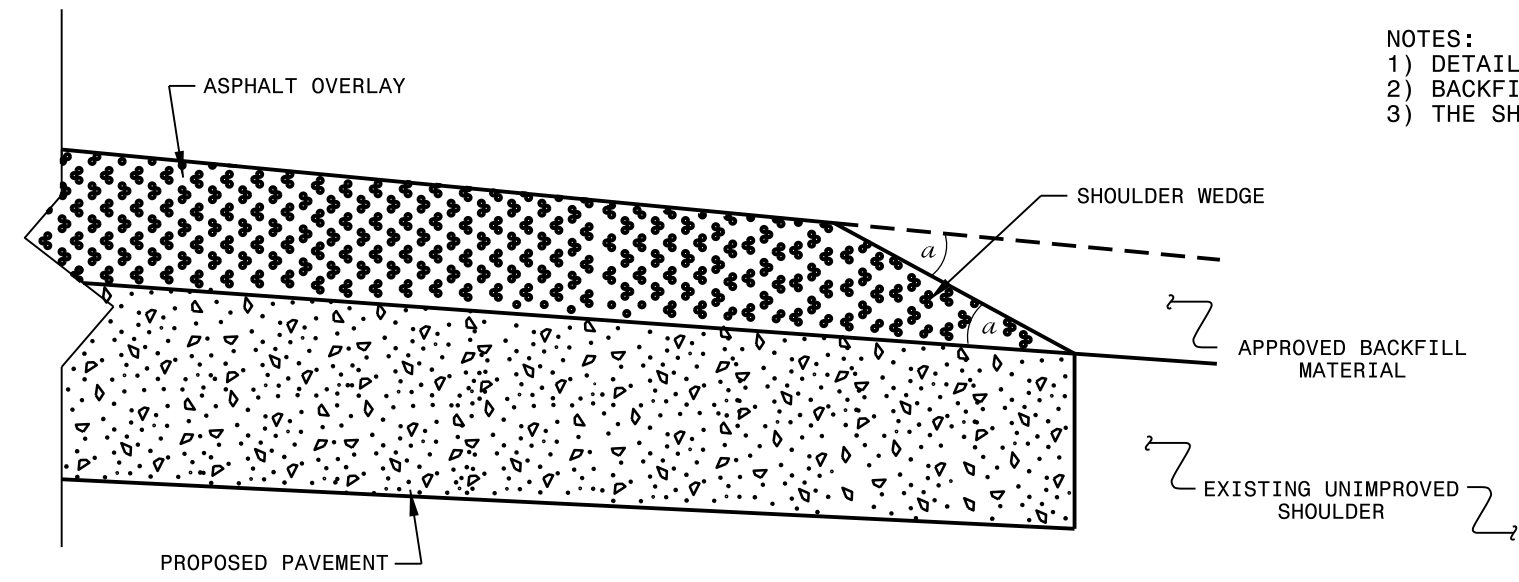

**SHOULDER WEDGE DETAIL**  
 (Resurfacing Projects w/ Widening or  
 with Existing Paved Shoulder having no dropoffs)

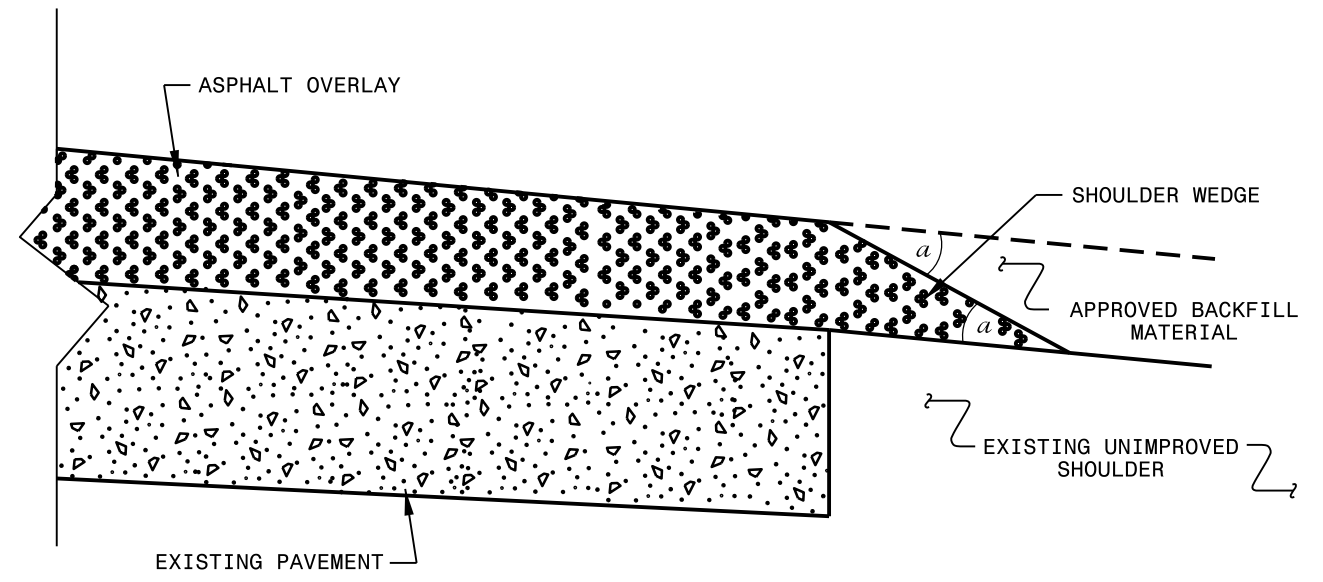

**SHOULDER WEDGE DETAIL**  
 (Resurfacing Projects w/ NO Widening)

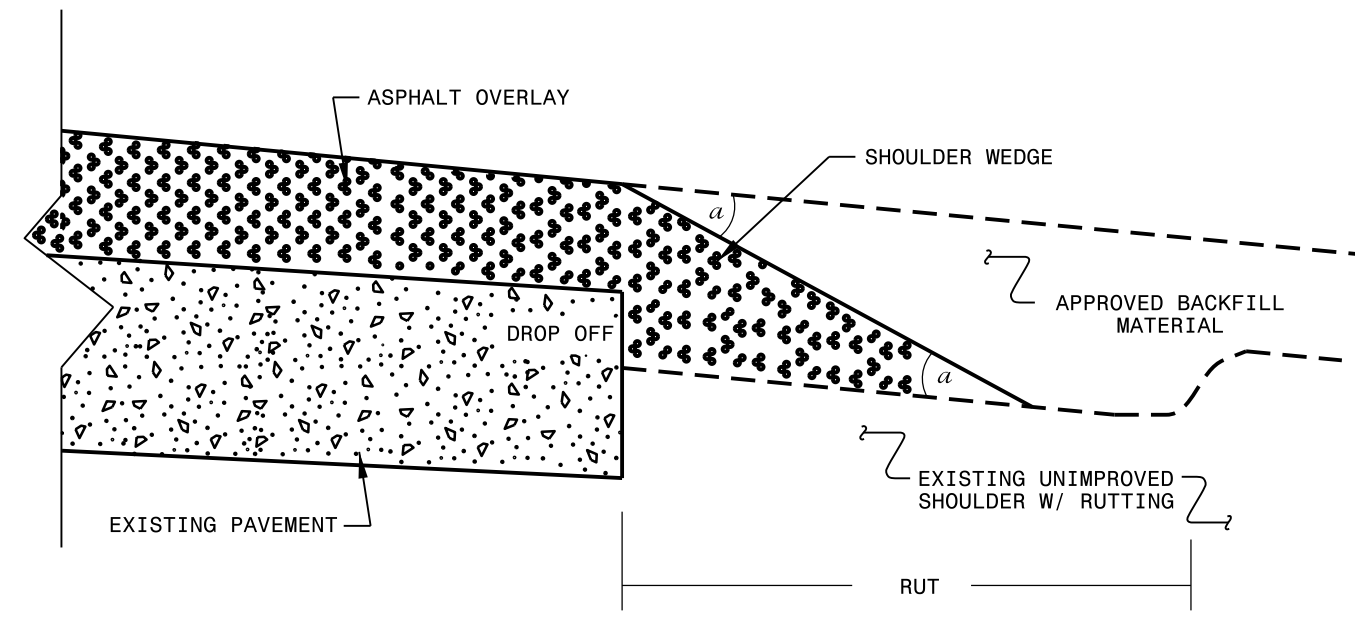

**SHOULDER WEDGE DETAIL**  
 (Resurfacing Adjacent to  
 Rutted Shoulder)

- SHOULDER WEDGE ANGLE = 30°

CONTRACT STANDARDS  
 AND DEVELOPMENT UNIT  
 Office 919-707-6950 FAX 919-250-4119

**SHOULDER WEDGE  
 DETAILS**

ORIGINAL BY: T.SPELL DATE: 7-19-11  
 MODIFIED BY: DATE: 10/16/12  
 CHECKED BY: DATE:  
 FILE SPEC.: susr/details/stand/shoulderwedgedetail.dgn

SYSTEMS DESIGN  
 USER NAME

## SIGNING FOR RESURFACING PROJECTS

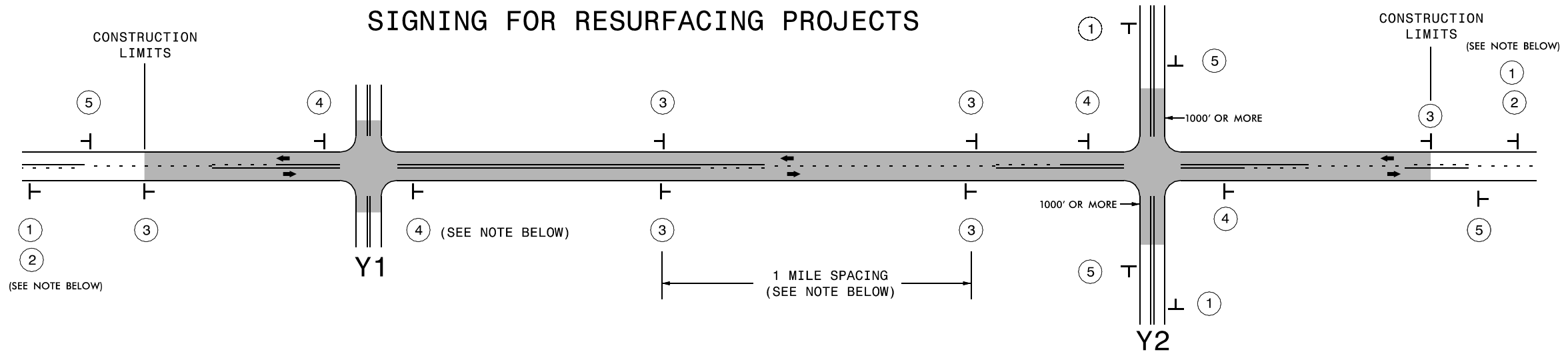

LEGEND	
┃	STATIONARY SIGN
←	DIRECTION OF TRAFFIC FLOW

### MAINLINE (-L-) SIGNING

### -Y- LINE SIGNING

SIGNING NOTES AND PLACEMENT PER DIRECTION	MAINLINE (-L-) SIGNING		-Y- LINE SIGNING	
	①	 <small>W20-1 48" X 48"</small>	<p>PLACE 1000' PRIOR TO BEGINNING OF CONSTRUCTION LIMITS. ONLY USED ON -Y- LINES IF RESURFACING LIMITS EXTEND 1000' ALONG -Y- LINE.</p>	
	②	 <small>W7-3aP 24" X 18"</small>	<p>#2 SIGN ONLY USED WHEN RESURFACING LIMITS ARE 2 OR MORE MILES IN LENGTH. ROUND UP TO NEXT WHOLE NUMBER. (NO FRACTIONAL OR DECIMAL NUMBERS)</p>	
	③	 <small>SP 13107 48" X 48"</small>	<p>PLACE INITIALLY AT THE CONSTRUCTION LIMITS AND SPACED 1 MILE APART THEREAFTER. IF NO -Y- LINES EXIST, PLACE 2ND SET 1/2 MILE FROM THE CONSTRUCTION LIMITS AND THEN SPACE 1 MILE THEREAFTER.</p>	
	④	 <small>SP 13106 48" X 48"</small>	<p>THESE ARE FOR -Y- LINES THAT ARE "THROUGH" ROADWAYS. DEAD END AND SUBDIVISION ROADS ARE NOT "THROUGH" ROADWAYS. INSTALL 500' +/- FROM EACH -Y- LINE APPROACH AS SHOWN ABOVE. FOR MULTIPLE -Y- LINES THAT ARE SEPARATED BY 0.25 MILES OR LESS, TREAT AS A SINGLE UNIT AND INSTALL WITHIN 500' OF EACH APPROACH. A MAXIMUM OF 2 SIGN SETS PER MILE. DO NOT INSTALL WHEN -Y- LINES ARE WITHIN 0.5 MILES FROM "END ROAD WORK" SIGN.</p>	
⑤	 <small>G20-2 A 48" X 24"</small>	<p>PLACE 500' FOLLOWING THE END OF CONSTRUCTION LIMITS.</p>		
		<p>NO REQUIRED STATIONARY SIGNING FOR THE FOLLOWING -Y- LINE CONDITIONS:</p> <ol style="list-style-type: none"> <li>1) LESS THAN 1000' OF RESURFACING ALONG -Y- LINE</li> <li>2) SUBDIVISION ROADS</li> <li>3) DEAD END ROADS</li> </ol> <p>WHEN PAVING/CONSTRUCTION ACTIVITIES PROCEED ACROSS AN UNSIGNED -Y- LINE, ADVANCE WARNING PORTABLE SIGNS SHALL BE USED ALONG THE -Y- LINE AS SHOWN BELOW. REMOVE UPON COMPLETION OF WORK.</p>		
		 <small>W20-1 48" X 48"</small>	 <small>W20-7 A 48" X 48"</small>	
		<p>PLACED 500' IN ADVANCE OF FLAGGER. PLACED 250' IN ADVANCE OF FLAGGER.</p>		

8/8/2013 S:\T\U\WZTC\Resurfacing\2013\Documents\New\_Pr ocedures\_05\_09\_2013\Resurfacing\_AdvWarn\_2Ln.dgn User:frmgarr.ett

**RESURFACING  
ADVANCE WARNING SIGNS  
FOR  
RURAL AND SUBURBAN  
2 LANE ROADWAYS**