

CONTRACT: DA00444 WBS PROJECT: 2019CPT.01.13.20082.1, ETC.

STATE OF NORTH CAROLINA
DIVISION OF HIGHWAYS

BERTIE COUNTY

STATE	STATE PROJECT REFERENCE NO.	SHEET NO.	TOTAL SHEETS
N.C.	2019CPT.01.13.20082.1, ETC.	1	
STATE PROJ. NO.	P.A. PROJ. NO.	DESCRIPTION	
2019CPT.01.13.20082.1		MAPS 1-8	



LOCATION:

<p>MAP 1 SR 1323 FROM DEAD END TO SR 1002 MAP 2 SR 1329 FROM SR 1002 TO CURB & GUTTER MAP 3 SR 1330 FROM SR 1331 TO SR 1329 MAP 4 SR 1331 FROM DEAD END TO HERTFORD CO.</p>	<p>MAP 5 SR 1350 FROM SR 1346 TO SR 1348 MAP 6 SR 1356 FROM SR 1355 TO NC 45 MAP 7 SR 1359 FROM DEAD END TO SR 1355 MAP 8 SR 1387 FROM SR 1355 TO SR 1346</p>
------------------------------------------------------------------------------------------------------------------------------------------------------------------------------------------------------------------------	------------------------------------------------------------------------------------------------------------------------------------------------------------------------------------------------------

TYPE OF WORK: ASPHALT SURFACE TREATMENT

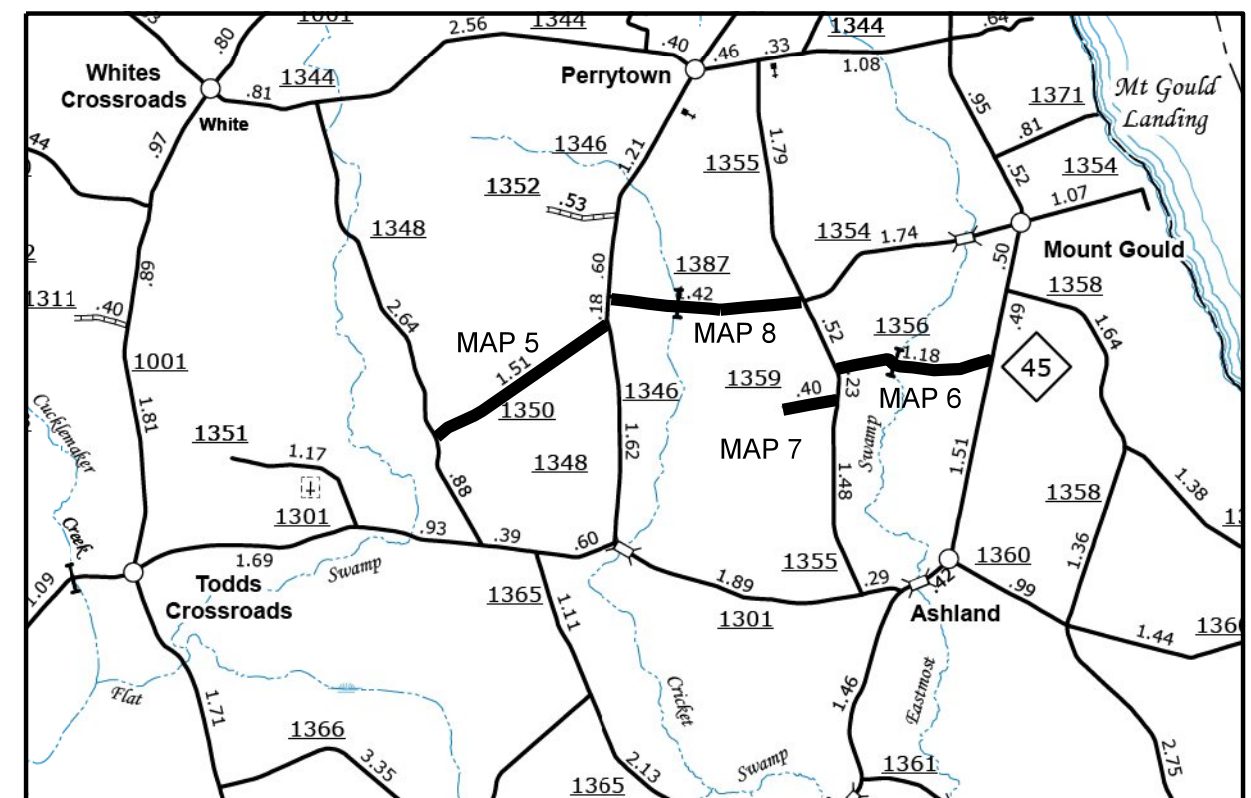
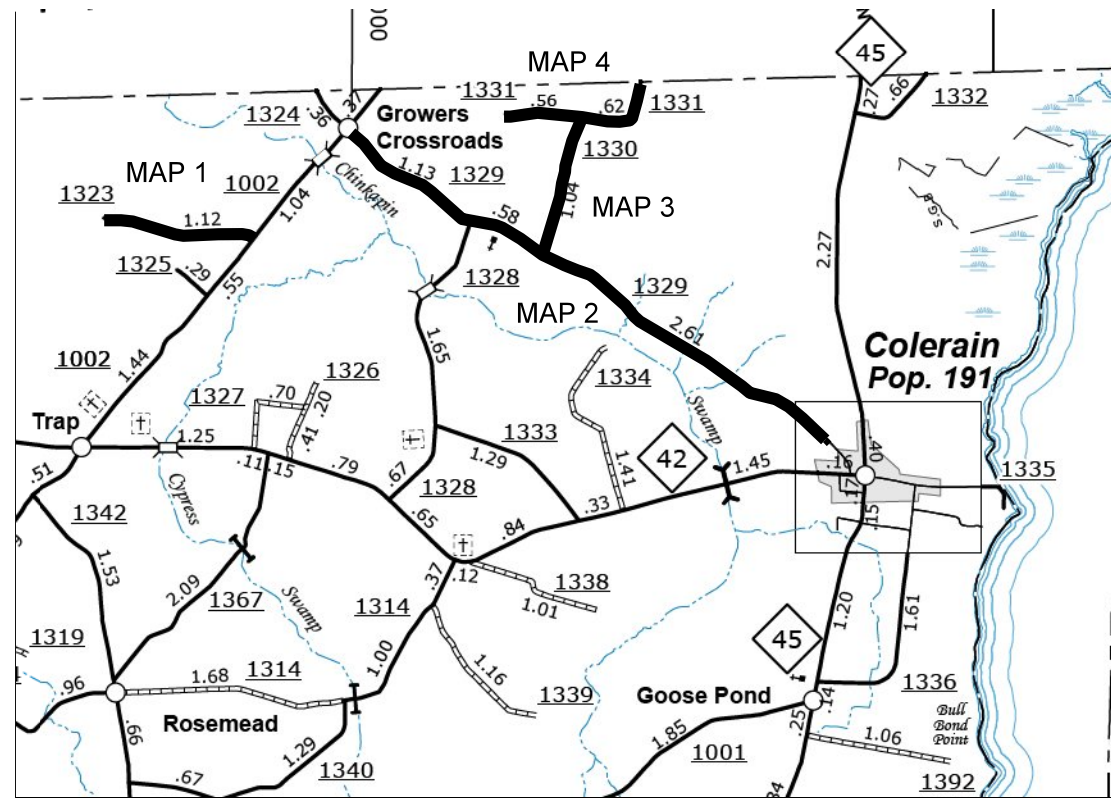

NTS

PROJECT LENGTH

LENGTH OF ROADWAY PROJECT MAP 1 = 1.10 MI.
 LENGTH OF ROADWAY PROJECT MAP 2 = 4.28 MI.
 LENGTH OF ROADWAY PROJECT MAP 3 = 1.03 MI.
 LENGTH OF ROADWAY PROJECT MAP 4 = 1.16 MI.
 LENGTH OF ROADWAY PROJECT MAP 5 = 1.49 MI.
 LENGTH OF ROADWAY PROJECT MAP 6 = 1.16 MI.
 LENGTH OF ROADWAY PROJECT MAP 7 = 0.38 MI.
 LENGTH OF ROADWAY PROJECT MAP 8 = 1.40 MI.

Prepared in the Office of:
DIVISION OF HIGHWAYS
113 Airport Dr., Edenton NC, 27932

2018 STANDARD SPECIFICATIONS

<p>S. P. FENWICK, PLS DIVISION DESIGN ENGINEER</p>	<p style="text-align: center;">W.B. HOBBS, P.E. DIVISION PROJECT TEAM LEAD</p> <hr/> <p style="text-align: center;">C.E. SLACHTA DIVISION PROPOSALS ENGINEER</p>
---------------------------------------------------------------	----------------------------------------------------------------------------------------------------------------------------------------------------------------------------------------

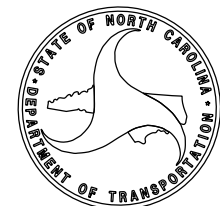

CONTRACT: DA00444 WBS PROJECT: 2019CPT.01.13.20082.1, ETC.

STATE OF NORTH CAROLINA
DIVISION OF HIGHWAYS

HERTFORD COUNTY

STATE	STATE PROJECT REFERENCE NO.	SHEET NO.	TOTAL SHEETS
N.C.	2019CPT.01.13.20082.1, ETC.	2	
STATE PROJ. NO.	F.A. PROJ. NO.	DESCRIPTION	
2019CPT.01.13.20462.1		MAPS 9-15	

LOCATION:

MAP 9 SR 1429 FROM DEAD END TO SR 1427 MAP 10 SR 1435 FROM BERTIE CO. TO SR 1434 MAP 11 SR 1436 FROM SR 1434 TO SR 1437 MAP 12 SR 1441 FROM BRIDGE #42 TO NC 45	MAP 13 SR 1443 FROM SR 1471 TO NC 45 MAP 14 SR 1446 FROM SR 1427 TO NC 45 MAP 15 SR 1471 FROM DEAD END TO SR 1445
--------------------------------------------------------------------------------------------------------------------------------------------------------------------------	-------------------------------------------------------------------------------------------------------------------------

TYPE OF WORK: ASPHALT SURFACE TREATMENT

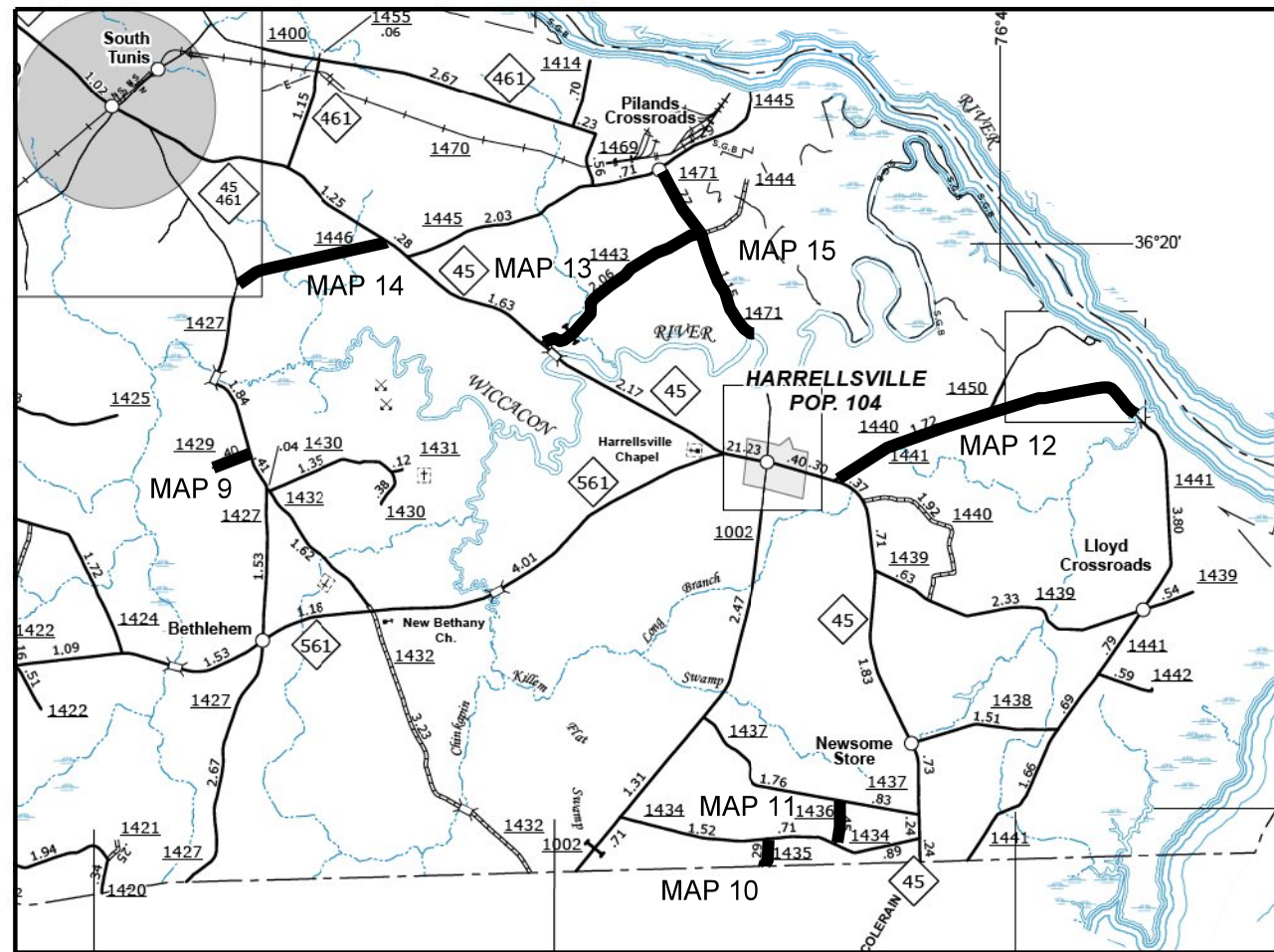

NTS

PROJECT LENGTH

LENGTH OF ROADWAY PROJECT MAP 9 = 0.47 MI.
 LENGTH OF ROADWAY PROJECT MAP 10 = 0.38 MI.
 LENGTH OF ROADWAY PROJECT MAP 11 = 0.41 MI.
 LENGTH OF ROADWAY PROJECT MAP 12 = 3.27 MI.
 LENGTH OF ROADWAY PROJECT MAP 13 = 2.02 MI.
 LENGTH OF ROADWAY PROJECT MAP 14 = 1.58 MI.
 LENGTH OF ROADWAY PROJECT MAP 15 = 1.90 MI.

Prepared in the Office of:
DIVISION OF HIGHWAYS

113 Airport Dr., Edenton NC, 27932

2018 STANDARD SPECIFICATIONS

S. P. FENWICK, PLS
DIVISION DESIGN ENGINEER

W.B. HOBBS, P.E.
DIVISION PROJECT TEAM LEAD

C.E. SLACHTA
DIVISION PROPOSALS ENGINEER

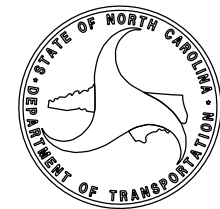

CONTRACT: DA00444 WBS PROJECT: 2019CPT.01.13.20082.1, ETC.

STATE OF NORTH CAROLINA
DIVISION OF HIGHWAYS

STATE	STATE PROJECT REFERENCE NO.	SHEET NO.	TOTAL SHEETS
N.C.	2019CPT.01.13.20082.1, ETC.	3	
STATE PROJ. NO.	F.A. PROJ. NO.	DESCRIPTION	
2019CPT.01.13.20662.1		MAPS 16-23	

NORTHAMPTON COUNTY



LOCATION: MAP 16 SR 1537 FROM US 158 TO SR 1536
 MAP 17 SR 1355 FROM SR 1351 TO HERTFORD CO.
 MAP 18 SR 1354 FROM SR 1351 TO DEAD END
 MAP 19 SR 1362 FROM SR 1360 TO SR 1364
 MAP 20 SR 1363 FROM HERTFORD CO. TO SR 1364
 MAP 21 SR 1364 FROM US 158 TO DEAD END
 MAP 22 SR 1544 FROM SR 1543 TO SR 1536
 MAP 23 SR 1538 FROM SR 1537 TO US 258

TYPE OF WORK: ASPHALT SURFACE TREATMENT

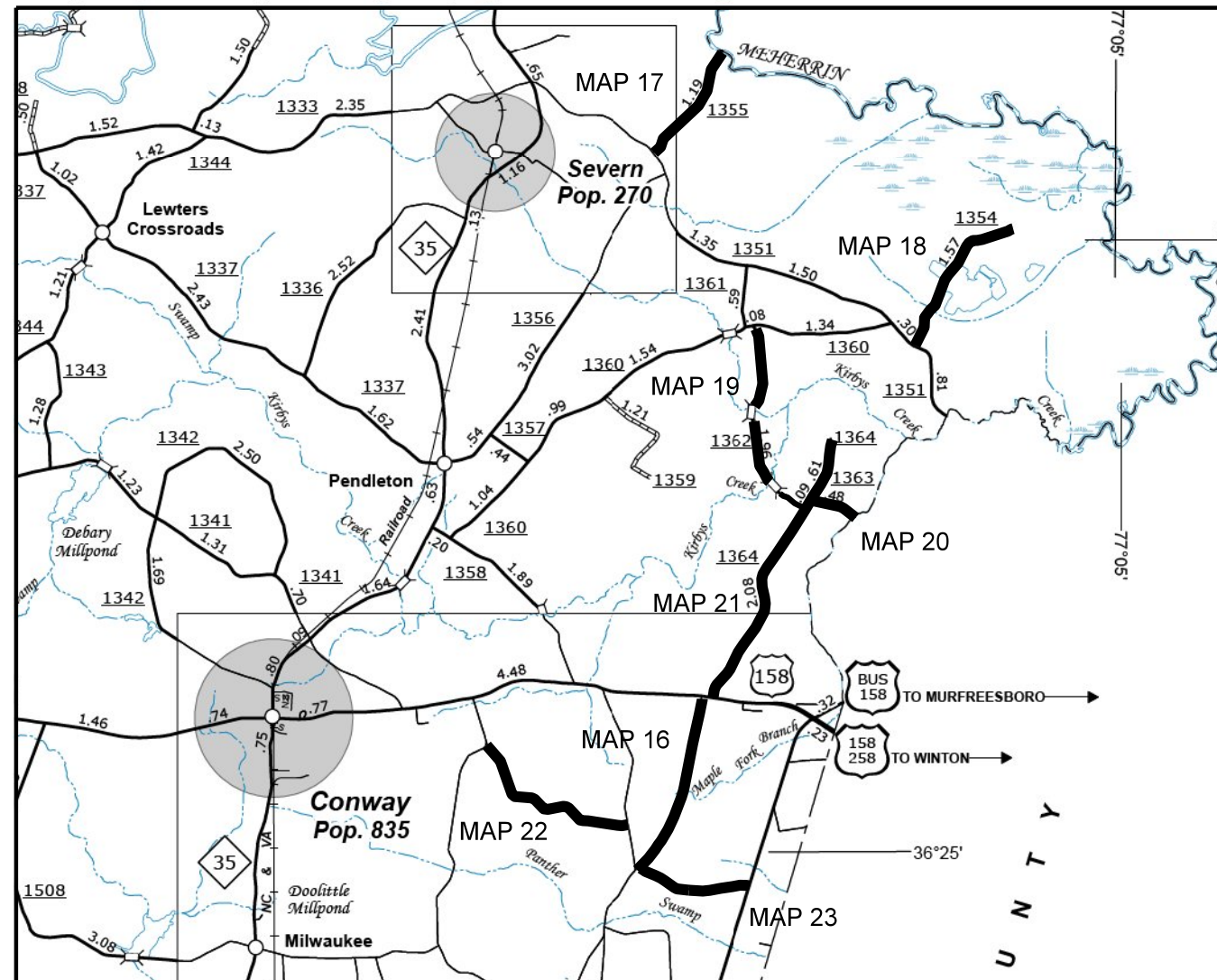

NTS

PROJECT LENGTH

LENGTH OF ROADWAY PROJECT MAP 16 = 1.80 MI.
 LENGTH OF ROADWAY PROJECT MAP 17 = 1.19 MI.
 LENGTH OF ROADWAY PROJECT MAP 18 = 1.57 MI.
 LENGTH OF ROADWAY PROJECT MAP 19 = 1.96 MI.
 LENGTH OF ROADWAY PROJECT MAP 20 = 0.48 MI.
 LENGTH OF ROADWAY PROJECT MAP 21 = 2.78 MI.
 LENGTH OF ROADWAY PROJECT MAP 22 = 1.76 MI.
 LENGTH OF ROADWAY PROJECT MAP 23 = 1.12 MI.

Prepared in the Office of:
DIVISION OF HIGHWAYS

113 Airport Dr., Edenton NC, 27932

2018 STANDARD SPECIFICATIONS

S. P. FENWICK, PLS
DIVISION DESIGN ENGINEER

W.B. HOBBS, P.E.
DIVISION PROJECT TEAM LEAD

C.E. SLACHTA
DIVISION PROPOSALS ENGINEER

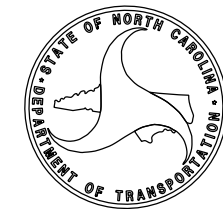

NOTES:

*ALL PAVED S.R. ROADS TO BE TREATED TO THE ENDS OF THE RADII.,
OR AS DIRECTED BY THE ENGINEER

*PAVEMENT MARKINGS TO BE PERFORMED BY OTHERS

*ASPHALT SURFACE TREATMENT, DOUBLE SEAL CONSISTS OF TWO LAYERS OF TREATMENT:

BOTTOM LAYER CONSISTS OF EMULSIFIED ASPHALT, GRADE CRS-2L AT A RATE OF APPROX
0.30 ± GAL/SY AND A LAYER OF 78M AGGREGATE AT A RATE OF APPROX. 18 ± LBS/SY.

TOP LAYER CONSISTS OF EMULSIFIED ASPHALT, GRADE CRS-2L AT A RATE OF APPROX
0.25 ± GAL/SY AND A LAYER OF: 5/16" LIGHTWEIGHT AGGREGATE AT A RATE OF APPROX. 9± LBS/SY.

* ALL AGGREGATE MATERIAL MAY BE STOCKPILED AT NCDOT MAINTENANCE FACILITIES AS APPROVED BY THE DEPARTMENT
THE RESIDENT ENGINEER'S OFFICE MUST BE CONTACTED PRIOR TO STOCKPILING STONE.

*CONTRACTOR SHALL BE RESPONSIBLE FOR LOADING, HAULING, & PLACING ALL AGGREGATE MATERIAL.

P A V E M E N T S C H E D U L E

F	PROP. ASPHALT SURFACE TREATMENT, DOUBLE SEAL, AT AN APPLICATION RATE TO BE DETERMINED BY FIELD CONDITIONS IN ACCORDANCE WITH PROJECT SPECIAL PROVISIONS (SEE NOTES)
U	EXISTING PAVEMENT.

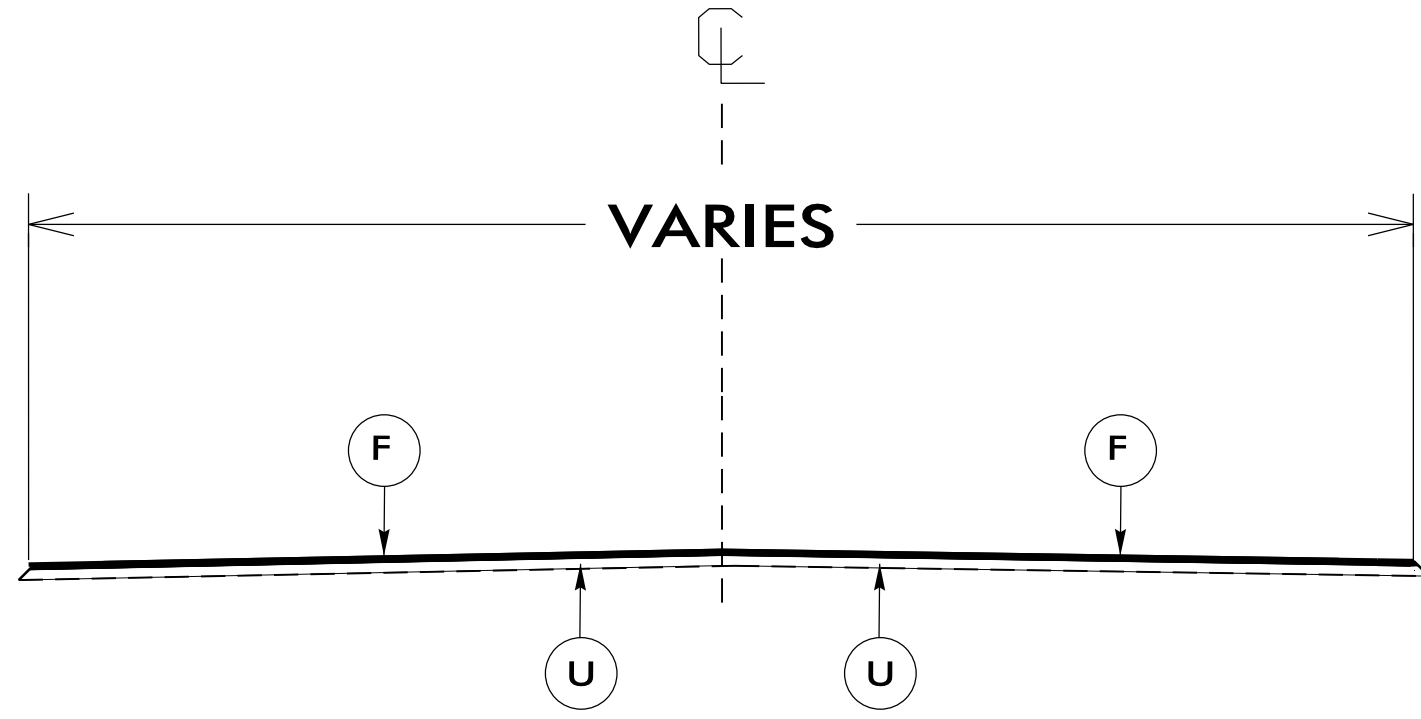

TYPICAL SECTION NO. 1

USE WITH MAPS 1 - 23

03-JAN-2020 13:52 S:\Sherrod\Division One Resurfacing & Retreatment Plans\2020-2021 AST\DA00444-District 2\Plans\AST Plans.dgn

NTS

NC DOT JACKSON MAINTENANCE FACILITY - NORTHAMPTON COUNTY
9339 Highway 305 N
Jackson, NC 27845

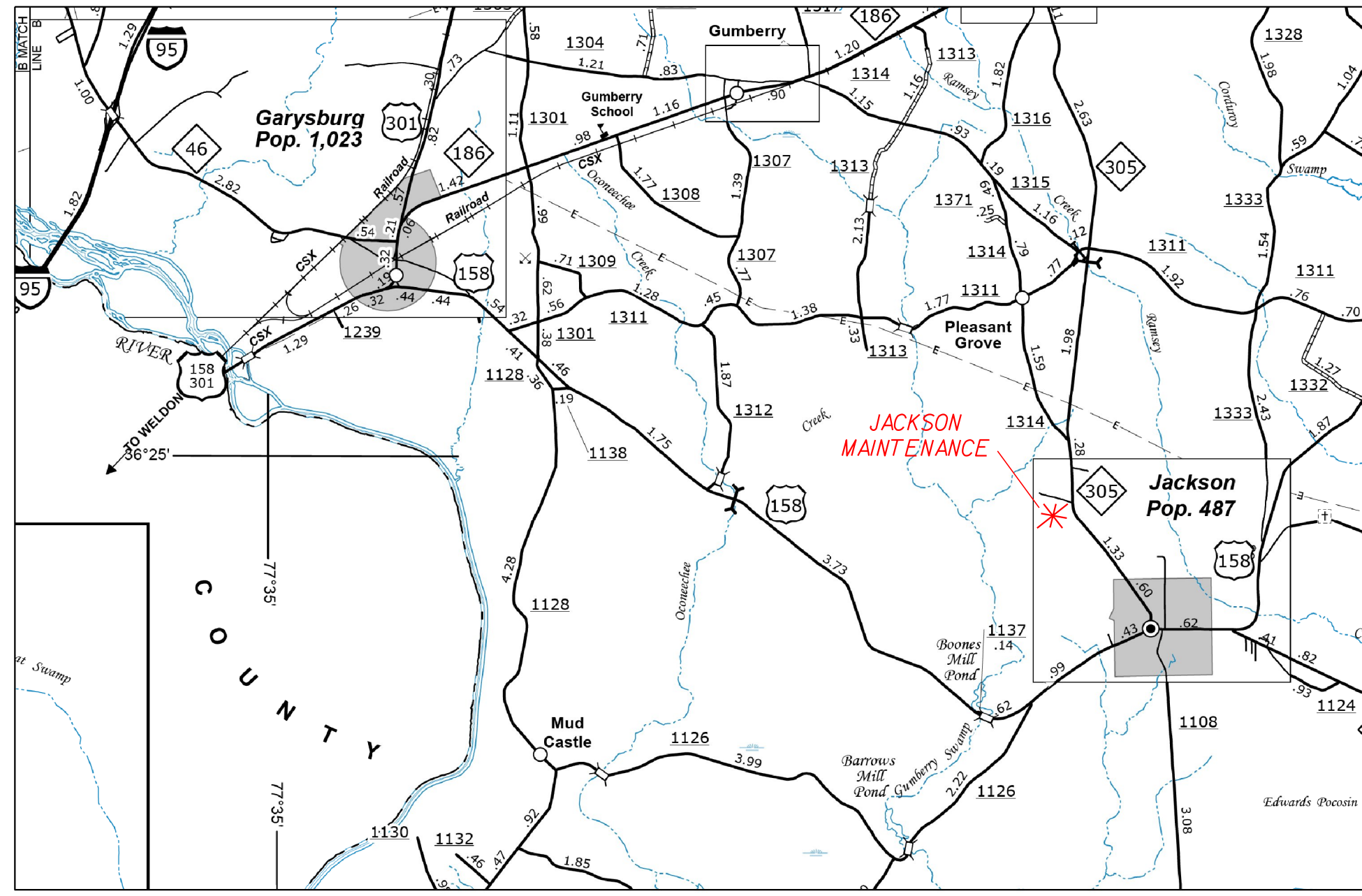

SYSTEMS TIME DESIGN CONSULTANTS
 1000 W. WELDON AVENUE
 WELDON, NC 27884
 TEL: 703.928.1100
 FAX: 703.928.1101
 WWW.SYSTIMEDESIGN.COM

SUMMARY OF QUANTITIES

PROJECT NO	COUNTY	MAP NO	ROUTE	DESCRIPTION	TYP NO	LANES	LANE TYPE	FINAL SURFACE TESTING REQUIRED	WARM MIX ASPHALT REQUIRED	LENGTH	WIDTH	MOBILIZATION	ASPHALT SURFACE TREATMENT, DOUBLE SEAL	EMULSION FOR ASPHALT SURFACE TREATMENT	TEMPORARY TRAFFIC CONTROL	ADV/GEN WARNING SIGNS
										MI	FT	LS	SY	GAL	LS	SF
2019CPT.01.13.20082.1	Bertie	1	SR1323 BUD TAYLOR RD	DEAD END TO SR1002	1	2	2WU	NO	NO	1.1	19	1	13,111	7,866	1	40
2019CPT.01.13.20082.1	Bertie	2	SR1329 GLOVERS CROSS RD	SR1002 TO BEGIN CURB AND GUTTER	1	2	2WU	NO	NO	4.28	20	*	52,769	31,661	*	150
2019CPT.01.13.20082.1	Bertie	3	SR1330 THOMPSON RD	SR1331 TO SR1329	1	2	2WU	NO	NO	1.03	18	*	12,577	7,546	*	86
2019CPT.01.13.20082.1	Bertie	4	SR1331 EAST & WEST JOHN THOMPSON RD	DEAD END TO HERTFORD CO LINE	1	2	2WU	NO	NO	1.16	20	*	14,461	8,677	*	80
2019CPT.01.13.20082.1	Bertie	5	SR1350 DOC BAKER RD	SR1346 TO SR1348	1	2	2WU	NO	NO	1.49	21	*	20,057	12,034	*	80
2019CPT.01.13.20082.1	Bertie	6	SR1356 DEWHIT SWAMP RD	SR1355 TO NC45	1	2	2WU	NO	NO	1.16	21	*	15,991	9,595	*	80
2019CPT.01.13.20082.1	Bertie	7	SR1359 LELLIE HUGHES RD	DEAD END TO SR1355	1	2	2WU	NO	NO	0.38	19	*	5,086	3,052	*	40
2019CPT.01.13.20082.1	Bertie	8	SR1387 NIXON RD	SR1355 TO SR1346	1	2	2WU	NO	NO	1.40	21	*	18,948	11,369	*	80
TOTAL FOR PROJ NO. 2019CPT.01.13.20082.1										12.00			153,000	91,800		636
2019CPT.01.13.20462.1	Hertford	9	SR1429 THOMAS RD	DEAD END TO SR1427	1	2	2WU	NO	NO	0.47	18	*	5,813	3,488	*	40
2019CPT.01.13.20462.1	Hertford	10	SR1435 JOHN THOMPSON RD	BERTIE CO LINE TO SR1434	1	2	2WU	NO	NO	0.38	20	*	5,309	3,185	*	40
2019CPT.01.13.20462.1	Hertford	11	SR1436 BAKERTOWN RD	SR1434 TO SR1437	1	2	2WU	NO	NO	0.41	18	*	6,030	3,617	*	80
2019CPT.01.13.20462.1	Hertford	12	SR1441 SWAINS MILL RD	BRIDGE#42 TO NC45	1	2	2WU	NO	NO	3.27	21	*	41,986	25,191	*	102
2019CPT.01.13.20462.1	Hertford	13	SR1443 WICCAON RD	SR1471 TO NC45	1	2	2WU	NO	NO	2.02	20	*	25,401	15,240	*	108
2019CPT.01.13.20462.1	Hertford	14	SR1446 PRITCHARD FARMS RD	SR1427 TO NC45	1	2	2WU	NO	NO	1.58	21	*	21,166	12,700	*	80
2019CPT.01.13.20462.1	Hertford	15	SR1471 COTTONS ISLAND RD	DEAD END TO SR1445	1	2	2WU	NO	NO	1.90	19	*	22,879	13,727	*	80
TOTAL FOR PROJ NO. 2019CPT.01.13.20462.1										10.03			128,584	77,148		530
2019CPT.01.13.20662.1	Northampton	16	SR1537 PERDUE HATCHERY RD	US158 TO SR1536	1	2	2WU	NO	NO	1.80	20	*	23,670	14,202	*	102
2019CPT.01.13.20662.1	Northampton	17	SR1355 BOONES BRIDGE RD	SR1351 TO HERTFORD CO LINE	1	2	2WU	NO	NO	1.19	21	*	16,361	9,817	*	40
2019CPT.01.13.20662.1	Northampton	18	SR1354 STANLEY BARNES RD	SR1351 TO DEAD END	1	2	2WU	NO	NO	1.57	20	*	20,121	12,073	*	40
2019CPT.01.13.20662.1	Northampton	19	SR1362 WATSON MILL RD	SR1360 TO SR1364	1	2	2WU	NO	NO	1.96	20	*	24,697	14,818	*	80
2019CPT.01.13.20662.1	Northampton	20	SR1363 TURKEY BRANCH RD	HERTFORD CO LINE TO SR1364	1	2	2WU	NO	NO	0.48	20	*	6,482	3,889	*	40
2019CPT.01.13.20662.1	Northampton	21	SR1364 BARRETT CABIN RD	US158 TO DEAD END	1	2	2WU	NO	NO	2.78	20	*	35,169	21,101	*	102
2019CPT.01.13.20662.1	Northampton	22	SR1544 LAURIE VANN RD	SR1543 TO SR1536	1	2	2WU	NO	NO	1.76	20	*	22,351	13,411	*	80
2019CPT.01.13.20662.1	Northampton	23	SR1538 PARKER RD	SR1537 TO US258	1	2	2WU	NO	NO	1.12	20	*	14,841	8,905	*	80
TOTAL FOR PROJ NO. 2019CPT.01.13.20662.1										12.66			163,692	98,216		564
GRAND TOTAL										34.69		1	445,276	267,164	1	1,730

SIGNING FOR ASPHALT SURFACE TREATMENT

LEGEND

PORTABLE SIGN

STATIONARY SIGN

DIRECTION OF TRAFFIC FLOW

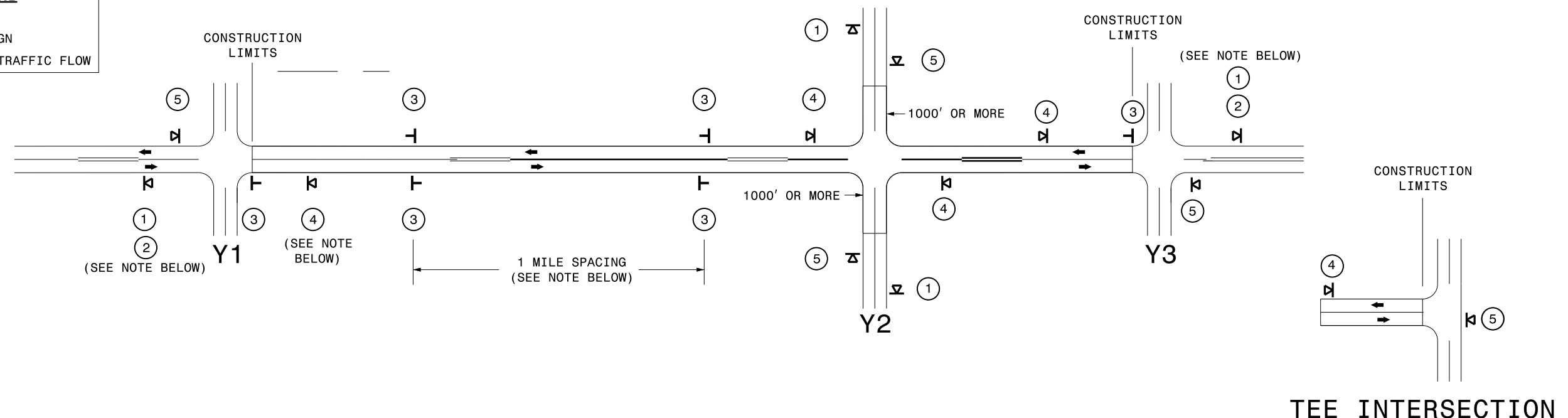

MAINLINE (-L-) SIGNING

-Y- LINE SIGNING

SIGNING NOTES AND PLACEMENT PER DIRECTION	①		<ul style="list-style-type: none"> - PLACE 1000' PRIOR TO BEGINNING OF CONSTRUCTION LIMITS. ONLY USED ON -Y- LINES IF RESURFACING LIMITS EXTEND 1000' ALONG -Y- LINE.
	②		<ul style="list-style-type: none"> - SIGN #2 ONLY USED WHEN RESURFACING LIMITS ARE 2 OR MORE MILES IN LENGTH. ROUND UP TO THE NEAREST WHOLE NUMBER. DO NOT USE FRACTIONAL OR DECIMAL NUMBERS.
	③	 	<ul style="list-style-type: none"> - ALTERNATE THE FOLLOWING TWO SIGNS: - STARTING WITH "LOOSE GRAVEL" (W8-7) FOLLOWED BY "UNMARKED PAVEMENT". - PLACE INITIALLY AT THE CONSTRUCTION LIMITS AND SPACED 1 MILE APART THEREAFTER. - AT TEE INTERSECTIONS INSTALL INITIALLY 0.5 MILE FROM INTERSECTION AND SPACE 1 MILE APART THEREAFTER.
	④		<ul style="list-style-type: none"> - THESE ARE FOR -Y- LINES THAT ARE "THROUGH" ROADWAYS. DEAD END AND SUBDIVISION ROADS ARE NOT "THROUGH" ROADWAYS. - INSTALL 500' +/- FROM EACH -Y- LINE APPROACH AS SHOWN ABOVE. - FOR MULTIPLE -Y- LINES THAT ARE SEPARATED BY 0.25 MILES OR LESS, TREAT AS A SINGLE UNIT AND INSTALL WITHIN 500' OF EACH APPROACH. - A MAXIMUM OF 2 SIGN SETS PER MILE. DO NOT INSTALL WHEN -Y- LINES ARE WITHIN 0.5 MILES FROM "END ROAD WORK" SIGN.
	⑤		<ul style="list-style-type: none"> - PLACE 500' FOLLOWING THE END OF CONSTRUCTION LIMITS OR AS SHOWN WHEN WORK ENDS AT A 3-WAY TEE INTERSECTION.
<p>THE ABOVE SIGNS ARE ALL THAT ARE REQUIRED FOR A CONTRACTOR TO BEGIN A RESURFACING CONTRACT. ANY ADDITIONAL SIGNS REQUESTED BY NCDOT DIVISIONS SHALL BE INSTALLED WITHIN 7 BUSINESS DAYS OF THE START OF CONTRACT WORK.</p>			
<p>FOR AST RESURFACING MAPS WITH CONSTRUCTION LIMITS LESS THAN 2 MILES IN LENGTH, USE A STATIONARY "LOOSE GRAVEL" SIGN AT THE BEGINNING CONSTRUCTION LIMIT FOLLOWED BY AN "UNMARKED PAVEMENT" SIGN MIDWAY THROUGH AND AN "END ROAD WORK" SIGN AT THE END CONSTRUCTION LIMIT.</p>			

STATIONARY SIGNING NOT REQUIRED FOR THE FOLLOWING -Y- LINE CONDITIONS:

- 1) LESS THAN 1000' OF RESURFACING ALONG -Y- LINE
- 2) SUBDIVISION ROADS
- 3) DEAD END ROADS

WHEN PAVING/CONSTRUCTION ACTIVITIES PROCEED ACROSS AN UNSIGNED -Y- LINE, PORTABLE ADVANCE WARNING SIGNS SHALL BE USED ALONG THE -Y- LINE AS SHOWN BELOW. REMOVE UPON COMPLETION OF WORK.

W20-1
48" X 48"
 PLACED 500' IN ADVANCE OF FLAGGER.

W20-7 A
48" X 48"
 PLACED 250' IN ADVANCE OF FLAGGER.

MAPS LESS THAN 2 MILES

ADVANCE WARNING SIGNS FOR 2-LANE ROADWAY ASPHALT SURFACE TREATMENT

07-MAR-2019 08:19
 S:\Groups-Div\CC\Projects\2019-2020 AST Maps\DA00444_District 2\Plans\AST Plans.dgn
 gnsinstallings AT DICAD2933715