

09/08/99

CONTRACT NO.: DA00293 WBS ELEMENT: 2016CPT.01.24.20281.1,ETC.

STATE OF NORTH CAROLINA  
DIVISION OF HIGHWAYS

**DARE COUNTY**

STATE	STATE PROJECT REFERENCE NO.	SHEET NO.	TOTAL NO.
N.C.	2016CPT.01.24.20281.1,ETC.	1	
STATE PROJ. NO.	F.A. PROJ. NO.	DESCRIPTION	
2016CPT.01.24.20281.1		MAP 1	
2016CPT.01.24.20281.2		MAP 2	
2016CPT.01.24.20281.3		MAP 3	
2016CPT.01.24.20281.4		MAP 4	
2016CPT.01.24.20281.5		MAP 5	
2016CPT.01.24.20281.6		MAP 6	
2016CPT.01.24.20281.7		MAP 7	
2016CPT.01.24.20281.8		MAP 8	



**LOCATION:** MAP 1 SR 1457 PARTRIDGE TRAIL FROM SR 1453 TO SR 1452  
 MAP 2 SR 1457 ST. CLAIR ROAD FROM SR 1452 TO SR 1459  
 MAP 3 SR 1459 COLINGTON CREEK ROAD FROM SR 1457 TO CUL-DE-SAC  
 MAP 4 SR 1453 W. OCEAN BAY BLVD. FROM SR 1457 TO SR 1452  
 MAP 5 SR 1454 FOXX GRAPE FROM SR 1452 TO SR 1453  
 MAP 6 SR 1455 BAY BERRY ROAD FROM SR 1454 TO SR 1457  
 MAP 7 SR 1456 PINE CONE TRAIL FROM SR 1452 TO SR 1457  
 MAP 8 SR 1465 PINE CONE DRIVE FROM SR 1457 TO SR 1454

**TYPE OF WORK:** RESURFACING & SHOULDER RECONSTRUCTION

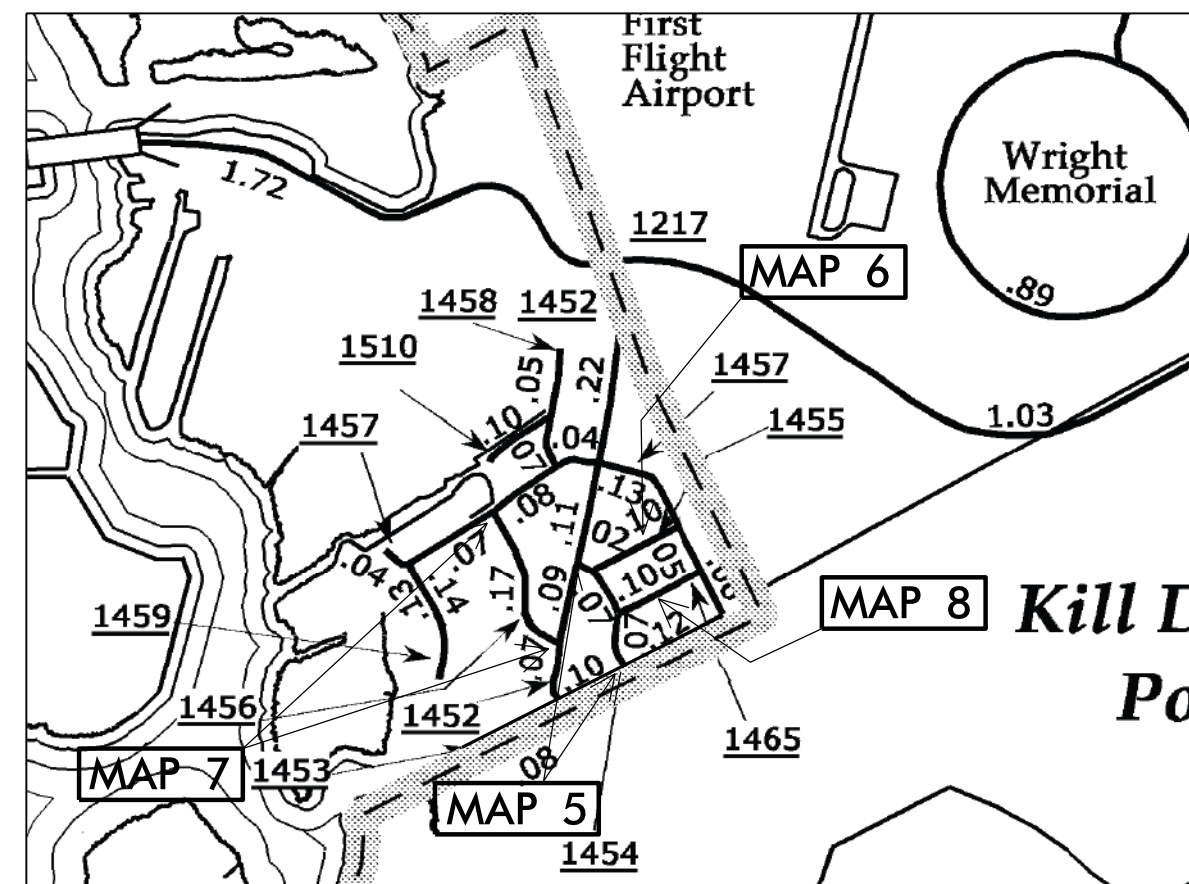
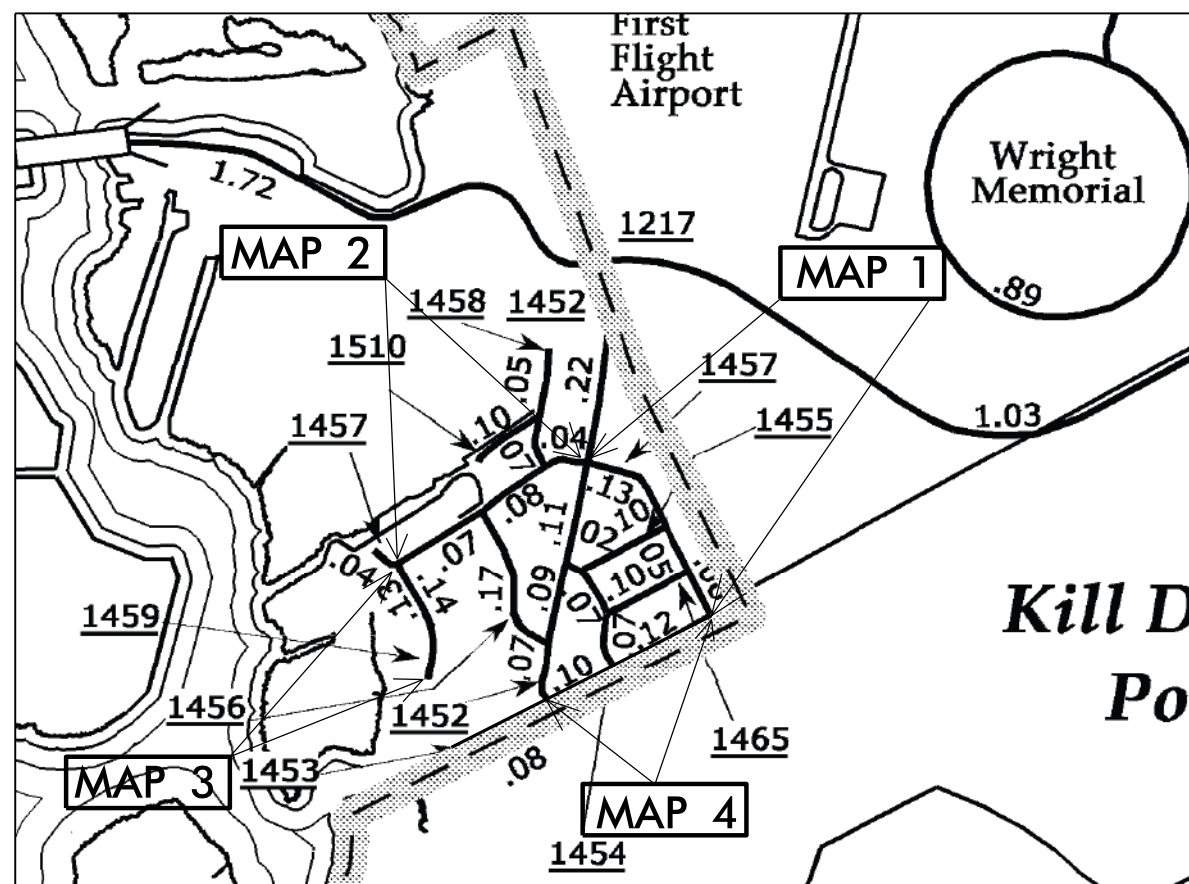

**NTS**

**PROJECT LENGTH**

LENGTH OF ROADWAY PROJECT MAP 1 = 0.23 MI  
 LENGTH OF ROADWAY PROJECT MAP 2 = 0.24 MI  
 LENGTH OF ROADWAY PROJECT MAP 3 = 0.14 MI  
 LENGTH OF ROADWAY PROJECT MAP 4 = 0.20 MI  
 LENGTH OF ROADWAY PROJECT MAP 5 = 0.14 MI  
 LENGTH OF ROADWAY PROJECT MAP 6 = 0.11 MI  
 LENGTH OF ROADWAY PROJECT MAP 7 = 0.17 MI  
 LENGTH OF ROADWAY PROJECT MAP 8 = 0.10 MI

Prepared in the Office of:  
**DIVISION OF HIGHWAYS**  
 113 Airport Dr., Edenton NC, 27932

2012 STANDARD SPECIFICATIONS

LETTING DATE:

W. B. HOBBS, P.E.  
 DIVISION PROJECT MANAGER

C. E. SLACHTA  
 DIVISION PROPOSALS ENGINEER

**DIVISION OF HIGHWAYS**  
 STATE OF NORTH CAROLINA

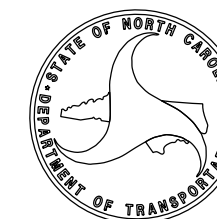

DRAWN BY: BJT

09/08/99

CONTRACT NO.: DA00293 WBS ELEMENT: 2016CPT.01.24.20281.1, ETC.

STATE OF NORTH CAROLINA  
DIVISION OF HIGHWAYS

**DARE COUNTY**

STATE	STATE PROJECT REFERENCE NO.	SHEET NO.
N.C.	2016CPT.01.24.20281.1,ETC.	2
STATE PROJ.NO.	F.A.PROJ.NO.	DESCRIPTION
2016CPT.01.24.20281.9		MAP 9
2016CPT.01.24.20281.10		MAP 10
2016CPT.01.24.20281.11		MAP 11
2016CPT.01.24.20281.12		MAP 12
2016CPT.01.24.20281.13		MAP 13
2016CPT.01.24.20281.14		MAP 14

**LOCATION:** MAP 9 SR 1534 SOUNDSHORE DRIVE FROM SR 1491 TO SR 1535  
 MAP 10 SR 1535 SUNRISE LANE FROM CUL-DE-SAC TO CUL-DE-SAC  
 MAP 11 SR 1210 BOB PERRY ROAD FROM SR 1208 TO END OF ROAD  
 MAP 12 SR 1213 HERBERT PERRY ROAD FROM SR 1206 TO SR 1214  
 MAP 13 SR 1209 AUSTIN CEMETARY ROAD FROM SR 1208 TO SR 1208  
 MAP 14 SR 1533 CARRENDA LANE FROM SR 1208 TO DEAD END

**TYPE OF WORK:** RESURFACING & SHOULDER RECONSTRUCTION

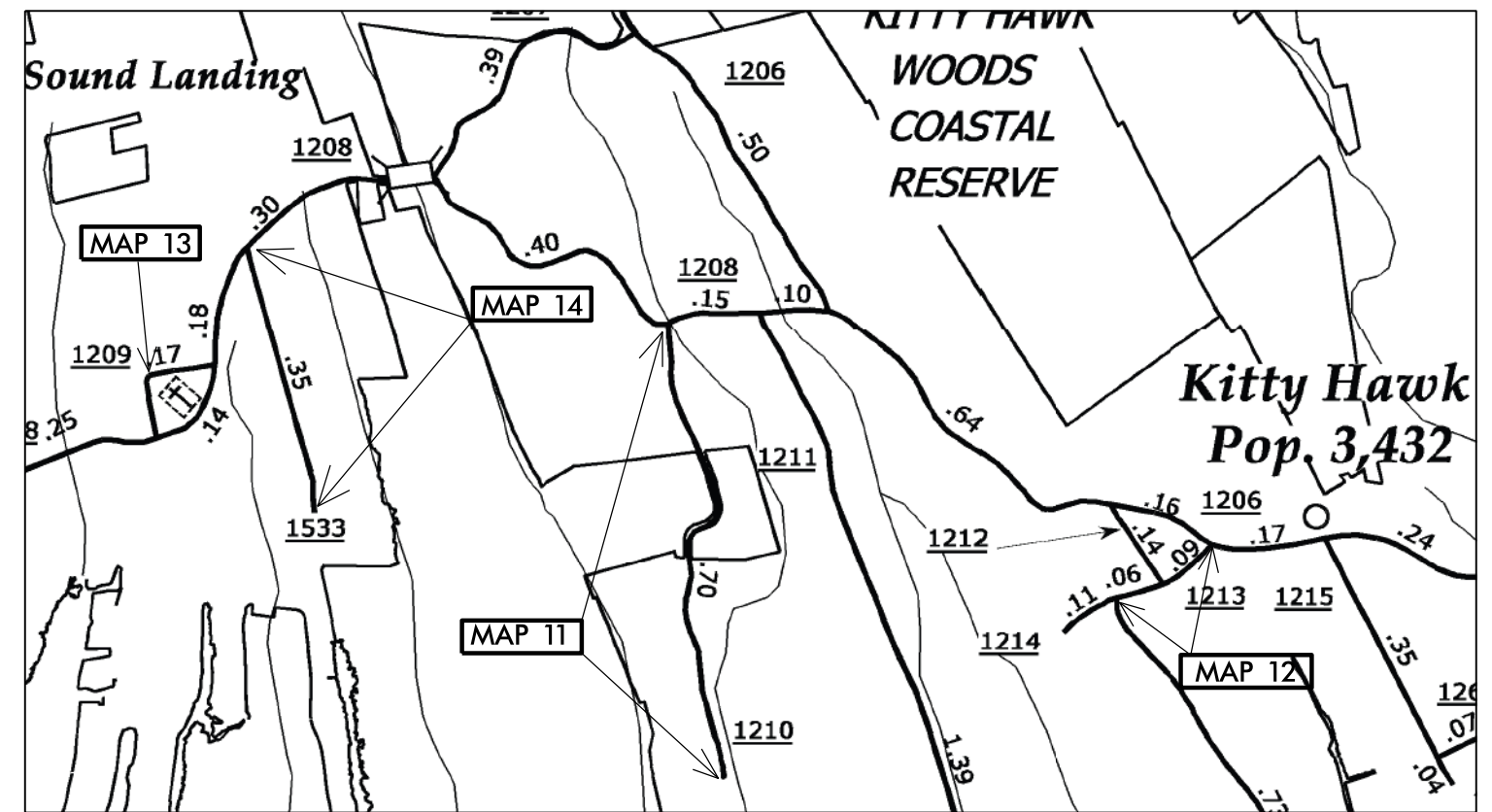
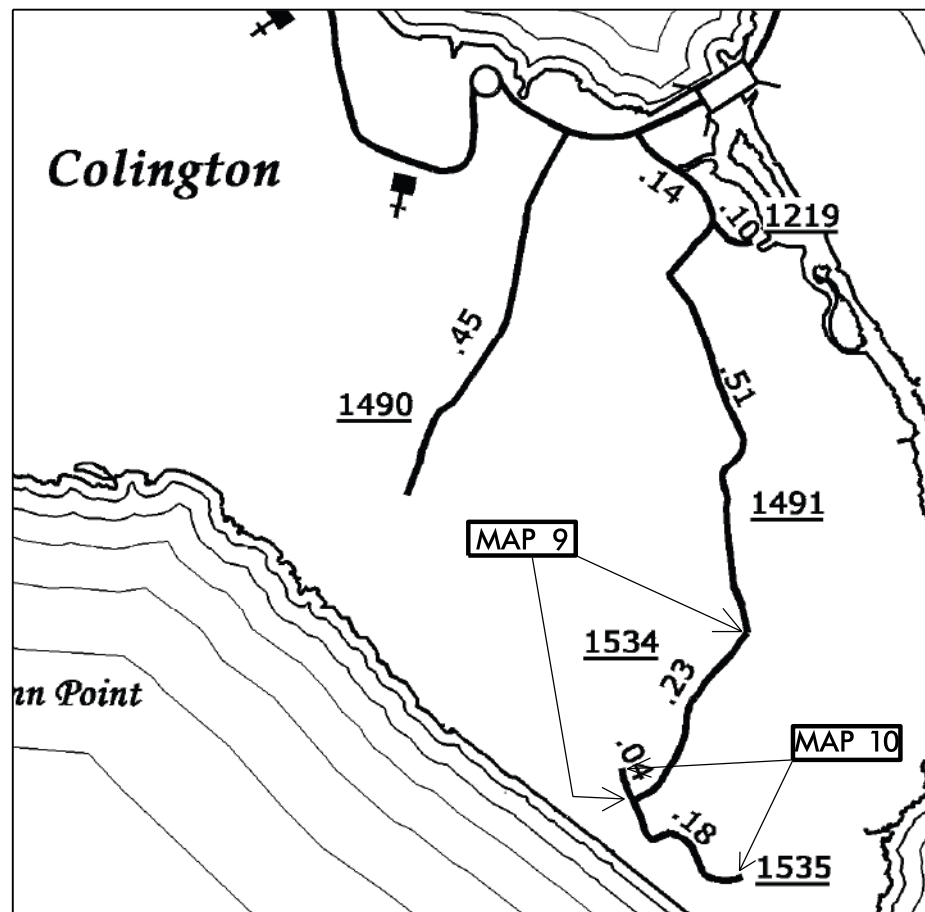

**NTS**

**PROJECT LENGTH**

- LENGTH OF ROADWAY PROJECT MAP 9 = 0.23 MI.
- LENGTH OF ROADWAY PROJECT MAP 10 = 0.24 MI.
- LENGTH OF ROADWAY PROJECT MAP 11 = 0.70 MI.
- LENGTH OF ROADWAY PROJECT MAP 12 = 0.18 MI.
- LENGTH OF ROADWAY PROJECT MAP 13 = 0.18 MI.
- LENGTH OF ROADWAY PROJECT MAP 14 = 0.40 MI.

Prepared in the Office of:  
**DIVISION OF HIGHWAYS**

113 Airport Dr., Edenton NC, 27932

2012 STANDARD SPECIFICATIONS

LETTING DATE:

W.B. HOBBS, P.E.  
DIVISION PROJECT MANAGER

C.E. SLACHTA  
DIVISION PROPOSALS ENGINEER

**DIVISION OF HIGHWAYS  
STATE OF NORTH CAROLINA**

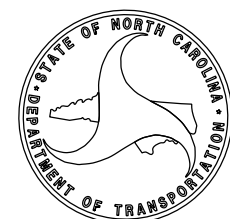

DRAWN BY: BJT

PROJECT REFERENCE NO.	SHEET NO.
2016CPT.01.09.20281.1, ETC.	3

C O N T R A C T P A V E M E N T S C H E D U L E

C1	PROP. APPROX. 1½" ASPHALT CONCRETE SURFACE COURSE, TYPE SF9.5A, AT AN AVERAGE RATE OF 165 LBS. PER SQ. YD.
T	EARTH MATERIAL
U	EXISTING PAVEMENT

PAVEMENT SCHEDULE

C1	PROP. APPROX. 1½" ASPHALT CONCRETE SURFACE COURSE, TYPE SF9.5A, AT AN AVERAGE RATE OF 165 LBS. PER SQ. YD.
U	EXISTING PAVEMENT.
T	EARTH MATERIAL

PROJECT REFERENCE NO.	SHEET NO.
2016CPT.01.09.20281.1, ETC.	4

NOTES:

\*ALL PAVED S.R. ROADS TO BE RESURFACED TO THE ENDS OF THE RADII, OR AS DIRECTED BY THE ENGINEER

\*EDGES, PAVEMENT WIDENING, INTERSECTIONS, AND BRIDGE FLARES ARE INCLUDED IN THE TABLE OF QUANTITIES

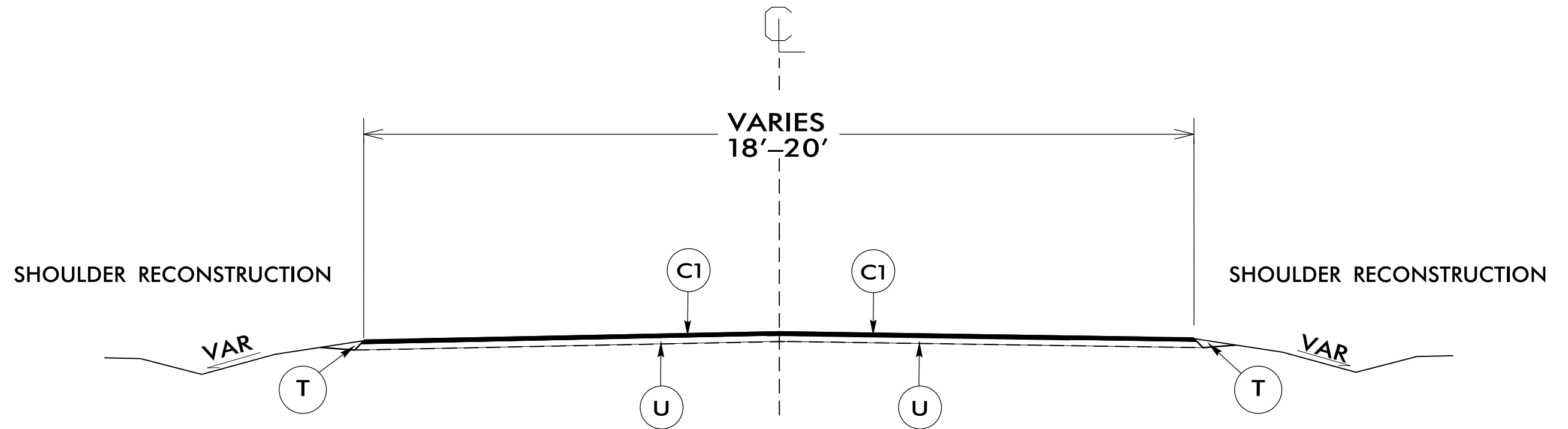

**TYPICAL SECTION NO. 1**

USE WITH MAPS 1 - 14

NTS

PROJECT NO.	SHEET NO.	TOTAL NO.
2016CPT.01.24.20281.1, ETC.	5	

## SUMMARY OF QUANTITIES

PROJECT NO	COUNTY	MAP NO	ROUTE	DESCRIPTION	TYP NO	LANES	LANE TYPE	FINAL SURFACE TESTING REQUIRED	WARM MIX ASPHALT REQUIRED	LENGTH MI	WIDTH FT	MOBILIZATION LS	BORROW CY	INCIDENTAL STONE BASE TONS	SHOULDER RECONSTRUCTION SMI	SURFACE COURSE, SF9.5A TONS	ASPHALT BINDER FOR PLANT MIX TONS	SEED & MULCHING AC	TRAFFIC CONTROL LS
2016CPT.01.24.20281.1	Dare	1	SR 1457 PARTRIDGE TRAIL	FROM SR 1453 TO SR 1452	1	2	2WU	NO	NO	0.23	20	1	80	4	0.46	246	17	0.20	1
2016CPT.01.24.20281.2	Dare	2	SR 1457 ST CLAIR RD	FROM SR 1452 TO SR 1459	1	2	2WU	NO	NO	0.24	20	*	100	2	0.48	257	17	0.20	*
2016CPT.01.24.20281.3	Dare	3	SR 1459 COLINGTON CREEK RD	FROM SR 1457 TO CUL-DE-SAC	1	2	2WU	NO	NO	0.14	20	*	50	2	0.28	150	10	0.10	*
2016CPT.01.24.20281.4	Dare	4	SR 1453 W OCEAN BAY BLVD	FROM SR 1457 TO SR 1452	1	2	2WU	NO	NO	0.2	20	*	80	2	0.40	214	14	0.20	*
2016CPT.01.24.20281.5	Dare	5	SR 1454 FOX GRAPE	FROM SR 1452 TO SR 1453	1	2	2WU	NO	NO	0.14	20	*	50	2	0.28	150	10	0.10	*
2016CPT.01.24.20281.6	Dare	6	SR 1455 BAY BERRY RD	FROM SR 1454 TO SR 1457	1	2	2WU	NO	NO	0.11	20	*	40	2	0.22	118	8	0.10	*
2016CPT.01.24.20281.7	Dare	7	SR 1456 PINE CONE TRAIL	FROM SR 1452 TO SR 1457	1	2	2WU	NO	NO	0.17	20	*	60	2	0.34	182	12	0.16	*
2016CPT.01.24.20281.8	Dare	8	SR 1465 PINE CONE DR	FROM SR 1457 TO SR 1454	1	2	2WU	NO	NO	0.1	20	*	40	2	0.20	107	7	0.10	*
2016CPT.01.24.20281.9	Dare	9	SR 1534 SOUNDSHORE DR	FROM SR 1491 TO SR 1535	1	2	2WU	NO	NO	0.23	20	*	100	2	0.46	246	17	0.20	*
2016CPT.01.24.20281.10	Dare	10	SR 1535 SUNRISE LANE	FROM CUL-DE-SAC TO CUL-DE-SAC	1	2	2WU	NO	NO	0.24	20	*	100	6	0.48	236	16	0.20	*
2016CPT.01.24.20281.11	Dare	11	SR 1210 BOB PERRY RD	FROM SR 1208 TO END OF ROAD	1	2	2WU	NO	NO	0.7	20	*	160	4	1.40	750	50	0.68	*
2016CPT.01.24.20281.12	Dare	12	SR 1213 HERBERT PERRY RD	FROM SR 1206 TO SR 1214	1	2	2WU	NO	NO	0.18	18	*	50	2	0.36	174	12	0.17	*
2016CPT.01.24.20281.13	Dare	13	SR 1209 AUSTIN CEMETARY RD	FROM SR 1208 TO SR 1208	1	2	2WU	NO	NO	0.18	20	*	50	2	0.36	193	13	0.17	*
2016CPT.01.24.20281.14	Dare	14	SR 1533 CARRENDA LANE	FROM SR 1208 TO DEAD END	1	2	2WU	NO	NO	0.4	18	*	150	6	0.80	386	26	0.40	*
<b>GRAND TOTAL</b>										<b>3.26</b>		<b>1</b>	<b>1,110</b>	<b>40</b>	<b>6.52</b>	<b>3,409</b>	<b>229</b>	<b>2.98</b>	<b>1</b>

- NOTES:  
 1) DETAIL DOES NOT APPLY TO OGAFB AND ULTRA-THIN BONDED WEARING COURSE.  
 2) BACKFILL SHOULDER WITH APPROVED MATERIAL.  
 3) THE SHOULDER WEDGE DEVICE MAY BE DISENGAGED AT PAVED DRIVEWAYS AND SIDE STREETS.

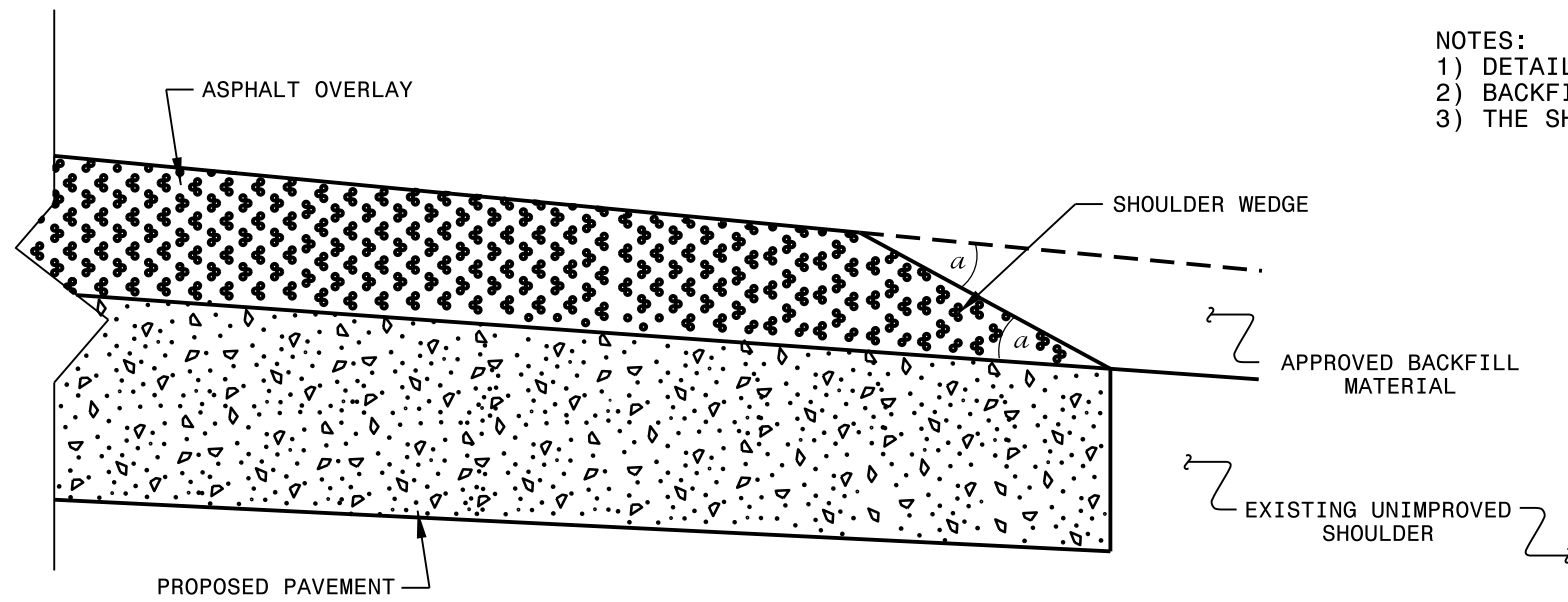

**SHOULDER WEDGE DETAIL**  
 (Resurfacing Projects w/ Widening or  
 with Existing Paved Shoulder having no dropoffs)

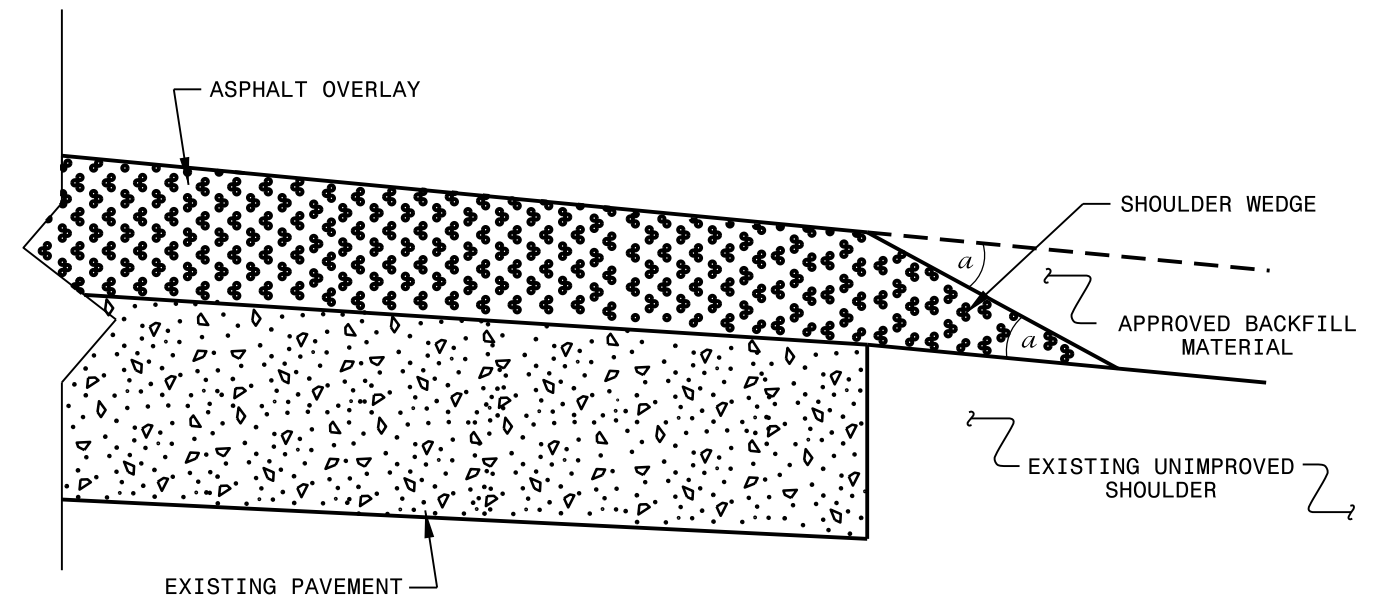

**SHOULDER WEDGE DETAIL**  
 (Resurfacing Projects w/ NO Widening)

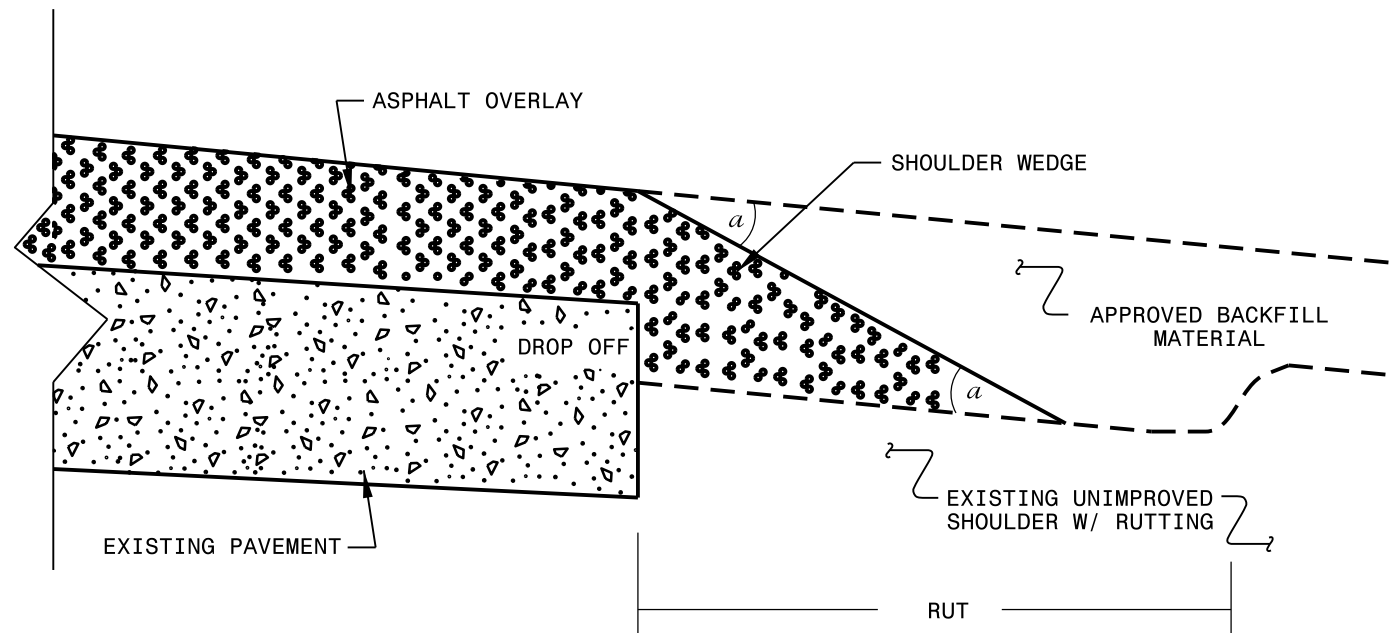

**SHOULDER WEDGE DETAIL**  
 (Resurfacing Adjacent to  
 Rutted Shoulder)

- SHOULDER WEDGE ANGLE = 30°

CONTRACT STANDARDS  
 AND DEVELOPMENT UNIT  
 Office 919-707-6950 FAX 919-250-4119

**SHOULDER WEDGE  
 DETAILS**

ORIGINAL BY: T.SPELL DATE: 7-19-11  
 MODIFIED BY: DATE: 10/16/12  
 CHECKED BY: DATE:  
 FILE SPEC.: s:\usr\details\stand\shoulderwedgedetail.dgn

R:\N:\2016\1125\Drawings\Map\Shoulder detail\Revised Shoulder Wedge Detail.dgn  
 .bstatum A1 D:\CAD\270261

# SIGNING FOR RESURFACING PROJECTS

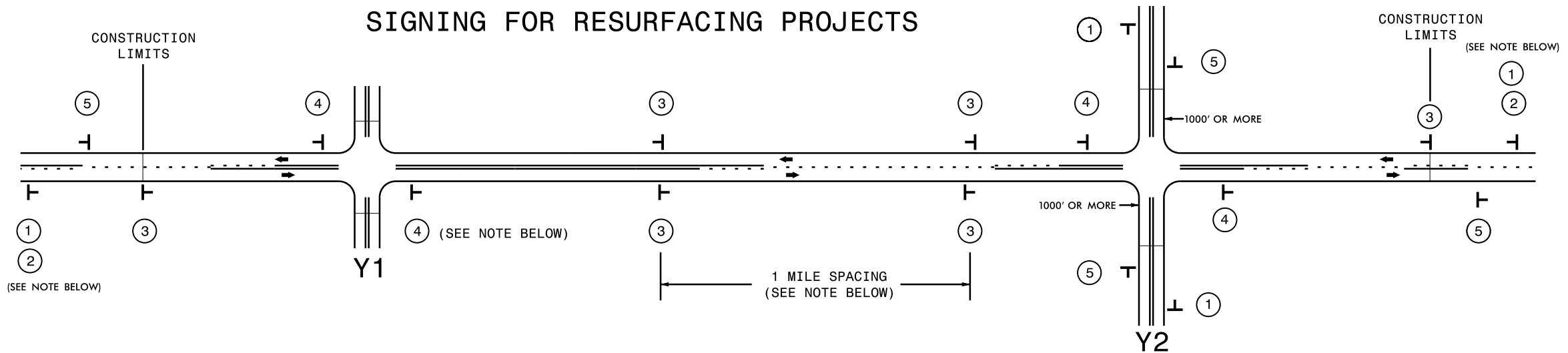

LEGEND	
T	STATIONARY SIGN
←	DIRECTION OF TRAFFIC FLOW

## MAINLINE (-L-) SIGNING

## -Y- LINE SIGNING

SIGNING NOTES AND PLACEMENT PER DIRECTION	①	 <small>W20-1 48" X 48"</small>	PLACE 1000' PRIOR TO BEGINNING OF CONSTRUCTION LIMITS. ONLY USED ON -Y- LINES IF RESURFACING LIMITS EXTEND 1000' ALONG -Y- LINE.
	②	 <small>W7-3aP 24" X 18"</small>	#2 SIGN ONLY USED WHEN RESURFACING LIMITS ARE 2 OR MORE MILES IN LENGTH. ROUND UP TO NEXT WHOLE NUMBER. (NO FRACTIONAL OR DECIMAL NUMBERS)
	③	 <small>SP 13107 48" X 48"</small>	PLACE INITIALLY AT THE CONSTRUCTION LIMITS AND SPACED 1 MILE APART THEREAFTER. IF NO -Y- LINES EXIST, PLACE 2ND SET 1/2 MILE FROM THE CONSTRUCTION LIMITS AND THEN SPACE 1 MILE THEREAFTER.
	④	 <small>SP 13106 48" X 48"</small>	THESE ARE FOR -Y- LINES THAT ARE "THROUGH" ROADWAYS. DEAD END AND SUBDIVISION ROADS ARE NOT "THROUGH" ROADWAYS. INSTALL 500' +/- FROM EACH -Y- LINE APPROACH AS SHOWN ABOVE. FOR MULTIPLE -Y- LINES THAT ARE SEPARATED BY 0.25 MILES OR LESS, TREAT AS A SINGLE UNIT AND INSTALL WITHIN 500' OF EACH APPROACH. A MAXIMUM OF 2 SIGN SETS PER MILE. DO NOT INSTALL WHEN -Y- LINES ARE WITHIN 0.5 MILES FROM "END ROAD WORK" SIGN.
⑤	 <small>G20-2 A 48" X 24"</small>	PLACE 500' FOLLOWING THE END OF CONSTRUCTION LIMITS.	

NO REQUIRED STATIONARY SIGNING FOR THE FOLLOWING -Y- LINE CONDITIONS:

- 1) LESS THAN 1000' OF RESURFACING ALONG -Y- LINE
- 2) SUBDIVISION ROADS
- 3) DEAD END ROADS

WHEN PAVING/CONSTRUCTION ACTIVITIES PROCEED ACROSS AN UNSIGNED -Y- LINE, ADVANCE WARNING PORTABLE SIGNS SHALL BE USED ALONG THE -Y- LINE AS SHOWN BELOW. REMOVE UPON COMPLETION OF WORK.



PLACED 500' IN ADVANCE OF FLAGGER. PLACED 250' IN ADVANCE OF FLAGGER.



**RESURFACING  
 ADVANCE WARNING SIGNS  
 FOR  
 RURAL AND SUBURBAN  
 2 LANE ROADWAYS**