



STATE OF NORTH CAROLINA  
DEPARTMENT OF TRANSPORTATION

PAT MCCRORY  
GOVERNOR

NICHOLAS J. TENNYSON  
SECRETARY

February 15, 2016

**Addendum No. 1**

Contract No.: DA00295

WBS Element: 2016CPT.01.26.20151.1, ETC.

*Resurfacing and Shoulder Reconstruction on Various Secondary Roads in Camden, Currituck and Pasquotank Counties*

To Whom It May Concern:

Reference is made to the proposal and plans previously furnished for this project.

The following revision has been made to the proposal and plans:

Plan Sheet #3 has been revised to correct the illustration for Map #16. Please void existing Plan Sheet #3 and staple the revised Plan Sheet #3 thereto.

Please acknowledge receipt of Addendum #1 in the space provided on the Addendum Acknowledgement Form.

Sincerely,

DocuSigned by:

A handwritten signature in black ink that reads "W. B. Hobbs".

99A5A272ED6A447...

W. B. Hobbs, PE  
Division Project Manager

WBH/ces

Attachment

cc: A. W. Roper, PE  
C. S. Mebane, PE  
C. W. Bridgers Jr., PE  
R. W. Midgett, PE

10/03/13

CONTRACT NO.: DA00295 WBS ELEMENT: 2016CPT.01.26.20151.1, ETC.

STATE OF NORTH CAROLINA  
DIVISION OF HIGHWAYS

REVISED 2/15/2016

STATE	STATE PROJECT REFERENCE NO.	SHEET NO.
N.C.	2016CPT.01.26.20151.1, ETC	3
STATE PROJ. NO.	F.A. PROJ. NO.	DESCRIPTION
2016CPT.01.26.20701.1		MAP 16
2016CPT.01.26.20701.2		MAP 17
2016CPT.01.26.20701.3		MAP 18
2016CPT.01.26.20701.4		MAP 19
2016CPT.01.26.20701.5		MAP 20
2016CPT.01.26.20701.6		MAP 21
2016CPT.01.26.20701.7		MAP 22
2016CPT.01.26.20701.8		MAP 23

# PASQUOTANK COUNTY

**LOCATION:** MAP 16 SR 1302 PASQUOTANK STATION RD. FROM SR 1300 TO SR 1144  
 MAP 17 SR 1417 MORGANS CORNER RD. FROM US 158 TO COUNTY LINE  
 MAP 18 SR 1416 NORTHSIDE RD. FROM US 17 SOUTH 2.8 MILES TO CHANGE IN PAVEMENT  
 MAP 19 SR 1454 JENNIFER DR. FROM SR 1456 TO CUL-DE-SAC  
 MAP 20 SR 1463 JASON DR. FROM SR 1456 TO CUL-DE-SAC  
 MAP 21 SR 1450 MEGAN DR. FROM SR 1140 TO DEAD END  
 MAP 22 SR 1453 STACIE DR. FROM SR 1450 TO SR 1456  
 MAP 23 SR 1456 BETTY DR. FROM SR 1461 TO SR 1374

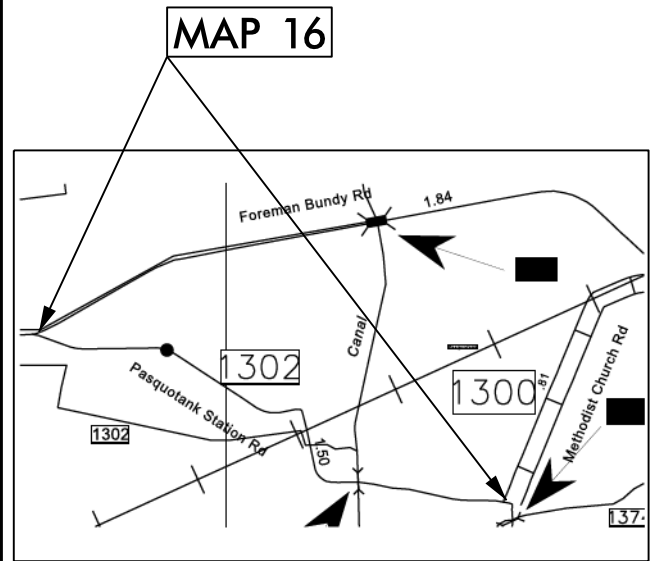

**TYPE OF WORK:** RESURFACING, WIDENING & SHOULDER RECONSTRUCTION

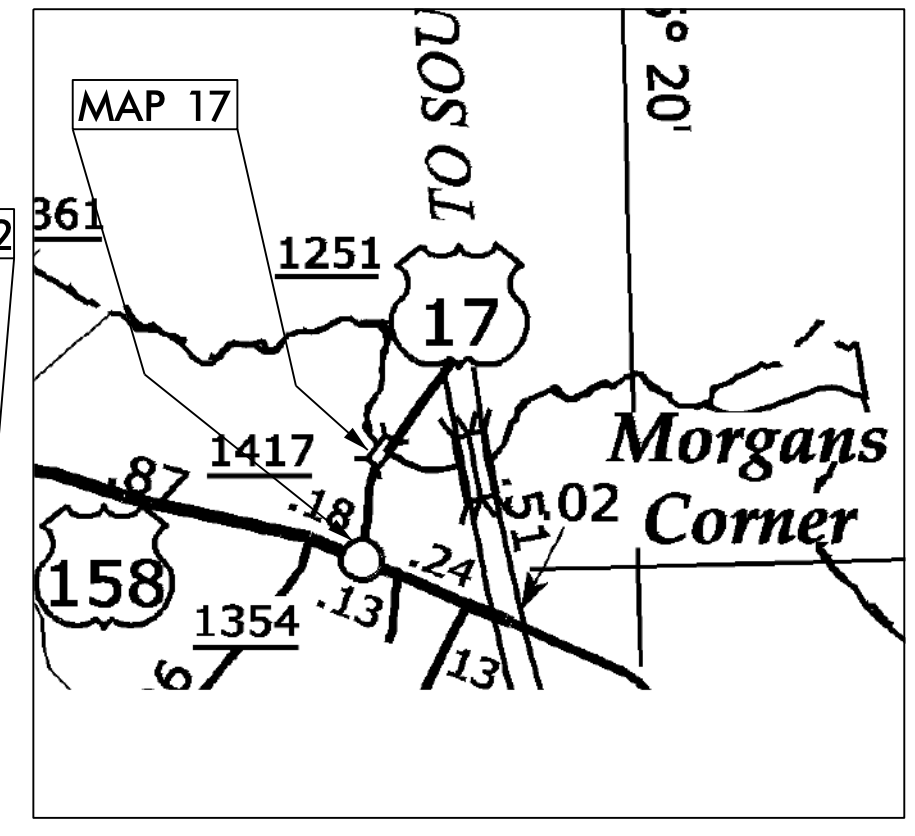
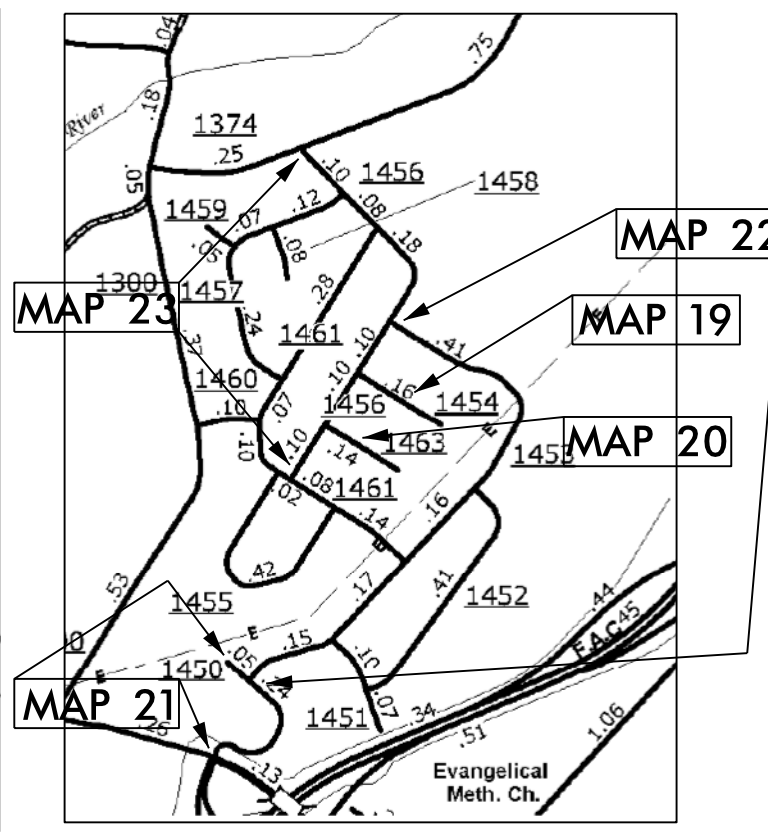
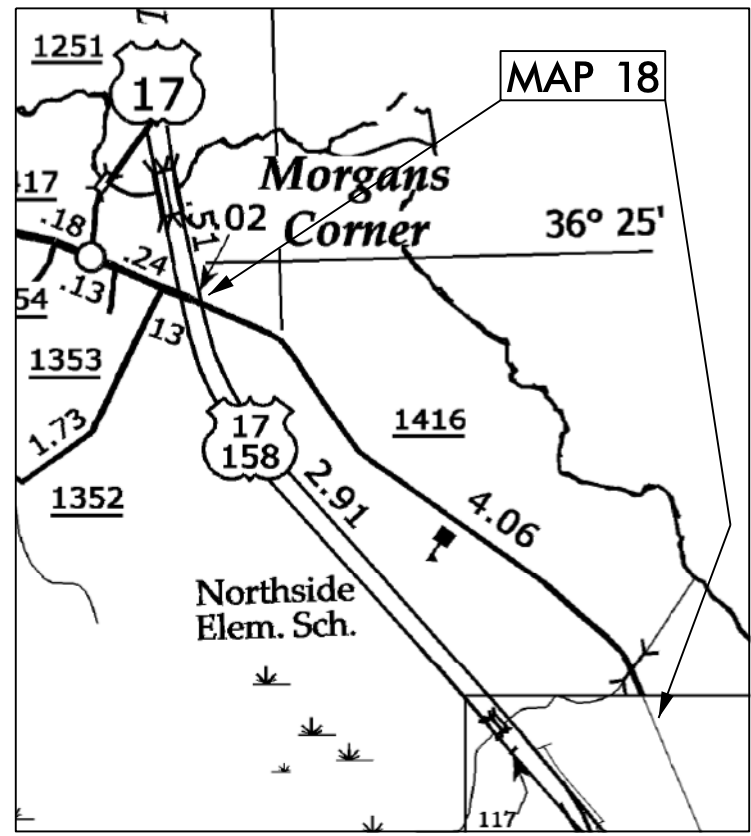

## NTS

PROJECT LENGTH	
LENGTH OF ROADWAY PROJECT	MAP 16 = 1.48 MI.
LENGTH OF ROADWAY PROJECT	MAP 17 = 0.33 MI.
LENGTH OF ROADWAY PROJECT	MAP 18 = 2.8 MI.
LENGTH OF ROADWAY PROJECT	MAP 19 = 0.15 MI.
LENGTH OF ROADWAY PROJECT	MAP 20 = 0.14 MI.
LENGTH OF ROADWAY PROJECT	MAP 21 = 0.28 MI.
LENGTH OF ROADWAY PROJECT	MAP 22 = 0.88 MI.
LENGTH OF ROADWAY PROJECT	MAP 23 = 0.64 MI.

Prepared in the Office of:  
**DIVISION OF HIGHWAYS**  
 113 Airport Dr., Edenton NC, 27932

2012 STANDARD SPECIFICATIONS

LETTING DATE: \_\_\_\_\_

W.B. HOBBS, P.E.  
 DIVISION PROJECT MANAGER

C.E. SLACHTA  
 DIVISION PROPOSALS ENGINEER

**DIVISION OF HIGHWAYS**  
 STATE OF NORTH CAROLINA

DRAWN BY: JWC