

10/03/13

CONTRACT NO.: DA00238 WBS ELEMENT: ICR.10701.6, ETC.

NTS

STATE OF NORTH CAROLINA
DIVISION OF HIGHWAYS

PASQUOTANK COUNTY

LOCATION:

- MAP 1 US 17 BUSINESS FROM KNOBBS CREEK BRIDGE TO NC 344
- MAP 2 SR 1376 DOGWOOD TRL FROM SR 1372 TO DEAD END
- MAP 3 SR 1376 DOGWOOD TRL FROM SR 1372 TO SR 1376
- MAP 4 SR 1433 L&M DR FROM SR 1332 TO SR 1434
- MAP 5 SR 1434 L&M DR FROM CUL-DE-SAC TO CUL-DE-SAC
- MAP 6 SR 1437 VINE ST FROM US 17 TO DEAD END
- MAP 10 SR 1397 COUNTRY CLUB DR FROM US 17 TO SR 1438
- MAP 11 SR 1438 CADDY LANE FROM SR 1397 TO DEAD END

TYPE OF WORK: MILLING, RESURFACING & PAVEMENT MARKINGS

STATE	STATE PROJECT REFERENCE NO.	SHEET NO.	TOTAL SHEETS
N.C.	1CR.10701.6, ETC.	1	11
STATE PROJ. NO.	F.A. PROJ. NO.	DESCRIPTION	
1CR.10701.6		MAP 1	
1CR.20701.106		MAP 2	
1CR.20701.107		MAP 3	
1SP.20705.5		MAP 4	
1SP.20705.6		MAP 5	
1SP.20705.7		MAP 6	
1SP.20705.11		MAP 10	
1SP.20705.12		MAP 11	

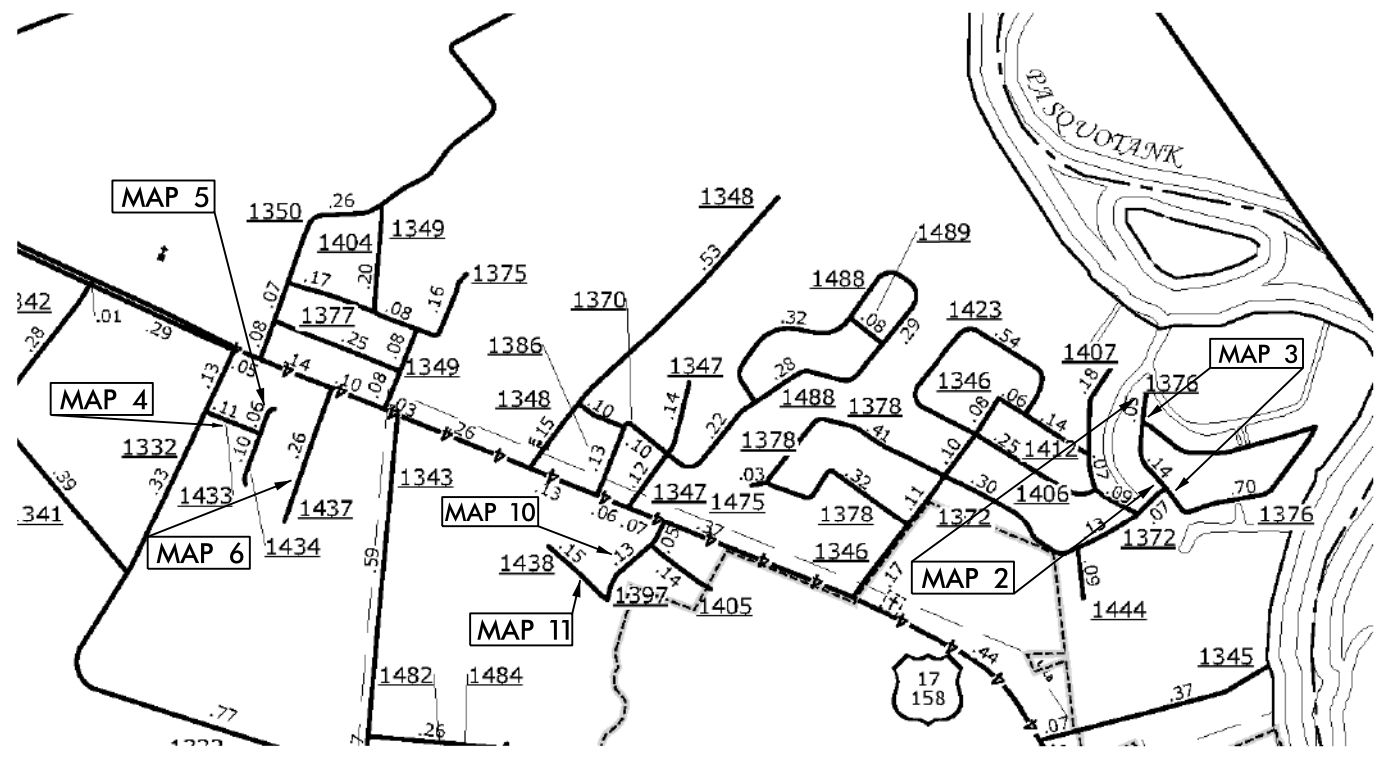
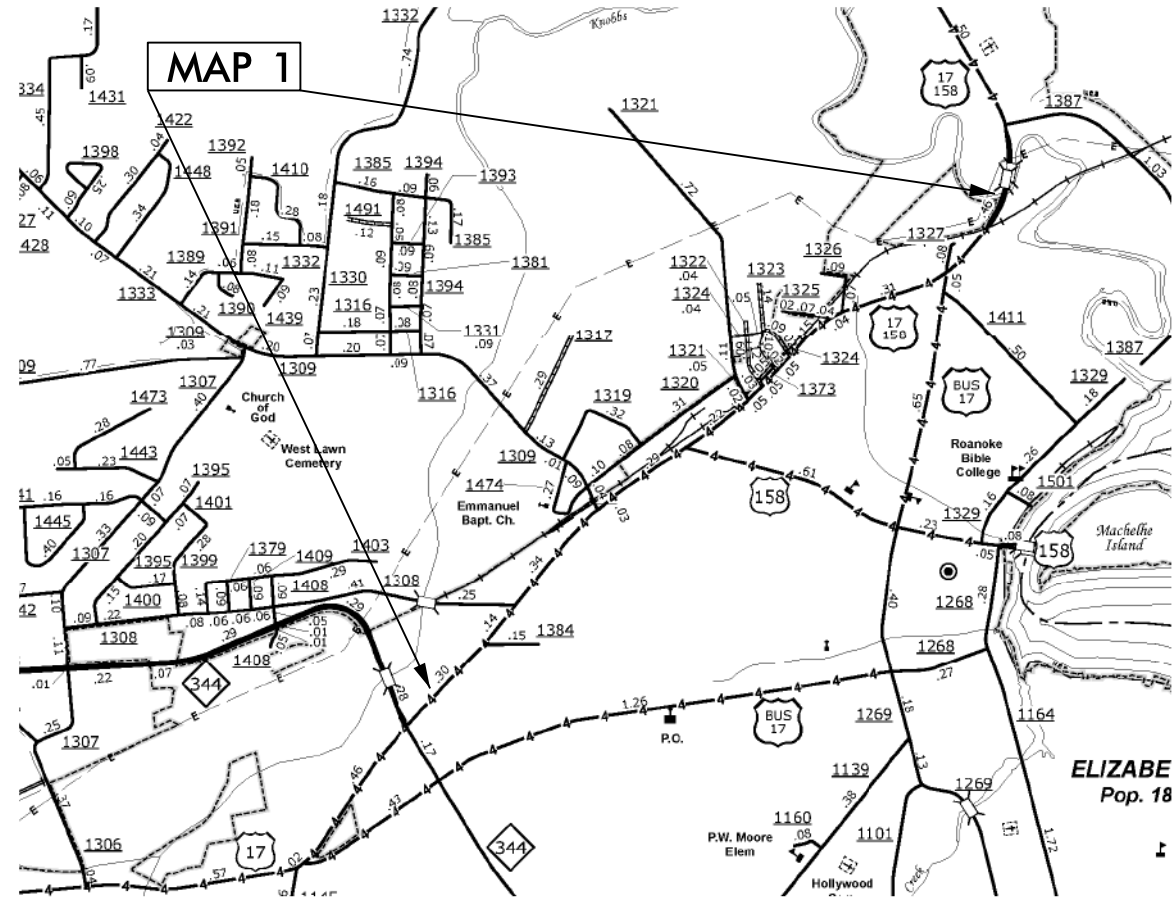

PROJECT LENGTH

LENGTH OF ROADWAY PROJECT MAP 1 = 1.93 MI.
 LENGTH OF ROADWAY PROJECT MAP 2 = 0.18 MI.
 LENGTH OF ROADWAY PROJECT MAP 3 = 0.69 MI.
 LENGTH OF ROADWAY PROJECT MAP 4 = 0.11 MI.
 LENGTH OF ROADWAY PROJECT MAP 5 = 0.19 MI.
 LENGTH OF ROADWAY PROJECT MAP 6 = 0.25 MI.

LENGTH OF ROADWAY PROJECT MAP 10 = 0.19 MI.
 LENGTH OF ROADWAY PROJECT MAP 11 = 0.14 MI.

Prepared in the Office of:
DIVISION OF HIGHWAYS

113 Airport Dr., Edenton NC, 27932

2012 STANDARD SPECIFICATIONS

LETTING DATE:

W.B. HOBBS, P.E.
DIVISION PROJECT MANAGER

C.E. SLACHTA
DIVISION PROPOSALS ENGINEER

DIVISION OF HIGHWAYS
STATE OF NORTH CAROLINA

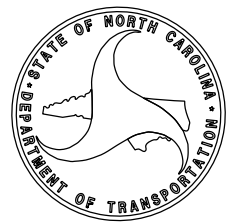

DRAWN BY: JWC

10/03/13

CONTRACT NO.: DA00238 WBS ELEMENT: ICR.10701.6, ETC.

NTS

STATE OF NORTH CAROLINA
DIVISION OF HIGHWAYS

PASQUOTANK COUNTY

STATE	STATE PROJECT REFERENCE NO.	SHEET NO.	TOTAL SHEETS
N.C.	1CR.10701.6, ETC.	2	11
STATE PROJ. NO.	F.A. PROJ. NO.	DESCRIPTION	
ISP.20705.8		MAP 7	
ISP.20705.9		MAP 8	
ISP.20705.10		MAP 9	
ISP.20705.13		MAP 12	
ISP.20705.14		MAP 13	
ISP.20705.15		MAP 14	
ISP.20705.16		MAP 15	
ISP.20705.17		MAP 16	
ISP.20705.24		MAP 17	
ISP.20705.25		MAP 18	
ISP.20705.26		MAP 19	

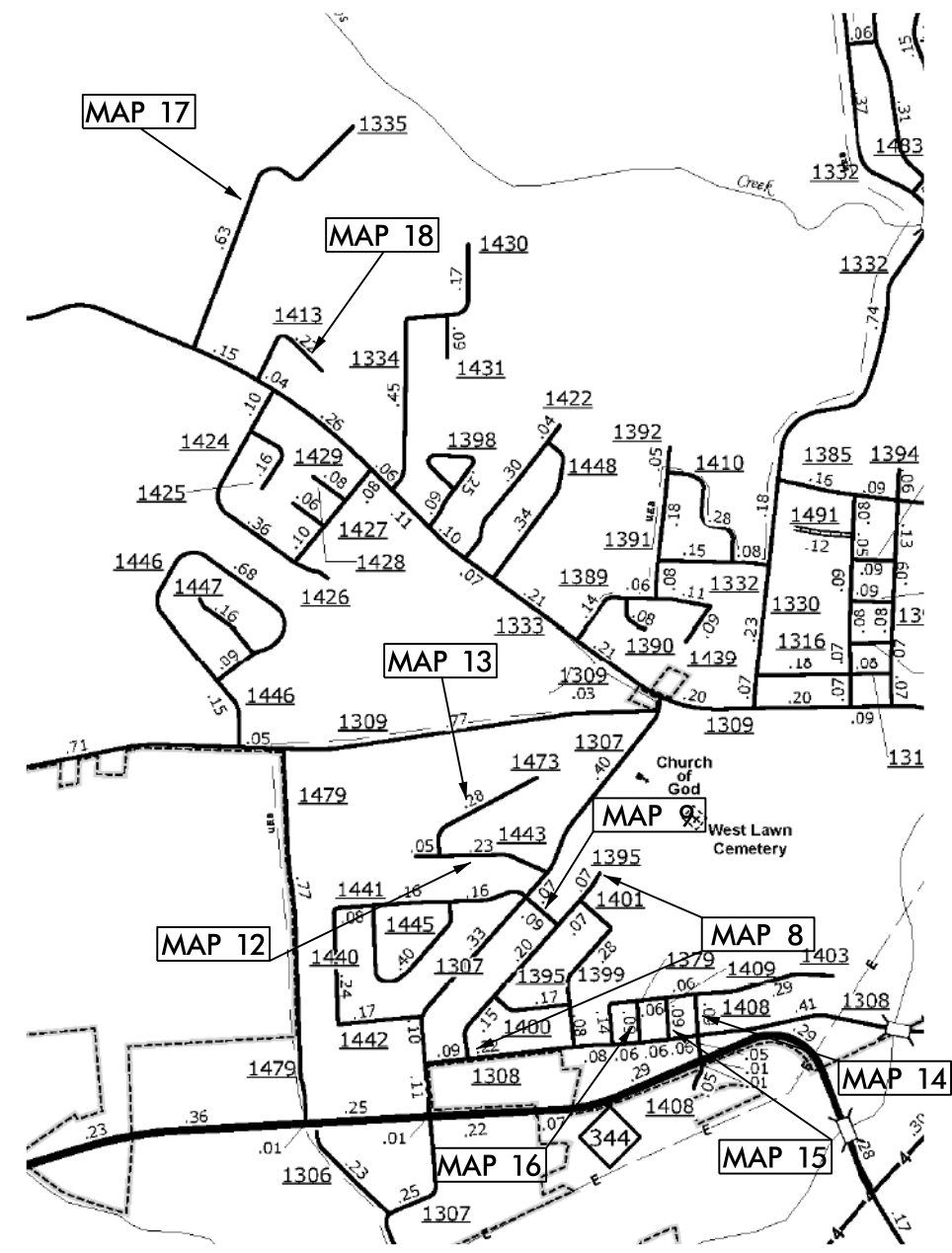

LOCATION:

- MAP 7 SR 1402 HAWTHORNE DR FROM SR 1338 TO SR 1338
- MAP 8 SR 1395 ALTON ST FROM SR 1308 TO DEAD END
- MAP 9 SR 1396 GENE ST FROM SR 1307 TO SR 1395
- MAP 12 SR 1443 RED GATE DR FROM SR 1307 TO DEAD END
- MAP 13 SR 1473 WILLIS DR FROM SR 1443 TO DEAD END
- MAP 14 SR 1408 RIDGEFIELD DR FROM SR 1403 TO SR 1308
- MAP 15 SR 1409 CLEARVIEW DR FROM SR 1403 TO SR 1308
- MAP 16 SR 1379 COSMO DR FROM SR 1403 TO SR 1308
- MAP 17 SR 1335 SHILLINGTON RD FROM SR 1333 TO DEAD END
- MAP 18 SR 1413 POWERS DR FROM SR 1333 TO DEAD END
- MAP 19 SR 1414 GEMINI ST FROM SR 1351 TO DEAD END

TYPE OF WORK: MILLING, RESURFACING & PAVEMENT MARKINGS

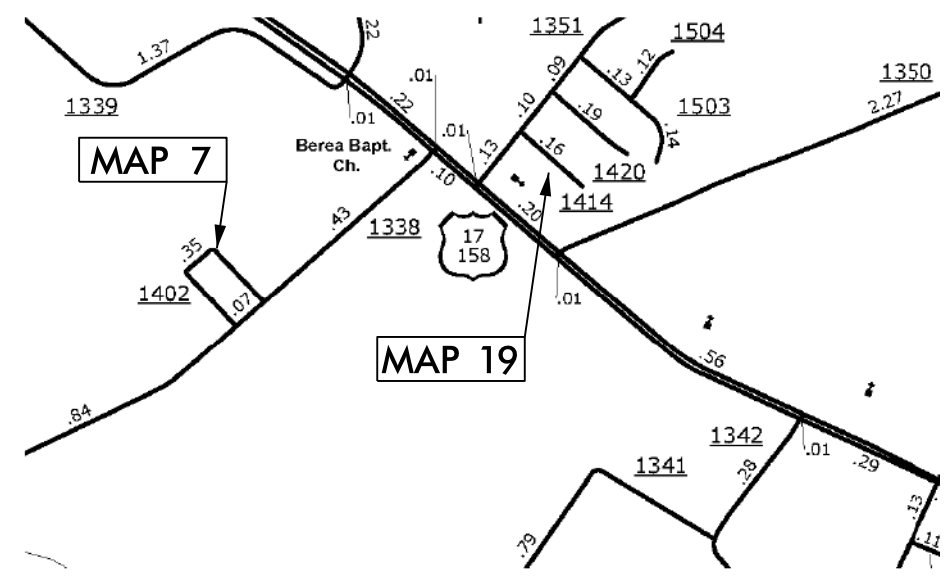

PROJECT LENGTH

LENGTH OF ROADWAY PROJECT MAP 7 = 0.34 MI.
 LENGTH OF ROADWAY PROJECT MAP 8 = 0.47 MI.
 LENGTH OF ROADWAY PROJECT MAP 9 = 0.09 MI.
 LENGTH OF ROADWAY PROJECT MAP 12 = 0.28 MI.
 LENGTH OF ROADWAY PROJECT MAP 13 = 0.27 MI.
 LENGTH OF ROADWAY PROJECT MAP 14 = 0.08 MI.

LENGTH OF ROADWAY PROJECT MAP 15 = 0.08 MI.
 LENGTH OF ROADWAY PROJECT MAP 16 = 0.08 MI.
 LENGTH OF ROADWAY PROJECT MAP 17 = 0.60 MI.
 LENGTH OF ROADWAY PROJECT MAP 18 = 0.22 MI.
 LENGTH OF ROADWAY PROJECT MAP 19 = 0.15 MI.

Prepared in the Office of:
DIVISION OF HIGHWAYS
113 Airport Dr., Edenton NC, 27932

2012 STANDARD SPECIFICATIONS

LETTING DATE:

W.B. HOBBS, P.E.
DIVISION PROJECT MANAGER

C.E. SLACHTA
DIVISION PROPOSALS ENGINEER

DIVISION OF HIGHWAYS
STATE OF NORTH CAROLINA

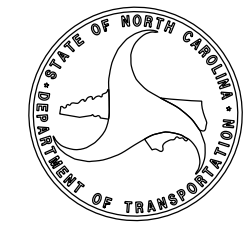

DRAWN BY: JWC

C O N T R A C T P A V E M E N T S C H E D U L E

C1	PROP. APPROX. 1½" ASPHALT CONCRETE SURFACE COURSE, TYPE S9.5B, AT AN AVERAGE RATE OF 168 LBS. PER SQ. YD.
C2	PROP. APPROX. 1¼" ASPHALT CONCRETE SURFACE COURSE, TYPE SF9.5A, AT AN AVERAGE RATE OF 137.5 LBS. PER SQ. YD.
C3	PROP. APPROX. ¾" ASPHALT CONCRETE SURFACE COURSE, TYPE S4.75A, AT AN AVERAGE RATE OF 75 LBS. PER SQ. YD.
V1	MILLING BITUMINOUS PAVEMENT. 1½" DEPTH.
U	EXISTING PAVEMENT.

5/14/99

PAVEMENT SCHEDULE

PROJECT REFERENCE NO.	SHEET NO.
1CR.10701.6, ETC.	4

C1	PROP. APPROX. 1½" ASPHALT CONCRETE SURFACE COURSE, TYPE S9.5B, AT AN AVERAGE RATE OF 168 LBS. PER SQ. YD.
U	EXISTING PAVEMENT.
V	MILLING BITUMINOUS PAVEMENT. 1½" DEPTH.

NOTES:

*ALL PAVED S.R. ROADS TO BE RESURFACED TO THE ENDS OF THE RADII, OR AS DIRECTED BY THE ENGINEER

*EDGES, PAVEMENT WIDENING, INTERSECTIONS, AND BRIDGE FLARES ARE INCLUDED IN THE TABLE OF QUANTITIES

*SHOULDERS TO BE RECONSTRUCTED BY OTHERS

* TRAFFIC LOOPS SHALL BE INSTALLED PRIOR TO THE FINAL LIFT OF SURFACE LAYED

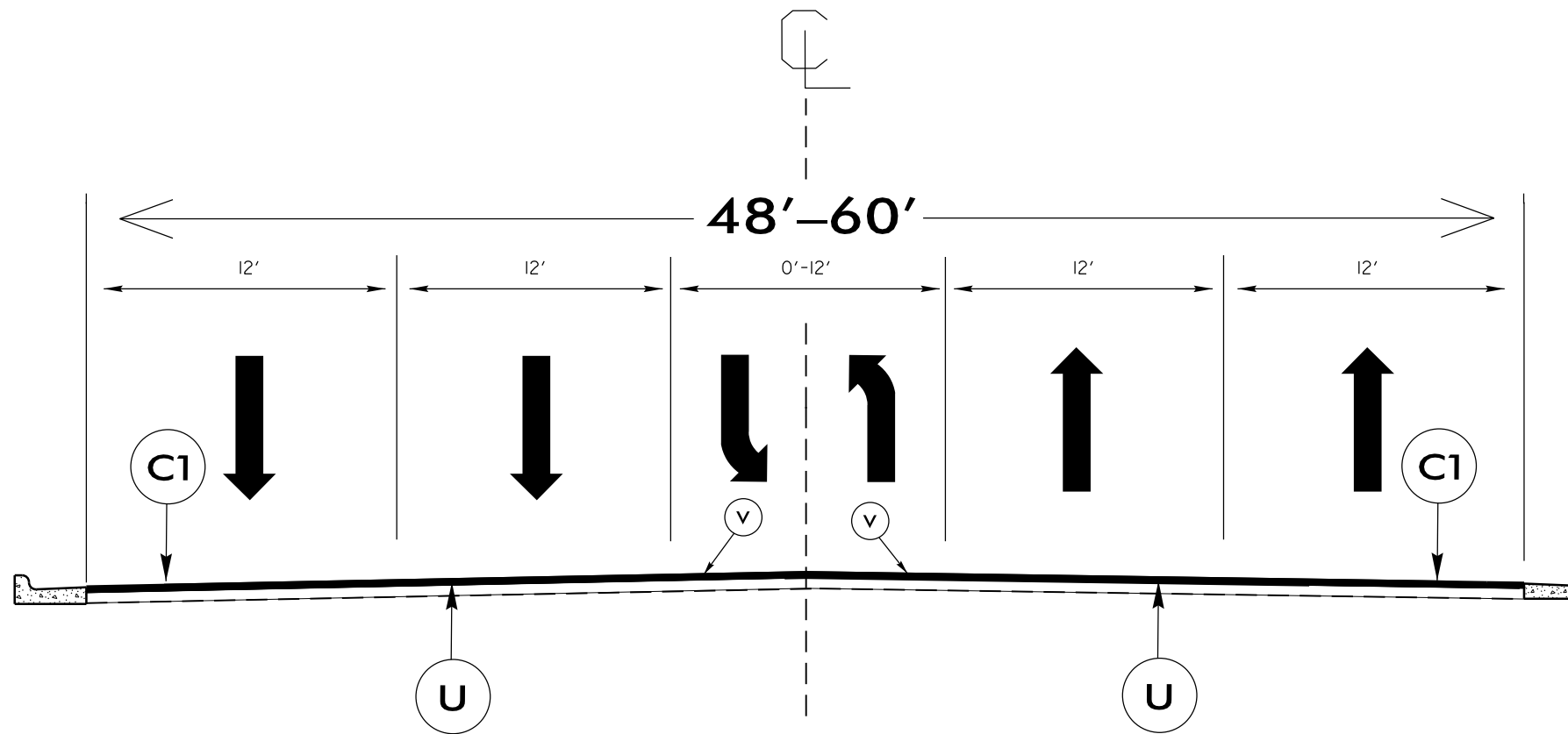

TYPICAL SECTION NO.1

USE WITH MAP 1

NTS

13-FEB-2015 11:21
s:\projects\10701\10701.dwg
10701.dwg

P A V E M E N T S C H E D U L E

C2	PROP. APPROX. 1 1/4" ASPHALT CONCRETE SURFACE COURSE, TYPE SF9.5A, AT AN AVERAGE RATE OF 137.5 LBS. PER SQ. YD.
U	EXISTING PAVEMENT.

PROJECT REFERENCE NO.	SHEET NO.
1CR.10701.6, ETC.	5

NOTES:

- *ALL PAVED S.R. ROADS TO BE RESURFACED TO THE ENDS OF THE RADII, OR AS DIRECTED BY THE ENGINEER
- *EDGES, PAVEMENT WIDENING, INTERSECTIONS, AND BRIDGE FLARES ARE INCLUDED IN THE TABLE OF QUANTITIES
- *SHOULDERS TO BE RECONSTRUCTED BY OTHERS

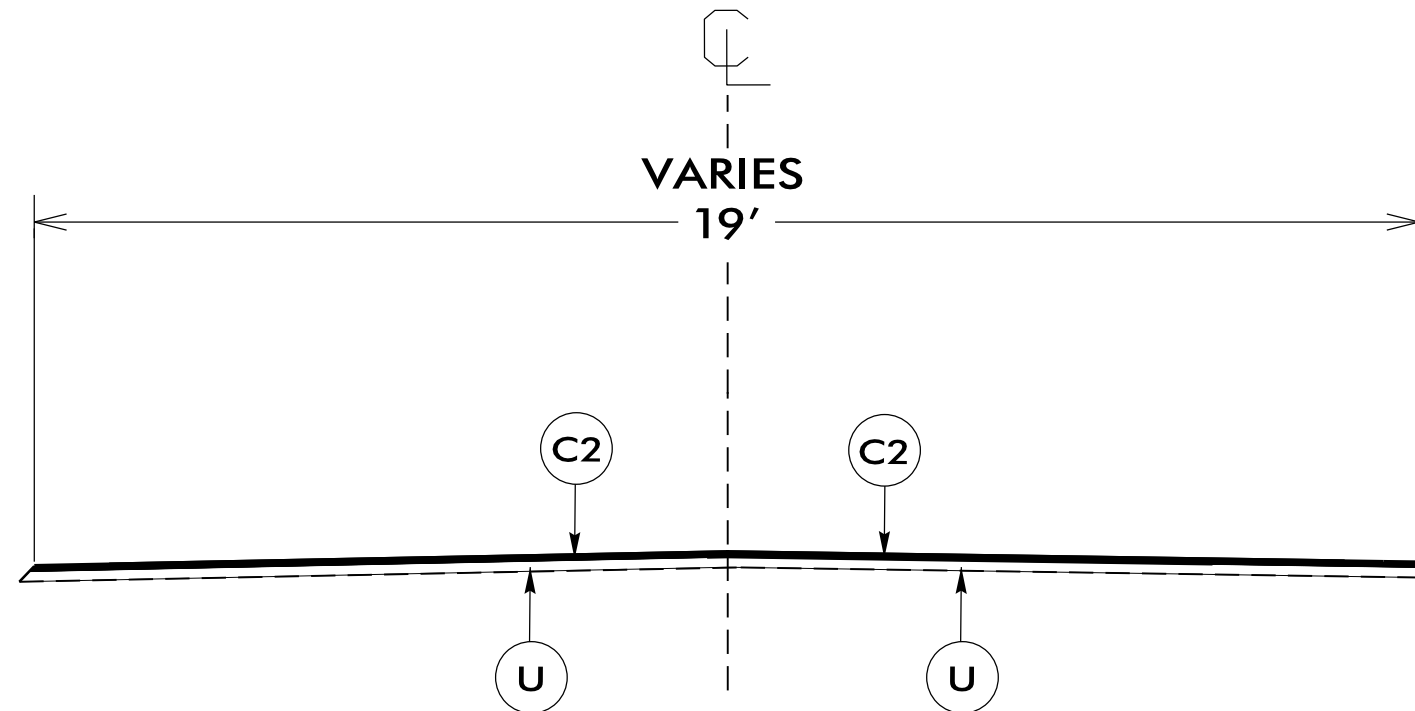

TYPICAL SECTION NO. 2

USE WITH MAP 2 , 3

NTS

PAVEMENT SCHEDULE

C3	PROP. APPROX. 3/4" ASPHALT CONCRETE SURFACE COURSE, TYPE S4.75A, AT AN AVERAGE RATE OF 75 LBS. PER SQ. YD.
U	EXISTING PAVEMENT.

PROJECT REFERENCE NO.	SHEET NO.
1CR.10701.6, ETC.	6

NOTES:

*ALL PAVED S.R. ROADS TO BE RESURFACED TO THE ENDS OF THE RADII, OR AS DIRECTED BY THE ENGINEER

*EDGES, PAVEMENT WIDENING, INTERSECTIONS, AND BRIDGE FLARES ARE INCLUDED IN THE TABLE OF QUANTITIES

*SHOULDERS TO BE RECONSTRUCTED BY OTHERS

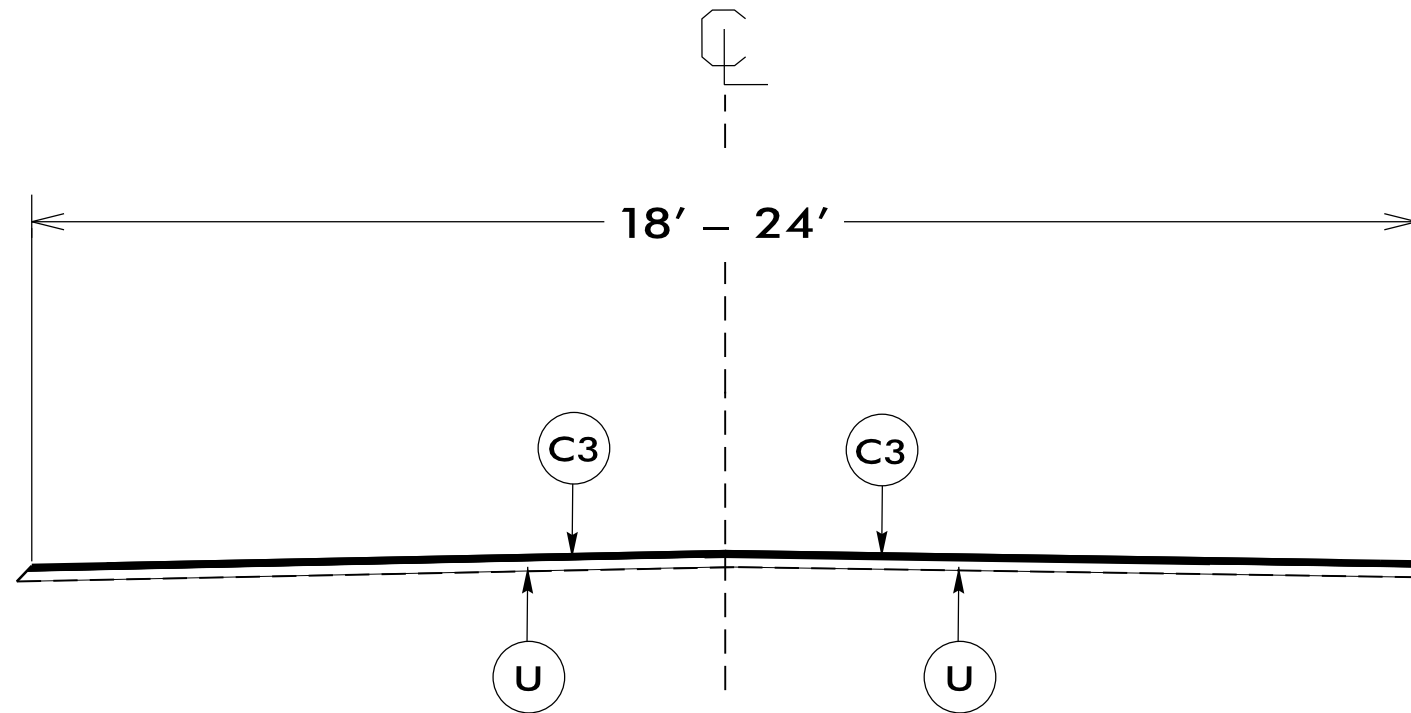

TYPICAL SECTION NO. 3

USE WITH MAP 4 - 19

NTS

- NOTES:
 1) DETAIL DOES NOT APPLY TO OGAFc AND ULTRA-THIN BONDED WEARING COURSE.
 2) BACKFILL SHOULDER WITH APPROVED MATERIAL.
 3) THE SHOULDER WEDGE DEVICE MAY BE DISENGAGED AT PAVED DRIVEWAYS AND SIDE STREETS.

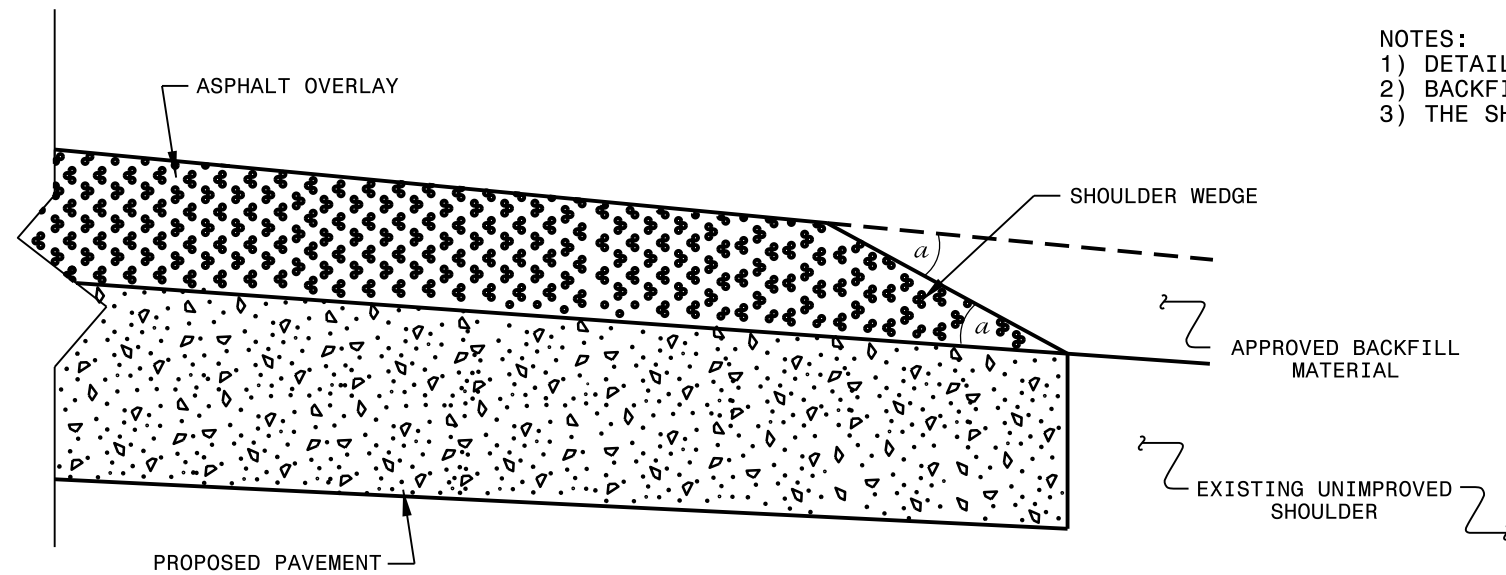

SHOULDER WEDGE DETAIL
 (Resurfacing Projects w/ Widening or
 with Existing Paved Shoulder having no dropoffs)

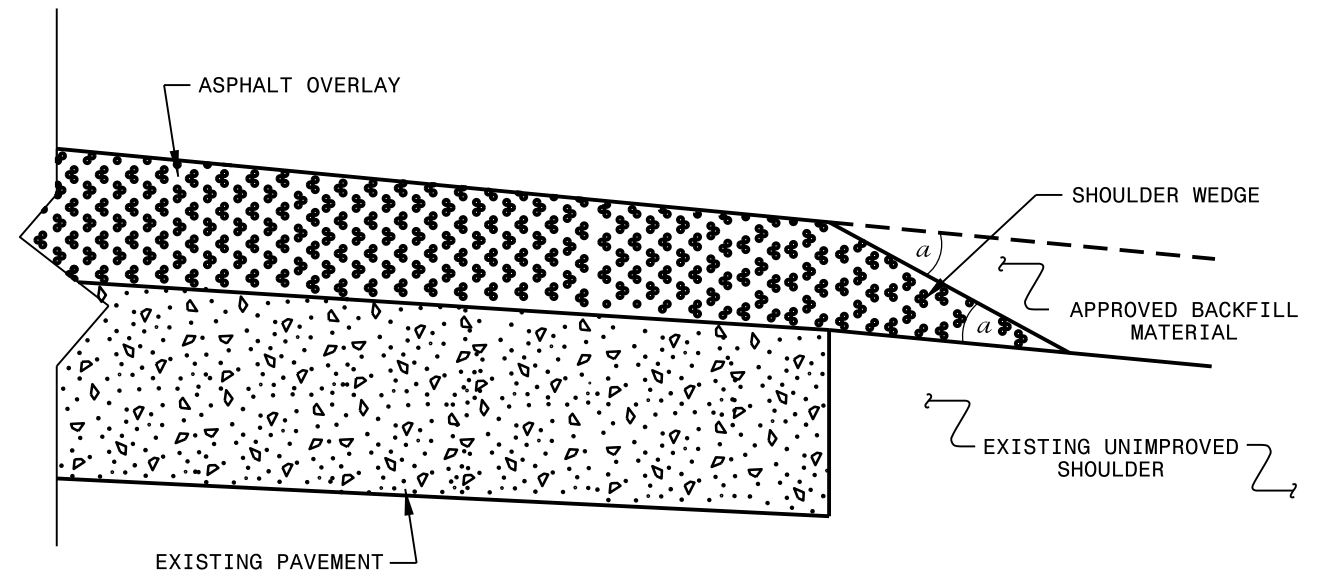

SHOULDER WEDGE DETAIL
 (Resurfacing Projects w/ NO Widening)

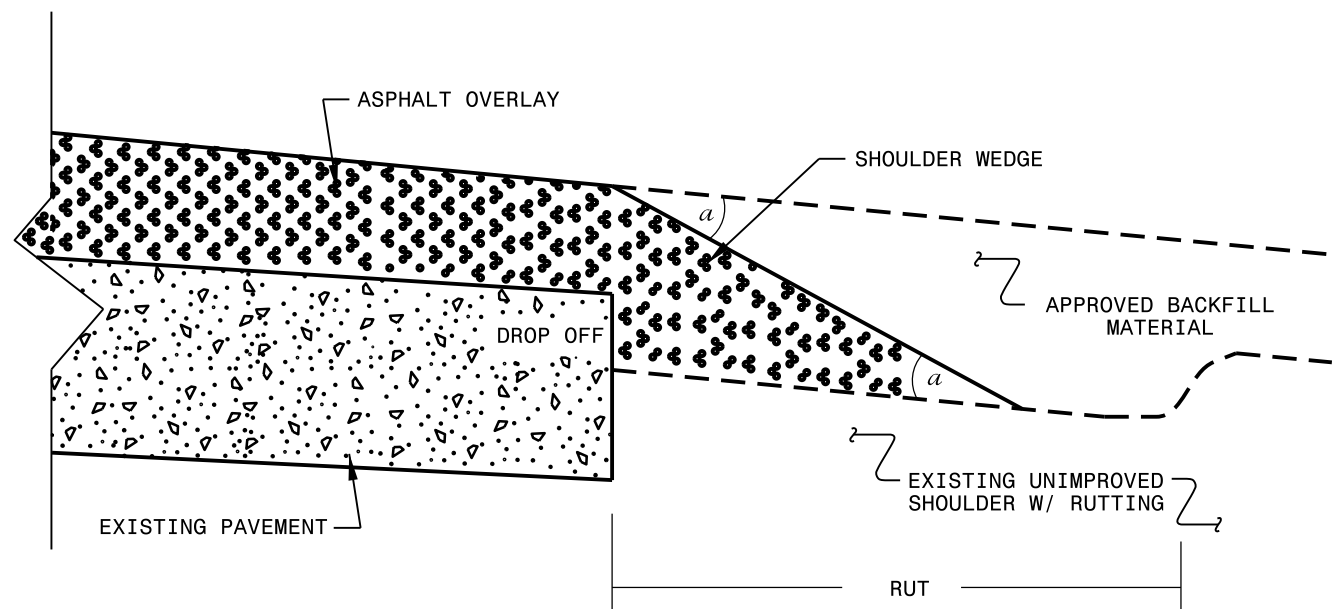

SHOULDER WEDGE DETAIL
 (Resurfacing Adjacent to
 Rutted Shoulder)

- SHOULDER WEDGE ANGLE = 30°

CONTRACT STANDARDS AND DEVELOPMENT UNIT	
Office 919-707-6950	FAX 919-250-4119
SHOULDER WEDGE DETAILS	
ORIGINAL BY: T.SPELL	DATE: 7-19-11
MODIFIED BY:	DATE: 10/16/12
CHECKED BY:	DATE:
FILE SPEC.: s:\usr\details\stand\shoulderwedgedetail.dgn	

SIGNING FOR RESURFACING PROJECTS

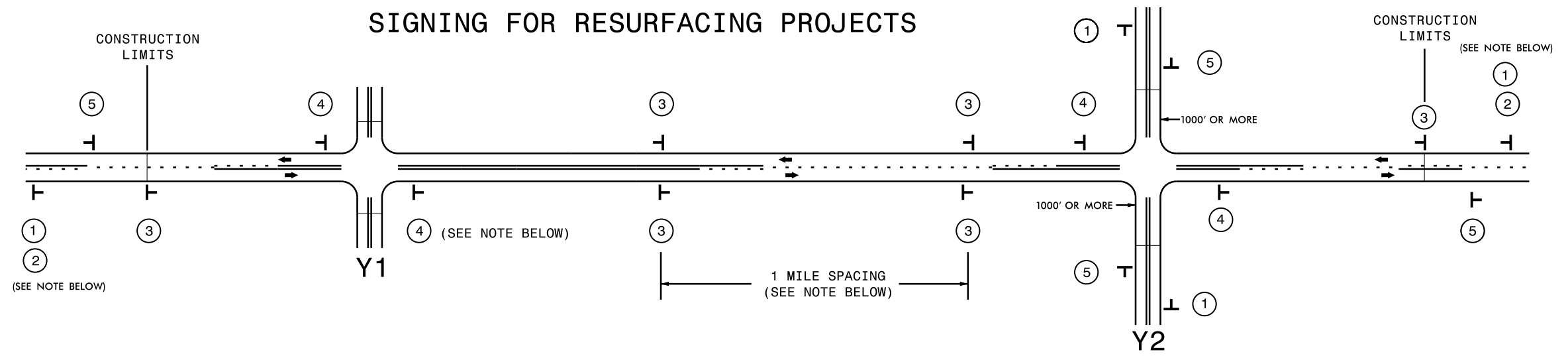

LEGEND	
T	STATIONARY SIGN
←	DIRECTION OF TRAFFIC FLOW

MAINLINE (-L-) SIGNING

-Y- LINE SIGNING

SIGNING NOTES AND PLACEMENT PER DIRECTION		
1 2		<p>PLACE 1000' PRIOR TO BEGINNING OF CONSTRUCTION LIMITS. ONLY USED ON -Y- LINES IF RESURFACING LIMITS EXTEND 1000' ALONG -Y- LINE.</p> <p>2) SUBDIVISION ROADS</p> <p>3) DEAD END ROADS</p>
3		<p>WHEN PAVING/CONSTRUCTION ACTIVITIES PROCEED ACROSS AN UNSIGNED -Y- LINE, ADVANCE WARNING PORTABLE SIGNS SHALL BE USED ALONG THE -Y- LINE AS SHOWN BELOW. REMOVE UPON COMPLETION OF WORK.</p>
4		<p>PLACED 500' IN ADVANCE OF FLAGGER. PLACED 250' IN ADVANCE OF FLAGGER.</p>
5		

13-FEB-2015 11:30
 \\D:\cadd\4931\13-01\Drawings\Resurfacing\AdvWarn_2Ln.dgn
 jccody AT D:\CADD\2651784

**RESURFACING
ADVANCE WARNING SIGNS
FOR
RURAL AND SUBURBAN
2 LANE ROADWAYS**

PROJECT NO.	SHEET NO.	TOTAL NO.
1CR.10701.6, ETC	10	11

SUMMARY OF QUANTITIES

PROJECT NO	COUNTY	MAP NO	ROUTE	DESCRIPTION	TYP	LANES	LANE TYPE	FINAL SURFACE TESTING REQUIRED	WARM MIX ASPHALT REQUIRED	LENGTH MI	WIDTH FT	MOBILIZATION LS	REMOVAL OF EXISTING CONCRETE PAVEMENT SY	INCIDENTAL STONE BASE TONS	1 1/2" MILLING SY	SURFACE COURSE, S9.5B TONS	SURFACE COURSE, SF9.5A TONS	SURFACE COURSE, S4.75A TONS	ASPHALT BINDER FOR PLANT MIX TONS	AC PLANT MIX (REPAIR) TONS	MASONRY DRAINAGE STRUCTURES EA	FRAME WITH COVER, STD 840.54 EA	2'-6" CURB & GUTTER LF	CONCRETE CURB RAMPS EA	ADJ. OF MANHOLES EA	ADJ. OF METER OR VALVE BOX EA	INDUCTIVE LOOP SAWCUT LF	LEAD-IN CABLE LF	REMOVAL OF EXISTING STRUCTURES AT STATION 10+75 LS	
1CR.10701.6	Pasquotank	1	US 17 BUSINESS	FROM KNOBBS CREEK BRIDGE TO NC 344	1	2	M2	NO	NO	1.93	60	1	500	40	67,550	6,001			360	100	5	5	320	6	15	8	5,950	1,000	1	
1CR.20701.106	Pasquotank	2	SR1376 DOGWOOD	FROM SR 1372 TO DEAD END	2	2	2WU	NO	NO	0.18	19	*		2			122		8											
1CR.20701.107	Pasquotank	3	SR 1376 DOGWOOD TRAIL	FROM SR 1372 TO SR 1376	2	2	2WU	NO	NO	0.69	19	*		2			467		31											
1SP.20705.5	Pasquotank	4	SR 1433 L&M DR	FROM SR 1332 TO SR 1434	3	2	2WU	NO	NO	0.11	18	*		2				53	4											
1SP.20705.6	Pasquotank	5	SR 1434 L&M DR	FROM CUL-DE-SAC TO CUL-DE-SAC	3	2	2WU	NO	NO	0.19	18	*		6				109	7											
1SP.20705.7	Pasquotank	6	SR 1437 VINE ST	FROM US 17 TO DEAD END	3	2	2WU	NO	NO	0.25	20	*		12				149	10											
1SP.20705.8	Pasquotank	7	SR 1402 HAWTHORNE DR	FROM SR 1338 TO SR 1338	3	2	2WU	NO	NO	0.34	18	*		5				156	11											
1SP.20705.9	Pasquotank	8	SR1395 ALTON ST	FROM SR 1308 TO DEAD END	3	2	2WU	NO	NO	0.47	22	*		2				285	19											
1SP.20705.10	Pasquotank	9	SR 1396 GENE ST	FROM SR 1307 TO SR 1395	3	2	2WU	NO	NO	0.09	22	*		2				50	3											
1SP.20705.11	Pasquotank	10	SR 1397 COUNTRY CLUB DR	FROM US 17 TO SR 1438	3	2	2WU	NO	NO	0.19	18	*		2				79	5											
1SP.20705.12	Pasquotank	11	SR 1438 CADDY LANE	FROM SR 1397 TO DEAD END	3	2	2WU	NO	NO	0.14	18	*		2				64	4											
1SP.20705.13	Pasquotank	12	SR 1443 RED GATE DR	FROM SR 1307 TO DEAD END	3	2	2WU	NO	NO	0.28	24	*		2				193	13											
1SP.20705.14	Pasquotank	13	SR 1473 WILLIS DR	FROM SR 1443 TO DEAD END	3	2	2WU	NO	NO	0.27	24	*		2				165	11											
1SP.20705.15	Pasquotank	14	SR 1408 RIDGEFIELD DR	FROM SR 1403 TO SR 1308	3	2	2WU	NO	NO	0.08	19	*		2				39	3											
1SP.20705.16	Pasquotank	15	SR 1409 CLEARVIEW DR	SR 1403 TO SR 1308	3	2	2WU	NO	NO	0.08	18	*		2				39	3											
1SP.20705.17	Pasquotank	16	SR 1379 COSMO DR	FROM SR 1403 TO SR 1308	3	2	2WU	NO	NO	0.08	18	*		2				37	2											
1SP.20705.24	Pasquotank	17	SR 1335 SHILLINGTON RD	FROM SR 1333 TO DEAD END	3	2	2WU	NO	NO	0.60	19.5	*		30				315	21											
1SP.20705.25	Pasquotank	18	SR 1413 POWERS DR	FROM SR 1333 TO DEAD END	3	2	2WU	NO	NO	0.22	21	*		2				118	8											
1SP.20705.26	Pasquotank	19	SR 1414 GEMINI ST	FROM SR 1351 TO DEAD END	3	2	2WU	NO	NO	0.15	18	*		8				69	5											
GRAND TOTAL										6.34		1	500	127	67,550	6,001	589	1,920	528	100	5	5	320	6	15	8	5,950	1,000	1	

PROJECT NO.	SHEET NO.	TOTAL NO.
1CR.10701.6, ETC	11	11

THERMOPLASTIC AND PAINT QUANTITIES

PROJECT NO	COUNTY	MAP NO	ROUTE	DESCRIPTION	TYP	LANES	LANE TYPE	LENGTH	WIDTH	TEMPORARY TRAFFIC CONTROL	WORK ZONE SIGNS (STATIONARY)	4" X 120 M WHITE THERMO	4" X 120 M YELLOW THERMO	16" X 120 M WHITE THERMO	24" X 120 M WHITE THERMO	THERMO RXR 120 M	THERMO STR & RT ARROW 90 M	THERMO LT ARROW 90 M	THERMO RT ARROW 90 M	THERMO STR ARROW 90 M	4" WHITE PAINT	4" YELLOW PAINT	16" WHITE PAINT	24" WHITE PAINT	PAINT MSG RXR	PAINT LT ARROW	PAINT STR ARROW	PAINT RT ARROW	PAINT STR & RT ARROW	PERMANENT RAISED PAVEMENT MARKERS
										LS	SF	LF	LF	LF	LF	EA	EA	EA	EA	EA	LF	LF	LF	LF	EA	EA	EA	EA	EA	EA
1CR.10701.6	Pasquotank	1	US 17 BUSINESS	FROM KNOBBS CREEK BRIDGE TO NC 344	1	2	M2	1.93	60	1	200	6,110	20,000	50	300	2	4	50	2	40	12,020	40,000	50	300	2	100	80	4	8	200
1CR.20701.106	Pasquotank	2	SR1376 DOGWOOD	FROM SR 1372 TO DEAD END	2	2	2WU	0.18	19	*																				
1CR.20701.107	Pasquotank	3	SR 1376 DOGWOOD TRAIL	FROM SR 1372 TO SR 1376	2	2	2WU	0.69	19	*																				
1SP.20705.5	Pasquotank	4	SR 1433 L&M DR	FROM SR 1332 TO SR 1434	3	2	2WU	0.11	18	*																				
1SP.20705.6	Pasquotank	5	SR 1434 L&M DR	FROM CUL-DE-SAC TO CUL-DE-SAC	3	2	2WU	0.19	18	*																				
1SP.20705.7	Pasquotank	6	SR 1437 VINE ST	FROM US 17 TO DEAD END	3	2	2WU	0.25	20	*																				
1SP.20705.8	Pasquotank	7	SR 1402 HAWTHORNE DR	FROM SR 1338 TO SR 1338	3	2	2WU	0.34	18	*																				
1SP.20705.9	Pasquotank	8	SR1395 ALTON ST	FROM SR 1308 TO DEAD END	3	2	2WU	0.47	22	*																				
1SP.20705.10	Pasquotank	9	SR 1396 GENE ST	FROM SR 1307 TO SR 1395	3	2	2WU	0.09	22	*																				
1SP.20705.11	Pasquotank	10	SR 1397 COUNTRY CLUB DR	FROM US 17 TO SR 1438	3	2	2WU	0.19	18	*																				
1SP.20705.12	Pasquotank	11	SR 1438 CADDY LANE	FROM SR 1397 TO DEAD END	3	2	2WU	0.14	18	*																				
1SP.20705.13	Pasquotank	12	SR 1443 RED GATE DR	FROM SR 1307 TO DEAD END	3	2	2WU	0.28	24	*																				
1SP.20705.14	Pasquotank	13	SR 1473 WILLIS DR	FROM SR 1443 TO DEAD END	3	2	2WU	0.27	24	*																				
1SP.20705.15	Pasquotank	14	SR 1408 RIDGEFIELD DR	FROM SR 1403 TO SR 1308	3	2	2WU	0.08	19	*																				
1SP.20705.16	Pasquotank	15	SR 1409 CLEARVIEW DR	SR 1403 TO SR 1308	3	2	2WU	0.08	18	*																				
1SP.20705.17	Pasquotank	16	SR 1379 COSMO DR	FROM SR 1403 TO SR 1308	3	2	2WU	0.08	18	*																				
1SP.20705.24	Pasquotank	17	SR 1335 SHILLINGTON RD	FROM SR 1333 TO DEAD END	3	2	2WU	0.60	19.5	*																				
1SP.20705.25	Pasquotank	18	SR 1413 POWERS DR	FROM SR 1333 TO DEAD END	3	2	2WU	0.22	21	*																				
1SP.20705.26	Pasquotank	19	SR 1414 GEMINI ST	FROM SR 1351 TO DEAD END	3	2	2WU	0.15	18	*																				
GRAND TOTAL								6.34		1	200	6,110	20,000	50	300	2	4	50	2	40	12,020	40,000	50	300	2	100	80	4	8	200
												26,110						96			52,020					392				