

09/08/99

08-JAN-2016 14:41
C:\Division Main\tenance\AST Contracts 16-17\Northampton\DA00288_psh.dgn
dstallings AT DICAD265782

CONTRACT: DA00288 WBS PROJECT: 2016CPT.01.14.20662.1

STATE OF NORTH CAROLINA
DIVISION OF HIGHWAYS

NORTHAMPTON COUNTY

STATE	STATE PROJECT REFERENCE NO.	SHEET NO.	TOTAL SHEETS
N.C.	2016CPT.01.14.20662.1	1	
STATE PROJ. NO.	F. A. PROJ. NO.	DESCRIPTION	
2016CPT.01.14.20662.1		MAP 1	
2016CPT.01.14.20662.1		MAP 2	
2016CPT.01.14.20662.1		MAP 3	
2016CPT.01.14.20662.1		MAP 4	
2016CPT.01.14.20662.1		MAP 5	
2016CPT.01.14.20662.1		MAP 6	
2016CPT.01.14.20662.1		MAP 7	
2016CPT.01.14.20662.1		MAP 8	

LOCATION: MAP #1 SR 1517 FROM SR 1516 TO SR 1501
 MAP #2 SR 1514 FROM SR 1503 TO SR 1502
 MAP #3 SR 1519 FROM SR 1503 TO SR 1514
 MAP #4 SR 1515 FROM SR 1511 TO SR 1514
 MAP #5 SR 1118 FROM NC 305 TO END OF PAVEMENT
 MAP #6 SR 1119 FROM SR 1118 TO SR 1121
 MAP #7 SR 1122 FROM NC 305 TO SR 1121
 MAP #8 SR 1123 FROM SR 1121 TO SR 1108

TYPE OF WORK: ASPHALT SURFACE TREATMENT DOUBLE SEAL

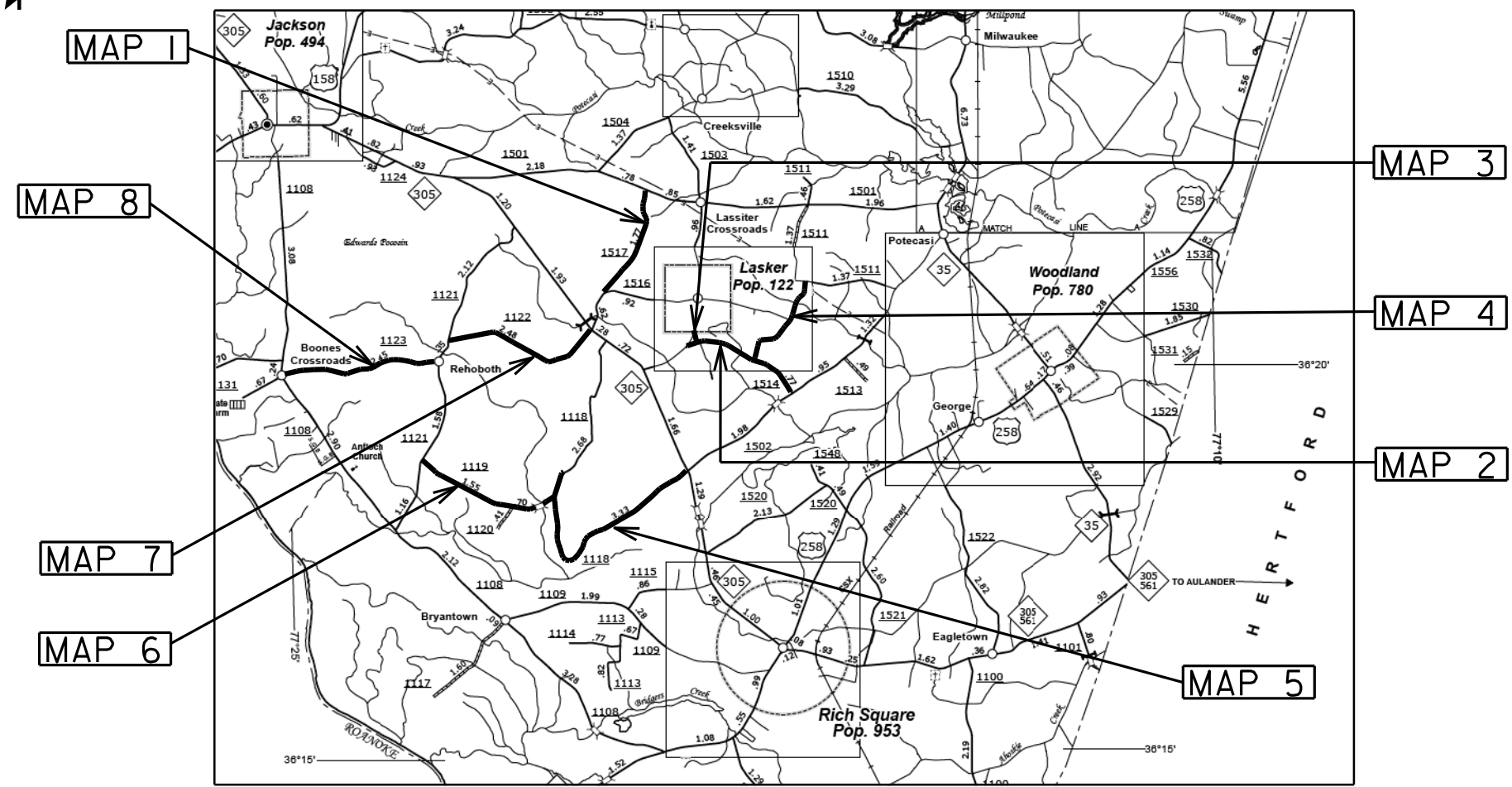

NTS

PROJECT LENGTH

- LENGTH OF ROADWAY PROJECT MAP 1 = 1.77 MI.
- LENGTH OF ROADWAY PROJECT MAP 2 = 1.88 MI.
- LENGTH OF ROADWAY PROJECT MAP 3 = 0.21 MI.
- LENGTH OF ROADWAY PROJECT MAP 4 = 1.50 MI.
- LENGTH OF ROADWAY PROJECT MAP 5 = 3.66 MI.
- LENGTH OF ROADWAY PROJECT MAP 6 = 2.25 MI.
- LENGTH OF ROADWAY PROJECT MAP 7 = 2.48 MI.
- LENGTH OF ROADWAY PROJECT MAP 8 = 2.45 MI.

Prepared in the Office of:
DIVISION OF HIGHWAYS

113 Airport Dr., Edenton NC, 27932

2012 STANDARD SPECIFICATIONS

LETTING DATE:

W.B. HOBBS, P.E.
DIVISION PROJECT MANAGER

C.E. SLACHTA
DIVISION PROPOSALS ENGINEER

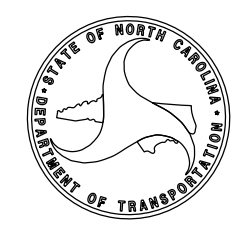

08-JAN-2016 14:43 C:\Division Main\tenance_VAST_Contracts 16-17\Northampton\DA00288.psh.dgn dinstallings AT DICAD265782

CONTRACT: DA00288 WBS PROJECT: 2016CPT.01.14.20662.1

STATE OF NORTH CAROLINA
DIVISION OF HIGHWAYS

NORTHAMPTON COUNTY

STATE	STATE PROJECT REFERENCE NO.	SHEET NO.	TOTAL SHEETS
N.C.	2016CPT.01.14.20662.1	2	
STATE PROJ. NO.	F. A. PROJ. NO.	DESCRIPTION	
2016CPT.01.14.20662.1		MAP 9	
2016CPT.01.14.20662.1		MAP 10	
2016CPT.01.14.20662.1		MAP 11	
2016CPT.01.14.20662.1		MAP 12	
2016CPT.01.14.20662.1		MAP 13	
2016CPT.01.14.20662.1		MAP 14	
2016CPT.01.14.20662.1		MAP 15	
2016CPT.01.14.20662.1		MAP 16	

LOCATION: MAP #9 SR 1115 FROM SR 1109 TO NC 305
 MAP #10 SR 1116 FROM SR 1115 TO DEAD END
 MAP #11 SR 1524 FROM US 258 TO DEAD END
 MAP #12 SR 1523 FROM SR 1522 TO US 258
 MAP #13 SR 1522 FROM NC 305 TO US 258
 MAP #14 SR 1521 FROM US 258 TO NC 305
 MAP #15 SR 1548 FROM SR 1520 TO DEAD END
 MAP #16 SR 1520 FROM NC 305 TO US 258

TYPE OF WORK: ASPHALT SURFACE TREATMENT DOUBLE SEAL

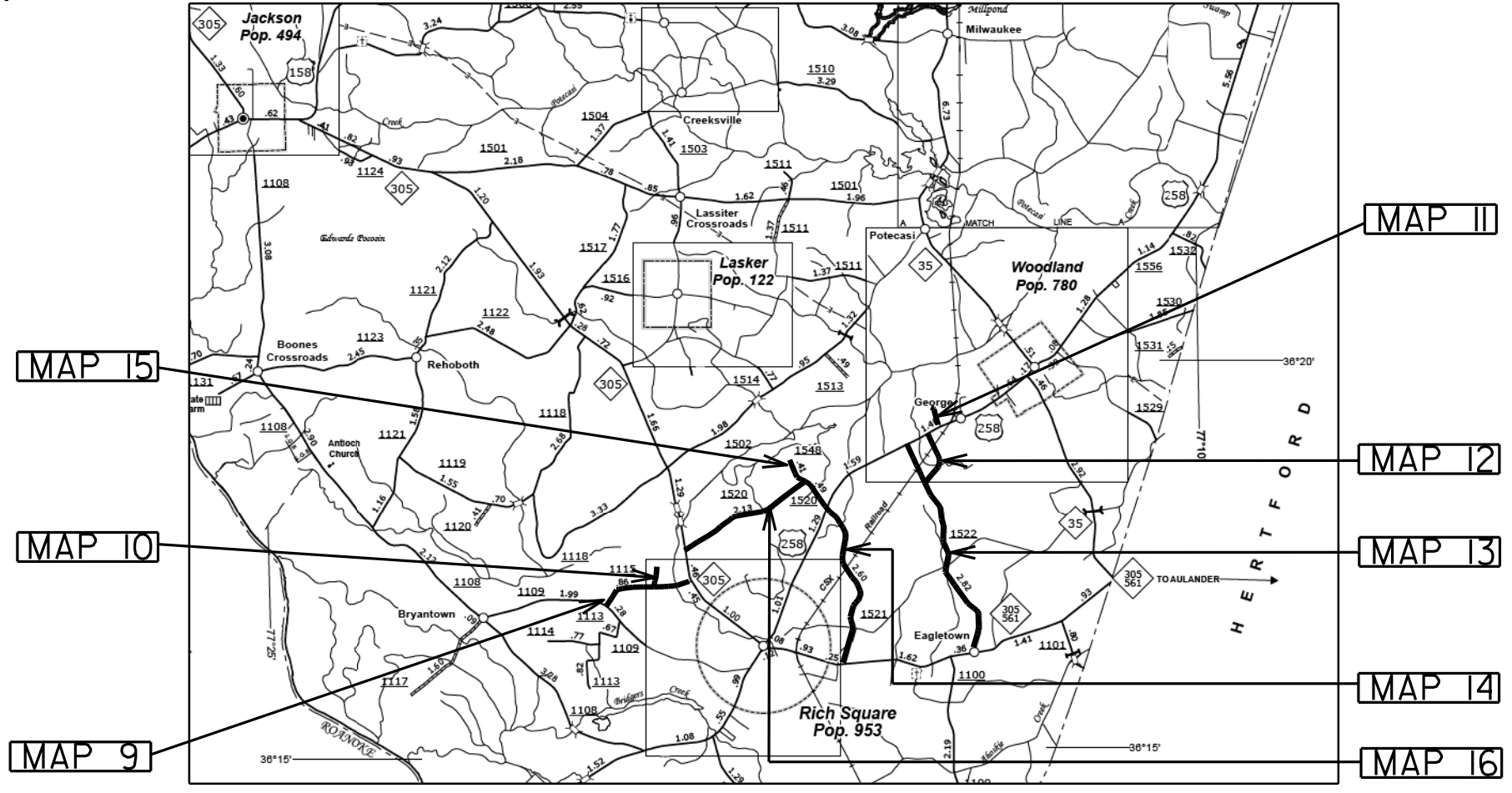

NTS

PROJECT LENGTH

LENGTH OF ROADWAY PROJECT MAP 9	= 1.41 MI.
LENGTH OF ROADWAY PROJECT MAP 10	= 0.30 MI.
LENGTH OF ROADWAY PROJECT MAP 11	= 0.30 MI.
LENGTH OF ROADWAY PROJECT MAP 12	= 0.87 MI.
LENGTH OF ROADWAY PROJECT MAP 13	= 3.47 MI.
LENGTH OF ROADWAY PROJECT MAP 14	= 2.60 MI.
LENGTH OF ROADWAY PROJECT MAP 15	= 0.41 MI.
LENGTH OF ROADWAY PROJECT MAP 16	= 2.62 MI.

Prepared in the Office of:
DIVISION OF HIGHWAYS
113 Airport Dr., Edenton NC, 27932

2012 STANDARD SPECIFICATIONS	LETTING DATE:
	W.B. HOBBS, P.E. <small>DIVISION PROJECT MANAGER</small>
	C.E. SLACHTA <small>DIVISION PROPOSALS ENGINEER</small>

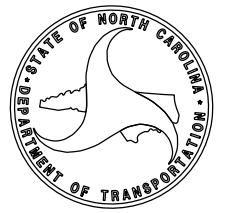

P A V E M E N T S C H E D U L E

C1	PROP. ASPHALT SURFACE TREATMENT, DOUBLE SEAL, AT AN APPLICATION RATE TO BE DETERMINED BY FIELD CONDITIONS IN ACCORDANCE WITH PROJECT SPECIAL PROVISIONS. (SEE NOTES)
U	EXISTING PAVEMENT.

NOTES:

*ALL PAVED S.R. ROADS TO BE TREATED TO THE ENDS OF THE RADII, OR AS DIRECTED BY THE ENGINEER

*PAVEMENT MARKINGS TO BE PERFORMED BY OTHERS

*ASPHALT SURFACE TREATMENT, DOUBLE SEAL CONSISTS OF TWO LAYERS OF TREATMENT:

BOTTOM LAYER CONSISTS OF EMULSIFIED ASPHALT, GRADE CRS-2L AT A RATE OF APPROX 0.30 ± GAL/SY AND A LAYER OF 7M AGGREGATE AT A RATE OF APPROX. 18 ± LBS/SY.

TOP LAYER CONSISTS OF EMULSIFIED ASPHALT, GRADE CRS-2L AT A RATE OF APPROX 0.25 ± GAL/SY AND A LAYER OF: $\frac{5}{16}$ " LIGHTWEIGHT AGGREGATE AT A RATE OF APPROX. 9± LBS/SY.

OR #9 AGGREGATE AT A RATE OF APPROX. 9± LBS/SY.

OR CA-9 LIGHTWEIGHT AGGREGATE AT A RATE OF APPROX. 9± LBS/SY.

*CONTRACTOR SHALL BE RESPONSIBLE FOR FURNISHING, LOADING, HAULING, AND PLACING ALL MATERIALS.

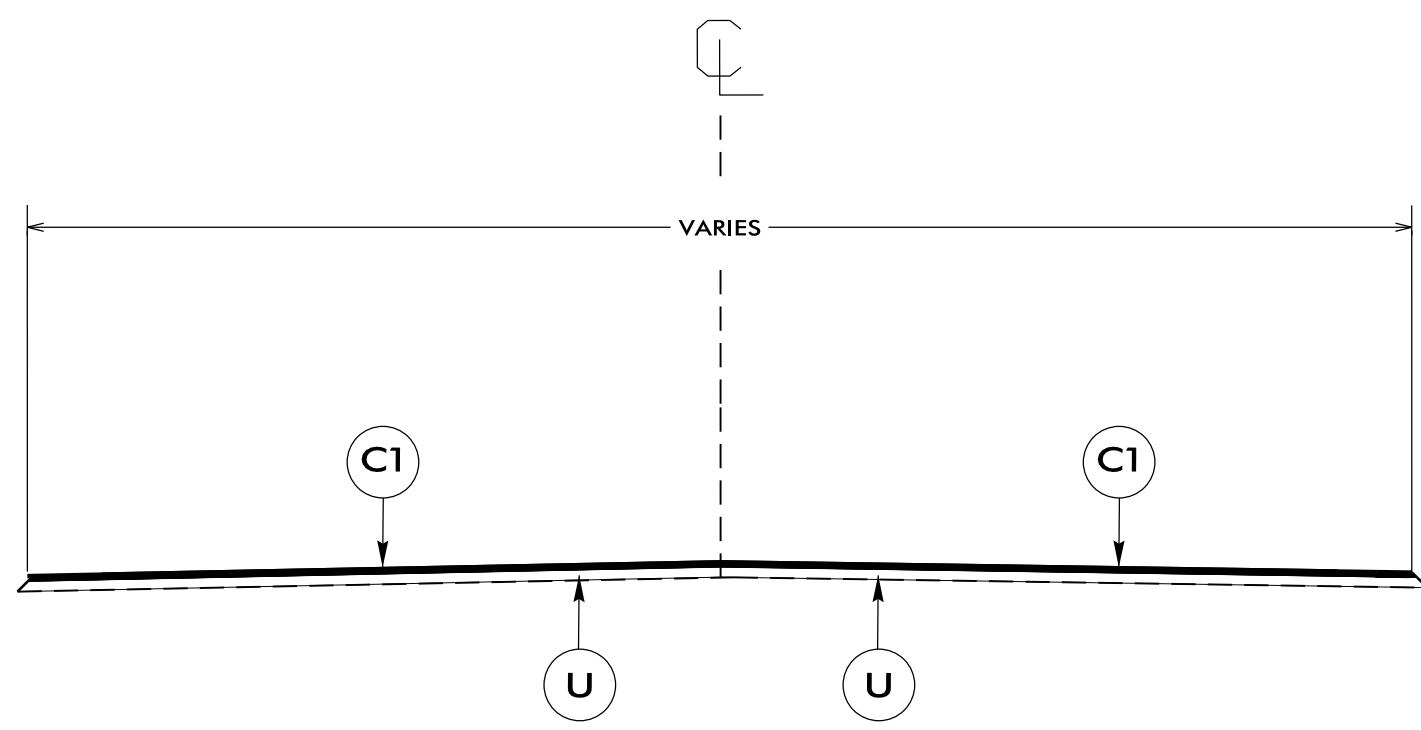

TYPICAL SECTION NO. 1

USE WITH MAPS 1 THRU 16

NTS

PROJECT NO.	SHEET NO.	TOTAL NO.
2016CPT.01.14.20662.1	4	

SUMMARY OF QUANTITIES

PROJECT NO	COUNTY	MAP NO	ROUTE	DESCRIPTION	TYP NO	LANES	LANE TYPE	LENGTH MI	WIDTH FT	MOBILIZATION LS	ASPHALT SURFACE TREATMENT, DOUBLE SEAL SY	LATEX MODIFIED EMULSION FOR AST (CRS-2L) GAL	TEMP TRAFFIC CONTROL LS
2016CPT.01.14.20662.1	Northampton	1	SR 1517	FROM SR 1516 TO SR 1501	1	2	2WU	1.77	20	1	20,768	11,422	1
2016CPT.01.14.20662.1	Northampton	2	SR 1514	FROM SR 1503 TO SR 1502	1	2	2WU	1.88	18	*	19,853	10,918	*
2016CPT.01.14.20662.1	Northampton	3	SR 1519	FROM SR 1503 TO SR 1514	1	2	2WU	0.21	20	*	3,008	1,654	*
2016CPT.01.14.20662.1	Northampton	4	SR 1515	FROM SR 1511 TO SR 1514	1	2	2WU	1.50	20	*	18,144	9,979	*
2016CPT.01.14.20662.1	Northampton	5	SR 1118	FROM NC 305 TO END OF PAVEMENT	1	2	2WU	3.66	20	*	43,888	24,138	*
2016CPT.01.14.20662.1	Northampton	6	SR 1119	FROM SR 1118 TO SR 1121	1	2	2WU	2.25	20	*	26,400	14,520	*
2016CPT.01.14.20662.1	Northampton	7	SR 1122	FROM NC 305 TO SR 1121	1	2	2WU	2.48	20	*	29,099	16,004	*
2016CPT.01.14.20662.1	Northampton	8	SR 1123	FROM SR 1121 TO SR 1108	1	2	2WU	2.45	18	*	25,872	14,229	*
2016CPT.01.14.20662.1	Northampton	9	SR 1115	FROM SR 1109 TO NC 305	1	2	2WU	1.41	18	*	14,890	8,190	*
2016CPT.01.14.20662.1	Northampton	10	SR 1116	FROM SR 1115 TO DEAD END	1	2	2WU	0.30	18	*	3,568	1,962	*
2016CPT.01.14.20662.1	Northampton	11	SR 1524	FROM US 258 TO DEAD END	1	2	2WU	0.30	18	*	3,168	1,742	*
2016CPT.01.14.20662.1	Northampton	12	SR 1523	FROM SR 1522 TO US 258	1	2	2WU	0.87	20	*	10,208	5,614	*
2016CPT.01.14.20662.1	Northampton	13	SR 1522	FROM NC 305 TO US 258	1	2	2WU	3.47	18	*	37,188	20,453	*
2016CPT.01.14.20662.1	Northampton	14	SR 1521	FROM US 258 TO NC 305	1	2	2WU	2.60	20	*	30,507	16,778	*
2016CPT.01.14.20662.1	Northampton	15	SR 1548	FROM SR 1520 TO DEAD END	1	2	2WU	0.41	18	*	4,330	2,382	*
2016CPT.01.14.20662.1	Northampton	16	SR 1520	FROM NC 305 TO US 258	1	2	2WU	2.62	18	*	27,667	15,217	*
GRAND TOTAL								28.18		1	318,558	175,202	1

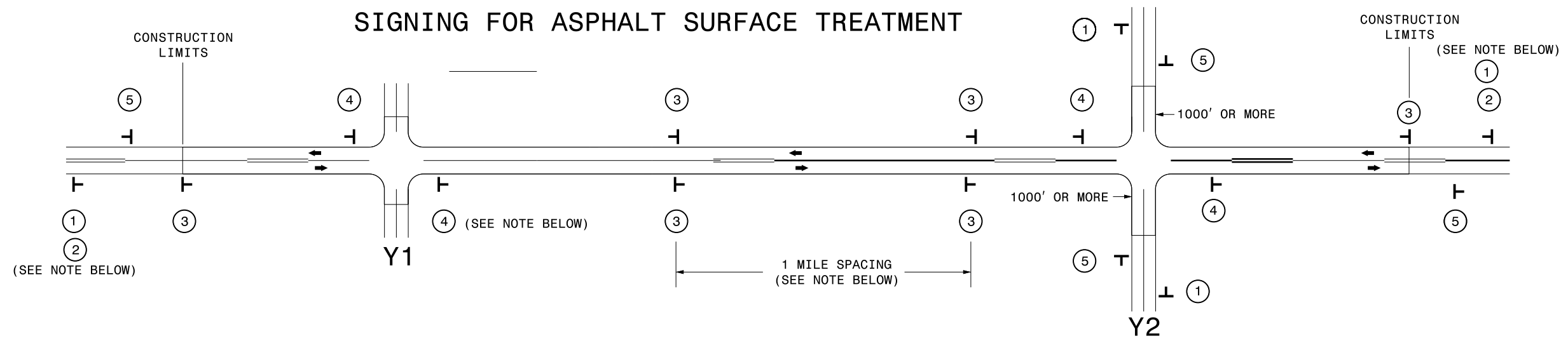

LEGEND
 T STATIONARY SIGN
 ← DIRECTION OF TRAFFIC FLOW

MAINLINE (-L-) SIGNING

-Y- LINE SIGNING

SIGNING NOTES AND PLACEMENT PER DIRECTION	①		PLACE 1000' PRIOR TO BEGINNING OF CONSTRUCTION LIMITS. ONLY USED ON -Y- LINES IF RESURFACING LIMITS EXTEND 1000' ALONG -Y- LINE.
	②		#2 SIGN ONLY USED WHEN RESURFACING LIMITS ARE 2 OR MORE MILES IN LENGTH. ROUND UP TO NEXT WHOLE NUMBER. (NO FRACTIONAL OR DECIMAL NUMBERS)
	③	 	ALTERNATE THE FOLLOWING TWO SIGNS: STARTING WITH "LOOSE GRAVEL" (W8-7) FOLLOWED BY "UNMARKED PAVEMENT". PLACE INITIALLY AT THE CONSTRUCTION LIMITS AND SPACED 1 MILE APART THEREAFTER. IF NO -Y- LINES EXIST, PLACE 2ND SET 1/2 MILE FROM THE CONSTRUCTION LIMITS AND THEN SPACE 1 MILE THEREAFTER.
	④		THESE ARE FOR -Y- LINES THAT ARE "THROUGH" ROADWAYS. DEAD END AND SUBDIVISION ROADS ARE NOT "THROUGH" ROADWAYS. INSTALL 500' +/- FROM EACH -Y- LINE APPROACH AS SHOWN ABOVE. FOR MULTIPLE -Y- LINES THAT ARE SEPARATED BY 0.25 MILES OR LESS, TREAT AS A SINGLE UNIT AND INSTALL WITHIN 500' OF EACH APPROACH. A MAXIMUM OF 2 SIGN SETS PER MILE. DO NOT INSTALL WHEN -Y- LINES ARE WITHIN 0.5 MILES FROM "END ROAD WORK" SIGN.
	⑤		PLACE 500' FOLLOWING THE END OF CONSTRUCTION LIMITS.

NO REQUIRED STATIONARY SIGNING FOR THE FOLLOWING -Y- LINE CONDITIONS:

- 1) LESS THAN 1000' OF RESURFACING ALONG -Y- LINE
- 2) SUBDIVISION ROADS
- 3) DEAD END ROADS

WHEN PAVING/CONSTRUCTION ACTIVITIES PROCEED ACROSS AN UNSIGNED -Y- LINE, ADVANCE WARNING PORTABLE SIGNS SHALL BE USED ALONG THE -Y- LINE AS SHOWN BELOW. REMOVE UPON COMPLETION OF WORK.

W20-1
 48" X 48"

W20-7 A
 48" X 48"

PLACED 500' IN ADVANCE OF FLAGGER. PLACED 250' IN ADVANCE OF FLAGGER.



ADVANCE WARNING SIGNS
 FOR
 ASPHALT SURFACE TREATMENTS
 2 LANE ROADWAYS