



STATE OF NORTH CAROLINA  
DEPARTMENT OF TRANSPORTATION

PAT MCCRORY  
GOVERNOR

NICHOLAS J. TENNYSON  
SECRETARY

August 18, 2015

**Addendum No. 1**

Contract No.: DA00248

WBS Element: 50138.3.FR24

*Improvements to the Intersection of NC11/42 & NC 903, in Martin County*

To Whom It May Concern:

Reference is made to the proposal and plans previously furnished for this project.

The following revision has been made to the proposal and plans:

Plan Sheet 2, has been revised to include a "Typical Section for the Transition Section" and revised the "Wedging Detail". Please void existing Plan Sheet 2 and staple revised Plan Sheet 2 thereto.

Plan Sheet 4, has been revised to remove the reference of 18" RCP and correct spelling errors. Please void existing Plan Sheet 4 and staple revised Plan Sheet 4 thereto.

Please acknowledge receipt of Addendum #1 in the space provided on the Addendum Acknowledgement Form.

Sincerely,

DocuSigned by:  
  
99A5A272ED6A447...

W. B. Hobbs, PE  
Division Project Manager

WBH/ces  
Attachment

cc: S. D. Baker, PE  
C. S. Mebane, PE  
D. S. Lee, PE

REVISED: 8/18/2015

### PAVEMENT SCHEDULE

C	PROP. APPROX. 1½" ASPHALT CONCRETE SURFACE COURSE, TYPE S9.5B, AT AN AVERAGE RATE OF 168 LBS. PER SQ. YD.
C1	PROP. VAR. DEPTH ASPHALT CONCRETE SURFACE COURSE, TYPE S9.5B, AT AN AVERAGE RATE OF 112 LBS. PER SQ. YD. PER 1" DEPTH. TO BE PLACED IN LAYERS NOT TO EXCEED 2" IN DEPTH.
D	PROP. APPROX. 2½" ASPHALT CONCRETE INTERMEDIATE COURSE, TYPE I19.0B, AT AN AVERAGE RATE OF 285 LBS. PER SQ. YD.
D1	PROP. VAR. DEPTH ASPHALT CONCRETE INTERMEDIATE COURSE, TYPE I19.0B, AT AN AVERAGE OF 114 LBS. PER SQ. YD. PER 1" DEPTH, TO BE PLACED IN LAYERS NOT LESS THAN 2½" IN DEPTH OR GREATER THAN 4" IN DEPTH.
E	PROP. APPROX. 4" ASPHALT CONCRETE BASE COURSE, TYPE B25.0B AT AN AVERAGE RATE OF 456 LBS. PER SQ. YD.
E1	PROP. VAR. DEPTH ASPHALT CONCRETE BASE COURSE, TYPE B25.0B AT AN AVERAGE RATE OF 114 LBS. PER SQ. YD. PER 1" DEPTH, TO BE PLACED IN LAYERS NOT LESS THAN 3" IN DEPTH.
T	EARTH MATERIAL.
U	EXISTING PAVEMENT.
W	VARIABLE DEPTH ASPHALT PAVEMENT (SEE STANDARD WEDGING DETAIL)

NOTE: PAVEMENT EDGE SLOPES ARE 1:1 UNLESS SHOWN OTHERWISE.

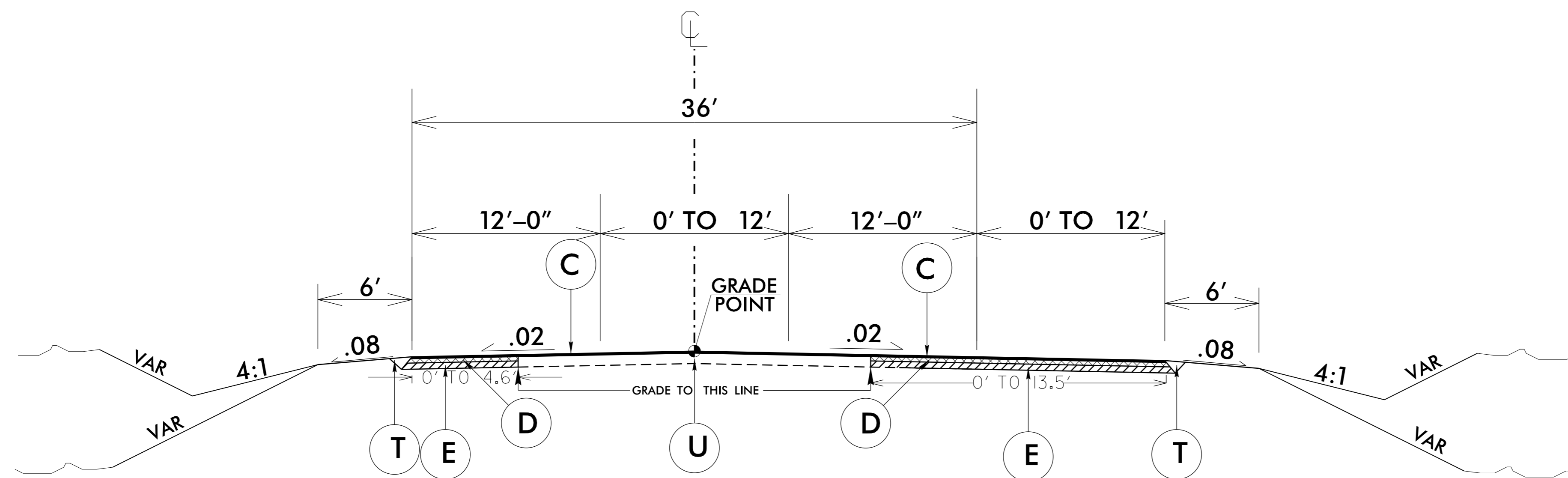

USE TYPICAL SECTION NO. 3 AT  
-Y- STA 14+29.63 TO -Y- STA 23+45.85

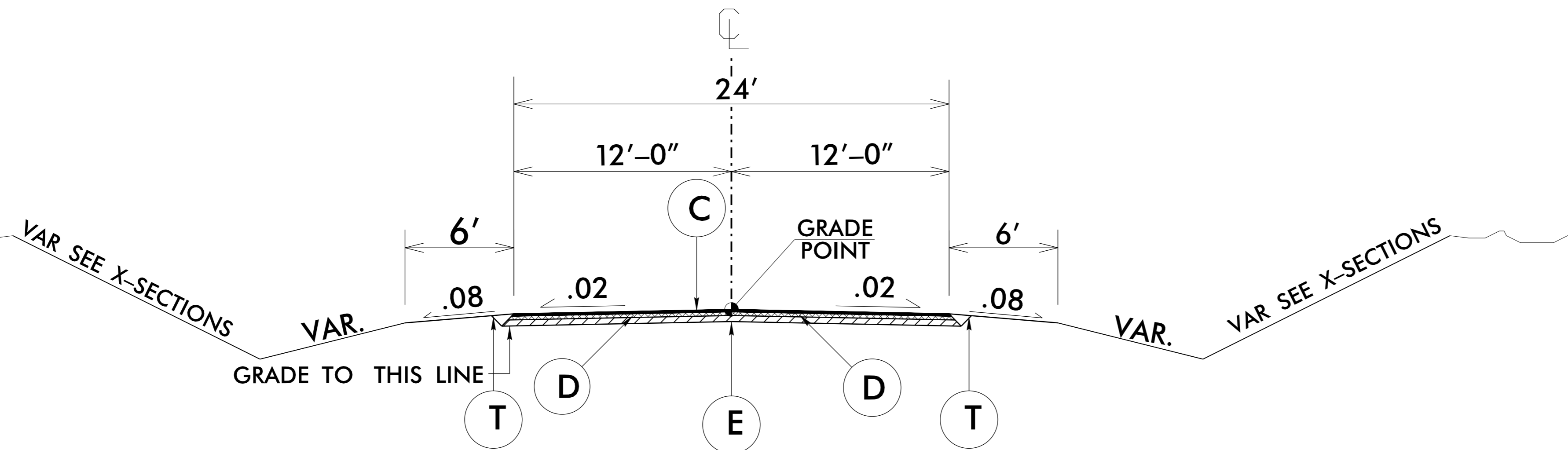

USE TYPICAL SECTION NO. 2 AT  
-L- STA 13+11.37 TO -L- STA 25+04.81

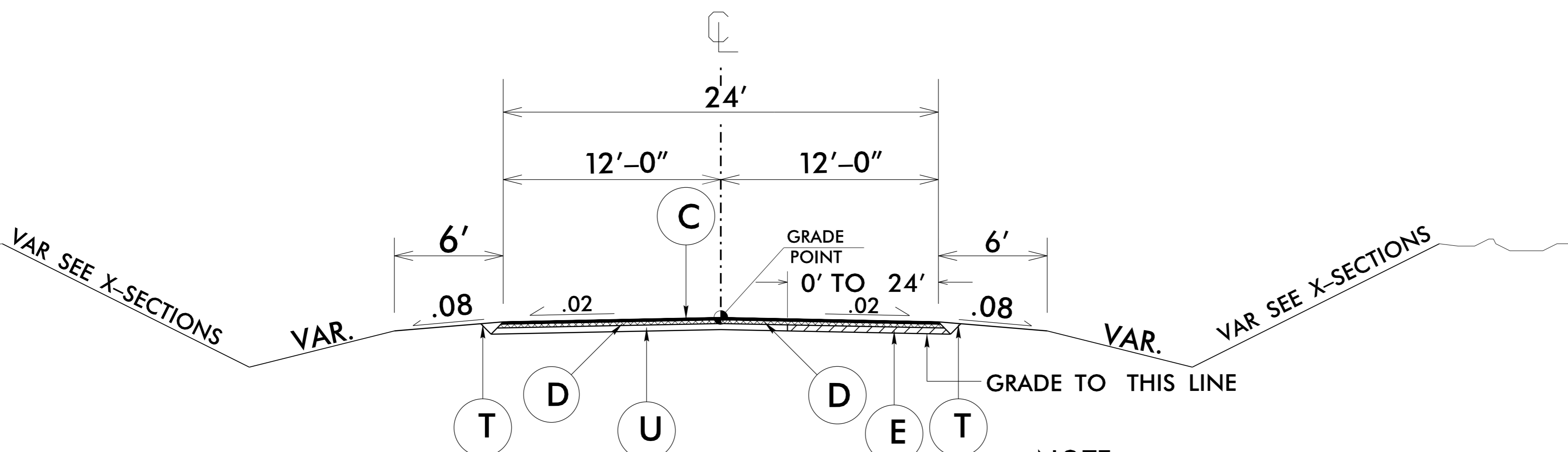

USE TYPICAL SECTION NO. 1 AT  
-L- STA 9+09.58 TO -L- STA 13+11.37

NOTE:  
RESURFACING ONLY FROM  
-L- STA. 9+09.58 TO -L- PC STA. 10+70.27

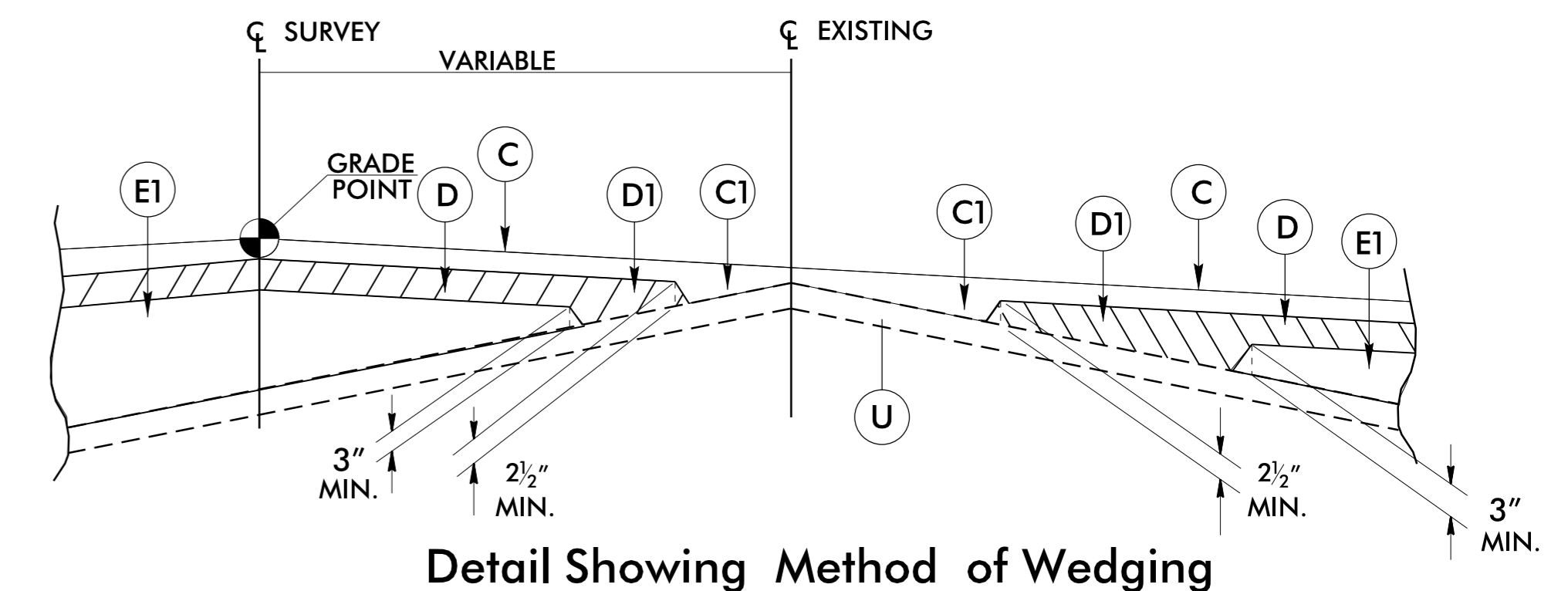

Detail Showing Method of Wedging

6/2/99

18-AUG-2015 10:29 AM  
F:\Documents\3101\PROJECTS\NC 11 & NC 903\Martin Co.\50138.3.FR24.d01.ph2.dgn

REVISED: 08/18/2015

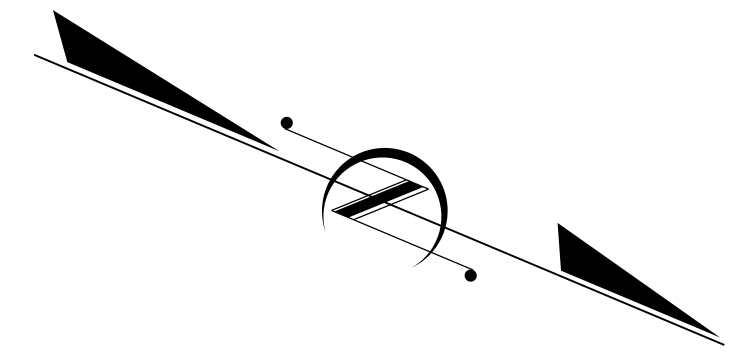

8/17/99  
 18-AUG-2015 10:37  
 I:\document\PROJECTS\NC 11 & NC 903\Mar+tr Co.\50138.3.FR24.d01.psh4.dgn  
 11/11/2015 10:37

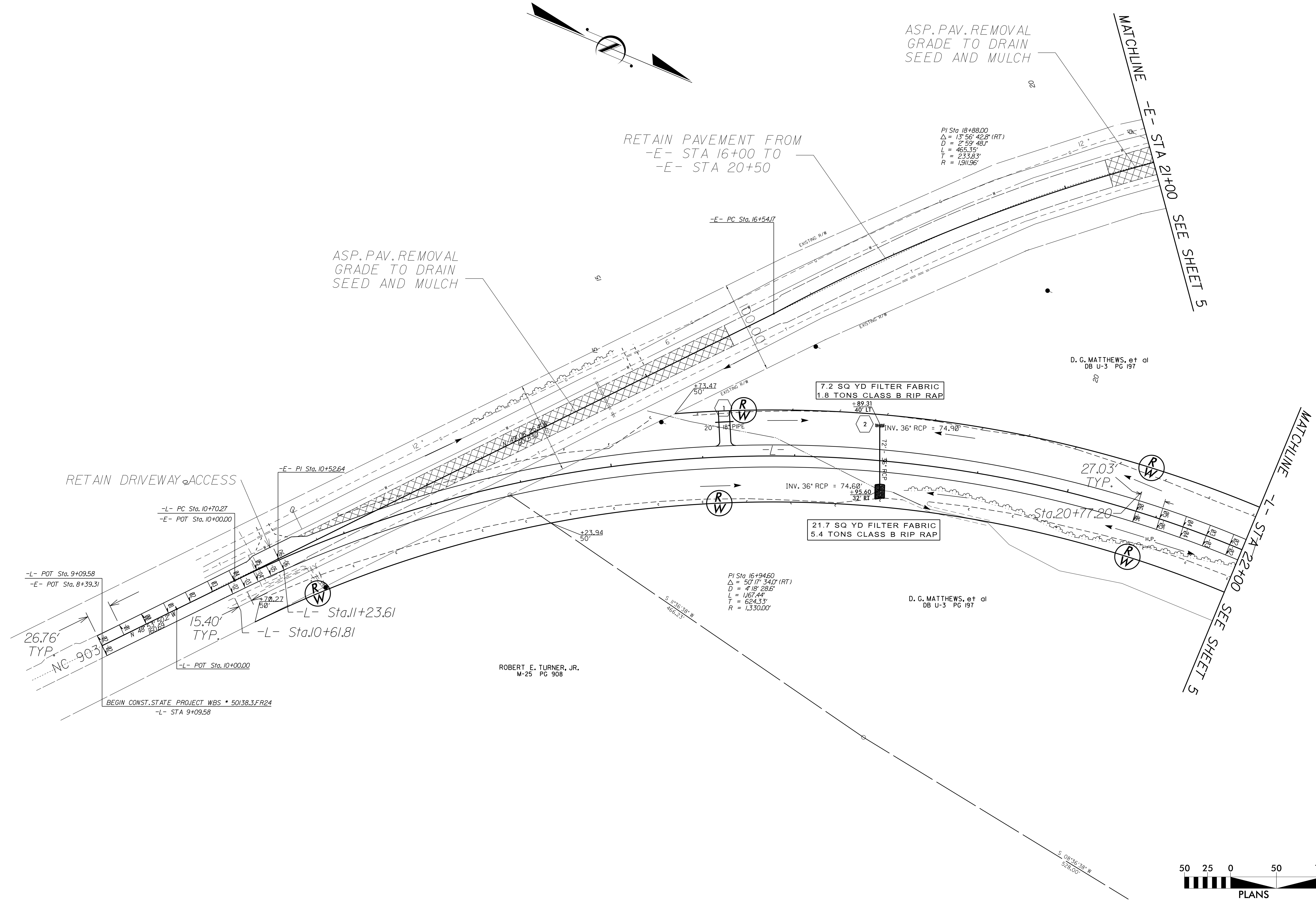

-L- POT Sta. 9+09.58  
-E- POT Sta. 8+39.31

-L- PC Sta. 10+70.27  
-E- POT Sta. 10+00.00

-E- PI Sta. 10+52.64

-E- PC Sta. 16+54.17

PI Sta 18+88.00  
Δ = 13°56' 42.2" (RT)  
D = 2'59' 48.1"  
L = 465.35'  
T = 233.83'  
R = 1,911.96'

7.2 SQ YD FILTER FABRIC  
1.8 TONS CLASS B RIP RAP

21.7 SQ YD FILTER FABRIC  
5.4 TONS CLASS B RIP RAP

PI Sta 16+94.60  
Δ = 50°17' 34.0" (RT)  
D = 4'18" 28.6"  
L = 1167.44'  
T = 624.33'  
R = 1,330.00'

D. G. MATTHEWS, et al  
DB U-3 PG 197

ROBERT E. TURNER, JR.  
M-25 PG 908

BEGIN CONST. STATE PROJECT WBS \* 50138.3.FR24  
-L- STA 9+09.58

