

02-SEP-2015 15:59  
 \\Dingsrv\vb\Division\_Let Projects\Pending DA\Projects\Hyde, Tyrrell & Washington Co Resurfacing (2016 - 2017)\Pre-Bid Documents\Addendum #\DA00266\_Plans.dgn  
 AT DICAD257101L

**CONTRACT NO. : DA00266 WBS NO. : 2016CPT.01.07.20941.1, ETC.**



STATE OF NORTH CAROLINA  
 DIVISION OF HIGHWAYS

REVISED 9/3/15

**HYDE COUNTY**

STATE	STATE PROJECT REFERENCE NO.	SHEET NO.	TOTAL SHEETS
N.C.	2016CPT.01.07.20481.1, ETC.	1	9
STATE PROJ. NO.	F.A. PROJ. NO.	DESCRIPTION	

LOCATION: MAP #1 SR 1311 FROM 2.6 MILES EAST SR 1305 TO 2.6 MILES EAST

TYPE OF WORK: RESURFACING

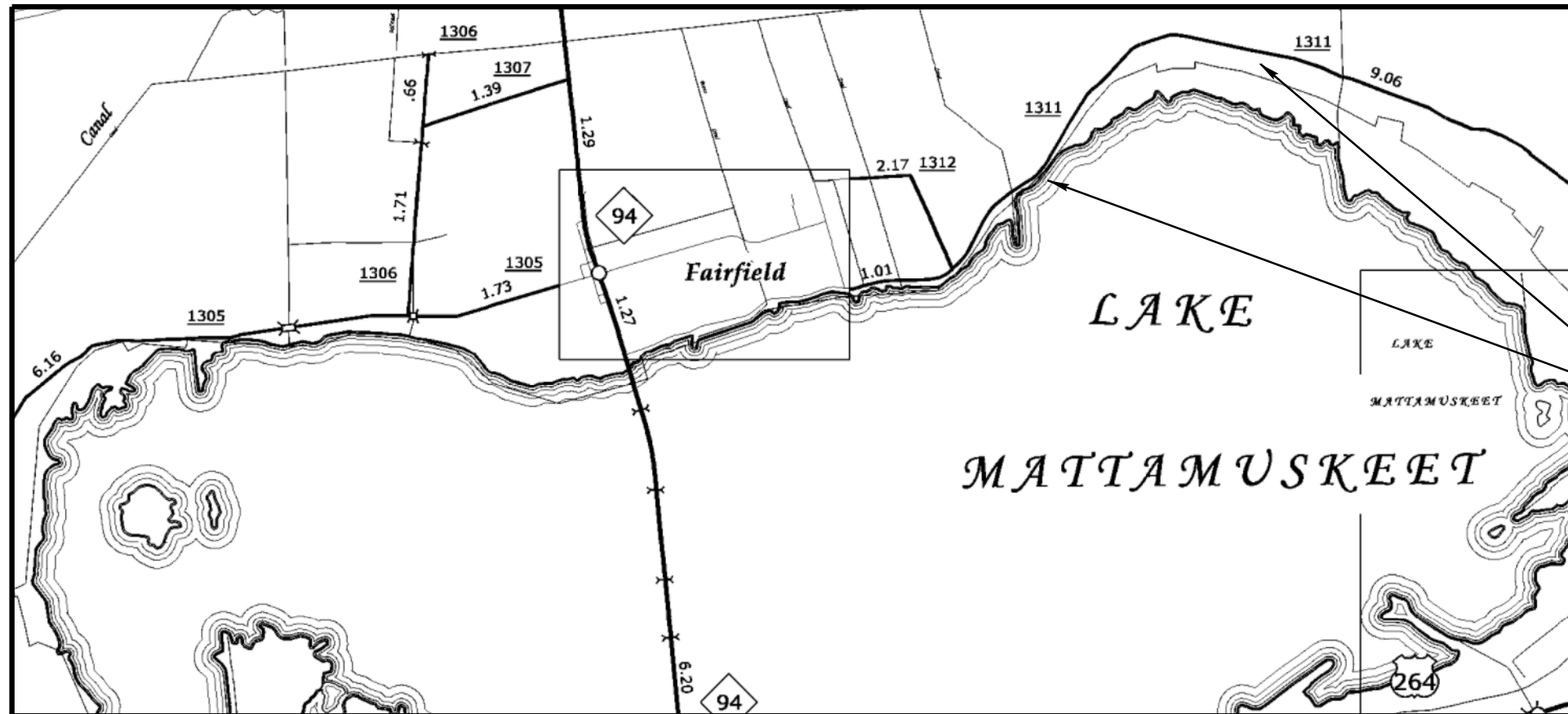

MAP # 1 SR 1311

NOT TO SCALE

PROJECT LENGTH

MAP#1 WBS# 2016CPT.01.07.20481.1 = 2.60 MILES

Prepared in the Office of:  
**DIVISION OF HIGHWAYS**

2012 STANDARD SPECIFICATIONS

LETTING DATE:

W.B. HOBBS, P.E.  
 DIVISION PROJECT MANAGER

C.E. SLACHTA  
 DIVISION PROPOSALS ENGINEER

DIVISION OF HIGHWAYS  
 STATE OF NORTH CAROLINA

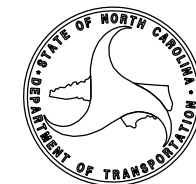

02-SEP-2015 16:00 \\Dingsr\y\bck\Division\_Let Projects\Pending DA\*\*\*\*\* Projects\DA00266 Hyde, Tyrrell & Washington Co Resurfacing (2016 - 2017)\1 Pre-Bid Documents\Addendum #INDA00266\_Plans.dgn 09/08/15  
 AT DICAD257101L cslachta

**CONTRACT NO. : DA00266 WBS NO. : 2016CPT.01.07.20941.1, ETC.**



STATE OF NORTH CAROLINA  
DIVISION OF HIGHWAYS

REVISED 9/3/15

***TYRRELL COUNTY***

**LOCATION: MAP #2 SRI301 FROM NC 94 TO END PAVEMENT  
MAP #3 SRI302 FROM SRI301 TO END PAVEMENT**

**TYPE OF WORK: RESURFACING**

STATE	STATE PROJECT REFERENCE NO.	SHEET NO.	TOTAL SHEETS
N.C.	2016CPT.01.07.20481.1, ETC.	2	9
STATE PROJ. NO.	F.A. PROJ. NO.	DESCRIPTION	

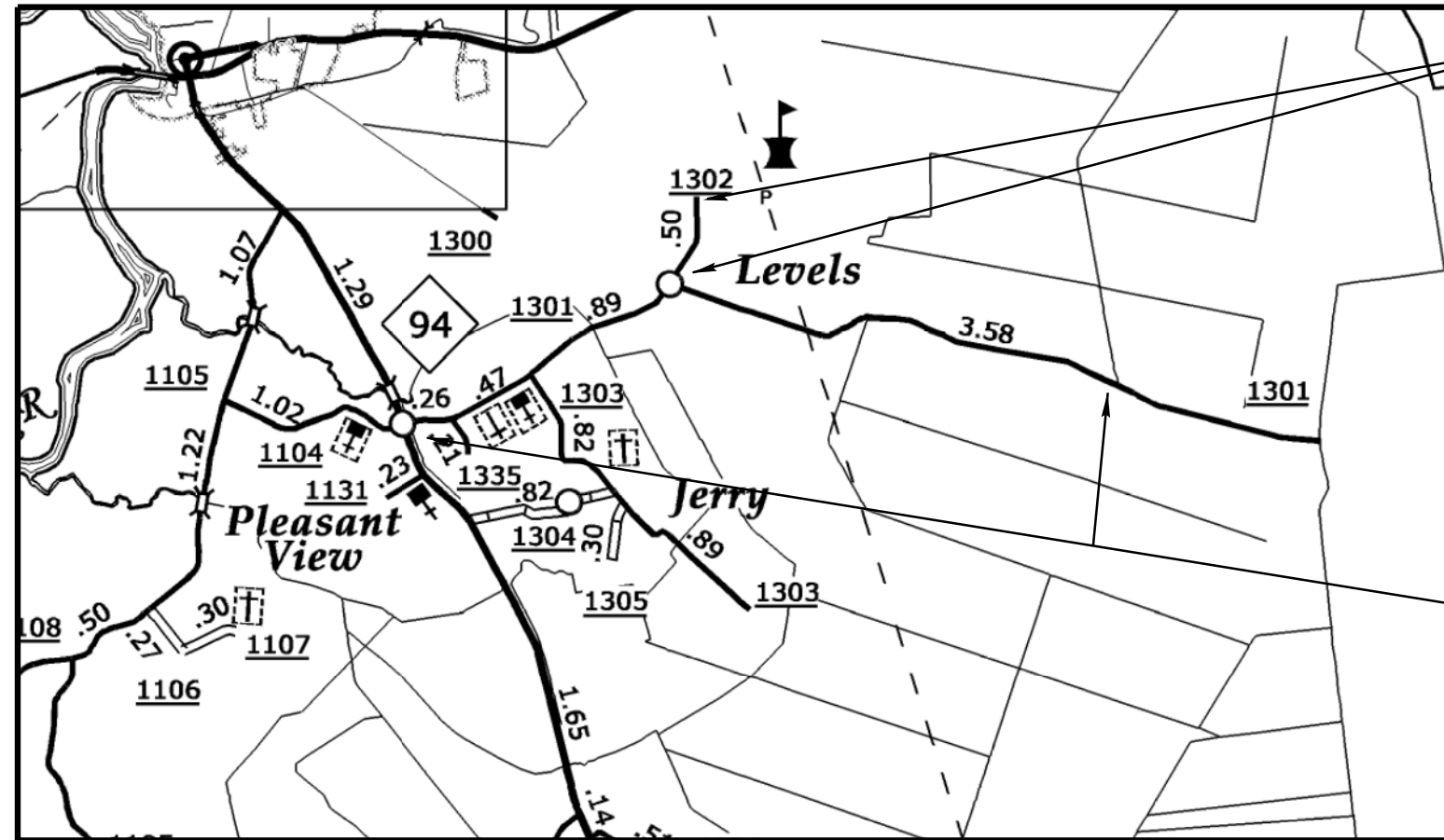

MAP # 3 SR 1302

MAP # 2 SR 1301

NOT TO SCALE

**PROJECT LENGTH**

MAP#2 WBS# 2016CPT.01.07.20891.1 = 2.50 MILES  
 MAP#3 WBS# 2016CPT.01.07.20891.1 = 0.50 MILES

Prepared in the Office of:  
**DIVISION OF HIGHWAYS**

2012 STANDARD SPECIFICATIONS

LETTING DATE:

W.B. HOBBS, P.E.  
DIVISION PROJECT MANAGER

C.E. SLACHTA  
DIVISION PROPOSALS ENGINEER

DIVISION OF HIGHWAYS  
STATE OF NORTH CAROLINA

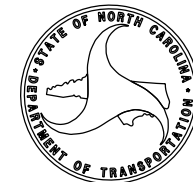

02-SEP-2015 16:01 \\D:\nsrv\bk\Division\_Let Projects\Pending DA\\*\*\*\* Projects\DA00266 Hyde, Tyrrell & Washington Co Resurfacing (2016 - 2017)\1 Pre-Bid Documents\Addendum #\DA00266\_Plans.dgn 09/08/15

**CONTRACT NO.: DA00266 WBS NO.: 2016CPT.01.07.20941.1, ETC.**



STATE OF NORTH CAROLINA  
DIVISION OF HIGHWAYS

REVISED 9/3/15

STATE	STATE PROJECT REFERENCE NO.	SHEET NO.	TOTAL SHEETS
N.C.	2016CPT.01.07.20481.1, ETC	3	9
STATE PROJ. NO.	F.A. PROJ. NO.	DESCRIPTION	

**WASHINGTON COUNTY**

LOCATION: MAP #4 SR1100 FROM SR1103 TO BEAUFORT COUNTY LINE  
MAP #5 SR1114 FROM NC 32 TO NC 45

TYPE OF WORK: RESURFACING

MAP # 4 SR 1100

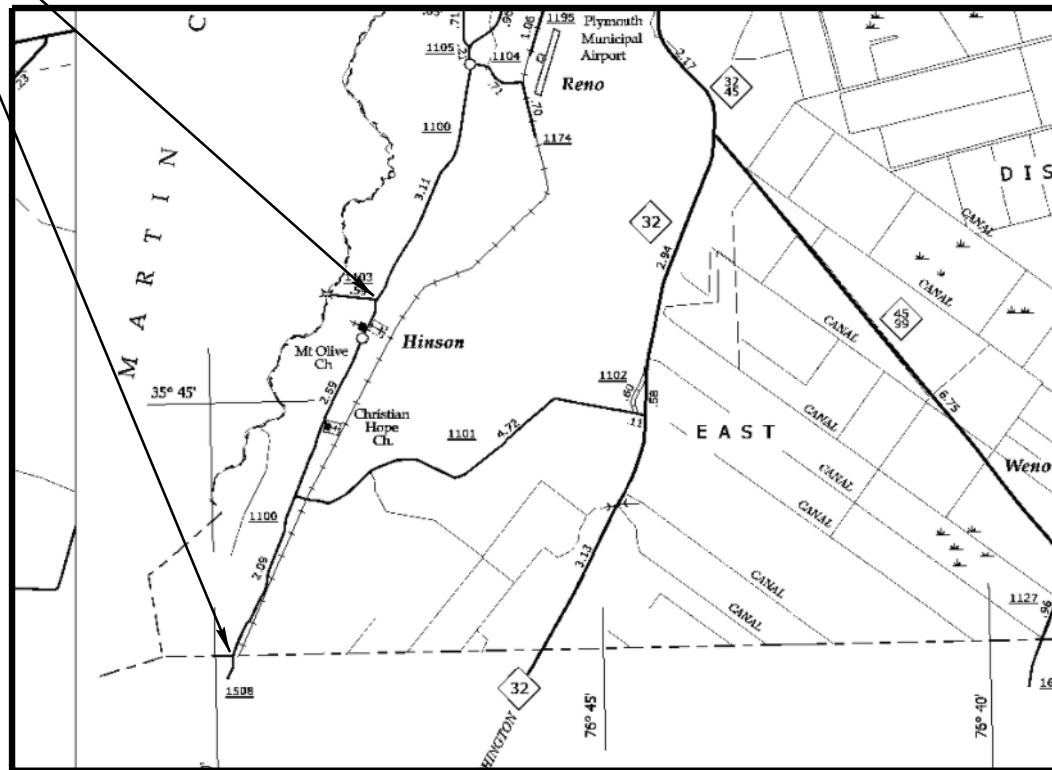

MAP # 5 SR 1114

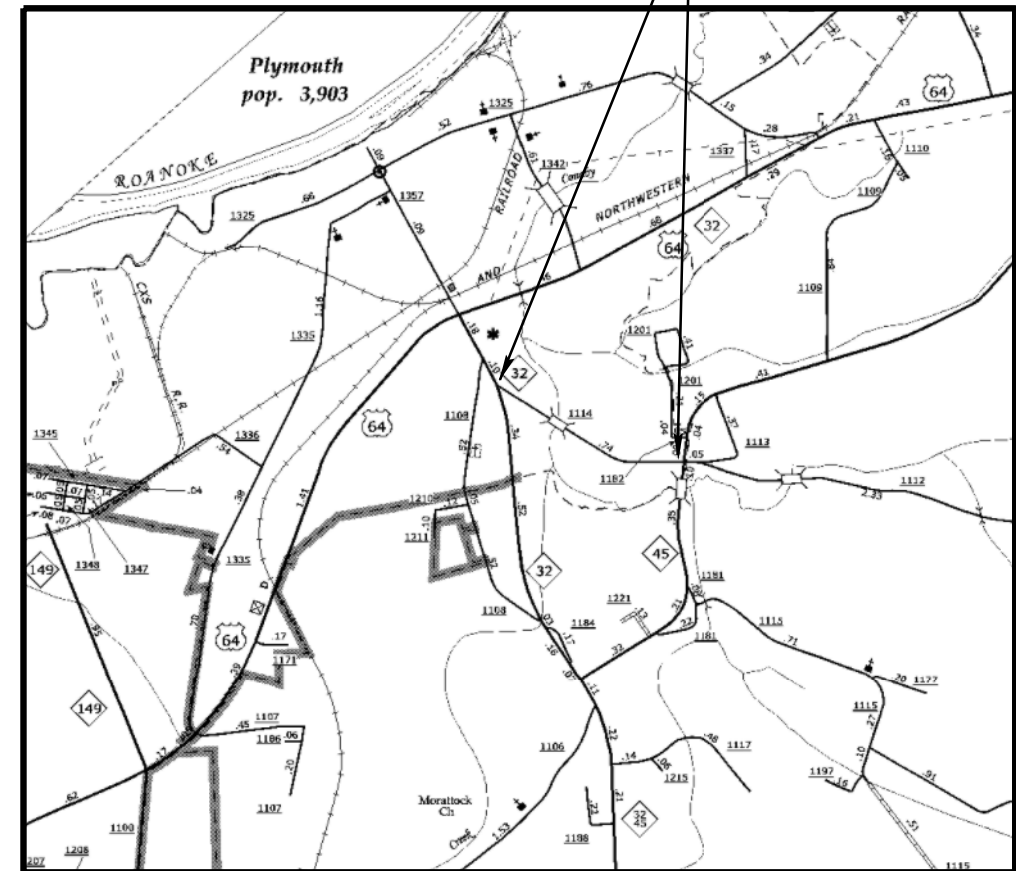

NOT TO SCALE

PROJECT LENGTH

MAP#4 WBS# 2016CPT.01.07.20941.1 = 4.70 MILES  
MAP#5 WBS# 2016CPT.01.07.20941.1 = 0.74 MILES

Prepared in the Office of:  
**DIVISION OF HIGHWAYS**

2012 STANDARD SPECIFICATIONS

LETTING DATE:

W.B. HOBBS, P.E.  
DIVISION PROJECT MANAGER

C.E. SLACHTA  
DIVISION PROPOSALS ENGINEER

DIVISION OF HIGHWAYS  
STATE OF NORTH CAROLINA

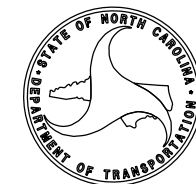

**CONTRACT NO. : DA00266 WBS NO. : 2016CPT.01.07.20941.1, ETC.**



STATE OF NORTH CAROLINA  
DIVISION OF HIGHWAYS

REVISED 9/3/15

**WASHINGTON COUNTY**

LOCATION: MAP #6, 7, 8 SR-1108 FROM NC32 TO SR-1210

TYPE OF WORK: MILLING RESURFACING

STATE	STATE PROJECT REFERENCE NO.	SHEET NO.	TOTAL SHEETS
N.C.	2016CPT.01.07.20481.1, ETC.	4	9
STATE PROJ. NO.	F.A. PROJ. NO.	DESCRIPTION	

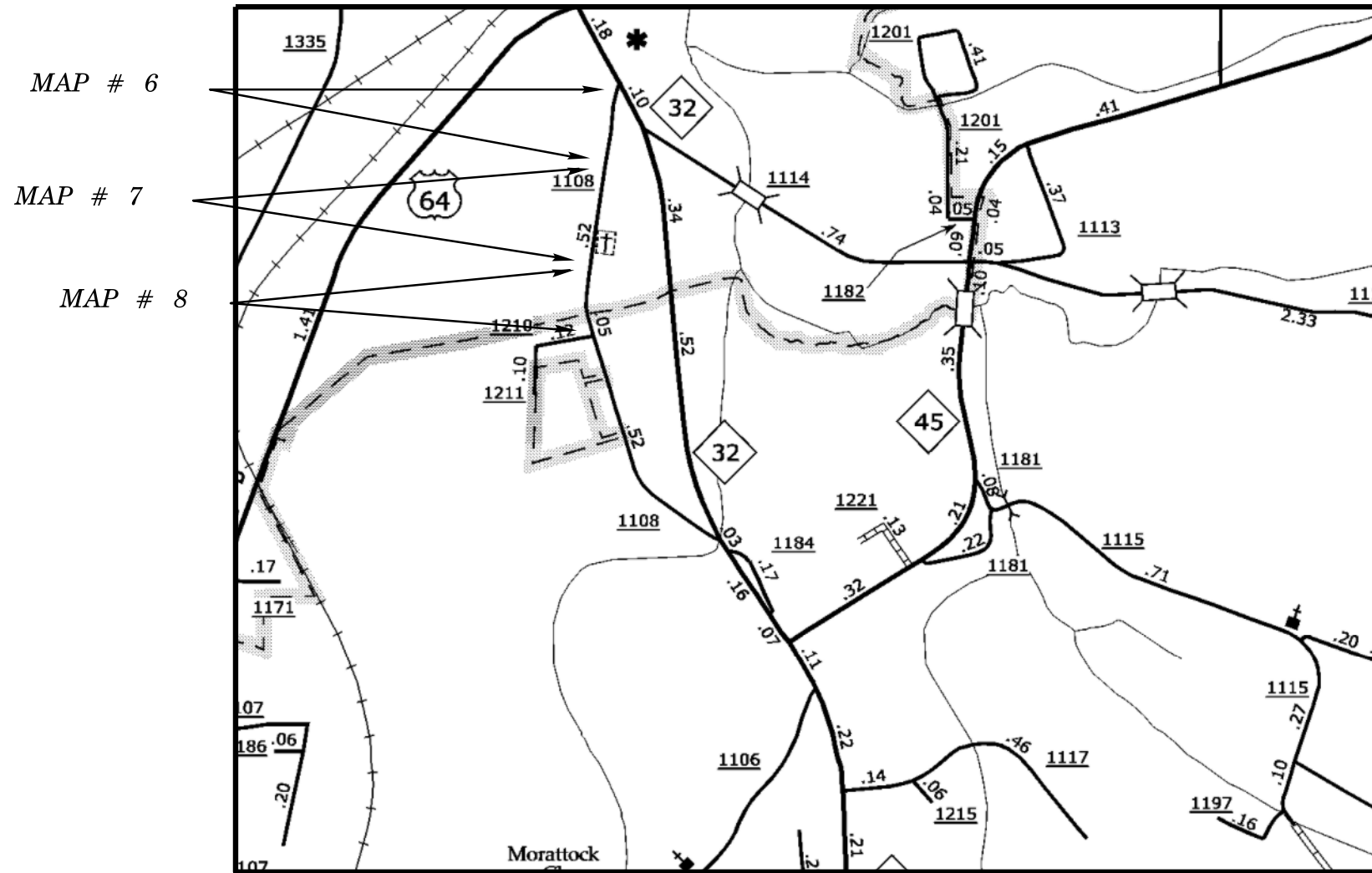

NOT TO SCALE

PROJECT LENGTH

MAP#6 WBS#2016CPT.01.07.20941.1=0.23 MILES  
 MAP#7 WBS#2016CPT.01.07.20941.1=0.15 MILES  
 MAP#8 WBS#2016CPT.01.07.20941.1=0.17 MILES

Prepared in the Office of:  
**DIVISION OF HIGHWAYS**

2012 STANDARD SPECIFICATIONS

LETTING DATE:

W.B. HOBBS, P.E.  
DIVISION PROJECT MANAGER

C.E. SLACHTA  
DIVISION PROPOSALS ENGINEER

DIVISION OF HIGHWAYS  
STATE OF NORTH CAROLINA

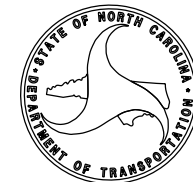

NOTES:

1. ALL PAVED S.R. ROADS TO BE RESURFACED TO THE ENDS OF THE RADII OR AS DIRECTED BY THE ENGINEER
2. EDGES, PAVEMENT WIDENING, INTERSECTIONS, AND BRIDGE FLARES ARE INCLUDED IN THE TABLE OF QUANTITIES
3. SHOULDERS AND DITCHES ARE TO BE CONSTRUCTED BY OTHERS

PROJECT REFERENCE NO.	SHEET NO.
2016CPT.01.07.20481.1, ETC.	5 OF 9

PAVEMENT SCHEDULE	
C1	PROP. APPROX. 1.5" ASPHALT CONCRETE SURFACE COURSE TYPE SF9.5A, AT AN AVERAGE RATE OF 165 LBS. PER SQ.YD.
U	EXISTING PAVEMENT.

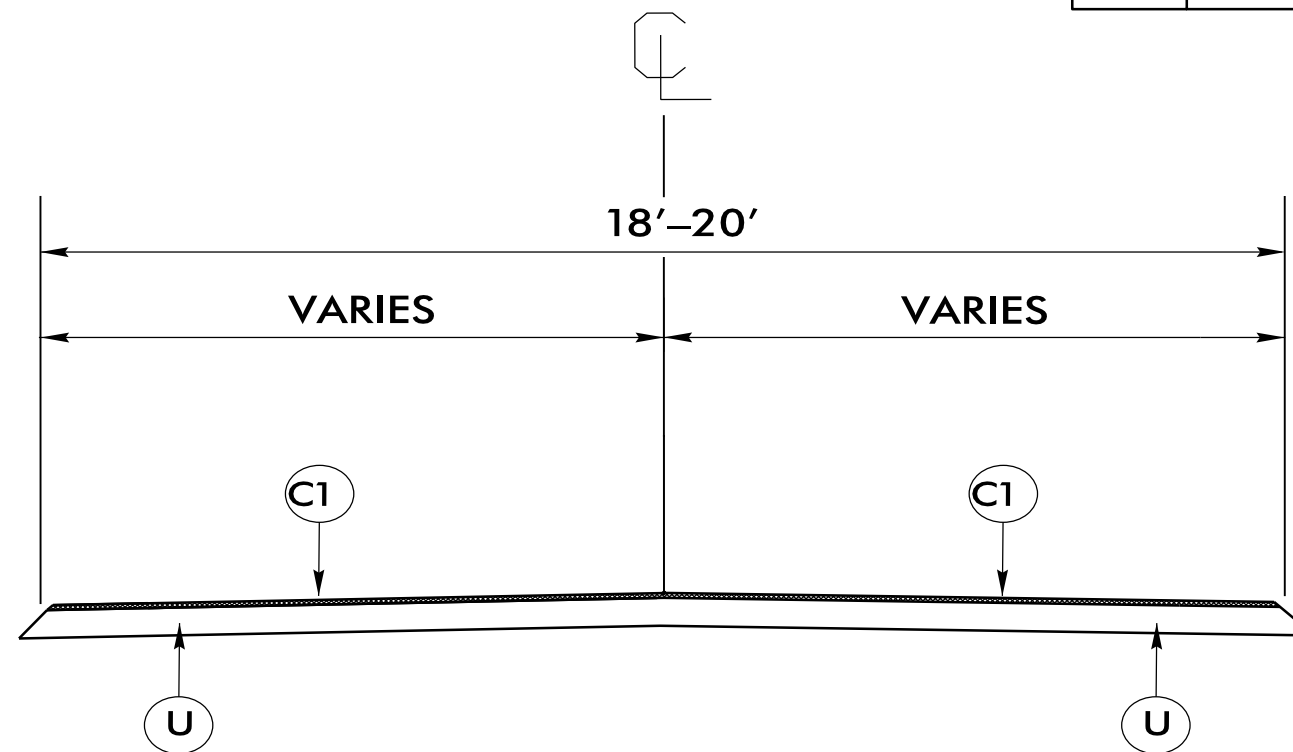

***TYPICAL SECTION #1***  
 USE WITH MAPS 1 - 5

NOTES:

1. ALL PAVED S.R. ROADS TO BE RESURFACED TO THE ENDS OF THE RADII OR AS DIRECTED BY THE ENGINEER
2. EDGES, PAVEMENT WIDENING, INTERSECTIONS, AND BRIDGE FLARES ARE INCLUDED IN THE TABLE OF QUANTITIES
3. PAVEMENT EDGE SLOPES ARE 1:1 UNLESS SHOWN OTHERWISE
4. SHOULDERS AND DITCHES ARE TO BE CONSTRUCTED BY OTHERS

PROJECT REFERENCE NO.	SHEET NO.
2016CPT.01.07.20481.1, ETC.	6 OF 9

PAVEMENT SCHEDULE	
C1	PROP. APPROX. 1.5" ASPHALT CONCRETE SURFACE COURSE TYPE SF9.5A, AT AN AVERAGE RATE OF 165 LBS. PER SQ.YD.
V	MILLING BITUMINOUS PAVEMENT 1.5" DEPTH
U	EXISTING PAVEMENT.

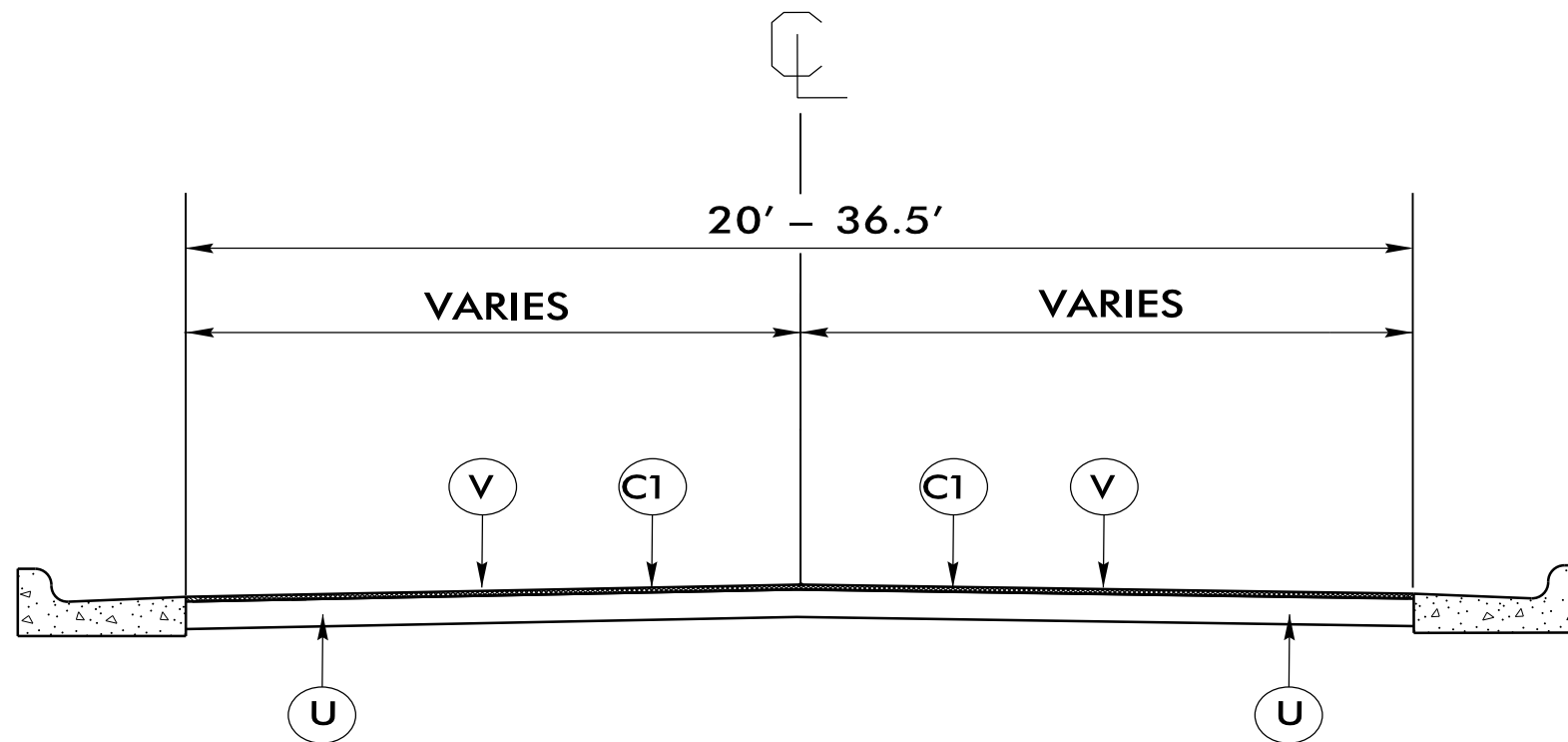

***TYPICAL SECTION #2***

USE WITH MAPS 6 - 8

REVISED 9/3/15

PROJECT NO.	SHEET NO.	TOTAL NO.
2016CPT.01.07.20481.1, ETC.	7	9

### SUMMARY OF QUANTITIES

PROJECT	COUNTY	MAP	ROUTE	DESCRIPTION	TYP	LANES	FINAL SURFACE TESTING REQUIRED	WARM MIX ASPHALT REQUIRED	LENGTH	WIDTH	MOBILIZATION	MILLING ASPHALT PAVEMENT 1 1/2" DEPTH	SURFACE COURSE, SF9.5A	ASPHALT BINDER FOR PLANT MIX	ADJ. OF MANHOLES	ADJ. OF METER OR VALVE BOX	TEMPORARY TRAFFIC CONTROL
NO		NO			NO				MI	FT	LUMP SUM	SY	TONS	TONS	EA	EA	LUMP SUM
2016CPT.01.07.20481.1	Hyde	1	SR 1311	FROM 2.6 MILES EAST OF SR 1305 FOR 2.6 MILES	1	2	NO	NO	2.6	20	1		2,786	187			1
2016CPT.01.07.20891.1	Tyrrell	2	SR 1301	FROM NC94 TO END PAVEMENT	1	2	NO	NO	2.5	20	*		2,679	179			*
2016CPT.01.07.20891.1	Tyrrell	3	SR 1302	FROM SR 1301 TO END PAVEMENT	1	2	NO	NO	0.5	18	*		482	32			*
2016CPT.01.07.20941.1	Washington	4	SR 1100	FROM SR 1103 TO BEAUFORT COUNTY LINE	1	2	NO	NO	4.7	20	*		5,036	337			*
2016CPT.01.07.20941.1	Washington	5	SR 1114	FROM NC 32 TO NC 45	1	2	NO	NO	0.74	20	*		793	53			*
2016CPT.01.07.20941.1	Washington	6	SR 1108A	FROM NC 32 TO BEGIN CURB & GUTTER	2	2	NO	NO	0.23	25	*	3,373	308	21			*
2016CPT.01.07.20941.1	Washington	7	SR 1108B	FROM BEGIN CURB & GUTTER TO END CURB & GUTTER			NO	NO	0.15	36.5	*	3,212	292	20			*
2016CPT.01.07.20941.1	Washington	8	SR 1108C	FROM NC 32 TO NC 45	1	2	NO	NO	0.17	20	*	1,995	182	12	7	2	*
									<b>11.59</b>		<b>1</b>	<b>8,580</b>	<b>12,558</b>	<b>841</b>	<b>7</b>	<b>2</b>	<b>1</b>
<b>GRAND TOTAL</b>									<b>11.59</b>		<b>1</b>	<b>8,580</b>	<b>12,558</b>	<b>841</b>	<b>7</b>	<b>2</b>	<b>1</b>

REVISED 9/3/15

- NOTES:  
 1) DETAIL DOES NOT APPLY TO OGAFc AND ULTRA-THIN BONDED WEARING COURSE.  
 2) BACKFILL SHOULDER WITH APPROVED MATERIAL.  
 3) THE SHOULDER WEDGE DEVICE MAY BE DISENGAGED AT PAVED DRIVEWAYS AND SIDE STREETS.

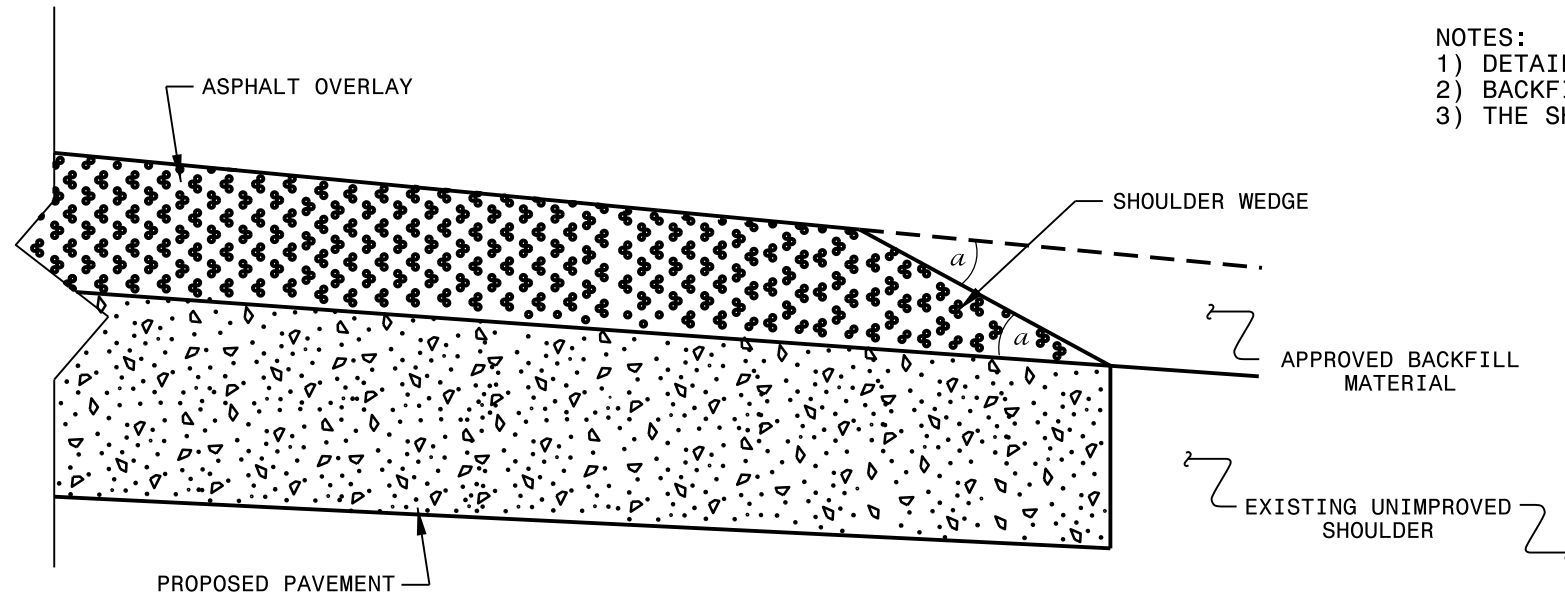

**SHOULDER WEDGE DETAIL**  
 (Resurfacing Projects w/ Widening or  
 with Existing Paved Shoulder having no dropoffs)

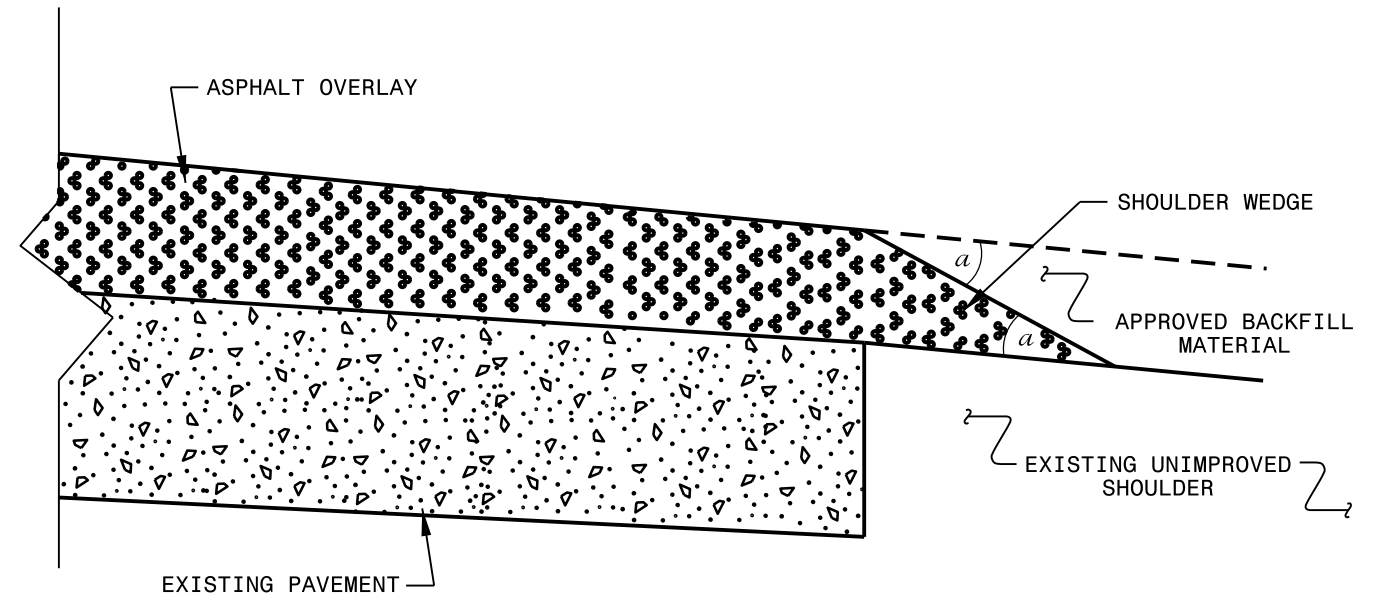

**SHOULDER WEDGE DETAIL**  
 (Resurfacing Projects w/ NO Widening)

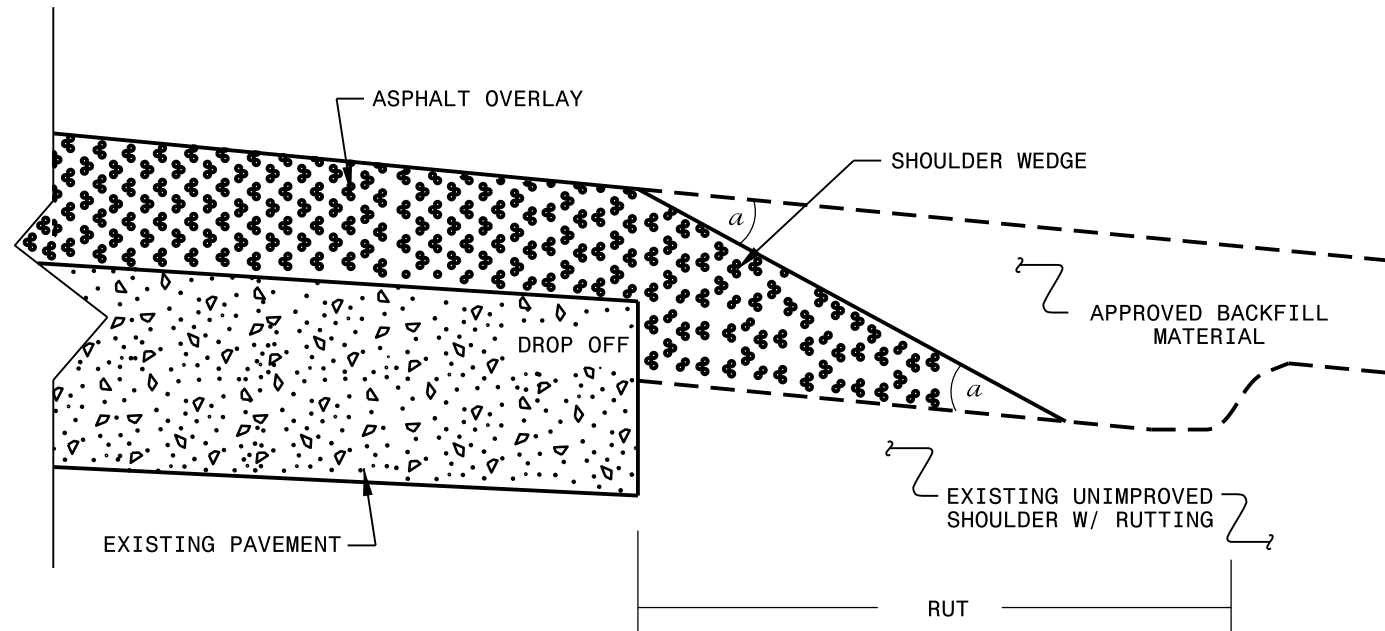

**SHOULDER WEDGE DETAIL**  
 (Resurfacing Adjacent to  
 Rutted Shoulder)

- SHOULDER WEDGE ANGLE = 30°

CONTRACT STANDARDS  
 AND DEVELOPMENT UNIT  
 Office 919-707-6950 FAX 919-250-4119

**SHOULDER WEDGE  
 DETAILS**

ORIGINAL BY: T. SPELL DATE: 7-19-11  
 MODIFIED BY: DATE: 10/16/12  
 CHECKED BY: DATE:  
 FILE SPEC.: s:\usr\details\stand\shoulderwedgedetail.dgn



REVISED 9/3/15

# SIGNING FOR RESURFACING PROJECTS

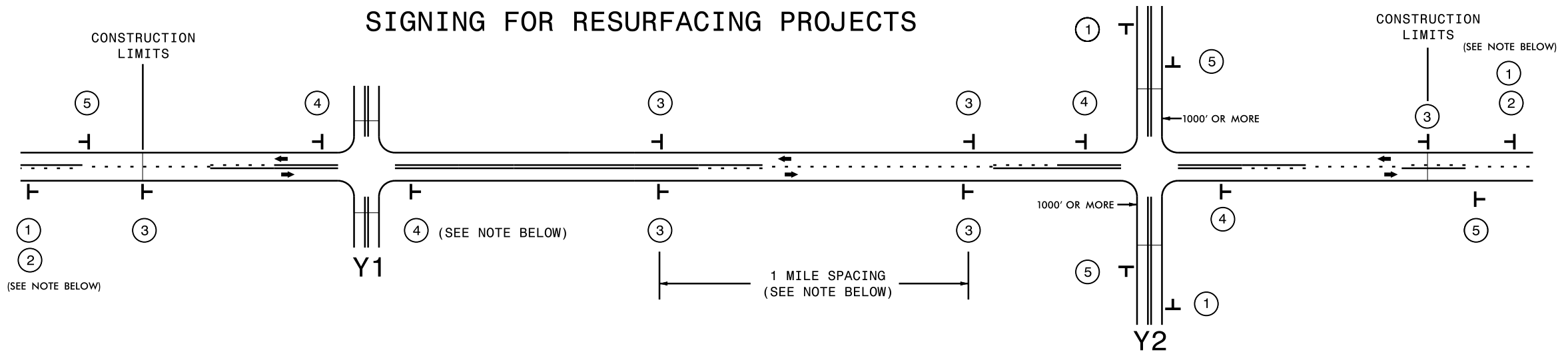

LEGEND	
	STATIONARY SIGN
	DIRECTION OF TRAFFIC FLOW

## MAINLINE (-L-) SIGNING

## -Y- LINE SIGNING

SIGNING NOTES AND PLACEMENT PER DIRECTION		<p>PLACE 1000' PRIOR TO BEGINNING OF CONSTRUCTION LIMITS. ONLY USED ON -Y- LINES IF RESURFACING LIMITS EXTEND 1000' ALONG -Y- LINE.</p>	<p><b>NO REQUIRED STATIONARY SIGNING FOR THE FOLLOWING -Y- LINE CONDITIONS:</b></p> <ol style="list-style-type: none"> <li>LESS THAN 1000' OF RESURFACING ALONG -Y- LINE</li> <li>SUBDIVISION ROADS</li> <li>DEAD END ROADS</li> </ol> <p>WHEN PAVING/CONSTRUCTION ACTIVITIES PROCEED ACROSS AN UNSIGNED -Y- LINE, ADVANCE WARNING PORTABLE SIGNS SHALL BE USED ALONG THE -Y- LINE AS SHOWN BELOW. REMOVE UPON COMPLETION OF WORK.</p> <div style="display: flex; justify-content: space-around; align-items: center;"> <div style="text-align: center;"> <p>W20-1 48" X 48"</p> </div> <div style="text-align: center;"> <p>W20-7 A 48" X 48"</p> </div> </div> <p>PLACED 500' IN ADVANCE OF FLAGGER. PLACED 250' IN ADVANCE OF FLAGGER.</p>
		<p>#2 SIGN ONLY USED WHEN RESURFACING LIMITS ARE 2 OR MORE MILES IN LENGTH. ROUND UP TO NEXT WHOLE NUMBER. (NO FRACTIONAL OR DECIMAL NUMBERS)</p>	
		<p>PLACE INITIALLY AT THE CONSTRUCTION LIMITS AND SPACED 1 MILE APART THEREAFTER. IF NO -Y- LINES EXIST, PLACE 2ND SET 1/2 MILE FROM THE CONSTRUCTION LIMITS AND THEN SPACE 1 MILE THEREAFTER.</p>	
		<p>THESE ARE FOR -Y- LINES THAT ARE "THROUGH" ROADWAYS. DEAD END AND SUBDIVISION ROADS ARE NOT "THROUGH" ROADWAYS. INSTALL 500' +/- FROM EACH -Y- LINE APPROACH AS SHOWN ABOVE. FOR MULTIPLE -Y- LINES THAT ARE SEPARATED BY 0.25 MILES OR LESS, TREAT AS A SINGLE UNIT AND INSTALL WITHIN 500' OF EACH APPROACH. A MAXIMUM OF 2 SIGN SETS PER MILE. DO NOT INSTALL WHEN -Y- LINES ARE WITHIN 0.5 MILES FROM "END ROAD WORK" SIGN.</p>	
	<p>PLACE 500' FOLLOWING THE END OF CONSTRUCTION LIMITS.</p>		

09-FEB-2015 07:52  
D:\cadd\2649\1\Drawings\11\Resurfacing\Plans\Resurfacing\_AdvWarn\_2Ln.dgn  
D:\cadd\2649\1\Drawings\11\Resurfacing\Plans\Resurfacing\_AdvWarn\_2Ln.dgn

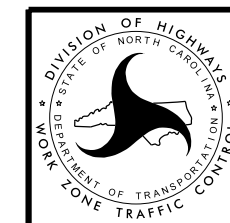

**RESURFACING  
ADVANCE WARNING SIGNS  
FOR  
RURAL AND SUBURBAN  
2 LANE ROADWAYS**