

STATE OF NORTH CAROLINA  
DIVISION OF HIGHWAYS

**CURRITUCK COUNTY**

**LOCATION: MAP #1 US 158 FROM CAMDEN CO. LINE TO  
PAVEMENT CHANGE 0.1 MILE WEST OF US 168**

**TYPE OF WORK: RESURFACING**

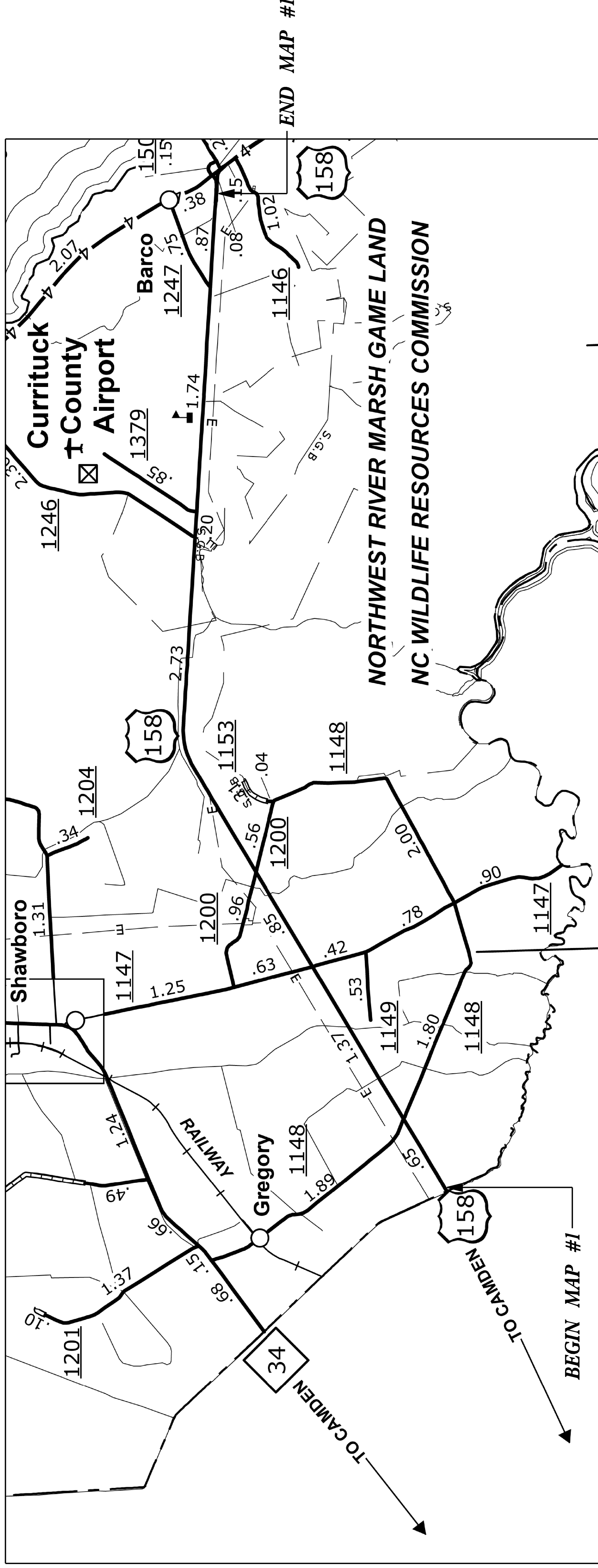

US 158 MAP #1

STATE	STATE PROJECT REFERENCE NO.	SHEET NO.	TOTAL SHEETS
N.C.	1CR.10271.4	1	
STATE PROJ. NO.	F.A. PROJ. NO.	DESCRIPTION	
1CR.10271.4		CONST.	

**WBS NO.: ICR.10271.4**

**CONTRACT: DA00207**

**NOT TO SCALE**

**PROJECT LENGTH**

TOTAL LENGTH STATE PROJECT ICR.10271.4 (MAP#1) = 8.36 MILES

Prepared in the Office of:  
**DIVISION OF HIGHWAYS**  
113 AIRPORT DR., EDENTON, NC 27932  
2012 STANDARD SPECIFICATIONS

LETTING DATE:  
OCTOBER 15, 2014

W.B. HOBBS, P.E.  
DIVISION PROJECT MANAGER

C.E. SLACHTA  
DIVISION PROPOSALS ENGINEER

DIVISION OF HIGHWAYS  
STATE OF NORTH CAROLINA

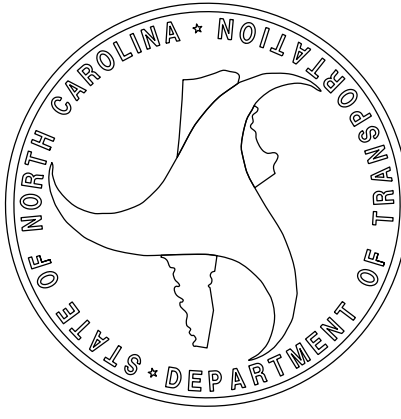

**PAVEMENT SCHEDULE**

C1	PROP. APPROX. 1 1/2" ASPHALT CONCRETE SURFACE COURSE, TYPE S9.5B, AT AN AVERAGE RATE OF 168 LBS. PER SQ. YD.
U	EXISTING PAVEMENT.

**NOTES:**

1. ALL PAVED S.R. ROADS TO BE RESURFACED TO THE ENDS OF RADII OR AS DIRECTED BY THE ENGINEER.
2. SHOULDERS ARE TO BE CONSTRUCTED BY OTHERS.

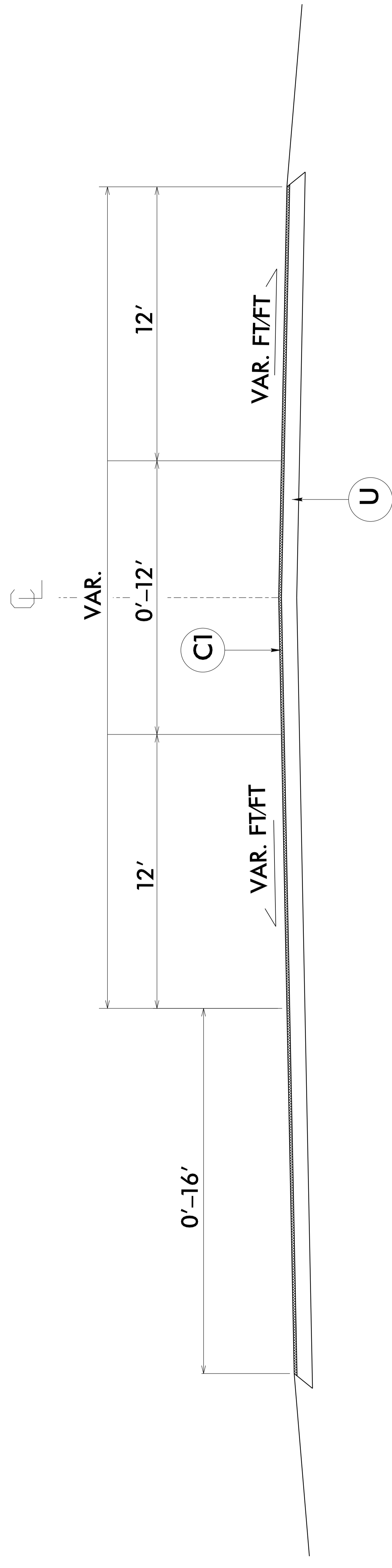

***TYPICAL SECTION #1***

**USE WITH MAP #1**

PROJECT NO.	SHEET NO.
1CR.10271.4	3

## SUMMARY OF QUANTITIES

PROJECT NO	COUNTY	MAP NO	ROUTE	DESCRIPTION	TYP NO	LANES	LANE TYPE	FINAL SURFACE TESTING REQUIRED	WARM MIX ASPHALT REQUIRED	LENGTH MI	WIDTH FT	MOBILIZATION LS	INCIDENTAL STONE BASE TONS	INCIDENTAL MILLING SY	SURFACE COURSE, S9.5B TONS	ASPHALT BINDER FOR PLANT MIX TONS	ADJ. OF METER OR VALVE BOX EA	STATIONARY WORK ZONE SIGN SF	TEMPORARY TRAFFIC CONTROL LS
1CR.10271.4	Currituck	1	US 158			2	2WU	YES	YES	8.36	24	1	100	500	10,935	656	4	300	1
<b>TOTAL FOR MAP NO. 1</b>										<b>8.36</b>		<b>1</b>	<b>100</b>	<b>500</b>	<b>10,935</b>	<b>656</b>	<b>4</b>	<b>300</b>	<b>1</b>
<b>TOTAL FOR PROJ NO. 1CR.10271.4</b>										<b>8.36</b>		<b>1</b>	<b>100</b>	<b>500</b>	<b>10,935</b>	<b>656</b>	<b>4</b>	<b>300</b>	<b>1</b>
<b>GRAND TOTAL</b>										<b>8.36</b>		<b>1</b>	<b>100</b>	<b>500</b>	<b>10,935</b>	<b>656</b>	<b>4</b>	<b>300</b>	<b>1</b>

# SIGNING FOR RESURFACING PROJECTS

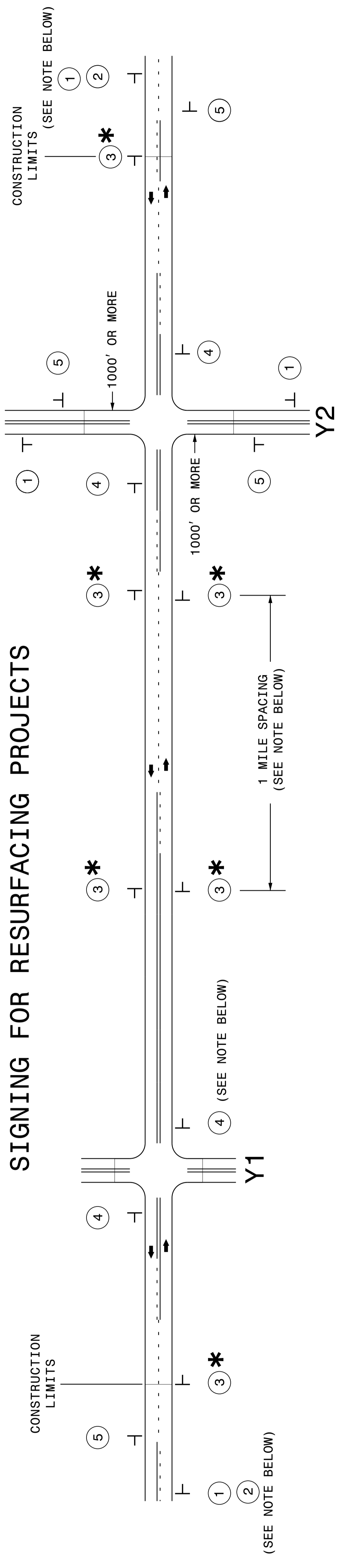

**LEGEND**  
 ┆ STATIONARY SIGN  
 ┆ DIRECTION OF TRAFFIC FLOW

## MAINLINE (-L-) SIGNING

## -Y- LINE SIGNING

**SIGNING NOTES AND PLACEMENT PER DIRECTION**

1	 ROAD WORK AHEAD W20-1 48" X 48"  NEXT XX MILES W7-3aP 24" X 18"	<p>PLACE 1000' PRIOR TO BEGINNING OF CONSTRUCTION LIMITS. ONLY USED ON -Y- LINES IF RESURFACING LIMITS EXTEND 1000' ALONG -Y- LINE.</p> <p>#2 SIGN ONLY USED WHEN RESURFACING LIMITS ARE 2 OR MORE MILES IN LENGTH. ROUND UP TO NEXT WHOLE NUMBER. (NO FRACTIONAL OR DECIMAL NUMBERS)</p>
3	 LOW/SOFT SHOULDER SP 13107 48" X 48"	<p>PLACE INITIALLY AT THE CONSTRUCTION LIMITS AND SPACED 1 MILE APART THEREAFTER. IF NO -Y- LINES EXIST, PLACE 2ND SET 1/2 MILE FROM THE CONSTRUCTION LIMITS AND THEN SPACE 1 MILE THEREAFTER.</p>
4	 ROAD UNDER CONST. SP 13106 48" X 48"	<p>THESE ARE FOR -Y- LINES THAT ARE "THROUGH" ROADWAYS. DEAD END AND SUBDIVISION ROADS ARE NOT "THROUGH" ROADWAYS. INSTALL 500' +/- FROM EACH -Y- LINE APPROACH AS SHOWN ABOVE. FOR MULTIPLE -Y- LINES THAT ARE SEPARATED BY 0.25 MILES OR LESS, TREAT AS A SINGLE UNIT AND INSTALL WITHIN 500' OF EACH APPROACH. A MAXIMUM OF 2 SIGN SETS PER MILE. DO NOT INSTALL WHEN -Y- LINES ARE WITHIN 0.5 MILES FROM "END ROAD WORK" SIGN.</p>
5	 END ROAD WORK G20-2 A 48" X 24"	<p>PLACE 500' FOLLOWING THE END OF CONSTRUCTION LIMITS.</p>

**NO REQUIRED STATIONARY SIGNING FOR THE FOLLOWING -Y- LINE CONDITIONS:**

- 1) LESS THAN 1000' OF RESURFACING ALONG -Y- LINE
- 2) SUBDIVISION ROADS
- 3) DEAD END ROADS

WHEN PAVING/CONSTRUCTION ACTIVITIES PROCEED ACROSS AN UNSIGNED -Y- LINE, ADVANCE WARNING PORTABLE SIGNS SHALL BE USED ALONG THE -Y- LINE AS SHOWN BELOW. REMOVE UPON COMPLETION OF WORK.

ROAD WORK AHEAD  
 W20-1  
 48" X 48"

FLAGGER  
 W20-7 A  
 48" X 48"

PLACED 500' IN ADVANCE OF FLAGGER. PLACED 250' IN ADVANCE OF FLAGGER.

## \* SIGNING FOR ASPHALT SURFACE TREATMENTS (ONLY)

SUBSTITUTE LOW/SOFT SHOULDER SIGNS BY ALTERNATING THE FOLLOWING TWO SIGNS: STARTING WITH "UNMARKED PAVEMENT AHEAD" (SP 06026) FOLLOWED BY "LOOSE GRAVEL" (WB-7).



RESURFACING  
 ADVANCE WARNING SIGNS  
 FOR  
 RURAL AND SUBURBAN  
 2 LANE ROADWAYS

NOTES:  
 1) DETAIL DOES NOT APPLY TO OGAFCC AND ULTRA-THIN BONDED WEARING COURSE.  
 2) BACKFILL SHOULDER WITH APPROVED MATERIAL.  
 3) THE SHOULDER WEDGE DEVICE MAY BE DISENGAGED AT PAVED DRIVEWAYS AND SIDE STREETS.

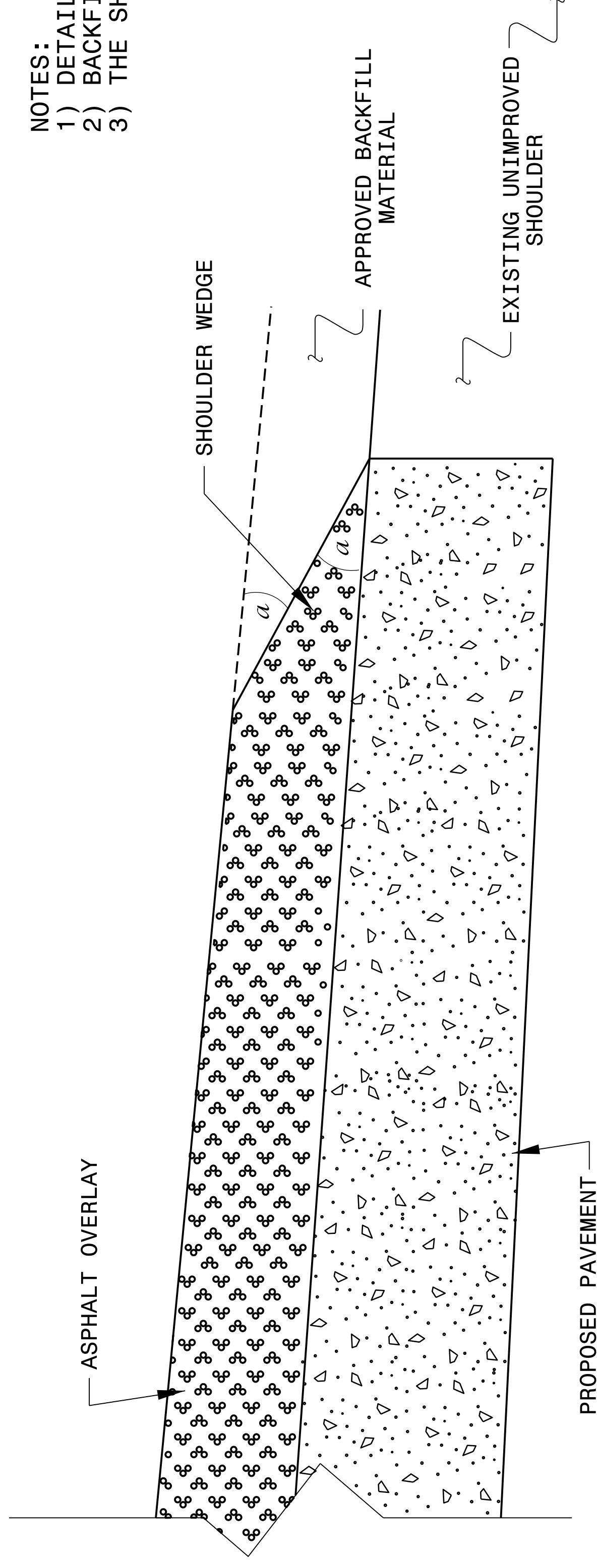

**SHOULDER WEDGE DETAIL**  
 (Resurfacing Projects w/ Widening or  
 with Existing Paved Shoulder having no dropoffs)

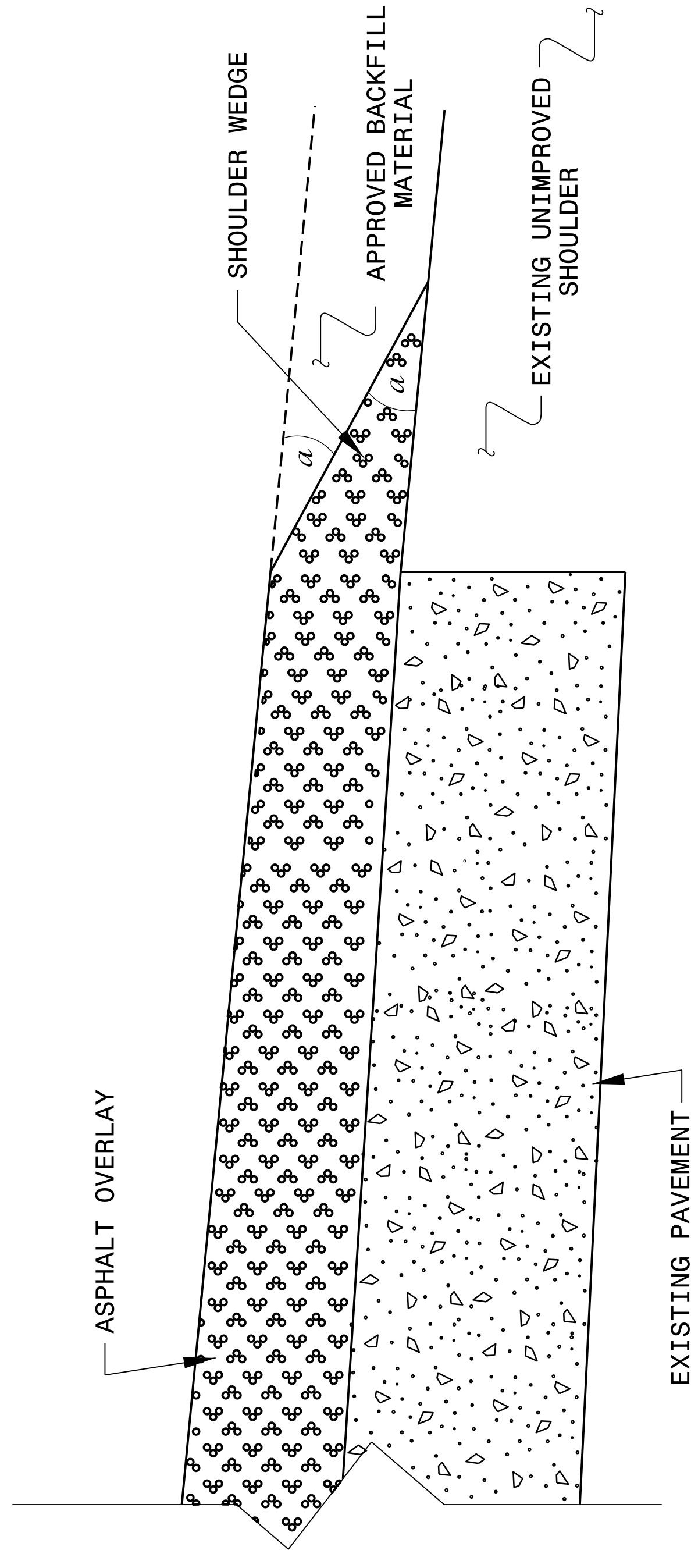

**SHOULDER WEDGE DETAIL**  
 (Resurfacing Projects w/ NO Widening)

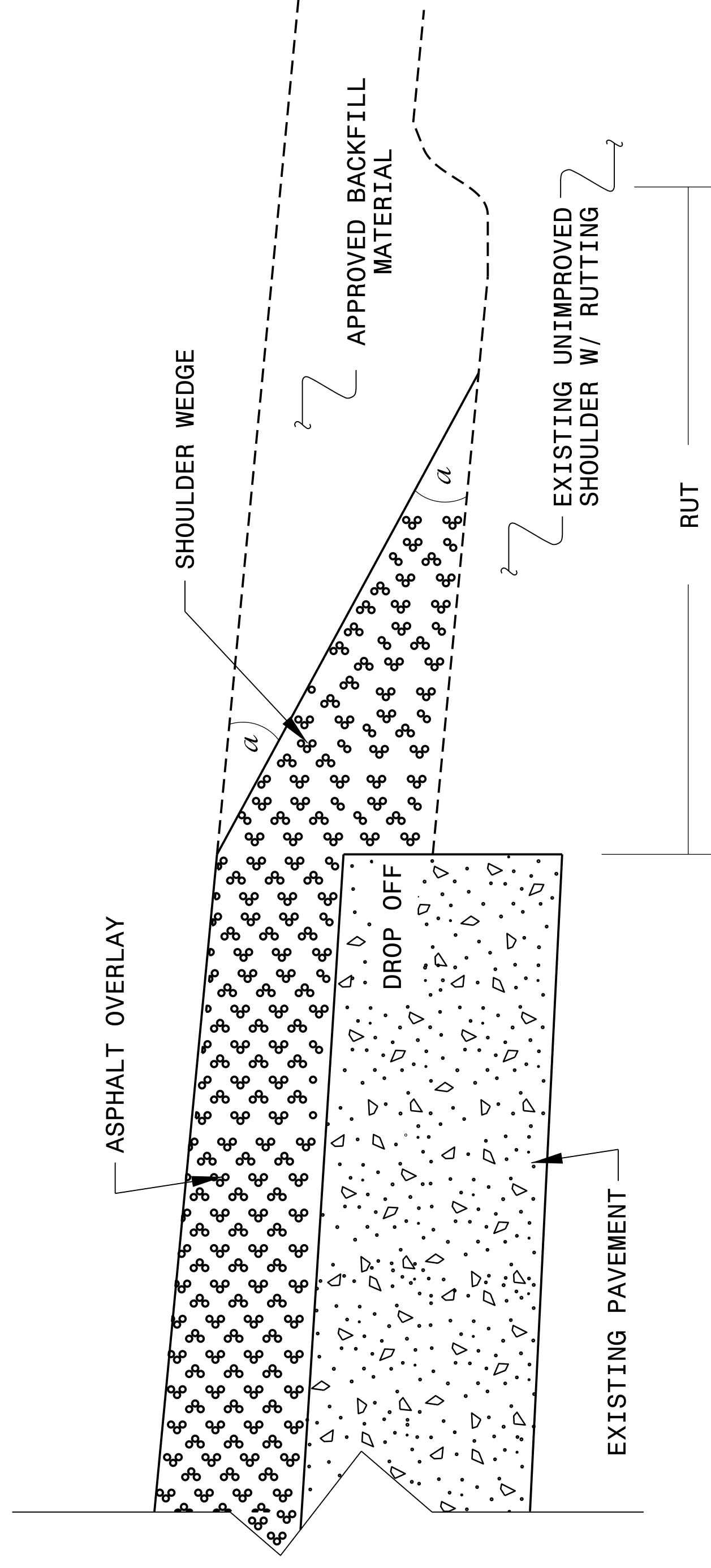

**SHOULDER WEDGE DETAIL**  
 (Resurfacing Adjacent to  
 Rutted Shoulder)

- SHOULDER WEDGE ANGLE = 30°

**CONTRACT STANDARDS  
 AND DEVELOPMENT UNIT**  
 Office 919-707-6950 FAX 919-250-4119

**SHOULDER WEDGE  
 DETAILS**

ORIGINAL BY: T. SPELL DATE: 7-19-11  
 MODIFIED BY: DATE: 10/16/12  
 CHECKED BY: DATE:  
 FILE SPEC.: s:\user\details\stand\shoulderwedge.dwg