

| STATE           | STATE PROJECT REFERENCE NO. | SHEET NO.   | TOTAL SHEETS |
|-----------------|-----------------------------|-------------|--------------|
| N.C.            | 1CR.10581.24, ETC.          | 1           | 4            |
| STATE PROJ. NO. | F.A. PROJ. NO.              | DESCRIPTION |              |
|                 |                             |             |              |
|                 |                             |             |              |
|                 |                             |             |              |
|                 |                             |             |              |
|                 |                             |             |              |

STATE OF NORTH CAROLINA  
DIVISION OF HIGHWAYS

**MARTIN COUNTY**

LOCATION: MAP #1 NC 42 FROM NC 11 TO EDGEcombe COUNTY LINE / MAP #2 SR 1500 FROM RAILROAD CROSSING TO NC 171  
MAP #3 SR 1528 FROM SR 1500 TO SR 1527

TYPE OF WORK: RESURFACING

SR 1500 MAP # 2

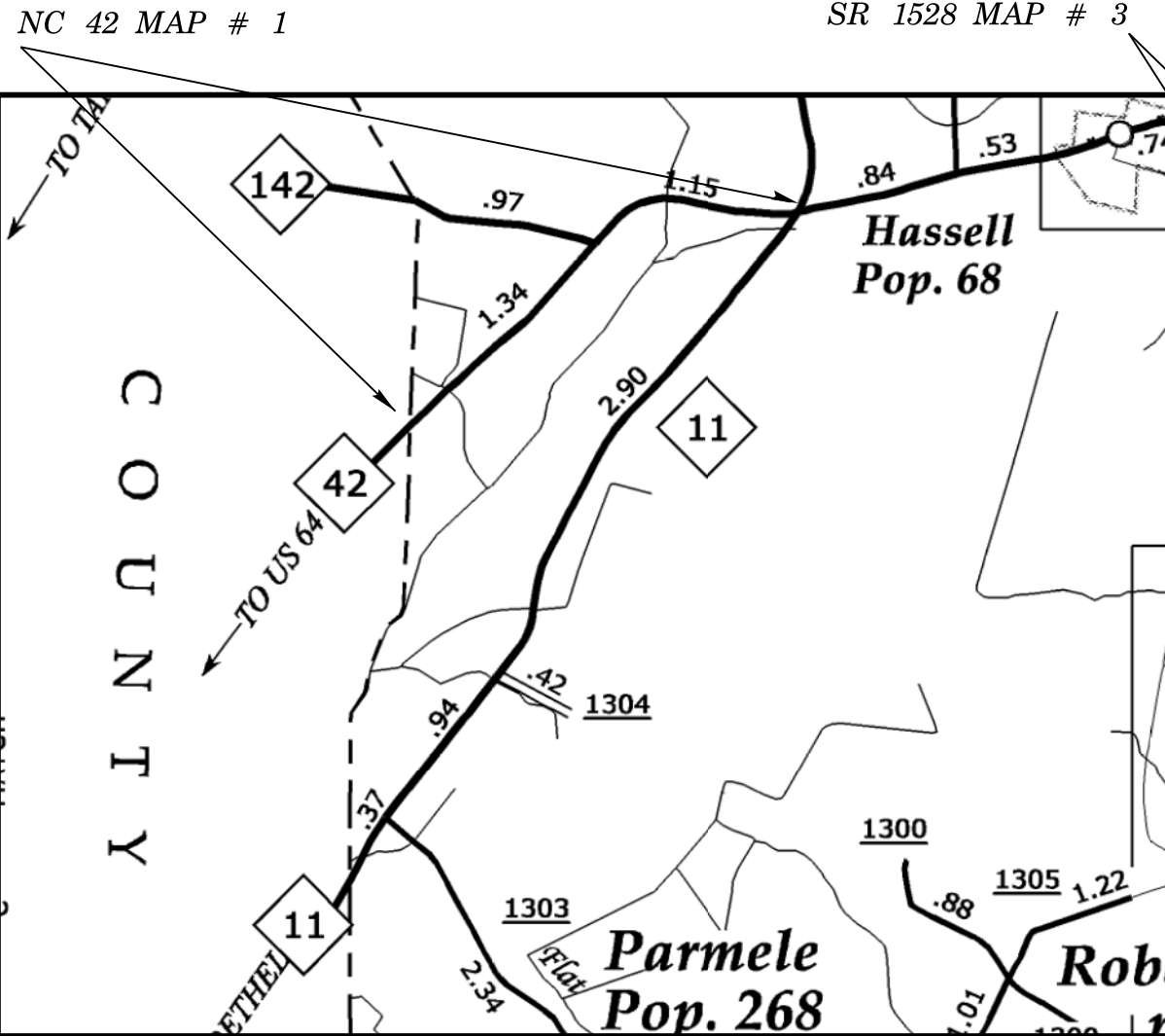

SR 1528 MAP # 3

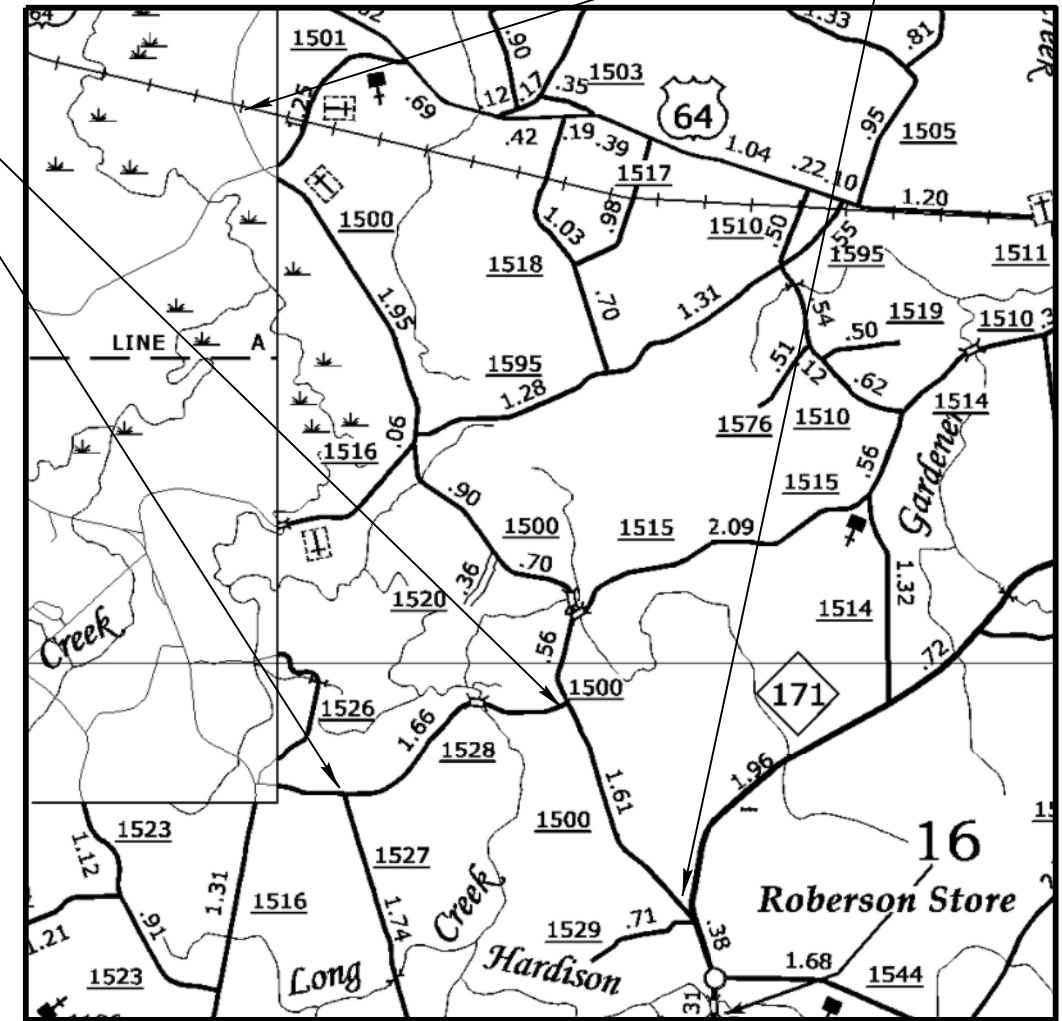

CONTRACT NO.: DA00173 WBS NO.: 1CR.10581.24, ETC.

NOT TO SCALE

PROJECT LENGTH

MAP#1 WBS# 1CR.10581.24 = 2.50 MILES  
MAP#2 WBS# 1CR.20581.54 = 6.30 MILES  
MAP#3 WBS# 1CR.20581.55 = 1.60 MILES

Prepared in the Office of:  
**DIVISION OF HIGHWAYS**

2012 STANDARD SPECIFICATIONS

LETTING DATE:

W.B. HOBBS, P.E.  
DIVISION PROJECT MANAGER

C.E. SLACHTA  
DIVISION PROPOSALS ENGINEER

DIVISION OF HIGHWAYS  
STATE OF NORTH CAROLINA

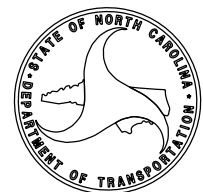

NOTES:

1. ALL PAVED S.R. ROADS TO BE RESURFACED TO THE ENDS OF THE RADII OR AS DIRECTED BY THE ENGINEER
2. EDGES, PAVEMENT WIDENING, INTERSECTIONS, AND BRIDGE FLARES ARE INCLUDED IN THE TABLE OF QUANTITIES
3. SHOULDERS AND DITCHES ARE TO BE CONSTRUCTED BY OTHERS

|                       |           |
|-----------------------|-----------|
| PROJECT REFERENCE NO. | SHEET NO. |
| 1CR.10581.24, ETC.    | 2 OF 4    |

| PAVEMENT SCHEDULE |  |
|-------------------|--|
| C1                | PROP. APPROX. 1.5" ASPHALT CONCRETE SURFACE COURSE TYPE S9.5B, AT AN AVERAGE RATE OF 168 LBS. PER SQ.YD. |
| U                 | EXISTING PAVEMENT.   |

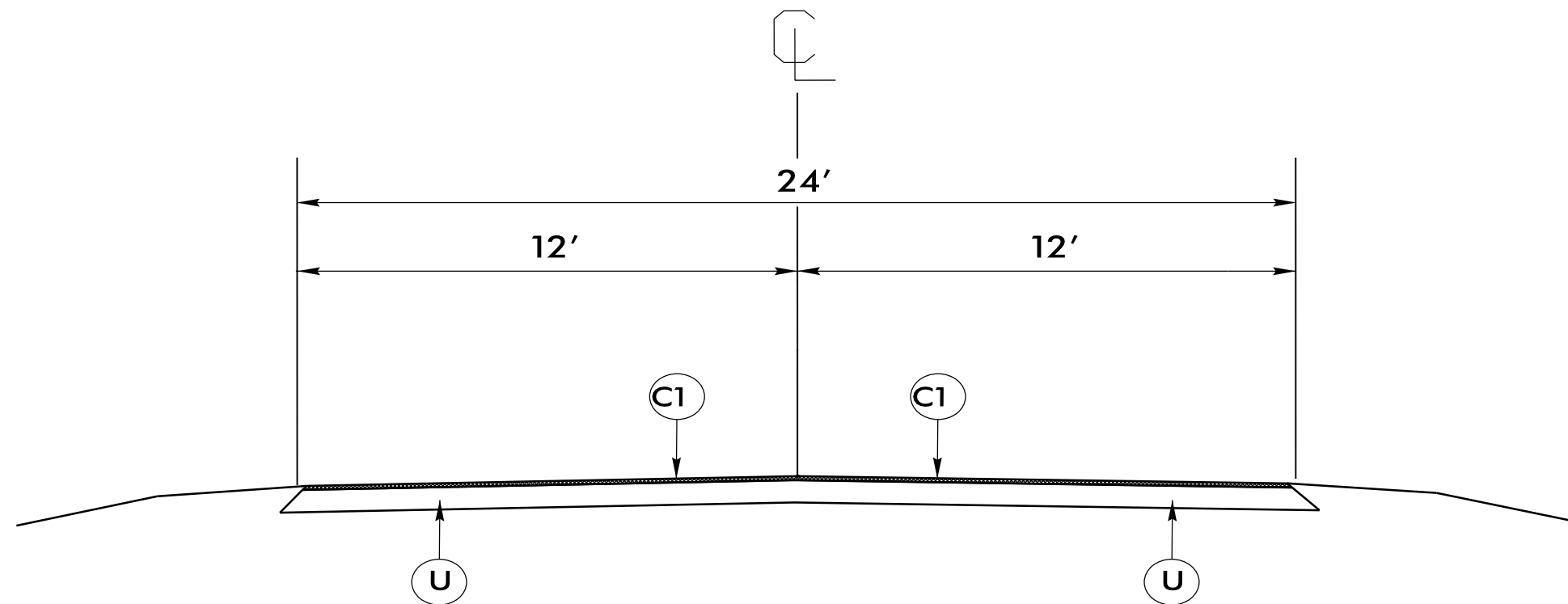

***TYPICAL SECTION #1***

USE WITH MAP 1

NOTES:

1. ALL PAVED S.R. ROADS TO BE RESURFACED TO THE ENDS OF THE RADII OR AS DIRECTED BY THE ENGINEER
2. EDGES, PAVEMENT WIDENING, INTERSECTIONS, AND BRIDGE FLARES ARE INCLUDED IN THE TABLE OF QUANTITIES
3. SHOULDERS AND DITCHES ARE TO BE CONSTRUCTED BY OTHERS

|                       |           |
|-----------------------|-----------|
| PROJECT REFERENCE NO. | SHEET NO. |
| 1CR.10581.24, ETC.    | 3 OF 4    |

| PAVEMENT SCHEDULE |   |
|-------------------|---|
| C1                | PROP. APPROX. 1.5" ASPHALT CONCRETE SURFACE COURSE TYPE SF9.5A, AT AN AVERAGE RATE OF 165 LBS. PER SQ.YD. |
| U                 | EXISTING PAVEMENT.  |

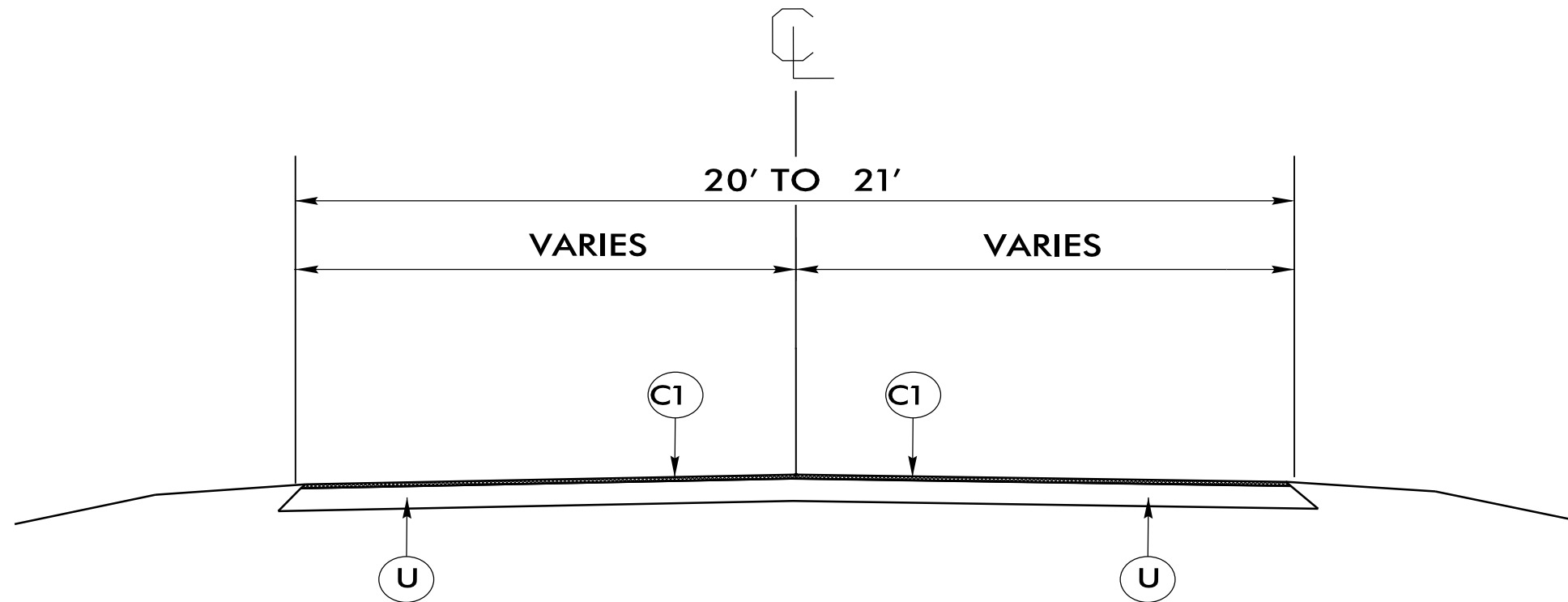

***TYPICAL SECTION #2***  
**USE WITH MAP 2 AND 3**

|                    |                  |                  |
|--------------------|------------------|------------------|
| <b>PROJECT NO.</b> | <b>SHEET NO.</b> | <b>TOTAL NO.</b> |
| 1CR.10581.24 ETC.  | 4                | 4                |

**SUMMARY OF QUANTITIES**

| PROJECT            | COUNTY | MAP | ROUTE   | DESCRIPTION                         | TYP | LANES | LANE TYPE | FINAL SURFACE TESTING REQUIRED | WARM MIX ASPHALT REQUIRED | LENGTH      | WIDTH | MOBILILIZATION | INCIDENTAL MILLING | SURFACE COURSE, S9.5B | SURFACE COURSE, SF9.5A | ASPHALT BINDER FOR PLANT MIX | TEMPORARY TRAFFIC CONTROL |
|--------------------|--------|-----|---------|-------------------------------------|-----|-------|-----------|--------------------------------|---------------------------|-------------|-------|----------------|--------------------|-----------------------|------------------------|------------------------------|---------------------------|
| NO                 |        | NO  |         |                                     | NO  |       |           |                                |                           | MI          | FT    | LUMP SUM       | SY                 | TONS                  | TONS                   | TONS                         | LUMP SUM                  |
| 1CR.10581.24       | Martin | 1   | NC 42   | FROM NC 11 TO EDGECOMBE COUNTY LINE | 1   | 2     | 2WD       | NO                             | NO                        | 2.5         | 24    | 1              |                    | 3,269                 |                        | 196                          | 1                         |
| 1CR.20581.54       | Martin | 2   | SR 1500 | RAILROAD CROOSSING TO NC 171        | 2   | 2     | 2WD       | NO                             | NO                        | 6.3         | 21    | *              | 500                |                       | 7,086                  | 475                          | *                         |
| 1CR.20581.55       | Martin | 3   | SR 1528 | FROM SR1500 TO SR 1527              | 2   | 2     | 2WD       | NO                             | NO                        | 1.6         | 20    | *              | 560                |                       | 1,714                  | 115                          | *                         |
| <b>GRAND TOTAL</b> |        |     |         |                                     |     |       |           |                                |                           | <b>10.4</b> |       | <b>1</b>       | <b>1,060</b>       | <b>3,269</b>          | <b>8,800</b>           | <b>786</b>                   | <b>1</b>                  |

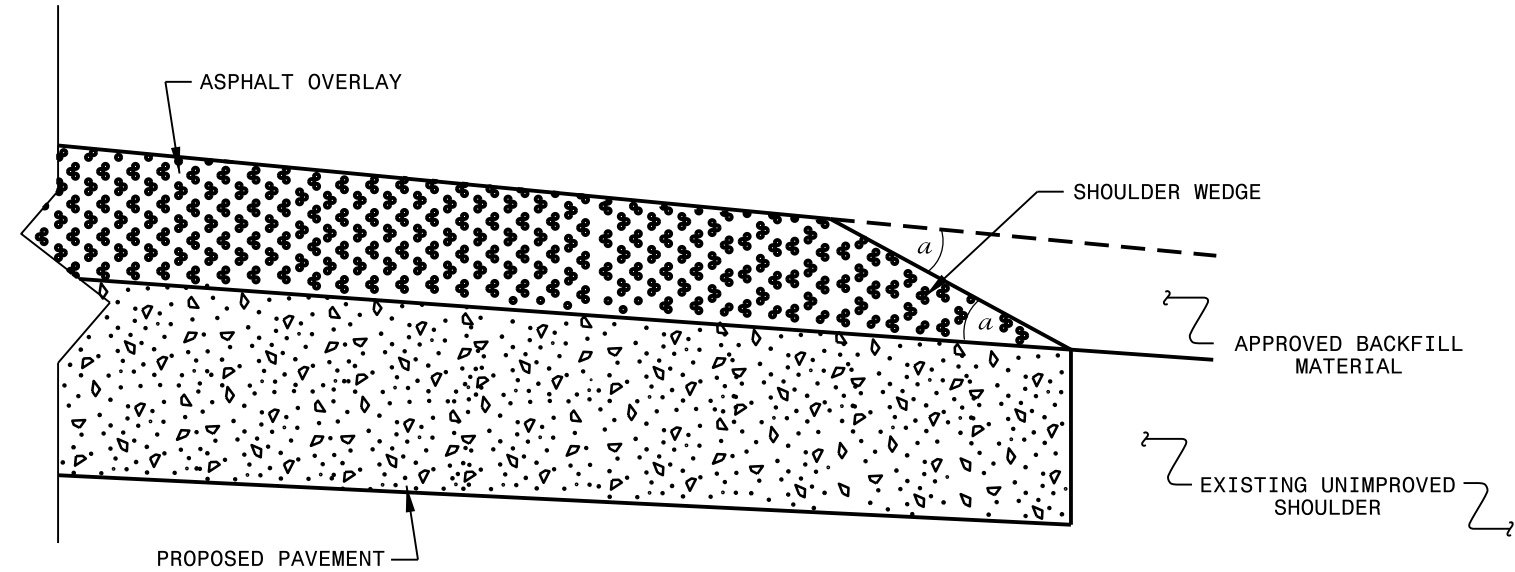

### SHOULDER WEDGE DETAIL

(Resurfacing Projects w/ Widening or  
with Existing Paved Shoulder > 2 ft.)

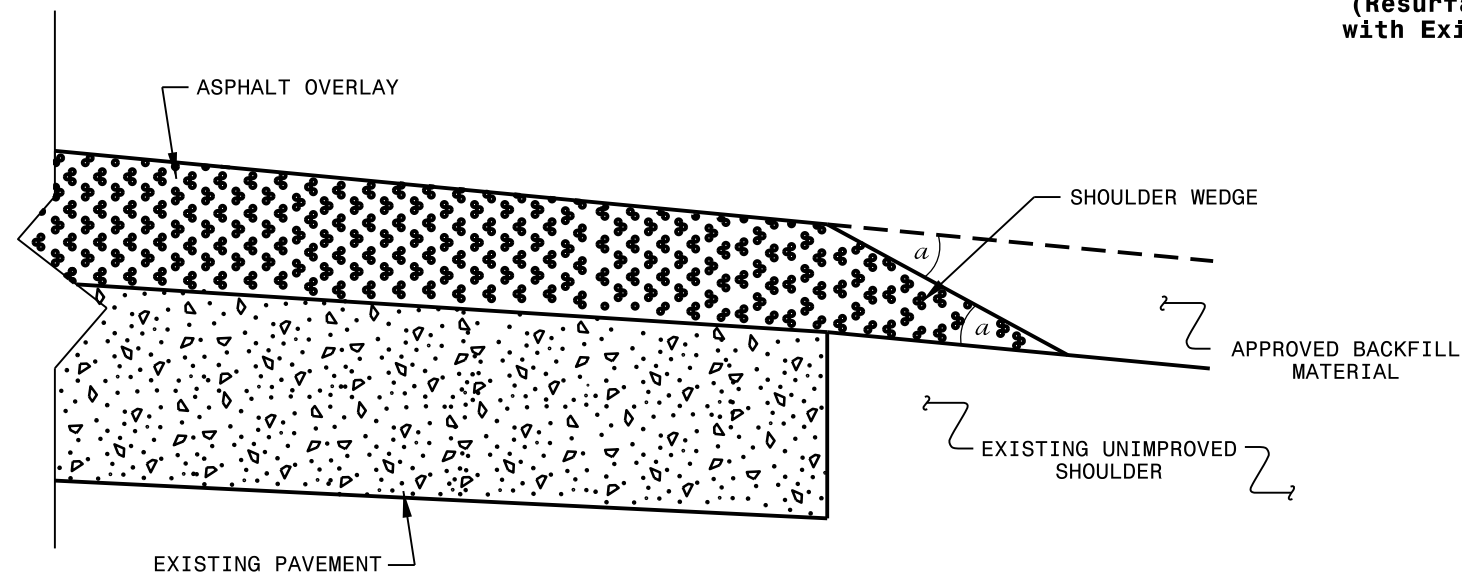

### SHOULDER WEDGE DETAIL

(Resurfacing Projects w/ NO Widening)

**NOTES:**

- 1) DETAIL DOES NOT APPLY TO OGAFB AND ULTRA-THIN BONDED WEARING COURSE.
- 2) BACKFILL SHOULDER WITH APPROVED MATERIAL.
- 3) THE SHOULDER WEDGE DEVICE MAY BE DISENGAGED AT PAVED DRIVEWAYS AND SIDE STREETS.

*a* - SHOULDER WEDGE ANGLE = 30°

|  |                |
|--|----------------|
| <b>CONTRACT STANDARDS<br/>AND DEVELOPMENT UNIT</b>     |                |
| Office 919-707-6950 FAX 919-250-4119                   |                |
| <b>SHOULDER WEDGE<br/>DETAILS</b>                      |                |
| ORIGINAL BY: T.SPELL                                   | DATE: 7-19-11  |
| MODIFIED BY:   | DATE: 10/16/12 |
| CHECKED BY:  | DATE:          |
| FILE SPEC.: susr/details/stand/shoulderwedgedetail.dgn |                |