



STATE OF NORTH CAROLINA  
DEPARTMENT OF TRANSPORTATION

ROY COOPER  
GOVERNOR

JAMES H. TROGDON, III  
SECRETARY

November 8, 2017

**Addendum No. 1**

Contract No.: DA00375

WBS Element: 2018CPT.01.06.10581.1, ETC.

*Milling, Resurfacing, Pavement Markings & Markers on Various Routes in Martin, Tyrrell & Washington Counties*

To Whom It May Concern:

Reference is made to the proposal and plans previously furnished for this project.

The following revisions have been made to the proposal:

Page Nos. 35 A & B, "**Detectable Warnings to Retrofit Existing Curb Ramps**" has been included in the proposal. Please insert Page Nos. 35 A & B in the appropriate location.

Page Nos. 71 - 72, "**Bid Form**" has been revised to include line items for "**Retrofit Existing Curb Ramp**", "**2'-6" Concrete Curb & Gutter**" and "**4" Concrete Sidewalk**". The quantities for "**Concrete Curb Ramps**", "**Thermoplastic Pavement Marking Lines (24", 120 MILS) and "Paint Pavement Marking Lines (24")**", have all been adjusted. Please void existing Page Nos. 71 - 72 and replace with the revised Page Nos. 71 - 72.

Plan Sheet No. 3, "**Summary of Quantities**" has been revised to include line items for "**Retrofit Existing Curb Ramp**", "**2'-6" Concrete Curb & Gutter**" and "**4" Concrete Sidewalk**". The quantities for "**Concrete Curb Ramps**", "**Thermoplastic Pavement Marking Lines (24", 120 MILS) and "Paint Pavement Marking Lines (24")**", have all been adjusted. Please void existing Plan Sheet No. 3 and replace with the revised Plan Sheet No. 3.

Plan Sheet Nos. 7 - 15, have been included in the plans. Please insert Plan Sheet Nos. 7 - 15 in the appropriate location.

If you choose the "Electronic Bid Preparation with Manual Delivery Method", please acknowledge receipt of Addendum #1 in the space provided on the Addendum Acknowledgement Form.

If you choose the "Electronic Bid Preparation with Manual Delivery Method," place DA00375.001 in the same folder with DA00375.EBS, so that Expedite Bid will properly apply the addendum.

*Mailing Address:*  
NC DEPARTMENT OF TRANSPORTATION  
DIVISION ONE  
113 AIRPORT DRIVE, SUITE 100  
EDENTON, NC 27932

*Telephone:* (252) 482-1850  
*Fax:* (252) 482-8722  
*Customer Service:* 1-877-368-4968

*Location:*  
113 AIRPORT DRIVE, SUITE 100  
EDENTON, NC 27932

*Website:* www.ncdot.gov

Sincerely,

DocuSigned by:  
  
CDAEAC77A6394FB...

C. E. Slachta  
Division Proposals Engineer

Cc: C. W. Bridgers Jr., PE  
C. S. Mebane, PE  
D. S. Lee, PE

REVISED 11/8/2017

**DETECTABLE WARNINGS TO RETROFIT EXISTING CURB RAMPS:**

(10-21-03) (Rev. 8-16-11)

848

SP8 R125

**Description**

Construct detectable warnings consisting of raised truncated domes to retrofit existing curb ramps in accordance with the plan details, Section 848 of the *2012 Standard Specifications*, the requirements of the *28 CFR Part 36 ADA Standards for Accessible Design* and these provisions.

**Materials**

Detectable warning for retrofitting existing curb ramps shall consist of raised truncated domes. The description, size and spacing shall conform to Section 848 of the *2012 Standard Specifications*.

Use material for detectable warning systems as shown herein. Material and coating specifications must be stated in the Manufacturers Type 3 Certification and all Detectable Warning systems must be on the NCDOT Approved Products List.

Install detectable warnings created from one of the following materials: precast concrete blocks or bricks, clay paving brick, gray or ductile iron castings, mild steel, stainless steel, and engineered plastics, rubber or composite tile. Only one material type for detectable warning will be permitted per project, unless otherwise approved by the Engineer.

- (A) Detectable Warnings shall consist of a base with integrated raised truncated domes, and when constructed of precast concrete they shall conform to the material requirements of Article 848-2 of the *2012 Standard Specifications*.
- (B) Detectable Warnings shall consist of a base with integrated raised truncated domes, and may be comprised of other materials including, but not limited to, clay paving brick, gray iron or ductile iron castings, mild steel, stainless steel, and engineered plastics, rubber or composite tile, which are applied directly to the curb ramps by incorporating into or attaching to the existing ramp floor. The material shall have an integral color throughout the thickness of the material. The detectable warning shall include fasteners, anchors, or adhesives for attachment in the existing ramp and shall be furnished as a system from the manufacturer.

Prior to installation, the Contractor shall submit to the Engineer assembling instructions from the manufacturer for each type of system used in accordance with Article 105-2 of the *2012 Standard Specifications*. The system shall be furnished as a kit containing all consumable materials and consumable tools, required for the application. They shall be capable of being affixed to or anchored in the concrete curb ramp, including green concrete (concrete that has set but not appreciably hardened). The system shall be solvent free and contain no volatile organic compounds (VOC). The static coefficient of friction shall be 0.8 or greater when measured on top of the truncated domes and when measured between the domes in accordance with ASTM C1028 (dry and wet). The system shall be resistant to deterioration due to exposure to sunlight, water, salt or

REVISED 11/8/2017

adverse weather conditions and impervious to degradation by motor fuels, lubricants and antifreeze.

- (C) When steel or gray iron or ductile iron casting products are provided, only products that meet the requirements of Subarticle 106-1(B) of the *2012 Standard Specifications* may be used. Submit to the Engineer a Type 6 Certification, catalog cuts and installation procedures at least 30 days prior to installation for all.

### Construction Methods

- (A) Prior to placing detectable warnings in existing concrete curb ramps, saw cut to the full depth of the concrete, for other material remove as necessary, and adjust the existing subgrade to the proper grade and in accordance with Article 848-3 of the *2012 Standard Specifications*.
- (B) Install all detectable warning to retrofit existing curb ramps in accordance with the manufacturer's recommendations.

### Measurement and Payment

*Retrofit Existing Curb Ramps* with detectable warnings constructed of any type material will be paid as the actual number of retrofitted curb ramps, completed and accepted. Such price and payment will be full compensation for excavating and backfilling; sawing, repairing and replacing portions of the existing curb ramp within the pay limits for retrofit shown on the detail; pavement repairs; furnishing and placing detectable warnings, construction joints and removing and disposing of portions of the existing curb ramp when required and for all materials, labor, equipment, tools and incidentals necessary to complete the work.

Payment will be made under:

**Pay Item**  
Retrofit Existing Curb Ramp

**Pay Unit**  
Each

County : Martin, Tyrrell, Washington

Line #	Item Number	Sec #	Description	Quantity	Unit Cost	Amount
<b>ROADWAY ITEMS</b>						
0001	0000100000-N	800	MOBILIZATION	Lump Sum	L.S.	
0002	1297000000-E	607	MILLING ASPHALT PAVEMENT, **** DEPTH (1.5" )	356,350 SY		
0003	1519000000-E	610	ASPHALT CONC SURFACE COURSE, TYPE S9.5B	33,325 TON		
0004	1575000000-E	620	ASPHALT BINDER FOR PLANT MIX	2,000 TON		
0005	1704000000-E	SP	PATCHING EXISTING PAVEMENT	250 TON		
0006	2549000000-E	846	2'-6" CONCRETE CURB & GUTTER	300 LF		
0007	2591000000-E	848	4" CONCRETE SIDEWALK	200 SY		
0008	2600000000-N	SP	RETROFIT EXISTING CURB RAMP	1 EA		
0009	2605000000-N	848	CONCRETE CURB RAMP	26 EA		
0010	2830000000-N	858	ADJUSTMENT OF MANHOLES	27 EA		
0011	2845000000-N	858	ADJUSTMENT OF METER BOXES OR VALVE BOXES	21 EA		
0012	4413000000-E	SP	WORK ZONE ADVANCE/GENERAL WARNING SIGNING	3,000 SF		
0013	4457000000-N	SP	TEMPORARY TRAFFIC CONTROL	Lump Sum	L.S.	
0014	4685000000-E	1205	THERMOPLASTIC PAVEMENT MARKING LINES (4", 90 MILS)	162,497 LF		
0015	4686000000-E	1205	THERMOPLASTIC PAVEMENT MARKING LINES (4", 120 MILS)	139,644 LF		
0016	4695000000-E	1205	THERMOPLASTIC PAVEMENT MARKING LINES (8", 90 MILS)	1,000 LF		
0017	4710000000-E	1205	THERMOPLASTIC PAVEMENT MARKING LINES (24", 120 MILS)	3,300 LF		
0018	4721000000-E	1205	THERMOPLASTIC PAVEMENT MARKING CHARACTER (120 MILS)	24 EA		

County : Martin, Tyrrell, Washington

Line #	Item Number	Sec #	Description	Quantity	Unit Cost	Amount
0019	4725000000-E	1205	THERMOPLASTIC PAVEMENT MARKING SYMBOL (90 MILS)	78	EA	
0020	4810000000-E	1205	PAINT PAVEMENT MARKING LINES (4")	300,013	LF	
0021	4820000000-E	1205	PAINT PAVEMENT MARKING LINES (8")	1,000	LF	
0022	4835000000-E	1205	PAINT PAVEMENT MARKING LINES (24")	3,300	LF	
0023	4840000000-N	1205	PAINT PAVEMENT MARKING CHARACTER	24	EA	
0024	4845000000-N	1205	PAINT PAVEMENT MARKING SYMBOL	78	EA	
0025	4905000000-N	1253	SNOWPLOWABLE PAVEMENT MARKERS	1,266	EA	
0026	7444000000-E	1725	INDUCTIVE LOOP SAWCUT	2,000	LF	
0027	7456000000-E	1726	LEAD-IN CABLE (***** (14-2)	200	LF	

1354/Nov08/Q1009926.0/D103162100000/E27

Total Amount Of Bid For Entire Project :

### SUMMARY OF QUANTITIES

PROJECT NO	COUNTY	MAP NO	ROUTE	DESCRIPTION	TYP	LANES	LANE TYPE	FINAL SURFACE TESTING REQUIRED	WARM MIX ASPHALT REQUIRED	MATERIAL TRANSFER VEHICLE REQUIRED	LENGTH MI	WIDTH FT	MOBILIZATION LS	1½" MILLING SY	SURFACE COURSE, S9.5B TONS	ASPHALT BINDER FOR PLANT MIX TONS	PATCHING EXISTING PAVEMENT TONS	2'-6" CONCRETE CURB & GUTTER LF	4" CONCRETE SIDEWALK SY	RETROFIT EXISTING CURB RAMPS EA	CONCRETE CURB RAMPS EA	ADJ. OF MANHOLES EA	ADJ. OF METER OR VALVE BOX EA	INDUCTIVE LOOP LF	LEAD-IN CABLE LF	
2018CPT.01.06.10581.1	Martin	1	NC 11	FROM EDGECOMBE CO. TO NC 42	1	2	2WU	NO	NO	YES	4.20	32	1	82,850	7,950	477	50									
2018CPT.01.06.10581.1	Martin	2	US 64 ALT	FROM PITT CO. TO BEGIN CURB	1	2	2WU	NO	NO	YES	4.44	26	*	82,300	7,600	456	50									
2018CPT.01.06.10891.1	Tyrrell	3	US 64	FROM SCUPPERNONG RIVER BRIDGE TO ECL COLUMBIA	2	2	MU	NO	NO	YES	1.65	60	*	67,500	6,300	378	50	100	100			3	15	14	2,000	200
2018CPT.01.06.10891.1	Tyrrell	4	US 64 BUS	FROM US 64 TO US 64	2	2	2WU	NO	NO	NO	0.48	34	*	12,200	1,150	69	25	200	100			23	12	7		
2018CPT.01.06.10941.1	Washington	5	NC 32	FROM NC 99 TO BEGIN CURB PLYMOUTH	1	2	2WU	NO	NO	YES	4.46	25	*	75,000	6,950	417	50			1						
2018CPT.01.06.10941.1	Washington	6	NC 32/NC 94	FROM ALBEMARLE SOUND BRIDGE TO PEA RIDGE	1	2	2WU	NO	NO	YES	2.00	27	*	36,500	3,375	203	25									
<b>GRAND TOTAL</b>											<b>17.23</b>		<b>1</b>	<b>356,350</b>	<b>33,325</b>	<b>2,000</b>	<b>250</b>	<b>300</b>	<b>200</b>	<b>1</b>	<b>26</b>	<b>27</b>	<b>21</b>	<b>2,000</b>	<b>200</b>	

### THERMOPLASTIC AND PAINT QUANTITIES

PROJECT NO	COUNTY	MAP NO	ROUTE	DESCRIPTION	TYP	LANES	LANE TYPE	FINAL SURFACE TESTING REQUIRED	WARM MIX ASPHALT REQUIRED	MATERIAL TRANSFER VEHICLE REQUIRED	LENGTH MI	WIDTH FT	WORK ZONE ADVANCED / GENERAL WARNING SIGNING SF	TEMPORARY TRAFFIC CONTROL LS	4" X 90 M WHITE THERMO LF	4" X 120 M YELLOW THERMO LF	4" X 120 M WHITE THERMO LF	8" X 90 M YELLOW THERMO LF	24" X 120 M WHITE THERMO LF	THERMO MSG SCHOOL 120 M EA	THERMO LT ARROW 90 M EA	THERMO RT ARROW 90 M EA	THERMO STR & RT ARROW 90 M EA	THERMO STR ARROW 90 M EA	THERMO STR & LT ARROW 90 M EA	
2018CPT.01.06.10581.1	Martin	1	NC 11	FROM EDGECOMBE CO. TO NC 42	1	2	2WU	NO	NO	YES	4.20	32	500	1	45,192	27,720										
2018CPT.01.06.10581.1	Martin	2	US 64 ALT	FROM PITT CO. TO BEGIN CURB	1	2	2WU	NO	NO	YES	4.44	26	500	*	47,774	35,520	500	500			5	2				
2018CPT.01.06.10891.1	Tyrrell	3	US 64	FROM SCUPPERNONG RIVER BRIDGE TO ECL COLUMBIA	2	2	MU	NO	NO	YES	1.65	60	500	*		21,780	4,455	250	2,150	24	52	4	5	6	4	
2018CPT.01.06.10891.1	Tyrrell	4	US 64 BUS	FROM US 64 TO US 64	2	2	2WU	NO	NO	NO	0.48	34	500	*		5,020			1,150							
2018CPT.01.06.10941.1	Washington	5	NC 32	FROM NC 99 TO BEGIN CURB PLYMOUTH	1	2	2WU	NO	NO	YES	4.46	25	500	*	48,011	29,449		250								
2018CPT.01.06.10941.1	Washington	6	NC 32/NC 94	FROM ALBEMARLE SOUND BRIDGE TO PEA RIDGE	1	2	2WU	NO	NO	YES	2.00	27	500	*	21,520	15,200										
<b>GRAND TOTAL</b>											<b>17.23</b>		<b>3,000</b>	<b>1</b>	<b>162,497</b>	<b>134,689</b>	<b>4,955</b>	<b>1,000</b>	<b>3,300</b>	<b>24</b>	<b>57</b>	<b>6</b>	<b>5</b>	<b>6</b>	<b>4</b>	
																<b>139,644</b>				<b>78</b>						

### THERMOPLASTIC AND PAINT QUANTITIES

PROJECT NO	COUNTY	MAP NO	ROUTE	DESCRIPTION	TYP	LANES	LANE TYPE	FINAL SURFACE TESTING REQUIRED	WARM MIX ASPHALT REQUIRED	MATERIAL TRANSFER VEHICLE REQUIRED	LENGTH MI	WIDTH FT	4" WHITE PAINT LF	4" YELLOW PAINT LF	8" YELLOW PAINT LF	24" WHITE PAINT LF	PAINT MSG SCHOOL EA	PAINT LT ARROW EA	PAINT RT ARROW EA	PAINT STR & RT ARROW EA	PAINT STR ARROW EA	PAINT STR & LT ARROW EA	SNOW PLOWABLE MARKERS EA
2018CPT.01.06.10581.1	Martin	1	NC 11	FROM EDGECOMBE CO. TO NC 42	1	2	2WU	NO	NO	YES	4.20	32	44,352	27,720									278
2018CPT.01.06.10581.1	Martin	2	US 64 ALT	FROM PITT CO. TO BEGIN CURB	1	2	2WU	NO	NO	YES	4.44	26	47,774	29,304	500			5	2				300
2018CPT.01.06.10891.1	Tyrrell	3	US 64	FROM SCUPPERNONG RIVER BRIDGE TO ECL COLUMBIA	2	2	MU	NO	NO	YES	1.65	60	4,455	21,780	250	2,150	24	52	4	5	6	4	218
2018CPT.01.06.10891.1	Tyrrell	4	US 64 BUS	FROM US 64 TO US 64	2	2	2WU	NO	NO	NO	0.48	34		5,020		1,150							35
2018CPT.01.06.10941.1	Washington	5	NC 32	FROM NC 99 TO BEGIN CURB PLYMOUTH	1	2	2WU	NO	NO	YES	4.46	25	47,119	29,449	250								300
2018CPT.01.06.10941.1	Washington	6	NC 32/NC 94	FROM ALBEMARLE SOUND BRIDGE TO PEA RIDGE	1	2	2WU	NO	NO	YES	2.00	27	21,520	21,520									135
<b>GRAND TOTAL</b>											<b>17.23</b>		<b>165,220</b>	<b>134,793</b>	<b>1,000</b>	<b>3,300</b>	<b>24</b>	<b>57</b>	<b>6</b>	<b>5</b>	<b>6</b>	<b>4</b>	<b>1,266</b>
																<b>300,013</b>				<b>78</b>			

# US 64 - PEDESTRIAN PAVEMENT MARKING PLAN

REVISED 11/8/2017

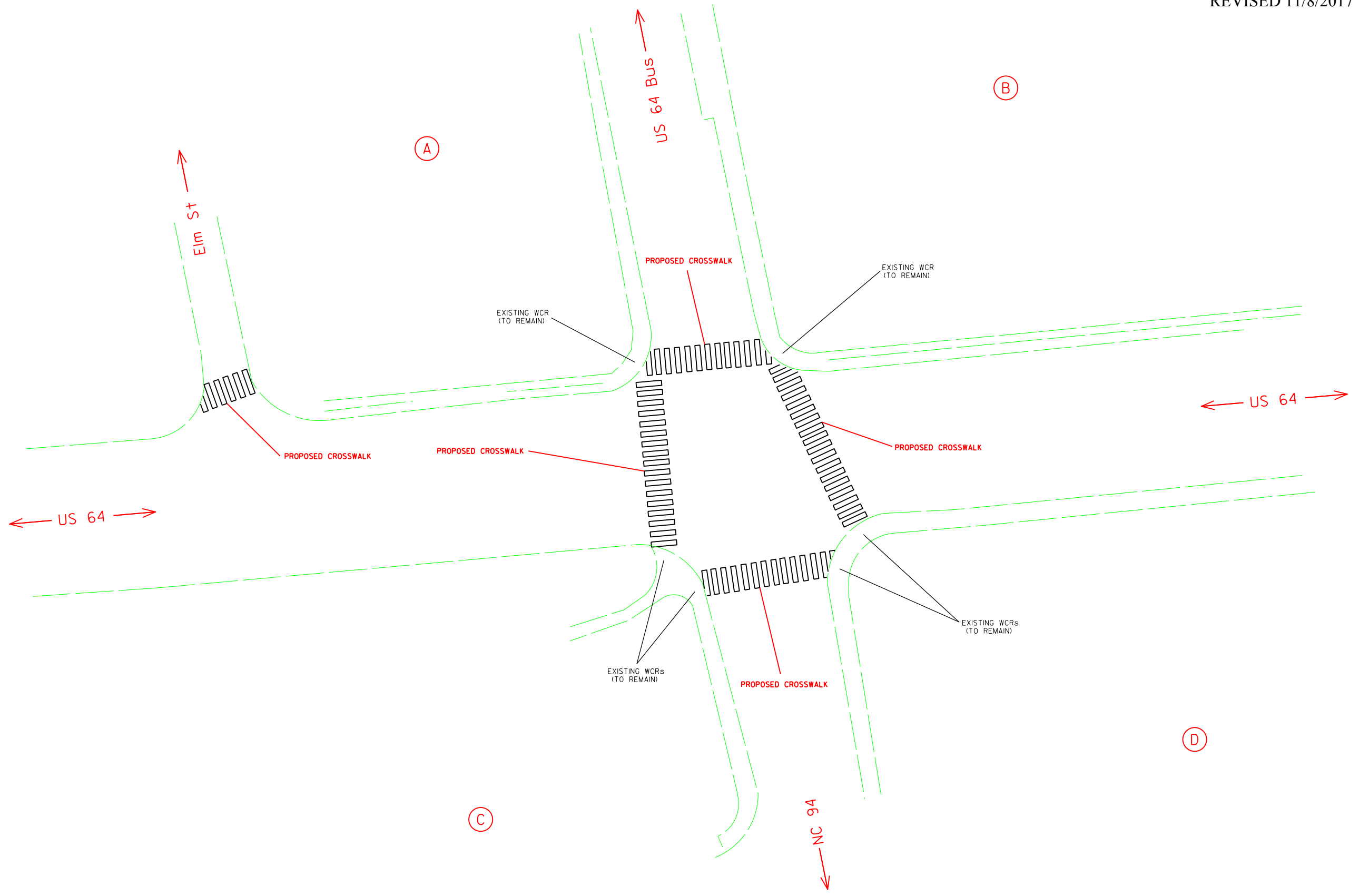

1" = 40 FT



# US 64 - PEDESTRIAN PAVEMENT MARKING PLAN

REVISED 11/8/2017



(A)

(B)

N Road St

US 64

EXISTING WCRs  
(TO REMAIN)

EXISTING WCRs  
(TO REMAIN)

PROPOSED CROSSWALK

US 64

PROPOSED CROSSWALK

EXISTING WCRs  
(TO REMAIN)

EXISTING WCRs  
(TO REMAIN)

(C)

(D)

N Road St

1" = 40 FT

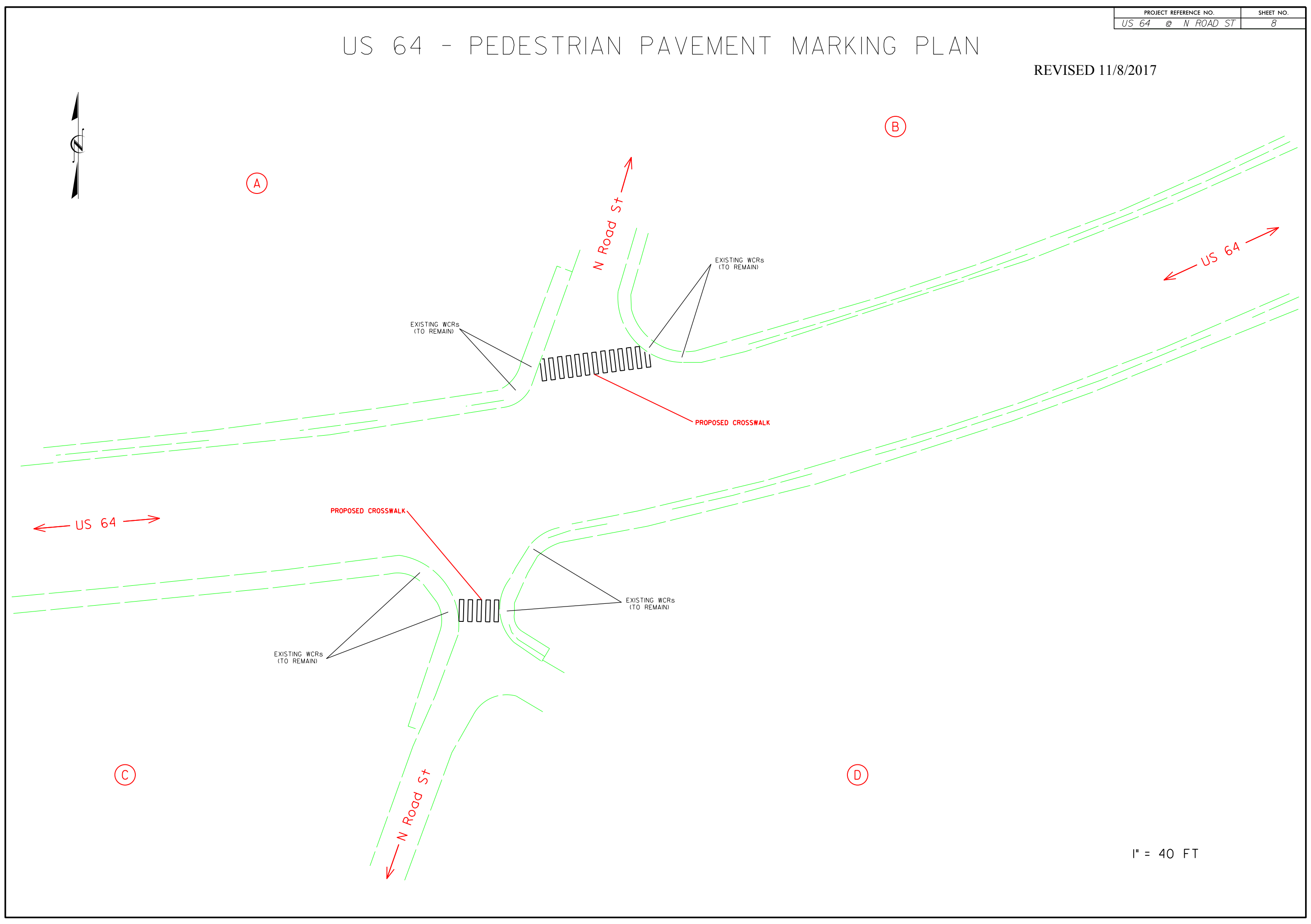

# US 64 - PEDESTRIAN PAVEMENT MARKING PLAN

REVISED 11/8/2017

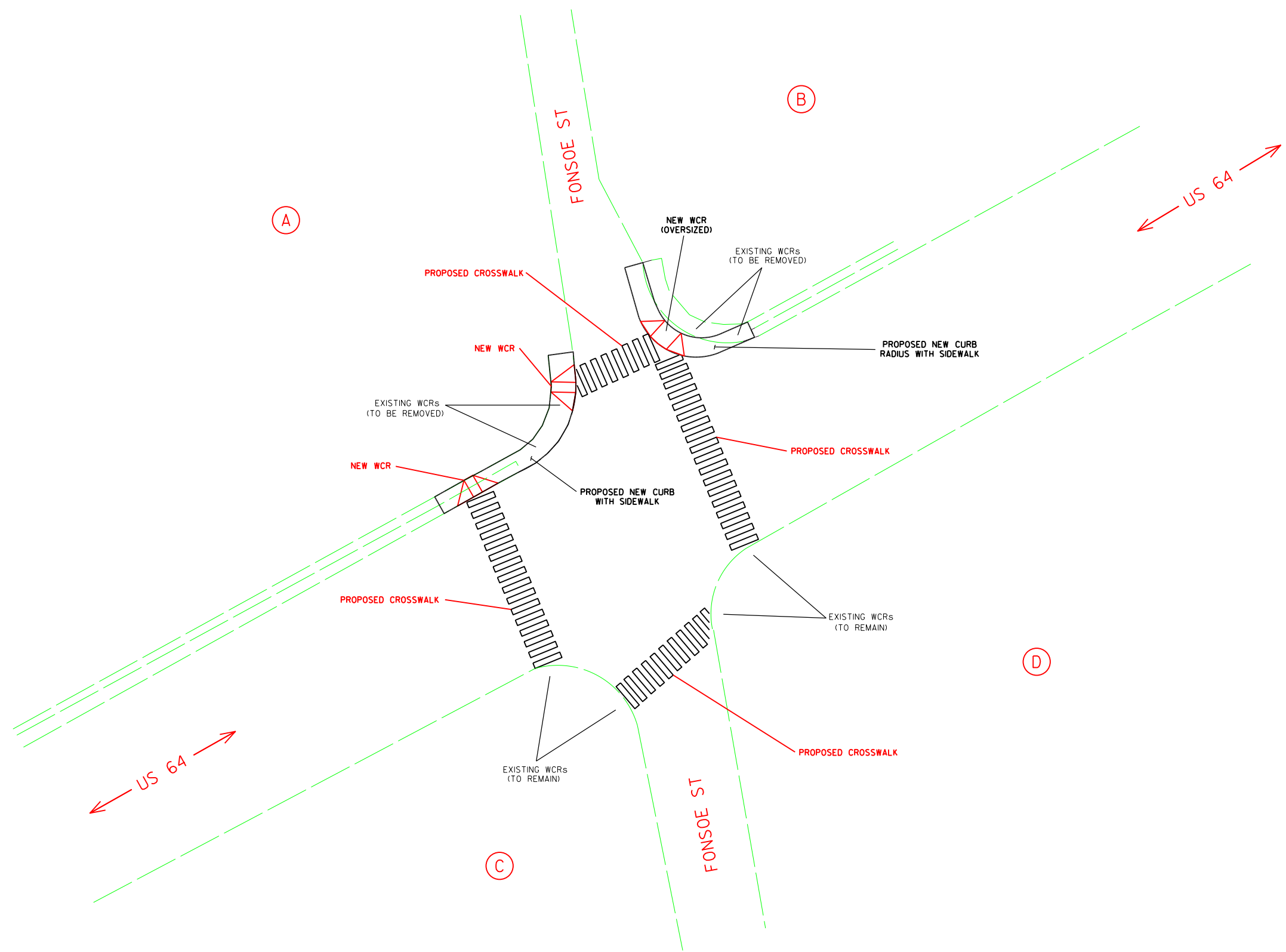

1" = 40 FT

# US 64 - PEDESTRIAN PAVEMENT MARKING PLAN

REVISED 11/8/2017



COLUMBIA HIGH SCHOOL  
PROPERTY

SCHOOL  
ENTRANCE

EXISTING WCRs  
(TO REMAIN)

(B)

EXISTING WCRs  
(TO REMAIN)

EXISTING SIDEWALK

← US 64 →

← US 64 BUS →

PROPOSED CROSSWALK

EXISTING WCRs  
(TO REMAIN)

EXISTING SIDEWALK

(A)

EXISTING WCRs  
(TO REMAIN)

PROPOSED CROSSWALK

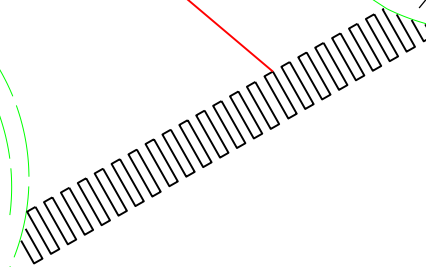

EXISTING SIDEWALK

(C)

← US 64 →

EXISTING SIDEWALK

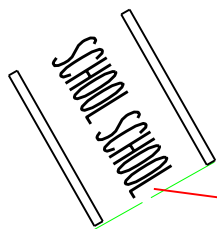

EXISTING SCHOOL SYMBOLS  
(TO BE RELOCATED WEST OF FONSOE ST)

1" = 40 FT

# US 64 BUS - PEDESTRIAN PAVEMENT MARKING PLAN

REVISED 11/8/2017

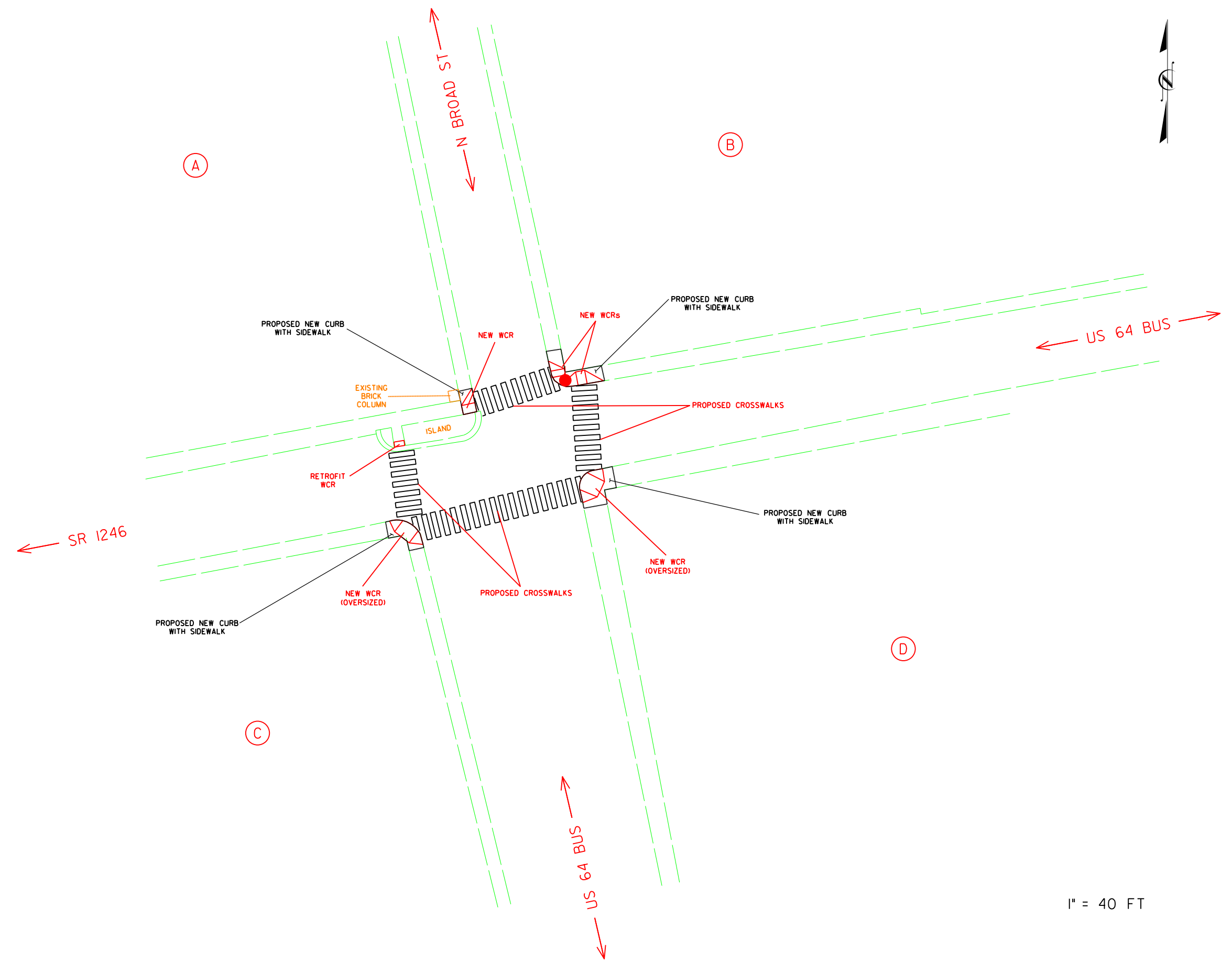

1" = 40 FT

# US 64 BUS - PEDESTRIAN PAVEMENT MARKING PLAN

REVISED 11/8/2017

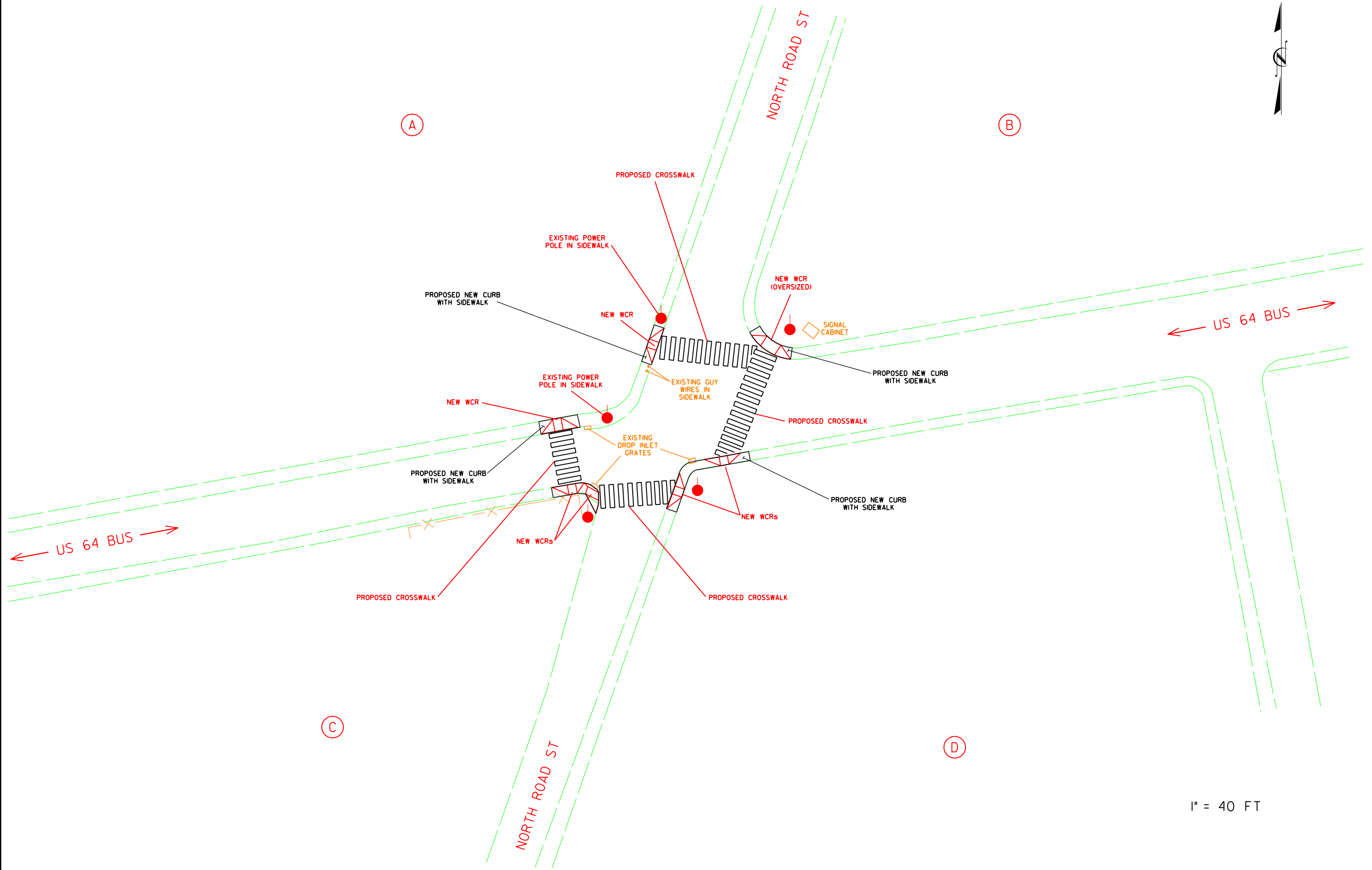

1" = 40 FT

# US 64 BUS - PEDESTRIAN PAVEMENT MARKING PLAN

REVISED 11/8/2017



COLUMBIA HIGH SCHOOL  
PROPERTY

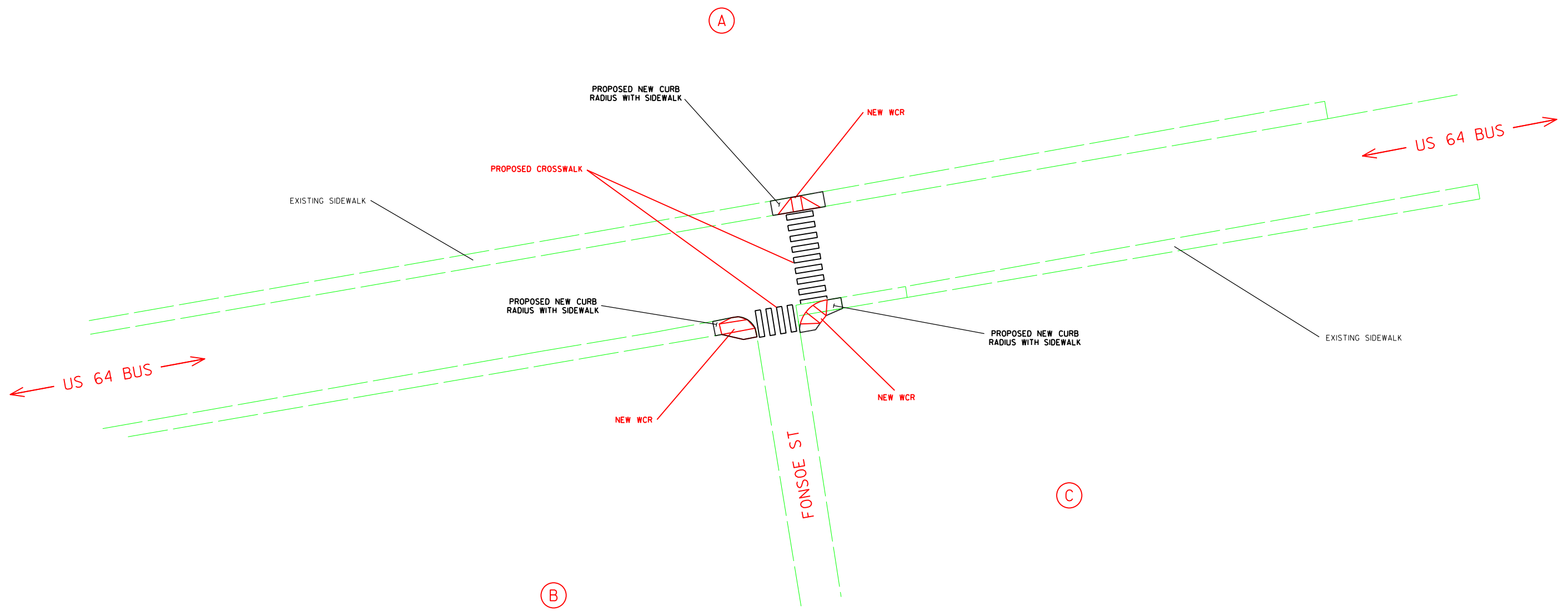

1" = 40 FT

# US 64 / US 64 BUS. - PEDESTRIAN PAVEMENT MARKING PLAN

REVISED 11/8/2017

## PEDESTRIAN ACCOMODATION DATA SHEET

LOCATION	NO. CROSSWALKS	NEW WHEELCHAIR RAMPS	RETROFIT WHEELCHAIR RAMPS	REFERENCE	COMMENTS
US 64 @ WATER ST	1	--	--	--	EXISTING WCRs TO REMAIN IN PLACE
US 64 @ ELM ST	1	--	--	SHEET 7	EXISTING WCRs TO REMAIN IN PLACE
US 64 @ BROAD ST	4	--	--	SHEET 7	EXISTING WCRs TO REMAIN IN PLACE
US 64 @ N ROAD ST	2	--	--	SHEET 8	EXISTING WCRs TO REMAIN IN PLACE
US 64 @ N KOHLOSS ST	2	--	--	--	EXISTING WCRs TO REMAIN IN PLACE
US 64 @ FONSOE ST	4	3	--	SHEET 9	REALIGN RADII, INSTALL 3 NEW WCRs
US 64 @ RAILROAD AVE	1	--	--	--	EXISTING WCRs TO REMAIN IN PLACE
US 64 @ MAIN ST	1	--	--	SHEET 10	EXISTING WCRs TO REMAIN IN PLACE
US 64 @ SCHOOL MAINT RD	1	--	--	SHEET 10	EXISTING WCRs TO REMAIN IN PLACE
MAIN ST @ BROAD ST	4	5	1	SHEET 11	INSTALL 5 NEW, 1 RETRO WCRs
MAIN ST @ CHURCH ST	2	4	--	--	INSTALL 4 NEW WCRs
MAIN ST @ SECOND ST	1	2	--	--	INSTALL 2 NEW WCRs
MAIN ST @ N ROAD ST	4	7	--	SHEET 12	INSTALL 7 NEW WCRs
MAIN ST @ KOHLOSS ST	1	2	--	--	INSTALL 2 NEW WCRs
MAIN ST @ FONSOE ST	2	3	--	SHEET 13	INSTALL 3 NEW WCRs

# US 64 / US 64 BUS. - PEDESTRIAN PAVEMENT MARKING PLAN

REVISED 11/8/2017

## NOTES:

SHEET 7 - US 64 @ NC 94  
INSTALL CROSSWALKS ACCORDING TO THE DIAGRAM  
EXISTING WHEELCHAIR RAMPS AT THIS LOCATION ARE TO REMAIN IN PLACE.

SHEET 8 - US 64 @ N ROAD ST  
INSTALL CROSSWALKS ACCORDING TO THE DIAGRAM  
EXISTING WHEELCHAIR RAMPS AT THIS LOCATION ARE TO REMAIN IN PLACE  
CROSSWALKS ACROSS US 64 ARE NOT NECESSARY AT THIS LOCATION

SHEET 9 - US 64 @ FONSOE ST  
INSTALL CROSSWALKS ON ALL 4 LEGS OF THIS INTERSECTION ACCORDING TO THE DIAGRAM  
REPOUR THE CURBING, SIDEWALK, AND WHEELCHAIR RAMPS ON QUADRANT A OF US 64 @ FONSOE ST  
REALIGN RADIUS AND REPOUR CURBING, SIDEWALK, AND WHEELCHAIR RAMPS ON QUADRANT B OF US 64 @ FONSOE ST  
WHEELCHAIR RAMP AT QUADRANT B TO BE POURED OVERSIZED

SHEET 10- US 64 @ US 64 BUS.  
INSTALL CROSSWALKS ACCORDING TO THE DIAGRAM  
EXISTING WHEELCHAIR RAMPS AT THIS LOCATION ARE TO REMAIN IN PLACE.  
EXISTING SCHOOL SYMBOLS ARE TO BE RELOCATED TO WEST OF FONSOE ST DUE TO SIGNIFICANT PEDESTRIAN TRAFFIC  
CROSSWALKS ACROSS US 64 ARE NOT NECESSARY AT THIS LOCATION

SHEET 11- MAIN ST @ BROAD ST  
INSTALL CROSSWALKS ACCORDING TO THE DIAGRAM  
REPOUR THE CURBING, SIDEWALK, AND WHEELCHAIR RAMPS ACCORDING TO THE DIAGRAM  
RETROFIT EXISTING WHEELCHAIR RAMP LOCATED IN ISLAND AT QUADRANT A  
WHEELCHAIR RAMPS AT QUADRANTS C & D TO BE POURED OVERSIZED

SHEET 12 - US 64 BUS @ N ROAD ST  
INSTALL CROSSWALKS ACCORDING TO THE DIAGRAM  
REPOUR THE CURBING, SIDEWALK, AND WHEELCHAIR RAMPS ACCORDING TO THE DIAGRAM  
RETROFIT EXISTING WHEELCHAIR RAMP LOCATED IN ISLAND AT QUADRANT A  
WHEELCHAIR RAMPS AT QUADRANT B TO BE POURED OVERSIZED  
WHEELCHAIR RAMPS AT THIS LOCATION MAY HAVE TO BE MOVED SLIGHTLY TO AVOID OBSTRUCTIONS

SHEET 13 - US 64 @ FONSOE ST  
INSTALL CROSSWALKS ACCORDING TO THE DIAGRAM  
REPOUR THE CURBING, SIDEWALK, AND WHEELCHAIR RAMPS ACCORDING TO THE DIAGRAM

- \*THE CONTRACTOR IS TO COORDINATE WITH THE TYRRELL COUNTY SCHOOL SUPERINTENDENT THROUGHOUT THE LENGTH OF THE PROJECT
- \* ANY DEVIATION FROM THE PEDESTRIAN PAVEMENT MARKING PLAN MUST BE APPROVED BY THE ENGINEER AND SCHOOL SUPERINTENDENT