

STATE OF NORTH CAROLINA  
DIVISION OF HIGHWAYS

# MARTIN COUNTY

LOCATION: MAP 1 NC 11 FROM EDGEcombe CO. TO NC 42  
 MAP 2 US 64 ALT FROM PITT CO. TO BEGINNING OF CURB AND GUTTER  
 TYPE OF WORK: MILLING, RESURFACING, & PAVEMENT MARKINGS

STATE	STATE PROJECT REFERENCE NO.	SHEET NO.	TOTAL SHEETS
N.C.	2018CPT.01.06.10581.1, ETC.	1	1
STATE PROJ. NO.	F.A. PROJ. NO.	DESCRIPTION	
2018CPT.01.06.10581.1		MAP 1	
2018CPT.01.06.10581.1		MAP 2	

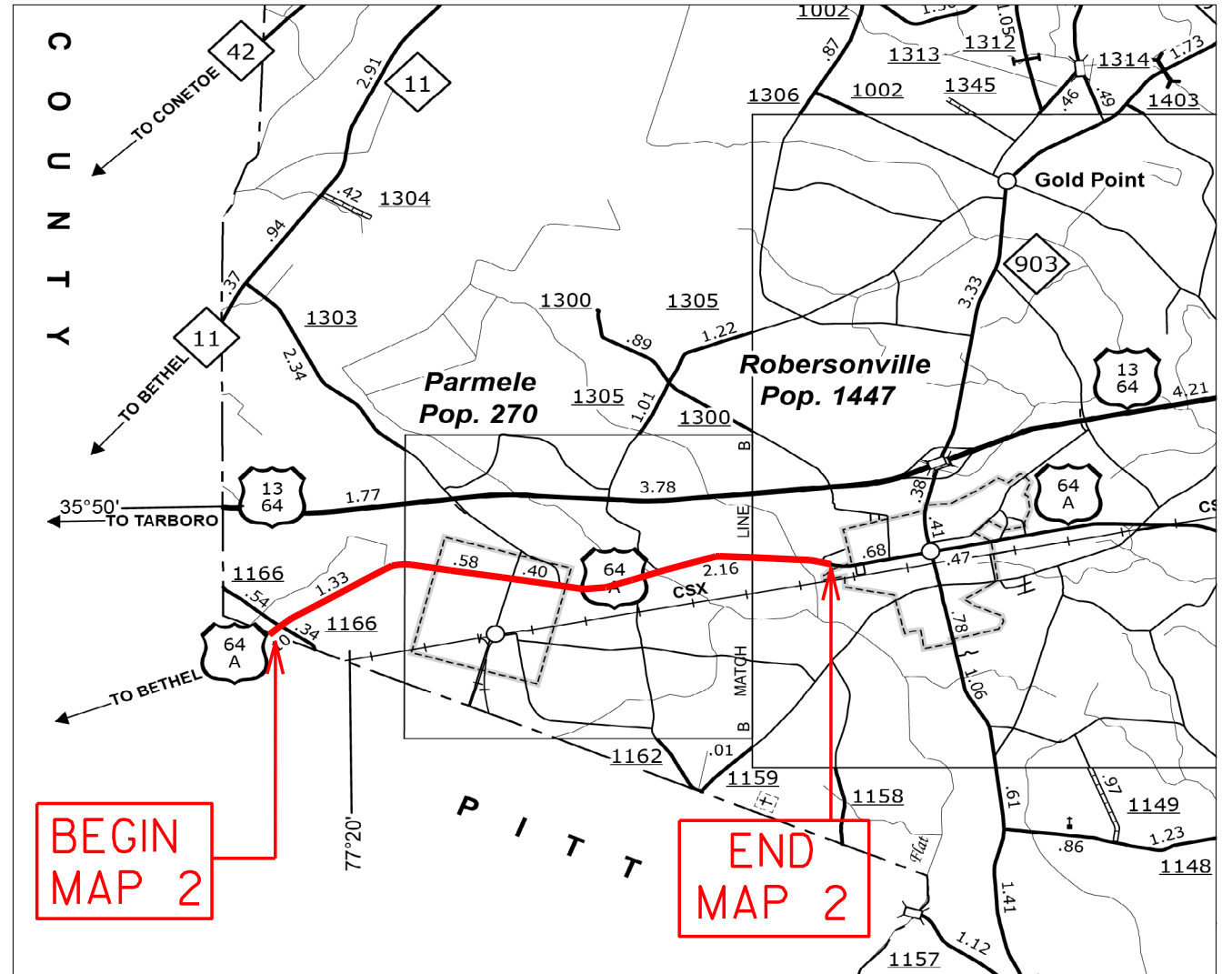
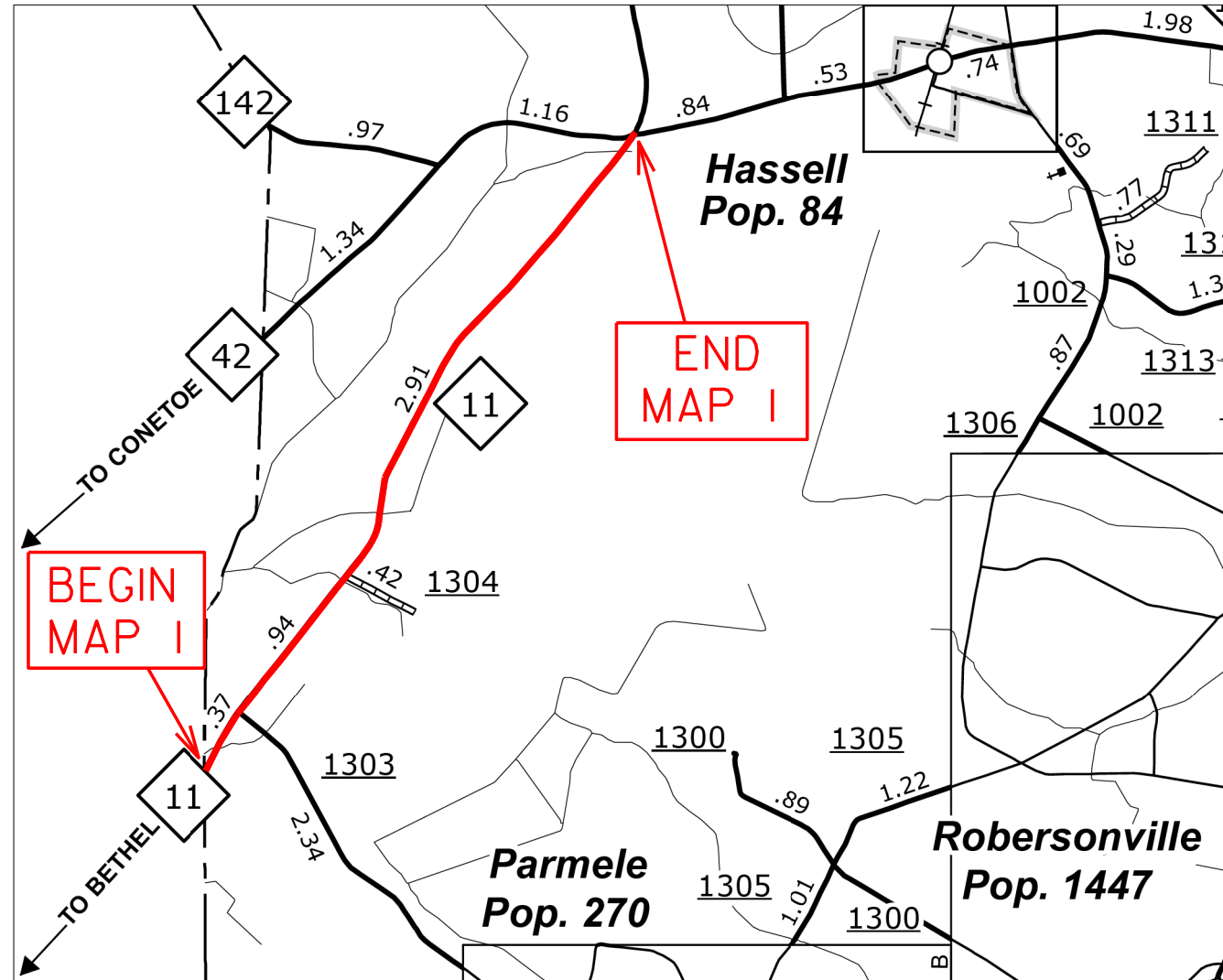

**CONTRACT: DA00375 WBS PROJECT: 2018CPT.01.06.10581.1, ETC.**

**NOT TO SCALE**

**PROJECT LENGTH**

LENGTH OF ROADWAY PROJECT MAP 1 = 4.20 MI.  
 LENGTH OF ROADWAY PROJECT MAP 2 = 4.44 MI.

Prepared in the Office of:  
**DIVISION OF HIGHWAYS**  
 113 Airport Dr., Edenton NC, 27932

2012 STANDARD SPECIFICATIONS

LETTING DATE: \_\_\_\_\_

**W.B. HOBBS, P.E.**  
 DIVISION PROJECT MANAGER

**C.E. SLACHTA**  
 DIVISION PROPOSALS ENGINEER

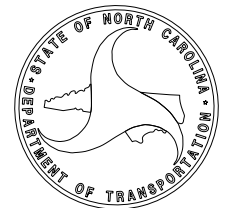

\$\$\$\$\$SYTIME\$\$\$\$\$  
 \$\$\$DDN\$\$\$\$\$  
 \$\$\$USERNAME\$\$\$\$\$

09/08/99

CONTRACT: DA00375 WBS PROJECT: 2018CPT.01.06.10581.1, ETC.

STATE OF NORTH CAROLINA  
DIVISION OF HIGHWAYS

STATE	STATE PROJECT REFERENCE NO.	SHEET NO.	TOTAL SHEETS
N.C.	2018CPT.01.06.10581.1, ETC.	1A	
STATE PROJ. NO.	F.A. PROJ. NO.	DESCRIPTION	
2018CPT.01.06.10891.1		MAP 3	
2018CPT.01.06.10891.1		MAP 4	

# TYRRELL COUNTY

LOCATION: MAP 3 US 64 FROM SCUPPERNONG RIVER BRIDGE TO ECL COLUMBIA  
 MAP 4 US 64 BUS. FROM US 64 TO US 64  
 TYPE OF WORK: MILLING, RESURFACING, & PAVEMENT MARKINGS

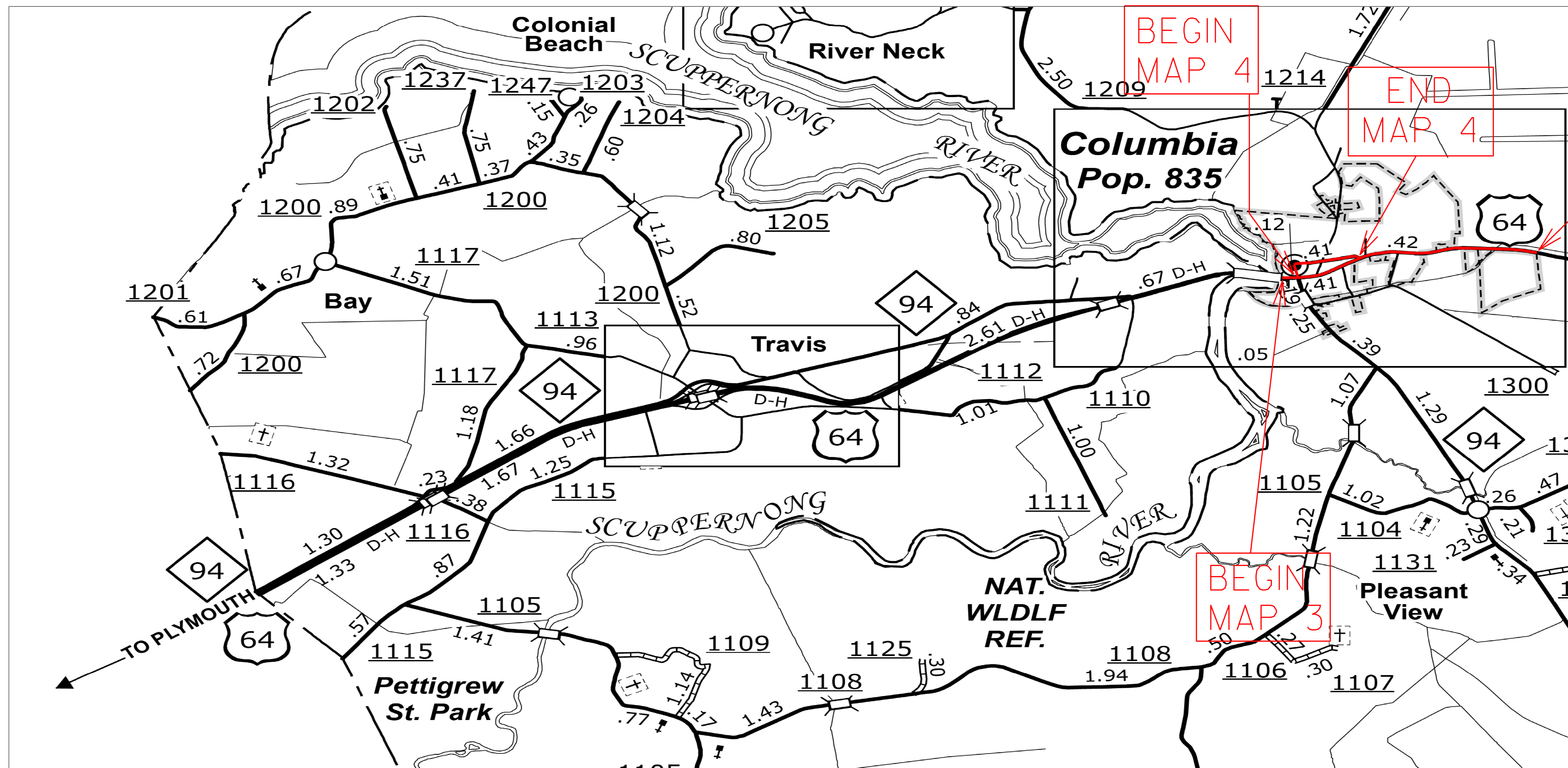

**NOT TO SCALE**

**PROJECT LENGTH**

LENGTH OF ROADWAY PROJECT MAP 3 = 1.65 MI.  
 LENGTH OF ROADWAY PROJECT MAP 4 = 0.48 MI.

Prepared in the Office of:  
**DIVISION OF HIGHWAYS**  
 113 Airport Dr., Edenton NC, 27932

2012 STANDARD SPECIFICATIONS

LETTING DATE:

**W.B. HOBBS, P.E.**  
 DIVISION PROJECT MANAGER

**C.E. SLACHTA**  
 DIVISION PROPOSALS ENGINEER

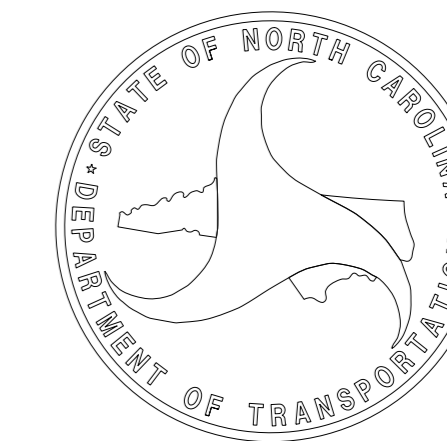

\$\$\$\$\$SYTIME\$\$\$\$\$  
 \$\$\$DDON\$\$\$\$\$  
 \$\$\$USERNAME\$\$\$\$\$

STATE OF NORTH CAROLINA  
DIVISION OF HIGHWAYS

STATE	STATE PROJECT REFERENCE NO.	SHEET NO.	TOTAL SHEETS
N.C.	2018CPT.01.06.10581.1, ETC.	1B	
STATE PROJ. NO.	F.A. PROJ. NO.	DESCRIPTION	
2018CPT.01.06.10941.1		MAP 5	
2018CPT.01.06.10941.1		MAP 6	

# WASHINGTON COUNTY

LOCATION: MAP 5 NC 32 FROM NC 99 TO BEGINNING OF CURB AND GUTTER  
MAP 6 NC 32/NC 94 FROM ALBEMARLE SOUND BRIDGE TO PEA RIDGE  
TYPE OF WORK: MILLING, RESURFACING, & PAVEMENT MARKINGS

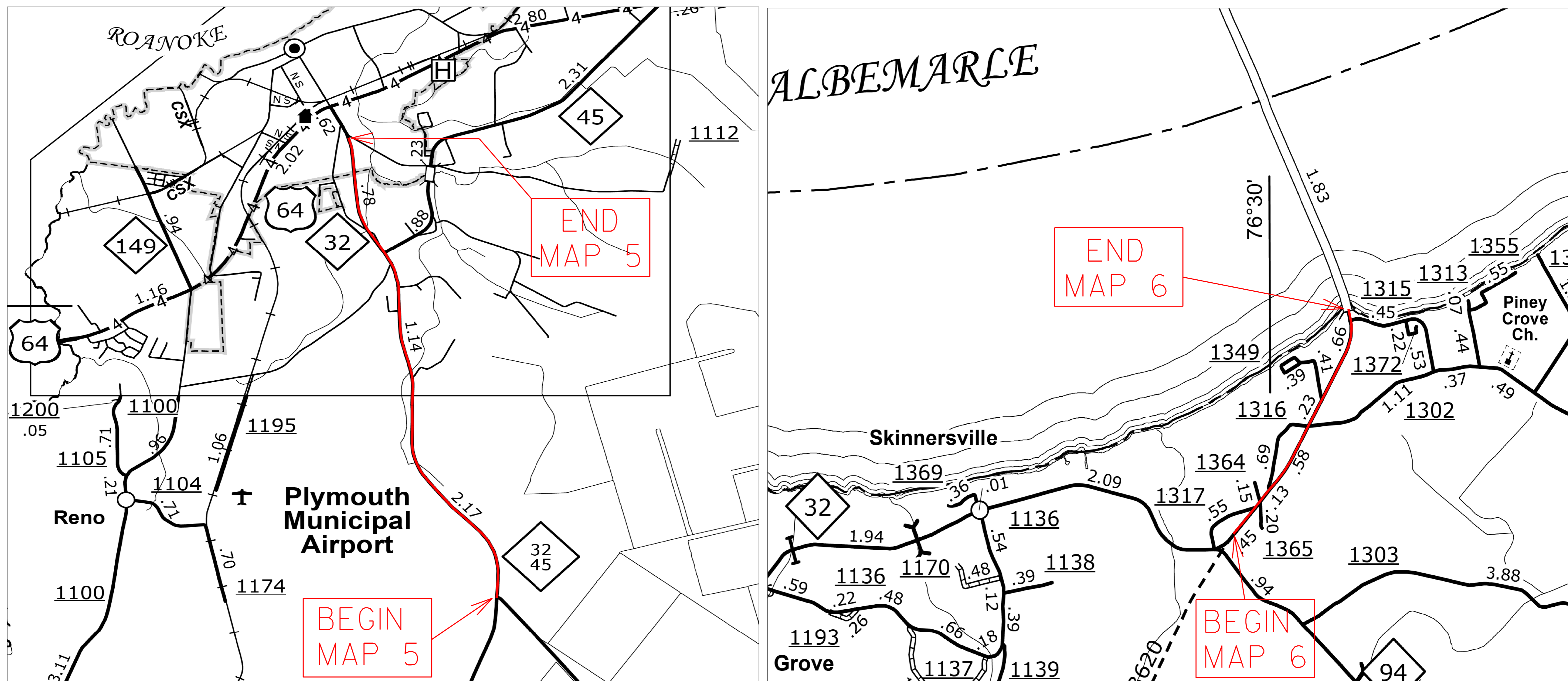

CONTRACT: DA00375 WBS PROJECT: 2018CPT.01.06.10581.1, ETC.

**NOT TO SCALE**

**PROJECT LENGTH**

LENGTH OF ROADWAY PROJECT MAP 5 = 4.46 MI.  
LENGTH OF ROADWAY PROJECT MAP 6 = 2.00 MI.

Prepared in the Office of:  
**DIVISION OF HIGHWAYS**  
113 Airport Dr., Edenton NC, 27932

2012 STANDARD SPECIFICATIONS

LETTING DATE:

**W.B. HOBBS, P.E.**  
DIVISION PROJECT MANAGER

**C.E. SLACHTA**  
DIVISION PROPOSALS ENGINEER

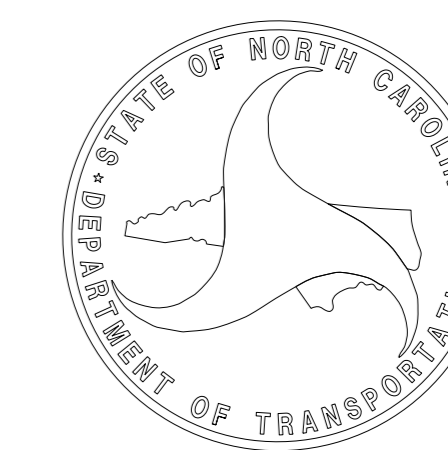

\$\$\$\$\$SYTIME\$\$\$\$\$  
\$\$\$\$\$DON\$\$\$\$\$  
\$\$\$\$\$USERNAME\$\$\$\$\$

P A V E M E N T   S C H E D U L E

C1	PROP. APPROX. 1.5" ASPHALT CONCRETE SURFACE COURSE, TYPE S9.5B, AT AN AVERAGE RATE OF 168 LBS. PER SQ. YD.
V1	MILLING BITUMINOUS PAVEMENT. 1.5"DEPTH.
U	EXISTING PAVEMENT.

NOTES:

\*ALL PAVED S.R. ROADS TO BE RESURFACED TO THE ENDS OF THE RADII., OR AS DIRECTED BY THE ENGINEER.

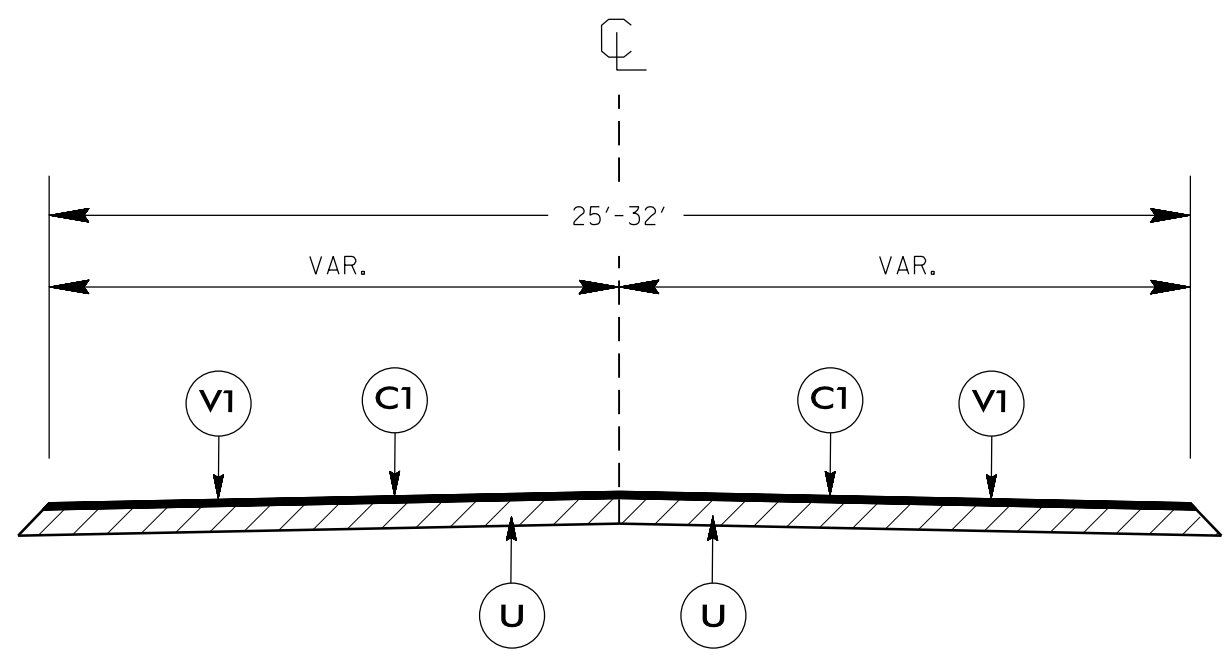

**TYPICAL SECTION NO. 1**

USE WITH MAPS 1, 2, 5, 6

**NTS**

PAVEMENT SCHEDULE

C1	PROP. APPROX. 1.5" ASPHALT CONCRETE SURFACE COURSE, TYPE S9.5B, AT AN AVERAGE RATE OF 168 LBS. PER SQ. YD.
V1	MILLING BITUMINOUS PAVEMENT. 1.5" IN DEPTH.
U	EXISTING PAVEMENT.

NOTES:

- \*ALL PAVED S.R. ROADS TO BE RESURFACED TO THE ENDS OF THE RADII., OR AS DIRECTED BY THE ENGINEER
- \*EDGES, PAVEMENT WIDENING, INTERSECTIONS, AND BRIDGE FLARES ARE INCLUDED IN THE SUMMARY OF QUANTITIES
- \*CONTRACTOR SHALL MILL 1.5" BELOW EXISTING EDGE OF CONC. CURB & GUTTER.
- \*IN AREAS WHERE THE ROADWAY IS PAVED TO THE FACE OF THE CURB, THE CONTRACTOR SHALL MILL AND RESURFACE ROADWAY TO MATCH EXISTING PAVEMENT.

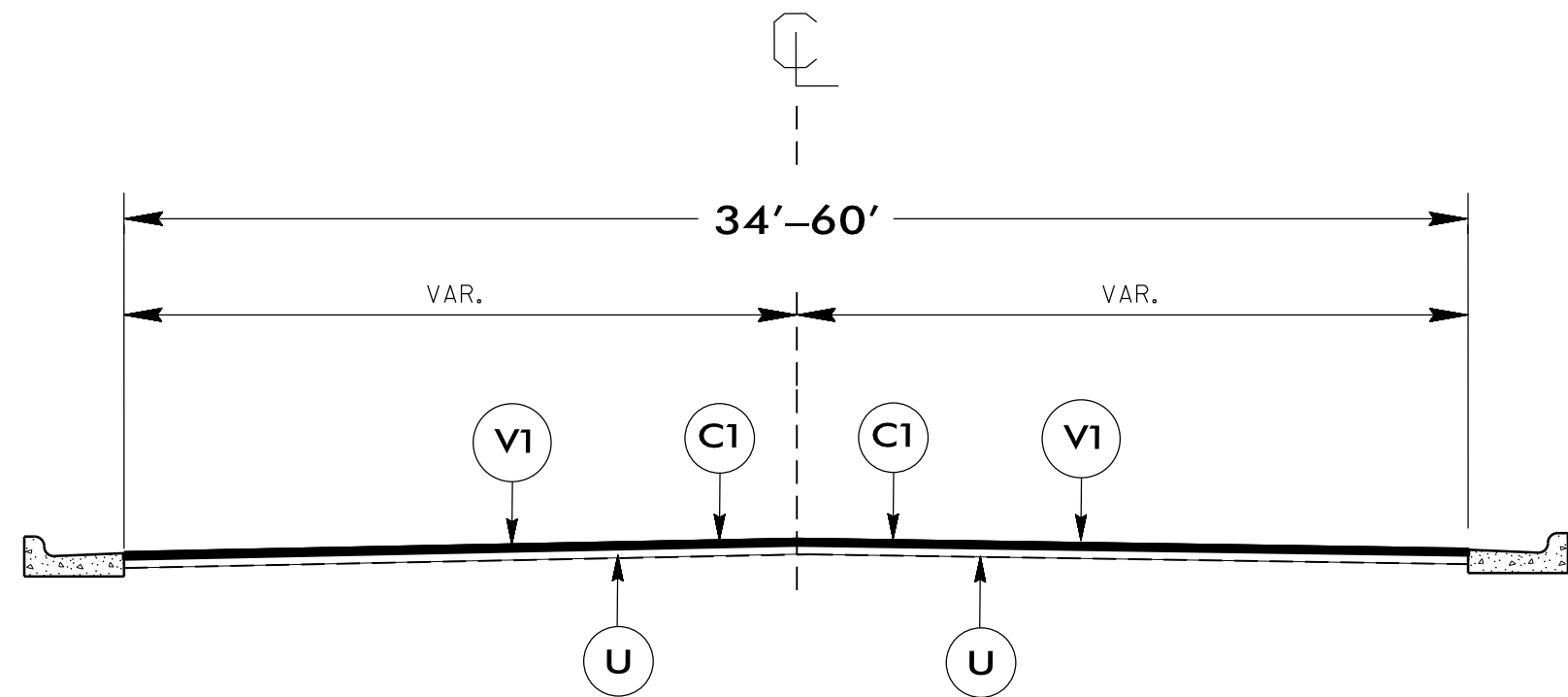

**TYPICAL SECTION NO. 2**

USE WITH MAPS 3, 4

05-SEP-2017 08:55 C:\Users\jboconnor\Documents\2018 Resurfacing\0A00XXX\_psh.dgn

NTS

### SUMMARY OF QUANTITIES

PROJECT NO	COUNTY	MAP NO	ROUTE	DESCRIPTION	TYP	LANES	LANE TYPE	FINAL SURFACE TESTING REQUIRED	WARM MIX ASPHALT REQUIRED	MATERIAL TRANSFER VEHICLE REQUIRED	LENGTH MI	WIDTH FT	MOBILIZATION LS	1½" MILLING SY	SURFACE COURSE, S9.5B TONS	ASPHALT BINDER FOR PLANT MIX TONS	PATCHING EXISTING PAVEMENT TONS	CONCRETE CURB RAMPS EA	ADJ. OF MANHOLES EA	ADJ. OF METER OR VALVE BOX EA	INDUCTIVE LOOP LF	LEAD-IN CABLE LF
2018CPT.01.06.10581.1	Martin	1	NC 11	FROM EDGECOMBE CO. TO NC 42	1	2	2WU	NO	NO	YES	4.20	32	1	82,850	7,950	477	50					
2018CPT.01.06.10581.1	Martin	2	US 64 ALT	FROM PITT CO. TO BEGIN CURB	1	2	2WU	NO	NO	YES	4.44	26	*	82,300	7,600	456	50					
2018CPT.01.06.10891.1	Tyrrell	3	US 64	FROM SCUPPERNONG RIVER BRIDGE TO ECL COLUMBIA	2	2	MU	NO	NO	YES	1.65	60	*	67,500	6,300	378	50	8	15	14	2,000	200
2018CPT.01.06.10891.1	Tyrrell	4	US 64 BUS	FROM US 64 TO US 64	2	2	2WU	NO	NO	NO	0.48	34	*	12,200	1,150	69	25	4	12	7		
2018CPT.01.06.10941.1	Washington	5	NC 32	FROM NC 99 TO BEGIN CURB PLYMOUTH	1	2	2WU	NO	NO	YES	4.46	25	*	75,000	6,950	417	50					
2018CPT.01.06.10941.1	Washington	6	NC 32/NC 94	FROM ALBEMARLE SOUND BRIDGE TO PEA RIDGE	1	2	2WU	NO	NO	YES	2.00	27	*	36,500	3,375	203	25					
<b>GRAND TOTAL</b>											<b>17.23</b>		<b>1</b>	<b>356,350</b>	<b>33,325</b>	<b>2,000</b>	<b>250</b>	<b>12</b>	<b>27</b>	<b>21</b>	<b>2,000</b>	<b>200</b>

### THERMOPLASTIC AND PAINT QUANTITIES

PROJECT NO	COUNTY	MAP NO	ROUTE	DESCRIPTION	TYP	LANES	LANE TYPE	FINAL SURFACE TESTING REQUIRED	WARM MIX ASPHALT REQUIRED	MATERIAL TRANSFER VEHICLE REQUIRED	LENGTH MI	WIDTH FT	WORK ZONE ADVANCED / GENERAL WARNING SIGNING SF	TEMPORARY TRAFFIC CONTROL LS	4" X 90 M WHITE THERMO LF	4" X 120 M YELLOW THERMO LF	4" X 120 M WHITE THERMO LF	8" X 90 M YELLOW THERMO LF	24" X 120 M WHITE THERMO LF	THERMO MSG SCHOOL 120 M EA	THERMO LT ARROW 90 M EA	THERMO RT ARROW 90 M EA	THERMO STR & RT ARROW 90 M EA	THERMO STR ARROW 90 M EA	THERMO STR & LT ARROW 90 M EA	
2018CPT.01.06.10581.1	Martin	1	NC 11	FROM EDGECOMBE CO. TO NC 42	1	2	2WU	NO	NO	YES	4.20	32	500	1	45,192	27,720										
2018CPT.01.06.10581.1	Martin	2	US 64 ALT	FROM PITT CO. TO BEGIN CURB	1	2	2WU	NO	NO	YES	4.44	26	500	*	47,774	35,520	500	500			5	2				
2018CPT.01.06.10891.1	Tyrrell	3	US 64	FROM SCUPPERNONG RIVER BRIDGE TO ECL COLUMBIA	2	2	MU	NO	NO	YES	1.65	60	500	*		21,780	4,455	250	1,800	24	52	4	5	6	4	
2018CPT.01.06.10891.1	Tyrrell	4	US 64 BUS	FROM US 64 TO US 64	2	2	2WU	NO	NO	NO	0.48	34	500	*		5,020			150							
2018CPT.01.06.10941.1	Washington	5	NC 32	FROM NC 99 TO BEGIN CURB PLYMOUTH	1	2	2WU	NO	NO	YES	4.46	25	500	*	48,011	29,449		250								
2018CPT.01.06.10941.1	Washington	6	NC 32/NC 94	FROM ALBEMARLE SOUND BRIDGE TO PEA RIDGE	1	2	2WU	NO	NO	YES	2.00	27	500	*	21,520	15,200										
<b>GRAND TOTAL</b>											<b>17.23</b>		<b>3,000</b>	<b>1</b>	<b>162,497</b>	<b>134,689</b>	<b>4,955</b>	<b>1,000</b>	<b>1,950</b>	<b>24</b>	<b>57</b>	<b>6</b>	<b>5</b>	<b>6</b>	<b>4</b>	
																<b>139,644</b>		<b>78</b>								

### THERMOPLASTIC AND PAINT QUANTITIES

PROJECT NO	COUNTY	MAP NO	ROUTE	DESCRIPTION	TYP	LANES	LANE TYPE	FINAL SURFACE TESTING REQUIRED	WARM MIX ASPHALT REQUIRED	MATERIAL TRANSFER VEHICLE REQUIRED	LENGTH MI	WIDTH FT	4" WHITE PAINT LF	4" YELLOW PAINT LF	8" YELLOW PAINT LF	24" WHITE PAINT LF	PAINT MSG SCHOOL EA	PAINT LT ARROW EA	PAINT RT ARROW EA	PAINT STR & RT ARROW EA	PAINT STR ARROW EA	PAINT STR & LT ARROW EA	SNOW PLOWABLE MARKERS EA
2018CPT.01.06.10581.1	Martin	1	NC 11	FROM EDGECOMBE CO. TO NC 42	1	2	2WU	NO	NO	YES	4.20	32	44,352	27,720									278
2018CPT.01.06.10581.1	Martin	2	US 64 ALT	FROM PITT CO. TO BEGIN CURB	1	2	2WU	NO	NO	YES	4.44	26	47,774	29,304	500			5	2				300
2018CPT.01.06.10891.1	Tyrrell	3	US 64	FROM SCUPPERNONG RIVER BRIDGE TO ECL COLUMBIA	2	2	MU	NO	NO	YES	1.65	60	4,455	21,780	250	1,800	24	52	4	5	6	4	218
2018CPT.01.06.10891.1	Tyrrell	4	US 64 BUS	FROM US 64 TO US 64	2	2	2WU	NO	NO	NO	0.48	34		5,020		150							35
2018CPT.01.06.10941.1	Washington	5	NC 32	FROM NC 99 TO BEGIN CURB PLYMOUTH	1	2	2WU	NO	NO	YES	4.46	25	47,119	29,449	250								300
2018CPT.01.06.10941.1	Washington	6	NC 32/NC 94	FROM ALBEMARLE SOUND BRIDGE TO PEA RIDGE	1	2	2WU	NO	NO	YES	2.00	27	21,520	21,520									135
<b>GRAND TOTAL</b>											<b>17.23</b>		<b>165,220</b>	<b>134,793</b>	<b>1,000</b>	<b>1,950</b>	<b>24</b>	<b>57</b>	<b>6</b>	<b>5</b>	<b>6</b>	<b>4</b>	<b>1,266</b>
																<b>300,013</b>		<b>78</b>					

# SIGNING FOR RESURFACING PROJECTS

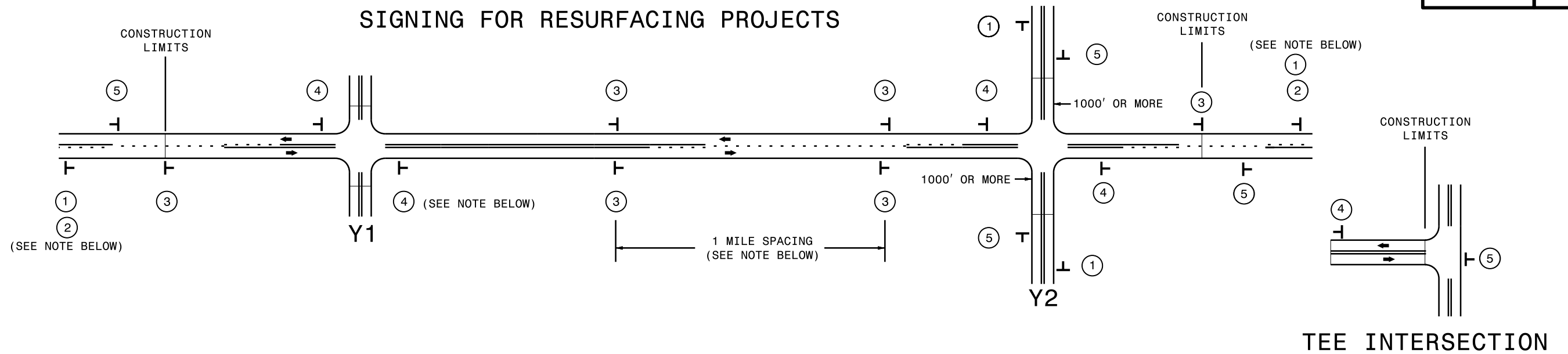

## MAINLINE (-L-) SIGNING

## -Y- LINE SIGNING

SIGNING NOTES AND PLACEMENT PER DIRECTION		<p>PLACE 1000' PRIOR TO BEGINNING OF CONSTRUCTION LIMITS. ONLY USED ON -Y- LINES IF RESURFACING LIMITS EXTEND 1000' ALONG -Y- LINE.</p> <p>#2 SIGN ONLY USED WHEN RESURFACING LIMITS ARE 2 OR MORE MILES IN LENGTH. ROUND UP TO NEXT WHOLE NUMBER. (NO FRACTIONAL OR DECIMAL NUMBERS)</p>	<p>NO REQUIRED STATIONARY SIGNING FOR THE FOLLOWING -Y- LINE CONDITIONS:</p> <ol style="list-style-type: none"> <li>1) LESS THAN 1000' OF RESURFACING ALONG -Y- LINE</li> <li>2) SUBDIVISION ROADS</li> <li>3) DEAD END ROADS</li> </ol> <p>WHEN PAVING/CONSTRUCTION ACTIVITIES PROCEED ACROSS AN UNSIGNED -Y- LINE, ADVANCE WARNING PORTABLE SIGNS SHALL BE USED ALONG THE -Y- LINE AS SHOWN BELOW. REMOVE UPON COMPLETION OF WORK.</p> <p>PLACED 500' IN ADVANCE OF FLAGGER. PLACED 250' IN ADVANCE OF FLAGGER.</p>
		<ul style="list-style-type: none"> <li>- PLACE INITIALLY AT THE CONSTRUCTION LIMITS AND SPACE 1 MILE APART THEREAFTER.</li> <li>- AT TEE INTERSECTIONS INSTALL INITIALLY 1/2 MILE FROM INTERSECTION AND SPACE 1 MILE APART THEREAFTER.</li> </ul>	
		<ul style="list-style-type: none"> <li>- THESE ARE FOR -Y- LINES THAT ARE "THROUGH" ROADWAYS.</li> <li>- DEAD END AND SUBDIVISION ROADS ARE NOT "THROUGH" ROADWAYS.</li> <li>- INSTALL 500' +/- FROM EACH -Y- LINE APPROACH AS SHOWN ABOVE.</li> <li>- FOR MULTIPLE -Y- LINES THAT ARE SEPARATED BY 0.25 MILES OR LESS, TREAT AS A SINGLE UNIT AND INSTALL WITHIN 500' OF EACH APPROACH.</li> <li>- A MAXIMUM OF 2 SIGN SETS PER MILE. DO NOT INSTALL WHEN -Y- LINES ARE WITHIN 0.5 MILES FROM "END ROAD WORK" SIGN.</li> <li>- FOR TEE INTERSECTIONS, INSTALL WITHIN 500' +/- OF THE INTERSECTION ALONG -L- LINE.</li> </ul>	
		<p>PLACE 500' FOLLOWING THE END OF CONSTRUCTION LIMITS OR AS SHOWN WHEN WORK ENDS AT A 3-WAY TEE INTERSECTION.</p>	



RESURFACING  
 ADVANCE WARNING SIGNS  
 FOR  
 RURAL AND SUBURBAN  
 2 LANE ROADWAYS

## URBAN / SUBURBAN WORKZONES

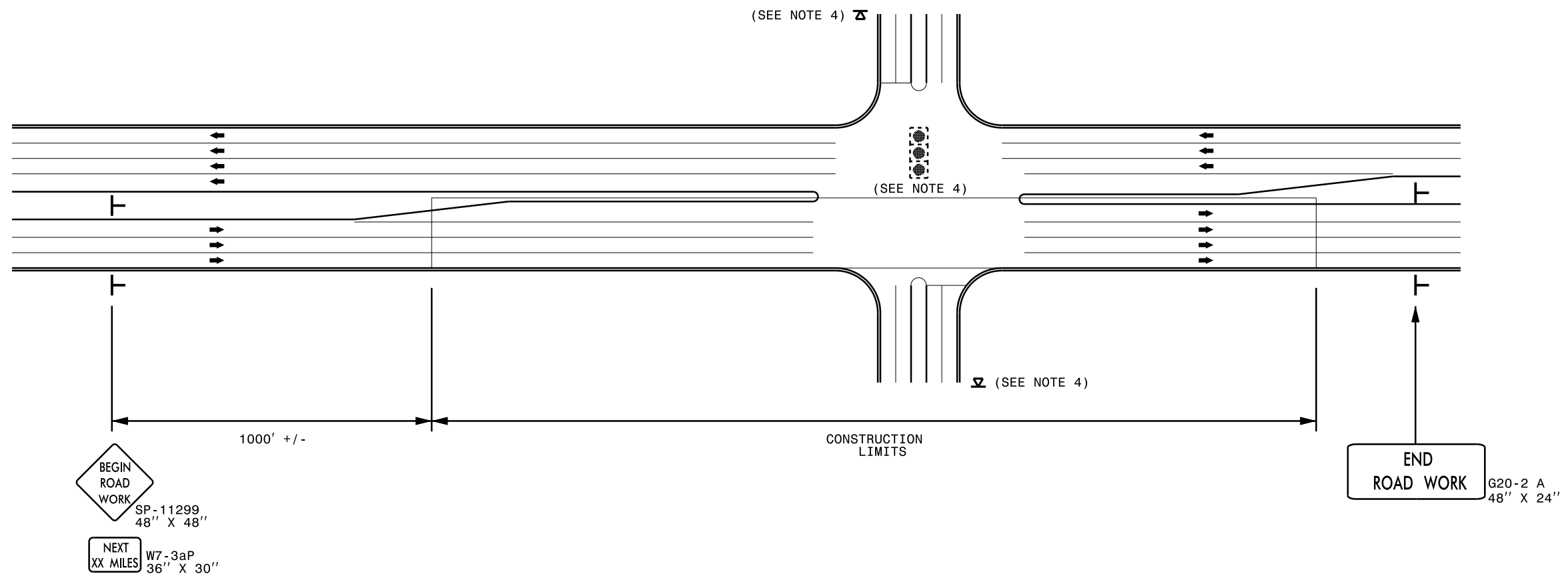

### NOTES:

- 1) 48" x 48" SIZED SIGNS (SP- 11299) MAY BE REDUCED TO 36" X 36" ON ROADWAYS WITH SPEED LIMITS OF 40 MPH OR LESS.
- 2) MOUNT SIGNS THAT ARE LARGER THAN 10 SQUARE FEET IN AREA ON TWO OR MORE WOOD OR U-CHANNEL SUPPORTS. PERFORATED SQUARE TUBING SUPPORT SYSTEMS MAY SUPPORT LARGER AREAS ON A SINGLE SUPPORT. FOLLOW MANUFACTURER'S RECOMMENDATIONS. THESE SYSTEMS SHALL BE NCHRP 350 COMPLIANT AND NCDOT APPROVED.
- 3) ADVANCE WARNING SIGNS NOT REQUIRED ON NON-SIGNALIZED SIDE STREETS.
- 4) MAY USE LAW ENFORCEMENT TO CONTROL TRAFFIC AT SIGNALIZED INTERSECTIONS AS DIRECTED BY THE ENGINEER. PROVIDE PORTABLE "ROAD WORK AHEAD" (W20-1) SIGNS 500' IN ADVANCE ALONG BOTH APPROACHES FROM THE SIDE STREETS WHEN PAVING PROCEEDS THROUGH THE INTERSECTION.
- 5) LATERAL CLEARANCE AT ALL SIGN LOCATIONS SHALL BE 2' AS MEASURED FROM THE EDGE OF PAVEMENT OR THE FACE OF THE CURB. WHEN UNABLE TO OBTAIN THE LATERAL CLEARANCE WITHIN THE MEDIAN AREA USE SHOULDER MOUNTS ONLY.
- 6) SIGN MOUNT LOCATIONS SHALL NOT BLOCK SIDEWALKS OR DRIVEWAYS.
- 7) IF STATIONARY GENERAL WARNING SIGNS ARE USED, THEY WILL BE PAID FOR PER SECTION 104 OF THE NCDOT STANDARD SPECIFICATIONS AS EXTRA WORK.
- 8) IF MILLED AREAS ARE NOT PAVED BACK BY THE END OF THE WORK DAY, PORTABLE SIGNS SHALL BE USED TO WARN DRIVERS OF THE PRESENT CONDITIONS. THESE ARE TO INCLUDE, BUT NOT LIMITED TO "ROUGH ROAD" W8-8, "UNEVEN LANES" W8-11, "GROOVED PAVEMENT" W8-15 w/MOTORCYCLE PLAQUE MOUNTED BELOW. THESE ARE TO BE DOUBLE INDICATED ON MULTI-LANE ROADWAYS WITH SPEED LIMITS 45 MPH AND GREATER WHERE LATERAL CLEARANCE CAN BE OBTAINED WITHIN THE MEDIAN AREAS. THESE PORTABLE SIGNS ARE INCIDENTAL TO THE OTHER ITEMS OF WORK INCLUDED IN THE TEMPORARY TRAFFIC CONTROL (LUMP SUM) PAY ITEM.

LEGEND	
T	STATIONARY SIGN
➔	DIRECTION OF TRAFFIC FLOW



**RESURFACING ADVANCE  
WARNING SIGNS FOR  
URBAN / SUBURBAN  
FACILITIES**



NOTES:

- 1) DETAIL DOES NOT APPLY TO OGAFB AND ULTRA-THIN BONDED WEARING COURSE.
- 2) BACKFILL SHOULDER WITH APPROVED MATERIAL.
- 3) THE SHOULDER WEDGE DEVICE MAY BE DISENGAGED AT PAVED DRIVEWAYS AND SIDE STREETS.

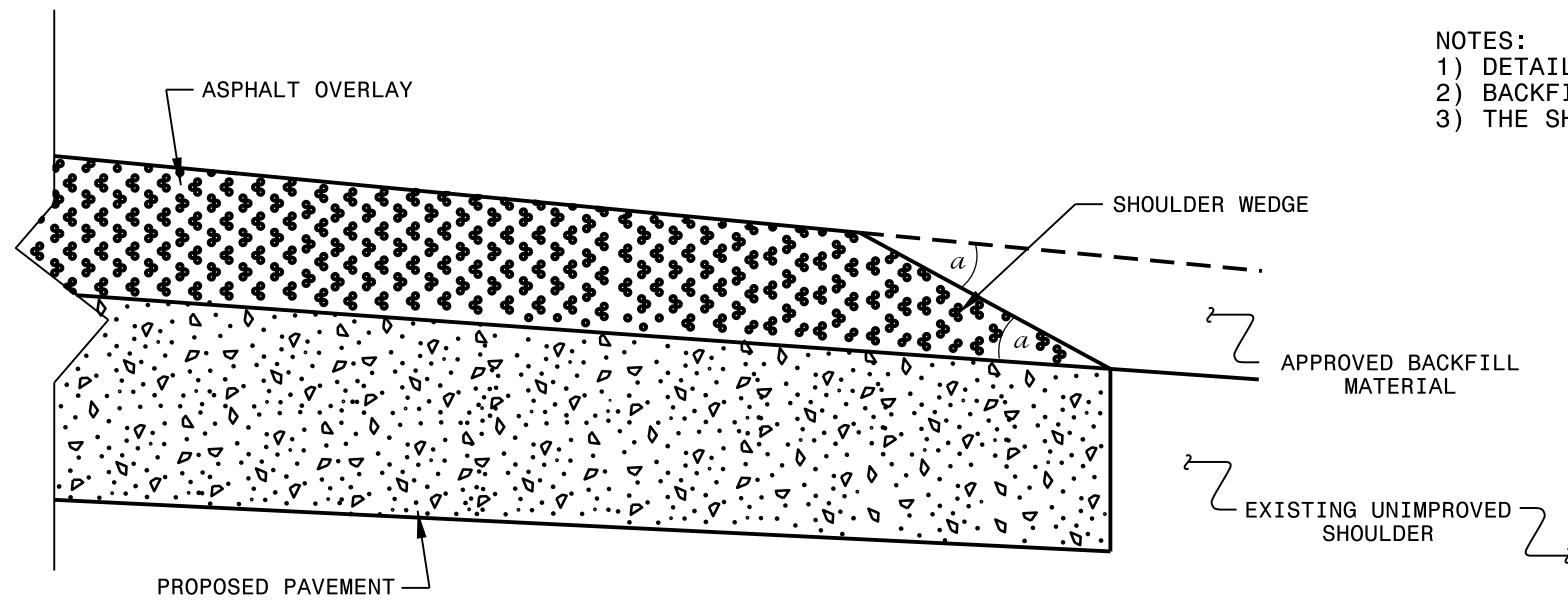

**SHOULDER WEDGE DETAIL**

(Resurfacing Projects w/ Widening or with Existing Paved Shoulder having no dropoffs)

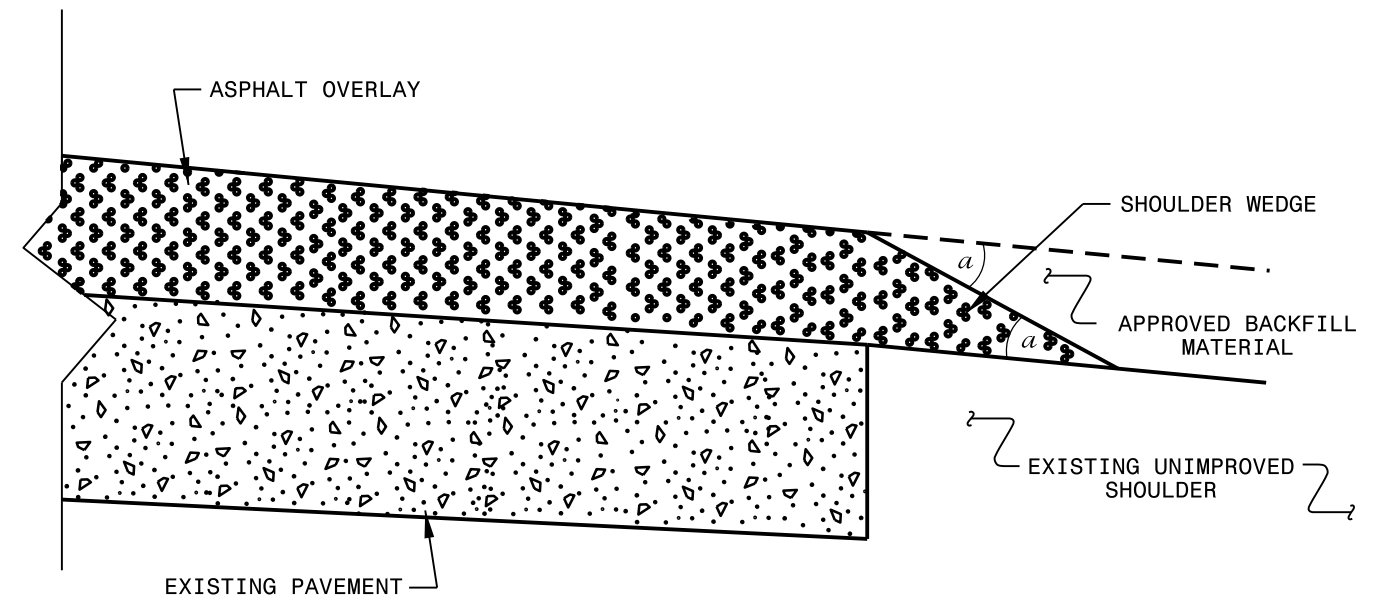

**SHOULDER WEDGE DETAIL**

(Resurfacing Projects w/ NO Widening)

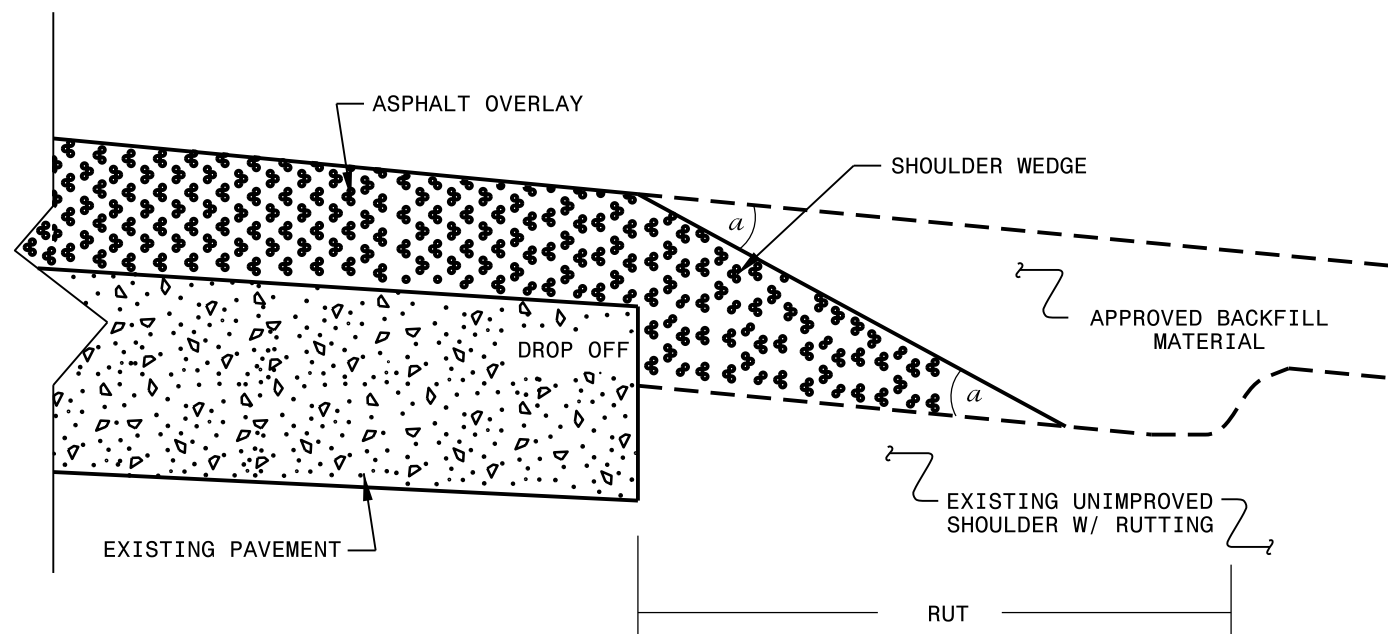

**SHOULDER WEDGE DETAIL**

(Resurfacing Adjacent to Rutted Shoulder)

- SHOULDER WEDGE ANGLE = 30°

CONTRACT STANDARDS AND DEVELOPMENT UNIT  
Office 919-707-6950 FAX 919-250-4119

**SHOULDER WEDGE DETAILS**

ORIGINAL BY: T.SPELL DATE: 7-19-11  
MODIFIED BY: DATE: 10/16/12  
CHECKED BY: DATE:  
FILE SPEC.: s:\usr\details\stand\shoulderwedgedetail.dgn