

05/08/99

CONTRACT NO.: DA00268 WBS ELEMENT: 2016CPT.01.09.20281.1,ETC.

DRAWN BY: BJT

# STATE OF NORTH CAROLINA DIVISION OF HIGHWAYS **DARE COUNTY**

STATE	STATE PROJECT REFERENCE NO.	SHEET NO.	TOTAL NO.
N.C.	2016CPT.01.09.20281.1,ETC.	1	
STATE PROJ. NO.	F.A. PROJ. NO.	DESCRIPTION	
2016CPT.01.09.20281.1		MAP 1	
2016CPT.01.09.20281.2		MAP 2	
2016CPT.01.09.20281.3		MAP 3	
2016CPT.01.09.20281.4		MAP 4	
2016CPT.01.09.20281.5		MAP 5	
2016CPT.01.09.20281.6		MAP 6	
2016CPT.01.09.20281.7		MAP 7	
2016CPT.01.09.20281.8		MAP 8	



**LOCATION:** MAP 1 SR 1206 KITTY HAWK RD FROM US 158 TO SR 1208  
 MAP 2 SR 1214 EMELINE RD FROM SR 1213 TO DEAD END  
 MAP 3 SR 1212 MIDGETT RD FROM SR 1206 TO SR 1213  
 MAP 4 SR 1452 BAUM BAY DR FROM SR 1217 TO SR 1453  
 MAP 5 SR 1458 SANDY TRAIL FROM SR 1457 TO DEAD END  
 MAP 6 SR 1510 RIDGE LANE FROM SR 1458 TO CUL-DE-SAC  
 MAP 7 SR 1490 WILLIAMS RD FROM SR 1217 TO END  
 MAP 8 SR 1219 OLD SCHOOLHOUSE RD FROM SR 1217 TO SR 1491

**TYPE OF WORK:** RESURFACING, SHOULDER RECONSTRUCTION & PAVEMENT MARKINGS

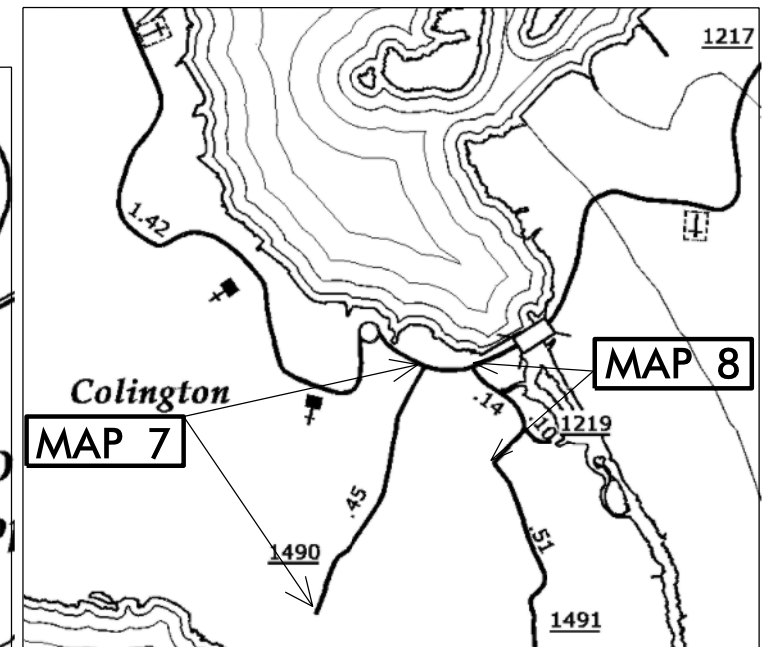
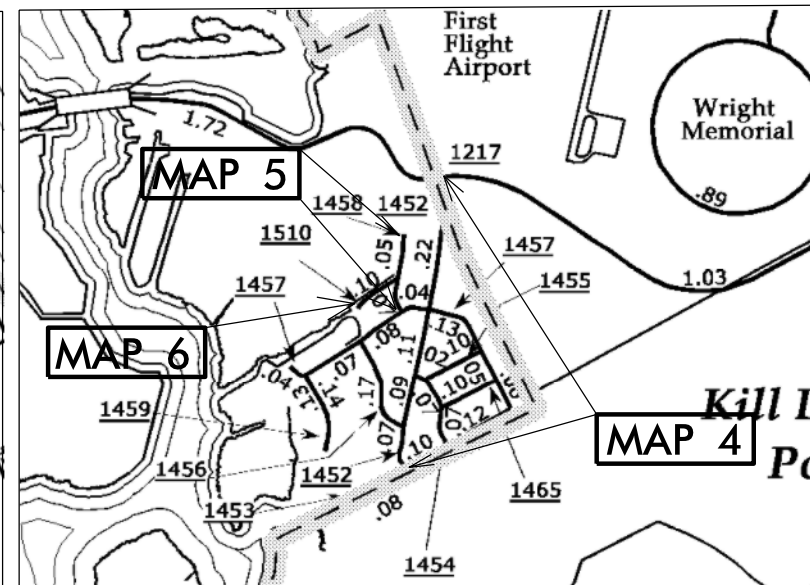
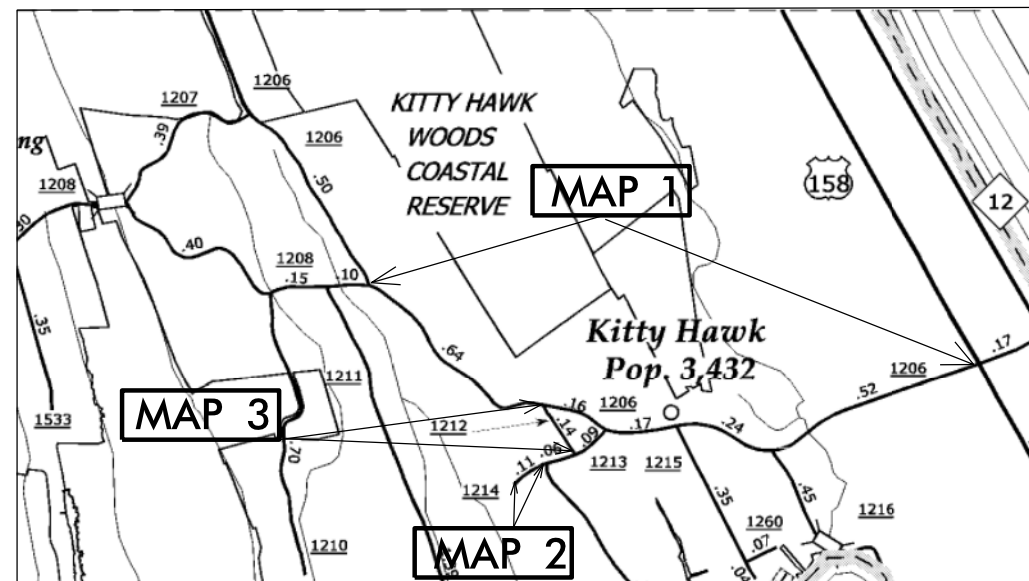

## NTS

### PROJECT LENGTH

- LENGTH OF ROADWAY PROJECT MAP 1 = 1.75 MI
- LENGTH OF ROADWAY PROJECT MAP 2 = 0.08 MI
- LENGTH OF ROADWAY PROJECT MAP 3 = 0.12 MI
- LENGTH OF ROADWAY PROJECT MAP 4 = 0.49 MI
- LENGTH OF ROADWAY PROJECT MAP 5 = 0.13 MI
- LENGTH OF ROADWAY PROJECT MAP 6 = 0.08 MI
- LENGTH OF ROADWAY PROJECT MAP 7 = 0.42 MI
- LENGTH OF ROADWAY PROJECT MAP 8 = 0.21 MI

Prepared in the Office of:  
**DIVISION OF HIGHWAYS**  
 113 Airport Dr., Edenton NC, 27932

2012 STANDARD SPECIFICATIONS

LETTING DATE:

W.B. HOBBS, P.E.  
 DIVISION PROJECT MANAGER

C. E. SLACHTA  
 DIVISION PROPOSALS ENGINEER

DIVISION OF HIGHWAYS  
 STATE OF NORTH CAROLINA

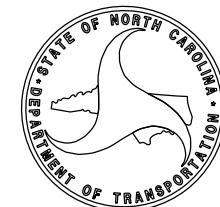

# C O N T R A C T P A V E M E N T S C H E D U L E

C1	PROP. APPROX. 1½" ASPHALT CONCRETE SURFACE COURSE, TYPE S9.5B, AT AN AVERAGE RATE OF 168 LBS. PER SQ. YD.
C2	PROP. APPROX. 1½" ASPHALT CONCRETE SURFACE COURSE, TYPE SF9.5A, AT AN AVERAGE RATE OF 165 LBS. PER SQ. YD.
T	EARTH MATERIAL
U	EXISTING PAVEMENT

PAVEMENT SCHEDULE

C1	PROP. APPROX. 1½" ASPHALT CONCRETE SURFACE COURSE, TYPE S9.5B, AT AN AVERAGE RATE OF 168 LBS. PER SQ. YD.
U	EXISTING PAVEMENT.
T	EARTH MATERIAL

PROJECT REFERENCE NO.	SHEET NO.
2016CPT.01.09.20281.1, ETC.	3

NOTES:

\*ALL PAVED S.R. ROADS TO BE RESURFACED TO THE ENDS OF THE RADII, OR AS DIRECTED BY THE ENGINEER

\*EDGES, PAVEMENT WIDENING, INTERSECTIONS, AND BRIDGE FLARES ARE INCLUDED IN THE TABLE OF QUANTITIES

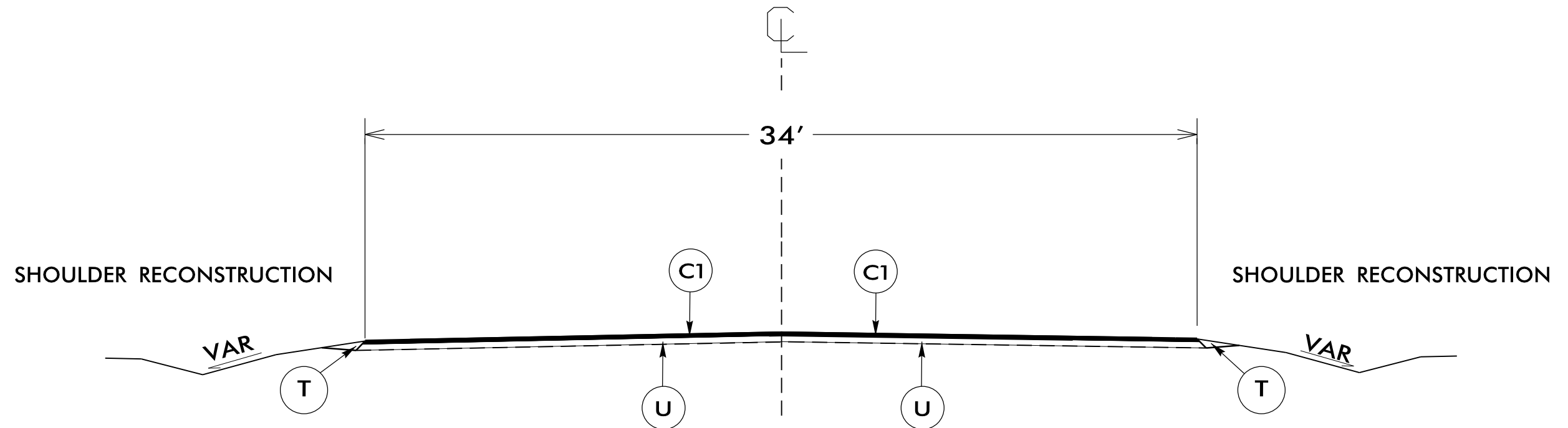

TYPICAL SECTION NO. 1

USE WITH MAP 1

NTS

PAVEMENT SCHEDULE

C2	PROP. APPROX. 1½" ASPHALT CONCRETE SURFACE COURSE, TYPE SF9.5A, AT AN AVERAGE RATE OF 165 LBS. PER SQ. YD.
U	EXISTING PAVEMENT.
T	EARTH MATERIAL

PROJECT REFERENCE NO.	SHEET NO.
2016CPT.01.09.20281.1, ETC.	4

NOTES:

\*ALL PAVED S.R. ROADS TO BE RESURFACED TO THE ENDS OF THE RADII, OR AS DIRECTED BY THE ENGINEER

\*EDGES, PAVEMENT WIDENING, INTERSECTIONS, AND BRIDGE FLARES ARE INCLUDED IN THE TABLE OF QUANTITIES

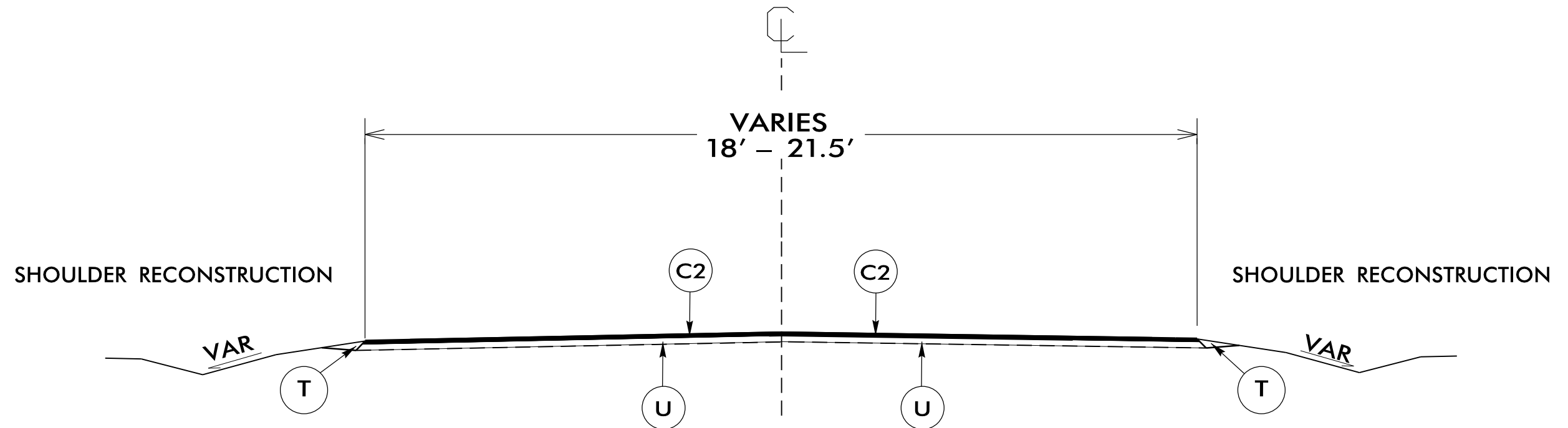

TYPICAL SECTION NO. 2

USE WITH MAPS 2-8

NTS



## SIGNING FOR RESURFACING PROJECTS

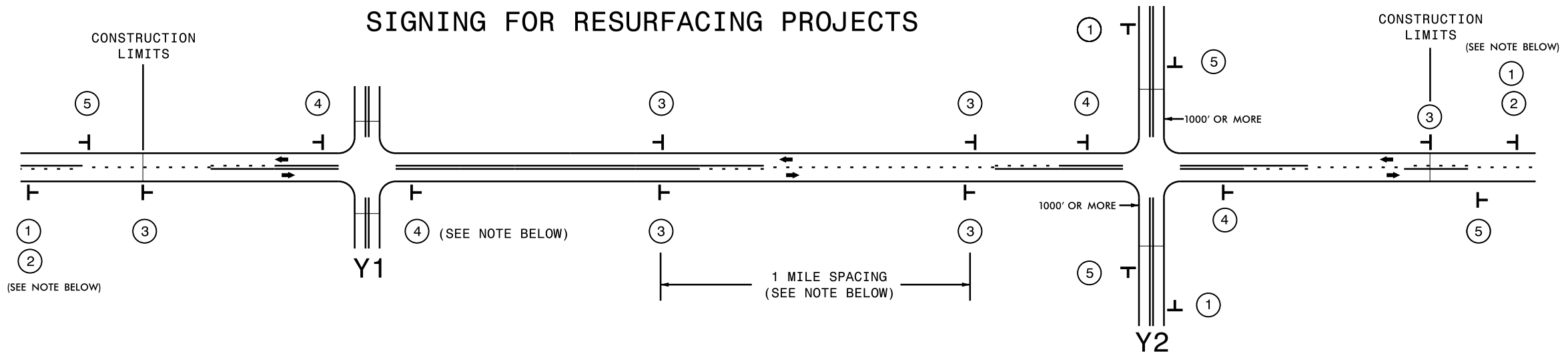

LEGEND	
T	STATIONARY SIGN
←	DIRECTION OF TRAFFIC FLOW

### MAINLINE (-L-) SIGNING

### -Y- LINE SIGNING

SIGNING NOTES AND PLACEMENT PER DIRECTION	① ②		<p>PLACE 1000' PRIOR TO BEGINNING OF CONSTRUCTION LIMITS. ONLY USED ON -Y- LINES IF RESURFACING LIMITS EXTEND 1000' ALONG -Y- LINE.</p> <p>#2 SIGN ONLY USED WHEN RESURFACING LIMITS ARE 2 OR MORE MILES IN LENGTH. ROUND UP TO NEXT WHOLE NUMBER. (NO FRACTIONAL OR DECIMAL NUMBERS)</p>	<p style="text-align: center;">NO REQUIRED STATIONARY SIGNING FOR THE FOLLOWING -Y- LINE CONDITIONS:</p> <ol style="list-style-type: none"> <li>1) LESS THAN 1000' OF RESURFACING ALONG -Y- LINE</li> <li>2) SUBDIVISION ROADS</li> <li>3) DEAD END ROADS</li> </ol> <p style="text-align: center;">WHEN PAVING/CONSTRUCTION ACTIVITIES PROCEED ACROSS AN UNSIGNED -Y- LINE, ADVANCE WARNING PORTABLE SIGNS SHALL BE USED ALONG THE -Y- LINE AS SHOWN BELOW. REMOVE UPON COMPLETION OF WORK.</p> <div style="display: flex; justify-content: space-around; align-items: center;"> <div style="text-align: center;"> <p>W20-1 48" X 48"</p> </div> <div style="text-align: center;"> <p>W20-7 A 48" X 48"</p> </div> </div> <p style="text-align: center;">PLACED 500' IN ADVANCE OF FLAGGER. PLACED 250' IN ADVANCE OF FLAGGER.</p>
	③		<p>PLACE INITIALLY AT THE CONSTRUCTION LIMITS AND SPACED 1 MILE APART THEREAFTER. IF NO -Y- LINES EXIST, PLACE 2ND SET 1/2 MILE FROM THE CONSTRUCTION LIMITS AND THEN SPACE 1 MILE THEREAFTER.</p>	
	④		<p>THESE ARE FOR -Y- LINES THAT ARE "THROUGH" ROADWAYS. DEAD END AND SUBDIVISION ROADS ARE NOT "THROUGH" ROADWAYS. INSTALL 500' +/- FROM EACH -Y- LINE APPROACH AS SHOWN ABOVE. FOR MULTIPLE -Y- LINES THAT ARE SEPARATED BY 0.25 MILES OR LESS, TREAT AS A SINGLE UNIT AND INSTALL WITHIN 500' OF EACH APPROACH. A MAXIMUM OF 2 SIGN SETS PER MILE. DO NOT INSTALL WHEN -Y- LINES ARE WITHIN 0.5 MILES FROM "END ROAD WORK" SIGN.</p>	
	⑤		<p>PLACE 500' FOLLOWING THE END OF CONSTRUCTION LIMITS.</p>	

09-FEB-2015 07:52  
 O:\CAD\264931\Drawings\11\Resurfacing\Plans\Resurfacing\_AdvWarn\_2Ln.dgn  
 dtatum AT 01/02/2026



**RESURFACING  
 ADVANCE WARNING SIGNS  
 FOR  
 RURAL AND SUBURBAN  
 2 LANE ROADWAYS**

PROJECT NO.	SHEET NO.	TOTAL NO.
2016CPT.01.09.20281.1, ETC	7	

### SUMMARY OF QUANTITIES

PROJECT NO	COUNTY	MAP NO	ROUTE	DESCRIPTION	TYP	LANES	LANE TYPE	FINAL SURFACE TESTING REQUIRED	WARM MIX ASPHALT REQUIRED	LENGTH MI	WIDTH FT	MOBILIZATION LS	BORROW CY	INCIDENTAL STONE BASE TONS	SHOULDER RECONSTRUCTION SMI	SURFACE COURSE, S9.5B TONS	SURFACE COURSE, SF9.5A TONS	ASPHALT BINDER FOR PLANT MIX TONS	ADJ. OF METER OR VALVE BOX EA	TEMPORARY SILT FENCE LF	SEEDING & MULCHING ACR
2016CPT.01.09.20281.1	Dare	1	SR1206 KITTY HAWK RD	FROM US 158 TO SR 1208	1	2	2WU	NO	NO	1.75	34	1	600	20	3.50	3,237		194	1		1.5
2016CPT.01.09.20281.2	Dare	2	SR 1214 EMELINE RD	FROM SR 1213 TO DEAD END	2	2	2WU	NO	NO	0.08	18	*	20	2	0.16		77	5		60	0.0
2016CPT.01.09.20281.3	Dare	3	SR 1212 MIDGETT RD	FROM SR 1206 TO SR 1213	2	2	2WU	NO	NO	0.12	19	*	20	2	0.24		122	8			0.1
2016CPT.01.09.20281.4	Dare	4	SR 1452 BAUM BAY DR	FROM SR 1217 TO SR 1453	2	2	2WU	NO	NO	0.49	19	*	200	5	1.00		543	36			0.4
2016CPT.01.09.20281.5	Dare	5	SR 1458 SANDY TRAIL	FROM SR 1457 TO DEAD END	2	2	2WU	NO	NO	0.13	20	*	50	2	0.26		139	9			0.1
2016CPT.01.09.20281.6	Dare	6	SR 1510 RIDGE LANE	FROM SR 1458 TO CUL-DE-SAC	2	2	2WU	NO	NO	0.08	20	*	40	2	0.16		86	6			0.1
2016CPT.01.09.20281.7	Dare	7	SR 1490 WILLIAMS RD	FROM SR 1217 TO END	2	2	2WU	NO	NO	0.42	21.5	*	160	15	0.84		440	29	2		0.3
2016CPT.01.09.20281.8	Dare	8	SR 1219 OLD SCHOOLHOUSE RD	FROM SR 1217 TO SR 1491	2	2	2WU	NO	NO	0.21	18	*	100	5	0.40		203	14	2		0.2
<b>GRAND TOTAL</b>										<b>3.28</b>		<b>1</b>	<b>1,190</b>	<b>53</b>	<b>6.56</b>	<b>3,237</b>	<b>1,610</b>	<b>301</b>	<b>5</b>	<b>60</b>	<b>2.5</b>

### THERMOPLASTIC AND PAINT QUANTITIES

PROJECT NO	COUNTY	MAP NO	ROUTE	DESCRIPTION	TYP	LANES	LANE TYPE	LENGTH	WIDTH	TEMPORARY TRAFFIC CONTROL LS	4" X 90 M WHITE THERMO LF	4" X 120 M YELLOW THERMO LF	4" YELLOW PAINT LF	4" WHITE PAINT LF	GENERIC PAVEMENT MARKING ITEM (PROFILED PAVEMENT MARKINGS) LF
2016CPT.01.09.20281.1	Dare	1	SR1206 KITTY HAWK RD	FROM US 158 TO SR 1208	1	2	2WU	1.75	34	1	18,830	11,550	11,550	18,830	18,000
2016CPT.01.09.20281.2	Dare	2	SR 1214 EMELINE RD	FROM SR 1213 TO DEAD END	2	2	2WU	0.08	18	*					
2016CPT.01.09.20281.3	Dare	3	SR 1212 MIDGETT RD	FROM SR 1206 TO SR 1213	2	2	2WU	0.12	19	*	1291	792	1200	790	
2016CPT.01.09.20281.4	Dare	4	SR 1452 BAUM BAY DR	FROM SR 1217 TO SR 1453	2	2	2WU	0.49	19	*					
2016CPT.01.09.20281.5	Dare	5	SR 1458 SANDY TRAIL	FROM SR 1457 TO DEAD END	2	2	2WU	0.13	20	*					
2016CPT.01.09.20281.6	Dare	6	SR 1510 RIDGE LANE	FROM SR 1458 TO CUL-DE-SAC	2	2	2WU	0.08	20	*					
2016CPT.01.09.20281.7	Dare	7	SR 1490 WILLIAMS RD	FROM SR 1217 TO END	2	2	2WU	0.42	21.5	*					
2016CPT.01.09.20281.8	Dare	8	SR 1219 OLD SCHOOLHOUSE RD	FROM SR 1217 TO SR 1491	2	2	2WU	0.21	18	*	2200	1386	1300	2200	
<b>GRAND TOTAL</b>								<b>3.28</b>		<b>1</b>	<b>22,321</b>	<b>13,728</b>	<b>14,050</b>	<b>21,820</b>	<b>18,000</b>
													<b>35,870</b>		

# VIBRALINE DETAIL

