

19-NOV-2013 10:01  
 C:\D\CURRENT\PROJECTS\DIVISION PROJECT WORKING FILES\District Three\DA00182 Chowan Co. Resurfacing (2014)\1 Pre-Bid Documents\DA00182 Title & Typical.dgn  
 cslachta AT DICAD257101L

**CONTRACT NO. : DA00182 WBS ELEMENT : IC.021031, ETC.**



STATE OF NORTH CAROLINA  
 DIVISION OF HIGHWAYS  

---

**CHOWAN COUNTY**



---

STATE	STATE PROJECT REFERENCE NO.	SHEET NO.	TOTAL SHEETS
N.C.	1C.021031, ETC.	1	10
STATE PROJ. NO.	F.A. PROJ. NO.	DESCRIPTION	

**LOCATION: MAP #2 NC 37 FROM NC 32 TO PERQUIMANS CL / MAP #3 NC 94 FROM NC 32 TO NC 32**  
**TYPE OF WORK: MILLING, WIDENING AND RESURFACING**

MAP # 2 NC 37

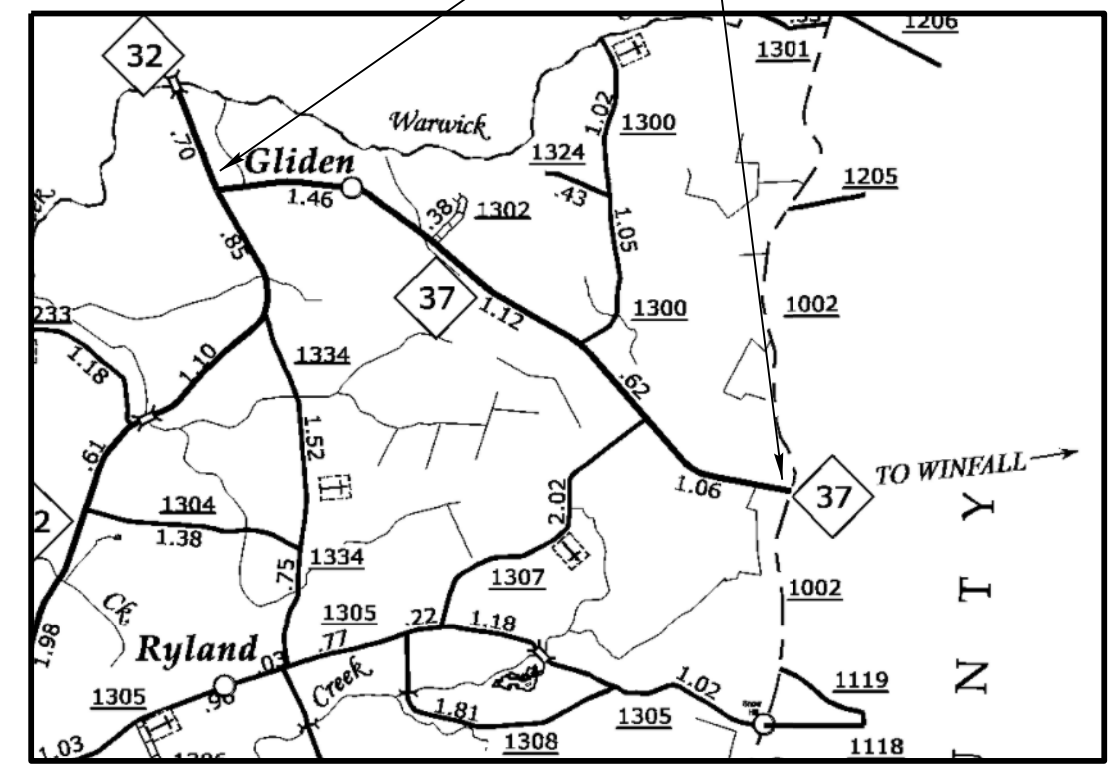
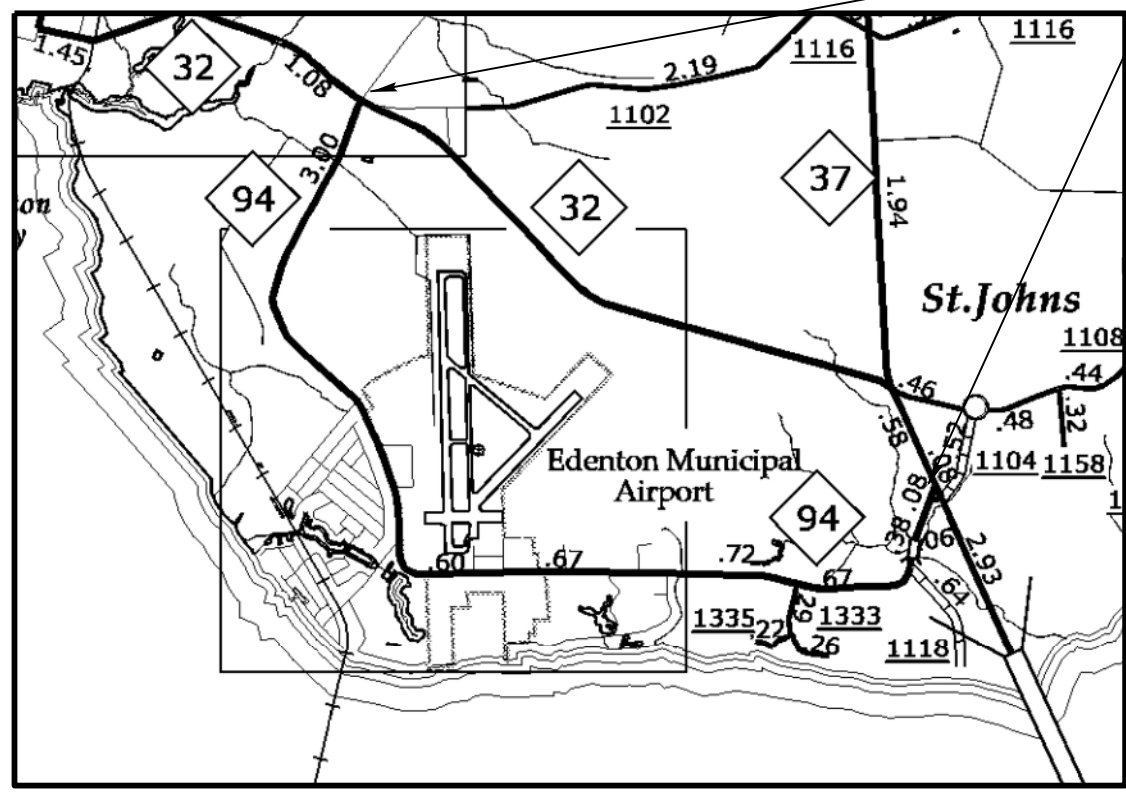
MAP # 3 & #4 NC 94



NOT TO SCALE

PROJECT LENGTH
MAP# 2 WBS# 1CR.10211.10 = 4.30 MILES
MAP# 3 WBS# 1CR.10211.11 = 6.30 MILES
MAP# 4 WBS# 36333.3FD9 = 6.30 MILES

Prepared In the Office of:

DIVISION OF HIGHWAYS

2012 STANDARD SPECIFICATIONS  LETTING DATE: _____	<div style="border-bottom: 1px solid black; margin-bottom: 5px;"> <p style="font-size: 0.8em;">W.B. HOBBS, P.E. DIVISION PROJECT MANAGER</p> </div> <div style="border-bottom: 1px solid black; margin-bottom: 5px;"> <p style="font-size: 0.8em;">C.E. SLACHTA DIVISION PROPOSALS ENGINEER</p> </div>
---	--

DIVISION OF HIGHWAYS  
STATE OF NORTH CAROLINA

19-NOV-2013 10:02  
 C:\CurrentProjects\DIVISION PROJECT WORKING FILES\District Three\DA00182 Chowan Co.\Resurfacing (2014)\1 Pre-Bid Documents\DA00182 Title & Typicals.dgn  
 cslachta AT DICAD257101L

**CONTRACT NO.: DA00182 WBS ELEMENT : 1C.021031, ETC.**



STATE OF NORTH CAROLINA  
 DIVISION OF HIGHWAYS  

---

**CHOWAN COUNTY**

---

STATE	STATE PROJECT REFERENCE NO.	SHEET NO.	TOTAL SHEETS
N.C.	1C.021031, ETC.	2	10
STATE PROJ. NO.	F.A. PROJ. NO.	DESCRIPTION	

**LOCATION:** MAP #5 SR 1210 FROM SR 1207 TO DEAD END  
 MAP #11 SR 1316 FROM NC 32 TO SR 1319

**TYPE OF WORK: MILLING, WIDENING AND RESURFACING**

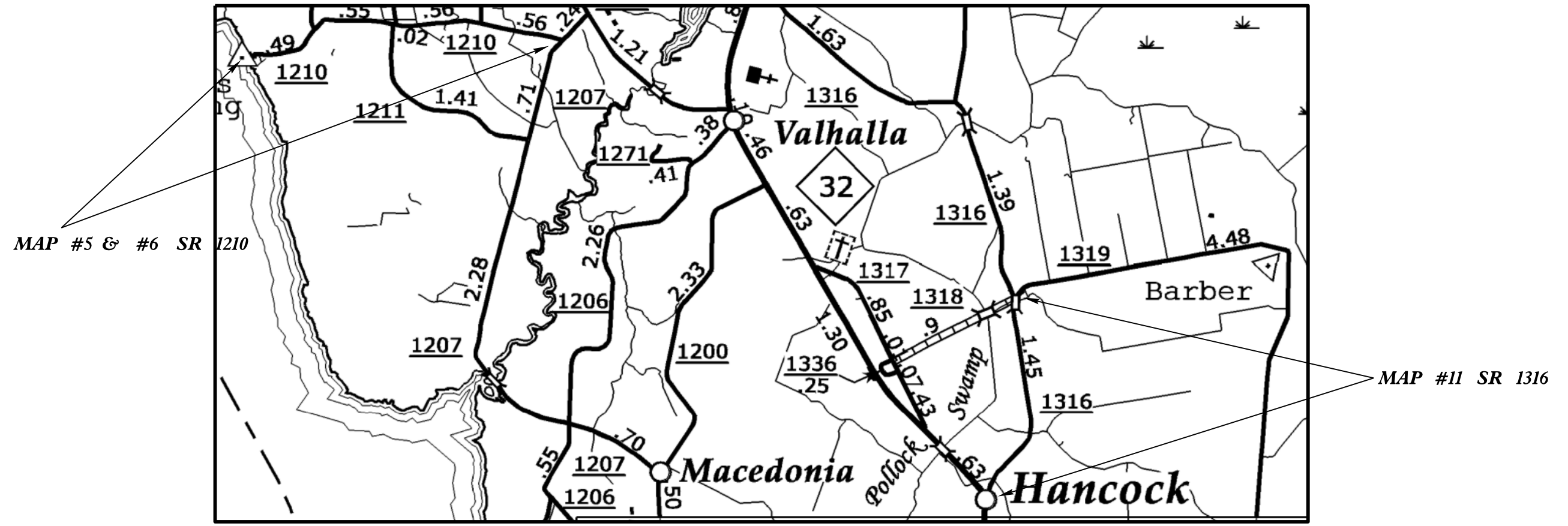

NOT TO SCALE

PROJECT LENGTH	
MAP#5 WBS# 1CR.20211.23 =	2.20 MILES
MAP #4 WBS# 36333.3FD9 =	2.20 MILES
MAP#11 WBS# 1CR.20211.26 =	1.50 MILES

Prepared In the Office of:

DIVISION OF HIGHWAYS

2012 STANDARD SPECIFICATIONS  LETTING DATE: _____	<div style="text-align: center; font-size: 0.8em;">           W.B. HOBBS, P.E.            DIVISION PROJECT MANAGER         </div> <div style="text-align: center; font-size: 0.8em; margin-top: 10px;">           C.E. SLACHTA            DIVISION PROPOSALS ENGINEER         </div>
---	--

DIVISION OF HIGHWAYS  
 STATE OF NORTH CAROLINA

19-NOV-2013 10:03  
 C:\D\CurrentProjects\DIVISION PROJECT WORKING FILES\District Three\DA00182 Chowan Co. Resurfacing (2014)\I Pre-Bid Documents\DA00182 Title & Typical.dgn  
 cslachta AT DICAD257101L

**CONTRACT NO.: DA00182 WBS ELEMENT : IC.021031, ETC.**



STATE OF NORTH CAROLINA  
 DIVISION OF HIGHWAYS  



---

**CHOWAN COUNTY**

---

STATE	STATE PROJECT REFERENCE NO.	SHEET NO.	TOTAL SHEETS
N.C.	1C.021031, ETC.	3	10
STATE PROJ. NO.	F.A. PROJ. NO.	DESCRIPTION	

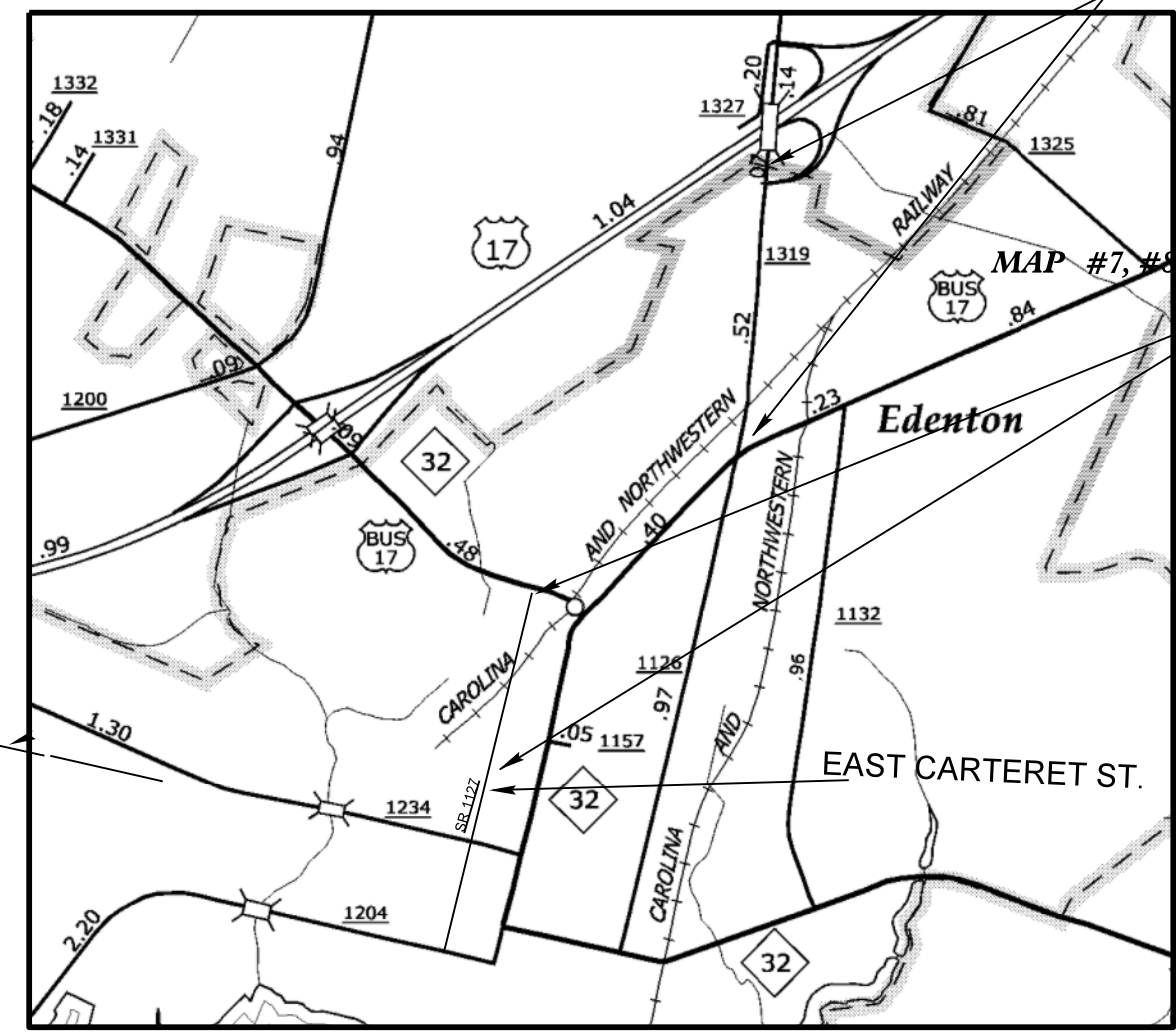
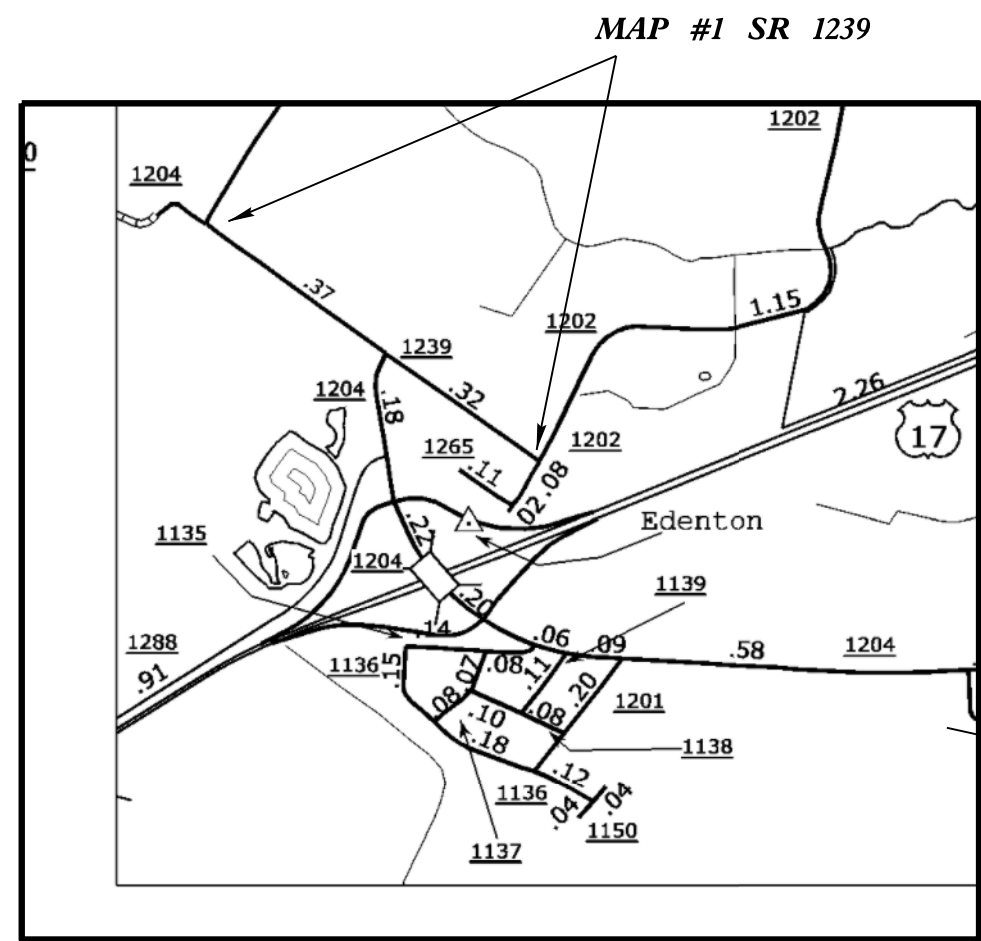
**LOCATION: MAP #1 SR 1239 FROM SR 1202 TO SR 1204 / MAP #7, #8 & #9 SR 1127 FROM NC 32 TO CARTERET STREET**  
**MAP #10 SR 1319 FROM US 17 BUS. TO US 17**  
**TYPE OF WORK: MILLING, WIDENING AND RESURFACING**



MAP #10 SR 1319

NOT TO SCALE

**PROJECT LENGTH**  
  
 MAP#1 WBS# 1C.021031 = 0.32 MILES  
 MAP#7, 8 & 9 WBS# 1CR.20211.24 = 0.43 MILES  
 MAP#10 WBS# 1CR.20211.25 = 0.48 MILES

Prepared in the Office of:  
**DIVISION OF HIGHWAYS**  

---

 2012 STANDARD SPECIFICATIONS  
 LETTING DATE: \_\_\_\_\_  

---

 W.B. HOBBS, P.E.  
 DIVISION PROJECT MANAGER  

---

 C.E. SLACHTA  
 DIVISION PROPOSALS ENGINEER

DIVISION OF HIGHWAYS  
 STATE OF NORTH CAROLINA

NOTES:

1. ALL PAVED S.R. ROADS TO BE RESURFACED TO THE ENDS OF THE RADII OR AS DIRECTED BY THE ENGINEER
2. EDGES, PAVEMENT WIDENING, INTERSECTIONS, AND BRIDGE FLARES ARE INCLUDED IN THE TABLE OF QUANTITIES
3. PAVEMENT EDGE SLOPES ARE 1:1 UNLESS SHOWN OTHERWISE
4. SHOULDERS AND DITCHES ARE TO BE CONSTRUCTED BY OTHERS

PROJECT REFERENCE NO.	SHEET NO.
1C.021031, ETC.	4 OF 10

PAVEMENT SCHEDULE	
C2	PROP. APPROX. 1.5" ASPHALT CONCRETE SURFACE COURSE TYPE S9.5B, AT AN AVERAGE RATE OF 168 LBS. PER SQ.YD.
U	EXISTING PAVEMENT.

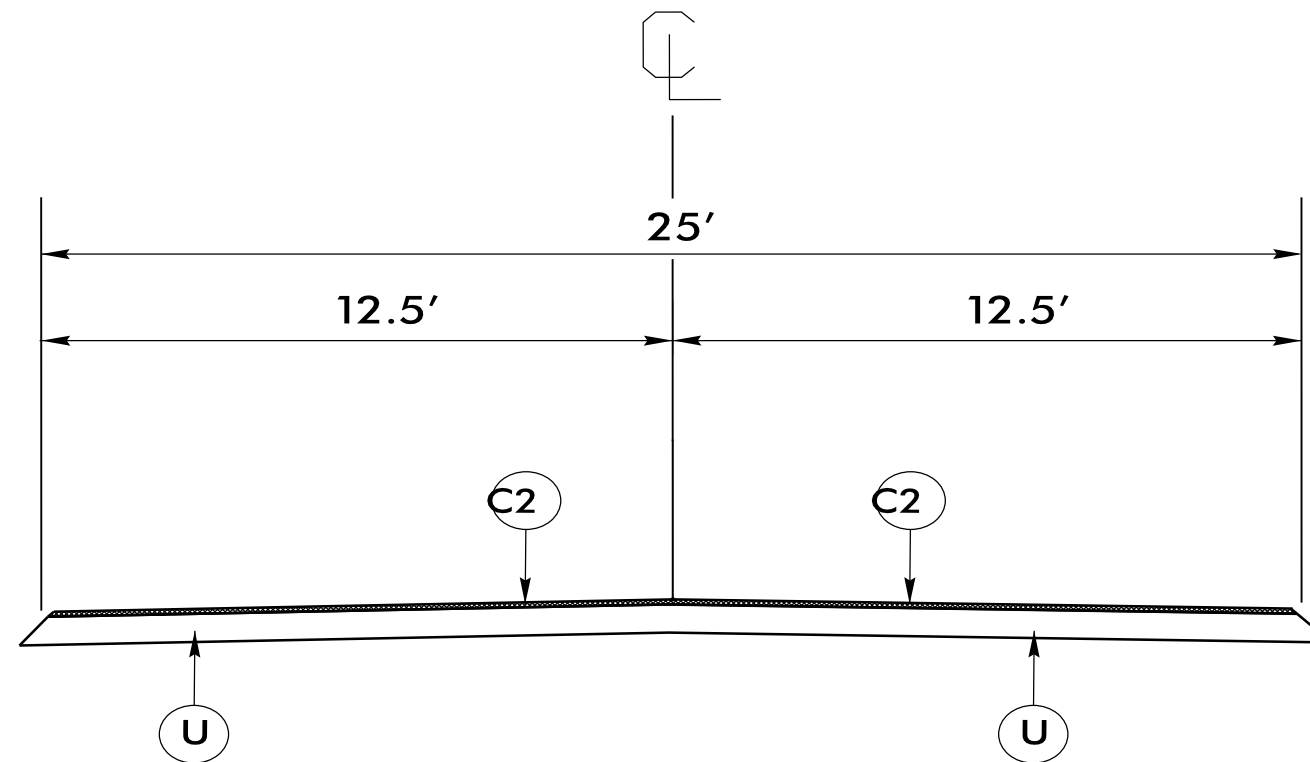

***TYPICAL SECTION #1***

USE WITH MAP 2

NOTES:

1. ALL PAVED S.R. ROADS TO BE RESURFACED TO THE ENDS OF THE RADII OR AS DIRECTED BY THE ENGINEER
2. EDGES, PAVEMENT WIDENING, INTERSECTIONS, AND BRIDGE FLARES ARE INCLUDED IN THE TABLE OF QUANTITIES
3. PAVEMENT EDGE SLOPES ARE 1:1 UNLESS SHOWN OTHERWISE
4. SHOULDERS AND DITCHES ARE TO BE CONSTRUCTED BY OTHERS

PROJECT REFERENCE NO.	SHEET NO.
1C.021031 ETC.	5 OF 10

PAVEMENT SCHEDULE	
C2	PROP. APPROX. 1.5" ASPHALT CONCRETE SURFACE COURSE TYPE S9.5 B, AT AN AVERAGE RATE OF 168 LBS. PER SQ.YD
E1	PROPOSED APPROX. 5.5" ASPHALT CONCRETE BASE COURSE TYPE B 25.0 B, AT AVERAGE RATE OF 627 LBS.PER SQ.YD
U	EXISTING PAVEMENT.

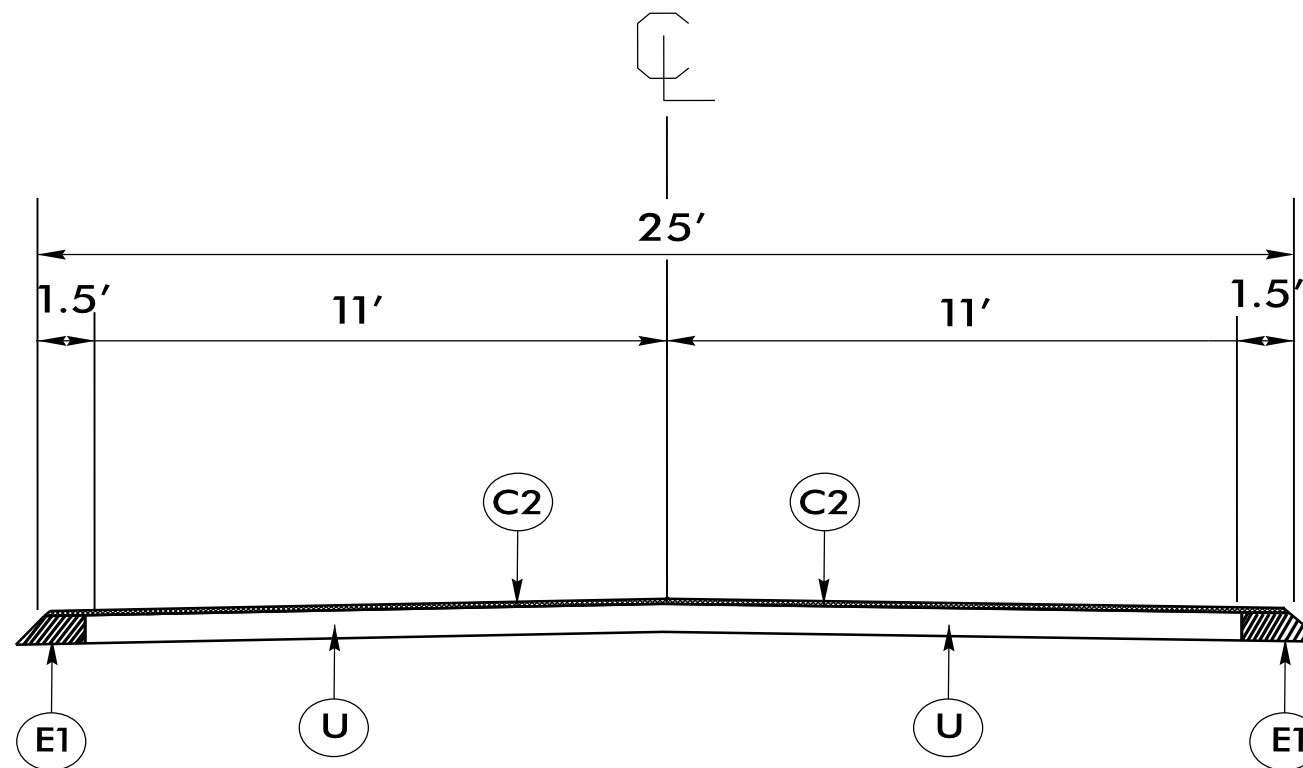

***TYPICAL SECTION #2***

USE WITH MAP 3 and 4

NOTES:

1. ALL PAVED S.R. ROADS TO BE RESURFACED TO THE ENDS OF THE RADII OR AS DIRECTED BY THE ENGINEER
2. EDGES, PAVEMENT WIDENING, INTERSECTIONS, AND BRIDGE FLARES ARE INCLUDED IN THE TABLE OF QUANTITIES
3. PAVEMENT EDGE SLOPES ARE 1:1 UNLESS SHOWN OTHERWISE
4. SHOULDERS AND DITCHES ARE TO BE CONSTRUCTED BY OTHERS

PROJECT REFERENCE NO.	SHEET NO.
1C.021031, ETC.	6 OF 10

PAVEMENT SCHEDULE	
C1	PROP. APPROX. 1.5" ASPHALT CONCRETE SURFACE COURSE TYPE SF9.5 A, AT AN AVERAGE RATE OF 165 LBS. PER SQ.YD
E1	PROPOSED APPROX. 5.5" ASPHALT CONCRETE BASE COURSE TYPE B 25.0 B, AT AVERAGE RATE OF 627 LBS.PER SQ.YD
U	EXISTING PAVEMENT.

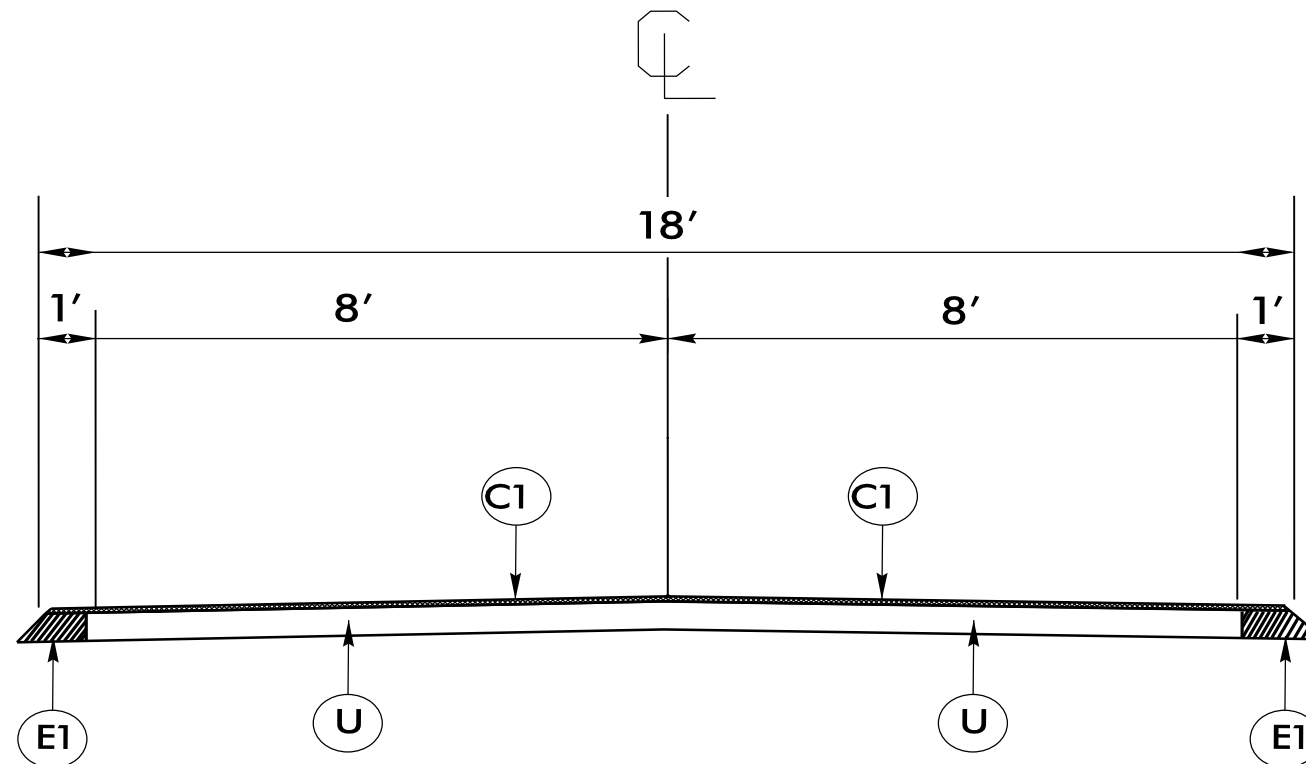

***TYPICAL SECTION #3***

USE WITH MAP 5 and 6

NOTES:

1. ALL PAVED S.R. ROADS TO BE RESURFACED TO THE ENDS OF THE RADII OR AS DIRECTED BY THE ENGINEER
2. EDGES, PAVEMENT WIDENING, INTERSECTIONS, AND BRIDGE FLARES ARE INCLUDED IN THE TABLE OF QUANTITIES
3. PAVEMENT EDGE SLOPES ARE 1:1 UNLESS SHOWN OTHERWISE

PROJECT REFERENCE NO.	SHEET NO.
1C.021031, ETC.	7 OF 10

PAVEMENT SCHEDULE	
C1	PROP. APPROX. 1.5" ASPHALT CONCRETE SURFACE COURSE TYPE SF9.5A, AT AN AVERAGE RATE OF 165 LBS. PER SQ.YD.
V1	MILLING BITUMINOUS PAVEMENT 1.5" DEPTH
U	EXISTING PAVEMENT.

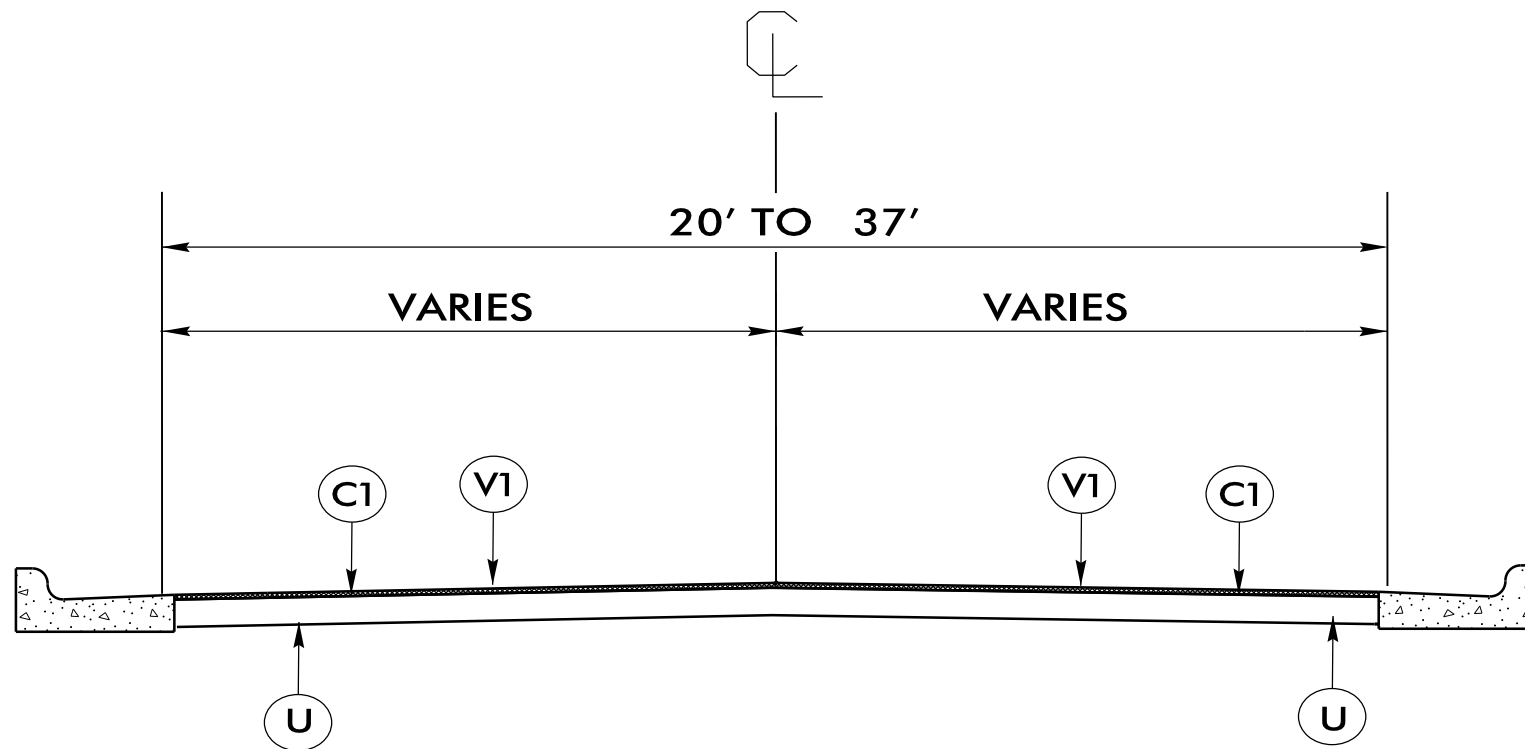

***TYPICAL SECTION #4***

USE WITH MAP 7, 8, 9 and 10

NOTES:

1. ALL PAVED S.R. ROADS TO BE RESURFACED TO THE ENDS OF THE RADII OR AS DIRECTED BY THE ENGINEER
2. EDGES, PAVEMENT WIDENING, INTERSECTIONS, AND BRIDGE FLARES ARE INCLUDED IN THE TABLE OF QUANTITIES
3. PAVEMENT EDGE SLOPES ARE 1:1 UNLESS SHOWN OTHERWISE
4. SHOULDERS AND DITCHES ARE TO BE CONSTRUCTED BY OTHERS

PROJECT REFERENCE NO.	SHEET NO.
1C.021031 ETC.	8 OF 10

PAVEMENT SCHEDULE	
C1	PROP. APPROX. 1.5" ASPHALT CONCRETE SURFACE COURSE TYPE SF9.5A, AT AN AVERAGE RATE OF 165 LBS. PER SQ.YD.
U	EXISTING PAVEMENT.

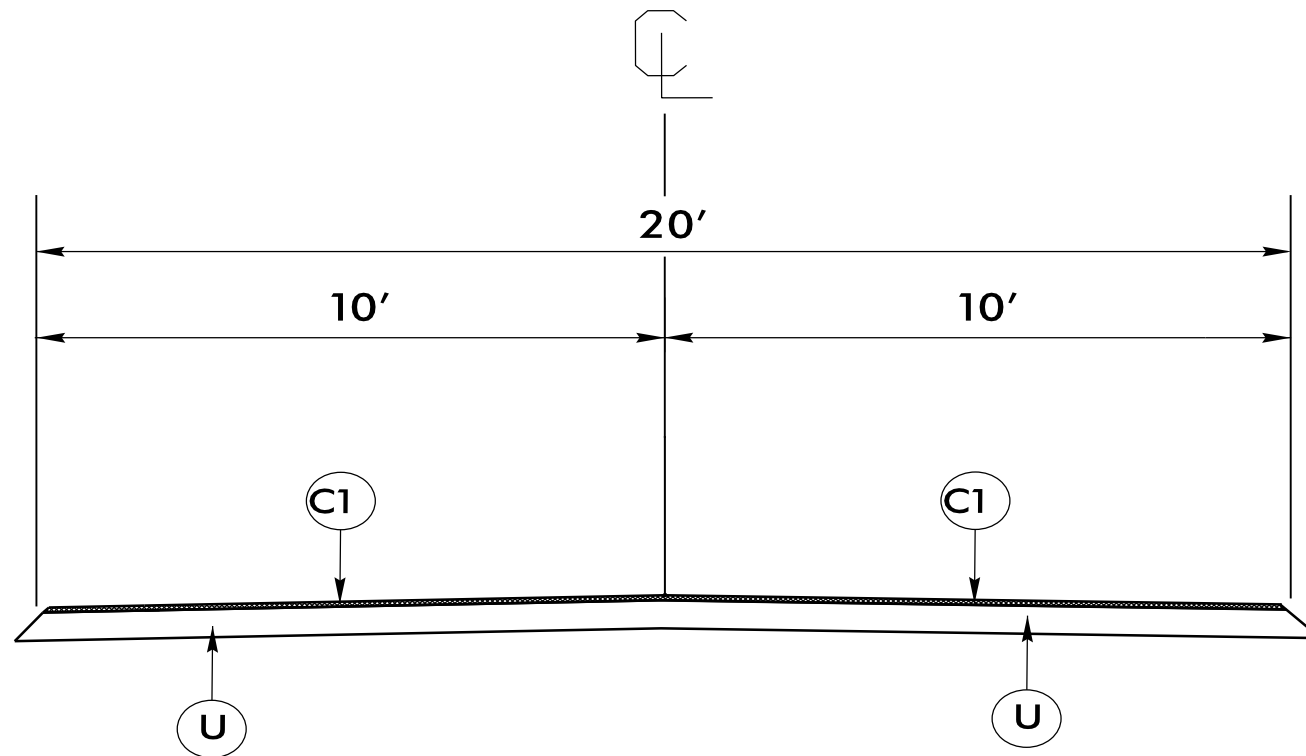

***TYPICAL SECTION #5***

USE WITH MAP 11



NOTES:

1. ALL PAVED S.R. ROADS TO BE RESURFACED TO THE ENDS OF THE RADII OR AS DIRECTED BY THE ENGINEER
2. EDGES, PAVEMENT WIDENING, INTERSECTIONS, AND BRIDGE FLARES ARE INCLUDED IN THE TABLE OF QUANTITIES
3. PAVEMENT EDGE SLOPES ARE 1:1 UNLESS SHOWN OTHERWISE
4. SHOULDERS AND DITCHES ARE TO BE CONSTRUCTED BY OTHERS

PROJECT REFERENCE NO.	SHEET NO.
1C.021031, ETC.	9 of 10

PAVEMENT SCHEDULE	
C1	PROP. APPROX. 1.5" ASPHALT CONCRETE SURFACE COURSE TYPE SF9.5 A, AT AN AVERAGE RATE OF 165 LBS. PER SQ.YD
E1	PROPOSED APPROX. 5.5" ASPHALT CONCRETE BASE COURSE TYPE B 25.0 B, AT AVERAGE RATE OF 627 LBS.PER SQ.YD
U	EXISTING PAVEMENT.

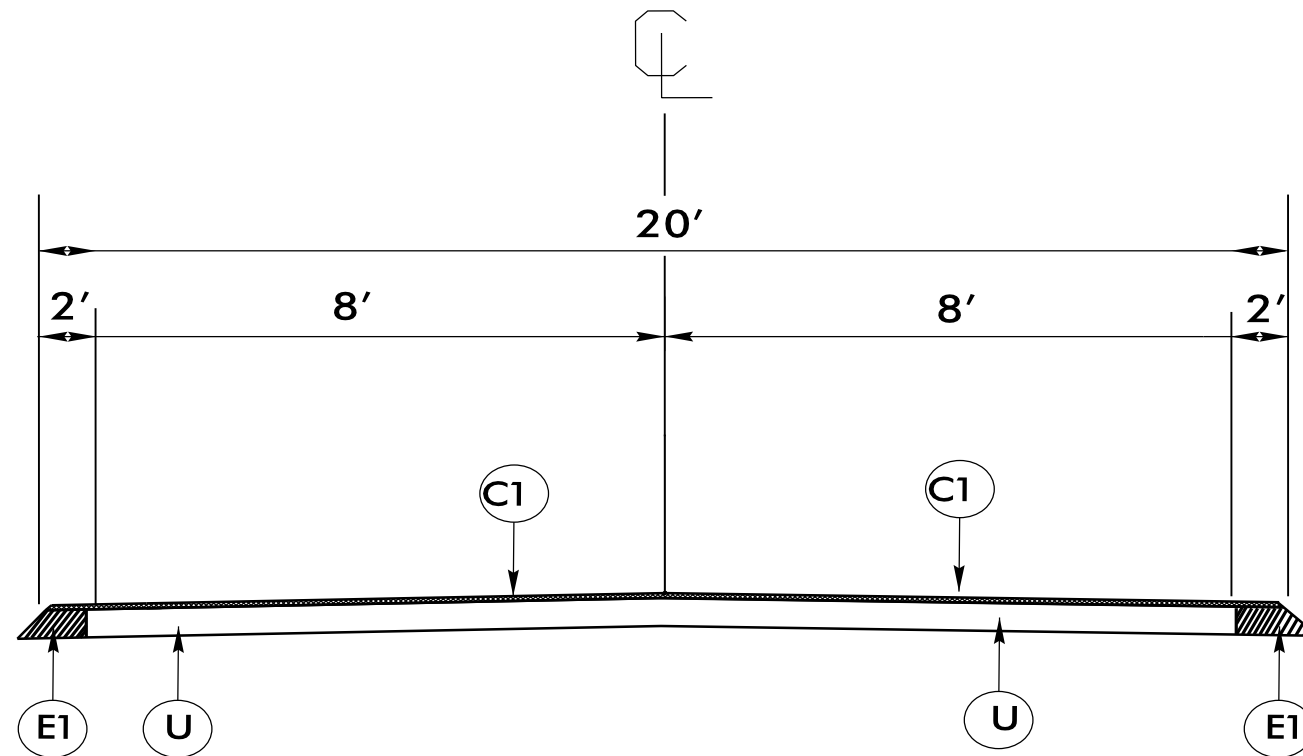

***TYPICAL SECTION #6***

USE WITH MAP 1

PROJECT NO.	SHEET NO.	TOTAL NO.
1C.021031, ETC.	10	10

### SUMMARY OF QUANTITIES

PROJECT NO	COUNTY	MAP NO	ROUTE	DESCRIPTION	TYP	LANES	FINAL SURFACE TESTING REQUIRED	WARM MIX ASPHALT REQUIRED	LENGTH MI	WIDTH FT	MOBILIZATION LUMP SUM	1½" MILLING SY	INCIDENTAL MILLING SY	BASE COURSE, B25.0B TONS	SURFACE COURSE, S9.5B TONS	SURFACE COURSE, SF9.5A TONS	ASPHALT BINDER FOR PLANT MIX TONS	ADJ. OF MANHOLES EA	TEMPORARY SILT FENCE LF	COIR FIBER MAT SY	COIR FIBER WATTLE LF	INDUCTIVE LOOP SAWCUT LF	LEAD-IN CABLE (14-2) LF	TEMPORARY TRAFFIC CONTROL LS
1C.021031	Chowan	1	SR 1239	FROM SR 1202 TO SR 1204	6	2	NO	NO	0.32	16	1			299		351	37							1
1CR.10211.10	Chowan	2	NC 37	FROM NC 32 TO PCL	1	2	NO	NO	4.3	25	*				5,856		351							*
1CR.10211.11	Chowan	3	NC 94	FROM NC32 TO NC 32	2	2	NO	NO	6.3	22	*		500		7,556		453		200	50	50			*
36333.3.FD9	Chowan	4	NC 94	FROM NC 32 TO NC 32	2	2	NO	NO	6.6	3	*			4,594	1,046		265							*
1CR.20211.23	Chowan	5	SR 1210	FROM SR 1207 TO DEAD END	3	2	NO	NO	2.2	16	*					1,889	127		200	100	100			*
36333.3.FD9	Chowan	6	SR 1210	FROM SR 1207 TO DEAD END	3	2	NO	NO	2.2	16	*			1,159		261	68							*
1CR.20211.24	Chowan	7	SR 1127	FROM CARTERET STREET AND HICKS STREET	4	2	NO	NO	0.22	37	*	4,776				435	29							*
1CR.20211.24	Chowan	8	SR 1127 B	HICKS TO WIDENING CHANGES	4	2	NO	NO	0.07	26	*	1,068				97	7							*
1CR.20211.24	Chowan	9	SR 1127	WIDTH CHANGE TO NC 32	4	2	NO	NO	0.14	20	*	1,643				150	10							*
1CR.20211.25	Chowan	10	SR 1319	FROM US17 BUS. TO US 17	4	2	NO	NO	0.48	36	*	10,138				923	62	1				400	250	*
1CR.20211.26	Chowan	11	1316	FROM NC 32 TO SR 1319	5	2	NO	NO	1.5	20	*					1,607	108							*
<b>GRAND TOTAL</b>									<b>24.33</b>		<b>1</b>	<b>17,625</b>	<b>500</b>	<b>6,052</b>	<b>14,458</b>	<b>5,713</b>	<b>1,517</b>	<b>1</b>	<b>400</b>	<b>150</b>	<b>150</b>	<b>400</b>	<b>250</b>	<b>1</b>

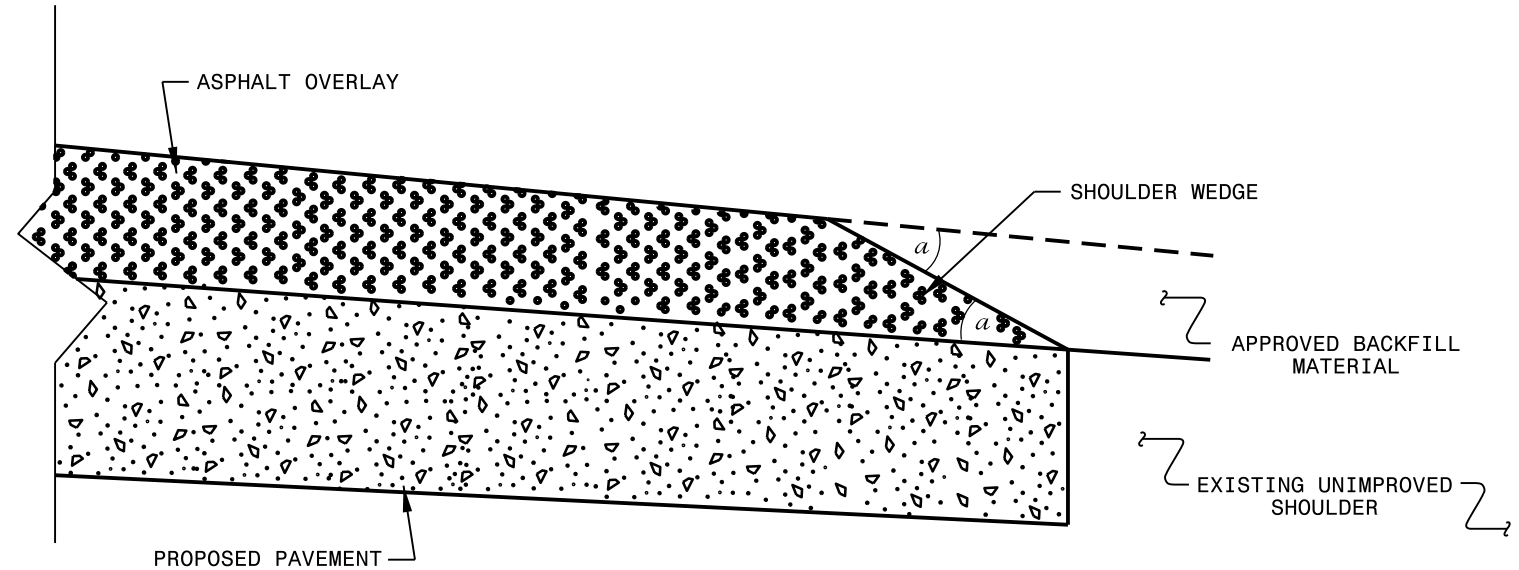

**SHOULDER WEDGE DETAIL**  
 (Resurfacing Projects w/ Widening or  
 with Existing Paved Shoulder > 2 ft.)

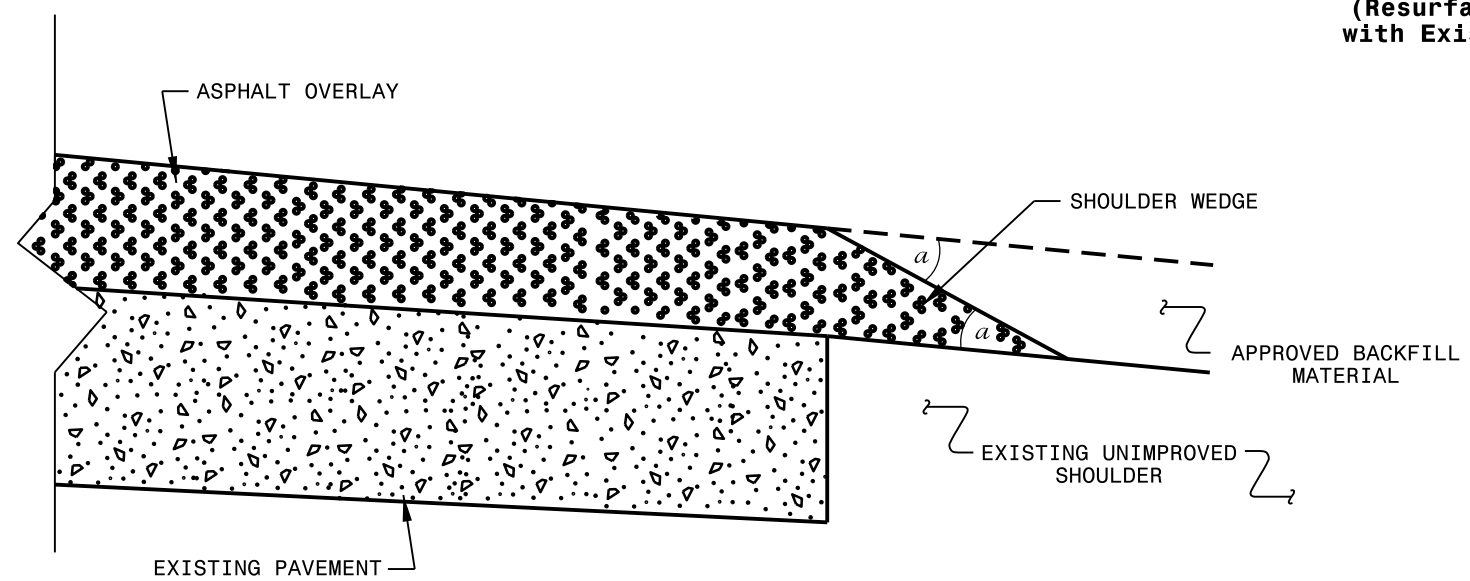

**SHOULDER WEDGE DETAIL**  
 (Resurfacing Projects w/ NO Widening)

- NOTES:
- 1) DETAIL DOES NOT APPLY TO OGAFD AND ULTRA-THIN BONDED WEARING COURSE.
  - 2) BACKFILL SHOULDER WITH APPROVED MATERIAL.
  - 3) THE SHOULDER WEDGE DEVICE MAY BE DISENGAGED AT PAVED DRIVEWAYS AND SIDE STREETS.

*a* - SHOULDER WEDGE ANGLE = 30°

<b>CONTRACT STANDARDS AND DEVELOPMENT UNIT</b>	
Office 919-707-6950 FAX 919-250-4119	
<b>SHOULDER WEDGE DETAILS</b>	
ORIGINAL BY: T.SPELL	DATE: 7-19-11
MODIFIED BY:	DATE: 10/16/12
CHECKED BY:	DATE:
FILE SPEC.: susr/details/stand/shoulderwedgedetail.dgn	