

PROJECT: 43923 TIP:

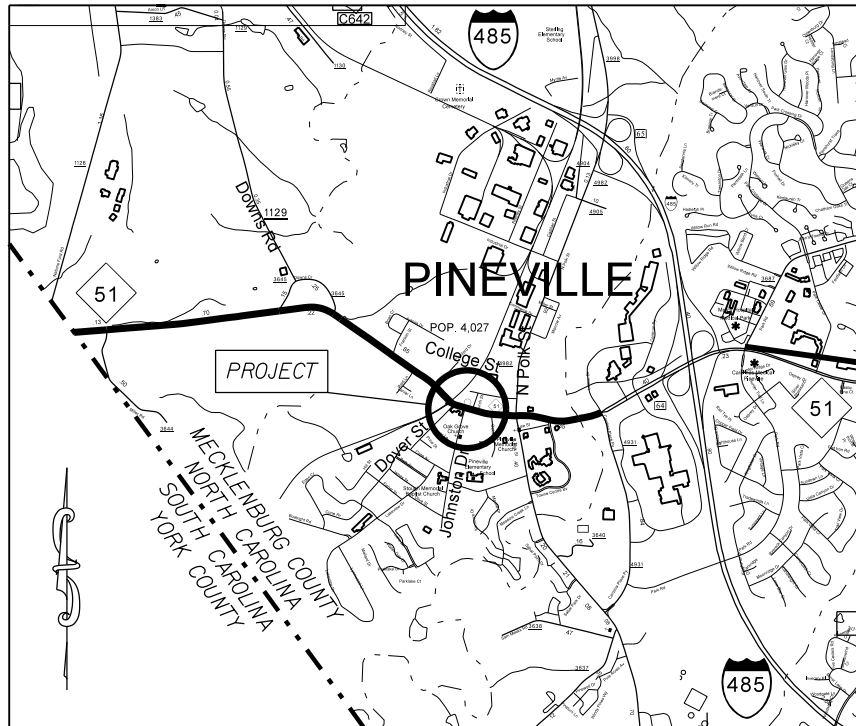

VICINITY MAP NOT TO SCALE

STATE OF NORTH CAROLINA
 DIVISION OF HIGHWAYS
MECKLENBURG COUNTY

LOCATION: NC-51 FROM RAIL ROAD TRACKS TO 140' EAST OF CHURCH STREET.

TYPE OF WORK: GRADING, PAVING, DRAINAGE, CONCRETE CURB AND GUTTER,
 CONCRETE DRIVEWAYS, AND THERMOPLASTIC PAVEMENT MARKINGS.

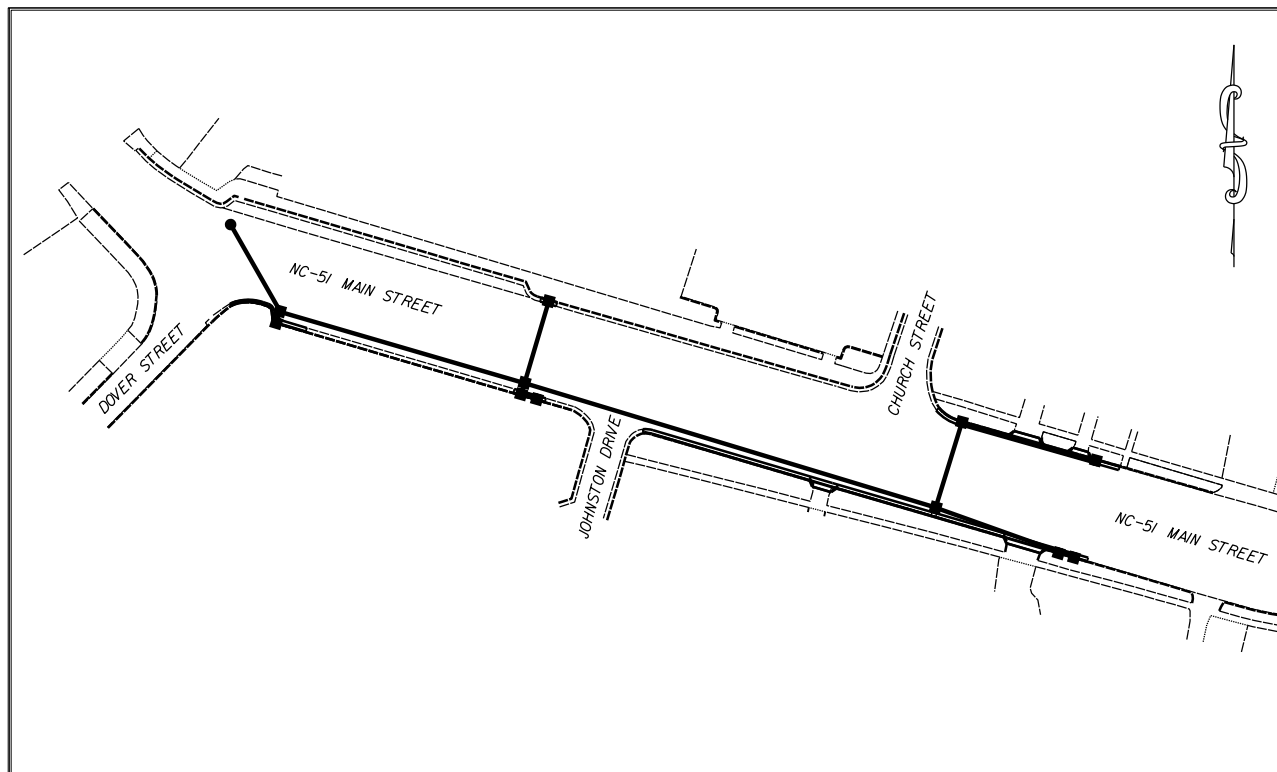

STATE	STATE PROJECT REFERENCE NO.	SHEET NO.	TOTAL SHEETS
N.C.	43923	1	
STATE PROJ. NO.	F.A. PROJ. NO.	DESCRIPTION	
		P.E.	
		R/W	
		CONST.	

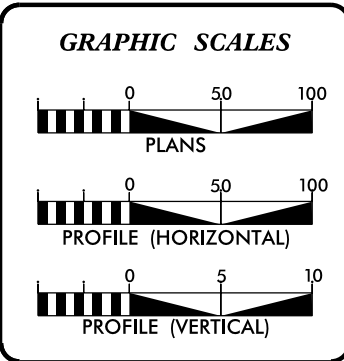

DESIGN DATA

ADT	=	
ADT	=	
DHV	=	%
D	=	%
T	=	%
V	=	MPH

PROJECT LENGTH

LENGTH OF ROADWAY PROJECT	=	0.12	MILES
TOTAL LENGTH OF STATE PROJECT	=	0.12	MILES

Prepared in the Office of:
DIVISION OF HIGHWAYS
 DIVISION TEN
 DIVISION DESIGN / CONSTRUCT UNIT

2012 STANDARD SPECIFICATIONS

RIGHT OF WAY DATE: _____	RANDY BOWERS PROJECT ENGINEER
LETTING DATE: April 15, 2015	TERRY BURLESON PROJECT DESIGN ENGINEER

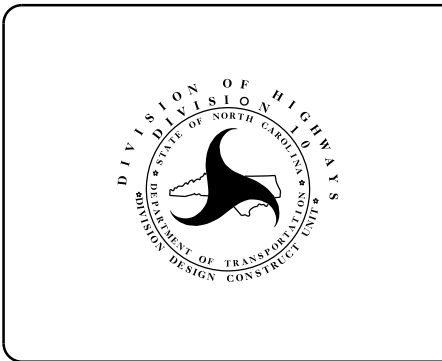

DIVISION OF HIGHWAYS
 STATE OF NORTH CAROLINA

DocuSigned by:
 Randy Bowers
 52A4A66079864B2... 3/24/2015

APPROVED BY _____ DATE _____
 DDC ENGINEER

STATE	PROJECT NO.	SHEET NO.	TOTAL SHEETS
N.C.	43923	2	
F.A. PROJECT NO.			

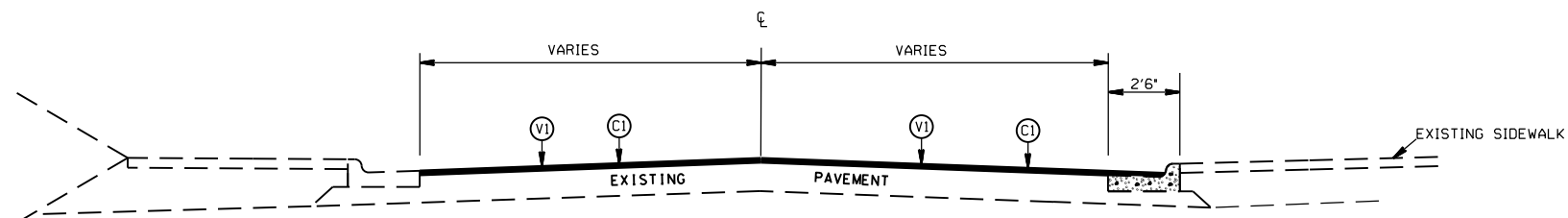

TYPICAL SECTION NO. 1
 -L-
 STA. 10+02+/- TO 11+10

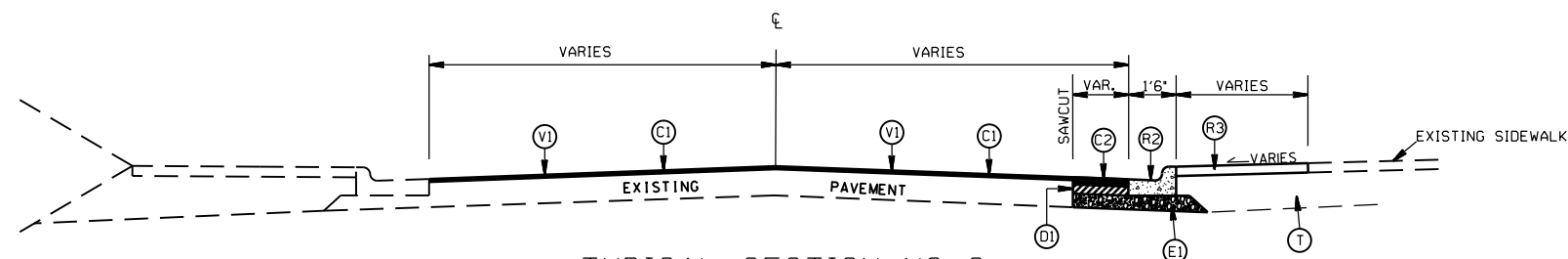

TYPICAL SECTION NO. 2
 -L-
 STA. 11+10+/- TO 11+39+/-
 STA. 12+90+/- TO 13+10+/-

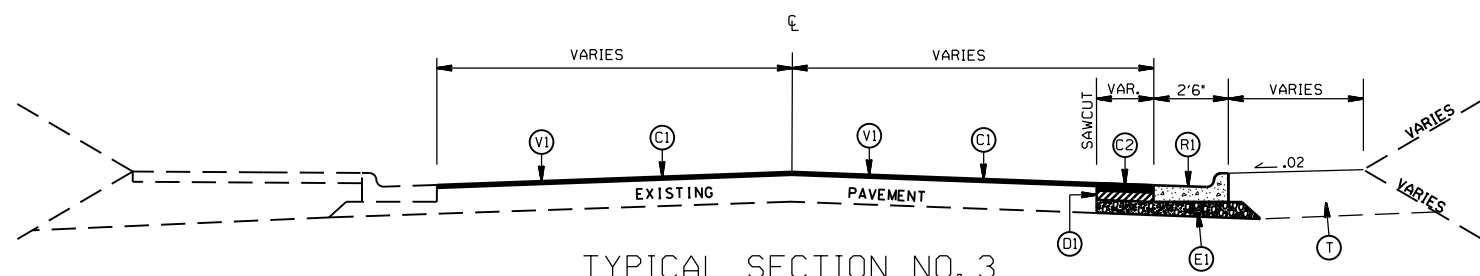

TYPICAL SECTION NO. 3
 -L-
 STA. 11+39+/- TO 11+60+/-
 STA. 13+71+/- TO 15+38+/-

PAVEMENT SCHEDULE

(C1)	PROP. APPROX. 1½" ASPHALT CONC. SURFACE COURSE, TYPE S9.5C, AT AN AVERAGE RATE OF 168 LBS. PER SQ. YD.
(C2)	PROP. APPROX. 3" ASPHALT CONC. SURFACE COURSE, TYPE S9.5C, AT AN AVERAGE RATE OF 336 LBS. PER SQ. YD. IN EACH OF TWO LAYERS.
(D1)	PROP. APPROX. 4" ASPHALT CONC. INTERMEDIATE COURSE, TYPE I19.0C, AT AN AVERAGE RATE OF 456 LBS. PER SQ. YD.
(E1)	PROP. APPROX. 3.0" ASPHALT CONC. BASE COURSE, TYPE B25.0C, AT AN AVERAGE RATE OF 342 LBS. PER SQ. YD.
(R1)	PROP. 2'-6" CURB & GUTTER
(R2)	PROP. 1'-6" CURB & GUTTER
(R3)	PROP 4" CONCRETE SIDEWALK
(T)	EARTH MATERIAL
(V1)	MILLING 1.5" IN DEPTH

NC 51 DRAINAGE IMPROVEMENTS
 IN PINEVILLE

SCALE -NA-
 DATE 05-02-13
 DWG. BY TWB
 DESIGN BY TWB
 APPROVED RWB



REVISIONS	

STATE	PROJECT NO.	SHEET NO.	TOTAL SHEETS
N.C.	43923	2A	
F.A. PROJECT NO.			

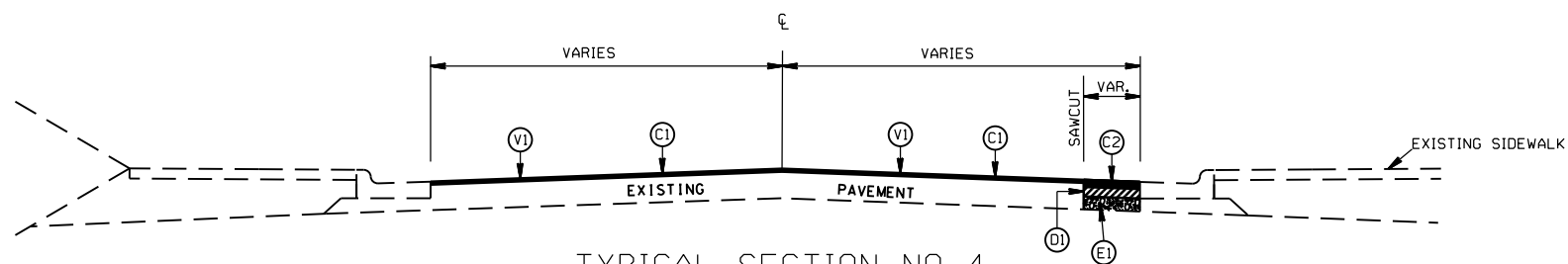

TYPICAL SECTION NO. 4
 -L-
 STA. 11+60+/- TO 12+90+/-
 STA. 13+10+/- TO 13+71+/-

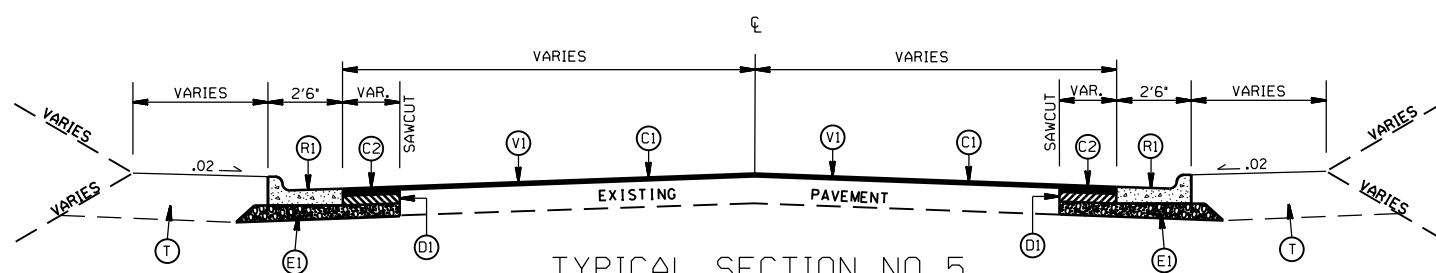

TYPICAL SECTION NO. 5
 -L-
 STA. 12+90+/- TO 13+10+/-
 STA. 15+38+/- TO 16+54+/-

PAVEMENT SCHEDULE

(C1)	PROP. APPROX. 1½" ASPHALT CONC. SURFACE COURSE, TYPE S9.5C, AT AN AVERAGE RATE OF 168 LBS. PER SQ. YD.
(C2)	PROP. APPROX. 3" ASPHALT CONC. SURFACE COURSE, TYPE S9.5C, AT AN AVERAGE RATE OF 336 LBS. PER SQ. YD. IN EACH OF TWO LAYERS.
(D1)	PROP. APPROX. 4" ASPHALT CONC. INTERMEDIATE COURSE, TYPE I19.0C, AT AN AVERAGE RATE OF 456 LBS. PER SQ. YD.
(E1)	PROP. APPROX. 3.0" ASPHALT CONC. BASE COURSE, TYPE B25.0C, AT AN AVERAGE RATE OF 342 LBS. PER SQ. YD.
(R1)	PROP. 2'-6" CURB & GUTTER
(R2)	PROP. 1'-6" CURB & GUTTER
(R3)	PROP. 4" CONCRETE SIDEWALK
(T)	EARTH MATERIAL
(V1)	MILLING 1.5" IN DEPTH

NC 51 DRAINAGE IMPROVEMENTS
 IN PINEVILLE

SCALE	-NA-
DATE	05-02-13
DWG. BY	TWB
DESIGN BY	TWB
APPROVED	RWB



REVISIONS	

STATE	PROJECT NO.	SHEET NO.	TOTAL SHEETS
N.C.	43923	2B	
F.A. PROJECT NO.			

PIPE INSTALLATION

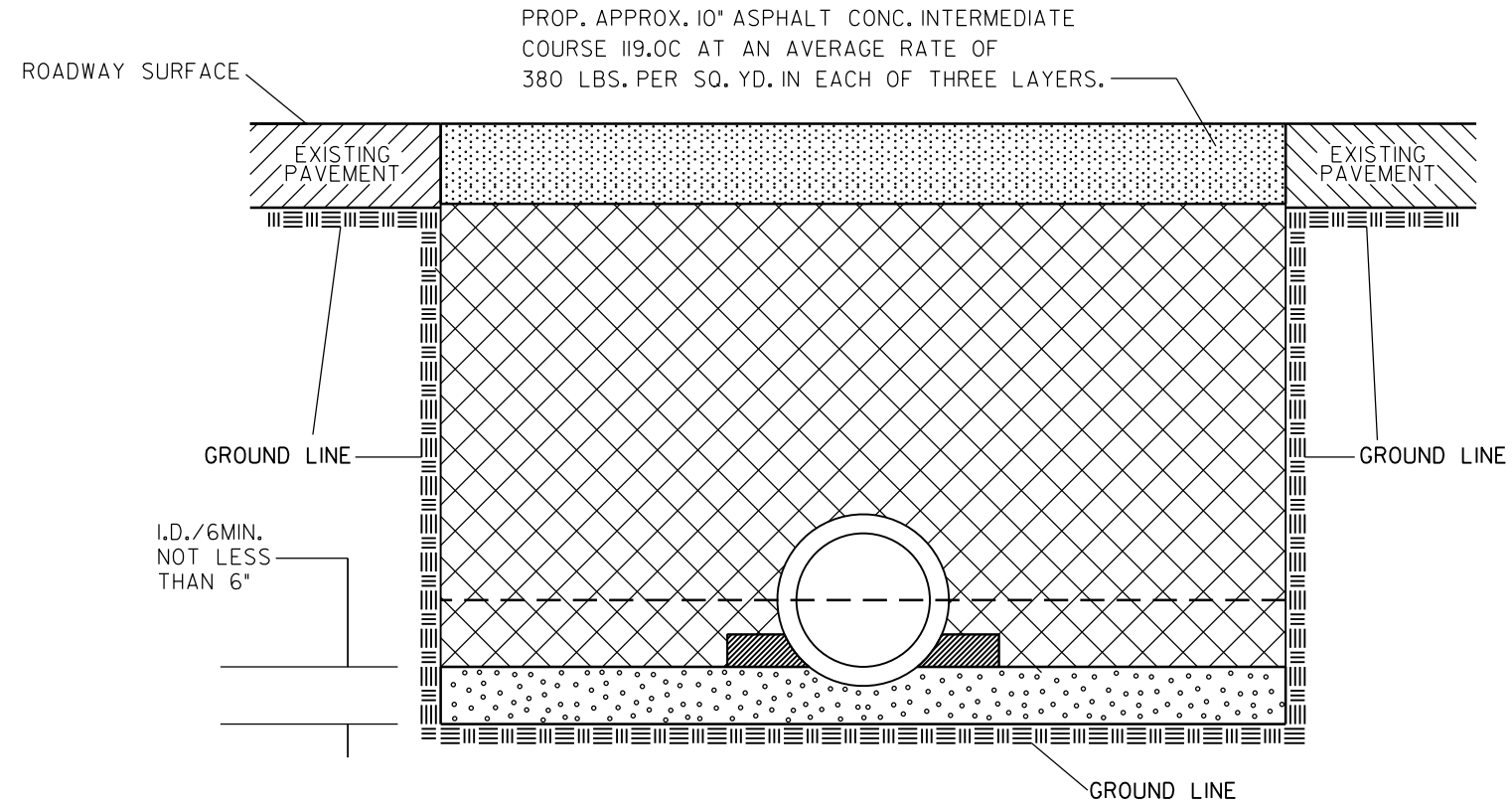

NORMAL EARTH FOUNDATION

GENERAL NOTES:

- SPRINGLINE OF PIPE
- TAKE CARE TO FULLY COMPACT HAUNCH ZONE OF PIPE BACKFILL
- LOOSELY PLACED SELECT MATERIAL CLASS III OR CLASS II, TYPE I FOR PIPE BEDDING. LEAVE SECTION DIRECTLY BENEATH PIPE UNCOMPACTED AS PIPE SEATING AND BACKFILL WILL ACCOMPLISH COMPACTION.
- SELECT GRANULAR MATERIAL CLASS II, TYPE I.
- UNDISTURBED EARTH MATERIAL

NC 51 DRAINAGE IMPROVEMENTS
IN PINEVILLE

SCALE	1"=50'
DATE	3/2015
DWG. BY	JDH
DESIGN BY	JDH
APPROVED	RWB



REVISIONS

STATE	PROJECT NO.	SHEET NO.	TOTAL SHEETS
N.C.	43923	4	
F.A. PROJECT NO.			

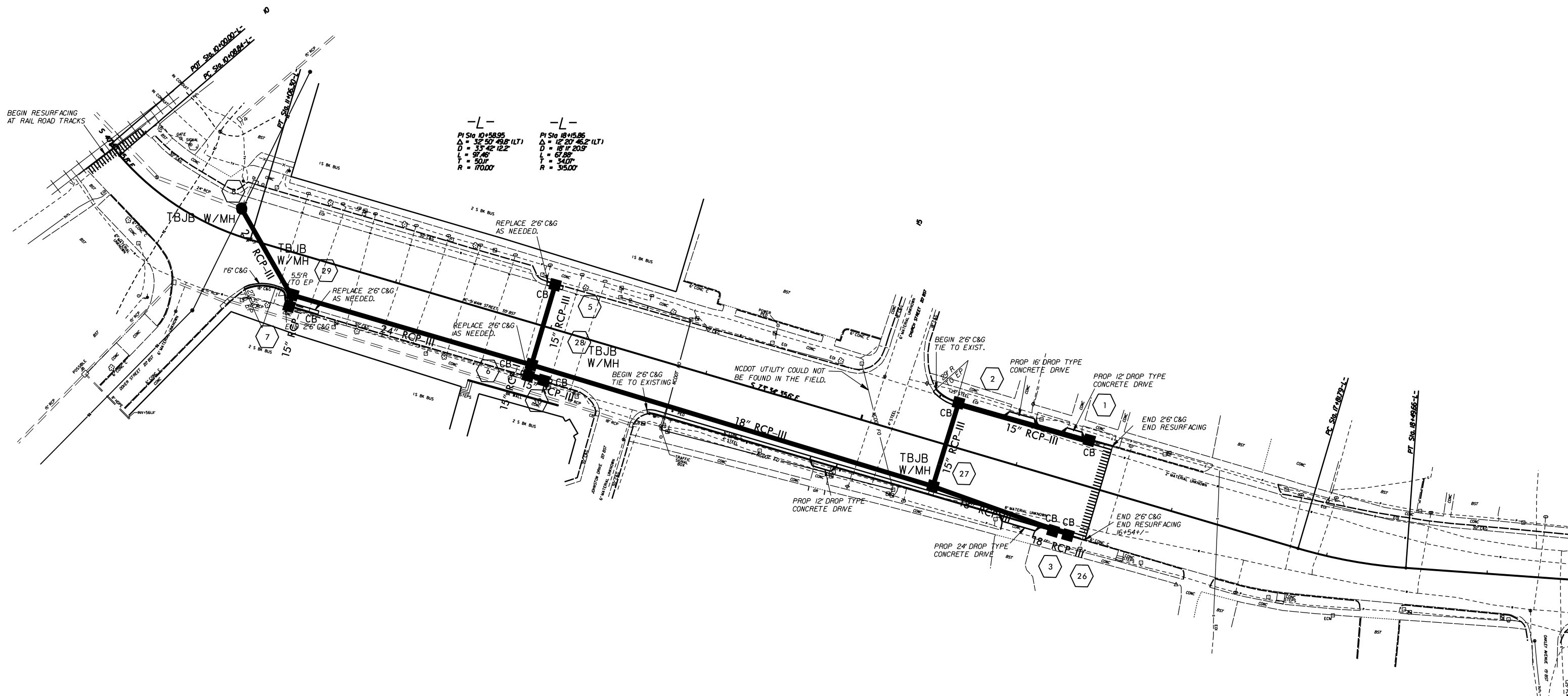

NC 51 DRAINAGE IMPROVEMENTS
IN PINEVILLE

SCALE 1"=60'
DATE 03-07-13
DWG. BY TWB
DESIGN BY
APPROVED RWB



REVISIONS	

STATE	PROJECT NO.	SHEET NO.	TOTAL SHEETS
N.C.	43923	PMP-1	
F.A. PROJECT NO.			

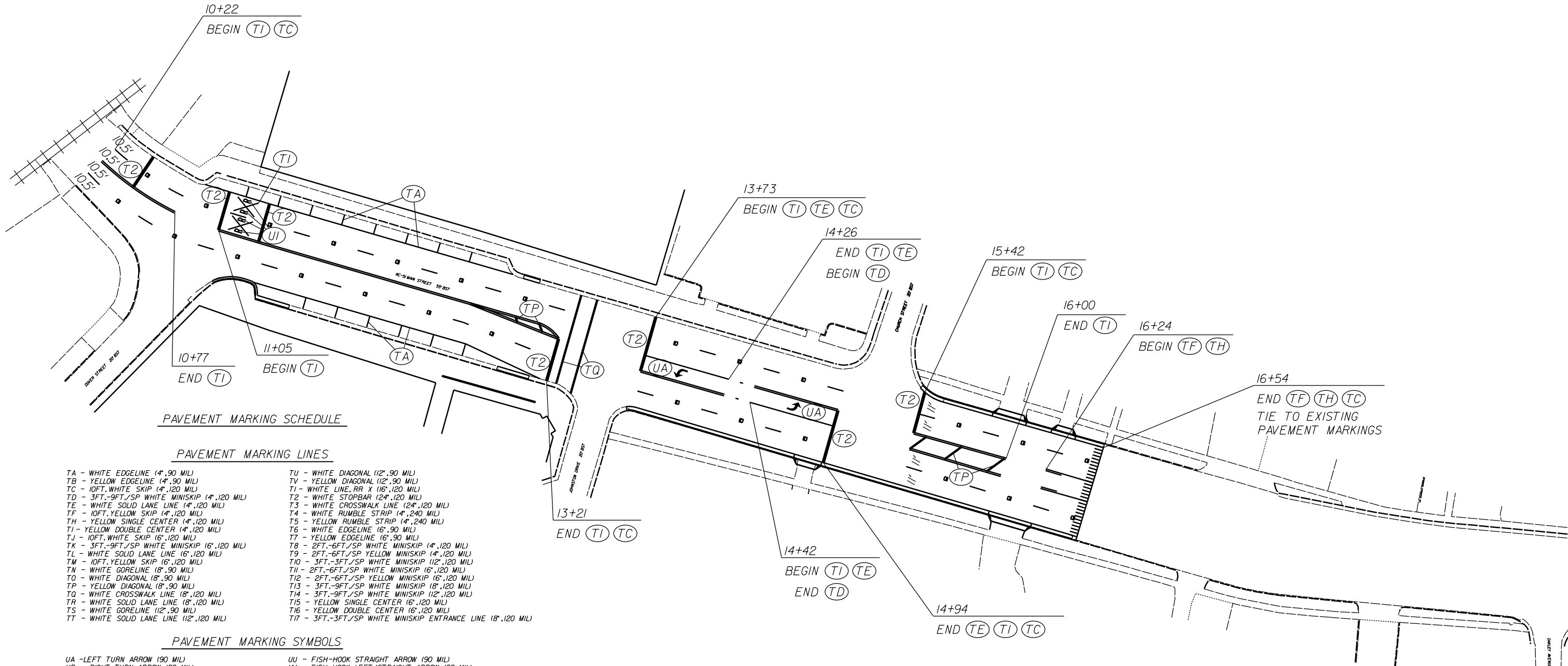

**NC 51 DRAINAGE IMPROVEMENTS
IN PINEVILLE**

SCALE	1"=60'		REVISIONS
DATE	3-2015		
DWG. BY	JDH		
DESIGN BY			
APPROVED	RWB		