

STATE	PROJECT NO.	SHEET NO.	TOTAL SHEETS
N.C.	2023CPT.10.04.10841 2023CPT.10.04.20841	1	17
F.A. PROJECT NO.			

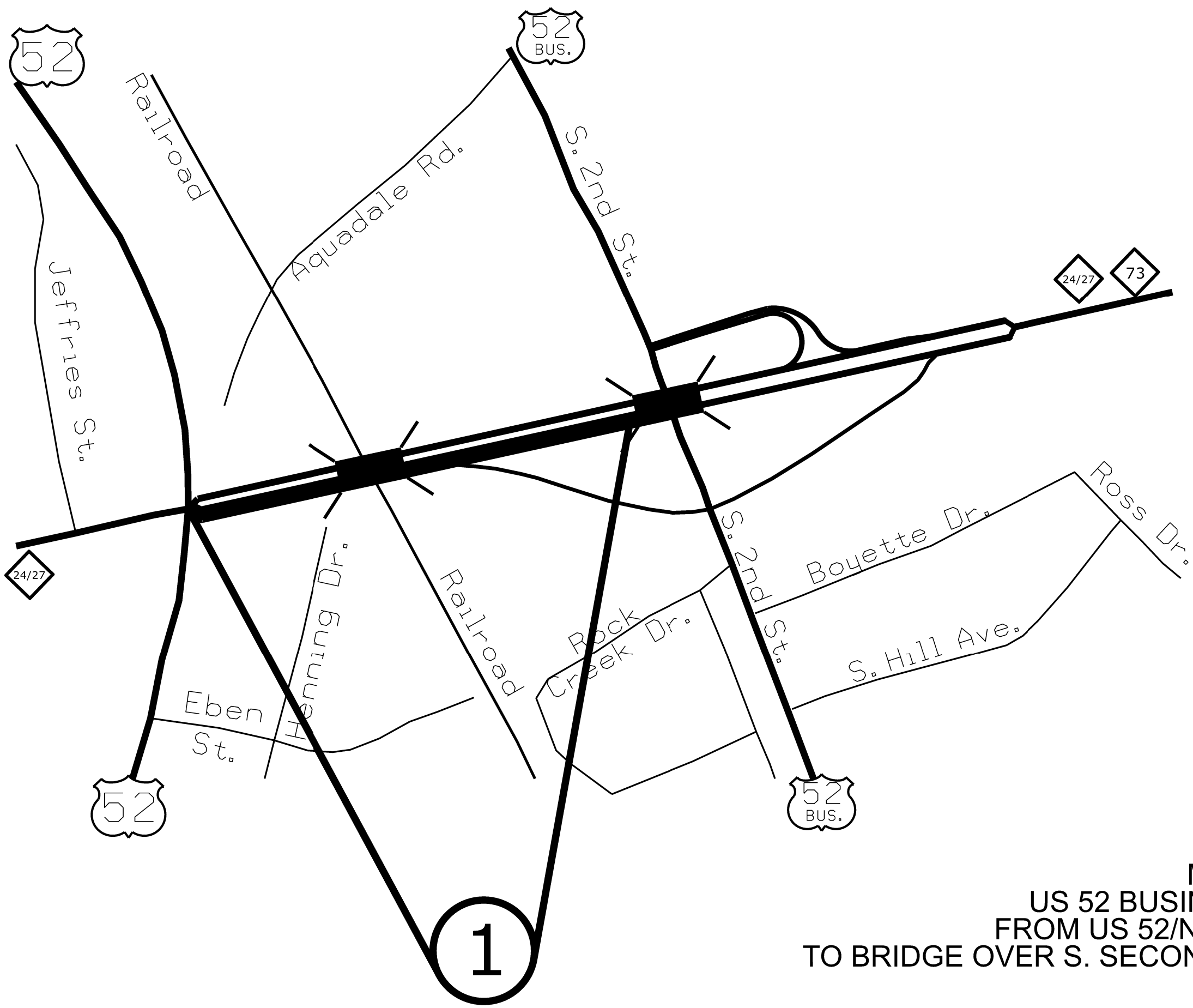

ENLARGED MUNICIPAL AND SUBURBAN AREAS  
**STANLY COUNTY**  
 NORTH CAROLINA  
PREPARED BY THE  
 NORTH CAROLINA DEPARTMENT OF TRANSPORTATION  
 DIVISION OF HIGHWAYS - DIVISION 10 DISTRICT 1



**MAP # 1**  
 US 52 BUSINESS 0.26 MILES  
 FROM US 52/NC 24/27/73 (MP 0.00)  
 TO BRIDGE OVER S. SECOND STREET (US 52 BUS.) (MP 0.26)

STATE	PROJECT NO.	SHEET NO.	TOTAL SHEETS
N.C.	2023CPT.10.04.10841 2023CPT.10.04.20841	2	17
F.A. PROJECT NO.			



ENLARGED MUNICIPAL AND SUBURBAN AREAS  
**STANLY COUNTY**  
 NORTH CAROLINA  
PREPARED BY THE  
 NORTH CAROLINA DEPARTMENT OF TRANSPORTATION  
 DIVISION OF HIGHWAYS - DIVISION 10 DISTRICT 1

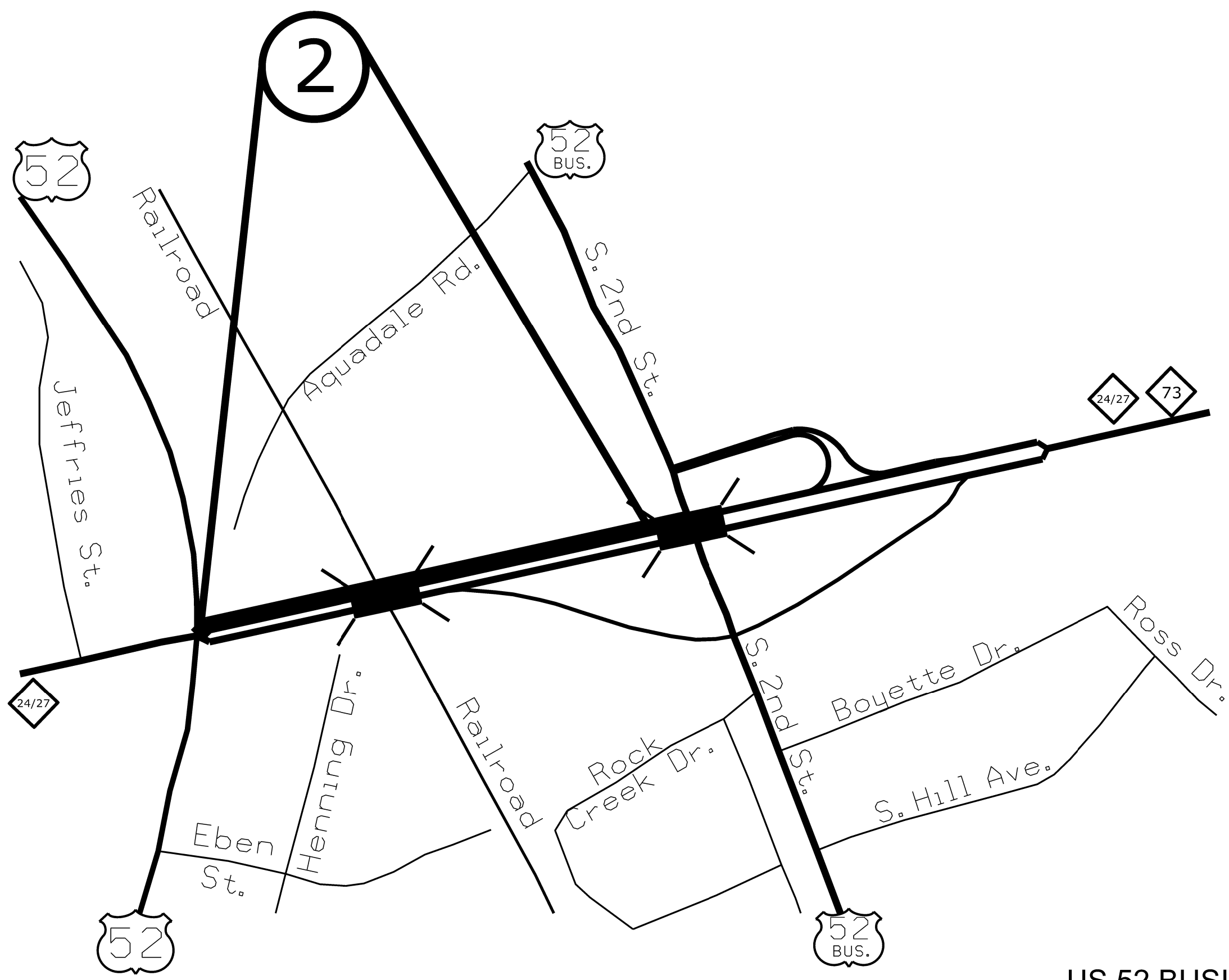

**MAP # 2**  
 US 52 BUSINESS 0.25 MILES  
 FROM BRIDGE OVER S. SECOND STREET (US 52 BUS.) (MP 2.12)  
 TO US 52/NC 24/27/73 (MP 2.37)

STATE	PROJECT NO.	SHEET NO.	TOTAL SHEETS
N.C.	2023CPT.10.04.10841 2023CPT.10.04.20841	3	17
F.A. PROJECT NO.			



ENLARGED MUNICIPAL AND SUBURBAN AREAS  
**STANLY COUNTY**  
 NORTH CAROLINA  
PREPARED BY: DHE  
 NORTH CAROLINA DEPARTMENT OF TRANSPORTATION  
 DIVISION OF HIGHWAYS - DIVISION 10 DISTRICT 1

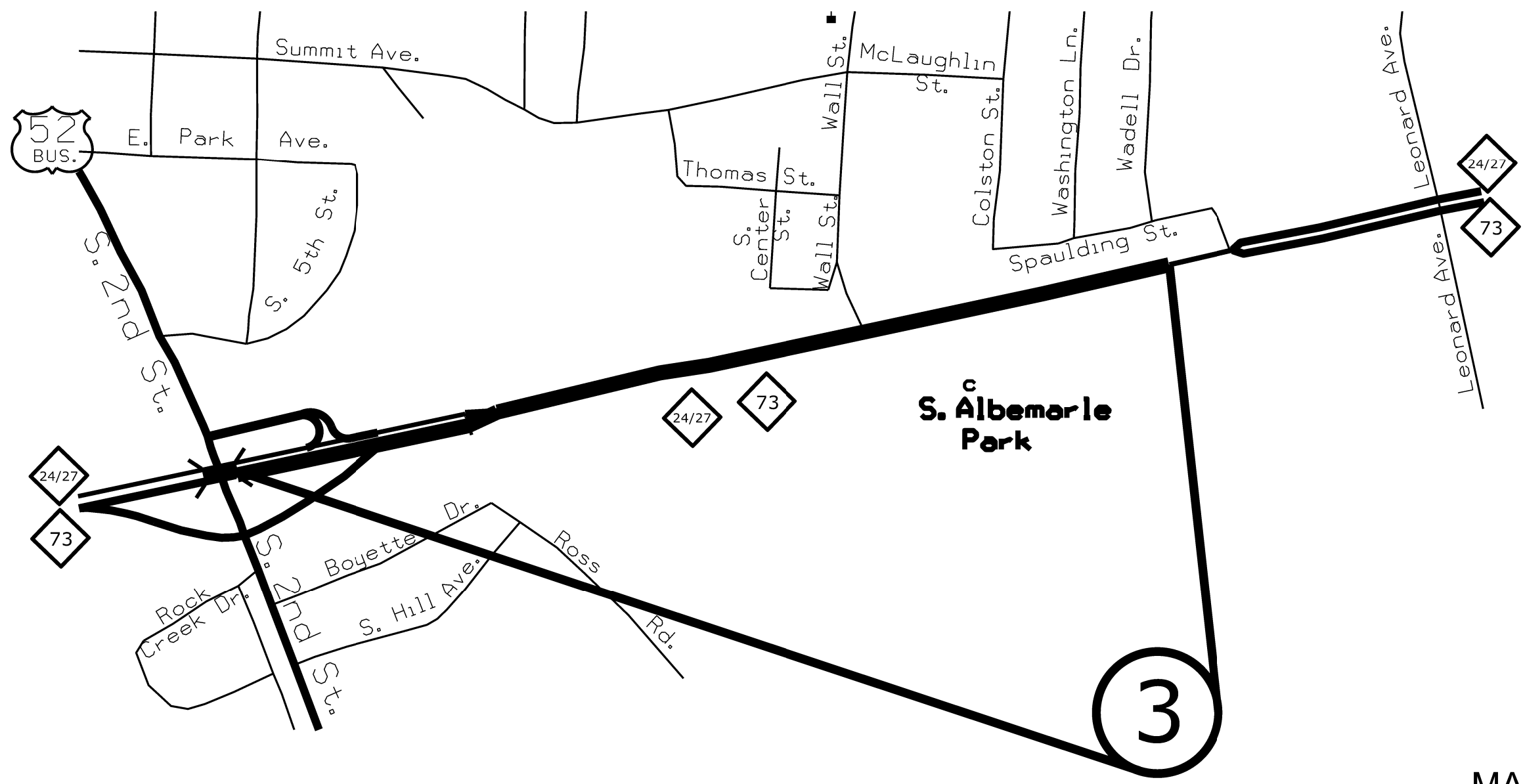

**MAP # 3**  
 NC 24/27 BYPASS EAST (EB AND WB) 0.78 MILES  
 FROM BRIDGE OVER S. SECOND STREET (US 52 BUS.)  
 (EASTBOUND ONLY) (MP 17.17)  
 TO JOINT BEFORE DIVIDED HIGHWAY  
 (EASTBOUND AND WESTBOUND) (MP 17.95)

STATE	PROJECT NO.	SHEET NO.	TOTAL SHEETS
N.C.	2023CPT.10.04.10841 2023CPT.10.04.20841	4	17
F.A. PROJECT NO.			



ENLARGED MUNICIPAL AND SUBURBAN AREAS  
**STANLY COUNTY**  
 NORTH CAROLINA  
PREPARED BY THE  
 NORTH CAROLINA DEPARTMENT OF TRANSPORTATION  
 DIVISION OF HIGHWAYS - DIVISION 10 DISTRICT 1

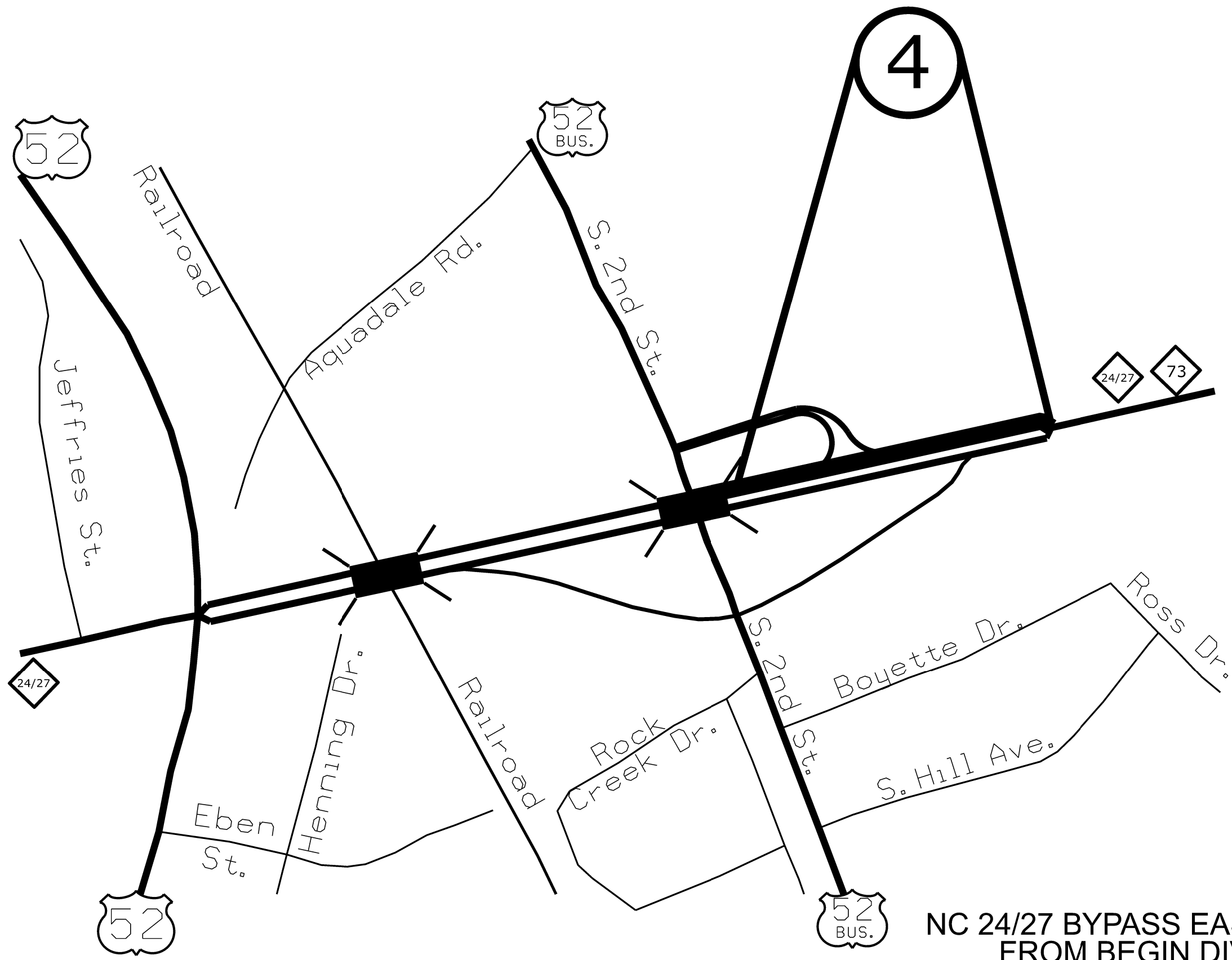

**MAP # 4**  
 NC 24/27 BYPASS EAST (WESTBOUND) 0.19 MILES  
 FROM BEGIN DIVIDED HIGHWAY (MP 7.64)  
 TO BRIDGE OVER S. SECOND STREET (US 52 BUS.) (MP 7.83)

STATE	PROJECT NO.	SHEET NO.	TOTAL SHEETS
N.C.	2023CPT.10.04.10841 2023CPT.10.04.20841	5	17
F.A. PROJECT NO.			



ENLARGED MUNICIPAL AND SUBURBAN AREAS  
**STANLY COUNTY**  
 NORTH CAROLINA  
PREPARED BY THE  
 NORTH CAROLINA DEPARTMENT OF TRANSPORTATION  
 DIVISION OF HIGHWAYS - DIVISION 10 DISTRICT 1

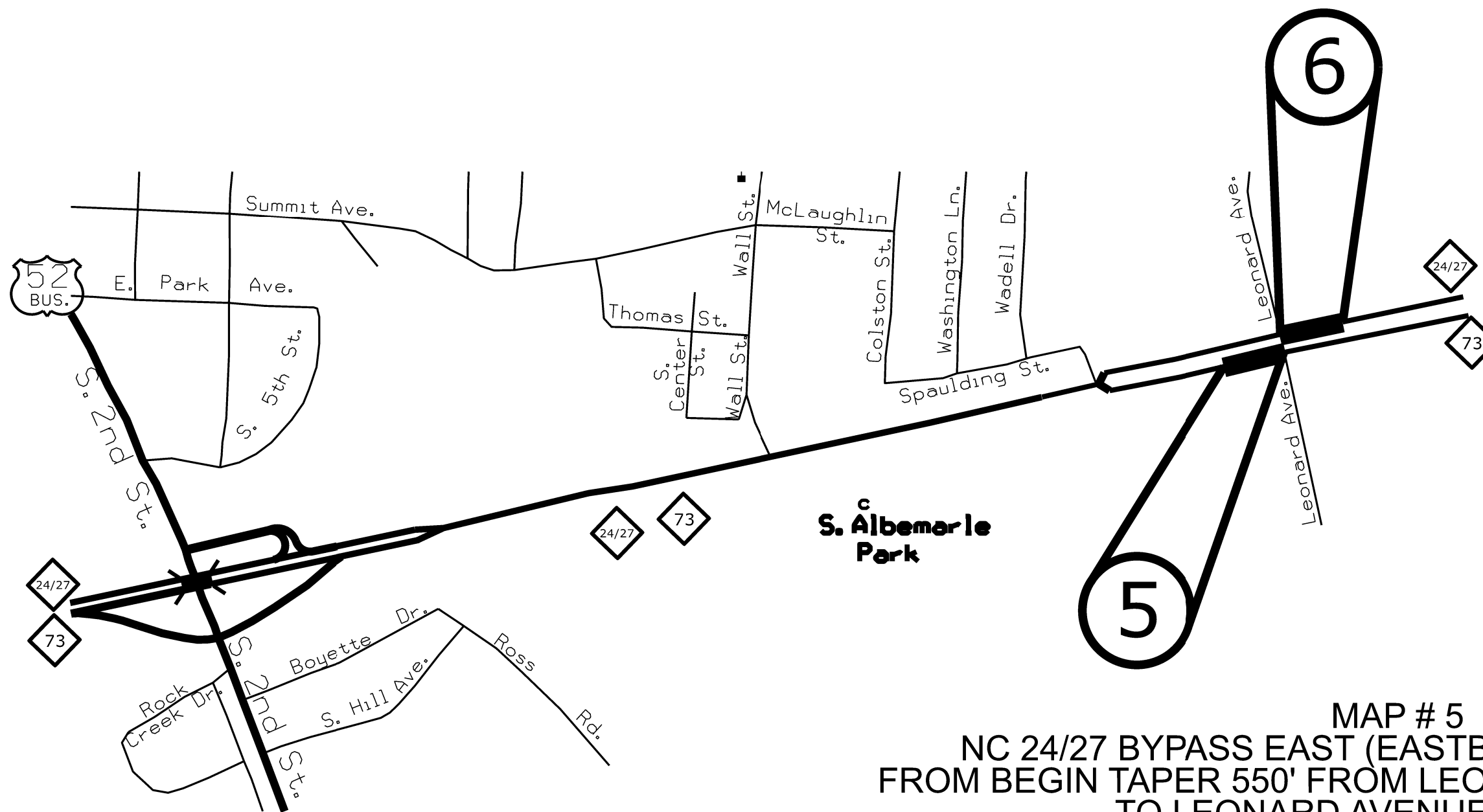

**MAP # 5**  
 NC 24/27 BYPASS EAST (EASTBOUND) 0.10 MILES  
 FROM BEGIN TAPER 550' FROM LEONARD AVENUE (MP 18.10)  
 TO LEONARD AVENUE (MP 18.20)

**MAP # 6**  
 NC 24/27 BYPASS EAST (WESTBOUND) 0.10 MILES  
 FROM BEGIN 550' FROM LEONARD AVENUE (MP 6.71)  
 TO LEONARD AVENUE (MP 6.81)

STATE	PROJECT NO.	SHEET NO.	TOTAL SHEETS
N.C.	2023CPT.10.04.10841 2023CPT.10.04.20841	6	17
F.A. PROJECT NO.			



ENLARGED MUNICIPAL AND SUBURBAN AREAS  
**STANLY COUNTY**  
 NORTH CAROLINA  
PREPARED BY THE  
 NORTH CAROLINA DEPARTMENT OF TRANSPORTATION  
 DIVISION OF HIGHWAYS - DIVISION 10 DISTRICT 1

**MAP # 7**  
 SR 1400 (OLD SALISBURY ROAD) 4.58 MILES  
 FROM SR 1214 (AUSTIN ROAD) (MP 3.05)  
 TO SR 1134 (MILLINGPORT ROAD) (MP 7.63)

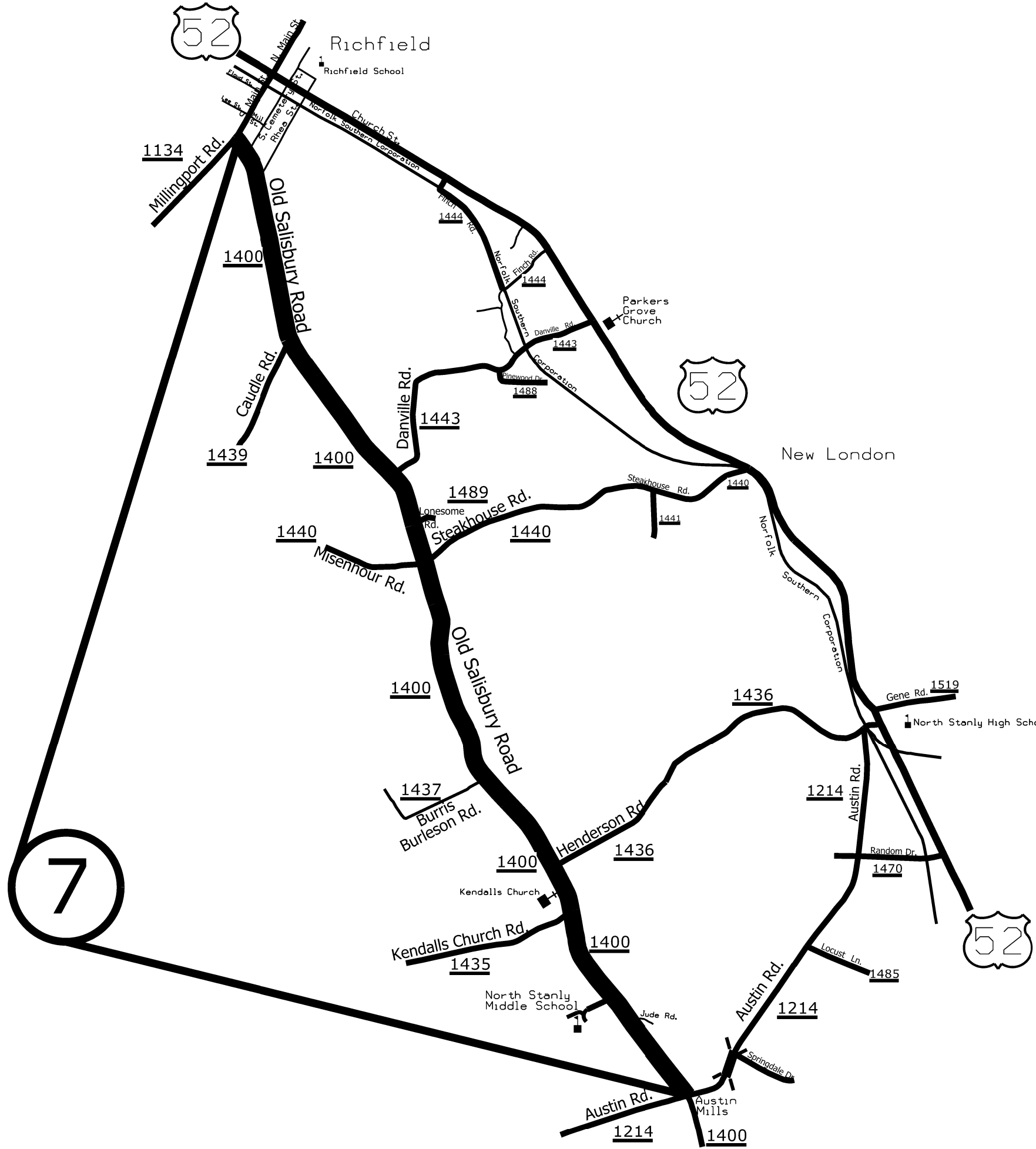

STATE	PROJECT NO.	SHEET NO.	TOTAL SHEETS
N.C.	2023CPT.10.04.10841 2023CPT.10.04.20841	7	17
F.A. PROJECT NO.			

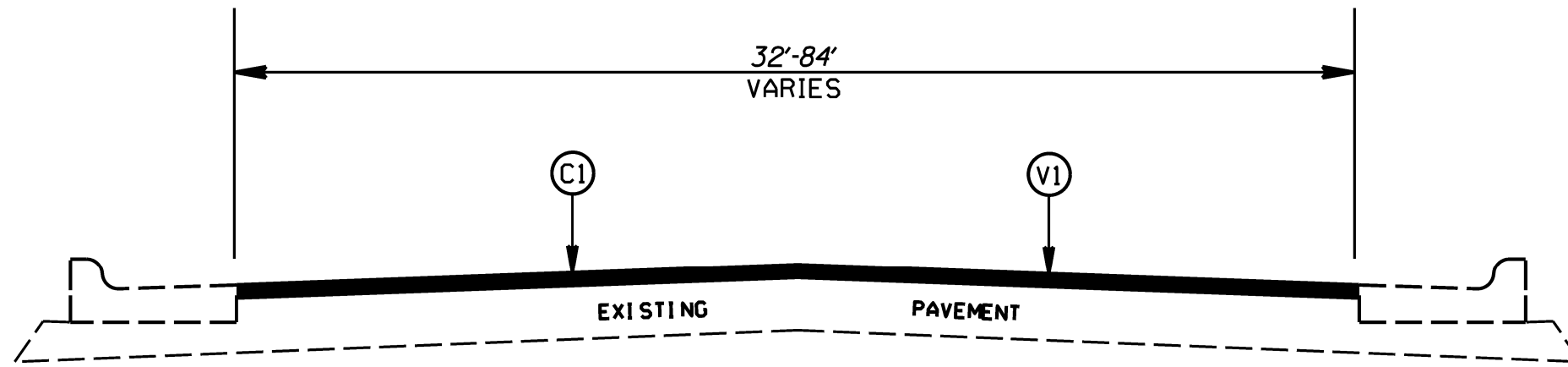

TYPICAL SECTION NO. 1

- MAP 1 - NC 24/27 BYPASS WEST (EASTBOUND)
- MAP 2 - NC 24/27 BYPASS WEST (WESTBOUND)
- MAP 3 - NC 24/27 BYPASS EAST (EASTBOUND)
- MAP 4 - NC 24/27 BYPASS EAST (WESTBOUND)

PAVEMENT SCHEDULE	
C1	PROP. APPROX. 1.50" ASPHALT CONCRETE SURFACE COURSE, TYPE S9.5C, AT AN AVERAGE RATE OF 168 LBS. PER SQ. YDS.
C2	PROP. APPROX. 2.00" ASPHALT CONCRETE SURFACE COURSE, TYPE S9.5D, AT AN AVERAGE RATE OF 224 LBS. PER SQ. YDS.
T1	SHOULDER RECONSTRUCTION
V1	MILLING OF EXISTING PAVEMENT, 1.50"
V2	PROFILE MILLING OF EXISTING ASPHALT, 0"-1.50" (8' WIDTH)
V3	MILLING OF EXISTING PAVEMENT, 2.00"

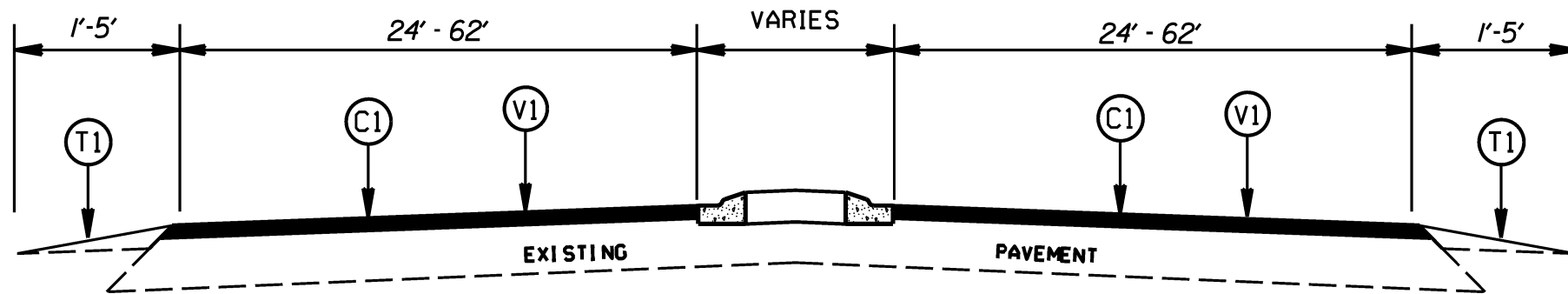

TYPICAL SECTION NO. 2

- MAP 1 - NC 24/27 BYPASS WEST (EASTBOUND)
- MAP 2 - NC 24/27 BYPASS WEST (WESTBOUND)
- MAP 3 - NC 24/27 BYPASS EAST (EASTBOUND)
- MAP 4 - NC 24/27 BYPASS EAST (WESTBOUND)

NOTES:  
1. LEVELING COURSE TO BE PLACED AS DIRECTED BY THE ENGINEER

STANLY COUNTY  
RESURFACING FALL 2022

SCALE	NA		REVISIONS
DATE	8/22		
DWG. BY	JWH		
DESIGN BY	JWH		
APPROVED	JWH		

STATE	PROJECT NO.	SHEET NO.	TOTAL SHEETS
N.C.	2023CPT.10.04.10841 2023CPT.10.04.20841	8	17
F.A. PROJECT NO.			

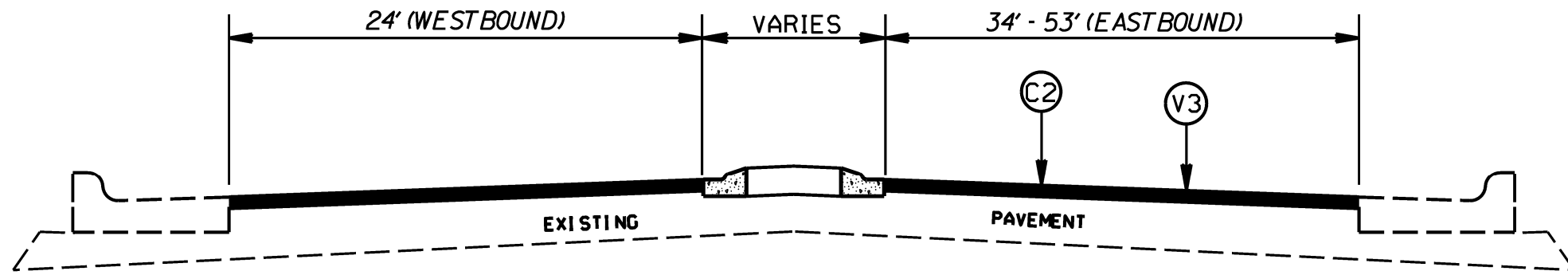

TYPICAL SECTION NO. 3  
MAP 5 - NC 24/27 BYPASS EAST (EASTBOUND)

PAVEMENT SCHEDULE	
C1	PROP. APPROX. 1.50" ASPHALT CONCRETE SURFACE COURSE, TYPE S9.5C, AT AN AVERAGE RATE OF 168 LBS. PER SQ. YDS.
C2	PROP. APPROX. 2.00" ASPHALT CONCRETE SURFACE COURSE, TYPE S9.5D, AT AN AVERAGE RATE OF 224 LBS. PER SQ. YDS.
T1	SHOULDER RECONSTRUCTION
V1	MILLING OF EXISTING PAVEMENT, 1.50"
V2	PROFILE MILLING OF EXISTING ASPHALT, 0"-1.50" (8' WIDTH)
V3	MILLING OF EXISTING PAVEMENT, 2.00"

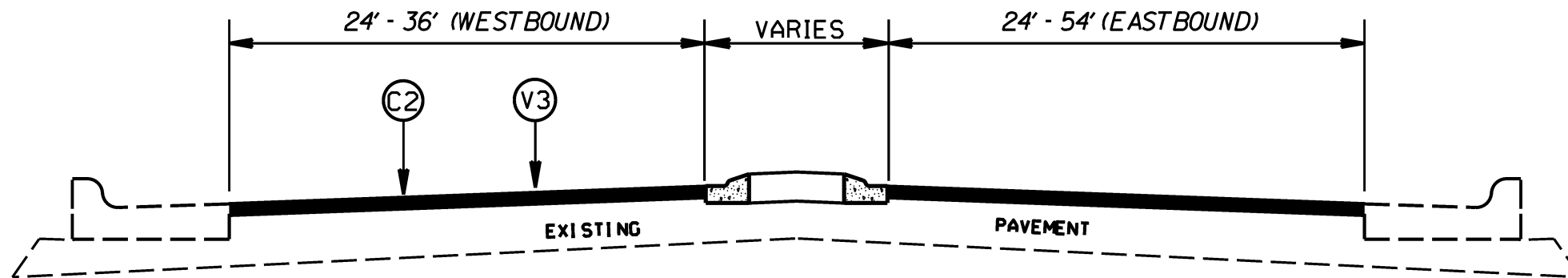

TYPICAL SECTION NO. 4  
MAP 6 - NC 24/27 BYPASS EAST (WESTBOUND)

NOTES:  
1. LEVELING COURSE TO BE PLACED AS DIRECTED BY THE ENGINEER

STANLY COUNTY  
RESURFACING FALL 2022

SCALE	NA		REVISIONS
DATE	8/22		
DWG. BY	JWH		
DESIGN BY	JWH		
APPROVED	JWH		



STATE	PROJECT NO.	SHEET NO.	TOTAL SHEETS
N.C.	2023CPT.10.04.10841 2023CPT.10.04.20841	9	17
F.A. PROJECT NO.			

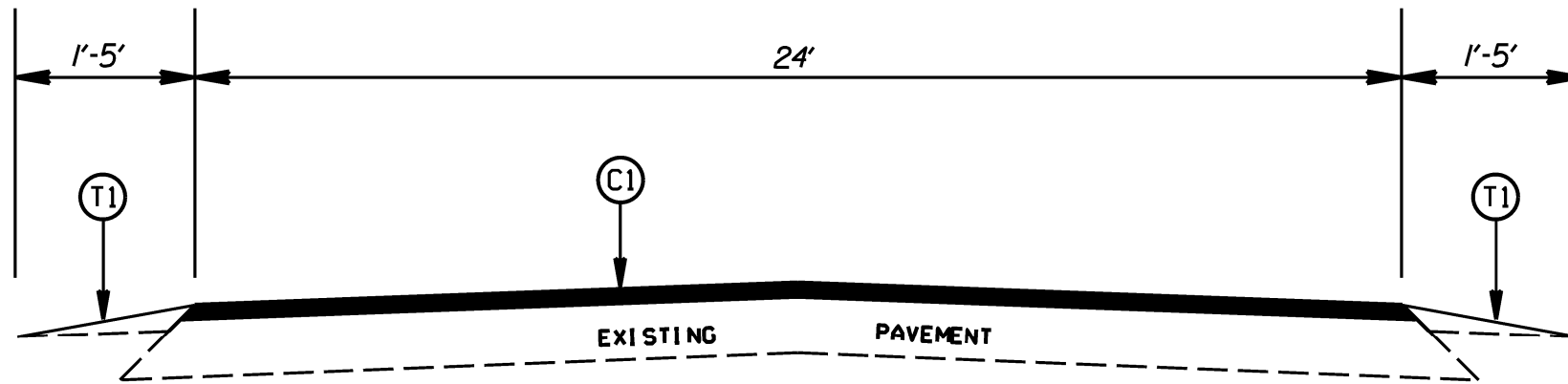

TYPICAL SECTION NO. 5  
MAP 7 - SR 1400 - OLD SALISBURY ROAD

PAVEMENT SCHEDULE	
C1	PROP. APPROX. 1.50' ASPHALT CONCRETE SURFACE COURSE, TYPE S9.5C, AT AN AVERAGE RATE OF 168 LBS. PER SQ. YDS.
C2	PROP. APPROX. 2.00' ASPHALT CONCRETE SURFACE COURSE, TYPE S9.5D, AT AN AVERAGE RATE OF 224 LBS. PER SQ. YDS.
T1	SHOULDER RECONSTRUCTION
V1	MILLING OF EXISTING PAVEMENT, 1.50'
V2	PROFILE MILLING OF EXISTING ASPHALT, 0'-1.50' (8' WIDTH)
V3	MILLING OF EXISTING PAVEMENT, 2.00'

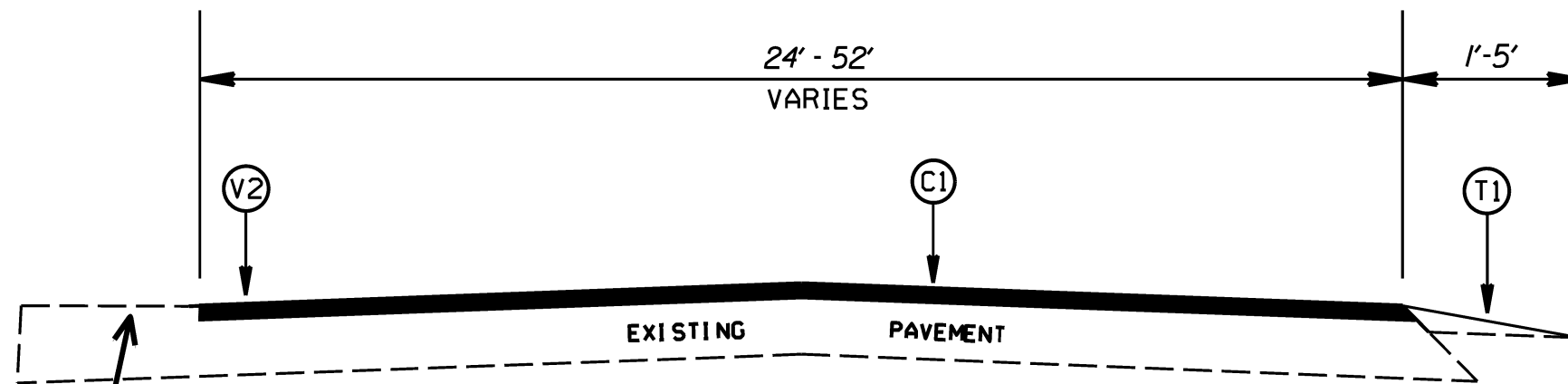

TYPICAL SECTION NO. 6  
MAP 7 - SR 1400 - OLD SALISBURY ROAD  
PAVED ENTRANCE AT SCHOOL

NOTES:  
1. LEVELING COURSE TO BE PLACED AS DIRECTED BY THE ENGINEER

STANLY COUNTY RESURFACING FALL 2022			
SCALE	-NA-		REVISIONS
DATE	8/22		
DWG. BY	JWH		
DESIGN BY	JWH		
APPROVED	JWH		

STATE	PROJECT NO.	SHEET NO.	TOTAL SHEETS
N.C.	2023CPT.10.04.10841 2023CPT.10.04.20841	10	17
F.A. PROJECT NO.			

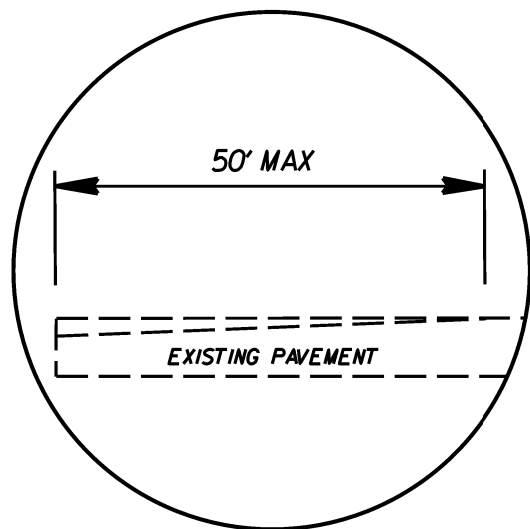

DETAIL FOR INCIDENTAL MILLING (0' TO 1.0')  
TIE-IN

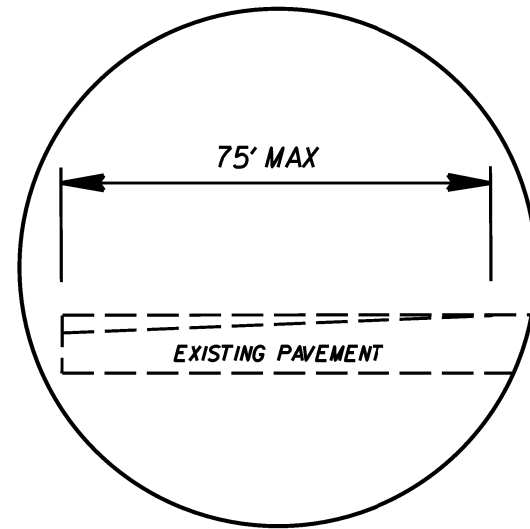

DETAIL FOR INCIDENTAL MILLING (0' TO 1.5')  
TIE-IN

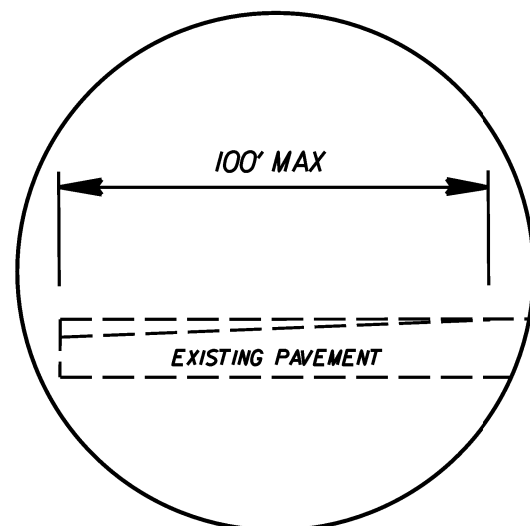

DETAIL FOR INCIDENTAL MILLING (0' TO 2.0')  
TIE-IN

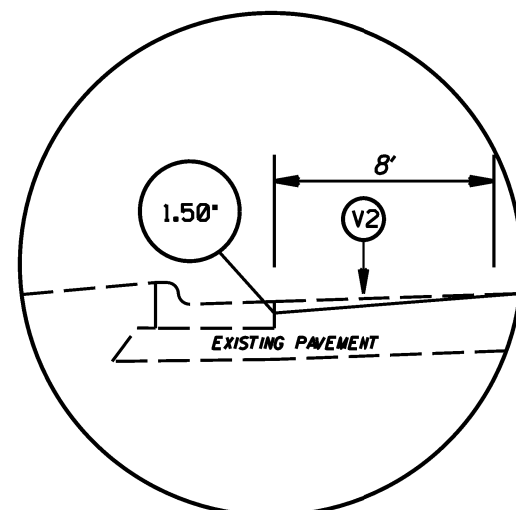

DETAIL FOR PROFILE MILLING (0' TO 1.50')

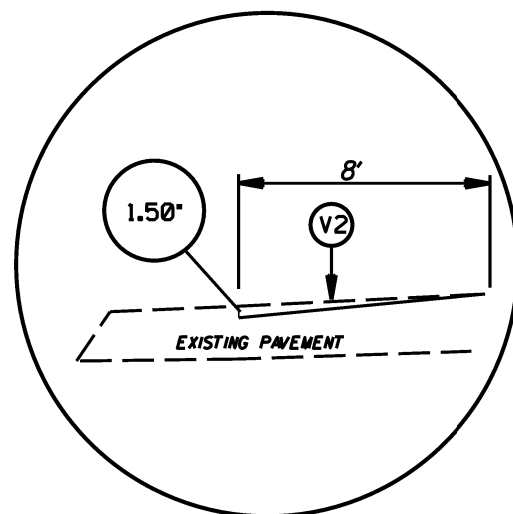

DETAIL FOR PROFILE MILLING (0' TO 1.50')

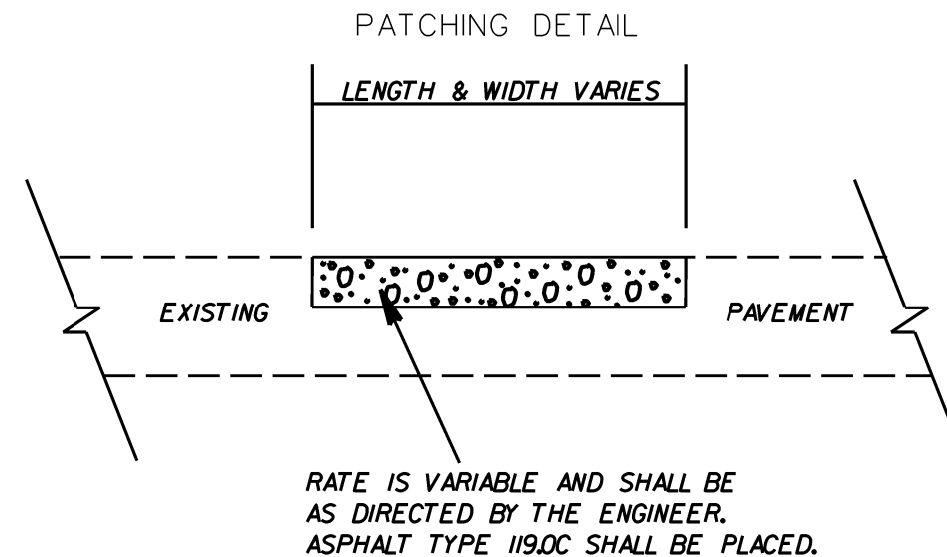

TYPE S9.5B OR S9.5C (LEVELING COURSE)

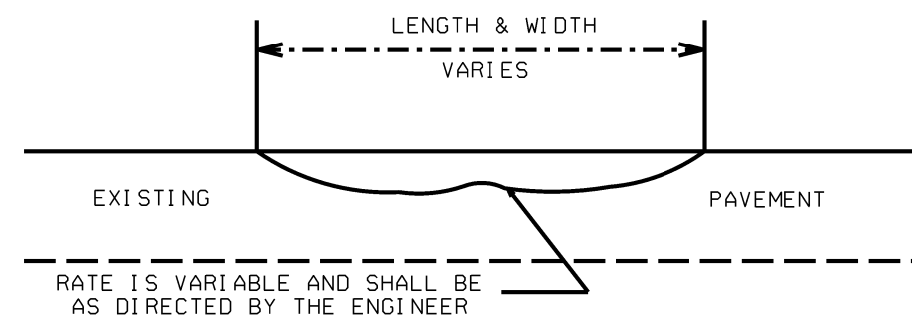

PATCHING, LEVELING, MILLING,  
PROFILE MILLING DETAILS

SCALE	-NA-		REVISIONS
DATE	10/21		
DWG. BY	JWH		
DESIGN BY	JWH		
APPROVED	JWH		

**NOTES:**

- 1) DETAIL DOES NOT APPLY TO OGAFB AND ULTRA-THIN BONDED WEARING COURSE.
- 2) BACKFILL SHOULDER WITH APPROVED MATERIAL.
- 3) THE SHOULDER WEDGE DEVICE MAY BE DISENGAGED AT PAVED DRIVEWAYS AND SIDE STREETS.

STATE	PROJECT NO.	SHEET NO.	TOTAL SHEETS
N.C.	2023CPT.10.04.10841 2023CPT.10.04.20841	11	17
F.A. PROJECT NO.			

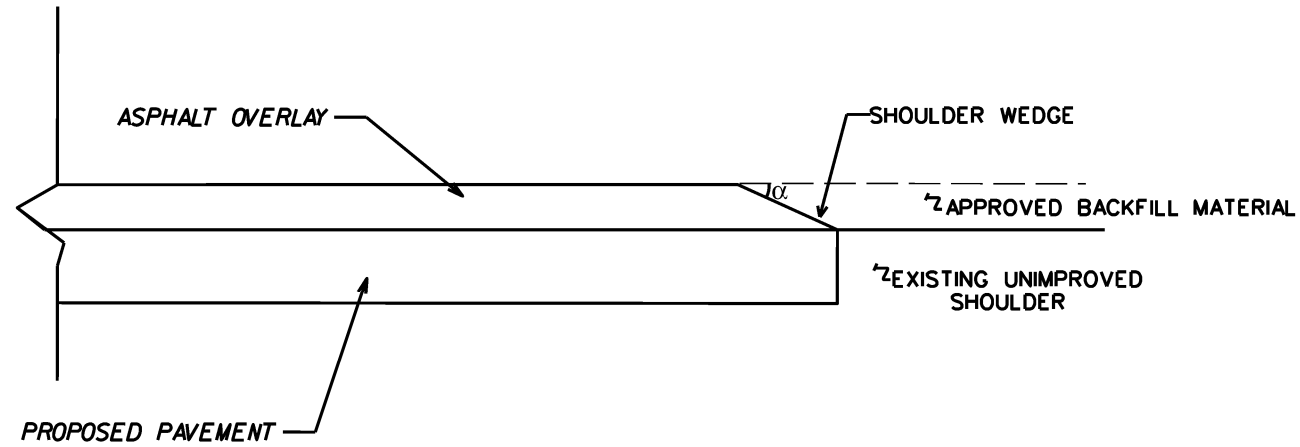

SHOULDER WEDGE DETAIL

(RESURFACING PROJECTS W/ WIDENING OR WITH EXISTING PAVED SHOULDER HAVING NO DROPOFFS)

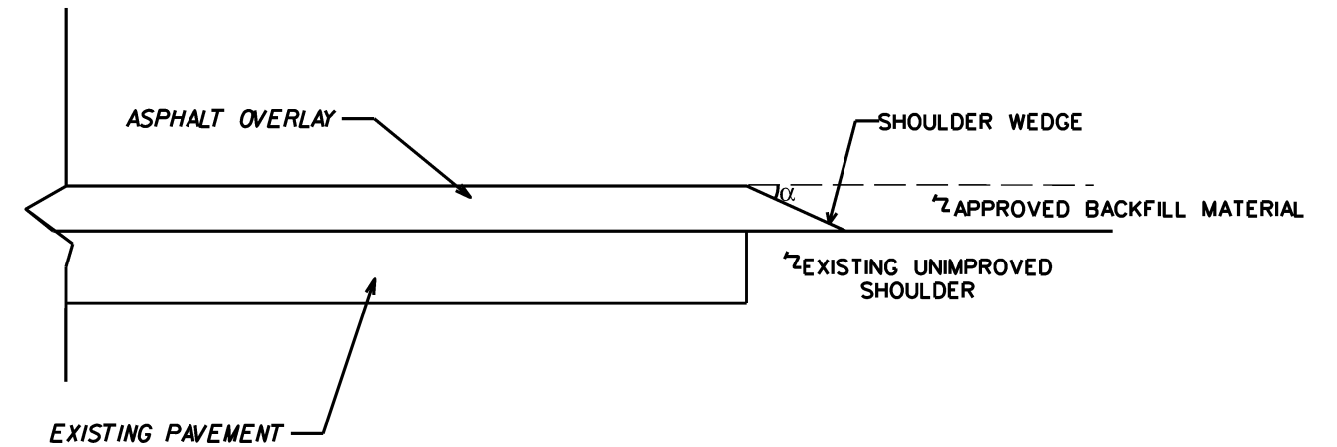

SHOULDER WEDGE DETAIL

(RESURFACING PROJECTS W/ NO WIDENING)

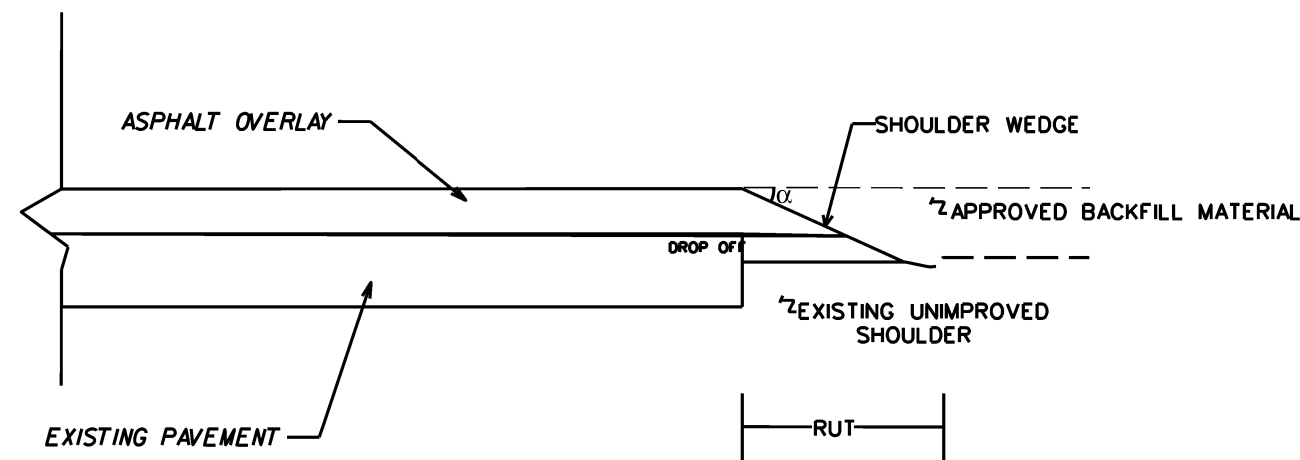

SHOULDER WEDGE DETAIL  
(RESURFACING ADJACENT TO RUTTED SHOULDER)

$\alpha = 30$  DEGREES

SHOULDER WEDGE DETAILS		
SCALE	DATE	REVISIONS
DATE	2/18	
DWG. BY	JAB	
DESIGN BY	JAB	
APPROVED	JAB	



PROJECT NO. 2023CPT.10.04.10841, 2023CPT.10.04.20841	SHEET NO. 12	TOTAL NO. 17
--	-----------------	-----------------

**SUMMARY OF QUANTITIES**

PROJECT NO	COUNTY	MAP NO	ROUTE	DESCRIPTION	TYP NO	LANES	LANE TYPE	FINAL SURFACE TESTING REQUIRED	WARM MIX ASPHALT REQUIRED	LENGTH	WIDTH	0106000000-E		1220000000-E		1245000000-E		1297000000-E		1308000000-E		1330000000-E		1523000000-E		1524000000-E		1524200000-E		1575000000-E		1577000000-E		1704000000-E		2600000000-N		2612000000-E		2845000000-N		5255000000-N		6071010000-E		6071020000-E											
												MI	FT	CY	TONS	SMI	SY	SY	SY	SY	TONS	TONS	TON	TONS	TONS	TONS	TONS	EA	SY	EA	LS	LF	LB																								
2023CPT.10.04.10841	Stanly	1	US 52 BUSINESS	FROM US 52/NC 24/27/73 (MP 0.00) TO BRIDGE OVER SOUTH SECOND STREET (MP 0.26)	1,2	2		NO	NO	0.26	32								4,600					450						36									0.20																		
		<b>TOTAL FOR MAP NO. 1</b>								0.26									4,600					450						36								0.20																			
2023CPT.10.04.10841	Stanly	2	US 52 BUSINESS	FROM BRIDGE OVER SOUTH SECOND STREET (MP 2.12) TO US 52/NC 24/27/73 (MP 2.37)	1,2	2		NO	NO	0.25	68								6,300					600						44									0.20																		
		<b>TOTAL FOR MAP NO. 2</b>								0.25									6,300					600						44								0.20																			
2023CPT.10.04.10841	Stanly	3	NC 24/27 BYPASS EAST (EASTBOUND)	FROM BRIDGE OVER SOUTH SECOND STREET (MP 17.17) TO JOINT BEFORE DIVIDED HIGHWAY (MP 17.95)	1,2	2		NO	NO	0.78	72								25,950					2,500						165				100			4.00			0.20																	
		<b>TOTAL FOR MAP NO. 3</b>								0.78									25,950					2,500						165				100			4.00			0.20																	
2023CPT.10.04.10841	Stanly	4	NC 24/27 BYPASS EAST (WESTBOUND)	FROM BEGIN DIVIDED HIGHWAY (MP 7.64) TO BRIDGE OVER S. SECOND STREET (MP 7.83)	1,2	2		NO	NO	0.19	42								4,050					375						27									0.20																		
		<b>TOTAL FOR MAP NO. 4</b>								0.19									4,050					375						27									0.20																		
2023CPT.10.04.10841	Stanly	5	NC 24/27 BYPASS EAST (EASTBOUND)	FROM BEGIN TAPER 550' FROM LEONARD AVENUE (MP 18.10) TO LEONARD AVENUE (MP 18.20)	3	2		NO	NO	0.10	53									2,900																			1			0.10															
		<b>TOTAL FOR MAP NO. 5</b>								0.10										2,900																		1			0.10																
2023CPT.10.04.10841	Stanly	6	NC 24/27 BYPASS EAST (WESTBOUND)	FROM BEGIN TAPER 550' FROM LEONARD AVENUE (MP 6.71) TO LEONARD AVENUE (MP 6.81)	4	2		NO	NO	0.10	36																												1			0.10															
		<b>TOTAL FOR MAP NO. 6</b>								0.10																												1			0.10																
<b>TOTAL FOR PROJ NO. 2023CPT.10.04.10841</b>											1.68								40,900	4,975								3,925				680			272			39			300			4.00			2			1.00							
<b>TOTAL FOR PROJ NO. 2023CPT.10.04.20841</b>											4.58	24	600	265	9.16								80	900	6,490	1,600							695									2,100				144			3			400		1			
<b>GRAND TOTAL</b>											6.26									40,900	4,975			80	900	10,415	1,600					680			967				39			2,400			4.00		144			5			1.00		400		1



# SIGNING FOR RESURFACING PROJECTS

STATE	PROJECT NO.	SHEET NO.	TOTAL SHEETS
N.C.	2023CPT.10.04.10841 2023CPT.10.04.20841	14	17
F.A. PROJECT NO.			

LEGEND	
	STATIONARY SIGN
	DIRECTION OF TRAFFIC FLOW

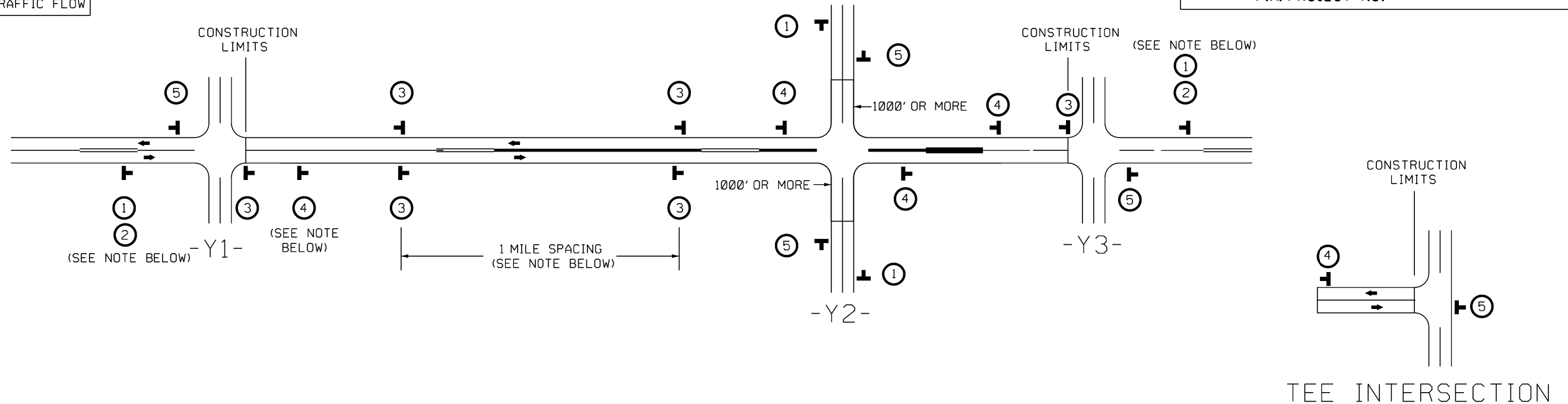

## MAINLINE (-L-) SIGNING

## -Y- LINE SIGNING

SIGNING NOTES AND PLACEMENT PER DIRECTION	1	ROAD WORK AHEAD W20-1 48" X 48"	PLACE 1000' PRIOR TO BEGINNING OF CONSTRUCTION LIMITS. ONLY USED ON -Y- LINES IF RESURFACING LIMITS EXTEND 1000' ALONG -Y- LINE.
	2	NEXT XX MILES W7-3aP 24" X 18"	*2 SIGN ONLY USED WHEN CONSTRUCTION LIMITS ARE 2 OR MORE MILES IN LENGTH. ROUND UP TO NEXT WHOLE NUMBER. (NO FRACTIONAL OR DECIMAL NUMBERS)
	3	LOW/SOFT SHOULDER SP 13107 48" X 48"	- PLACE INITIALLY AT THE CONSTRUCTION LIMITS AND SPACE 1 MILE APART THEREAFTER. - AT TEE INTERSECTIONS INSTALL INITIALLY 1/2 MILE FROM INTERSECTION AND SPACE 1 MILE APART THEREAFTER.
	4	ROAD UNDER CONST SP 13106 48" X 48"	- THESE ARE FOR -Y- LINES THAT ARE "THROUGH" ROADWAYS. DEAD END AND SUBDIVISION ROADS ARE NOT "THROUGH" ROADWAYS. - INSTALL 500' +/- FROM EACH -Y- LINE APPROACH AS SHOWN ABOVE. - FOR MULTIPLE -Y- LINES THAT ARE SEPARATED BY 0.25 MILES OR LESS, TREAT AS A SINGLE UNIT AND INSTALL WITHIN 500' OF EACH APPROACH. - A MAXIMUM OF 2 SIGN SETS PER MILE. DO NOT INSTALL WHEN -Y- LINES ARE WITHIN 0.5 MILES FROM "END ROAD WORK" SIGN. - FOR TEE INTERSECTIONS, INSTALL WITHIN 500' +/- OF THE INTERSECTION ALONG -L- LINE.
	5	END ROAD WORK G20-2 A 48" X 24"	PLACE 500' FOLLOWING THE END OF CONSTRUCTION LIMITS OR AS SHOWN WHEN WORK ENDS AT A 3-WAY TEE INTERSECTION.
THE ABOVE SIGNS ARE ALL THAT ARE REQUIRED FOR A CONTRACTOR TO BEGIN A RESURFACING CONTRACT. ANY ADDITIONAL SIGNS REQUESTED BY NCDOT DIVISIONS SHALL BE INSTALLED WITHIN 7 BUSINESS DAYS OF THE START OF CONTRACT WORK.			
MAPS LESS THAN 2 MILES	FOR RESURFACING MAPS WITH CONSTRUCTION LIMITS LESS THAN 2 MILES IN LENGTH, NO STATIONARY SIGNS ARE REQUIRED. USE PORTABLE "ROAD UNDER CONSTRUCTION" OR "ROAD WORK AHEAD" SIGNS IN LIEU OF STATIONARY ADVANCE WARNING SIGNS.		

NO REQUIRED STATIONARY SIGNING FOR THE FOLLOWING -Y- LINE CONDITIONS:

- 1) LESS THAN 1000' OF RESURFACING ALONG -Y- LINE
- 2) SUBDIVISION ROADS
- 3) DEAD END ROADS

WHEN PAVING/CONSTRUCTION ACTIVITIES PROCEED ACROSS AN UNSIGNED -Y- LINE, PORTABLE ADVANCE WARNING SIGNS SHALL BE USED ALONG THE -Y- LINE AS SHOWN BELOW. REMOVE UPON COMPLETION OF WORK.

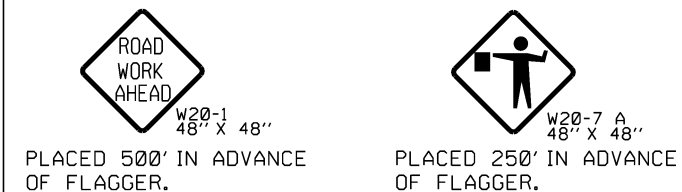

ADVANCE WARNING SIGNS FOR RURAL AND SUBURBAN 2-LANE ROADWAY RESURFACING

LEGEND	
	STATIONARY SIGN
	DIRECTION OF TRAFFIC FLOW

# SIGNING FOR RESURFACING PROJECTS

STATE	PROJECT NO.	SHEET NO.	TOTAL SHEETS
N.C.	2023CPT.10.04.10841 2023CPT.10.04.20841	15	17
F.A. PROJECT NO.			

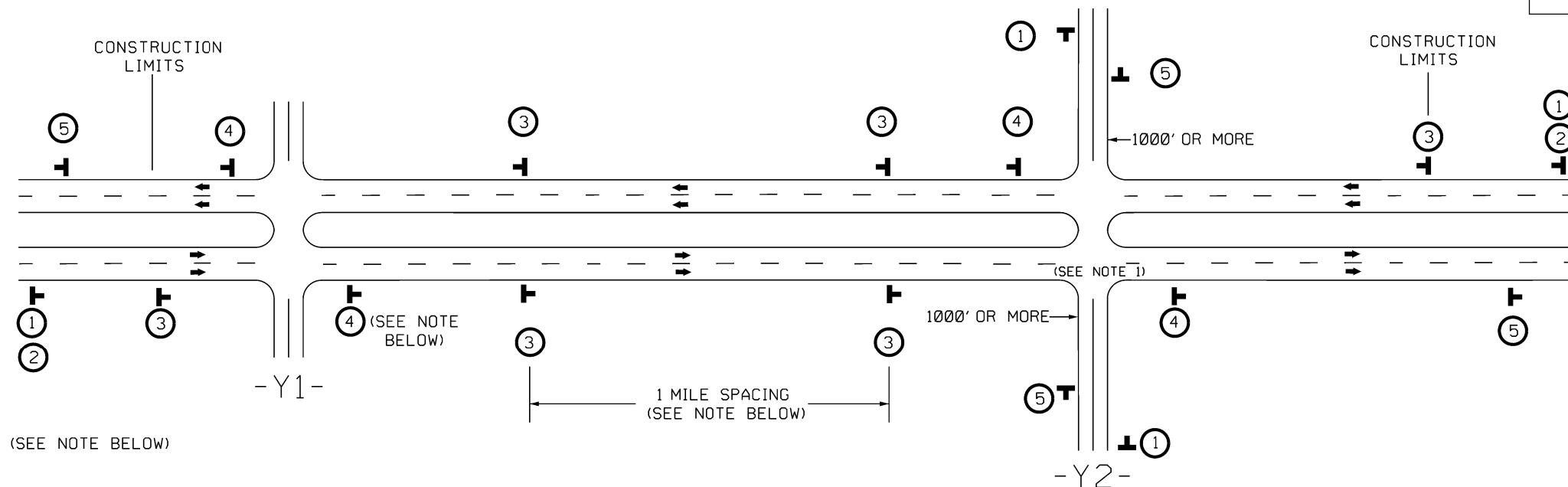

## MAINLINE (-L-) SIGNING

## -Y- LINE SIGNING

SIGNING NOTES AND PLACEMENT PER DIRECTION	  <p>PLACE 1000' PRIOR TO BEGINNING OF CONSTRUCTION LIMITS. ONLY USED ON -Y- LINES IF RESURFACING LIMITS EXTEND 1000' ALONG -Y- LINE.          #2 SIGN ONLY USED WHEN CONSTRUCTION LIMITS ARE 2 OR MORE MILES IN LENGTH. ROUND UP TO NEXT WHOLE NUMBER. (NO FRACTIONAL OR DECIMAL NUMBERS)</p>	<p>NO REQUIRED STATIONARY SIGNING FOR THE FOLLOWING -Y- LINE CONDITIONS:</p> <ol style="list-style-type: none"> <li>LESS THAN 1000' OF RESURFACING ALONG -Y- LINE</li> <li>SUBDIVISION ROADS</li> <li>DEAD END ROADS</li> </ol> <p>WHEN PAVING/CONSTRUCTION ACTIVITIES PROCEED ACROSS AN UNSIGNED -Y- LINE, PORTABLE ADVANCE WARNING SIGNS SHALL BE USED ALONG THE -Y- LINE AS SHOWN BELOW. REMOVE UPON COMPLETION OF WORK.</p> PLACED 500' IN ADVANCE OF FLAGGER. PLACED 250' IN ADVANCE OF FLAGGER.
	 <p>PLACE INITIALLY AT THE CONSTRUCTION LIMITS AND SPACE 1 MILE APART THEREAFTER. IF NO -Y- LINES EXIST, PLACE 2ND SET 1/2 MILE FROM THE CONSTRUCTION LIMITS AND THEN SPACE 1 MILE APART THEREAFTER. (NOTE: THESE SIGNS ARE TO BE OMITTED IN CURB AND GUTTER SECTIONS)</p>	
	 <p>THESE ARE FOR -Y- LINES THAT ARE "THROUGH" ROADWAYS. DEAD END AND SUBDIVISION ROADS ARE NOT "THROUGH" ROADWAYS. INSTALL 500' +/- FROM EACH -Y- LINE APPROACH AS SHOWN ABOVE. FOR MULTIPLE -Y- LINES THAT ARE SEPARATED BY 0.25 MILES OR LESS, TREAT AS A SINGLE UNIT AND INSTALL WITHIN 500' OF EACH APPROACH. A MAXIMUM OF 2 SIGN SETS PER MILE. DO NOT INSTALL WHEN -Y- LINES ARE WITHIN 0.5 MILES FROM "END ROAD WORK" SIGN.</p>	
	 <p>PLACE 500' FOLLOWING THE END OF CONSTRUCTION LIMITS</p>	

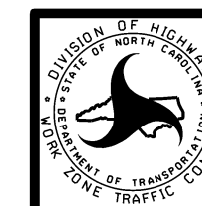

RESURFACING  
ADVANCE WARNING SIGNS  
FOR RURAL AND SUBURBAN  
MULTI-LANE ROADWAY  
W/ SHOULDER SECTIONS

NOTES: LESS THAN 5' - 10' UNDISTURBED BUFFER FROM ROW, DITCHLINE, WATER FEATURE, OR DRAINAGE INLET, ADD BMP.

BMP OPTIONS: WATTLE OR SILT FENCE

STATE	PROJECT NO.	SHEET NO.	TOTAL SHEETS
N.C.	2023CPT.10.04.10841 2023CPT.10.04.20841	16	17
F.A. PROJECT NO.			

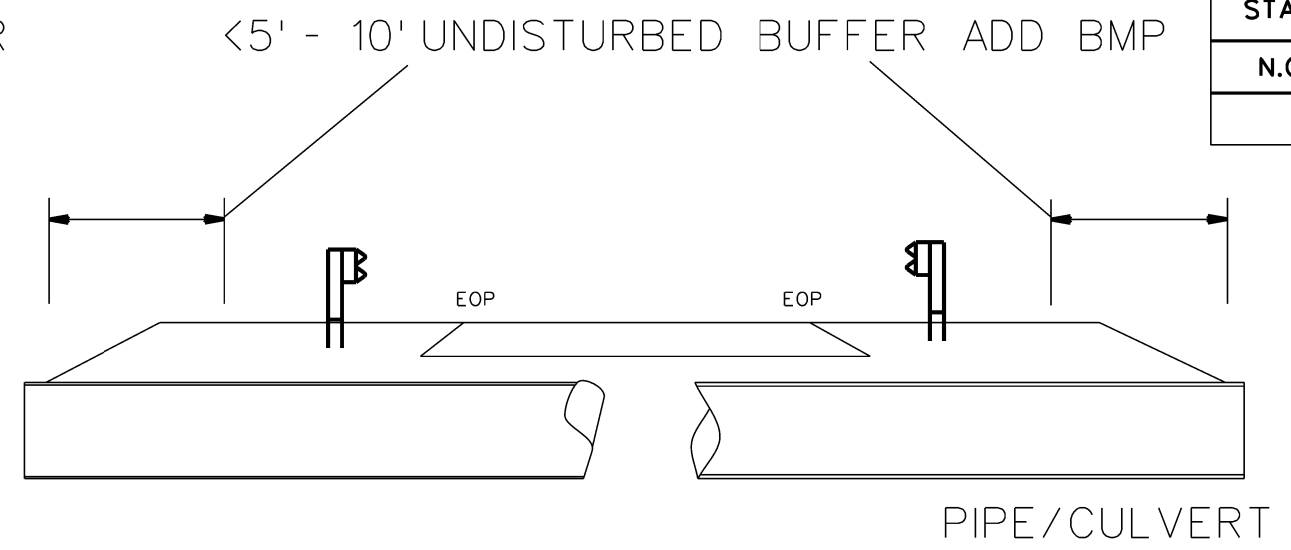

<5' - 10' UNDISTURBED BUFFER FROM JURISDICTIONAL FEATURE ADD BMP



USE BMP'S IF SHOULDERS AND/OR FRONTSLOPES AND/OR DITCHLINE AND/OR BACKSLOPES ARE DISTURBED

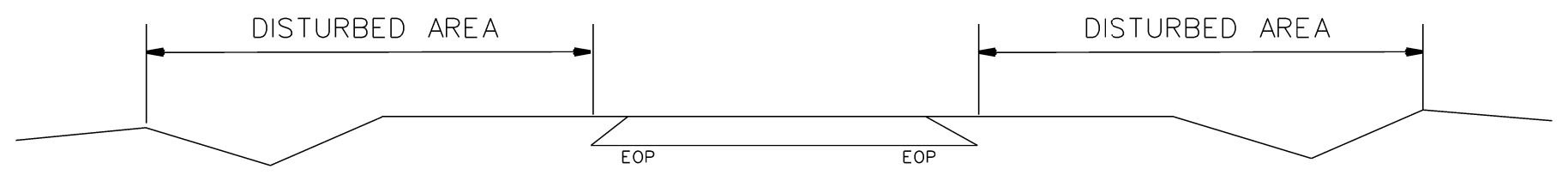

<5' - 10' UNDISTURBED BUFFER FROM INLET, ADD WATTLE

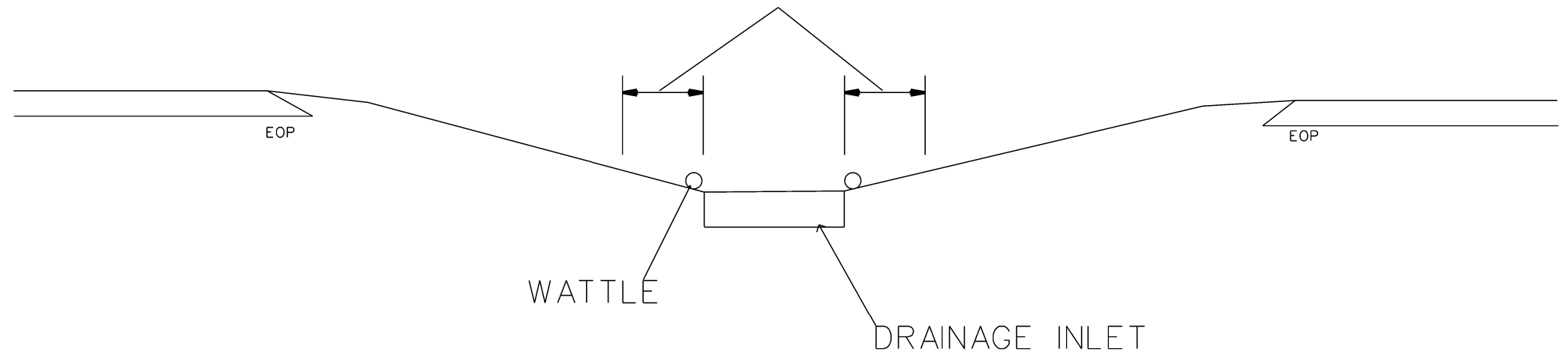

**EROSION CONTROL DETAIL**

SCALE	-1/4"		REVISIONS
DATE	2/18		
DWG. BY	JAB		
DESIGN BY	JAB		
APPROVED	JAB		



# WATTLE WITH POLYACRYLAMIDE DETAIL

STATE	PROJECT NO.	SHEET NO.	TOTAL SHEETS
N.C.	2023CPT.10.04.10841 2023CPT.10.04.20841	17	17
F.A. PROJECT NO.			

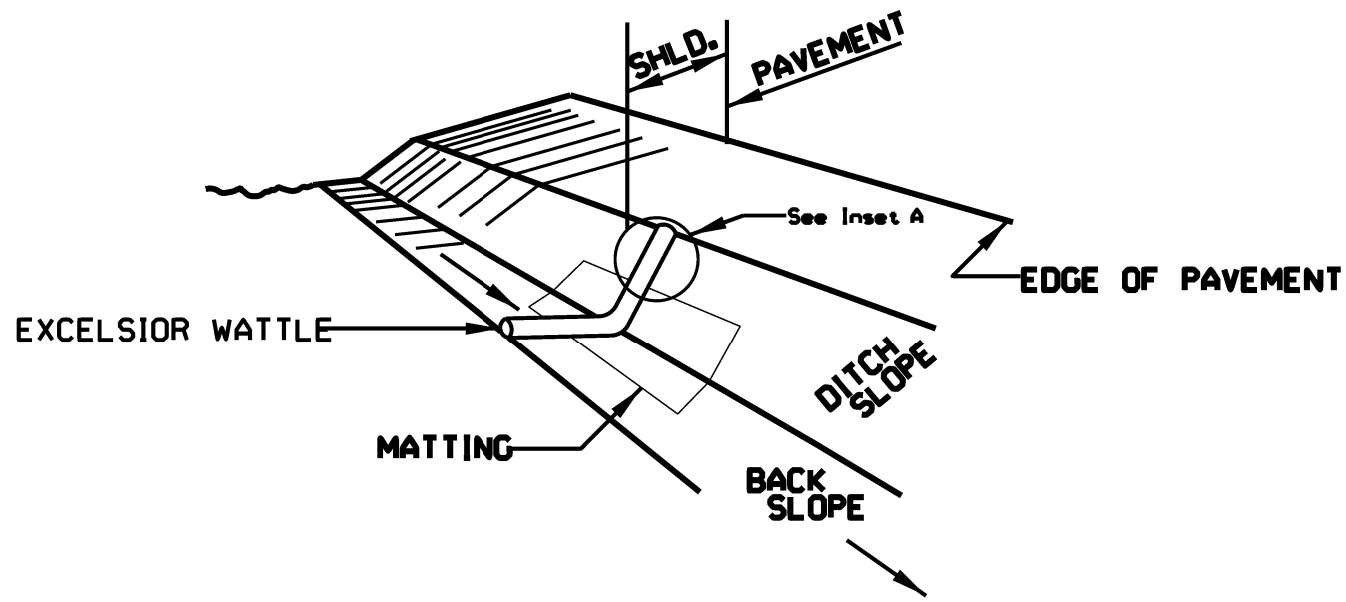

**ISOMETRIC VIEW**

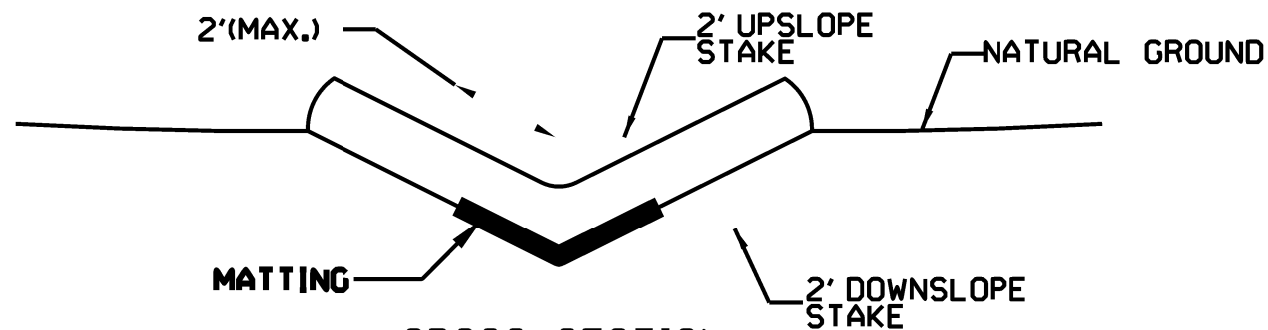

**CROSS SECTION VEE DITCH**

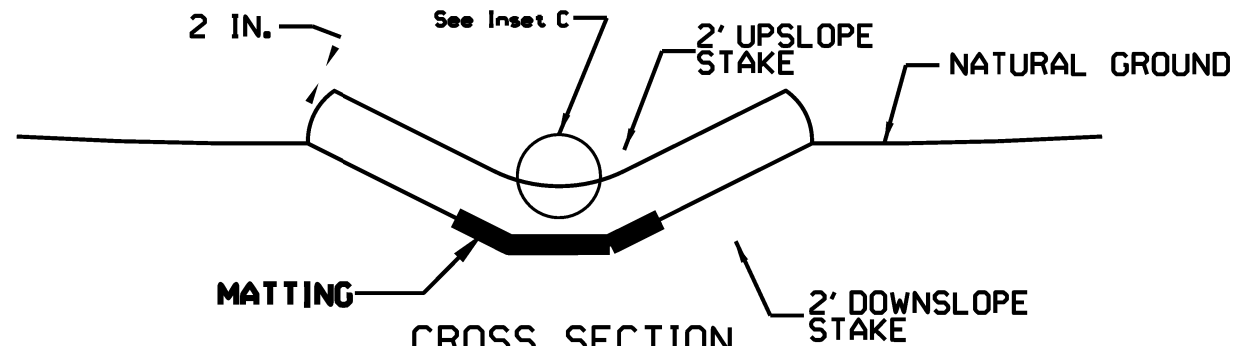

**CROSS SECTION TRAPEZOIDAL DITCH**

**NOTES:**

USE MINIMUM 12 IN. DIAMETER EXCELSIOR WATTLE.

USE 2 FT. WOODEN STAKES WITH A 2 IN. BY 2 IN. CROSS SECTION.

INSTALL A MINIMUM OF 2 UPSLOPE STAKES AND 4 DOWNSLOPE STAKES AT AN ANGLE TO WEDGE WATTLE TO BOTTOM OF DITCH.

PROVIDE STAPLES MADE OF 0.125 IN. DIAMETER STEEL WIRE FORMED INTO A U SHAPE NOT LESS THAN 12" IN LENGTH.

INSTALL STAPLES APPROXIMATELY EVERY 1 LINEAR FOOT ON BOTH SIDES OF WATTLE AND AT EACH END TO SECURE IT TO THE SOIL.

INSTALL MATTING IN ACCORDANCE WITH SECTION 1631 OF THE STANDARD SPECIFICATIONS.

PRIOR TO POLYACRYLAMIDE (PAM) APPLICATION, OBTAIN A SOIL SAMPLE FROM PROJECT LOCATION, AND FROM OFFSITE MATERIAL, AND ANALYZE FOR APPROPRIATE PAM FLOCCULANT TO BE APPLIED TO EACH WATTLE.

INITIALLY APPLY 3.5 OUNCES OF ANIONIC OR NEUTRALLY CHARGED POLYACRYLAMIDE (PAM) OVER WATTLE WHERE WATER WILL FLOW AND AFTER EVERY RAINFALL EVENT THAT IS EQUAL TO OR EXCEEDS 0.50 IN.

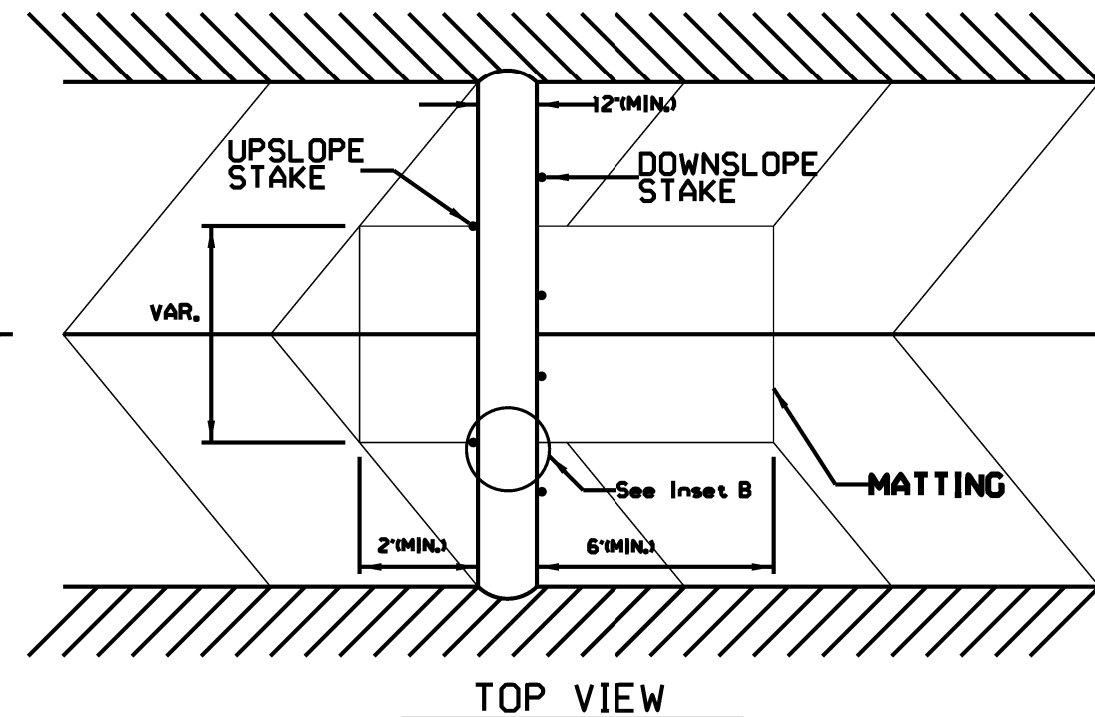
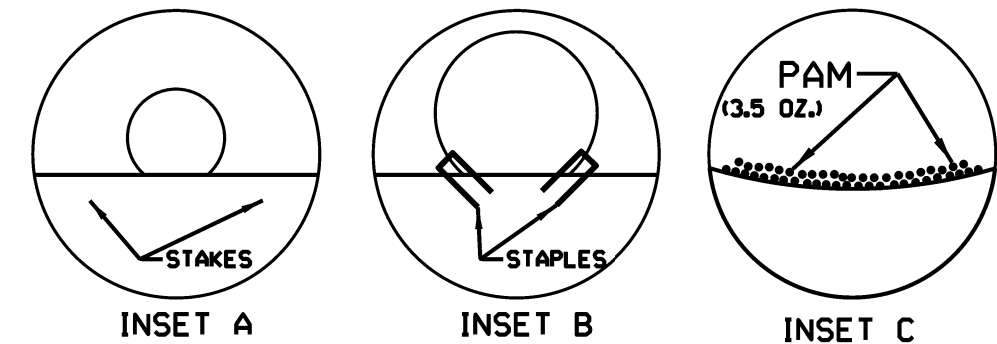

**TOP VIEW**