

8/17/99

- "PATCHING EXISTING PAVEMENT" HAS BEEN INCLUDED AS A PAY ITEM ON MAPS. PATCHING MAY OR MAY NOT BE NEEDED DEPENDING ON CONDITION OF MAP SURFACE AT TIME THAT PAVING SEASON BEGINS. AREAS TO BE DELINIATED BY THE ENGINEER.
- INCIDENTAL MILLING AT LOCATIONS AS DIRECTED BY THE ENGINEER
- *** LEVELING AT LOCATIONS AS DIRECTED BY ENGINEER THE ENGINEER

PROJECT REFERENCE NO.	SHEET NO.
DK00378	01

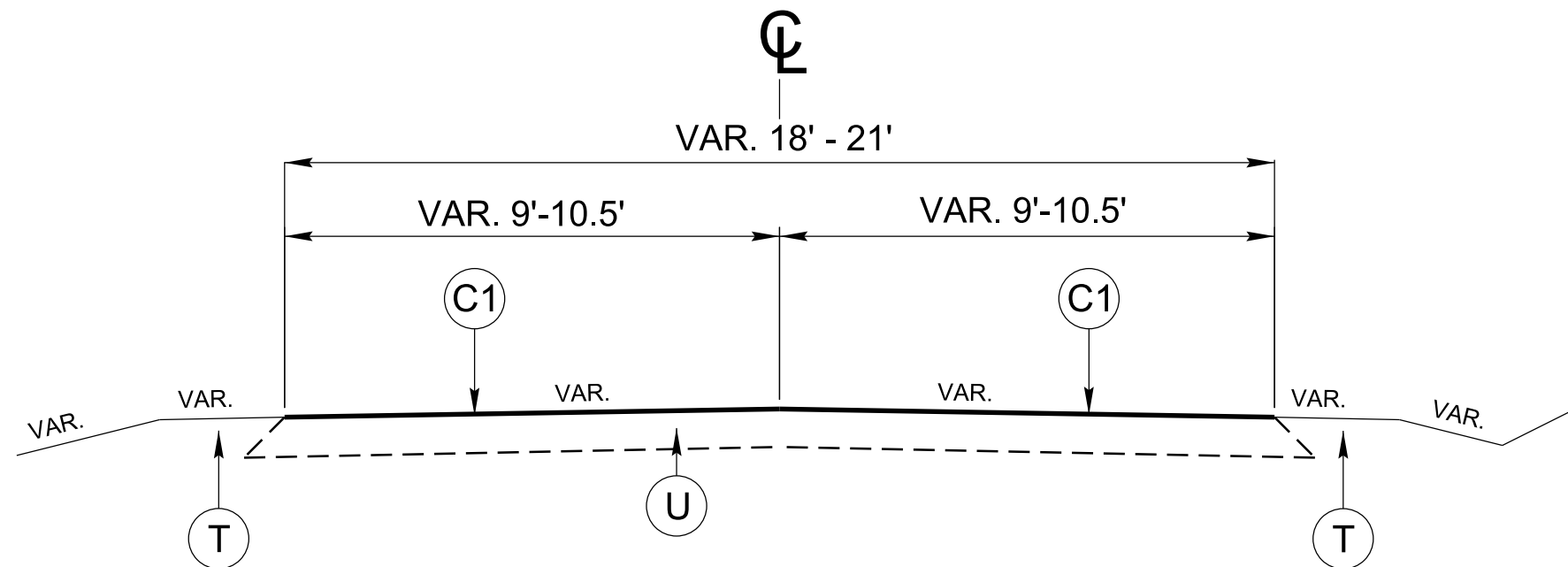

TYPICAL SECTION NO. 1

- ***MAP 1 - SR 1112 FROM NC 194 TO NC 105
*(See Typical No.2 for bridge overlay locations)
- ***MAP 2 - SR 1359 FROM US 421 TO ASHE CO LINE
*(See Typical No.2 for bridge overlay locations)
- MAP 4 - SR 1547 FROM GREENWAY RD (NS) TO SR 1541
- ***MAP 5 - SR 1549 FROM SR 1541 TO SR 1550
- MAP 6 - SR 1552 FROM SR 1541 TO US 221
- MAP 7 - SR 1571 FROM SR 1552 TO BRP

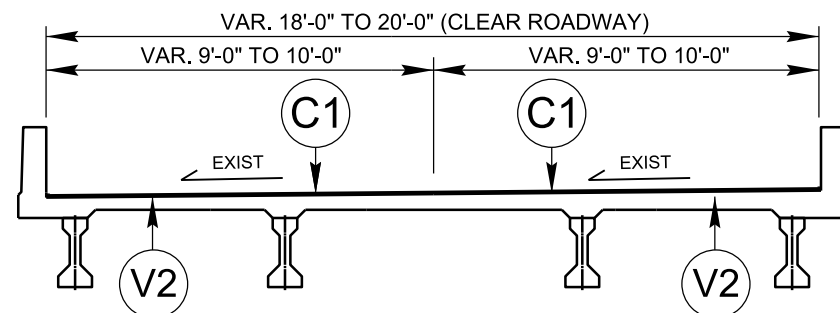

NOTE: EXISTING BRIDGE SUPERSTRUCTURES
#2 & #142

TYPICAL SECTION NO. 2

- MAP 1 - SR 1112 FROM MP 0.02 TO 0.04
- MAP 2 - SR 1359 FROM MP 2.448 TO 2.455

PAVEMENT SCHEDULE	
C1	PROP. APPROX. 1½" ASPHALT CONCRETE SURFACE COURSE, TYPE S9.5C, AN AVERAGE RATE OF 168 LBS. PER SQ. YD.
T	SHOULDER RECONSTRUCTION
U	EXISTING PAVEMENT
V1	MILLING OF EXISTING ASPHALT PAVEMENT AT DEPTH OF 1½"
V2	INCIDENTAL MILLING (See Tie in Detail)

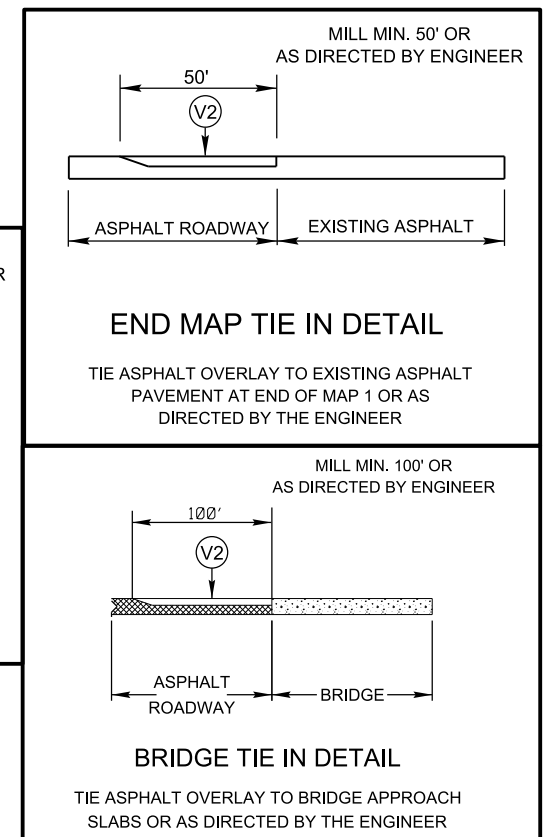
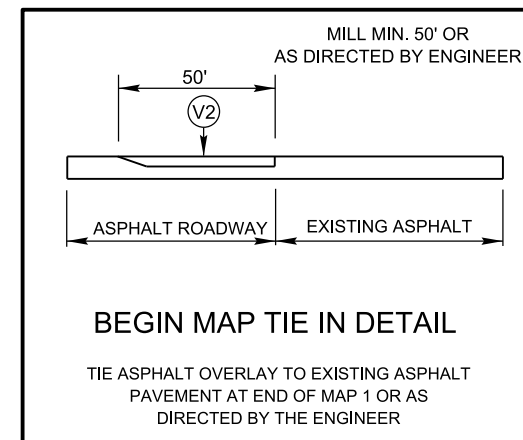

NOTE: TYPICALS ARE NOT TO SCALE

WATAUGA COUNTY
SECONDARY ROADS
2024 ASPHALT RESURFACING

REVISIONS	INIT.	DATE
N.C. DEPARTMENT of TRANSPORTATION DIVISION of HIGHWAYS DIVISION ELEVEN		



SCALE: N/A	DATE: 2/7/2024
PREPARED BY: DLH	
REVIEWED BY:	
REVIEWED BY:	

15-FEB-2024 19:37
R:\2024\Resurfacing Maps\Watauga\DK00378_Watauga-resurfacing-typicals.dgn
ASSISTANT PROJECT MANAGER

8/17/99

- "PATCHING EXISTING PAVEMENT" HAS BEEN INCLUDED AS A PAY ITEM ON MAPS. PATCHING MAY OR MAY NOT BE NEEDED DEPENDING ON CONDITION OF MAP SURFACE AT TIME THAT PAVING SEASON BEGINS. AREAS TO BE DELINIATED BY THE ENGINEER.
- INCIDENTAL MILLING AT LOCATIONS AS DIRECTED BY THE ENGINEER
- *** LEVELING AT LOCATIONS AS DIRECTED BY ENGINEER THE ENGINEER

PROJECT REFERENCE NO.	SHEET NO.
DK00378	02

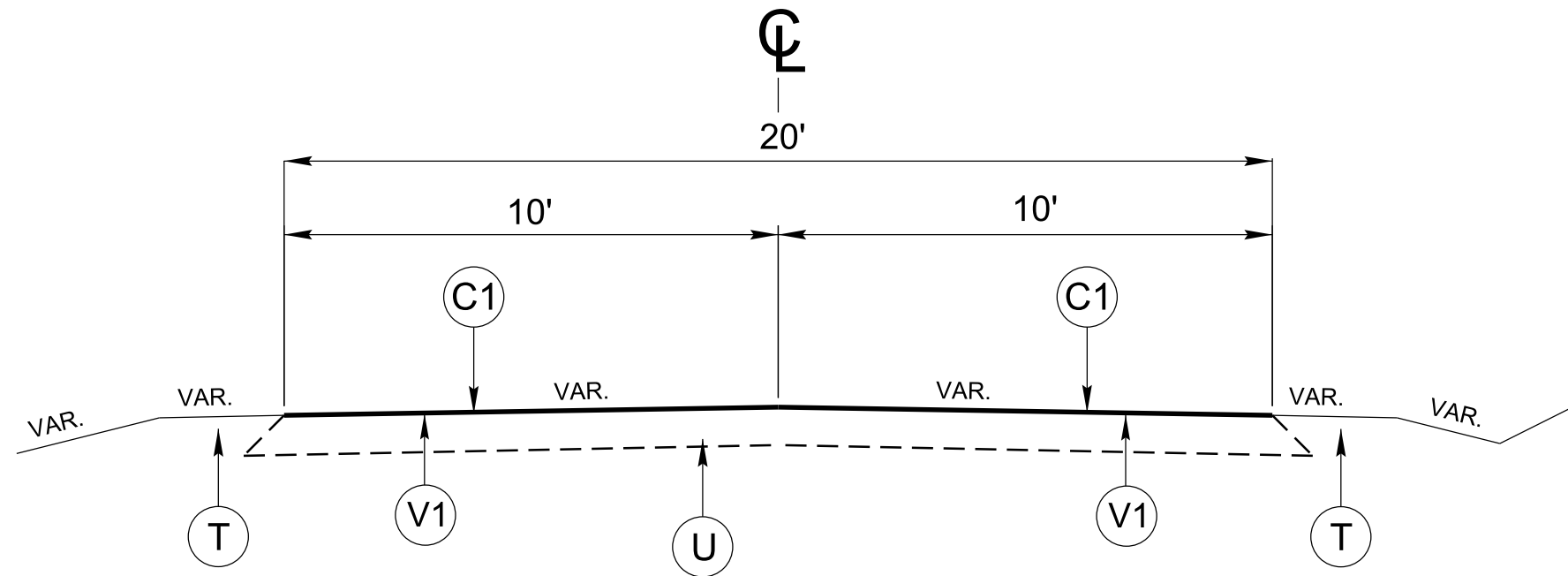

TYPICAL SECTION NO. 3

*MAP 3 - SR 1547 FROM US 221 TO GREENWAY RD (NS)
*(See Typical No.4 for bridge overlay locations)

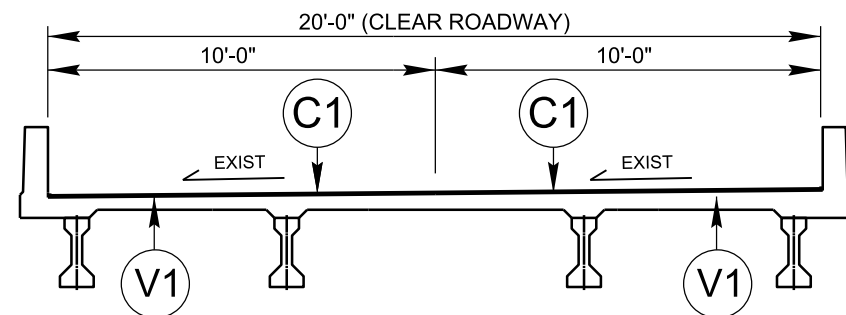

NOTE: EXISTING BRIDGE SUPERSTRUCTURES
#11 & #98

TYPICAL SECTION NO. 4

MAP 3 - SR 1547 FROM MP 0.35 TO 0.36
MAP 3 - SR 1547 FROM MP 0.199 TO 0.206

PAVEMENT SCHEDULE	
C1	PROP. APPROX. 1½" ASPHALT CONCRETE SURFACE COURSE, TYPE S9.5C, AN AVERAGE RATE OF 168 LBS. PER SQ. YD.
T	SHOULDER RECONSTRUCTION
U	EXISTING PAVEMENT
V1	MILLING OF EXISTING ASPHALT PAVEMENT AT DEPTH OF 1½"
V2	INCIDENTAL MILLING (See Tie in Detail)

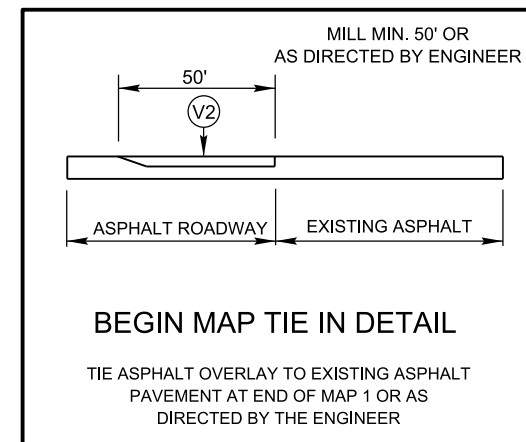

BEGIN MAP TIE IN DETAIL

TIE ASPHALT OVERLAY TO EXISTING ASPHALT PAVEMENT AT END OF MAP 1 OR AS DIRECTED BY THE ENGINEER

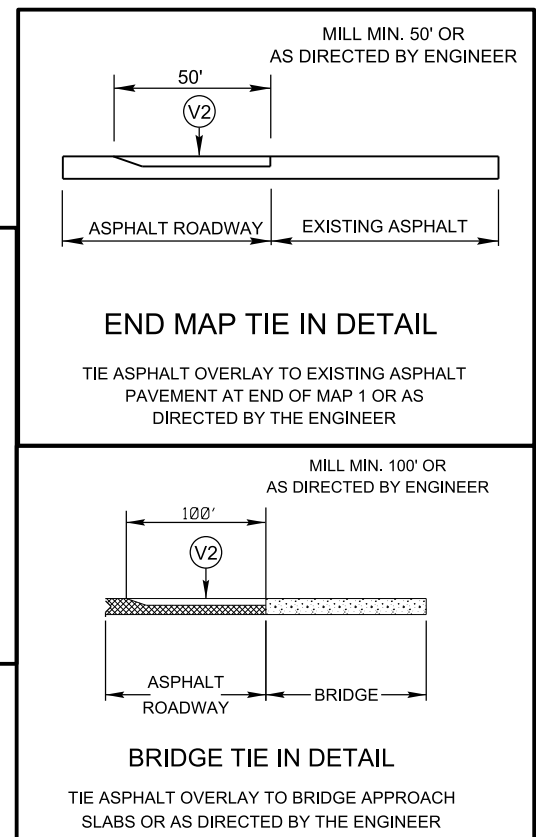

END MAP TIE IN DETAIL

TIE ASPHALT OVERLAY TO EXISTING ASPHALT PAVEMENT AT END OF MAP 1 OR AS DIRECTED BY THE ENGINEER

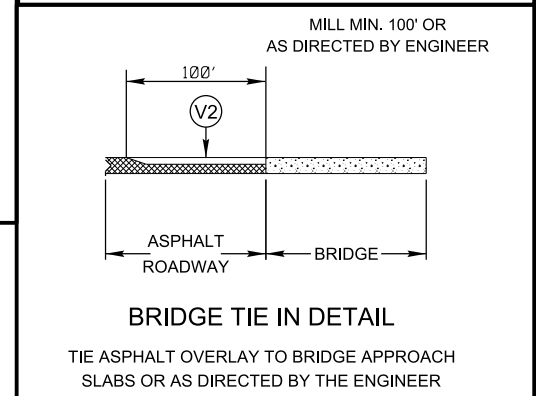

BRIDGE TIE IN DETAIL

TIE ASPHALT OVERLAY TO BRIDGE APPROACH SLABS OR AS DIRECTED BY THE ENGINEER

NOTE: TYPICALS ARE NOT TO SCALE

WATAUGA COUNTY
SECONDARY ROADS
2024 ASPHALT RESURFACING

REVISIONS	INIT.	DATE

N.C. DEPARTMENT of TRANSPORTATION
DIVISION of HIGHWAYS
DIVISION ELEVEN



SCALE: N/A DATE: 2/7/2024

PREPARED BY: DLH

REVIEWED BY:

REVIEWED BY:

WATAUGA COUNTY

TYPE OF WORK: ASPHALT RESURFACING
MAPS # 1 THROUGH # 2

2024

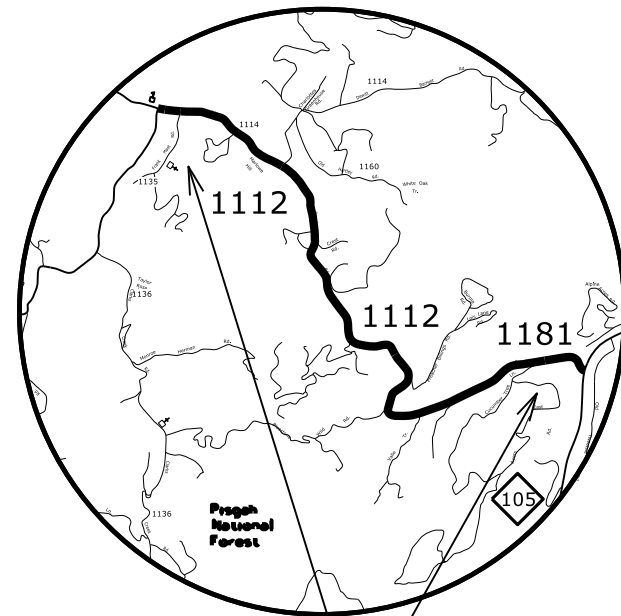
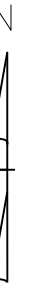

MAP #1

* SR 1112 - (2.89mi.)
(FROM NC 194 TO NC 105)

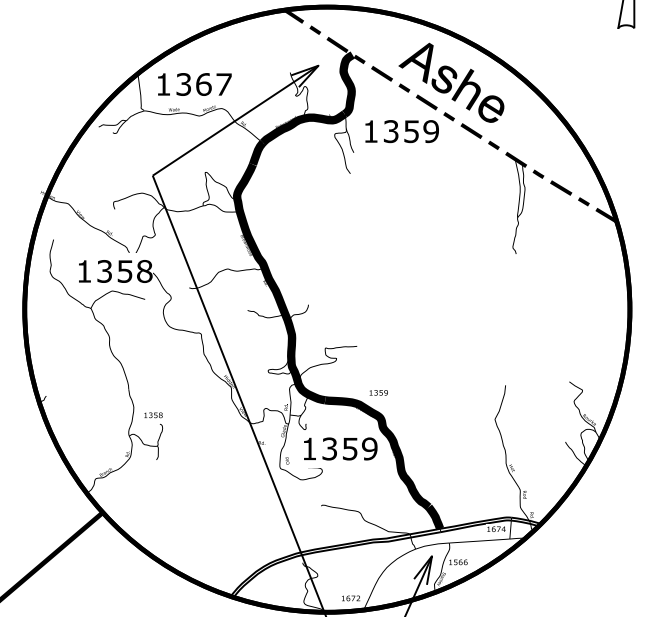
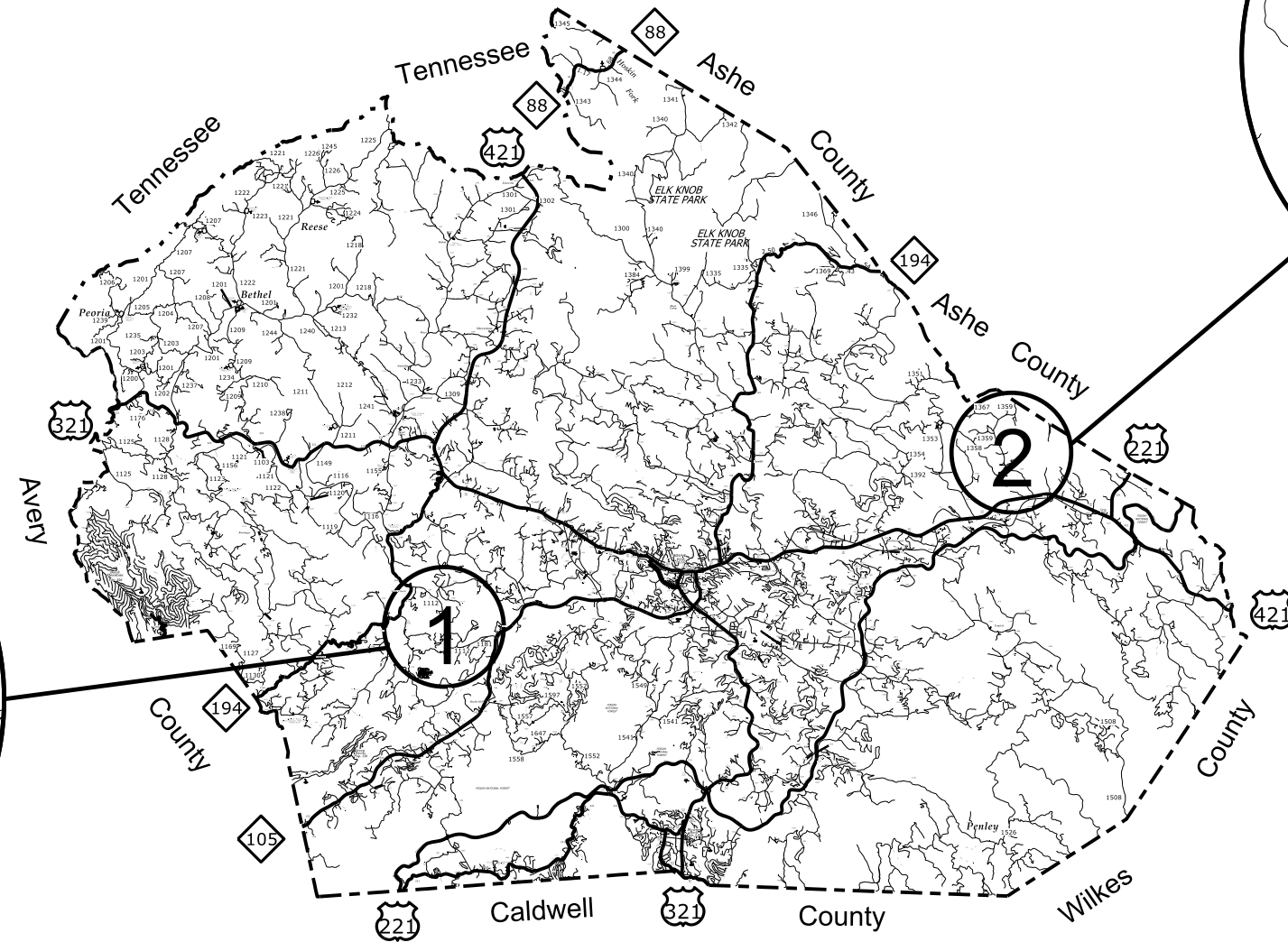

MAP #2

* SR 1359 - (2.73mi.)
(FROM US 421 TO ASHE CO LINE)

WATAUGA COUNTY

TYPE OF WORK: ASPHALT RESURFACING
MAPS # 3 THROUGH # 4

2024

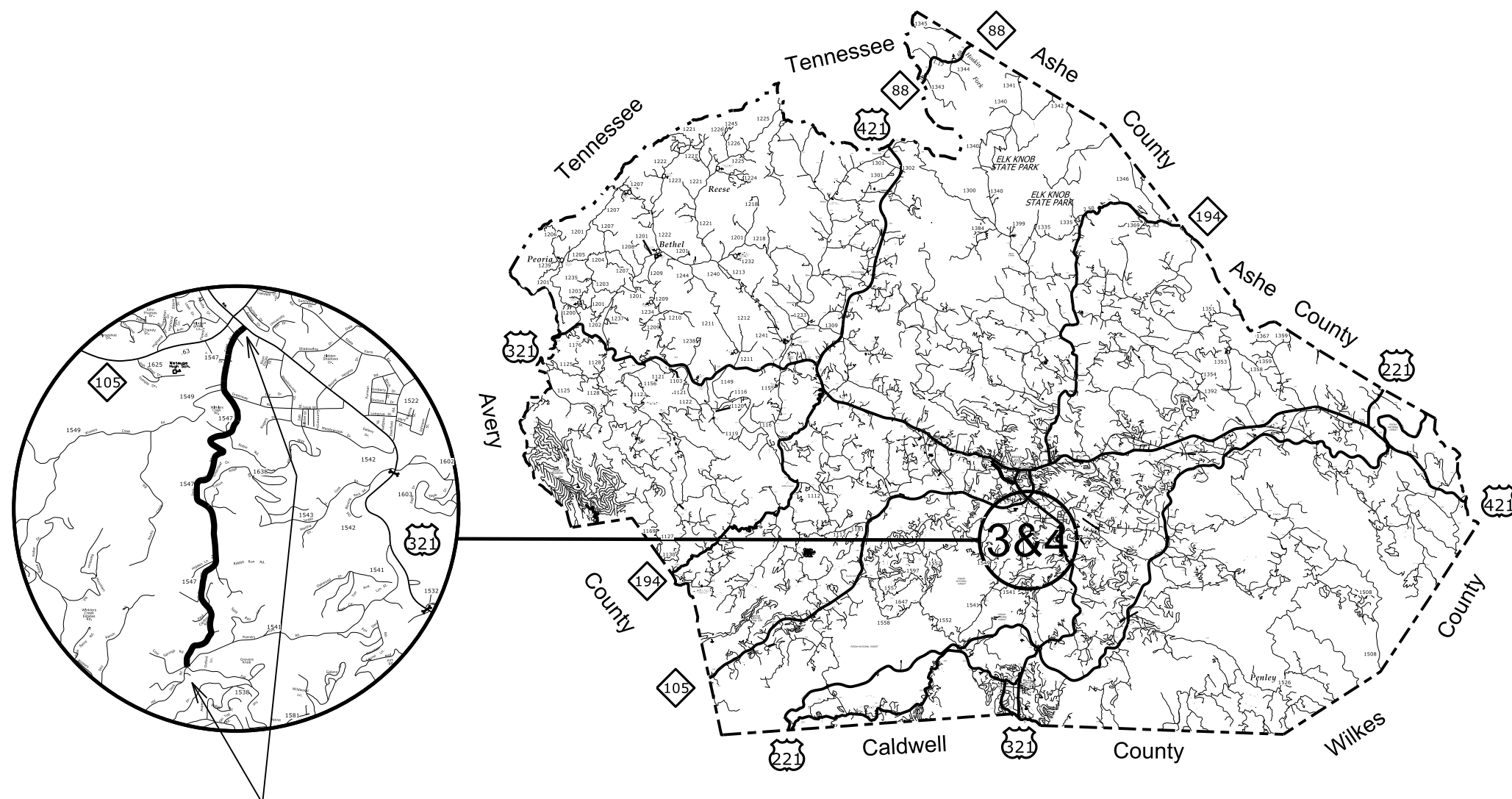

MAPS #3 - #4

* SR 1547 - (0.45mi.)
(FROM US 221 TO GREENWAY RD (NS))

* SR 1547 - (1.98mi.)
(FROM GREENWAY RD (NS) TO SR 1541)

WATAUGA COUNTY

TYPE OF WORK: ASPHALT RESURFACING
MAPS # 5 THROUGH # 7

2024

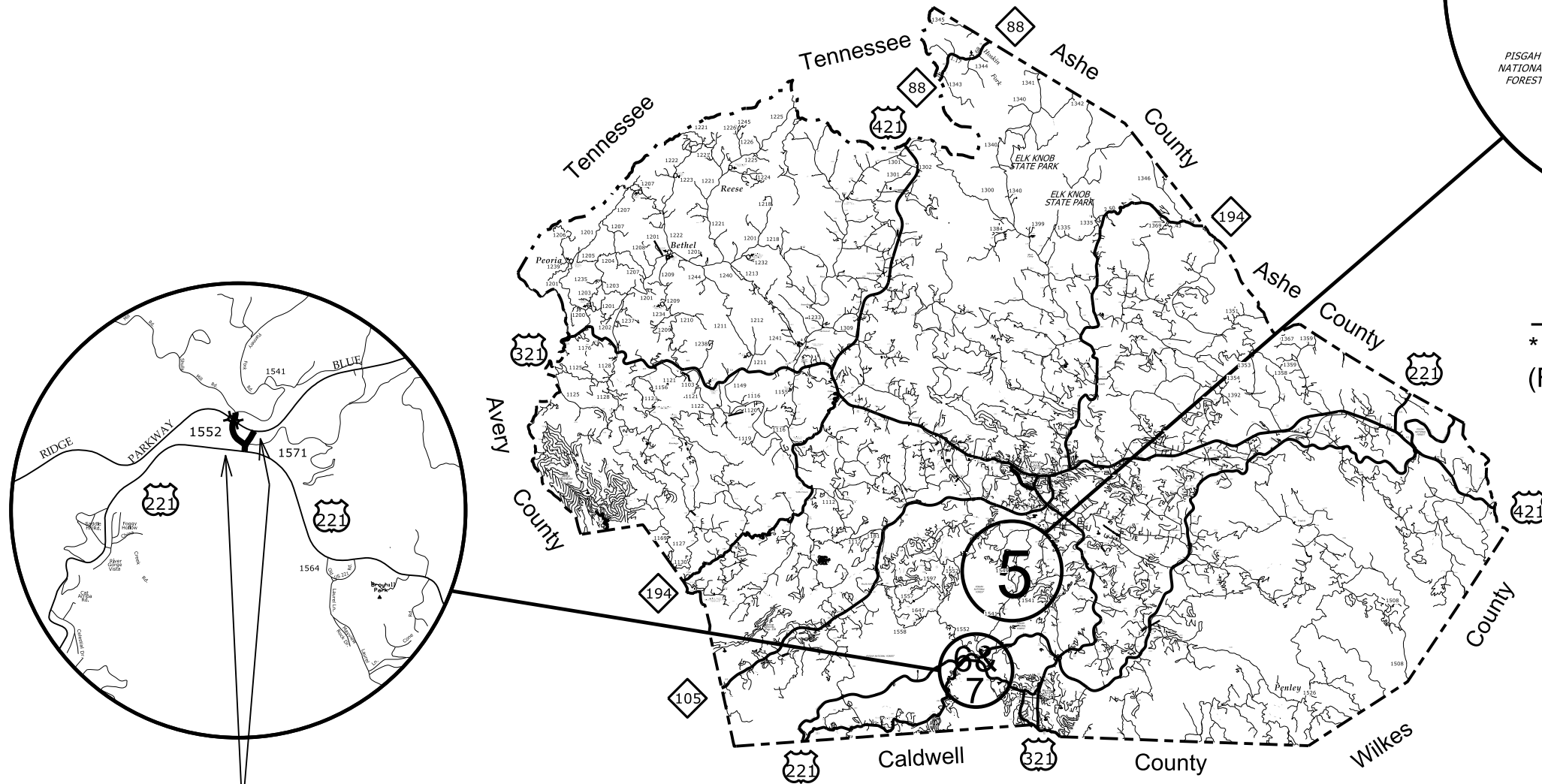
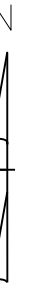

MAP #5

* SR 1549 - (1.98mi.)
(FROM SR 1541 TO SR 1550)

MAPS #6 - #7

* SR 1552 - (0.21mi.)
(FROM SR 1541 TO US 221)

* SR 1571 - (0.06mi.)
(FROM SR 1552 TO BRP)

THERMOPLASTIC AND PAINT QUANTITIES																							
												4413000000-E	4695000000-E	4720000000-E	4725000000-E						4890000000-E	4709000000-E	4905100000-N
PROJECT NO	COUNTY	MAP NO	ROUTE	DESCRIPTION	TYP NO	LANES	LANE TYPE	LENGTH	WIDTH	BEGIN MP	END MP	WORK ZONE ADVANCE/GENERAL WARNING SIGNING	THERMOPLASTIC PAVEMENT MARKING LINES (8", 90 MILS) YELLOW	THERMOPLASTIC MSG SCHOOL 90 MILS	THERMOPLASTIC LT ARROW 90 MILS	THERMOPLASTIC RT ARROW 90 MILS	THERMOPLASTIC STR ARROW 90 MILS	THERMOPLASTIC STR & RT ARROW 90 MILS	THERMOPLASTIC STR & LT ARROW 90 MILS	GENERIC MARKING ITEM HOT SPRAY THERMOPLASTIC PAVEMENT MARKING LINES (4", 55 MILS)	THERMOPLASTIC PAVEMENT MARKING LINES (24", 90 MILS) WHITE	NON-CAST IRON SNOWPLOWABLE PAVEMENT MARKER	
								MI	FT			SF	LF	EA	EA	EA	EA	EA	EA	LF	LF	EA	
2024CPT.11.06.20951	Watauga	1	SR-1112 (BROADSTONE ROAD)	FROM NC 194 TO R-2566AB END OF PROJECT LIMITS	1	2	2WU	2.89	20	0.00	2.89	136		6						62,193	70	191	
2024CPT.11.06.20951	Watauga	2	SR-1359 (BROWNWOOD ROAD)	FROM US 421 TO ASHE COUNTY LINE	1	2	2WU	2.73	18	0.00	2.73	136								58,750			
2024CPT.11.06.20951	Watauga	3	SR-1547 (WINKLERS CREEK ROAD)	FROM US 221 END OF CURB AND GUTTER SECTION	2	2	2WU	0.45	20	0.00	0.45	80	50		5	6	2	5	4	9,684	200		
2024CPT.11.06.20951	Watauga	4	SR-1547 (DECK HILL ROAD)	FROM END CURB AND GUTTER SECTION TO SR 1541	1	2	2WU	1.98	20	0.45	2.43	96								42,610			
2024CPT.11.06.20951	Watauga	5	SR-1549 (WINKLERS CREEK ROAD)	FROM SR 1541 TO SR 1550	1	2	2WU	1.98	18	0.00	1.98	96								42,610			
2024CPT.11.06.20951	Watauga	6	SR-1552 (SHULLS MILL ROAD)	FROM SR 1541 TO US 221	1	2	2WU	0.21	18	6.49	6.70	80								4,519			
2024CPT.11.06.20951	Watauga	7	SR-1571 (BLUE RIDGE PARKWAY ACCESS)	FROM SR 1552 TO BLUE RIDGE PARKWAY	1	2	2WU	0.06	21	0.00	0.06	80								1,291			
TOTAL FOR PROJ NO. 2024CPT.11.06.20951							10.3					704	50	6	5	6	2	5	4	221,657	270	191	
																	22						
GRAND TOTAL							10.3					704	50	6	5	6	2	5	4	221,657	270	191	
																	22						
GO/NC Milepost Map																							

- NOTES:
- 1) DETAIL DOES NOT APPLY TO OGAFB AND ULTRA-THIN BONDED WEARING COURSE.
 - 2) BACKFILL SHOULDER WITH APPROVED MATERIAL.
 - 3) THE SHOULDER WEDGE DEVICE MAY BE DISENGAGED AT PAVED DRIVEWAYS AND SIDE STREETS.

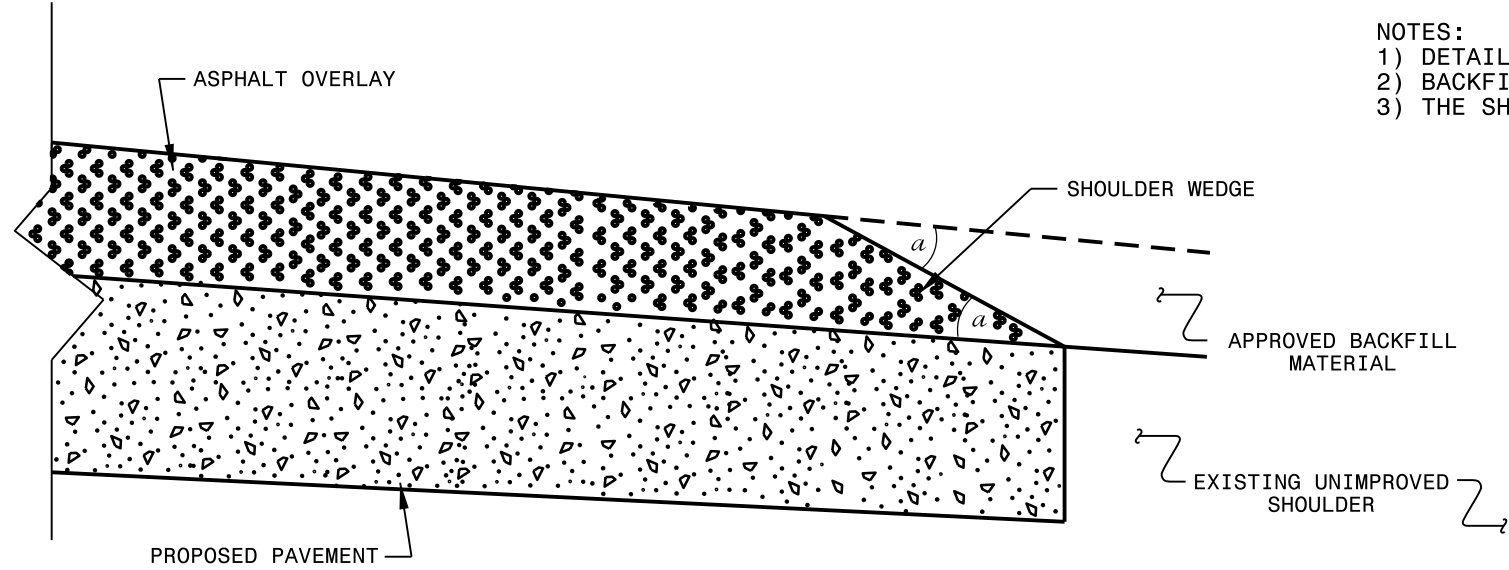

SHOULDER WEDGE DETAIL
(Resurfacing Projects w/ Widening or
with Existing Paved Shoulder having no dropoffs)

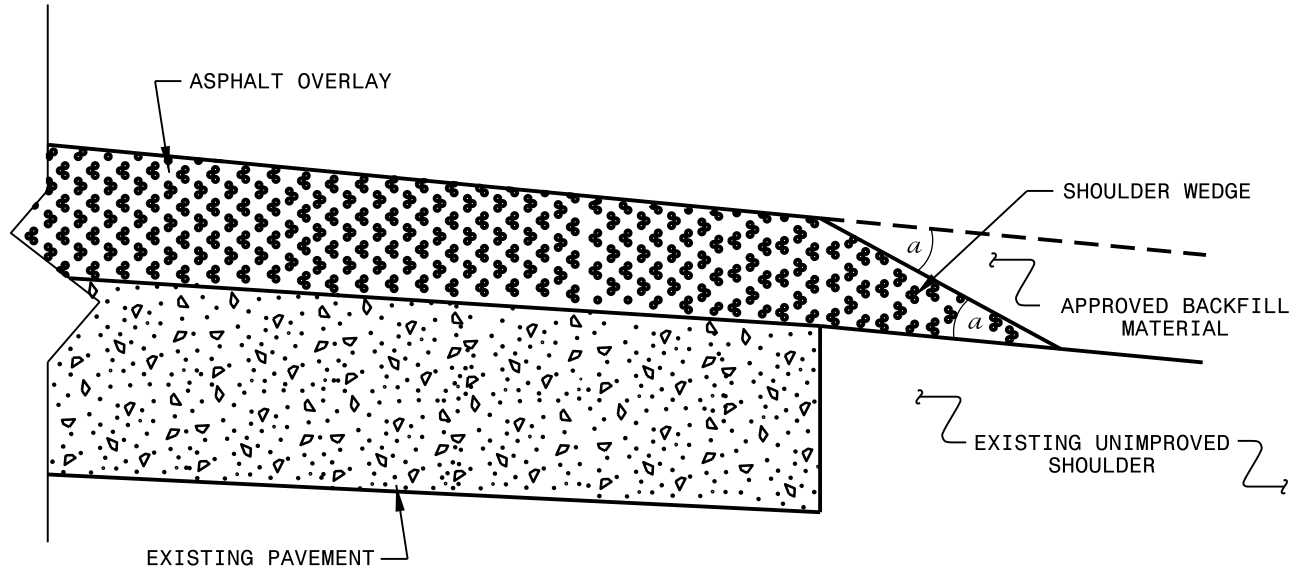

SHOULDER WEDGE DETAIL
(Resurfacing Projects w/ NO Widening)

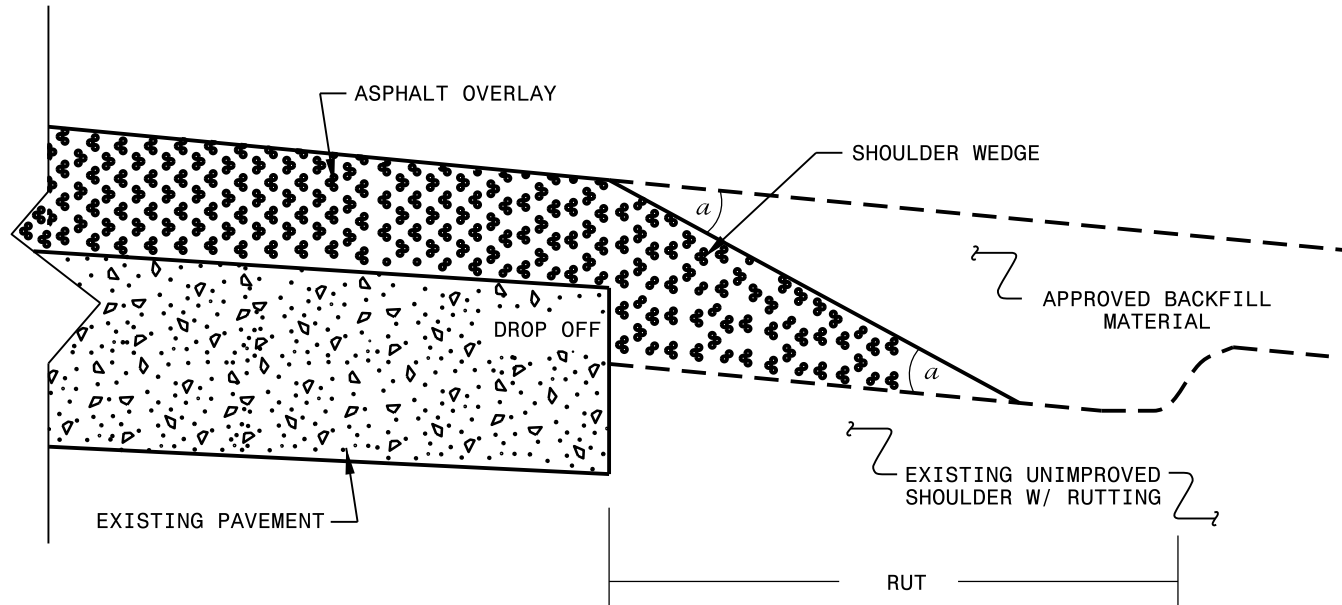

SHOULDER WEDGE DETAIL
(Resurfacing Adjacent to
Rutted Shoulder)

- SHOULDER WEDGE ANGLE = 30°

**CONTRACT STANDARDS
AND DEVELOPMENT UNIT**
Office 919-707-6950 FAX 919-250-4119

**SHOULDER WEDGE
DETAILS**

ORIGINAL BY: T.SPELL DATE: 7-19-11
MODIFIED BY: DATE: 10/16/12
CHECKED BY: DATE:
FILE SPEC.: s:\usr\details\stand\shoulderwedgedetail.dgn

SIGNING FOR RESURFACING PROJECTS

LEGEND

STATIONARY SIGN

DIRECTION OF TRAFFIC FLOW

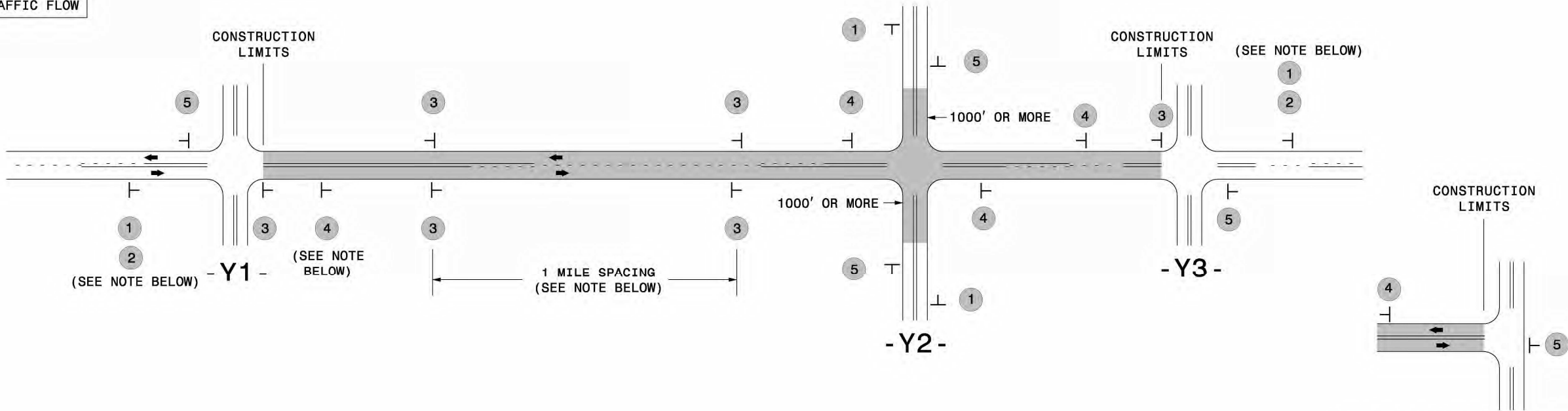

TEE INTERSECTION

MAINLINE (-L-) SIGNING

-Y- LINE SIGNING

SIGNING NOTES AND PLACEMENT PER DIRECTION	<div><div>1</div><div><div>ROAD WORK AHEAD</div><div>W20-1 48" X 48"</div><div><div>NEXT XX MILES</div><div>W7-3aP 24" X 18"</div></div></div></div> <div>PLACE 1000' PRIOR TO BEGINNING OF CONSTRUCTION LIMITS. ONLY USED ON -Y- LINES IF RESURFACING LIMITS EXTEND 1000' ALONG -Y- LINE.</div> <div>#2 SIGN ONLY USED WHEN CONSTRUCTION LIMITS ARE 2 OR MORE MILES IN LENGTH. ROUND UP TO NEXT WHOLE NUMBER.(NO FRACTIONAL OR DECIMAL NUMBERS)</div>	NO REQUIRED STATIONARY SIGNING FOR THE FOLLOWING -Y- LINE CONDITIONS: 1) LESS THAN 1000' OF RESURFACING ALONG -Y- LINE 2) SUBDIVISION ROADS 3) DEAD END ROADS WHEN PAVING/CONSTRUCTION ACTIVITIES PROCEED ACROSS AN UNSIGNED -Y- LINE, PORTABLE ADVANCE WARNING SIGNS SHALL BE USED ALONG THE -Y- LINE AS SHOWN BELOW. REMOVE UPON COMPLETION OF WORK. <div><div><div>ROAD WORK AHEAD</div><div>W20-1 48" X 48"</div></div><div>PLACED 500' IN ADVANCE OF FLAGGER.</div></div> <div><div><div><div></div><div>W20-7 A 48" X 48"</div></div><div>PLACED 250' IN ADVANCE OF FLAGGER.</div></div></div>
	<div><div>3</div><div><div>LOW/SOFT SHOULDER</div><div>SP 13107 48" X 48"</div></div></div> <div>- PLACE INITIALLY AT THE CONSTRUCTION LIMITS AND SPACE 1 MILE APART THEREAFTER. - AT TEE INTERSECTIONS INSTALL INITIALLY 1/2 MILE FROM INTERSECTION AND SPACE 1 MILE APART THEREAFTER.</div>	
	<div><div>4</div><div><div>ROAD UNDER CONST</div><div>SP 13106 48" X 48"</div></div></div> <div>- THESE ARE FOR -Y- LINES THAT ARE "THROUGH" ROADWAYS. - DEAD END AND SUBDIVISION ROADS ARE NOT "THROUGH" ROADWAYS. - INSTALL 500' +/- FROM EACH -Y- LINE APPROACH AS SHOWN ABOVE. - FOR MULTIPLE -Y- LINES THAT ARE SEPARATED BY 0.25 MILES OR LESS, TREAT AS A SINGLE UNIT AND INSTALL WITHIN 500' OF EACH APPROACH. - A MAXIMUM OF 2 SIGN SETS PER MILE. DO NOT INSTALL WHEN -Y- LINES ARE WITHIN 0.5 MILES FROM "END ROAD WORK" SIGN. - FOR TEE INTERSECTIONS, INSTALL WITHIN 500' +/- OF THE INTERSECTION ALONG -L- LINE.</div>	
	<div><div>5</div><div><div>END ROAD WORK</div><div>G20-2 A 48" X 24"</div></div></div> <div>PLACE 500' FOLLOWING THE END OF CONSTRUCTION LIMITS OR AS SHOWN WHEN WORK ENDS AT A 3-WAY TEE INTERSECTION.</div>	
	THE ABOVE SIGNS ARE ALL THAT ARE REQUIRED FOR A CONTRACTOR TO BEGIN A RESURFACING CONTRACT. ANY ADDITIONAL SIGNS REQUESTED BY NCDOT DIVISIONS SHALL BE INSTALLED WITHIN 7 BUSINESS DAYS OF THE START OF CONTRACT WORK.	
LESS 2 MILES	FOR RESURFACING MAPS WITH CONSTRUCTION LIMITS LESS THAN 2 MILES IN LENGTH, NO STATIONARY SIGNS ARE REQUIRED. USE PORTABLE "ROAD UNDER CONSTRUCTION" OR "ROAD WORK AHEAD" SIGNS IN LIEU OF STATIONARY ADVANCE WARNINGS SIGNS.	

DIVISION OF HIGHWAYS
STATE OF NORTH CAROLINA
DEPARTMENT OF TRANSPORTATION
WORK ZONE TRAFFIC CONTROL



ADVANCE WARNING SIGNS FOR RURAL AND SUBURBAN 2-LANE ROADWAY RESURFACING

GENERAL NOTES:

1. USE RAPID SET DYED CONCRETE WITH A MINIMUM COMPRESSIVE STRENGTH OF 4000 PSI.
2. REMOVE ALL FAULTY EXISTING BRICKWORK AND REPLACE WITH NEW BRICK MASONRY.
3. SHEER CUT RECTANGULAR EXCAVATION FOR THE ADJUSTMENT ON ALL SIDES. NO OVERSAW CUTS ALLOWED IN CORNERS.
4. FILL AREA BELOW 8" DEPTH WITH 78M OR NO. 57 CLEAN STONE.
5. MIX MORTAR TO NCDOT SPECIFICATIONS.
6. MORTAR JOINTS 1/2" +/- 1/8"

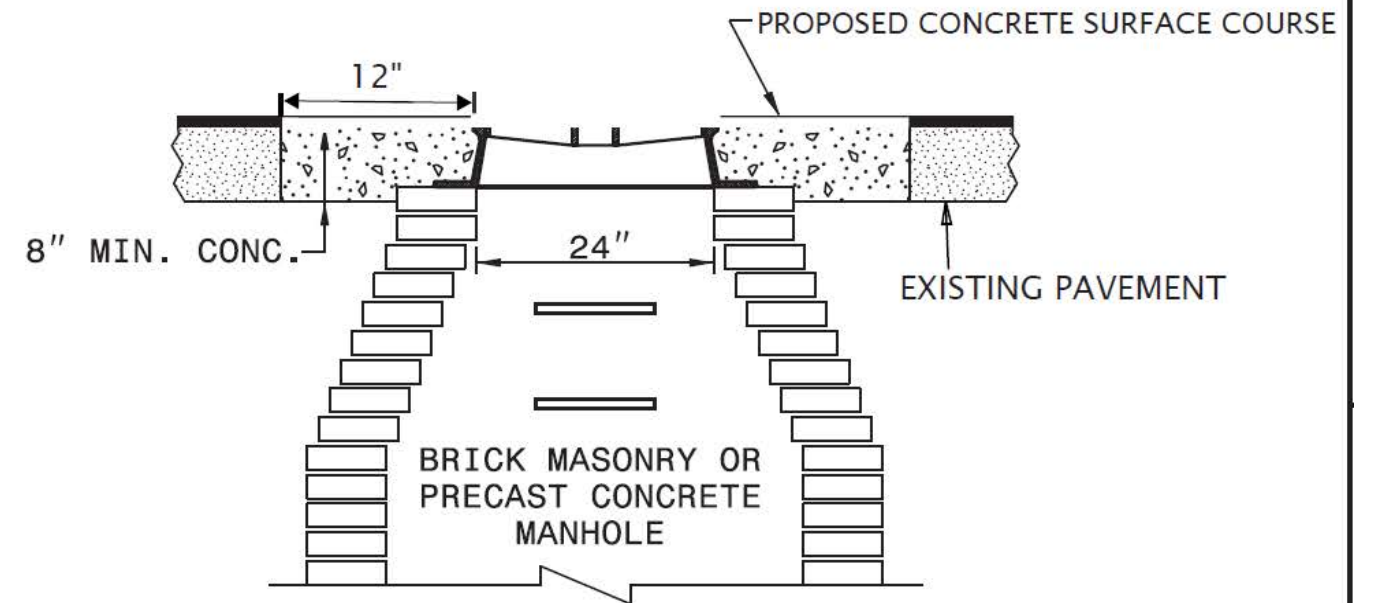

MANHOLE CONCRETE ENCASEMENT

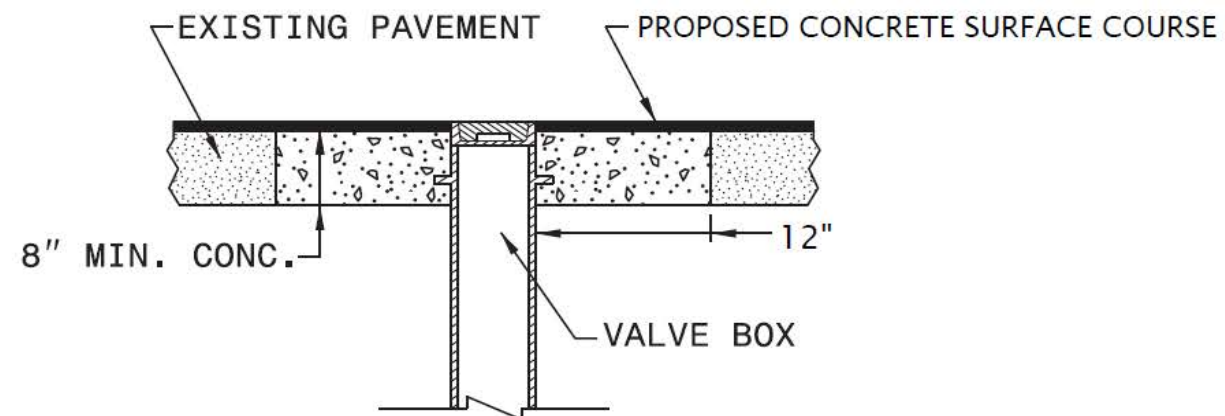

VALVE BOX CONCRETE ENCASEMENT

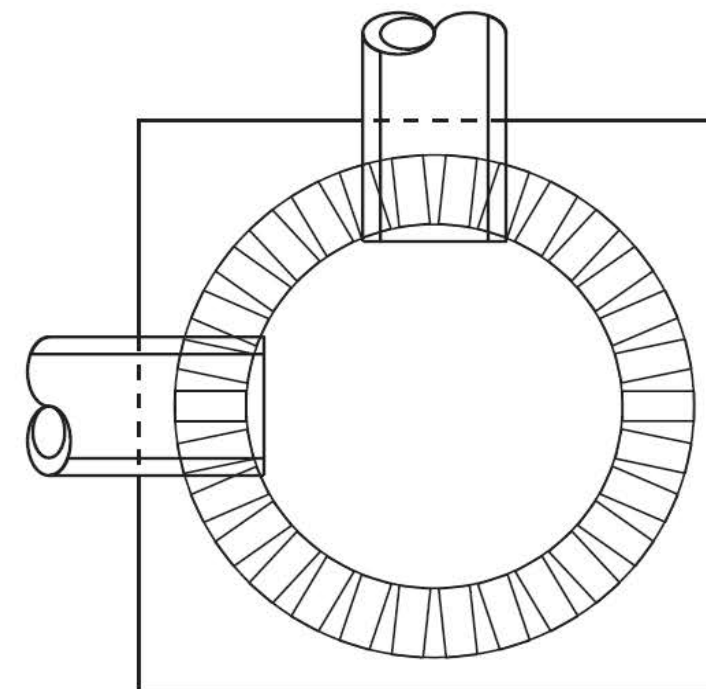

ELEVATION VIEW

PLACE BRICK ACCORDING TO ELEVATION VIEW

REVISIONS

8/17/99

24-JAN-2016 13:31
C:\Users\jokimel\OneDrive\Documents\DETAIL PSHS\Microstation Files\MH_Valve_Adjust_2015.dgn
\$\$\$\$\$USERNAME\$\$\$\$\$