

PROJECT NO.	SHEET NO.	TOTAL NO.
11CR.20061.19, 11CR.20141.19		

SUMMARY OF QUANTITIES

PROJECT	COUNTY	MAP	ROUTE	DESCRIPTION	TYP	FINAL SURFACE TESTING REQUIRED	LENGTH	WIDTH	ASPHALT SURFACE TREATMENT, MAT & SEAL	ASPHALT SURFACE TREATMENT, SPLIT SEAL	ASPHALT SURFACE TREATMENT, TRIPLE SEAL	ASPHALT SURFACE TREATMENT, TRIPLE SEAL (LIGHTWEIGHT AGGREGATE)	
NO		NO			NO		MI	FT	SY	SY	SY	SY	
11CR.20061.19	Avery	38	SR 1129	FROM SR 1126 TO MITCHELL CO. LINE	2	NO	0.1	16			939		
11CR.20061.19	Avery	39	SR 1134	FROM SR 1132 TO EOM	2	NO	0.82	16			7,697		
11CR.20061.19	Avery	40	SR 1128	FROM SR 1126 TO EOP	2	NO	0.31	16			2,910		
11CR.20061.19	Avery	41	SR 1126	FROM US 19E TO SR 1127	2	NO	0.87	18			9,187		
11CR.20061.19	Avery	42	SR 1126	FROM SR 1127 TO BRIDGE	2	NO	1.24	18			13,094		
11CR.20061.19	Avery	43	SR 1126	FROM BRIDGE TO EOM	2	NO	0.87	18			9,187		
11CR.20061.19	Avery	44	SR 1117	FROM SR 1114 TO EOP	2	NO	1.32	16			12,390		
11CR.20061.19	Avery	45	SR 1180	FROM SR 1159 TO EOM	2	NO	0.25	16			2,347		
11CR.20061.19	Avery	46	SR 1176	FROM SR 1114 TO EOM	2	NO	0.2	16			1,877		
11CR.20061.19	Avery	47	SR 1155	FROM SR 1117 TO EOP	2	NO	0.3	16			2,816		
11CR.20061.19	Avery	48	SR 1116	FROM SR 1114 TO EOM	2	NO	0.5	16			4,693		
11CR.20061.19	Avery	49	SR 1324	FROM SR 1321 TO EOM	2	NO	1.1	16			10,325		
11CR.20061.19	Avery	50	SR 1325	FROM NC 194 TO EOM	2	NO	0.61	16			5,726		
TOTAL FOR PROJ NO. 11CR.20061.19							8.49				83,188		
11CR.20141.19	Caldwell	51	SR 1511	FROM SR 1551 TO PAVEMENT CHANGE	4	NO	2.5	18				26,400	
11CR.20141.19	Caldwell	52	SR 1748	FROM SR 1751 TO SR 1718	4	NO	0.8	20				9,387	
11CR.20141.19	Caldwell	53	SR 1513	FROM BEGIN PAVEMENT TO SR 1604	4	NO	0.84	20				9,856	
11CR.20141.19	Caldwell	54	SR 1339	FROM SR 1143 TO SR 1310	4	NO	1.37	21				16,878	
11CR.20141.19	Caldwell	55	SR 1372	FROM US 321 TO BRIDGE	4	NO	2.28	20				26,752	
11CR.20141.19	Caldwell	56	SR 1844	FROM SR 1718 TO EOM	4	NO	0.19	20				2,229	
11CR.20141.19	Caldwell	57	SR 1399	FROM SR 1301 TO EOM	4	NO	0.1	16				939	
11CR.20141.19	Caldwell	58	SR 1376	FROM SR 1328 TO EOM	4	NO	0.4	18				4,224	
11CR.20141.19	Caldwell	59	SR 1513	FROM SR 1604 TO US 321	4	NO	0.78	18				8,237	
11CR.20141.19	Caldwell	60	SR 1811	FROM US 64 TO EOM	4	NO	0.22	18				2,323	
11CR.20141.19	Caldwell	61	SR 1789	FROM US 64 TO EOM	4	NO	0.35	18				3,696	
11CR.20141.19	Caldwell	62	SR 1851	FROM SR 1789 TO EOM	4	NO	0.33	18				3,485	
TOTAL FOR PROJ NO. 11CR.20141.19							10.16					114,406	
GRAND TOTAL								18.65				83,188	114,406

PROJECT NO.	SHEET NO.	TOTAL NO.
11CR.20061.19, 11CR.20141.19		

THERMOPLASTIC AND PAINT QUANTITIES

PROJECT	COUNTY	MAP	ROUTE	DESCRIPTION	LENGTH	WIDTH	4810000000-E				
							4" WHITE PAINT	4" YELLOW PAINT	24" WHITE PAINT	PAINT MSG SCHOOL EA	
NO		NO					LF	LF	LF	EA	SNOW PLOWABLE MARKERS EA
11CR.20061.19	Avery	38	SR 1129	FROM SR 1126 TO MITCHELL CO. LINE	0.1	16	2,112	2,112			
11CR.20061.19	Avery	39	SR 1134	FROM SR 1132 TO EOM	0.82	16	17,318	17,318			
11CR.20061.19	Avery	40	SR 1128	FROM SR 1126 TO EOP	0.31	16	6,547	6,547			
11CR.20061.19	Avery	41	SR 1126	FROM US 19E TO SR 1127	0.87	18	18,374	18,374			
11CR.20061.19	Avery	42	SR 1126	FROM SR 1127 TO BRIDGE	1.24	18	26,189	26,189			
11CR.20061.19	Avery	43	SR 1126	FROM BRIDGE TO EOM	0.87	18	18,374	18,374			
11CR.20061.19	Avery	44	SR 1117	FROM SR 1114 TO EOP	1.32	16	27,878	27,878			
11CR.20061.19	Avery	45	SR 1180	FROM SR 1159 TO EOM	0.25	16					
11CR.20061.19	Avery	46	SR 1176	FROM SR 1114 TO EOM	0.2	16					
11CR.20061.19	Avery	47	SR 1155	FROM SR 1117 TO EOP	0.3	16					
11CR.20061.19	Avery	48	SR 1116	FROM SR 1114 TO EOM	0.5	16					
11CR.20061.19	Avery	49	SR 1324	FROM SR 1321 TO EOM	1.1	16	23,232	23,232			
11CR.20061.19	Avery	50	SR 1325	FROM NC 194 TO EOM	0.61	16					
TOTAL FOR PROJ NO. 11CR.20061.19							140,024	140,024			
							280,048				
11CR.20141.19	Caldwell	51	SR 1511	FROM SR 1551 TO PAVEMENT CHANGE	2.5	18	52,800	52,800			
11CR.20141.19	Caldwell	52	SR 1748	FROM SR 1751 TO SR 1718	0.8	20	16,896	16,896			
11CR.20141.19	Caldwell	53	SR 1513	FROM BEGIN PAVEMENT TO SR 1604	0.84	20	17,741	17,741			
11CR.20141.19	Caldwell	54	SR 1339	FROM SR 1143 TO SR 1310	1.37	21	28,934	28,934			
11CR.20141.19	Caldwell	55	SR 1372	FROM US 321 TO BRIDGE	2.28	20	48,154	48,154			
11CR.20141.19	Caldwell	56	SR 1844	FROM SR 1718 TO EOM	0.19	20					
11CR.20141.19	Caldwell	57	SR 1399	FROM SR 1301 TO EOM	0.1	16					
11CR.20141.19	Caldwell	58	SR 1376	FROM SR 1328 TO EOM	0.4	18					
11CR.20141.19	Caldwell	59	SR 1513	FROM SR 1604 TO US 321	0.78	18	16,474	16,474			
11CR.20141.19	Caldwell	60	SR 1811	FROM US 64 TO EOM	0.22	18					
11CR.20141.19	Caldwell	61	SR 1789	FROM US 64 TO EOM	0.35	18					
11CR.20141.19	Caldwell	62	SR 1851	FROM SR 1789 TO EOM	0.33	18					
TOTAL FOR PROJ NO. 11CR.20141.19							180,999	180,999			
							361,998				
GRAND TOTAL							18.65	321,023	321,023		
							642,046				

STATE OF NORTH CAROLINA
 DIVISION OF HIGHWAYS
AVERY COUNTY
 ASPHALT SURFACE TREATMENT

MAP #38 SR 1129
 FROM SR 1126 TO
 MITCHELL CO LINE

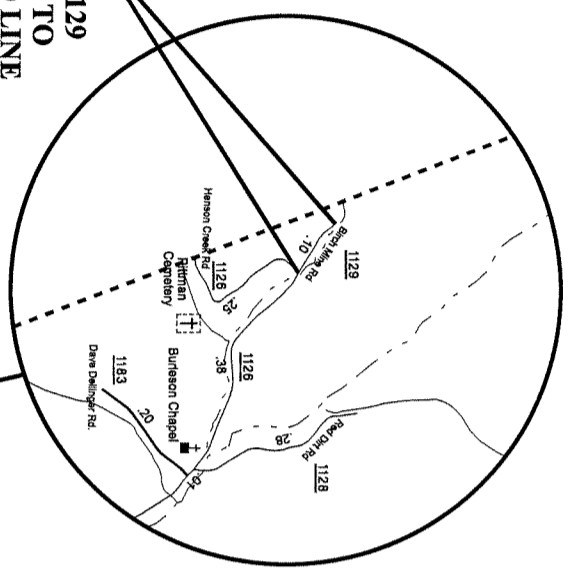

MAP #40 SR 1128
 FROM SR 1126
 TO E.O.P.

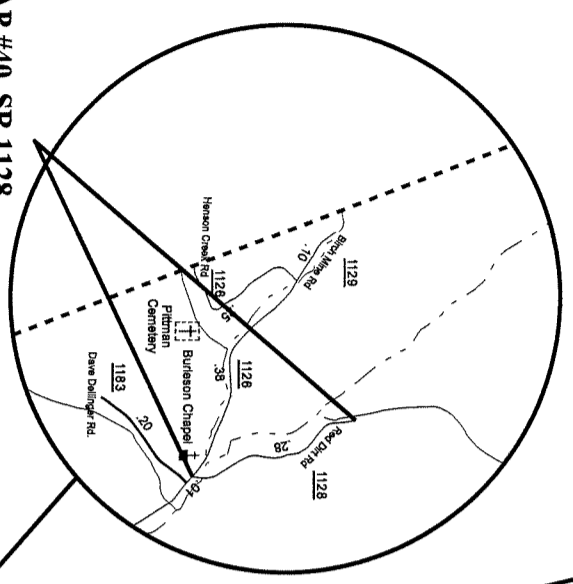

MAP #42 SR 1126
 FROM SR 1127
 TO BRIDGE

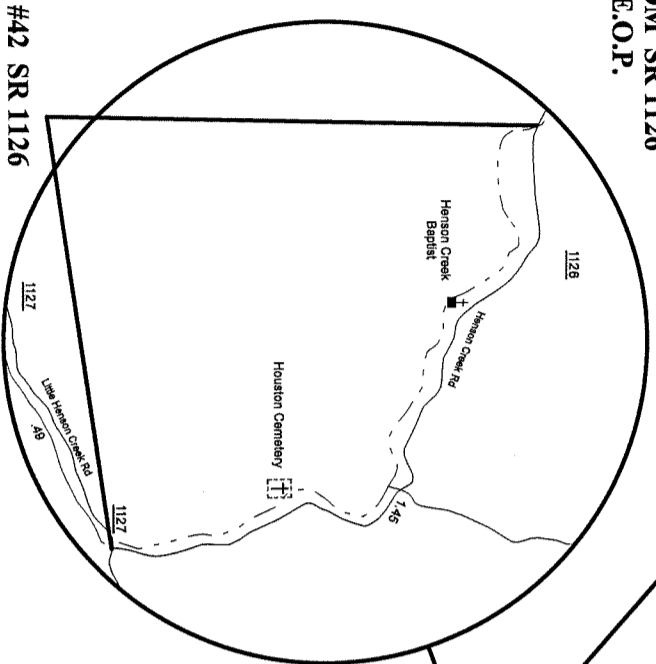

MAP #39 SR 1134
 FROM SR 1132 TO
 END MAINTENANCE

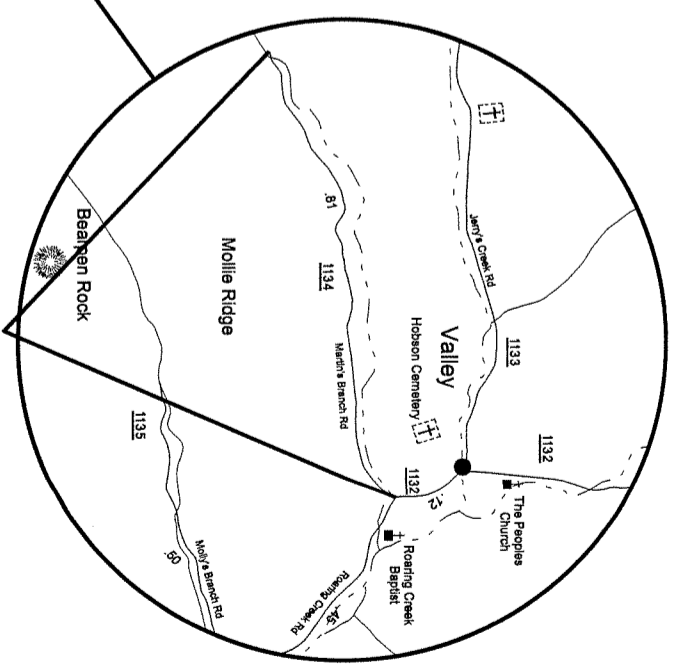

MAP #43 SR 1126
 FROM BRIDGE TO
 END MAINTENANCE

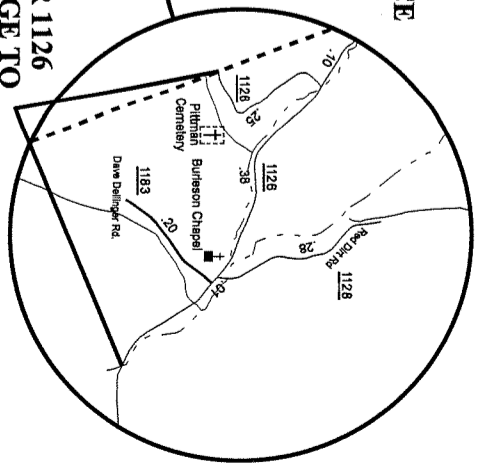

MAP #41 SR 1126
 FROM US 19E
 TO SR 1127

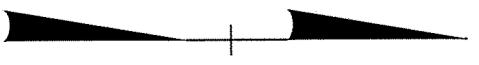
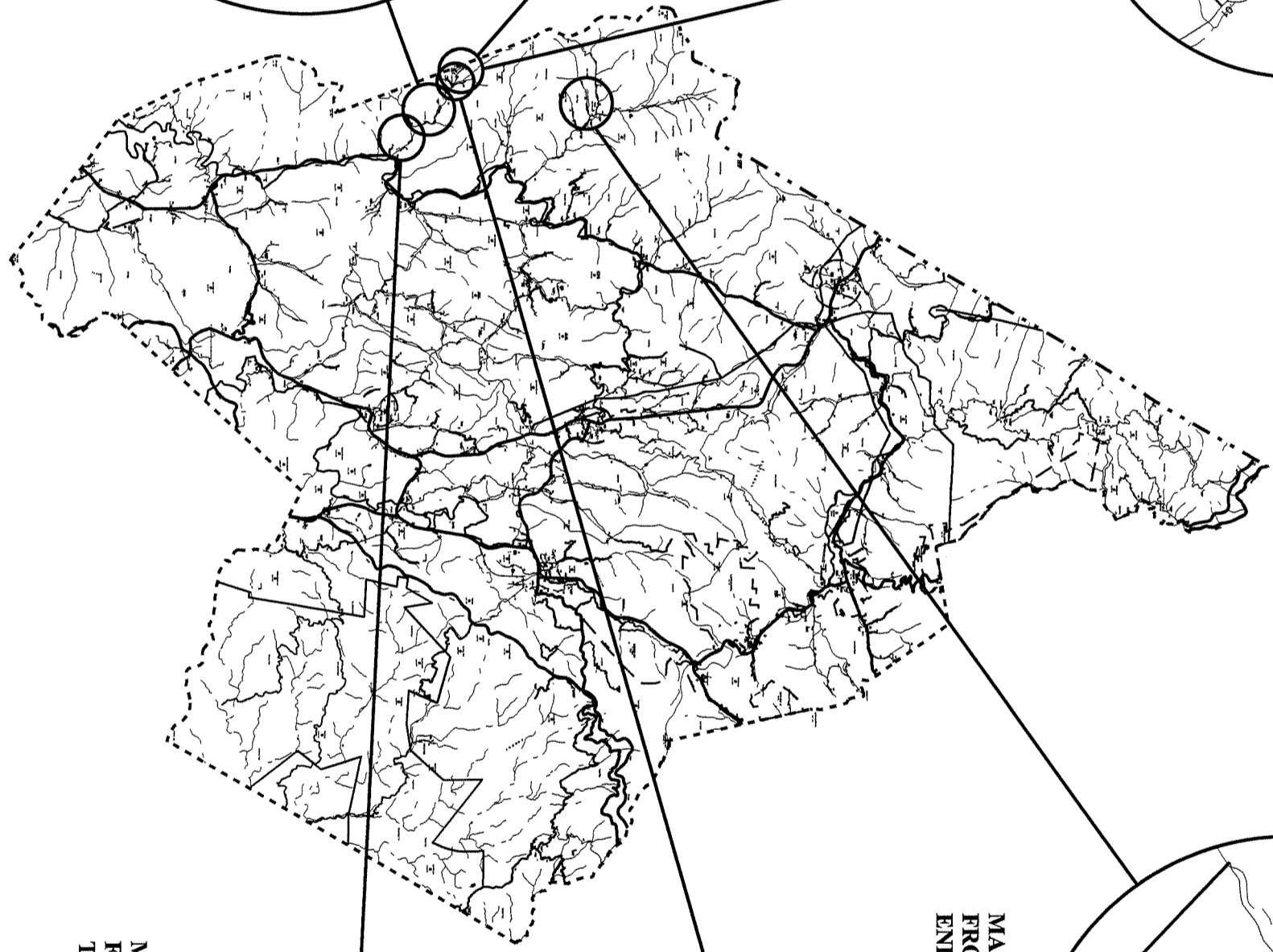
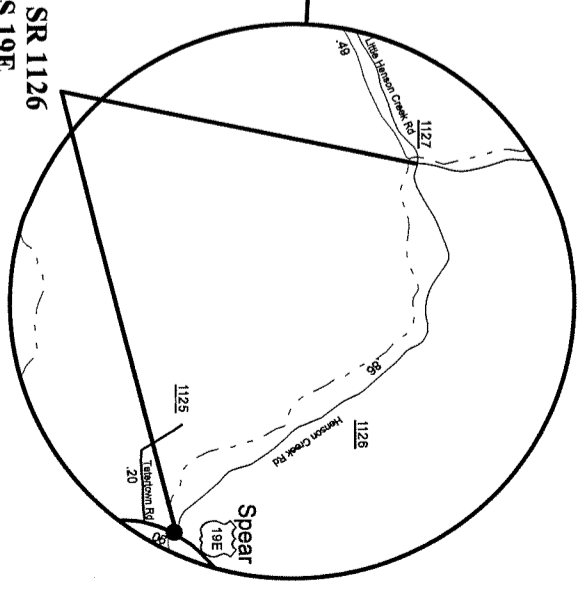

MAP #46 SR 1176
FROM SR 1114 TO
END MAINTENANCE

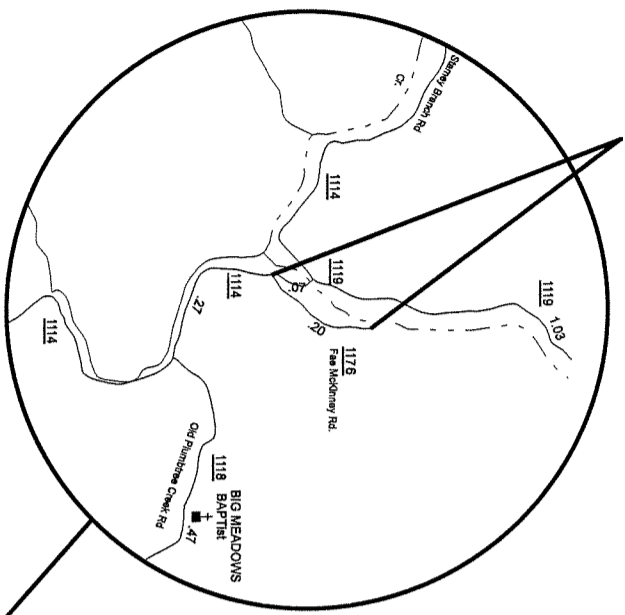

MAP #45 SR 1180
FROM SR 1159 TO
END MAINTENANCE

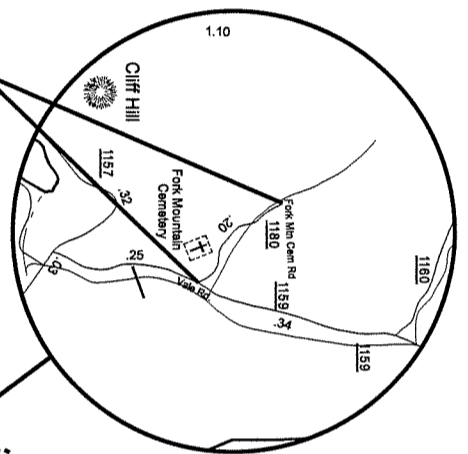

STATE OF NORTH CAROLINA
DIVISION OF HIGHWAYS
AVERY COUNTY
ASPHALT SURFACE TREATMENT

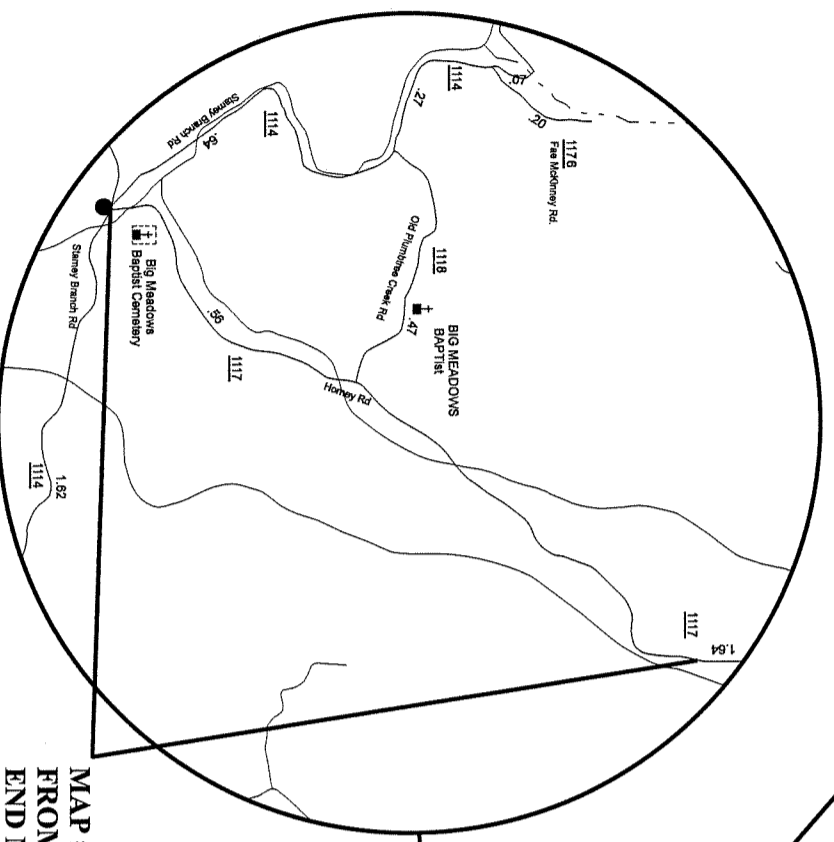

MAP #44 SR 1117
FROM SR 1114 TO
END MAINTENANCE

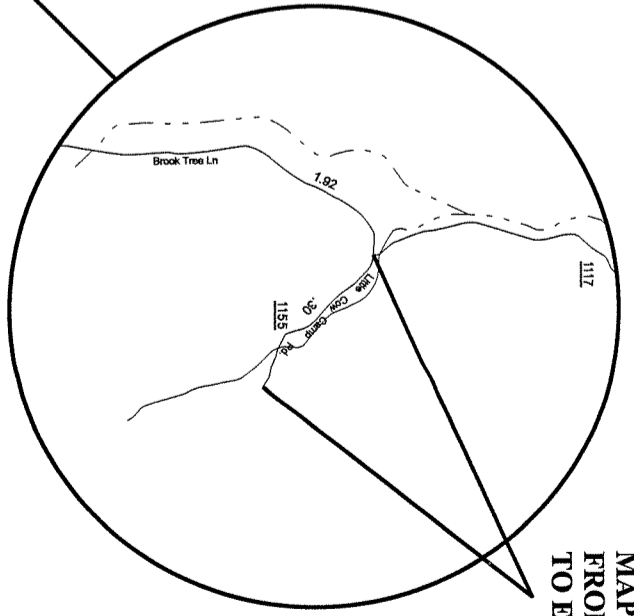

MAP #47 SR 1155
FROM SR 1117
TO E.O.P.

MAP #48 SR 1116
FROM SR 1114 TO
END MAINTENANCE

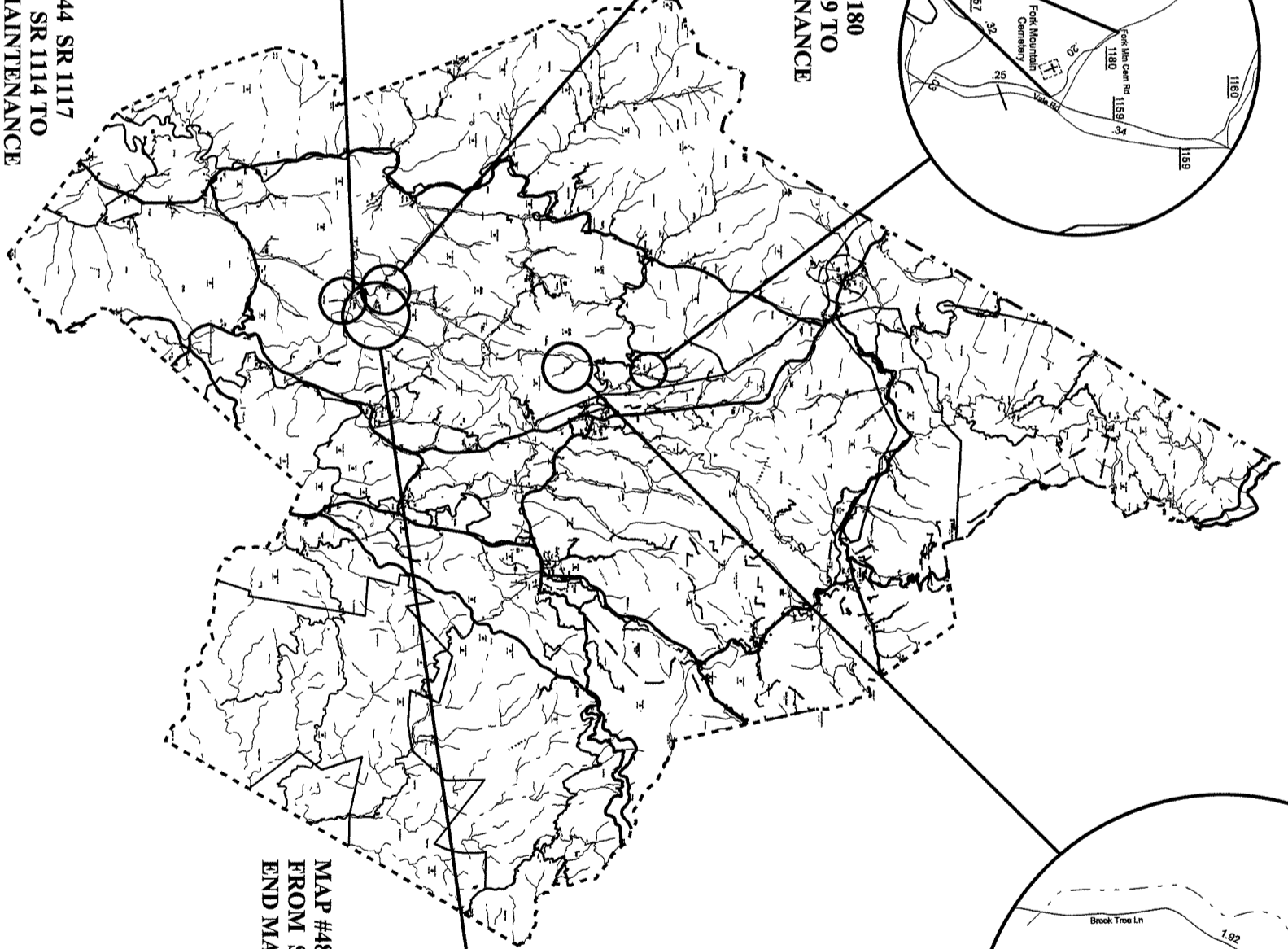
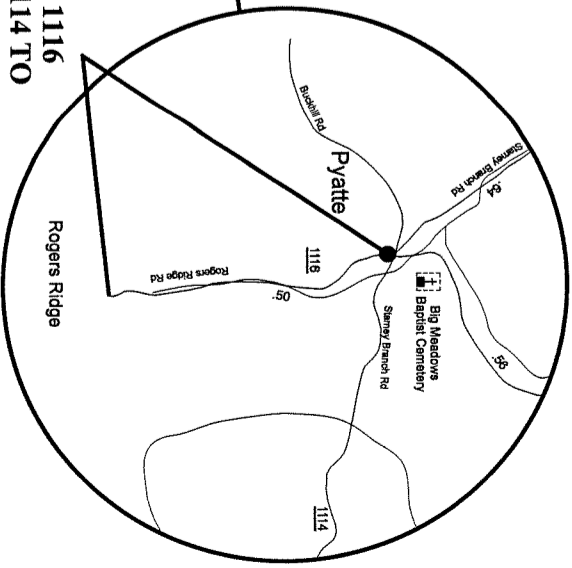

STATE OF NORTH CAROLINA
DIVISION OF HIGHWAYS

AVERY COUNTY

ASPHALT SURFACE TREATMENT

MAP #49 SR 1324
FROM SR 1321 TO
END MAINTENANCE

MAP #50 SR 1325
FROM NC 194 TO
END MAINTENANCE

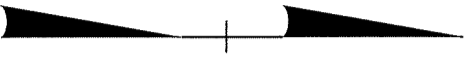
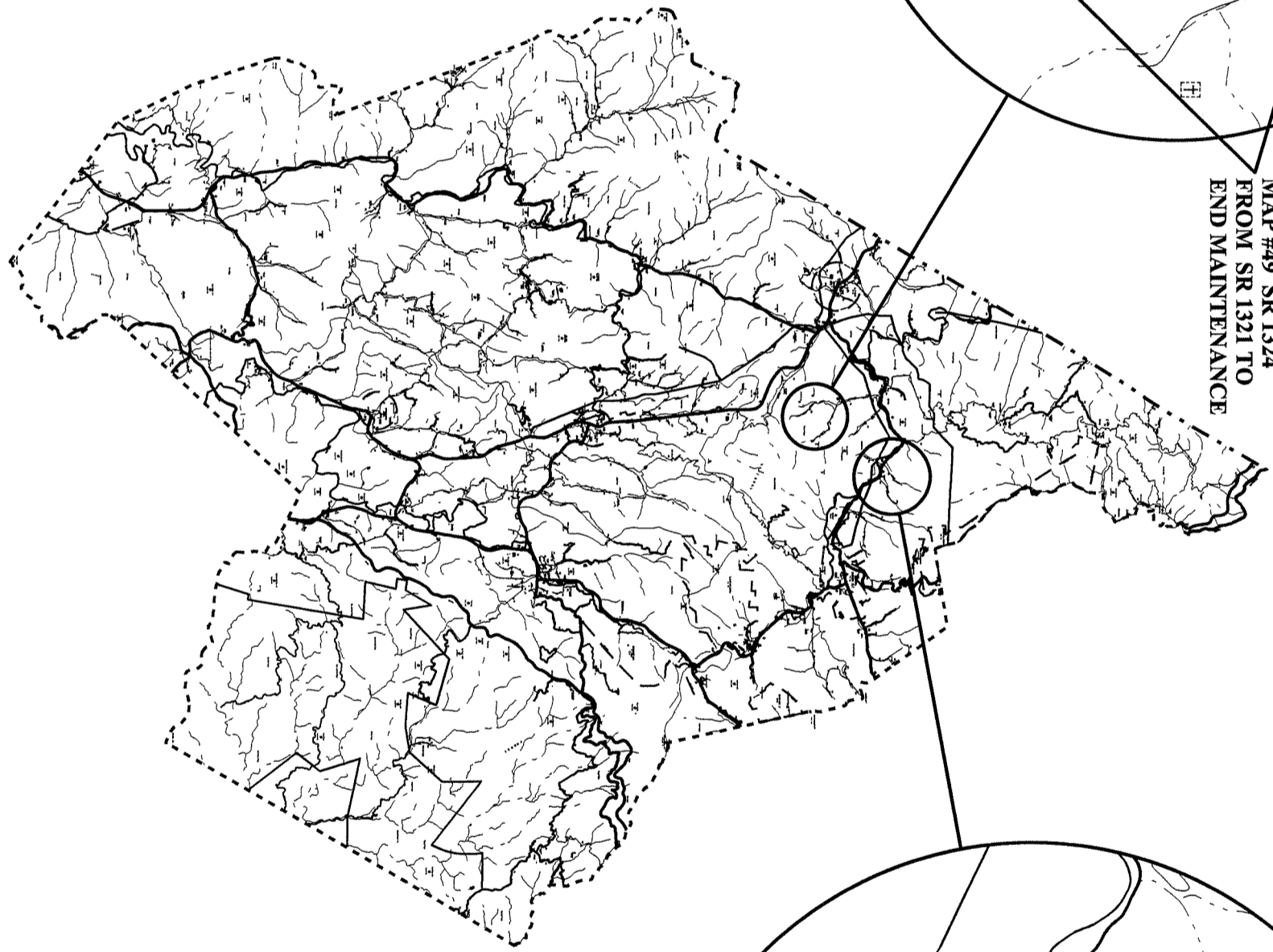
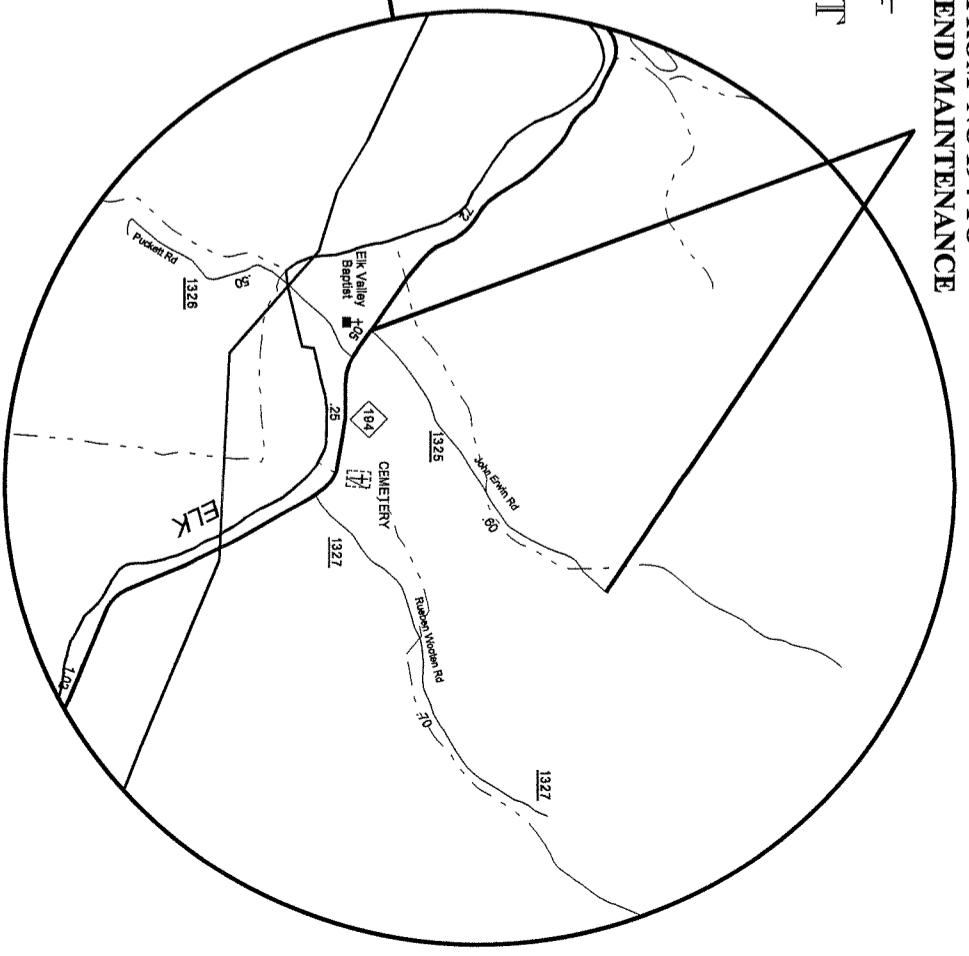
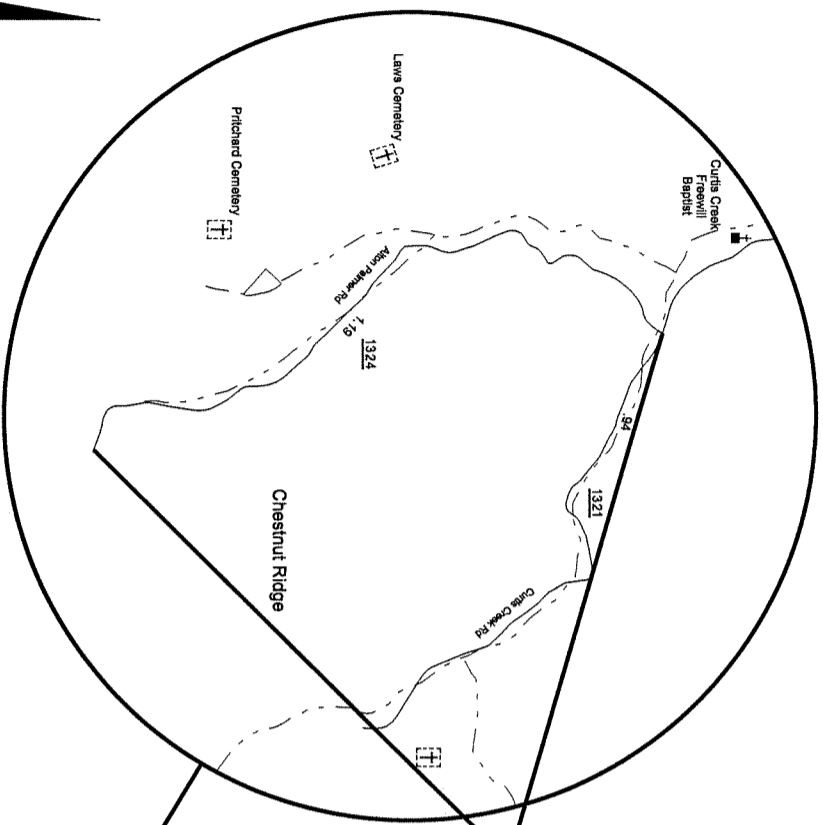

STATE OF NORTH CAROLINA
DIVISION OF HIGHWAYS
CALDWELL COUNTY
ASPHALT SURFACE TREATMENT

MAP #51 SR 1511
FROM SR 1551
TO PYMT CHANGE

MAP #55 SR 1372
FROM US 321 TO BRIDGE

MAP #53 SR 1513
FROM BEG PYMT
TO SR 1604

MAP #54 SR 1339
FROM SR 1143
TO SR 1310

MAP #52 SR 1748
FROM SR 1751 TO SR 1718

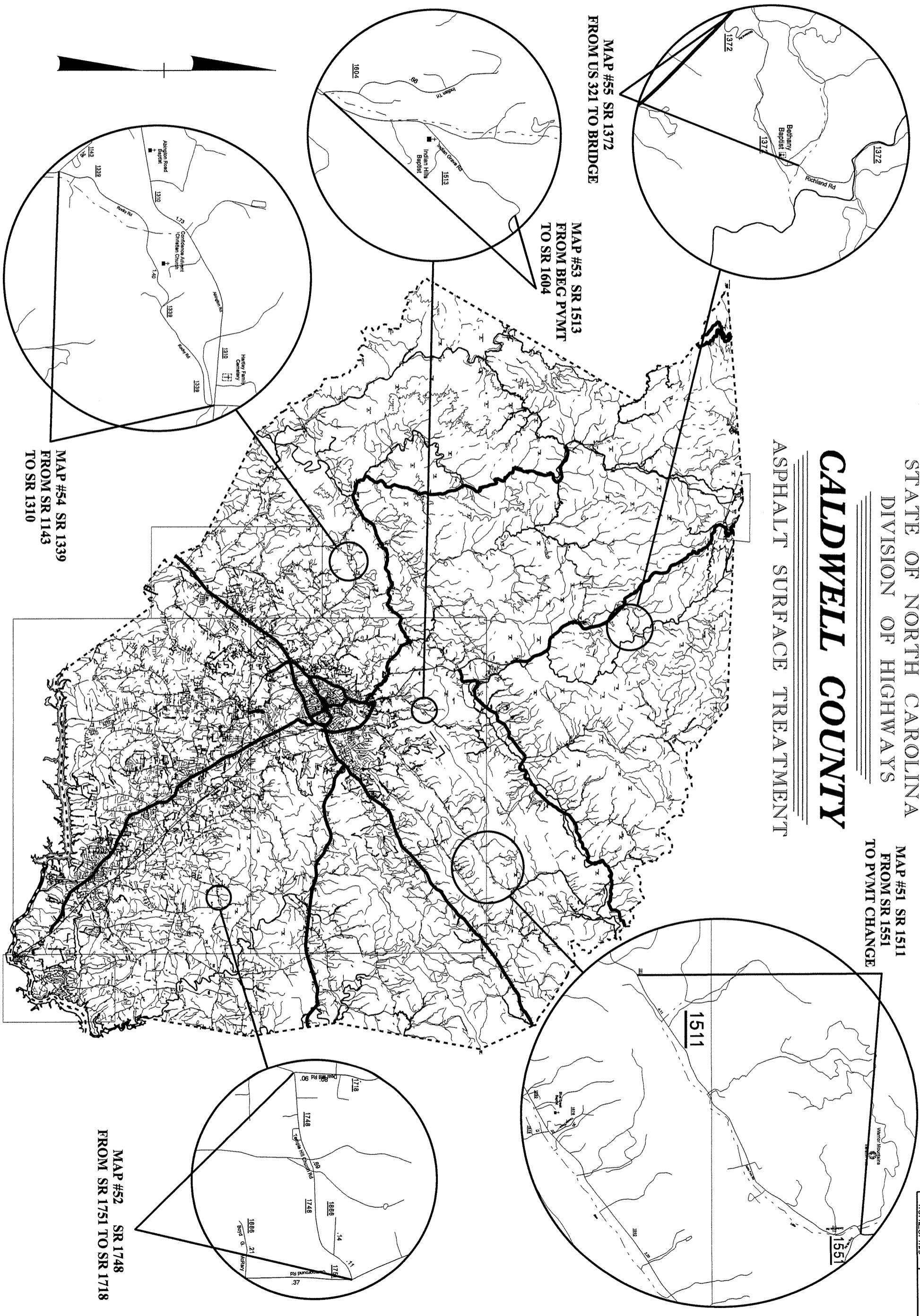

STATE OF NORTH CAROLINA
DIVISION OF HIGHWAYS

CALDWELL COUNTY

ASPHALT SURFACE TREATMENT

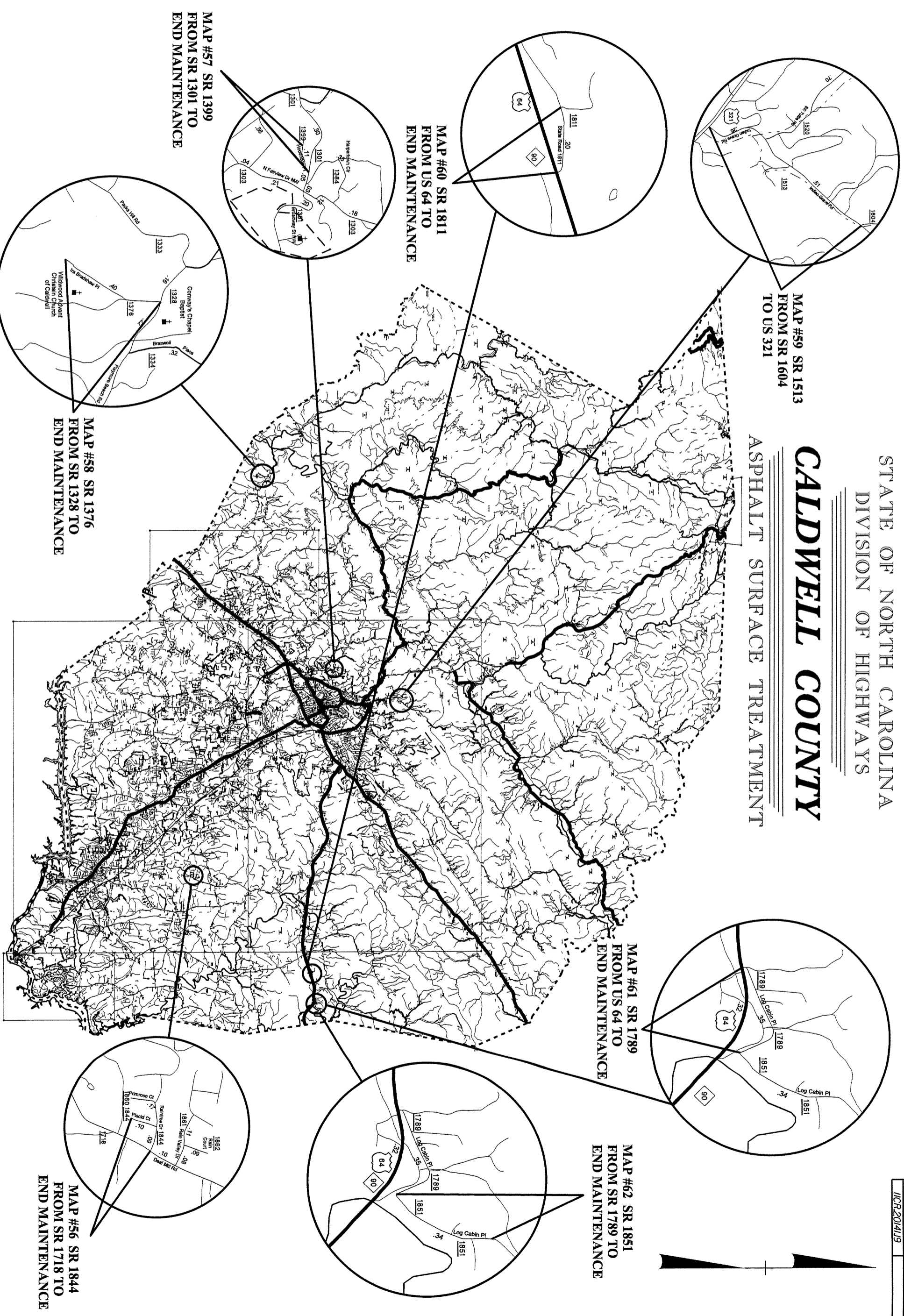

MAP #59 SR 1513
FROM SR 1604
TO US 321

MAP #60 SR 1811
FROM US 64 TO
END MAINTENANCE

MAP #57 SR 1399
FROM SR 1301 TO
END MAINTENANCE

MAP #58 SR 1376
FROM SR 1328 TO
END MAINTENANCE

MAP #61 SR 1789
FROM US 64 TO
END MAINTENANCE

MAP #62 SR 1851
FROM SR 1789 TO
END MAINTENANCE

MAP #56 SR 1844
FROM SR 1718 TO
END MAINTENANCE

PROJECT REFERENCE NO. ICR201419	SHEET NO.
------------------------------------	-----------

TYPICAL SECTION NO. 2

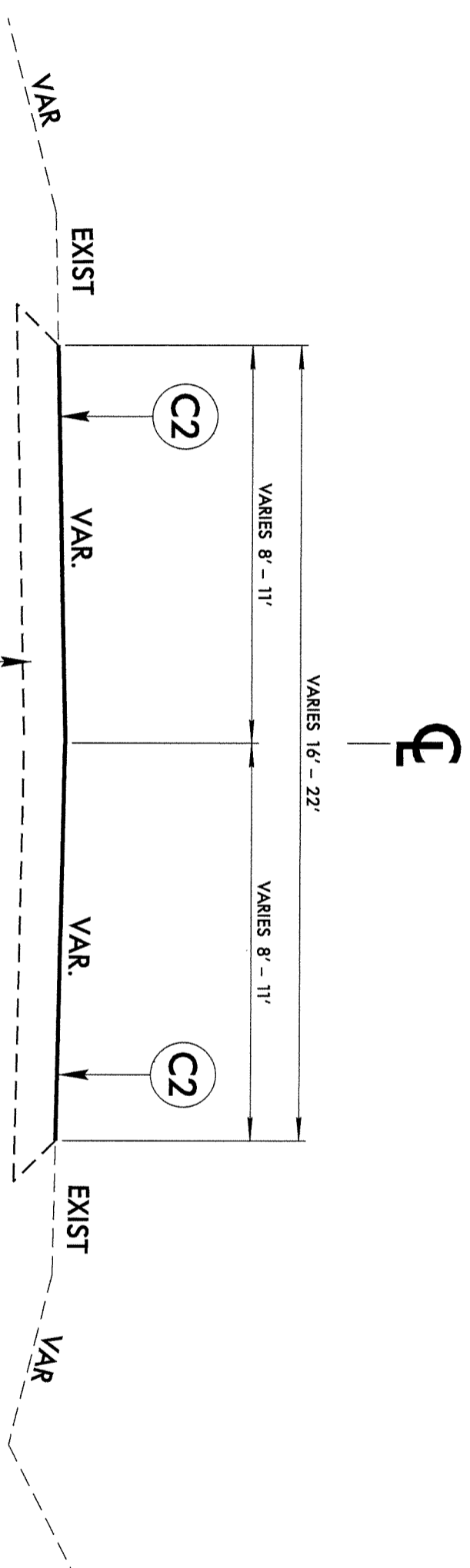

PAVEMENT SCHEDULE	
C2	PROP. ASPHALT SURFACE TREATMENT, TRIPLE SEAL
C4	PROP. ASPHALT SURFACE TREATMENT, TRIPLE SEAL (LIGHTWEIGHT AGGREGATE)
U	EXISTING PAVEMENT

TYPICAL SECTION NO. 4

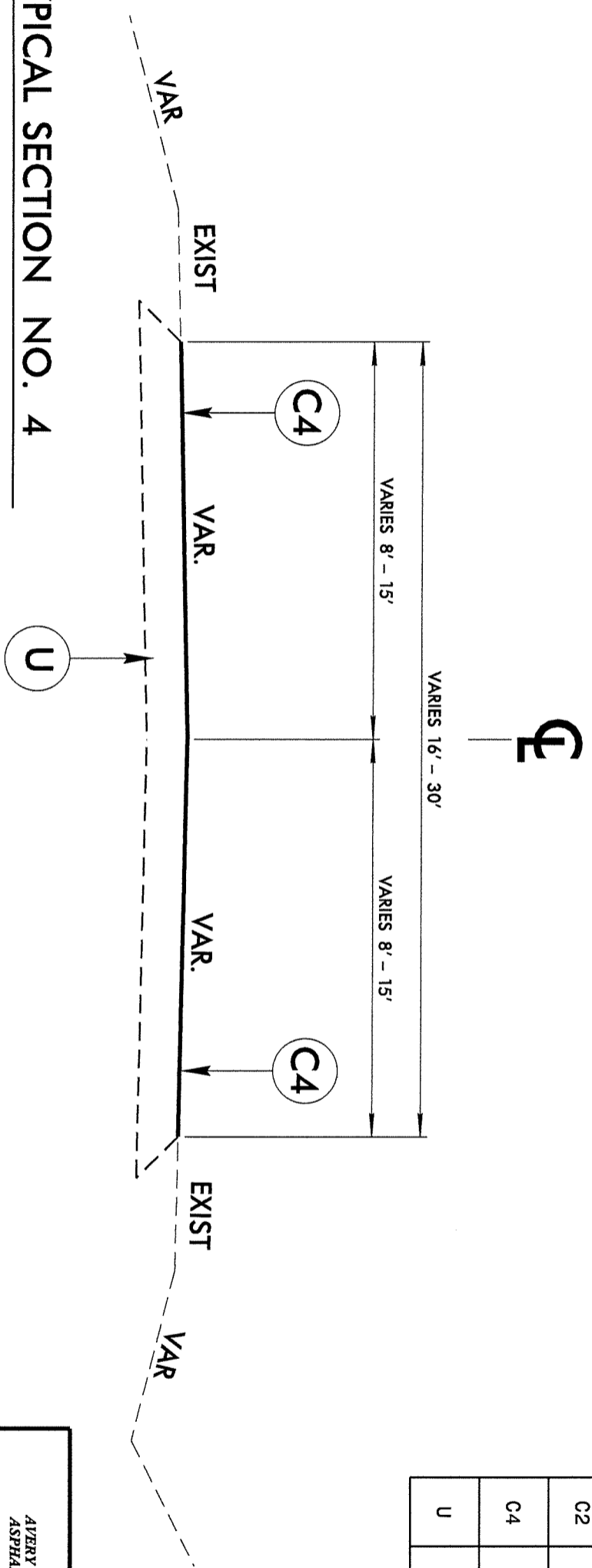

**AVERY & CALDWELL COUNTIES
ASPHALT SURFACE TREATMENT
RESURFACING**

DIVISION II

REVISIONS	INT.	DATE

SCALE: N/A DATE: 3/2012

PREPARED BY: J.L. LAWS

REVIEWED BY:

ENGINEER BY:

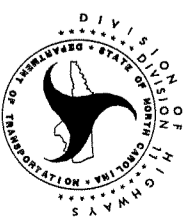

**N.C. DEPARTMENT OF TRANSPORTATION
DIVISION of HIGHWAYS
DIVISION ELEVEN**