

STATE OF NORTH CAROLINA
DIVISION OF HIGHWAYS

2016

CALDWELL COUNTY

PRIMARY ASPHALT RESURFACING

*DETAIL FOR AGGREGATE SHOULDER BORROW
AT STREAM CROSSING

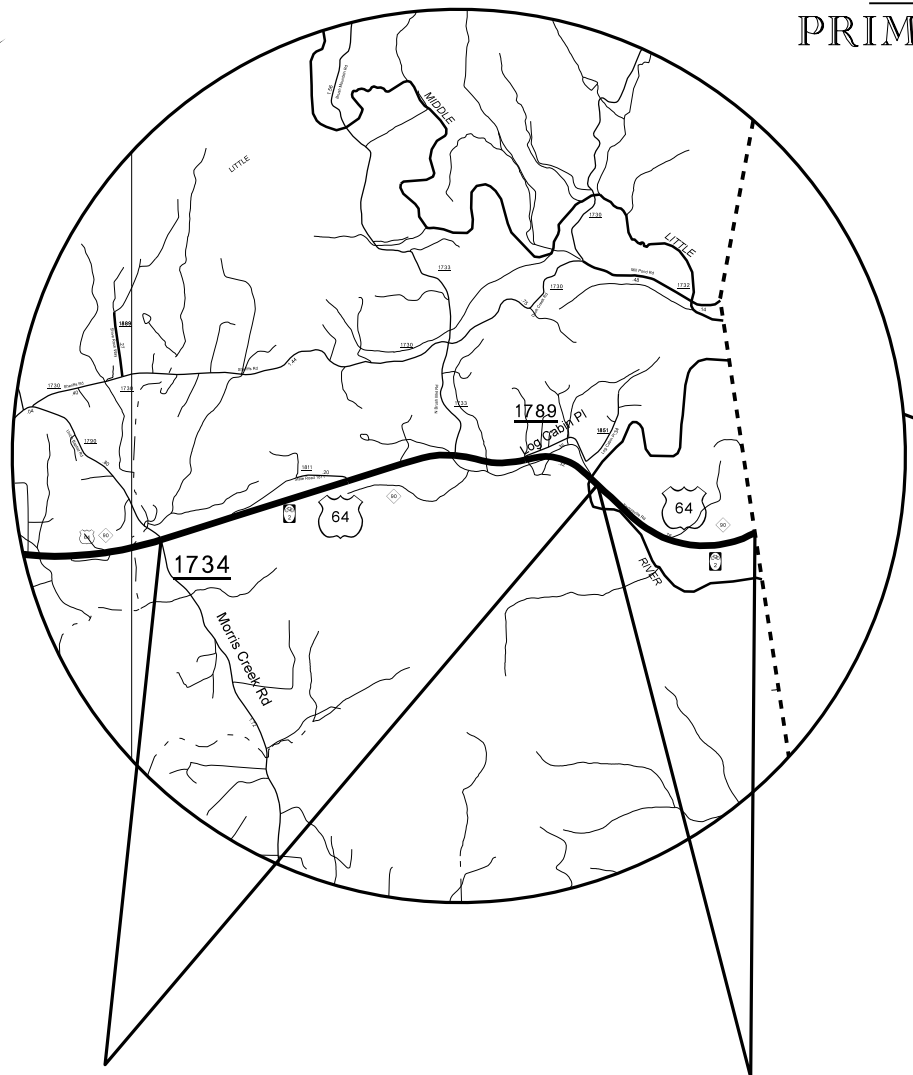
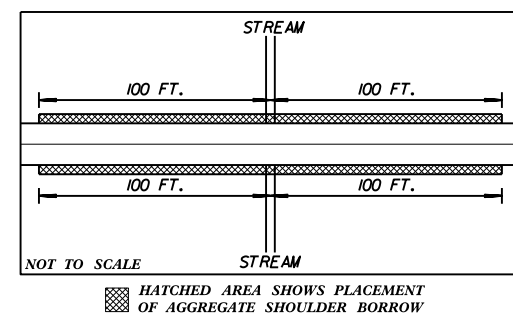

MAP #1 US 64 (2.00 MILES)
FROM SR 1734 TO
0.44 MILES EAST OF SR 1789

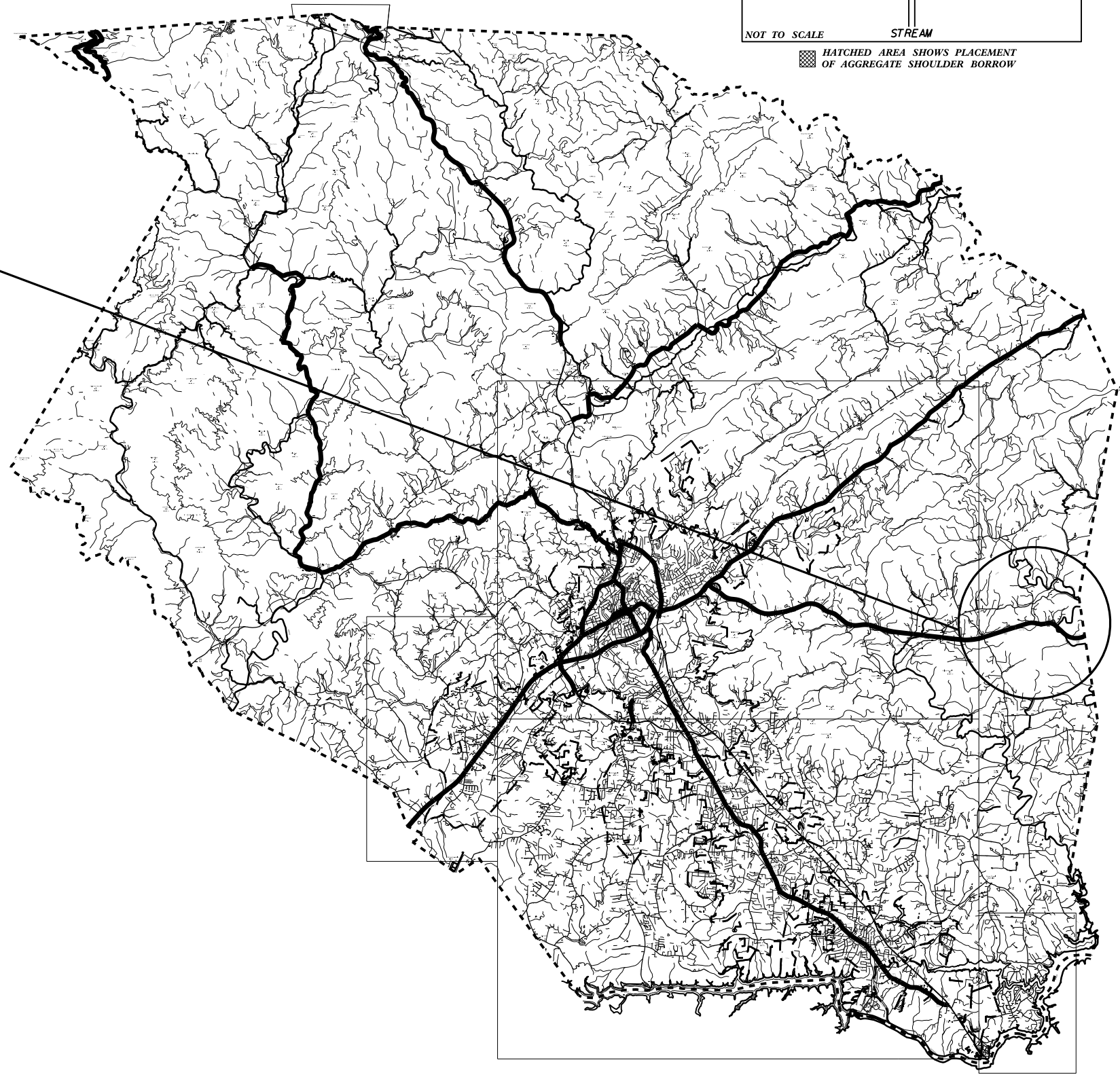

MAP #2 US 64 (0.65 MILES)
FROM 0.44 MILES EAST OF SR 1789
TO ALEXANDER COUNTY LINE

AGGREGATE SHOULDER BORROW
TO BE PLACED: SEE DETAIL
 * APPROX. STATION 65+50 TO 67+50 RT & LT
 * APPROX. STATION 73+00 TO 75+00 RT & LT
 * APPROX. STATION 87+00 TO 89+00 RT & LT
 * APPROX. STATION 96+00 TO 100+50 RT & LT

AGGREGATE SHOULDER BORROW
TO BE PLACED: SEE DETAIL
 * APPROX. STATION 0+00 TO 6+00 RT

