

T E N N E S S E E

J O H N S O N

W A T A U G A

GRAYSON

C O U N T Y

A L L E G H A N Y

C O U N T Y

Lansing  
Pop. 158

West  
Jefferson  
Pop. 1,330

Jefferson  
Pop. 1,594

MT. JEFFERSON  
STATE  
NATURAL AREA

NEW RIVER  
STATE PARK

The Peak

Ore  
Knob

Index

Othello

Glendale  
Springs

Obids

Danvers  
Gap

Idlewild

Yates

Fleetwood

Todd

Mill  
Creek

Woodford

Baldwin

Beaver  
Creek

Smethport

Tree Top

Slitton

Dresden

Warrensville

Bina

Phoenix

Mountain

Shuttle  
Springs

Crumpier

Comet

Roten

Fig

Green  
Valley

Sutherland

Maxwell

Green  
Valley

Green  
Valley

Green  
Valley

Green  
Valley

Green  
Valley

Green  
Valley

Green  
Valley

Green  
Valley

Green  
Valley

Green  
Valley

Green  
Valley

Green  
Valley

Green  
Valley

Green  
Valley

Green  
Valley

Green  
Valley

Green  
Valley

Green  
Valley

Green  
Valley

Green  
Valley

Green  
Valley

Green  
Valley

Green  
Valley

Green  
Valley

Green  
Valley

Green  
Valley

Green  
Valley

Green  
Valley

Green  
Valley

Green  
Valley

Green  
Valley

Green  
Valley

Green  
Valley

Green  
Valley

Green  
Valley

Green  
Valley

Green  
Valley

Green  
Valley

Green  
Valley

Green  
Valley

Green  
Valley

Green  
Valley

Green  
Valley

Green  
Valley

Green  
Valley

Green  
Valley

Green  
Valley

Green  
Valley

Green  
Valley

Green  
Valley

Green  
Valley

Green  
Valley

Green  
Valley

Green  
Valley

Green  
Valley

Green  
Valley

Green  
Valley

Green  
Valley

Green  
Valley

Green  
Valley

Green  
Valley

Green  
Valley

Green  
Valley

Green  
Valley

Green  
Valley

Green  
Valley

Green  
Valley

Green  
Valley

Green  
Valley

Green  
Valley

Green  
Valley

Green  
Valley

Green  
Valley

Green  
Valley

Green  
Valley

Green  
Valley

Green  
Valley

Green  
Valley

Green  
Valley

Green  
Valley

Green  
Valley

Green  
Valley

Green  
Valley

Green  
Valley

Green  
Valley

Green  
Valley

Green  
Valley

Green  
Valley

Green  
Valley

Green  
Valley

Green  
Valley

Green  
Valley

Green  
Valley

Green  
Valley

Green  
Valley

Green  
Valley

Green  
Valley

Green  
Valley

Green  
Valley

Green  
Valley

Green  
Valley

Green  
Valley

Green  
Valley

Green  
Valley

Green  
Valley

Green  
Valley

Green  
Valley

Green  
Valley

Green  
Valley

Green  
Valley

Green  
Valley

Green  
Valley

Green  
Valley

Green  
Valley

Green  
Valley

Green  
Valley

Green  
Valley

Green  
Valley

Green  
Valley

Green  
Valley

Green  
Valley

Green  
Valley

Green  
Valley

Green  
Valley

Green  
Valley

Green  
Valley

Green  
Valley

Green  
Valley

Green  
Valley

Green  
Valley

Green  
Valley

Green  
Valley

Green  
Valley

Green  
Valley

Green  
Valley

Green  
Valley

Green  
Valley

Green  
Valley

Green  
Valley

Green  
Valley

Green  
Valley

Green  
Valley

Green  
Valley

Green  
Valley

Green  
Valley

Green  
Valley

Green  
Valley

Green  
Valley

Green  
Valley

Green  
Valley

Green  
Valley

Green  
Valley

Green  
Valley

Green  
Valley

Green  
Valley

Green  
Valley

Green  
Valley

Green  
Valley

Green  
Valley

Green  
Valley

Green  
Valley

Green  
Valley

Green  
Valley

Green  
Valley

Green  
Valley

Green  
Valley

Green  
Valley

Green  
Valley

Green  
Valley

Green  
Valley

Green  
Valley

Green  
Valley

Green  
Valley

Green  
Valley

Green  
Valley

Green  
Valley

Green  
Valley

Green  
Valley

Green  
Valley

Green  
Valley

Green  
Valley

Green  
Valley

Green  
Valley

Green  
Valley

Green  
Valley

Green  
Valley

Green  
Valley

Green  
Valley

Green  
Valley

Green  
Valley

Green  
Valley

Green  
Valley

Green  
Valley

Green  
Valley

Green  
Valley

Green  
Valley

Green  
Valley

Green  
Valley

Green  
Valley

Green  
Valley

Green  
Valley

Green  
Valley

Green  
Valley

Green  
Valley



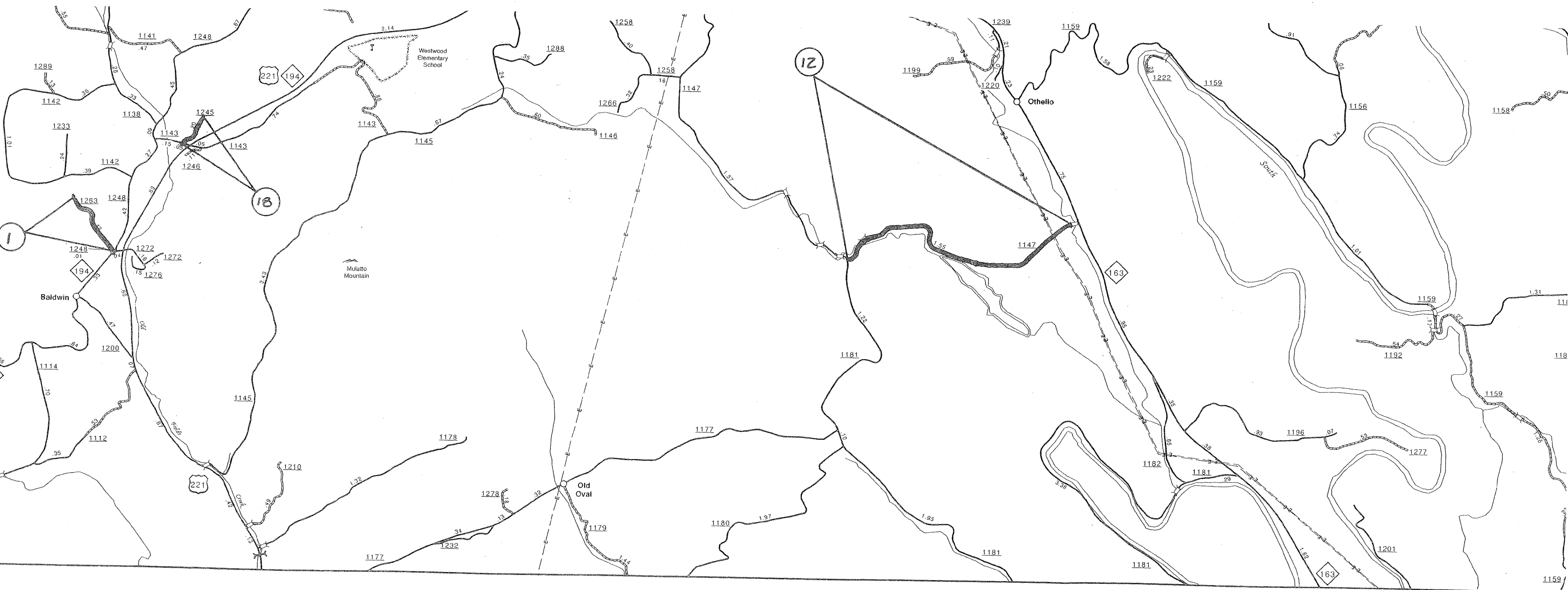

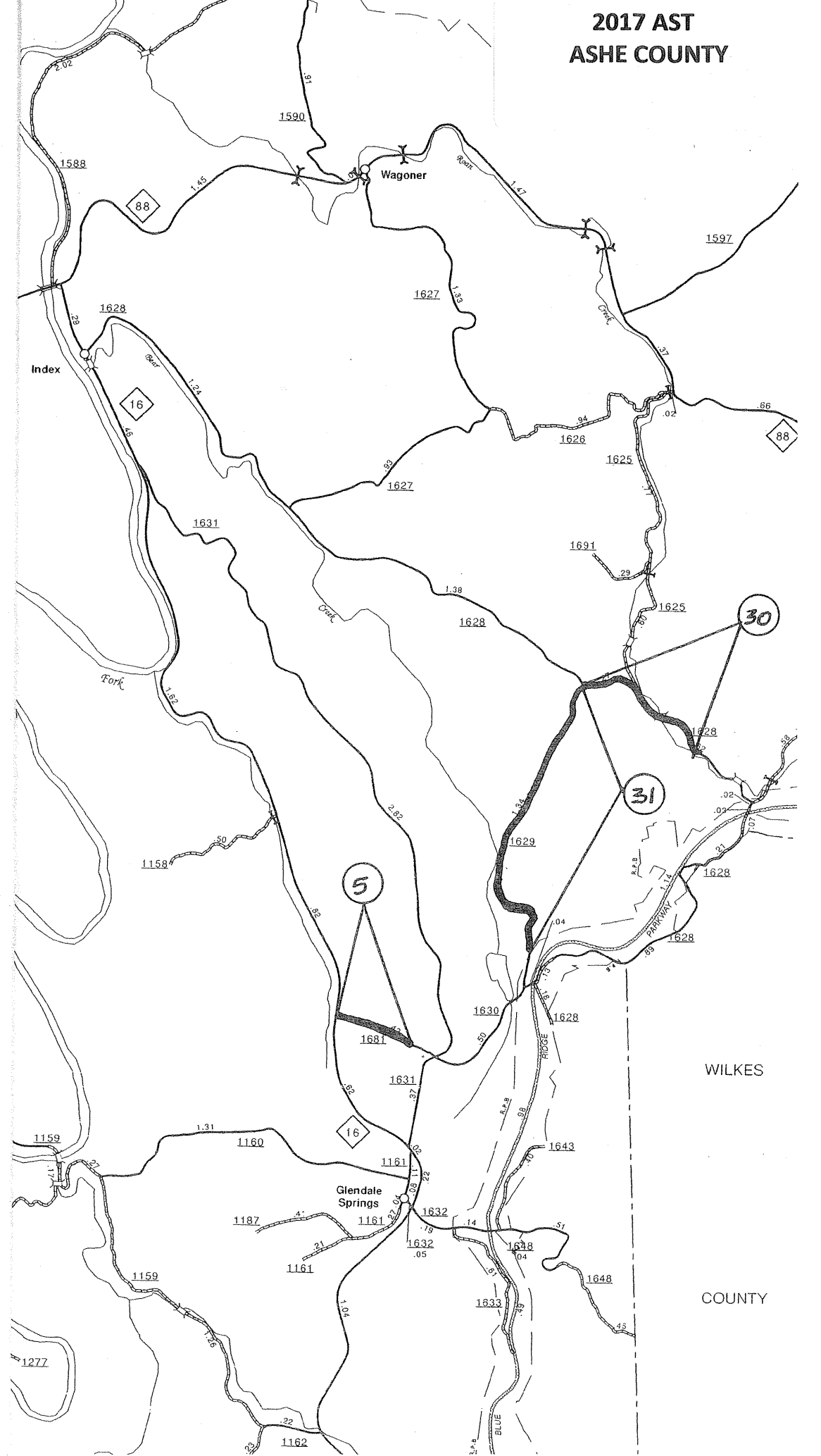
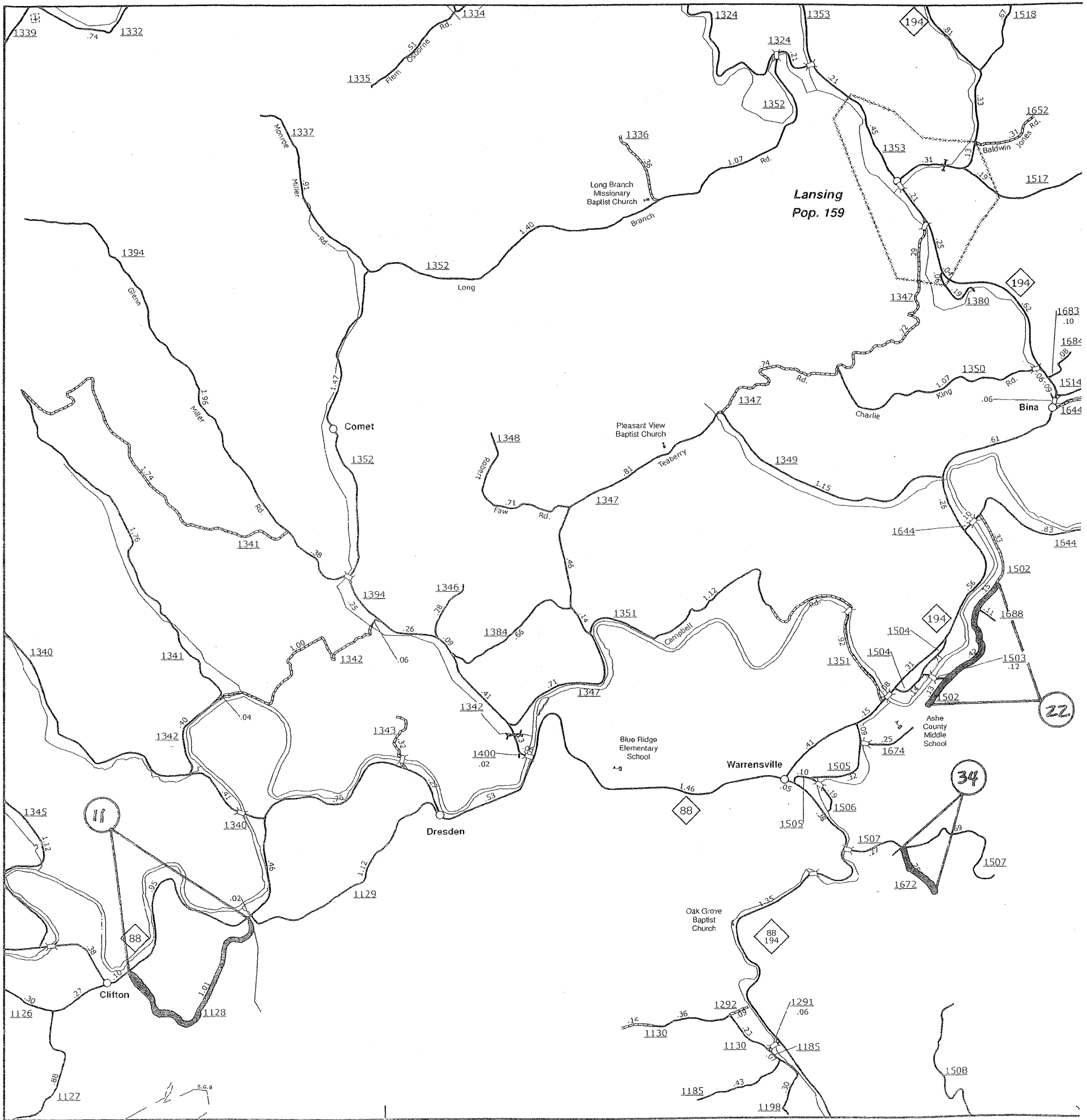

WILKES  
COUNTY



<b>TOTAL FOR PROJ NO. 2017CPT.11.19.20052</b>							<b>37.3</b>		<b>383,405</b>	<b>304,362</b>	<b>18,528</b>	<b>4,384</b>	<b>1</b>	<b>693,804</b>	<b>680,912</b>		
<b>GRAND TOTAL</b>							<b>37.3</b>		<b>383,405</b>	<b>304,362</b>	<b>18,528</b>	<b>4,384</b>	<b>1</b>	<b>693,804</b>	<b>680,912</b>		