

R-5849 CROSS-SECTION INDEX

CROSS-SECTION INDEX	X-1A
EARTHWORK VOLUME SUMMARY	X-1B
-L-	X-1 TO X-7
-Y1-	X-8 TO X-10
-Y2-	X-11 TO X-15

STATE OF NORTH CAROLINA
DIVISION OF HIGHWAYS

PROJ. REFERENCE NO.	SHEET NO.
R-5849	X-1B

NOTE: EMBANKMENT COLUMN DOES NOT INCLUDES BACKFILL FOR UNDERCUT

CROSS-SECTION SUMMARY

Station	Uncl. Exc. (cu. yd.)	Embt (cu. yd.)	Station	Uncl. Exc. (cu. yd.)	Embt (cu. yd.)															
L			Y1																	
10+50.00	0	0	13+00.00	67	20															
11+00.00	14	2	13+30.00	58	5															
11+50.00	32	7	13+50.00	41	1															
12+00.00	41	11	14+00.00	94	3															
12+50.00	43	7	14+50.00	103	0															
13+00.00	32	0	15+00.00	98	5															
13+50.00	24	0	15+50.00	92	10															
14+00.00	29	0	16+00.00	89	5															
14+50.00	48	10	16+50.00	82	7															
15+00.00	54	10	16+76.07	41	6															
15+50.00	74	0	17+00.00	56	3															
16+00.00	86	0	17+50.00	202	0															
16+50.00	65	55	17+80.47	94	6															
17+00.00	63	141	17+91.00	6	2															
17+50.00	61	195																		
17+75.00	29	104	Station	Uncl. Exc.	Embt															
18+00.00	27	118																		
18+50.00	50	301	Y2	(cu. yd.)	(cu. yd.)															
19+00.00	44	302	10+08.85	0	0															
19+50.00	38	318	10+50.00	8	43															
19+90.00	36	402	11+00.00	5	65															
20+00.00	12	130	11+50.00	0	163															
20+50.00	33	609	12+00.00	0	290															
21+00.00	0	513	12+50.00	0	375															
21+50.00	135	321	13+00.00	0	434															
22+00.00	328	126	13+50.00	0	493															
22+50.00	320	61	14+00.00	0	616															
23+00.00	339	26	14+50.00	0	825															
23+50.00	401	7	15+00.00	0	970															
24+00.00	330	4	15+50.00	0	905															
24+50.00	245	2	16+00.00	0	863															
25+00.00	160	0	16+50.00	0	921															
25+50.00	118	4	17+00.00	0	921															
26+00.00	123	6	17+50.00	0	893															
26+50.00	108	4	18+00.00	0	1011															
27+00.00	95	4	18+50.00	0	1325															
27+50.00	89	4	19+00.00	0	1783															
28+00.00	84	4	19+50.00	0	2376															
28+50.00	51	4	20+00.00	0	1401															
29+00.00	24	1	20+50.00	643	50															
29+50.00	57	1	21+00.00	1806	0															
29+72.00	35	2	21+20.00	466	0															
29+90.000	13	1																		
Station	Uncl. Exc.	Embt																		
Y1	(cu. yd.)	(cu. yd.)																		
10+32.16	0	0																		
10+50.00	50	7																		
11+00.00	83	39																		
11+50.00	42	62																		
12+00.00	59	57																		
12+50.00	59	37																		

Approximate quantities only. Unclassified excavation, borrow excavation, shoulder borrow, fine grading, clearing and grubbing, and removal of existing pavement will be paid for at the lump sum price for "Grading".

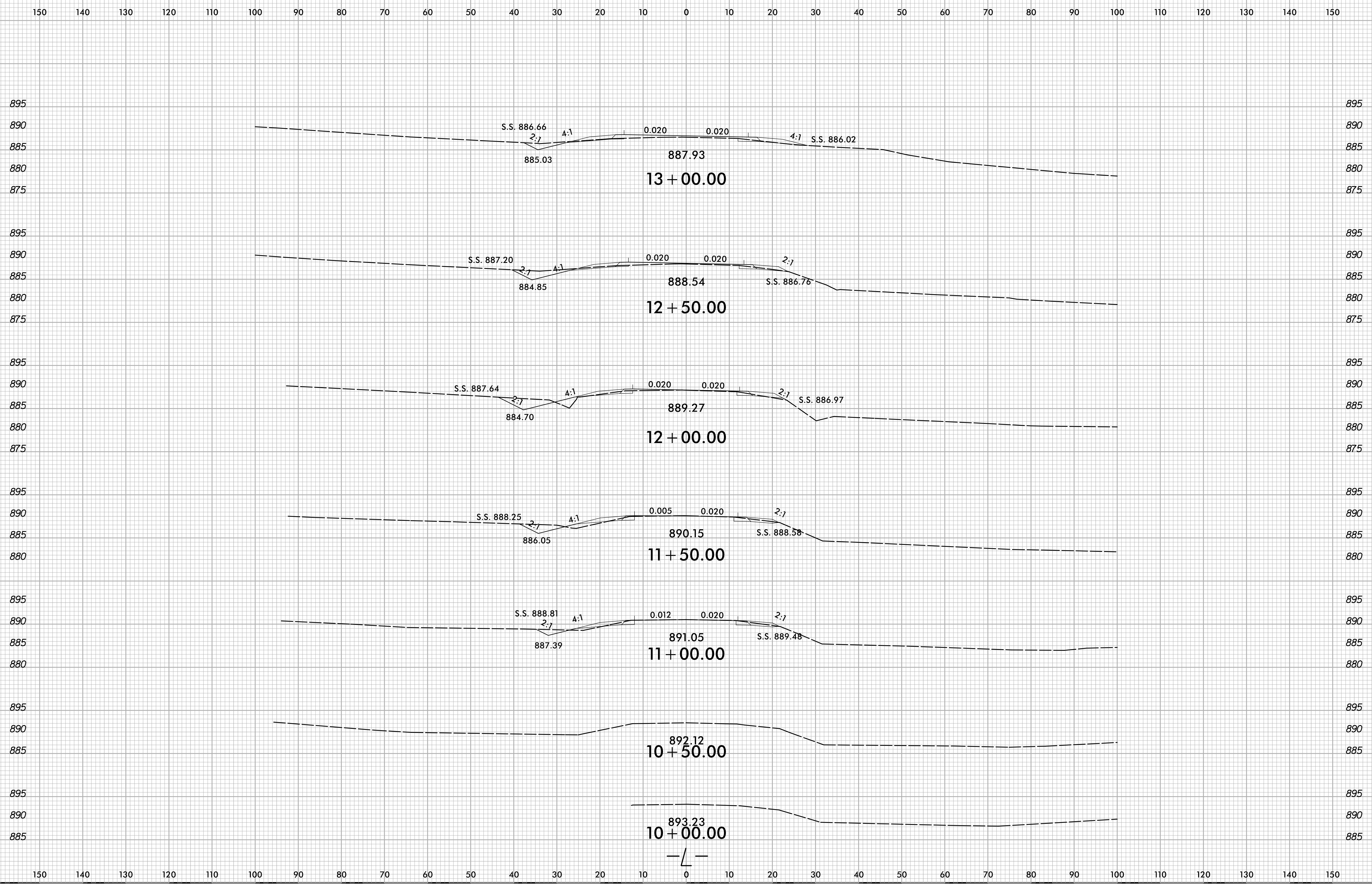

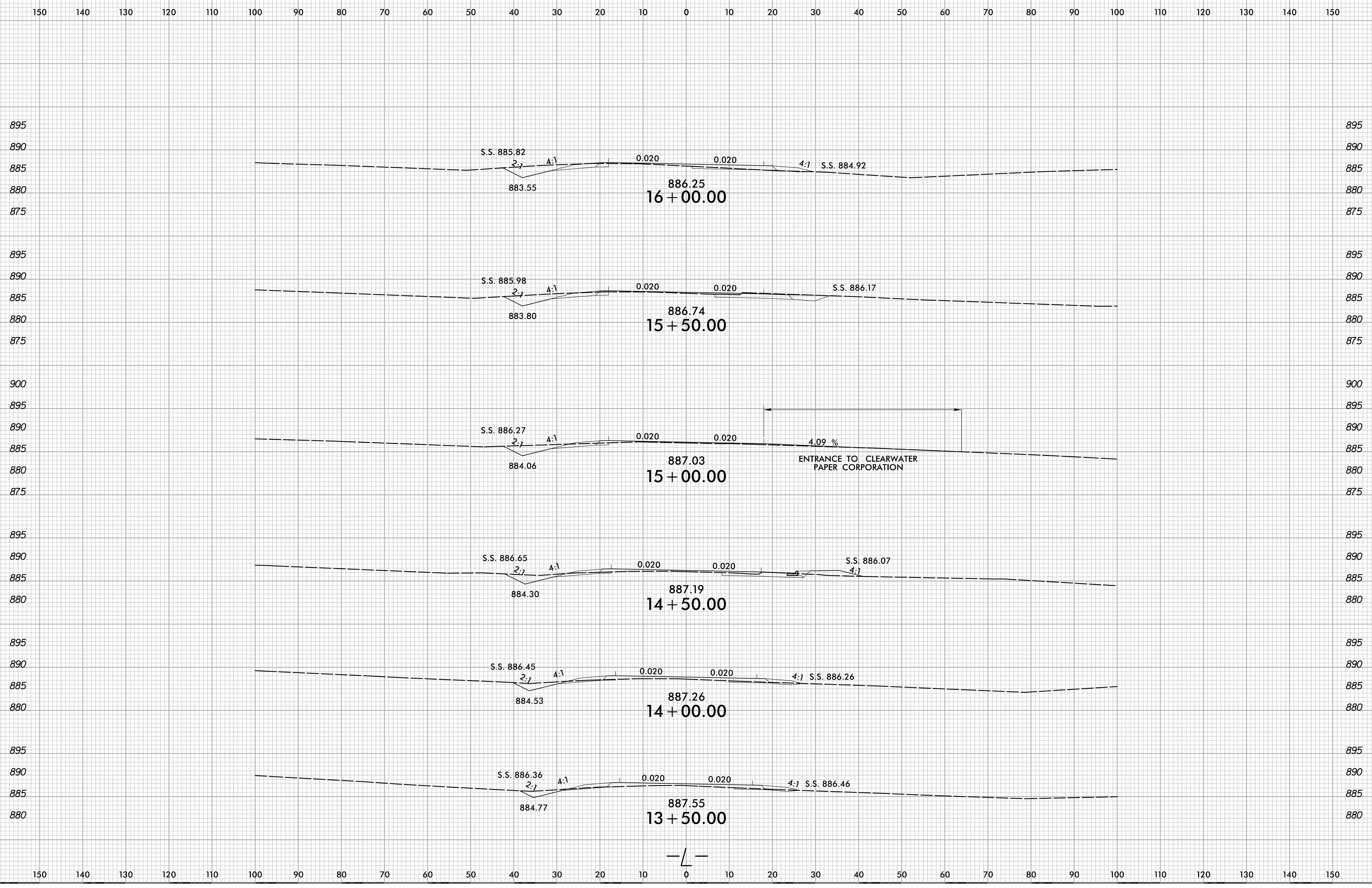

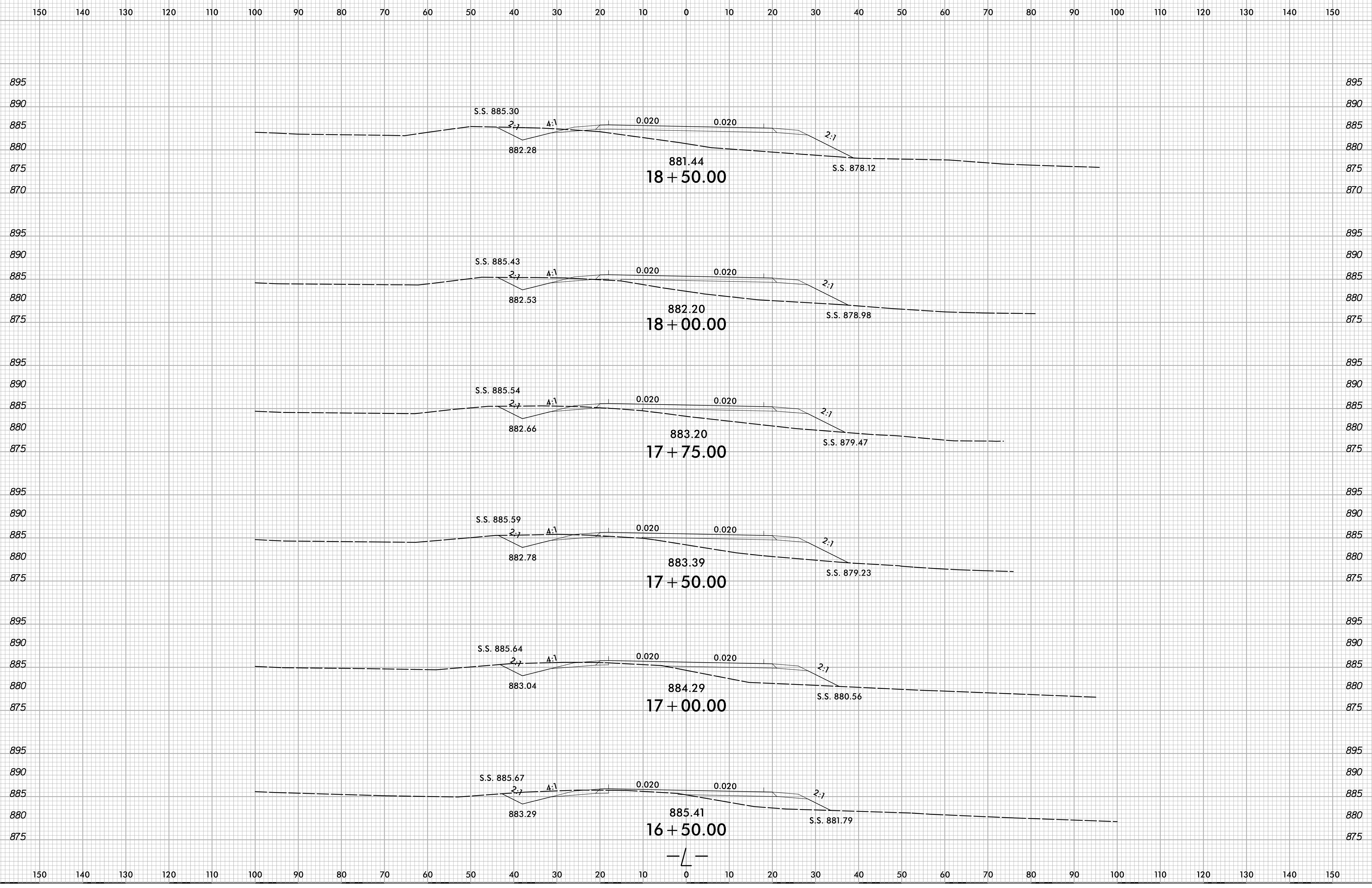

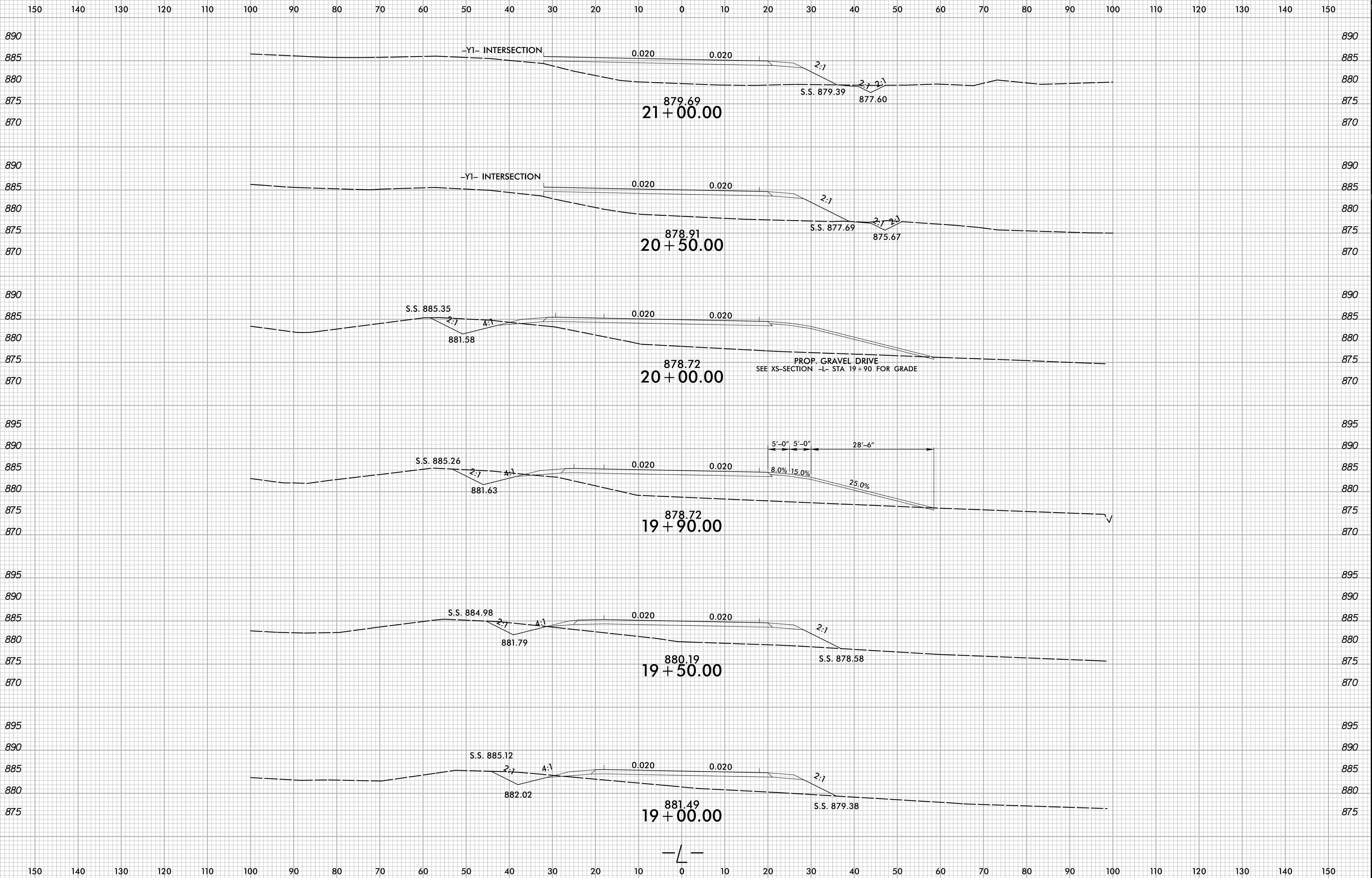

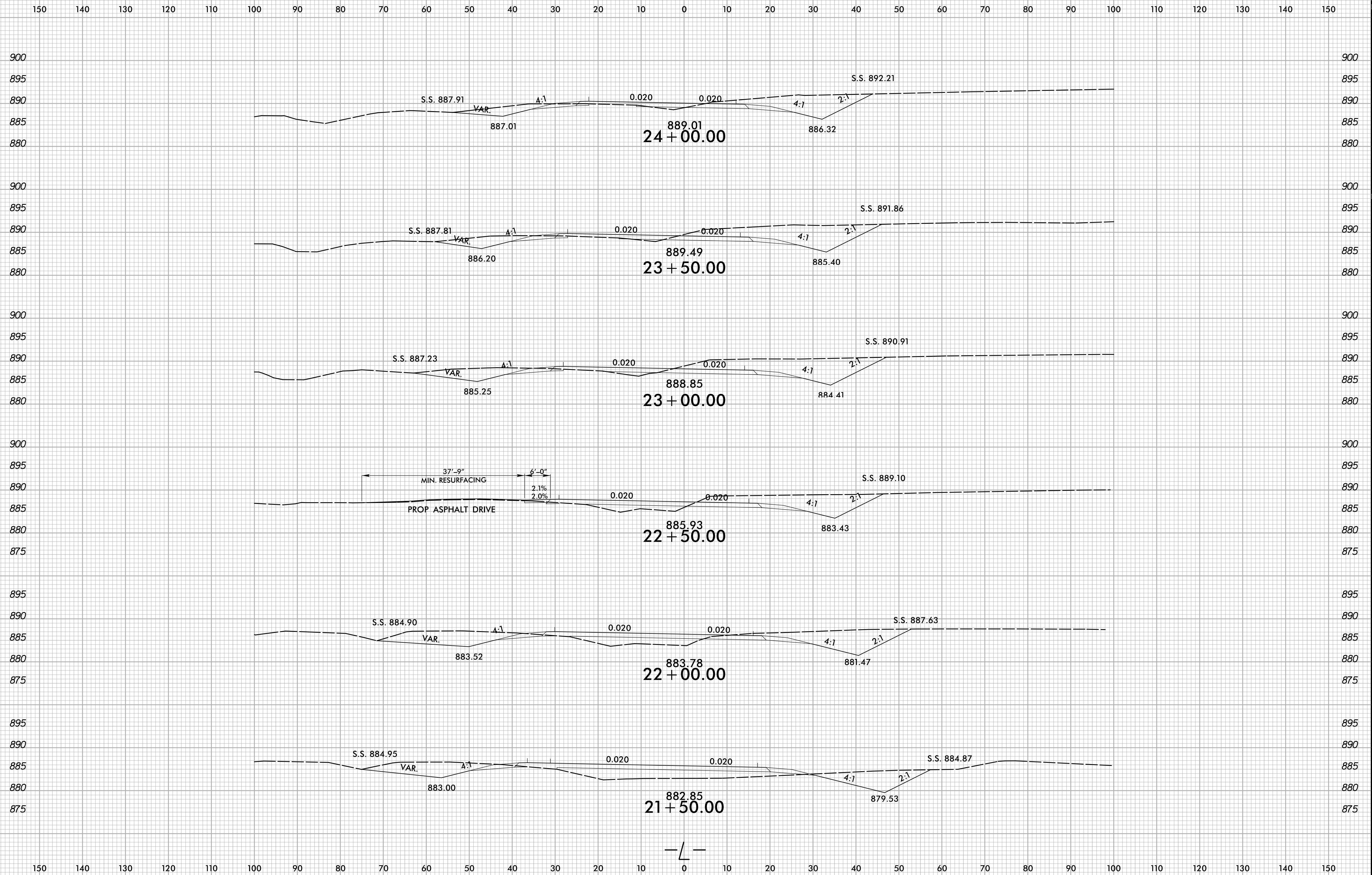

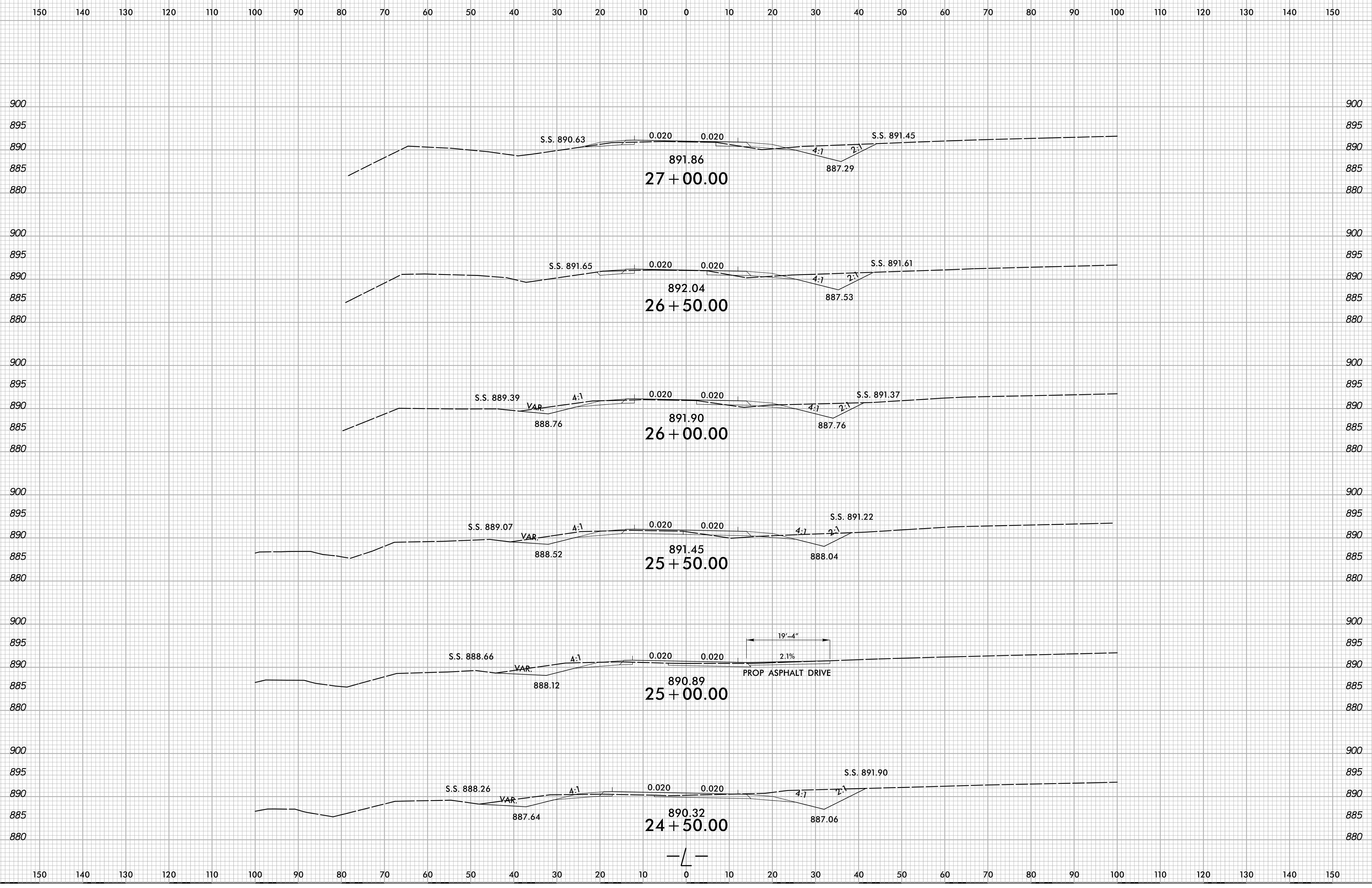

I:\12\2017
 X:\County Projects\Cleveland County\Washburn Switch Business Park\Roadway\XSC\WSBP_Rdy_xp1.L.dgn
 User:zmeivn

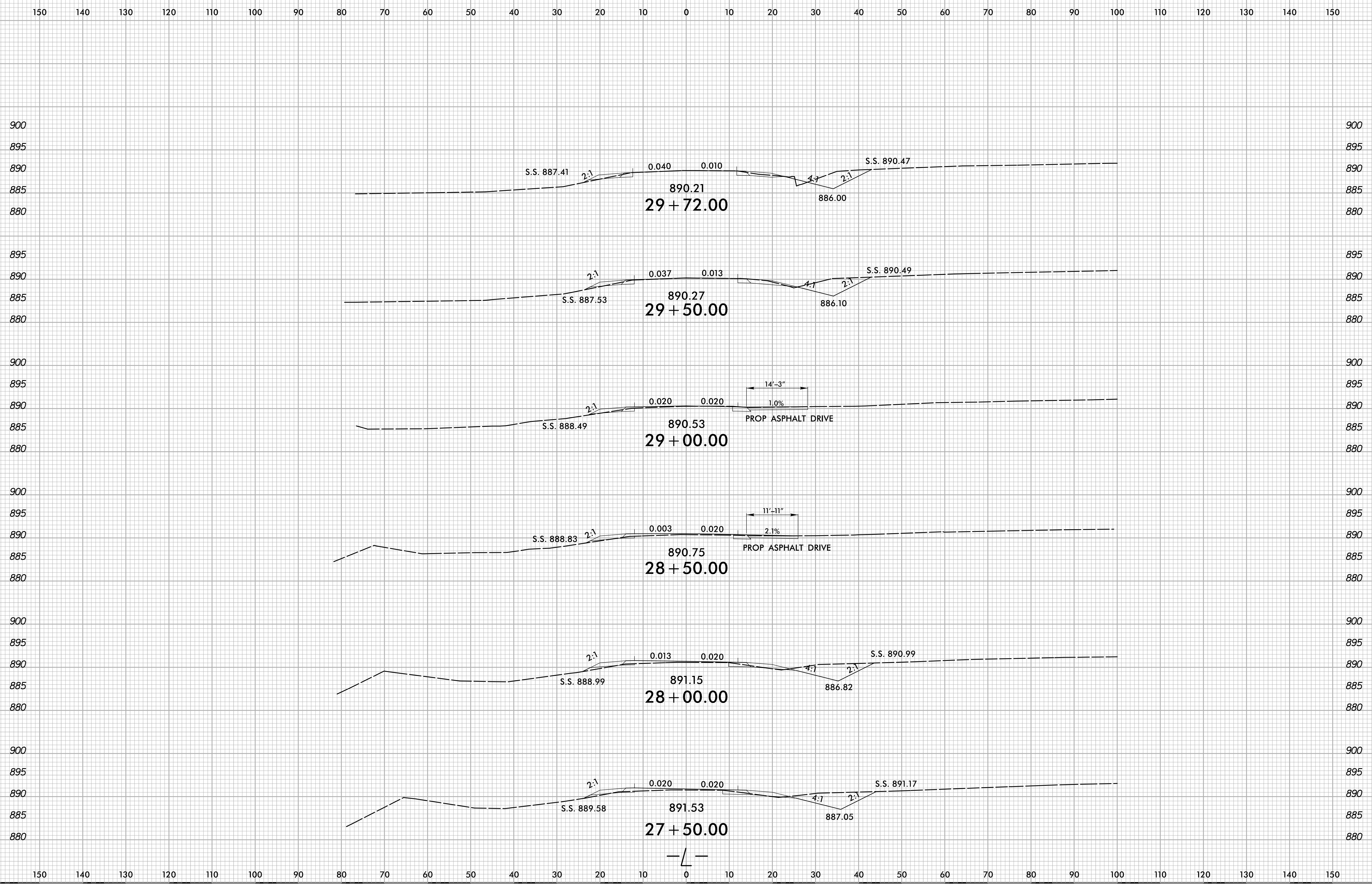

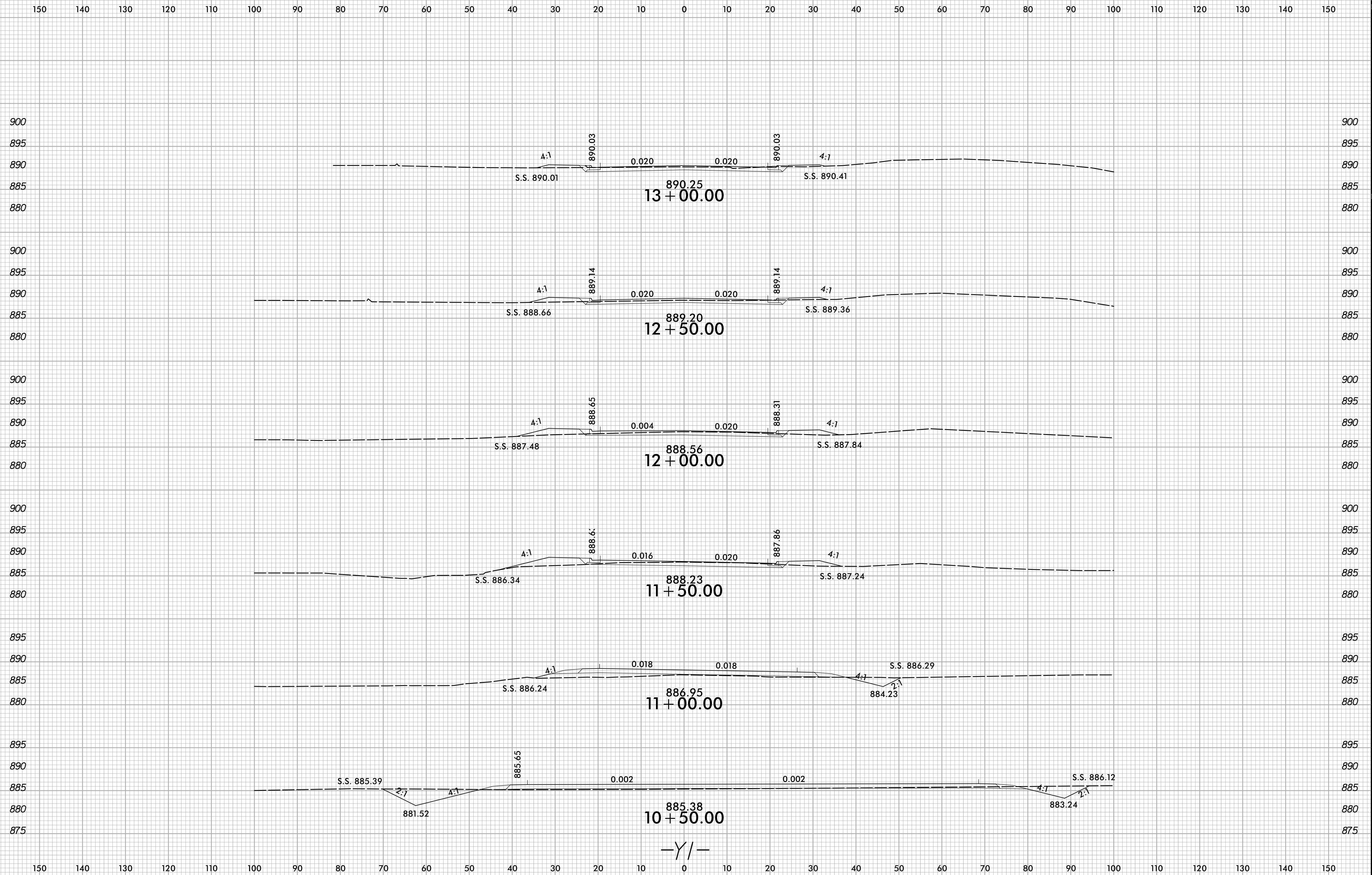

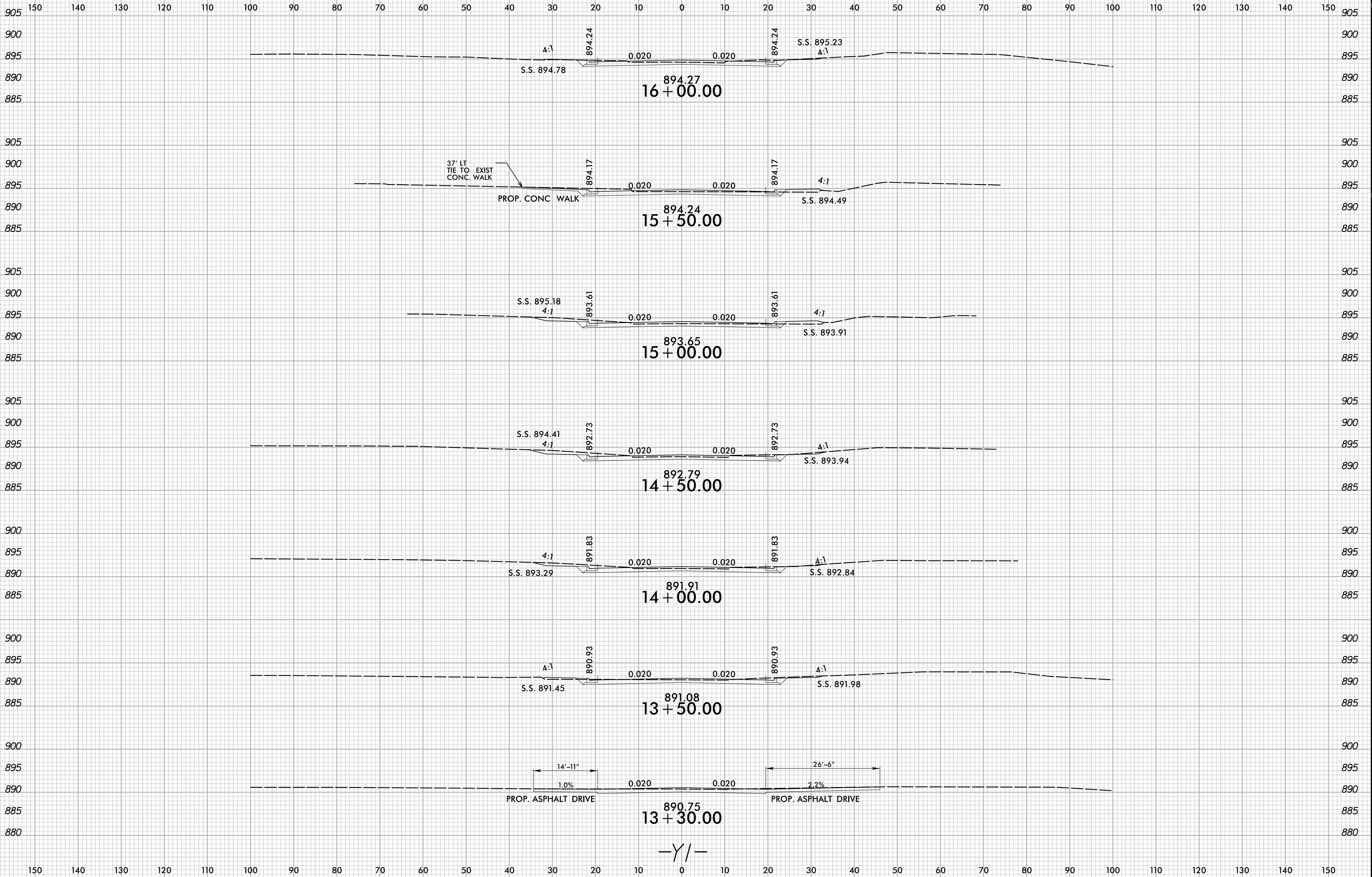

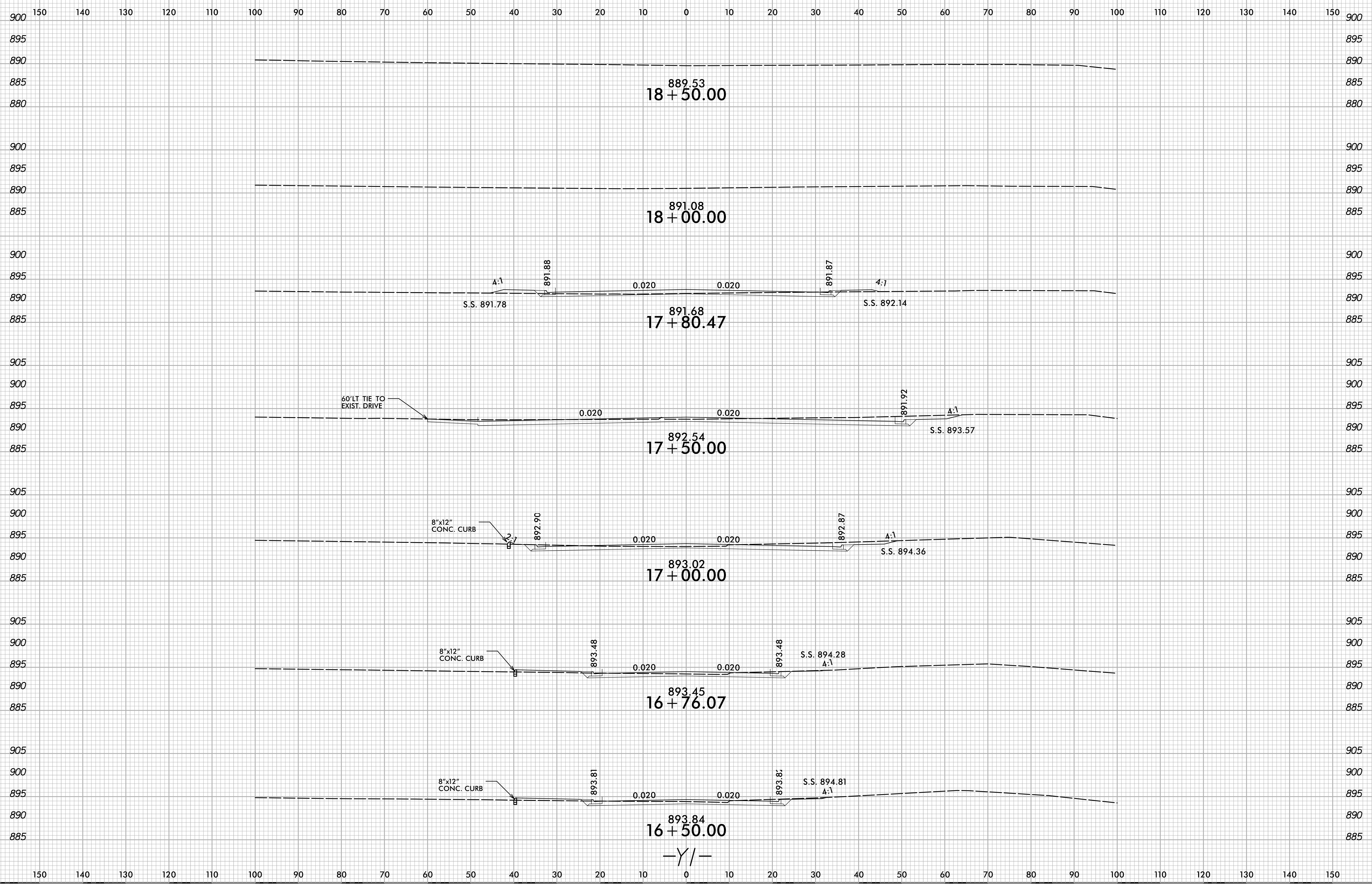

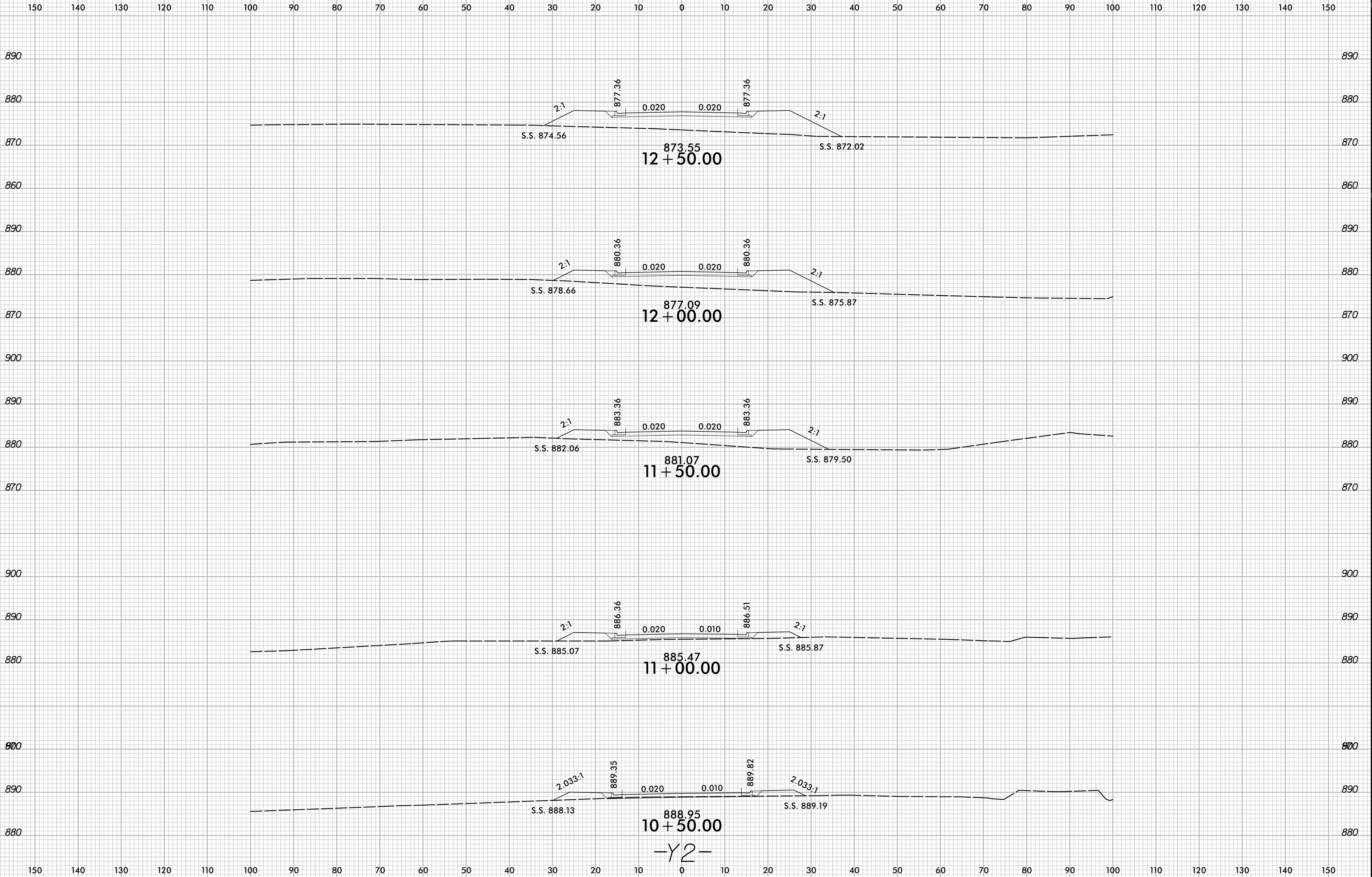

-Y2-

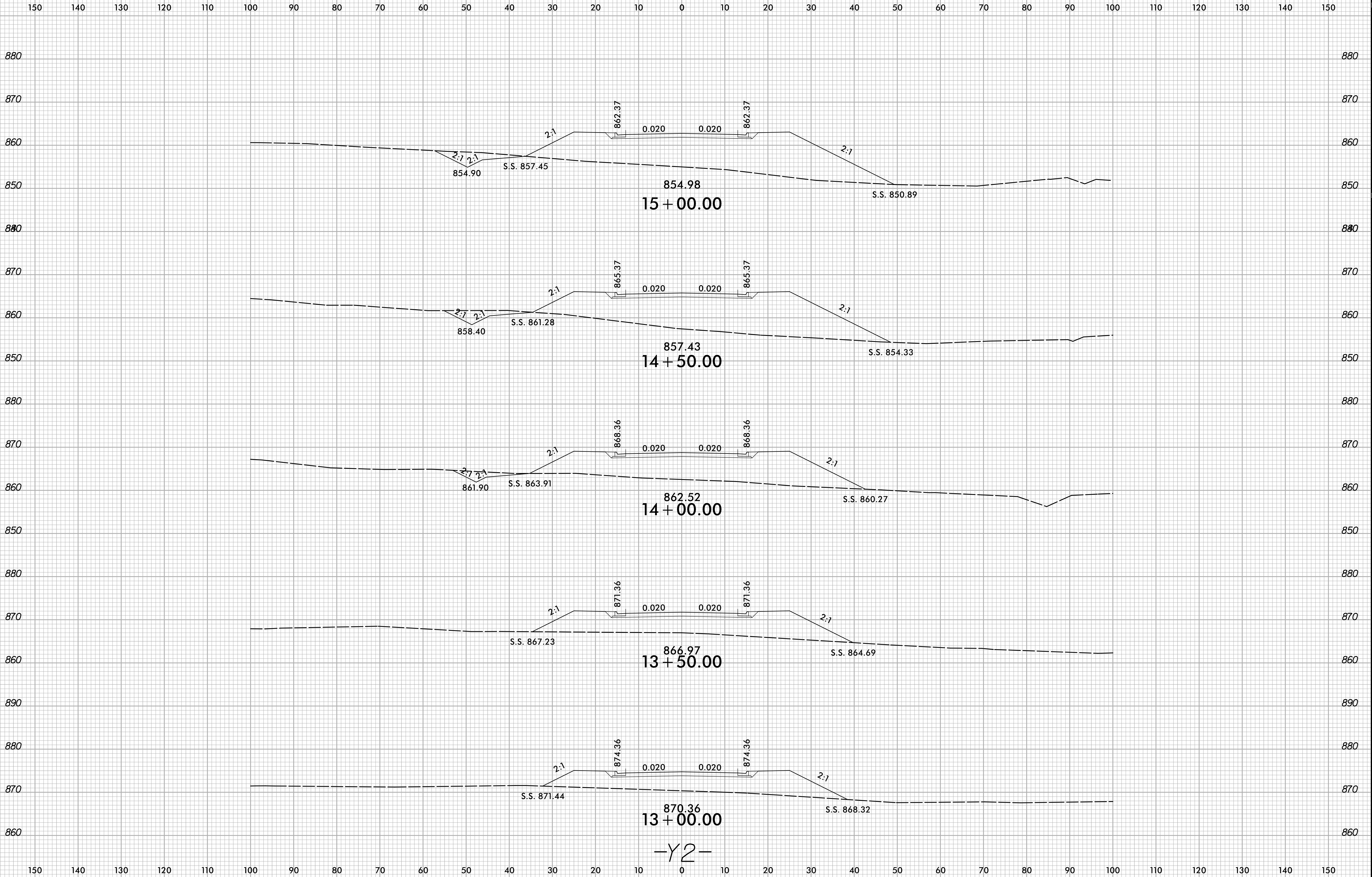

I:\2017\Projects\Cleveland County\Washburn Switch Business Park\Roadway\XSC\WSBP_Rdy_xp1_Y2.dgn

-Y2-

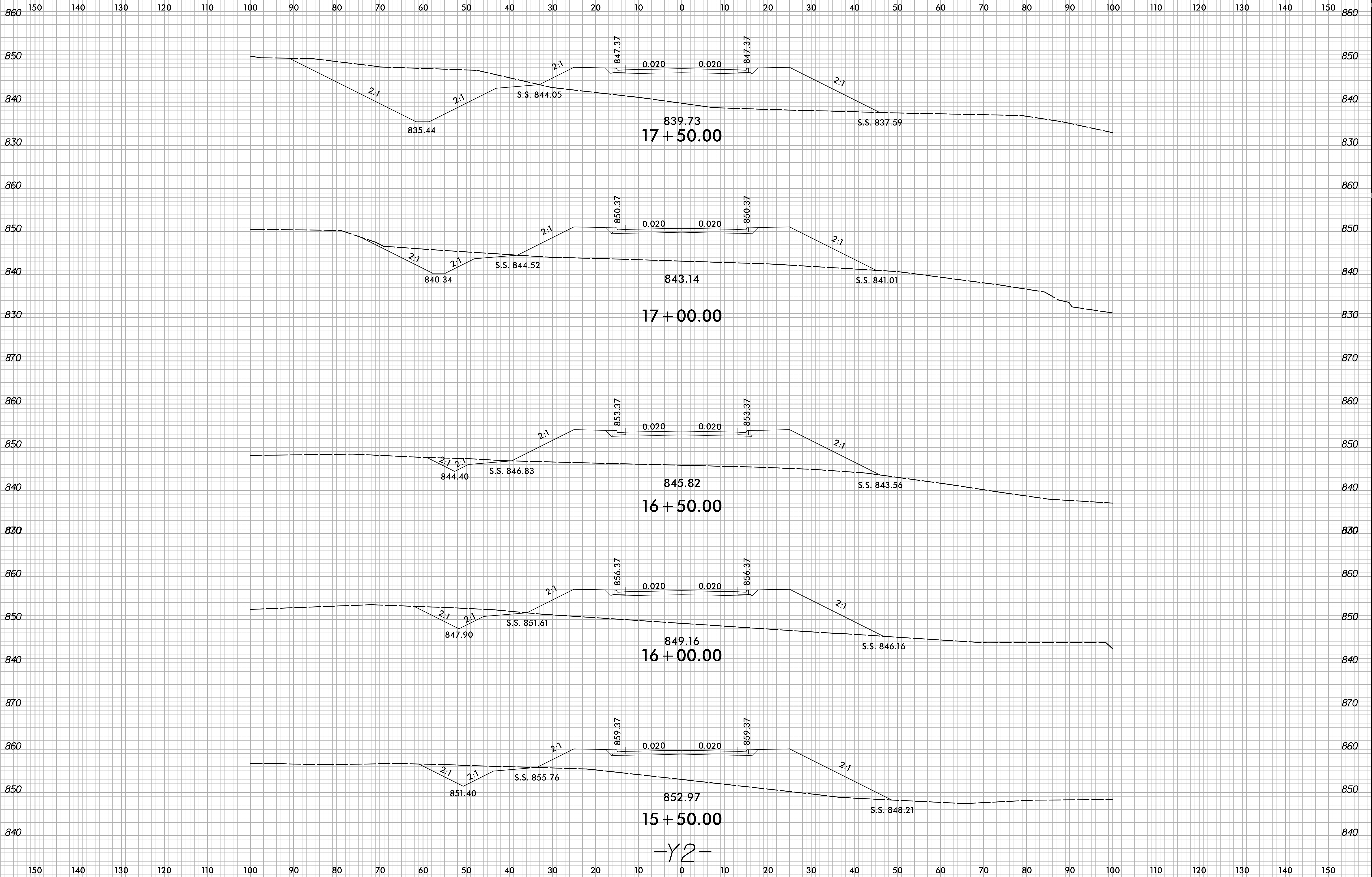

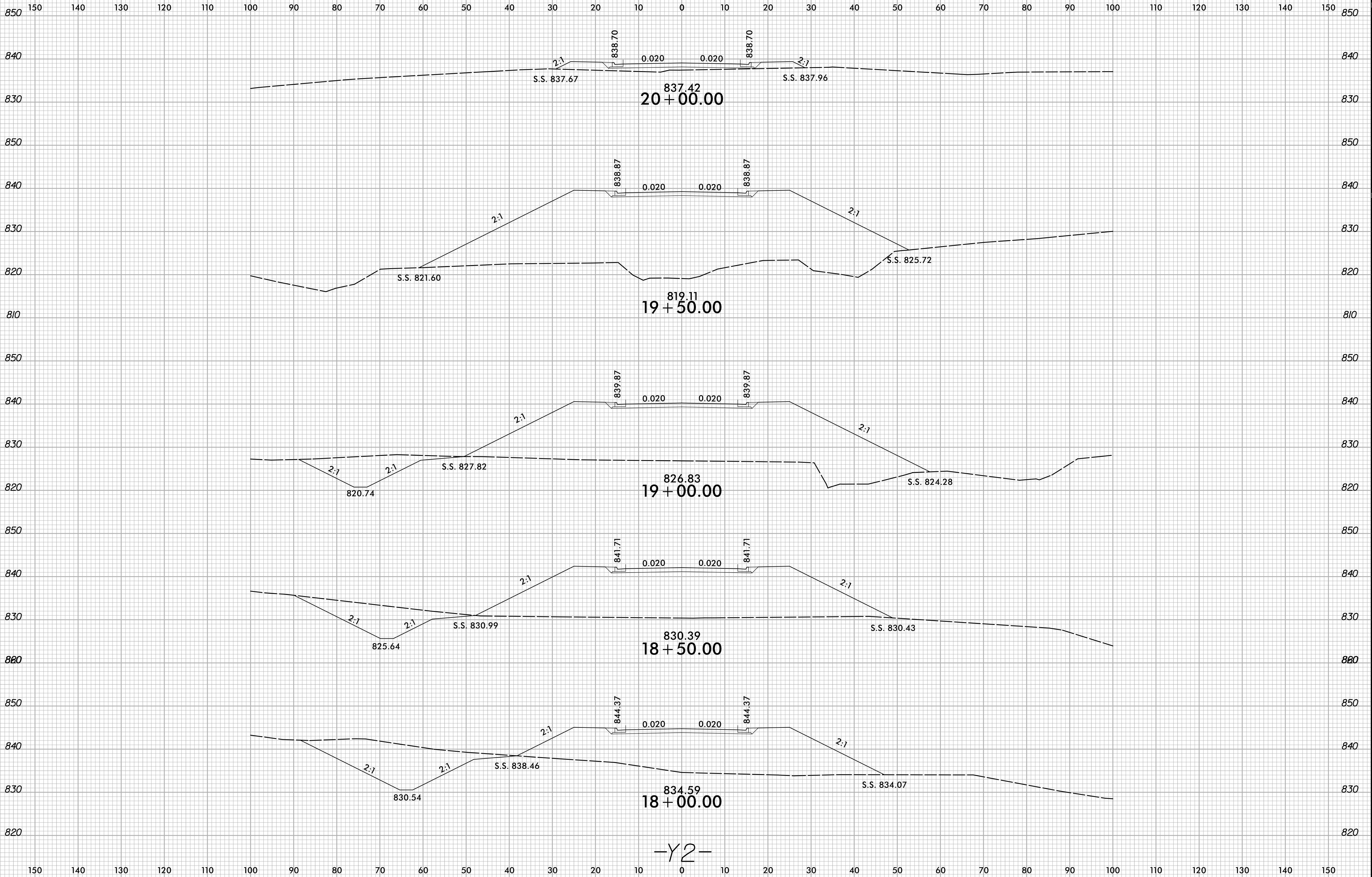

-Y2-

150 140 130 120 110 100 90 80 70 60 50 40 30 20 10 0 10 20 30 40 50 60 70 80 90 100 110 120 130 140 150

860

860

850

850

840

840

850

850

840

840

830

830

150 140 130 120 110 100 90 80 70 60 50 40 30 20 10 0 10 20 30 40 50 60 70 80 90 100 110 120 130 140 150

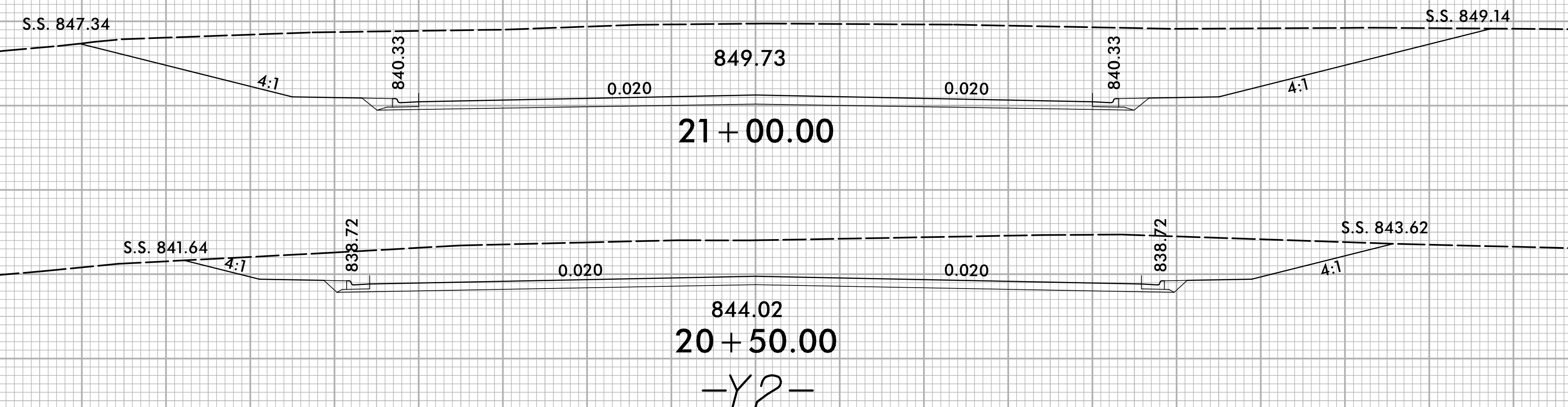

21 + 00.00

20 + 50.00

-Y2-