

**This electronic collection of documents is provided
for the convenience of the user
and is Not a Certified Document –**

**The documents contained herein were originally issued
and sealed by the individuals whose names and license
numbers appear on each page, on the dates appearing
with their signature on that page.**

**This file or an individual page
shall not be considered a certified document.**

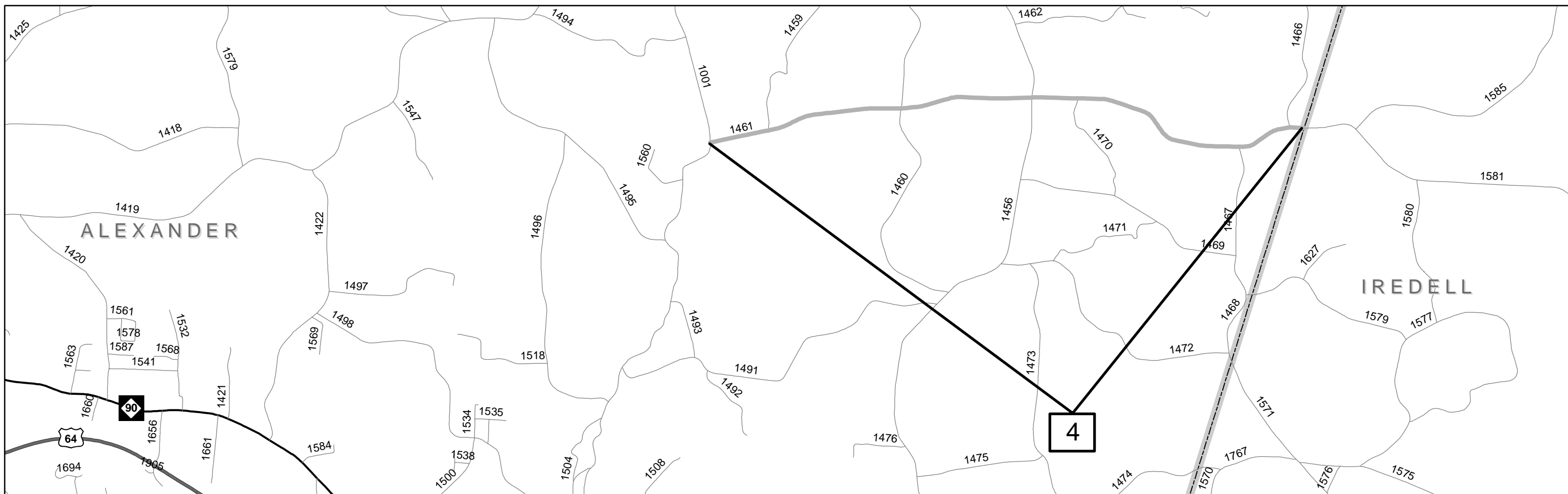

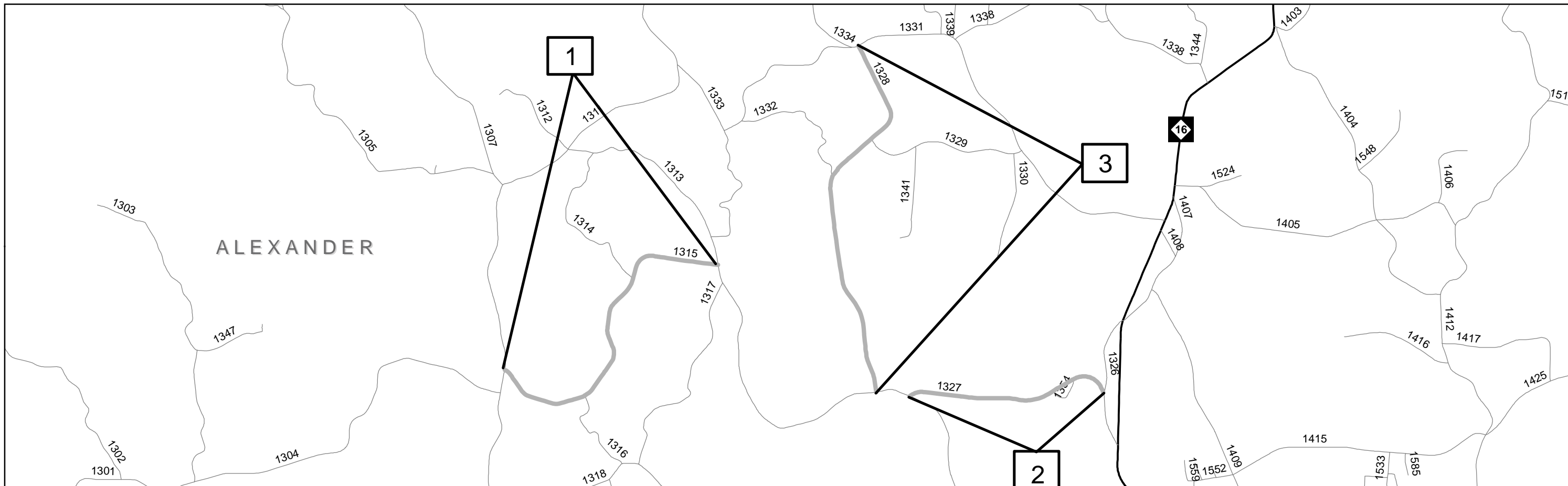
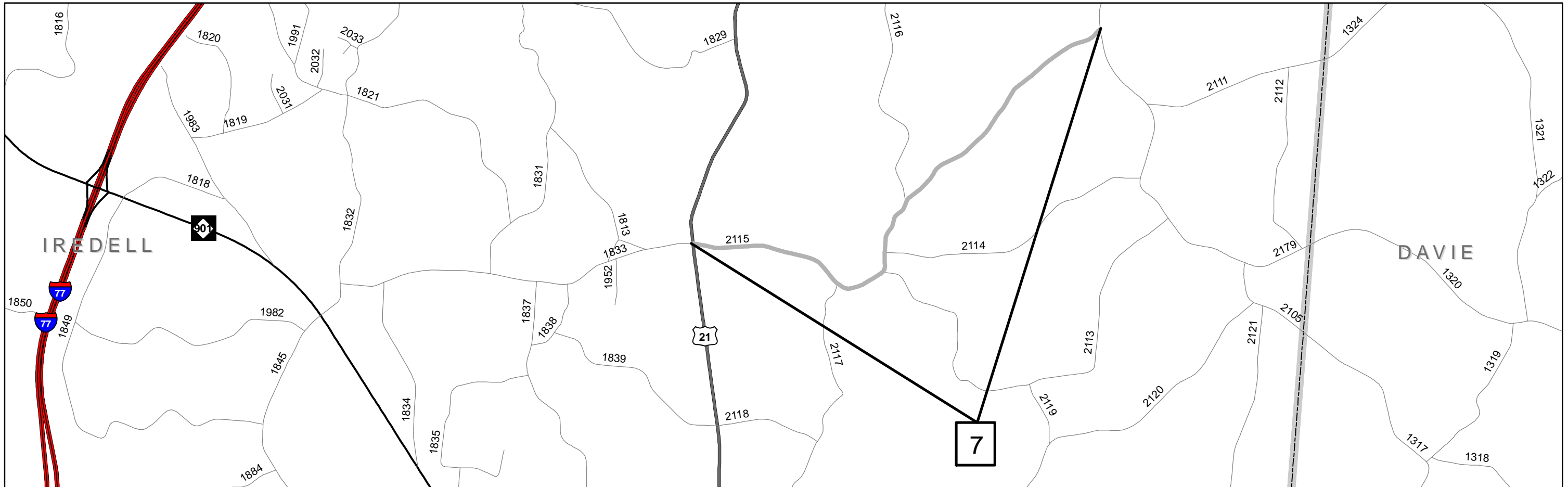
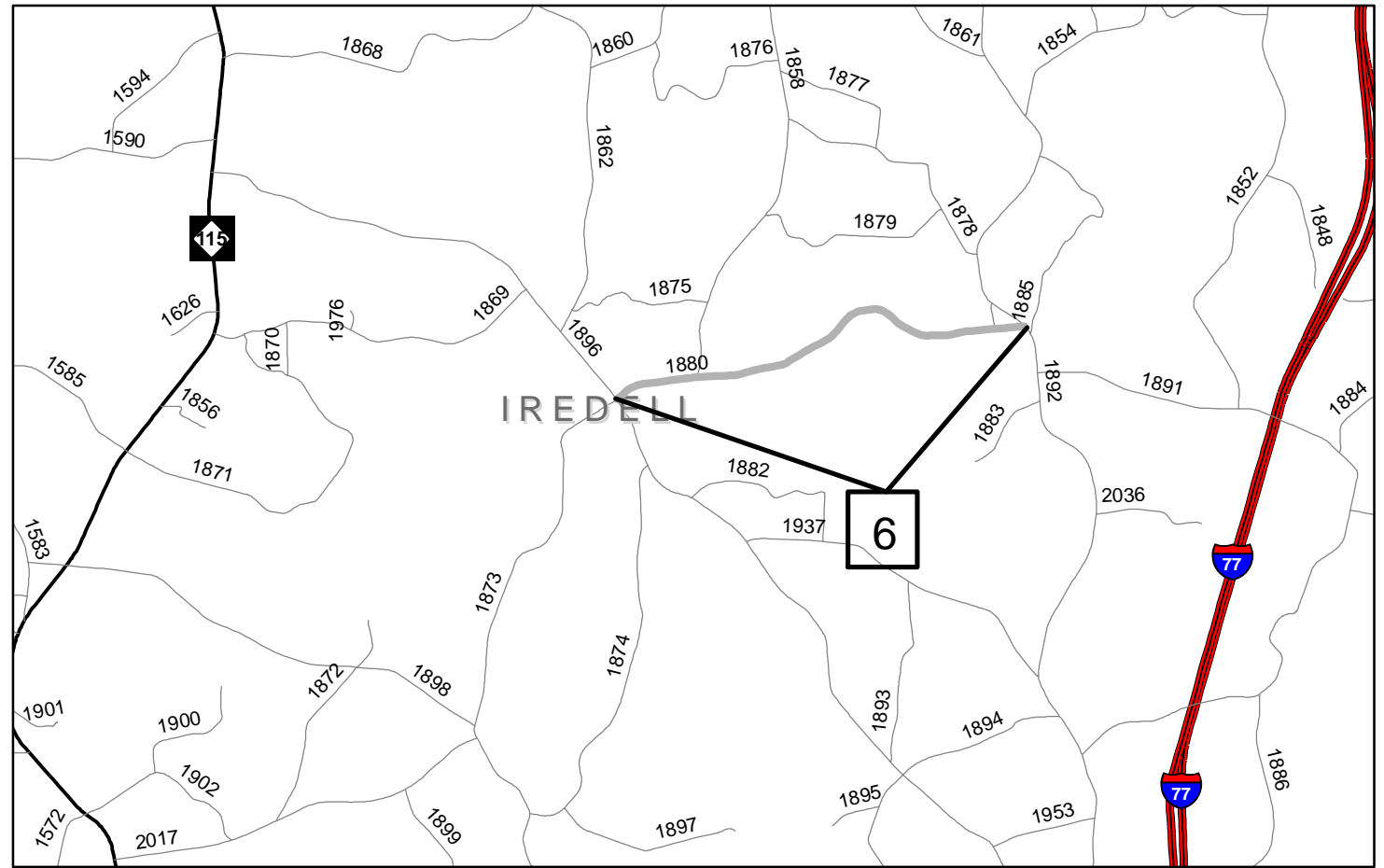
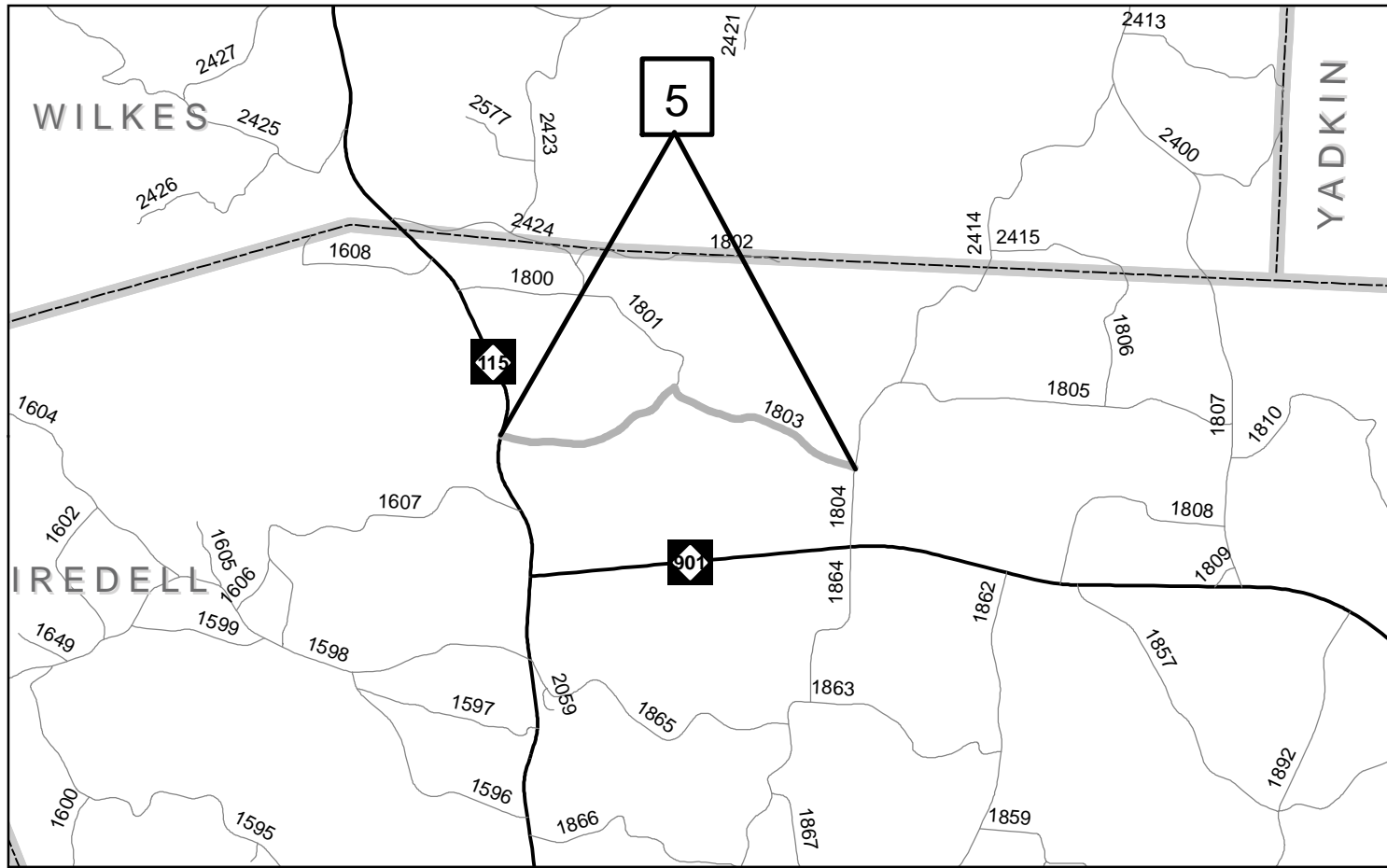

Crack Sealing Summary of Quantities

| County | Map # | SR # | Road Name | From | To | Miles | Pounds | WBS # |
|--------------------|-------|------|-----------------------|---------|-------------|--------------|---------------|---------------------|
| Alexander | 1 | 1315 | Chapman Mill Rd. | SR 1307 | SR 1313 | 2.08 | 4,205 | 2018CPT.12.20.20022 |
| Alexander | 2 | 1327 | Piney Grove Rd. | SR 1313 | SR 1326 | 1.30 | 3,295 | 2018CPT.12.20.20022 |
| Alexander | 3 | 1328 | Kirby Lackey Rd. | SR 1313 | SR 1331 | 2.42 | 3,995 | 2018CPT.12.20.20022 |
| Alexander | 4 | 1461 | Sharpe Mill Rd. | SR 1001 | Iredell Co. | 3.89 | 11,445 | 2018CPT.12.20.20022 |
| Total | | | | | | 9.69 | 22,940 | 2018CPT.12.20.20022 |
| County | Map # | SR # | Road Name | From | To | Miles | Pounds | WBS # |
| Iredell | 5 | 1803 | Fletcher Rd./Zeb Rd. | NC 115 | SR 1804 | 2.26 | 5,690 | 2018CPT.12.20.20492 |
| Iredell | 6 | 1880 | Mt. Vernon Church Rd. | SR 1892 | SR 1896 | 2.33 | 5,880 | 2018CPT.12.20.20492 |
| Iredell | 7 | 2115 | E. Houstonville Rd. | US 21 | SR 2105 | 3.48 | 10,490 | 2018CPT.12.20.20492 |
| Total | | | | | | 8.07 | 22,060 | 2018CPT.12.20.20492 |
| Grand Total | | | | | | 17.76 | 45,000 | |