

**This electronic collection of documents is provided
for the convenience of the user
and is Not a Certified Document –**

**The documents contained herein were originally issued
and sealed by the individuals whose names and license
numbers appear on each page, on the dates appearing
with their signature on that page.**

**This file or an individual page
shall not be considered a certified document.**

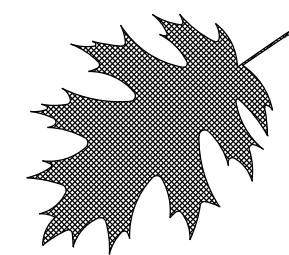

HIGHWAY LANDSCAPE DEVELOPMENT PROJECT

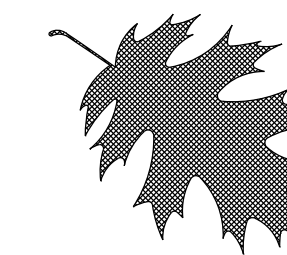

T.I.P. #	STATE PROJECT W.B.S. #	SHEET #	SHEET # TOTAL
ER-5600LB	46305.3.55	L1	6
FED. PROJ. #	DESCRIPTION		DIVISION
- - - -	Enhancement		12

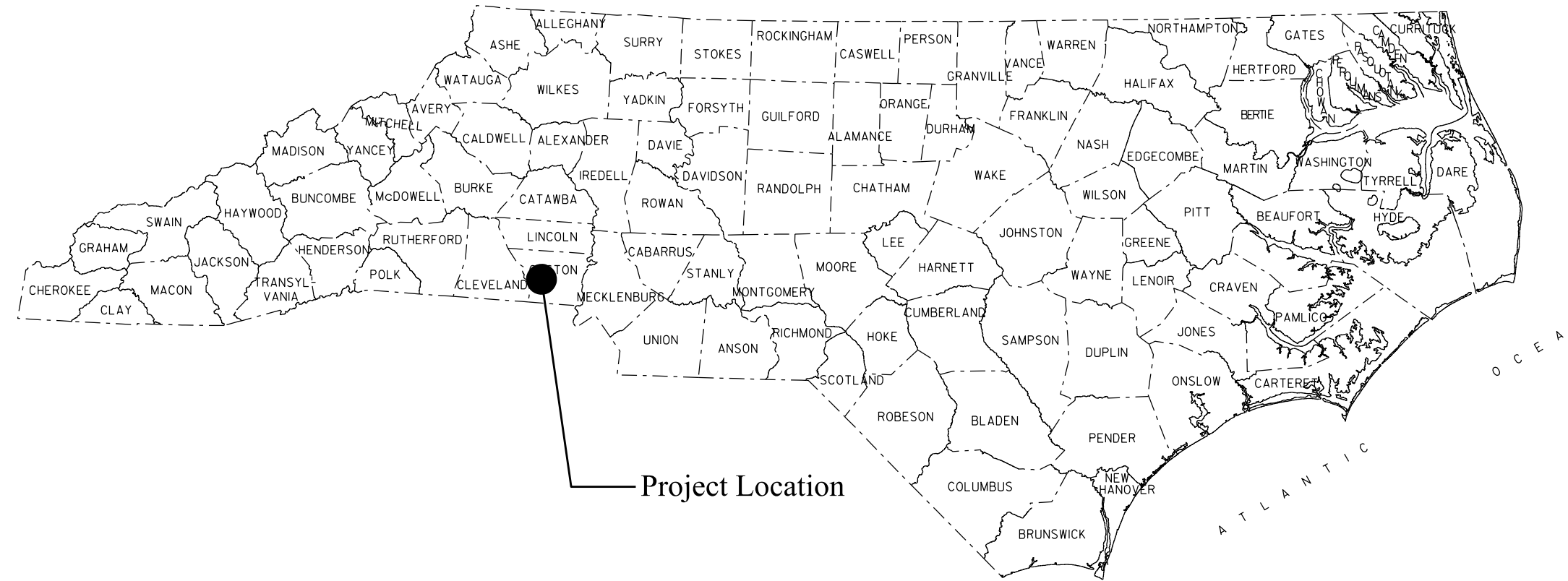
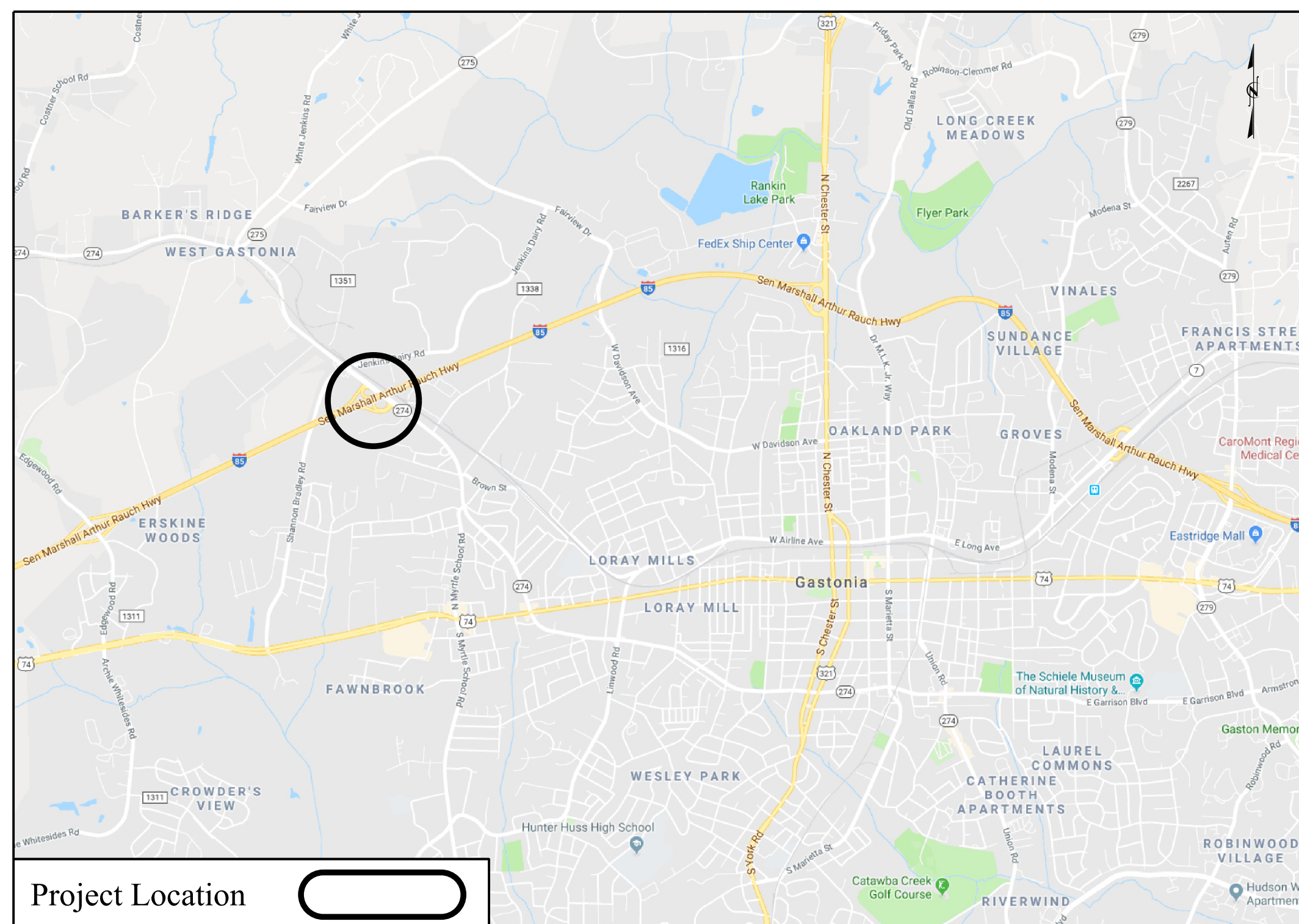

I-85 EXIT 14 IN GASTONIA

CONVENTIONAL SYMBOLS

County Line	-----
City or Town Line	-----
Exist. Right of Way Line Marker	-----▲-----
Prop. Right of Way Line Marker (By Others)	-----▲-----
Prop Right of Way Line Marker (By Contract)	-----▲-----
Exist. Control of Access Line	-----○-----
Prop. Control of Access Line	-----○-----
Property Line	-----
Easement Line	-----
Slope Stake Line	-----
Exist. Fence	-----
Prop. Woven Wire Fence	-----
Prop. Chain Link Fence	-----
Exist. Road	-----
Prop. Road	-----
Guardrail	-----
Survey Line	-----
Denotes Line Equality	-----
Bridge	-----
Culvert	-----
Railroad	-----
Woods	-----
Exist. Telephone Pole	-----
Prop. Telephone Pole	-----
Tower Pole and Line	-----
Exist. Power Pole	-----
Prop. Power Pole	-----
Sanitary Sewer Line	-----
Water Line	-----
Gas Line	-----
Picnic Shelter	-----
Regeneration	-----
Reforestation	-----

Summary of Quantities
1 Year Establishment

DES	SEC	QTY	UNIT	KEY	BOTANICAL NAME	COMMON NAME	SIZE	CALIPER	FURNISH	A.S.N.S.	REMARKS
Trees											
L	1670	4	ea	LT	<i>Lagerstroemia indica x fauriei</i> 'Tuscarora'	Tuscarora Crape Myrtle	6-7'		B&B	2.5	10.5' O.C.
L	1670	9	ea	ML	<i>Magnolia grandiflora</i> 'Little Gem'	Little Gem Southern Magnolia	7-8'		B&B	2.2	10' O.C.
Shrubs											
L	1670	38	ea	CG	<i>Chamaecyparis pisifera</i> 'Golden Mop'	Golden Mop Japanese Falsecypress	18-24"		#3 Cont.	4.6	4' O.C.
L	1670	10	ea	IB	<i>Ilex cornuta</i> 'Burfordii Nana'	Dwarf Burford Holly	24-30"		#7 Cont.	5.7	6' O.C.
L	1670	178	ea	LC	<i>Loropetalum chinense</i> 'Ruby'	Ruby Chinese Fringe Flower	18-24"		#3 Cont.	5.7	4' O.C.
L	1670	58	ea	RR	<i>Rosa</i> 'Radtko'	The Double Knockout Rose	18-24"		#3 Cont.	6.3	4.5' O.C.
Grasses/Groundcovers/Perennials											
L	1670	1701	ea	HB	<i>Hemerocallis</i> 'Buttered Popcorn'	Buttered Popcorn Daylily	6-12"		#1 Cont.	13.2.3	2' O.C.
L	1670	1672	ea	HO	<i>Hemerocallis</i> 'Orange Vols' [Leebea Orange Crush]	Orange Vols Daylily [Leebea Orange Crush]	6-12"		#1 Cont.	13.2.3	2' O.C.
L	1670	175	ea	SA	<i>Sedum spectabile</i> 'Autumn Joy'	Autumn Joy Sedum	6-12"		#1 Cont.	13.3	2' O.C.
Other Vegetation Costs											
L	1670	726	sy		Existing Vegetation removal						
L	1670	299	cy		Mulch for Planting						4" Depth
L	1670	28	m/g		Water for Planting						
L	1670	2719	sy		Pre emergence Herbicidal Treatment						
L	1670	2719	sy		Post emergence Herbicidal Treatment						
L	1670	12	ea		Monthly Maintenance						
[] - Alternative Plant Option											

INDEX OF L SHEETS:

- L 1.0 - Title Sheet
- L 2.0 - Planting Details
- L 3.0 - Demolition Plan
- L 4.0 - Planting Plan Key
- L 5.0 - Planting Plan A
- L 6.0 - Planting Plan B

PREPARED BY: KC DATE:08/21/2018

REVISIONS

DATE	DESCRIPTION

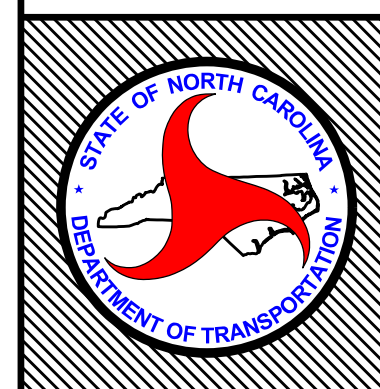

STATE OF
NORTH CAROLINA
DEPARTMENT OF TRANSPORTATION





LOCATION: I-85 Exit 14 in Gastonia

TYPE of WORK: Enhancement

COUNTY: Gaston County

2014 American Standard for Nursery Stock
2018 NCDOT STANDARD SPECIFICATIONS
PREPARED IN THE OFFICE OF:
NCDOT- ROADSIDE ENVIRONMENTAL UNIT
AESTHETIC ENGINEERING SECTION
1557 MAIL SERVICE CENTER
RALEIGH NC 27699 919-707-2920

NOTES:

-  SCHEDULE FOR PLANT HOLE SIZE: PLANT HOLE WIDTH (X) TO BE TWICE THE ROOT BALL SIZE OR CONTAINER DIAMETER.
-  SEE STANDARD SPECIFICATIONS FOR PLANT BED FUMIGATION AND HERBICIDAL TREATMENT.
-  APPLY FERTILIZER AT PLANTING TIME IN THE FORM OF A SLOW RELEASE PELLET OR TABLET. APPLY AT RATE RECOMMENDED BY MANUFACTURER. BOTH RATE AND FORMULATION MUST BE APPROVED BY FIELD ENGINEER PRIOR TO APPLICATION.
-  REMOVE WIRE BASKET AND FOLD BURLAP BACK FROM TOP OF ROOT BALL BEFORE BACKFILLING IS COMPLETE.
-  ALL PRUNING TO FOLLOW STANDARD ARBORICULTURAL PRACTICES AS SPECIFIED BY INTERNATIONAL SOCIETY OF ARBORICULTURE.
-  DO NOT ATTEMPT TO STRAIGHTEN A TREE THAT HAS BEEN PLANTED AT AN ANGLE WITH THE USE OF STAKING OR GUYING. DIG TREE AND REPLANT TO UPRIGHT POSITION.

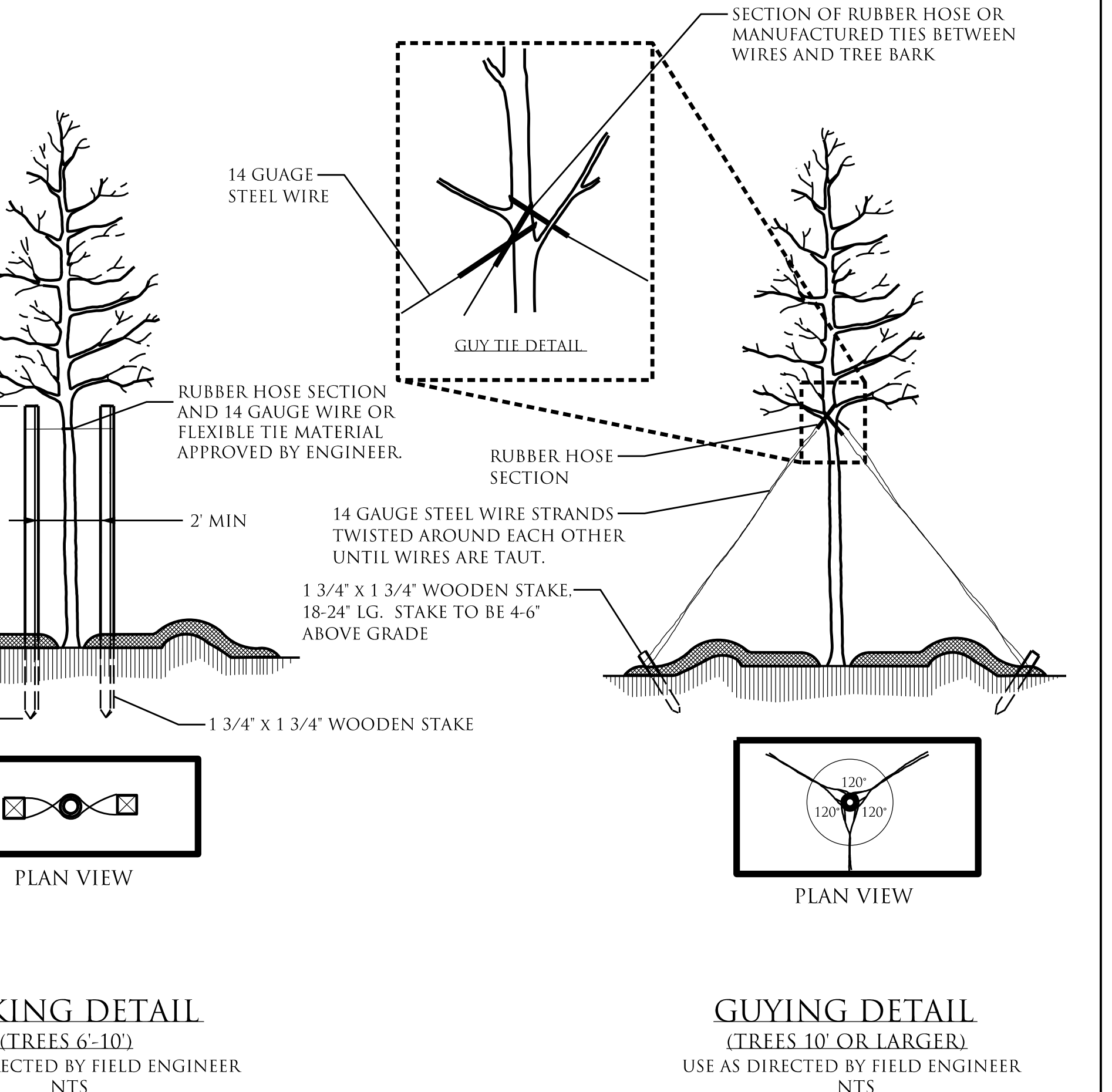
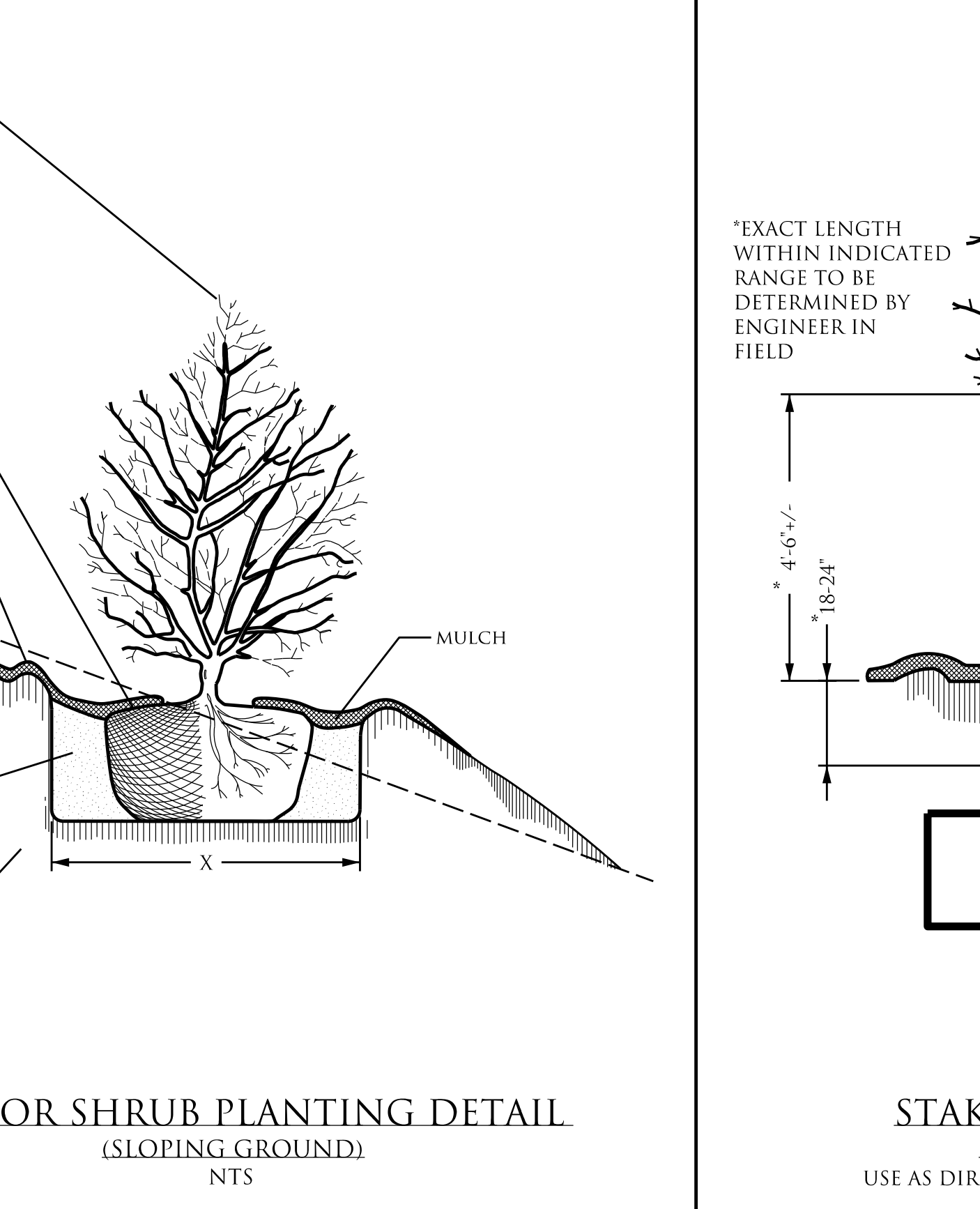
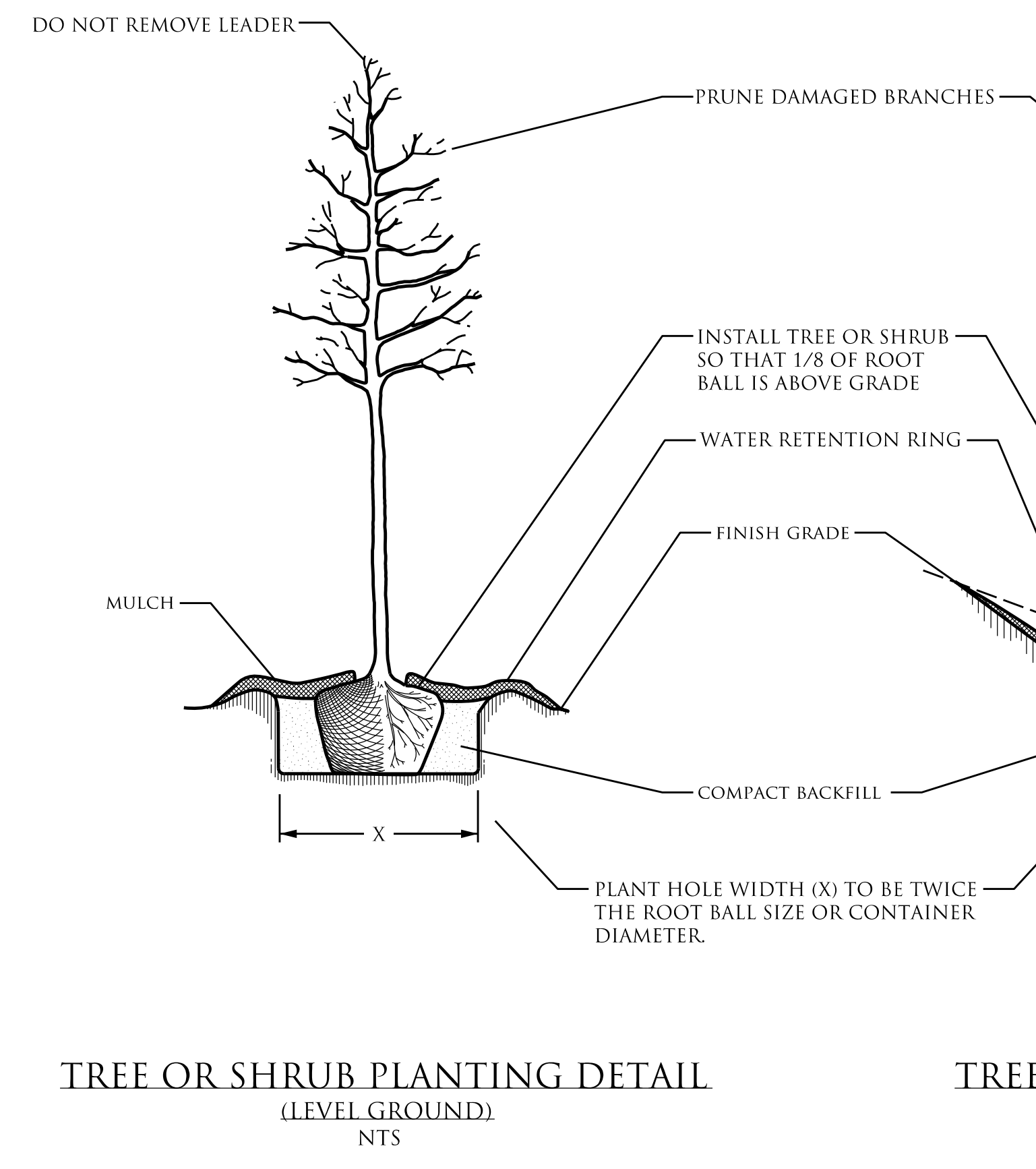
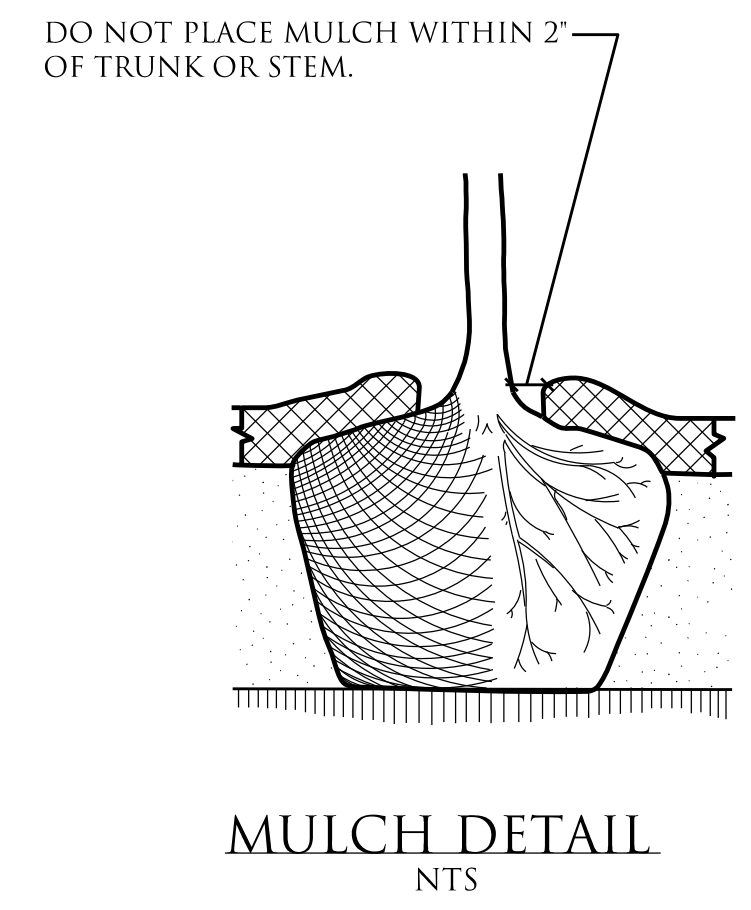
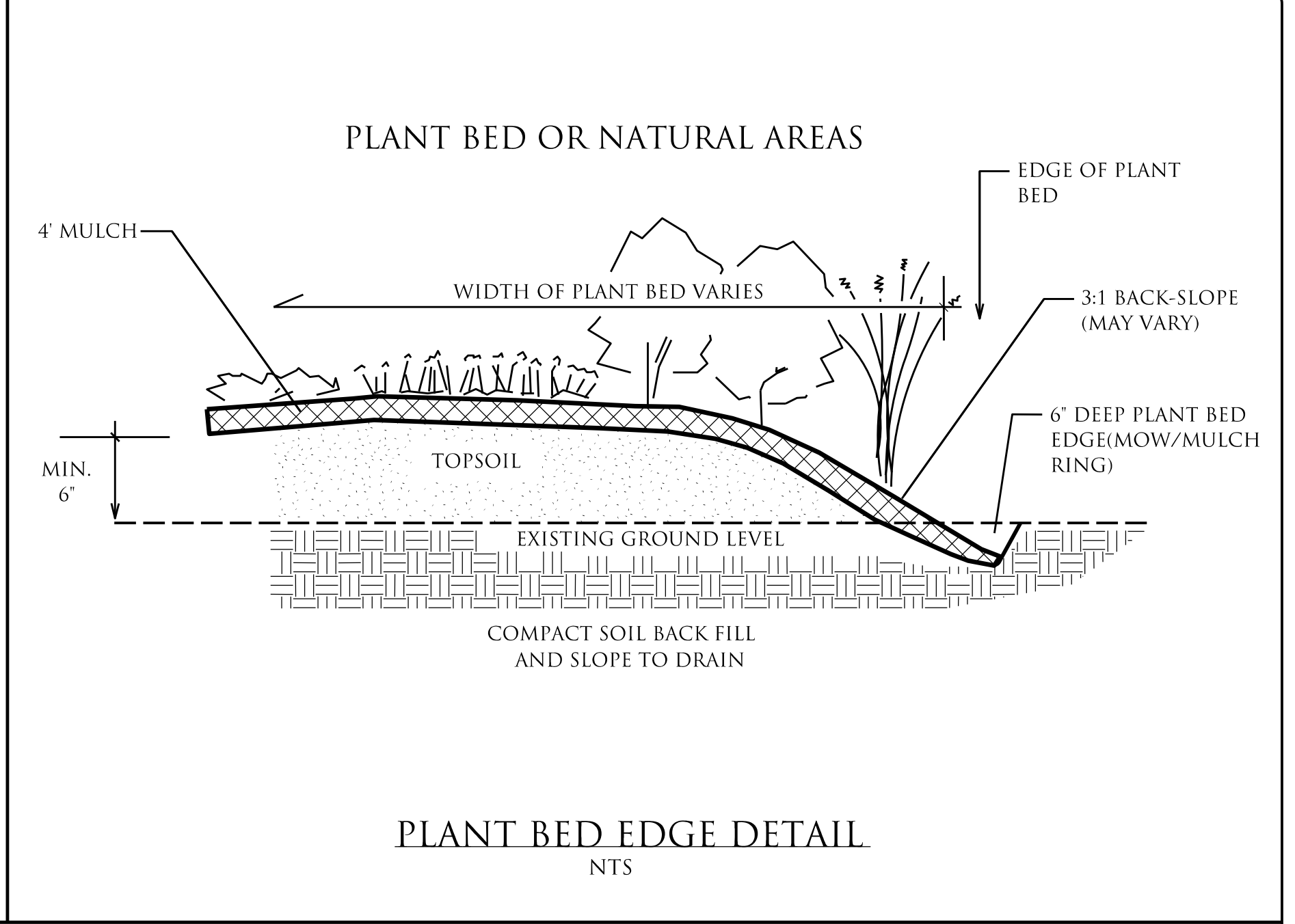
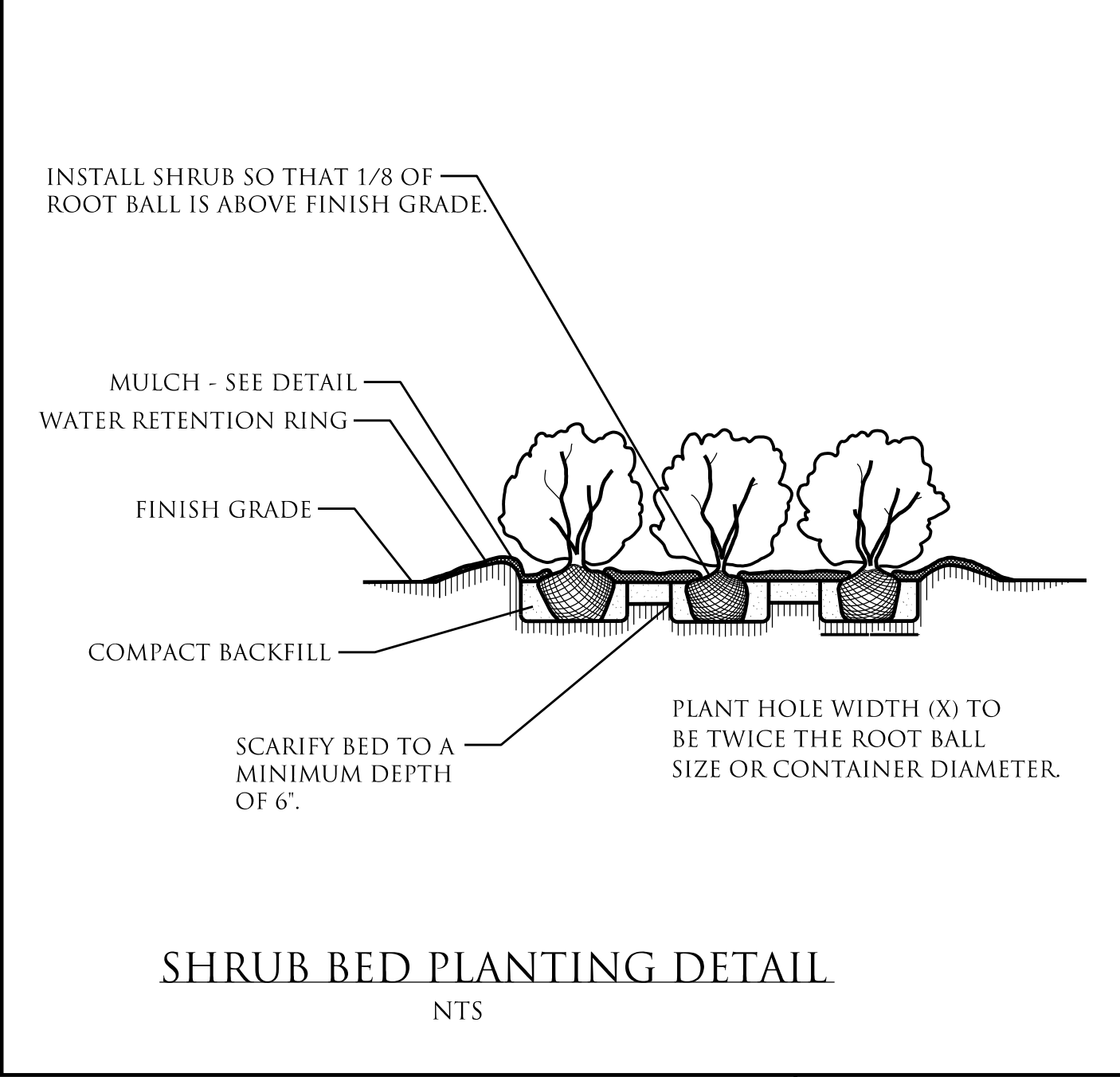
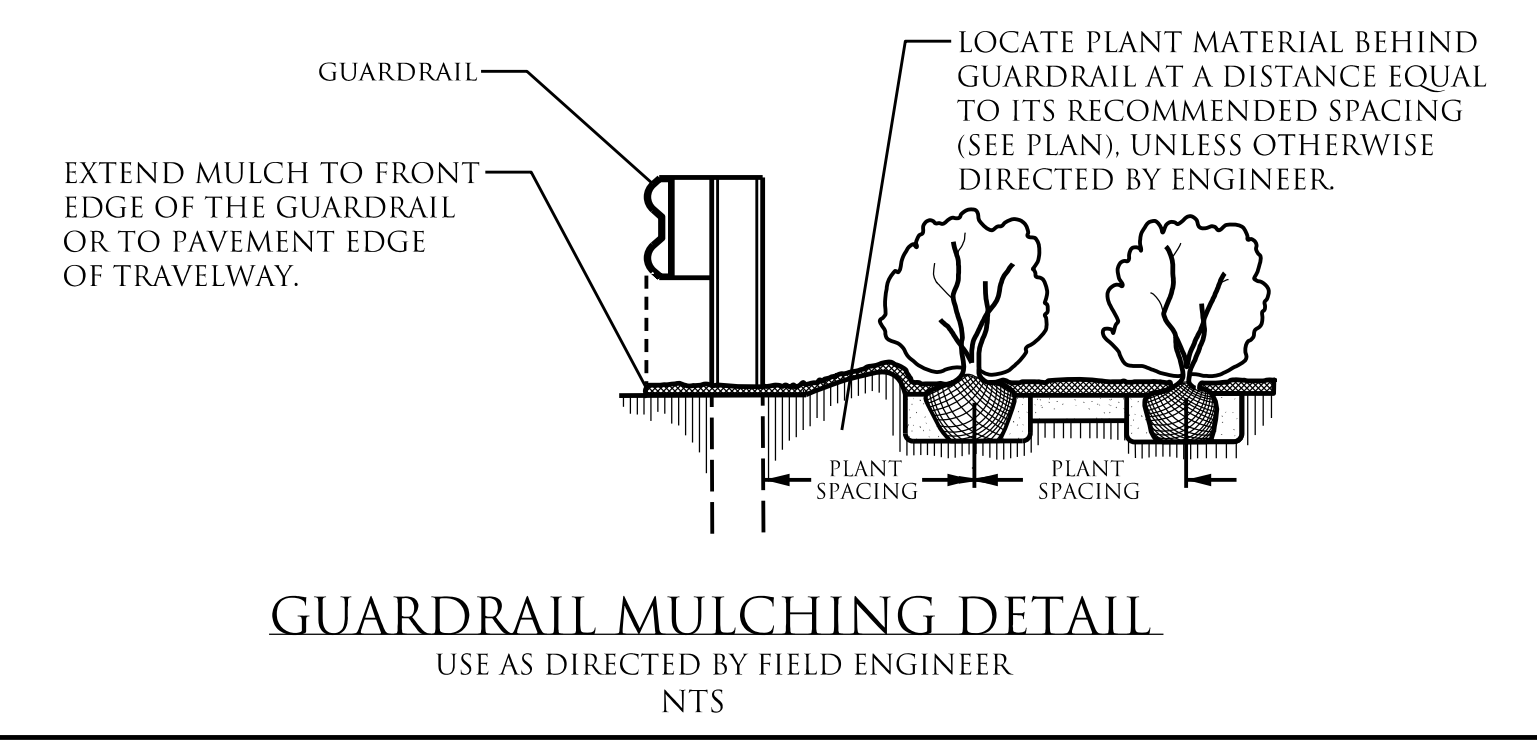
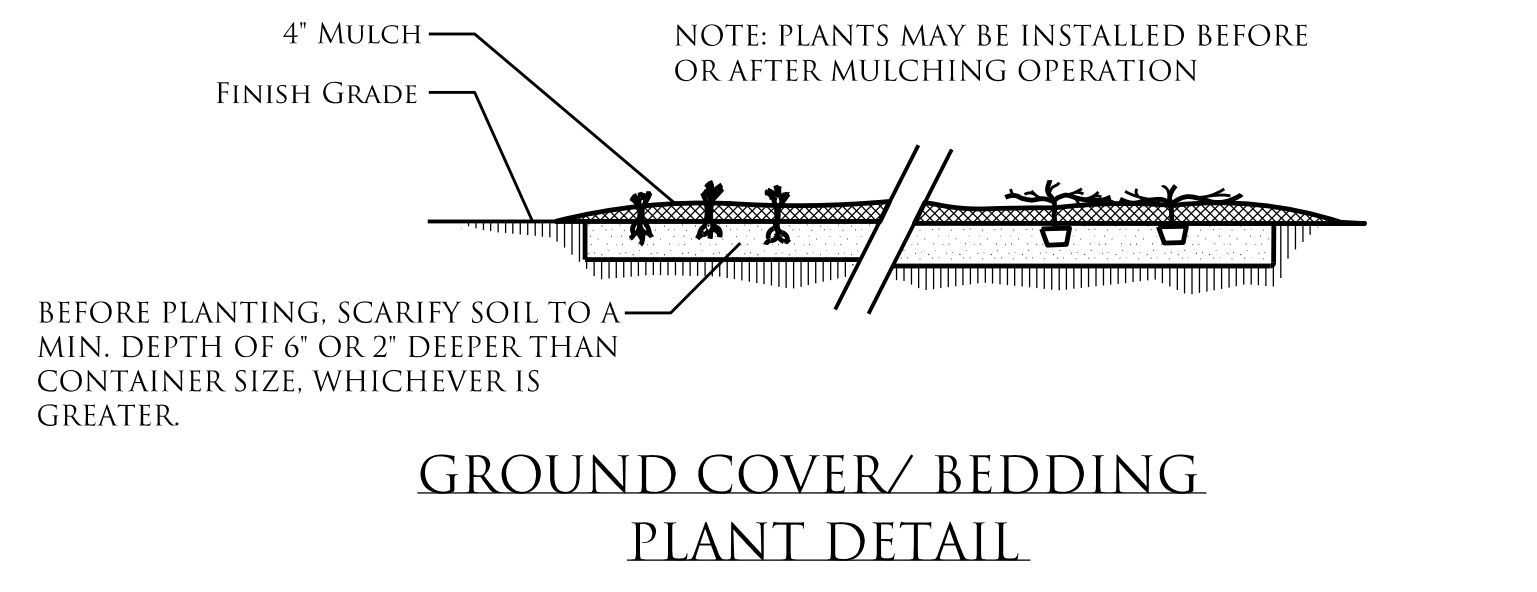

NCDOT - ROADSIDE ENVIRONMENTAL UNIT
 LANDSCAPE DESIGN & DEVELOPMENT
 1557 MAIL SERVICE CENTER RALEIGH NC 27699-1557
 PH: 919-707-2935 FAX: 919-715-2554
[HTTP://WWW.NCDOT.ORG/DOH/OPERATIONS/DP_CHIEF_ENG/ROADSIDE/](http://www.ncdot.org/DOH/OPERATIONS/DP_CHIEF_ENG/ROADSIDE/)

I-85 EXIT 14 IN GASTONIA
 GASTON COUNTY
 WBS #: 46305.3.55

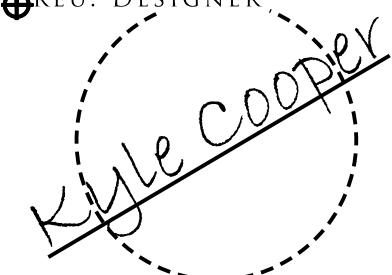
DESIGNER

PREL. DESIGN DATE: JULY 25, 2018
 CHECKED BY & DATE: _____
 FINAL DESIGN DATE: AUG. 21, 2018

PLANTING DETAILS
 LANDSCAPE PLAN SHEET

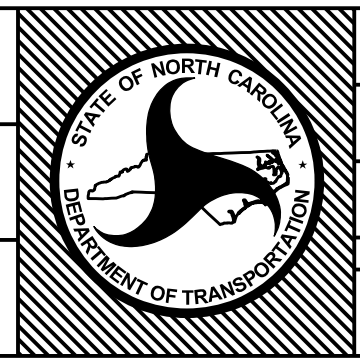

T.I.P. # ER-5600LB
 WBS # 46305.3.55
 FED I.D. # _____
 SHEET NO.: L-2 TOTAL SHEET NO.: L-6

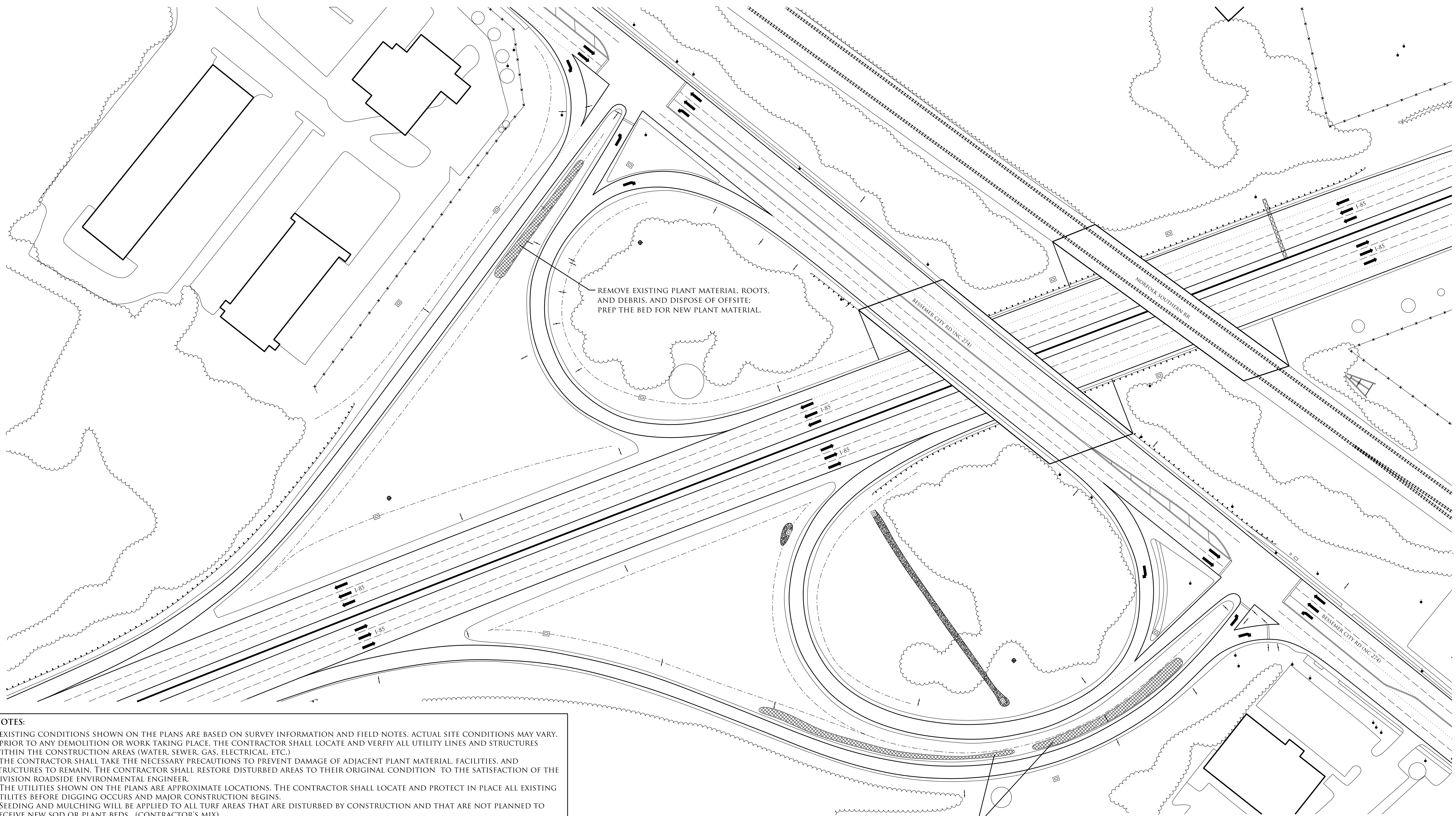

NOTES:

- EXISTING CONDITIONS SHOWN ON THE PLANS ARE BASED ON SURVEY INFORMATION AND FIELD NOTES. ACTUAL SITE CONDITIONS MAY VARY.
- PRIOR TO ANY DEMOLITION OR WORK TAKING PLACE, THE CONTRACTOR SHALL LOCATE AND VERIFY ALL UTILITY LINES AND STRUCTURES WITHIN THE CONSTRUCTION AREAS (WATER, SEWER, GAS, ELECTRICAL, ETC.)
- THE CONTRACTOR SHALL TAKE THE NECESSARY PRECAUTIONS TO PREVENT DAMAGE OF ADJACENT PLANT MATERIAL, FACILITIES, AND STRUCTURES TO REMAIN. THE CONTRACTOR SHALL RESTORE DISTURBED AREAS TO THEIR ORIGINAL CONDITION TO THE SATISFACTION OF THE DIVISION ROADSIDE ENVIRONMENTAL ENGINEER.
- THE UTILITIES SHOWN ON THE PLANS ARE APPROXIMATE LOCATIONS. THE CONTRACTOR SHALL LOCATE AND PROTECT IN PLACE ALL EXISTING UTILITIES BEFORE DIGGING OCCURS AND MAJOR CONSTRUCTION BEGINS.
- SEEDING AND MULCHING WILL BE APPLIED TO ALL TURF AREAS THAT ARE DISTURBED BY CONSTRUCTION AND THAT ARE NOT PLANNED TO RECEIVE NEW SOD OR PLANT BEDS. (CONTRACTOR'S MIX).
- DEMOLITION, REMOVAL, AND DISPOSAL OF ITEMS FROM THE SITE MUST BE COMPLETELY IN ACCORDANCE WITH THE LAW. THE CONTRACTOR IS RESPONSIBLE FOR MAKING A SITE VISIT TO DETERMINE AND VERIFY ALL DEMOLITION REQUIREMENTS PRIOR TO BIDDING.

REMOVE EXISTING PLANT MATERIAL, ROOTS, AND DEBRIS, AND DISPOSE OF OFFSITE; PREP THE BED FOR NEW PLANT MATERIAL.

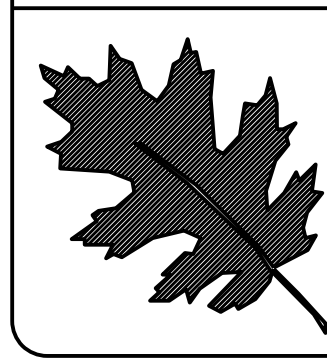

NCDOT - ROADSIDE ENVIRONMENTAL UNIT
 LANDSCAPE DESIGN & DEVELOPMENT
 1557 MAIL SERVICE CENTER RALEIGH NC 27699-1557
 PH: 919-707-2935 FAX: 919-715-2554
[HTTP://WWW.NCDOT.ORG/DOH/OPERATIONS/DP_CHIEF_ENG/ROADSIDE/](http://www.ncdot.org/DOH/OPERATIONS/DP_CHIEF_ENG/ROADSIDE/)

I-85 EXIT 14 IN GASTONIA
 GASTON COUNTY
 WBS #: 46305.3.55

REV. DESIGNER
Kyle Corder

SHEET DESCRIPTION:	PREL. DESIGN DATE:	JULY 25, 2018
	CHECKED BY & DATE:	---
	FINAL DESIGN DATE:	AUG. 21, 2018

DEMOLITION PLAN
 LANDSCAPE PLAN SHEET

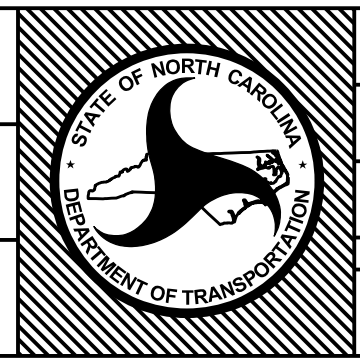

T.I.P. #	ER-5600LB
WBS #	46305.3.55
FED I.D. #	
SHEET NO.:	TOTAL SHEET NO.:
L-3	L-6

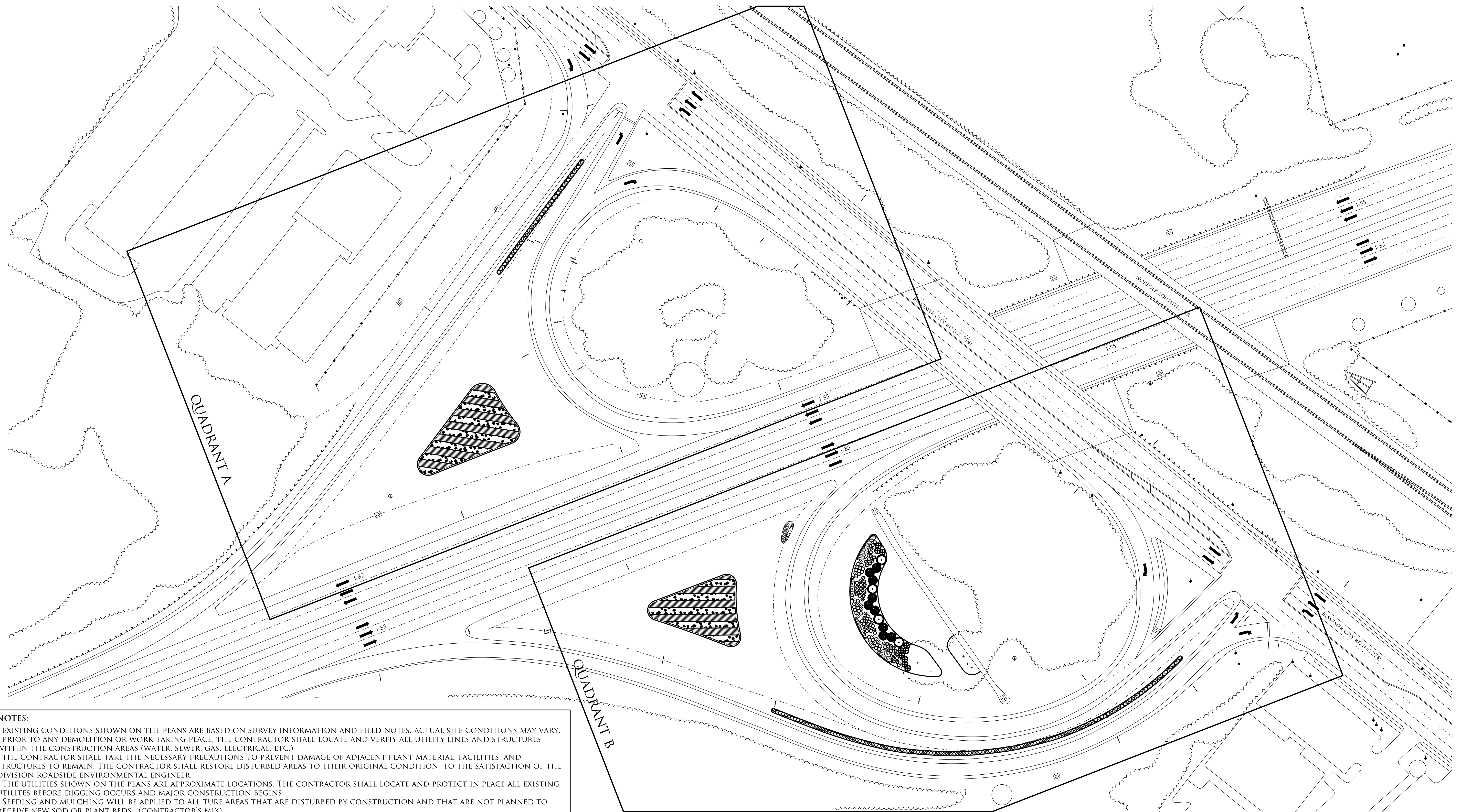

NOTES:

- EXISTING CONDITIONS SHOWN ON THE PLANS ARE BASED ON SURVEY INFORMATION AND FIELD NOTES. ACTUAL SITE CONDITIONS MAY VARY.
- PRIOR TO ANY DEMOLITION OR WORK TAKING PLACE, THE CONTRACTOR SHALL LOCATE AND VERIFY ALL UTILITY LINES AND STRUCTURES WITHIN THE CONSTRUCTION AREAS (WATER, SEWER, GAS, ELECTRICAL, ETC.)
- THE CONTRACTOR SHALL TAKE THE NECESSARY PRECAUTIONS TO PREVENT DAMAGE OF ADJACENT PLANT MATERIAL, FACILITIES, AND STRUCTURES TO REMAIN. THE CONTRACTOR SHALL RESTORE DISTURBED AREAS TO THEIR ORIGINAL CONDITION TO THE SATISFACTION OF THE DIVISION ROADSIDE ENVIRONMENTAL ENGINEER.
- THE UTILITIES SHOWN ON THE PLANS ARE APPROXIMATE LOCATIONS. THE CONTRACTOR SHALL LOCATE AND PROTECT IN PLACE ALL EXISTING UTILITIES BEFORE DIGGING OCCURS AND MAJOR CONSTRUCTION BEGINS.
- SEEDING AND MULCHING WILL BE APPLIED TO ALL TURF AREAS THAT ARE DISTURBED BY CONSTRUCTION AND THAT ARE NOT PLANNED TO RECEIVE NEW SOD OR PLANT BEDS. (CONTRACTOR'S MIX).
- DEMOLITION, REMOVAL, AND DISPOSAL OF ITEMS FROM THE SITE MUST BE COMPLETELY IN ACCORDANCE WITH THE LAW. THE CONTRACTOR IS RESPONSIBLE FOR MAKING A SITE VISIT TO DETERMINE AND VERIFY ALL DEMOLITION REQUIREMENTS PRIOR TO BIDDING.

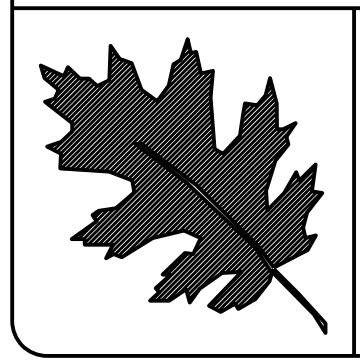

NCDOT - ROADSIDE ENVIRONMENTAL UNIT
 LANDSCAPE DESIGN & DEVELOPMENT
 1557 MAIL SERVICE CENTER RALEIGH NC 27699-1557
 PH: 919-707-2935 FAX: 919-715-2554
[HTTP://WWW.NCDOT.ORG/DOH/OPERATIONS/DP_CHIEF_ENG/ROADSIDE/](http://www.ncdot.org/DOH/OPERATIONS/DP_CHIEF_ENG/ROADSIDE/)

I-85 EXIT 14 IN GASTONIA
 GASTON COUNTY
 WBS #: 46305.3.55

REV. DESIGNER
Kyle Corder

SHEET DESCRIPTION:	PREL. DESIGN DATE:	JULY 25, 2018
	CHECKED BY & DATE:	---
	FINAL DESIGN DATE:	AUG. 21, 2018

PLANTING PLAN KEY
LANDSCAPE PLAN SHEET

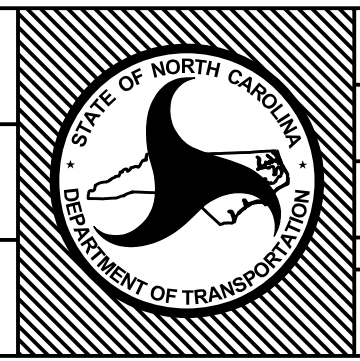

T.I.P. #	ER-5600LB
WBS #	46305.3.55
FED I.D. #	
SHEET NO.:	TOTAL SHEET NO.:
L-4	L-6

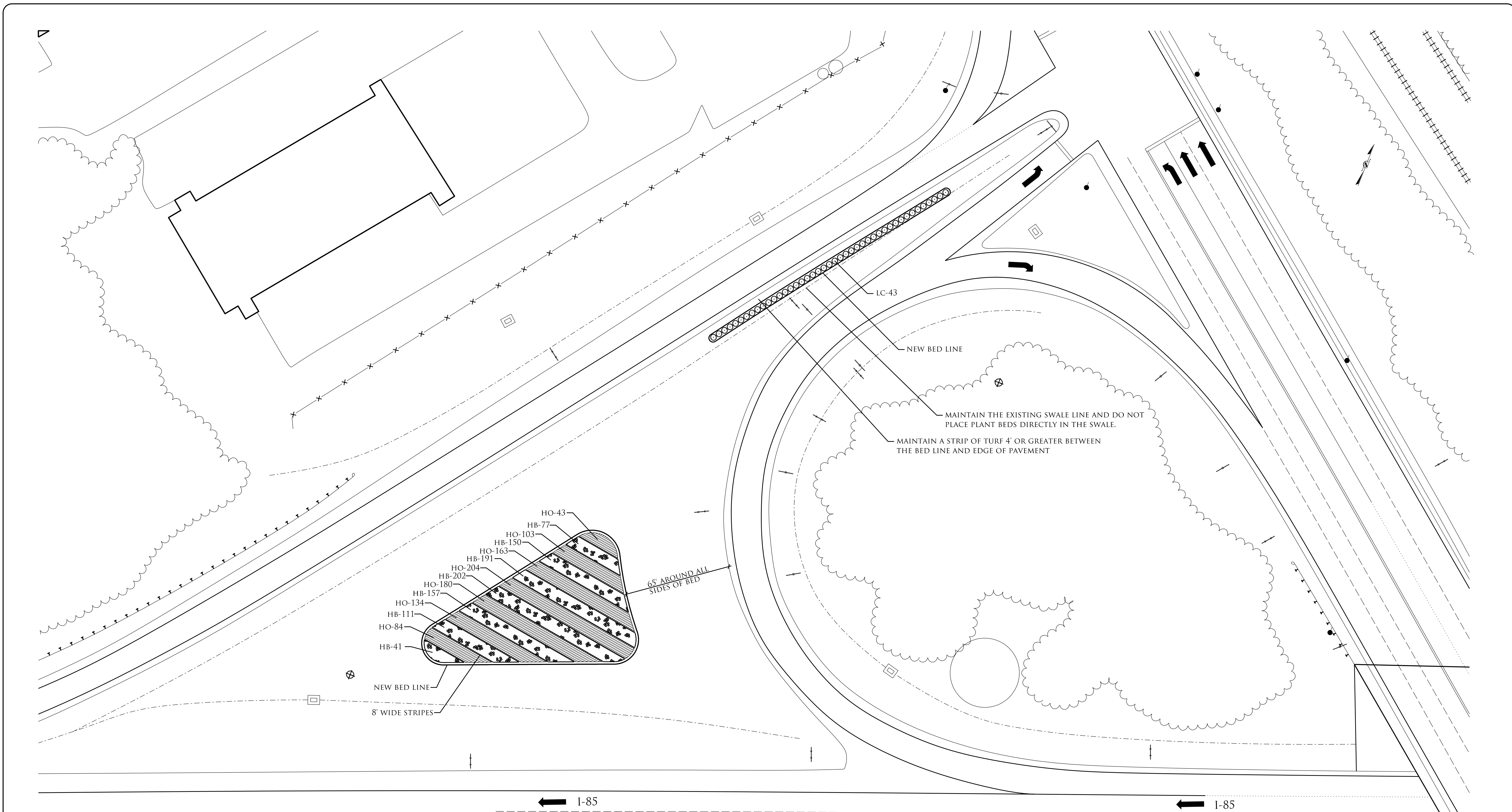

QTY	KEY	BOTANICAL NAME	COMMON NAME	SPACING
43	LC	LOROPETALUM CHINENSE 'RUBY'	RUBY CHINESE FRINGE FLOWER	4' O.C.
929	HB	HEMEROCALLIS 'BUTTERED POPCORN'	BUTTERED POPCORN DAYLILY	2' O.C.
911	HO	HEMEROCALLIS 'ORANGE VOIS' ['LEESEA ORANGE CRUSH']	ORANGE VOIS DAYLILY ['LEESEA ORANGE CRUSH']	2' O.C.

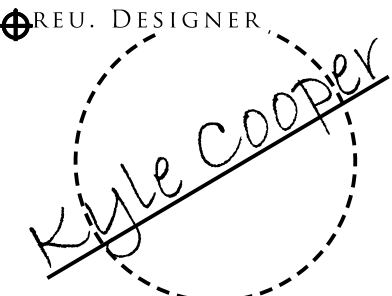

 NCDOT - ROADSIDE ENVIRONMENTAL UNIT
 LANDSCAPE DESIGN & DEVELOPMENT
 1557 MAIL SERVICE CENTER RALEIGH NC 27699-1557
 PH: 919-707-2935 FAX: 919-715-2554
[HTTP://WWW.NCDOT.ORG/DOH/OPERATIONS/DP_CHIEF_ENG/ROADSIDE/](http://www.ncdot.org/DOH/OPERATIONS/DP_CHIEF_ENG/ROADSIDE/)

I-85 EXIT 14 IN GASTONIA
GASTON COUNTY
WBS #: 46305.3.55

REU. DESIGNER

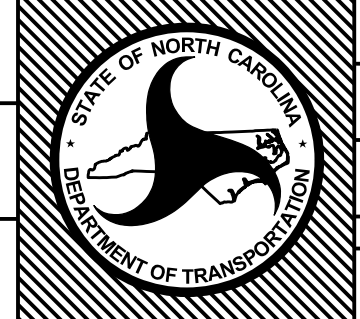
SHEET DESCRIPTION:	PREL. DESIGN DATE:	JULY 25, 2018	PLANTING PLAN
	CHECKED BY & DATE:	---	QUADRANT A
	FINAL DESIGN DATE:	AUG. 21, 2018	LANDSCAPE PLAN SHEET

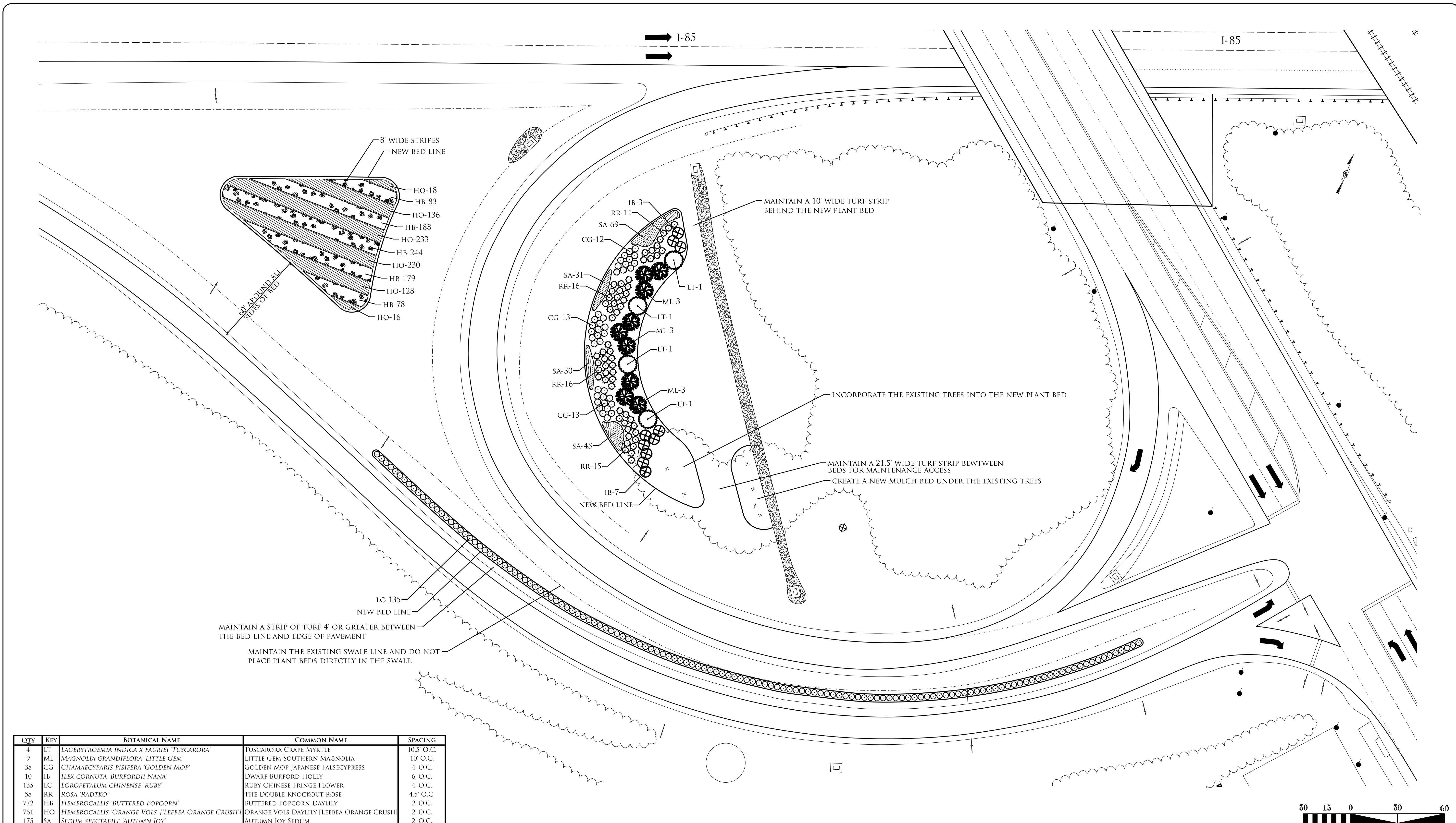
	T.I.P. #	ER-5600LB
	WBS #	46305.3.55
	FED I.D. #	
SHEET NO.:	TOTAL SHEET NO.:	
L-5	L-6	



QTY	KEY	BOTANICAL NAME	COMMON NAME	SPACING
4	LT	LAGERSTROEMIA INDICA X FAURIEI 'TUSCARORA'	TUSCARORA CRAPE MYRTLE	10.5' O.C.
9	ML	MAGNOLIA GRANDIFLORA 'LITTLE GEM'	LITTLE GEM SOUTHERN MAGNOLIA	10' O.C.
38	CG	CHAMAECYPARIS PISIFERA 'GOLDEN MOP'	GOLDEN MOP JAPANESE FALSECYPRESS	4' O.C.
10	IB	ILEX CORNUTA 'BURFORDII NANA'	DWARF BURFORD HOLLY	6' O.C.
135	LC	LOROPETALUM CHINENSE 'RUBY'	RUBY CHINESE FRINGE FLOWER	4' O.C.
58	RR	ROSA 'RADTKO'	THE DOUBLE KNOCKOUT ROSE	4.5' O.C.
772	HB	HEMEROCALLIS 'BUTTERED POPCORN'	BUTTERED POPCORN DAYLILY	2' O.C.
761	HO	HEMEROCALLIS 'ORANGE VOLS' ['LEEBEA ORANGE CRUSH']	ORANGE VOLS DAYLILY [LEEBEA ORANGE CRUSH]	2' O.C.
175	SA	SEDUM SPECTABILE 'AUTUMN JOY'	AUTUMN JOY SEDUM	2' O.C.

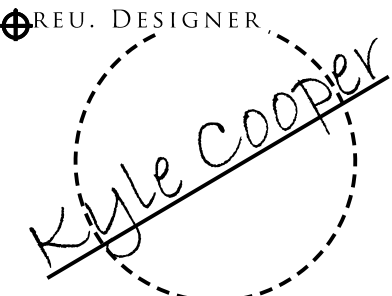

 NCDOT - ROADSIDE ENVIRONMENTAL UNIT
 LANDSCAPE DESIGN & DEVELOPMENT
 1557 MAIL SERVICE CENTER RALEIGH NC 27699-1557
 PH: 919-707-2935 FAX: 919-715-2554
[HTTP://WWW.NCDOT.ORG/DOH/OPERATIONS/DP_CHIEF_ENG/ROADSIDE/](http://www.ncdot.org/doh/operations/dp_chief_eng/roadside/)

I-85 EXIT 14 IN GASTONIA
GASTON COUNTY
WBS #: 46305.3.55

REU. DESIGNER

SHEET DESCRIPTION:
 PREL. DESIGN DATE: JULY 25, 2018
 CHECKED BY & DATE: _____
 FINAL DESIGN DATE: AUG. 21, 2018

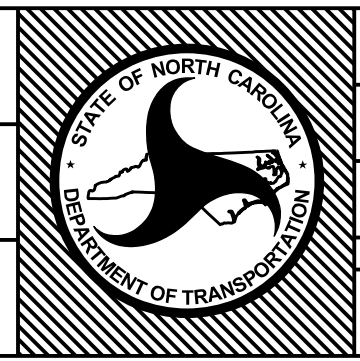
PLANTING PLAN
 QUADRANT B
 LANDSCAPE PLAN SHEET



T.I.P. # ER-5600LB
 WBS # 46305.3.55
 FED I.D. # _____
 SHEET NO.: **L-6** / TOTAL SHEET NO.: **L-6**