

**This electronic collection of documents is provided  
for the convenience of the user  
and is Not a Certified Document –**

**The documents contained herein were originally issued  
and sealed by the individuals whose names and license  
numbers appear on each page, on the dates appearing  
with their signature on that page.**

**This file or an individual page  
shall not be considered a certified document.**

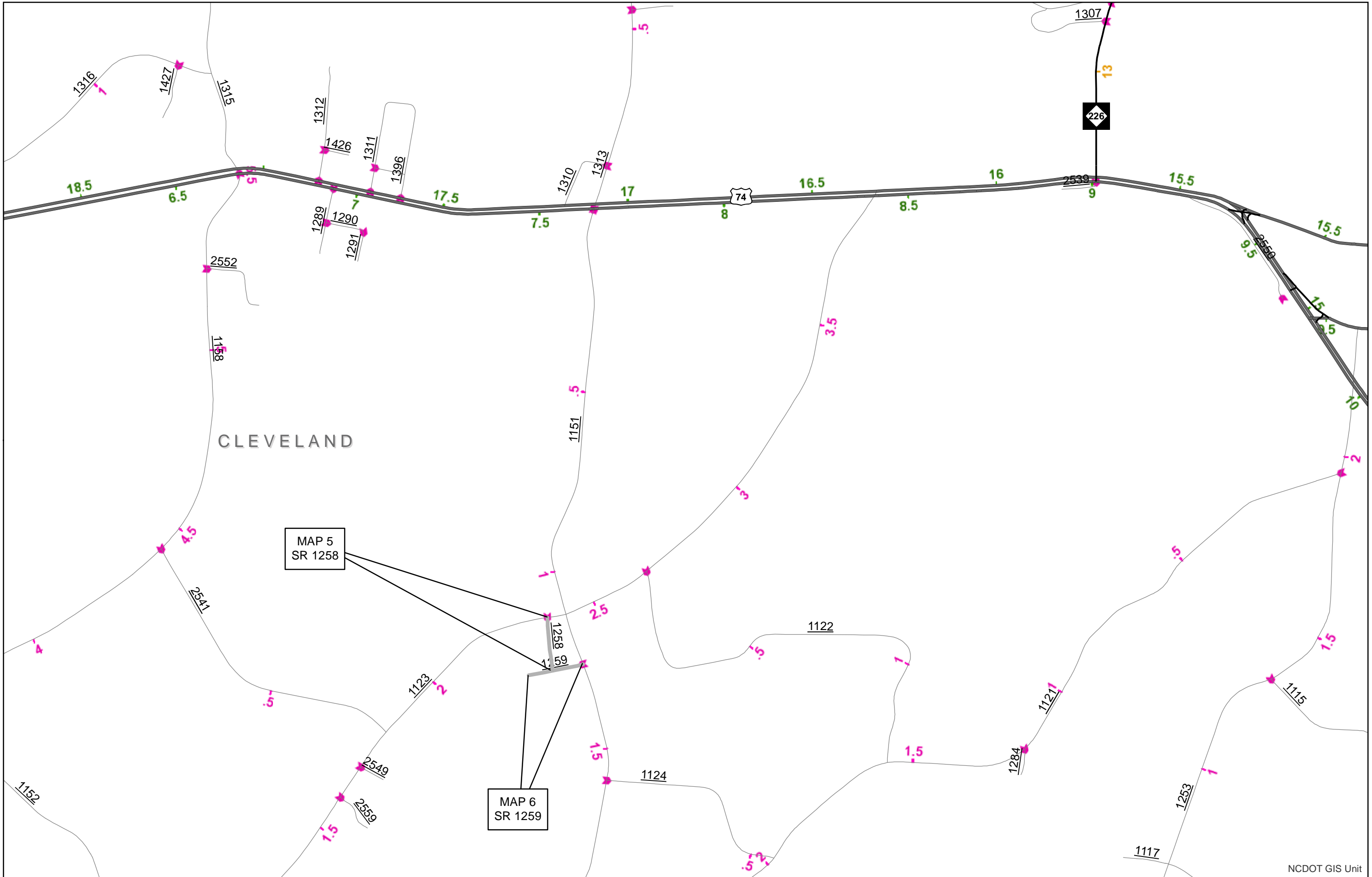



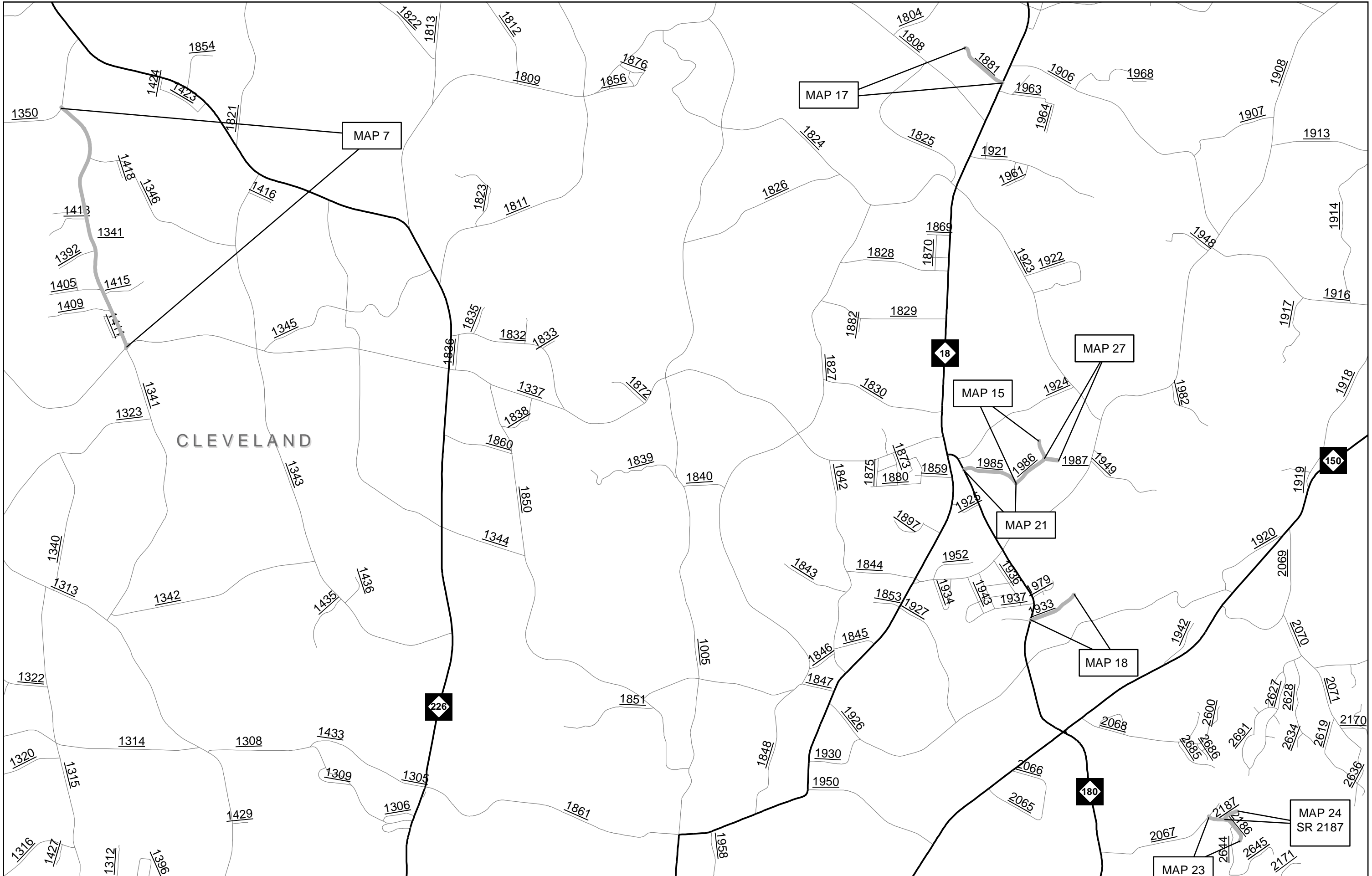



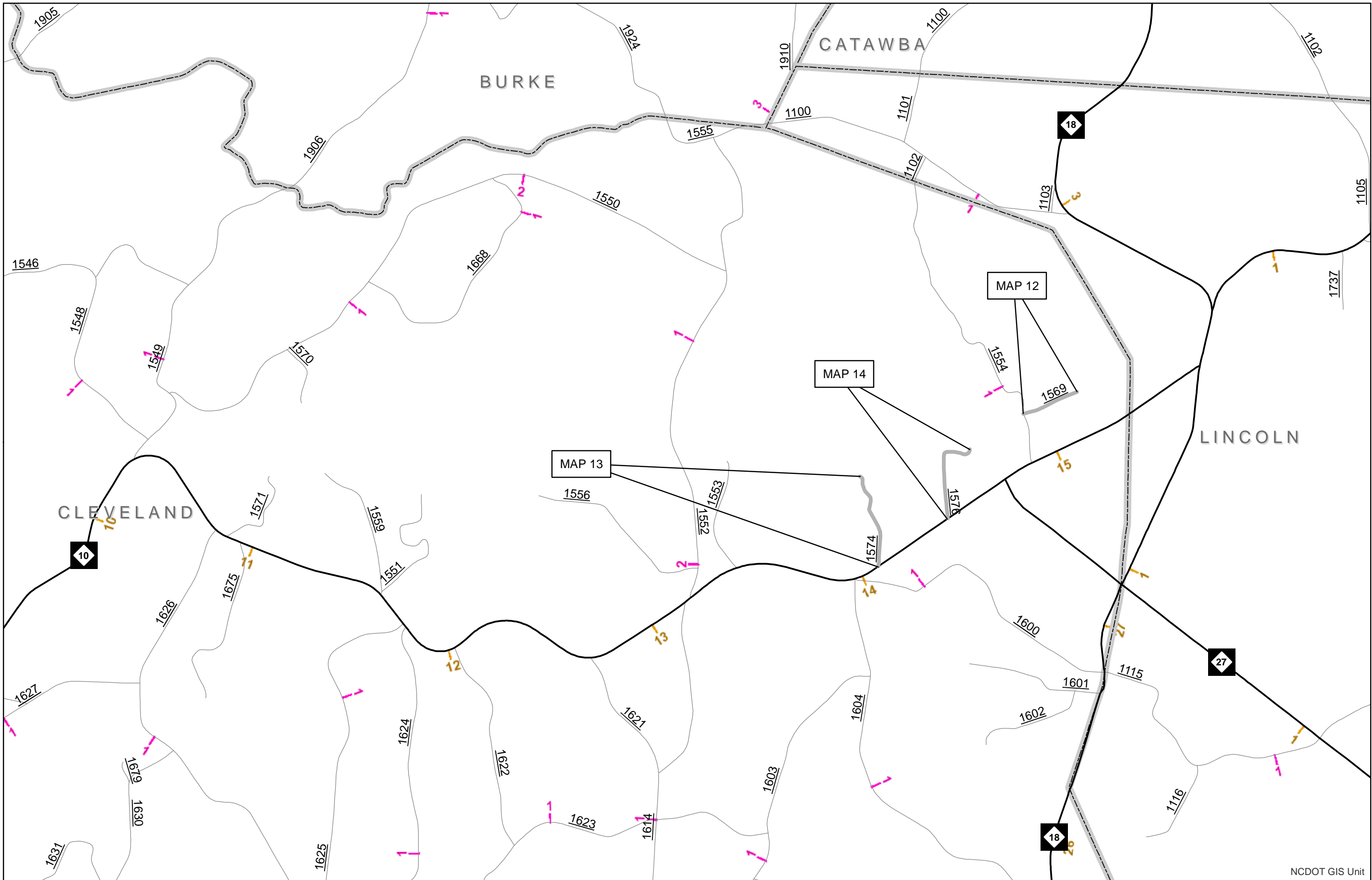



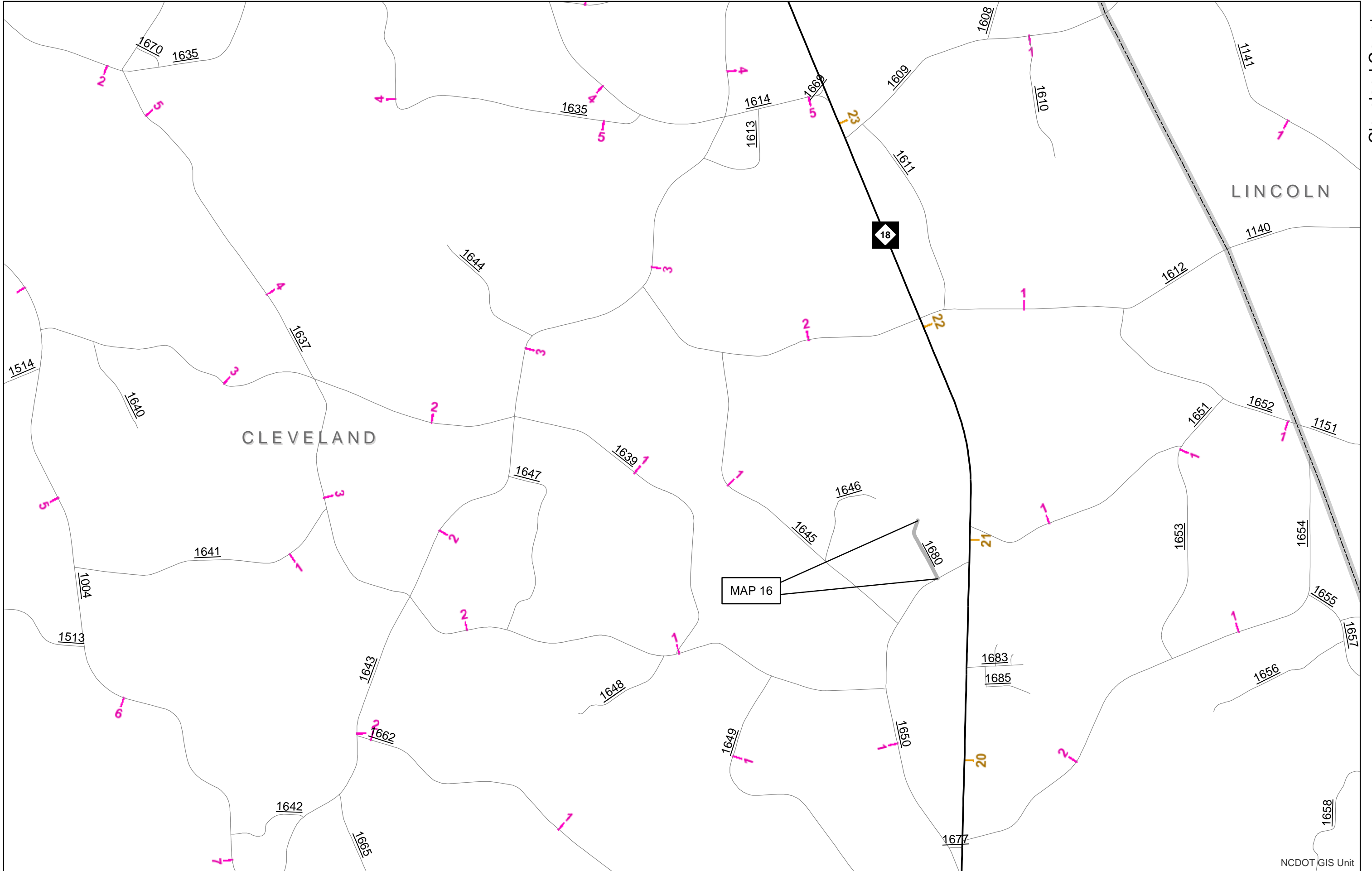





PAVEMENT SCHEDULE	
C1	PROP. APPROX. 3/4" ASPHALT CONCRETE SURFACE COURSE, SF4.75A, TYPE AT AN AVERAGE RATE OF 95 LBS. PER SQ. YD.

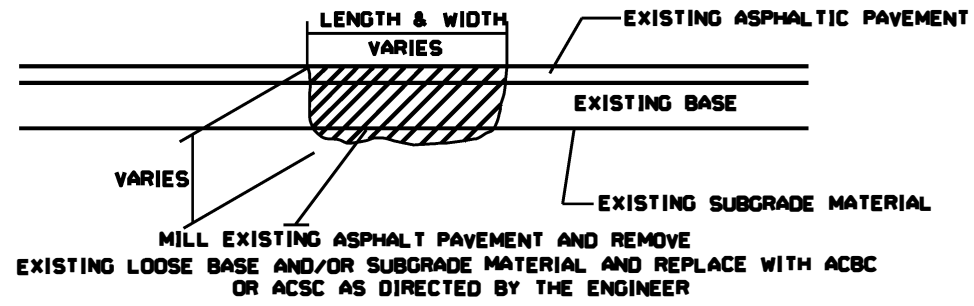

**PARTIAL DEPTH PAVEMENT REPAIR**

PROJ. REFERENCE NO.	SHEET NO.	TOTAL SHEETS
CLEVELAND COUNTY 2021-2022	9	
STATE PROJ. NO.	F. A. PROJ. NO.	DESCRIPTION
2021 CPT. 12.04.20232		

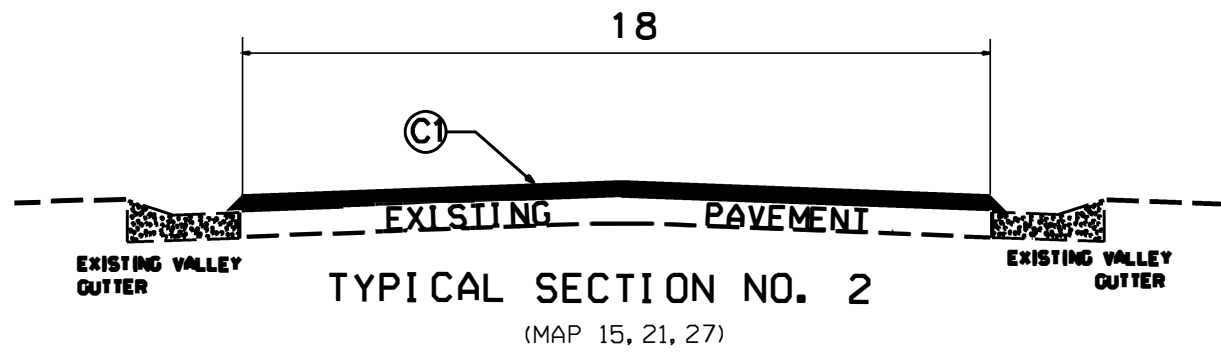
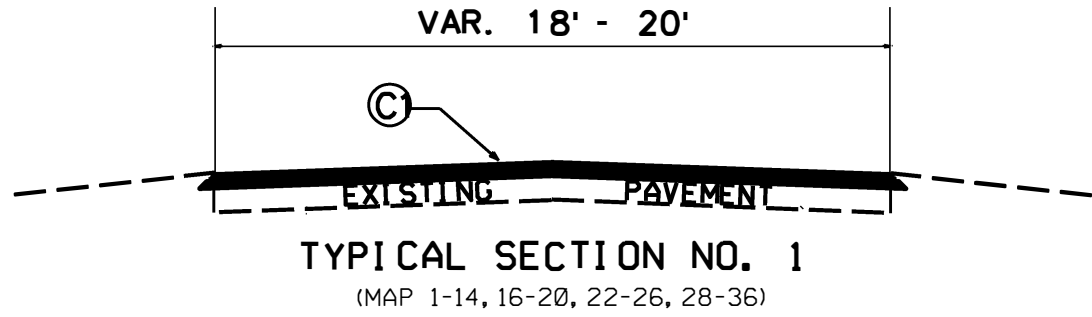

PROJECT NO.	SHEET NO.	TOTAL NO.
2021CPT.12.04.20232	10	

## SUMMARY OF QUANTITIES

PROJECT NO	COUNTY	MAP NO	ROUTE	DESCRIPTION	TYP NO	LANES	LANE TYPE	FINAL SURFACE TESTING REQUIRED	WARM MIX ASPHALT REQUIRED	LENGTH	WIDTH	152600000-E	157500000-E	169300000-E
												SURFACE COURSE, S4.75A	ASPHALT BINDER FOR PLANT MIX	PARTIAL DEPTH PAVEMENT REPAIR
												TONS	TONS	TON
2021CPT.12.04.20232	Cleveland	1	SR 1129 (EMERALD MINE RD.)	SR 2522 TO DEAD END	1	2	2WU	NO	NO	1.34	18	884	62	150
2021CPT.12.04.20232	Cleveland	2	SR 1232 (CARMEL DR.)	NC 180 TO DEAD END	1	2	2WU	NO	NO	0.37	18	244	17	49
2021CPT.12.04.20232	Cleveland	3	SR 1236 (IDLEWILD DR.)	NC 180 TO DEAD END	1	2	2WU	NO	NO	0.18	18	119	8	24
2021CPT.12.04.20232	Cleveland	4	SR 1243 (PETERSON DR.)	SR 1104 TO SR 1236	1	2	2WU	NO	NO	0.26	18	171	12	20
2021CPT.12.04.20232	Cleveland	5	SR 1258 (FROST PL.)	SR 1123 TO SR 1259	1	2	2WU	NO	NO	0.14	18	92	6	12
2021CPT.12.04.20232	Cleveland	6	SR 1259 (HILLWOOD ST.)	SR 1151 TO DEAD END	1	2	2WU	NO	NO	0.15	18	99	7	10
2021CPT.12.04.20232	Cleveland	7	SR 1341 (KINGSTON RD.)	SR 1337 TO SR 1350	1	2	2WU	NO	NO	1.88	20	1,377	96	234
2021CPT.12.04.20232	Cleveland	8	SR 1374 (ELLIOT DR.)	SR 1361 TO SR 1375	1	2	2WU	NO	NO	0.2	18	132	9	19
2021CPT.12.04.20232	Cleveland	9	SR 1375 (SHYTLER DR.)	NC 226 TO DEAD END	1	2	2WU	NO	NO	0.24	18	158	11	18
2021CPT.12.04.20232	Cleveland	10	SR 1384 (N. CIRCLE DR.)	NC 226 TO SR 1361	1	2	2WU	NO	NO	0.45	18	297	21	30
2021CPT.12.04.20232	Cleveland	11	SR 1404 (S. WITHROW DR.)	NC 226 TO NC 226	1	2	2WU	NO	NO	0.45	18	297	21	30
2021CPT.12.04.20232	Cleveland	12	SR 1569 (APPLETREE LN.)	SR 1554 TO DEAD END	1	2	2WU	NO	NO	0.25	18	165	12	18
2021CPT.12.04.20232	Cleveland	13	SR 1574 (CARPENTER KNOB DR.)	NC 10 TO DEAD END	1	2	2WU	NO	NO	0.36	18	237	17	31
2021CPT.12.04.20232	Cleveland	14	SR 1576 (FOREST MORRISON RD.)	NC 10 TO DEAD END	1	2	2WU	NO	NO	0.4	20	293	21	30
2021CPT.12.04.20232	Cleveland	15	SR 1986 (EAGLES TERRACE)	SR 1985 TO DEAD END	2	2	2WU	NO	NO	0.42	VAR. 24-25	373	26	10
2021CPT.12.04.20232	Cleveland	16	SR 1680 (STACEY ST.)	SR 1650 TO END MAINT AT MILE 0.29	1	2	2WU	NO	NO	0.29	18	191	13	25
2021CPT.12.04.20232	Cleveland	17	SR 1881 (PLEASANTDALE DR.)	NC 18 TO DEAD END	1	2	2WU	NO	NO	0.38	18	251	18	26
2021CPT.12.04.20232	Cleveland	18	SR 1933 (FRIENDSHIP RD.)	NC 180 TO END MAINT AT 0.38 MILE	1	2	2WU	NO	NO	0.38	18	251	18	
2021CPT.12.04.20232	Cleveland	19	SR 1983 (CAROL LYN DR.)	SR 1984 TO DEAD END	1	2	2WU	NO	NO	0.13	18	86	6	9
2021CPT.12.04.20232	Cleveland	20	SR 1984 (WILLCORT DR.)	SR 2245 TO DEAD END	1	2	2WU	NO	NO	0.14	18	92	6	9
2021CPT.12.04.20232	Cleveland	21	SR 1985 (DEER BROOK DR.)	NC 180 TO SR 1986	2	2	2WU	NO	NO	0.41	VAR. 24-25	365	26	27
2021CPT.12.04.20232	Cleveland	22	SR 2440 (GRIER ST.)	SR 2237 TO DEAD END	1	2	2WU	NO	NO	0.21	18	138	10	66
2021CPT.12.04.20232	Cleveland	23	SR 2186 (DOGWOOD LN.)	SR 2067 TO DEAD END	1	2	2WU	NO	NO	0.33	18	218	15	22
2021CPT.12.04.20232	Cleveland	24	SR 2187 (FAIRVIEW FARMS RD.)	SR 2186 TO END MAINT AT MILE 0.11	1	2	2WU	NO	NO	0.11	18	73	5	7
2021CPT.12.04.20232	Cleveland	25	SR 2203 (WARE RD.)	SR 2325 TO DEAD END	1	2	2WU	NO	NO	0.76	18	501	35	50
2021CPT.12.04.20232	Cleveland	26	SR 2204 (SYLVAN RD.)	SR 1103 TO END MAINT AT MILE 0.49	1	2	2WU	NO	NO	0.49	18	323	23	32
2021CPT.12.04.20232	Cleveland	27	SR 1987 (CADDIES CT.)	SR 1986 TO DEAD END	2	2	2WU	NO	NO	0.05	VAR. 24-25	44	3	3
2021CPT.12.04.20232	Cleveland	28	SR 2228 (MALLARD DR.)	SR 2226 TO END MAINT AT MILE 0.22	1	2	2WU	NO	NO	0.22	18	145	10	21
2021CPT.12.04.20232	Cleveland	29	SR 2232 (ROUNTREE RD.)	NC 226 TO END MAINT AT MILE 0.40	1	2	2WU	NO	NO	0.4	18	264	18	29
2021CPT.12.04.20232	Cleveland	30	SR 2259 (BAIN RD.)	SR 2263 TO DEAD END	1	2	2WU	NO	NO	0.17	18	112	8	12
2021CPT.12.04.20232	Cleveland	31	SR 2477 (ADELE LN.)	SR 2259 TO SR 2479	1	2	2WU	NO	NO	0.15	18	99	7	10
2021CPT.12.04.20232	Cleveland	32	SR 2479 (DREW CT.)	SR 2477 TO DEAD END	1	2	2WU	NO	NO	0.06	18	40	3	4
2021CPT.12.04.20232	Cleveland	33	SR 2522 (CAROL ST.)	NC 18 TO SR 2523	1	2	2WU	NO	NO	0.08	18	53	4	5
2021CPT.12.04.20232	Cleveland	34	SR 2523 (PECAN DR.)	SR 2522 TO SR 2551	1	2	2WU	NO	NO	0.5	18	330	23	33
2021CPT.12.04.20232	Cleveland	35	SR 2524 (RIDGEWOOD ST.)	NC 18 TO END MAINT AT MILE 0.33	1	2	2WU	NO	NO	0.33	18	218	15	22
2021CPT.12.04.20232	Cleveland	36	SR 2551 (PINEBURR DR.)	SR 2524 TO SR 2523	1	2	2WU	NO	NO	0.23	18	152	11	16
<b>TOTAL FOR PROJ NO. 2021CPT.12.04.20232</b>											<b>12.91</b>	<b>8,884</b>	<b>623</b>	<b>1,113</b>
<b>GRAND TOTAL</b>											<b>12.91</b>	<b>8,884</b>	<b>623</b>	<b>1,113</b>

PROJECT NO.	SHEET NO.	TOTAL NO.
2021CPT.12.04.20232	11	

## THERMOPLASTIC AND PAINT QUANTITIES

PROJECT NO	COUNTY	MAP NO	ROUTE	DESCRIPTION	TYP NO	LANES	LANE TYPE	LENGTH		WIDTH	4413000000-E	4810000000-E	4810000000-E	4457000000-N
								MI	FT		WORK ZONE ADVANCE/GENERAL WARNING SIGNING	4" WHITE PAINT	4" YELLOW PAINT	WORK ZONE TRAFFIC CONTROL
											SF	LF	LF	LS
2021CPT.12.04.20232	Cleveland	1	SR 1129 (EMERALD MINE RD.)	SR 2522 TO DEAD END	1	2	2WU	1.34	18		212	28,837	28,837	*
2021CPT.12.04.20232	Cleveland	2	SR 1232 (CARMEL DR.)	NC 180 TO DEAD END	1	2	2WU	0.37	18		84	7,962	7,962	*
2021CPT.12.04.20232	Cleveland	3	SR 1236 (IDLEWILD DR.)	NC 180 TO DEAD END	1	2	2WU	0.18	18		84			*
2021CPT.12.04.20232	Cleveland	4	SR 1243 (PETERSON DR.)	SR 1104 TO SR 1236	1	2	2WU	0.26	18		84			*
2021CPT.12.04.20232	Cleveland	5	SR 1258 (FROST PL.)	SR 1123 TO SR 1259	1	2	2WU	0.14	18		84			*
2021CPT.12.04.20232	Cleveland	6	SR 1259 (HILLWOOD ST.)	SR 1151 TO DEAD END	1	2	2WU	0.15	18		84			*
2021CPT.12.04.20232	Cleveland	7	SR 1341 (KINGSTON RD.)	SR 1337 TO SR 1350	1	2	2WU	1.88	20		116	40,458	40,458	*
2021CPT.12.04.20232	Cleveland	8	SR 1374 (ELLIOT DR.)	SR 1361 TO SR 1375	1	2	2WU	0.2	18		132	4,304	4,304	*
2021CPT.12.04.20232	Cleveland	9	SR 1375 (SHYTLER DR.)	NC 226 TO DEAD END	1	2	2WU	0.24	18		132	5,165	5,165	*
2021CPT.12.04.20232	Cleveland	10	SR 1384 (N. CIRCLE DR.)	NC 226 TO SR 1361	1	2	2WU	0.45	18		180	9,684	9,684	*
2021CPT.12.04.20232	Cleveland	11	SR 1404 (S. WITHROW DR.)	NC 226 TO NC 226	1	2	2WU	0.45	18		180	9,684	9,684	*
2021CPT.12.04.20232	Cleveland	12	SR 1569 (APPLETREE LN.)	SR 1554 TO DEAD END	1	2	2WU	0.25	18		84	5,380	5,380	*
2021CPT.12.04.20232	Cleveland	13	SR 1574 (CARPENTER KNOB DR.)	NC 10 TO DEAD END	1	2	2WU	0.36	18		84			*
2021CPT.12.04.20232	Cleveland	14	SR 1576 (FOREST MORRISON RD.)	NC 10 TO DEAD END	1	2	2WU	0.4	20		84			*
2021CPT.12.04.20232	Cleveland	15	SR 1986 (EAGLES TERRACE)	SR 1985 TO DEAD END	2	2	2WU	0.42	VAR. 24-25		84			*
2021CPT.12.04.20232	Cleveland	16	SR 1680 (STACEY ST.)	SR 1650 TO END MAINT AT MILE 0.29	1	2	2WU	0.29	18		84			*
2021CPT.12.04.20232	Cleveland	17	SR 1881 (PLEASANTDALE DR.)	NC 18 TO DEAD END	1	2	2WU	0.38	18		84	8,178	8,178	*
2021CPT.12.04.20232	Cleveland	18	SR 1933 (FRIENDSHIP RD.)	NC 180 TO END MAINT AT 0.38 MILE	1	2	2WU	0.38	18		84	7,962	7,962	*
2021CPT.12.04.20232	Cleveland	19	SR 1983 (CAROL LYN DR.)	SR 1984 TO DEAD END	1	2	2WU	0.13	18		84			*
2021CPT.12.04.20232	Cleveland	20	SR 1984 (WILLCORT DR.)	SR 2245 TO DEAD END	1	2	2WU	0.14	18		84			*
2021CPT.12.04.20232	Cleveland	21	SR 1985 (DEER BROOK DR.)	NC 180 TO SR 1986	2	2	2WU	0.41	VAR. 24-25		84			*
2021CPT.12.04.20232	Cleveland	22	SR 2440 (GRIER ST.)	SR 2237 TO DEAD END	1	2	2WU	0.21	18		84			*
2021CPT.12.04.20232	Cleveland	23	SR 2186 (DOGWOOD LN.)	SR 2067 TO DEAD END	1	2	2WU	0.33	18		84			*
2021CPT.12.04.20232	Cleveland	24	SR 2187 (FAIRVIEW FARMS RD.)	SR 2186 TO END MAINT AT MILE 0.11	1	2	2WU	0.11	18		84			*
2021CPT.12.04.20232	Cleveland	25	SR 2203 (WARE RD.)	SR 2325 TO DEAD END	1	2	2WU	0.76	18		84	16,355	16,355	*
2021CPT.12.04.20232	Cleveland	26	SR 2204 (SYLVAN RD.)	SR 1103 TO END MAINT AT MILE 0.49	1	2	2WU	0.49	18		84	10,545	10,545	*
2021CPT.12.04.20232	Cleveland	27	SR 1987 (CADDIES CT.)	SR 1986 TO DEAD END	2	2	2WU	0.05	VAR. 24-25		84			*
2021CPT.12.04.20232	Cleveland	28	SR 2228 (MALLARD DR.)	SR 2226 TO END MAINT AT MILE 0.22	1	2	2WU	0.22	18		84			*
2021CPT.12.04.20232	Cleveland	29	SR 2232 (ROUNTREE RD.)	NC 226 TO END MAINT AT MILE 0.40	1	2	2WU	0.4	18		84			*
2021CPT.12.04.20232	Cleveland	30	SR 2259 (BAIN RD.)	SR 2263 TO DEAD END	1	2	2WU	0.17	18		84			*
2021CPT.12.04.20232	Cleveland	31	SR 2477 (ADELE LN.)	SR 2259 TO SR 2479	1	2	2WU	0.15	18		84			*
2021CPT.12.04.20232	Cleveland	32	SR 2479 (DREW CT.)	SR 2477 TO DEAD END	1	2	2WU	0.06	18		84			*
2021CPT.12.04.20232	Cleveland	33	SR 2522 (CAROL ST.)	NC 18 TO SR 2523	1	2	2WU	0.08	18		84	1,722	1,722	*
2021CPT.12.04.20232	Cleveland	34	SR 2523 (PECAN DR.)	SR 2522 TO SR 2551	1	2	2WU	0.5	18		84	10,760	10,760	*
2021CPT.12.04.20232	Cleveland	35	SR 2524 (RIDGEWOOD ST.)	NC 18 TO END MAINT AT MILE 0.33	1	2	2WU	0.33	18		84	7,102	7,102	*
2021CPT.12.04.20232	Cleveland	36	SR 2551 (PINEBURR DR.)	SR 2524 TO SR 2523	1	2	2WU	0.23	18		84	4,950	4,950	*
<b>TOTAL FOR PROJ NO. 2021CPT.12.04.20232</b>								<b>12.91</b>			<b>3,472</b>	<b>179,048</b>	<b>179,048</b>	<b>*</b>
<b>GRAND TOTAL</b>								<b>12.91</b>			<b>3,472</b>	<b>179,048</b>	<b>179,048</b>	<b>1</b>

# SIGNING FOR RESURFACING PROJECTS

**LEGEND**  
 ┆ STATIONARY SIGN  
 ← DIRECTION OF TRAFFIC FLOW

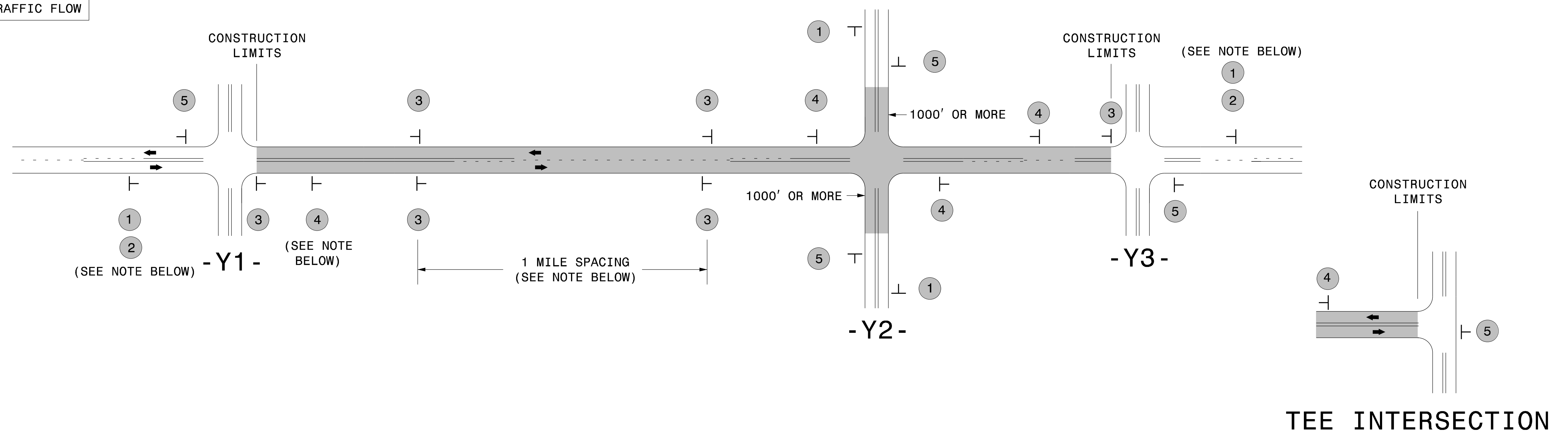

## MAINLINE (-L-) SIGNING

## -Y- LINE SIGNING

SIGNING NOTES AND PLACEMENT PER DIRECTION	1		PLACE 1000' PRIOR TO BEGINNING OF CONSTRUCTION LIMITS. ONLY USED ON -Y- LINES IF RESURFACING LIMITS EXTEND 1000' ALONG -Y- LINE.	<p>NO REQUIRED STATIONARY SIGNING FOR THE FOLLOWING -Y- LINE CONDITIONS:</p> <ol style="list-style-type: none"> <li>1) LESS THAN 1000' OF RESURFACING ALONG -Y- LINE</li> <li>2) SUBDIVISION ROADS</li> <li>3) DEAD END ROADS</li> </ol> <p>WHEN PAVING/CONSTRUCTION ACTIVITIES PROCEED ACROSS AN UNSIGNED -Y- LINE, PORTABLE ADVANCE WARNING SIGNS SHALL BE USED ALONG THE -Y- LINE AS SHOWN BELOW. REMOVE UPON COMPLETION OF WORK.</p> <div style="display: flex; justify-content: space-around;"> <div style="text-align: center;">             W20-1 48" X 48"            PLACED 500' IN ADVANCE OF FLAGGER.         </div> <div style="text-align: center;">             W20-7 A 48" X 48"            PLACED 250' IN ADVANCE OF FLAGGER.         </div> </div>
	2		#2 SIGN ONLY USED WHEN CONSTRUCTION LIMITS ARE 2 OR MORE MILES IN LENGTH. ROUND UP TO NEXT WHOLE NUMBER. (NO FRACTIONAL OR DECIMAL NUMBERS)	
	3		- PLACE INITIALLY AT THE CONSTRUCTION LIMITS AND SPACE 1 MILE APART THEREAFTER. - AT TEE INTERSECTIONS INSTALL INITIALLY 1/2 MILE FROM INTERSECTION AND SPACE 1 MILE APART THEREAFTER.	
	4		- THESE ARE FOR -Y- LINES THAT ARE "THROUGH" ROADWAYS. - DEAD END AND SUBDIVISION ROADS ARE NOT "THROUGH" ROADWAYS. - INSTALL 500' +/- FROM EACH -Y- LINE APPROACH AS SHOWN ABOVE. - FOR MULTIPLE -Y- LINES THAT ARE SEPARATED BY 0.25 MILES OR LESS, TREAT AS A SINGLE UNIT AND INSTALL WITHIN 500' OF EACH APPROACH. - A MAXIMUM OF 2 SIGN SETS PER MILE. DO NOT INSTALL WHEN -Y- LINES ARE WITHIN 0.5 MILES FROM "END ROAD WORK" SIGN. - FOR TEE INTERSECTIONS, INSTALL WITHIN 500' +/- OF THE INTERSECTION ALONG -L- LINE.	
	5		PLACE 500' FOLLOWING THE END OF CONSTRUCTION LIMITS OR AS SHOWN WHEN WORK ENDS AT A 3-WAY TEE INTERSECTION.	

THE ABOVE SIGNS ARE ALL THAT ARE REQUIRED FOR A CONTRACTOR TO BEGIN A RESURFACING CONTRACT. ANY ADDITIONAL SIGNS REQUESTED BY NCDOT DIVISIONS SHALL BE INSTALLED WITHIN 7 BUSINESS DAYS OF THE START OF CONTRACT WORK.

**MAPS LESS THAN 2 MILES**

FOR RESURFACING MAPS WITH CONSTRUCTION LIMITS LESS THAN 2 MILES IN LENGTH, NO STATIONARY SIGNS ARE REQUIRED. USE PORTABLE "ROAD UNDER CONSTRUCTION" OR "ROAD WORK AHEAD" SIGNS IN LIEU OF STATIONARY ADVANCE WARNINGS SIGNS.

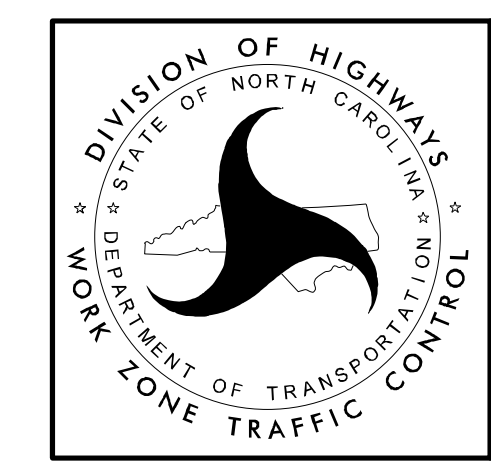

**ADVANCE WARNING SIGNS FOR RURAL AND SUBURBAN 2-LANE ROADWAY RESURFACING**

5/15/2017 S:\TUXWZTC\Resurfacing\2L2W & AST Resurfacing Details\Resurfacing\_AdvWarn\_2Ln.dgn User:kadai