

**This electronic collection of documents is provided
for the convenience of the user
and is Not a Certified Document –**

**The documents contained herein were originally issued
and sealed by the individuals whose names and license
numbers appear on each page, on the dates appearing
with their signature on that page.**

**This file or an individual page
shall not be considered a certified document.**

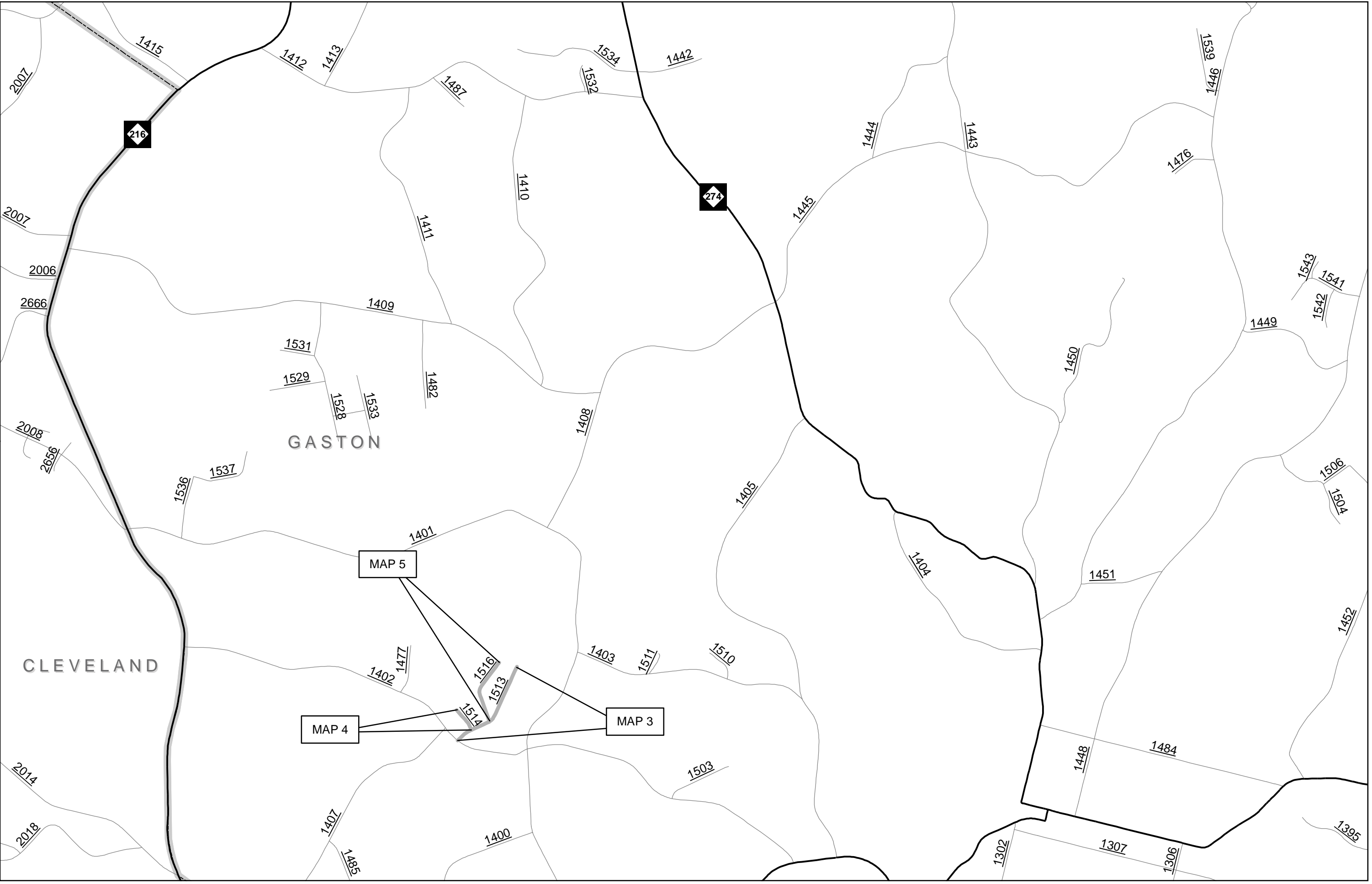

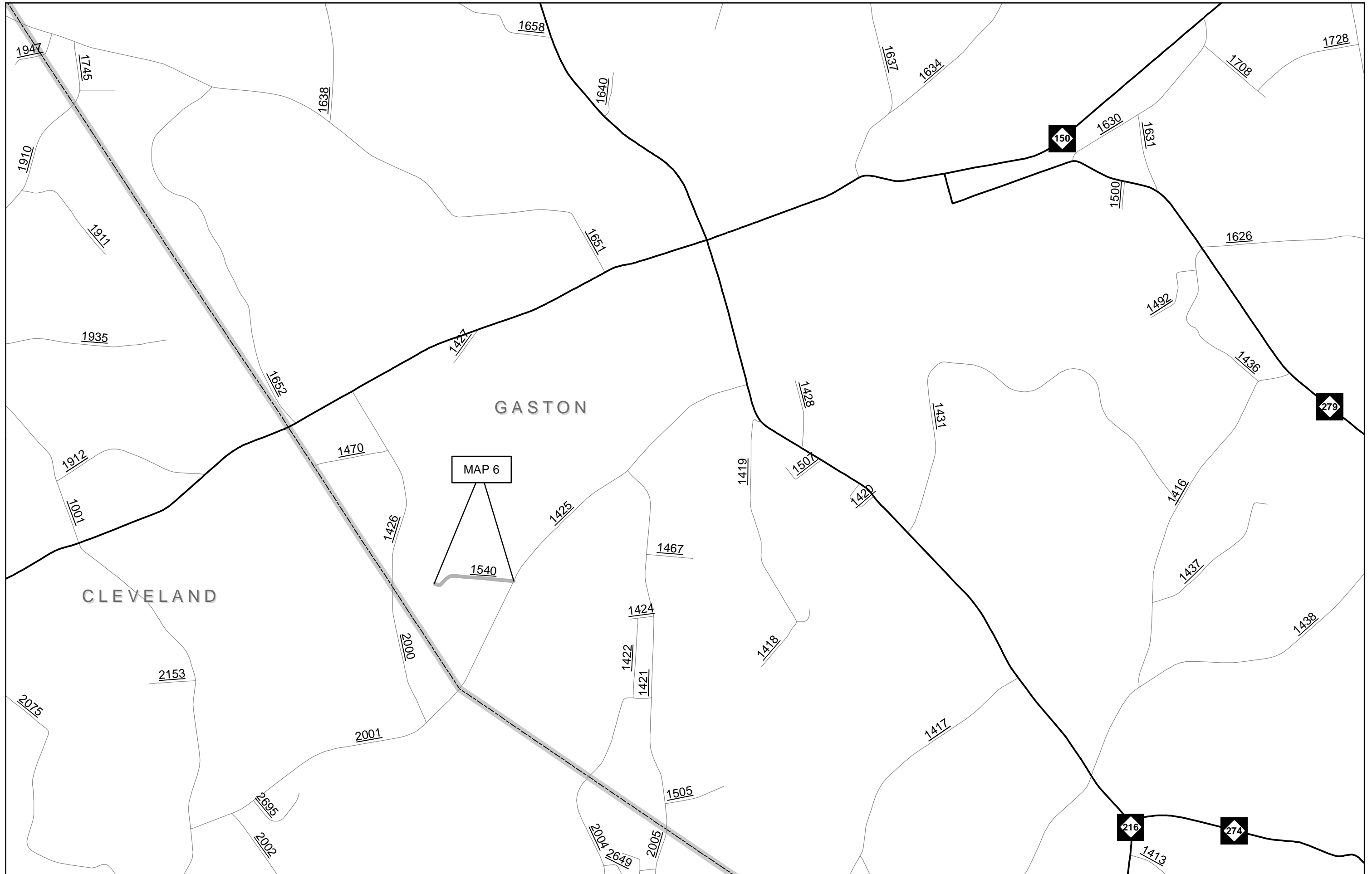

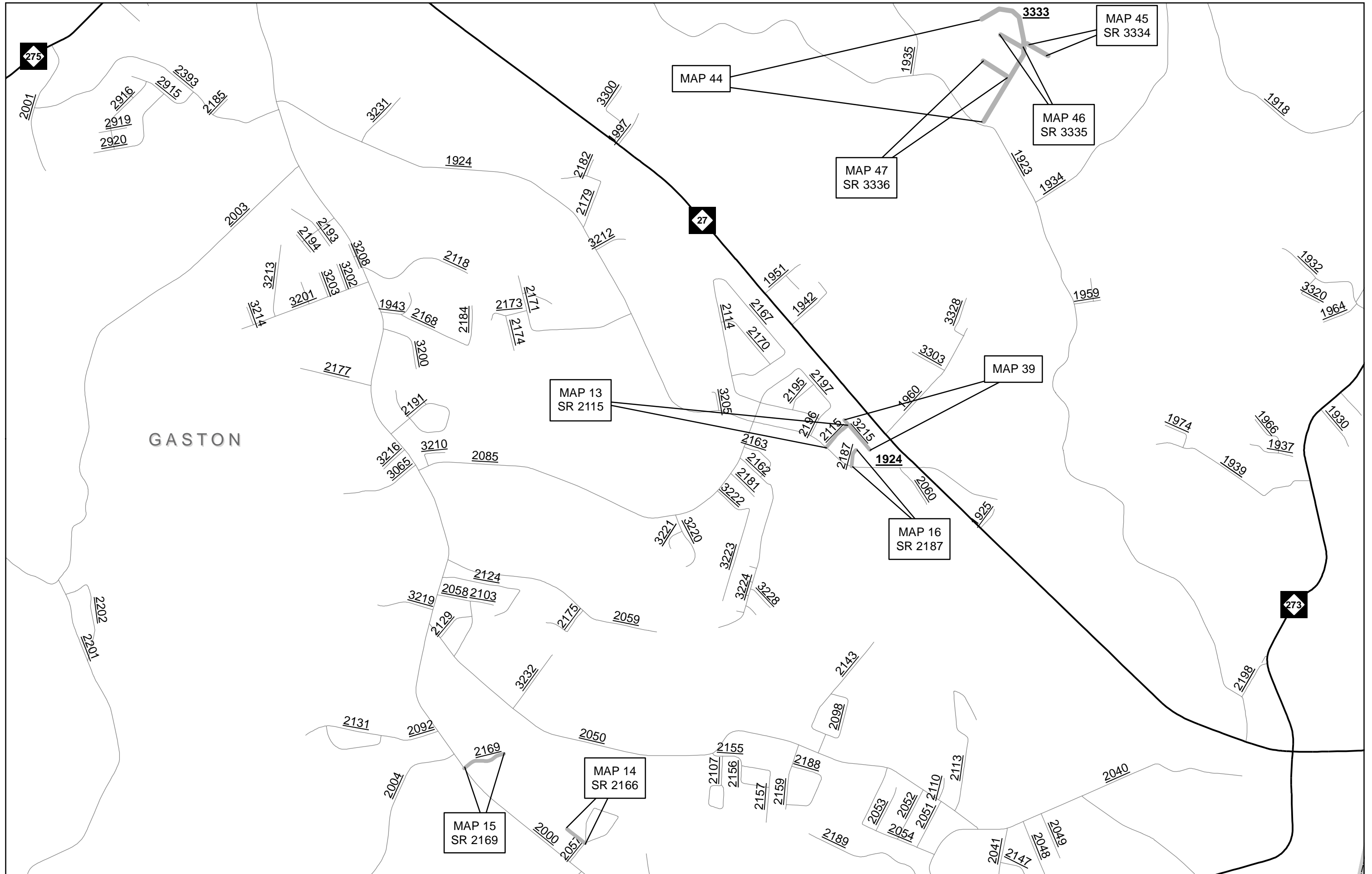

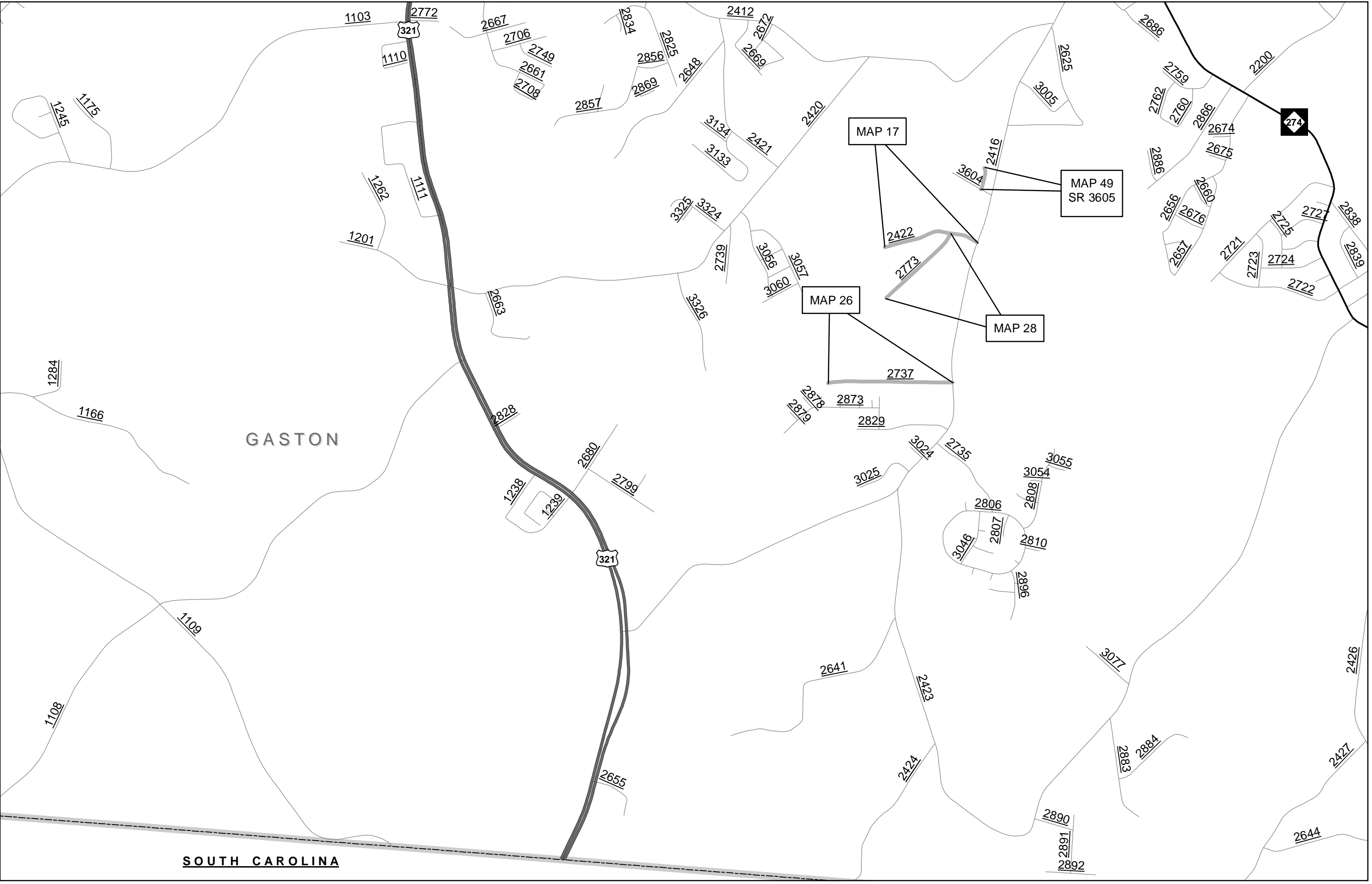

GASTON

SOUTH CAROLINA



Parcel numbers shown on the map include: 1103, 1110, 1111, 1108, 1109, 1166, 1284, 1285, 1175, 1245, 1201, 1262, 1288, 1238, 1239, 2655, 2667, 2706, 2749, 2661, 2708, 2856, 2834, 2835, 2648, 2857, 2869, 2412, 2672, 2669, 2420, 3134, 2421, 3133, 2623, 3005, 2686, 2759, 2200, 2762, 2760, 2866, 2674, 2675, 2886, 2656, 2676, 2660, 2667, 2721, 2723, 2724, 2722, 2725, 2727, 2838, 2839, 3325, 3324, 2739, 3056, 3057, 3060, 3063, 3326, 2737, 2773, 2422, 3604, 2416, 2737, 2878, 2879, 2873, 2829, 3025, 3024, 2735, 3055, 3054, 2806, 2808, 2810, 3046, 2807, 2896, 2641, 2423, 2424, 3077, 2883, 2884, 2426, 2427, 2644, 2890, 2891, 2892.

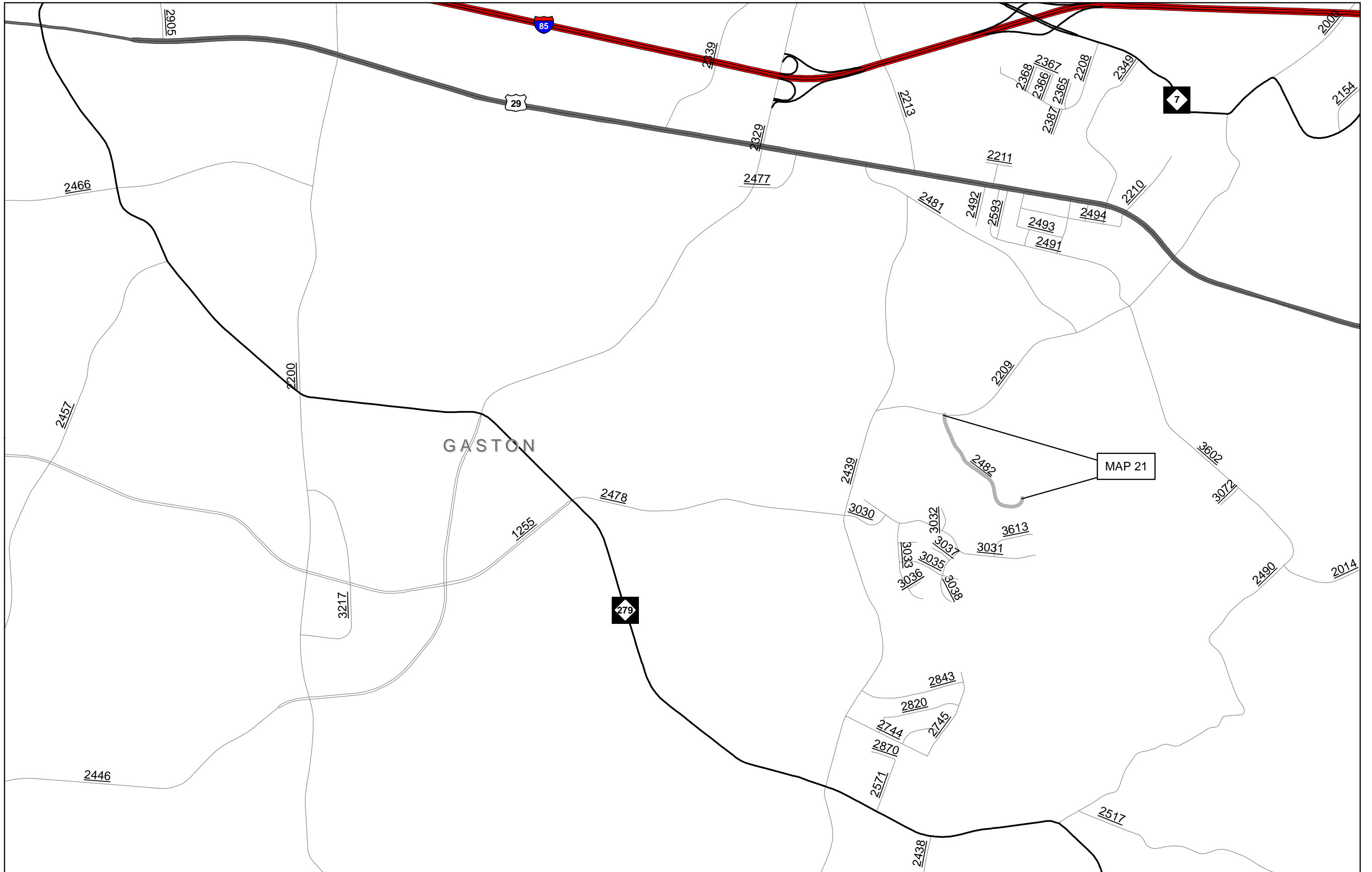

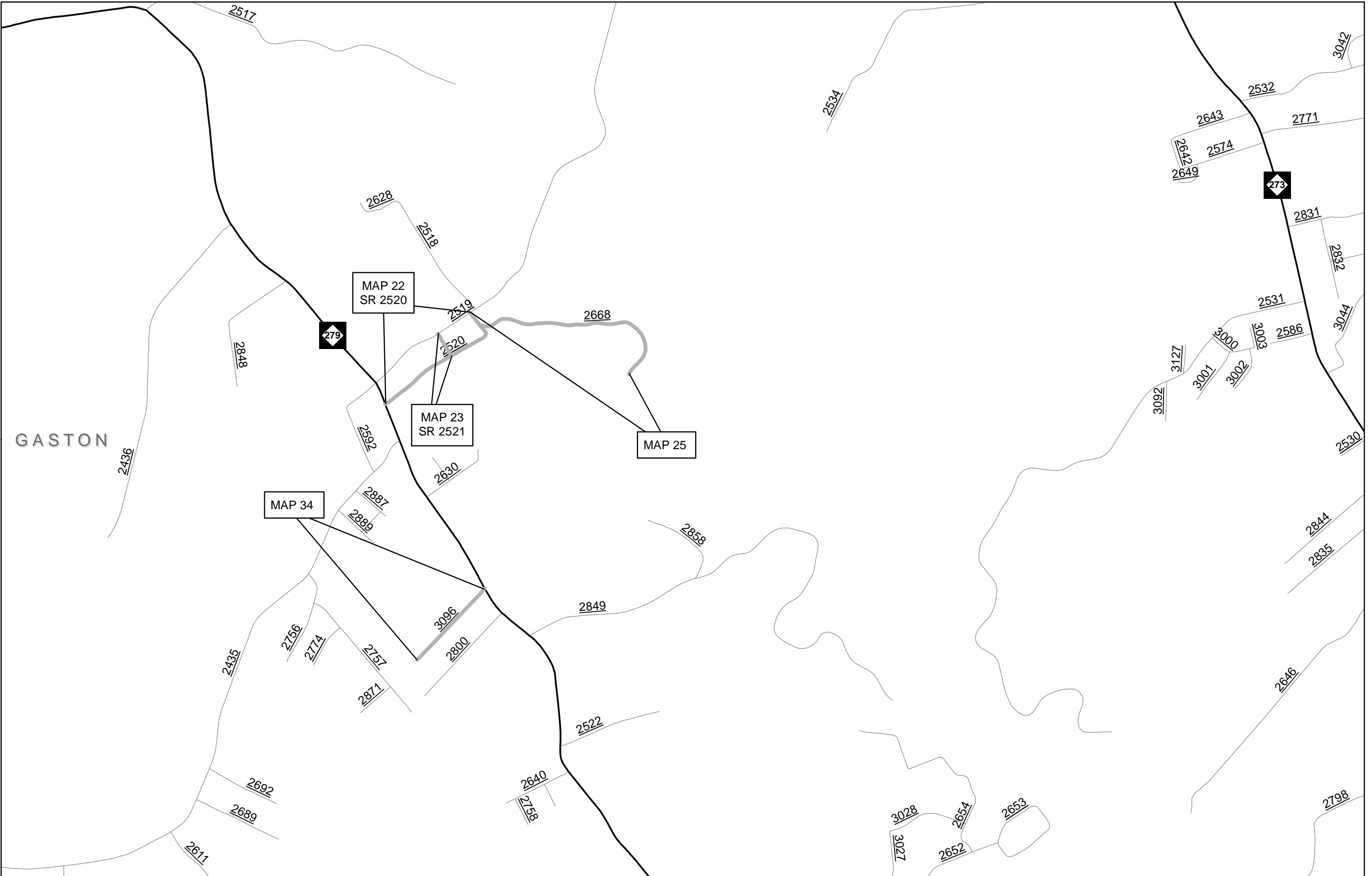

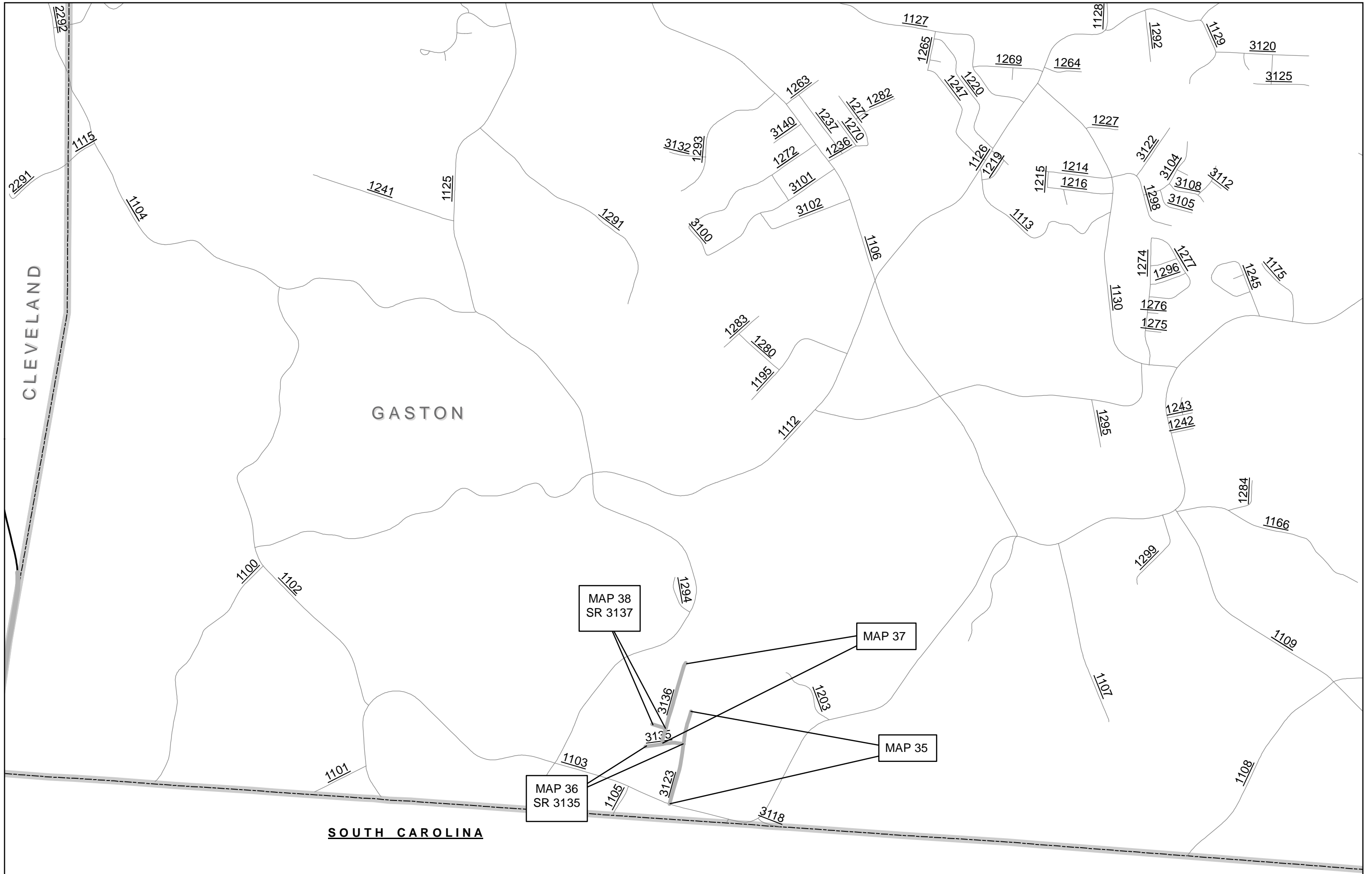

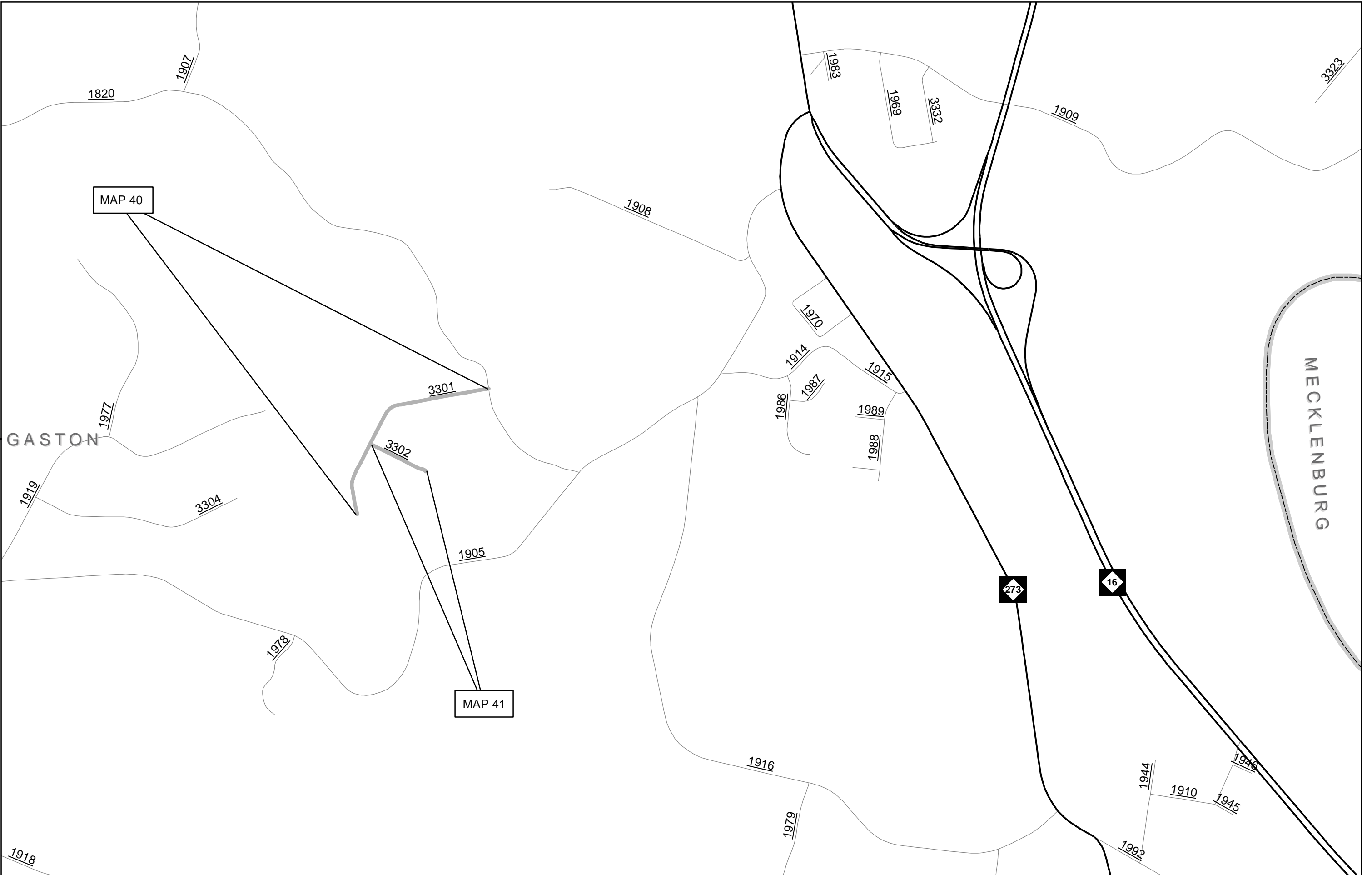

PAVEMENT SCHEDULE

C1

PROP. APPROX. 3/4" ASPHALT CONCRETE SURFACE COURSE, SF4.75A, TYPE AT AN AVERAGE RATE OF 95 LBS. PER SQ. YD.

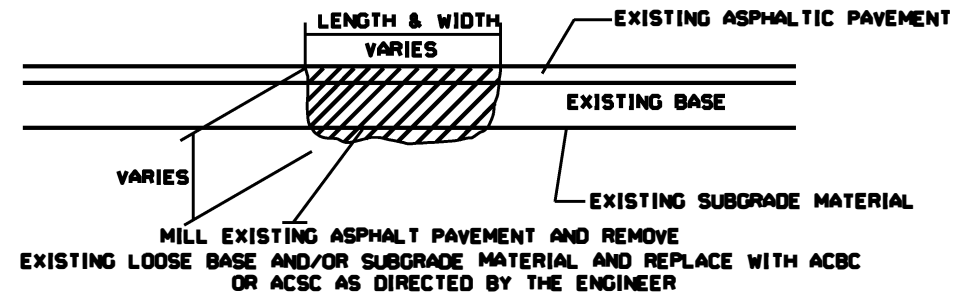

PARTIAL DEPTH PAVEMENT REPAIR DETAIL

PROJ. REFERENCE NO.	SHEET NO.	TOTAL SHEETS
GASTON COUNTY 2021-2022	13	
STATE PROJ. NO.	F. A. PROJ. NO.	DESCRIPTION
2021 CPT. 12.04.20362		

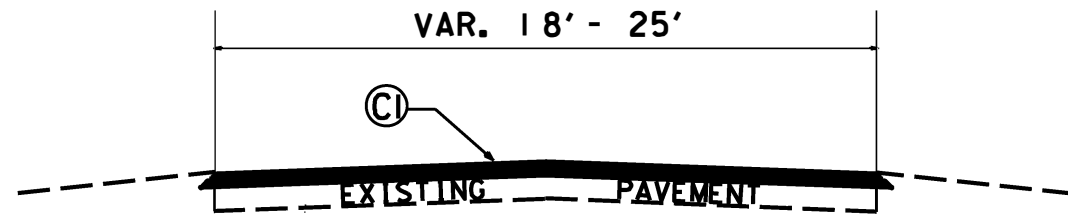

TYPICAL SECTION NO. 1

(MAP 1, 2 thru 13, 15 thru 22, 24 thru 38, 40 thru 48)

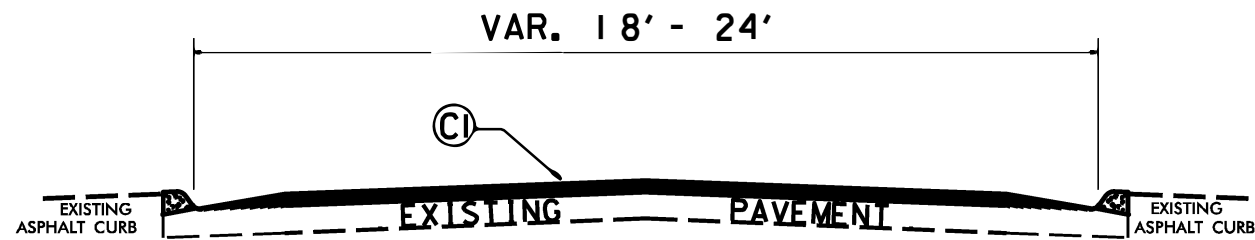

TYPICAL SECTION NO. 2

(MAP 14, 23)

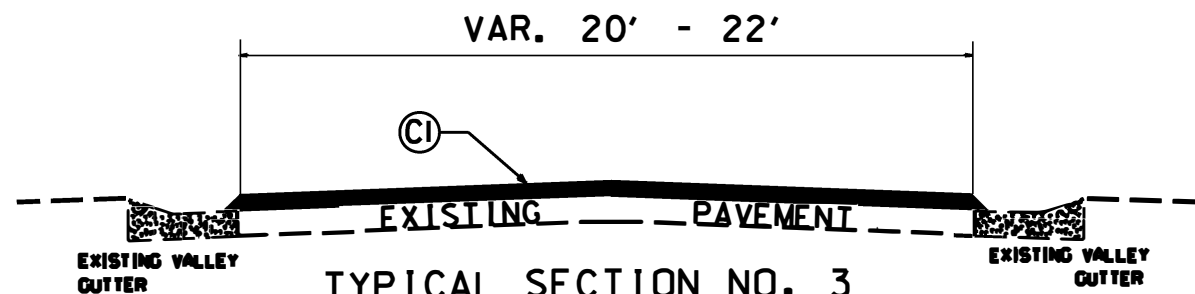

TYPICAL SECTION NO. 3

(MAP 2, 39, 49, 50)

PROJECT NO.	SHEET NO.	TOTAL NO.
2020CPT.12.04.20362	14	

SUMMARY OF QUANTITIES

PROJECT NO	COUNTY	MAP NO	ROUTE	DESCRIPTION	TYP NO	LANES	LANE TYPE	FINAL SURFACE TESTING REQUIRED	WARM MIX ASPHALT REQUIRED	LENGTH	WIDTH	1526000000-E	1575000000-E	1693000000-E	
												SURFACE COURSE, S4.75A	ASPHALT BINDER FOR PLANT MIX	PARTIAL DEPTH PAVEMENT REPAIR	
												MI	FT	TONS	TONS
2020CPT.12.04.20362	Gaston	1	SR 1369 (NELDA ST.)	NC 275 TO SR 1370	1	2		NO	NO	0.2	19	139	10	18	
2020CPT.12.04.20362	Gaston	2	SR 1370 (KNOWLES DR.)	SR 1369 TO DEAD END	3	2		NO	NO	0.2	22	161	11	17	
2020CPT.12.04.20362	Gaston	3	SR 1513 (CHESTNUT WOODS DR.)	SR 1402 TO DEAD END	1	2		NO	NO	0.45	20	330	23	33	
2020CPT.12.04.20362	Gaston	4	SR 1514 (TARY CT.)	SR 1513 TO DEAD END	1	2		NO	NO	0.11	20	81	6	7	
2020CPT.12.04.20362	Gaston	5	SR 1516 (SANDYCREST CT.)	SR 1513 TO DEAD END	1	2		NO	NO	0.3	20	220	15	22	
2020CPT.12.04.20362	Gaston	6	SR 1540 (CRICKET CREEK DR.)	SR 1425 TO DEAD END	1	2		NO	NO	0.37	VAR. 24-25	332	23	94	
2020CPT.12.04.20362	Gaston	7	SR 1949 (ROLLINGWOOD DR.)	NC 16 TO SR 1947	1	2		NO	NO	0.5	18	330	23	30	
2020CPT.12.04.20362	Gaston	8	SR 1980 (OLD BEATY RD.)	NC 16 BUS TO DEAD END	1	2		NO	NO	0.59	20	432	30	50	
2020CPT.12.04.20362	Gaston	9	SR 1981 (GRIFFIN ST.)	NC 16 BUS TO DEAD END	1	2		NO	NO	0.48	20	351	25	34	
2020CPT.12.04.20362	Gaston	10	SR 1982 (OLIVIA CT.)	NC 16 BUS TO DEAD END	1	2		NO	NO	0.18	20	132	9	12	
2020CPT.12.04.20362	Gaston	11	SR 1995 (LARAMIE DR.)	SR 1994 TO LINCOLN COUNTY	1	2		NO	NO	0.02	20	15	1	2	
2020CPT.12.04.20362	Gaston	12	SR 1999 (ROBERT KEEVER RD.)	NC 16 BUS TO SR 3310	1	2		NO	NO	0.28	20	205	14	20	
2020CPT.12.04.20362	Gaston	13	SR 2115 (RACHEL ST.)	SR 1924 TO SR 3215	1	2		NO	NO	0.14	18	92	6	9	
2020CPT.12.04.20362	Gaston	14	SR 2166 (MIDWAY ST.)	SR 2057 TO END PAVEMENT	2	2		NO	NO	0.1	18	66	5	5	
2020CPT.12.04.20362	Gaston	15	SR 2169 (MELODY DR.)	SR 2000 TO END MAINT AT FIRST CULDESAC	1	2		NO	NO	0.19	20	139	10	7	
2020CPT.12.04.20362	Gaston	16	SR 2187 (HANSEL ST.)	SR 1924 TO DEAD END	1	2		NO	NO	0.08	20	59	4	7	
2020CPT.12.04.20362	Gaston	17	SR 2422 (LAKEWOOD DR.)	SR 2416 TO DEAD END	1	2		NO	NO	0.32	18	211	15	23	
2020CPT.12.04.20362	Gaston	18	SR 2429 (WILSON RD.)	NC 274 TO DEAD END	1	2		NO	NO	0.41	18	270	19	12	
2020CPT.12.04.20362	Gaston	19	SR 2432 (GRAHAM RD.)	SR 2431 TO DEAD END	1	2		NO	NO	0.47	18	310	22	18	
2020CPT.12.04.20362	Gaston	20	SR 2433 (RATCHFORD FARM RD.)	SR 2431 TO DEAD END	1	2		NO	NO	0.51	18	336	24	16	
2020CPT.12.04.20362	Gaston	21	SR 2482 (KIRKLAND RD.)	SR 2209 TO DEAD END	1	2		NO	NO	0.5	19	348	24	17	
2020CPT.12.04.20362	Gaston	22	SR 2520 (OAK ST./HARRISON DR.)	SR 2519 TO NC 279	1	2		NO	NO	0.41	20	300	21	15	
2020CPT.12.04.20362	Gaston	23	SR 2521 (CREST ST.)	SR 2519 TO SR 2520	2	2		NO	NO	0.07	24	61	4	4	
2020CPT.12.04.20362	Gaston	24	SR 2626 (FLOYD DR.)	SR 2430 TO DEAD END	1	2		NO	NO	0.14	18	92	6	17	
2020CPT.12.04.20362	Gaston	25	SR 2668 (N. LAKE WYLIE RD.)	SR 2520 TO END MAINT AT 0.59 MILE	1	2		NO	NO	0.59	20	432	30	19	
2020CPT.12.04.20362	Gaston	26	SR 2737 (PAM DR.)	SR 2416 TO DEAD END	1	2		NO	NO	0.45	20	330	23	33	
2020CPT.12.04.20362	Gaston	27	SR 2743 (FRANCES CT.)	SR 2742 TO DEAD END	1	2		NO	NO	0.07	20	51	4		
2020CPT.12.04.20362	Gaston	28	SR 2773 (GORDON DR.)	SR 2422 TO DEAD END	1	2		NO	NO	0.33	20	242	17	24	
2020CPT.12.04.20362	Gaston	29	SR 2845 (ARMSTRONG LN.)	SR 2430 TO DEAD END	1	2		NO	NO	0.17	20	124	9	3	
2020CPT.12.04.20362	Gaston	30	SR 3023 (SUMMERGLEN DR.)	SR 2429 TO DEAD END	1	2		NO	NO	0.35	18	231	16	16	
2020CPT.12.04.20362	Gaston	31	SR 3029 (SUMMER PL)	NC 274 TO DEAD END	1	2		NO	NO	0.24	19	167	12	8	
2020CPT.12.04.20362	Gaston	32	SR 3084 (CATAWBA WINDS DR.)	SR 2650 TO DEAD END	1	2		NO	NO	0.48	18	316	22	10	
2020CPT.12.04.20362	Gaston	33	SR 3085 (CATAWBA WOODS CT.)	SR 3084 TO DEAD END	1	2		NO	NO	0.11	18	73	5	3	
2020CPT.12.04.20362	Gaston	34	SR 3096 (CAMERON POINTE LN.)	NC 279 TO DEAD END	1	2		NO	NO	0.27	19	188	13	42	
2020CPT.12.04.20362	Gaston	35	SR 3123 (MALLARD LN.)	SR 1103 TO DEAD END	1	2		NO	NO	0.41	18	270	19	15	
2020CPT.12.04.20362	Gaston	36	SR 3135 (PINTAIL WAY)	SR 3123 TO DEAD END	1	2		NO	NO	0.17	VAR. 20-21	126	9	12	
2020CPT.12.04.20362	Gaston	37	SR 3136 (SAWBILL LN.)	SR 3135 TO DEAD END	1	2		NO	NO	0.37	20	271	19	26	
2020CPT.12.04.20362	Gaston	38	SR 3137 (CANVAS BACK CT.)	SR 3136 TO DEAD END	1	2		NO	NO	0.06	20	44	3	8	
2020CPT.12.04.20362	Gaston	39	SR 3215 (GREGORY CT.)	DEAD END TO DEAD END	3	2		NO	NO	0.17	22	137	10	3	
2020CPT.12.04.20362	Gaston	40	SR 3301 (LIN MAR DR.)	SR 1820 TO DEAD END	1	2		NO	NO	0.59	20	432	30	6	
2020CPT.12.04.20362	Gaston	41	SR 3302 (LIN MAR LN.)	SR 3301 TO DEAD END	1	2		NO	NO	0.14	20	103	7	3	
2020CPT.12.04.20362	Gaston	42	SR 3310 (CANDY TUFF LN.)	SR 1999 TO DEAD END	1	2		NO	NO	0.22	20	161	11	10	
2020CPT.12.04.20362	Gaston	43	SR 3311 (ORCHID CT.)	SR 3310 TO DEAD END	1	2		NO	NO	0.12	20	88	6	4	
2020CPT.12.04.20362	Gaston	44	SR 3333 (STOCKBRIDGE DR.)	SR 1923 TO DEAD END	1	2		NO	NO	0.64	20	469	33	16	
2020CPT.12.04.20362	Gaston	45	SR 3334 (AMBERWOOD DR.)	SR 3333 TO DEAD END	1	2		NO	NO	0.07	20	51	4	1	
2020CPT.12.04.20362	Gaston	46	SR 3335 (CHATHAM DR.)	SR 3333 TO DEAD END	1	2		NO	NO	0.07	20	51	4	1	
2020CPT.12.04.20362	Gaston	47	SR 3336 (BELLINGHAM DR.)	SR 3333 TO DEAD END	1	2		NO	NO	0.07	20	51	4	1	
2020CPT.12.04.20362	Gaston	48	SR 3603 (J AND J LANE)	SR 2431 TO END MAINT AT 0.26 MILE	1	2		NO	NO	0.26	18	171	12	11	
2020CPT.12.04.20362	Gaston	49	SR 3605 (BUTTERFLY CT.)	SR 3604 TO DEAD END	3	2		NO	NO	0.08	20	59	4	1	
2020CPT.12.04.20362	Gaston	50	SR 3606 (PETUNIA CT.)	SR 2435 TO DEAD END	3	2		NO	NO	0.16	20	117	8	5	
TOTAL FOR PROJ NO. 2020CPT.12.04.20362												13.68	9,767	684	770
GRAND TOTAL												13.68	9,767	684	770

PROJECT NO.	SHEET NO.	TOTAL NO.
2020CPT.12.04.20362	15	

THERMOPLASTIC AND PAINT QUANTITIES

PROJECT NO	COUNTY	MAP NO	ROUTE	DESCRIPTION	TYP NO	LANES	LANE TYPE	LENGTH	WIDTH	4413000000-E WORK ZONE ADVANCE/GE NERAL WARNING SIGNING	4457000000-N WORK ZONE TRAFFIC CONTROL
								MI	FT	SF	LS
2020CPT.12.04.20362	Gaston	1	SR 1369 (NELDA ST.)	NC 275 TO SR 1370	1	2		0.2	19	84	*
2020CPT.12.04.20362	Gaston	2	SR 1370 (KNOWLES DR.)	SR 1369 TO DEAD END	3	2		0.2	22	84	*
2020CPT.12.04.20362	Gaston	3	SR 1513 (CHESTNUT WOODS DR.)	SR 1402 TO DEAD END	1	2		0.45	20	84	*
2020CPT.12.04.20362	Gaston	4	SR 1514 (TARY CT.)	SR 1513 TO DEAD END	1	2		0.11	20	84	*
2020CPT.12.04.20362	Gaston	5	SR 1516 (SANDYCREST CT.)	SR 1513 TO DEAD END	1	2		0.3	20	84	*
2020CPT.12.04.20362	Gaston	6	SR 1540 (CRICKET CREEK DR.)	SR 1425 TO DEAD END	1	2		0.37	VAR. 24-25	84	*
2020CPT.12.04.20362	Gaston	7	SR 1949 (ROLLINGWOOD DR.)	NC 16 TO SR 1947	1	2		0.5	18	84	*
2020CPT.12.04.20362	Gaston	8	SR 1980 (OLD BEATY RD.)	NC 16 BUS TO DEAD END	1	2		0.59	20	84	*
2020CPT.12.04.20362	Gaston	9	SR 1981 (GRIFFIN ST.)	NC 16 BUS TO DEAD END	1	2		0.48	20	84	*
2020CPT.12.04.20362	Gaston	10	SR 1982 (OLIVIA CT.)	NC 16 BUS TO DEAD END	1	2		0.18	20	84	*
2020CPT.12.04.20362	Gaston	11	SR 1995 (LARAMIE DR.)	SR 1994 TO LINCOLN COUNTY	1	2		0.02	20	168	*
2020CPT.12.04.20362	Gaston	12	SR 1999 (ROBERT KEEVER RD.)	NC 16 BUS TO SR 3310	1	2		0.28	20	84	*
2020CPT.12.04.20362	Gaston	13	SR 2115 (RACHEL ST.)	SR 1924 TO SR 3215	1	2		0.14	18	84	*
2020CPT.12.04.20362	Gaston	14	SR 2166 (MIDWAY ST.)	SR 2057 TO END PAVEMENT	2	2		0.1	18	84	*
2020CPT.12.04.20362	Gaston	15	SR 2169 (MELODY DR.)	SR 2000 TO END MAINT AT FIRST CULDESAC	1	2		0.19	20	84	*
2020CPT.12.04.20362	Gaston	16	SR 2187 (HANSEL ST.)	SR 1924 TO DEAD END	1	2		0.08	20	87	*
2020CPT.12.04.20362	Gaston	17	SR 2422 (LAKEWOOD DR.)	SR 2416 TO DEAD END	1	2		0.32	18	84	*
2020CPT.12.04.20362	Gaston	18	SR 2429 (WILSON RD.)	NC 274 TO DEAD END	1	2		0.41	18	84	*
2020CPT.12.04.20362	Gaston	19	SR 2432 (GRAHAM RD.)	SR 2431 TO DEAD END	1	2		0.47	18	84	*
2020CPT.12.04.20362	Gaston	20	SR 2433 (RATCHFORD FARM RD.)	SR 2431 TO DEAD END	1	2		0.51	18	84	*
2020CPT.12.04.20362	Gaston	21	SR 2482 (KIRKLAND RD.)	SR 2209 TO DEAD END	1	2		0.5	19	84	*
2020CPT.12.04.20362	Gaston	22	SR 2520 (OAK ST./HARRISON DR.)	SR 2519 TO NC 279	1	2		0.41	20	84	*
2020CPT.12.04.20362	Gaston	23	SR 2521 (CREST ST.)	SR 2519 TO SR 2520	2	2		0.07	24	84	*
2020CPT.12.04.20362	Gaston	24	SR 2626 (FLOYD DR.)	SR 2430 TO DEAD END	1	2		0.14	18	84	*
2020CPT.12.04.20362	Gaston	25	SR 2668 (N. LAKE WYLIE RD.)	SR 2520 TO END MAINT AT 0.59 MILE	1	2		0.59	20	84	*
2020CPT.12.04.20362	Gaston	26	SR 2737 (PAM DR.)	SR 2416 TO DEAD END	1	2		0.45	20	84	*
2020CPT.12.04.20362	Gaston	27	SR 2743 (FRANCES CT.)	SR 2742 TO DEAD END	1	2		0.07	20	84	*
2020CPT.12.04.20362	Gaston	28	SR 2773 (GORDON DR.)	SR 2422 TO DEAD END	1	2		0.33	20	84	*
2020CPT.12.04.20362	Gaston	29	SR 2845 (ARMSTRONG LN.)	SR 2430 TO DEAD END	1	2		0.17	20	84	*
2020CPT.12.04.20362	Gaston	30	SR 3023 (SUMMERGLEN DR.)	SR 2429 TO DEAD END	1	2		0.35	18	84	*
2020CPT.12.04.20362	Gaston	31	SR 3029 (SUMMER PL)	NC 274 TO DEAD END	1	2		0.24	19	84	*
2020CPT.12.04.20362	Gaston	32	SR 3084 (CATAWBA WINDS DR.)	SR 2650 TO DEAD END	1	2		0.48	18	84	*
2020CPT.12.04.20362	Gaston	33	SR 3085 (CATAWBA WOODS CT.)	SR 3084 TO DEAD END	1	2		0.11	18	84	*
2020CPT.12.04.20362	Gaston	34	SR 3096 (CAMERON POINTE LN.)	NC 279 TO DEAD END	1	2		0.27	19	84	*
2020CPT.12.04.20362	Gaston	35	SR 3123 (MALLARD LN.)	SR 1103 TO DEAD END	1	2		0.41	18	84	*
2020CPT.12.04.20362	Gaston	36	SR 3135 (PINTAIL WAY)	SR 3123 TO DEAD END	1	2		0.17	VAR. 20-21	84	*
2020CPT.12.04.20362	Gaston	37	SR 3136 (SAWBILL LN.)	SR 3135 TO DEAD END	1	2		0.37	20	84	*
2020CPT.12.04.20362	Gaston	38	SR 3137 (CANVAS BACK CT.)	SR 3136 TO DEAD END	1	2		0.06	20	84	*
2020CPT.12.04.20362	Gaston	39	SR 3215 (GREGORY CT.)	DEAD END TO DEAD END	3	2		0.17	22	84	*
2020CPT.12.04.20362	Gaston	40	SR 3301 (LIN MAR DR.)	SR 1820 TO DEAD END	1	2		0.59	20	84	*
2020CPT.12.04.20362	Gaston	41	SR 3302 (LIN MAR LN.)	SR 3301 TO DEAD END	1	2		0.14	20	84	*
2020CPT.12.04.20362	Gaston	42	SR 3310 (CANDY TUFF LN.)	SR 1999 TO DEAD END	1	2		0.22	20	84	*
2020CPT.12.04.20362	Gaston	43	SR 3311 (ORCHID CT.)	SR 3310 TO DEAD END	1	2		0.12	20	84	*
2020CPT.12.04.20362	Gaston	44	SR 3333 (STOCKBRIDGE DR.)	SR 1923 TO DEAD END	1	2		0.64	20	84	*
2020CPT.12.04.20362	Gaston	45	SR 3334 (AMBERWOOD DR.)	SR 3333 TO DEAD END	1	2		0.07	20	84	*
2020CPT.12.04.20362	Gaston	46	SR 3335 (CHATHAM DR.)	SR 3333 TO DEAD END	1	2		0.07	20	84	*
2020CPT.12.04.20362	Gaston	47	SR 3336 (BELLINGHAM DR.)	SR 3333 TO DEAD END	1	2		0.07	20	84	*
2020CPT.12.04.20362	Gaston	48	SR 3603 (J AND J LANE)	SR 2431 TO END MAINT AT 0.26 MILE	1	2		0.26	18	84	*
2020CPT.12.04.20362	Gaston	49	SR 3605 (BUTTERFLY CT.)	SR 3604 TO DEAD END	3	2		0.08	20	84	*
2020CPT.12.04.20362	Gaston	50	SR 3606 (PETUNIA CT.)	SR 2435 TO DEAD END	3	2		0.16	20	84	*
TOTAL FOR PROJ NO. 2020CPT.12.04.20362								13.68		4,287	*
GRAND TOTAL								13.68		4,287	1

SIGNING FOR RESURFACING PROJECTS

LEGEND

┆ STATIONARY SIGN

← DIRECTION OF TRAFFIC FLOW

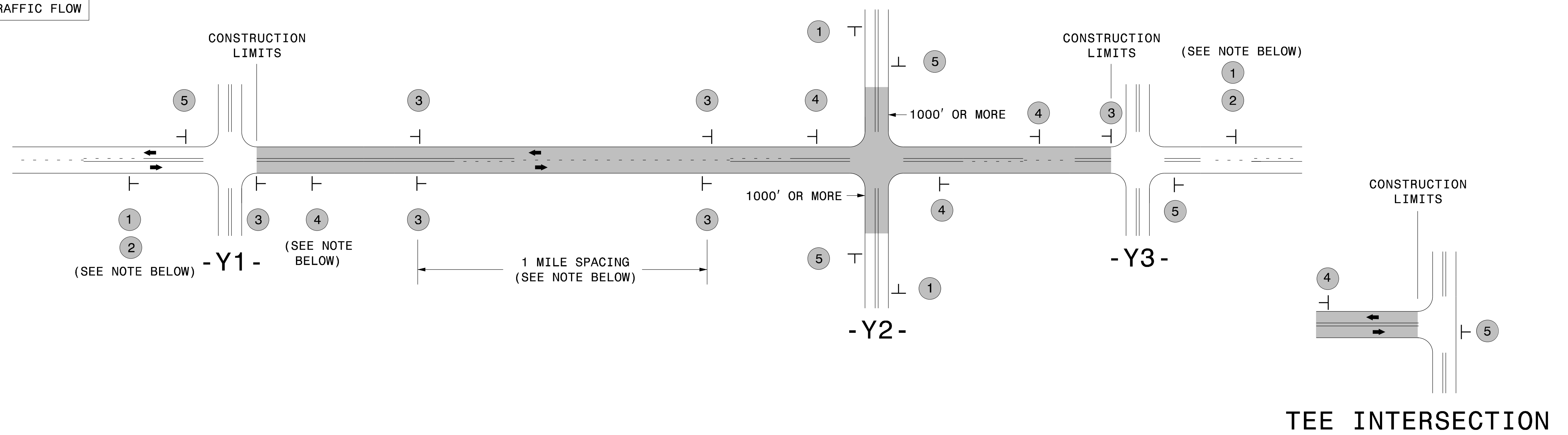

MAINLINE (-L-) SIGNING

-Y- LINE SIGNING

SIGNING NOTES AND PLACEMENT PER DIRECTION	1	 W20-1 48" X 48"	PLACE 1000' PRIOR TO BEGINNING OF CONSTRUCTION LIMITS. ONLY USED ON -Y- LINES IF RESURFACING LIMITS EXTEND 1000' ALONG -Y- LINE.	<p>NO REQUIRED STATIONARY SIGNING FOR THE FOLLOWING -Y- LINE CONDITIONS:</p> <ol style="list-style-type: none"> LESS THAN 1000' OF RESURFACING ALONG -Y- LINE SUBDIVISION ROADS DEAD END ROADS <p>WHEN PAVING/CONSTRUCTION ACTIVITIES PROCEED ACROSS AN UNSIGNED -Y- LINE, PORTABLE ADVANCE WARNING SIGNS SHALL BE USED ALONG THE -Y- LINE AS SHOWN BELOW. REMOVE UPON COMPLETION OF WORK.</p> <div style="display: flex; justify-content: space-around;"> <div style="text-align: center;"> W20-1 48" X 48" </div> <div style="text-align: center;"> W20-7 A 48" X 48" </div> </div> <p>PLACED 500' IN ADVANCE OF FLAGGER. PLACED 250' IN ADVANCE OF FLAGGER.</p>
	2	 W7-3aP 24" X 18"	#2 SIGN ONLY USED WHEN CONSTRUCTION LIMITS ARE 2 OR MORE MILES IN LENGTH. ROUND UP TO NEXT WHOLE NUMBER. (NO FRACTIONAL OR DECIMAL NUMBERS)	
	3	 SP 13107 48" X 48"	<ul style="list-style-type: none"> PLACE INITIALLY AT THE CONSTRUCTION LIMITS AND SPACE 1 MILE APART THEREAFTER. AT TEE INTERSECTIONS INSTALL INITIALLY 1/2 MILE FROM INTERSECTION AND SPACE 1 MILE APART THEREAFTER. 	
	4	 SP 13106 48" X 48"	<ul style="list-style-type: none"> THESE ARE FOR -Y- LINES THAT ARE "THROUGH" ROADWAYS. DEAD END AND SUBDIVISION ROADS ARE NOT "THROUGH" ROADWAYS. INSTALL 500' +/- FROM EACH -Y- LINE APPROACH AS SHOWN ABOVE. FOR MULTIPLE -Y- LINES THAT ARE SEPARATED BY 0.25 MILES OR LESS, TREAT AS A SINGLE UNIT AND INSTALL WITHIN 500' OF EACH APPROACH. A MAXIMUM OF 2 SIGN SETS PER MILE. DO NOT INSTALL WHEN -Y- LINES ARE WITHIN 0.5 MILES FROM "END ROAD WORK" SIGN. FOR TEE INTERSECTIONS, INSTALL WITHIN 500' +/- OF THE INTERSECTION ALONG -L- LINE. 	
	5	 G20-2 A 48" X 24"	PLACE 500' FOLLOWING THE END OF CONSTRUCTION LIMITS OR AS SHOWN WHEN WORK ENDS AT A 3-WAY TEE INTERSECTION.	

THE ABOVE SIGNS ARE ALL THAT ARE REQUIRED FOR A CONTRACTOR TO BEGIN A RESURFACING CONTRACT. ANY ADDITIONAL SIGNS REQUESTED BY NCDOT DIVISIONS SHALL BE INSTALLED WITHIN 7 BUSINESS DAYS OF THE START OF CONTRACT WORK.

MAPS LESS THAN 2 MILES

FOR RESURFACING MAPS WITH CONSTRUCTION LIMITS LESS THAN 2 MILES IN LENGTH, NO STATIONARY SIGNS ARE REQUIRED. USE PORTABLE "ROAD UNDER CONSTRUCTION" OR "ROAD WORK AHEAD" SIGNS IN LIEU OF STATIONARY ADVANCE WARNINGS SIGNS.

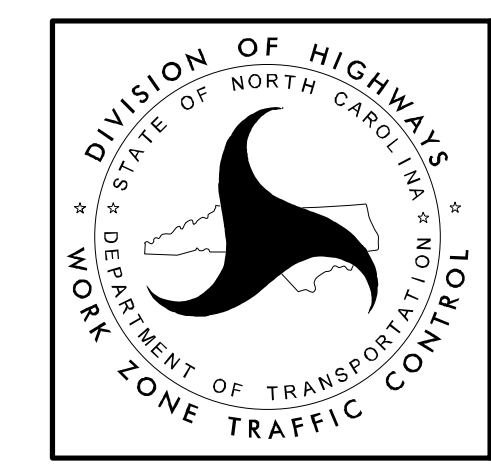

ADVANCE WARNING SIGNS FOR RURAL AND SUBURBAN 2-LANE ROADWAY RESURFACING

5/15/2017 S:\TUX\WZTC\Resurfacing\2L2W & AST Resurfacing Details\Resurfacing_AdvWarn_2Ln.dgn User:kadai