

**This electronic collection of documents is provided
for the convenience of the user
and is Not a Certified Document –**

**The documents contained herein were originally issued
and sealed by the individuals whose names and license
numbers appear on each page, on the dates appearing
with their signature on that page.**

**This file or an individual page
shall not be considered a certified document.**

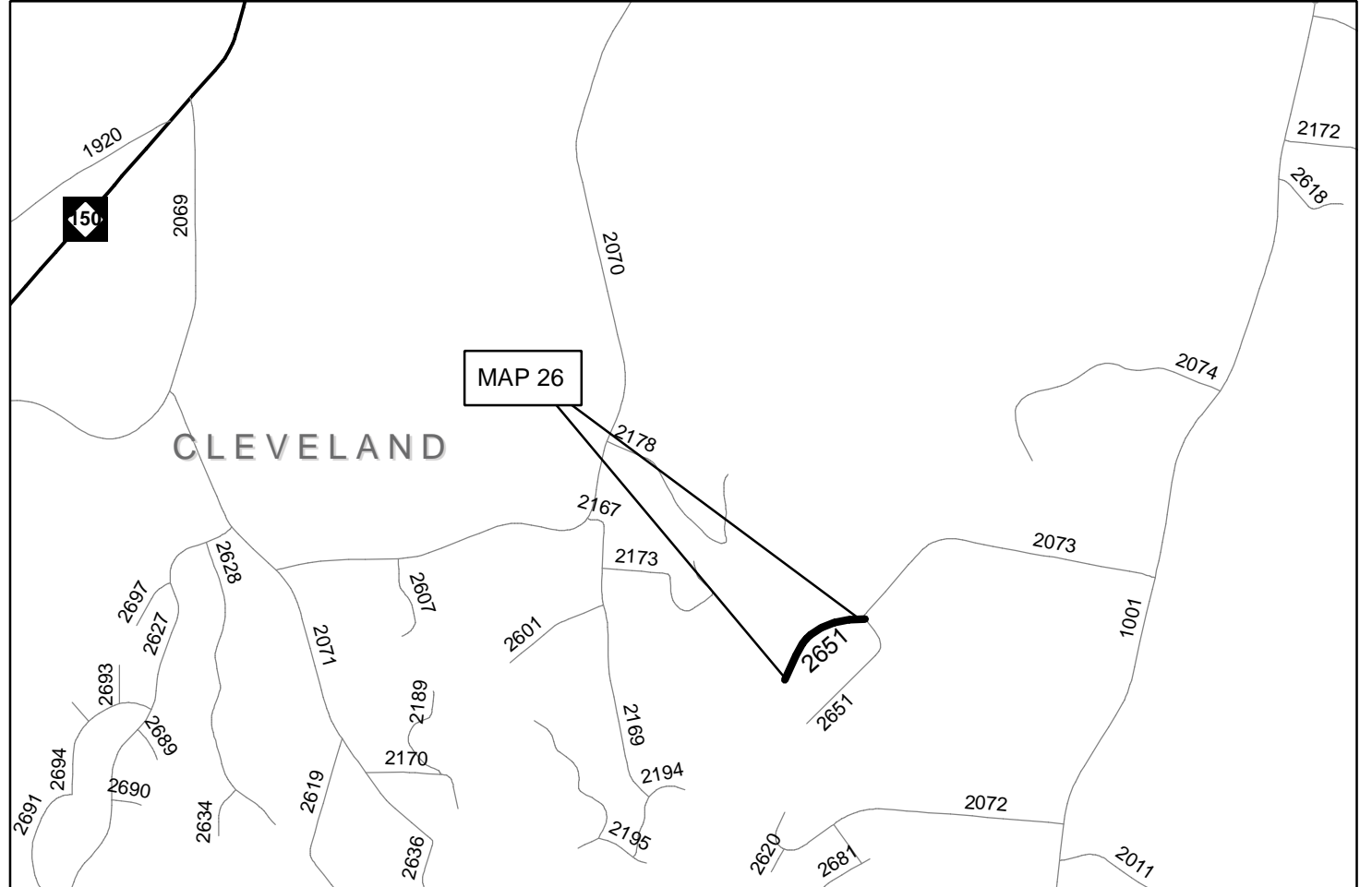

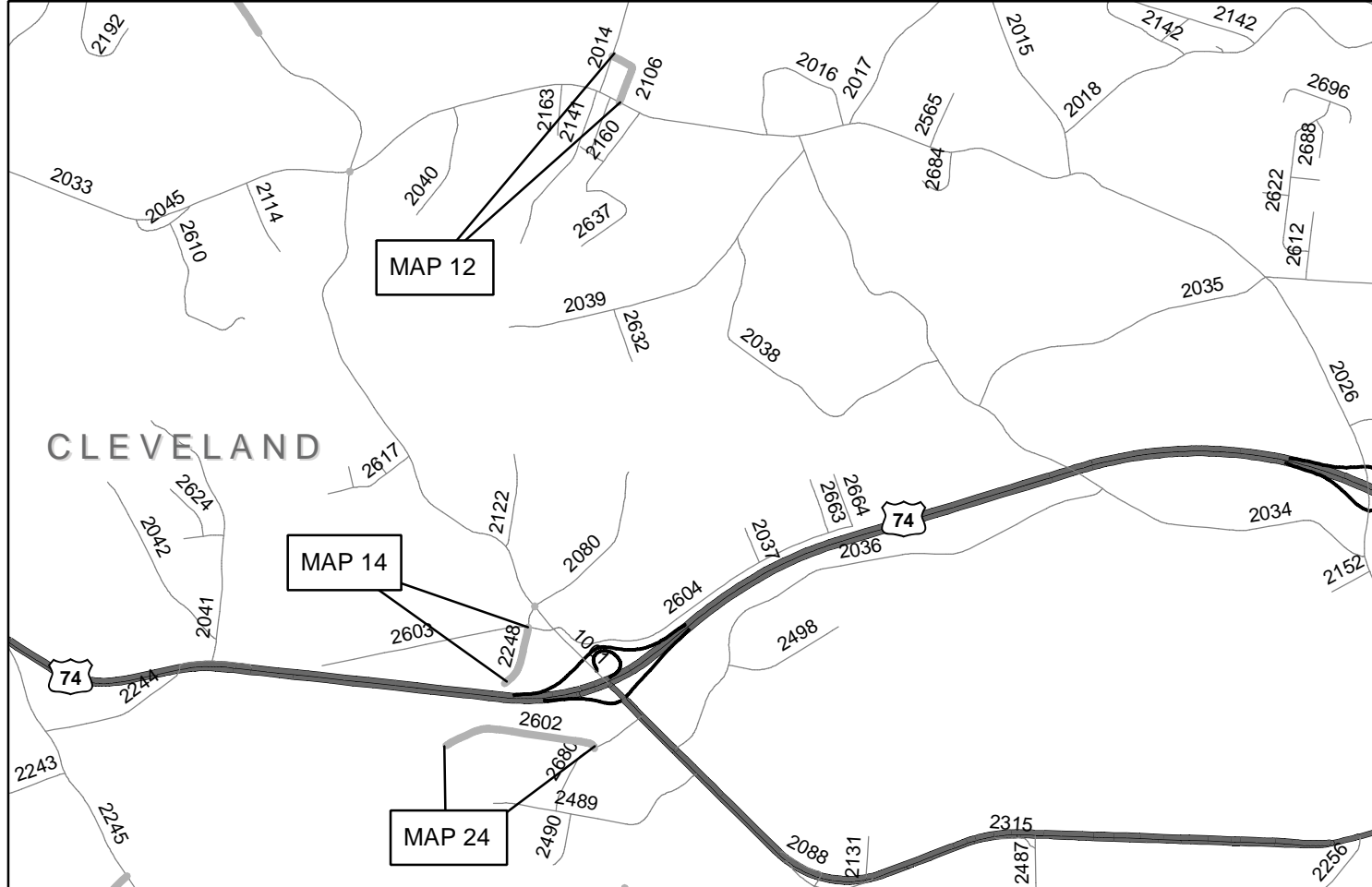
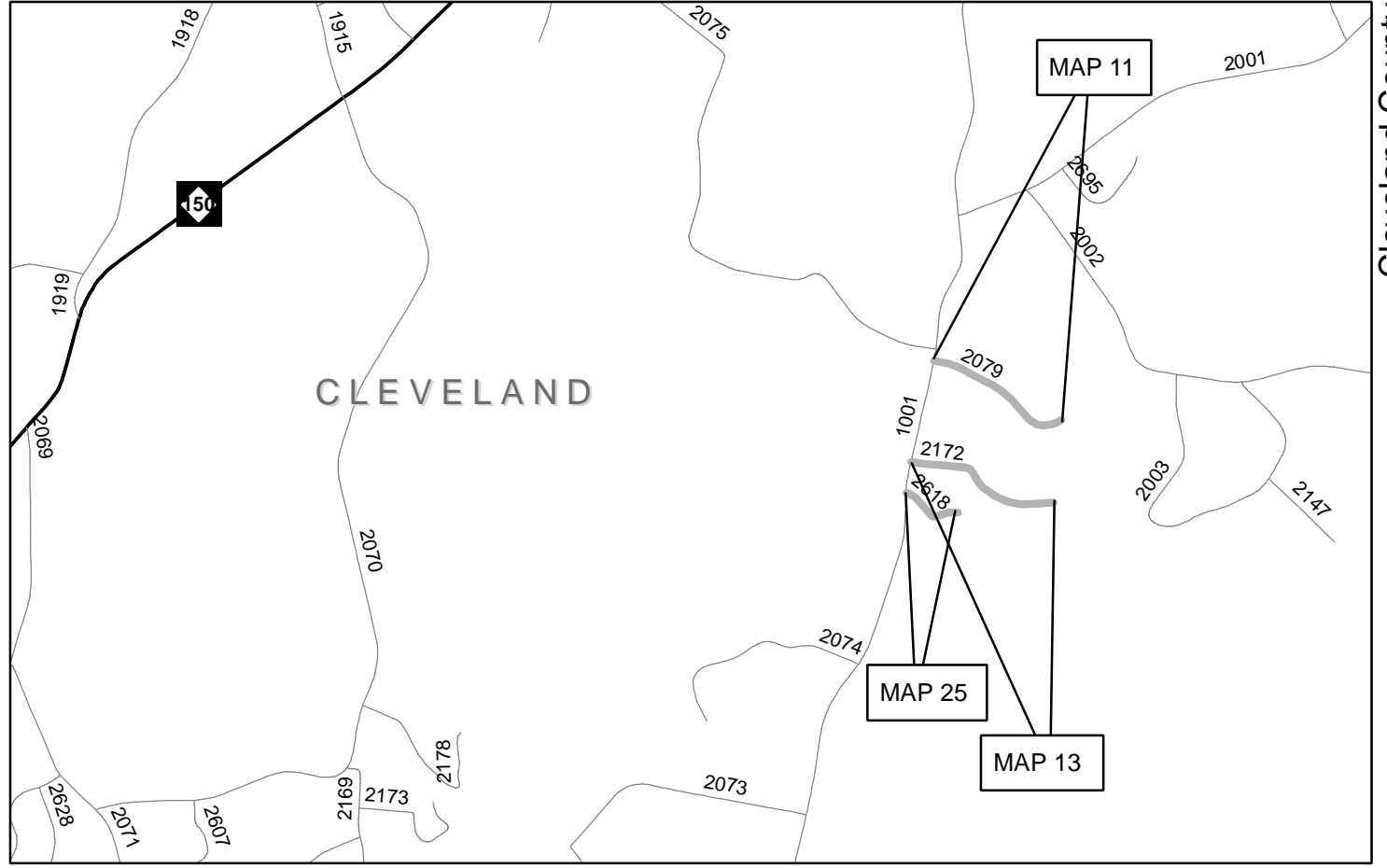
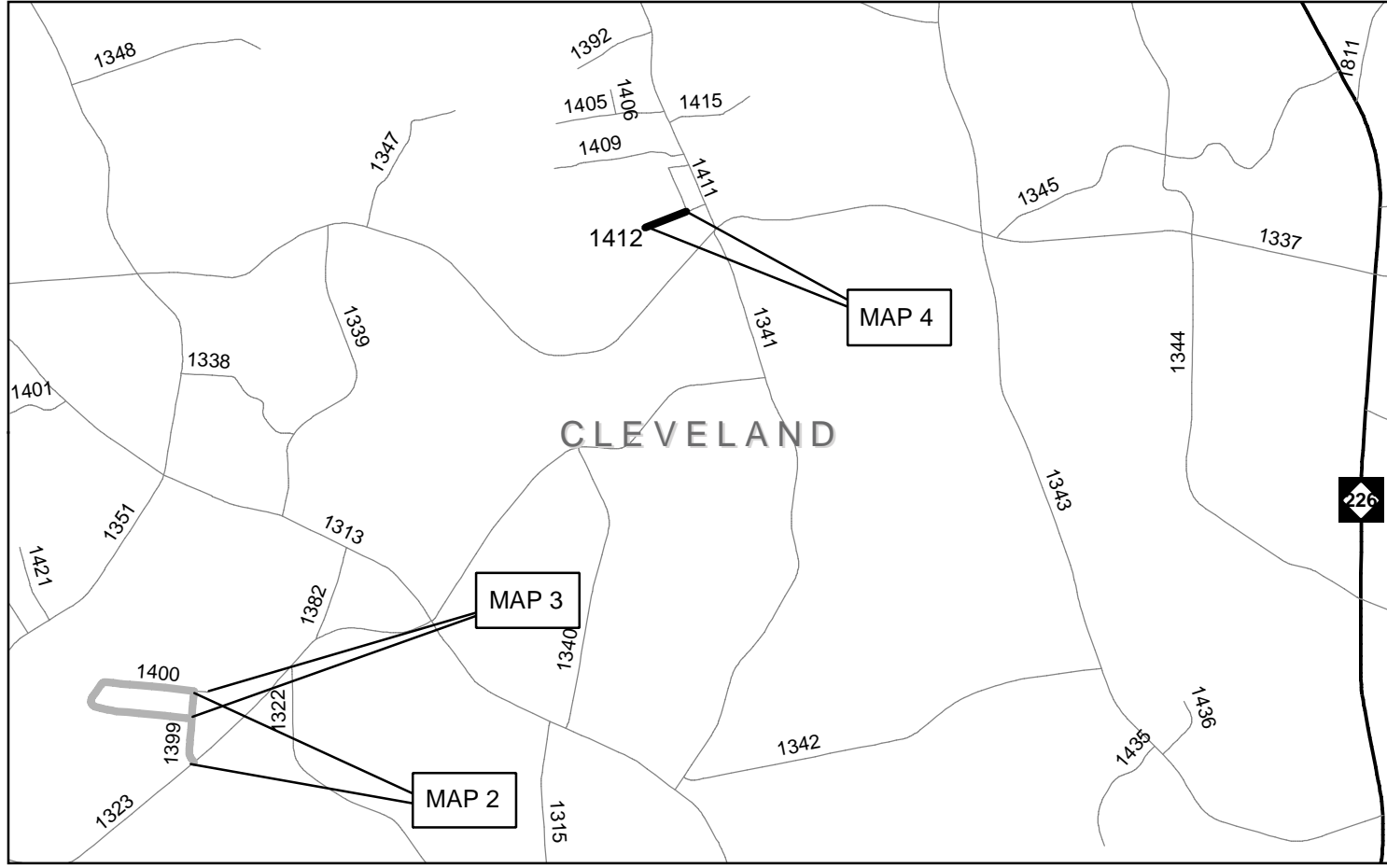
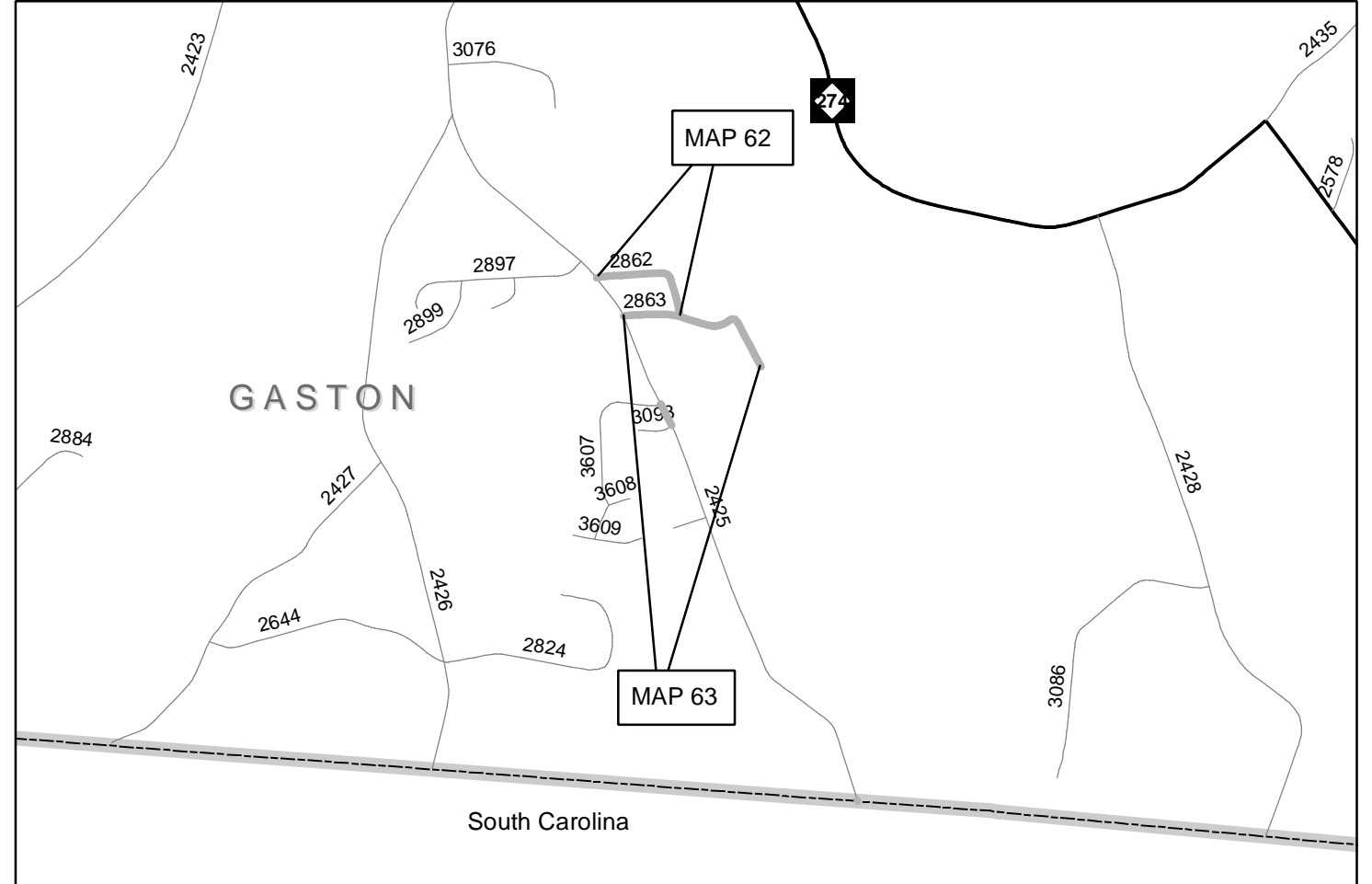
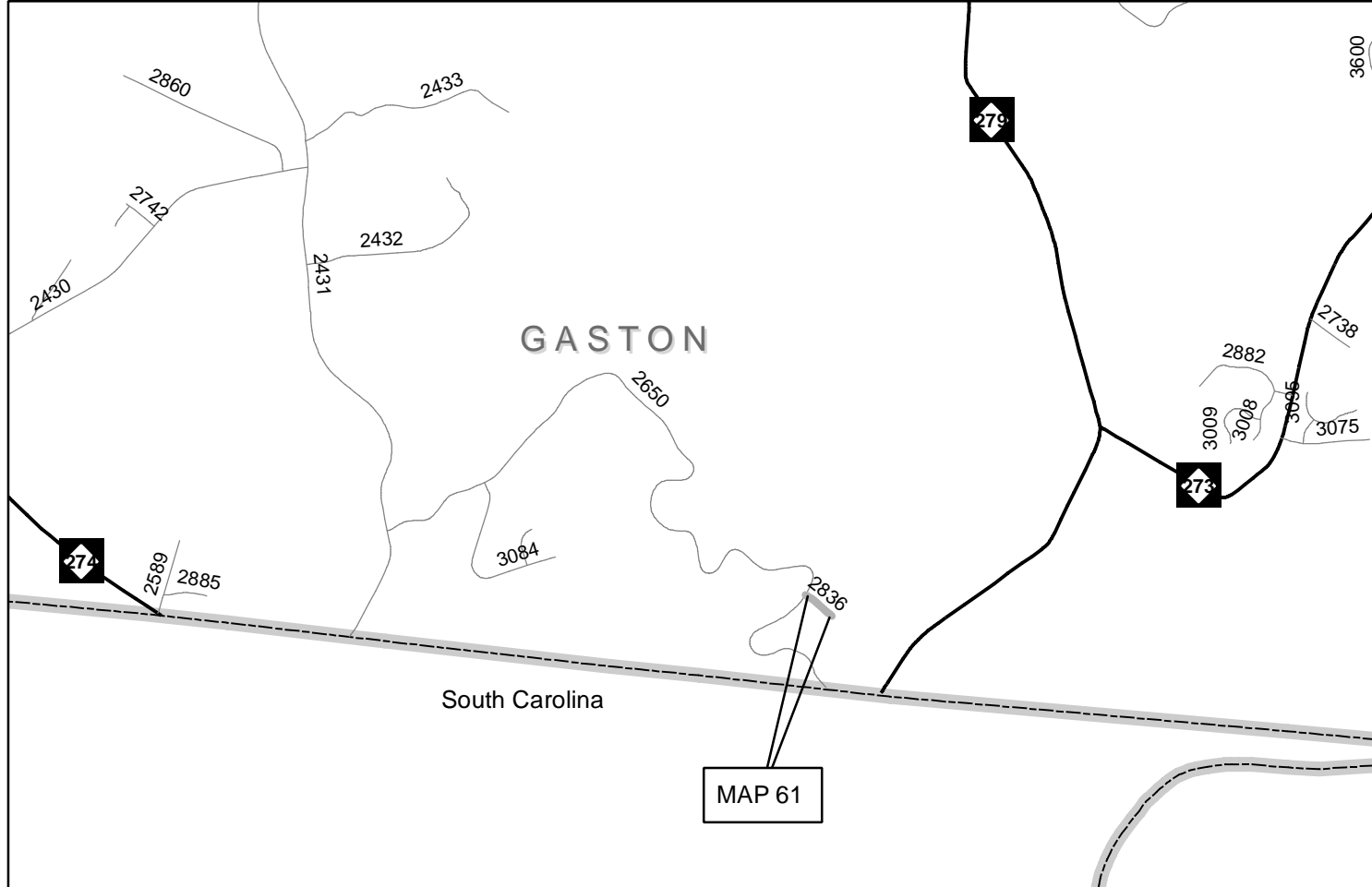
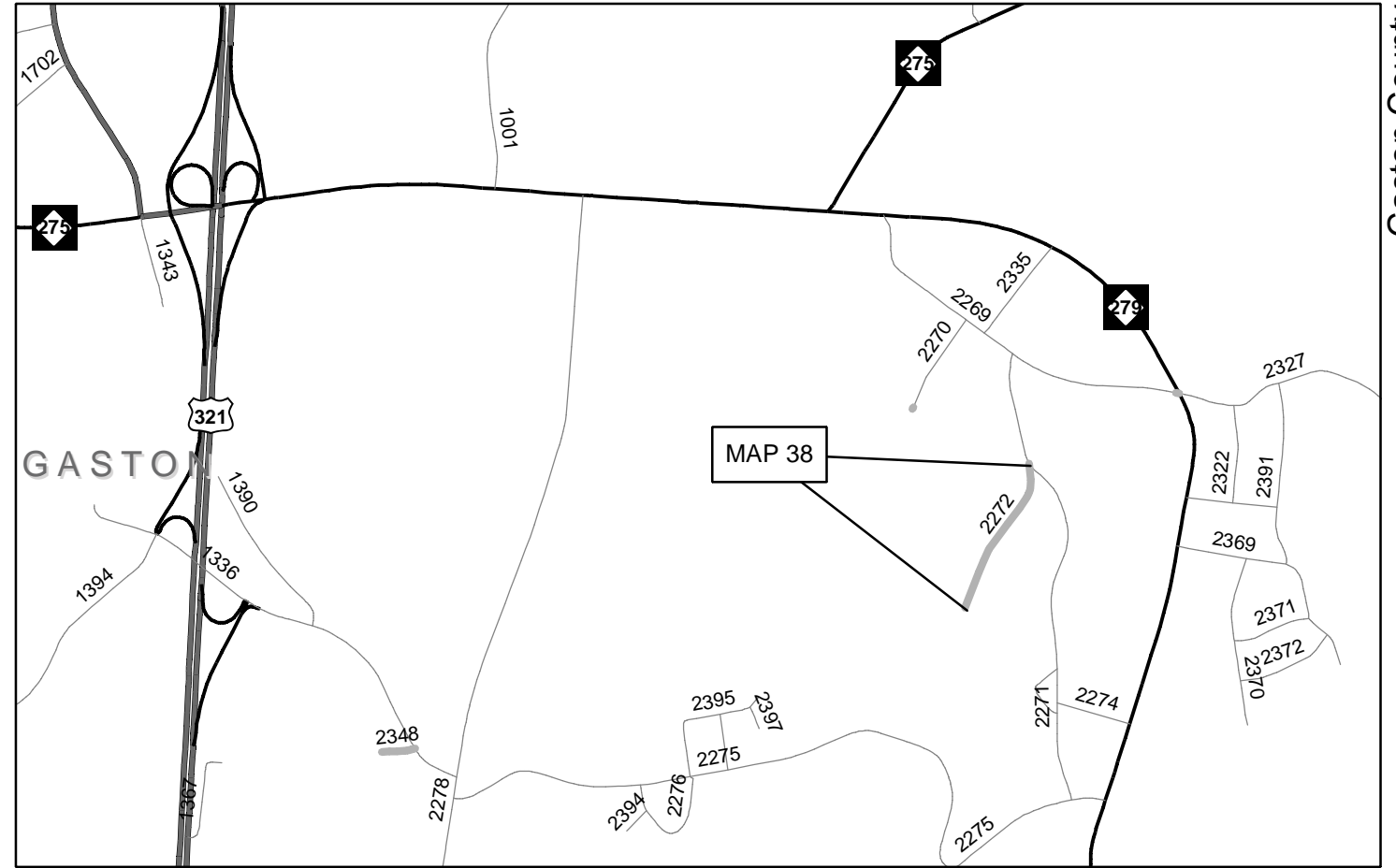
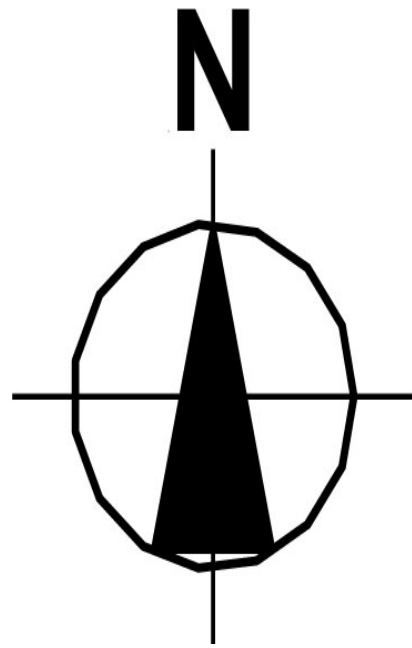

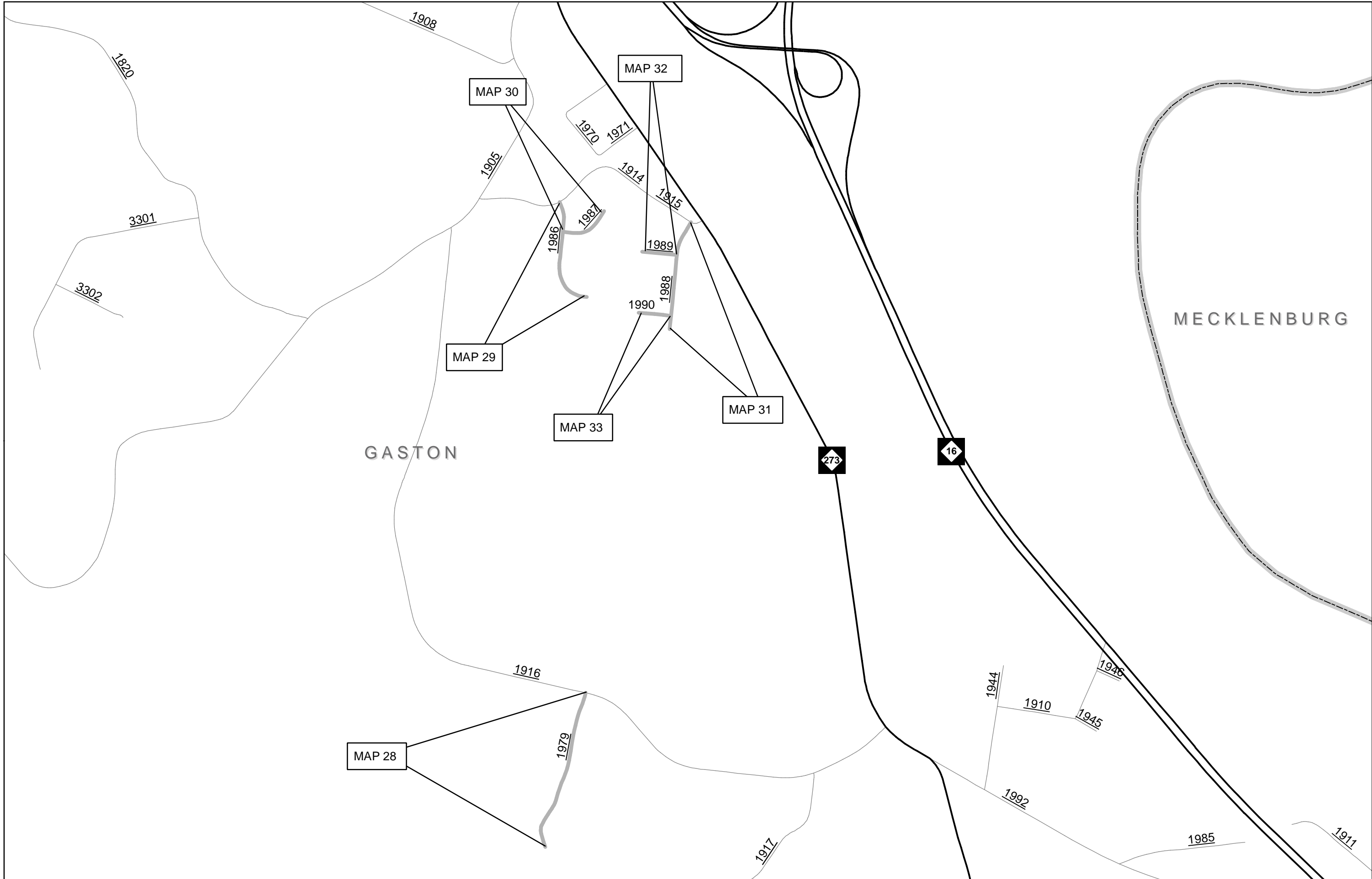

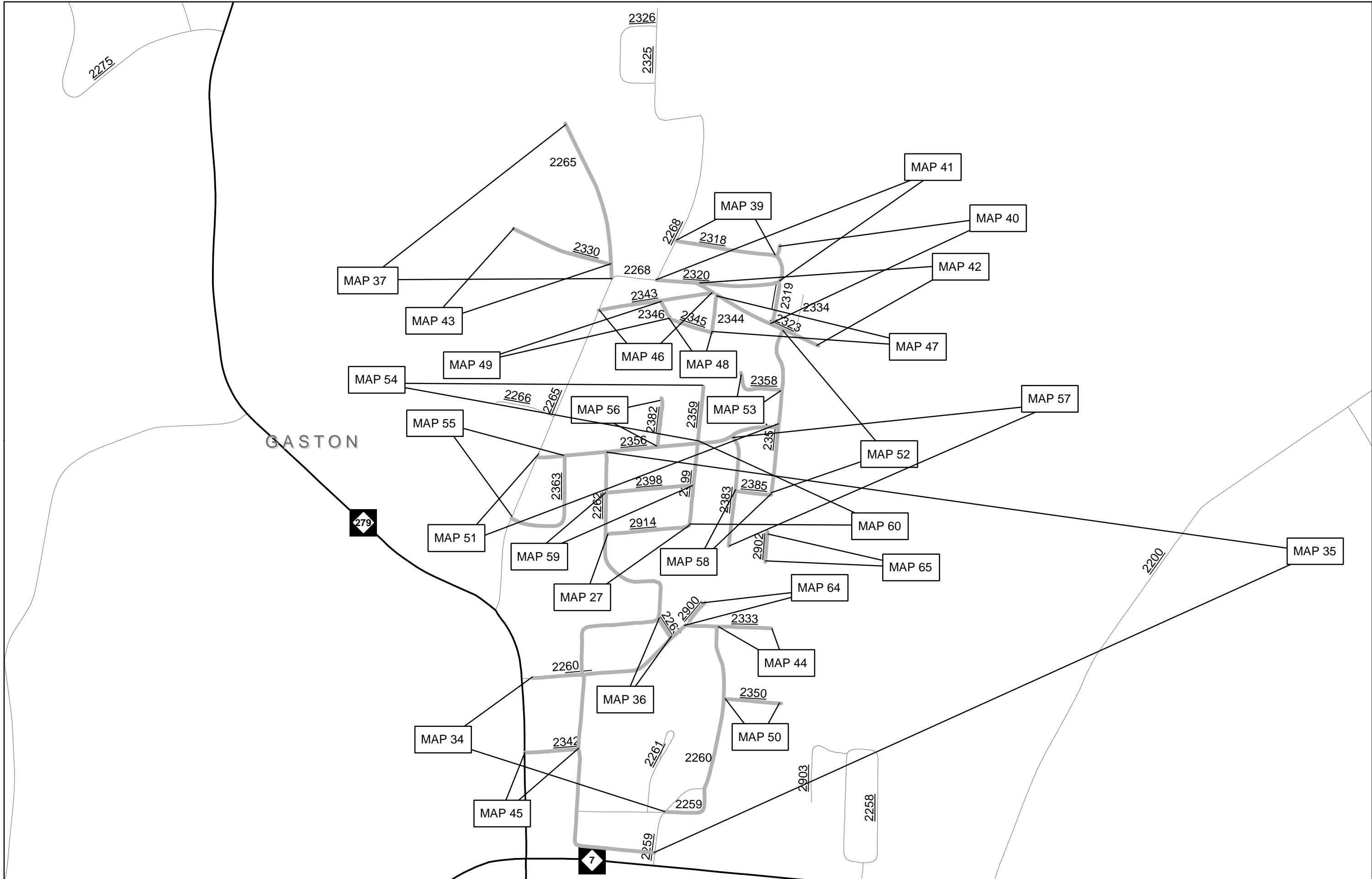

PAVEMENT SCHEDULE	
C	PROP. APPROX. 3/4" ASPHALT CONCRETE SURFACE COURSE, TYPE S 4.75A, AT AN AVERAGE RATE OF 95 LBS. PER SQ. YD.

NOTE: PAVEMENT EDGE SLOPES ARE 1:1 UNLESS SHOWN OTHERWISE.

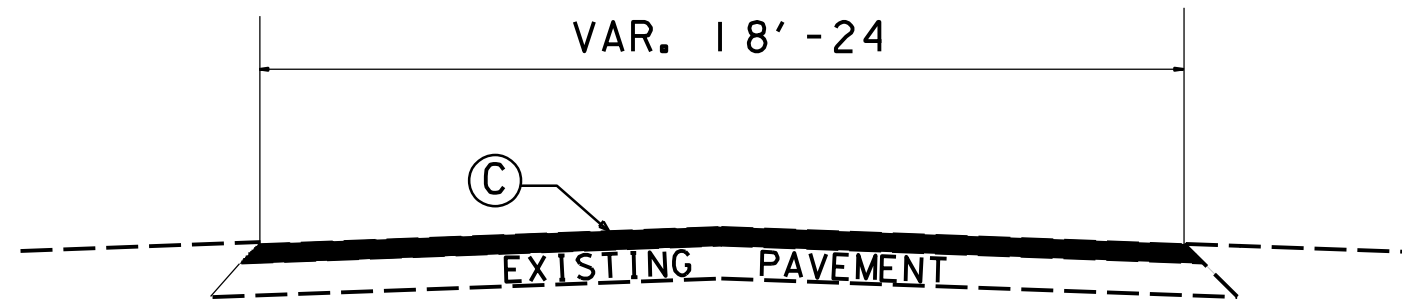

TYPICAL SECTION NO. 1

(MAPS 1 - 11, 13 - 36, 38-42, 44-45, 49-65)

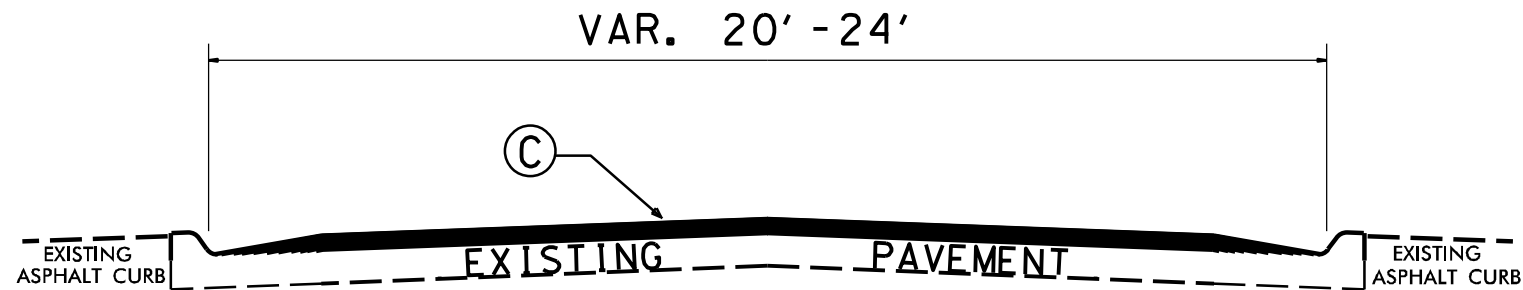

TYPICAL SECTION NO. 2

(MAPS 12, 35, 37, 43, 46-48)

2017-2018
PAVEMENT PRESERVATION
TYPICAL SECTIONS
CLEVELAND & GASTON CO.'S

PROJECT NO.	SHEET NO.	TOTAL NO.
2017CPT.12.30.20232, 2017CPT.12.30.20362	8	

SUMMARY OF QUANTITIES

PROJECT NO	COUNTY	MAP	ROUTE	DESCRIPTION	TYP	LANES	FINAL SURFACE TESTING REQUIRED	WARM MIX ASPHALT REQUIRED	LENGTH MI	WIDTH FT	SURFACE COURSE, S4.75A		PARTIAL DEPTH REPAIR TONS
											TONS	TONS	
2017CPT.12.30.20232	Cleveland	1	SR 1284 (RONALD DR)	SR 1121 TO END MAINT	NO	1	NO	NO	0.071	18	41	3	5
2017CPT.12.30.20232	Cleveland	2	SR 1399 (DAWN DR)	SR 1323 TO SR 1400	1	2	NO	NO	0.256	20	165	12	17
2017CPT.12.30.20232	Cleveland	3	SR 1400 (SOUTH/NORTH WHITE OAK DR)	SR 1399 TO DE	1	2	NO	NO	0.818	20	528	37	53
2017CPT.12.30.20232	Cleveland	4	SR 1412 (BUSHY CRK EXT)	SR 1411 TO DE	1	2	NO	NO	0.1	20	65	5	7
2017CPT.12.30.20232	Cleveland	5	SR 1565 (CLYDE ST)	SR 1538 TO DE	1	2	NO	NO	0.232	18	135	9	14
2017CPT.12.30.20232	Cleveland	6	SR 1566 (BRACKETT ST)	SR 1565 TO DE	1	2	NO	NO	0.132	20	85	6	9
2017CPT.12.30.20232	Cleveland	7	SR 1568 (HAPPY VALLEY DR)	SR 1565 TO DE	1	2	NO	NO	0.052	18	30	2	3
2017CPT.12.30.20232	Cleveland	8	SR 1673 (WARLUCK ST)	SR 1604 TO DE	1	2	NO	NO	0.481	18	279	20	28
2017CPT.12.30.20232	Cleveland	9	SR 1674 (WHITE ST)	NC 10 TO SR 1673	1	2	NO	NO	0.175	18	102	7	10
2017CPT.12.30.20232	Cleveland	10	SR 1682 (DEVINEY ST)	NC 10 TO DE	1	2	NO	NO	0.162	24	125	9	13
2017CPT.12.30.20232	Cleveland	11	SR 2079 (ROSS RD)	SR 1001 TO DE	1	2	NO	NO	0.394	18	229	16	23
2017CPT.12.30.20232	Cleveland	12	SR 2106 (WAVE RD)	SR 2033 TO DE	2	2	NO	NO	0.216	24	167	12	17
2017CPT.12.30.20232	Cleveland	13	SR 2172 (ENOLA DR)	SR 1001 TO DE	1	2	NO	NO	0.417	18	242	17	24
2017CPT.12.30.20232	Cleveland	14	SR 2248 (BETHWARE DR)	SR 2603 TO DE	1	2	NO	NO	0.226	18	131	9	13
2017CPT.12.30.20232	Cleveland	15	SR 2300 (DYER DR)	SR 2200 TO END MAINT	1	2	NO	NO	0.401	20	259	18	26
2017CPT.12.30.20232	Cleveland	16	SR 2378 (LAKE VIEW DR)	SR 2201 TO SR 2379	1	2	NO	NO	0.083	20	54	4	5
2017CPT.12.30.20232	Cleveland	17	SR 2379 (LAKE VIEW DR)	SR 2201 TO SR 2378	1	2	NO	NO	0.234	20	151	11	15
2017CPT.12.30.20232	Cleveland	18	SR 2410 (MANCHESTER DR)	SR 2317 TO SR 2412	1	2	NO	NO	0.341	20	220	15	22
2017CPT.12.30.20232	Cleveland	19	SR 2411 (W KELLY LN)	SR 2410 TO SR 2412	1	2	NO	NO	0.122	18	71	5	7
2017CPT.12.30.20232	Cleveland	20	SR 2412 (JANEA PL)	SR 2411 TO SR 2410	1	2	NO	NO	0.092	18	53	4	5
2017CPT.12.30.20232	Cleveland	21	SR 2435 (SYLVIA DR)	SR 2201 TO DE	1	2	NO	NO	0.253	20	163	11	16
2017CPT.12.30.20232	Cleveland	22	SR 2436 (CHESTERFIELD DR)	SR 2435 TO SR 2437	1	2	NO	NO	0.211	20	136	10	14
2017CPT.12.30.20232	Cleveland	23	SR 2437 (WINSTON DR)	SR 2201 TO SR 2436	1	2	NO	NO	0.079	20	51	4	5
2017CPT.12.30.20232	Cleveland	24	SR 2602 (VESTIBULE CH RD)	SR 2680 (PVMT CHG) TO DE	1	2	NO	NO	0.554	20	358	25	36
2017CPT.12.30.20232	Cleveland	25	SR 2618 (GODDARD RD)	SR 1001 TO DE	1	2	NO	NO	0.165	18	96	7	10
2017CPT.12.30.20232	Cleveland	26	SR 2651 (THAMON RD)	SR 2073 TO CDS	1	2	NO	NO	0.3	20	194	14	19
TOTAL FOR PROJ NO. 2017CPT.12.30.20232													
										6.567	4,130	289	416
2017CPT.12.30.20362	Gaston	27	SR 2914 (DOUGLAS DR)	SR 2399 TO SR 2262	1	2	NO	NO	0.152	20	98	7	9
2017CPT.12.30.20362	Gaston	28	SR 1979 (BLACKBERRY LN)	SR 1916 TO DE	1	2	NO	NO	0.368	20	237	17	24
2017CPT.12.30.20362	Gaston	29	SR 1986 (FOX TRAIL DR)	SR 1914 TO CDS	1	2	NO	NO	0.252	20	163	11	16
2017CPT.12.30.20362	Gaston	30	SR 1987 (GRAY FOX LN)	SR 1986 TO CDS	1	2	NO	NO	0.115	20	74	5	7
2017CPT.12.30.20362	Gaston	31	SR 1988 (FOX DEN DR)	SR 1915 TO CDS	1	2	NO	NO	0.25	20	161	11	16
2017CPT.12.30.20362	Gaston	32	SR 1989 (SILVER FOX CT)	SR 1988 TO CDS	1	2	NO	NO	0.06	20	39	3	4
2017CPT.12.30.20362	Gaston	33	SR 1990 (RED FOX CT)	SR 1988 TO CDS	1	2	NO	NO	0.074	20	48	3	5
2017CPT.12.30.20362	Gaston	34	SR 2260 (MORNINGSIDE DR/LEROY AVE)	SR 2259 TO NC 279	1	2	NO	NO	0.791	20	510	36	51
2017CPT.12.30.20362	Gaston	35	SR 2262 (FRANCIS ST/CECELIA DR)	SR 2259 TO SR 2356	1	2	NO	NO	0.072	VAR. 18-20	651	46	65
2017CPT.12.30.20362	Gaston	36	SR 2263 (BLACK SPRINGS DR)	SR 2262 TO SR 2260	1	2	NO	NO	0.043	20	28	2	3
2017CPT.12.30.20362	Gaston	37	SR 2265 (AUTEN RD)	SR 2268 TO DE	2	2	NO	NO	0.298	20	192	13	19
2017CPT.12.30.20362	Gaston	38	SR 2272 (ROSEWOOD LN)	SR 2271 TO DE	1	2	NO	NO	0.285	18	166	12	17
2017CPT.12.30.20362	Gaston	39	SR 2318 (JAMAICA AVE)	SR 2268 TO SR 2319	1	2	NO	NO	0.184	20	119	8	12
2017CPT.12.30.20362	Gaston	40	SR 2319 (PANAMA ST)	SR 2323 TO DE	1	2	NO	NO	0.148	20	96	7	10
2017CPT.12.30.20362	Gaston	41	SR 2320 (ACAPULCO DR)	SR 2268 TO SR 2319	1	2	NO	NO	0.223	20	144	10	14
2017CPT.12.30.20362	Gaston	42	SR 2332 (SUNSET ST)	SR 2320 TO END MAINT	1	2	NO	NO	0.248	20	160	11	16
2017CPT.12.30.20362	Gaston	43	SR 2330 (HOWARD AVE)	SR 2265 TO CDS	2	2	NO	NO	0.189	20	122	9	12
2017CPT.12.30.20362	Gaston	44	SR 2333 (LEROY EXTENSION)	SR 2260 TO DE	1	2	NO	NO	0.098	18	57	4	6
2017CPT.12.30.20362	Gaston	45	SR 2342 (WARD AVE)	SR 2262 TO NC 279	1	2	NO	NO	0.097	20	63	4	6
2017CPT.12.30.20362	Gaston	46	SR 2343 (POWERLINE DR)	SR 2265 TO SR 2323	2	2	NO	NO	0.21	20	136	9	14
2017CPT.12.30.20362	Gaston	47	SR 2344 (SUNNYDALE DR)	SR 2323 TO SR 2345	2	2	NO	NO	0.069	20	45	3	5
2017CPT.12.30.20362	Gaston	48	SR 2345 (DALEWOOD DR)	SR 2344 TO SR 2346	2	2	NO	NO	0.077	20	50	3	5
2017CPT.12.30.20362	Gaston	49	SR 2346 (DALEWOOD DR)	SR 2345 TO SR 2343	1	2	NO	NO	0.039	20	25	2	3
2017CPT.12.30.20362	Gaston	50	SR 2350 (MILL ST)	SR 2260 TO DE	1	2	NO	NO	0.105	20	68	5	7
2017CPT.12.30.20362	Gaston	51	SR 2356 (BROOKNEAL DR)	SR 2357 TO SR 2265	1	2	NO	NO	0.443	20	286	20	29
2017CPT.12.30.20362	Gaston	52	SR 2357 (ALPINE LN)	SR 2323 TO SR 2385	1	2	NO	NO	0.303	20	196	14	20
2017CPT.12.30.20362	Gaston	53	SR 2358 (CLOVERWOOD LN)	SR 2357 TO DE	1	2	NO	NO	0.098	20	63	4	6
2017CPT.12.30.20362	Gaston	54	SR 2359 (FLEETWOOD DR)	SR 2356 TO DE	1	2	NO	NO	0.103	20	66	5	7
2017CPT.12.30.20362	Cleveland	55	SR 2363 (RHONDA DR)	SR 2265 TO SR 2356	1	2	NO	NO	0.217	20	140	10	14
2017CPT.12.30.20362	Gaston	56	SR 2382 (RHYNELAND CIR)	SR 2356 TO DE	1	2	NO	NO	0.089	20	57	4	6
2017CPT.12.30.20362	Gaston	57	SR 2383 (OLD ENGLISH DR)	SR 2356 TO DE	1	2	NO	NO	0.202	20	130	9	13
2017CPT.12.30.20362	Gaston	58	SR 2385 (RIDGEWOOD DR)	SR 2357 TO SR 2383	1	2	NO	NO	0.065	20	42	3	4
2017CPT.12.30.20362	Gaston	59	SR 2398 (RIDGEWOOD DR)	SR 2262 TO SR 2399	1	2	NO	NO	0.158	20	102	7	10
2017CPT.12.30.20362	Gaston	60	SR 2399 (FLEETWOOD DR)	SR 2356 TO SR 2914	1	2	NO	NO	0.148	20	96	7	10
2017CPT.12.30.20362	Gaston	61	SR 2836 (CATAWBA COVE LN)	SR 2650 TO DE	1	2	NO	NO	0.09	20	58	4	6
2017CPT.12.30.20362	Gaston	62	SR 2862 (GATEWOOD DR)	SR 2425 TO SR 2863	1	2	NO	NO	0.248	20	160	11	16
2017CPT.12.30.20362	Gaston	63	SR 2863 (SCOTT DR)	SR 2425 TO DE	1	2	NO	NO	0.363	20	234	16	23
2017CPT.12.30.20362	Gaston	64	SR 2900 (WILMONT DR)	SR 2260 TO END MAINT	1	2	NO	NO	0.054	20	35	2	4
2017CPT.12.30.20362	Gaston	65	SR 2902 (ALPINE LN)	ESSEN LN TO DE	1	2	NO	NO	0.055	20	35	2	4
TOTAL FOR PROJ NO. 2017CPT.12.30.20362													
										8.053	5,151	361	518
GRAND TOTAL										14.62	9,281	650	934

PROJECT NO.	SHEET NO.	TOTAL NO.
2017CPT.12.30.20232, 2017CPT.12.30.20362	9	

THERMOPLASTIC AND PAINT QUANTITIES

PROJECT NO	COUNTY	MAP	ROUTE	DESCRIPTION	TYP	LANES	LENGTH	WIDTH	WORK ZONE ADV./GENERAL WARNING SIGNING SF	TEMPORARY TRAFFIC CONTROL LS	4810000000-E 4" WHITE PAINT LF	4810000000-E 4" YELLOW PAINT LF
2017CPT.12.30.20232	Cleveland	NO	SR 1284 (RONALD DR)	SR 1121 TO END MAINT	NO	1	2	0.071	84	*		
2017CPT.12.30.20232	Cleveland	2	SR 1399 (DAWN DR)	SR 1323 TO SR 1400	1	2	0.256	20	84	*		
2017CPT.12.30.20232	Cleveland	3	SR 1400 (SOUTH/NORTH WHITE OAK DR)	SR 1399 TO DE	1	2	0.818	20	84	*		
2017CPT.12.30.20232	Cleveland	4	SR 1412 (BUSHY CRK EXT)	SR 1411 TO DE	1	2	0.1	20	84	*		
2017CPT.12.30.20232	Cleveland	5	SR 1565 (CLYDE ST)	SR 1538 TO DE	1	2	0.232	18	84	*	4,734	4,734
2017CPT.12.30.20232	Cleveland	6	SR 1566 (BRACKETT ST)	SR 1565 TO DE	1	2	0.132	20	84	*		
2017CPT.12.30.20232	Cleveland	7	SR 1568 (HAPPY VALLEY DR)	SR 1565 TO DE	1	2	0.052	18	84	*		
2017CPT.12.30.20232	Cleveland	8	SR 1673 (WARLICK ST)	SR 1004 TO DE	1	2	0.481	18	84	*	10,351	10,351
2017CPT.12.30.20232	Cleveland	9	SR 1674 (WHITE ST)	NC 10 TO SR 1673	1	2	0.175	18	84	*	3,766	3,766
2017CPT.12.30.20232	Cleveland	10	SR 1682 (DEVINEY ST)	NC 10 TO DE	1	2	0.162	24	84	*	3,486	3,486
2017CPT.12.30.20232	Cleveland	11	SR 2079 (ROSS RD)	SR 1001 TO DE	1	2	0.394	18	84	*		
2017CPT.12.30.20232	Cleveland	12	SR 2106 (WAVE RD)	SR 2033 TO DE	2	2	0.216	24	84	*		
2017CPT.12.30.20232	Cleveland	13	SR 2172 (ENOLA DR)	SR 1001 TO DE	1	2	0.417	18	84	*		
2017CPT.12.30.20232	Cleveland	14	SR 2248 (BETHWARE DR)	SR 2603 TO DE	1	2	0.226	18	84	*	4,864	4,864
2017CPT.12.30.20232	Cleveland	15	SR 2300 (DYER DR)	SR 2200 TO END MAINT	1	2	0.401	20	84	*		
2017CPT.12.30.20232	Cleveland	16	SR 2378 (LAKE VIEW DR)	SR 2200 TO SR 2379	1	2	0.083	20	84	*		
2017CPT.12.30.20232	Cleveland	17	SR 2379 (LAKE VIEW DR)	SR 2201 TO SR 2378	1	2	0.234	20	84	*		
2017CPT.12.30.20232	Cleveland	18	SR 2410 (MANCHESTER DR)	SR 2317 TO SR 2412	1	2	0.341	20	84	*	7,338	7,338
2017CPT.12.30.20232	Cleveland	19	SR 2411 (W KELLY LN)	SR 2410 TO SR 2412	1	2	0.122	18	84	*	2,625	2,625
2017CPT.12.30.20232	Cleveland	20	SR 2412 (JANEAL PL)	SR 2411 TO SR 2410	1	2	0.092	18	84	*	1,980	1,980
2017CPT.12.30.20232	Cleveland	21	SR 2435 (SYLVIA DR)	SR 2201 TO DE	1	2	0.253	20	84	*		
2017CPT.12.30.20232	Cleveland	22	SR 2436 (CHESTERFIELD DR)	SR 2435 TO SR 2437	1	2	0.211	20	84	*		
2017CPT.12.30.20232	Cleveland	23	SR 2437 (WINSTON DR)	SR 2201 TO SR 2436	1	2	0.079	20	84	*		
2017CPT.12.30.20232	Cleveland	24	SR 2602 (VESTIBULE CH RD)	SR 2680 (PVMT CHG) TO DE	1	2	0.554	20	84	*	11,922	11,922
2017CPT.12.30.20232	Cleveland	25	SR 2618 (GODDARD RD)	SR 1001 TO DE	1	2	0.165	18	84	*		
2017CPT.12.30.20232	Cleveland	26	SR 2651 (THAMON RD)	SR 2073 TO CDS	1	2	0.3	20	84	*		
TOTAL FOR PROJ NO. 2017CPT.12.30.20232												
							6.567		2,184	*	51,066	51,066
2017CPT.12.30.20362	Gaston	27	SR 2914 (DOUGLAS DR)	SR 2399 TO SR 2262	1	2	0.152	20	84	*		
2017CPT.12.30.20362	Gaston	28	SR 1979 (BLACKBERRY LN)	SR 1916 TO DE	1	2	0.368	20	84	*		
2017CPT.12.30.20362	Gaston	29	SR 1986 (FOX TRAIL DR)	SR 1914 TO CDS	1	2	0.252	20	84	*		
2017CPT.12.30.20362	Gaston	30	SR 1987 (GRAY FOX LN)	SR 1986 TO CDS	1	2	0.115	20	84	*		
2017CPT.12.30.20362	Gaston	31	SR 1988 (FOX DEN DR)	SR 1915 TO CDS	1	2	0.25	20	84	*		
2017CPT.12.30.20362	Gaston	32	SR 1989 (SILVER FOX CT)	SR 1988 TO CDS	1	2	0.06	20	84	*		
2017CPT.12.30.20362	Gaston	33	SR 1990 (RED FOX CT)	SR 1988 TO CDS	1	2	0.074	20	84	*		
2017CPT.12.30.20362	Gaston	34	SR 2260 (MORNINGSIDE DR/LEROY AVE)	SR 2259 TO NC 279	1	2	0.791	20	84	*		
2017CPT.12.30.20362	Gaston	35	SR 2262 (FRANCIS ST/CECELIA DR)	SR 2259 TO SR 2356	1	2	0.872	VAR. 18-20	84	*		
2017CPT.12.30.20362	Gaston	36	SR 2263 (BLACK SPRINGS DR)	SR 2262 TO SR 2260	2	2	0.17	VAR. 18-20	84	*		
2017CPT.12.30.20362	Gaston	37	SR 2265 (AUTEN RD)	SR 2268 TO DE	1	2	0.298	20	84	*		
2017CPT.12.30.20362	Gaston	38	SR 2272 (ROSEWOOD LN)	SR 2271 TO DE	1	2	0.285	18	84	*		
2017CPT.12.30.20362	Gaston	39	SR 2318 (JAMAICA AVE)	SR 2268 TO SR 2319	1	2	0.184	20	84	*		
2017CPT.12.30.20362	Gaston	40	SR 2319 (PANAMA ST)	SR 2323 TO DE	1	2	0.148	20	84	*		
2017CPT.12.30.20362	Gaston	41	SR 2320 (ACAPULCO DR)	SR 2268 TO SR 2319	1	2	0.223	20	84	*		
2017CPT.12.30.20362	Gaston	42	SR 2323 (SUNSET ST)	SR 2320 TO END MAINT	1	2	0.248	20	84	*		
2017CPT.12.30.20362	Gaston	43	SR 2330 (HOWARD AVE)	SR 2265 TO CDS	2	2	0.189	20	84	*		
2017CPT.12.30.20362	Gaston	44	SR 2333 (LEROY EXTENSION)	SR 2260 TO DE	1	2	0.098	18	84	*		
2017CPT.12.30.20362	Gaston	45	SR 2342 (WARD AVE)	SR 2262 TO NC 279	1	2	0.097	20	84	*		
2017CPT.12.30.20362	Gaston	46	SR 2343 (POWERLINE DR)	SR 2265 TO SR 2323	2	2	0.21	20	84	*		
2017CPT.12.30.20362	Gaston	47	SR 2344 (SUNNIDALE DR)	SR 2323 TO SR 2345	2	2	0.069	20	84	*		
2017CPT.12.30.20362	Gaston	48	SR 2345 (DALEWOOD DR)	SR 2344 TO SR 2346	2	2	0.077	20	84	*		
2017CPT.12.30.20362	Gaston	49	SR 2346 (DALEWOOD DR)	SR 2345 TO SR 2343	1	2	0.039	20	84	*		
2017CPT.12.30.20362	Gaston	50	SR 2350 (MILL ST)	SR 2260 TO DE	1	2	0.105	20	84	*		
2017CPT.12.30.20362	Gaston	51	SR 2356 (BROOKNEAL DR)	SR 2357 TO SR 2265	1	2	0.443	20	84	*		
2017CPT.12.30.20362	Gaston	52	SR 2357 (ALPINE LN)	SR 2323 TO SR 2385	1	2	0.303	20	84	*		
2017CPT.12.30.20362	Gaston	53	SR 2358 (CLOVERWOOD LN)	SR 2357 TO DE	1	2	0.098	20	84	*		
2017CPT.12.30.20362	Gaston	54	SR 2359 (FLEETWOOD DR)	SR 2356 TO DE	1	2	0.103	20	84	*		
2017CPT.12.30.20362	Cleveland	55	SR 2363 (RHONDA DR)	SR 2265 TO SR 2356	1	2	0.217	20	84	*		
2017CPT.12.30.20362	Gaston	56	SR 2382 (RHYNELAND CIR)	SR 2356 TO DE	1	2	0.089	20	84	*		
2017CPT.12.30.20362	Gaston	57	SR 2383 (OLD ENGLISH DR)	SR 2356 TO DE	1	2	0.202	20	84	*		
2017CPT.12.30.20362	Gaston	58	SR 2385 (RIDGWOOD DR)	SR 2357 TO SR 2383	1	2	0.065	20	84	*		
2017CPT.12.30.20362	Gaston	59	SR 2398 (RIDGWOOD DR)	SR 2262 TO SR 2399	1	2	0.158	20	84	*		
2017CPT.12.30.20362	Gaston	60	SR 2399 (FLEETWOOD DR)	SR 2356 TO SR 2914	1	2	0.148	20	84	*		
2017CPT.12.30.20362	Gaston	61	SR 2836 (CATAWBA COVE LN)	SR 2650 TO DE	1	2	0.09	20	84	*		
2017CPT.12.30.20362	Gaston	62	SR 2862 (GATEWOOD DR)	SR 2425 TO SR 2863	1	2	0.248	20	84	*		
2017CPT.12.30.20362	Gaston	63	SR 2863 (SCOTT DR)	SR 2425 TO DE	1	2	0.363	20	84	*		
2017CPT.12.30.20362	Gaston	64	SR 2900 (WILMONT DR)	SR 2260 TO END MAINT	1	2	0.054	20	84	*		
2017CPT.12.30.20362	Gaston	65	SR 2902 (ALPINE LN)	ESSEN LN TO DE	1	2	0.055	20	84	*		
TOTAL FOR PROJ NO. 2017CPT.12.30.20362												
							8.053		3,276	*		
GRAND TOTAL												
							14.62		5,460	1	51,066	51,066

SIGNING FOR RESURFACING PROJECTS

LEGEND
 ┆ STATIONARY SIGN
 ← DIRECTION OF TRAFFIC FLOW

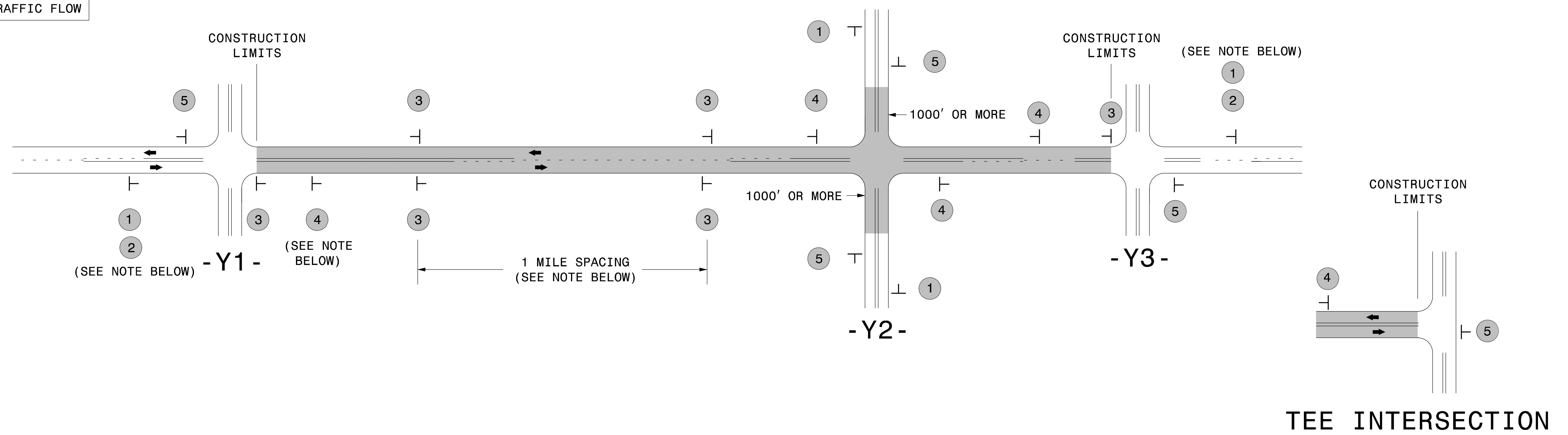

MAINLINE (-L-) SIGNING

-Y- LINE SIGNING

SIGNING NOTES AND PLACEMENT PER DIRECTION	1		PLACE 1000' PRIOR TO BEGINNING OF CONSTRUCTION LIMITS. ONLY USED ON -Y- LINES IF RESURFACING LIMITS EXTEND 1000' ALONG -Y- LINE.	<p>NO REQUIRED STATIONARY SIGNING FOR THE FOLLOWING -Y- LINE CONDITIONS:</p> <ol style="list-style-type: none"> 1) LESS THAN 1000' OF RESURFACING ALONG -Y- LINE 2) SUBDIVISION ROADS 3) DEAD END ROADS <p>WHEN PAVING/CONSTRUCTION ACTIVITIES PROCEED ACROSS AN UNSIGNED -Y- LINE, PORTABLE ADVANCE WARNING SIGNS SHALL BE USED ALONG THE -Y- LINE AS SHOWN BELOW. REMOVE UPON COMPLETION OF WORK.</p> <div style="display: flex; justify-content: space-around;"> <div style="text-align: center;"> PLACED 500' IN ADVANCE OF FLAGGER. </div> <div style="text-align: center;"> PLACED 250' IN ADVANCE OF FLAGGER. </div> </div>
	2		#2 SIGN ONLY USED WHEN CONSTRUCTION LIMITS ARE 2 OR MORE MILES IN LENGTH. ROUND UP TO NEXT WHOLE NUMBER. (NO FRACTIONAL OR DECIMAL NUMBERS)	
	3		- PLACE INITIALLY AT THE CONSTRUCTION LIMITS AND SPACE 1 MILE APART THEREAFTER. - AT TEE INTERSECTIONS INSTALL INITIALLY 1/2 MILE FROM INTERSECTION AND SPACE 1 MILE APART THEREAFTER.	
	4		- THESE ARE FOR -Y- LINES THAT ARE "THROUGH" ROADWAYS. - DEAD END AND SUBDIVISION ROADS ARE NOT "THROUGH" ROADWAYS. - INSTALL 500' +/- FROM EACH -Y- LINE APPROACH AS SHOWN ABOVE. - FOR MULTIPLE -Y- LINES THAT ARE SEPARATED BY 0.25 MILES OR LESS, TREAT AS A SINGLE UNIT AND INSTALL WITHIN 500' OF EACH APPROACH. - A MAXIMUM OF 2 SIGN SETS PER MILE. DO NOT INSTALL WHEN -Y- LINES ARE WITHIN 0.5 MILES FROM "END ROAD WORK" SIGN. - FOR TEE INTERSECTIONS, INSTALL WITHIN 500' +/- OF THE INTERSECTION ALONG -L- LINE.	
	5		PLACE 500' FOLLOWING THE END OF CONSTRUCTION LIMITS OR AS SHOWN WHEN WORK ENDS AT A 3-WAY TEE INTERSECTION.	

THE ABOVE SIGNS ARE ALL THAT ARE REQUIRED FOR A CONTRACTOR TO BEGIN A RESURFACING CONTRACT. ANY ADDITIONAL SIGNS REQUESTED BY NCDOT DIVISIONS SHALL BE INSTALLED WITHIN 7 BUSINESS DAYS OF THE START OF CONTRACT WORK.

MAPS LESS THAN 2 MILES

FOR RESURFACING MAPS WITH CONSTRUCTION LIMITS LESS THAN 2 MILES IN LENGTH, NO STATIONARY SIGNS ARE REQUIRED. USE PORTABLE "ROAD UNDER CONSTRUCTION" OR "ROAD WORK AHEAD" SIGNS IN LIEU OF STATIONARY ADVANCE WARNINGS SIGNS.

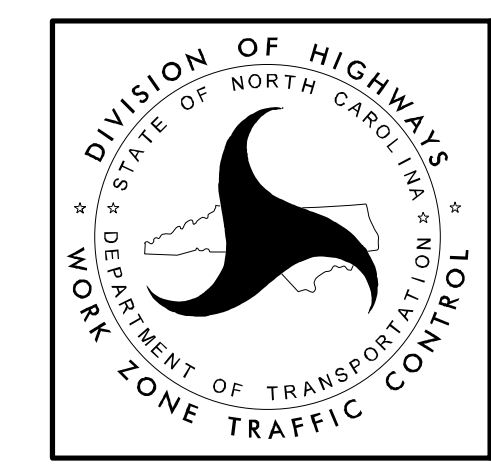

ADVANCE WARNING SIGNS FOR RURAL AND SUBURBAN 2-LANE ROADWAY RESURFACING

5/15/2017 S:\TUXWZTC\Resurfacing\2L2W & AST Resurfacing Details\Resurfacing_AdvWarn_2Ln.dgn User:kadai