

PROJECT NO.	SHEET NO.	TOTAL NO.
2018CPT.13.03.10571, 2018CPT.13.03.20571	1	16

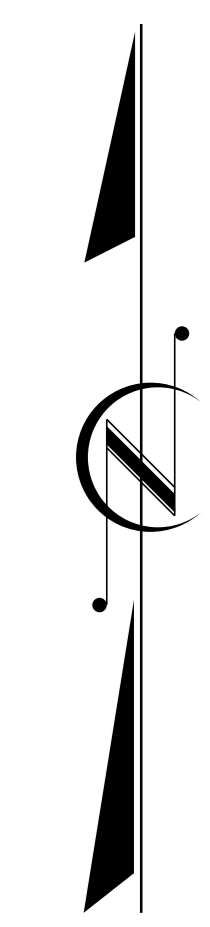

MADISON COUNTY

PROJECT NO.	SHEET NO.	TOTAL NO.
2018CPT.13.03.10571, 2018CPT.13.03.20571	2	16

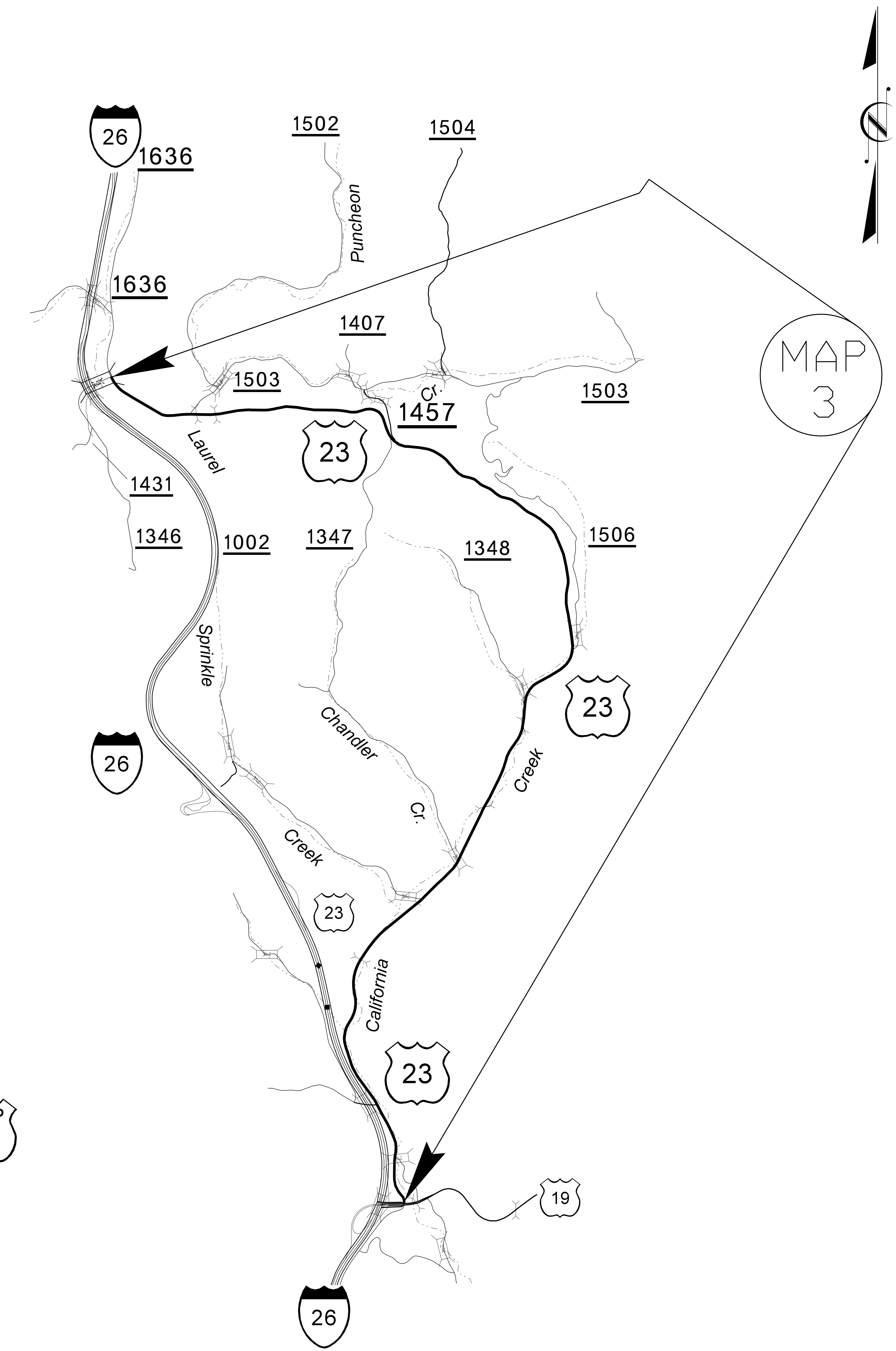
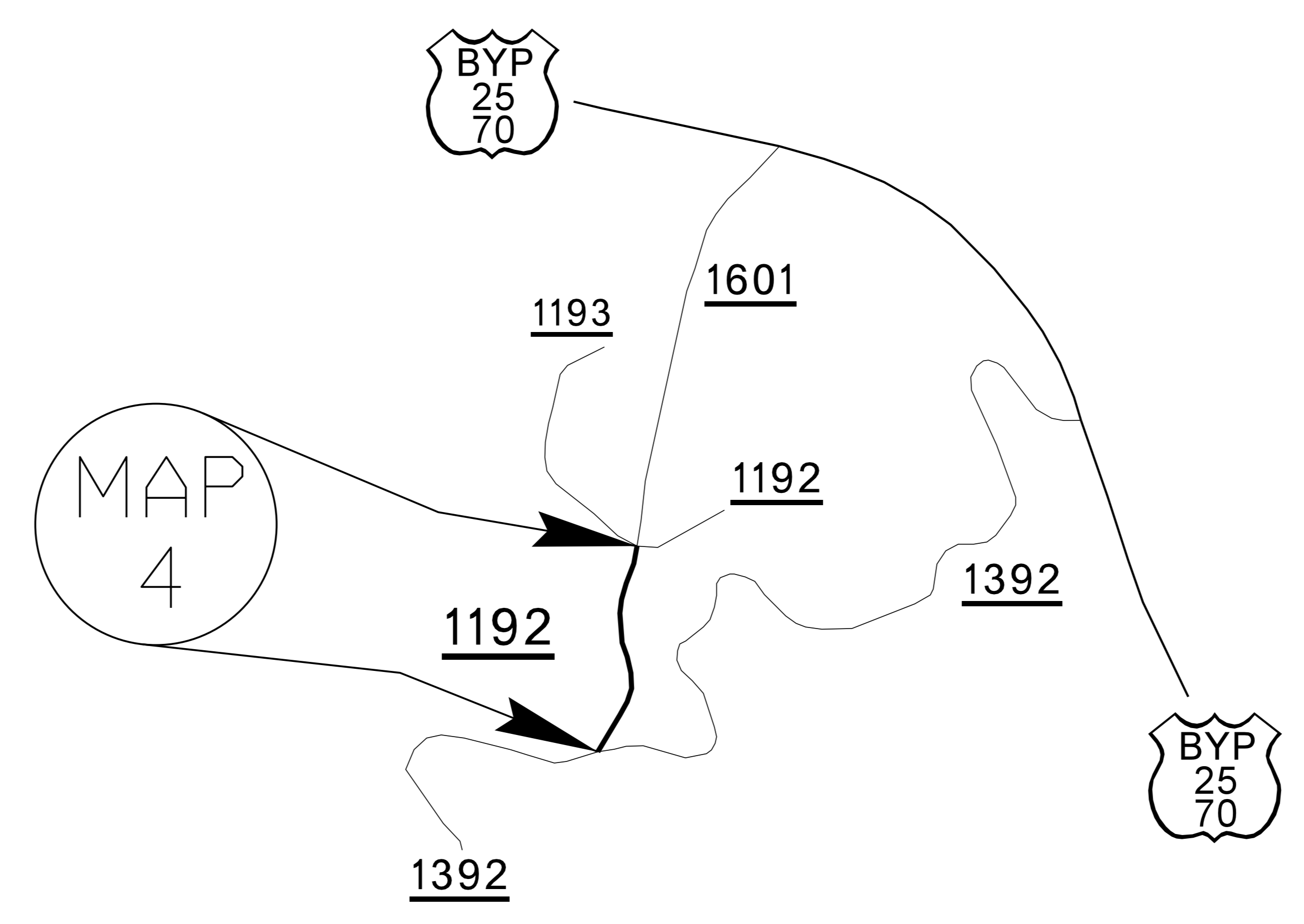
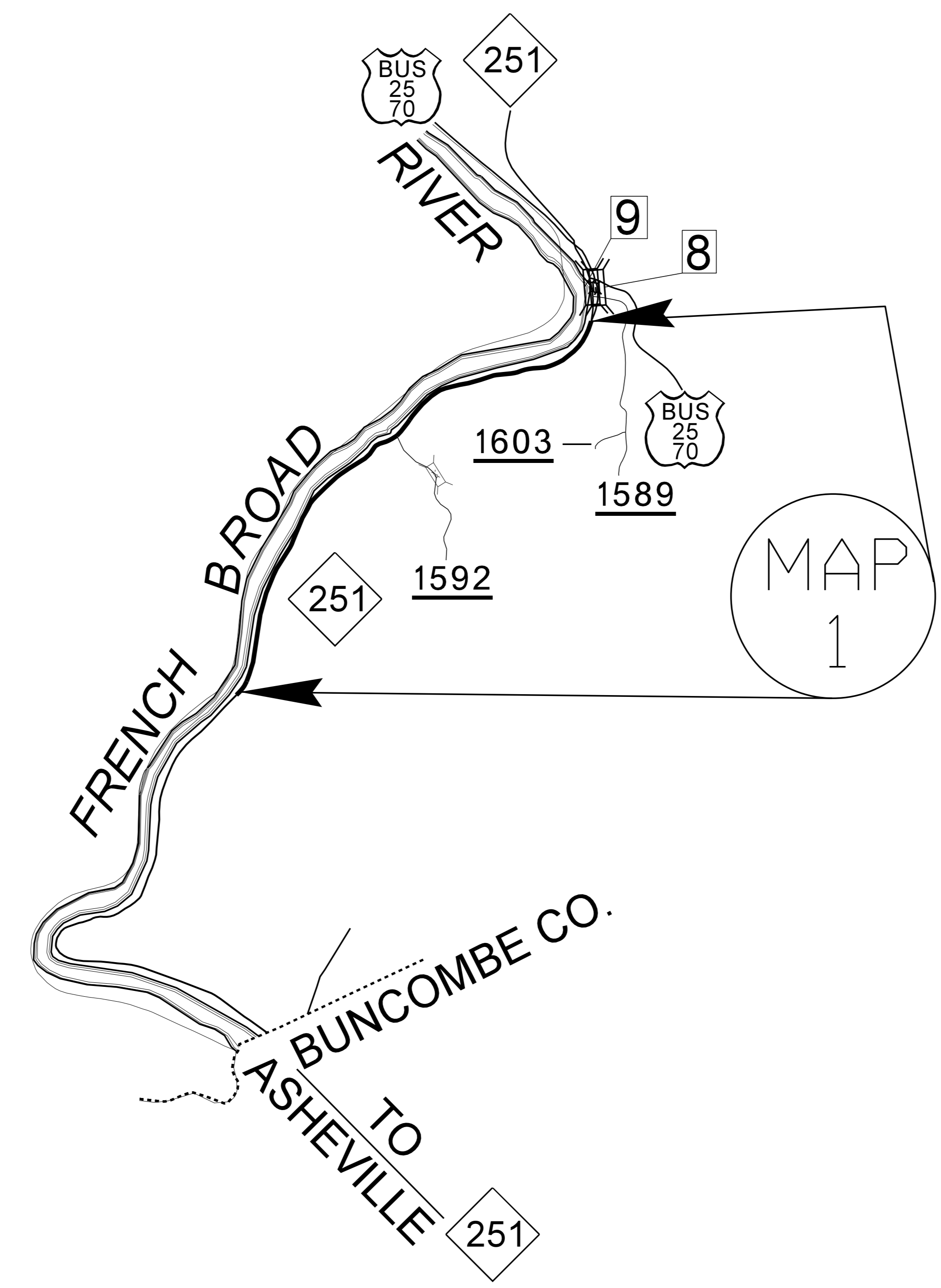
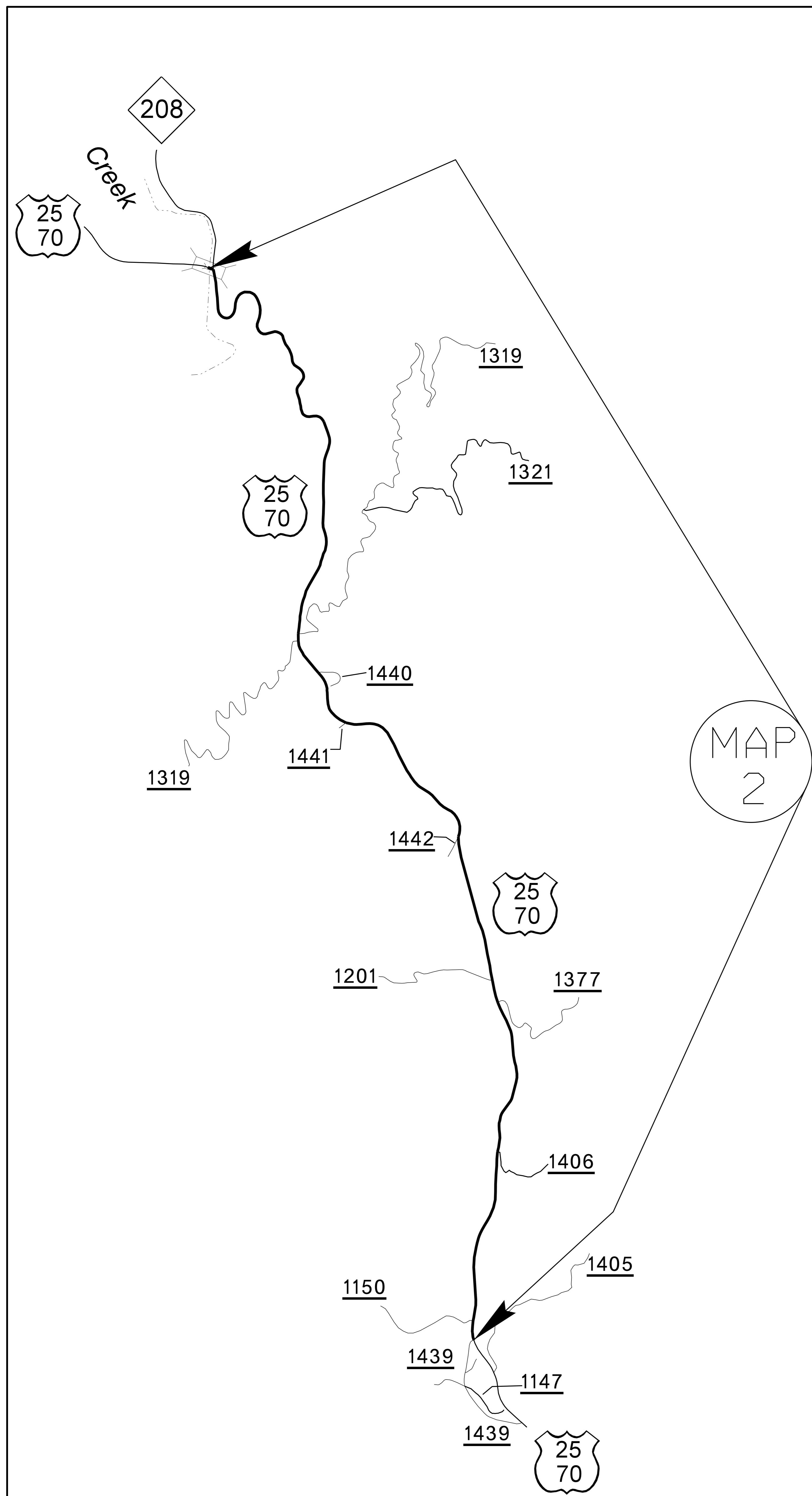
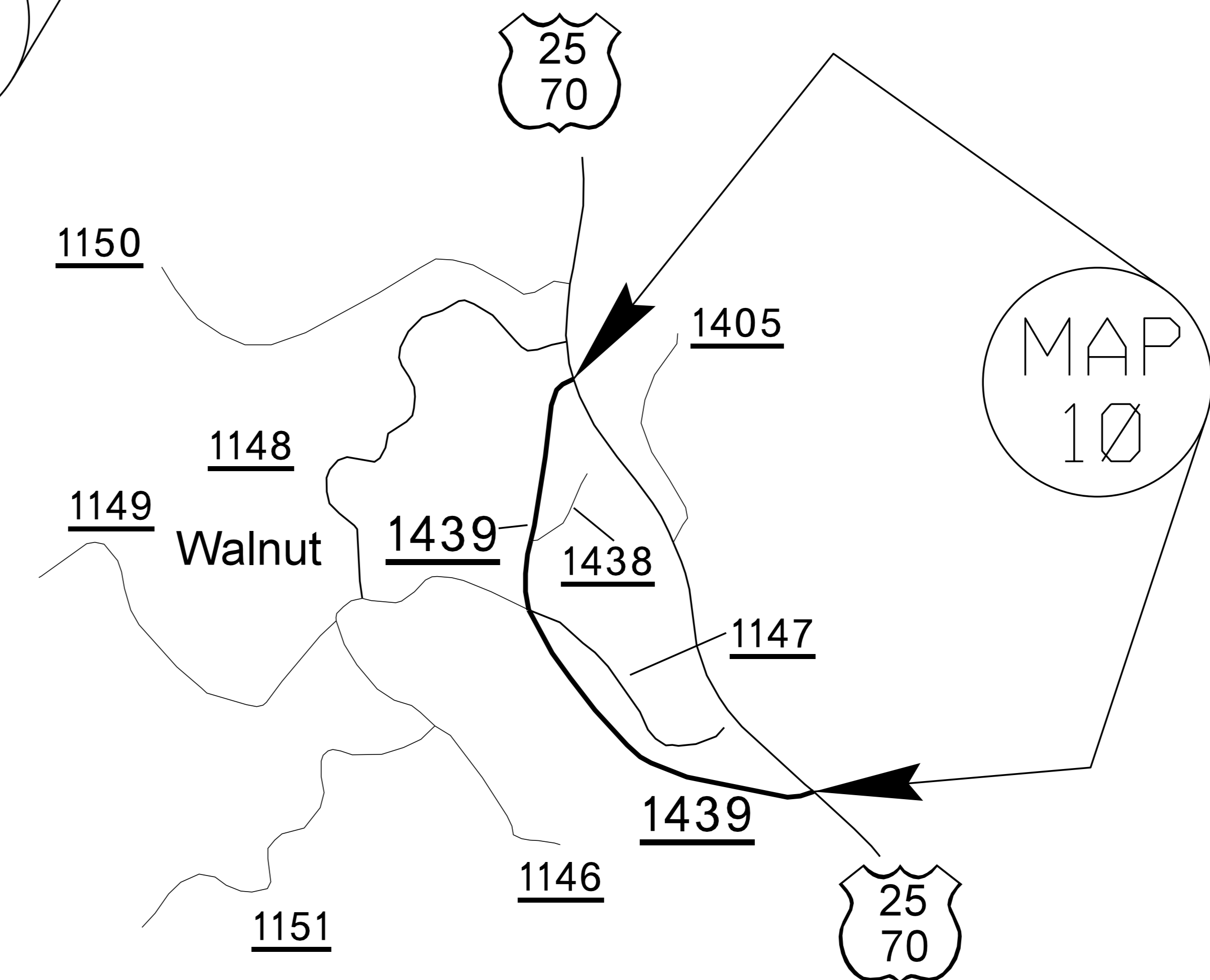
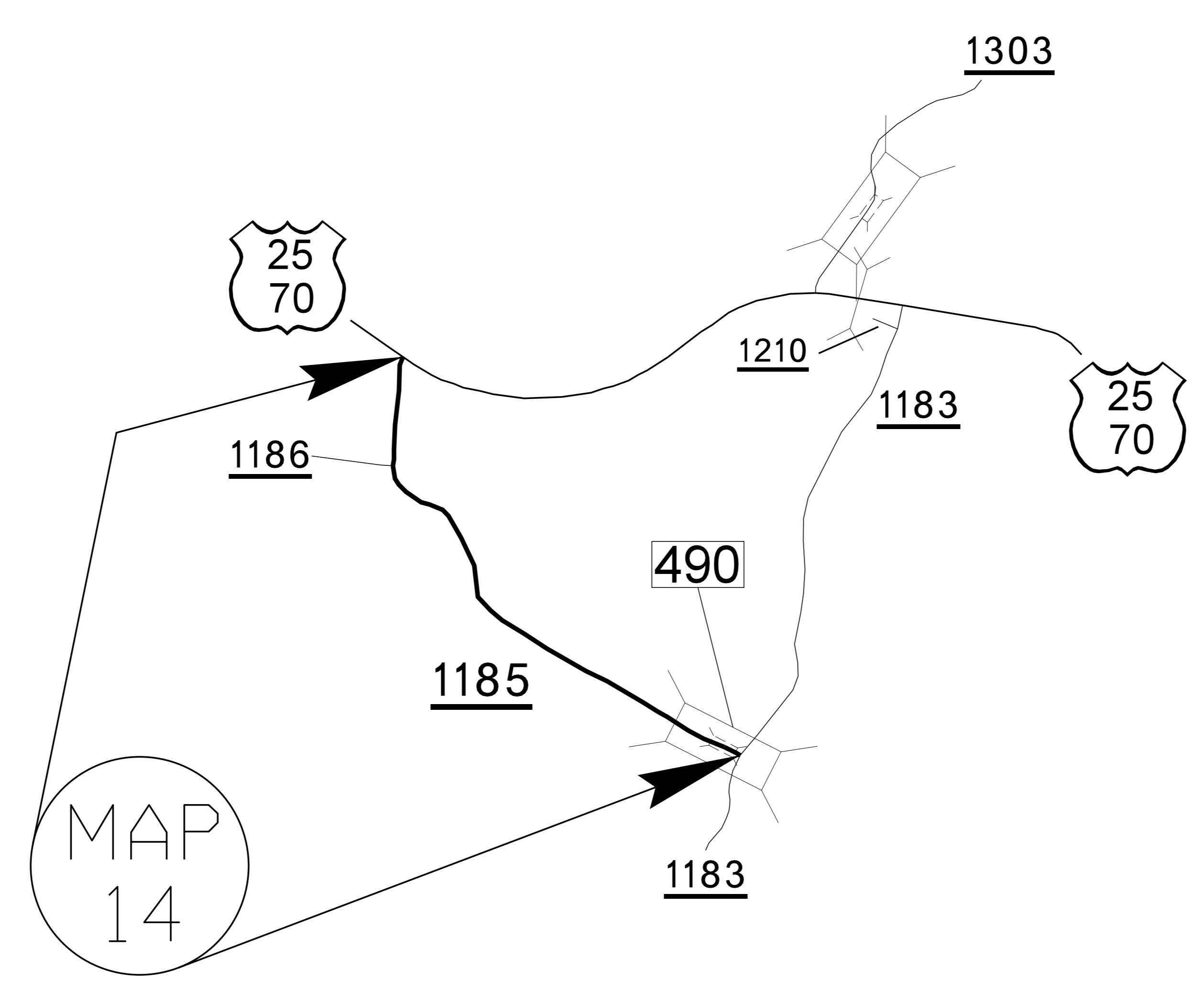
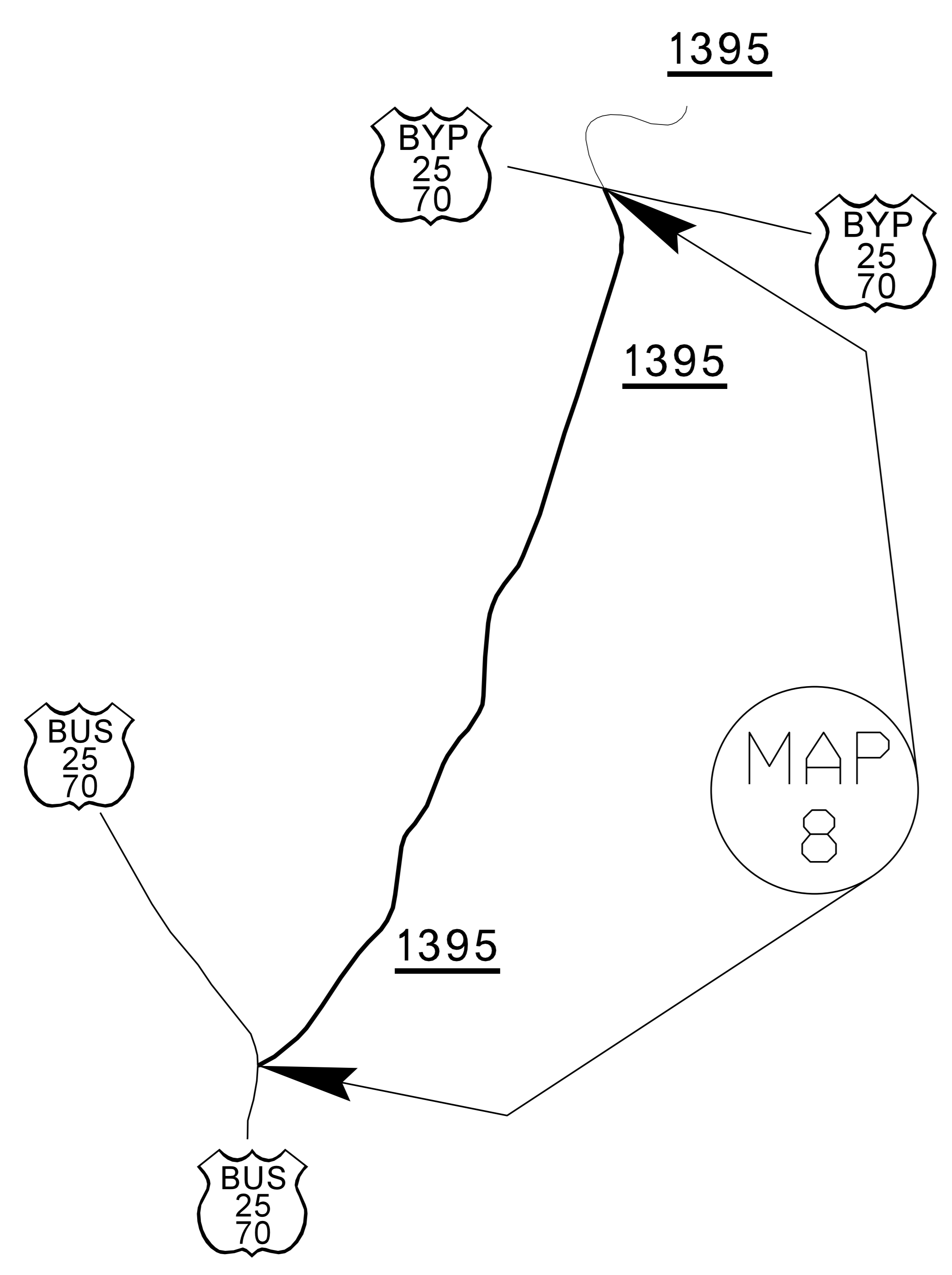
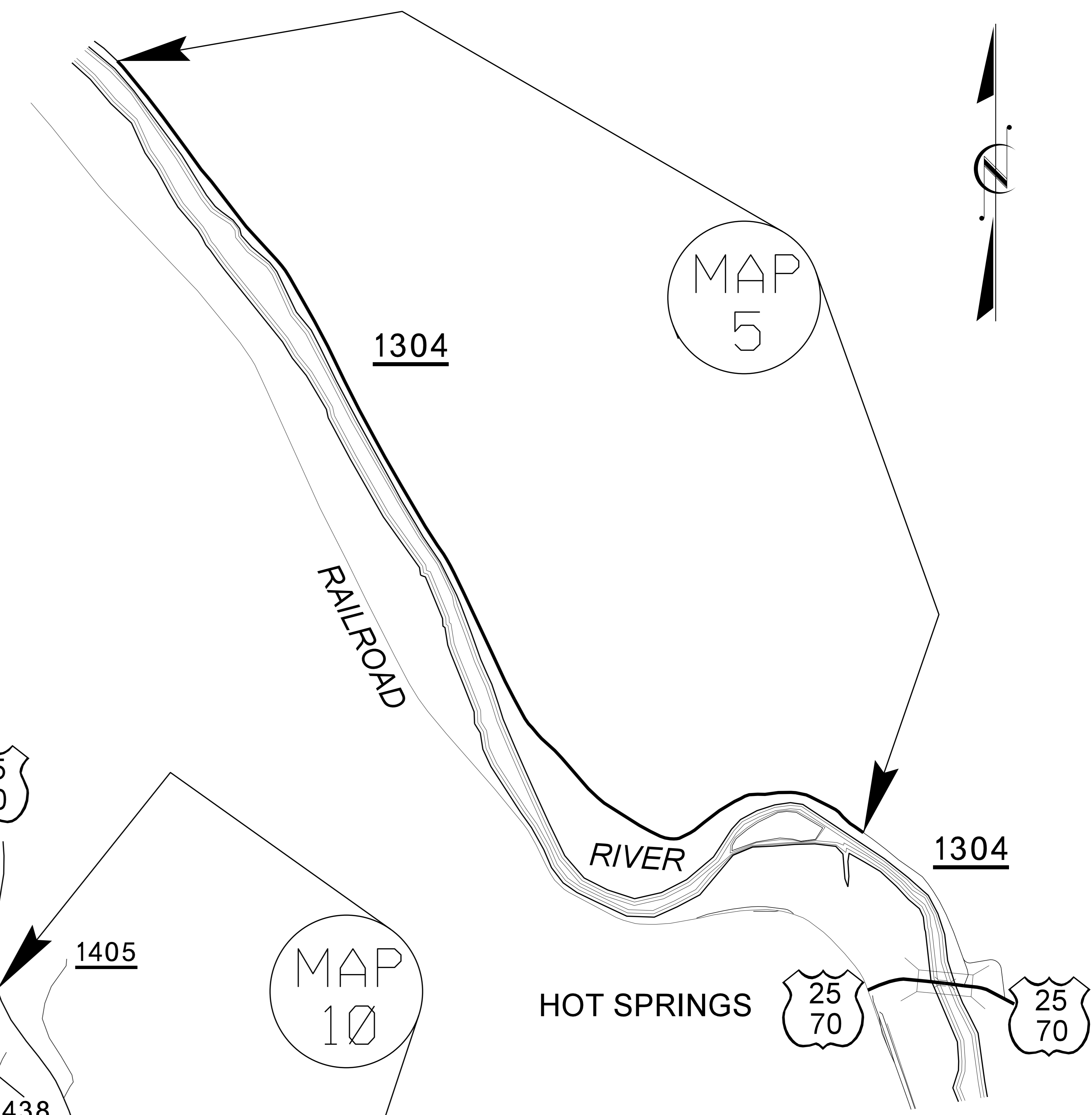
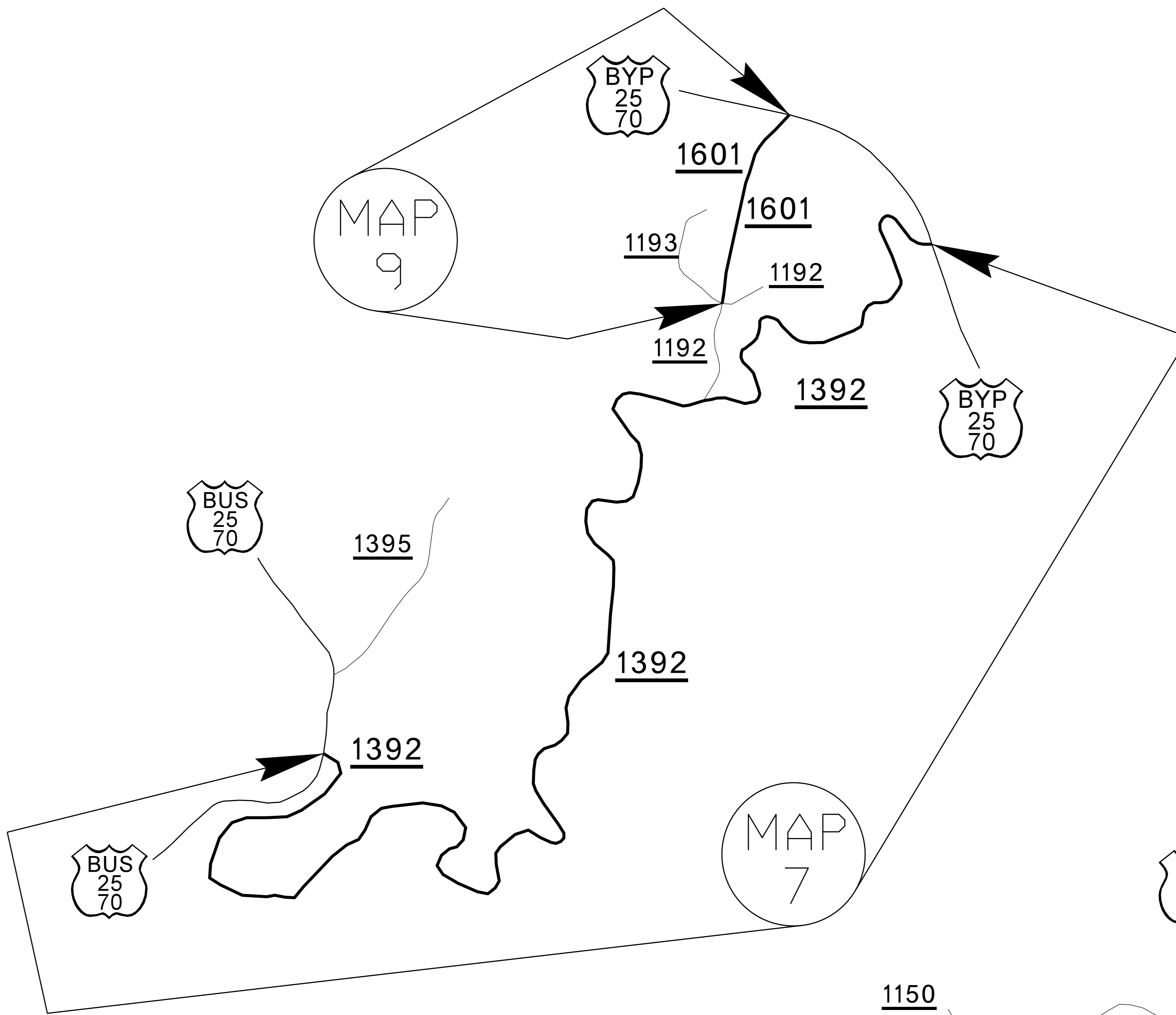
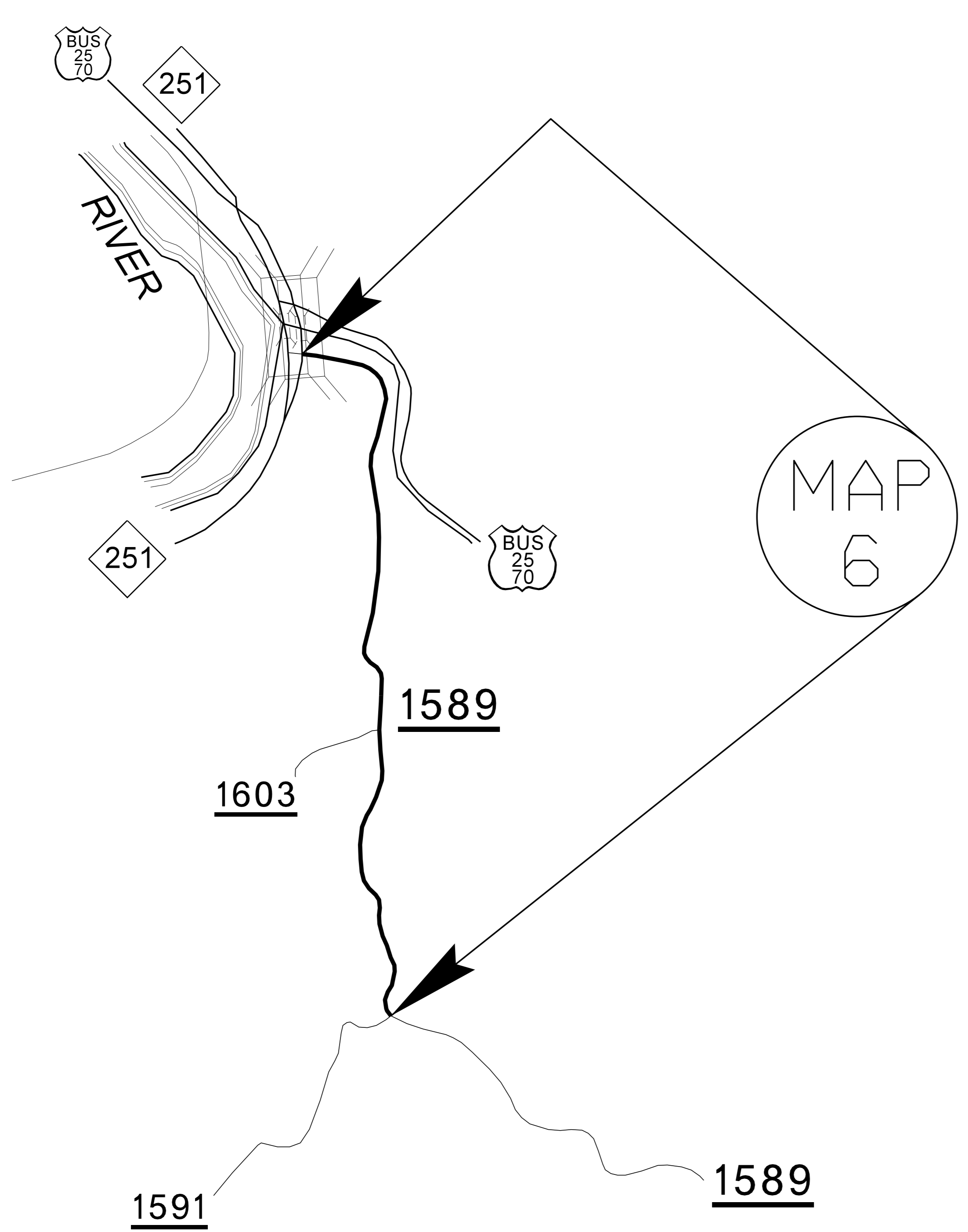

MADISON COUNTY

PROJECT NO.	SHEET NO.	TOTAL NO.
2018CPT.13.03.10571, 2018CPT.13.03.20571	3	16

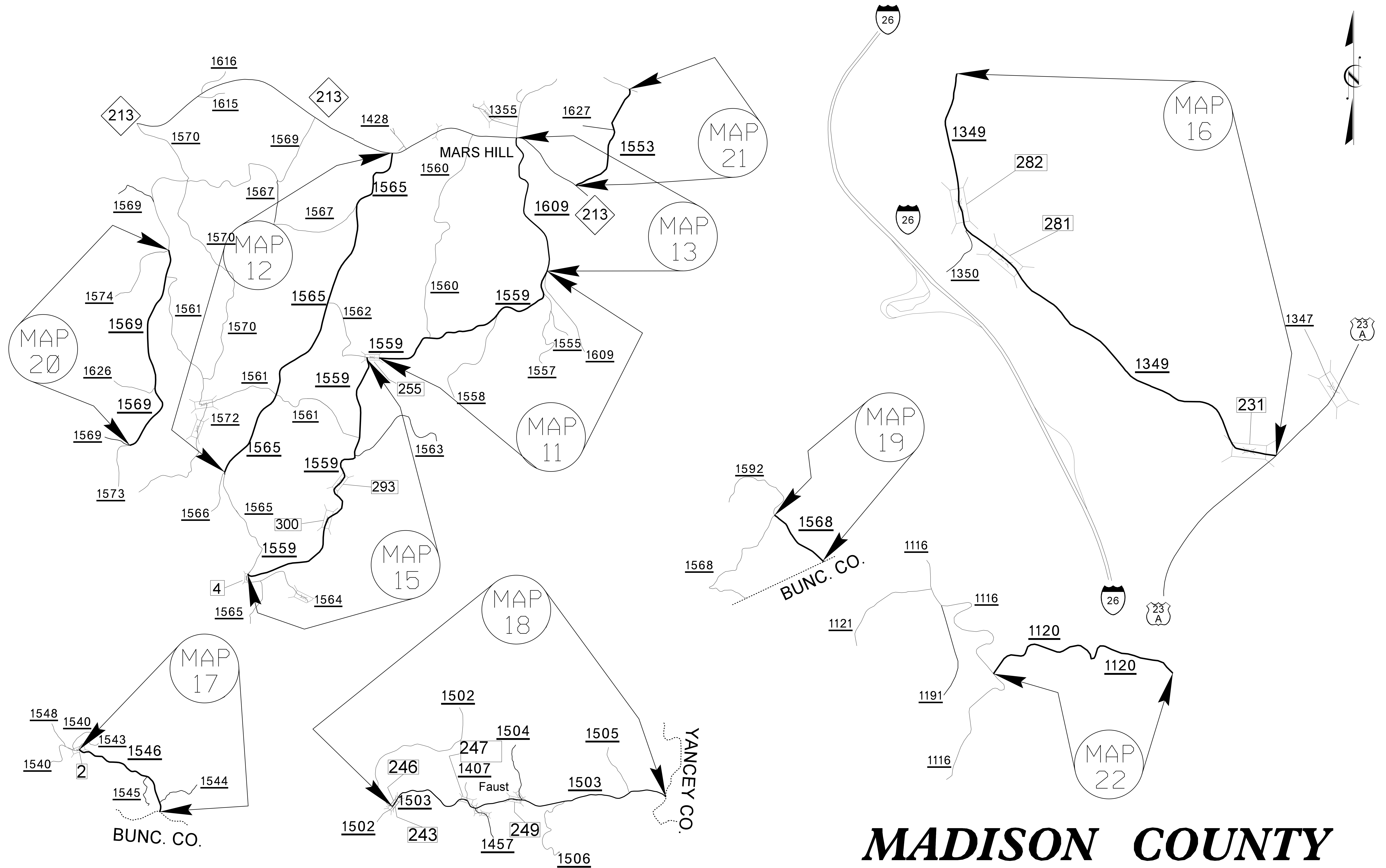

MADISON COUNTY

PROJECT NO.	SHEET NO.	TOTAL NO.
2018CPT.13.03.10571, 2018CPT.13.03.20571	4	16

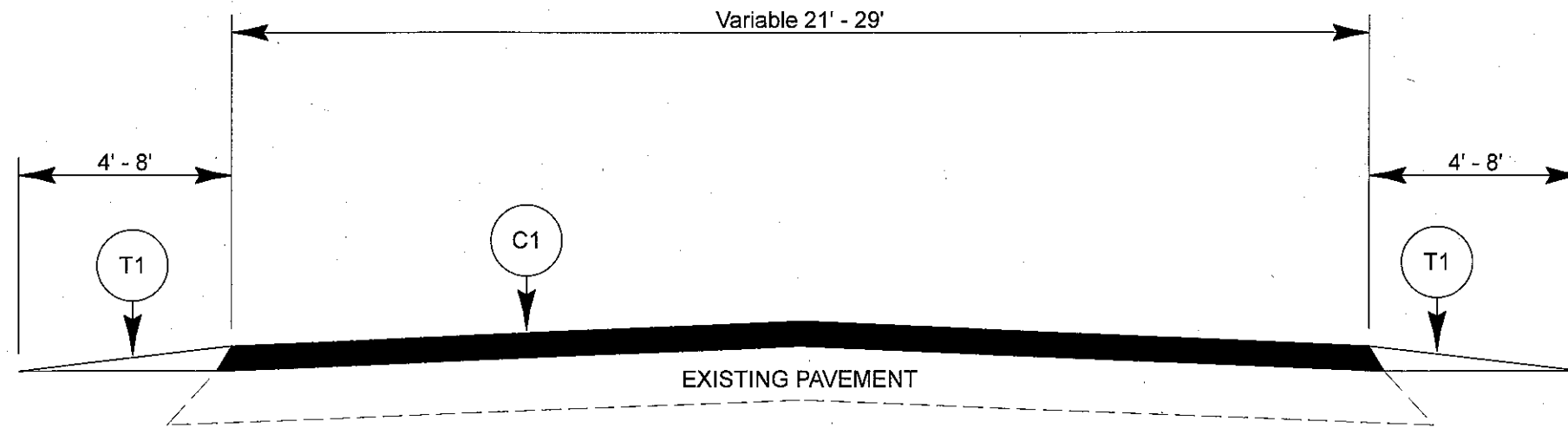

TYPICAL SECTION NO. 1

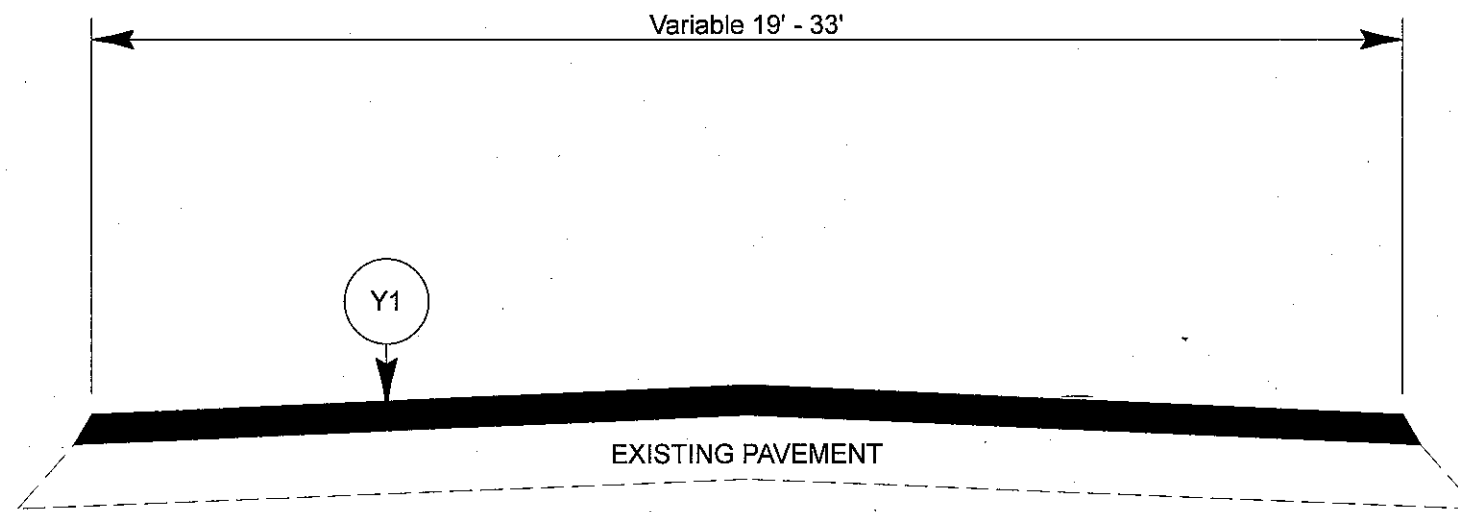
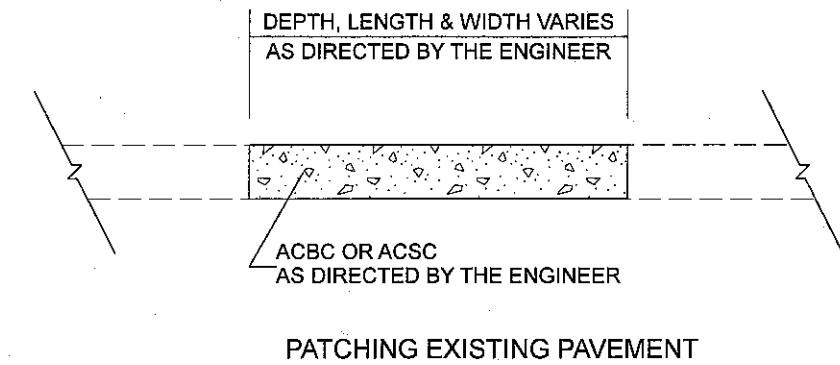

TYPICAL SECTION NO. 2

PAVEMENT SCHEDULE	
C1	PROP. APPROX. 1-1/2" ASPHALT CONCRETE SURFACE COURSE, TYPE S9.5B, AT AN AVERAGE RATE OF 168 LBS. PER SQ. YARD
C2	PROP. APPROX. 1-1/2" ASPHALT CONCRETE SURFACE COURSE, TYPE SF9.5A, AT AN AVERAGE RATE OF 165 LBS. PER SQ. YARD
F1	ASPHALT SURFACE TREATMENT, DOUBLE SEAL
F2	ASPHALT SURFACE TREATMENT, FOG SEAL
T1	SHOULDER RECONSTRUCTION
V1	MILLING ASPHALT PAVEMENT, 0 TO 1-1/2" DEPTH
V2	INCIDENTAL MILLING
V3	MILLING ASPHALT PAVEMENT, 3" DEPTH
Y1	LATEX MODIFIED MICRO-SURFACING, TYPE III

PROJECT NO.	SHEET NO.	TOTAL NO.
2018CPT.13.03.10571, 2018CPT.13.03.20571	5	16

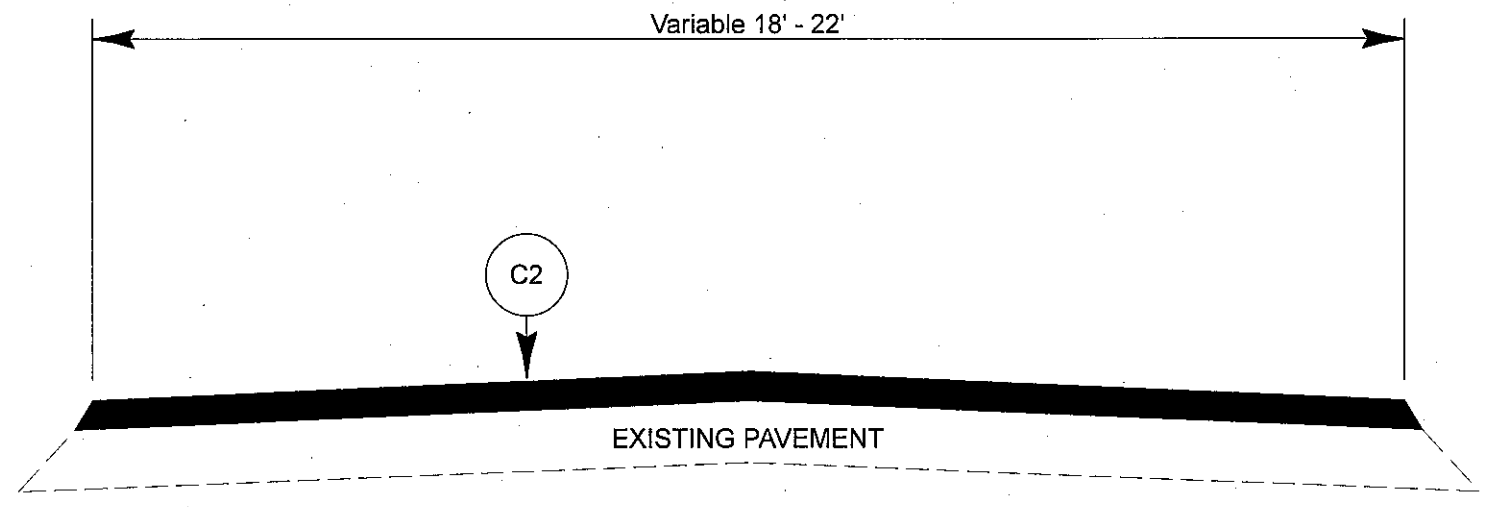

TYPICAL SECTION NO. 3

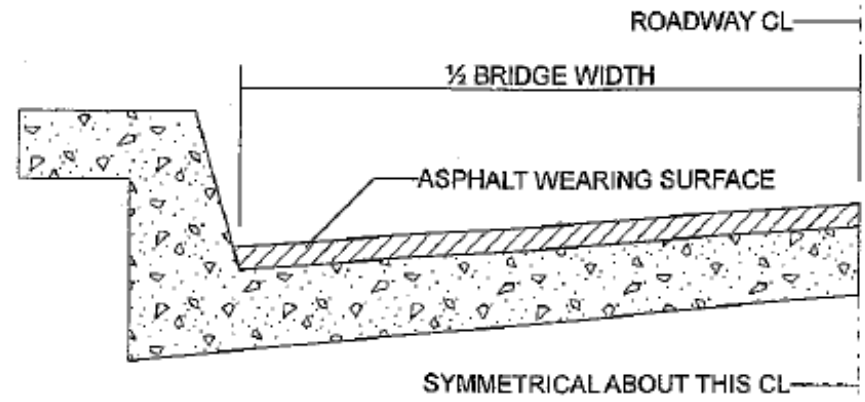

BRIDGE HALF TYPICAL SECTION

FOR BRIDGES WITH FLOOR DRAINS, CARE SHALL BE EXERCISED IN PLACING THE WEARING SURFACE AROUND FLOOR DRAINS SO AS NOT TO HINDER EFFECTIVE DRAINAGE. ALL DRAINS SHALL BE LEFT OPEN THE PROPOSED WEARING SURFACE SHALL VARY IN THICKNESS AS NECESSARY TO PROVIDE A SMOOTH RIDING SURFACE. THE MINIMUM THICKNESS SHOULD DEPEND ON PAVEMENT TYPE AS FOLLOWS: S4.75A 3/4", SF9.5A 1.0", S9.5X 1.5", S12.5X 2.0", ULTRATHIN HOT MIX ASPHALT-TYPE A 3/4", ULTRATHIN HOT MIX ASPHALT-TYPE B 5/8", ULTRATHIN HOT MIX ASPHALT-TYPE C 1/2". THE MAXIMUM THICKNESS SHOULD DEPEND ON PAVEMENT TYPE AS FOLLOWS: S4.75A 1.0", SF9.5A 1.5", S9.5X 2.0", S12.5X 2.0", ULTRATHIN HOT MIX ASPHALT-TYPE A 3/4", ULTRATHIN HOT MIX ASPHALT-TYPE B 5/8", ULTRATHIN HOT MIX ASPHALT-TYPE C 1/2".

NOTES

ALL UNPAVED ROADS TO BE RESURFACED 50' FROM EDGE OF PAVEMENT OF MAIN PROJECT.
 ALL PAVED S.R. ROADS TO BE RESURFACED TO THE ENDS OF THE RADII, OR AS DIRECTED BY THE ENGINEER.
 EDGES, PAVEMENT WIDENING, INTERSECTIONS AND BRIDGE FLARES ARE INCLUDED IN THE TABLE OF QUANTITIES.
 SHOULDERS AND DITCHES ARE TO BE CONSTRUCTED BY OTHERS UNLESS OTHERWISE INDICATED.
 BRIDGES ARE TO BE RESURFACED AT LOCATIONS AND TO DEPTH AS DIRECTED BY THE ENGINEER.

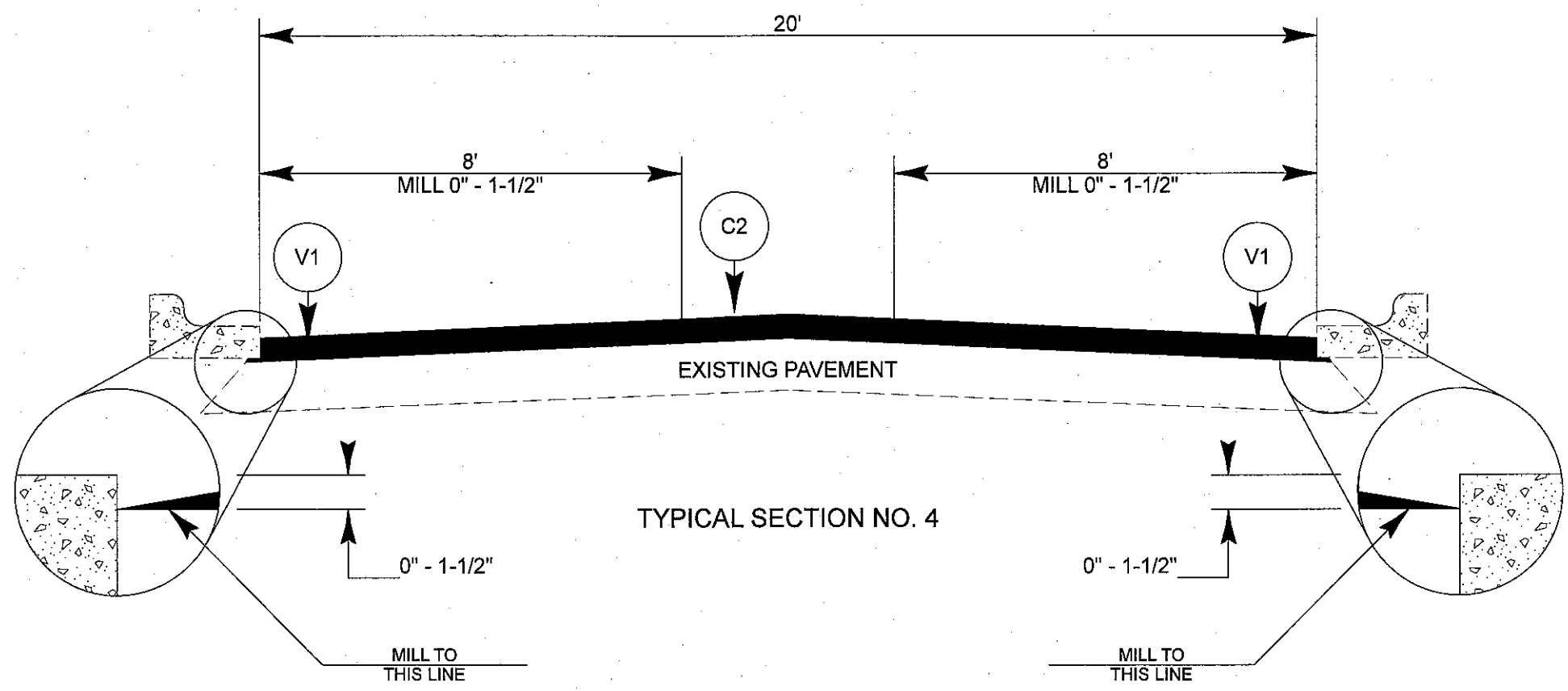

TYPICAL SECTION NO. 4

PROJECT NO.	SHEET NO.	TOTAL NO.
2018CPT.13.03.10571, 2018CPT.13.03.20571	6	16

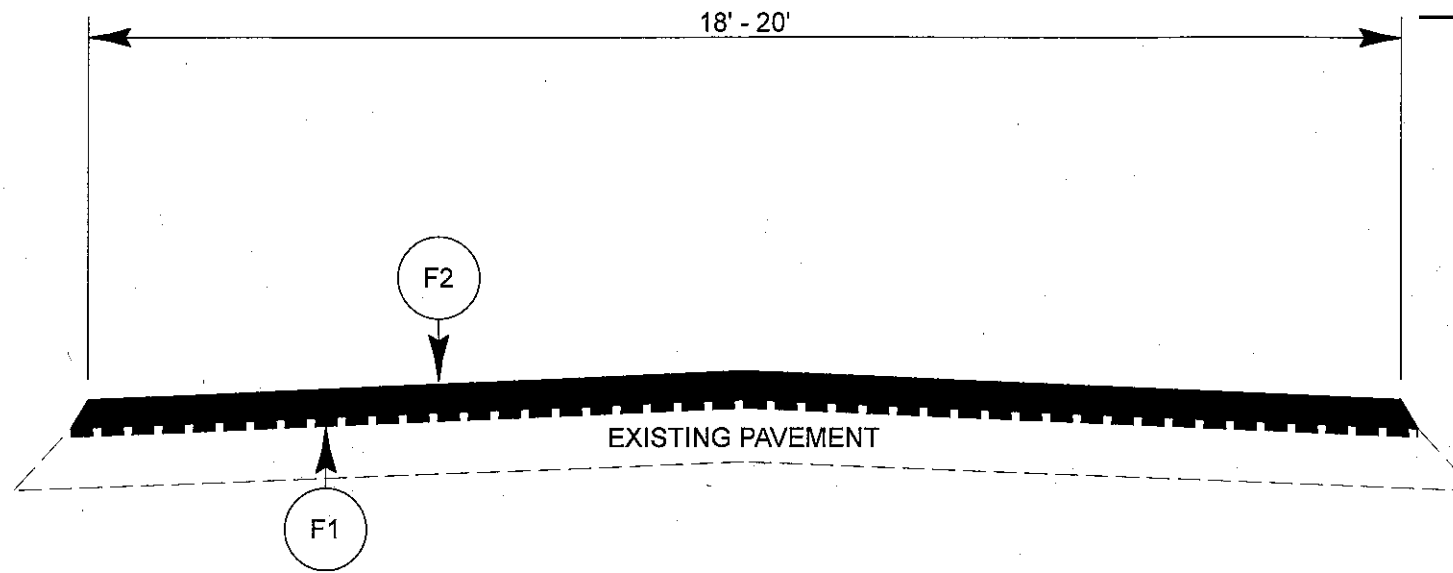

TYPICAL SECTION NO. 5

PROJECT NO.	SHEET NO.	TOTAL NO.
2018CPT.13.03.10571, 2018CPT.13.03.20571	7	16

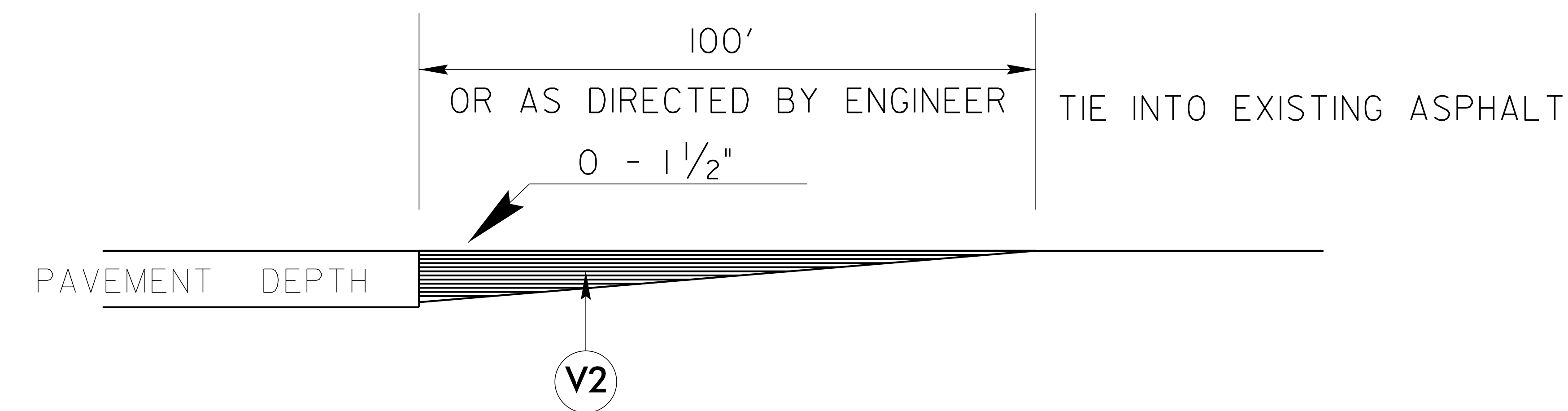

DETAIL TO TIE INTO EXIST PAVEMENT

THE CONTRACTOR'S ATTENTION IS DIRECTED TO THE FACT THAT HE WILL BE REQUIRED TO MILL THE EXISTING ASPHALT PAVEMENT TO ENSURE A PROPER TIE-IN WITH THE EXISTING SURFACE AT THE BEGINNING, END AND Y LINES OF EACH MAP TO BE RESURFACED WITH ASPHALT CONC SURFACE COURSE, TYPE S9.5B. THIS WILL BE PAID FOR AS INCIDENTAL MILLING.

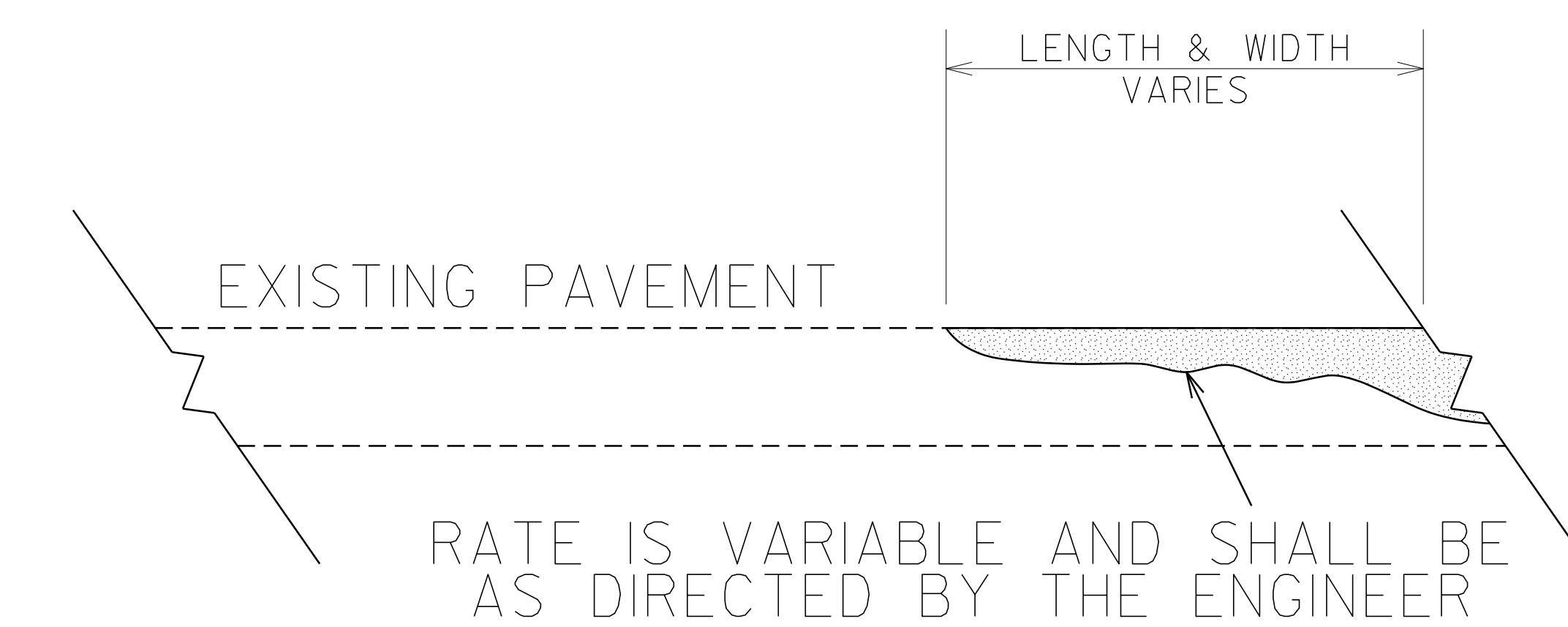
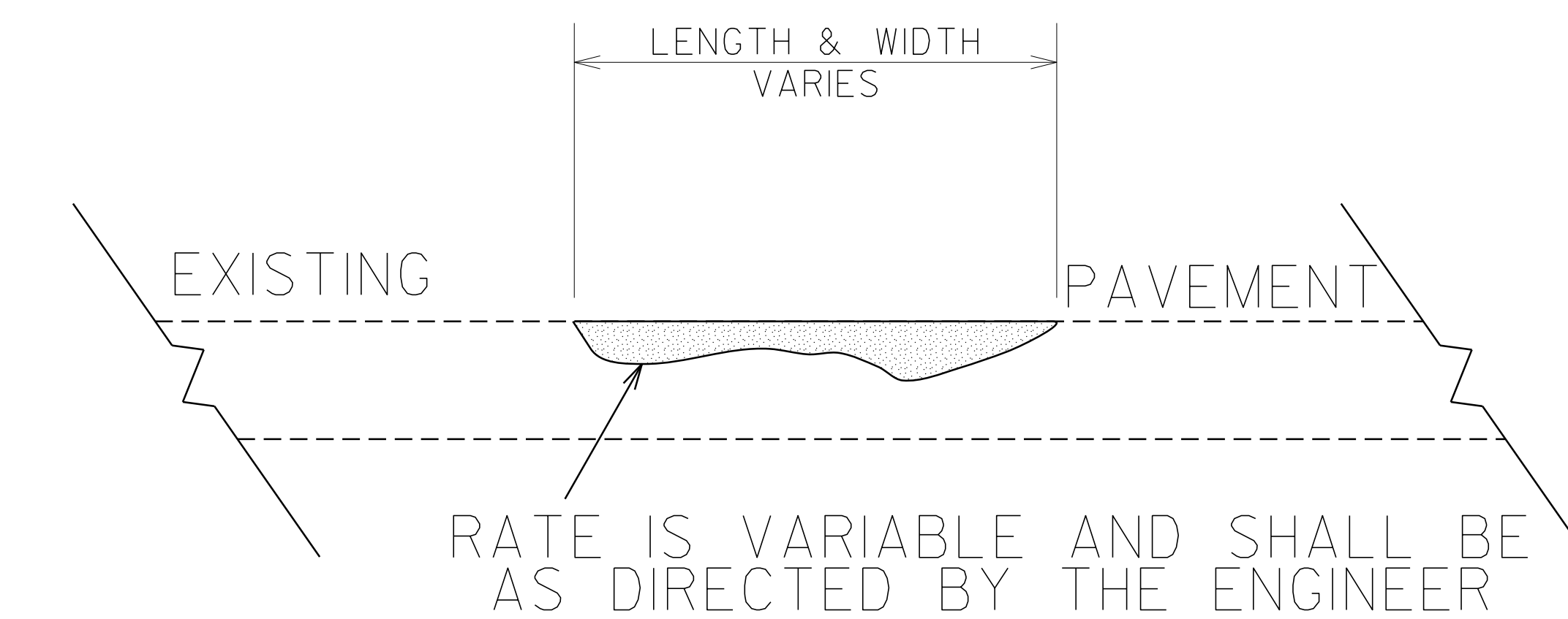

DETAIL SHOWING METHOD OF WEDGING

- NOTES:
 1) DETAIL DOES NOT APPLY TO OGAF C AND ULTRA-THIN BONDED WEARING COURSE.
 2) BACKFILL SHOULDER WITH APPROVED MATERIAL.
 3) THE SHOULDER WEDGE DEVICE MAY BE DISENGAGED AT PAVED DRIVEWAYS AND SIDE STREETS.

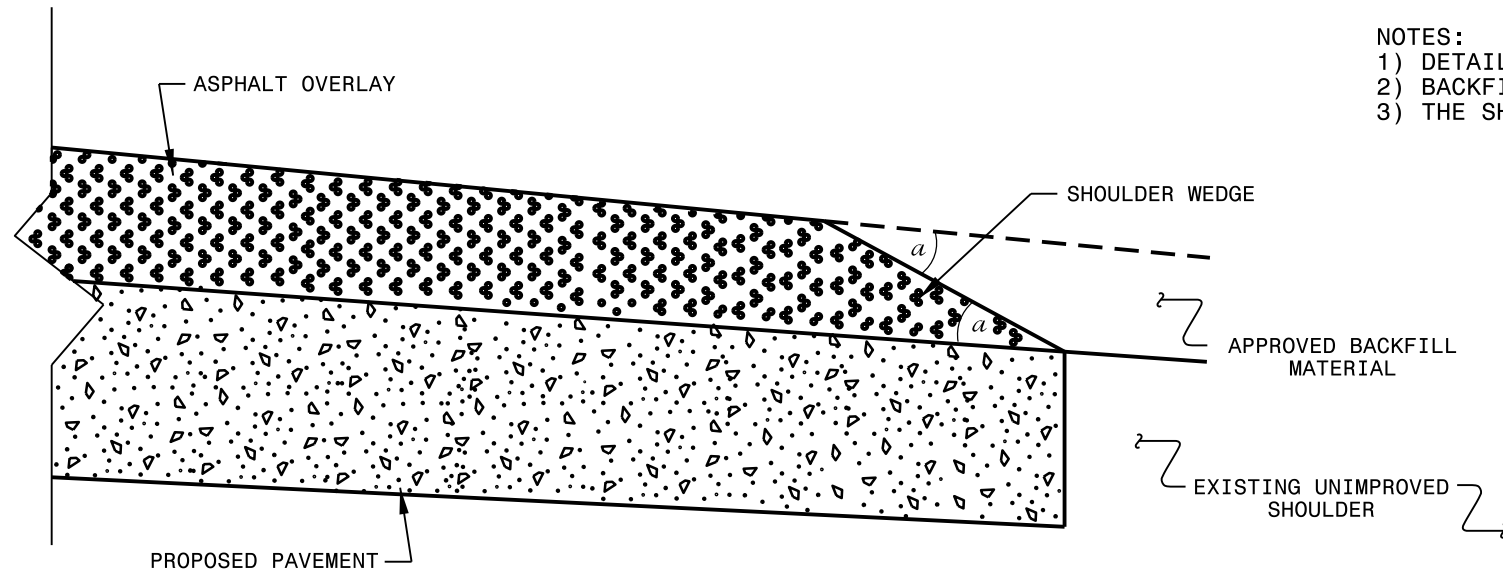

SHOULDER WEDGE DETAIL
 (Resurfacing Projects w/ Widening or
 with Existing Paved Shoulder having no dropoffs)

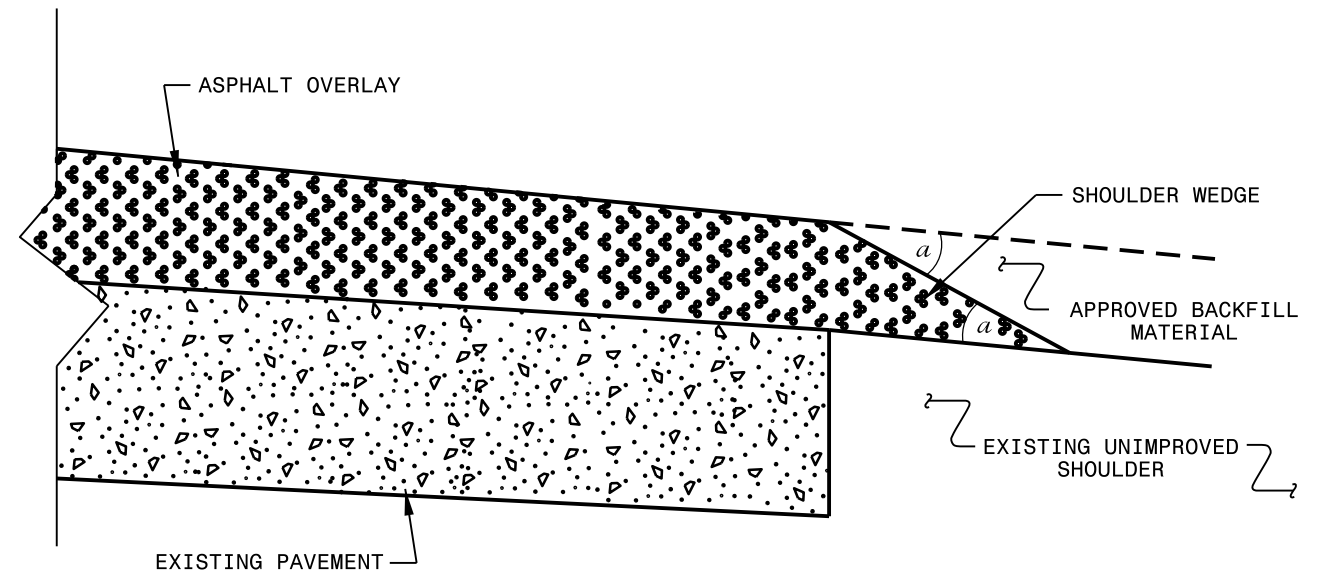

SHOULDER WEDGE DETAIL
 (Resurfacing Projects w/ NO Widening)

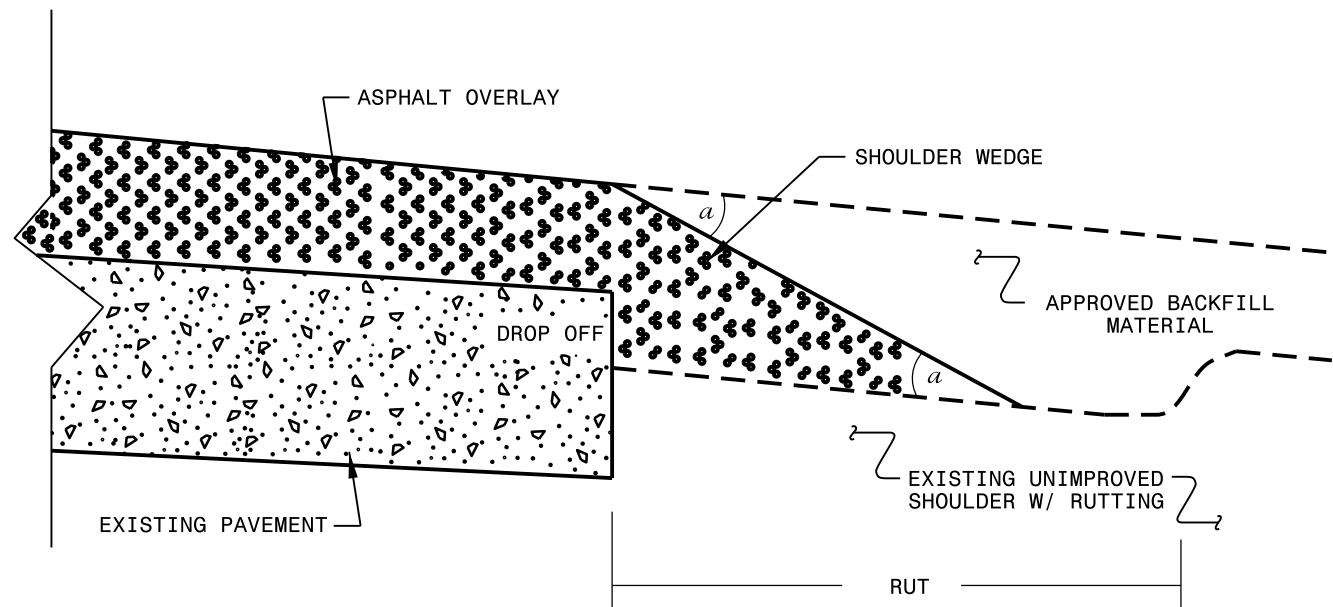

SHOULDER WEDGE DETAIL
 (Resurfacing Adjacent to
 Rutted Shoulder)

- SHOULDER WEDGE ANGLE = 30°

CONTRACT STANDARDS AND DEVELOPMENT UNIT	
Office 919-707-6950	FAX 919-250-4119
SHOULDER WEDGE DETAILS	
ORIGINAL BY: T.SPELL	DATE: 7-19-11
MODIFIED BY:	DATE: 10/16/12
CHECKED BY:	DATE:
FILE SPEC.: susr/details/stand/shoulderwedgedetail.dgn	

SYSTEMS DESIGN
 USER NAME

SIGNING FOR RESURFACING PROJECTS

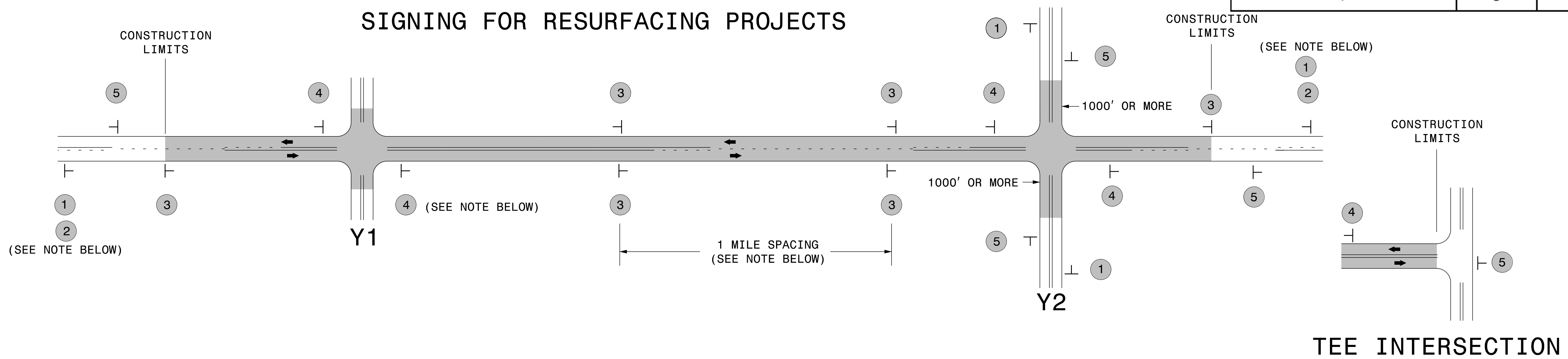

MAINLINE (-L-) SIGNING

-Y- LINE SIGNING

SIGNING NOTES AND PLACEMENT PER DIRECTION	MAINLINE (-L-) SIGNING		-Y- LINE SIGNING	
	1	<p>W20-1 48" X 48"</p>	<p>NO REQUIRED STATIONARY SIGNING FOR THE FOLLOWING -Y- LINE CONDITIONS:</p> <ol style="list-style-type: none"> LESS THAN 1000' OF RESURFACING ALONG -Y- LINE SUBDIVISION ROADS DEAD END ROADS 	
	2	<p>W7-3aP 24" X 18"</p>	<p>WHEN PAVING/CONSTRUCTION ACTIVITIES PROCEED ACROSS AN UNSIGNED -Y- LINE, ADVANCE WARNING PORTABLE SIGNS SHALL BE USED ALONG THE -Y- LINE AS SHOWN BELOW. REMOVE UPON COMPLETION OF WORK.</p>	
	3	<p>SP 13107 48" X 48"</p>	<p>PLACED 500' IN ADVANCE OF FLAGGER. PLACED 250' IN ADVANCE OF FLAGGER.</p>	
	4	<p>SP 13106 48" X 48"</p>	<p>PLACED 500' FOLLOWING THE END OF CONSTRUCTION LIMITS OR AS SHOWN WHEN WORK ENDS AT A 3-WAY TEE INTERSECTION.</p>	

**RESURFACING
ADVANCE WARNING SIGNS
FOR
RURAL AND SUBURBAN
2 LANE ROADWAYS**

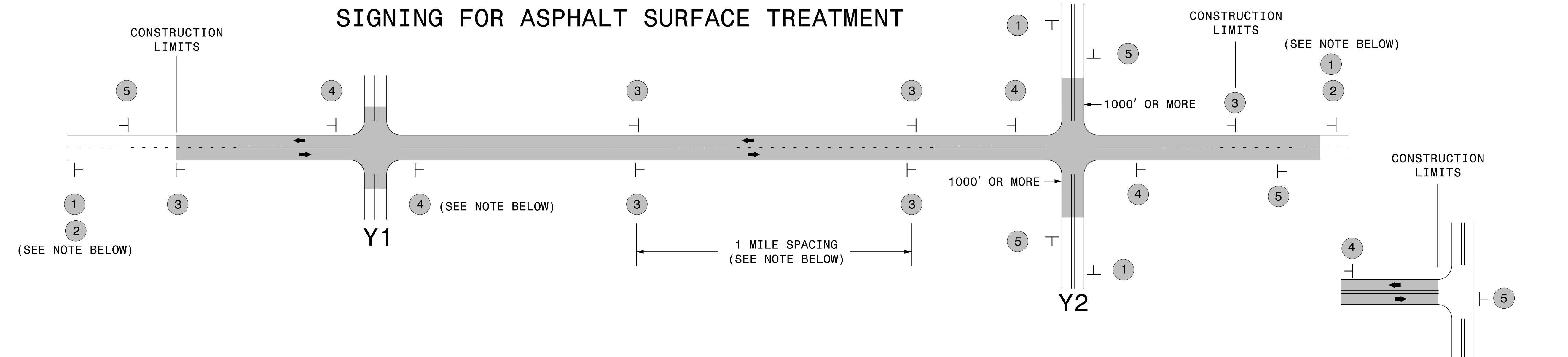

LEGEND
 ┆ STATIONARY SIGN
 ← DIRECTION OF TRAFFIC FLOW

MAINLINE (-L-) SIGNING

-Y- LINE SIGNING

SIGNING NOTES AND PLACEMENT PER DIRECTION	1		PLACE 1000' PRIOR TO BEGINNING OF CONSTRUCTION LIMITS. ONLY USED ON -Y- LINES IF RESURFACING LIMITS EXTEND 1000' ALONG -Y- LINE.
	2		#2 SIGN ONLY USED WHEN RESURFACING LIMITS ARE 2 OR MORE MILES IN LENGTH. ROUND UP TO NEXT WHOLE NUMBER. (NO FRACTIONAL OR DECIMAL NUMBERS)
	3		<ul style="list-style-type: none"> - ALTERNATE THE FOLLOWING TWO SIGNS: - STARTING WITH "LOOSE GRAVEL" (W8-7) FOLLOWED BY "UNMARKED PAVEMENT". - PLACE INITIALLY AT THE CONSTRUCTION LIMITS AND SPACED 1 MILE APART THEREAFTER. - AT TEE INTERSECTIONS INSTALL INITIALLY 0.5 MILE FROM INTERSECTION AND SPACE 1 MILE APART THEREAFTER.
	4		<ul style="list-style-type: none"> - THESE ARE FOR -Y- LINES THAT ARE "THROUGH" ROADWAYS. - DEAD END AND SUBDIVISION ROADS ARE NOT "THROUGH" ROADWAYS. - INSTALL 500' +/- FROM EACH -Y- LINE APPROACH AS SHOWN ABOVE. - FOR MULTIPLE -Y- LINES THAT ARE SEPARATED BY 0.25 MILES OR LESS, TREAT AS A SINGLE UNIT AND INSTALL WITHIN 500' OF EACH APPROACH. - A MAXIMUM OF 2 SIGN SETS PER MILE. DO NOT INSTALL WHEN -Y- LINES ARE WITHIN 0.5 MILES FROM "END ROAD WORK" SIGN. - FOR TEE INTERSECTIONS, INSTALL WITHIN 500' +/- OF THE INTERSECTION ALONG -L- LINE.
	5		PLACE 500' FOLLOWING THE END OF CONSTRUCTION LIMITS OR AS SHOWN WHEN WORK ENDS AT A 3-WAY TEE INTERSECTION.

NO REQUIRED STATIONARY SIGNING FOR THE FOLLOWING -Y- LINE CONDITIONS:

- 1) LESS THAN 1000' OF RESURFACING ALONG -Y- LINE
- 2) SUBDIVISION ROADS
- 3) DEAD END ROADS

WHEN PAVING/CONSTRUCTION ACTIVITIES PROCEED ACROSS AN UNSIGNED -Y- LINE, ADVANCE WARNING PORTABLE SIGNS SHALL BE USED ALONG THE -Y- LINE AS SHOWN BELOW. REMOVE UPON COMPLETION OF WORK.

W20-1
48" X 48"

W20-7 A
48" X 48"

PLACED 500' IN ADVANCE OF FLAGGER. PLACED 250' IN ADVANCE OF FLAGGER.

ADVANCE WARNING SIGNS FOR ASPHALT SURFACE TREATMENTS 2 LANE ROADWAYS

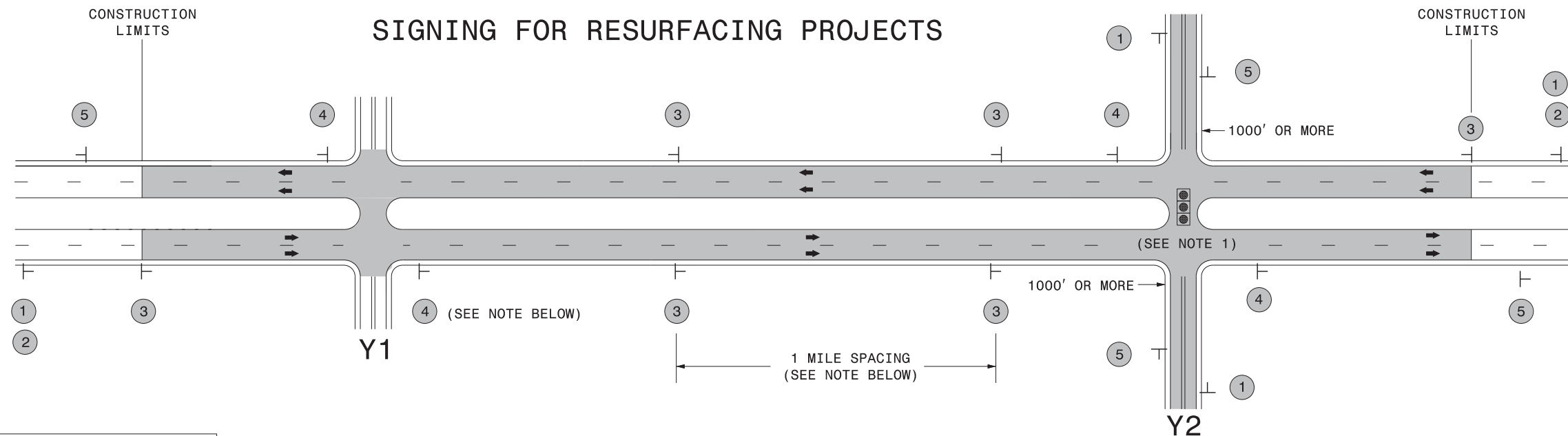

LEGEND
 | STATIONARY SIGN
 ← DIRECTION OF TRAFFIC FLOW

MAINLINE (-L-) SIGNING

-Y- LINE SIGNING

SIGNING NOTES AND PLACEMENT PER DIRECTION	1	 W20-1 48" X 48"	PLACE 1000' PRIOR TO BEGINNING OF CONSTRUCTION LIMITS. ONLY USED ON -Y- LINES IF RESURFACING LIMITS EXTEND 1000' ALONG -Y- LINE.	<p>NO REQUIRED STATIONARY SIGNING FOR THE FOLLOWING -Y- LINE CONDITIONS:</p> <ol style="list-style-type: none"> 1) LESS THAN 1000' OF RESURFACING ALONG -Y- LINE 2) SUBDIVISION ROADS 3) DEAD END ROADS <p>WHEN PAVING/CONSTRUCTION ACTIVITIES PROCEED ACROSS AN UNSIGNED -Y- LINE, ADVANCE WARNING PORTABLE SIGNS SHALL BE USED ALONG THE -Y- LINE AS SHOWN BELOW. REMOVE UPON COMPLETION OF WORK.</p> <div style="display: flex; justify-content: space-around;"> <div style="text-align: center;"> W20-1 48" X 48" </div> <div style="text-align: center;"> W20-7 A 48" X 48" </div> </div> <p>PLACED 500' IN ADVANCE OF FLAGGER. PLACED 250' IN ADVANCE OF FLAGGER.</p> <p>NOTES:</p> <ol style="list-style-type: none"> 1) MAY USE LAW ENFORCEMENT TO CONTROL TRAFFIC AT SIGNALIZED INTERSECTIONS AS DIRECTED BY THE ENGINEER. PROVIDE PORTABLE "ROAD WORK AHEAD" (W20-1) SIGNS 500' IN ADVANCE ALONG BOTH APPROACHES FROM THE SIDE STREETS WHEN PAVING PROCEEDS THROUGH THE INTERSECTION.
	2	 W7-3aP 24" X 18"	#2 SIGN ONLY USED WHEN RESURFACING LIMITS ARE 2 OR MORE MILES IN LENGTH. ROUND UP TO NEXT WHOLE NUMBER. (NO FRACTIONAL OR DECIMAL NUMBERS)	
	3	 SP 13107 48" X 48"	PLACE INITIALLY AT THE CONSTRUCTION LIMITS AND SPACED 1 MILE APART THEREAFTER. IF NO -Y- LINES EXIST, PLACE 2ND SET 1/2 MILE FROM THE CONSTRUCTION LIMITS AND THEN SPACE 1 MILE THEREAFTER.	
	4	 SP 13106 48" X 48"	THESE ARE FOR -Y- LINES THAT ARE "THROUGH" ROADWAYS. DEAD END AND SUBDIVISION ROADS ARE NOT "THROUGH" ROADWAYS. INSTALL 500' +/- FROM EACH -Y- LINE APPROACH AS SHOWN ABOVE. FOR MULTIPLE -Y- LINES THAT ARE SEPARATED BY 0.25 MILES OR LESS, TREAT AS A SINGLE UNIT AND INSTALL WITHIN 500' OF EACH APPROACH. A MAXIMUM OF 2 SIGN SETS PER MILE. DO NOT INSTALL WHEN -Y- LINES ARE WITHIN 0.5 MILES FROM "END ROAD WORK" SIGN.	
5	 G20-2 A 48" X 24"	PLACE 500' FOLLOWING THE END OF CONSTRUCTION LIMITS.		

**RESURFACING
 ADVANCE WARNING SIGNS
 FOR RURAL AND SUBURBAN
 MULTI-LANE ROADWAYS
 W/ SHOULDER SECTIONS**

SIGN NUMBER: 11299
 TYPE: B
 QUANTITY: SEE PLANS

BACKG COLOR: Fluorescent Orange
 COPY COLOR: Black

DESIGN BY: WJ
 PROJECT ID: ALL

CHECKED BY:
 DIV: ALL

DATE: Jun 22, 2011

SP 11299

PROJECT NO.	SHEET NO.	TOTAL NO.
2018CPT.13.03.10571, 2018CPT.13.03.20571	12	16

SIGN WIDTH: 5'-6"
 HEIGHT: 5'-6"
 TOTAL AREA: 30.5 Sq.Ft.

SYMBOL	X	Y	WID	HT

BORDER TYPE: INSET
 RECESS: 0.59"
 WIDTH: 0.75"
 RADII: 1.38"

MAT'L: 0.125" (3.2 mm) ALUMINUM

NO. Z BARS: N/A
 LENGTH: N/A

USE NOTES: 1,2

1. Legend and border shall be direct applied black non-reflective sheeting.
2. Background shall be Type VII, VIII, or IX (prismatic) fluorescent orange retroreflective sheeting.

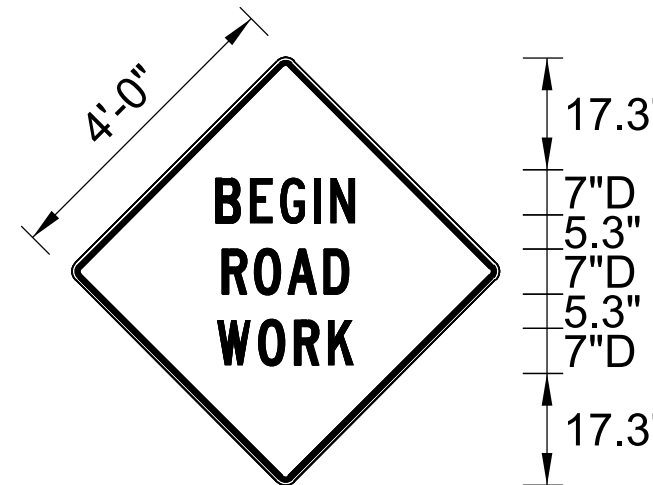

BORDER
 R=1.38"
 TH=0.75"
 IN=0.59"

20.5" 25.2" 20.5"

Spacing Factor is 1 unless specified otherwise

LETTER POSITIONS

Letter spacings are to start of next letter

Series/Size
 Text Length

	B	E	G	I	N																			D 2000	
20.5	6	5.4	6.3	2.8	4.8	20.5																		25.2	
	R	O	A	D																					D 2000
21.4	5.8	5.9	7	4.8	21.4																				23.5
	W	O	R	K																					D 2000
20.9	7.1	6.5	5.9	4.9	20.9																				24.5

SIGN NUMBER: SP13106
 TYPE: STATIONARY
 QUANTITY: SEE PLANS

BACKG COLOR: Fluorescent Orange
 COPY COLOR: Black

DESIGN BY: B. RASHID
 PROJECT ID:

CHECKED BY: AIA
 DIV:

DATE: Apr 26, 2013

SYMBOL	X	Y	WID	HT

SIGN WIDTH: 4'-0"
 HEIGHT: 4'-0"
 TOTAL AREA: 16.00 Sq.Ft.

BORDER TYPE: INSET
 RECESS: 0.75"
 WIDTH: 1.25"
 RADII: 3"

NO. Z BARS:
 LENGTH:

MAT'L: 0.080" (2.0 mm) ALUMINUM

PROJECT NO.	SHEET NO.	TOTAL NO.
2018CPT.13.03.10571, 2018CPT.13.03.20571	13	16

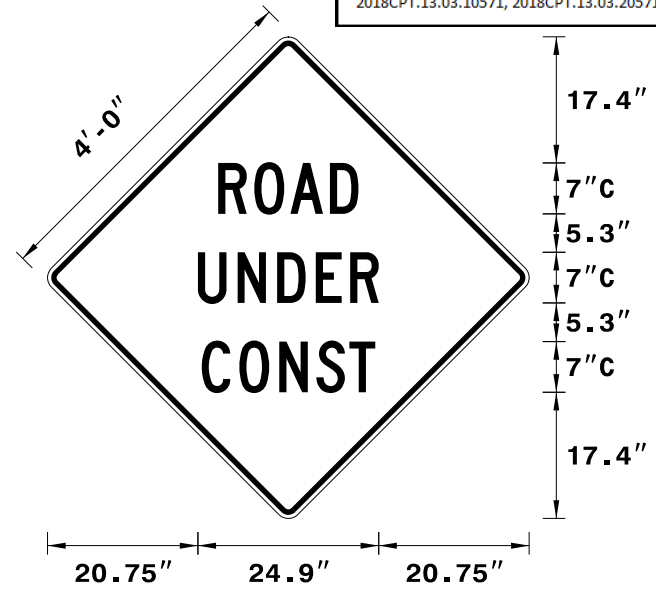

Spacing Factor is 1 unless specified otherwise

USE NOTES: 1,2

- Legend and border shall be direct applied black non-reflective sheeting.
- Background shall be NC GRADE B fluorescent orange retroreflective sheeting.

LETTER POSITIONS

Letter spacings are to start of next letter

Letter spacings are to start of next letter																		Series/Size Text Length
		R	O	A	D													C 2000
	23.5	5	5	5.5	3.9	23.5												19.3
		U	N	D	E	R												C 2000
	20.7	5.5	5.5	5.3	4.8	3.9	20.7											24.9
		C	O	N	S	T												C 2000
	21.2	5.2	5.5	5.1	4.6	3.6	21.2											23.9

SIGN NUMBER: SP13107
 TYPE: STATIONARY
 QUANTITY: SEE PLANS

BACKG COLOR: Fluorescent Orange
 COPY COLOR: Black

DESIGN BY: B. RASHID
 PROJECT ID:

CHECKED BY: AIA
 DIV:

DATE: Apr 26, 2013

SYMBOL	X	Y	WID	HT

MAT'L: 0.080" (2.0 mm) ALUMINUM

BORDER TYPE: INSET
 RECESS: 0.75"
 WIDTH: 1.25"
 RADII: 3"

NO. Z BARS:
 LENGTH:

PROJECT NO.	SHEET NO.	TOTAL NO.
2018CPT.13.03.10571, 2018CPT.13.03.20571	14	16

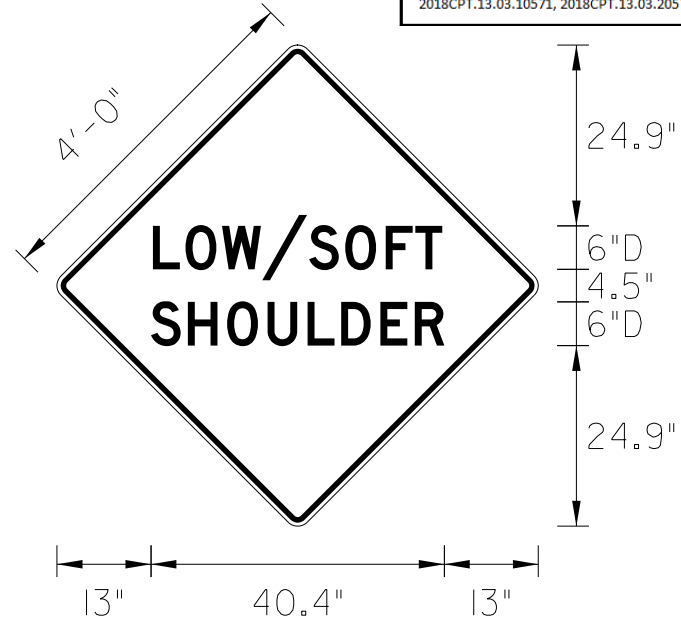

Spacing Factor is 1 unless specified otherwise

USE NOTES: 1,2

- Legend and border shall be direct applied black non-reflective sheeting.
- Background shall be NC GRADE B fluorescent orange retroreflective sheeting.

LETTER POSITIONS

Letter spacings are to start of next letter											Series/Size
	L	O	W	/	S	O	F	T			Text Length
	13.2	4.5	5	5.5	6.5	5	5.6	4.1	3.7	13.2	D 2000
											39.9
	S	H	O	U	L	D	E	R			D 2000
	13	5.1	5.4	5.6	5.5	4.6	5.4	4.7	4.1	13	40.4

PROJECT NO.	SHEET NO.	TOTAL NO.
2018CPT.13.03.10571, 2018CPT.13.03.20571	15	16

SUMMARY OF QUANTITIES

PROJECT NO	COUNTY	MAP NO	ROUTE	DESCRIPTION	TYP	LANES	LANE TYPE	FINAL SURFACE TESTING REQUIRED	WARM MIX ASPHALT REQUIRED	LENGTH MI	WIDTH FT	INCIDENTAL STONE BASE TON	SHOULDER RECONSTRUCTION SMI	3" MILLING SY	MILLING ASPHALT PAVEMENT, 0" TO 1-1/2" DEPTH SY	INCIDENTAL MILLING SY	ASPHALT CONC SURFACE COURSE, TYPE S9.5B TON	ASPHALT CONC SURFACE COURSE, TYPE SF9.5A TON	ASPHALT BINDER FOR PLANT MIX TON	PATCHING EXISTING PAVEMENT TON	ASPHALT SURFACE TREATMENT, DOUBLE SEAL SY	ASPHALT SURFACE TREATMENT, FOG SEAL SY	EMULSION FOR ASPHALT SURFACE TREATMENT GAL	LATEX MODIFIED MICRO-SURFACING, TYPE III SY	RETROFIT EXISTING CURB RAMP EA	ADJUSTMENT OF CATCH BASINS EA	VACUUM TRUCK WK			
2018CPT.13.03.10571	Madison	1	NC 251	FROM PVMT JOINT TO PVMT SPLIT (MP 2.15-MP 4.04)	1	2	2WU	NO	NO	1.89	21	95	3.78			500	2,351		142	130										
		2	US 25/70	FROM SR 1439 TO NC 208 (MP 10.76-MP 15.92)	1	2	2WU	NO	NO	5.6	29	280	11.20				2,500	9,702		582	700									
		3	US-23A	FROM US 19 TP SR 1636 (MP 0.15 - MP 7.79)	2	2	2WU	NO	NO	7.64	33										1,200				162,701					
TOTAL FOR PROJ NO. 2018CPT.13.03.10571										15.13		375	14.98			3,000	12,063		724	2,030				162,701						
2018CPT.13.03.20571	Madison	4	SR 1192	FROM SR 1601 TO SR 1392 (MP 0.00 - MP 0.13)	3	2	2WU	NO	NO	0.13	20	7						152	10	20										
		5	SR 1304	FROM MP 0.05 TO EOP (MP 0.05 - MP 3.08)	2	2	2WU	NO	NO	2.65	19										90				29,539					
		6	SR 1589	FROM NC 251 (RIVER RD) TO SR 1591 (MP 0.00 - MP 0.98)	3	2	2WU	NO	NO	0.98	18	49							1,033	69	175									
		7	SR 1392	FROM US 25/70 TO US 25/70 BUSINESS (MP 0.00 - MP 2.38)	3	2	2WU	NO	NO	2.38	18	119			1,560				2,509	168	150									
		8	SR 1395	FROM US 25/70 TO US 25/70 BUSINESS (MP 0.00-MP 0.83)	3	2	2WU	NO	NO	0.83	18	42							875	59	125									
		9	SR 1601	FROM SR 1192 TO US 25/70 (MP 0.00 - 0.28)	3	2	2WU	NO	NO	0.28	20	14							305	20	125									
		10	SR 1439	FROM US 25/70 TO US 25/70 (MP 0.00 - MP 0.46)	3	2	2WU	NO	NO	0.46	22	23							593	40	80									
		11	SR 1559	FROM SR 1609 TO PVMT JOINT AT BRIDGE 255 (MP 0.00 - MP 1.58)	3	2	2WU	NO	NO	1.58	20	79							1,851	124	350									
		12	SR 1565	FROM NC 213 TO PVMT JOINT PAST SR 1566 (MP 0.00-MP 2.68)	3	2	2WU	NO	NO	2.68	18	134							2,825	189	450									
		13	SR 1609	FROM NC 213 TO PVMT JOINT PAST SR 1559 (MP 2.41 - MP 3.51)	3,4	2	2WU	NO	NO	1.1	20	55				1,100			1,288	85	80						9	1		2
		14	SR 1185	FROM SR 1183 TO US 25/70 (MP 0.00 - MP 0.68)	5	2	2WU	NO	NO	0.68	18												7,181	7,181	5,290					
		15	SR 1559	FROM PVMT JNT NEAR SR 1562 TO PVMT JOINT NEAR BRIDGE 4 AT SR 1639 (MP 0.00 - 2.09)	5	2	2WU	NO	NO	2.09	18												21,542	21,542	11,850					
		16	SR 1349	FROM US 23A TO EOP (MP 0.00 - MP 2.05)	5	2	2WU	NO	NO	2.05	18												21,648	21,648	11,910					
		17	SR 1546	FROM SR 1540 TO BCL (MP 0.00 - MP 1.78)	3	2	2WU	NO	NO	1.78	18	89							1,718	115	350									
		18	SR 1503	FROM SR 1502 TO YCL (MP 0.23 - MP 3.43)	5	2	2WU	NO	NO	3.2	18												33,792	33,792	18,590					
		19	SR 1568	FROM SR 1592 TO BCL (MP 0.00 - MP 0.73)	5	2	2WU	NO	NO	0.73	18												13,094	13,094	7,205					
		20	SR 1569	FROM SR 1574 TO EOP (MP 2.14 - MP 3.87)	5	2	2WU	NO	NO	1.73	20												20,299	20,299	11,165					
		21	SR 1553	FROM NC 213 TO SR 1623 (MP 0.00 - MP 0.85)	3	2	2WU	NO	NO	0.85	20	43							911	61	100									
		22	SR 1116	FROM SR 1116 TO EOP (MP 0.00 - MP 0.81)	5	2	2WU	NO	NO	0.81	18												8,554	8,554	4,705					
		TOTAL FOR PROJ NO. 2018CPT.13.03.20571										26.99		654	14.98	1,560	1,100	3,000	12,063	14,060	941	2,095	126,110	126,110	70,715	29,539	9	1	2	
		GRAND TOTAL										42.12		1,029	14.98	1,560	1,100	3,000	12,063	14,060	1,665	4,125	126,110	126,110	70,715	192,240	9	1	2	

PROJECT NO.	SHEET NO.	TOTAL NO.
2018CPT.13.03.10571, 2018CPT.13.03.20571	16	16

THERMOPLASTIC AND PAINT QUANTITIES

PROJECT NO	COUNTY	MAP NO	ROUTE	DESCRIPTION	TYP	LANES	LANE TYPE	LENGTH	WIDTH	4413000000-E	4457000000-N	4725000000-E	4810000000-E		4847000000-E		4850000000-E	4905000000-N		
										WORK ZONE ADVANCE/GENERAL WARNING SIGNING	TEMPORARY TRAFFIC CONTROL	THERMOPLASTIC PAVEMENT MARKING SYMBOL (90 MILS) LT ARROW	PAINT PAVEMENT MARKING LINES (4") YELLOW	PAINT PAVEMENT MARKING LINES (4") WHITE	POLYUREA PAVEMENT MARKING LINES (4") WHITE (HIGHLY REFLECTIVE ELEMENTS)	POLYUREA PAVEMENT MARKING LINES (4") YELLOW (HIGHLY REFLECTIVE ELEMENTS)	REMOVAL OF PAVEMENT MARKING LINES (4")	SNOWPLOWABLE PAVEMENT MARKERS		
NO		NO			NO					SF	LS	EA	LF	LF	LF	LF	LF	EA		
2018CPT.13.03.10571	Madison	1	NC 251	FROM PVMT JOINT TO BRDG 8 & 9 (MP 2.15-MP 4.04)	1	2	2WU	1.89	21	1,698	*	8			19,958	19,958		166		
		2	US 25/70	FROM SR 1439 TO NC 208 (MP 10.76- MP 15.92)	1	2	2WU	5.6	29						59,242	64,856		371		
		3	US-23A	FROM US 19 TP SR 1636 (MP 0.15 - MP 7.79)	2	2	2WU	7.64	33								80,678	80,678	161,357	1,009
TOTAL FOR PROJ NO. 2018CPT.13.03.10571											8			159,878	165,492	161,357	1,546			
													325,370							
2018CPT.13.03.20571	Madison	4	SR 1192	FROM SR 1601 TO SR 1392 (MP 0.00 - MP 0.13)	3	2	2WU	0.13	20	3,079	*		2,746							
		5	SR 1304	FROM MP 0.05 TO EOP (MP 0.05 - MP 3.08)	2	2	2WU	2.65	19				55,968	55,968			55,968			
		6	SR 1589	FROM NC 251 TO SR 1591 (MP 0.00 - MP 0.98)	3	2	2WU	0.98	18						20,698	20,698				
		7	SR 1392	FROM US 25/70 TO US 25/70 BUSINESS (MP 0.00 - MP 2.38)	3	2	2WU	2.38	18						50,266	50,266				
		8	SR 1395	FROM US 25/70 TO US 25/70 BUSINESS (MP 0.00- MP 0.83)	3	2	2WU	0.83	18						17,530	17,530				
		9	SR 1601	FROM SR 1192 TO US 25/70 (MP 0.00 - 0.28)	3	2	2WU	0.28	20						5,914	5,914				
		10	SR 1439	FROM US 25/70 TO US 25/70 (MP 0.00 - MP 0.46)	3	2	2WU	0.46	22						9,715	9,715				
		11	SR 1559	FROM SR 1609 TO PVMT JOINT AT BRIDGE 255 (MP 0.00 - MP 1.58)	3	2	2WU	1.58	20						33,370	33,370				
		12	SR 1565	FROM NC 213 TO PVMT JOINT PAST SR 1566 (MP 0.00-MP 2.68)	3	2	2WU	2.68	18						56,602	56,602				
		13	SR 1609	FROM NC 213 TO PVMT JOINT PAST SR 1559 (MP 2.41 - MP 3.51)	3,4	2	2WU	1.1	20						23,232	23,232				
		14	SR 1185	FROM SR 1183 TO US 25/70 (MP 0.00-MP 0.68)	5	2	2WU	0.68	18						14,362	14,362				
		15	SR 1559	FROM PVMT JNT NEAR SR 1562 TO PVMT JOINT NEAR BRIDGE 4 AT SR 1639 (MP 0.00 - 2.09)	5	2	2WU	2.09	18						44,141	44,141				
		16	SR 1349	FROM US 23A TO EOP (MP 0.00 - MP 2.05)	5	2	2WU	2.05	18						43,296	43,296				
		17	SR 1546	FORM SR 1540 TO BCL (MP 0.00 - MP 1.78)	3	2	2WU	1.78	18						37,594	37,594				
		18	SR 1503	FROM SR 1502 TO YCL (MP 0.23 - MP 3.43)	5	2	2WU	3.2	18						67,584	67,584				
		19	SR 1568	FROM SR 1592 TO BCL (MP 0.00 - MP 0.73)	5	2	2WU	0.73	18						15,418	15,418				
		20	SR 1569	FROM SR 1574 TO EOP (MP 2.14 - MP 3.87)	5	2	2WU	1.73	20						36,538	36,538				
		21	SR 1553	FROM NC 213 TO SR 1623 (MP 0.00 - MP 0.85)	3	2	2WU	0.85	20						17,952	17,952				
		22	SR1116	FROM SR 1116 TO EOP (MP 0.00 - MP 0.81)	5	2	2WU	0.81	18											
		TOTAL FOR PROJ NO. 2018CPT.13.03.20571													552,926	550,180		55,968		
															1,103,106					
		GRAND TOTAL												8	552,926	550,180	159,878	165,492	217,325	1,546
													1,103,106		325,370					