

PROJECT NO.	SHEET NO.	TOTAL SHEETS
2020CPT.13.03.10571, 2020CPT.13.03.20571	1	14

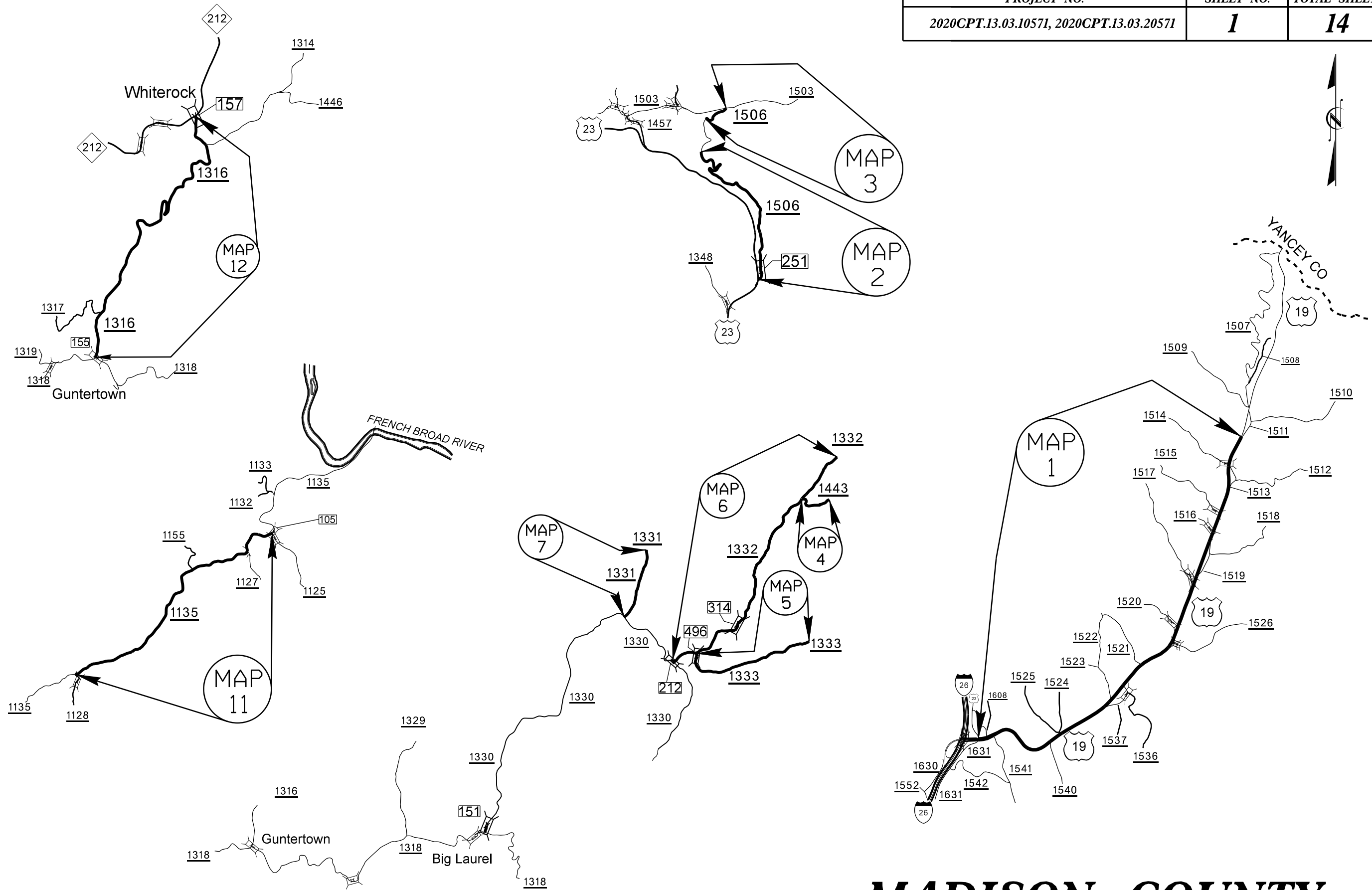

MADISON COUNTY

PROJECT NO.	SHEET NO.	TOTAL SHEETS
2020CPT.13.03.10571, 2020CPT.13.03.20571	2	14

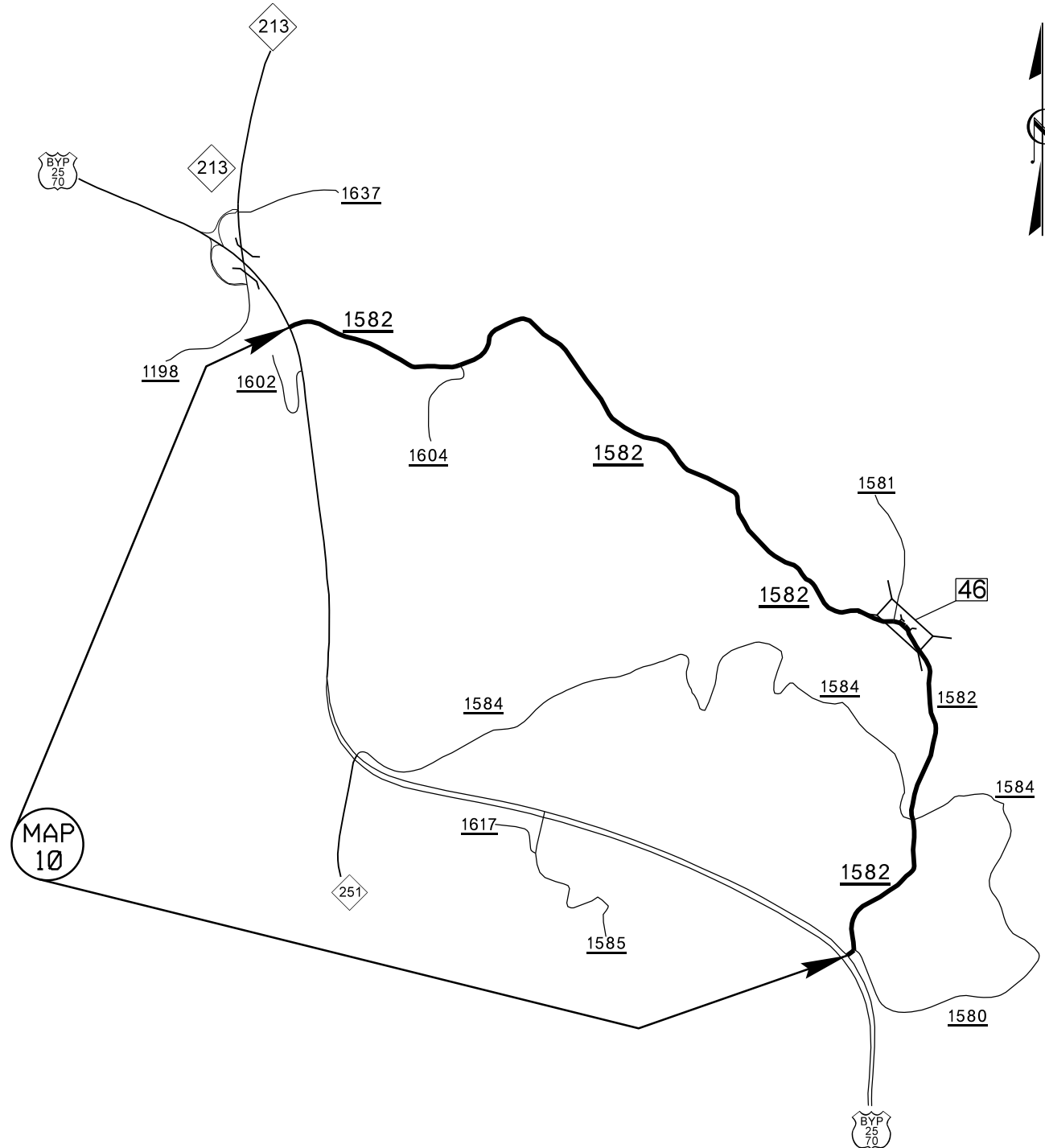
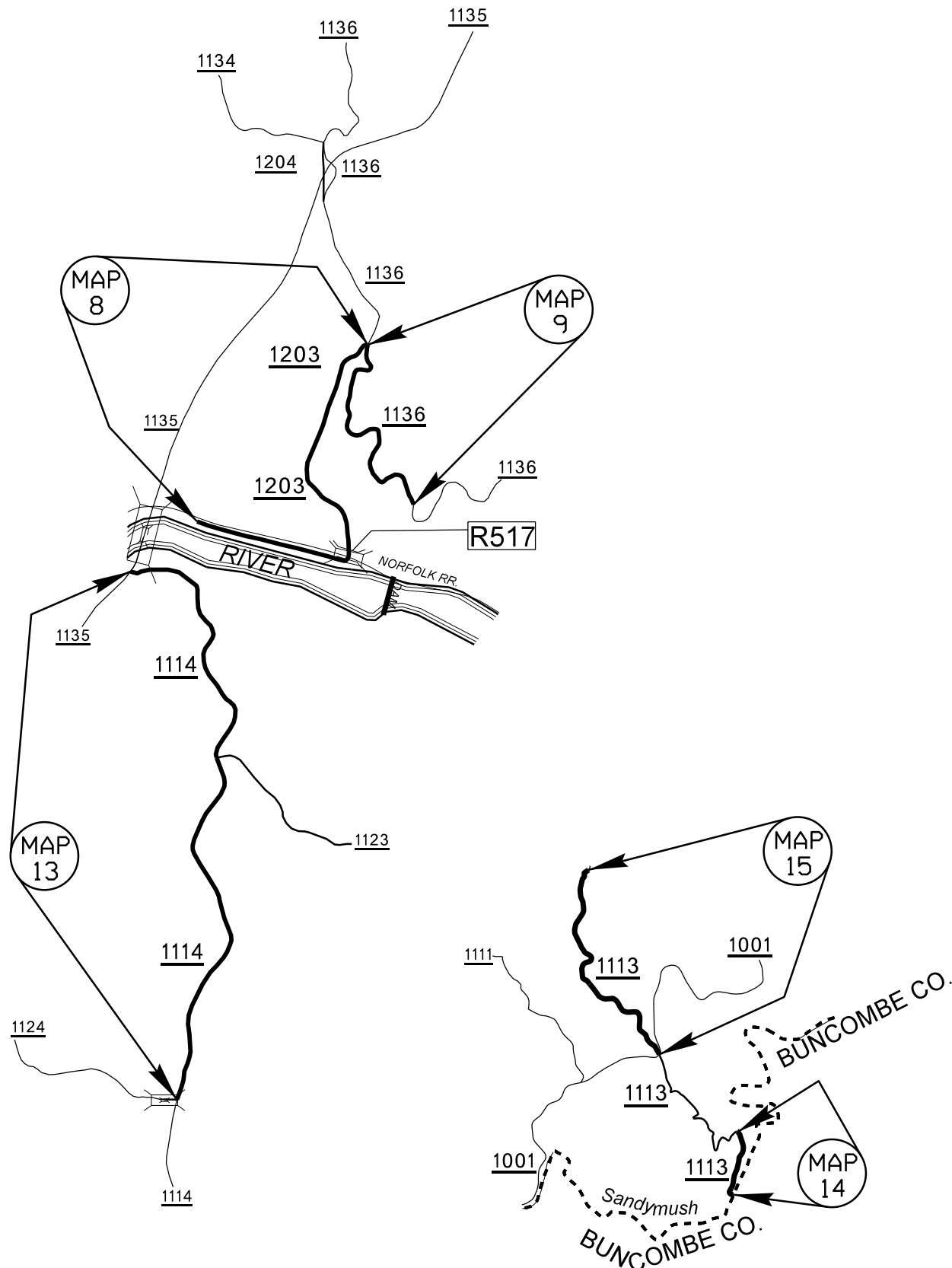

MADISON COUNTY

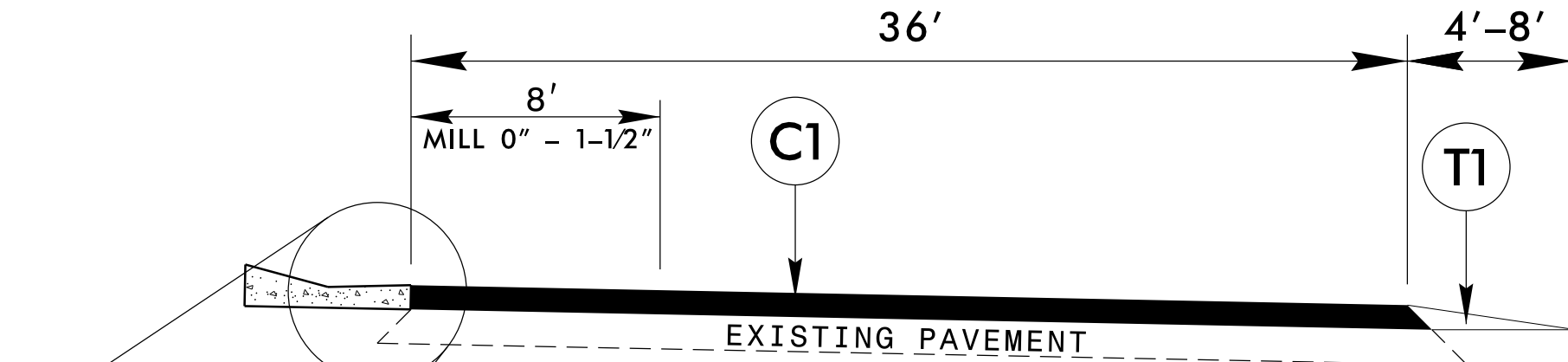

TYPICAL SECTION #1
(EASTBOUND OR WESTBOUND)

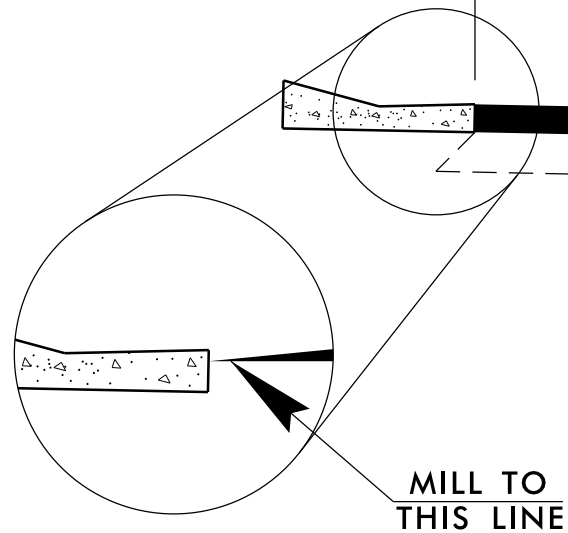

MILL TO THIS LINE

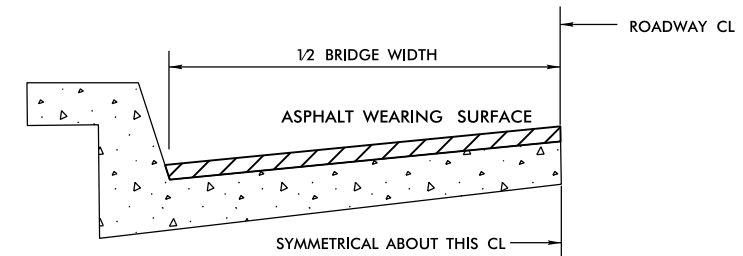

BRIDGE HALF TYPICAL SECTION

FOR BRIDGES WITH FLOOR DRAINS, CARE SHALL BE EXERCISED IN PLACING THE WEARING SURFACE AROUND FLOOR DRAINS SO AS NOT TO HINDER EFFECTIVE DRAINAGE. ALL DRAINS SHALL BE LEFT OPEN.

THE PROPOSED WEARING SURFACE SHALL VARY IN THICKNESS AS NECESSARY TO PROVIDE A SMOOTH RIDING SURFACE. THE MINIMUM THICKNESS SHOULD DEPEND ON PAVEMENT TYPE AS FOLLOWS: S4.75A 1/2", S9.5B 1", S9.5C,D 1.5" - 2". ULTRA-THIN HOT MIX ASPHALT - TYPE A 3/4". ULTRA-THIN HOT MIX ASPHALT - TYPE B 5/8". ULTRA-THIN HOT MIX ASPHALT - TYPE C 1/2". THE MAXIMUM THICKNESS SHOULD DEPEND ON PAVEMENT TYPE AS FOLLOWS: S4.75A 1", S9.5B 1.5", S9.5C,D 2". ULTRA-THIN HOT MIX ASPHALT - TYPE A 3/4", ULTRA-THIN HOT MIX ASPHALT - TYPE B 5/8", ULTRA-THIN HOT MIX ASPHALT - TYPE C 1/2".

NOTES

ALL UNPAVED ROADS TO BE RESURFACED 50' FROM EDGE OF PAVEMENT OF MAIN PROJECT. ALL PAVED S. R. ROADS TO BE RESURFACED TO THE ENDS OF THE RADII, OR AS DIRECTED BY THE ENGINEER.

EDGES, PAVEMENT WIDENING, INTERSECTIONS AND BRIDGE FLARES ARE INCLUDED IN THE TABLE OF QUANTITIES.

SHOULDERS AND DITCHES ARE TO BE CONSTRUCTED BY OTHERS UNLESS OTHERWISE INDICATED.

BRIDGES ARE TO BE RESURFACED AT LOCATIONS AND TO DEPTH AS DIRECTED BY THE ENGINEER.

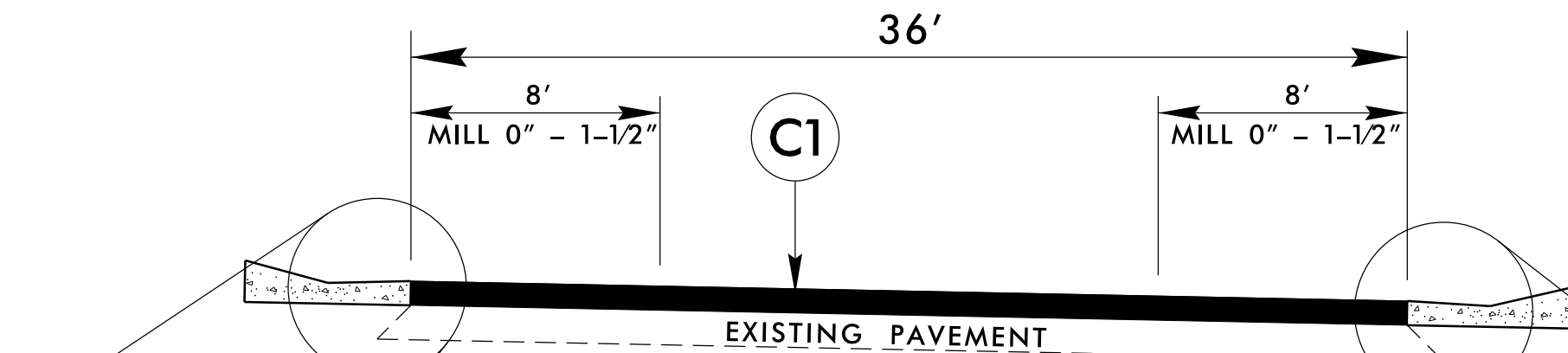

TYPICAL SECTION #2
(EASTBOUND OR WESTBOUND)

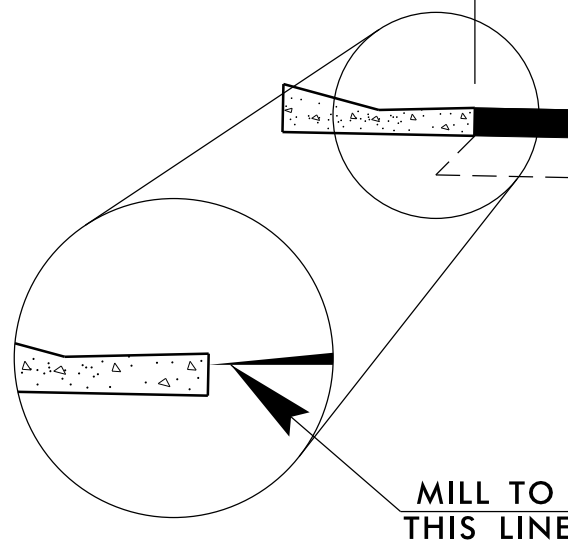

MILL TO THIS LINE

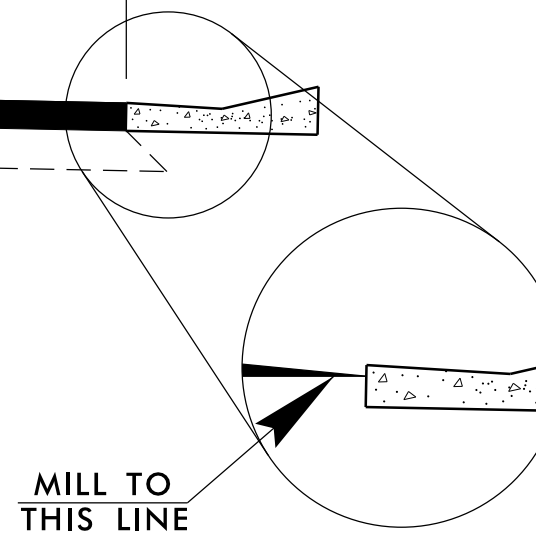

MILL TO THIS LINE

PAVEMENT SCHEDULE	
C1	PROP. APPROX. 1 1/2" ASPHALT CONCRETE SURFACE COURSE TYPE S9.5C, AT AN AVERAGE RATE OF 168 LBS. PER SQ.YD.
C2	PROP. APPROX. 1 1/2" ASPHALT CONCRETE SURFACE COURSE TYPE S9.5B, AT AN AVERAGE RATE OF 165 LBS. PER SQ.YD.
E1	PROP. APPROX. 6" ASPHALT CONCRETE BASE COURSE TYPE B25.0C, AT AN AVERAGE RATE OF 342 LBS. PER SQ.YD. IN EACH OF TWO LAYERS.
F1	ASPHALT SURFACE TREATMENT, DOUBLE SEAL
F2	ASPHALT SURFACE TREATMENT, FOG SEAL
T1	SHOULDER RECONSTRUCTION
V1	INCIDENTAL MILLING
V2	MILLING ASPHALT PAVEMENT, 1-1/2" DEPTH

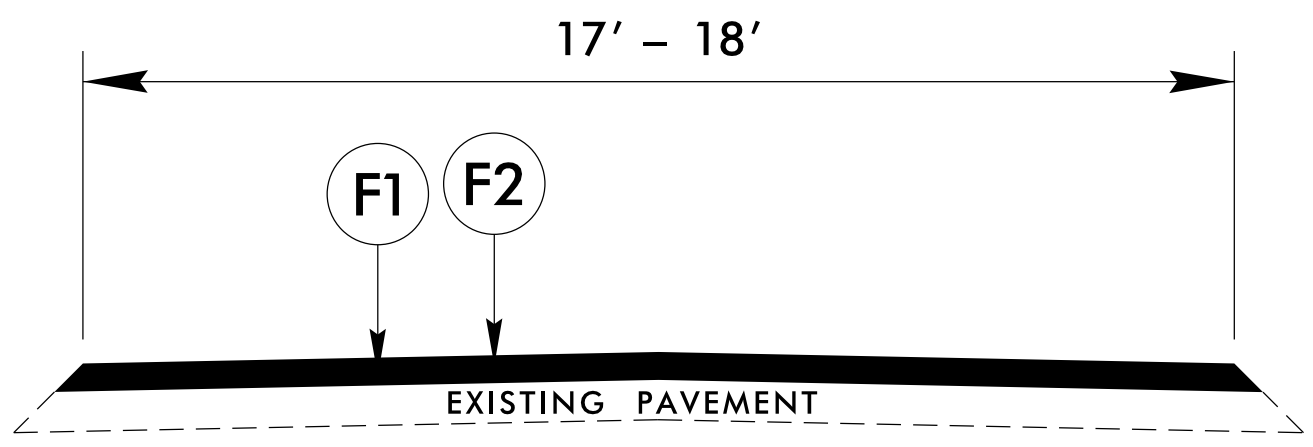

TYPICAL SECTION #3

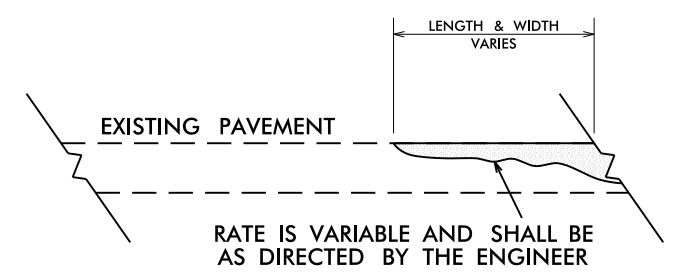
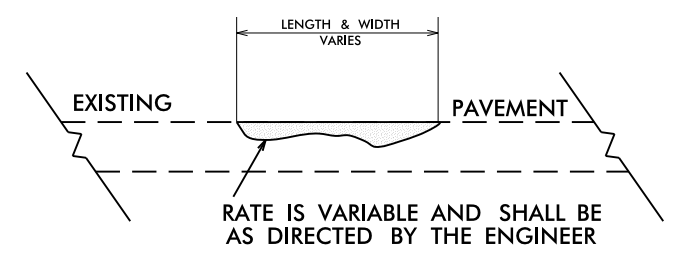

DETAIL SHOWING METHOD OF WEDGING

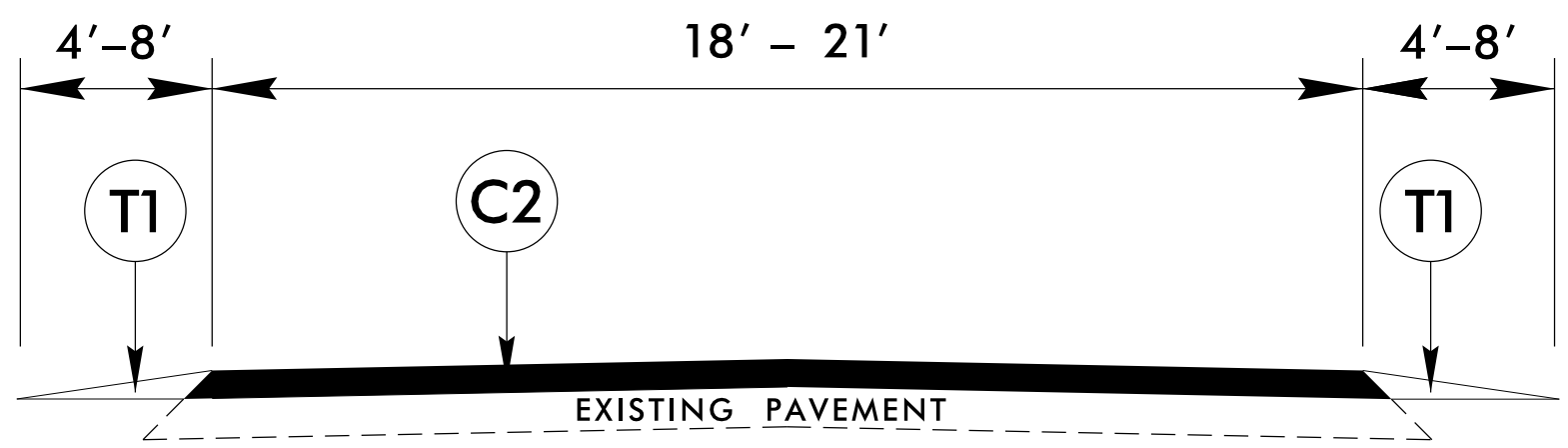

TYPICAL SECTION #4

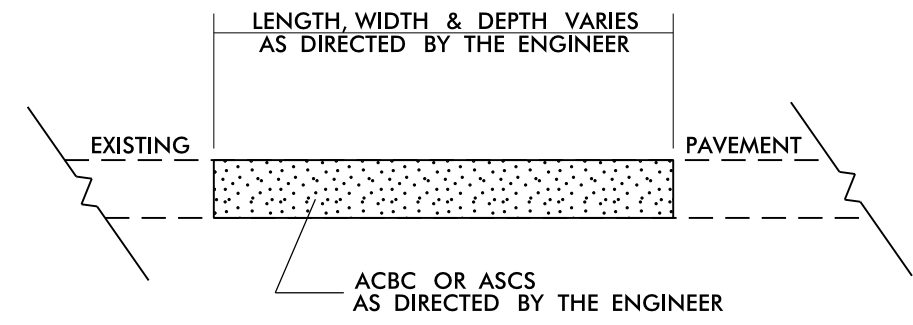

PATCHING EXISTING PAVEMENT

PAVEMENT SCHEDULE	
C2	PROP. APPROX. 1 1/2" ASPHALT CONCRETE SURFACE COURSE TYPE S9.5B, AT AN AVERAGE RATE OF 165 LBS. PER SQ.YD.
F1	ASPHALT SURFACE TREATMENT, DOUBLE SEAL
F2	ASPHALT SURFACE TREATMENT, FOG SEAL
T1	SHOULDER RECONSTRUCTION

6/2/19
25-OCT-2018 11:22
S:\00\Resurfacing\2020\Resurfacing\2020\Madison-Resurfacing-TYP.dgn

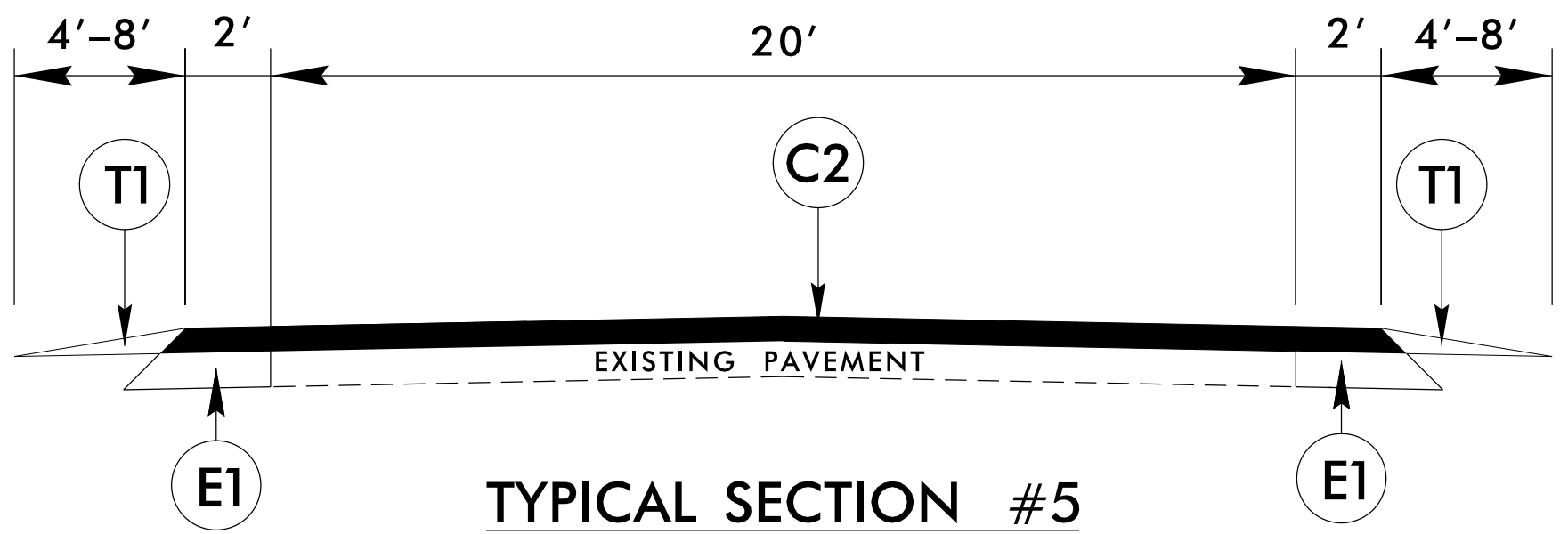

TYPICAL SECTION #5
 FROM NORTHERN MOST INTERSECTION W/US 25/70
 TO INTERSECTION OF KEN PACK RD

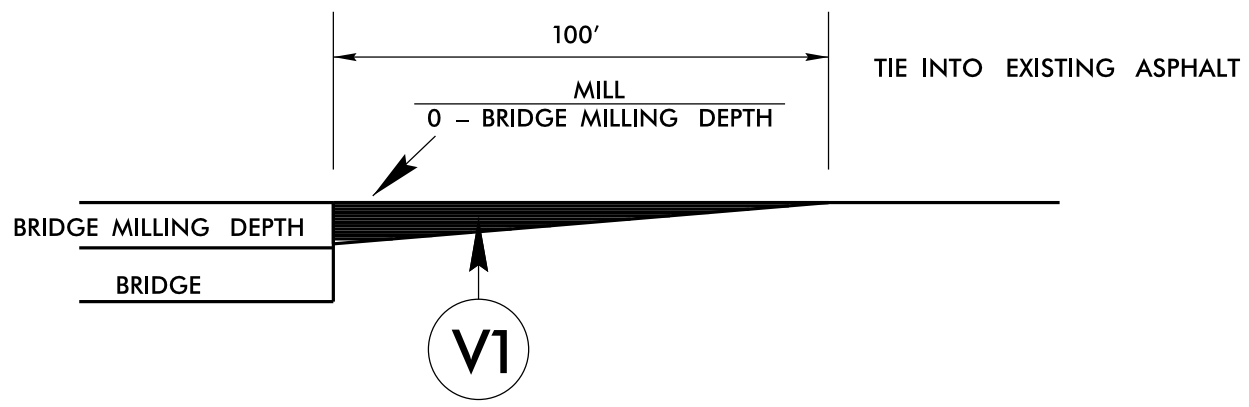

MILLING DETAIL AT BRIDGE APPROACHES
 WHERE BRIDGES WILL BE MILLED THEN RESURFACED.
 THIS WILL BE PAID FOR AS INCIDENTAL MILLING.
 USE AT BRIDGE NUMBER: 157 MAP 12.

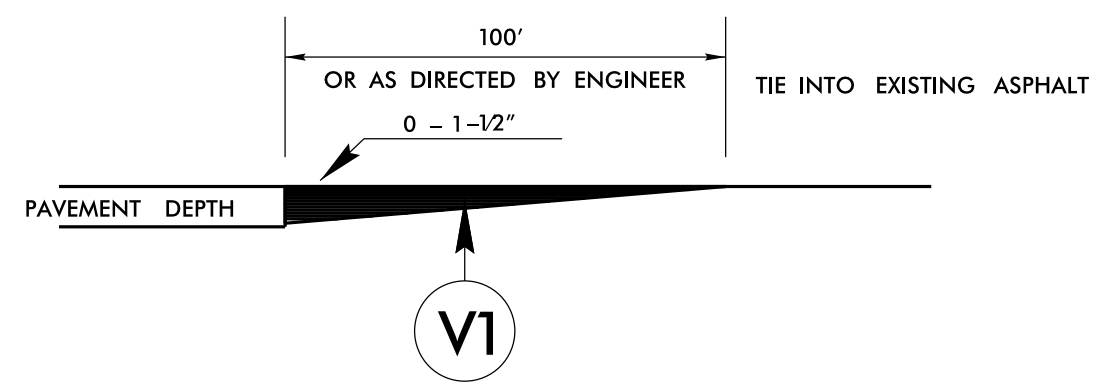

DETAIL TO TIE INTO EXIST PAVEMENT
 THE CONTRACTOR'S ATTENTION IS DIRECTED TO
 THE FACT THAT HE WILL BE REQUIRED TO MILL
 THE EXISTING ASPHALT PAVEMENT TO ENSURE A PROPER
 TIE-IN WITH THE EXISTING SURFACE AT THE BEGINNING, END
 AND Y LINES OF EACH MAP TO BE RESURFACED WITH
 ASPHALT CONC SURFACE COURSE, TYPE S9.5C.
 THIS WILL BE PAID FOR AS INCIDENTAL MILLING.

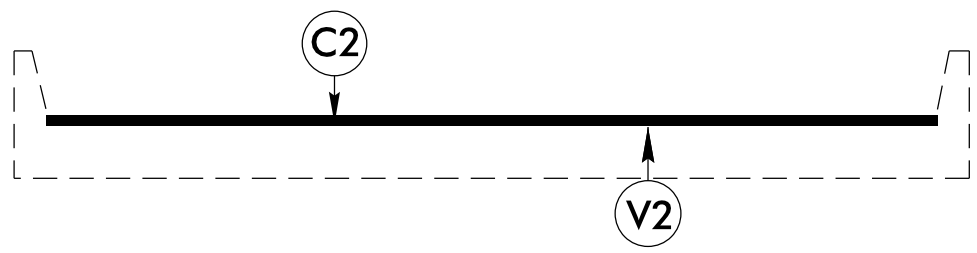

BRIDGE DETAIL
 BRIDGE NUMBER 157 MAP 12.
 MILL 1-1/2" OFF EXISTING PAVEMENT
 SEE MAP FOR BRIDGE LOCATION.

PAVEMENT SCHEDULE	
C2	PROP. APPROX. 1 1/2" ASPHALT CONCRETE SURFACE COURSE TYPE S9.5B, AT AN AVERAGE RATE OF 165 LBS. PER SQ.YD.
E1	PROP. APPROX. 6" ASPHALT CONCRETE BASE COURSE TYPE B25.0C, AT AN AVERAGE RATE OF 342 LBS. PER SQ.YD. IN EACH OF TWO LAYERS.
T1	SHOULDER RECONSTRUCTION
V1	INCIDENTAL MILLING

25-OCT-2018 13:17
 S:\00\Resurfacing\2020\Resurfacing\Madison\2020_Madison_Resurfacing-TYP.dgn
 6/2/19

- NOTES:
- 1) DETAIL DOES NOT APPLY TO OGAFD AND ULTRA-THIN BONDED WEARING COURSE.
 - 2) BACKFILL SHOULDER WITH APPROVED MATERIAL.
 - 3) THE SHOULDER WEDGE DEVICE MAY BE DISENGAGED AT PAVED DRIVEWAYS, SIDE STREETS, HIGH SHOULDERS, AND OTHER LOCATIONS NOT FEASIBLE TO CONSTRUCT AS APPROVED BY THE ENGINEER.

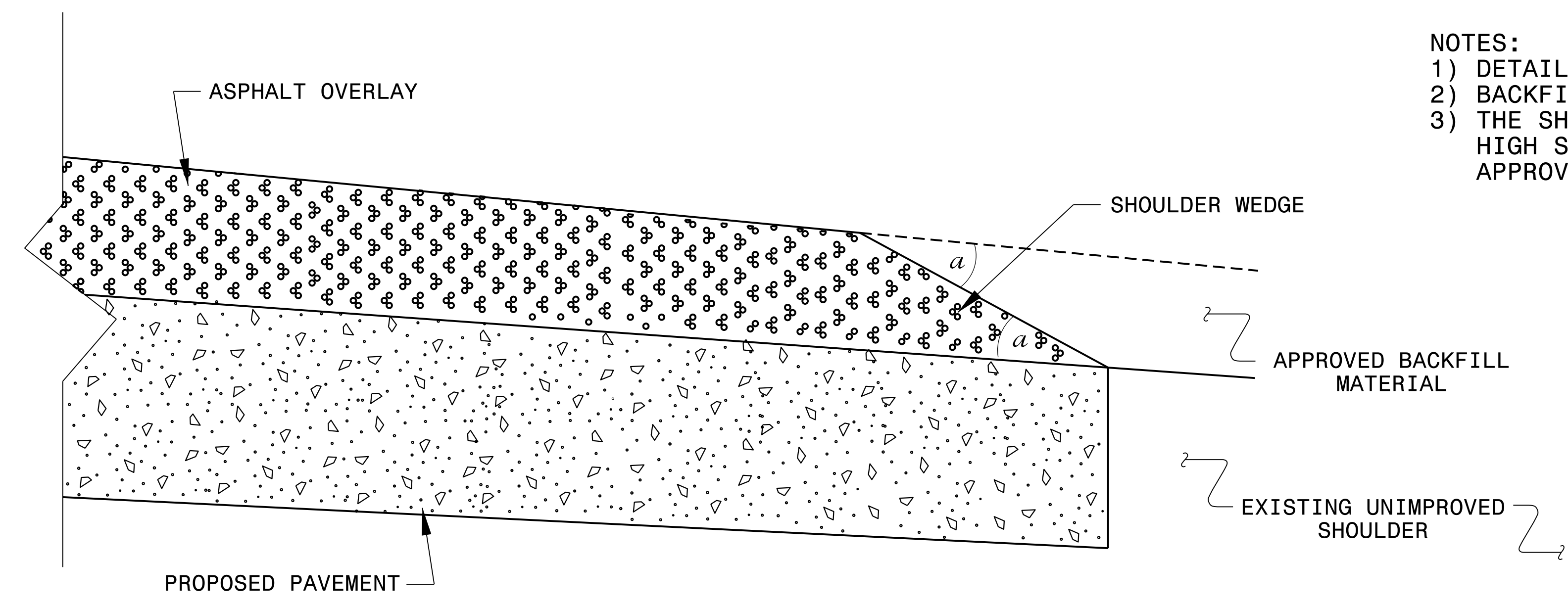

SHOULDER WEDGE DETAIL
 (Resurfacing Projects w/ Widening or with Existing Paved Shoulder having no dropoffs)

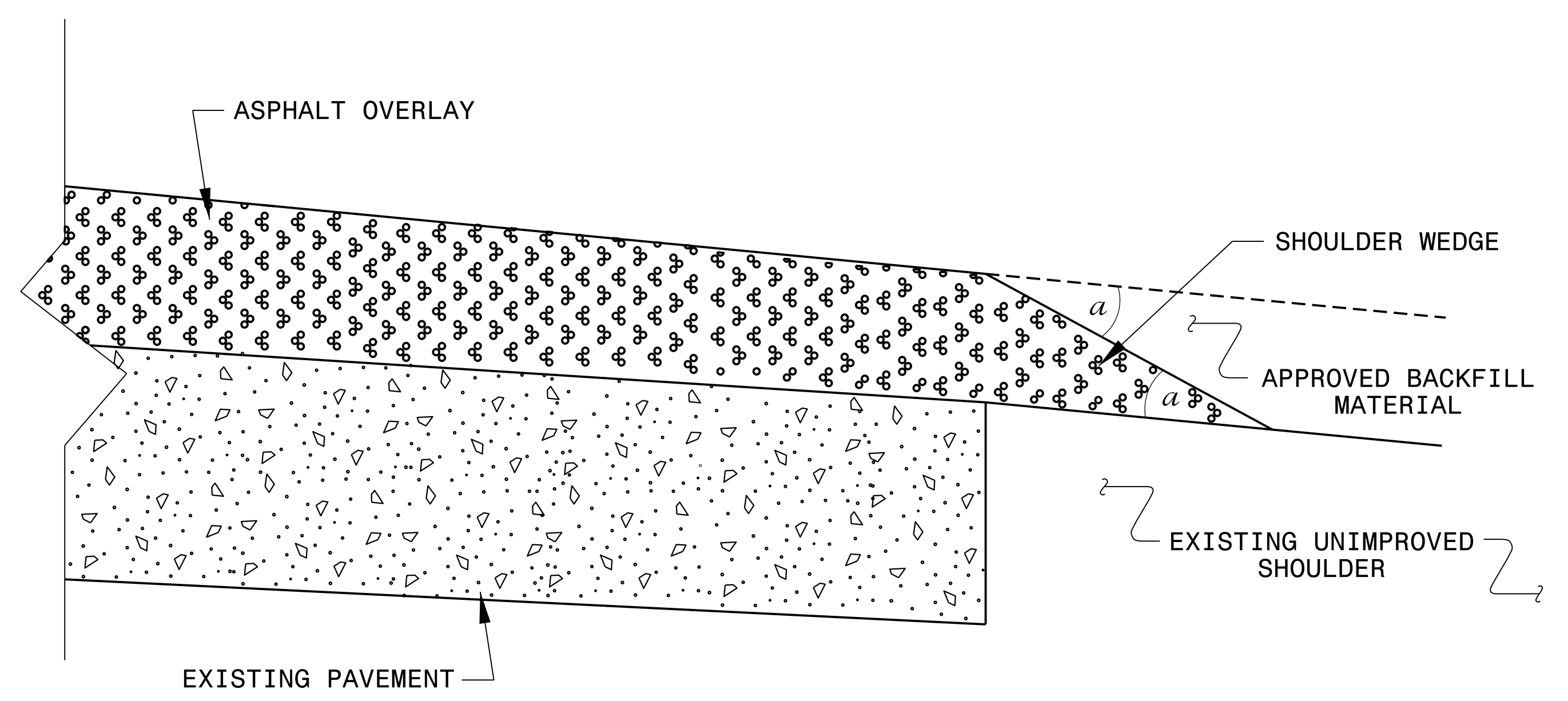

SHOULDER WEDGE DETAIL
 (Resurfacing Projects w/ NO Widening)

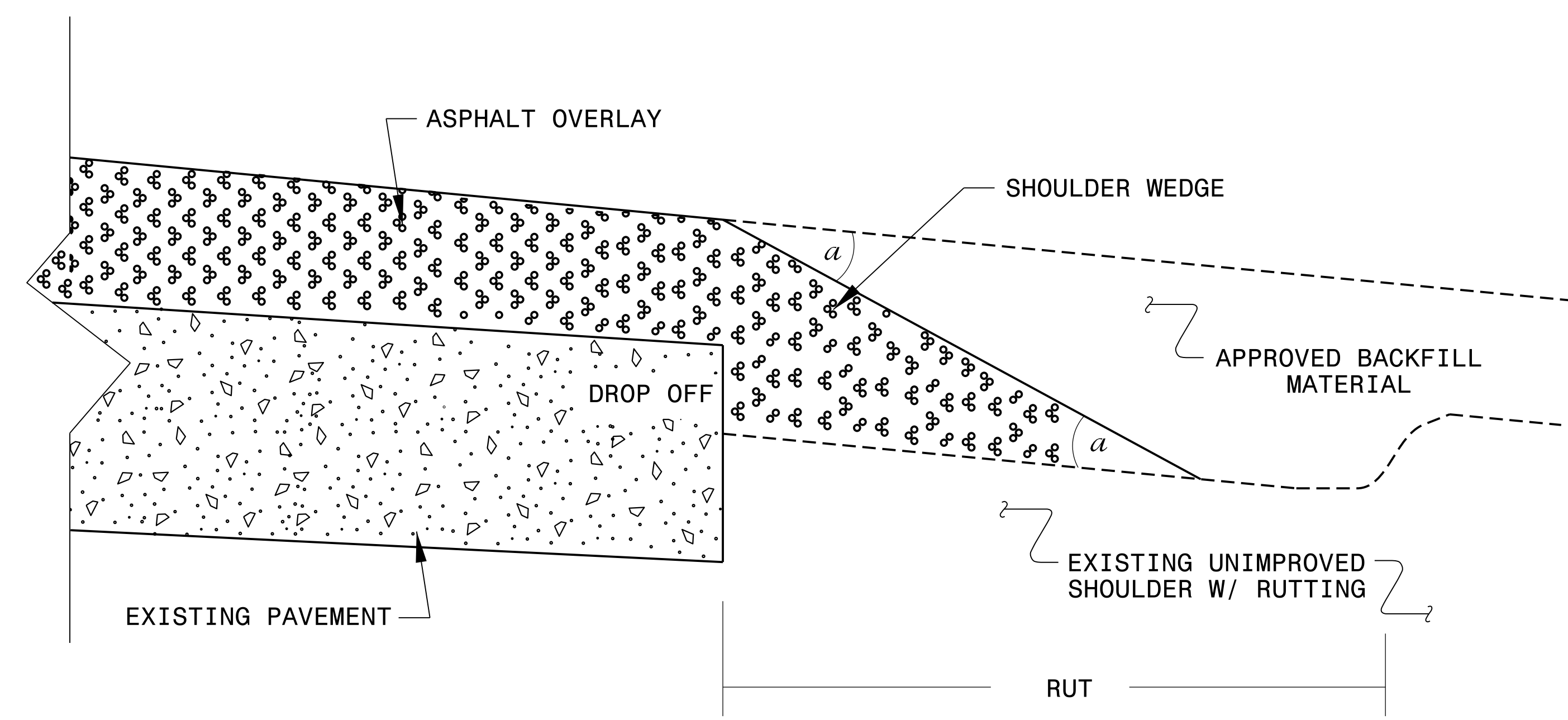

SHOULDER WEDGE DETAIL
 (Resurfacing Adjacent to Rutted Shoulder)

- SHOULDER WEDGE ANGLE = 30°



CONTRACT STANDARDS AND DEVELOPMENT UNIT	
Office 919-707-6950 FAX 919-250-4119	
SHOULDER WEDGE DETAILS	
ORIGINAL BY: T. SPELL	DATE: 7-19-11
MODIFIED BY:	DATE: 2/2/16
CHECKED BY:	DATE:
FILE SPEC.: s:\usr\details\stand\shoulderwedgedetail.dgn	

DOCUMENT NOT CONSIDERED FINAL UNLESS ALL SIGNATURES COMPLETED

I2-SEP-2018 10:10 S:\Contracts\Projects\Resurfacing Projects\Shoulder Wedge Details\Revised Shoulder Wedge Detail.dgn J:\over-ton AT_CSD-232595

PROJECT NO.	SHEET NO.	TOTAL NO.
2020CPT.13.03.10571	7	14
2020CPT.13.03.20571		

SUMMARY OF QUANTITIES

PROJECT NO	COUNTY	MAP NO	ROUTE	DESCRIPTION	TYP NO	LANES	LANE TYPE	FINAL SURFACE TESTING REQUIRED	WARM MIX ASPHALT REQUIRED	LENGTH	WIDTH	1220000000-E	1245000000-E	1260000000-E	1297000000-E	1308000000-E	1330000000-E	1491000000-E	1519000000-E	1523000000-E	1575000000-E	1704000000-E	1803500000-E	1820000000-E	1838000000-E	1838500000-N		
												INCIDENTAL STONE BASE	SHOULDER RECONSTRUCTION	AGGREGATE SHOULDER BORROW	MILLING ASPHALT PAVEMENT, 1-1/2" DEPTH	MILLING ASPHALT PAVEMENT, 0" TO 11/2" DEPTH	INCIDENTAL MILLING	ASPHALT CONC BASE COURSE, TYPE B25.0C	ASPHALT CONC SURFACE COURSE, TYPE S9.5B	ASPHALT CONC SURFACE COURSE, TYPE S9.5C	ASPHALT BINDER FOR PLANT MIX	PATCHING EXISTING PAVEMENT	ASPHALT SURFACE TREATMENT, DOUBLE SEAL	ASPHALT SURFACE TREATMENT, FOG SEAL	EMULSION FOR ASPHALT SURFACE TREATMENT	VACUUM TRUCK		
												MI	FT	TON	SMI	TON	SY	SY	SY	TON	TON	TON	TON	TON	SY	SY	GAL	WK
2020CPT.13.03.10571	Madison	1	US 19	FROM I-26 INTERCHANGE TO S. INT OF SR 1511 (BETHEL CIRCLE RD) (MP 3.69-8.02)	1,2	2	MD	NO	NO	4.33	70	217	8.66	1,083		51,100	5,000			16,460	988	1,000						
TOTAL FOR PROJ NO. 2020CPT.13.03.10571												4.33		217	8.66	1,083		51,100	5,000			16,460	988	1,000				
2020CPT.13.03.20571	Madison	2	SR 1506	FROM US 23 TO EOP (MP 0.0 TO MP 1.84)	3	2	2WU	NO	NO	1.84	18											700	19,430	19,430	10,687			
2020CPT.13.03.20571	Madison	3	SR 1506	FROM SR 1503 (LAUREL VALLEY) TO EOP (MP 2.23 TO MP 2.48)	3	2	2WU	NO	NO	0.25	18											250	2,640	2,640	1,452			
2020CPT.13.03.20571	Madison	4	SR 1443	FROM SR 1332 (CULVIN CREEK) TO EOP (MP 0.0 TO MP 0.44)	3	2	2WU	NO	NO	0.44	18											100	4,646	4,646	2,556			
2020CPT.13.03.20571	Madison	5	SR 1333	FROM SR 1332 (CULVIN CREEK) TO EOP (MP 0.0 TO MP 1.25)	3	2	2WU	NO	NO	1.25	18											175	13,200	13,200	7,260			
2020CPT.13.03.20571	Madison	6	SR 1332	FROM SR 1330 (SPILLCORN) TO EOP (MP 0.0 TO MP 2.62)	3	2	2WU	NO	NO	2.62	18											250	27,667	27,667	15,217			
2020CPT.13.03.20571	Madison	7	SR 1331	FROM SR 1330 (SPILLCORN) TO EOP (MP 0.0 TO MP 0.65)	3	2	2WU	NO	NO	0.65	18											150	6,864	6,864	3,775			
2020CPT.13.03.20571	Madison	8	SR 1203	FROM SR 1136 (DRY BRANCH) TO EOP (MP 0.0 TO MP 0.86)	3	2	2WU	NO	NO	0.86	17											125	8,577	8,577	4,717			
2020CPT.13.03.20571	Madison	9	SR 1136	FROM SR 1203 (REDMOND RD.) TO MP 2.1 (MP 1.55 TO MP 2.1)	3	2	2WU	NO	NO	0.55	17											100	5,485	5,485	3,017			
2020CPT.13.03.20571	Madison	10	SR 1582	FROM US 25/70 TO US 25/70 (MP 0.0 TO MP 2.58)	4,5	2	2WU	NO	NO	2.58	20	129	5.16	671			367	2,764		201	800							
2020CPT.13.03.20571	Madison	11	SR 1135	FROM SR 1125 (ROBERTS BRANCH) TO SR 1128 (SECLUDED VALLEY) (MP 3.82 - MP 6.7)	4	2	2WU	NO	NO	2.88	21	144	5.76	749				3,239		217	800							
2020CPT.13.03.20571	Madison	12	SR 1316	FROM SR 1318 (BIG LAUREL RD.) TO NC 212 (MP 0.0 TO MP 3.04)	4	2	2WU	NO	NO	3.04	18	152	6.08	790	470		376	2,934		197	700							
2020CPT.13.03.20571	Madison	13	SR 1114	FROM SR 1124 (DRY POND) TO SR 1135 (LITTLE PINE) (MP 3.22 TO 4.75)	4	2	2WU	NO	NO	1.53	18	77	3.06	398				1,476		99	350							
2020CPT.13.03.20571	Madison	14	SR 1113	FROM BCL TO EOP (MP 0.0 TO 0.4)	3	2	2WU	NO	NO	0.4	18										400	4,224	4,224	2,323				
2020CPT.13.03.20571	Madison	15	SR 1113	FROM SR 1001 TO EOP (MP 1.33 TO 2.61)	3	2	2WU	NO	NO	1.28	18										350	13,516	13,516	7,434				
TOTAL FOR PROJ NO. 2020CPT.13.03.20571												20.17		502	20.06	2608	470		376	367	10413		714	5250	106249	106249	58438	5
GRAND TOTAL												24.5		719	28.72	3,691	470		5,376	367	10,413	16,460	1,702	6,250	106,249	106,249	58,438	5

PROJECT NO.	SHEET NO.	TOTAL NO.
2020CPT.13.03.10571 2020CPT.13.03.20571	8	14

THERMOPLASTIC AND PAINT QUANTITIES

PROJECT NO	COUNTY	MAP NO	ROUTE	DESCRIPTION	TYP NO	LANES	LANE TYPE	LENGTH	WIDTH	441300000-E	445700000-N	469500000-E	471000000-E	472100000-E		472500000-E				481000000-E		484701000-E		490500000-N		
										WORK ZONE ADVANCE/GENERAL WARNING SIGNING	TEMPORARY TRAFFIC CONTROL	THERMOPLASTIC PAVEMENT MARKING LINES (8", 90 MILS) YELLOW	THERMOPLASTIC PAVEMENT MARKING LINES (24", 120 MILS) WHITE	THERMOPLASTIC MSG AHEAD 120 M	THERMOPLASTIC PAVEMENT MARKING CHARACTER (120 MILS) ONLY	THERMOPLASTIC PAVEMENT MARKING SYMBOL (90 MILS) LT ARROW	THERMOPLASTIC PAVEMENT MARKING SYMBOL (90 MILS) RT ARROW	THERMOPLASTIC PAVEMENT MARKING SYMBOL (90 MILS) STR & RT ARROW	THERMOPLASTIC PAVEMENT MARKING SYMBOL (90 MILS) STR ARROW	PAINT PAVEMENT MARKING LINES (4") WHITE	PAINT PAVEMENT MARKING LINES (4") YELLOW	POLYUREA PAVEMENT MARKING LINES WHITE (4", 20 MILS) (HIGHLY REFLECTIVE MEDIA)	POLYUREA PAVEMENT MARKING LINES YELLOW (4", 20 MILS) (HIGHLY REFLECTIVE MEDIA)	SNOWPLOWABLE PAVEMENT MARKERS		
MI	FT	SF	LS	LF	LF	EA	EA	EA	EA	EA	EA	EA	EA	EA	EA	EA	EA	EA	EA	EA	EA	EA	EA	EA		
2020CPT.13.03.10571	Madison	1	US 19	FROM I-26 INTERCHANGE TO S. INT OF SR 1511 (BETHEL CIRCLE RD) (MP 3.69-8.02)	1,2	2	MD	4.33	70	32	*	75	470	16	16	64	7	34	68			65,500	2,049	1,215		
TOTAL FOR PROJ NO. 2020CPT.13.03.10571										32	*	75	470	16	16	64	7	34	68			65,500	2,049	1,215		
														32			173					67,549				
2020CPT.13.03.20571	Madison	2	SR 1506	FROM US 23 TO EOP (MP 0.0 TO MP 1.84)	3	2	2WU	1.84	18	2,265	*															
2020CPT.13.03.20571	Madison	3	SR 1506	FROM SR 1503 (LAUREL VALLEY) TO EOP (MP 2.23 TO MP 2.48)	3	2	2WU	0.25	18															38,861	38,861	
2020CPT.13.03.20571	Madison	4	SR 1443	FROM SR 1332 (CULVIN CREEK) TO EOP (MP 0.0 TO MP 0.44)	3	2	2WU	0.44	18															5,280	5,280	
2020CPT.13.03.20571	Madison	5	SR 1333	FROM SR 1332 (CULVIN CREEK) TO EOP (MP 0.0 TO MP 1.25)	3	2	2WU	1.25	18															26,400	26,400	
2020CPT.13.03.20571	Madison	6	SR 1332	FROM SR 1330 (SPILLCORN) TO EOP (MP 0.0 TO MP 2.62)	3	2	2WU	2.62	18															55,334	55,334	
2020CPT.13.03.20571	Madison	7	SR 1331	FROM SR 1330 (SPILLCORN) TO EOP (MP 0.0 TO MP 0.65)	3	2	2WU	0.65	18																	
2020CPT.13.03.20571	Madison	8	SR 1203	FROM SR 1136 (DRY BRANCH) TO EOP (MP 0.0 TO MP 0.86)	3	2	2WU	0.86	17																	
2020CPT.13.03.20571	Madison	9	SR 1136	FROM SR 1203 (REDMOND RD.) TO MP 2.1 (MP 1.55 TO MP 2.1)	3	2	2WU	0.55	17															11,616	11,616	
2020CPT.13.03.20571	Madison	10	SR 1582	FROM US 25/70 TO US 25/70 (MP 0.0 TO MP 2.58)	4,5	2	2WU	2.58	20															54,490	54,490	
2020CPT.13.03.20571	Madison	11	SR 1135	FROM SR 1125 (ROBERTS BRANCH) TO SR 1128 (SECLUDED VALLEY) (MP 3.82 - MP 6.7)	4	2	2WU	2.88	21															60,826	60,826	
2020CPT.13.03.20571	Madison	12	SR 1316	FROM SR 1318 (BIG LAUREL RD.) TO NC 212 (MP 0.0 TO MP 3.04)	4	2	2WU	3.04	18															64,205	64,205	
2020CPT.13.03.20571	Madison	13	SR 1114	FROM SR 1124 (DRY POND) TO SR 1135 (LITTLE PINE) (MP 3.22 TO 4.75)	4	2	2WU	1.53	18															32,314	32,314	
2020CPT.13.03.20571	Madison	15	SR 1113	FROM BCL TO EOP (MP 0.0 TO 0.4)	3	2	2WU	0.4	18															8,448	8,448	
2020CPT.13.03.20571	Madison	16	SR 1113	FROM SR 1001 TO EOP (MP 1.33 TO 2.61)	3	2	2WU	1.28	18															27,034	27,034	
TOTAL FOR PROJ NO. 2020CPT.13.03.20571												2265	*											384,808	384,808	
																								769,616		
GRAND TOTAL										2,297	1.00	75	470	16	16	64	7	34	68	384,808	384,808	65,500	2,049	1,215		
														32			173				769,616		67,549			

SIGNING FOR RESURFACING PROJECTS

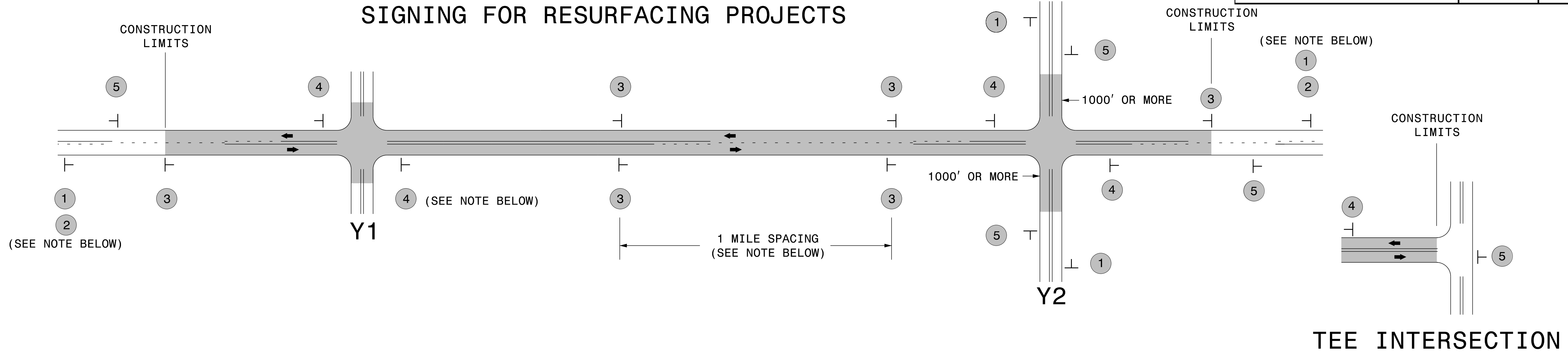

LEGEND	
—	STATIONARY SIGN
←	DIRECTION OF TRAFFIC FLOW

MAINLINE (-L-) SIGNING

-Y- LINE SIGNING

SIGNING NOTES AND PLACEMENT PER DIRECTION	1	 <small>W20-1 48" X 48"</small>	PLACE 1000' PRIOR TO BEGINNING OF CONSTRUCTION LIMITS. ONLY USED ON -Y- LINES IF RESURFACING LIMITS EXTEND 1000' ALONG -Y- LINE. #2 SIGN ONLY USED WHEN RESURFACING LIMITS ARE 2 OR MORE MILES IN LENGTH. ROUND UP TO NEXT WHOLE NUMBER. (NO FRACTIONAL OR DECIMAL NUMBERS)	<p style="text-align: center;">NO REQUIRED STATIONARY SIGNING FOR THE FOLLOWING -Y- LINE CONDITIONS:</p> <ol style="list-style-type: none"> 1) LESS THAN 1000' OF RESURFACING ALONG -Y- LINE 2) SUBDIVISION ROADS 3) DEAD END ROADS <p>WHEN PAVING/CONSTRUCTION ACTIVITIES PROCEED ACROSS AN UNSIGNED -Y- LINE, ADVANCE WARNING PORTABLE SIGNS SHALL BE USED ALONG THE -Y- LINE AS SHOWN BELOW. REMOVE UPON COMPLETION OF WORK.</p> <div style="display: flex; justify-content: space-around;"> <div style="text-align: center;"> <small>W20-1 48" X 48"</small> </div> <div style="text-align: center;"> <small>W20-7 A 48" X 48"</small> </div> </div> <p style="text-align: center;">PLACED 500' IN ADVANCE OF FLAGGER. PLACED 250' IN ADVANCE OF FLAGGER.</p>
	2	 <small>W7-3aP 24" X 18"</small>		
	3	 <small>SP 13107 48" X 48"</small>	<ul style="list-style-type: none"> - PLACE INITIALLY AT THE CONSTRUCTION LIMITS AND SPACE 1 MILE APART THEREAFTER. - AT TEE INTERSECTIONS INSTALL INITIALLY 0.5 MILE FROM INTERSECTION AND SPACE 1 MILE APART THEREAFTER. 	
	4	 <small>SP 13106 48" X 48"</small>	<ul style="list-style-type: none"> - THESE ARE FOR -Y- LINES THAT ARE "THROUGH" ROADWAYS. - DEAD END AND SUBDIVISION ROADS ARE NOT "THROUGH" ROADWAYS. - INSTALL 500' +/- FROM EACH -Y- LINE APPROACH AS SHOWN ABOVE. - FOR MULTIPLE -Y- LINES THAT ARE SEPARATED BY 0.25 MILES OR LESS, TREAT AS A SINGLE UNIT AND INSTALL WITHIN 500' OF EACH APPROACH. - A MAXIMUM OF 2 SIGN SETS PER MILE. DO NOT INSTALL WHEN -Y- LINES ARE WITHIN 0.5 MILES FROM "END ROAD WORK" SIGN. - FOR TEE INTERSECTIONS, INSTALL WITHIN 500' +/- OF THE INTERSECTION ALONG -L- LINE. 	
	5	 <small>G20-2 A 48" X 24"</small>	PLACE 500' FOLLOWING THE END OF CONSTRUCTION LIMITS OR AS SHOWN WHEN WORK ENDS AT A 3-WAY TEE INTERSECTION.	

**RESURFACING
ADVANCE WARNING SIGNS
FOR
RURAL AND SUBURBAN
2 LANE ROADWAYS**

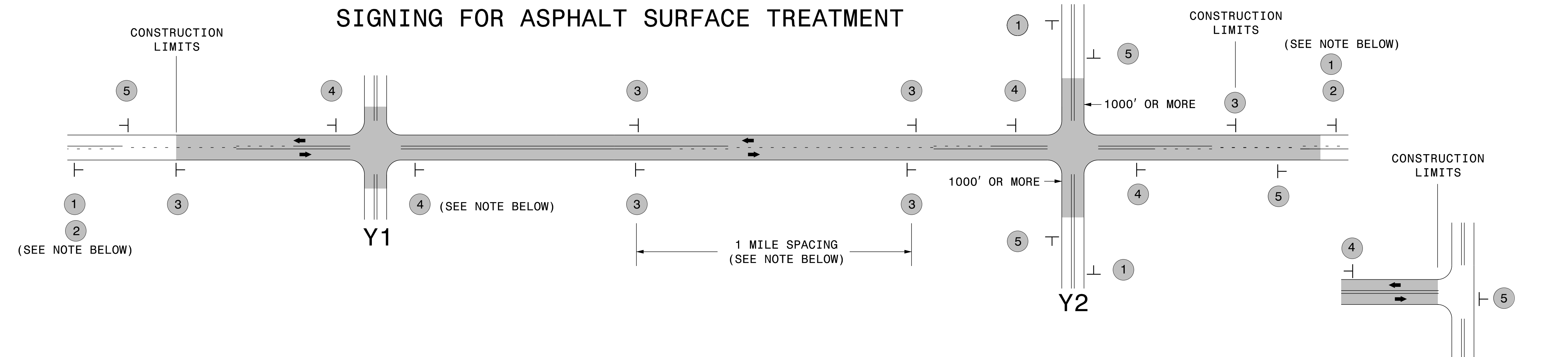

LEGEND

┆ STATIONARY SIGN

← DIRECTION OF TRAFFIC FLOW

MAINLINE (-L-) SIGNING

-Y- LINE SIGNING

SIGNING NOTES AND PLACEMENT PER DIRECTION	1		PLACE 1000' PRIOR TO BEGINNING OF CONSTRUCTION LIMITS. ONLY USED ON -Y- LINES IF RESURFACING LIMITS EXTEND 1000' ALONG -Y- LINE.
	2		#2 SIGN ONLY USED WHEN RESURFACING LIMITS ARE 2 OR MORE MILES IN LENGTH. ROUND UP TO NEXT WHOLE NUMBER. (NO FRACTIONAL OR DECIMAL NUMBERS)
	3	 	<ul style="list-style-type: none"> - ALTERNATE THE FOLLOWING TWO SIGNS: - STARTING WITH "LOOSE GRAVEL" (W8-7) FOLLOWED BY "UNMARKED PAVEMENT". - PLACE INITIALLY AT THE CONSTRUCTION LIMITS AND SPACED 1 MILE APART THEREAFTER. - AT TEE INTERSECTIONS INSTALL INITIALLY 0.5 MILE FROM INTERSECTION AND SPACE 1 MILE APART THEREAFTER.
	4		<ul style="list-style-type: none"> - THESE ARE FOR -Y- LINES THAT ARE "THROUGH" ROADWAYS. - DEAD END AND SUBDIVISION ROADS ARE NOT "THROUGH" ROADWAYS. - INSTALL 500' +/- FROM EACH -Y- LINE APPROACH AS SHOWN ABOVE. - FOR MULTIPLE -Y- LINES THAT ARE SEPARATED BY 0.25 MILES OR LESS, TREAT AS A SINGLE UNIT AND INSTALL WITHIN 500' OF EACH APPROACH. - A MAXIMUM OF 2 SIGN SETS PER MILE. DO NOT INSTALL WHEN -Y- LINES ARE WITHIN 0.5 MILES FROM "END ROAD WORK" SIGN. - FOR TEE INTERSECTIONS, INSTALL WITHIN 500' +/- OF THE INTERSECTION ALONG -L- LINE.
	5		PLACE 500' FOLLOWING THE END OF CONSTRUCTION LIMITS OR AS SHOWN WHEN WORK ENDS AT A 3-WAY TEE INTERSECTION.

NO REQUIRED STATIONARY SIGNING FOR THE FOLLOWING -Y- LINE CONDITIONS:

- 1) LESS THAN 1000' OF RESURFACING ALONG -Y- LINE
- 2) SUBDIVISION ROADS
- 3) DEAD END ROADS

WHEN PAVING/CONSTRUCTION ACTIVITIES PROCEED ACROSS AN UNSIGNED -Y- LINE, ADVANCE WARNING PORTABLE SIGNS SHALL BE USED ALONG THE -Y- LINE AS SHOWN BELOW. REMOVE UPON COMPLETION OF WORK.

W20-1
48" X 48"

W20-7 A
48" X 48"

PLACED 500' IN ADVANCE OF FLAGGER. PLACED 250' IN ADVANCE OF FLAGGER.

**ADVANCE WARNING SIGNS
FOR
ASPHALT SURFACE TREATMENTS
2 LANE ROADWAYS**

4/20/2016 C:\Users\rmgarrrett\Downloads\Resurfacing_AdvWarn_2Ln - AST.dgn User:rmgarrrett

PROJECT NO.	SHEET NO.	TOTAL NO.
2020CPT.13.03.10571, 2020CPT.13.03.20571	11	14

URBAN / SUBURBAN WORKZONES

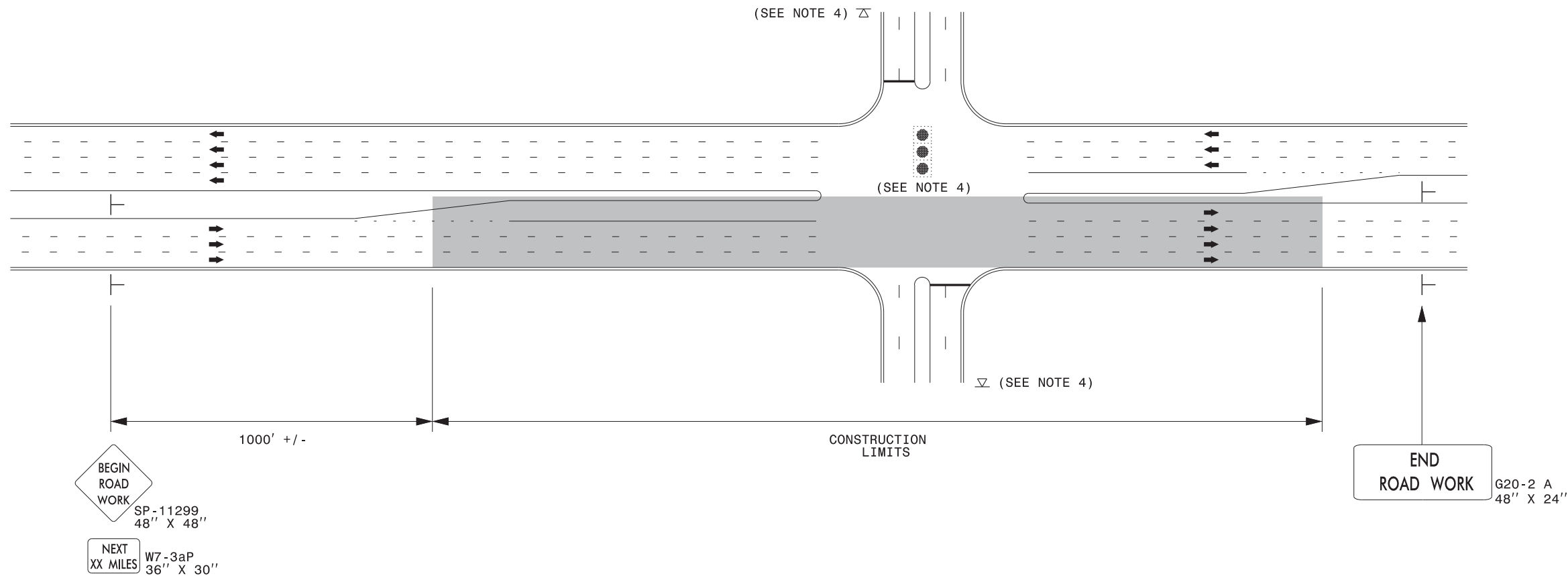

NOTES:

- 1) 48" x 48" SIZED SIGNS (SP- 11299) MAY BE REDUCED TO 36" X 36" ON ROADWAYS WITH SPEED LIMITS OF 40 MPH OR LESS.
- 2) MOUNT SIGNS THAT ARE LARGER THAN 10 SQUARE FEET IN AREA ON TWO OR MORE WOOD OR U-CHANNEL SUPPORTS. PERFORATED SQUARE TUBING SUPPORT SYSTEMS MAY SUPPORT LARGER AREAS ON A SINGLE SUPPORT. FOLLOW MANUFACTURER'S RECOMMENDATIONS. THESE SYSTEMS SHALL BE NCHRP 350 COMPLIANT AND NCDOT APPROVED.
- 3) ADVANCE WARNING SIGNS NOT REQUIRED ON NON-SIGNALIZED SIDE STREETS.
- 4) MAY USE LAW ENFORCEMENT TO CONTROL TRAFFIC AT SIGNALIZED INTERSECTIONS AS DIRECTED BY THE ENGINEER. PROVIDE PORTABLE "ROAD WORK AHEAD" (W20-1) SIGNS 500' IN ADVANCE ALONG BOTH APPROACHES FROM THE SIDE STREETS WHEN PAVING PROCEEDS THROUGH THE INTERSECTION.
- 5) LATERAL CLEARANCE AT ALL SIGN LOCATIONS SHALL BE 2' AS MEASURED FROM THE EDGE OF PAVEMENT OR THE FACE OF THE CURB. WHEN UNABLE TO OBTAIN THE LATERAL CLEARANCE WITHIN THE MEDIAN AREA USE SHOULDER MOUNTS ONLY.
- 6) SIGN MOUNT LOCATIONS SHALL NOT BLOCK SIDEWALKS OR DRIVEWAYS.
- 7) IF STATIONARY GENERAL WARNING SIGNS ARE USED, THEY WILL BE PAID FOR PER SECTION 104 OF THE NCDOT STANDARD SPECIFICATIONS AS EXTRA WORK.
- 8) IF MILLED AREAS ARE NOT PAVED BACK BY THE END OF THE WORK DAY, PORTABLE SIGNS SHALL BE USED TO WARN DRIVERS OF THE PRESENT CONDITIONS. THESE ARE TO INCLUDE, BUT NOT LIMITED TO "ROUGH ROAD" W8-8, "UNEVEN LANES" W8-11, "GROOVED PAVEMENT" W8-15 w/MOTORCYCLE PLAQUE MOUNTED BELOW. THESE ARE TO BE DOUBLE INDICATED ON MULTI-LANE ROADWAYS WITH SPEED LIMITS 45 MPH AND GREATER WHERE LATERAL CLEARANCE CAN BE OBTAINED WITHIN THE MEDIAN AREAS. THESE PORTABLE SIGNS ARE INCIDENTAL TO THE OTHER ITEMS OF WORK INCLUDED IN THE TEMPORARY TRAFFIC CONTROL (LUMP SUM) PAY ITEM.

LEGEND	
┆	STATIONARY SIGN
➔	DIRECTION OF TRAFFIC FLOW



**RESURFACING ADVANCE
WARNING SIGNS FOR
URBAN / SUBURBAN
FACILITIES**

SIGN NUMBER: 11299
 TYPE: B
 QUANTITY: SEE PLANS

BACKG COLOR: Fluorescent Orange
 COPY COLOR: Black

DESIGN BY: WJ
 PROJECT ID: ALL

CHECKED BY:
 DIV: ALL

DATE: Jun 22, 2011

SIGN WIDTH: 5'-6"
 HEIGHT: 5'-6"
 TOTAL AREA: 30.5 Sq.Ft.

BORDER TYPE: INSET
 RECESS: 0.59"
 WIDTH: 0.75"
 RADII: 1.38"

NO. Z BARS: N/A
 LENGTH: N/A

SYMBOL	X	Y	WID	HT

MAT'L: 0.125" (3.2 mm) ALUMINUM

SP 11299

PROJECT NO.	SHEET NO.	TOTAL NO.
2020CPT.13.03.10571, 2020CPT.13.03.20571	12	14

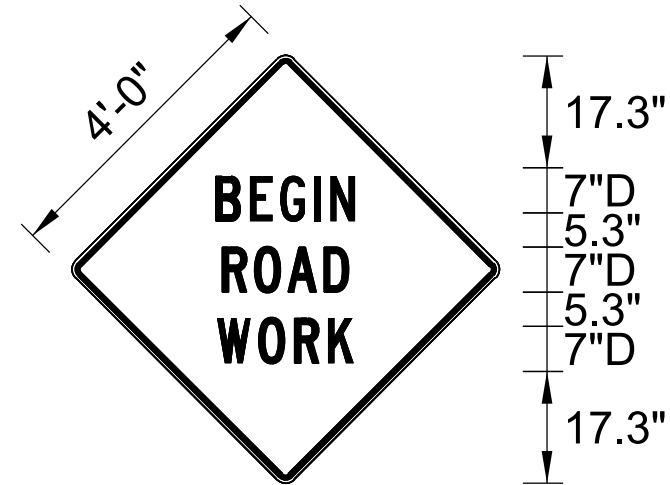

BORDER
 R=1.38"
 TH=0.75"
 IN=0.59"

Spacing Factor is 1 unless specified otherwise

USE NOTES: 1,2

- Legend and border shall be direct applied black non-reflective sheeting.
- Background shall be Type VII, VIII, or IX (prismatic) fluorescent orange retroreflective sheeting.

LETTER POSITIONS

Letter spacings are to start of next letter																	Series/Size	
																	Text Length	
		B	E	G	I	N												D 2000
20.5	6	5.4	6.3	2.8	4.8	20.5												25.2
		R	O	A	D													D 2000
21.4	5.8	5.9	7	4.8	21.4													23.5
		W	O	R	K													D 2000
20.9	7.1	6.5	5.9	4.9	20.9													24.5

SIGN NUMBER: SP13106
 TYPE: STATIONARY
 QUANTITY: SEE PLANS

BACKG COLOR: Fluorescent Orange
 COPY COLOR: Black

DESIGN BY: B. RASHID
 PROJECT ID:

CHECKED BY: AIA
 DIV:

DATE: Apr 26, 2013

SYMBOL	X	Y	WID	HT

SIGN WIDTH: 4'-0"
 HEIGHT: 4'-0"
 TOTAL AREA: 16.00 Sq.Ft.

BORDER TYPE: INSET
 RECESS: 0.75"
 WIDTH: 1.25"
 RADII: 3"

NO. Z BARS:
 LENGTH:

MAT'L: 0.080" (2.0 mm) ALUMINUM

USE NOTES: 1,2

- Legend and border shall be direct applied black non-reflective sheeting.
- Background shall be NC GRADE B fluorescent orange retroreflective sheeting.

PROJECT NO.	SHEET NO.	TOTAL NO.
2020CPT.13.03.10571, 2020CPT.13.03.20571	13	14

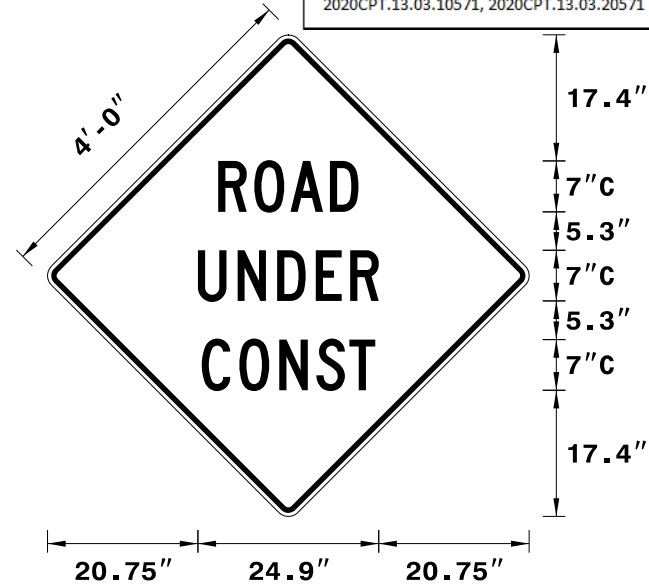

Spacing Factor is 1 unless specified otherwise

LETTER POSITIONS

Letter spacings are to start of next letter

Letter spacings are to start of next letter																	Series/Size Text Length	
		R	O	A	D													C 2000
	23.5	5	5	5.5	3.9	23.5												19.3
		U	N	D	E	R												C 2000
	20.7	5.5	5.5	5.3	4.8	3.9	20.7											24.9
		C	O	N	S	T												C 2000
	21.2	5.2	5.5	5.1	4.6	3.6	21.2											23.9

