

See Sheet 1-A For Index of Sheets

STATE OF NORTH CAROLINA
DIVISION OF HIGHWAYS

U.S. 74 EXIT 103 RAMP EXTENSION

LOCATION: U.S. 74 WESTBOUND AT EXIT 103
HAYWOOD COUNTY

TYPE OF WORK: PAVING, GRADING, DRAINAGE, GUARDRAIL, PAVEMENT MARKING

STATE	STATE PROJECT REFERENCE NO.	SHEET NO.	TOTAL SHEETS
N.C.	SS-4914AA	1	19
STATE PROJ. NO.	F.A. PROJ. NO.	DESCRIPTION	
42777.3.1		CONSTRUCTION	

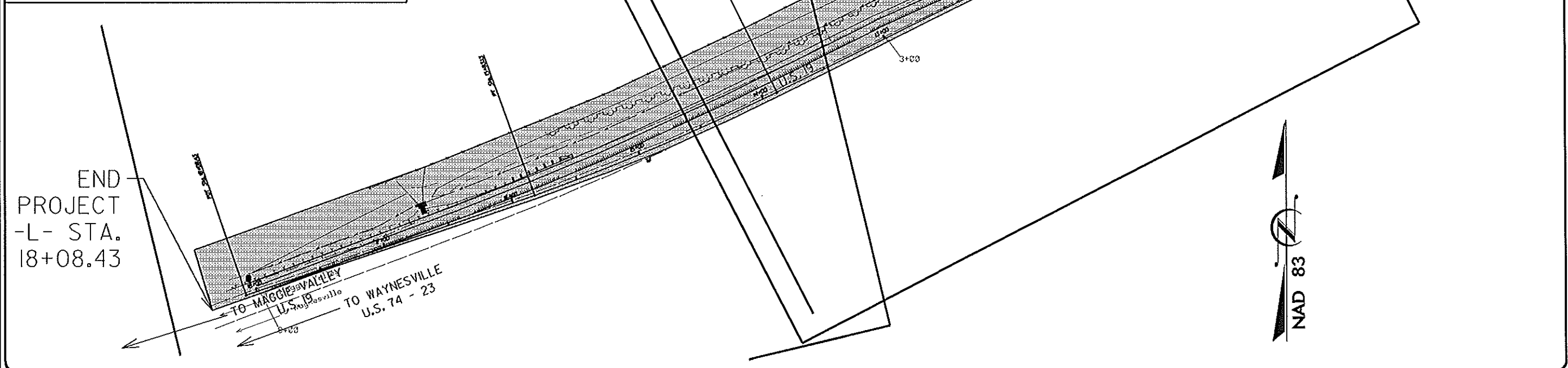
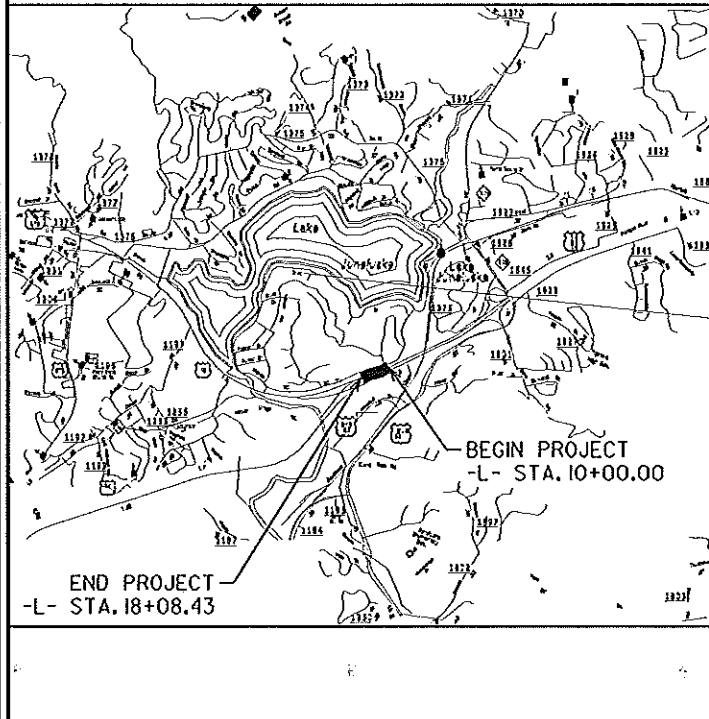

TIP PROJECT: SS-4914AA

CONTRACT: DN00220

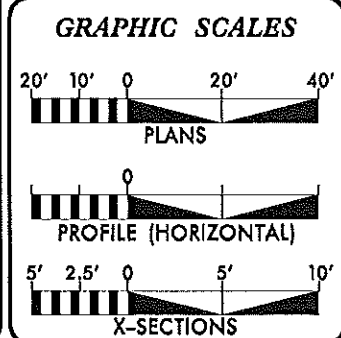

DESIGN DATA

PROJECT LENGTH

Prepared in the Office of:
DIVISION OF HIGHWAYS
176 Henry Bird Road, Whitler, NC 28789

2012 STANDARD SPECIFICATIONS

RIGHT OF WAY DATE: Jonathan L. Woodard, P.E.
PROJECT ENGINEER

LETTING DATE: Jeffrey E. Alsbaugh, E.I.
PROJECT DESIGN ENGINEER
March 12, 2013

HYDRAULICS ENGINEER

SIGNATURE: _____ P.E.

ROADWAY DESIGN ENGINEER

SIGNATURE: _____ P.E.

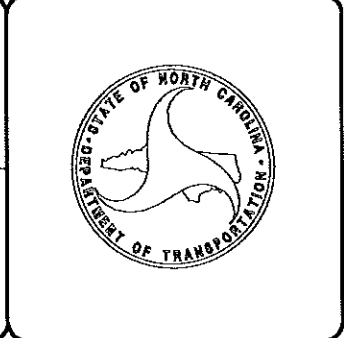

05-FEB-2013 08:58 C:\p\us74\Haywood County\Completed Projects\US 74-23 at Exit 103 Ramp Extension Project\DCN\General Plan Sheets\SS4914AA_Rdy_tsn_01.dgn \$\$\$USERNAME\$\$\$

8/17/99
 I:\SEP-2012 08:46
 C:\Users\p.doggett\OneDrive\Documents\SS4914AA_Rdy_psh_Notes_01A.dgn
 Project\SS4914AA_Rdy_psh_Notes_01A.dgn

PROJECT REFERENCE NO. SS-4914AA	SHEET NO. 1-A
ROADWAY DESIGN ENGINEER	

SHEET NUMBER	INDEX OF SHEETS
SHEET	SHEET
1	TITLE SHEET
1-A	INDEX OF SHEETS, GENERAL NOTES, AND LIST OF STANDARD DRAWINGS
1-B	CONVENTIONAL SYMBOLS
2	PAVEMENT SCHEDULE, TYPICAL SECTIONS
3	SUMMARY OF QUANTITIES
3A	SUMMARY OF DRAINAGE QUANTITIES
	SUMMARY OF GUARDRAIL, EARTHWORK
	SUMMARY AND ASPHALT PAVEMENT
	REMOVAL SUMMARY
4 THRU 5	PLAN SHEET
	PROFILE SHEET
TCP-1 THRU TCP-3	TRAFFIC CONTROL PLANS
FM-1 THRU FM-2	PAVEMENT MARKING PLANS
L-1 THRU L	LANDSCAPE PLANS
RE-1 THRU RE	REFORESTATION PLANS
EC-1 THRU EC-2	EROSION CONTROL PLANS
SIGN-1 THRU SIGN	SIGNING PLANS
U-1 THRU U	UTILITIES PLANS
X-1 THRU X-5	CROSS-SECTIONS
S-1 THRU S	STRUCTURE PLANS

2012 SPECIFICATIONS
EFFECTIVE: 01-17-12
REVISED: 07/30/12

GENERAL NOTES:

GRADING AND SURFACING OR RESURFACING AND WIDENING:

THE GRADE LINES SHOWN DENOTE THE FINISHED ELEVATION OF THE PROPOSED SURFACING AT GRADE POINTS SHOWN ON THE TYPICAL SECTIONS. WHERE NO GRADE LINES ARE SHOWN, THE PROFILES SHOWN DENOTE THE TOP ELEVATION OF THE EXISTING PAVEMENT ALONG THE CENTER LINE OF SURVEY ON WHICH THE PROPOSED RESURFACING WILL BE PLACED. GRADE LINES MAY BE ADJUSTED BY THE ENGINEER IN ORDER TO SECURE A PROPER TIE-IN.

REMOVAL AND DISPOSAL OF THE FOLLOWING EXISTING ITEMS SHALL BE CONSIDERED INCIDENTAL TO LUMP SUM GRADING: TYPE A SIGN FOOTERS AND SUPPORT STEEL COLUMNS, CONCRETE END WALLS, CONCRETE DITCH LINING, PORTIONS OF CONCRETE FLUMES.

CLEARING:

CLEARING ON THIS PROJECT SHALL BE PERFORMED TO THE LIMITS ESTABLISHED BY METHOD II.

SHOULDER CONSTRUCTION:

ASPHALT, EARTH, AND CONCRETE SHOULDER CONSTRUCTION ON THE HIGH SIDE OF SUPERELEVATED CURVES SHALL BE IN ACCORDANCE WITH STD. NO. 560.01.

GUARDRAIL:

THE GUARDRAIL LOCATIONS SHOWN ON THE PLANS MAY BE ADJUSTED DURING CONSTRUCTION AS DIRECTED BY THE ENGINEER. THE CONTRACTOR SHOULD CONSULT WITH THE ENGINEER PRIOR TO ORDERING GUARDRAIL MATERIAL.

SUBSURFACE PLANS:

NO SUBSURFACE PLANS ARE AVAILABLE ON THIS PROJECT. THE CONTRACTOR SHOULD MAKE HIS OWN INVESTIGATION AS TO THE SUBSURFACE CONDITIONS.

2012 ROADWAY ENGLISH STANDARD DRAWINGS

The following Roadway Standards as appear in 'Roadway Standard Drawings' Highway Design Branch - N.C. Department of Transportation - Raleigh, N.C., Dated January, 2012 are applicable to this project and by reference hereby are considered a part of these plans:

STD. NO.	TITLE
DIVISION 2 -	EARTHWORK
200.02	Method of Clearing - Method II
225.01	Guide for Grading Subgrade - Interstate and Freeway
DIVISION 3 -	PIPE CULVERTS
300.01	Method of Pipe Installation
DIVISION 6 -	ASPHALT BASES AND PAVEMENTS
665.01	Asphalt Shoulders - Milled Rumble Strips
DIVISION 8 -	INCIDENTALS
838.05	Concrete 'L' Endwall for Single Pipe Culverts - 15' thru 48' Pipe
862.01	Guardrail Placement
862.02	Guardrail Installation

04/16/11

Note: Not to Scale
 *S.U.E. = Subsurface Utility Engineering

STATE OF NORTH CAROLINA
 DIVISION OF HIGHWAYS

CONVENTIONAL PLAN SHEET SYMBOLS

BOUNDARIES AND PROPERTY:

State Line	-----
County Line	-----
Township Line	-----
City Line	-----
Reservation Line	-----
Property Line	-----
Existing Iron Pin	○
Property Corner	-----
Property Monument	□
Parcel/Sequence Number	②③
Existing Fence Line	-----
Proposed Woven Wire Fence	-----
Proposed Chain Link Fence	-----
Proposed Barbed Wire Fence	-----
Existing Wetland Boundary	-----
Proposed Wetland Boundary	-----
Existing Endangered Animal Boundary	-----
Existing Endangered Plant Boundary	-----
Known Soil Contamination: Area or Site	☠ ☠
Potential Soil Contamination: Area or Site	☠ ☠

BUILDINGS AND OTHER CULTURE:

Gas Pump Vent or U/G Tank Cap	○
Sign	○
Well	○
Small Mine	✕
Foundation	□
Area Outline	□
Cemetery	□
Building	□
School	□
Church	□
Dam	□

HYDROLOGY:

Stream or Body of Water	-----
Hydro, Pool or Reservoir	□
Jurisdictional Stream	-----
Buffer Zone 1	-----
Buffer Zone 2	-----
Flow Arrow	-----
Disappearing Stream	-----
Spring	○
Wetland	-----
Proposed Lateral, Tail, Head Ditch	-----
False Sump	-----

RAILROADS:

Standard Gauge	-----
RR Signal Milepost	-----
Switch	-----
RR Abandoned	-----
RR Dismantled	-----

RIGHT OF WAY:

Baseline Control Point	◆
Existing Right of Way Marker	△
Existing Right of Way Line	-----
Proposed Right of Way Line	-----
Proposed Right of Way Line with Iron Pin and Cap Marker	-----
Proposed Right of Way Line with Concrete or Granite RW Marker	-----
Proposed Control of Access Line with Concrete CA Marker	-----
Existing Control of Access	-----
Proposed Control of Access	-----
Existing Easement Line	-----
Proposed Temporary Construction Easement	-----
Proposed Temporary Drainage Easement	-----
Proposed Permanent Drainage Easement	-----
Proposed Permanent Drainage / Utility Easement	-----
Proposed Permanent Utility Easement	-----
Proposed Temporary Utility Easement	-----
Proposed Aerial Utility Easement	-----
Proposed Permanent Easement with Iron Pin and Cap Marker	◆

ROADS AND RELATED FEATURES:

Existing Edge of Pavement	-----
Existing Curb	-----
Proposed Slope Stakes Cut	-----
Proposed Slope Stakes Fill	-----
Proposed Curb Ramp	-----
Existing Metal Guardrail	-----
Proposed Guardrail	-----
Existing Cable Guiderail	-----
Proposed Cable Guiderail	-----
Equality Symbol	-----
Pavement Removal	-----

VEGETATION:

Single Tree	○
Single Shrub	○
Hedge	-----
Woods Line	-----

Orchard	-----
Vineyard	-----

EXISTING STRUCTURES:

MAJOR:	
Bridge, Tunnel or Box Culvert	-----
Bridge Wing Wall, Head Wall and End Wall	-----
MINOR:	
Head and End Wall	-----
Pipe Culvert	-----
Footbridge	-----
Drainage Box: Catch Basin, DI or JB	-----
Paved Ditch Gutter	-----
Storm Sewer Manhole	-----
Storm Sewer	-----

UTILITIES:

POWER:	
Existing Power Pole	-----
Proposed Power Pole	-----
Existing Joint Use Pole	-----
Proposed Joint Use Pole	-----
Power Manhole	-----
Power Line Tower	-----
Power Transformer	-----
U/G Power Cable Hand Hole	-----
H-Frame Pole	-----
Recorded U/G Power Line	-----
Designated U/G Power Line (S.U.E.*)	-----

TELEPHONE:

Existing Telephone Pole	-----
Proposed Telephone Pole	-----
Telephone Manhole	-----
Telephone Booth	-----
Telephone Pedestal	-----
Telephone Cell Tower	-----
U/G Telephone Cable Hand Hole	-----
Recorded U/G Telephone Cable	-----
Designated U/G Telephone Cable (S.U.E.*)	-----
Recorded U/G Telephone Conduit	-----
Designated U/G Telephone Conduit (S.U.E.*)	-----
Recorded U/G Fiber Optics Cable	-----
Designated U/G Fiber Optics Cable (S.U.E.*)	-----

WATER:

Water Manhole	-----
Water Meter	-----
Water Valve	-----
Water Hydrant	-----
Recorded U/G Water Line	-----
Designated U/G Water Line (S.U.E.*)	-----
Above Ground Water Line	-----

TV:

TV Satellite Dish	-----
TV Pedestal	-----
TV Tower	-----
U/G TV Cable Hand Hole	-----
Recorded U/G TV Cable	-----
Designated U/G TV Cable (S.U.E.*)	-----
Recorded U/G Fiber Optic Cable	-----
Designated U/G Fiber Optic Cable (S.U.E.*)	-----

GAS:

Gas Valve	-----
Gas Meter	-----
Recorded U/G Gas Line	-----
Designated U/G Gas Line (S.U.E.*)	-----
Above Ground Gas Line	-----

SANITARY SEWER:

Sanitary Sewer Manhole	-----
Sanitary Sewer Cleanout	-----
U/G Sanitary Sewer Line	-----
Above Ground Sanitary Sewer	-----
Recorded SS Forced Main Line	-----
Designated SS Forced Main Line (S.U.E.*)	-----

MISCELLANEOUS:

Utility Pole	-----
Utility Pole with Base	-----
Utility Located Object	-----
Utility Traffic Signal Box	-----
Utility Unknown U/G Line	-----
U/G Tank; Water, Gas, Oil	-----
Underground Storage Tank, Approx. Loc.	-----
A/G Tank; Water, Gas, Oil	-----
Geoenvironmental Boring	-----
U/G Test Hole (S.U.E.*)	-----
Abandoned According to Utility Records	-----
End of Information	-----

PROJECT REFERENCE NO. SS-4914AA	SHEET NO. 2
ROADWAY DESIGN ENGINEER	PAVEMENT DESIGN ENGINEER

PAVEMENT SCHEDULE

(FINAL PAVEMENT DESIGN)

C	PROP. APPROX. 2" ASPHALT CONCRETE SURFACE COURSE, TYPE S9.5B, AT AN AVERAGE RATE OF 224 LBS. PER SQ. YD.
D	PROP. APPROX. 3" ASPHALT CONCRETE INTERMEDIATE COURSE, TYPE I19.0B, AT AN AVERAGE RATE OF 342 LBS. PER SQ. YD.
E	PROP. APPROX. 8" ASPHALT CONCRETE BASE COURSE, TYPE B25.0B, AT AN AVERAGE RATE OF 648 LBS. PER SQ. YD.
T	EARTH MATERIAL
U	EXISTING PAVEMENT

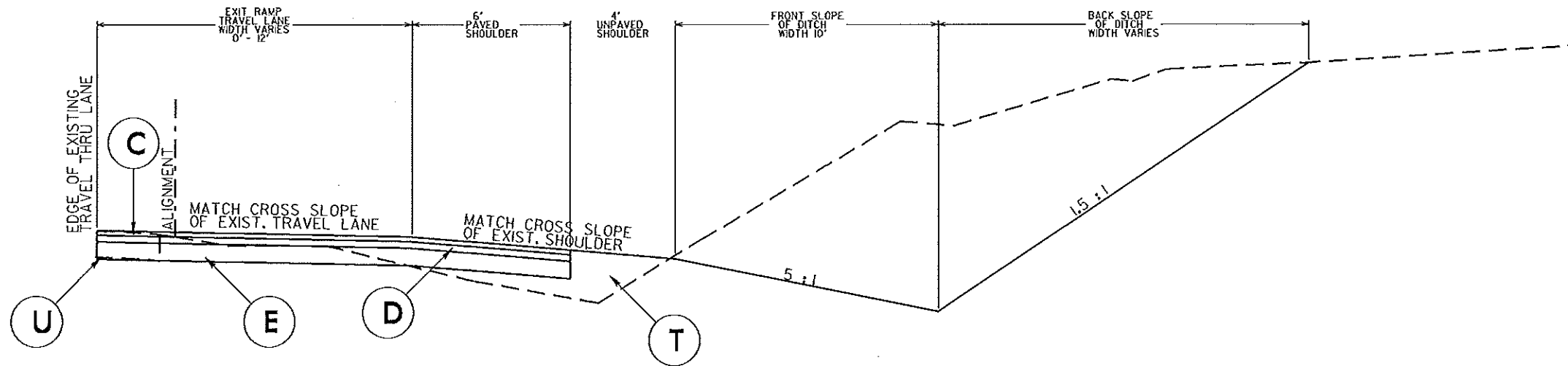

TYPICAL SECTION NO. 1

U.S. 74 - 23 AT EXIT 103 ALONG RAMP EXTENTION
 STA. 10+00.00 TO STA. 18+08.43
 NOT TO SCALE

6/2/99
 19-SEP-2002 15:21
 C:\Users\jerry\Documents\Wood County\US 74-23 at Exit 103 Ramp Extension Project\Drawings\General Plan Sheets\SS-4914AA_Rdy.txd_02.dgn

8/17/99
 REVISIONS
 15-SEP-2012 10:20
 C:\p\proj\hwy\wood County\US 74-23 at Exit 103 Ramp Extension Project\IGN\Roadway Plans\SS4914AA_Rdy_psh_04.dgn
 19-SEP-2012 10:20
 C:\p\proj\hwy\wood County\US 74-23 at Exit 103 Ramp Extension Project\IGN\Roadway Plans\SS4914AA_Rdy_psh_04.dgn

PROJECT REFERENCE NO.	SHEET NO.
SS-4914AA	4
RW SHEET NO.	
ROADWAY DESIGN ENGINEER	HYDRAULICS ENGINEER

MATCH TO SHEET 5

MATCH TO SHEET 5

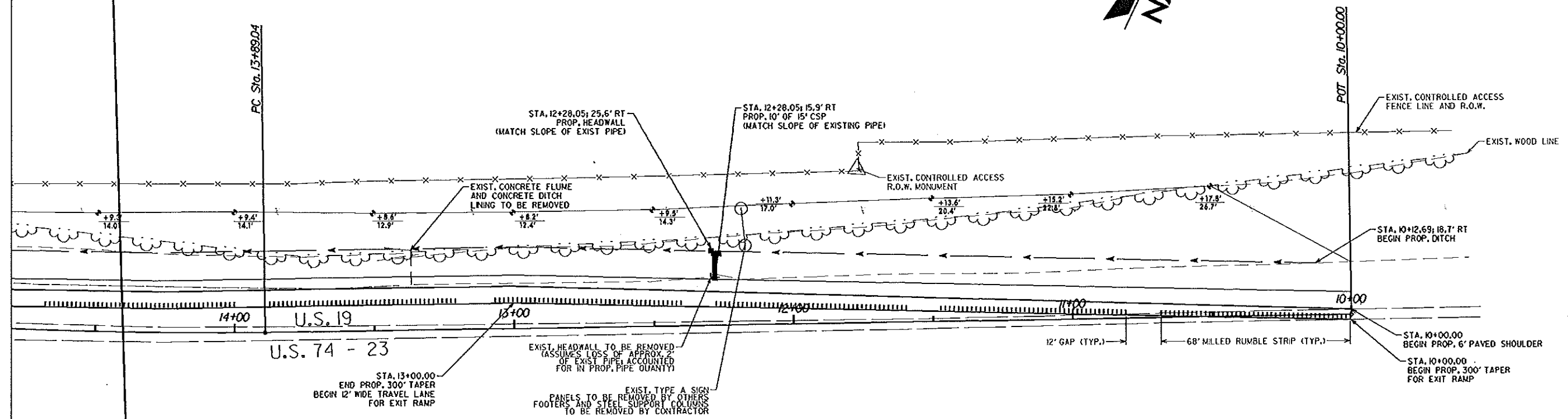
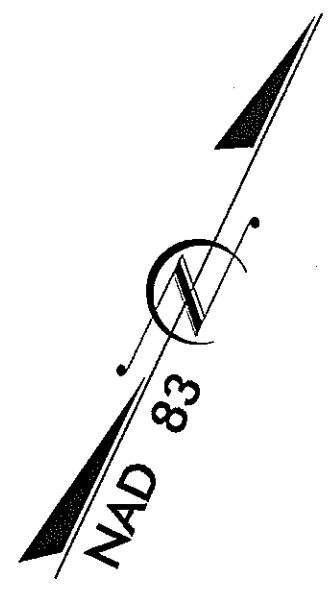

PC Sta. 15+89.04

POT Sta. 10+00.00

U.S. 19
 U.S. 74 - 23

STA. 13+00.00
 END PROP. 300' TAPER
 BEGIN 12' WIDE TRAVEL LANE
 FOR EXIT RAMP

STA. 12+28.05; 25.6' RT
 PROP. HEADWALL
 (MATCH SLOPE OF EXIST PIPE)

EXIST. CONCRETE FLUME
 AND CONCRETE DITCH
 LINING TO BE REMOVED

EXIST. HEADWALL TO BE REMOVED
 (ASSUMES LOSS OF APPROX. 2'
 OF EXIST PIPE, ACCOUNTED
 FOR IN PROP. PIPE QUANTITY)

EXIST. TYPE A SIGN
 PANELS TO BE REMOVED BY OTHERS
 FOOTERS AND STEEL SUPPORT COLUMNS
 TO BE REMOVED BY CONTRACTOR

STA. 12+28.05; 15.9' RT
 PROP. 10' OF 15' CSP
 (MATCH SLOPE OF EXISTING PIPE)

EXIST. CONTROLLED ACCESS
 R.O.W. MONUMENT

EXIST. CONTROLLED ACCESS
 FENCE LINE AND R.O.W.

STA. 10+12.69; 18.7' RT
 BEGIN PROP. DITCH

STA. 10+00.00
 BEGIN PROP. 6' PAVED SHOULDER

STA. 10+00.00
 BEGIN PROP. 300' TAPER
 FOR EXIT RAMP

12' GAP (TYP.)

68' MILLED RUMBLE STRIP (TYP.)

EXIST. WOOD LINE

PROJECT REFERENCE NO.	SHEET NO.
SS-4914AA	5
RW SHEET NO.	
ROADWAY DESIGN ENGINEER	HYDRAULICS ENGINEER

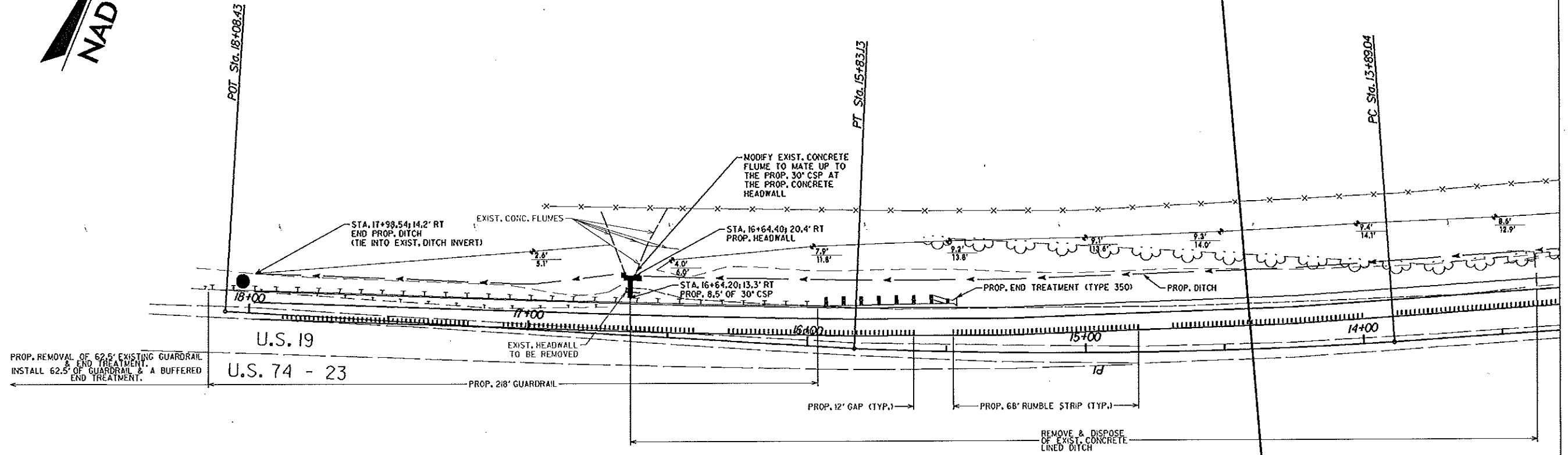
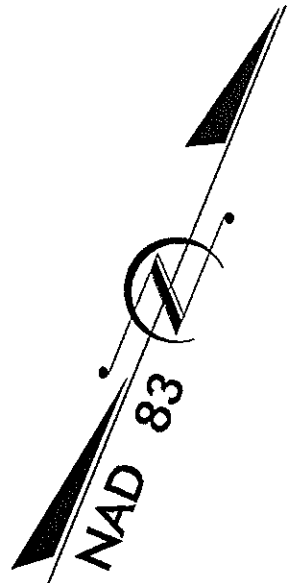

MATCH TO SHEET 4

MATCH TO SHEET 4

REVISIONS

8/17/99

9-SEP-2012 10:23
 C:\VFP\Projects\Haywood County\US 74-23 at Exit 103 Ramp Extension Project\DCN\Roadway Plans\SS4914AA_Rdy-ph_05.dgn
 P:\ELLERSON\ME\4444

REVISIONS

PROJECT REFERENCE NO. SS-4914AA	SHEET NO. TCP-1
RW SHEET NO.	
ROADWAY DESIGN ENGINEER	HYDRAULICS ENGINEER

TRAFFIC CONTROL PLAN PHASE I

(SHOULDER CLOSER FOR THE DURATION OF THE PROJECT:
FOR ALL WORK > 2' FROM EDGE OF TRAVEL LANE)

- EROSION CONTROL
- CLEARING & GRUBBING
- GRADING
- SIGN REMOVAL & DISPOSAL
- DRAINAGE INSTALLATIONS
- GUARDRAIL INSTALLATION

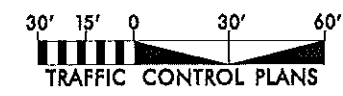
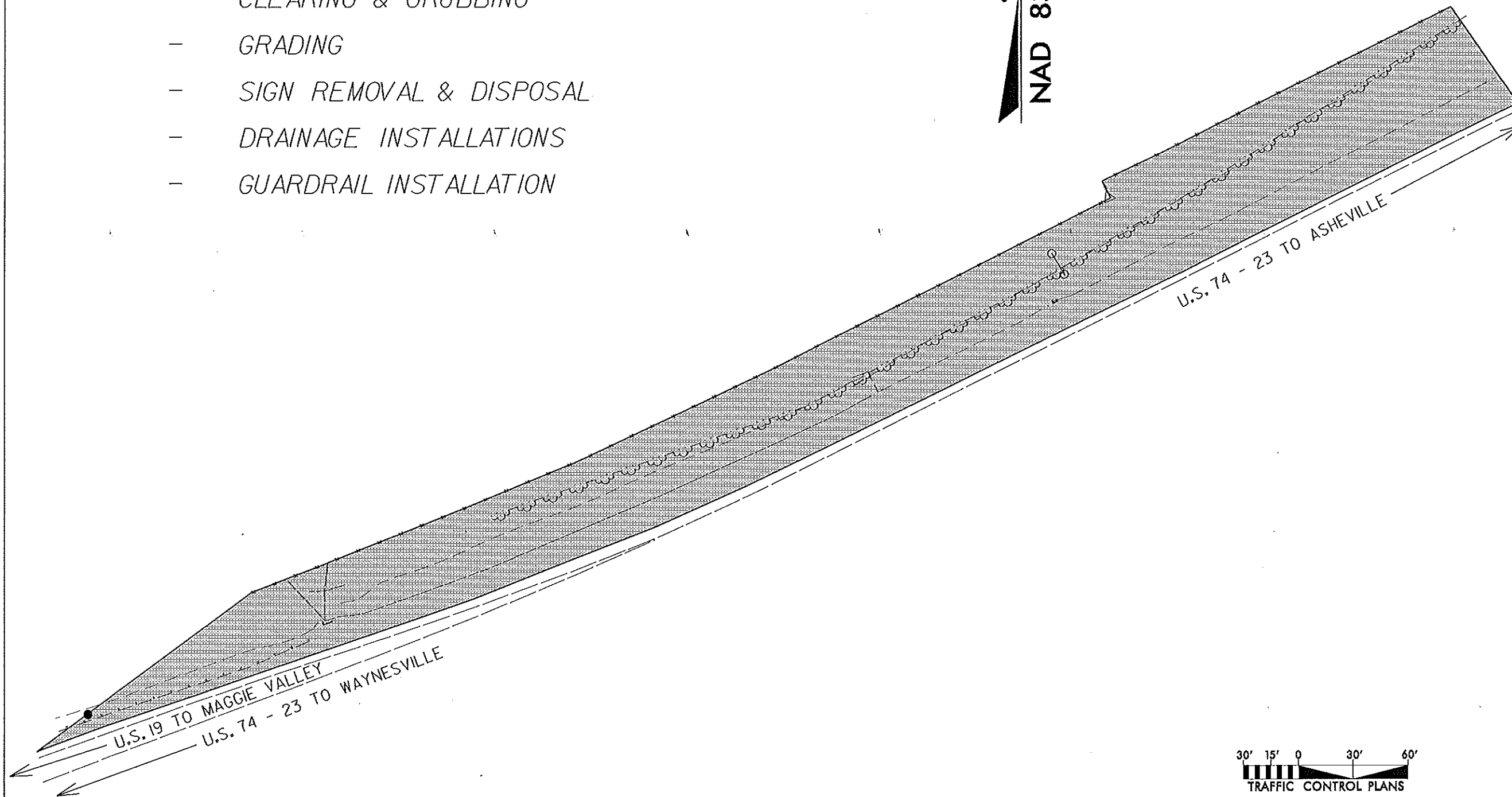

REVISIONS

PROJECT REFERENCE NO. SS-4914AA	SHEET NO. TCP-2
RW SHEET NO.	
ROADWAY DESIGN ENGINEER	HYDRAULICS ENGINEER

TRAFFIC CONTROL PLAN PHASE 2

(24-HOUR LANE CLOSURE FOR SEVERAL DAYS:
FOR ALL WORK 2' OR LESS FROM THE EDGE
OF THE TRAVEL LANE)

- PAVEMENT REMOVAL
- SUBGRADE WORK
- PAVING OF BASE COURSE (B25.0B)
- PAVING OF INTERMEDIATE COURSE (I19.0B)

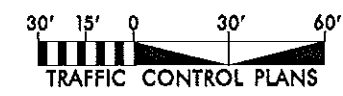
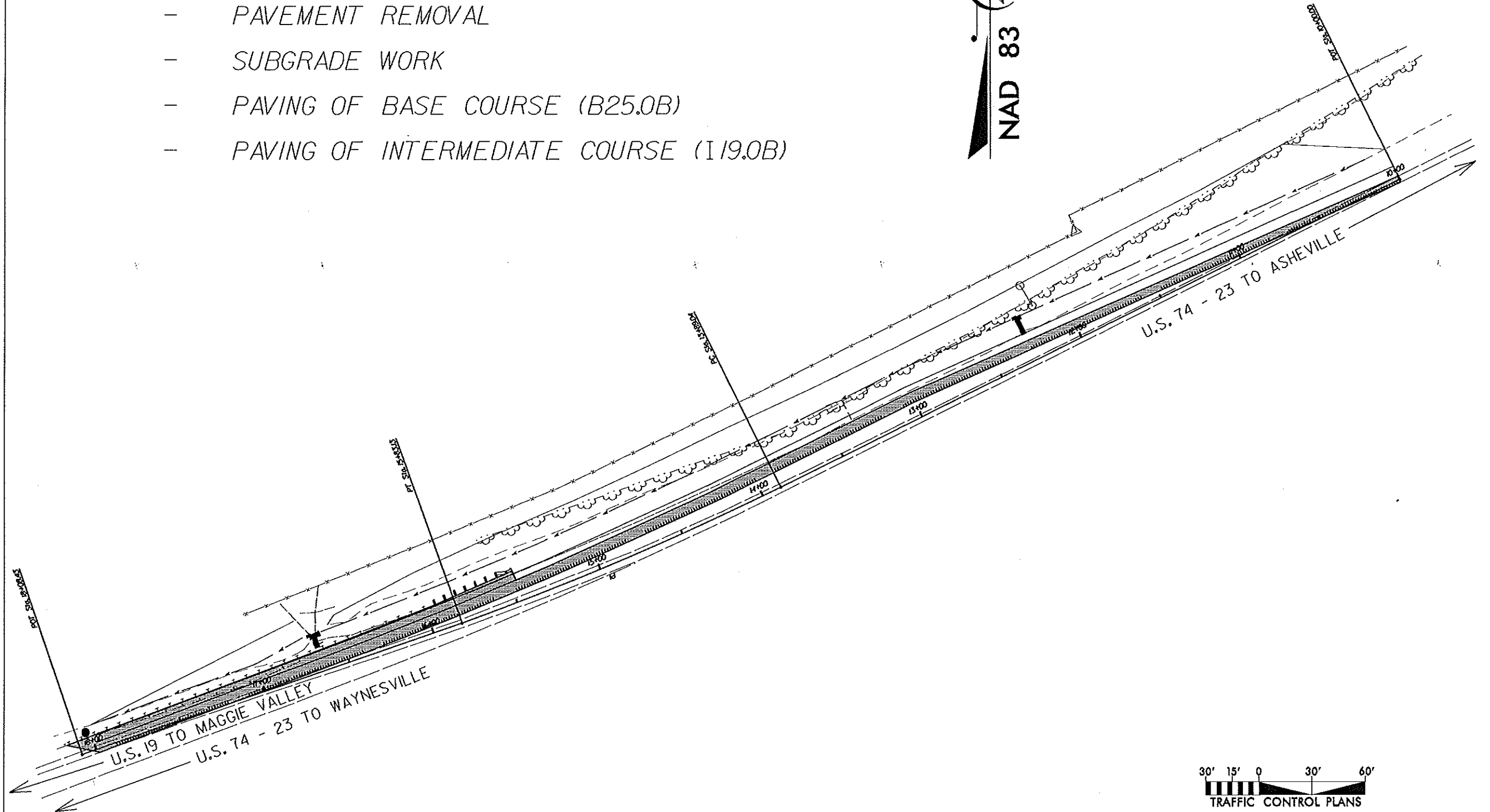

REVISIONS

PROJECT REFERENCE NO. SS-4914AA	SHEET NO. TCP-3
RAW SHEET NO.	
ROADWAY DESIGN ENGINEER	HYDRAULICS ENGINEER

TRAFFIC CONTROL PLAN PHASE 3

(LANE CLOSURE DURING THE DAY:
FOR ALL WORK 2' OR LESS FROM
THE EDGE OF THE TRAVEL LANE))

- PAVEMENT SURFACE COURSE (S9.5B)
- CONSTRUCT PAVED SHOULDERS
- RUMBLE STRIPS
- PAVEMENT MARKING

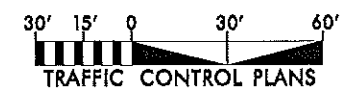
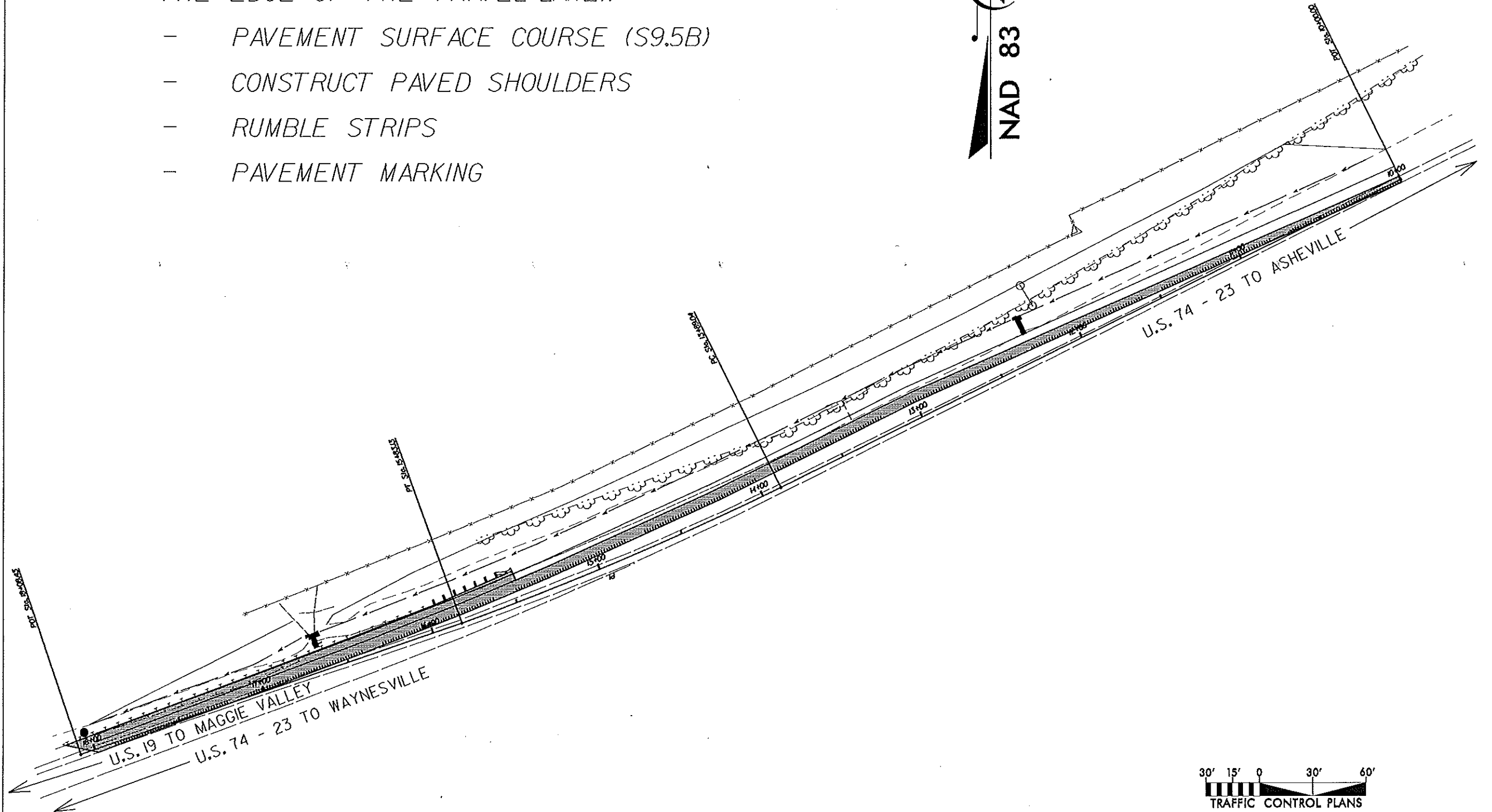

8-SEP-2012 10:40
C:\P\Projects\Holwood County\US 74-23 at Exit 103 Ramp Extension Project\DDN\Pavomont Marking Plans\42777_Rdu_psh_Pavomont_Marking_01.dgn

8/17/99

REVISIONS

MATCH TO SHEET PM-2

MATCH TO SHEET PM-2

PC Sta. 13+89.04

POT Sta. 10+00.00

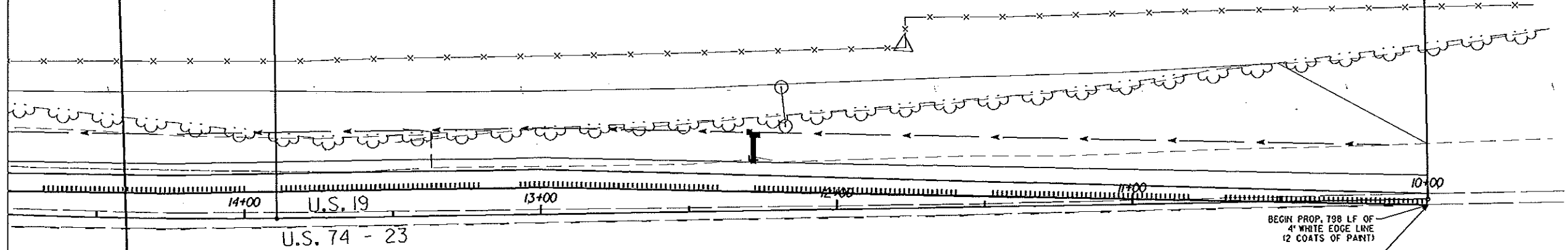

BEGIN PROP. 788 LF OF
4" WHITE EDGE LINE
(2 COATS OF PAINT)
BEGIN PROP. 805 LF OF
4" WHITE 3' - 9" SKIP
(2 COATS OF PAINT)

PROJECT REFERENCE NO.	SHEET NO.
SS-4914AA	PM-1
RW SHEET NO.	
ROADWAY DESIGN ENGINEER	HYDRAULICS ENGINEER

8/17/99
REVISIONS
9-SEP-2012 10:42
C:\p\proj\212\shwood County\US 74-23 at Exit 203 Rmp Extension Project\DCN\Pavement Marking Plans\42777_Rdy_psh_Pavement_Marking_02.dgn
REVISED

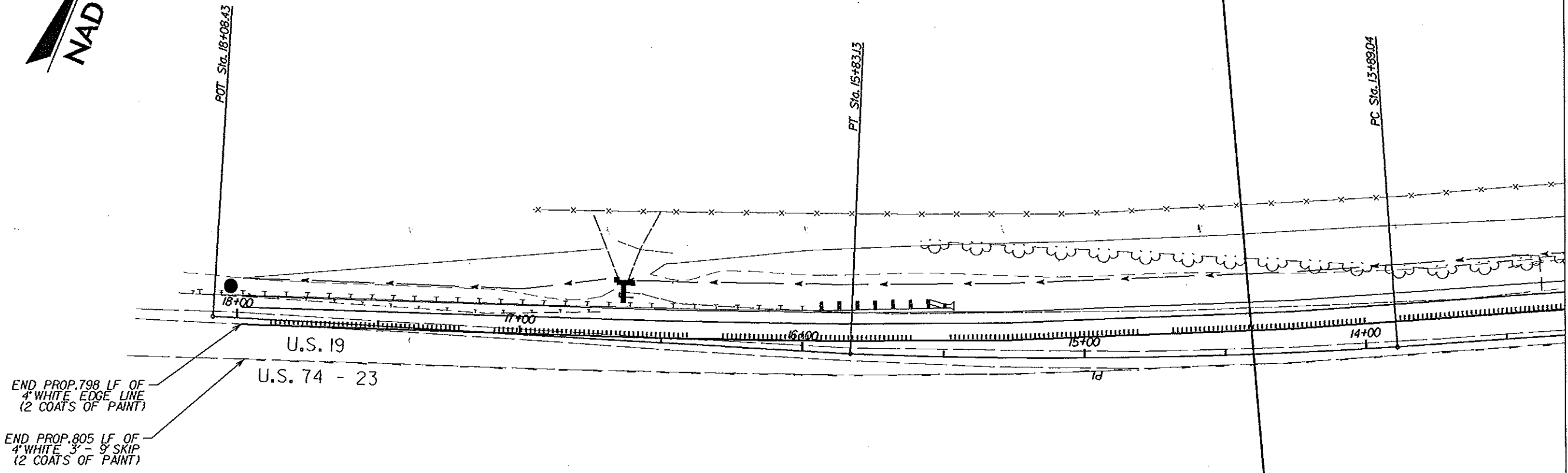
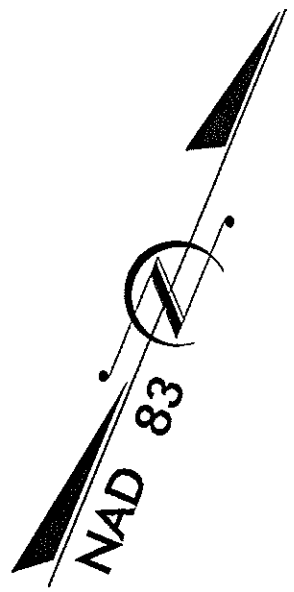

END PROP. 798 LF OF
4' WHITE EDGE LINE
(2 COATS OF PAINT)

END PROP. 805 LF OF
4' WHITE 3' - 9' SKIP
(2 COATS OF PAINT)

PROJECT REFERENCE NO. SS-4914AA	SHEET NO. PM-2
RAW SHEET NO.	
ROADWAY DESIGN ENGINEER	HYDRAULICS ENGINEER

MATCH TO SHEET PM-1

MATCH TO SHEET PM-1

8/17/99

19-SEP-2012 10:44 C:\Projects\Highwood County\US 74-23 at Exit 303 Ramp Extension Project\DWG\Erosion Control Plans\42777_Rdypsh-Erosion_Control_01.dgn

REVISIONS

MATCH TO SHEET EC-2

MATCH TO SHEET EC-2

Std. #	Description	Symbol
1605.01	Temporary Silt Fence	--- --- ---
1606.01	Special Sediment Control Fence	---X---X---X---
1622.01	Temporary Berms and Slope Drains	---T---T---T---
1630.02	Silt Basin Type B	▨
1630.03	Temporary Silt Ditch	--- --- ---
1630.05	Temporary Diversion	--- --- ---
1630.06	Special Stilling Basin	▨
1632.03	Rock Inlet Sediment Trap Type C	□
1633.01	Temporary Rock Silt Check Type-A	▨
	Temporary Rock Silt Check Type-A with Matting and Polyacrylamide (PAM)	▨
1633.02	Temporary Rock Silt Check Type-B	▨
	Wattle	--- --- ---
	Wattle with Polyacrylamide (PAM)	--- --- ---
1634.02	Temporary Rock Sediment Dam Type-B	▨
1636.01	Rock Pipe Inlet Sediment Trap Type-A	C

2012 STANDARD DRAWINGS

1604.01 Railroad Erosion Control Detail	1632.01 Rock Inlet Sediment Trap Type A
1605.01 Temporary Silt Fence	1632.02 Rock Inlet Sediment Trap Type B
1606.01 Special Sediment Control Fence	1632.03 Rock Inlet Sediment Trap Type C
1607.01 Gravel Construction Entrance	1633.01 Temporary Rock Silt Check Type A
1622.01 Temporary Berms and Slope Drains	1633.02 Temporary Rock Silt Check Type B
1630.01 Riser Basin	1634.01 Temporary Rock Sediment Dam Type A
1630.02 Silt Basin Type B	1634.02 Temporary Rock Sediment Dam Type B
1630.03 Temporary Silt Ditch	1635.01 Rock Pipe Inlet Sediment Trap Type A
1630.04 Stilling Basin	1635.02 Rock Pipe Inlet Sediment Trap Type B
1630.05 Temporary Diversion	1640.01 Coir Fiber Baffle
1630.06 Special Stilling Basin	1645.01 Temporary Stream Crossing
1631.01 Matting Installation	

DISTURBED AREA
41,383 SF

THESE EROSION AND SEDIMENT CONTROL PLANS COMPLY WITH THE REGULATIONS SET FORTH BY THE NCG-010000 GENERAL CONSTRUCTION PERMIT EFFECTIVE AUGUST 3, 2011 ISSUED BY THE NORTH CAROLINA DEPARTMENT OF ENVIRONMENT AND NATURAL RESOURCES DIVISION OF WATER QUALITY.

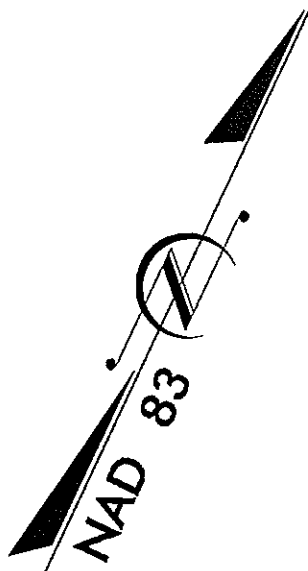

PROJECT REFERENCE NO. SS-4914AA	SHEET NO. EC-1
RW SHEET NO.	
ROADWAY DESIGN ENGINEER	HYDRAULICS ENGINEER

JEFFREY E. ALSPAUGH
LEVEL IIIA NAME
678
LEVEL IIIA CERTIFICATION NO.

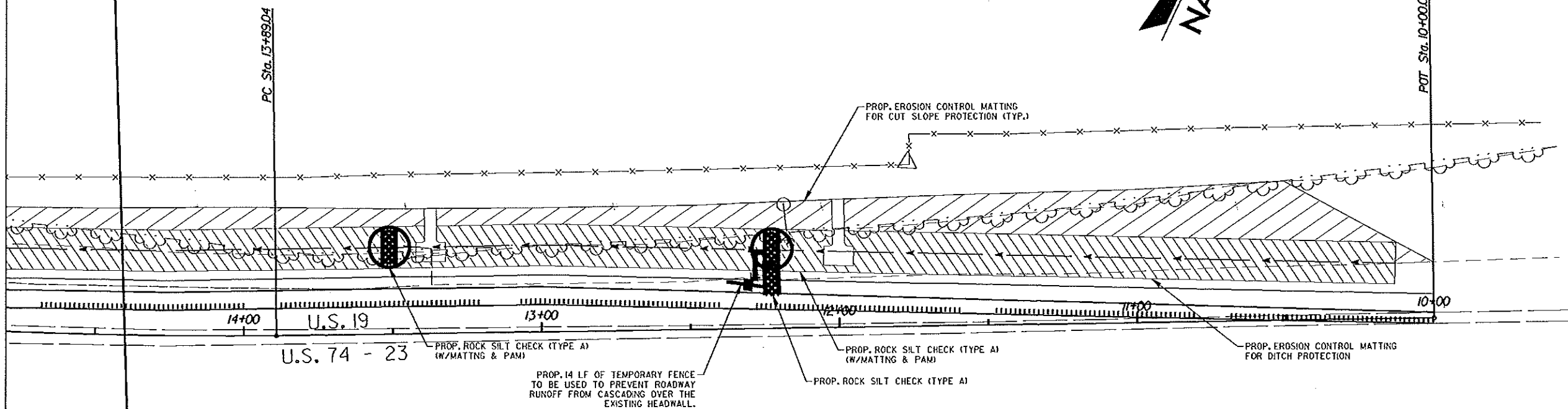

SOIL STABILIZATION TIMEFRAMES

SITE DESCRIPTION	STABILIZATION TIME	TIMEFRAME EXCEPTIONS
PERIMETER DICES, SHALES, DITCHES AND SLOPES	7 DAYS	NONE
HIGH QUALITY WATER (HOW) ZONES	7 DAYS	NONE
SLOPES STEEPER THAN 3#	7 DAYS	IF SLOPES ARE 10' OR LESS IN LENGTH AND ARE NOT STEEPER THAN 2#, 14 DAYS ARE ALLOWED.
SLOPES 3# OR FLATTER	14 DAYS	7 DAYS FOR SLOPES GREATER THAN 50' IN LENGTH.
ALL OTHER AREAS WITH SLOPES FLATTER THAN 4#	14 DAYS	NONE, EXCEPT FOR PERIMETERS AND HOW ZONES.

INSTALL MATTING FOR EROSION CONTROL IN THE PROPOSED DITCH LINE.



For Slopes Excavated Greater Than 10 feet Install Matting for Erosion Control on Entire Slope as Work Allows.

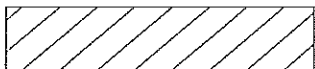

8/23/99

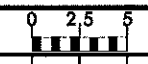

PROJ. REFERENCE NO.
SS-4914AA

SHEET NO.
X-1

75 70 65 60 55 50 45 40 35 30 25 20 15 10 5 0 5 10 15 20 25 30 35 40 45 50 55 60 65 70 75

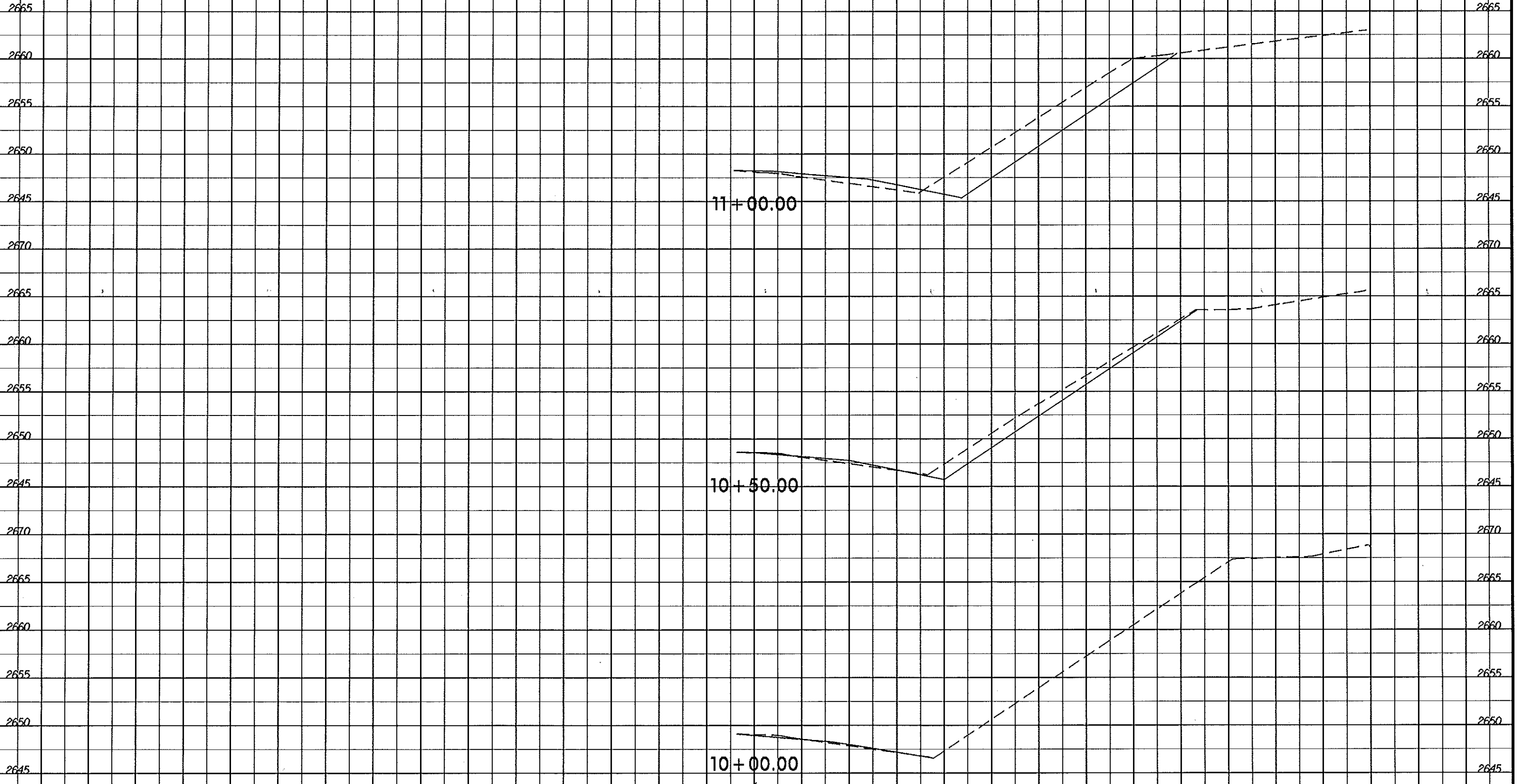

I:\SEP-2002 15:32
 C:\PROJECTS\Highwood County\US 74-23 at Exit 103 Remp Extension Project\Xac\42777_Rdy_xpl.dgn
 SS:USER\NAME\$

75 70 65 60 55 50 45 40 35 30 25 20 15 10 5 0 5 10 15 20 25 30 35 40 45 50 55 60 65 70 75

8/23/99



PROJ. REFERENCE NO.
SS-4914AA

SHEET NO.
X-4

75 70 65 60 55 50 45 40 35 30 25 20 15 10 5 0 5 10 15 20 25 30 35 40 45 50 55 60 65 70 75

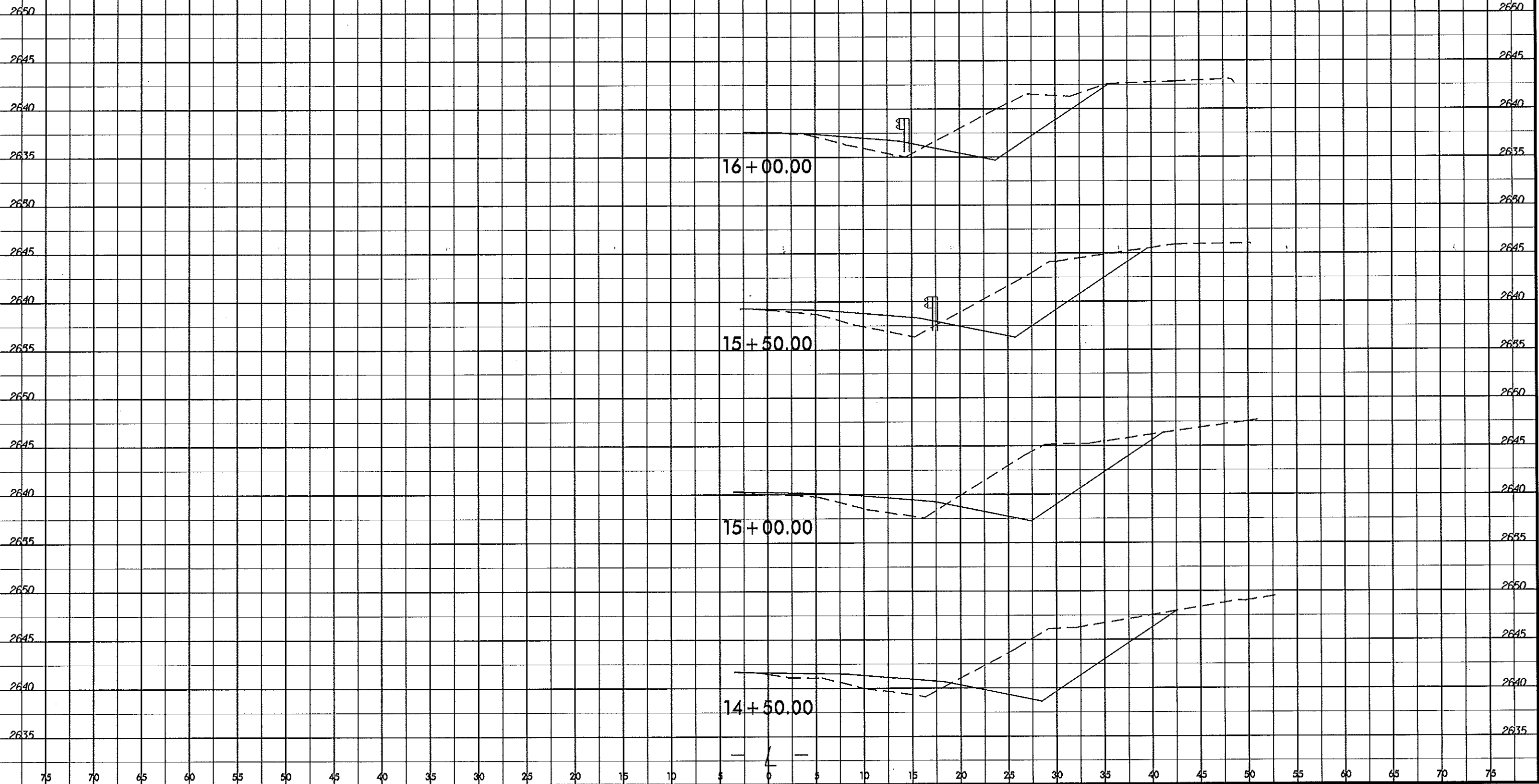

I:\SEP-2002\15135
 Substation\Barnes\Barnes.dgn
 I:\SEP-2002\15135
 Substation\Barnes\Barnes.dgn

8/23/99



PROJ. REFERENCE NO.	SHEET NO.
SS-4914AA	X-5

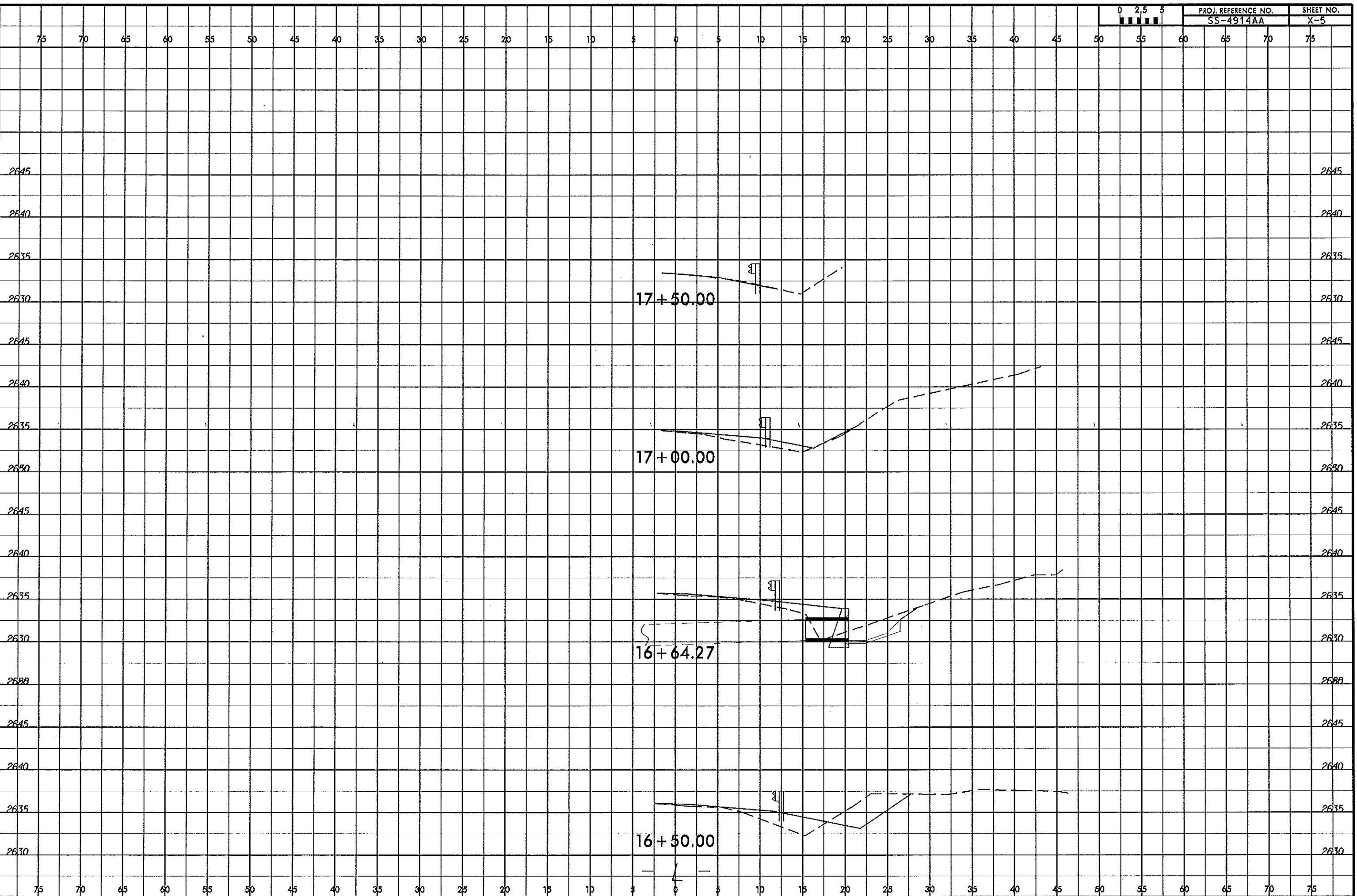

B:\SEP-2002\15.36
 CA\PROJECTS\Hwywood County\US 74-23 at Exit 103 Ramp Extension Project\Xoc\42777_Rdy_xpl.dgn
 33450SERNAME336

75 70 65 60 55 50 45 40 35 30 25 20 15 10 5 0 5 10 15 20 25 30 35 40 45 50 55 60 65 70 75

2645 2645

2640 2640

2635 2635

2630 2630

2645 2645

2640 2640

2635 2635

2630 2630

2645 2645

2640 2640

2635 2635

2630 2630

2645 2645

2640 2640

2635 2635

2630 2630

2645 2645

2640 2640

2635 2635

2630 2630

75 70 65 60 55 50 45 40 35 30 25 20 15 10 5 0 5 10 15 20 25 30 35 40 45 50 55 60 65 70 75