



STATE OF NORTH CAROLINA
DEPARTMENT OF TRANSPORTATION

ROY COOPER
GOVERNOR

JAMES H. TROGDON, III
SECRETARY

February 15, 2017

ADDENDUM # 1

To: Plan Holders

^{DS}
wa

From: Wanda H. Austin, P.E.
Division 14 Project Team Lead

RE: **Traffic Management Plan Revision, Summary of Earthwork (Unclassified Excavation) Revision, Aggregate Base Course Quantity Revision, Additions of a Traffic Control Project Special Provision, a Structures Pay Item, and a Corresponding Structures Project Special Provision**

Contract ID: DN00117
County: Transylvania
Letting Date: February 28, 2017

The above contract has experienced the following revisions:

1. Replace plan sheet **TMP-5** (Traffic Management Plan) with the attached, revised TMP sheet. It has been revised to show an increased radius that will accommodate trucks near the northwest end of the bridge.
2. On page **TC-5** of the contract proposal, below the last paragraph, insert the following:

TEMPORARY DETOURS (WIDENING):

Construct the temporary detour (widening) required on this project, in accordance with the typical sections in the plans or as directed by the Engineer.

After the detours have served their purpose, remove the portions deemed unsuitable for use as a permanent part of the project as directed by the Engineer. Salvage and stockpile the aggregate base course removed from the detours at locations within the right of way, as directed by the Engineer, for removal by State Forces. Place earth material removed from the detour in embankments or dispose of in waste areas furnished by the Contractor.

Payment for the construction of the detour (widening) will be made at the contract unit price per ton for *Aggregate Base Course*.

No direct payment will be made for removing the aggregate base course and earth material, as the cost of same shall be included in the lump sum price bid for *Grading*. Such prices and payments will be full compensation for the work of removing, salvaging, and stockpiling aggregate base course; and for placing earth material in embankments or disposing of earth material in waste areas.

3. Between the **last page of the Structures Project Special Provisions** and the **first page of the Permits Project Special Provisions** of the contract proposal, insert the attached Project Special Provision titled: **Construction, Maintenance and Removal of Temporary Access at Station 13+57.50 -L-**.
4. Pay Item number **8017000000-N, CONST, MTC AND REMOVAL OF TEMP ACCESS AT STA 13+57.50 -L-, LS**, has been added to the contract proposal.
5. Plan sheet number **3B-1**, in the table titled **SUMMARY OF EARTHWORK IN CUBIC YARDS**, under the column heading titled **UNCLASSIFIED EXCAVATION**, the quantity for **LOCATION, -L- STA. 11+00.00 TO STA. 12+96.20 (BEG. BRIDGE), of PHASE 2 (RIGHT)**, has **increased from 112 cubic yards to 149 cubic yards**; the **PHASE 2 TOTAL** has **increased from 118 cubic yards to 155 cubic yards** and the **GRAND TOTAL** has been **increased from 268 cubic yards to 305 cubic yards** in order to accommodate the increased radius identified in item # 1 above.
6. The quantity for Pay Item number **1121000000-E, AGGREGATE BASE COURSE**, has been **increased to 168 tons**, in order to accommodate the increased radius identified in revision # 1 above.

Please access ebs addenda files on Bid Express®.

Please insert this letter into the addendum section of the proposal and sign the verification. Thank you for your attention to this matter.

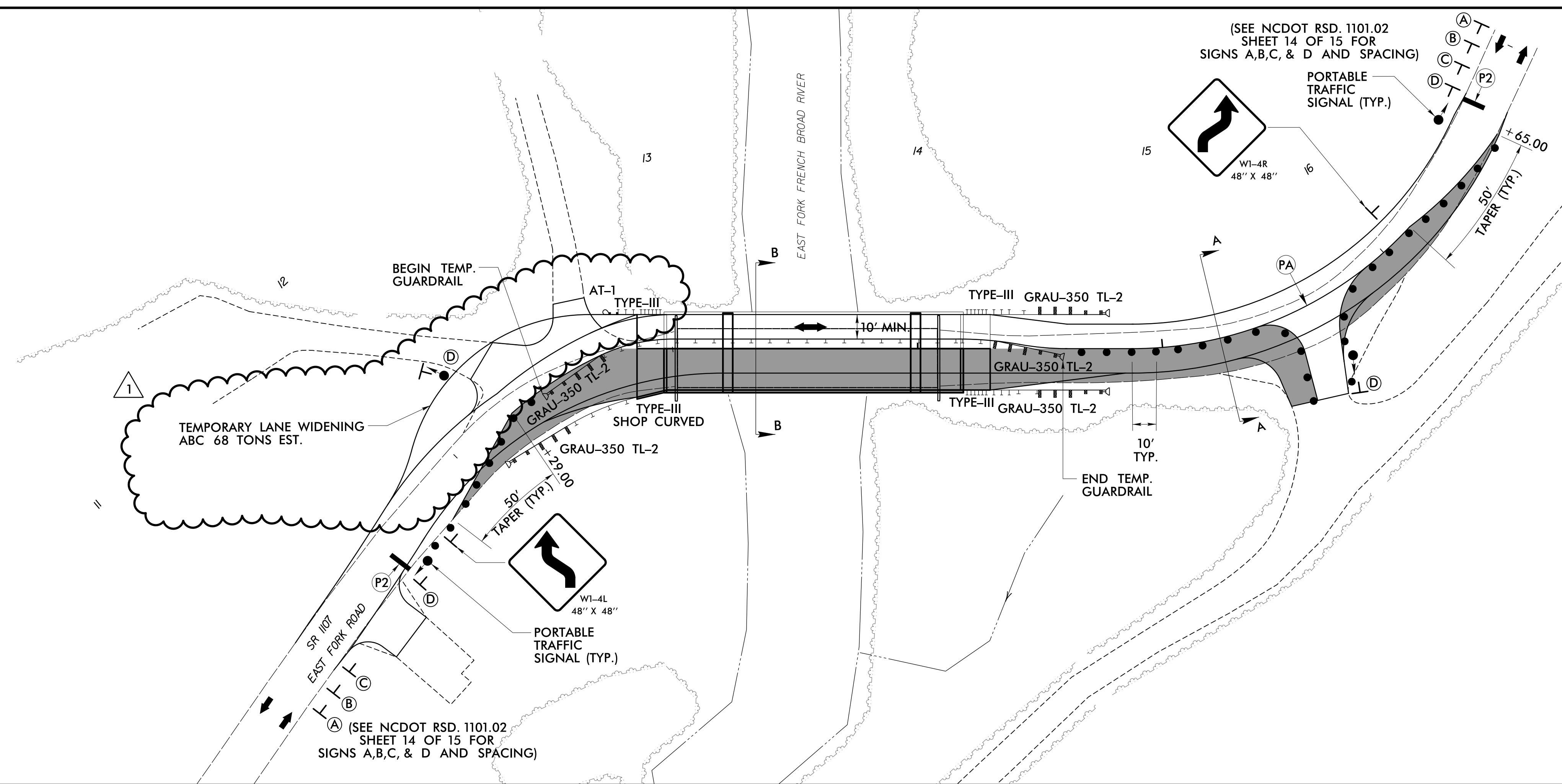

REVISIONS
 2/10/2017 - TRAFFIC CONTROL REVISION (MKA) - ADDED TEMPORARY LANE WIDENING.

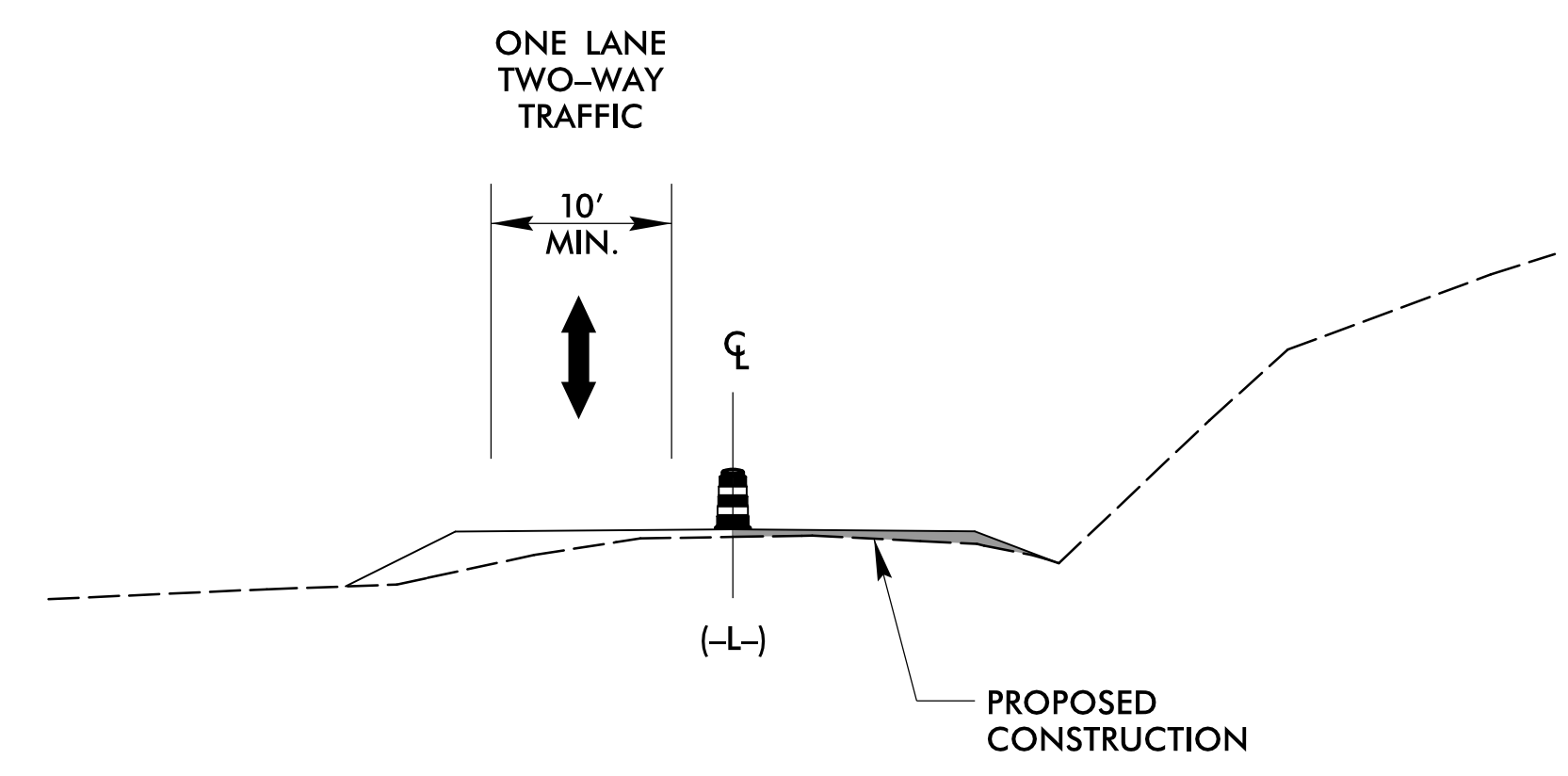

 SCALE 1" = 30'

SECTION A-A

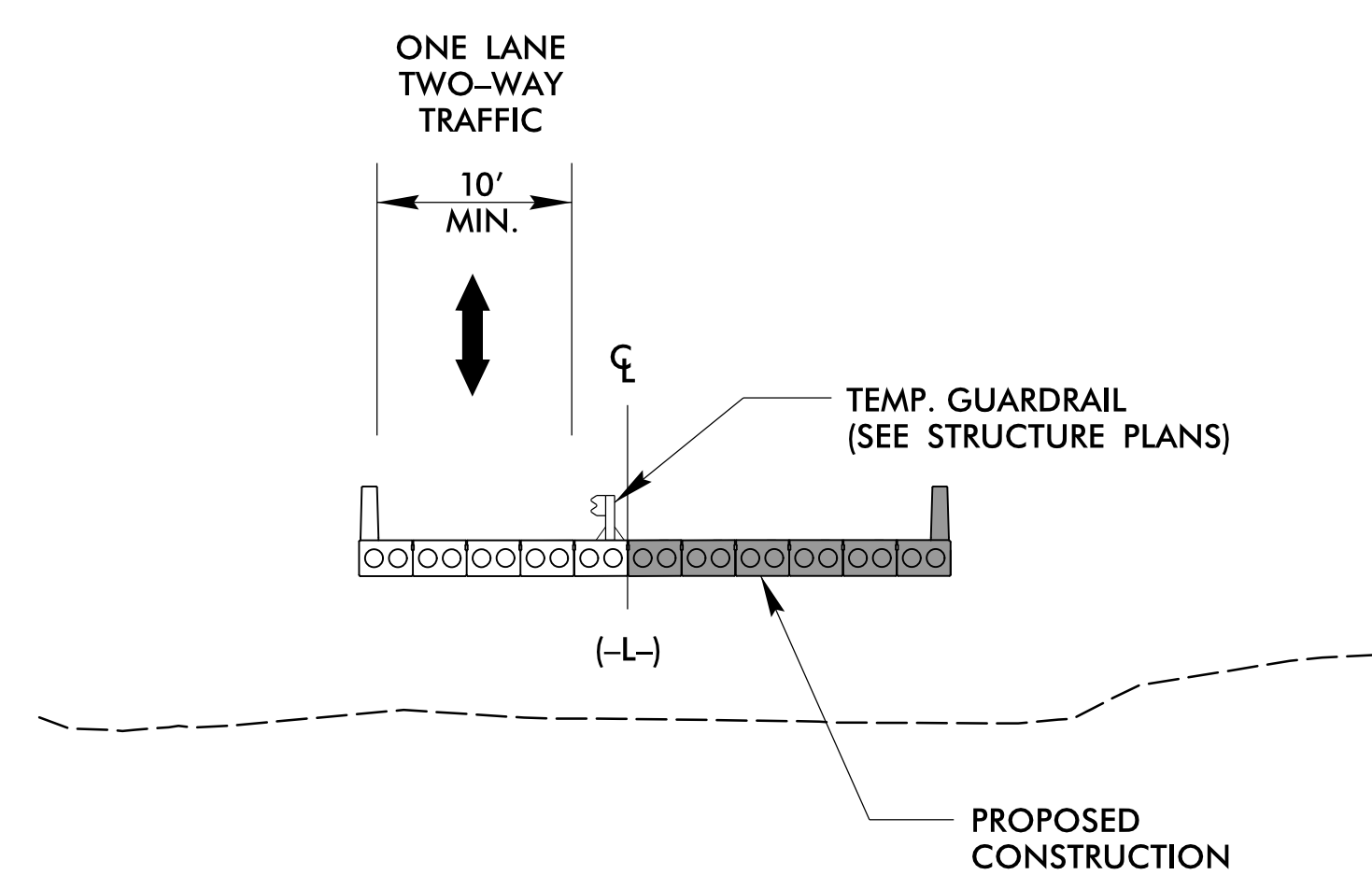

N.T.S

SECTION B-B



N.T.S

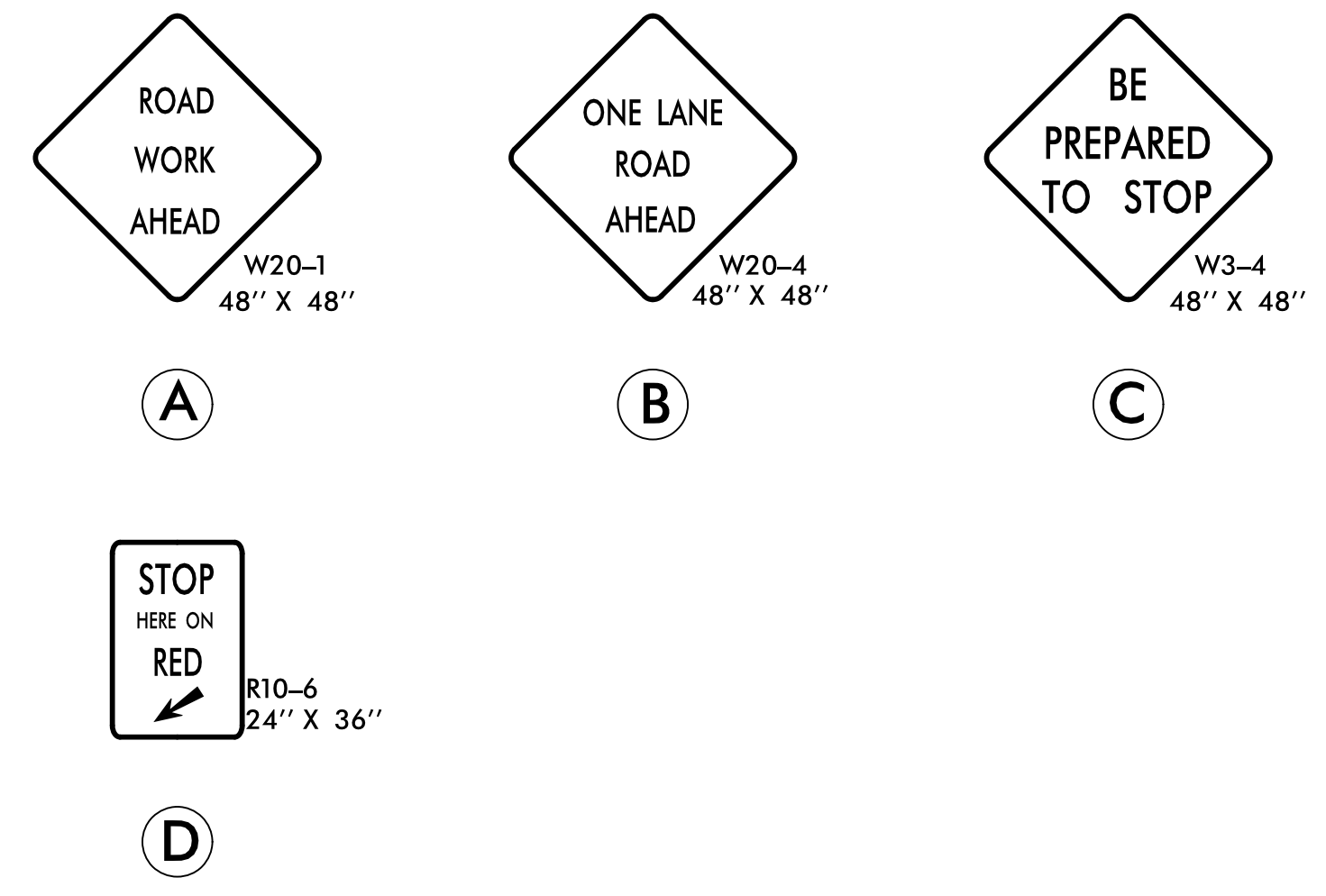

DOCUMENT NOT CONSIDERED FINAL UNLESS ALL SIGNATURES COMPLETED

APPROVED: *Gerard H. McCauley* DATE: 2/10/2017

Vaughn & Melton
 Consulting Engineers
 Charlotte, North Carolina 704-357-0488
 Tri-Cities, Tennessee 423-461-9400
 Knoxville, Tennessee 865-546-5800
 Asheville, North Carolina 828-253-2196
 Middlesboro, Kentucky 606-246-1600
 Spartanburg, South Carolina 864-574-4775
Copyright © 2006 Vaughn & Melton, Inc. All Rights Reserved.

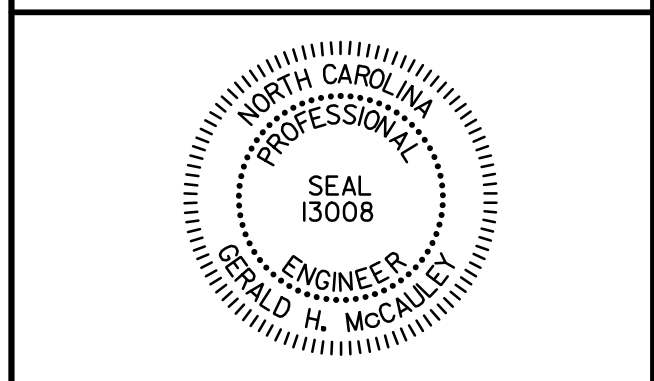

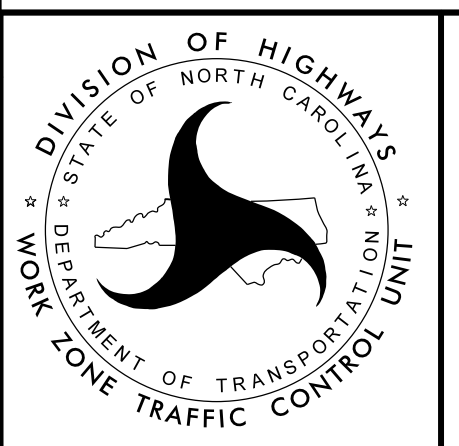

PHASE II DETAIL

2/10/2017
 R:\CPN\B05144AD_TCP_SHT_5.dgn
 mdb061d21z

**CONSTRUCTION, MAINTENANCE AND REMOVAL
OF TEMPORARY ACCESS AT STATION 13+57.50 -L-**

(12-12-13)



1.0 GENERAL

2/7/2017

Construct, maintain, and remove the temporary access required to provide the working area necessary for construction of the new bridge, construction of the temporary detour structure, or for the removal of an existing bridge, as applicable. Temporary access may involve the use of a rock causeway [workpad], a work bridge, or other methods; however, all types of temporary access are required to meet the requirements of all permits, the Standard Specifications, and this Special Provision.

2.0 TEMPORARY ROCK CAUSEWAY [WORKPAD]

At the contractor's option, construction of a temporary rock causeway [workpad] within the limits shown on the plans is permitted. Build the causeway [workpad] with Class II riprap topped by a layer of Class B riprap or as otherwise designated on the plans or approved by the Engineer. If desired, recycle the Class II riprap used in the causeway [workpad] for placement in the final riprap slope protection as directed by the Engineer. No payment will be made for recycled riprap as this material is considered incidental to the causeway [workpad] placement and removal. If this option is exercised, no adjustment in contract bid price will be allowed due to an underrun in the quantity of "Rip Rap Class II (2'-0" Thick)".

Completely remove all causeway [workpad] material including pipes and return the entire causeway [workpad] footprint to the original contours and elevations within 90 days of the completion of the deck slab or as otherwise required by permits.

Do not construct or remove causeway [workpad] during the moratorium period shown on the permit. If the completion of the deck slab falls within the prohibitive dates for causeway [workpad] construction or removal, begin causeway [workpad] removal immediately following the prohibitive dates.

3.0 TEMPORARY WORK BRIDGE

At the contractor's option, construction of a temporary work bridge in lieu of the causeway(s) [workpad] is acceptable, provided the temporary work bridge satisfies all permits. Submit details of the temporary work bridge to the Engineer prior to constructing the work bridge to ensure conformance with the plans and all permits. Completely remove the temporary bridge prior to final acceptance or as otherwise required by the permits.

4.0 BASIS OF PAYMENT

The lump sum price bid for “Construction, Maintenance and Removal of Temporary Access at Station 13+57.50 -L-” will be full compensation for the above work, or other methods of access, including all material, pipes, work bridge components, equipment, tools, labor, disposal, and incidentals necessary to complete the work.

Feb 15, 2017 1:24 pm

ITEMIZED PROPOSAL FOR CONTRACT NO. DN00117

Page 1 of 6

County : Transylvania

Line #	Item Number	Sec #	Description	Quantity	Unit Cost	Amount
ROADWAY ITEMS						
0001	0000100000-N	800	MOBILIZATION	Lump Sum	L.S.	
0002	0000400000-N	801	CONSTRUCTION SURVEYING	Lump Sum	L.S.	
0003	0030000000-N	SP	BRIDGE APPROACH FILL - SUB REGIONAL TIER, STATION ***** (STA 13+57.50)	Lump Sum	L.S.	
0004	0043000000-N	226	GRADING	Lump Sum	L.S.	
0005	0050000000-E	226	SUPPLEMENTARY CLEARING & GRUB-BING	0.1 ACR		
0006	0057000000-E	226	UNDERCUT EXCAVATION	50 CY		
0007	0134000000-E	240	DRAINAGE DITCH EXCAVATION	32 CY		
0008	0195000000-E	265	SELECT GRANULAR MATERIAL	50 CY		
0009	0196000000-E	270	GEOTEXTILE FOR SOIL STABILIZATION	50 SY		
0010	0199000000-E	SP	TEMPORARY SHORING	475 SF		
0011	0318000000-E	300	FOUNDATION CONDITIONING MATERIAL, MINOR STRUCTURES	12 TON		
0012	0320000000-E	300	FOUNDATION CONDITIONING GEOTEXTILE	35 SY		
0013	0582000000-E	310	15" CS PIPE CULVERTS, 0.064" THICK	20 LF		
0014	1099700000-E	505	CLASS IV SUBGRADE STABILIZATION	50 TON		
0015	1121000000-E	520	AGGREGATE BASE COURSE	168 TON		
0016	1220000000-E	545	INCIDENTAL STONE BASE	50 TON		
0017	1489000000-E	610	ASPHALT CONC BASE COURSE, TYPE B25.0B	30 TON		
0018	1519000000-E	610	ASPHALT CONC SURFACE COURSE, TYPE S9.5B	130 TON		

County : Transylvania

Line #	Item Number	Sec #	Description	Quantity	Unit Cost	Amount
0019	1575000000-E	620	ASPHALT BINDER FOR PLANT MIX	10 TON		
0020	2286000000-N	840	MASONRY DRAINAGE STRUCTURES	1 EA		
0021	2367000000-N	840	FRAME WITH TWO GRATES, STD 840.29	1 EA		
0022	2556000000-E	846	SHOULDER BERM GUTTER	15 LF		
0023	3030000000-E	862	STEEL BM GUARDRAIL	87.5 LF		
0024	3045000000-E	862	STEEL BM GUARDRAIL, SHOP CURVED	12.5 LF		
0025	3150000000-N	862	ADDITIONAL GUARDRAIL POSTS	5 EA		
0026	3180000000-N	862	GUARDRAIL ANCHOR UNITS, TYPE ***** (TYPE III)	1 EA		
0027	3195000000-N	862	GUARDRAIL ANCHOR UNITS, TYPE AT-1	1 EA		
0028	3215000000-N	862	GUARDRAIL ANCHOR UNITS, TYPE III	3 EA		
0029	3270000000-N	SP	GUARDRAIL ANCHOR UNITS, TYPE 350	3 EA		
0030	3380000000-E	862	TEMPORARY STEEL BM GUARDRAIL	275 LF		
0031	3382000000-E	862	TEMPORARY STEEL BM GUARDRAIL (SHOP CURVED)	37.5 LF		
0032	3389000000-N	SP	TEMPORARY GUARDRAIL ANCHOR UNITS, TYPE ***** (350 TL-2)	4 EA		
0033	3635000000-E	876	RIP RAP, CLASS II	17 TON		
0034	3649000000-E	876	RIP RAP, CLASS B	54 TON		
0035	3656000000-E	876	GEOTEXTILE FOR DRAINAGE	550 SY		
0036	4400000000-E	1110	WORK ZONE SIGNS (STATIONARY)	152 SF		

County : Transylvania

Line #	Item Number	Sec #	Description	Quantity	Unit Cost	Amount
0037	4430000000-N	1130	DRUMS	32	EA	
0038	4455000000-N	1150	FLAGGER	2	DAY	
0039	4810000000-E	1205	PAINT PAVEMENT MARKING LINES (4")	5,740	LF	
0040	4835000000-E	1205	PAINT PAVEMENT MARKING LINES (24")	20	LF	
0041	4850000000-E	1205	REMOVAL OF PAVEMENT MARKING LINES (4")	150	LF	
0042	4960000000-N	SP	GENERIC TRAFFIC CONTROL ITEM (PORTABLE TRAFFIC SIGNAL SYSTEM) (3 HEAD)	1	EA	
0043	5325200000-E	1510	2" WATER LINE	80	LF	
0044	5798000000-E	1530	ABANDON *** UTILITY PIPE (2)	160	LF	
0045	5835400000-E	1540	6" ENCASEMENT PIPE	60	LF	
0046	6000000000-E	1605	TEMPORARY SILT FENCE	300	LF	
0047	6006000000-E	1610	STONE FOR EROSION CONTROL, CLASS A	65	TON	
0048	6009000000-E	1610	STONE FOR EROSION CONTROL, CLASS B	60	TON	
0049	6012000000-E	1610	SEDIMENT CONTROL STONE	95	TON	
0050	6015000000-E	1615	TEMPORARY MULCHING	1	ACR	
0051	6018000000-E	1620	SEED FOR TEMPORARY SEEDING	100	LB	
0052	6021000000-E	1620	FERTILIZER FOR TEMPORARY SEEDING	0.5	TON	
0053	6029000000-E	SP	SAFETY FENCE	300	LF	
0054	6030000000-E	1630	SILT EXCAVATION	110	CY	

County : Transylvania

Line #	Item Number	Sec #	Description	Quantity	Unit Cost	Amount
0055	6036000000-E	1631	MATTING FOR EROSION CONTROL	550		SY
0056	6042000000-E	1632	1/4" HARDWARE CLOTH	25		LF
0057	6070000000-N	1639	SPECIAL STILLING BASINS	4		EA
0058	6071010000-E	SP	WATTLE	165		LF
0059	6071013000-E	SP	WATTLE BARRIER	110		LF
0060	6071020000-E	SP	POLYACRYLAMIDE (PAM)	20		LB
0061	6084000000-E	1660	SEEDING & MULCHING	0.4		ACR
0062	6087000000-E	1660	MOWING	0.4		ACR
0063	6090000000-E	1661	SEED FOR REPAIR SEEDING	50		LB
0064	6093000000-E	1661	FERTILIZER FOR REPAIR SEEDING	0.25		TON
0065	6096000000-E	1662	SEED FOR SUPPLEMENTAL SEEDING	50		LB
0066	6105000000-E	1664	WATER	130		M/G
0067	6108000000-E	1665	FERTILIZER TOPDRESSING	0.5		TON
0068	6111000000-E	SP	IMPERVIOUS DIKE	73		LF
0069	6117000000-N	SP	RESPONSE FOR EROSION CONTROL	13		EA
0070	6123000000-E	1670	REFORESTATION	0.1		ACR
0071	6132000000-N	SP	GENERIC EROSION CONTROL ITEM (ONSITE CONCRETE WASHOUT STRUCTURE)	1		EA

County : Transylvania

Line #	Item Number	Sec #	Description	Quantity	Unit Cost	Amount
STRUCTURE ITEMS						
0072	8035000000-N	402	REMOVAL OF EXISTING STRUCTURE AT STATION ***** (STA 13+57.50)	Lump Sum	L.S.	
0073	8105520000-E	411	3'-0" DIA DRILLED PIERS IN SOIL	108.8 LF		
0074	8105620000-E	411	3'-0" DIA DRILLED PIERS NOT IN SOIL	70 LF		
0075	8111200000-E	411	PERMANENT STEEL CASING FOR 3'-0" DIA DRILLED PIER	72.8 LF		
0076	8112730000-N	450	PDA TESTING	1 EA		
0077	8113000000-N	411	SID INSPECTIONS	1 EA		
0078	8114000000-N	411	SPT TESTING	6 EA		
0079	8115000000-N	411	CSL TESTING	1 EA		
0080	8121000000-N	412	UNCLASSIFIED STRUCTURE EXCAVA- TION AT STATION ***** (13+57.50)	Lump Sum	L.S.	
0081	8182000000-E	420	CLASS A CONCRETE (BRIDGE)	76.2 CY		
0082	8210000000-N	422	BRIDGE APPROACH SLABS, STATION ***** (STA 13+57.50)	Lump Sum	L.S.	
0083	8217000000-E	425	REINFORCING STEEL (BRIDGE)	25,231 LB		
0084	8238000000-E	425	SPIRAL COLUMN REINFORCING STEEL (BRIDGE)	3,699 LB		
0085	8364000000-E	450	HP12X53 STEEL PILES	385 LF		
0086	8391000000-N	450	STEEL PILE POINTS	14 EA		
0087	8430000000-E	452	SHEET PILE RETAINING WALLS	1,518 SF		
0088	8505000000-E	460	VERTICAL CONCRETE BARRIER RAIL	240.75 LF		
0089	8590000000-E	876	RIP RAP, CLASS ** (I)	63 TON		

County : Transylvania

Line #	Item Number	Sec #	Description	Quantity	Unit Cost	Amount
0090	8594000000-E	876	RIP RAP, CLASS B	25 TON		
0091	8608000000-E	876	RIP RAP CLASS II (2'-0" THICK)	84 TON		
0092	8622000000-E	876	GEOTEXTILE FOR DRAINAGE	169 SY		
0093	8657000000-N	430	ELASTOMERIC BEARINGS	Lump Sum	L.S.	
0094	8762000000-E	430	3'-0" X 1'-9" PRESTRESSED CONC CORED SLABS	550 LF		
0095	8763000000-E	430	3'-0" X 2'-0" PRESTRESSED CONC CORED SLABS	770 LF		
0096	8860000000-N	SP	GENERIC STRUCTURE ITEM (ASBESTOS ASSESSMENT)	Lump Sum	L.S.	
0097	8017000000-N	SP	CONSTRUCTION, MAINTENANCE, & REMOVAL OF TEMP ACCESS AT STA ***** (STA. 13+57.50 -L-)	Lump Sum	L.S.	

1324/Feb15/Q43946.3/D484821913000/E97

Total Amount Of Bid For Entire Project :