

**This electronic collection of documents is provided
for the convenience of the user
and is Not a Certified Document –**

**The documents contained herein were originally issued
and sealed by the individuals whose names and license
numbers appear on each page, on the dates appearing
with their signature on that page.**

**This file or an individual page
shall not be considered a certified document.**

U - 6055

CROSS - SECTION INDEX

XS - INDEX	X - 1A
EARTHWORK VOLUME SUMMARY.....	X - 1B
- L -	X - 1 THRU X - 2
- Y1 -	X - 3 THRU X - 4
- Y2 -	X - 5 THRU X - 6
- Y3 -	X - 7 THRU X - 8
- Y4 -	X - 9 THRU X - 10

REVISIONS

8/17/99

I:\R\2008\Roadway\XSC\U-6055_Rdy_xpl\Index.dgn
 I:\R\2008\Roadway\XSC\U-6055_Rdy_xpl\

PROJ. REFERENCE NO.	SHEET NO.
U-6055	X-1B

STATE OF NORTH CAROLINA DIVISION OF HIGHWAYS

CROSS-SECTION SUMMARY

NOTE: EMBANKMENT COLUMN DOES NOT INCLUDES BACKFILL FOR UNDERCUT

Station	Uncl. Exc. (cu. yd.)	Embt (cu. yd.)																		
L																				
10+00.00	0	0																		
12+20.00	7	0																		
12+50.00	16	2																		
12+67.86	6	2																		
12+81.00	5	1																		
13+00.00	10	0																		
13+50.00	20	14																		
13+65.16	3	17																		
14+10.16	4	92																		
Y3																				
10+00.00	0	0																		
10+45.00	1	121																		
10+50.00	0	14																		
11+00.00	8	82																		
11+50.00	47	29																		
12+00.00	42	18																		
12+50.00	2	3																		
Y1																				
10+70.00	0	0																		
11+00.00	6	0																		
11+50.00	40	4																		
11+75.00	38	4																		
12+00.00	53	3																		
12+07.79	18	1																		
12+52.79	94	8																		
Y2																				
10+00.00	0	0																		
10+45.00	2	16																		
10+50.00	0	2																		
10+75.00	6	35																		
11+00.00	9	45																		
11+50.00	8	35																		
Y4																				
10+55.00	0	0																		
10+75.00	37	0																		
11+00.00	94	2																		
11+25.00	143	2																		
11+50.00	165	0																		
11+83.03	128	1																		

Approximate quantities only. Unclassified excavation, fine grading, clearing and grubbing, and removal of existing pavement will be paid for at the lump sum price for "Grading".

6/23/16

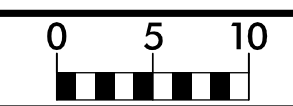

PROJ. REFERENCE NO.	SHEET NO.
U-6055	X-1

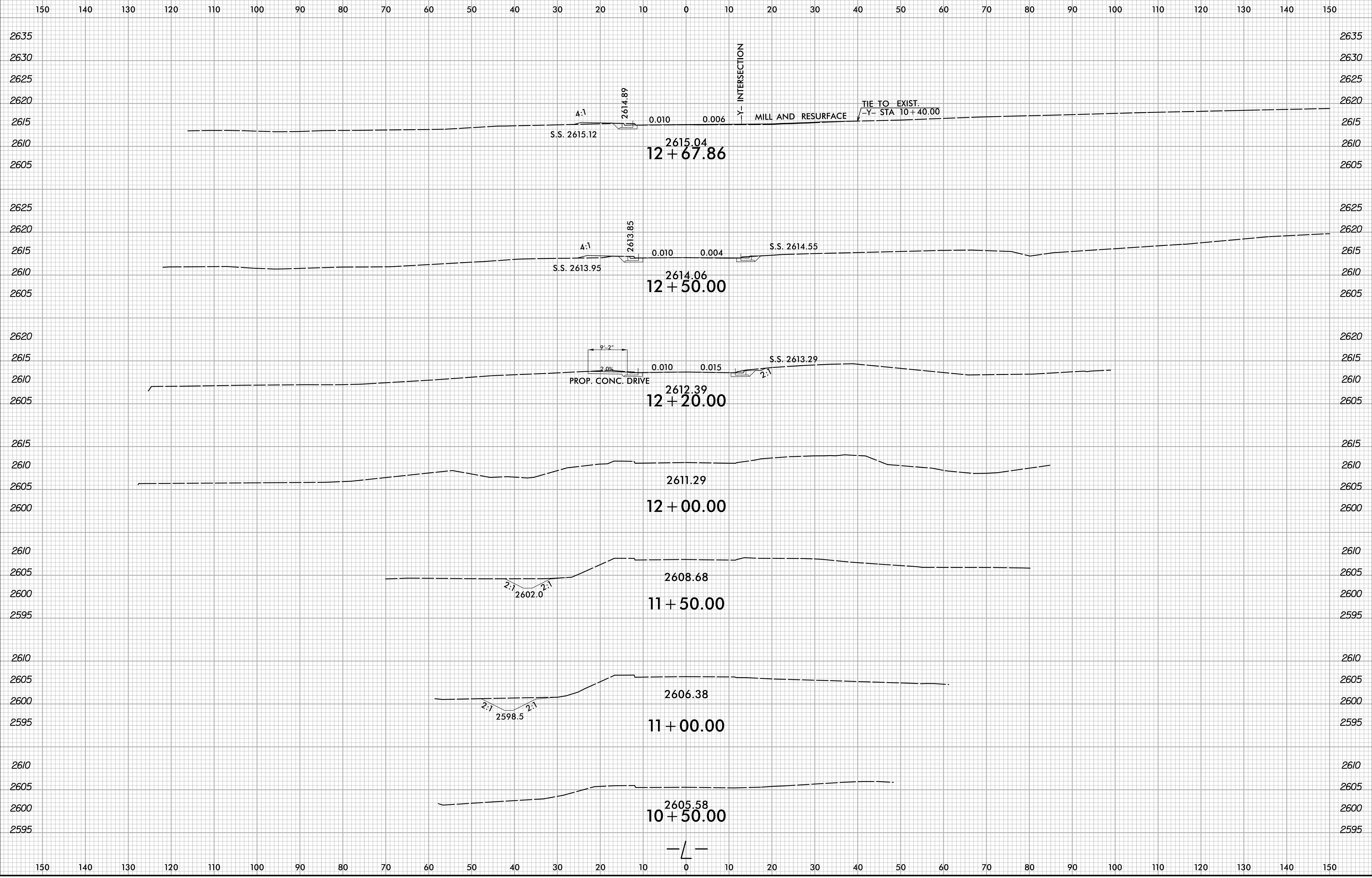

10/12/2018
X:\NCD00\U-6055_Roadway\XSC\U-6055_Rdy_xp1.L.dgn
User:sm1411

6/23/16

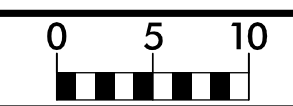

PROJ. REFERENCE NO.	SHEET NO.
U-6055	X-2

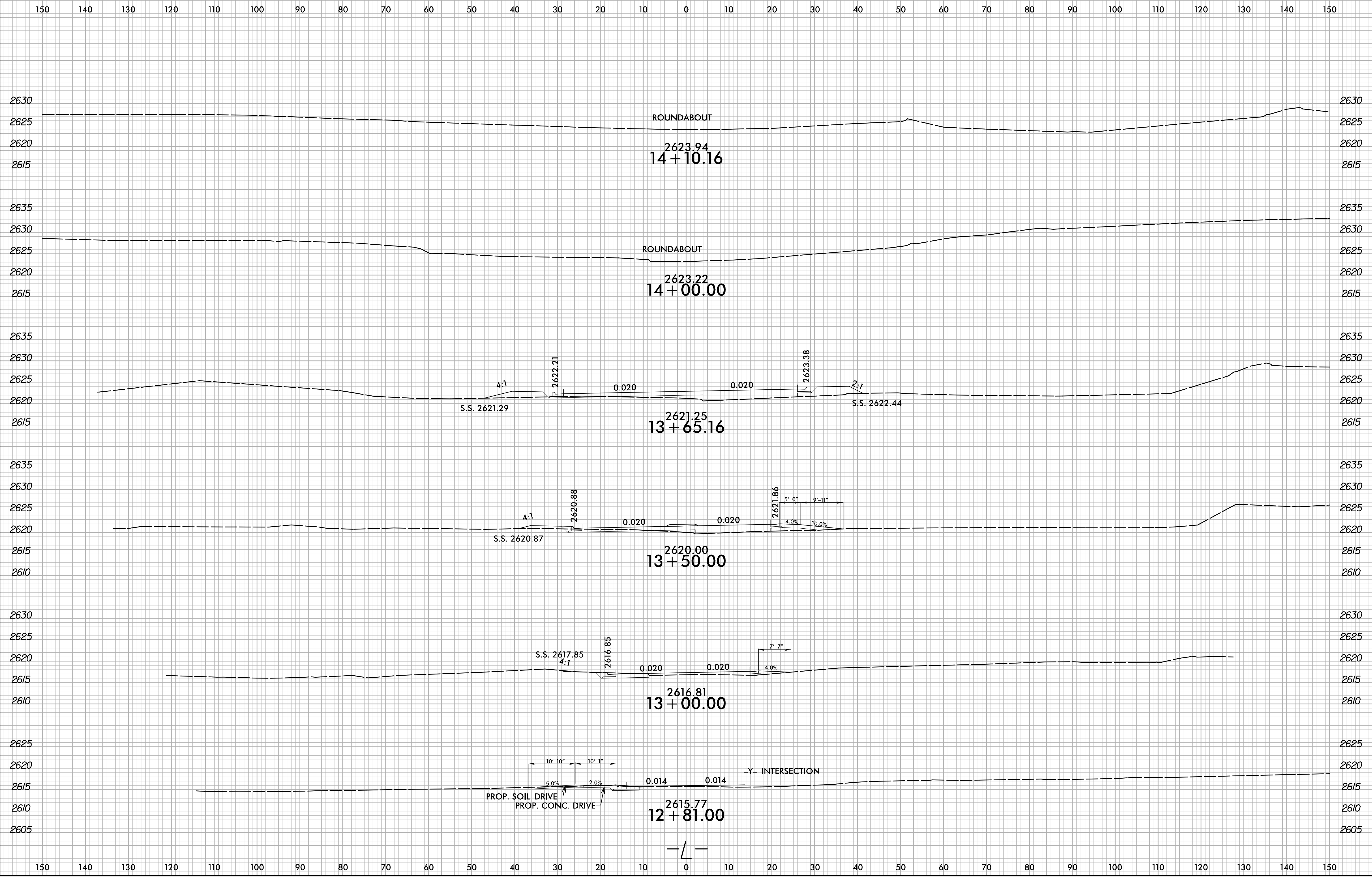

I:\12\2018\U-6055\Roadway\XSC\U-6055_Rdy_xp1.L.dgn
User:sm3\jrn

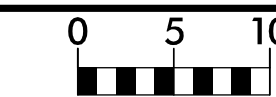

PROJ. REFERENCE NO. U-6055	SHEET NO. X-3
-------------------------------	------------------

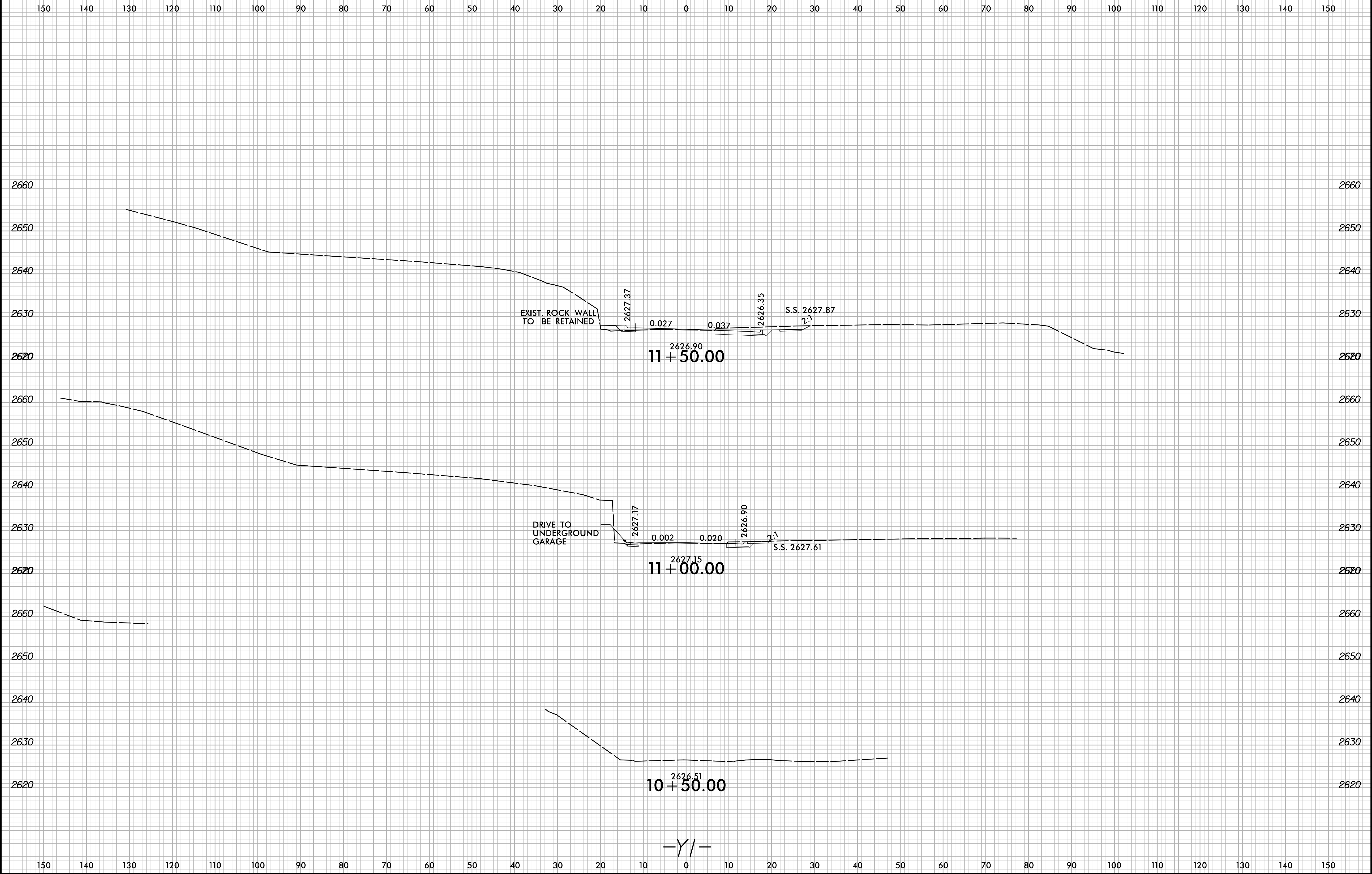

6/23/16

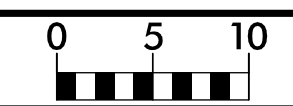

PROJ. REFERENCE NO.	SHEET NO.
U-6055	X-4

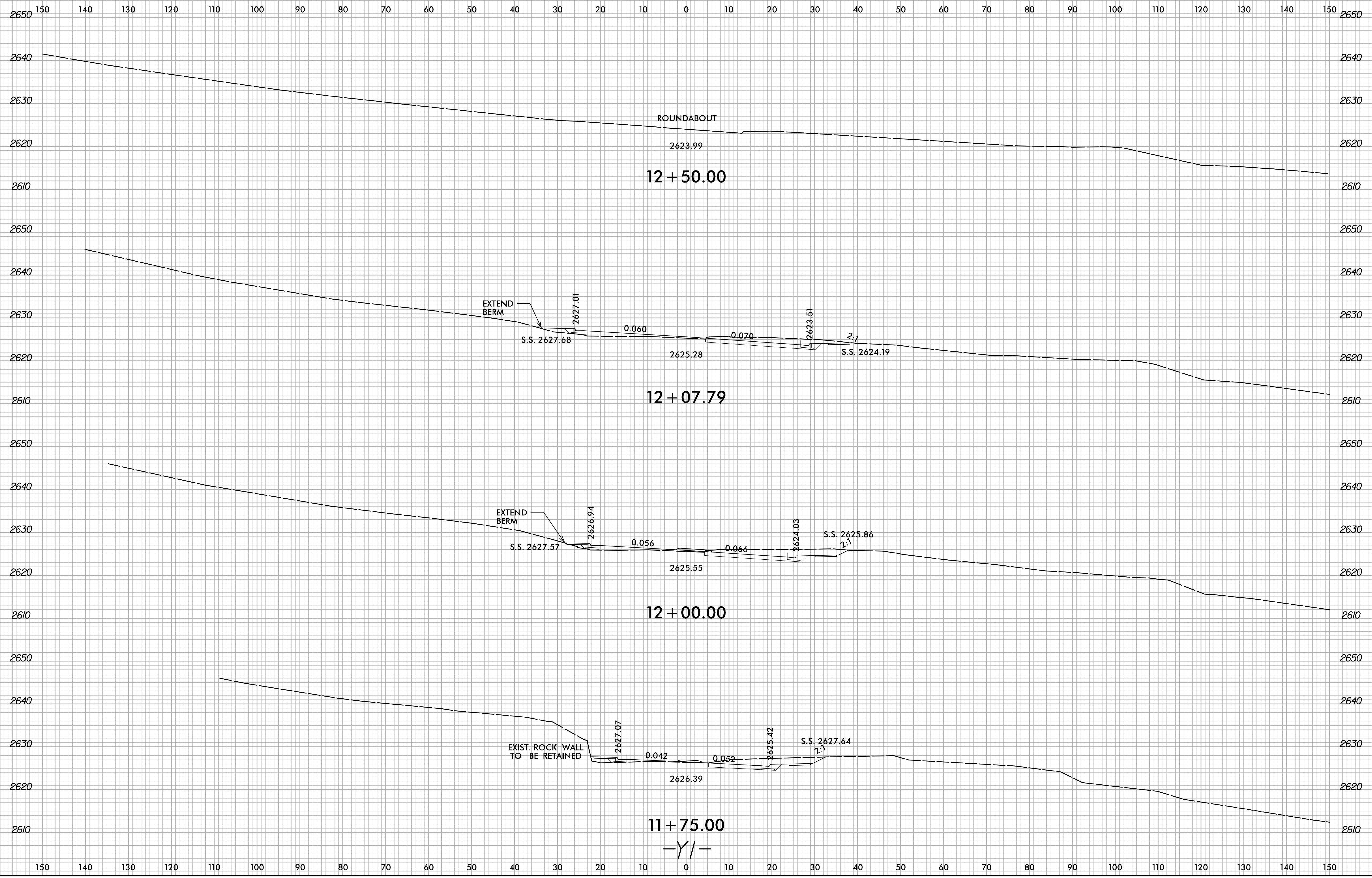

0/12/2018
X:\NCD00\U-6055\Roadway\XSC\U-6055_Rdy_xp1_Y1.dgn
User:smeylin

6/23/16

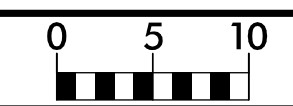

PROJ. REFERENCE NO.	SHEET NO.
U-6055	X-5

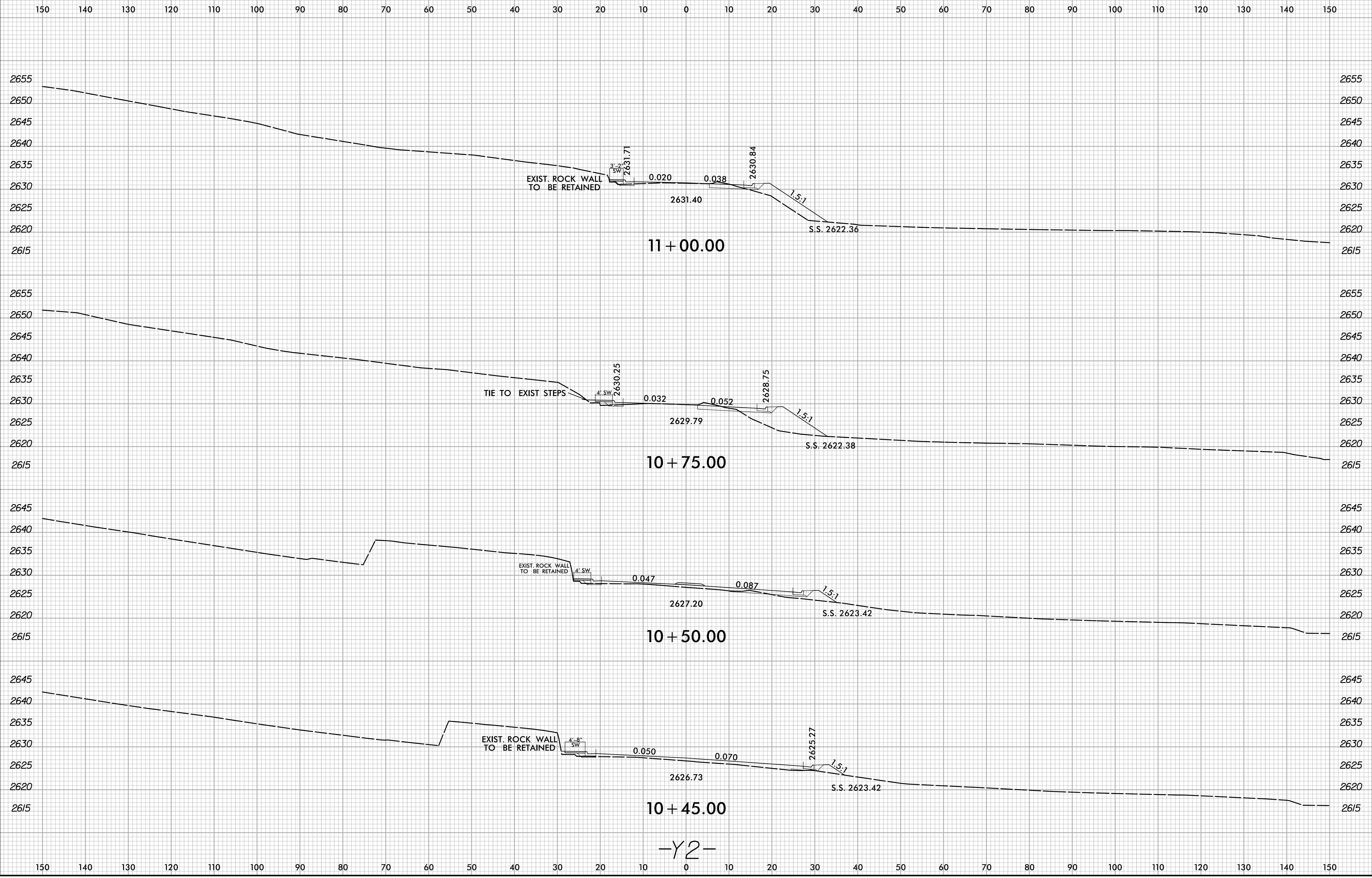

11 + 00.00

10 + 75.00

10 + 50.00

10 + 45.00

-Y2-

I:\12\2018\X\NC00\U-6055\Roadway\XSC\U-6055_Rdy-XP1_Y2.dgn
User:sm141m

6/23/16

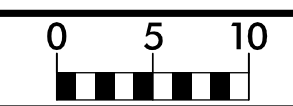

PROJ. REFERENCE NO.	SHEET NO.
U-6055	X-6

150 140 130 120 110 100 90 80 70 60 50 40 30 20 10 0 10 20 30 40 50 60 70 80 90 100 110 120 130 140 150

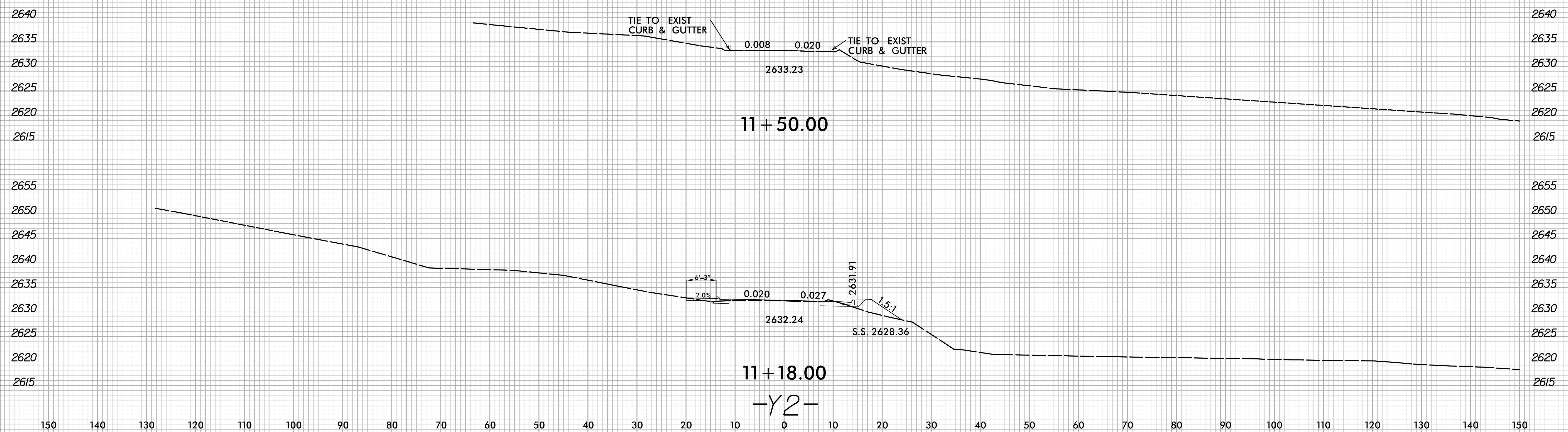

I:\12\2018
 \Users\jshim\My Documents\Projects\U-6055_Roadway\XSC\U-6055_Rdy_xp1_Y2.dgn
 User:jshim

150 140 130 120 110 100 90 80 70 60 50 40 30 20 10 0 10 20 30 40 50 60 70 80 90 100 110 120 130 140 150

6/23/16

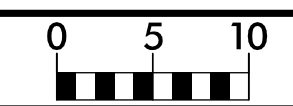

PROJ. REFERENCE NO.	SHEET NO.
U-6055	X-7

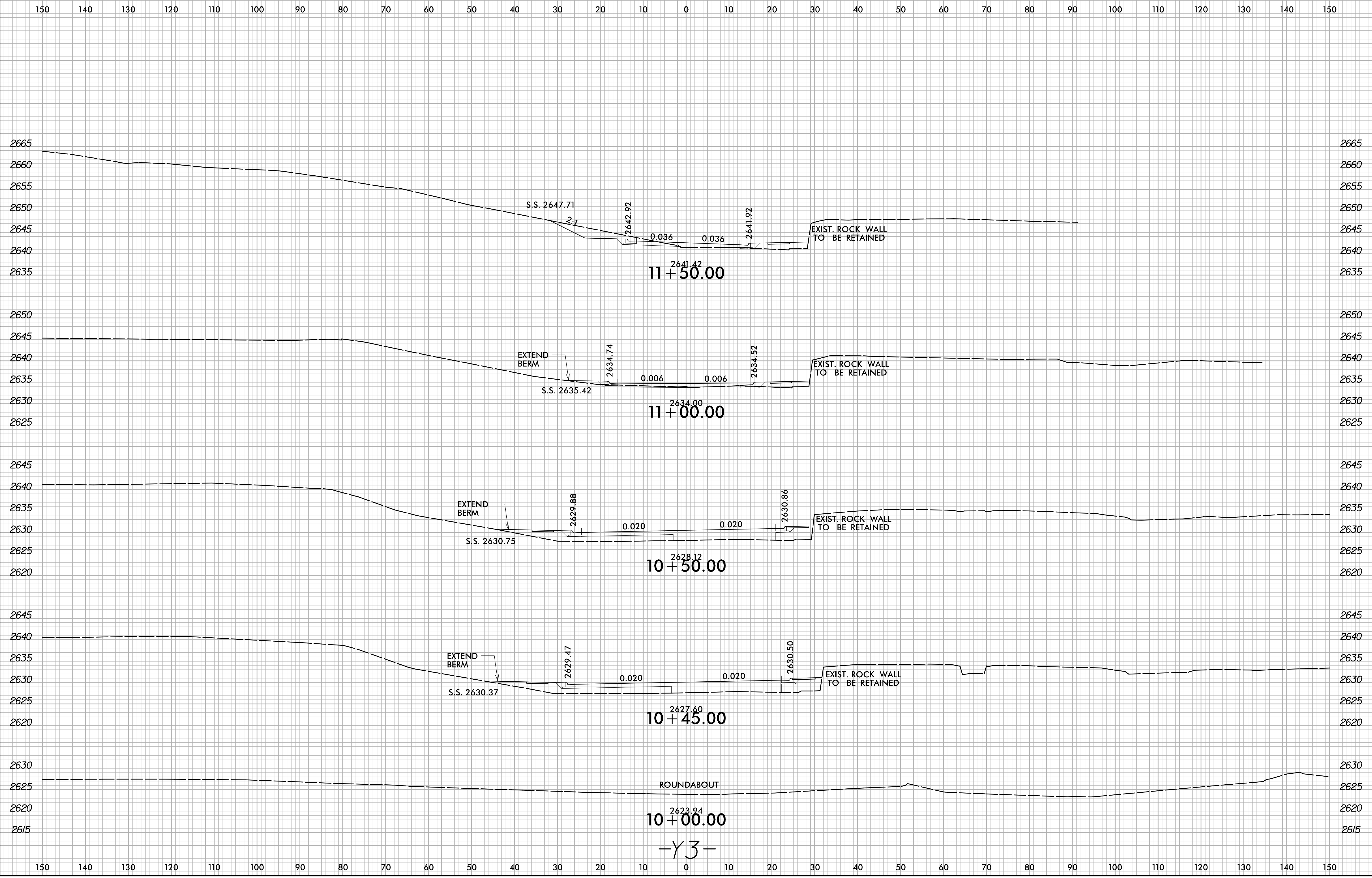

I:\12\2018\X:\NC00\U-6055\Roadway\XSC\U-6055_Rdy_xp1_Y3.dgn

-Y3-

6/23/16

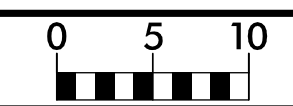

PROJ. REFERENCE NO.	SHEET NO.
U-6055	X-8

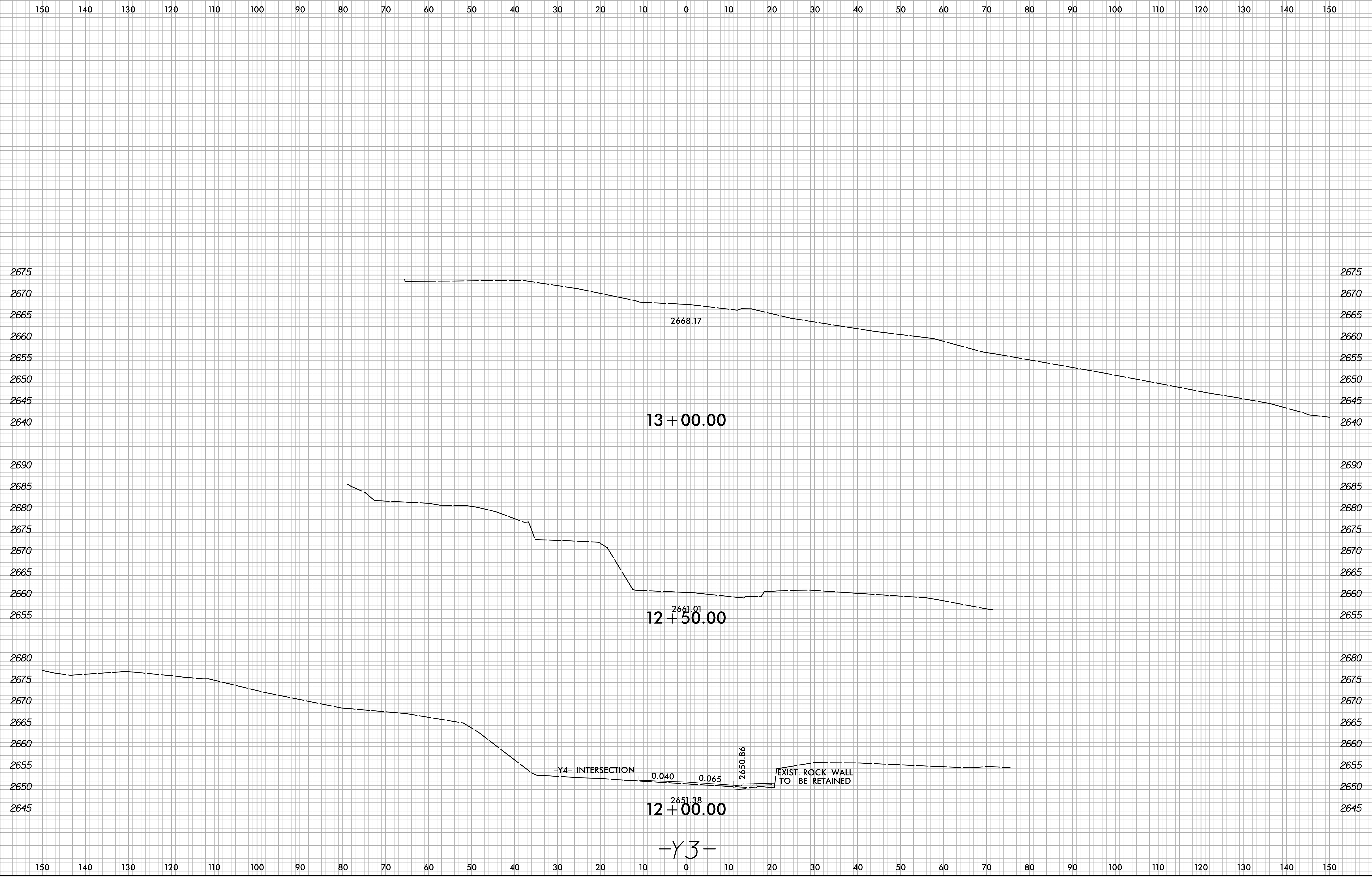

I:\12\2016\U-6055\Roadway\XSC\U-6055_Rdy_xpl_Y3.dgn
User:rsme1\m

150 140 130 120 110 100 90 80 70 60 50 40 30 20 10 0 10 20 30 40 50 60 70 80 90 100 110 120 130 140 150

-Y3-

12+00.00

12+50.00

13+00.00

2668.17

2661.01

2651.38

2650.86

-Y4- INTERSECTION

0.040

0.065

EXIST. ROCK WALL
TO BE RETAINED

2675
2670
2665
2660
2655
2650
2645
2640
2690
2685
2680
2675
2670
2665
2660
2655
2680
2675
2670
2665
2660
2655
2650
2645

2675
2670
2665
2660
2655
2650
2645
2640
2690
2685
2680
2675
2670
2665
2660
2655
2680
2675
2670
2665
2660
2655
2650
2645

6/23/16

0 5 10	PROJ. REFERENCE NO.	SHEET NO.
	U-6055	X-9



I:\12\2018\12\12\1000\U-6055\Roadway\XSC\U-6055_Rdy_xp1_Y4.dgn
User:smeylin

-Y4-

6/23/16

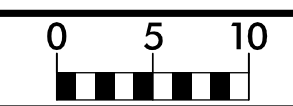

PROJ. REFERENCE NO.	SHEET NO.
U-6055	X-10

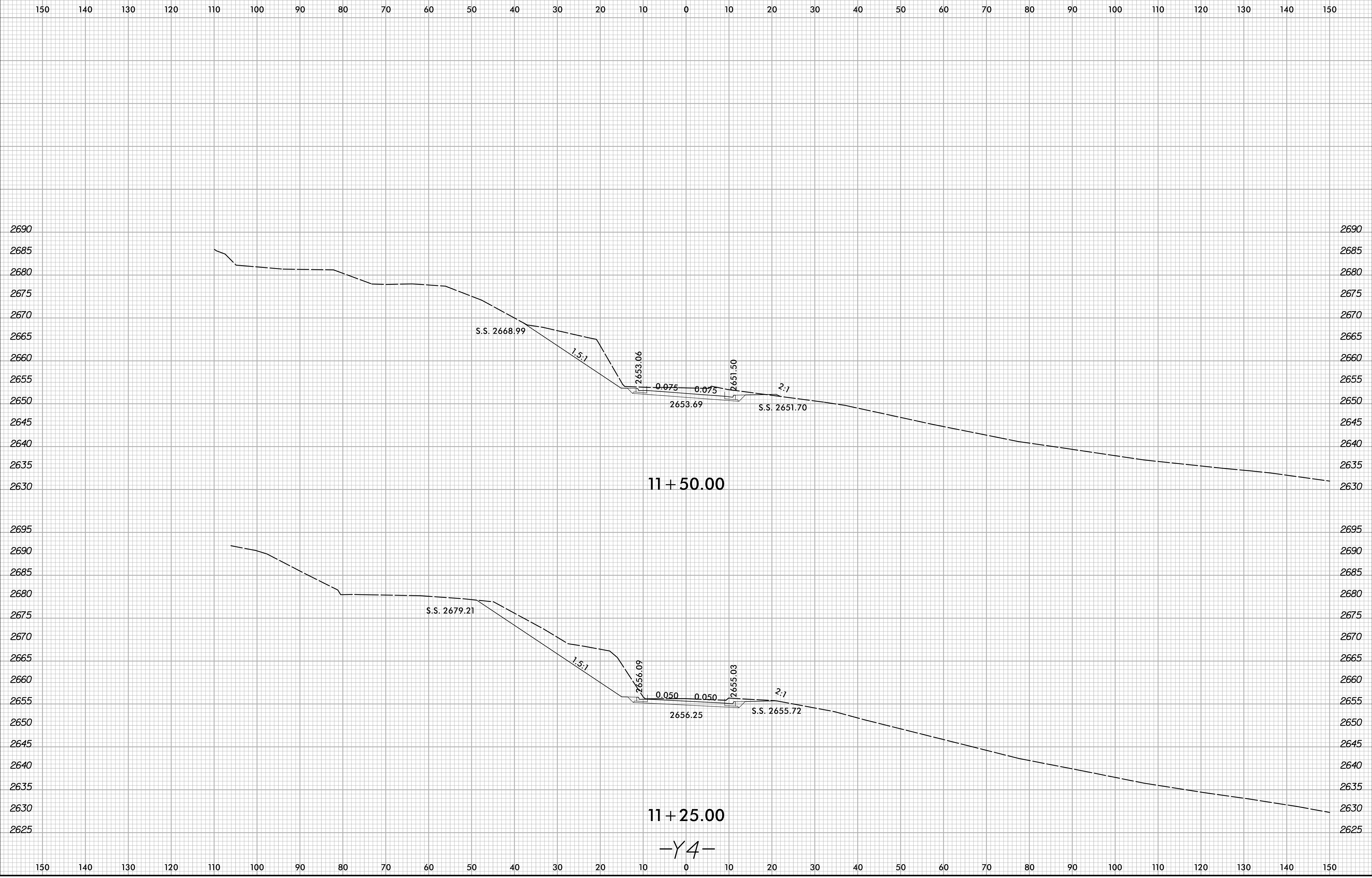

I:\12\2018
X:\NC00\U-6055\Roadway\XSC\U-6055_Rdy_xp1_Y4.dgn
User:sm1\jrn