

**This electronic collection of documents is provided
for the convenience of the user
and is Not a Certified Document –**

**The documents contained herein were originally issued
and sealed by the individuals whose names and license
numbers appear on each page, on the dates appearing
with their signature on that page.**

**This file or an individual page
shall not be considered a certified document.**

09/08/99

TIP PROJECT: U-4412

CONTRACT: DN00539

See Sheet 1-A For Index of Sheets

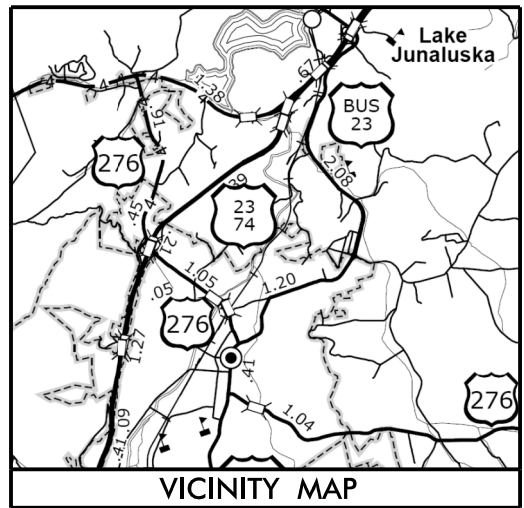

STATE OF NORTH CAROLINA
DIVISION OF HIGHWAYS

HAYWOOD COUNTY

LOCATION: SR-1184 (HOWELL MILL RD) 0.056 MILES
FROM BUS 1923

TYPE OF WORK: GRADING, PAVING, PAVEMENT MARKING AND
TRAFFIC CONTROL

STATE	STATE PROJECT REFERENCE NO.	SHEET NO.	TOTAL SHEETS
N.C.	U-4412	1	
STATE PROJ. NO.	F.A. PROJ. NO.	DESCRIPTION	
35022.3.FD1	STP-1184(4)		

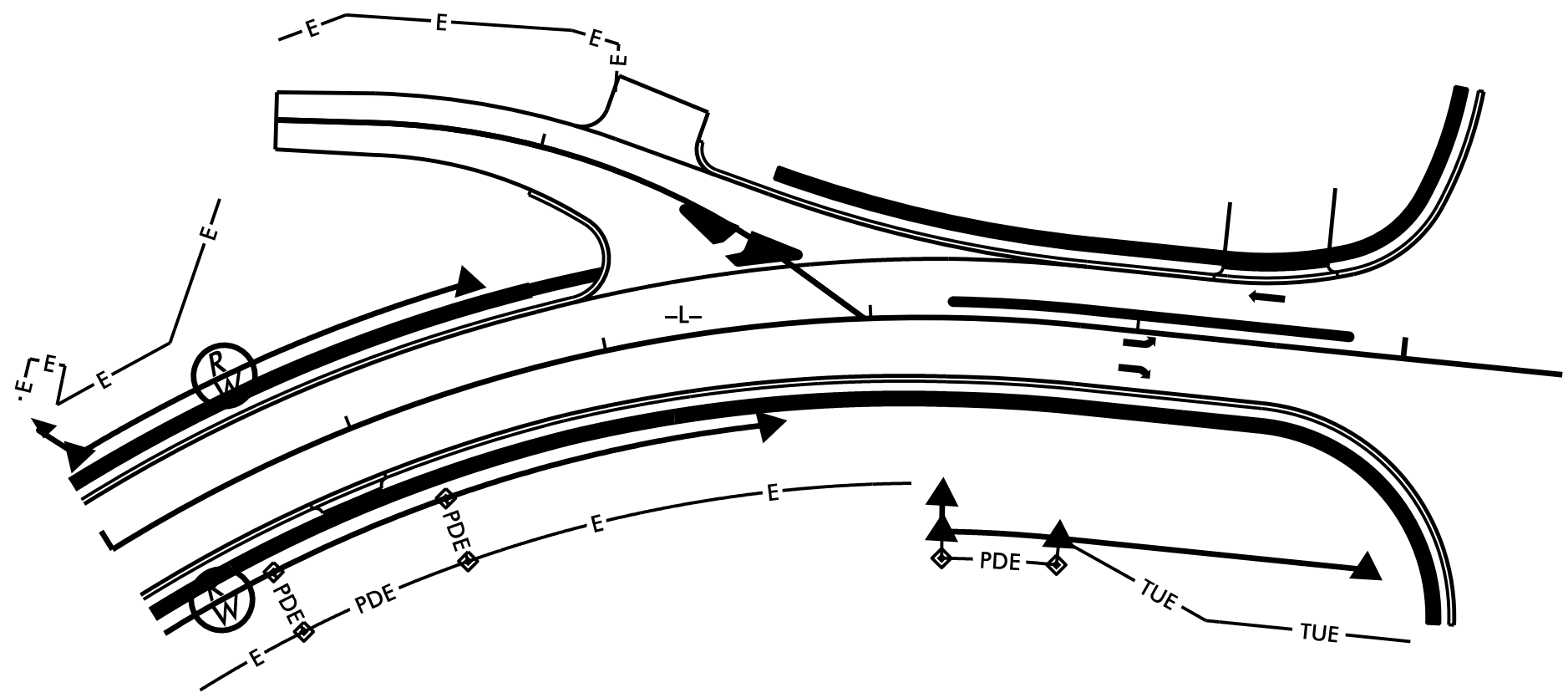

DOCUMENT NOT CONSIDERED FINAL
UNLESS ALL SIGNATURES COMPLETED

GRAPHIC SCALES

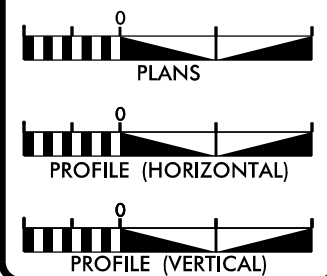

DESIGN DATA

ADT =
ADT =
K = %
D = %
T = % *
V = MPH
* TTST = DUAL
FUNC CLASS =

PROJECT LENGTH

LENGTH OF PROJECT: 200FT = .04 MILES

Prepared in the Office of:
DIVISION OF HIGHWAYS
1000 Birch Ridge Dr., Raleigh NC, 27610

2012 STANDARD SPECIFICATIONS

RIGHT OF WAY DATE:

LETTING DATE:

PROJECT ENGINEER

PROJECT DESIGN ENGINEER

HYDRAULICS ENGINEER

SIGNATURE: _____ P.E.

ROADWAY DESIGN ENGINEER

SIGNATURE: _____ P.E.

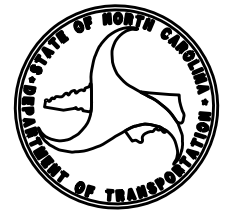

\$\$\$\$\$ SYSTEM \$\$\$\$\$\$
\$\$\$\$\$ DGN \$\$\$\$\$\$
\$\$\$\$\$ USERNAME \$\$\$\$\$\$

STATE OF NORTH CAROLINA, DIVISION OF HIGHWAYS CONVENTIONAL PLAN SHEET SYMBOLS

Note: Not to Scale *S.U.E. = *Subsurface Utility Engineering*

BOUNDARIES AND PROPERTY:

State Line	
County Line	
Township Line	
City Line	
Reservation Line	
Property Line	
Existing Iron Pin	
Property Corner	
Property Monument	
Parcel/Sequence Number	
Existing Fence Line	
Proposed Woven Wire Fence	
Proposed Chain Link Fence	
Proposed Barbed Wire Fence	
Existing Wetland Boundary	
Proposed Wetland Boundary	
Existing Endangered Animal Boundary	
Existing Endangered Plant Boundary	
Existing Historic Property Boundary	
Known Contamination Area: Soil	
Potential Contamination Area: Soil	
Known Contamination Area: Water	
Potential Contamination Area: Water	
Contaminated Site: Known or Potential	

BUILDINGS AND OTHER CULTURE:

Gas Pump Vent or U/G Tank Cap	
Sign	
Well	
Small Mine	
Foundation	
Area Outline	
Cemetery	
Building	
School	
Church	
Dam	

HYDROLOGY:

Stream or Body of Water	
Hydro, Pool or Reservoir	
Jurisdictional Stream	
Buffer Zone 1	
Buffer Zone 2	
Flow Arrow	
Disappearing Stream	
Spring	
Wetland	
Proposed Lateral, Tail, Head Ditch	
False Sump	

RAILROADS:

Standard Gauge	
RR Signal Milepost	
Switch	
RR Abandoned	
RR Dismantled	

RIGHT OF WAY:

Baseline Control Point	
Existing Right of Way Marker	
Existing Right of Way Line	
Proposed Right of Way Line	
Proposed Right of Way Line with Iron Pin and Cap Marker	
Proposed Right of Way Line with Concrete or Granite RW Marker	
Proposed Control of Access Line with Concrete C/A Marker	
Existing Control of Access	
Proposed Control of Access	
Existing Easement Line	
Proposed Temporary Construction Easement	
Proposed Temporary Drainage Easement	
Proposed Permanent Drainage Easement	
Proposed Permanent Drainage / Utility Easement	
Proposed Permanent Utility Easement	
Proposed Temporary Utility Easement	
Proposed Aerial Utility Easement	
Proposed Permanent Easement with Iron Pin and Cap Marker	

ROADS AND RELATED FEATURES:

Existing Edge of Pavement	
Existing Curb	
Proposed Slope Stakes Cut	
Proposed Slope Stakes Fill	
Proposed Curb Ramp	
Existing Metal Guardrail	
Proposed Guardrail	
Existing Cable Guiderail	
Proposed Cable Guiderail	
Equality Symbol	
Pavement Removal	

VEGETATION:

Single Tree	
Single Shrub	
Hedge	
Woods Line	

Orchard	
Vineyard	

EXISTING STRUCTURES:

MAJOR:	
Bridge, Tunnel or Box Culvert	
Bridge Wing Wall, Head Wall and End Wall	
MINOR:	
Head and End Wall	
Pipe Culvert	
Footbridge	
Drainage Box: Catch Basin, DI or JB	
Paved Ditch Gutter	
Storm Sewer Manhole	
Storm Sewer	

UTILITIES:

POWER:	
Existing Power Pole	
Proposed Power Pole	
Existing Joint Use Pole	
Proposed Joint Use Pole	
Power Manhole	
Power Line Tower	
Power Transformer	
U/G Power Cable Hand Hole	
H-Frame Pole	
U/G Power Line LOS B (S.U.E.*)	
U/G Power Line LOS C (S.U.E.*)	
U/G Power Line LOS D (S.U.E.*)	

TELEPHONE:

Existing Telephone Pole	
Proposed Telephone Pole	
Telephone Manhole	
Telephone Pedestal	
Telephone Cell Tower	
U/G Telephone Cable Hand Hole	
U/G Telephone Cable LOS B (S.U.E.*)	
U/G Telephone Cable LOS C (S.U.E.*)	
U/G Telephone Cable LOS D (S.U.E.*)	
U/G Telephone Conduit LOS B (S.U.E.*)	
U/G Telephone Conduit LOS C (S.U.E.*)	
U/G Telephone Conduit LOS D (S.U.E.*)	
U/G Fiber Optics Cable LOS B (S.U.E.*)	
U/G Fiber Optics Cable LOS C (S.U.E.*)	
U/G Fiber Optics Cable LOS D (S.U.E.*)	

WATER:

Water Manhole	
Water Meter	
Water Valve	
Water Hydrant	
U/G Water Line LOS B (S.U.E.*)	
U/G Water Line LOS C (S.U.E.*)	
U/G Water Line LOS D (S.U.E.*)	
Above Ground Water Line	

TV:

TV Pedestal	
TV Tower	
U/G TV Cable Hand Hole	
U/G TV Cable LOS B (S.U.E.*)	
U/G TV Cable LOS C (S.U.E.*)	
U/G TV Cable LOS D (S.U.E.*)	
U/G Fiber Optic Cable LOS B (S.U.E.*)	
U/G Fiber Optic Cable LOS C (S.U.E.*)	
U/G Fiber Optic Cable LOS D (S.U.E.*)	

GAS:

Gas Valve	
Gas Meter	
U/G Gas Line LOS B (S.U.E.*)	
U/G Gas Line LOS C (S.U.E.*)	
U/G Gas Line LOS D (S.U.E.*)	
Above Ground Gas Line	

SANITARY SEWER:

Sanitary Sewer Manhole	
Sanitary Sewer Cleanout	
U/G Sanitary Sewer Line	
Above Ground Sanitary Sewer	
SS Forced Main Line LOS B (S.U.E.*)	
SS Forced Main Line LOS C (S.U.E.*)	
SS Forced Main Line LOS D (S.U.E.*)	

MISCELLANEOUS:

Utility Pole	
Utility Pole with Base	
Utility Located Object	
Utility Traffic Signal Box	
Utility Unknown U/G Line LOS B (S.U.E.*)	
U/G Tank; Water, Gas, Oil	
Underground Storage Tank, Approx. Loc.	
A/G Tank; Water, Gas, Oil	
Geoenvironmental Boring	
U/G Test Hole LOS A (S.U.E.*)	
Abandoned According to Utility Records	
End of Information	

5/14/99

FINAL PAVEMENT SCHEDULE	
C1	PROP. APPROX. 3" ACSC, TYPE S9.5B
D1	PROP. APPROX. 4" ACIC, I19.0B
E1	PROP. APPROX. 4" ACBC, TYPE B25.0B
R1	2'-6" CONCRETE CURB AND GUTTER.
T	EARTH MATERIAL.

NOTE: PAVEMENT EDGE SLOPES ARE 1:1 UNLESS SHOWN OTHERWISE.

PROJECT REFERENCE NO. U-4412	SHEET NO. 2
RW SHEET NO.	
ROADWAY DESIGN ENGINEER	PAVEMENT DESIGN ENGINEER

CONSTR. REVISION (06/22/16) TLS: ADDED TYPICAL SECTION NOS. 9A & 9B FOR -Y11-

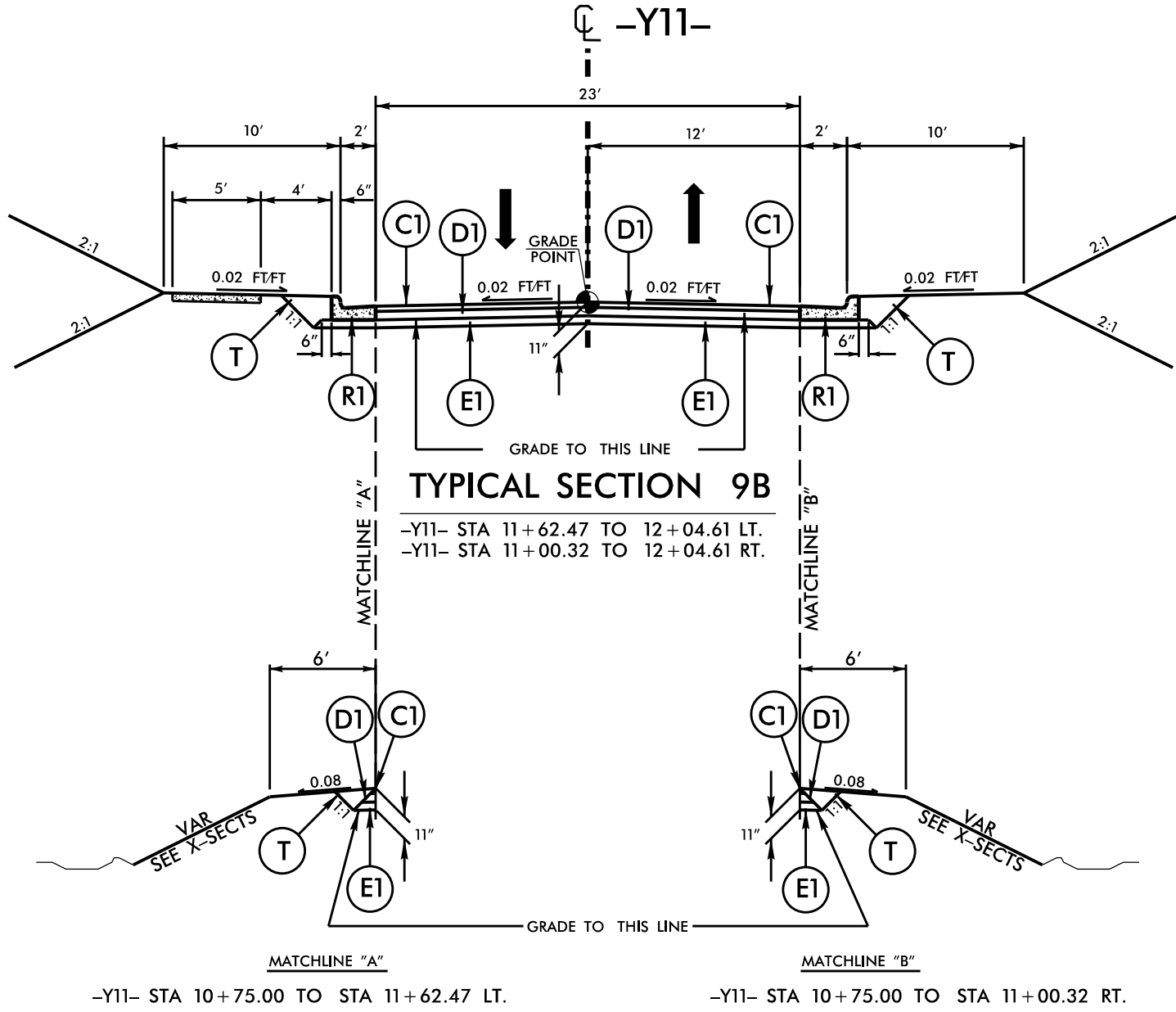

1
2
3
4
5
6
7
8
9
10
11
12
13
14
15
16
17
18
19
20
21
22
23
24
25
26
27
28
29
30
31
32
33
34
35
36
37
38
39
40
41
42
43
44
45
46
47
48
49
50
51
52
53
54
55
56
57
58
59
60
61
62
63
64
65
66
67
68
69
70
71
72
73
74
75
76
77
78
79
80
81
82
83
84
85
86
87
88
89
90
91
92
93
94
95
96
97
98
99
100

CONSTR. REVISION (06/22/16) TLS: REVISED HORIZONTAL ALIGNMENT AND INTERSECTION CONFIGURATION OF -EL- WITH -L- AND RENAMED NEW ALIGNMENT FOR -EL- AS -YII-. MOVED STRUCTURE NO. 95 OUT OF EMBANKMENT.
 RW REVISION (06/22/16) TLS: ADDED TCE TO PARCEL 45.

8/17/99

23-JUN-2016 13:33
 P:\Projects\4412\4412_rdy_psh_10.dgn
 PSH

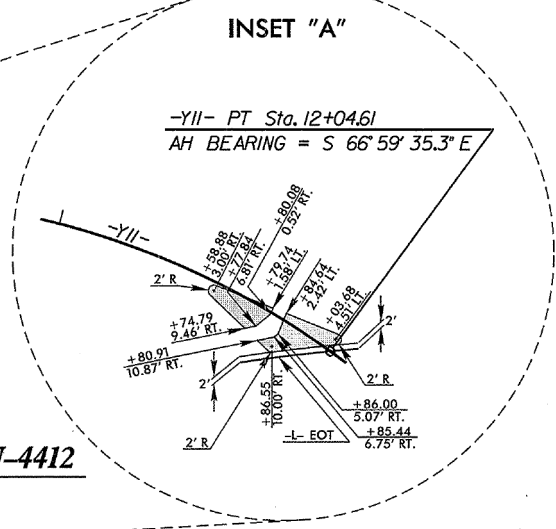
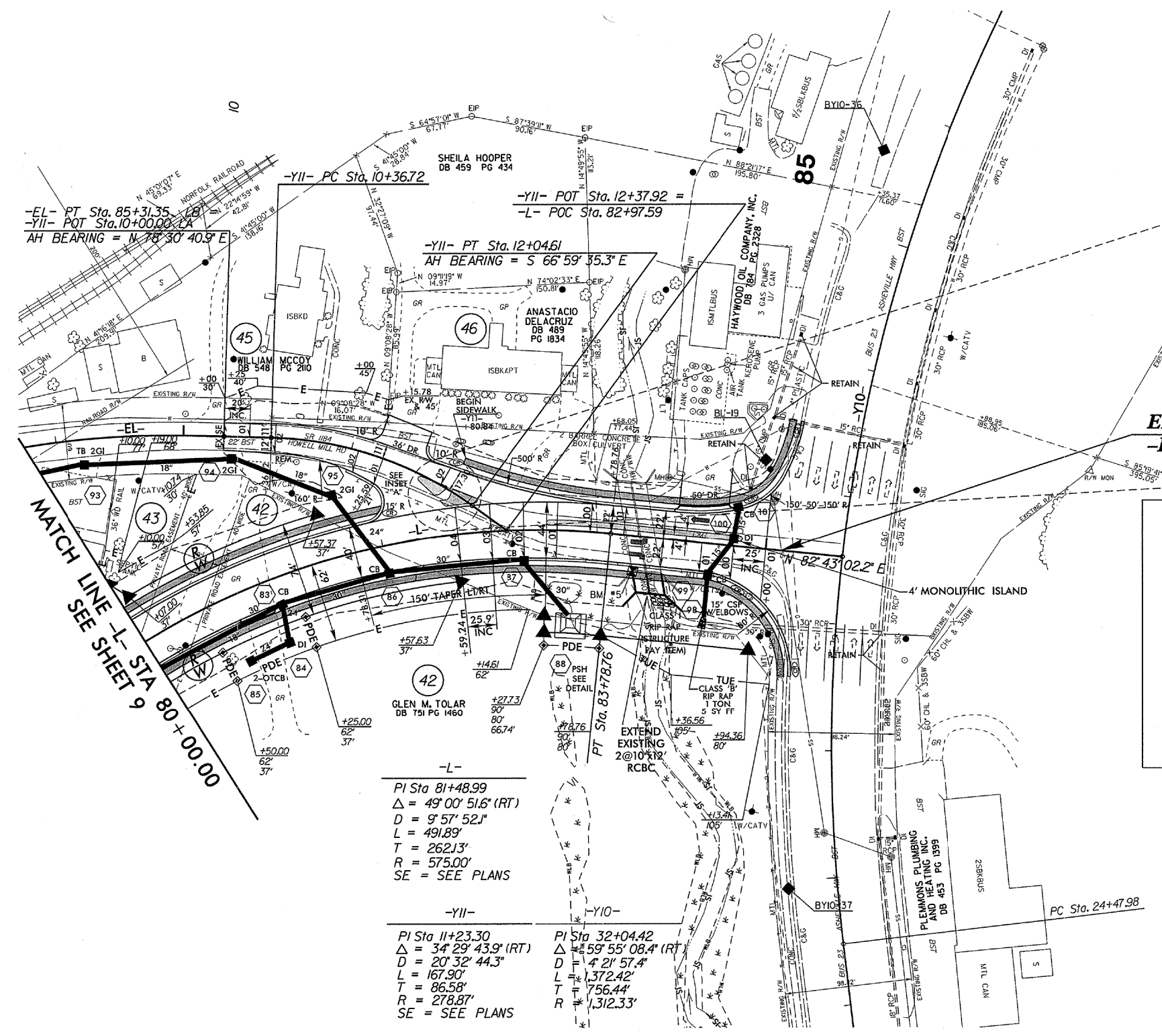

END TIP PROJECT U-4412
-L- STA 85 + 11.82

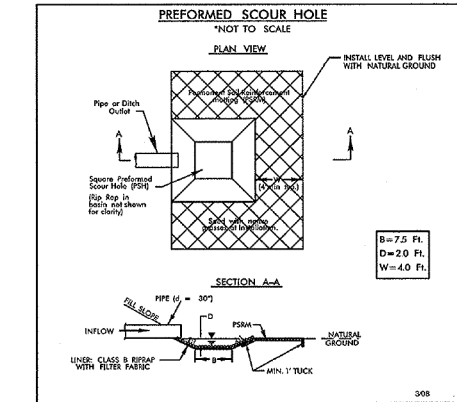

SR 1184 (HOWELL MILL ROAD) AT US 23 (ASHEVILLE HWY)

2013 ADT	13264
2033 ADT	17024

4464	1060	US 23
6224	1460	

11800
13800

FOR -L- PROFILE, SEE SHEET 15
 FOR -YII- PROFILE, SEE SHEET 17
 FOR CULVERT PLANS, SEE C-1 TO C-25

PROJECT REFERENCE NO. U-4412 SHEET NO. 4

R/W SHEET NO.

ROADWAY DESIGN ENGINEER: GARY R. LOVERING, PROFESSIONAL ENGINEER, NO. 225873

HYDRAULICS ENGINEER: MARE T. SHOWN, PROFESSIONAL ENGINEER, NO. 2020870

PAVEMENT REMOVAL

CONST. REVISION (06/22/16) TLS: ADDED PROFILE GRADE FOR -Y11-

5/28/99

23 JUN 2016 13:26 R:\PROJECTS\4412_r.dwg - pahl7.dgn

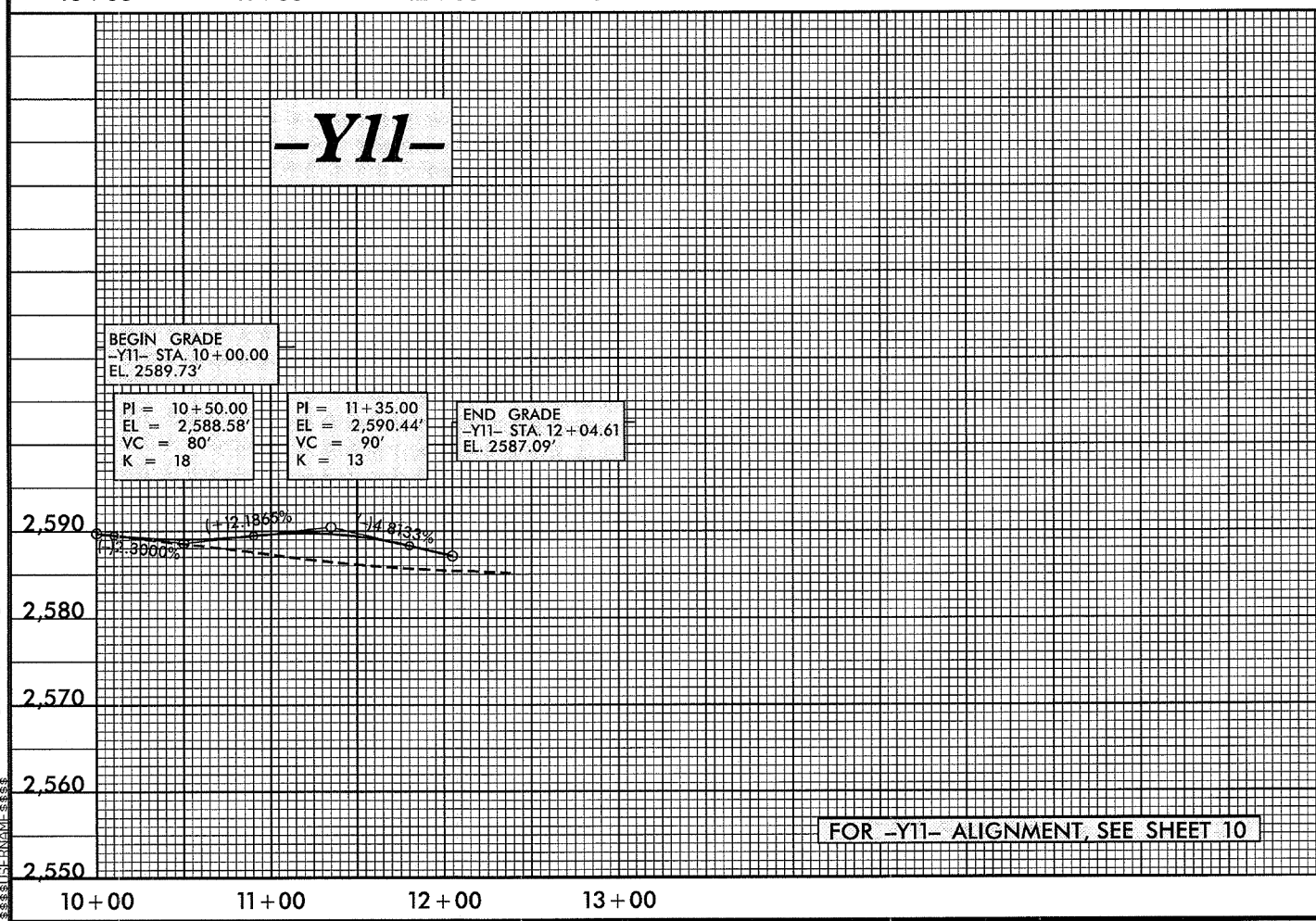
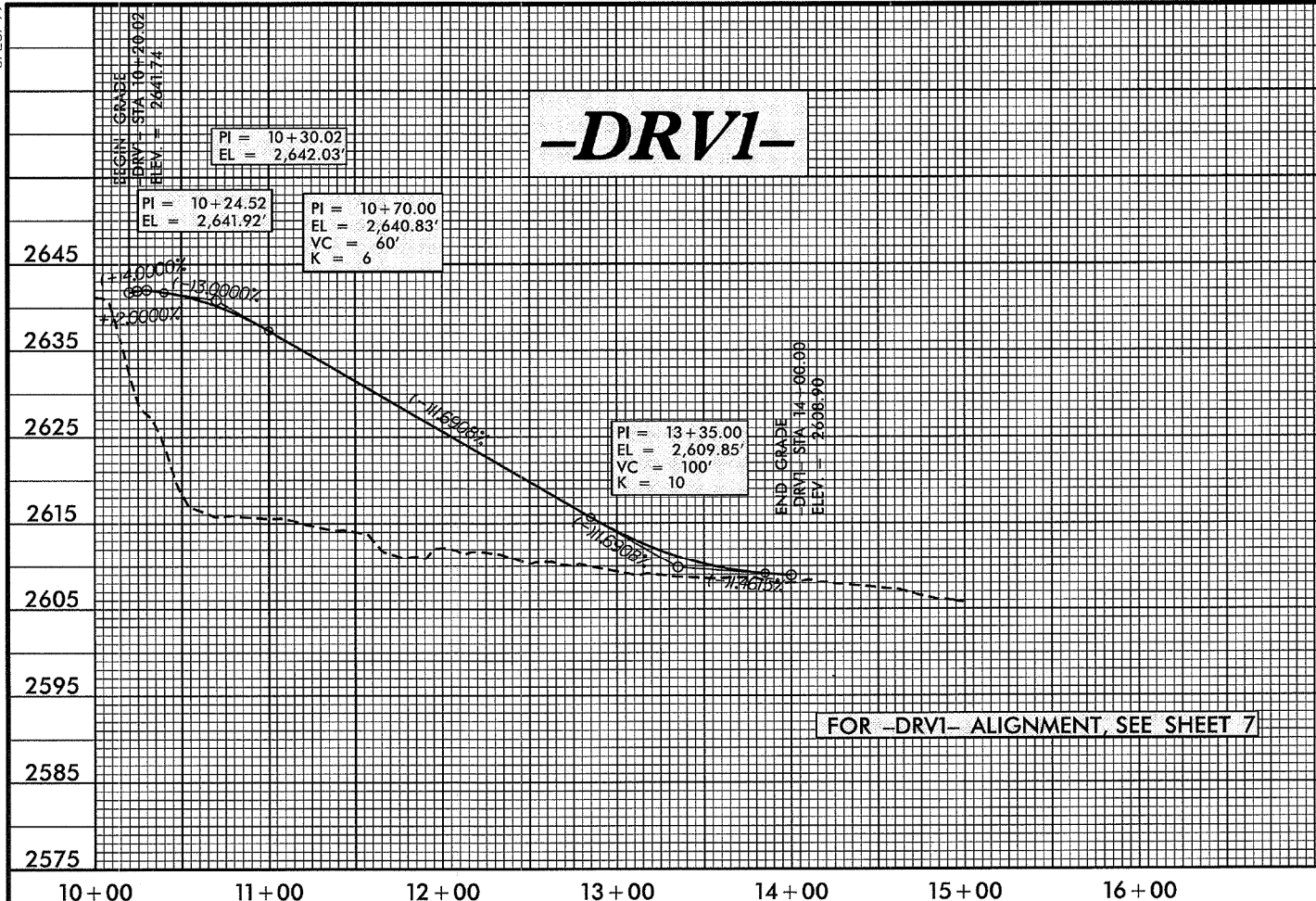

PROJECT REFERENCE NO. U-4412	SHEET NO. 5
ROADWAY DESIGN ENGINEER GARY LOVING PROFESSIONAL ENGINEER NO. 025873 STATE OF NORTH CAROLINA	HYDRAULICS ENGINEER MARC SHAW PROFESSIONAL ENGINEER NO. 020870 STATE OF NORTH CAROLINA

PAVEMENT MARKING SCHEDULE

FINAL PAVEMENT MARKINGS	
SYMBOL	DESCRIPTION PAINT
PA	WHITE EDGELINE
PI	YELLOW DOUBLE CENTER
PF	24" STOP BAR
PG	2' - 6' MINI SKIPS (WHITE)

NOTE: PEDESTRIAN CROSSWALK

PEDESTRIAN CROSSWALK TO USE THE FOLLOWING:
24" THERMOPLASTIC PAVEMENT MARKING (120 MIL)

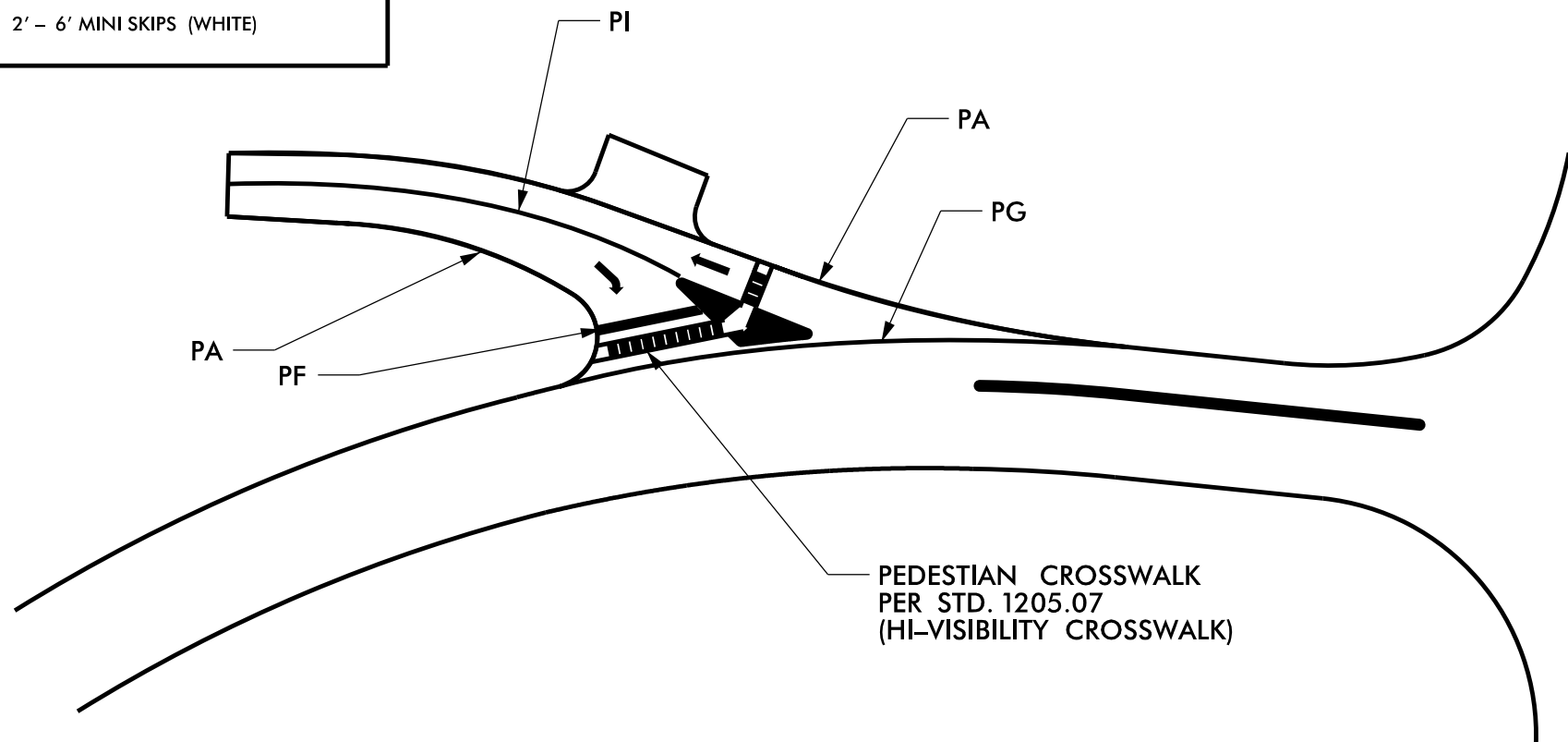

ROADWAY STANDARD DRAWINGS

THE FOLLOWING ROADWAY STANDARDS AS APPEAR IN "ROADWAY STANDARD DRAWINGS" - PROJECT SERVICES UNIT - N.C. DEPARTMENT OF TRANSPORTATION - RALEIGH, N.C., DATED JANUARY 2012 ARE APPLICABLE TO THIS PROJECT AND BY REFERENCE HEREBY ARE CONSIDERED AS PART OF THESE PLANS:

STD. NO.	TITLE
1205.01	PAVEMENT MARKINGS - LINE TYPES AND OFFSETS
1205.02	PAVEMENT MARKINGS - TWO-LANE AND MULTILANE ROADWAYS
1205.07	PAVEMENT MARKINGS - PEDESTRIAN CROSSWALKS

GENERAL NOTES

THE FOLLOWING GENERAL NOTES APPLY AT ALL TIMES FOR THE DURATION OF THE CONSTRUCTION PROJECT, EXCEPT WHEN OTHERWISE NOTED IN THE PLAN, OR DIRECTED BY THE ENGINEER.

A) INSTALL PAVEMENT MARKINGS AND PAVEMENT MARKERS ON THE FINAL SURFACE AS FOLLOWS:

ROAD NAME	MARKING	MARKER
ENTRANCE TO EVERGREEN PACKAGING	PAINT	NONE

B) PLACE TWO APPLICATIONS OF PAINT PAVEMENT MARKINGS ON THE FINAL WEARING SURFACE. PLACE THE SECOND APPLICATION OF PAINT UPON SUFFICIENT DRYING TIME OF THE FIRST.

C) TIE PROPOSED PAVEMENT MARKING LINES TO EXISTING PAVEMENT MARKING LINES.

D) REMOVE/REPLACE ANY CONFLICTING/DAMAGED PAVEMENT MARKINGS AND MARKERS

REVISIONS

8/17/99
SYSTEMS DESIGN
CONSTRUCTION
MANAGEMENT