

NORTH CAROLINA DEPARTMENT OF  
TRANSPORTATION  
DIVISION OF HIGHWAYS  
PROJECT DEVELOPMENT &  
ENVIRONMENTAL ANALYSIS UNIT



**17BP.2.R.79  
REPLACE BRIDGE 124 ON SR 1550  
OVER BRIERY SWAMP  
PITT COUNTY**

VICINITY MAP

FIGURE 1

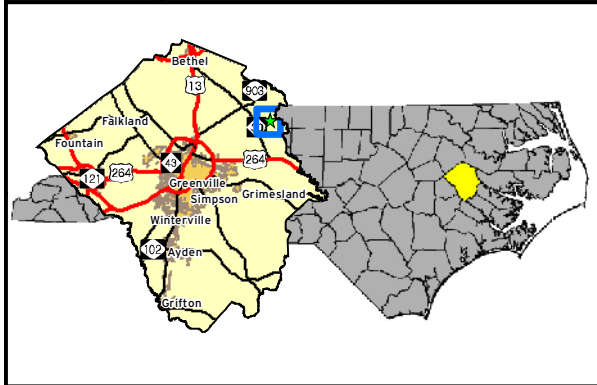

	<p>NORTH CAROLINA DEPARTMENT OF TRANSPORTATION DIVISION OF HIGHWAYS PROJECT DEVELOPMENT &amp; ENVIRONMENTAL ANALYSIS UNIT</p>	
<p><b>17BP.2.R.79 REPLACE BRIDGE 124 ON SR 1550 OVER BRIERY SWAMP PITT COUNTY</b></p>		
<p>USGS MAP</p>		<p>FIGURE 2</p>

Source: USGS 7.5 Minute Quadrangle, Leggetts Crossroads, NC

## RIPARIAN BUFFER IMPACTS SUMMARY

			IMPACT									BUFFER REPLACEMENT	
SITE NO.	STRUCTURE SIZE / TYPE	STATION (FROM/TO)	TYPE			ALLOWABLE			MITIGABLE			ZONE 1 (ft <sup>2</sup> )	ZONE 2 (ft <sup>2</sup> )
			ROAD CROSSING	BRIDGE	PARALLEL IMPACT	ZONE 1 (ft <sup>2</sup> )	ZONE 2 (ft <sup>2</sup> )	TOTAL (ft <sup>2</sup> )	ZONE 1 (ft <sup>2</sup> )	ZONE 2 (ft <sup>2</sup> )	TOTAL (ft <sup>2</sup> )		
1	Bridge	-L- 15+90 to 17+40		x		1832	897	2728					
<b>TOTAL:</b>						1832	897	2728	0	0	0	0	0

N.C. DEPT. OF TRANSPORTATION  
DIVISION OF HIGHWAYS

Pitt County Bridge No. 124  
SF-730124  
17BP.2.R.79

November 22, 2017

SHEET 3 OF 17

## WETLANDS IN BUFFER IMPACTS SUMMARY

SITE NO.	STATION (FROM/TO)	WETLANDS IN BUFFERS	
		ZONE 1 (ft <sup>2</sup> )	ZONE 2 (ft <sup>2</sup> )
1	-L- 15+90 to 17+40	1806	743
<b>TOTAL:</b>		1806	743

N.C. DEPT. OF TRANSPORTATION  
 DIVISION OF HIGHWAYS  
  
 Pitt County Bridge No. 124  
 SF-730124  
 17BP.2.R.79  
  
 November 22, 2017  
 SHEET 4 OF 17

**WETLAND AND SURFACE WATER IMPACTS SUMMARY**

Site No.	Station (From/To)	Structure Size / Type	WETLAND IMPACTS					SURFACE WATER IMPACTS				
			Permanent Fill In Wetlands (ac)	Temp. Fill In Wetlands (ac)	Excavation in Wetlands (ac)	Mechanized Clearing in Wetlands (ac)	Hand Clearing in Wetlands (ac)	Permanent SW impacts (ac)	Temp. SW impacts (ac)	Existing Channel Impacts Permanent (ft)	Existing Channel Impacts Temp. (ft)	Natural Stream Design (ft)
	-L- 15+00 to 18+80	Bridge	0.017			0.016	0.094					
<b>TOTALS*:</b>			0.017	0.000	0.000	0.016	0.094	0.000	0.000	0.000	0.000	0.000

\*Rounded totals are sum of actual impacts

NOTES:  
 Interior bents to be removed are wooden piles that may be cut or pulled.  
 Floating turbidity curtain to be used to isolate end bents and abutments during construction.  
 Impervious dike used to dewater for construction of and around proposed bents.

NC DEPARTMENT OF TRANSPORTATION  
 DIVISION OF HIGHWAYS  
 November 22, 2017  
 Pitt County Bridge No. 124  
 SF-730124  
 17BP.2.R.79  
 SHEET 5 OF 17

# STATE OF NORTH CAROLINA, DIVISION OF HIGHWAYS CONVENTIONAL PLAN SHEET SYMBOLS

Note: Not to Scale

\*S.U.E. = Subsurface Utility Engineering

### BOUNDARIES AND PROPERTY:

State Line	-----
County Line	-----
Township Line	-----
City Line	-----
Reservation Line	-----
Property Line	-----
Existing Iron Pin	○ EP
Property Corner	✕
Property Monument	□ EGM
Parcel/Sequence Number	①23
Existing Fence Line	-x-x-x-
Proposed Woven Wire Fence	○
Proposed Chain Link Fence	□
Proposed Barbed Wire Fence	◇
Existing Wetland Boundary	-w.l.b.-
Proposed Wetland Boundary	-w.l.b.-
Existing Endangered Animal Boundary	-E.A.B.-
Existing Endangered Plant Boundary	-E.P.B.-
Existing Historic Property Boundary	-H.P.B.-
Known Contamination Area: Soil	-----
Potential Contamination Area: Soil	-----
Known Contamination Area: Water	-----
Potential Contamination Area: Water	-----
Contaminated Site: Known or Potential	☠ ?

### BUILDINGS AND OTHER CULTURE:

Gas Pump Vent or U/G Tank Cap	○
Sign	○ S
Well	○ W
Small Mine	✕
Foundation	□
Area Outline	□
Cemetery	□ †
Building	□
School	□
Church	□
Dam	□

### HYDROLOGY:

Stream or Body of Water	-----
Hydro, Pool or Reservoir	-----
Jurisdictional Stream	----- JS
Buffer Zone 1	----- BZ 1
Buffer Zone 2	----- BZ 2
Flow Arrow	←
Disappearing Stream	→
Spring	○
Wetland	-----
Proposed Lateral, Tail, Head Ditch	-----
False Sump	-----

### RAILROADS:

Standard Gauge	-----
RR Signal Milepost	○ MILEPOST 35
Switch	□ SWITCH
RR Abandoned	-----
RR Dismantled	-----

### RIGHT OF WAY:

Baseline Control Point	◆
Existing Right of Way Marker	△
Existing Right of Way Line	-----
Proposed Right of Way Line	----- R/W
Proposed Right of Way Line with Iron Pin and Cap Marker	----- R/W ▲
Proposed Right of Way Line with Concrete or Granite RW Marker	----- R/W ▲
Proposed Control of Access Line with Concrete C/A Marker	----- C/A
Existing Control of Access	----- C/A
Proposed Control of Access	----- C/A
Existing Easement Line	----- E
Proposed Temporary Construction Easement	----- E
Proposed Temporary Drainage Easement	----- TDE
Proposed Permanent Drainage Easement	----- PDE
Proposed Permanent Drainage / Utility Easement	----- DUE
Proposed Permanent Utility Easement	----- PUE
Proposed Temporary Utility Easement	----- TUE
Proposed Aerial Utility Easement	----- AUE
Proposed Permanent Easement with Iron Pin and Cap Marker	----- ◆

### ROADS AND RELATED FEATURES:

Existing Edge of Pavement	-----
Existing Curb	-----
Proposed Slope Stakes Cut	----- C
Proposed Slope Stakes Fill	----- F
Proposed Curb Ramp	----- (CR)
Existing Metal Guardrail	-----
Proposed Guardrail	-----
Existing Cable Guiderail	-----
Proposed Cable Guiderail	-----
Equality Symbol	⊕
Pavement Removal	-----

### VEGETATION:

Single Tree	☼
Single Shrub	☼
Hedge	-----
Woods Line	-----

Orchard	☼ ☼ ☼ ☼
Vineyard	□ Vineyard

### EXISTING STRUCTURES:

MAJOR:	
Bridge, Tunnel or Box Culvert	----- CONC
Bridge Wing Wall, Head Wall and End Wall	----- CONC WW
MINOR:	
Head and End Wall	----- CONC HW
Pipe Culvert	-----
Footbridge	-----
Drainage Box: Catch Basin, DI or JB	□ CB
Paved Ditch Gutter	-----
Storm Sewer Manhole	⊕
Storm Sewer	----- S

### UTILITIES:

POWER:	
Existing Power Pole	●
Proposed Power Pole	○
Existing Joint Use Pole	●
Proposed Joint Use Pole	○
Power Manhole	⊕
Power Line Tower	⊗
Power Transformer	⊗
U/G Power Cable Hand Hole	●
H-Frame Pole	●
U/G Power Line LOS B (S.U.E.*)	----- P
U/G Power Line LOS C (S.U.E.*)	----- P
U/G Power Line LOS D (S.U.E.*)	----- P

### TELEPHONE:

Existing Telephone Pole	●
Proposed Telephone Pole	○
Telephone Manhole	⊕
Telephone Pedestal	⊕
Telephone Cell Tower	⊕
U/G Telephone Cable Hand Hole	⊕
U/G Telephone Cable LOS B (S.U.E.*)	----- T
U/G Telephone Cable LOS C (S.U.E.*)	----- T
U/G Telephone Cable LOS D (S.U.E.*)	----- T
U/G Telephone Conduit LOS B (S.U.E.*)	----- TC
U/G Telephone Conduit LOS C (S.U.E.*)	----- TC
U/G Telephone Conduit LOS D (S.U.E.*)	----- TC
U/G Fiber Optics Cable LOS B (S.U.E.*)	----- T FO
U/G Fiber Optics Cable LOS C (S.U.E.*)	----- T FO
U/G Fiber Optics Cable LOS D (S.U.E.*)	----- T FO

### EROSION AND SEDIMENT CONTROL MEASURES

Std. #	Description	Symbol
1630.05	Temporary Silt Ditch	-----
1630.05	Temporary Diversion	----- TD
1605.01	Temporary Silt Fence	-----
1606.01	Special Sediment Control Fence	-----
1622.01	Temporary Berms and Slope Drains	-----
1630.02	Silt Basin Type B	-----
1635.01	Temporary Rock Silt Check Type-A	-----
1635.02	Temporary Rock Silt Check Type-A with Matting and Polyacrylamide (PAM)	-----
1635.02	Temporary Rock Silt Check Type-B	-----
1635.02	Wattle / Coir Fiber Wattle	-----
1635.02	Wattle / Coir Fiber Wattle with Polyacrylamide (PAM)	-----
1634.01	Temporary Rock Sediment Dam Type-A	-----
1634.02	Temporary Rock Sediment Dam Type-B	-----
1635.01	Rock Pipe Inlet Sediment Trap Type-A	-----
1635.02	Rock Pipe Inlet Sediment Trap Type-B	-----
1630.04	Stilling Basin	-----
1630.06	Special Stilling Basin	-----
1632.01	Rock Inlet Sediment Trap: Type A	----- A
1632.02	Type B	----- B
1632.03	Type C	----- C
	Skimmer Basin	-----
	Tiered Skimmer Basin	-----
	Infiltration Basin	-----

PLANS PREPARED BY :

**RK&K**  
 RUMMEL, KLEPPER & KAHL, LLP  
 900 RIDGEFIELD DRIVE SUITE 350  
 RALEIGH, NORTH CAROLINA 27609-3960  
 NC LICENSE NO. F-0112 • (919) 878-9560

8/17/99

PROJECT REFERENCE NO. 17BP.2.R.79	SHEET NO. 2D-1
HYDRAULIC DESIGN ENGINEER	
<b>PERMIT DRAWING SHEET 7 OF 17</b>	

# DRAINAGE DETAILS

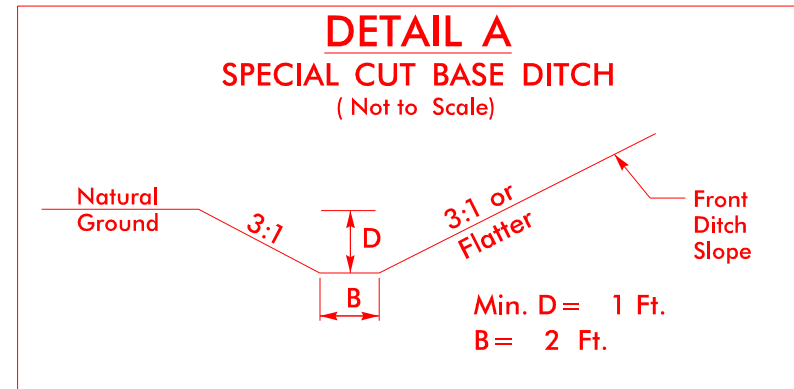

FROM -L- STA. 18+50 TO STA. 19+50 LT

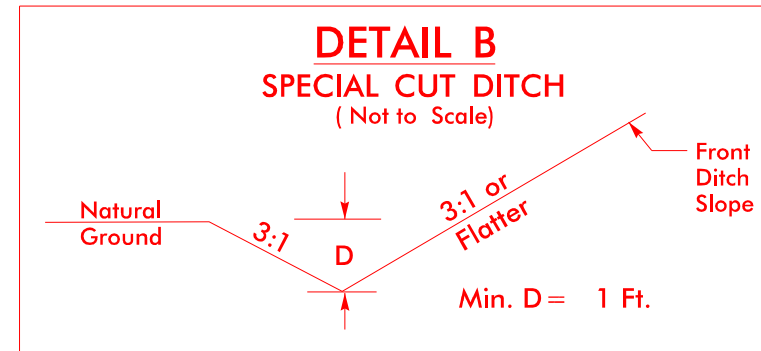

FROM -L- STA. 18+50 TO STA. 19+70 RT

I:\22\2017  
R\Hydro\Utilities\PERMITS-Environmental\Drawings\730124\_Hyd-prm-psh\_details.dgn  
8/17/99

PLANS PREPARED BY :

**RK&K**

RUMMEL, KLEPPER & KAHL, LLP  
900 RIDGEFIELD DRIVE SUITE 350  
RALEIGH, NORTH CAROLINA 27609-3960  
NC LICENSE NO. F-0112 • (919) 878-9560

B2  
 ZONE 1 BUFFER IMPACTS = 556 SF  
 ZONE 2 BUFFER IMPACTS = 223 SF

# BUFFER IMPACTS PERMIT

NOTE: ONLY IMPACTS FROM REMOVAL OF GREENVILLE UTILITIES COMMISSION POWER LINES AND POLES ARE INCLUDED AS PART OF THIS PERMIT. ANY FUTURE RELOCATION OF THESE UTILITIES WILL REQUIRE AN ADDITIONAL PERMIT.

B1  
 ZONE 1 BUFFER IMPACTS = 395 SF  
 ZONE 2 BUFFER IMPACTS = 174 SF

PROJECT REFERENCE NO. 17BP.2.R.81	SHEET NO. 4
RW SHEET NO.	
ROADWAY DESIGN ENGINEER	HYDRAULICS ENGINEER
<b>BUFFER DRAWING SHEET 8 OF 17</b>	

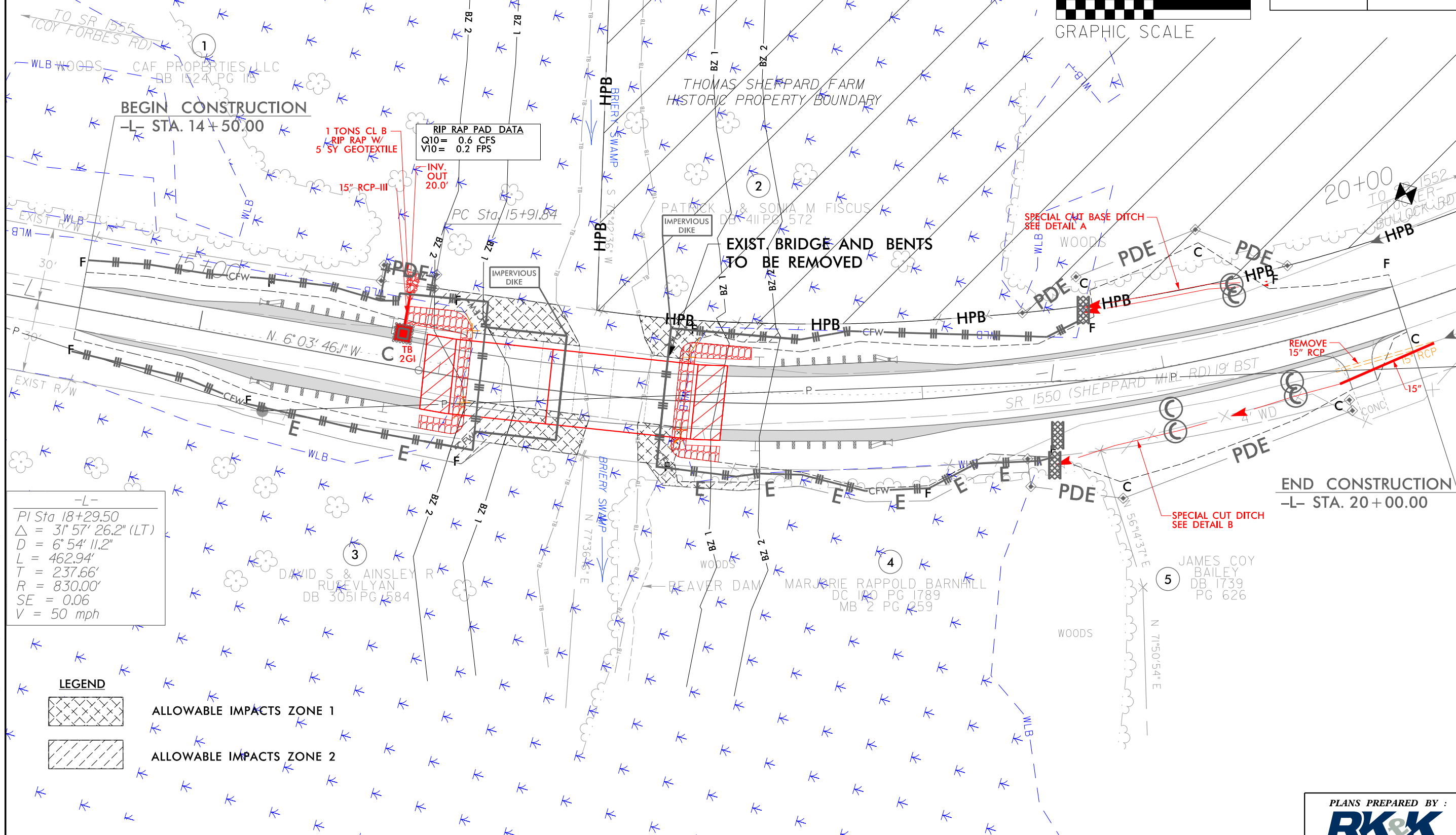
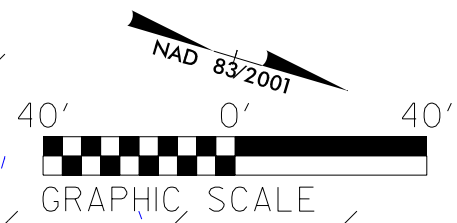

-L-  
 PI Sta 18+29.50  
 $\Delta = 31^\circ 57' 26.2''$  (LT)  
 D = 6' 54" 11.2"  
 L = 462.94'  
 T = 237.66'  
 R = 830.00'  
 SE = 0.06  
 V = 50 mph

**LEGEND**

ALLOWABLE IMPACTS ZONE 1

ALLOWABLE IMPACTS ZONE 2

B3  
 ZONE 1 BUFFER IMPACTS = 501 SF  
 ZONE 2 BUFFER IMPACTS = 434 SF

B4  
 ZONE 1 BUFFER IMPACTS = 379 SF  
 ZONE 2 BUFFER IMPACTS = 65 SF

PLANS PREPARED BY :

**RK&K**

RUMMEL, KLEPPER & KAHL, LLP  
 900 RIDGEFIELD DRIVE SUITE 350  
 RALEIGH, NORTH CAROLINA 27609-3960  
 NC LICENSE NO. F-0112 • (919) 878-9560

8/17/99  
 1/30/2017  
 R:\Hydro\lics\PERMITS\_Environmental\Drawings\730124\_Hyd\_prm\_buf\_psh\_moccon.dgn



B.17/99  
K:\30\2017  
R:\Hydro\lics\PERMITS\_Environmental\Drawings\730124\_Hyd\_prm\_buf\_psh\_con.dgn

**B2**  
ZONE 1 BUFFER IMPACTS = 556 SF  
ZONE 2 BUFFER IMPACTS = 223 SF

# BUFFER IMPACTS PERMIT

NOTE: ONLY IMPACTS FROM REMOVAL OF GREENVILLE UTILITIES COMMISSION POWER LINES AND POLES ARE INCLUDED AS PART OF THIS PERMIT. ANY FUTURE RELOCATION OF THESE UTILITIES WILL REQUIRE AN ADDITIONAL PERMIT.

**B1**  
ZONE 1 BUFFER IMPACTS = 395 SF  
ZONE 2 BUFFER IMPACTS = 174 SF

PROJECT REFERENCE NO. 17BP.2.R.81	SHEET NO. 4
RW SHEET NO.	
ROADWAY DESIGN ENGINEER	HYDRAULICS ENGINEER
<b>BUFFER DRAWING SHEET 9 OF 17</b>	

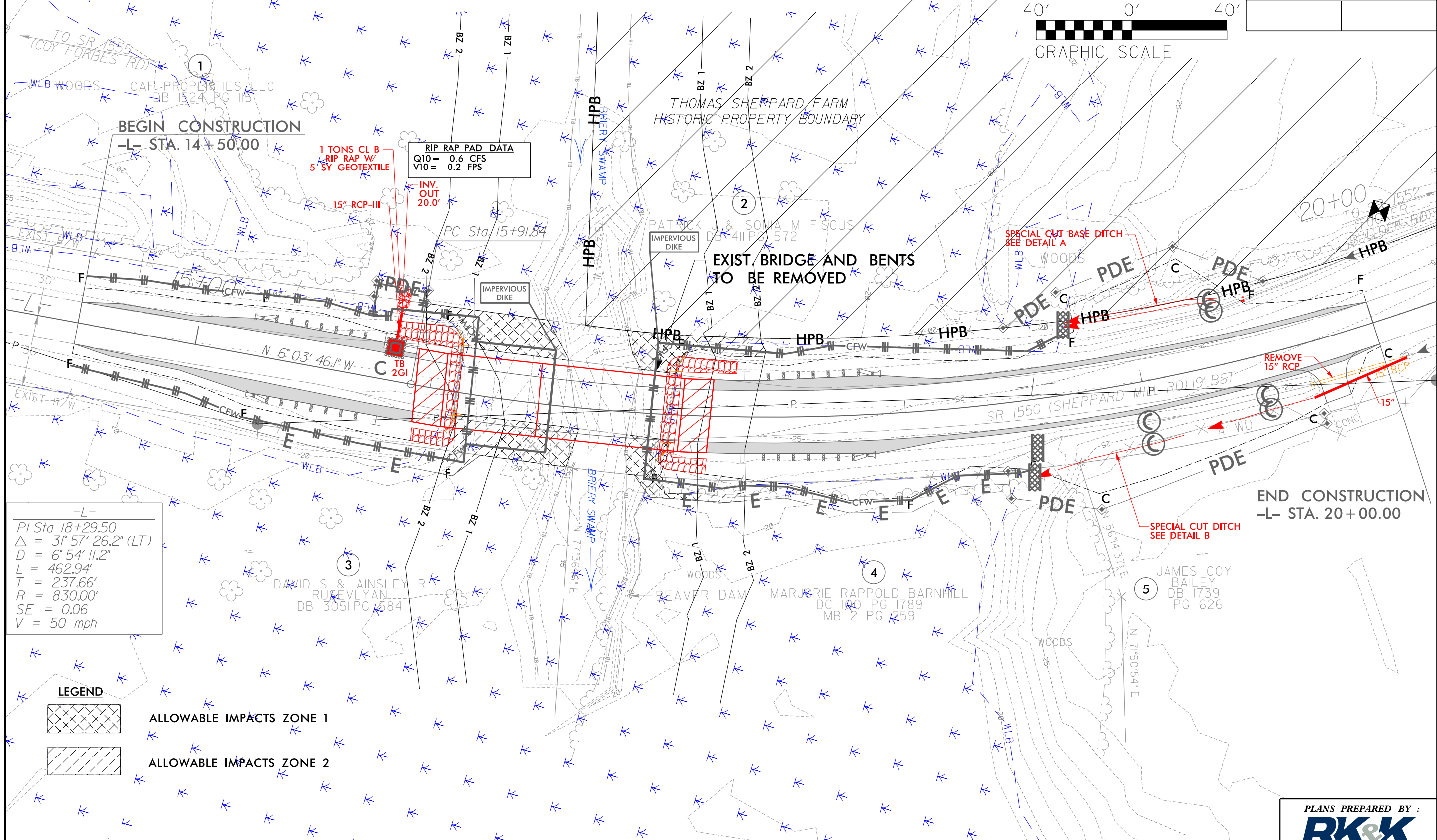
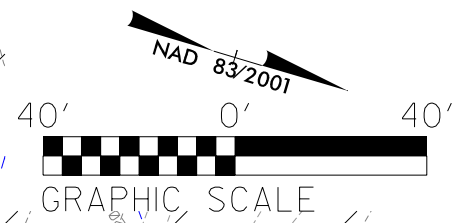

-L-  
PI Sta 18+29.50  
 $\Delta = 31^\circ 57' 26.2" (LT)$   
 $D = 6' 54" 11.2"$   
 $L = 462.94'$   
 $T = 237.66'$   
 $R = 830.00'$   
 $SE = 0.06$   
 $V = 50 \text{ mph}$

**LEGEND**

ALLOWABLE IMPACTS ZONE 1

ALLOWABLE IMPACTS ZONE 2

**B3**  
ZONE 1 BUFFER IMPACTS = 501 SF  
ZONE 2 BUFFER IMPACTS = 434 SF

**B4**  
ZONE 1 BUFFER IMPACTS = 379 SF  
ZONE 2 BUFFER IMPACTS = 65 SF

PLANS PREPARED BY :

**RK&K**

RUMMEL, KLEPPER & KAHL, LLP  
900 RIDGEFIELD DRIVE SUITE 350  
RALEIGH, NORTH CAROLINA 27609-3960  
NC LICENSE NO. F-0112 • (919) 878-9560

# WETLAND AND SURFACE WATER IMPACTS PERMIT

PROJECT REFERENCE NO. 17BP.2.R.81	SHEET NO. 4
RW SHEET NO.	
ROADWAY DESIGN ENGINEER	HYDRAULICS ENGINEER
<b>PERMIT DRAWING SHEET 10 OF 17</b>	

**W2**  
 FILL IN WETLAND = <0.01 AC /9 SF  
 HAND CLEARING = 0.02 AC /1,042 SF  
 MECHANIZED CLEARING = <0.01 AC /174 SF

**W1**  
 FILL IN WETLAND = <0.01 AC /133 SF  
 HAND CLEARING = <0.03 AC /1,203 SF  
 MECHANIZED CLEARING = <0.01 AC /135 SF

**-L-**  
 PI Sta 18+29.50  
 $\Delta = 31^{\circ} 57' 26.2''$  (LT)  
 $D = 6^{\circ} 54' 11.2''$   
 $L = 462.94'$   
 $T = 237.66'$   
 $R = 830.00'$   
 $SE = 0.06$   
 $V = 50$  mph

**LEGEND**

	DENOTES FILL IN WETLAND
	DENOTES HAND CLEARING
	DENOTES MECHANIZED CLEARING

**W3**  
 FILL IN WETLAND = <0.01 AC /119 SF  
 HAND CLEARING = 0.02 AC /832 SF  
 MECHANIZED CLEARING = <0.01 AC /207 SF

**NOTE:** ONLY IMPACTS FROM REMOVAL OF GREENVILLE UTILITIES COMMISSION POWER LINES AND POLES ARE INCLUDED AS PART OF THIS PERMIT. ANY FUTURE RELOCATION OF THESE UTILITIES WILL REQUIRE AN ADDITIONAL PERMIT.

**W4**  
 FILL IN WETLAND = 0.01 AC /494 SF  
 HAND CLEARING = 0.02 AC /1,003 SF  
 MECHANIZED CLEARING = <0.01 AC /174 SF

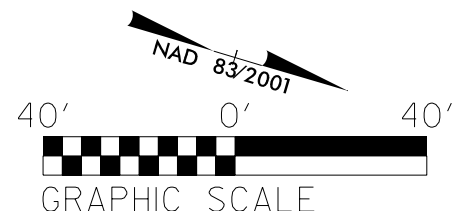
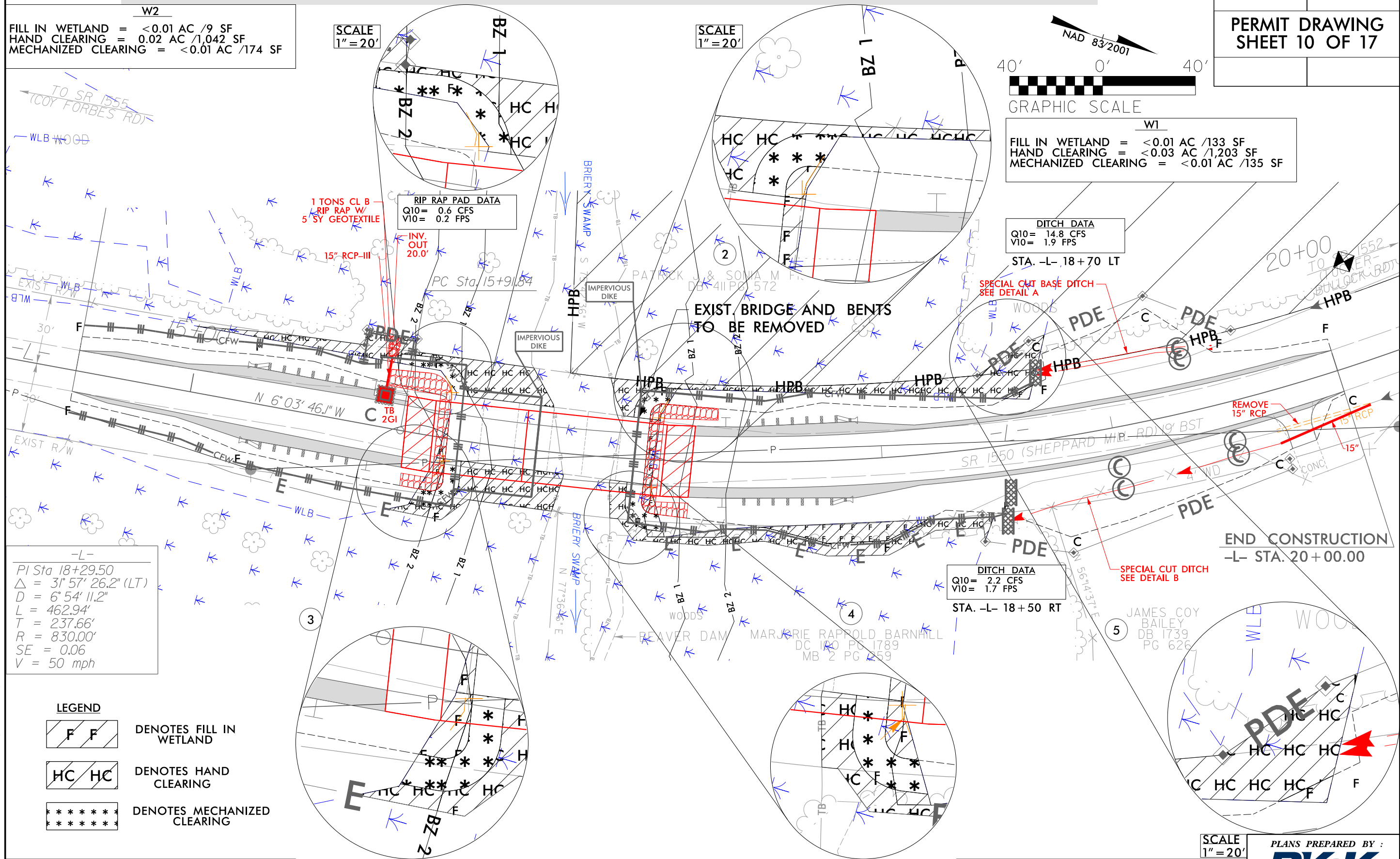

SCALE  
1" = 20'

SCALE  
1" = 20'

SCALE  
1" = 20'

SCALE  
1" = 20'

**PLANS PREPARED BY:**  
  
 RUMMEL, KLEPPER & KAHL, LLP  
 900 RIDGEFIELD DRIVE SUITE 350  
 RALEIGH, NORTH CAROLINA 27609-3960  
 NC LICENSE NO. F-0112 • (919) 878-9560

B.17/99  
 11/30/2017  
 R:\Hydro\lics\PERMITS\_Environmental\Drawings\730124\_Hyd\_prm\_wet\_psh\_moccon.dgn

# WETLAND AND SURFACE WATER IMPACTS PERMIT

PROJECT REFERENCE NO. 17BP.2.R.81	SHEET NO. 4
RW SHEET NO.	
ROADWAY DESIGN ENGINEER	HYDRAULICS ENGINEER
<b>PERMIT DRAWING SHEET 11 OF 17</b>	

**W2**  
 FILL IN WETLAND = <0.01 AC /9 SF  
 HAND CLEARING = 0.02 AC /1,042 SF  
 MECHANIZED CLEARING = <0.01 AC /174 SF

SCALE  
1" = 20'

SCALE  
1" = 20'

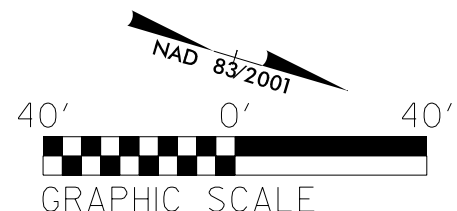

**W1**  
 FILL IN WETLAND = <0.01 AC /133 SF  
 HAND CLEARING = <0.03 AC /1,203 SF  
 MECHANIZED CLEARING = <0.01 AC /135 SF

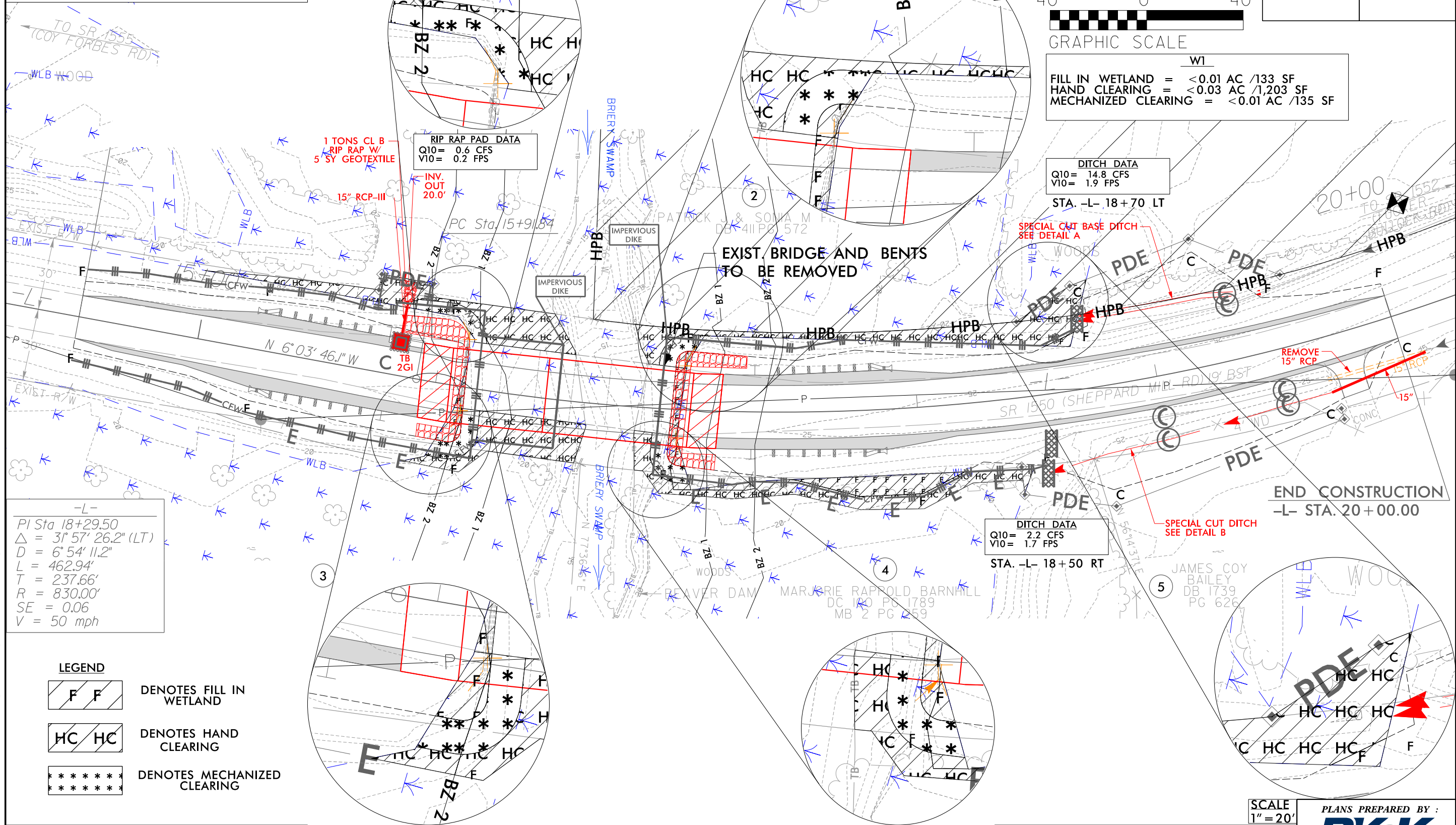

**-L-**  
 PI Sta 18+29.50  
 $\Delta = 31^{\circ} 57' 26.2''$  (LT)  
 $D = 6^{\circ} 54' 11.2''$   
 $L = 462.94'$   
 $T = 237.66'$   
 $R = 830.00'$   
 $SE = 0.06$   
 $V = 50$  mph

- LEGEND**
- DENOTES FILL IN WETLAND
  - DENOTES HAND CLEARING
  - DENOTES MECHANIZED CLEARING

**W3**  
 FILL IN WETLAND = <0.01 AC /119 SF  
 HAND CLEARING = 0.02 AC /832 SF  
 MECHANIZED CLEARING = <0.01 AC /207 SF

SCALE  
1" = 20'

SCALE  
1" = 20'

SCALE  
1" = 20'

**W4**  
 FILL IN WETLAND = 0.01 AC /494 SF  
 HAND CLEARING = 0.02 AC /1,003 SF  
 MECHANIZED CLEARING = <0.01 AC /174 SF

NOTE: ONLY IMPACTS FROM REMOVAL OF GREENVILLE UTILITIES COMMISSION POWER LINES AND POLES ARE INCLUDED AS PART OF THIS PERMIT. ANY FUTURE RELOCATION OF THESE UTILITIES WILL REQUIRE AN ADDITIONAL PERMIT.

PLANS PREPARED BY :

RUMMEL, KLEPPER & KAHL, LLP  
 900 RIDGEFIELD DRIVE SUITE 350  
 RALEIGH, NORTH CAROLINA 27609-3960  
 NC LICENSE NO. F-0112 • (919) 878-9560

B.17/99  
 11/30/2017  
 R:\Hydrolics\PERMITS\_Environmental\Drawings\730124\_Hyd\_prm\_wet\_psh\_con.dgn

5/28/99

-L-

PROJECT REFERENCE NO. 17BP.2.R.79	SHEET NO. 5
ROADWAY DESIGN ENGINEER	HYDRAULICS ENGINEER
<b>PERMIT DRAWING SHEET 12 OF 17</b>	

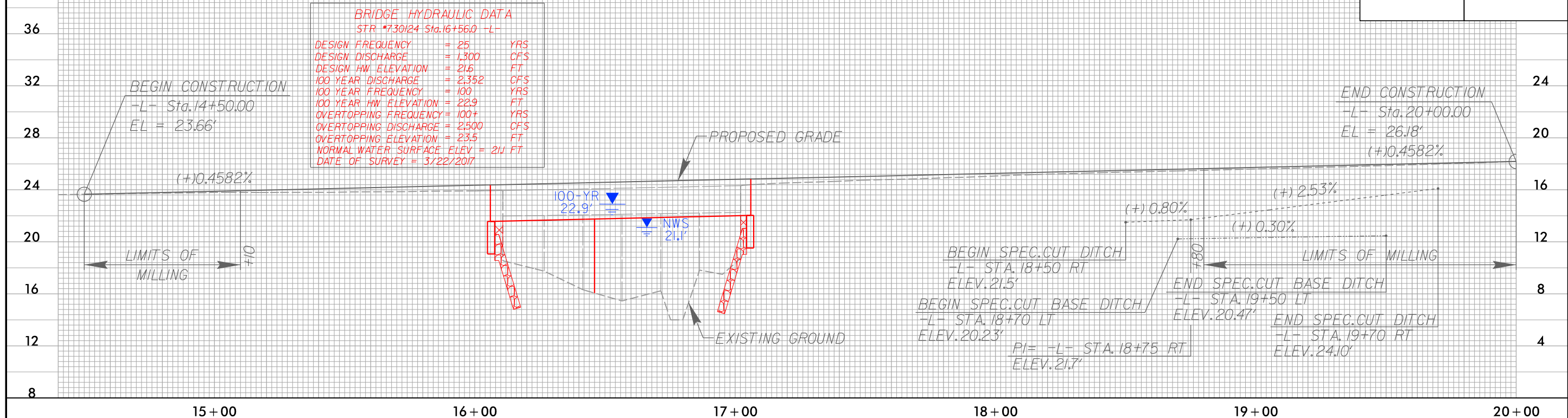

XXXX MATERIAL TO BE REMOVED

LEFT DITCH -----

RIGHT DITCH -----

PLANS PREPARED BY :

**RK&K**  
RUMMEL, KLEPPER & KAHL, LLP  
900 RIDGEFIELD DRIVE, SUITE 350  
RALEIGH, NORTH CAROLINA 27609-3960  
NC LICENSE NO. F-0112 • (919) 878-9560

K:\22\2017\Hyd\Drawings\PERMITS\_Environmental\Drawings\730124\_Hyd\_perm\_psh\_pr\_of\_1.e.dgn

6/23/16

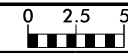

PROJ. REFERENCE NO. 17BP.2.R.79	SHEET NO. X-1
------------------------------------	------------------

75 70 65 60 55 50 45 40 35 30 25 20 15 10 5 0 5 10 15 20 25 30 35 40 45 50 55 60 65 70 75

PERMIT DRAWING  
SHEET 13 OF 17

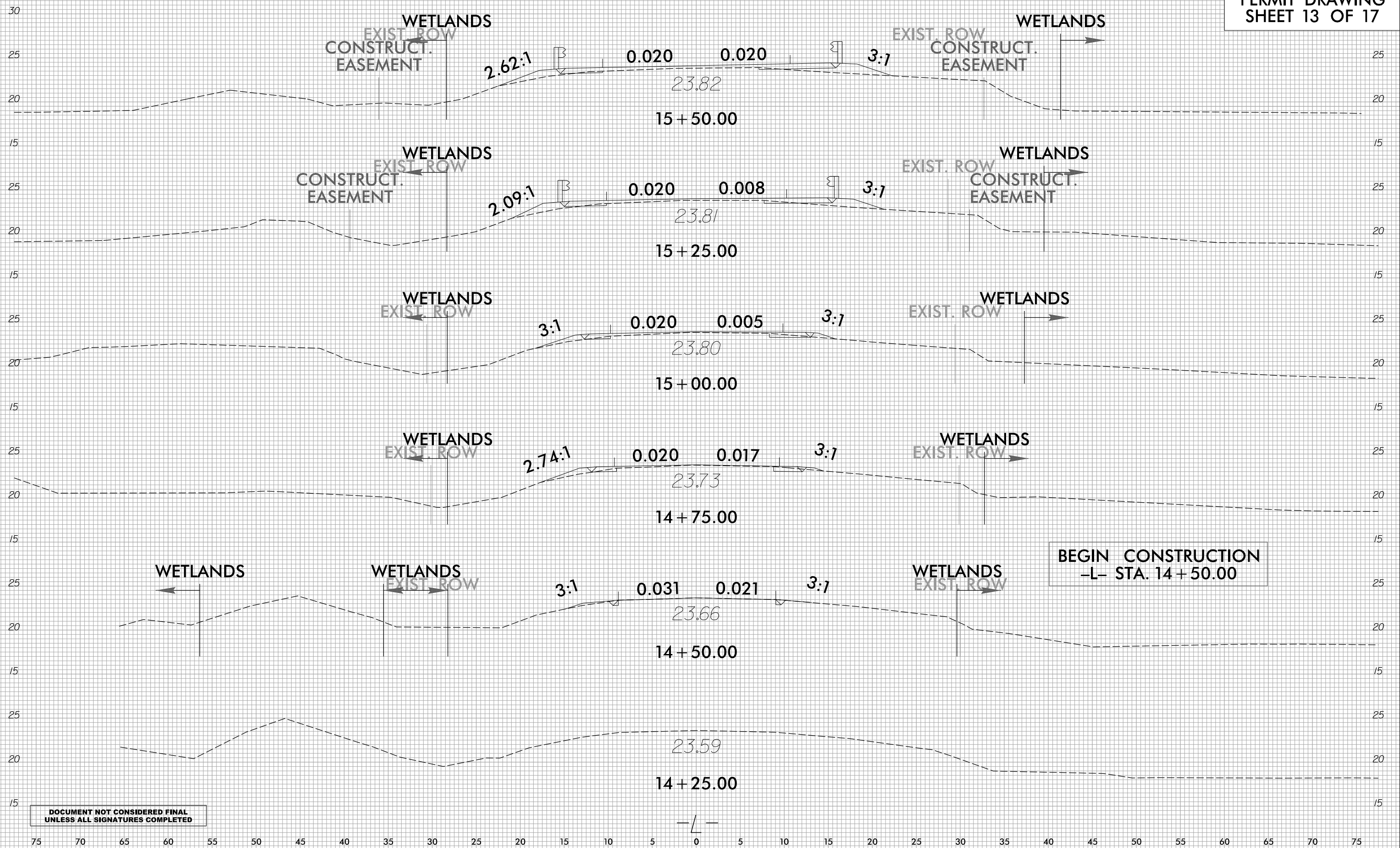

BEGIN CONSTRUCTION  
-L- STA. 14 + 50.00

DOCUMENT NOT CONSIDERED FINAL  
UNLESS ALL SIGNATURES COMPLETED

I:\22\2017  
R:\Hydro\lics\PERMITS\Environmental\Drawings\730124\_Hyd\_prm\_wet\_xsc\_L.dgn  
ccavalier

75 70 65 60 55 50 45 40 35 30 25 20 15 10 5 0 5 10 15 20 25 30 35 40 45 50 55 60 65 70 75

6/23/16

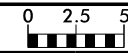

PROJ. REFERENCE NO.	SHEET NO.
17BP.2.R.79	X-2

75 70 65 60 55 50 45 40 35 30 25 20 15 10 5 0 5 10 15 20 25 30 35 40 45 50 55 60 65 70 75

PERMIT DRAWING SHEET 14 OF 17

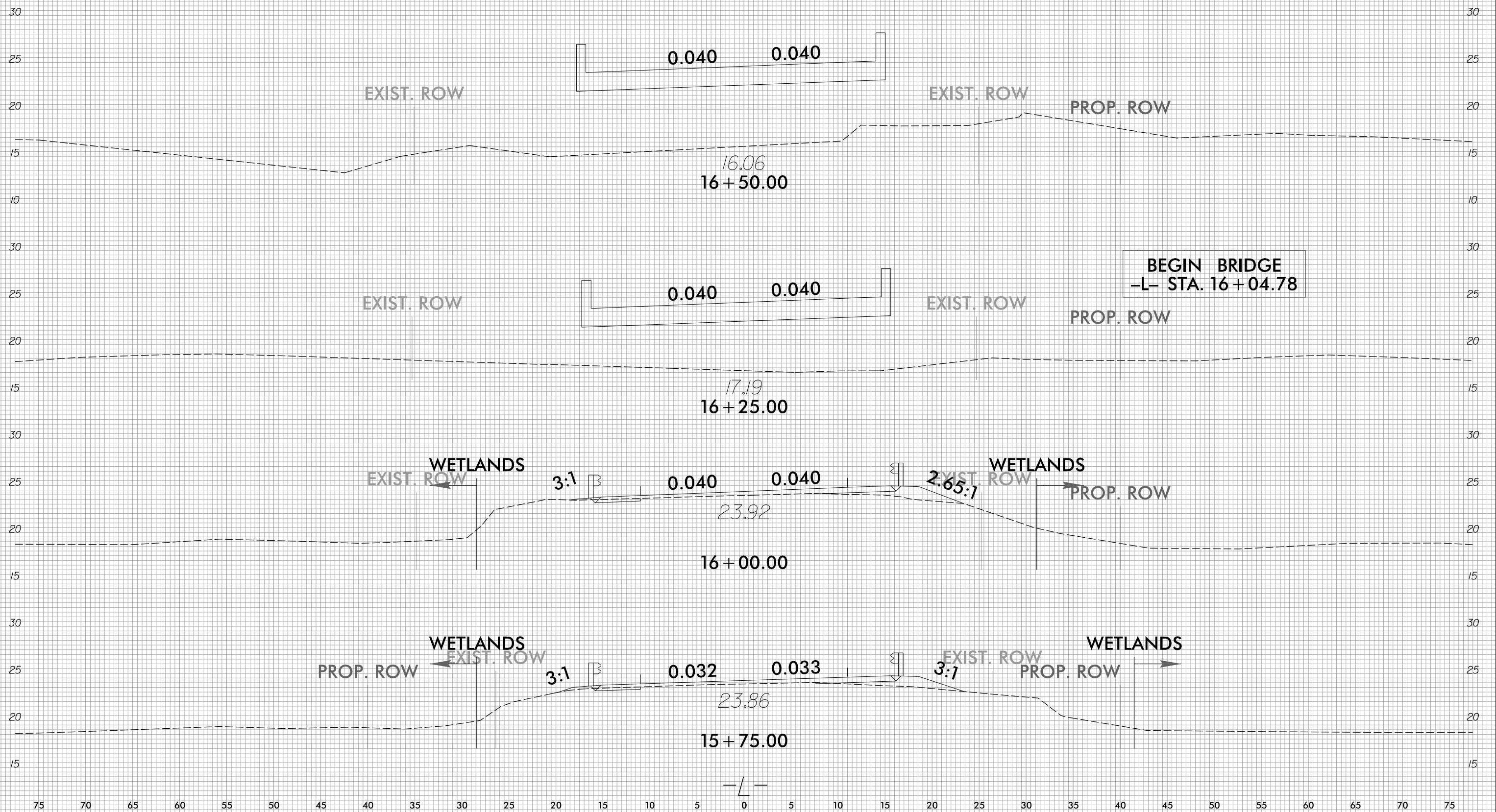

I:\22\2017\17BP\17BP.2.R.79\Drawings\730124\_Hyd.prm.wet.xsc.L.dgn  
ccavalier

6/23/16

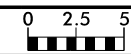

PROJ. REFERENCE NO. 17BP.2.R.79	SHEET NO. X-3
------------------------------------	------------------

PERMIT DRAWING  
SHEET 15 OF 17

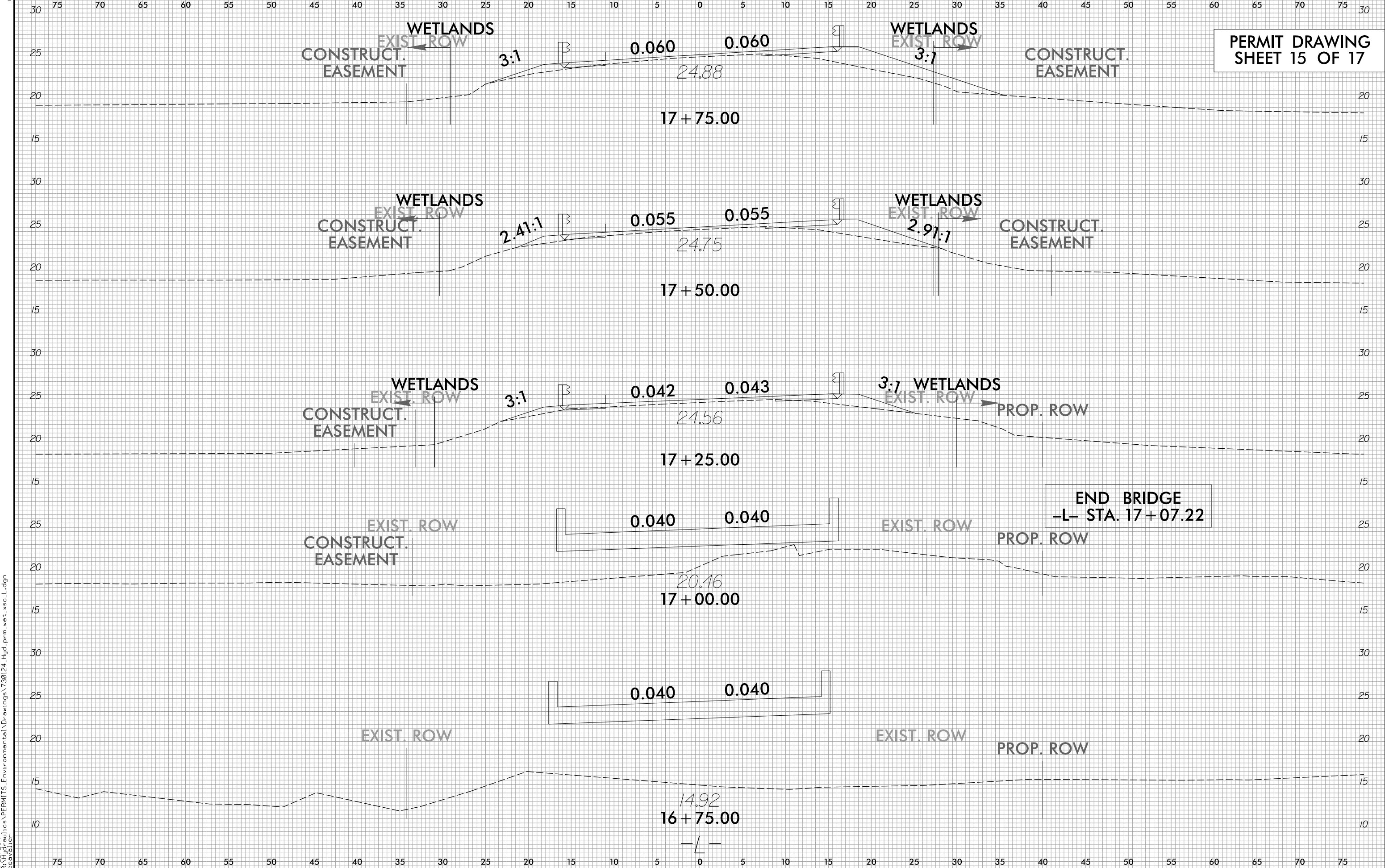

I:\22\2017  
R:\Hydro\17BP.2.R.79\Drawings\730124\_Hyd\_prm\_wet.xsc.L.dgn  
ccavaller

6/23/16  
11/22/2017  
R:\Hydraulics\PERMITS\_Environmental\Drawings\730124\_Hyd\_prm\_wet.xsc.L.dgn  
ccavaller

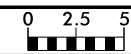

PROJ. REFERENCE NO. 17BP.2.R.79	SHEET NO. X-4
------------------------------------	------------------

PERMIT DRAWING  
SHEET 16 OF 17

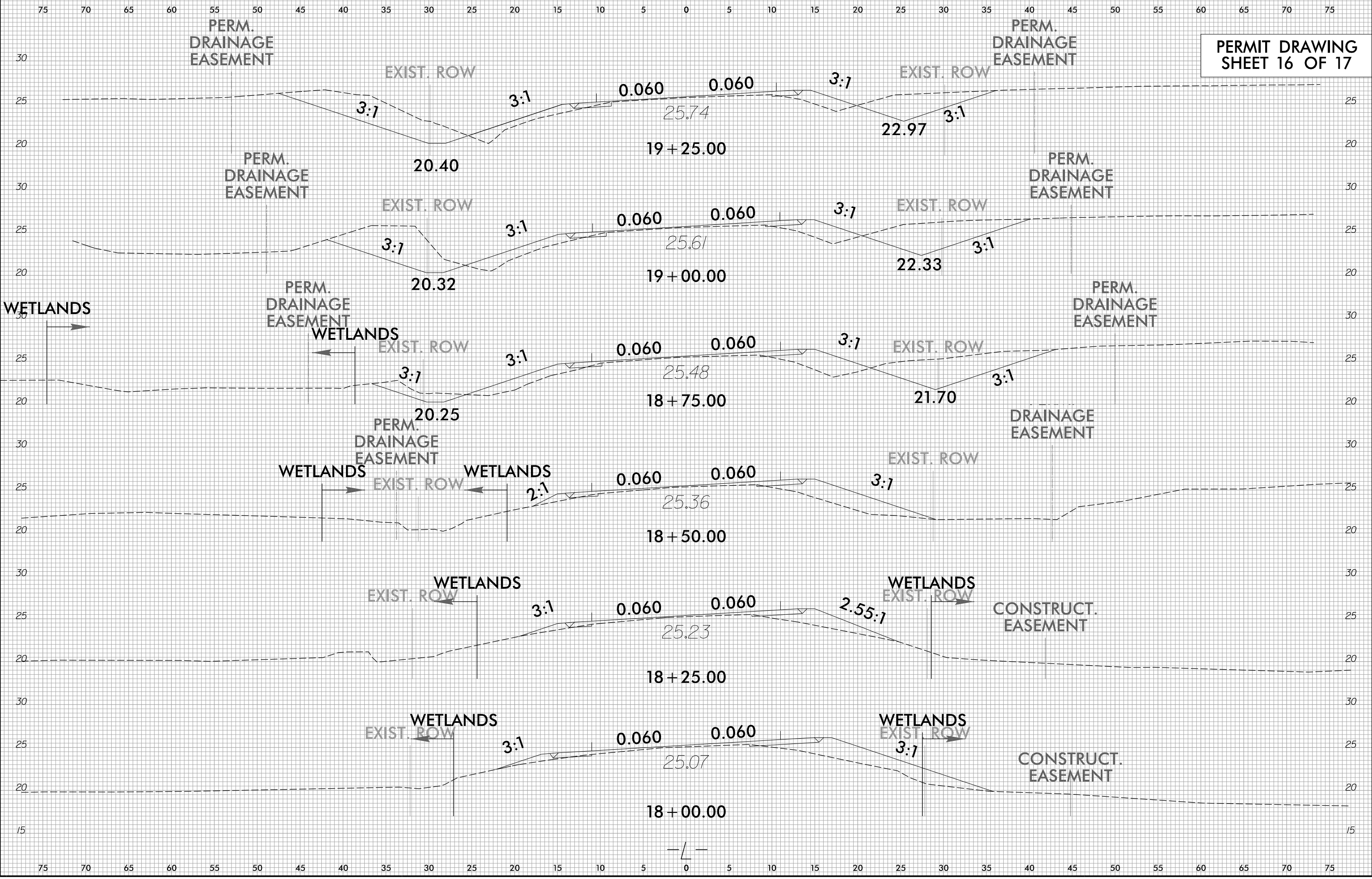



6/23/16

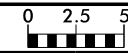

PROJ. REFERENCE NO.  
17BP.2.R.79

SHEET NO.  
X-5

75 70 65 60 55 50 45 40 35 30 25 20 15 10 5 0 5 10 15 20 25 30 35 40 45 50 55 60 65 70 75

PERMIT DRAWING  
SHEET 17 OF 17

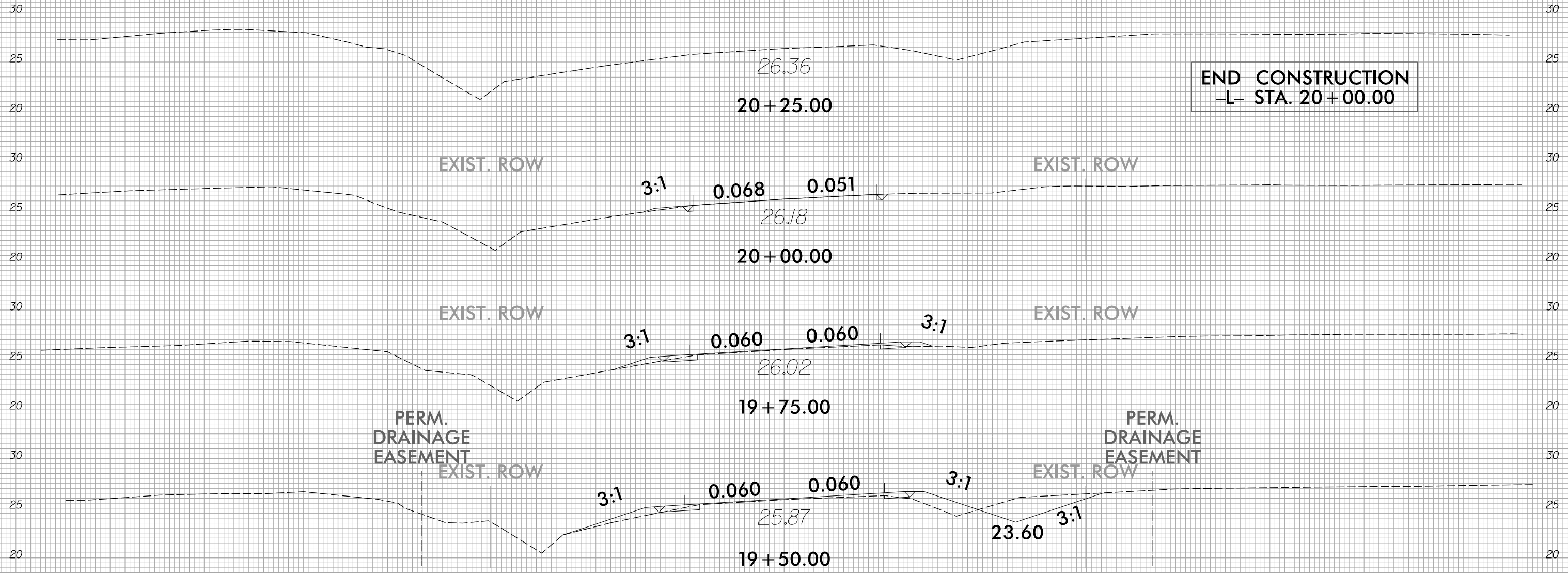

75 70 65 60 55 50 45 40 35 30 25 20 15 10 5 0 5 10 15 20 25 30 35 40 45 50 55 60 65 70 75

I:\22\2017  
R:\Hydraulics\PERMITS-Environmental\Drawings\730124\_Hyd\_prm\_wet.xsc\_L.dgn  
ccavaller