

09.08/99

See Sheet 1A-1 for Index of Sheets  
See Sheet 1B for Sheet Symbology

# STATE OF NORTH CAROLINA DIVISION OF HIGHWAYS

STATE	STATE PROJECT REFERENCE NO.	SHEET NO.	TOTAL SHEETS
N.C.	B-4789	1	11
STATE PROJ. NO.	F.A. PROJ. NO.	DESCRIPTION	
38559.1.2	N/A	P.E.	

## PITT COUNTY

**LOCATION:** BRIDGE #164 OVER GRINDLE CREEK ON SR 1424

**TYPE OF WORK:** GRADING, DRAINAGE, PAVING, AND STRUCTURE

**TIP PROJECT: B-4789**

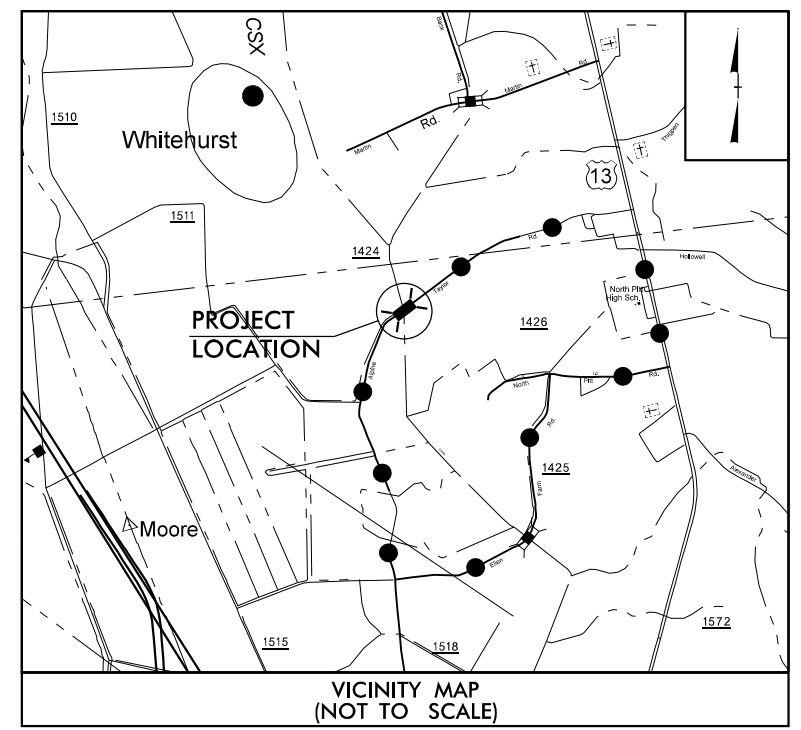

VICINITY MAP  
(NOT TO SCALE)



90% PLANS

**BUFFER IMPACTS**

PERMIT DRAWING  
SHEET 1 OF 3

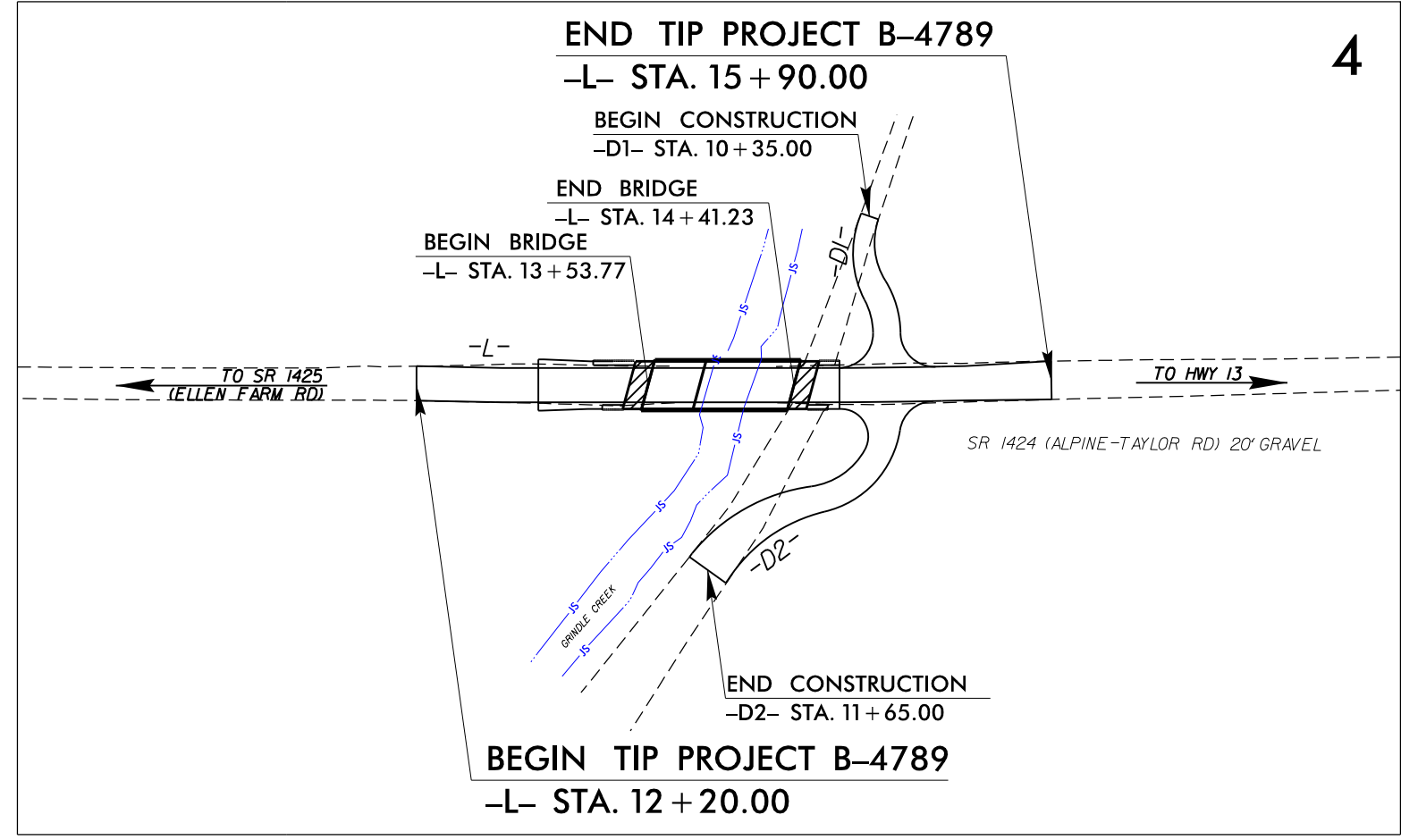

4

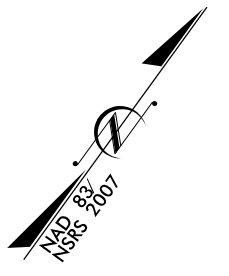

THERE IS NO CONTROL OF ACCESS ON THIS PROJECT

DOCUMENT NOT CONSIDERED FINAL  
UNLESS ALL SIGNATURES COMPLETED

**CONTRACT:**

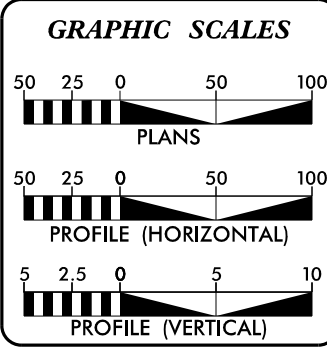

**DESIGN DATA**

ADT 2013 =	40
ADT 2040 =	80
K =	0 %
D =	0 %
T =	0 %
V =	50 MPH
(TTST = 0% + DUAL = 0%)	
FUNC CLASS =	
LOCAL RURAL	
SUBREGIONAL TIER	

**PROJECT LENGTH**

LENGTH ROADWAY TIP PROJECT B-4789 =	0.053 MILES
LENGTH STRUCTURES TIP PROJECT B-4789 =	0.017 MILES
TOTAL LENGTH TIP PROJECT B-4789 =	0.070 MILES

Prepared in the Office of:  
**HDR** HDR Engineering, Inc. of the Carolinas  
 555 Fayetteville St., Suite 900 Raleigh, NC 27601  
 N.C.B.E.L.S. License Number: F-0116

2018 STANDARD SPECIFICATIONS

**RIGHT OF WAY DATE:**  
NOVEMBER 10, 2017

**LETTING DATE:**  
MARCH 28, 2018

PHILLIP E. ROGERS, P.E. PROJECT ENGINEER
ANTHONY G. THOMPSON, P.E. PROJECT DESIGN ENGINEER
HEATHER LANE, P.E. NCDOT CONTACT

**HYDRAULICS ENGINEER**

SIGNATURE: \_\_\_\_\_ P.E.

**ROADWAY DESIGN ENGINEER**

SIGNATURE: \_\_\_\_\_ P.E.

**DIVISION OF HIGHWAYS  
STATE OF NORTH CAROLINA**

1/30/2018 08:47:89\_HYD\_PRM\_TSH.dgn

8/17/99

# BUFFER IMPACTS

## LEGEND:

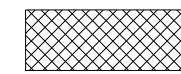

ALLOWABLE IMPACTS ZONE 1

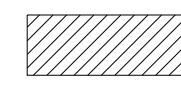

ALLOWABLE IMPACTS ZONE 2

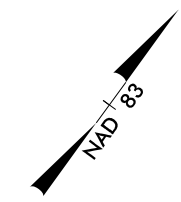

PROJECT REFERENCE NO. <b>B-4789</b>	SHEET NO. <b>4</b>
RW SHEET NO.	
ROADWAY DESIGN ENGINEER	HYDRAULICS ENGINEER
<b>INCOMPLETE PLANS</b> DO NOT USE FOR R/W ACQUISITION	
<b>DOCUMENT NOT CONSIDERED FINAL</b> UNLESS ALL SIGNATURES COMPLETED	
HDR Engineering, Inc. of the Carolinas 555 Fayetteville St. Suite 900 Raleigh, N.C. 27601 N.C.B.E.L.S. License Number: F-0116	

REVISIONS

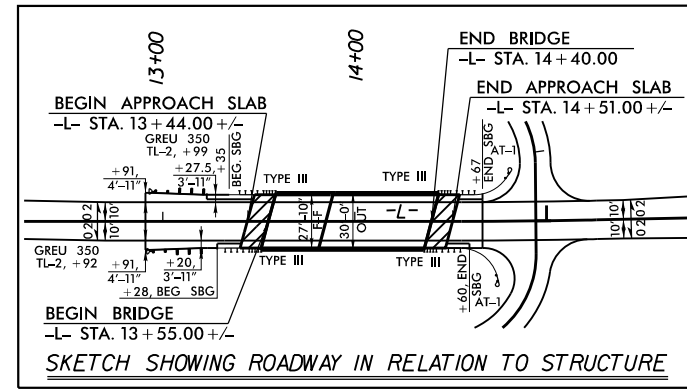
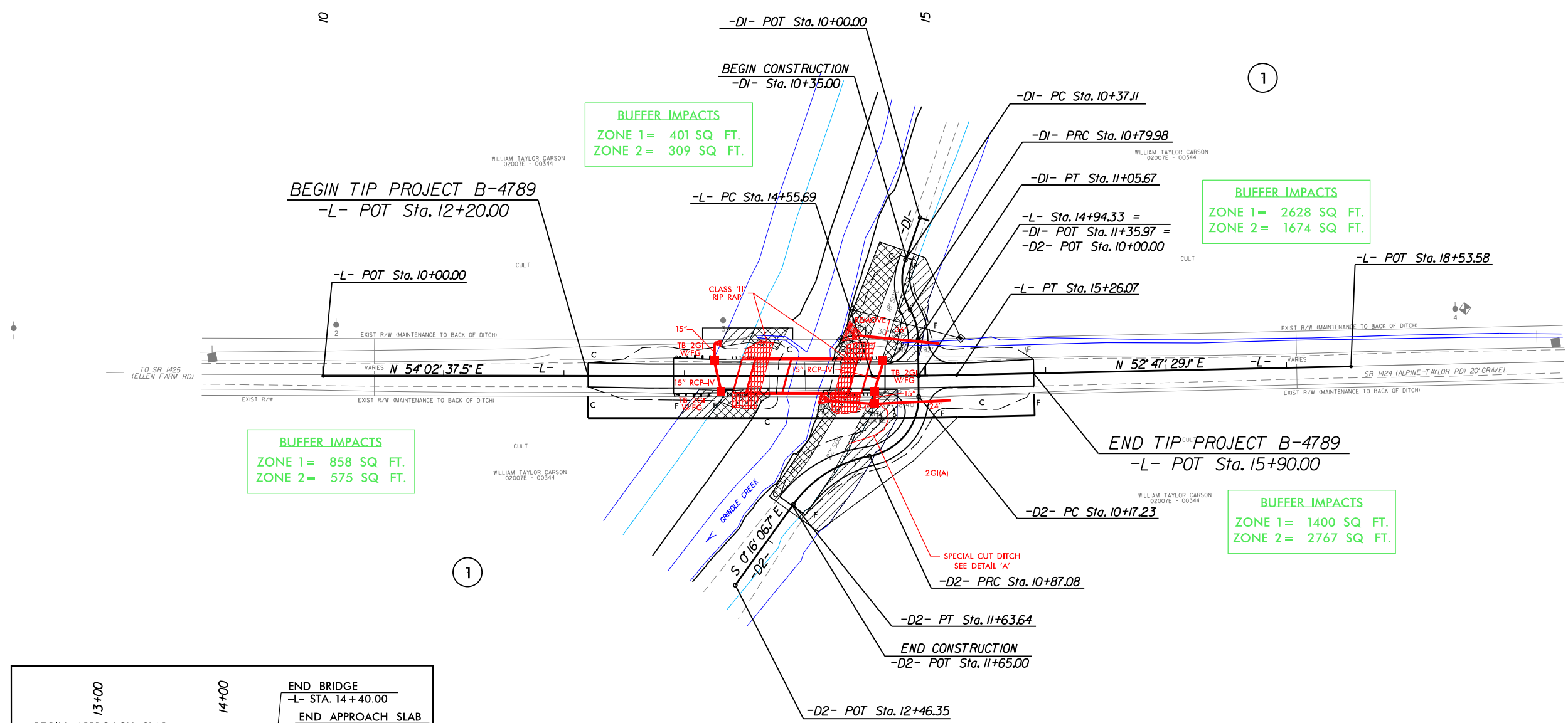

### PERMIT DRAWING SHEET 2 OF 3

SEE SHEET 5 FOR PROFILES

1/30/2018 08:47:89 HYD\_PRM\_PSH.dgn

## RIPARIAN BUFFER IMPACTS SUMMARY

SITE NO.	STRUCTURE SIZE / TYPE	STATION (FROM/TO)	IMPACT									BUFFER REPLACEMENT	
			TYPE			ALLOWABLE			MITIGABLE			ZONE 1 (ft <sup>2</sup> )	ZONE 2 (ft <sup>2</sup> )
			ROAD CROSSING	BRIDGE	PARALLEL IMPACT	ZONE 1 (ft <sup>2</sup> )	ZONE 2 (ft <sup>2</sup> )	TOTAL (ft <sup>2</sup> )	ZONE 1 (ft <sup>2</sup> )	ZONE 2 (ft <sup>2</sup> )	TOTAL (ft <sup>2</sup> )		
1	Bridge	13+00 to 15+00		X		2149	884	3033					
1	DR1	10+00 to 11+30	X			2192	1674	3866					
1	DR2	10+00 to 11+65	X			946	2767	3713					
<b>TOTAL:</b>						5287	5325	10612	0	0	0	0.0	0.0

N.C. DEPT. OF TRANSPORTATION  
 DIVISION OF HIGHWAYS  
  
 PITT COUNTY  
 PROJECT: B-4789  
  
 9/20/2017  
 SHEET 3 OF 3