

PROJECT REFERENCE NO.	SHEET NO.
DB00335	1

BEAUFORT & PITT COUNTY

DB00335
WBS: 2017CPT.02.23.20072.1
WBS: 2017CPT.02.24.20742.1

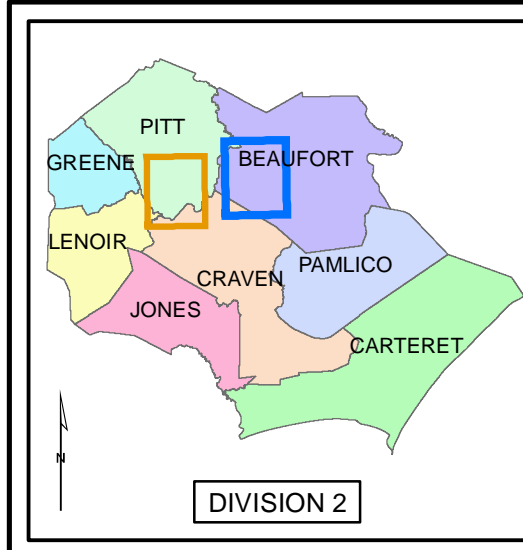

LOCATION: SEE NEXT PLAN SHEET FOR ROUTE LOCATIONS

TYPE OF WORK: DOUBLE SEAL



NCDOT
DIVISION 2

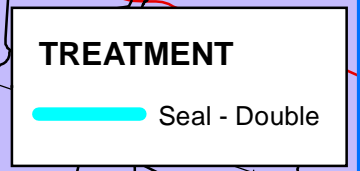
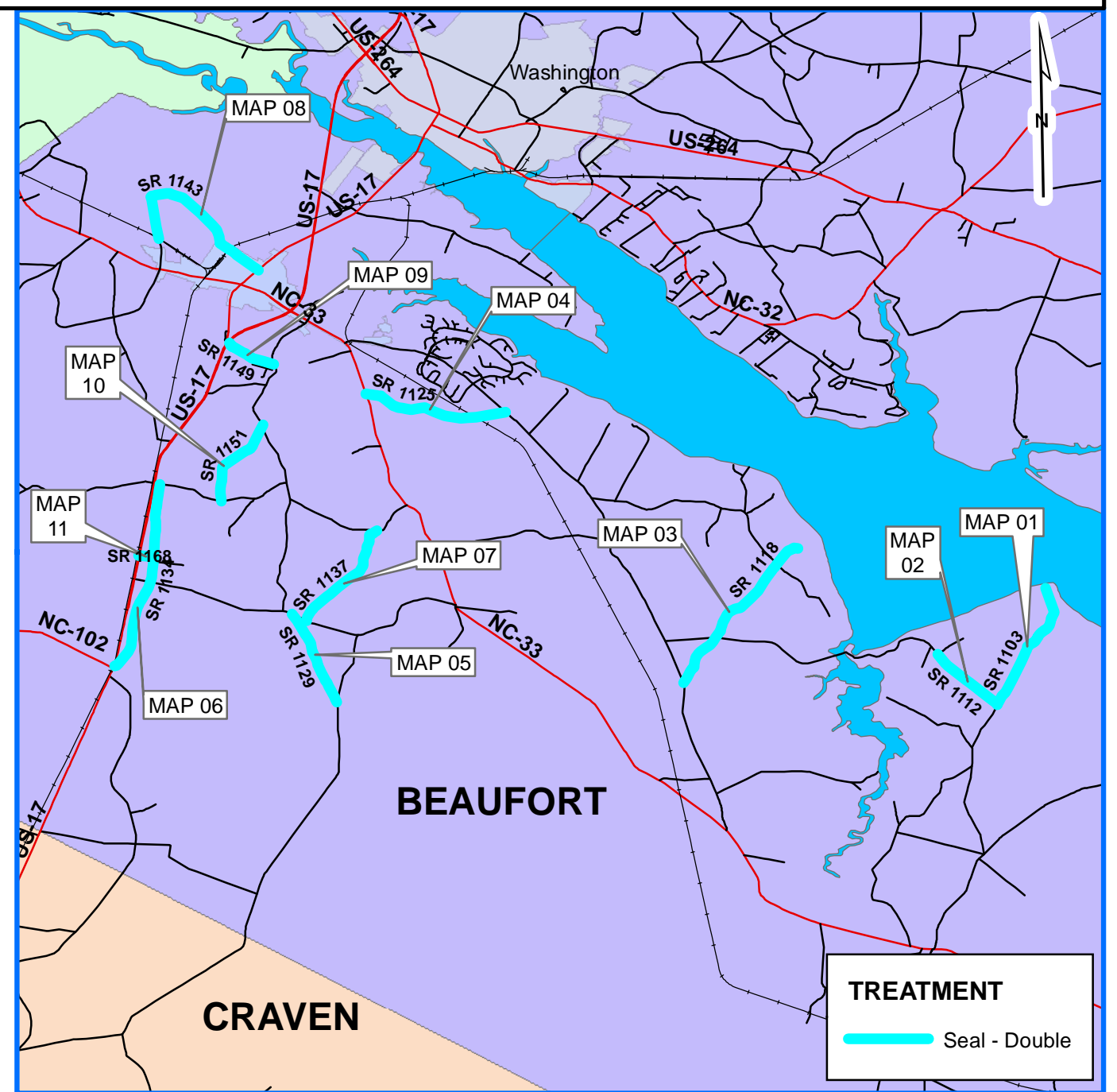
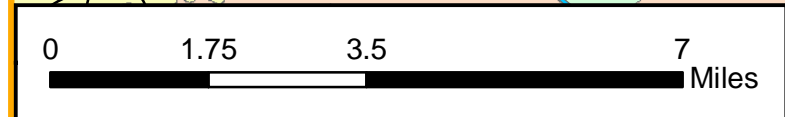
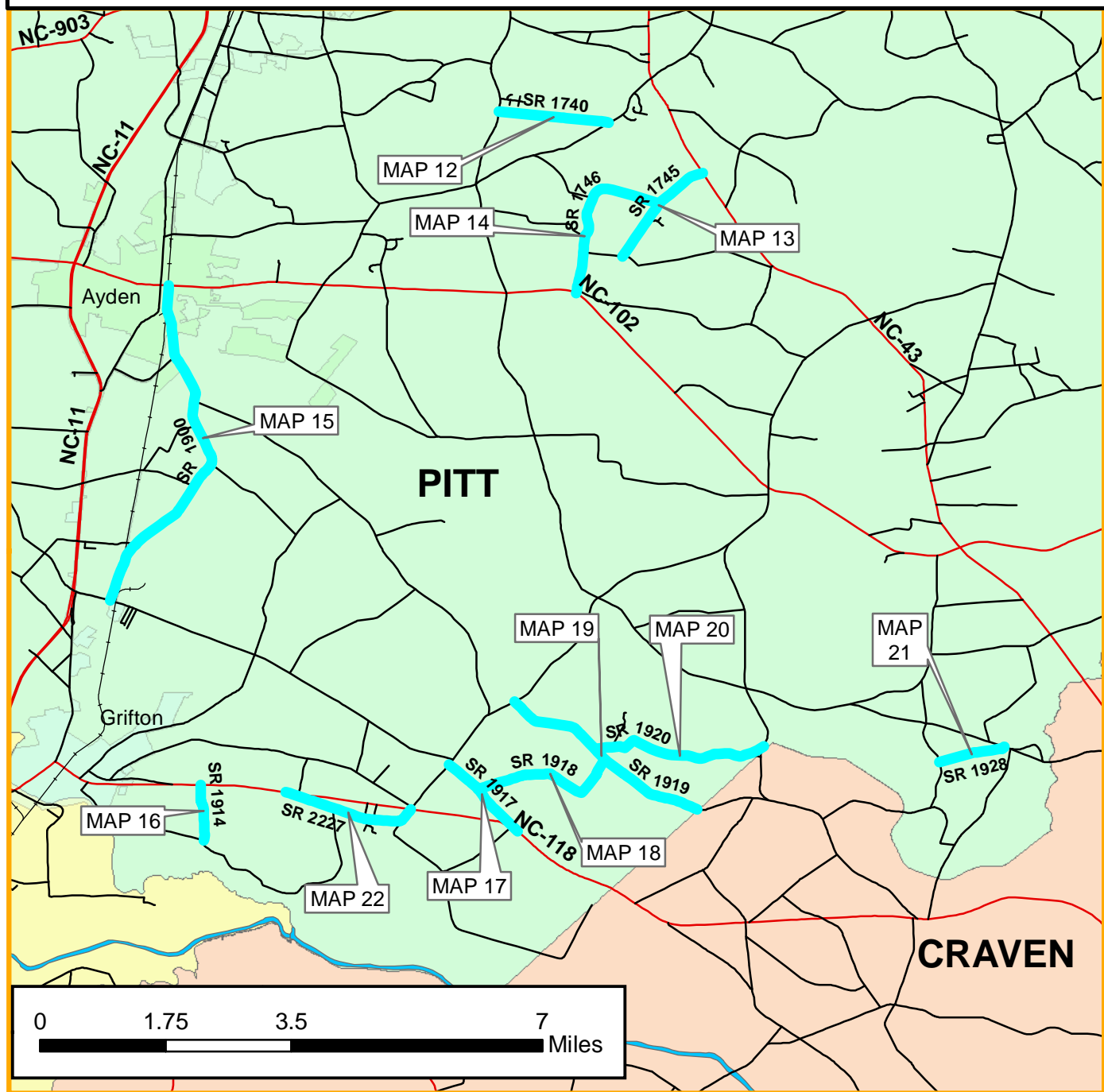

LOCATION SUMMARY

Map Number	WBS	County	Route Name	From Description	To Description	Begin MP	To MP	Length	Width	SQ YDS
01	2017CPT.02.23.20072.1	007-Beaufort	SR 1103	SR 1112	DEAD END	2.33	4.26	1.93	20.00	22,645
02	2017CPT.02.23.20072.1	007-Beaufort	SR 1112	SR 1103	SR 1189	0.00	1.05	1.05	18.00	11,088
03	2017CPT.02.23.20072.1	007-Beaufort	SR 1118	SR 1114	END MAINT	0.00	2.54	2.54	18.00	26,822
04	2017CPT.02.23.20072.1	007-Beaufort	SR 1125	NC 33	SR 1123	0.00	1.81	1.81	20.00	21,273
05	2017CPT.02.23.20072.1	007-Beaufort	SR 1129	SR 1127	SR 1128	0.00	1.43	1.43	16.00	13,423
06	2017CPT.02.23.20072.1	007-Beaufort	SR 1134	US 17	SR 1152	0.00	2.80	2.80	20.00	32,830
07	2017CPT.02.23.20072.1	007-Beaufort	SR 1137	SR 1127	SR 1138	0.00	1.67	1.67	18.00	17,635
08	2017CPT.02.23.20072.1	007-Beaufort	SR 1143	RR	US 17	0.46	2.95	2.49	18.00	26,294
09	2017CPT.02.23.20072.1	007-Beaufort	SR 1149	US 17	SR 1136	0.02	0.65	0.64	18.00	6,706
10	2017CPT.02.23.20072.1	007-Beaufort	SR 1151	SR 1152	SR 1136	0.00	1.32	1.32	20.00	15,488
11	2017CPT.02.23.20072.1	007-Beaufort	SR 1168	US 17	SR 1134	0.00	0.19	0.19	15.00	1,663
12	2017CPT.02.24.20742.1	074-Pitt	SR 1740	SR 2241	SR 1725	0.00	1.26	1.26	20.00	14,784
13	2017CPT.02.24.20742.1	074-Pitt	SR 1745	NC 43	SR 1749	0.00	1.50	1.50	18.00	15,882
14	2017CPT.02.24.20742.1	074-Pitt	SR 1746	NC 102	SR 1751	0.00	2.22	2.22	20.00	26,048
15	2017CPT.02.24.20742.1	074-Pitt	SR 1900	SR 1110	NC 102	0.00	4.85	4.85	18.00	51,216
16	2017CPT.02.24.20742.1	074-Pitt	SR 1914	SR 1910	NC 118	2.90	3.66	0.77	20.00	8,976
17	2017CPT.02.24.20742.1	074-Pitt	SR 1917	SR 1753	NC 118	0.00	1.21	1.21	24.00	17,037
18	2017CPT.02.24.20742.1	074-Pitt	SR 1918	SR 1917	SR 1919	0.00	1.84	1.84	20.00	21,589
19	2017CPT.02.24.20742.1	074-Pitt	SR 1919	SR 1753	CRAVEN CO	0.00	2.65	2.65	18.00	27,984
20	2017CPT.02.24.20742.1	074-Pitt	SR 1920	SR 1919	SR 1921	0.00	2.09	2.09	24.00	29,427
21	2017CPT.02.24.20742.1	074-Pitt	SR 1928	SR 1725	SR 1929	0.00	0.77	0.77	20.00	9,035
22	2017CPT.02.24.20742.1	074-Pitt	SR 2227	NC 118	NC 118	0.00	1.58	1.58	18.00	16,727

NOTE:

1. ALL PAVED SECONDARY ROUTES TO BE TREATED TO THE ENDS OF THE RADII OR AS DIRECTED BY THE ENGINEER
2. ASPHALT SURFACE TREATMENT, DOUBLE SEAL CONSISTS OF TWO LAYERS OF TREATMENT:
 BOTTOM LAYER CONSISTS OF EMULSIFIED ASPHALT, GRADE CRS-2L AT A RATE OF APPROX. 0.25[±] GAL/SY AND A LAYER OF 5/16" LIGHT WEIGHT AGGREGATE AT A RATE OF APPROX. 9[±] LBS/SY.

 TOP LAYER CONSISTS OF EMULSIFIED ASPHALT, GRADE CRS-2L AT A RATE OF APPROX. 0.25[±] GAL/SY AND A LAYER OF 5/16" LIGHT WEIGHT AGGREGATE AT A RATE OF APPROX. 9[±] LBS/SY.
3. PAVEMENT MARKINGS TO BE PERFORMED BY OTHERS

PAVEMENT SCHEDULE	
C1	PROPOSED ASPHALT SURFACE TREATMENT, DOUBLE SEAL, AT AN APPLICATION RATE TO BE DETERMINED BY FIELD CONDITIONS IN ACCORDANCE WITH PROJECT SPECIAL PROVISIONS.
U	EXISTING PAVEMENT
DRAWINGS NOT TO SCALE	

NOTE: PAVEMENT EDGE SLOPES ARE 1:1 UNLESS SHOWN OTHERWISE.

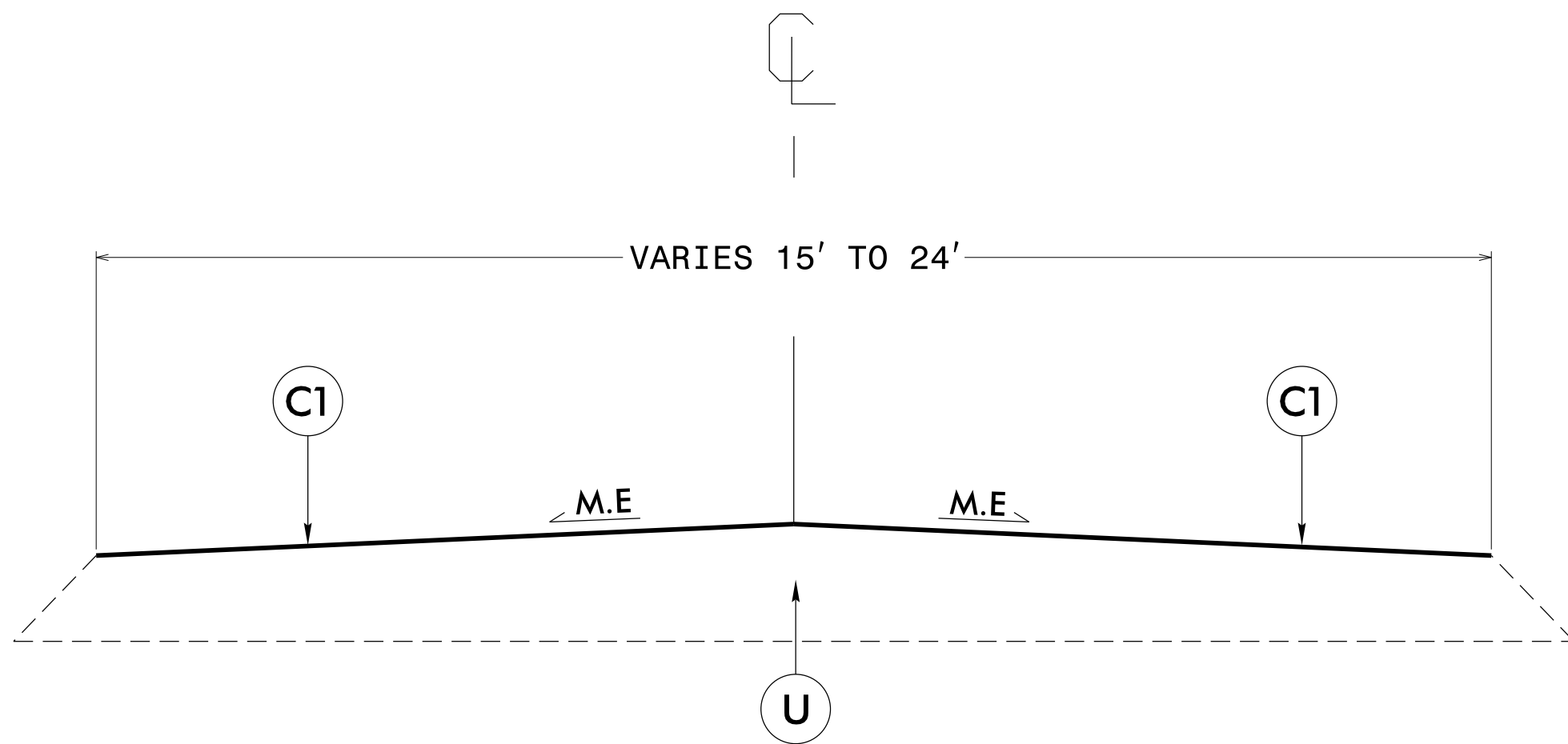

TYPICAL SECTION NO. 1

MAP 1 THROUGH MAP 22

PROJECT NO.	SHEET NO.
DB00335	4

SUMMARY OF QUANTITIES

PROJECT NO	COUNTY	MAP NO	ROUTE	DESCRIPTION	TYP NO	LANES	LANE TYPE	FINAL SURFACE TESTING REQUIRED	WARM MIX ASPHALT REQUIRED	LENGTH MI	WIDTH FT	ASPHALT SURFACE TREATMENT, DOUBLE SEAL SY	EMULSION FOR ASPHALT SURFACE TREATMENT GAL
2017CPT.02.23.20072.1	Beaufort	1	SR 1103	FROM SR 1112 TO DEAD END	1	2	2WU	NO	NO	1.93	20	22,645	11,323
TOTAL FOR MAP NO. 1										1.93		22,645	11,323
2017CPT.02.23.20072.1	Beaufort	2	SR 1112	FROM SR 1103 TO SR 1189	1	2	2WU	NO	NO	1.05	18	11,088	5,544
TOTAL FOR MAP NO. 2										1.05		11,088	5,544
2017CPT.02.23.20072.1	Beaufort	3	SR 1118	FROM SR 1114 TO END MAINT	1	2	2WU	NO	NO	2.54	18	26,822	13,411
TOTAL FOR MAP NO. 3										2.54		26,822	13,411
2017CPT.02.23.20072.1	Beaufort	4	SR 1125	FROM NC 33 TO SR 1123	1	2	2WU	NO	NO	1.81	20	21,237	10,636
TOTAL FOR MAP NO. 4										1.81		21,237	10,636
2017CPT.02.23.20072.1	Beaufort	5	SR 1129	FROM SR 1127 TO SR 1128	1	2	2WU	NO	NO	1.43	16	13,423	6,711
TOTAL FOR MAP NO. 5										1.43		13,423	6,711
2017CPT.02.23.20072.1	Beaufort	6	SR 1134	FROM US 17 TO SR 1152	1	2	2WU	NO	NO	2.80	20	32,853	16,415
TOTAL FOR MAP NO. 6										2.80		32,853	16,415
2017CPT.02.23.20072.1	Beaufort	7	SR 1137	FROM SR 1127 TO SR 1138	1	2	2WU	NO	NO	1.67	18	17,635	8,818
TOTAL FOR MAP NO. 7										1.67		17,635	8,818
2017CPT.02.23.20072.1	Beaufort	8	SR 1143	FROM RXR TO US 17	1	2	2WU	NO	NO	2.49	18	26,294	13,147
TOTAL FOR MAP NO. 8										2.49		26,294	13,147
2017CPT.02.23.20072.1	Beaufort	9	SR 1149	FROM US 17 TO SR 1136	1	2	2WU	NO	NO	0.64	18	6,758	3,353
TOTAL FOR MAP NO. 9										0.64		6,758	3,353
2017CPT.02.23.20072.1	Beaufort	10	SR 1151	FROM SR 1152 TO SR 1136	1	2	2WU	NO	NO	1.32	20	15,488	7,744
TOTAL FOR MAP NO. 10										1.32		15,488	7,744
2017CPT.02.23.20072.1	Beaufort	11	SR 1168	FROM US 17 TO SR 1134	1	2	2WU	NO	NO	0.19	15	1,672	832
TOTAL FOR MAP NO. 11										0.19		1,672	832
TOTAL FOR PROJ NO. 2017CPT.02.23.20072.1										17.87		195,915	97,934
2017CPT.02.24.20742.1	Pitt	12	SR 1740	FROM SR 2241 TO SR 1725	1	2	2WU	NO	NO	1.26	20	14,784	7,392
TOTAL FOR MAP NO. 12										1.26		14,784	7,392
2017CPT.02.24.20742.1	Pitt	13	SR 1745	FROM NC 43 TO SR 1749	1	2	2WU	NO	NO	1.50	18	15,840	7,941
TOTAL FOR MAP NO. 13										1.50		15,840	7,941
2017CPT.02.24.20742.1	Pitt	14	SR 1746	FROM NC 102 TO SR 1751	1	2	2WU	NO	NO	2.22	20	26,048	13,024
TOTAL FOR MAP NO. 14										2.22		26,048	13,024
2017CPT.02.24.20742.1	Pitt	15	SR 1900	FROM SR 1110 TO NC 102	1	2	2WU	NO	NO	4.85	18	51,216	25,608
TOTAL FOR MAP NO. 15										4.85		51,216	25,608
2017CPT.02.24.20742.1	Pitt	16	SR 1914	FROM SR 1910 TO NC 118	1	2	2WU	NO	NO	0.77	20	9,035	4,488
TOTAL FOR MAP NO. 16										0.77		9,035	4,488
2017CPT.02.24.20742.1	Pitt	17	SR 1917	FROM SR 1753 TO NC 118	1	2	2WU	NO	NO	1.21	24	17,037	8,518
TOTAL FOR MAP NO. 17										1.21		17,037	8,518
2017CPT.02.24.20742.1	Pitt	18	SR 1918	FROM SR 1917 TO SR 1919	1	2	2WU	NO	NO	1.84	20	21,589	10,795
TOTAL FOR MAP NO. 18										1.84		21,589	10,795
2017CPT.02.24.20742.1	Pitt	19	SR 1919	FROM SR 1753 TO CRAVEN CO.	1	2	2WU	NO	NO	2.65	18	27,984	13,992
TOTAL FOR MAP NO. 19										2.65		27,984	13,992
2017CPT.02.24.20742.1	Pitt	20	SR 1920	FROM SR 1919 TO SR 1921	1	2	2WU	NO	NO	2.09	24	29,427	14,714
TOTAL FOR MAP NO. 20										2.09		29,427	14,714
2017CPT.02.24.20742.1	Pitt	21	SR 1928	FROM SR 1725 TO SR 1929	1	2	2WU	NO	NO	0.77	20	9,035	4,517
TOTAL FOR MAP NO. 21										0.77		9,035	4,517
2017CPT.02.24.20742.1	Pitt	22	SR 2227	FROM NC 118 TO NC 118	1	2	2WU	NO	NO	1.58	18	16,685	8,364
TOTAL FOR MAP NO. 22										1.58		16,685	8,364
TOTAL FOR PROJ NO. 2017CPT.02.24.20742.1										20.74		238,680	119,353
GRAND TOTAL										38.61		434,595	217,287

PROJECT NO.	SHEET NO.
DB00335	5

THERMOPLASTIC AND PAINT QUANTITIES

PROJECT NO	COUNTY	MAP NO	ROUTE	DESCRIPTION	TYP NO	LANES	LANE TYPE	LENGTH	WIDTH	441300000-E	445700000-N
										WORK ZONE ADVANCE/GENERAL WARNING SIGNING SF	TEMPORARY TRAFFIC CONTROL LS
2017CPT.02.23.20072.1	Beaufort	1	SR 1103	FROM SR 1112 TO DEAD END	1	2	2WU	1.93	20	220	0.05
TOTAL FOR MAP NO. 1											
2017CPT.02.23.20072.1	Beaufort	2	SR 1112	FROM SR 1103 TO SR 1189	1	2	2WU	1.05	18	120	0.06
TOTAL FOR MAP NO. 2											
2017CPT.02.23.20072.1	Beaufort	3	SR 1118	FROM SR 1114 TO END MAINT	1	2	2WU	2.54	18	285	0.07
TOTAL FOR MAP NO. 3											
2017CPT.02.23.20072.1	Beaufort	4	SR 1125	FROM NC 33 TO SR 1123	1	2	2WU	1.81	20	205	0.05
TOTAL FOR MAP NO. 4											
2017CPT.02.23.20072.1	Beaufort	5	SR 1129	FROM SR 1127 TO SR 1128	1	2	2WU	1.43	16	160	0.04
TOTAL FOR MAP NO. 5											
2017CPT.02.23.20072.1	Beaufort	6	SR 1134	FROM US 17 TO SR 1152	1	2	2WU	2.80	20	315	0.04
TOTAL FOR MAP NO. 6											
2017CPT.02.23.20072.1	Beaufort	7	SR 1137	FROM SR 1127 TO SR 1138	1	2	2WU	1.67	18	190	0.04
TOTAL FOR MAP NO. 7											
2017CPT.02.23.20072.1	Beaufort	8	SR 1143	FROM RXR TO US 17	1	2	2WU	2.49	18	280	0.07
TOTAL FOR MAP NO. 8											
2017CPT.02.23.20072.1	Beaufort	9	SR 1149	FROM US 17 TO SR 1136	1	2	2WU	0.64	18	75	0.02
TOTAL FOR MAP NO. 9											
2017CPT.02.23.20072.1	Beaufort	10	SR 1151	FROM SR 1152 TO SR 1136	1	2	2WU	1.32	20	150	0.03
TOTAL FOR MAP NO. 10											
2017CPT.02.23.20072.1	Beaufort	11	SR 1168	FROM US 17 TO SR 1134	1	2	2WU	0.19	15	25	0.01
TOTAL FOR MAP NO. 11											
TOTAL FOR PROJ NO. 2017CPT.02.23.20072.1								17.87		2,025	0.46
2017CPT.02.24.20742.1	Pitt	12	SR 1740	FROM SR 2241 TO SR 1725	1	2	2WU	1.26	20	145	0.03
TOTAL FOR MAP NO. 12											
2017CPT.02.24.20742.1	Pitt	13	SR 1745	FROM NC 43 TO SR 1749	1	2	2WU	1.50	18	170	0.04
TOTAL FOR MAP NO. 13											
2017CPT.02.24.20742.1	Pitt	14	SR 1746	FROM NC 102 TO SR 1751	1	2	2WU	2.22	20	250	0.06
TOTAL FOR MAP NO. 14											
2017CPT.02.24.20742.1	Pitt	15	SR 1900	FROM SR 1110 TO NC 102	1	2	2WU	4.85	18	545	0.13
TOTAL FOR MAP NO. 15											
2017CPT.02.24.20742.1	Pitt	16	SR 1914	FROM SR 1910 TO NC 118	1	2	2WU	0.77	20	90	0.02
TOTAL FOR MAP NO. 16											
2017CPT.02.24.20742.1	Pitt	17	SR 1917	FROM SR 1753 TO NC 118	1	2	2WU	1.21	24	135	0.03
TOTAL FOR MAP NO. 17											
2017CPT.02.24.20742.1	Pitt	18	SR 1918	FROM SR 1917 TO SR 1919	1	2	2WU	1.84	20	210	0.05
TOTAL FOR MAP NO. 18											
2017CPT.02.24.20742.1	Pitt	19	SR 1919	FROM SR 1753 TO CRAVEN CO.	1	2	2WU	2.65	18	300	0.07
TOTAL FOR MAP NO. 19											
2017CPT.02.24.20742.1	Pitt	20	SR 1920	FROM SR 1919 TO SR 1921	1	2	2WU	2.09	24	235	0.05
TOTAL FOR MAP NO. 20											
2017CPT.02.24.20742.1	Pitt	21	SR 1928	FROM SR 1725 TO SR 1929	1	2	2WU	0.77	20	90	0.02
TOTAL FOR MAP NO. 21											
2017CPT.02.24.20742.1	Pitt	22	SR 2227	FROM NC 118 TO NC 118	1	2	2WU	1.58	18	180	0.04
TOTAL FOR MAP NO. 22											
TOTAL FOR PROJ NO. 2017CPT.02.24.20742.1								20.74		2,350	0.54
GRAND TOTAL											
								38.61		4,375	1.00

SIGNING FOR ASPHALT SURFACE TREATMENT

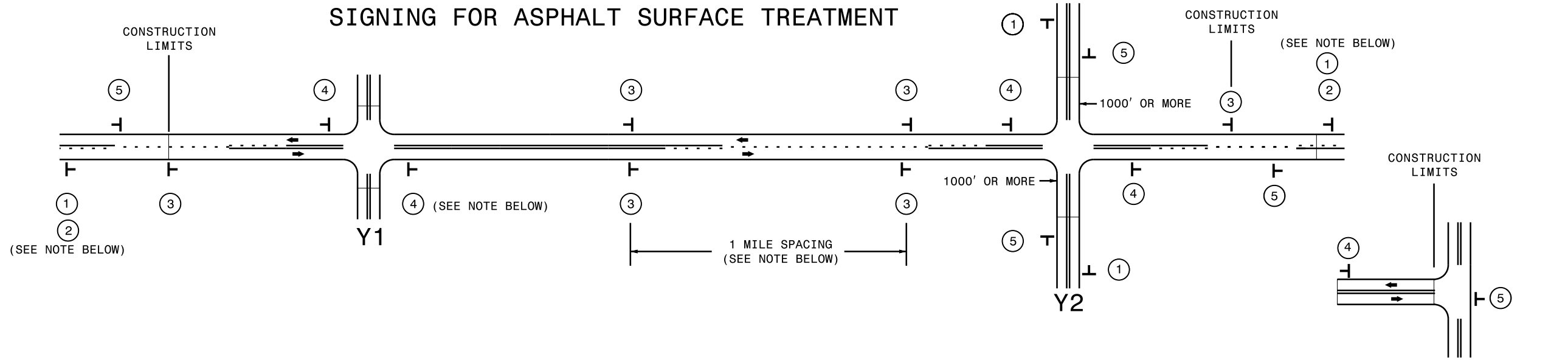

LEGEND
 T STATIONARY SIGN
 ← DIRECTION OF TRAFFIC FLOW

MAINLINE (-L-) SIGNING

-Y- LINE SIGNING

SIGNING NOTES AND PLACEMENT PER DIRECTION		<p>PLACE 1000' PRIOR TO BEGINNING OF CONSTRUCTION LIMITS. ONLY USED ON -Y- LINES IF RESURFACING LIMITS EXTEND 1000' ALONG -Y- LINE.</p>	<p>NO REQUIRED STATIONARY SIGNING FOR THE FOLLOWING -Y- LINE CONDITIONS:</p> <ol style="list-style-type: none"> LESS THAN 1000' OF RESURFACING ALONG -Y- LINE SUBDIVISION ROADS DEAD END ROADS <p>WHEN PAVING/CONSTRUCTION ACTIVITIES PROCEED ACROSS AN UNSIGNED -Y- LINE, ADVANCE WARNING PORTABLE SIGNS SHALL BE USED ALONG THE -Y- LINE AS SHOWN BELOW. REMOVE UPON COMPLETION OF WORK.</p> <div style="display: flex; justify-content: space-around;"> </div> <p>PLACED 500' IN ADVANCE OF FLAGGER. PLACED 250' IN ADVANCE OF FLAGGER.</p>
		<p>#2 SIGN ONLY USED WHEN RESURFACING LIMITS ARE 2 OR MORE MILES IN LENGTH. ROUND UP TO NEXT WHOLE NUMBER. (NO FRACTIONAL OR DECIMAL NUMBERS)</p>	
	 	<p>- ALTERNATE THE FOLLOWING TWO SIGNS: - STARTING WITH "LOOSE GRAVEL" (W8-7) FOLLOWED BY "UNMARKED PAVEMENT". - PLACE INITIALLY AT THE CONSTRUCTION LIMITS AND SPACED 1 MILE APART THEREAFTER. - AT TEE INTERSECTIONS INSTALL INITIALLY 0.5 MILE FROM INTERSECTION AND SPACE 1 MILE APART THEREAFTER.</p>	
		<p>- THESE ARE FOR -Y- LINES THAT ARE "THROUGH" ROADWAYS. - DEAD END AND SUBDIVISION ROADS ARE NOT "THROUGH" ROADWAYS. - INSTALL 500' +/- FROM EACH -Y- LINE APPROACH AS SHOWN ABOVE. - FOR MULTIPLE -Y- LINES THAT ARE SEPARATED BY 0.25 MILES OR LESS, TREAT AS A SINGLE UNIT AND INSTALL WITHIN 500' OF EACH APPROACH. - A MAXIMUM OF 2 SIGN SETS PER MILE. DO NOT INSTALL WHEN -Y- LINES ARE WITHIN 0.5 MILES FROM "END ROAD WORK" SIGN. - FOR TEE INTERSECTIONS, INSTALL WITHIN 500' +/- OF THE INTERSECTION ALONG -L- LINE.</p>	
		<p>PLACE 500' FOLLOWING THE END OF CONSTRUCTION LIMITS OR AS SHOWN WHEN WORK ENDS AT A 3-WAY TEE INTERSECTION.</p>	



ADVANCE WARNING SIGNS FOR ASPHALT SURFACE TREATMENTS 2 LANE ROADWAYS

08-MAR-2017 11:25 C:\Users\lids\Documents\Assistant Division Maintenance Engineer\Bituminous Seal Treatment\FY 2018 DB00335_Contract Documents\DN\DB00335 (6 TrafficControl).dgn