

09/08/99

TIP PROJECT: W5202L

CONTRACT:

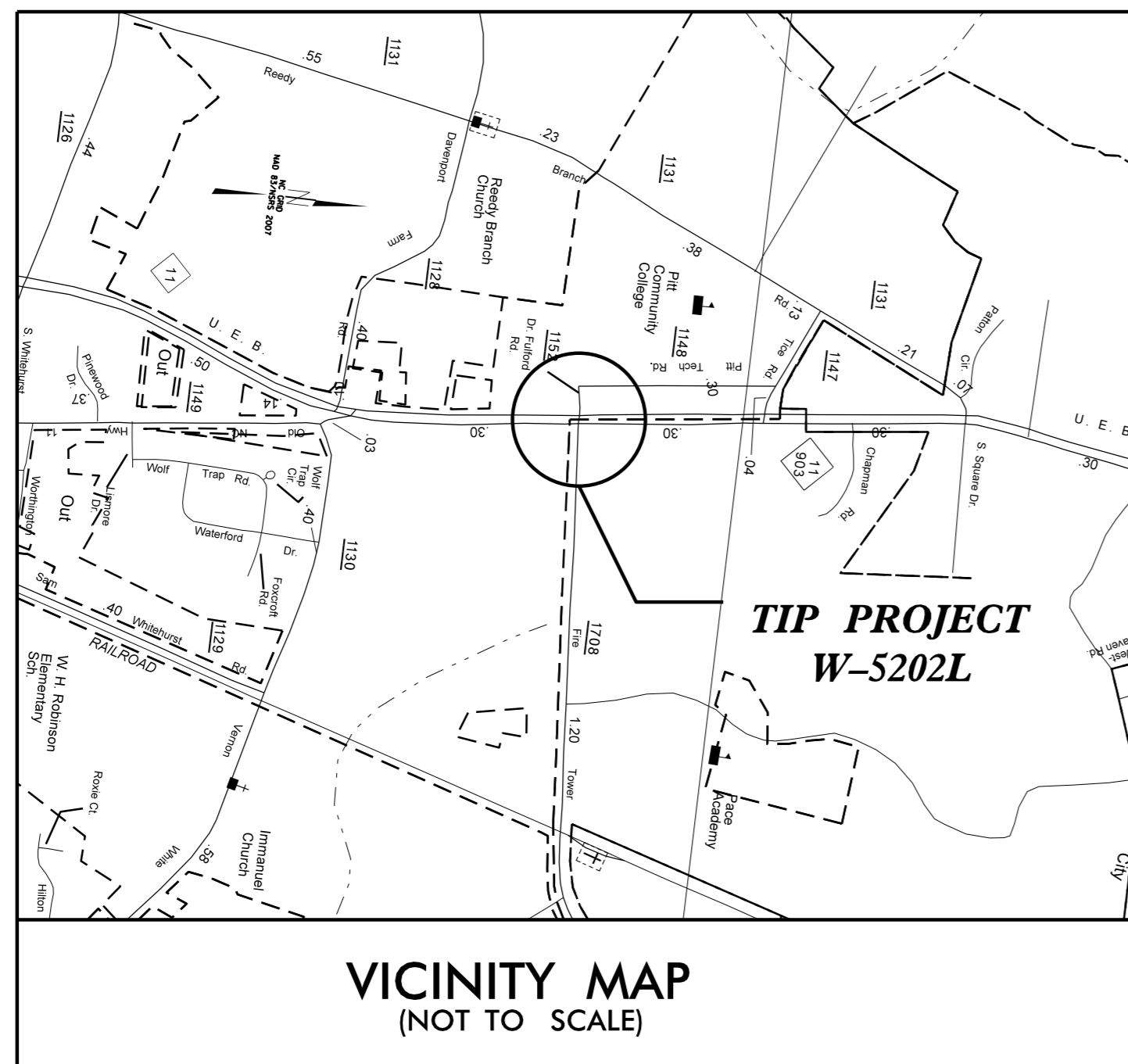

VICINITY MAP
(NOT TO SCALE)

See Sheet 1-A For Index of Sheets

STATE OF NORTH CAROLINA
DIVISION OF HIGHWAYS

PITT COUNTY

LOCATION: NC 11 AT FIRETOWER

TYPE OF WORK: WIDENING, PAVING, GRADING, DRAINAGE

| STATE | STATE PROJECT REFERENCE NO. | SHEET NO. | TOTAL SHEETS |
|-----------------|-----------------------------|-------------|--------------|
| N.C. | W5202L | 1 | |
| STATE PROJ. NO. | F.A. PROJ. NO. | DESCRIPTION | |
| 45332.1.12 | | PE | |
| 45332.3.12 | | CONST | |
| | | | |
| | | | |
| | | | |

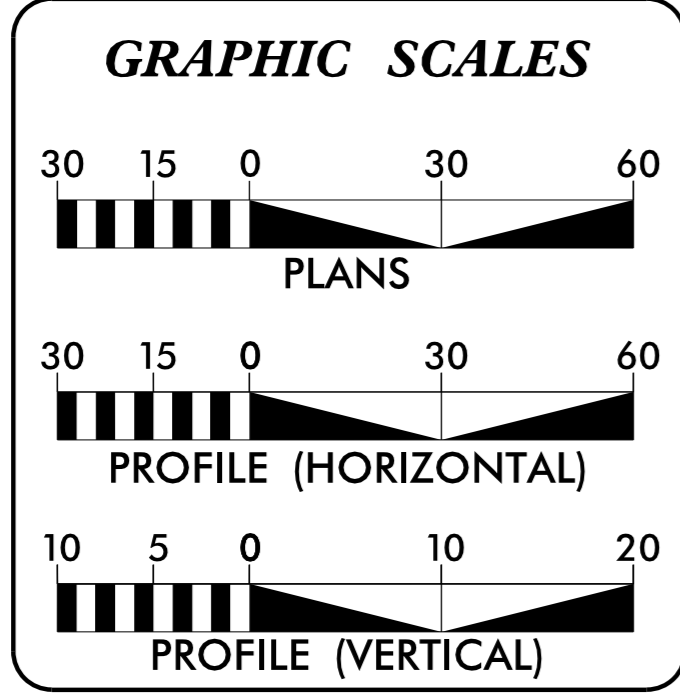
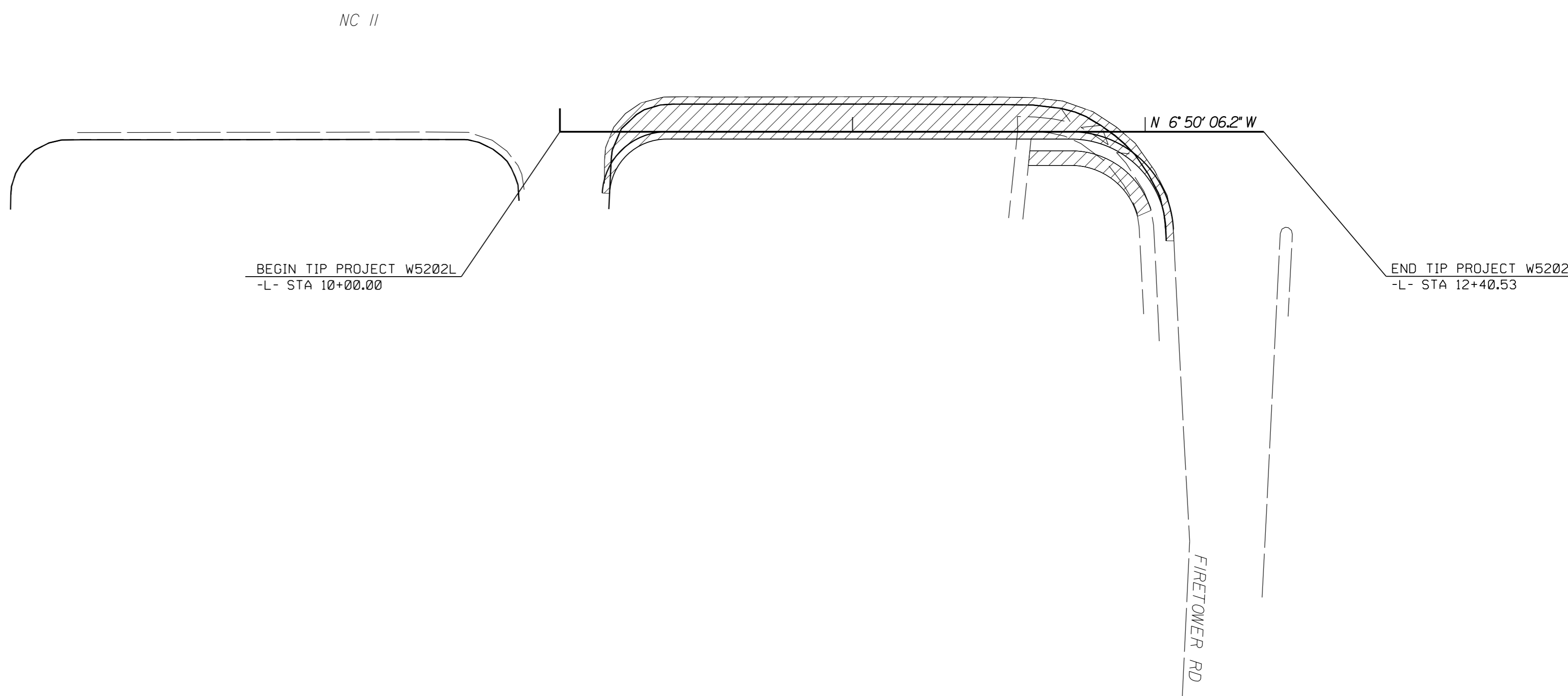
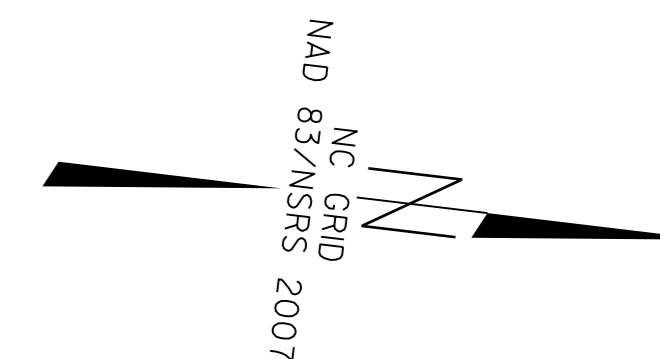

DESIGN DATA

| | | |
|------------|---|------|
| ADT | = | |
| ADT | = | |
| DHV | = | % |
| D | = | % |
| T | = | % * |
| V | = | MPH |
| * TTST | = | DUAL |
| FUNC CLASS | = | |

PROJECT LENGTH

TIP PROJECT W-5202L LENGTH = 0.046 MILES

Prepared in the Office of:
DIVISION OF HIGHWAYS
1704 N. GREENE STREET, GREENVILLE NC, 27835

2012 STANDARD SPECIFICATIONS

RIGHT OF WAY DATE: _____

LETTING DATE: APRIL 2014

DWAYNE ALLIGOOD
PROJECT ENGINEER

LANG JONES
PROJECT DESIGN ENGINEER

HYDRAULICS ENGINEER

Dwayne H. Alligood
SIGNATURE: 03/18/2014

ROADWAY DESIGN ENGINEER

Dwayne H. Alligood
SIGNATURE: 03/18/2014

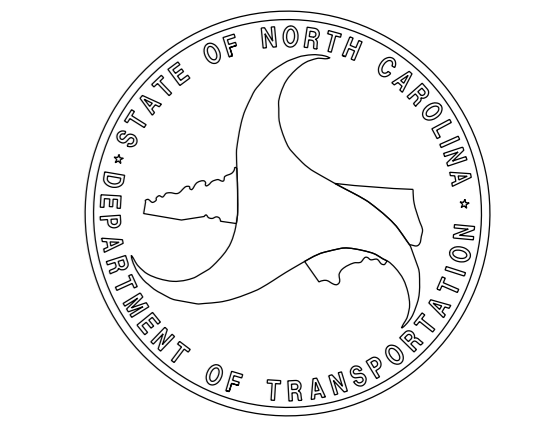

18-MAR-2014 14:34
G:\PROJECTS\PITT_WFIRE\NFI\FIRE\NC11_ddc2_pshi.dgn
jwwilder AT D2CAD27037

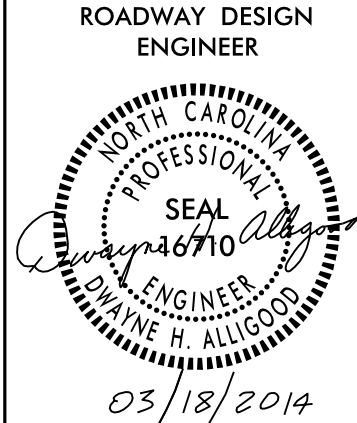

INDEX OF SHEETS

| SHEET NUMBER | SHEET |
|--------------|---|
| 1 | TITLE SHEET |
| 1A | INDEX OF SHEETS, GENERAL NOTES, STANDARD DRAWINGS |
| 1B | CONVENTIONAL SYMBOLS |
| 2 | TYPICAL SECTIONS |
| 3 | SUMMARY OF QUANTITIES |
| 3A | SUMMARY OF DRAINAGE QUANTITIES AND EARTHWORK |
| 4 | PLAN SHEET |
| EC1-EC3 | EROSION CONTROL SHEETS |
| X1A | CROSS-SECTION SUMMARY |
| X1 | CROSS-SECTIONS |

GENERAL NOTES:

2012 SPECIFICATIONS
 EFFECTIVE: 01-17-2012
 REVISED: 07-30-2012

GRADING AND SURFACING OR RESURFACING AND WIDENING:

THE GRADE LINES SHOWN DENOTE THE FINISHED ELEVATION OF THE PROPOSED SURFACING AT GRADE POINTS SHOWN ON THE TYPICAL SECTIONS. WHERE NO GRADE LINES ARE SHOWN, THE PROFILES SHOWN DENOTE THE TOP ELEVATION OF THE EXISTING PAVEMENT ALONG THE CENTER LINE OF SURVEY ON WHICH THE PROPOSED RESURFACING WILL BE PLACED. GRADE LINES MAY BE ADJUSTED BY THE ENGINEER IN ORDER TO SECURE A PROPER TIE-IN.

SIDE ROADS:

THE CONTRACTOR WILL BE REQUIRED TO DO ALL NECESSARY WORK TO PROVIDE SUITABLE CONNECTIONS WITH ALL ROADS, STREETS, AND DRIVES ENTERING THIS PROJECT. THIS WORK WILL BE PAID FOR AT THE CONTRACT UNIT PRICE FOR THE PARTICULAR ITEMS INVOLVED.

DRIVEWAYS:

STREET TURNOUT:

STREET RETURNS SHALL BE CONSTRUCTED IN ACCORDANCE WITH STD. NO. 848.04 USING THE RADII NOTED ON PLANS.
 ANY RELOCATION OF EXISTING UTILITIES WILL BE ACCOMPLISHED BY OTHERS.

RIGHT-OF-WAY MARKERS:

ALL RIGHT-OF-WAY MARKERS ON THIS PROJECT SHALL BE PLACED BY OTHERS.

CURB RAMP:

CURB RAMP ARE SHOWN ON THE PLANS AT APPROXIMATE LOCATIONS.
 CONSTRUCT ALL CURB RAMP ACCORDANCE WITH STD 848.05 and/or 848.06.

2012 ROADWAY ENGLISH STANDARD DRAWINGS

EFF. 01-17-2012
 REV. 10-30-2012

The following Roadway Standards as appear in "Roadway Standard Drawings" Highway Design Branch - N. C. Department of Transportation - Raleigh, N. C., Dated January, 2012 are applicable to this project and by reference hereby are considered a part of these plans:

| STD. NO. | TITLE |
|---|---|
| DIVISION 2 - EARTHWORK | |
| 225.02 | Guide for Grading Subgrade - Secondary and Local |
| DIVISION 3 - PIPE CULVERTS | |
| 300.01 | Method of Pipe Installation |
| DIVISION 7 - CONCRETE PAVEMENTS AND SHOULDERS | |
| 700.05 | Tying Proposed Pavement to Existing |
| DIVISION 8 - INCIDENTALS | |
| 840.02 | Concrete Catch Basin - 12" thru 54" Pipe |
| 840.03 | Frame, Grates and Hood - for Use on Standard Catch Basin |
| 840.34 | Traffic Bearing Junction Box - for Use with Pipes 42" and Under |
| 848.02 | Driveway Turnout - Radius Type |
| 848.05 | Curb Ramp - Proposed Curb & Gutter |

12/05/11

Note: Not to Scale

*S.U.E. = Subsurface Utility Engineering

STATE OF NORTH CAROLINA
DIVISION OF HIGHWAYS

CONVENTIONAL PLAN SHEET SYMBOLS

BOUNDARIES AND PROPERTY:

| | |
|--|-----------|
| State Line | ----- |
| County Line | ----- |
| Township Line | ----- |
| City Line | ----- |
| Reservation Line | ----- |
| Property Line | ----- |
| Existing Iron Pin | ○ EP |
| Property Corner | -----> |
| Property Monument | □ ECM |
| Parcel/Sequence Number | ⑫③ |
| Existing Fence Line | -x-x-x- |
| Proposed Woven Wire Fence | ○ |
| Proposed Chain Link Fence | □ |
| Proposed Barbed Wire Fence | ◇ |
| Existing Wetland Boundary | ----- MLB |
| Proposed Wetland Boundary | ----- MLB |
| Existing Endangered Animal Boundary | ----- EAB |
| Existing Endangered Plant Boundary | ----- EPB |
| Known Soil Contamination: Area or Site | ☠ |
| Potential Soil Contamination: Area or Site | ☠? |

BUILDINGS AND OTHER CULTURE:

| | |
|-------------------------------|-----|
| Gas Pump Vent or U/G Tank Cap | ○ |
| Sign | ○ |
| Well | ○ W |
| Small Mine | ✕ |
| Foundation | □ |
| Area Outline | □ |
| Cemetery | □ † |
| Building | □ |
| School | □ |
| Church | □ |
| Dam | □ |

HYDROLOGY:

| | |
|------------------------------------|------------|
| Stream or Body of Water | ----- |
| Hydro, Pool or Reservoir | □ |
| Jurisdictional Stream | ----- JS |
| Buffer Zone 1 | ----- BZ 1 |
| Buffer Zone 2 | ----- BZ 2 |
| Flow Arrow | ← |
| Disappearing Stream | -----> |
| Spring | ○ |
| Wetland | ----- |
| Proposed Lateral, Tail, Head Ditch | ----- |
| False Sump | ----- |

RAILROADS:

| | |
|--------------------|-------------------------------------|
| Standard Gauge | ----- |
| RR Signal Milepost | ○ CSX TRANSPORTATION MILEPOST 35 |
| Switch | □ SWITCH |
| RR Abandoned | ----- |
| RR Dismantled | ----- |

RIGHT OF WAY:

| | |
|--|------------|
| Baseline Control Point | ◆ |
| Existing Right of Way Marker | △ |
| Existing Right of Way Line | ----- |
| Proposed Right of Way Line | ----- RW |
| Proposed Right of Way Line with Iron Pin and Cap Marker | ----- RW ▲ |
| Proposed Right of Way Line with Concrete or Granite R/W Marker | ----- RW ▲ |
| Proposed Control of Access Line with Concrete CA Marker | ----- CA |
| Existing Control of Access | ----- CA |
| Proposed Control of Access | ----- CA |
| Existing Easement Line | ----- E |
| Proposed Temporary Construction Easement | ----- E |
| Proposed Temporary Drainage Easement | ----- TDE |
| Proposed Permanent Drainage Easement | ----- PDE |
| Proposed Permanent Drainage / Utility Easement | ----- DUE |
| Proposed Permanent Utility Easement | ----- PUE |
| Proposed Temporary Utility Easement | ----- TUE |
| Proposed Aerial Utility Easement | ----- AUE |
| Proposed Permanent Easement with Iron Pin and Cap Marker | ----- ◆ |

ROADS AND RELATED FEATURES:

| | |
|----------------------------|----------|
| Existing Edge of Pavement | ----- |
| Existing Curb | ----- |
| Proposed Slope Stakes Cut | ----- C |
| Proposed Slope Stakes Fill | ----- F |
| Proposed Curb Ramp | ----- CR |
| Existing Metal Guardrail | ----- |
| Proposed Guardrail | ----- |
| Existing Cable Guiderail | ----- |
| Proposed Cable Guiderail | ----- |
| Equality Symbol | ⊕ |
| Pavement Removal | ----- |

VEGETATION:

| | |
|--------------|-------|
| Single Tree | ☼ |
| Single Shrub | ☼ |
| Hedge | ----- |
| Woods Line | ----- |

| | |
|----------|-------|
| Orchard | ----- |
| Vineyard | ----- |

EXISTING STRUCTURES:

| | |
|--|---------------|
| MAJOR: | |
| Bridge, Tunnel or Box Culvert | ----- CONC |
| Bridge Wing Wall, Head Wall and End Wall | ----- CONC WW |
| MINOR: | |
| Head and End Wall | ----- CONC HW |
| Pipe Culvert | ----- |
| Footbridge | ----- |
| Drainage Box: Catch Basin, DI or JB | □ CB |
| Paved Ditch Gutter | ----- |
| Storm Sewer Manhole | ○ |
| Storm Sewer | ----- S |

UTILITIES:

| | |
|-------------------------------------|---------|
| POWER: | |
| Existing Power Pole | ● |
| Proposed Power Pole | ○ |
| Existing Joint Use Pole | ● |
| Proposed Joint Use Pole | ○ |
| Power Manhole | ⊕ |
| Power Line Tower | ⊗ |
| Power Transformer | ⊗ |
| U/G Power Cable Hand Hole | □ |
| H-Frame Pole | ● |
| Recorded U/G Power Line | ----- P |
| Designated U/G Power Line (S.U.E.*) | ----- P |

TELEPHONE:

| | |
|---|------------|
| Existing Telephone Pole | ● |
| Proposed Telephone Pole | ○ |
| Telephone Manhole | ⊕ |
| Telephone Booth | □ |
| Telephone Pedestal | ⊕ |
| Telephone Cell Tower | ⊕ |
| U/G Telephone Cable Hand Hole | □ |
| Recorded U/G Telephone Cable | ----- T |
| Designated U/G Telephone Cable (S.U.E.*) | ----- T |
| Recorded U/G Telephone Conduit | ----- TC |
| Designated U/G Telephone Conduit (S.U.E.*) | ----- TC |
| Recorded U/G Fiber Optics Cable | ----- T FO |
| Designated U/G Fiber Optics Cable (S.U.E.*) | ----- T FO |

WATER:

| | |
|-------------------------------------|-----------------|
| Water Manhole | ⊕ |
| Water Meter | ○ |
| Water Valve | ⊗ |
| Water Hydrant | ⊕ |
| Recorded U/G Water Line | ----- W |
| Designated U/G Water Line (S.U.E.*) | ----- W |
| Above Ground Water Line | ----- A/G Water |

TV:

| | |
|--|-------------|
| TV Satellite Dish | ☼ |
| TV Pedestal | □ |
| TV Tower | ⊗ |
| U/G TV Cable Hand Hole | □ |
| Recorded U/G TV Cable | ----- TV |
| Designated U/G TV Cable (S.U.E.*) | ----- TV |
| Recorded U/G Fiber Optic Cable | ----- TV FO |
| Designated U/G Fiber Optic Cable (S.U.E.*) | ----- TV FO |

GAS:

| | |
|-----------------------------------|---------------|
| Gas Valve | ◇ |
| Gas Meter | ⊕ |
| Recorded U/G Gas Line | ----- G |
| Designated U/G Gas Line (S.U.E.*) | ----- G |
| Above Ground Gas Line | ----- A/G Gas |

SANITARY SEWER:

| | |
|--|--------------------------|
| Sanitary Sewer Manhole | ⊕ |
| Sanitary Sewer Cleanout | ⊕ |
| U/G Sanitary Sewer Line | ----- SS |
| Above Ground Sanitary Sewer | ----- A/G Sanitary Sewer |
| Recorded SS Forced Main Line | ----- FSS |
| Designated SS Forced Main Line (S.U.E.*) | ----- FSS |

MISCELLANEOUS:

| | |
|--|------------|
| Utility Pole | ● |
| Utility Pole with Base | □ |
| Utility Located Object | ○ |
| Utility Traffic Signal Box | ⊕ |
| Utility Unknown U/G Line | ----- ?UTL |
| U/G Tank; Water, Gas, Oil | □ |
| Underground Storage Tank, Approx. Loc. | ⊕ |
| A/G Tank; Water, Gas, Oil | □ |
| Geoenvironmental Boring | ⊕ |
| U/G Test Hole (S.U.E.*) | ⊕ |
| Abandoned According to Utility Records | AATUR |
| End of Information | E.O.I. |

STATE OF NORTH CAROLINA
DIVISION OF HIGHWAYS
SUMMARY OF QUANTITIES

| SECT | QUANTITY | UNIT | ITEM DESCRIPTION |
|------|----------|------|---|
| 800 | 1 | LS | MOBILIZATION |
| 801 | 1 | LS | CONSTRUCTION SURVEYING |
| 226 | 1 | LS | GRADING |
| 610 | 90 | TON | ASPHALT CONCRETE BASE COURSE,TYPE B25.0B |
| 610 | 60 | TON | ASPHALT CONCRETE INTERMEDIATE COURSE,TYPE I19.0B |
| 610 | 40 | TON | ASPHALT CONCRETE SURFACE COURSE,TYPE S9.5B |
| 620 | 10 | TON | ASPHALT BINDER FOR PLANT MIX,GRADE PG64-22 |
| 300 | 10 | TON | FOUNDATION CONDITIONING MATERIAL,MINOR STRUCTURES |
| 300 | 10 | SY | FOUNDATION CONDITIONING GEOTEXTILE |
| 305 | 10 | LF | 15" RCP (CLASS IV) |
| 840 | 2 | EA | MASONRY DRAINAGE STRUCTURES |
| 840 | 1 | EA | FRAME WITH GRATE & HOOD,STD 840.03,TYPE E |
| 840 | 1 | EA | FRAME WITH COVER,STD 840.54 |
| 1605 | 150 | LF | TEMPORARY SILT FENCE |
| 1620 | 50 | LB | SEED FOR TEMPORARY SEEDING |
| 1620 | 0.2 | TON | FERTILIZER FOR TEMPORARY SEEDING |
| 1660 | 1 | ACRE | SEEDING AND MULCHING |
| 1661 | 50 | LB | SEED FOR REPAIR SEEDING |
| 1661 | 2 | TON | FERTILIZER FOR REPAIR SEEDING |
| SP | 4 | EA | RESPONSE FOR EROSION CONTROL |
| 846 | 230 | LF | 2' 6" CONCRETE CURB AND GUTTER |
| 848 | 30 | SY | 4" CONCRETE SIDEWALK |
| 848 | 1 | EA | CONCRETE CURB RAMP |

REVISIONS

8/17/99

I:\MAR_2014\1434\PROJECT\AT\DC\AT27071\WF\FRE@NC11.ddc2.pst\3.dgn

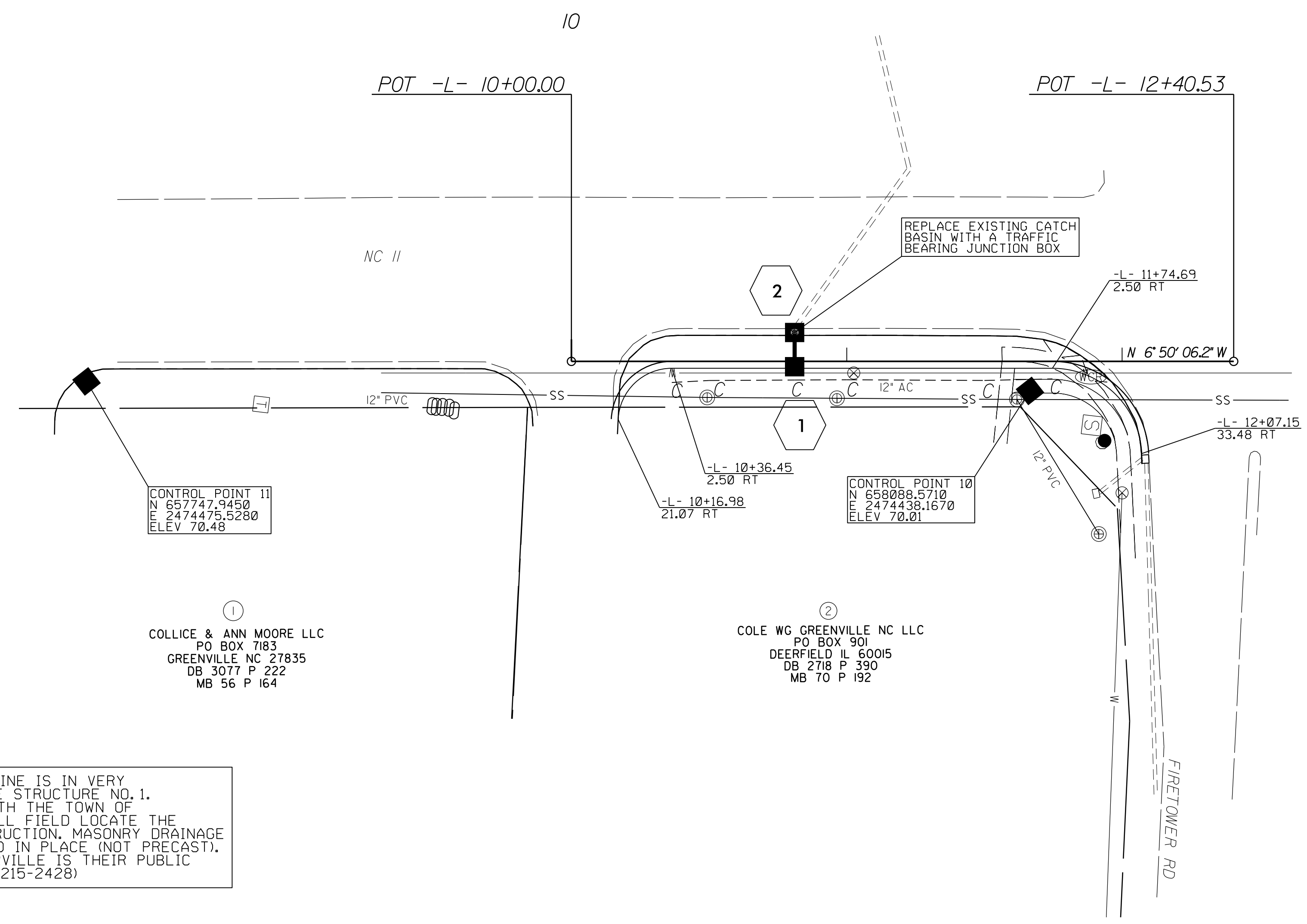
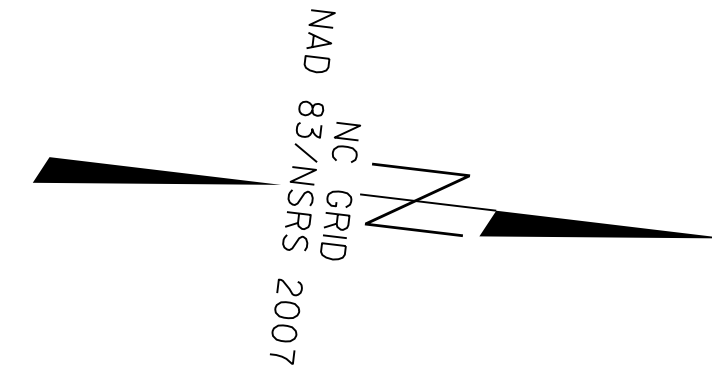
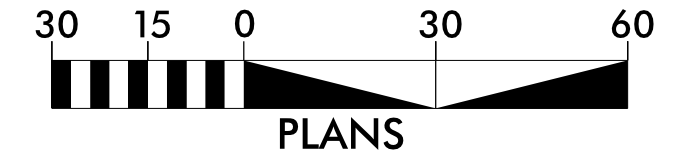

TOWN OF WINTERVILLE'S 12" AC WATER LINE IS IN VERY CLOSE PROXIMITY TO MASONRY DRAINAGE STRUCTURE NO. 1. THE CONTRACTOR SHALL COORDINATE WITH THE TOWN OF WINTERVILLE AND THE CONTRACTOR SHALL FIELD LOCATE THE WATER LINE PRIOR TO STARTING CONSTRUCTION. MASONRY DRAINAGE STRUCTURE NO. 1 SHALL BE CONSTRUCTED IN PLACE (NOT PRECAST). THE CONTACT FOR THE TOWN OF WINTERVILLE IS THEIR PUBLIC WORKS DIRECTOR, TRAVIS WELBORN (252-215-2428)

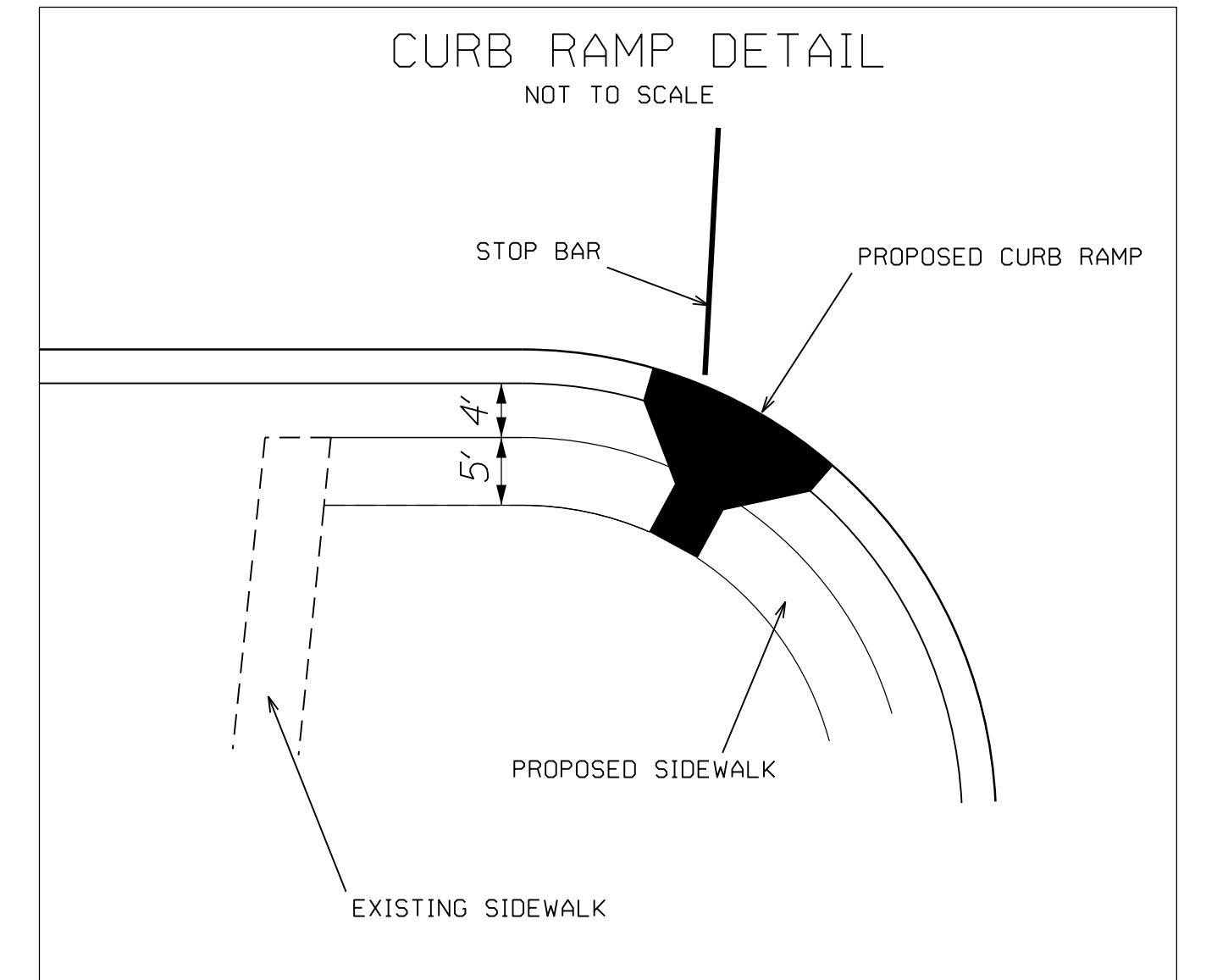

REVISIONS

-LPRO-
SCALE: 1" = 30' HORIZ.
1" = 10' VERT.

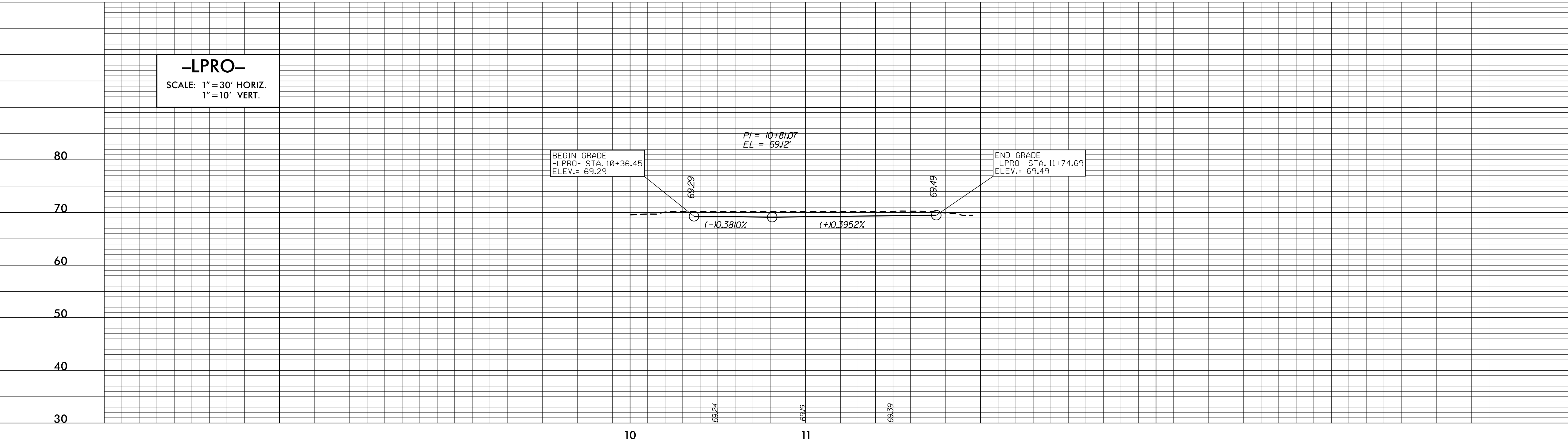

8/17/99

I:\8-VAR-2014\4434\PROJECT\AT\120127001\WF\FRE@NC11.dwg 2:ps4.dgn

DIVISION OF HIGHWAYS
STATE OF NORTH CAROLINA

CROSS-SECTION SUMMARY
IN CUBIC YARDS

| LOCATION (-L-) | UNCLASSIFIED EXCAVATION | UNDERCUT | EMBANKMENT |
|-------------------|----------------------------|----------|------------|
| <i>10 + 36.45</i> | <i>0</i> | <i>0</i> | <i>0</i> |
| <i>10 + 50.00</i> | <i>14</i> | <i>0</i> | <i>0</i> |
| <i>10 + 81.07</i> | <i>30</i> | <i>0</i> | <i>0</i> |
| <i>11 + 00.00</i> | <i>18</i> | <i>0</i> | <i>0</i> |
| <i>11 + 50.00</i> | <i>48</i> | <i>0</i> | <i>0</i> |
| <i>11 + 74.69</i> | <i>21</i> | <i>0</i> | <i>0</i> |

NOTE: EMBANKMENT COLUMN DOES NOT INCLUDE BACKFILL FOR UNDERCUT.

NOTE:
APPROXIMATE QUANTITIES ONLY. UNCLASSIFIED EXCAVATION, BORROW EXCAVATION, FINE GRADING, CLEARING AND GRUBBING AND REMOVAL OF EXISTING PAVEMENT WILL BE PAID FOR AT THE CONTRACT LUMP SUM PRICE FOR "GRADING."

