



STATE OF NORTH CAROLINA
DEPARTMENT OF TRANSPORTATION

PAT MCCRORY
GOVERNOR

ANTHONY J. TATA
SECRETARY

June 6, 2013

CONTRACT: DB00132
WBS ELEMENTS: 17BP.2.R.13, 17BP.2.R.15
COUNTY: Beaufort
ROUTES: SR 1718 (Sidney Rd), SR 1530 (Baseline Rd)
DESCRIPTION: Bridge-to-Pipe Replacements of Bridges #124, #241
ADDENDUM NUMBER 1

TO: Prospective Bidders

Please note the following revisions to the contract proposal for the above-referenced project. These changes are required due to quantity revision of turbidity curtain on both contracts.

- Replace the Items sheet with the version attached.
- Replace Sheet 3 and EC2 for project 17BP.2.R.13 and Sheet 3 for project 17BP.2.R.15 with the versions attached.
- An electronic addendum file (DB00132.001) is available on the Division 2 letting website if bidders elect to utilize the computer bid preparation option.

If you should have any questions concerning this addendum, please call me at (252) 439-2807.

Sincerely,

A handwritten signature in black ink that reads "A Bullard".

Aaron Bullard, PE
Division Contract Officer

Attachments

cc: Mr. Ed Eatmon, PE
Mr. Bill Kincannon, PE
Ms. Maria Rogerson, PE

MAILING ADDRESS:
DIVISION TWO - OPERATIONS
P.O. BOX 1587
GREENVILLE, NC 27835

TELEPHONE: (252) 439-2800
FAX: (252) 830-3341
WEBSITE: WWW.NCDOT.GOV

LOCATION:
1704 N GREENE ST
GREENVILLE, NC

County : Beaufort

Line #	Item Number	Sec #	Description	Quantity	Unit Cost	Amount
ROADWAY ITEMS						
0001	0000100000-N	800	MOBILIZATION	Lump Sum	L.S.	
0002	0000400000-N	801	CONSTRUCTION SURVEYING	Lump Sum	L.S.	
0003	0063000000-N	SP	GRADING BRIDGE NO. 124 SITE	Lump Sum	L.S.	
0004	0063000000-N	SP	GRADING BRIDGE NO. 241 SITE	Lump Sum	L.S.	
0005	0234000000-E	SP	GENERIC GRADING ITEM UNDERCUT EXCAVATION	200 CY		
0006	0992000000-E	SP	GENERIC PIPE ITEM ALUMINUM BOX CULVERT - 1 @ 22'-1" X 9'-3" WITH HEADW ALLS	1 EA		
0007	0992000000-E	SP	GENERIC PIPE ITEM ALUMINUM BOX CULVERT - 1 @ 33'-8" X 8'-3" WITH HEADW ALLS	1 EA		
0008	1121000000-E	520	AGGREGATE BASE COURSE	110 TON		
0009	1489000000-E	610	ASPHALT CONC BASE COURSE, TYPE B25.0B	270 TON		
0010	1498000000-E	610	ASPHALT CONC INTERMEDIATE COURSE, TYPE I19.0B	170 TON		
0011	1519000000-E	610	ASPHALT CONC SURFACE COURSE, TYPE S9.5B	80 TON		
0012	1525000000-E	610	ASPHALT CONC SURFACE COURSE, TYPE SF9.5A	100 TON		
0013	1575000000-E	620	ASPHALT BINDER FOR PLANT MIX	40 TON		
0014	3030000000-E	862	STEEL BM GUARDRAIL	400 LF		
0015	3270000000-N	SP	GUARDRAIL ANCHOR UNITS, TYPE 350	8 EA		
0016	3656000000-E	876	GEOTEXTILE FOR DRAINAGE	450 SY		

County : Beaufort

Line #	Item Number	Sec #	Description	Quantity	Unit Cost	Amount
0017	5912000000-N	SP	GENERIC UTILITY ITEM RELOCATE EXISTING 6" WATER MAIN (BRIDGE NO. 124)	Lump Sum	L.S.	
0018	5912000000-N	SP	GENERIC UTILITY ITEM RELOCATE EXISTING 6" WATER MAIN (BRIDGE NO. 241)	Lump Sum	L.S.	
0019	6000000000-E	1605	TEMPORARY SILT FENCE	800 LF		
0020	6009000000-E	1610	STONE FOR EROSION CONTROL, CLASS B	20 TON		
0021	6012000000-E	1610	SEDIMENT CONTROL STONE	20 TON		
0022	6015000000-E	1615	TEMPORARY MULCHING	1 ACR		
0023	6018000000-E	1620	SEED FOR TEMPORARY SEEDING	40 LB		
0024	6021000000-E	1620	FERTILIZER FOR TEMPORARY SEEDING	0.2 TON		
0025	6030000000-E	1630	SILT EXCAVATION	60 CY		
0026	6036000000-E	1631	MATTING FOR EROSION CONTROL	2,400 SY		
0027	6042000000-E	1632	1/4" HARDWARE CLOTH	200 LF		
0028	6048000000-E	SP	FLOATING TURBIDITY CURTAIN	320 SY		
0029	6071010000-E	SP	WATTLE	450 LF		
0030	6071020000-E	SP	POLYACRYLAMIDE (PAM)	10 LB		
0031	6084000000-E	1660	SEEDING & MULCHING	2 ACR		
0032	6090000000-E	1661	SEED FOR REPAIR SEEDING	100 LB		
0033	6093000000-E	1661	FERTILIZER FOR REPAIR SEEDING	0.4 TON		
0034	6117000000-N	SP	RESPONSE FOR EROSION CONTROL	6 EA		

County : Beaufort

Line #	Item Number	Sec #	Description	Quantity	Unit Cost	Amount
0035	8035000000-N	402	REMOVAL OF EXISTING STRUCTURE AT STATION ***** BRIDGE NO. 124	Lump Sum	L.S.	

0036	8035000000-N	402	REMOVAL OF EXISTING STRUCTURE AT STATION ***** BRIDGE NO. 241	Lump Sum	L.S.	

1557/Jun06/Q6267.6/D145678530000/E36			Total Amount Of Bid For Entire Project :			

STATE OF NORTH CAROLINA
DIVISION OF HIGHWAYS
SUMMARY OF QUANTITIES

SECT	QUANTITY	UNIT	ITEM DESCRIPTION
800	1	LS	MOBILIZATION
801	1	LS	CONSTRUCTION SURVEYING
SP	1	LS	GRADING
SP	100	CY	UNDERCUT EXCAVATION
520	65	TON	AGGREGATE BASE COURSE
610	80	TON	ASPHALT CONCRETE BASE COURSE,TYPE B25.0B
610	45	TON	ASPHALT CONCRETE INTERMEDIATE COURSE,TYPE I19.0B
610	80	TON	ASPHALT CONCRETE SURFACE COURSE,TYPE S9.5B
620	15	TON	ASPHALT BINDER FOR PLANT MIX,GRADE PG64-22
862	200	LF	STEEL BEAM GUARDRAIL
SP	4	EA	GUARDRAIL ANCHOR UNITS,TYPE 350
876	250	SY	GEOTEXTILE FOR DRAINAGE
1605	650	LF	TEMPORARY SILT FENCE
1610	10	TON	STONE FOR EROSION CONTROL,CLASS B
1610	10	TON	SEDIMENT CONTROL STONE
1615	0.5	ACRE	TEMPORARY MULCHING
1620	20	LB	SEED FOR TEMPORARY SEEDING
1620	01	TON	FERTILIZER FOR TEMPORARY SEEDING
1630	30	CY	SILT EXCAVATION
1631	1000	SY	MATTING FOR EROSION CONTROL
1632	100	LF	1/4" HARDWARE CLOTH
SP	100	LF	WATTLE
1660	1	ACRE	SEEDING AND MULCHING
1661	50	LB	SEED FOR REPAIR SEEDING
1661	0.2	TON	FERTILIZER FOR REPAIR SEEDING
SP	300	SY	TURBIDITY CURTAIN
SP	3	EA	RESPONSE FOR EROSION CONTROL
402	1	LS	REMOVAL OF EXISTING STRUCTURE AT -EL- STATION 12+7.36
SP	1	LS	1 @ 8'-3" X 33'-8" CORRUGATED ALUMINUM BOX CULVERT WITH HEADWALLS AT -EL- STATION 12+7.36
SP	1	LS	RELOCATE EXISTING 6" WATER MAIN

REVISIONS
 REVISED 6-4-2013 TO INCLUDE ADDITIONAL QUANTITIES FOR TURBIDITY CURTAIN.

04 JUN 2013 15:26
 C:\PHOTO\S\OFF\DFT\Beaufort\124\Beaufort\124.psh3.dgn
 \$\$\$JUSTFRN\$\$\$

8/17/99

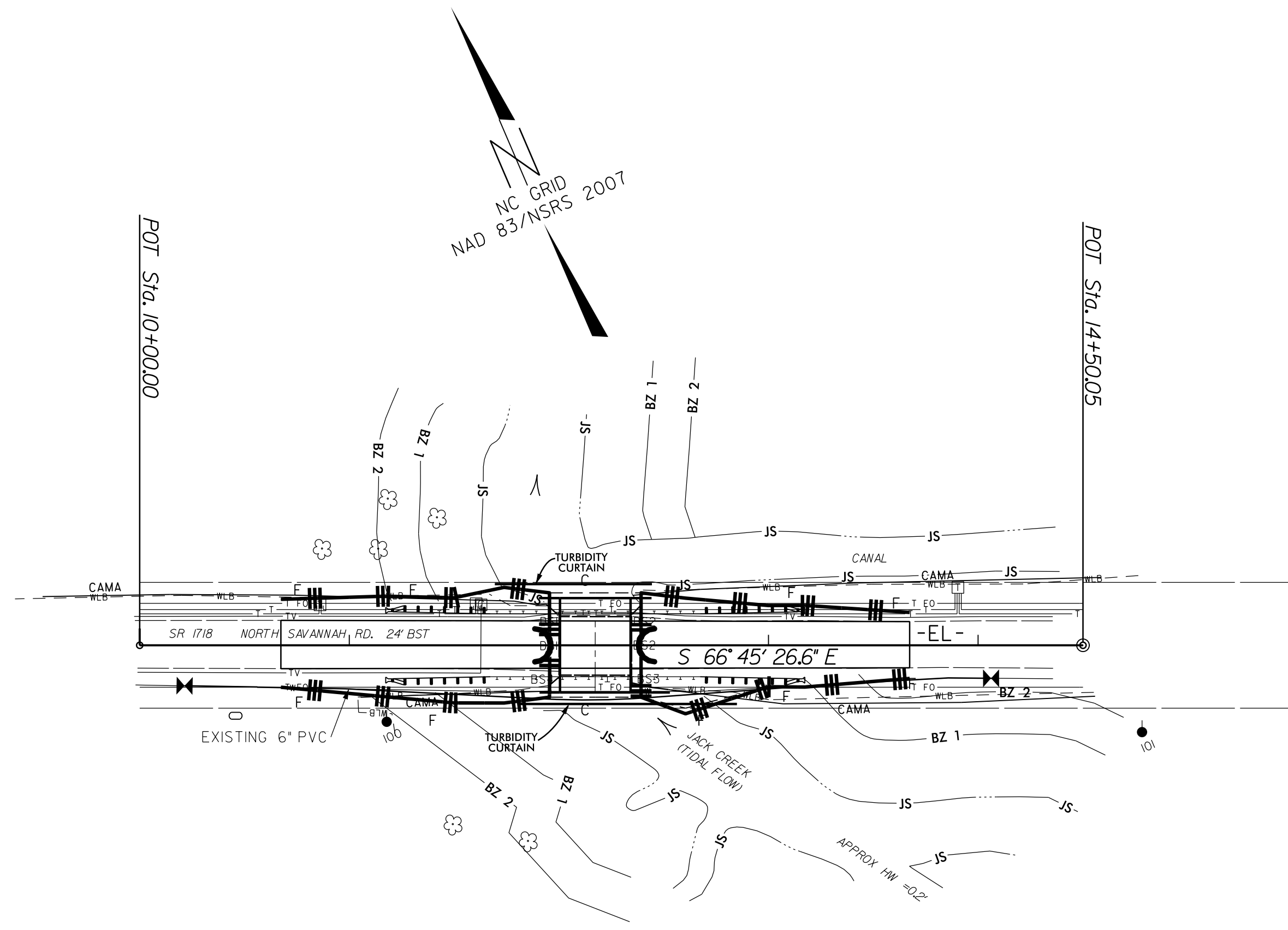
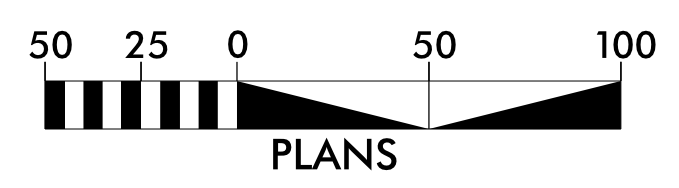

REVISIONS
 REVISED 6-4-2013 TO SHOW TURBIDITY CURTAIN.

04 JUN 2013 15:25 SAUFORT\Beaufort 124\beaufort14.ec2.dgn
 8/17/99

SOIL STABILIZATION TIMEFRAMES

SITE DESCRIPTION	STABILIZATION TIME	TIMEFRAME EXCEPTIONS
PERIMETER DIKES, SWALES, DITCHES AND SLOPES	7 DAYS	NONE
HIGH QUALITY WATER (HOW) ZONES	7 DAYS	NONE
SLOPES STEEPER THAN 3:1	7 DAYS	IF SLOPES ARE 10' OR LESS IN LENGTH AND ARE NOT STEEPER THAN 2:1, 14 DAYS ARE ALLOWED.
SLOPES 3:1 OR FLATTER	14 DAYS	7 DAYS FOR SLOPES GREATER THAN 50' IN LENGTH.
ALL OTHER AREAS WITH SLOPES FLATTER THAN 4:1	14 DAYS	NONE, EXCEPT FOR PERIMETERS AND HOW ZONES.

Std. #	Description	Symbol
1605.01	High Vis Temporary Silt Fence	
1632.03	Rock Inlet Sediment Trap Type C	
SP	Wattle with Polyacrylamide	
SP	Wattle	
	Ditch Flow Line	

NOTES: ANY DEVIATION FROM OPTIONS GIVEN WILL REQUIRE PRIOR APPROVAL BY ENGINEER.
 ADDITIONAL EROSION CONTROL DEVICES MAY NEED TO BE INSTALLED AS DIRECTED BY THE ENGINEER.
 CONTRACTOR SHALL INSTALL SPECIAL SEDIMENT CONTROL FENCE OR WATTLES IN LOW AREAS OF SILT FENCE AS NEEDED OR DIRECTED BY THE ENGINEER.

8/17/99

REVISIONS

REVISED 6-4-2013 TO INCLUDE ADDITIONAL QUANTITIES FOR TURBIDITY CURTAIN.

04 JUN 2013 15:41
 C:\AUFORPT\Beaufort 241\6241.ddc2\psh_3.dgn
 9:58:41 AM

STATE OF NORTH CAROLINA
 DIVISION OF HIGHWAYS
 SUMMARY OF QUANTITIES

SECT	QUANTITY	UNIT	ITEM DESCRIPTION
800	1	LS	MOBILIZATION
801	1	LS	CONSTRUCTION SURVEYING
SP	1	LS	GRADING
SP	100	CY	UNDERCUT EXCAVATION
520	45	TON	AGGREGATE BASE COURSE
610	190	TON	ASPHALT CONCRETE BASE COURSE,TYPE B25.0B
610	125	TON	ASPHALT CONCRETE INTERMEDIATE COURSE,TYPE I19.0B
610	100	TON	ASPHALT CONCRETE SURFACE COURSE,TYPE SF9.5A
620	25	TON	ASPHALT BINDER FOR PLANT MIX,GRADE PG64-22
862	200	LF	STEEL BEAM GUARDRAIL
876	200	SY	GEOTEXTILE FOR DRAINAGE
SP	4	EA	GUARDRAIL ANCHOR UNITS,TYPE 350
1605	150	LF	TEMPORARY SILT FENCE
1610	10	TON	STONE FOR EROSION CONTROL,CLASS B
1610	10	TON	SEDIMENT CONTROL STONE
1615	0.5	ACRE	TEMPORARY MULCHING
1620	20	LB	SEED FOR TEMPORARY SEEDING
1620	0J	TON	FERTILIZER FOR TEMPORARY SEEDING
1630	30	CY	SILT EXCAVATION
1631	1400	SY	MATTING FOR EROSION CONTROL
SP	350	LF	WATTLE
SP	10	LB	POLYACRYLAMIDE (PAM)
1632	100	LF	1/4" HARDWARE CLOTH
1660	1	ACRE	SEEDING AND MULCHING
1661	50	LB	SEED FOR REPAIR SEEDING
1661	0.2	TON	FERTILIZER FOR REPAIR SEEDING
SP	20	SY	TURBIDITY CURTAIN
SP	3	EA	RESPONSE FOR EROSION CONTROL
402	1	LS	REMOVAL OF EXISTING STRUCTURE AT -L- STATION 12+9.50
SP	1	LS	1 @ 9'-3" X 22'-1" CORRUGATED ALUMINUM BOX CULVERT WITH HEADWALLS AT -L- STATION 12+9.50
SP	1	LS	RELOCATE EXISTING 6" WATER MAIN