



STATE OF NORTH CAROLINA
DEPARTMENT OF TRANSPORTATION

ROY COOPER
GOVERNOR

JAMES H. TROGDON, III
SECRETARY

June 5, 2017

CONTRACT: DB00357
WBS ELEMENT: 2017CPT.02.57.10741.7
COUNTY: Pitt
ROUTE: US 264A (Greenville Boulevard)
DESCRIPTION: Milling, Resurfacing, Pavement Markings, and Pavement Markers

ADDENDUM 2

TO: PROSPECTIVE BIDDERS

Please note the following revision to the proposal.

- Quantities have been removed for line items 18-21. Please note the following on page 50 of the Project Proposal:

Mainline pavement shall not be left milled, unmarked or uneven at the end of a paving season. If the Contractor begins any map and does not complete within the seasonal restrictions, including placement of final pavement markings or permanent markers, the Contractor shall be responsible for, at his expense, Paint in accordance with Article 1205-08 and Temporary Markers in accordance with Section 1251 of the 2012 Standard Specifications.

- Revised plans, which removes the paint quantities.
- A revised electronic file has been uploaded to bid express and the bid letting website named "DB00357.002".

Please note the following additional Addendum acknowledgement page for the above referenced project.

Please make sure to sign the addendum page in the proposal to acknowledge this addendum.

Sincerely,

DocuSigned by:



714C11DCCEBC4C6...

Mary Voelker Moore, P.E.
Division Contract Engineer

cc: Mr. Ed Eatmon, PE
Preston Hunter, PE
Mr. Jeremy Stroud, PE
Mr. Cadmus Capehart, PE
Mr. William Kincannon, PE
Ms. Claudia Wainwright

County : Pitt

Line #	Item Number	Sec #	Description	Quantity	Unit Cost	Amount
ROADWAY ITEMS						
0001	0000100000-N	800	MOBILIZATION	Lump Sum	L.S.	
0002	1297000000-E	607	MILLING ASPHALT PAVEMENT, **** DEPTH 2" MILLING	186,700 SY		
0003	1519000000-E	610	ASPHALT CONC SURFACE COURSE, TYPE S9.5B	23,000 TON		
0004	1575000000-E	620	ASPHALT BINDER FOR PLANT MIX	1,380 TON		
0005	2549000000-E	846	2'-6" CONCRETE CURB & GUTTER	320 LF		
0006	2612000000-E	848	6" CONCRETE DRIVEWAY	25 SY		
0007	2830000000-N	858	ADJUSTMENT OF MANHOLES	10 EA		
0008	2845000000-N	858	ADJUSTMENT OF METER BOXES OR VALVE BOXES	10 EA		
0009	4413000000-E	SP	WORK ZONE ADVANCE/GENERAL WARNING SIGNING	750 SF		
0010	4457000000-N	SP	TEMPORARY TRAFFIC CONTROL	Lump Sum	L.S.	
0011	4510000000-N	SP	LAW ENFORCEMENT	200 HR		
0012	4690000000-E	1205	THERMOPLASTIC PAVEMENT MARKING LINES (6", 120 MILS)	83,965 LF		
0013	4697000000-E	1205	THERMOPLASTIC PAVEMENT MARKING LINES (8", 120 MILS)	2,500 LF		
0014	4705000000-E	1205	THERMOPLASTIC PAVEMENT MARKING LINES (16", 120 MILS)	500 LF		
0015	4710000000-E	1205	THERMOPLASTIC PAVEMENT MARKING LINES (24", 120 MILS)	2,850 LF		
0016	4721000000-E	1205	THERMOPLASTIC PAVEMENT MARKING CHARACTER (120 MILS)	52 EA		
0017	4725000000-E	1205	THERMOPLASTIC PAVEMENT MARKING SYMBOL (90 MILS)	445 EA		

County : Pitt

Line #	Item Number	Sec #	Description	Quantity	Unit Cost	Amount
0022	4905000000-N	1253	SNOWPLOWABLE PAVEMENT MARKERS	1,590		
				EA		

1057/Jun02/Q304299.0/D61760100000/E18

Total Amount Of Bid For Entire Project :



PITT COUNTY

DB00357

WBS# 2017CPT.02.57.10741.7

PROJECT REFERENCE NO.	SHEET NO.
DB00357	1

LOCATION:

MAP 1 - US 264 ALT (GREENVILLE BLVD) FROM NC-11 (MEMORIAL DRIVE) TO NC-33 (10TH STREET)

TYPE OF WORK: MILLING, RESURFACING, PAVEMENT MARKINGS & PAVEMENT MARKERS



NCDOT
DIVISION 2

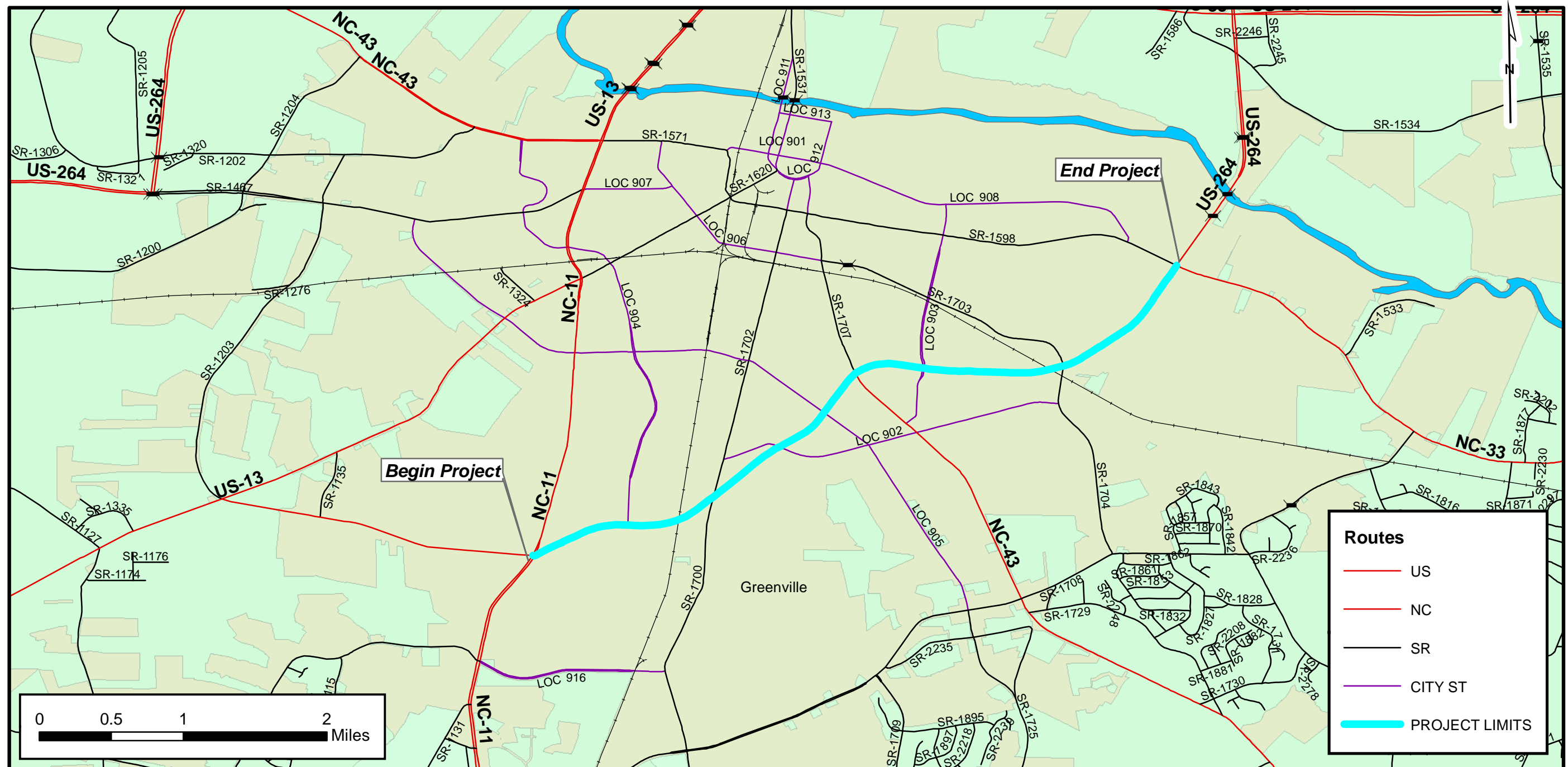

PAVEMENT SCHEDULE	
C1	PROP. APPROX. 2" ASPHALT CONCRETE SURFACE COURSE, TYPE S 9.5B, AT AN AVERAGE RATE OF 224.0 LBS. PER SQ. YD.
V1	2" DEPTH MILLING
DRAWINGS NOT TO SCALE	

NOTE: PAVEMENT EDGE SLOPES ARE 1:1 UNLESS SHOWN OTHERWISE.

TYPICAL SECTION NO. 1

MAP 1 - US 264 ALT (GREENVILLE BLVD) FROM NC-11 (MEMORIAL DRIVE)
TO 600 FT NORTH OF NC 33 (10TH ST)

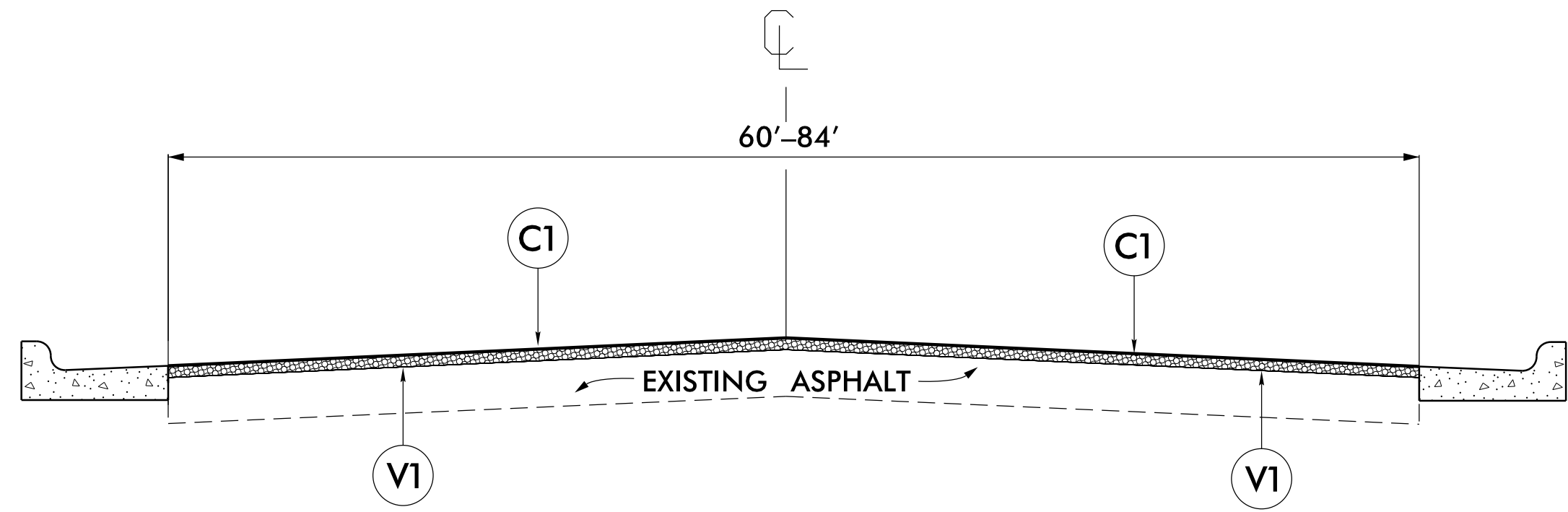

- NOTE:**
1. MILL FULL WIDTH OF EXISTING ASPHALT PAVEMENT, AS DIRECTED BY THE ENGINEER.
 2. PLACE ASPHALT SURFACE COURSE AT FULL WIDTH OF EXISTING ASPHALT PAVEMENT, AS DIRECTED BY THE ENGINEER.

MILLING TYPICALS

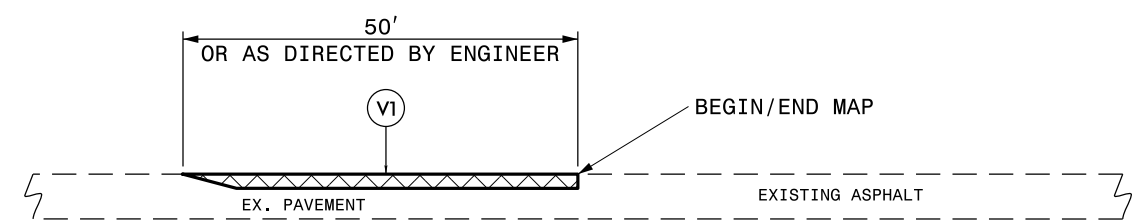

DETAIL 1
BEGIN/END MAP TIE-IN

NOTE:
1. MILLING SHALL BE PERFORMED AT MAIN LINE TIE-INS AND Y-LINE TIE-INS AS DIRECTED BY THE ENGINEER, IN ACCORDANCE WITH THIS DETAIL.

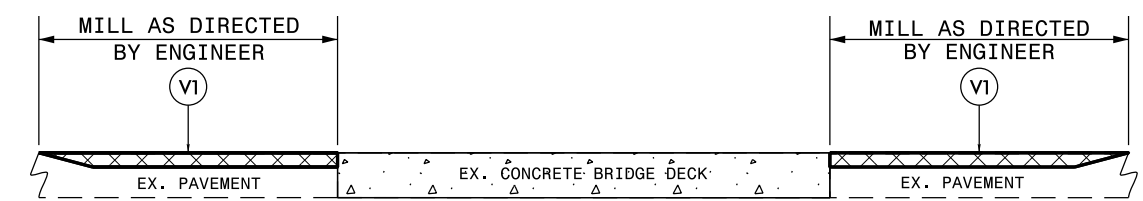

DETAIL 2
BRIDGE MILLING

NOTE:
1. MILLING SHALL BE PERFORMED AT THE BRIDGE APPROACHES AS DIRECTED BY THE ENGINEER, IN ACCORDANCE WITH THIS DETAIL.

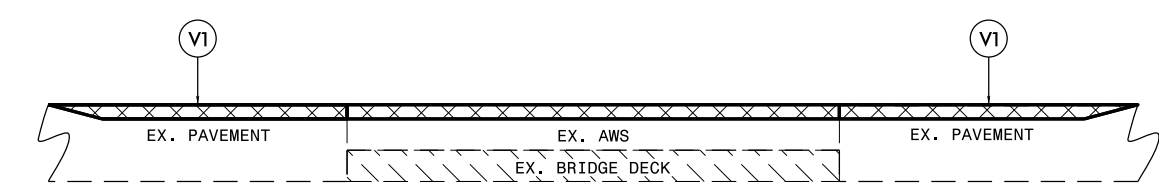

DETAIL 3
BRIDGE MILLING

NOTE:
1. INCLUDES MILLING FOR THE ENTIRE WIDTH OF THE BRIDGE WEARING SURFACE, AS DIRECTED BY THE ENGINEER.

<u>Side Street Name</u>	<u>Left (FT)</u>	<u>Right (FT)</u>
Belvedere Drive		38
Bismark Street	39	
Crestline Blvd		34
St Andrews Drive	40	
Brimley Drive	45	
Hooker Road	City of Greenville	
Convention Center Entrance		25
Landmark Street		41
Evans Street	40	40
Granville Drive		25
Red Banks	90	120
Highland Avenue	35	
Arlington Boulevard	65	96
Charles Boulevard	85	115
Sheraton Drive		47
Rosewood Drive	47	
Forest Hill Drive	48	50
Elm Street	84	84
Sherwood Drive		27
Fairview Way	28	39
Brownlea Drive	56	
Dellwood Drive		25
14th Street	66	128
Adams Blvd	46	27
Emerson Drive		53
Golden Road	12	
Alexander Circle	48	
10th Street	83	120

NOTE:
1. APPROXIMATE LENGTHS (FT) FROM THE MAINLINE FOR Y-LINE MILLING AND PAVING. TO BE FIELD VERIFIED BY THE ENGINEER.

PROJECT NO.	SHEET NO.
DB00357	4 - REVISION (2)

SUMMARY OF QUANTITIES

PROJECT NO	COUNTY	MAP NO	ROUTE	DESCRIPTION	TYP NO	LANES	LANE TYPE	FINAL SURFACE TESTING REQUIRED	WARM MIX ASPHALT REQUIRED	LENGTH MI	WIDTH FT	2" MILLING SY	SURFACE COURSE, S9.5B TONS	ASPHALT BINDER FOR PLANT MIX TONS	2'-6" CURB & GUTTER LF	6" DRIVEWAYS SY	ADJ. OF MANHOLES EA	ADJ. OF METER OR VALVE BOX EA
2017CPT.02.57.10741.7	Pitt	1	US 264 ALT (GREENVILLE BLVD)	NC-11 (MEMORIAL DRIVE) TO NC-33 (10TH STREET)	1	4	M2	NO	NO	4.597	64	186,700	23,000	1,380	320	25	10	10
TOTAL FOR MAP NO. 1										4.597		186,700	23,000	1,380	320	25	10	10
TOTAL FOR PROJ NO. 2017CPT.02.57.10741.7										4.597		186,700	23,000	1,380	320	25	10	10
GRAND TOTAL										4.597		186,700	23,000	1,380	320	25	10	10

Curb and Gutter		
STATION	LEFT (FT)	RIGHT (FT)
43+16		20
143+63	30	
152+27	100	
158+03		36
161+72	30	
163+32	20	
166+40	20	
174+41	34	
209+37	30	

Driveway		
STATION	LEFT (FT)	RIGHT (FT)
174+18	20	

THERMOPLASTIC AND PAINT QUANTITIES

PROJECT NO	COUNTY	MAP NO	ROUTE	DESCRIPTION	TYP NO	LANES	LANE TYPE	LENGTH	WIDTH	4413000000-E	4457000000-N	4510000000-N	4690000000-E		4697000000-E	4705000000-E	4710000000-E
										WORK ZONE ADVANCE/GENERAL WARNING SIGNING SF	TEMPORARY TRAFFIC CONTROL LS	LAW ENFORCEMENT HR	6" X 120 M YELLOW THERMO LF	6" X 120 M WHITE THERMO LF	8" X 120 M WHITE THERMO LF	16" X 120 M WHITE THERMO LF	24" X 120 M WHITE THERMO LF
2017CPT.02.57.10741.7	Pitt	1	US 264 ALT (GREENVILLE BLVD)	NC-11 (MEMORIAL DRIVE) TO NC-33 (10TH STREET)	1	4	M2	4.597	64	750	1.000	200	67,172	16,793	2,500	500	2,850
TOTAL FOR MAP NO. 1								4.597		750	1	200	67,172	16,793	2,500	500	2,850
TOTAL FOR PROJ NO. 2017CPT.02.57.10741.7								4.597		750	1	200	67,172	16,793	2,500	500	2,850
GRAND TOTAL													83,965				

PROJECT NO	COUNTY	MAP NO	ROUTE	DESCRIPTION	TYP NO	LANES	LANE TYPE	LENGTH	WIDTH	4721000000-E			4725000000-E					4905000000-N
										THERMO RXR 120 M EA	THERMO MSG ONLY 120 M EA	THERMO MSG SCHOOL 120 M EA	THERMO LT ARROW 90 M EA	THERMO STR ARROW 90 M EA	THERMO RT ARROW 90 M EA	THERMO STR & RT ARROW 90 M EA	THERMO STR & LT ARROW 90 M EA	SNOW PLOWABLE MARKERS EA
2017CPT.02.57.10741.7	Pitt	1	US 264 ALT (GREENVILLE BLVD)	NC-11 (MEMORIAL DRIVE) TO NC-33 (10TH STREET)	1	4	M2	4.597	64	20	20	12	275	90	30	45	5	1,590
TOTAL FOR MAP NO. 1								4.597		20	20	12	275	90	30	45	5	1,590
TOTAL FOR PROJ NO. 2017CPT.02.57.10741.7								4.597		20	20	12	275	90	30	45	5	1,590
GRAND TOTAL													52			445		

URBAN / SUBURBAN WORKZONES

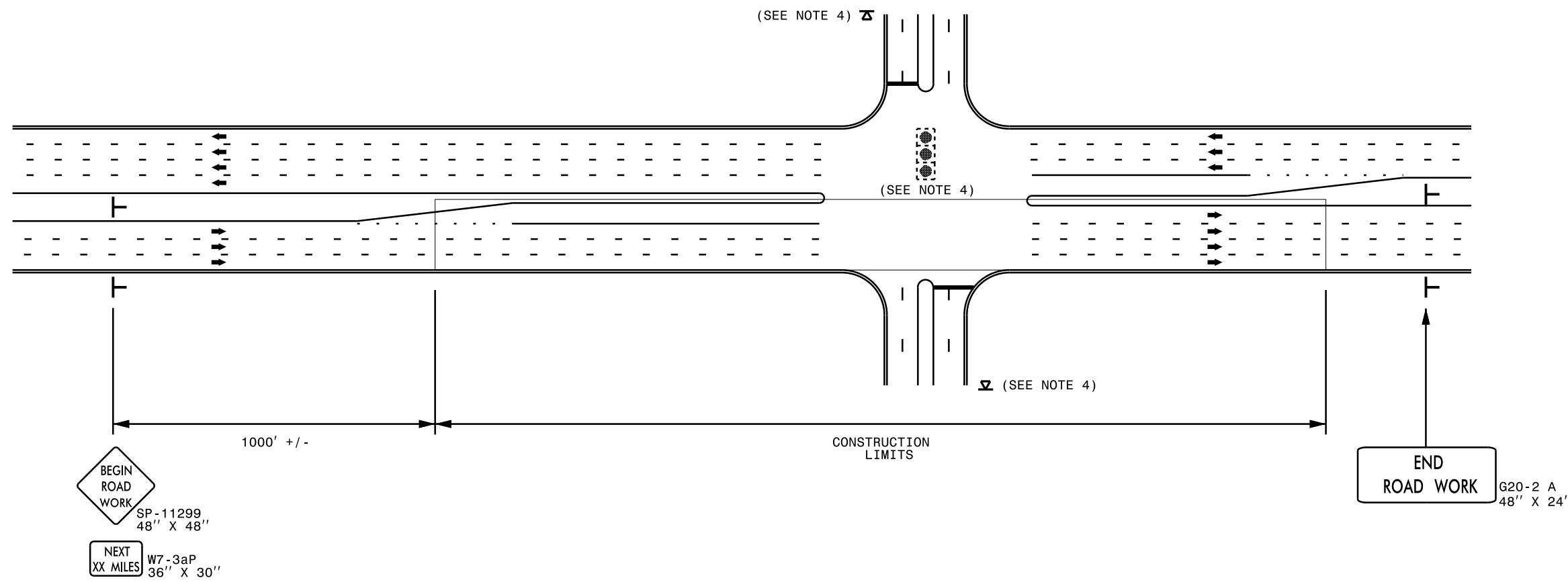

NOTES:

- 1) 48" x 48" SIZED SIGNS (SP- 11299) MAY BE REDUCED TO 36" X 36" ON ROADWAYS WITH SPEED LIMITS OF 40 MPH OR LESS.
- 2) MOUNT SIGNS THAT ARE LARGER THAN 10 SQUARE FEET IN AREA ON TWO OR MORE WOOD OR U-CHANNEL SUPPORTS. PERFORATED SQUARE TUBING SUPPORT SYSTEMS MAY SUPPORT LARGER AREAS ON A SINGLE SUPPORT. FOLLOW MANUFACTURER'S RECOMMENDATIONS. THESE SYSTEMS SHALL BE NCHRP 350 COMPLIANT AND NCDOT APPROVED.
- 3) ADVANCE WARNING SIGNS NOT REQUIRED ON NON-SIGNALIZED SIDE STREETS.
- 4) MAY USE LAW ENFORCEMENT TO CONTROL TRAFFIC AT SIGNALIZED INTERSECTIONS AS DIRECTED BY THE ENGINEER. PROVIDE PORTABLE "ROAD WORK AHEAD" (W20-1) SIGNS 500' IN ADVANCE ALONG BOTH APPROACHES FROM THE SIDE STREETS WHEN PAVING PROCEEDS THROUGH THE INTERSECTION.
- 5) LATERAL CLEARANCE AT ALL SIGN LOCATIONS SHALL BE 2' AS MEASURED FROM THE EDGE OF PAVEMENT OR THE FACE OF THE CURB. WHEN UNABLE TO OBTAIN THE LATERAL CLEARANCE WITHIN THE MEDIAN AREA USE SHOULDER MOUNTS ONLY.
- 6) SIGN MOUNT LOCATIONS SHALL NOT BLOCK SIDEWALKS OR DRIVEWAYS.
- 7) IF STATIONARY GENERAL WARNING SIGNS ARE USED, THEY WILL BE PAID FOR PER SECTION 104 OF THE NCDOT STANDARD SPECIFICATIONS AS EXTRA WORK.
- 8) IF MILLED AREAS ARE NOT PAVED BACK BY THE END OF THE WORK DAY, PORTABLE SIGNS SHALL BE USED TO WARN DRIVERS OF THE PRESENT CONDITIONS. THESE ARE TO INCLUDE, BUT NOT LIMITED TO "ROUGH ROAD" W8-8, "UNEVEN LANES" W8-11, "GROOVED PAVEMENT" W8-15 w/MOTORCYCLE PLAQUE MOUNTED BELOW. THESE ARE TO BE DOUBLE INDICATED ON MULTI-LANE ROADWAYS WITH SPEED LIMITS 45 MPH AND GREATER WHERE LATERAL CLEARANCE CAN BE OBTAINED WITHIN THE MEDIAN AREAS. THESE PORTABLE SIGNS ARE INCIDENTAL TO THE OTHER ITEMS OF WORK INCLUDED IN THE TEMPORARY TRAFFIC CONTROL (LUMP SUM) PAY ITEM.

LEGEND	
└	STATIONARY SIGN
➔	DIRECTION OF TRAFFIC FLOW



**RESURFACING ADVANCE
WARNING SIGNS FOR
URBAN / SUBURBAN
FACILITIES**