

WETLAND & STREAM IMPACTS

HNTB HNTB NORTH CAROLINA, P.C.
343 E. Six Forks Road, Suite 200
Raleigh, North Carolina 27609
NC License No: C-1554

| | |
|---|-----------------------|
| PROJECT REFERENCE NO. 17BP.2.R.34 | SHEET NO. 4 |
| RW SHEET NO. | |
| ROADWAY DESIGN ENGINEER | HYDRAULICS ENGINEER |
| INCOMPLETE PLANS DO NOT USE FOR R/W ACQUISITION | |
| PRELIMINARY PLANS DO NOT USE FOR CONSTRUCTION | |

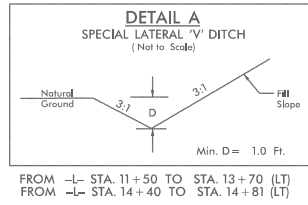

W2
PERMANENT WETLAND IMPACTS = 0 Ac/0 SF
TEMPORARY WETLAND IMPACTS = 0 Ac/0 SF
PERMANENT STREAM IMPACTS = 0 LF
TEMPORARY STREAM IMPACTS = 0 LF

W1
PERMANENT WETLAND IMPACTS = 0 Ac/0 SF
TEMPORARY WETLAND IMPACTS = 0 Ac/0 SF
PERMANENT STREAM IMPACTS = 34 LF
TEMPORARY STREAM IMPACTS = 0 LF

W3
PERMANENT WETLAND IMPACTS = 0 Ac/0 SF
TEMPORARY WETLAND IMPACTS = 0 Ac/0 SF
PERMANENT STREAM IMPACTS = 0 LF
TEMPORARY STREAM IMPACTS = 0 LF

W4
PERMANENT WETLAND IMPACTS = 0 Ac/0 SF
TEMPORARY WETLAND IMPACTS = 0 Ac/0 SF
PERMANENT STREAM IMPACTS = 30 LF
TEMPORARY STREAM IMPACTS = 0 LF

LEGEND
 DENOTES IMPACTS IN SURFACE WATER
 DENOTES TEMPORARY IMPACTS IN SURFACE WATER

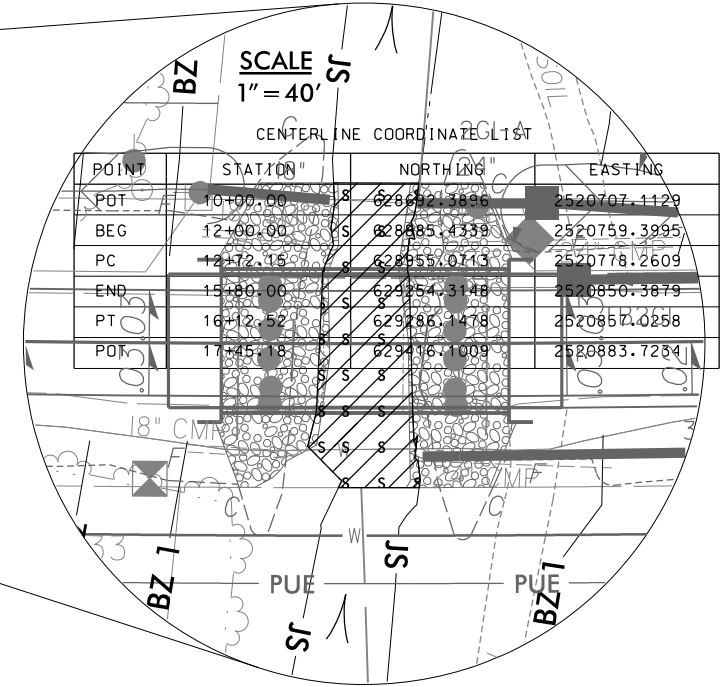

PROFILE

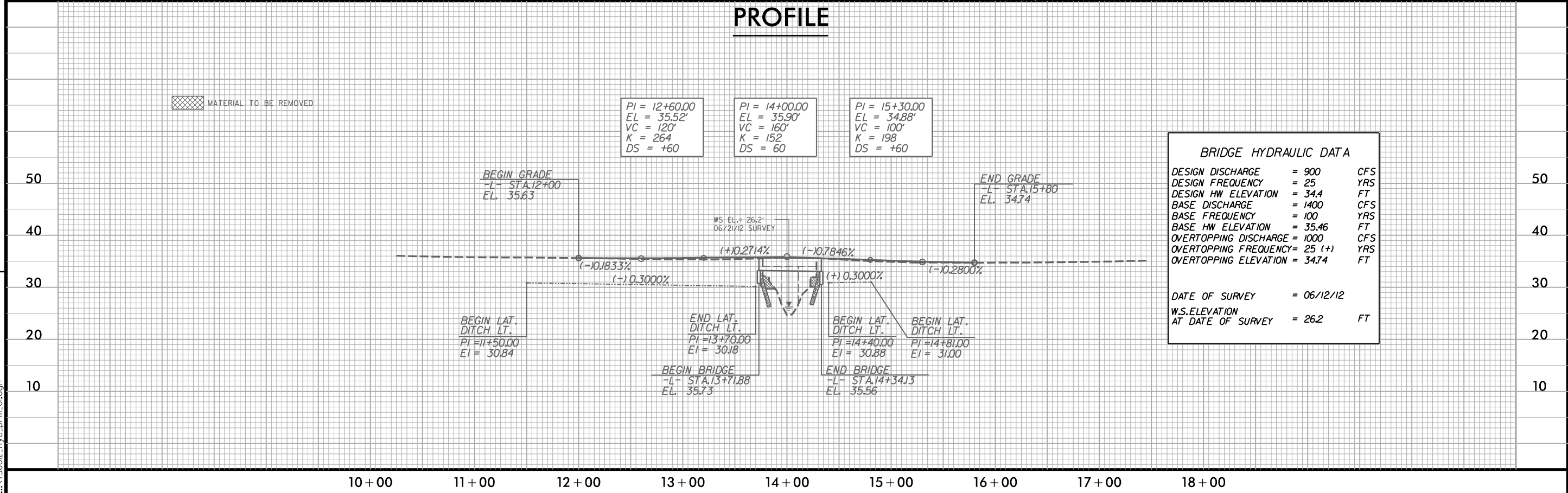

REVISIONS

7/30/2013 3:46:57 PM
...\\130012.hyd.prm_01.dgn

WETLAND & STREAM IMPACTS

HNTB HNTB NORTH CAROLINA, P.C.
343 E. Six Forks Road, Suite 200
Raleigh, North Carolina 27609
NC License No: C-1554

| | |
|--|---------------------|
| PROJECT REFERENCE NO. 17BP.2.R.34 | SHEET NO. 4 |
| RW SHEET NO. | |
| ROADWAY DESIGN ENGINEER | HYDRAULICS ENGINEER |
| INCOMPLETE PLANS DO NOT USE FOR R/W ACQUISITION PRELIMINARY PLANS DO NOT USE FOR CONSTRUCTION | |

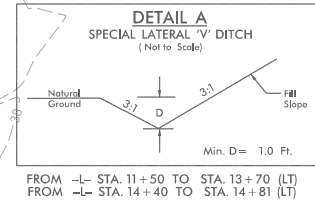

W2
 PERMANENT WETLAND IMPACTS = 0 Ac/0 SF
 TEMPORARY WETLAND IMPACTS = 0 Ac/0 SF
 PERMANENT STREAM IMPACTS = 0 LF
 TEMPORARY STREAM IMPACTS = 0 LF

W1
 PERMANENT WETLAND IMPACTS = 0 Ac/0 SF
 TEMPORARY WETLAND IMPACTS = 0 Ac/0 SF
 PERMANENT STREAM IMPACTS = 34 LF
 TEMPORARY STREAM IMPACTS = 0 LF

W3
 PERMANENT WETLAND IMPACTS = 0 Ac/0 SF
 TEMPORARY WETLAND IMPACTS = 0 Ac/0 SF
 PERMANENT STREAM IMPACTS = 0 LF
 TEMPORARY STREAM IMPACTS = 0 LF

W4
 PERMANENT WETLAND IMPACTS = 0 Ac/0 SF
 TEMPORARY WETLAND IMPACTS = 0 Ac/0 SF
 PERMANENT STREAM IMPACTS = 30 LF
 TEMPORARY STREAM IMPACTS = 0 LF

LEGEND
 DENOTES IMPACTS IN SURFACE WATER
 DENOTES TEMPORARY IMPACTS IN SURFACE WATER

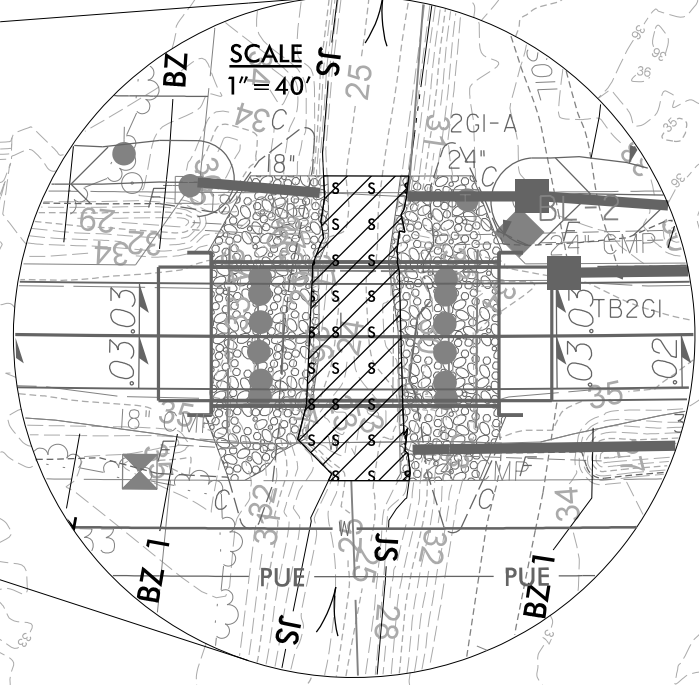

PROFILE

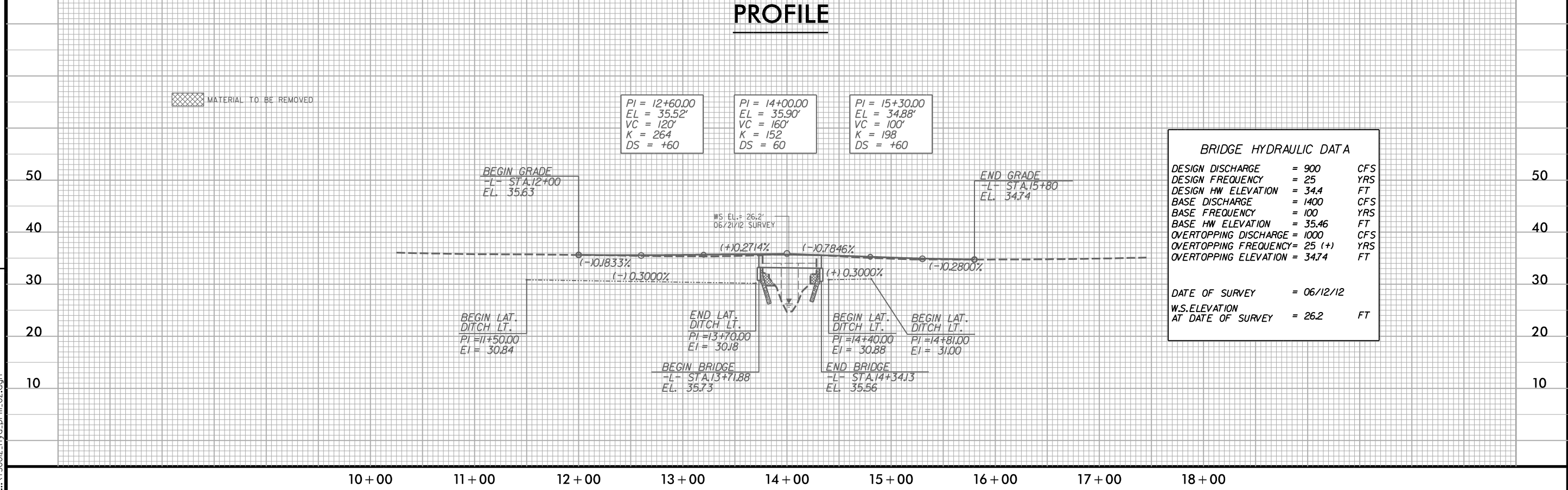

REVISIONS

7/30/2013 3:47:48 PM ...\\130002.hyd.prm_02.dgn

BUFFER IMPACTS

HNTB HNTB NORTH CAROLINA, P.C.
343 E. Six Forks Road, Suite 200
Raleigh, North Carolina 27609
NC License No: C-1554

| | |
|--|---------------------|
| PROJECT REFERENCE NO. | SHEET NO. |
| 17BP.2.R.34 | 4 |
| RW SHEET NO. | |
| ROADWAY DESIGN ENGINEER | HYDRAULICS ENGINEER |
| INCOMPLETE PLANS DO NOT USE FOR R/W ACQUISITION PRELIMINARY PLANS DO NOT USE FOR CONSTRUCTION | |

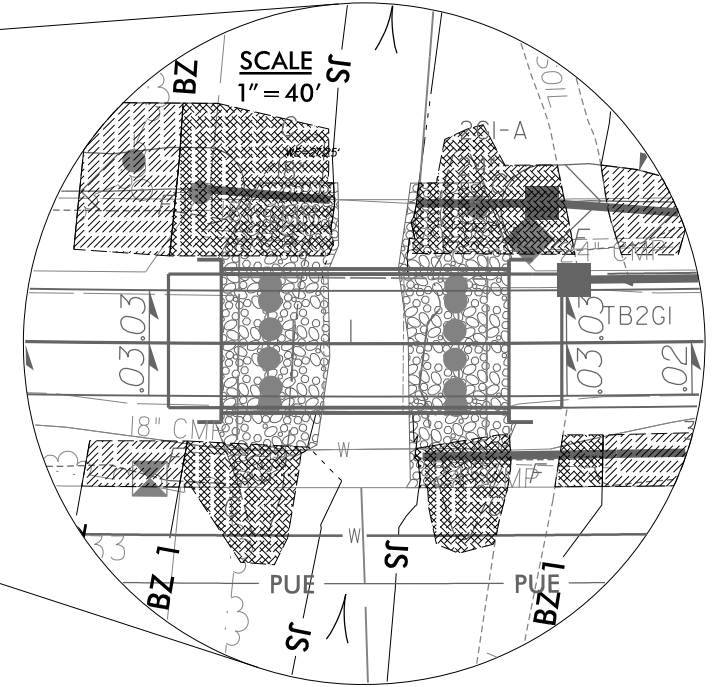
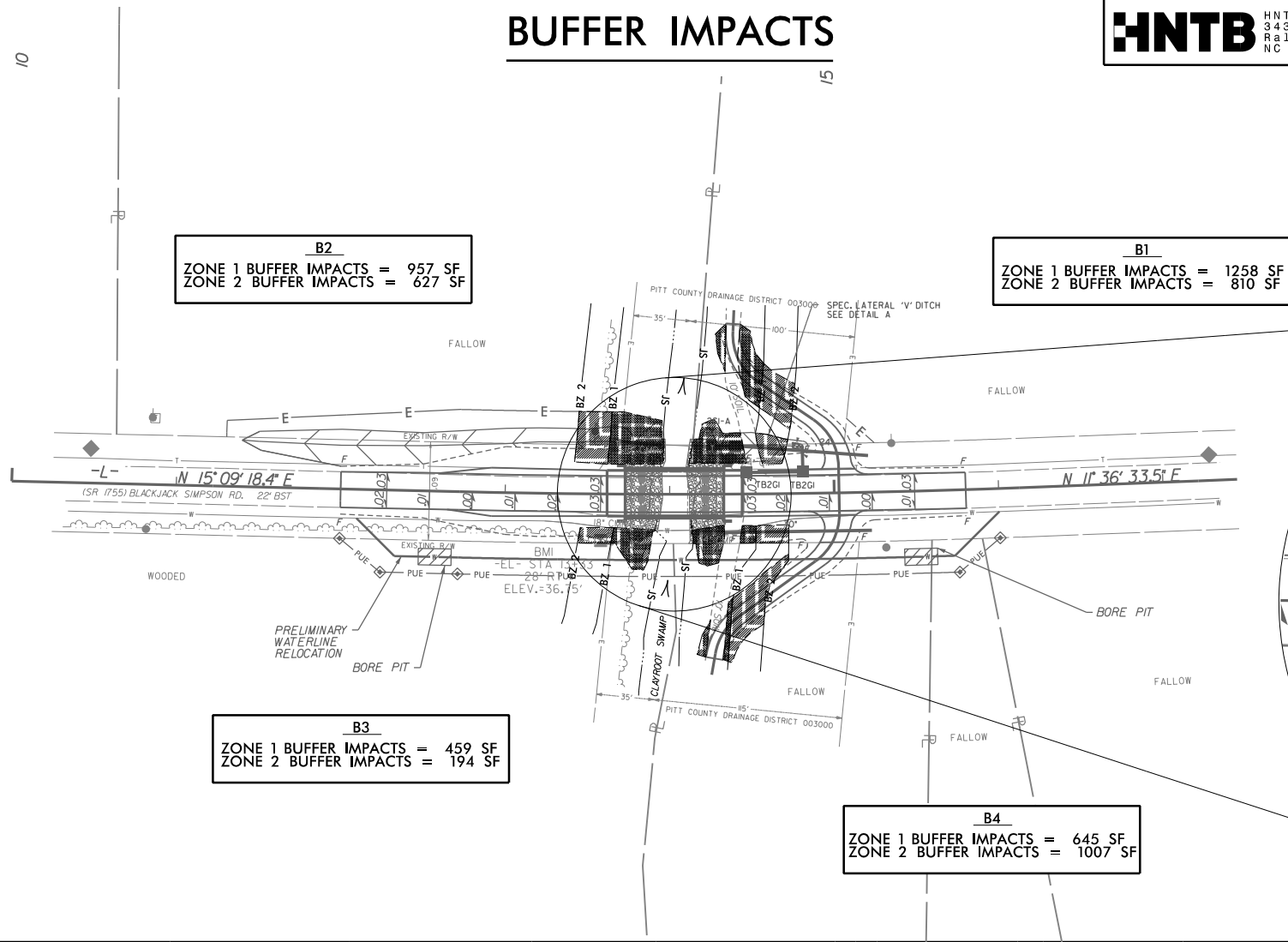
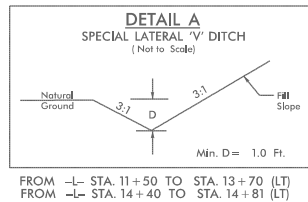

B2
ZONE 1 BUFFER IMPACTS = 957 SF
ZONE 2 BUFFER IMPACTS = 627 SF

B1
ZONE 1 BUFFER IMPACTS = 1258 SF
ZONE 2 BUFFER IMPACTS = 810 SF

B3
ZONE 1 BUFFER IMPACTS = 459 SF
ZONE 2 BUFFER IMPACTS = 194 SF

B4
ZONE 1 BUFFER IMPACTS = 645 SF
ZONE 2 BUFFER IMPACTS = 1007 SF

LEGEND
 ALLOWABLE IMPACTS ZONE 1
 ALLOWABLE IMPACTS ZONE 2

PROFILE

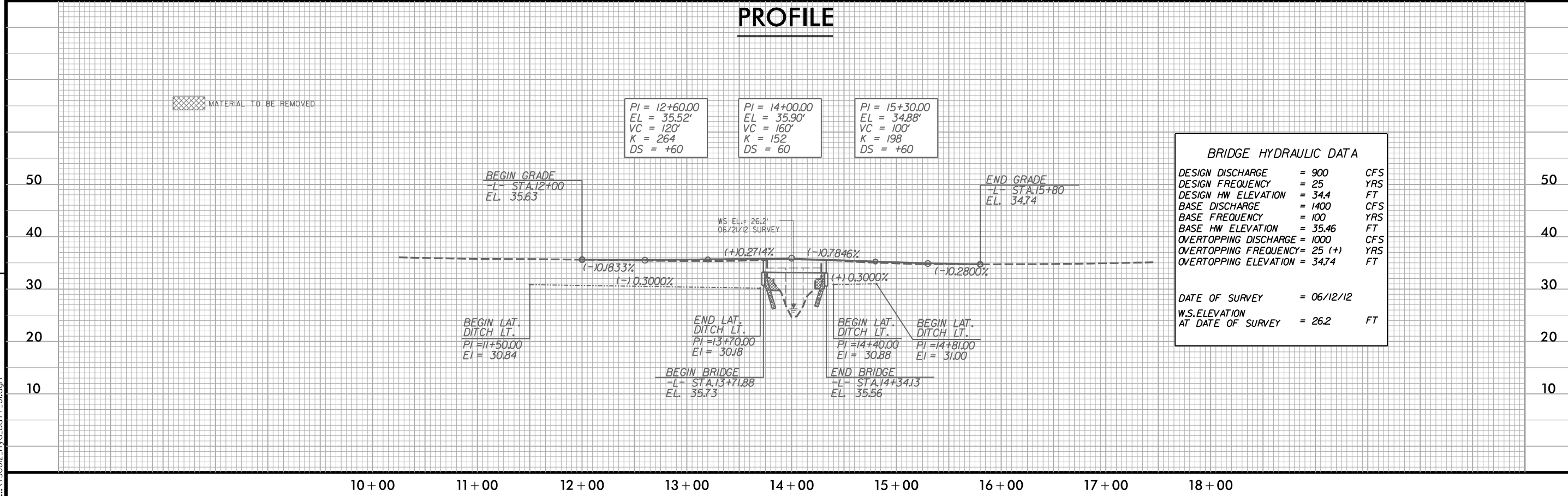

REVISIONS

7/30/2013 3:46:21 PM ...\\130002.hyd.buf.01.dgn

BUFFER IMPACTS

HNTB HNTB NORTH CAROLINA, P.C.
343 E. Six Forks Road, Suite 200
Raleigh, North Carolina 27609
NC License No: C-1554

| | |
|--|-----------------------|
| PROJECT REFERENCE NO. 17BP.2.R.34 | SHEET NO. 4 |
| RW SHEET NO. | |
| ROADWAY DESIGN ENGINEER | HYDRAULICS ENGINEER |
| INCOMPLETE PLANS DO NOT USE FOR R/W ACQUISITION PRELIMINARY PLANS DO NOT USE FOR CONSTRUCTION | |

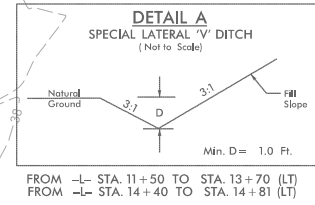

B2
ZONE 1 BUFFER IMPACTS = 957 SF
ZONE 2 BUFFER IMPACTS = 627 SF

B1
ZONE 1 BUFFER IMPACTS = 1258 SF
ZONE 2 BUFFER IMPACTS = 810 SF

B3
ZONE 1 BUFFER IMPACTS = 459 SF
ZONE 2 BUFFER IMPACTS = 194 SF

B4
ZONE 1 BUFFER IMPACTS = 645 SF
ZONE 2 BUFFER IMPACTS = 1007 SF

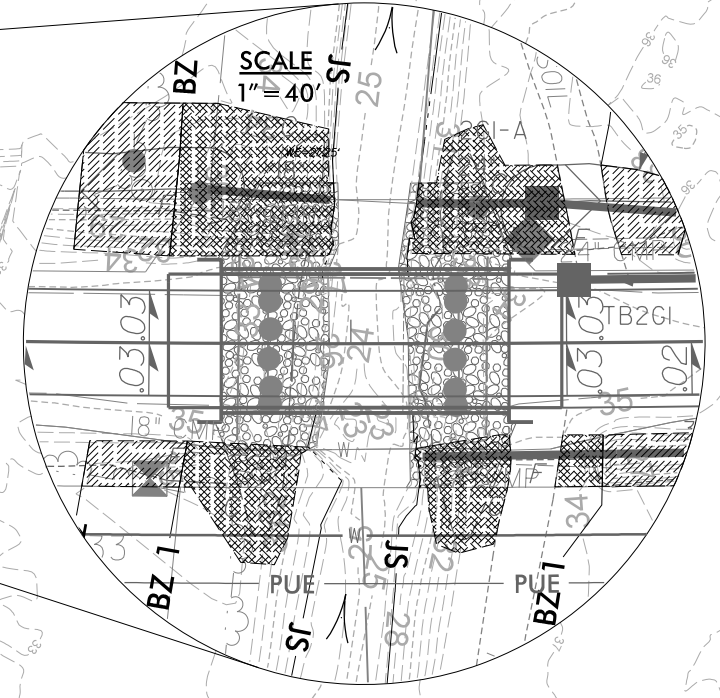
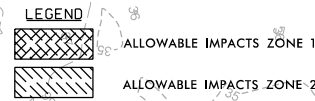

PROFILE

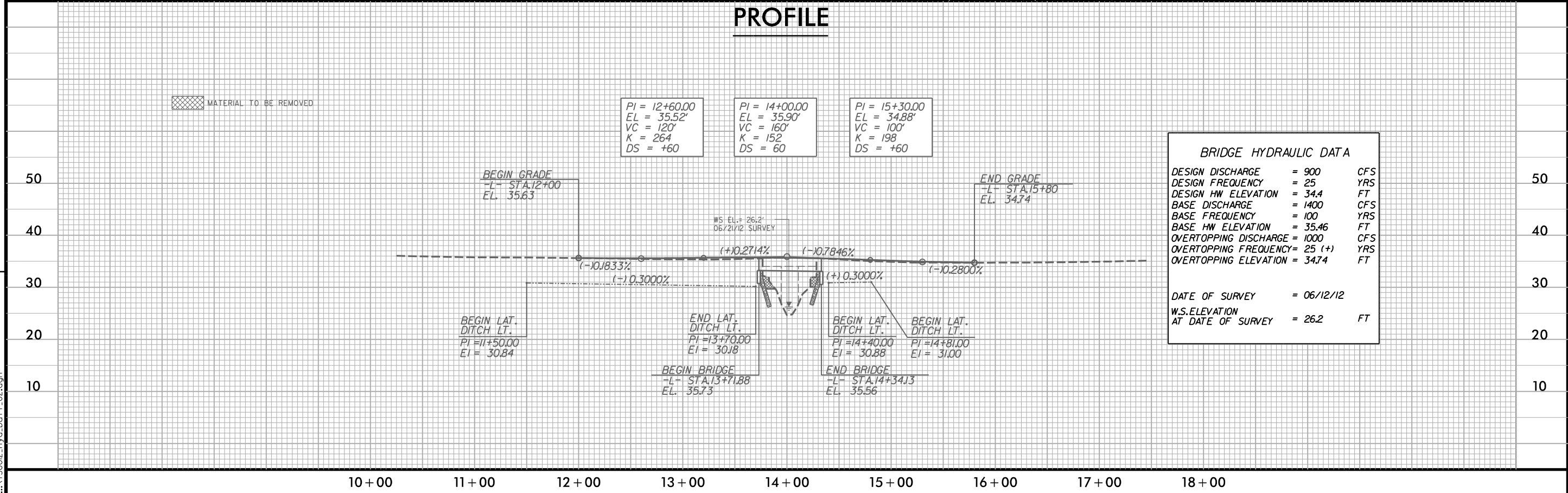

REVISIONS

7/30/2013 3:49:13 PM
...\\130002.hyd.buff.02.dgn