

GREENE 22 NW 3 APPLICATION
 NC 58, OVER RAINBOW CREEK
 42' LONG BY 28.1' WIDE REINFORCED CONCRETE BRIDGE ON CONCRETE ABUTMENTS
 TO BE REPLACED WITH A 120' LONG X 36' WIDE CORED SLAB BRIDGE
 HOOKERTON USGS QUAD MAP
 SHEET NUMBER 6 OF THE SOIL SURVEY OF GREENE COUNTY
 CONTENT NEA 03020203 NEUSE RIVER BASIN
 NEUSE RIPARIAN BUFFER RULES APPLY
 NO MORATORIUM AS PER TRAVIS WILSON, NCWRC
 WBS ELEMENT NUMBER 45348JJ5
 SCALE: 1"=20'

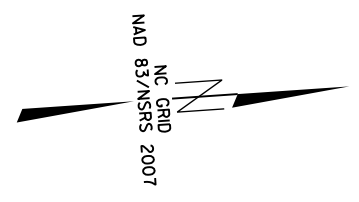

B1
 BUFFER ZONE 1
 IMPACTS = 35 Sq.Ft.
 BUFFER ZONE 2
 IMPACTS = 180 Sq.Ft.

Rolland G. Murray
 DB 540 PG 23

B2
 BUFFER ZONE 1
 IMPACTS = 150 Sq.Ft.
 BUFFER ZONE 2
 IMPACTS = 90 q.Ft.

Rainbow United
 Methodist Church
 DB 608 PG 708

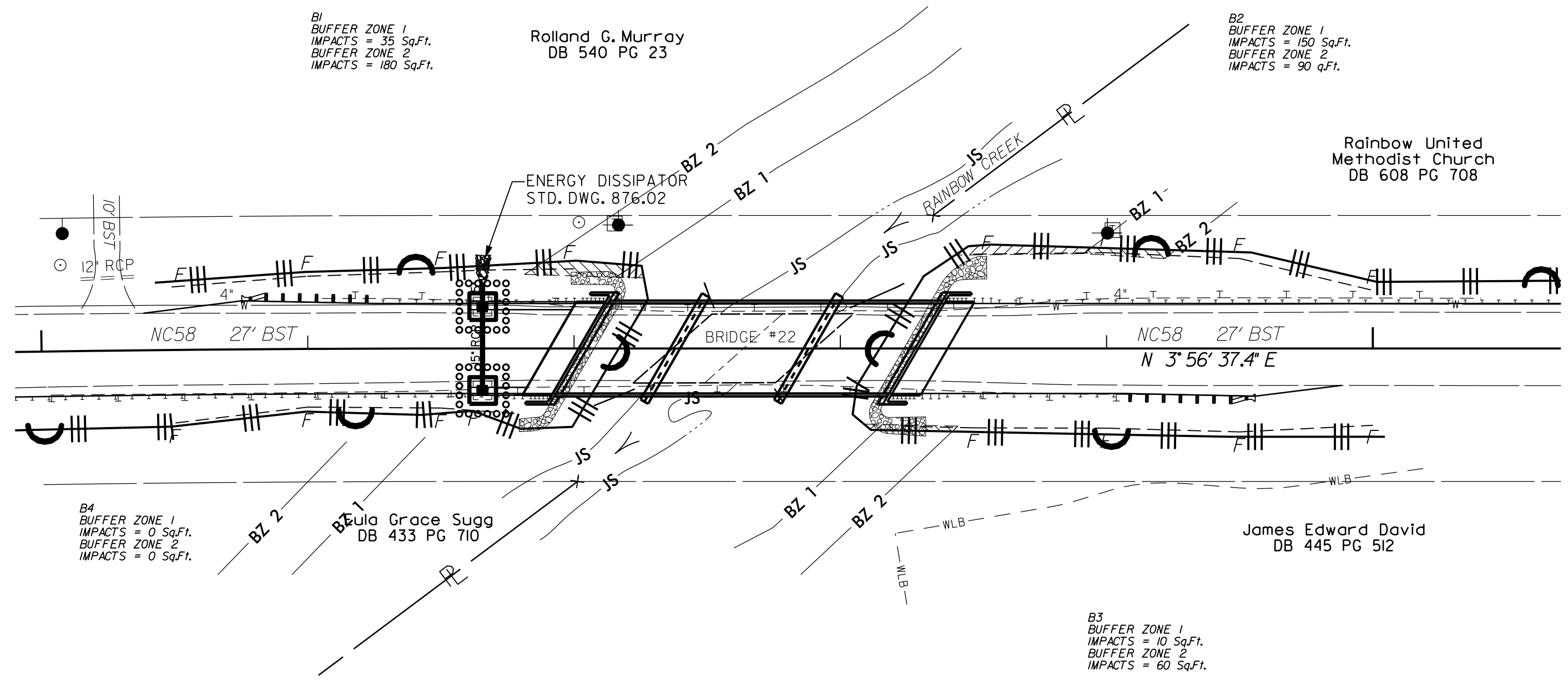

B4
 BUFFER ZONE 1
 IMPACTS = 0 Sq.Ft.
 BUFFER ZONE 2
 IMPACTS = 0 Sq.Ft.

Eula Grace Sugg
 DB 433 PG 710

James Edward David
 DB 445 PG 512

B3
 BUFFER ZONE 1
 IMPACTS = 10 Sq.Ft.
 BUFFER ZONE 2
 IMPACTS = 60 Sq.Ft.

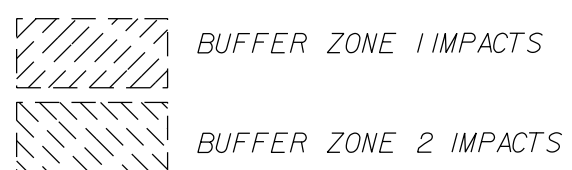

TOTAL BUFFER IMPACTS:
 ZONE 1 = 195 Sq.Ft. (0.0045 ACRES)
 ZONE 2 = 330 Sq.Ft. (0.0076 ACRES)
TOTAL STREAM IMPACTS: 0 LINEAR FEET
TOTAL WETLAND IMPACTS: 0 Sq.Ft.

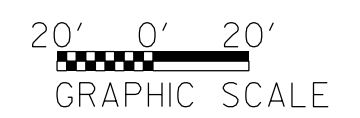

REVISIONS

8/17/99
 11-JUL-2013 15:27
 G:\PROJECTS\GREENE\03-51020-Greene 22\B051020.ddc2.psh-permit.dgn