

STATE	STATE PROJECT REFERENCE NO.	SHEET NO.	TOTAL SHEETS
N.C.	42596	1	23
STATE PROJ. NO.	F.A. PROJ. NO.	DESCRIPTION	
42596.1.1		PE	
42596.2.1		RW	
42596.3.1		CONST	

STATE OF NORTH CAROLINA  
DIVISION OF HIGHWAYS

**CARTERET COUNTY**

LOCATION: INTERSECTION OF US 70 AND MCCABE RD.

TYPE OF WORK: GRADING, PAVING AND DRAINAGE.

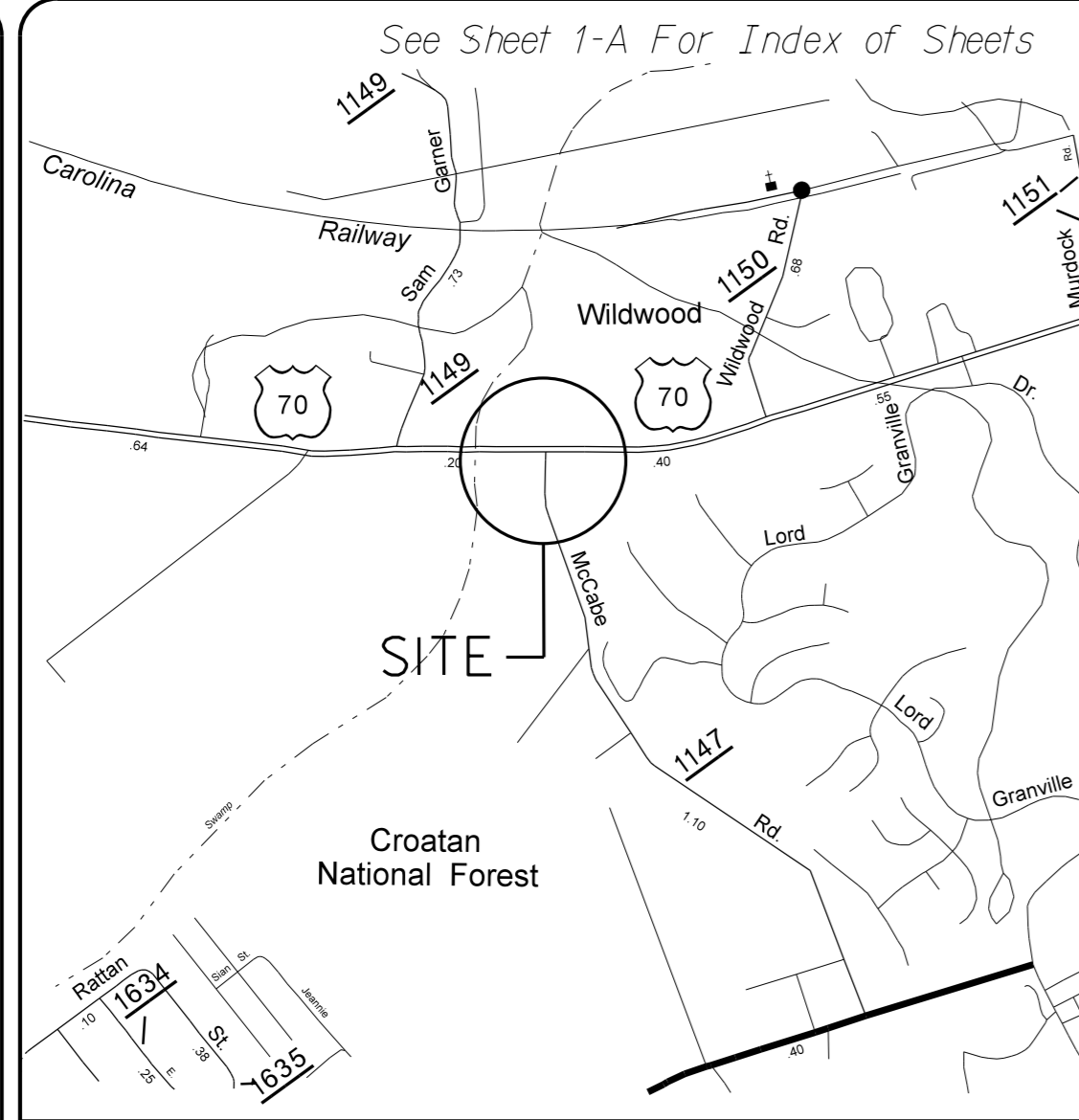

VICINITY MAP

SS-4902AC

TIP:

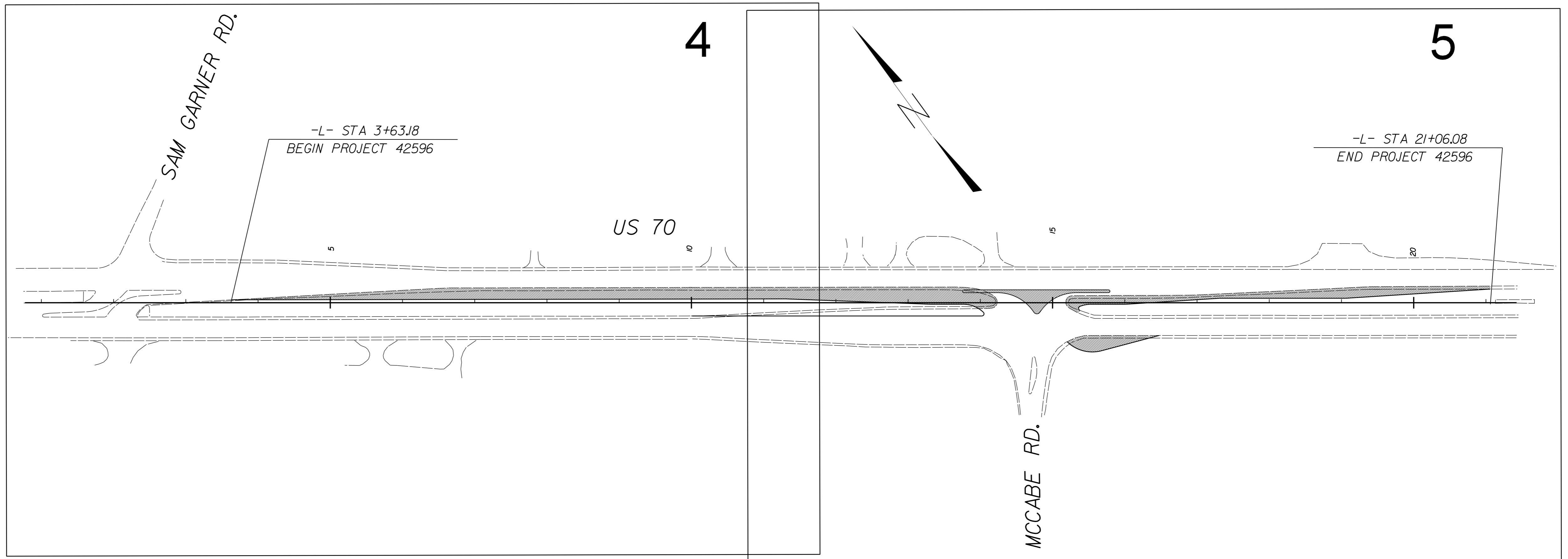

GRAPHIC SCALES

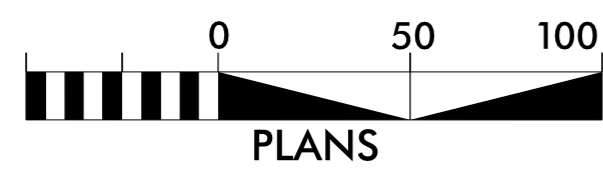

DESIGN DATA

PROJECT LENGTH

LENGTH ROADWAY PROJECT 42596 -L- = 0.33 MILES

Prepared in the Office of:  
**DIVISION OF HIGHWAYS**  
1704 N. GREENE ST., GREENVILLE NC, 27834

2012 STANDARD SPECIFICATIONS

RIGHT OF WAY DATE: DWAYNE H. ALLIGOOD, PE  
PROJECT ENGINEER

LETTING DATE: 09-26-2012  
LANG JONES  
PROJECT DESIGN ENGINEER

HYDRAULICS ENGINEER

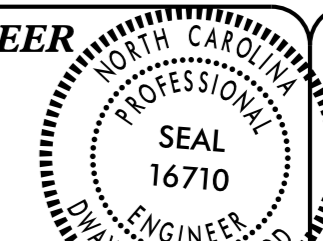

Dwayne H. Alligood P.E. 09/03/2012  
SIGNATURE:

ROADWAY DESIGN ENGINEER



Dwayne H. Alligood P.E. 09/03/2012  
SIGNATURE:

DIVISION OF HIGHWAYS  
STATE OF NORTH CAROLINA

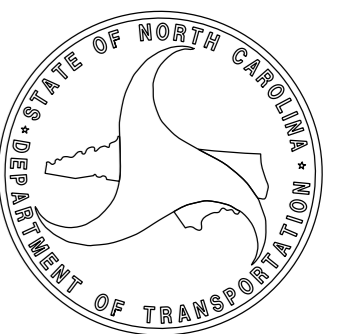

STATE HIGHWAY DESIGN ENGINEER P.E.



3/15/06

Note: Not to Scale

\*S.U.E. = Subsurface Utility Engineering

STATE OF NORTH CAROLINA  
DIVISION OF HIGHWAYS

# CONVENTIONAL PLAN SHEET SYMBOLS

**BOUNDARIES AND PROPERTY:**

State Line	-----
County Line	-----
Township Line	-----
City Line	-----
Reservation Line	-----
Property Line	-----
Existing Iron Pin	○ EIP
Property Corner	-----
Property Monument	□ ECM
Parcel/Sequence Number	(123)
Existing Fence Line	-x-x-x-
Proposed Woven Wire Fence	○
Proposed Chain Link Fence	□
Proposed Barbed Wire Fence	◇
Existing Wetland Boundary	-WLB-
Proposed Wetland Boundary	WLB
Existing Endangered Animal Boundary	EAB
Existing Endangered Plant Boundary	EPB

**BUILDINGS AND OTHER CULTURE:**

Gas Pump Vent or U/G Tank Cap	○
Sign	○ S
Well	○ W
Small Mine	✕
Foundation	□
Area Outline	□
Cemetery	□ †
Building	□
School	□
Church	□
Dam	□

**HYDROLOGY:**

Stream or Body of Water	-----
Hydro, Pool or Reservoir	□
Jurisdictional Stream	JS
Buffer Zone 1	BZ 1
Buffer Zone 2	BZ 2
Flow Arrow	←
Disappearing Stream	-----
Spring	○
Wetland	▽
Proposed Lateral, Tail, Head Ditch	-----
False Sump	▽

**RAILROADS:**

Standard Gauge	-----
RR Signal Milepost	○ MILEPOST 35
Switch	□ SWITCH
RR Abandoned	-----
RR Dismantled	-----

**RIGHT OF WAY:**

Baseline Control Point	◆
Existing Right of Way Marker	△
Existing Right of Way Line	-----
Proposed Right of Way Line	○ R W
Proposed Right of Way Line with Iron Pin and Cap Marker	○ R W ▲
Proposed Right of Way Line with Concrete or Granite Marker	○ R W ▲
Existing Control of Access	○ C A
Proposed Control of Access	○ C A
Existing Easement Line	E
Proposed Temporary Construction Easement	E
Proposed Temporary Drainage Easement	TDE
Proposed Permanent Drainage Easement	PDE
Proposed Permanent Utility Easement	PUE
Proposed Temporary Utility Easement	TUE
Proposed Permanent Easement with Iron Pin and Cap Marker	◆

**ROADS AND RELATED FEATURES:**

Existing Edge of Pavement	-----
Existing Curb	-----
Proposed Slope Stakes Cut	C
Proposed Slope Stakes Fill	F
Proposed Wheel Chair Ramp	WCR
Existing Metal Guardrail	T T T T
Proposed Guardrail	T T T T
Existing Cable Guiderail	□ □ □ □
Proposed Cable Guiderail	□ □ □ □
Equality Symbol	⊙
Pavement Removal	⊗

**VEGETATION:**

Single Tree	☼
Single Shrub	☼
Hedge	~~~~~
Woods Line	~~~~~
Orchard	☼ ☼ ☼ ☼
Vineyard	□ Vineyard

**EXISTING STRUCTURES:**

MAJOR:	
Bridge, Tunnel or Box Culvert	CONC
Bridge Wing Wall, Head Wall and End Wall	CONC WW
MINOR:	
Head and End Wall	CONC HW
Pipe Culvert	-----
Footbridge	-----
Drainage Box: Catch Basin, DI or JB	□ CB
Paved Ditch Gutter	-----
Storm Sewer Manhole	○ S
Storm Sewer	S

**UTILITIES:**

POWER:	
Existing Power Pole	●
Proposed Power Pole	○
Existing Joint Use Pole	●
Proposed Joint Use Pole	○
Power Manhole	⊕
Power Line Tower	⊗
Power Transformer	⊗
U/G Power Cable Hand Hole	□ PH
H-Frame Pole	●●
Recorded U/G Power Line	P
Designated U/G Power Line (S.U.E.*)	P

**TELEPHONE:**

Existing Telephone Pole	●
Proposed Telephone Pole	○
Telephone Manhole	⊕
Telephone Booth	□
Telephone Pedestal	⊕
Telephone Cell Tower	⊗
U/G Telephone Cable Hand Hole	□ PH
Recorded U/G Telephone Cable	T
Designated U/G Telephone Cable (S.U.E.*)	T
Recorded U/G Telephone Conduit	TC
Designated U/G Telephone Conduit (S.U.E.*)	TC
Recorded U/G Fiber Optics Cable	T FO
Designated U/G Fiber Optics Cable (S.U.E.*)	T FO

**WATER:**

Water Manhole	⊕
Water Meter	○
Water Valve	⊗
Water Hydrant	⊕
Recorded U/G Water Line	W
Designated U/G Water Line (S.U.E.*)	W
Above Ground Water Line	A/G Water

**TV:**

TV Satellite Dish	☼
TV Pedestal	□
TV Tower	⊗
U/G TV Cable Hand Hole	□ PH
Recorded U/G TV Cable	TV
Designated U/G TV Cable (S.U.E.*)	TV
Recorded U/G Fiber Optic Cable	TV FO
Designated U/G Fiber Optic Cable (S.U.E.*)	TV FO

**GAS:**

Gas Valve	◇
Gas Meter	⊕
Recorded U/G Gas Line	G
Designated U/G Gas Line (S.U.E.*)	G
Above Ground Gas Line	A/G Gas

**SANITARY SEWER:**

Sanitary Sewer Manhole	⊕
Sanitary Sewer Cleanout	⊕
U/G Sanitary Sewer Line	SS
Above Ground Sanitary Sewer	A/G Sanitary Sewer
Recorded SS Forced Main Line	FSS
Designated SS Forced Main Line (S.U.E.*)	FSS

**MISCELLANEOUS:**

Utility Pole	●
Utility Pole with Base	□
Utility Located Object	○
Utility Traffic Signal Box	□
Utility Unknown U/G Line	U/L
U/G Tank; Water, Gas, Oil	□
A/G Tank; Water, Gas, Oil	□
U/G Test Hole (S.U.E.*)	⊕
Abandoned According to Utility Records	AATUR
End of Information	E.O.I.

C1	PROP. APPROX. 1½" ASPHALT CONCRETE SURFACE COURSE, TYPE S9.5B, AT AN AVERAGE RATE OF 168 LBS. PER SQ.YD.
D1	PROP. APPROX. 3" ASPHALT CONCRETE BINDER COURSE. TYPE I19.0B, AT AN AVERAGE RATE OF 342 LBS. PER SQ. YD.
E1	PROP. APPROX. 4" ASPHALT CONCRETE BASE COURSE, TYPE B25.0B, AT AN AVERAGE RATE OF 456 LBS. PER SQ. YD.
T	EARTH MATERIAL.
U	EXISTING PAVEMENT.
V1	REMOVAL OF EXISTING ASPHALT PAVEMENT

NOTE: PAVEMENT EDGE SLOPES ARE 1:1 UNLESS SHOWN OTHERWISE.

US 70  
WBL

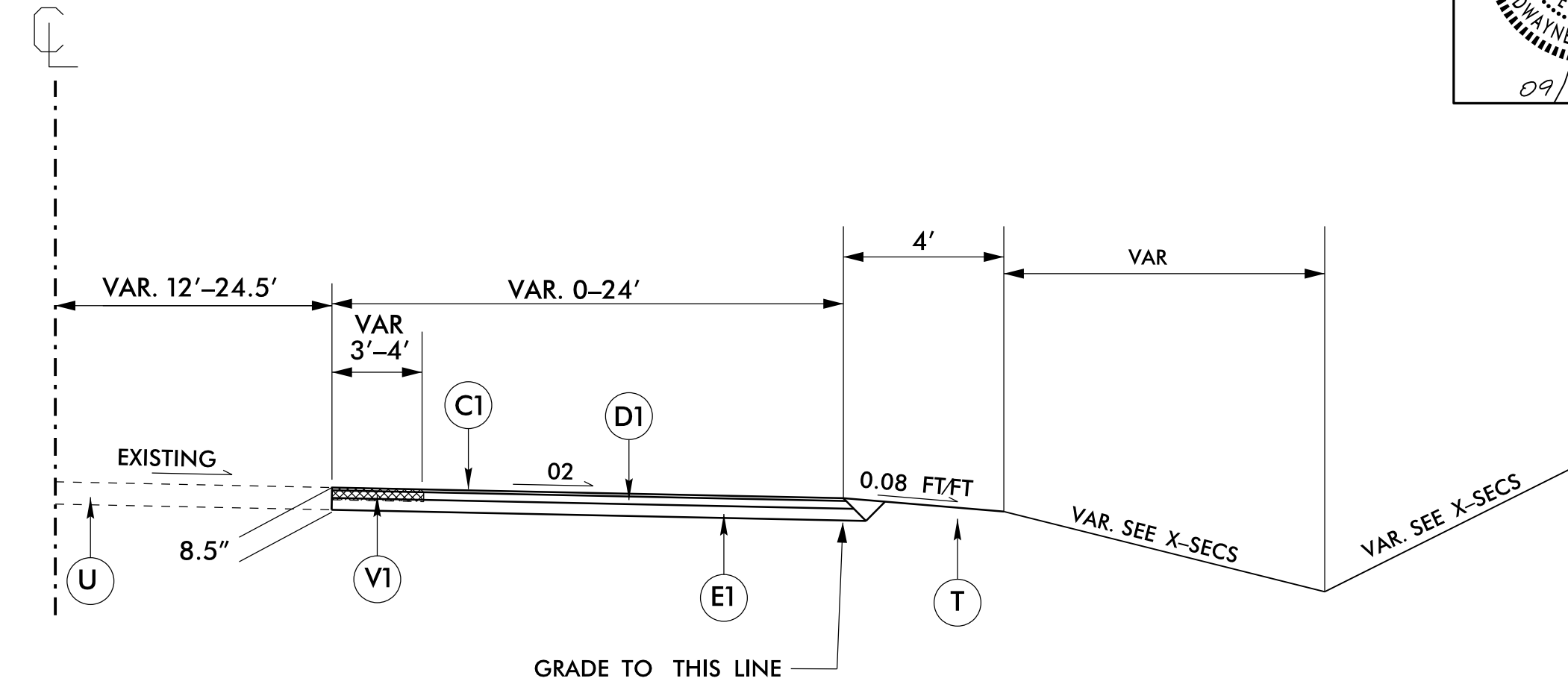

TYPICAL SECTION #2

NOT TO SCALE

- L- LT 3+63.18 TO 14+04.90
- L- LT 15+35.97 TO 21+06.08

US 70  
EBL

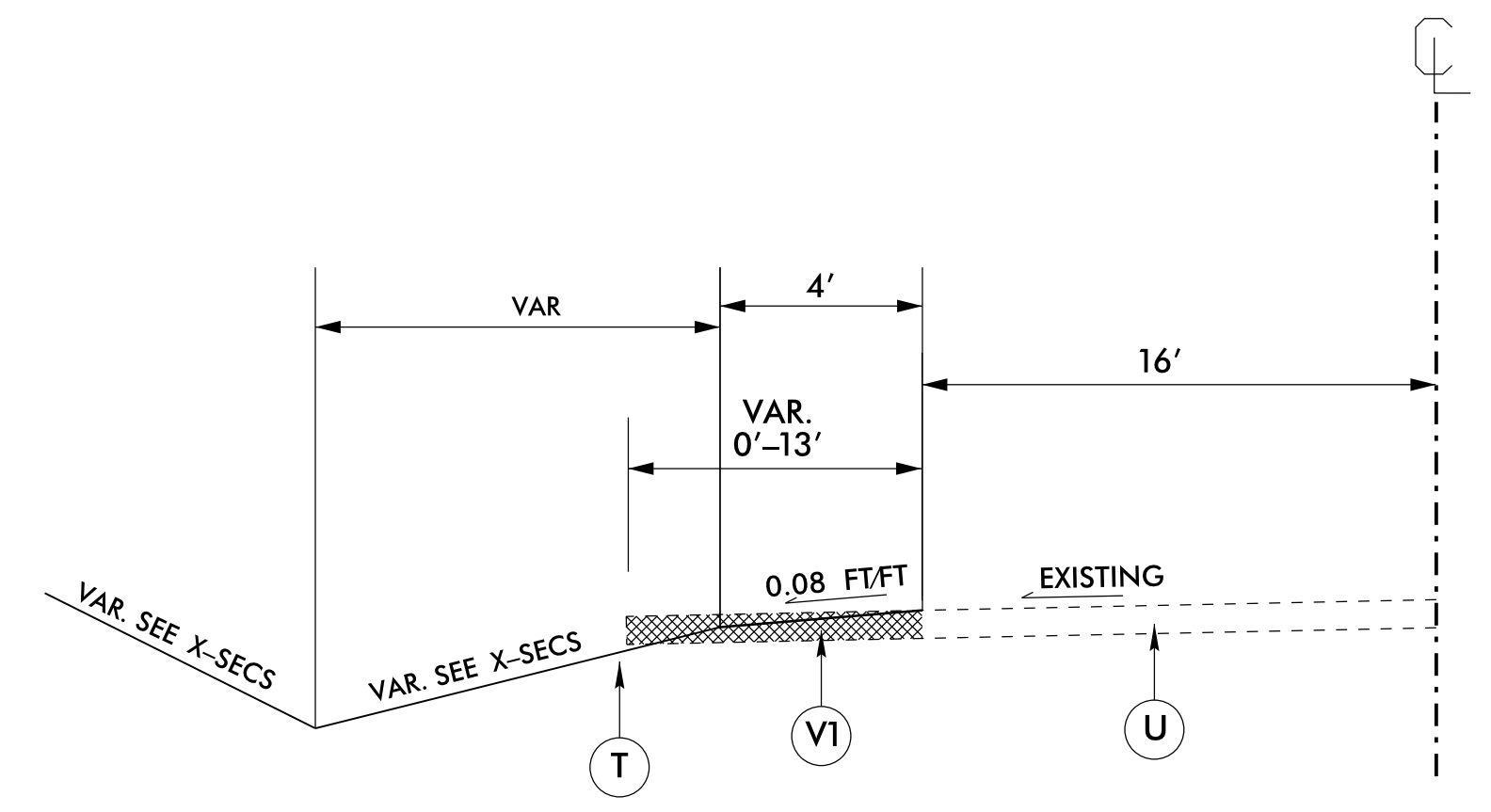

TYPICAL SECTION #2

NOT TO SCALE

- L- 10+01.02 TO 14+04.90

US 70  
EBL

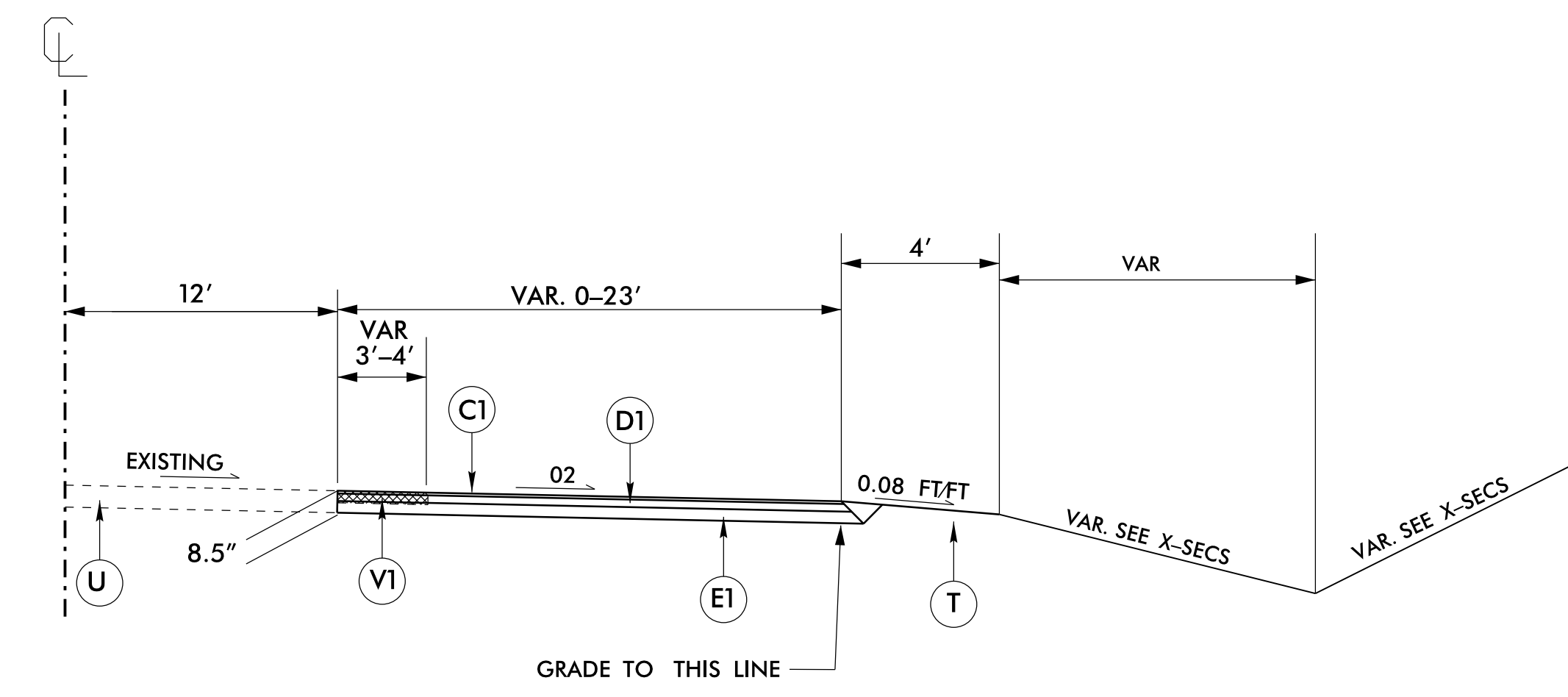

TYPICAL SECTION #3

NOT TO SCALE

- L- RT 15+20.11 TO 16+47.54

REVISIONS

8/17/99

05-SEP-2012 16:49  
 08-APR-2012 15:44  
 01-DEC-2011 15:51  
 M:\PROJECTS\2012\42596\US70\mccobe\70\_dtbl2\_psh\_2.dgn

STATE OF NORTH CAROLINA  
DIVISION OF HIGHWAYS  
SUMMARY OF QUANTITIES

SECT	QUANTITY	UNIT	ITEM DESCRIPTION
800	1	LS	MOBILIZATION
226	1	LS	GRADING
226	100	CY	UNDERCUT EXCAVATION
300	10	TON	FOUNDATION CONDITIONING MATERIAL, MINOR STRUCTURES
310	24	LF	24" RC PIPE CULVERTS, CLASS III
310	4	LF	18" RC PIPE CULVERTS, CLASS III
310	1	EA	24" PIPE END SECTION
610	610	TON	ASPHALT CONCRETE BASE COURSE, TYPE B25.0B
610	460	TON	ASPHALT CONCRETE INTERMEDIATE COURSE, TYPE I19.0B
610	230	TON	ASPHALT CONCRETE SURFACE COURSE, TYPE S9.5B
620	65	TON	ASPHALT BINDER FOR PLANT MIX, GRADE PG64-22
840	2	EA	MASONRY DRAINAGE STRUCTURES
840	2	EA	FRAME WITH GRATE, STD 840.22
840	1	EA	MANHOLE FRAME AND COVER, STD 840.54
852	210	SY	5" MONOLITHIC CONCRETE ISLANDS (SURFACE MOUNTED)
862	1	EA	CONVERT EXISTING DROP INLET TO JUNCTION BOX
1105	1	LS	TEMPORARY TRAFFIC CONTROL
1205	2496	LF	THERMOPLASTIC PAVEMENT MARKING LINES (6", 90 MILS)
1205	388	LF	THERMOPLASTIC PAVEMENT MARKING LINES (6", 120 MILS)
1205	9	EA	THERMOPLASTIC PAVEMENT MARKING SYMBOLS (90 MILS)
1610	3	TON	SEDIMENT CONTROL STONE
1620	50	LB	SEED FOR TEMPORARY SEEDING
1620	0.2	TON	FERTILIZER FOR TEMPORARY SEEDING
1631	220	SY	MATTING FOR EROSION CONTROL
1632	60	LF	1/4" HARDWARE CLOTH
SP	60	LF	WATTLE
SP	1	LB	POLYACRYLAMIDE (PAM)
1660	0.8	ACRE	SEEDING AND MULCHING
1661	50	LB	SEED FOR REPAIR SEEDING
1661	0.2	TON	FERTILIZER FOR REPAIR SEEDING

REVISIONS

8/17/99

05-SEP-2016 16:49  
D:\PROJECTS\AT\PROJECTS\MCCABE\70\mccabe\70\ddc2.psh\_3.dgn  
mccabed





PROJECT REFERENCE NO.	SHEET NO.
42596	4
RW SHEET NO.	
ROADWAY DESIGN ENGINEER	HYDRAULICS ENGINEER

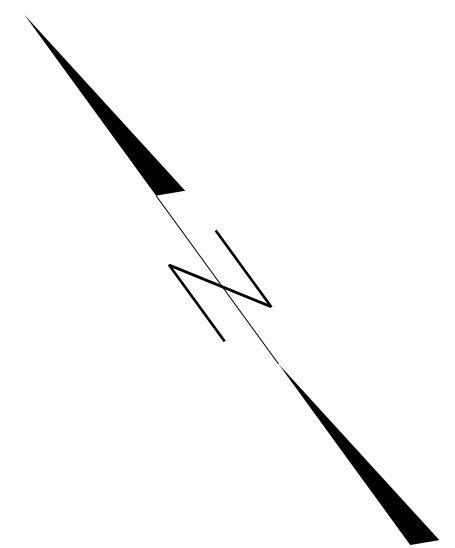

REVISIONS

05-SEP-2012 16:49 D:\PROJECTS\42596\REF\1\MC\cbse70\mccbbe70\cdd2.psh.4.dgn 8/17/99

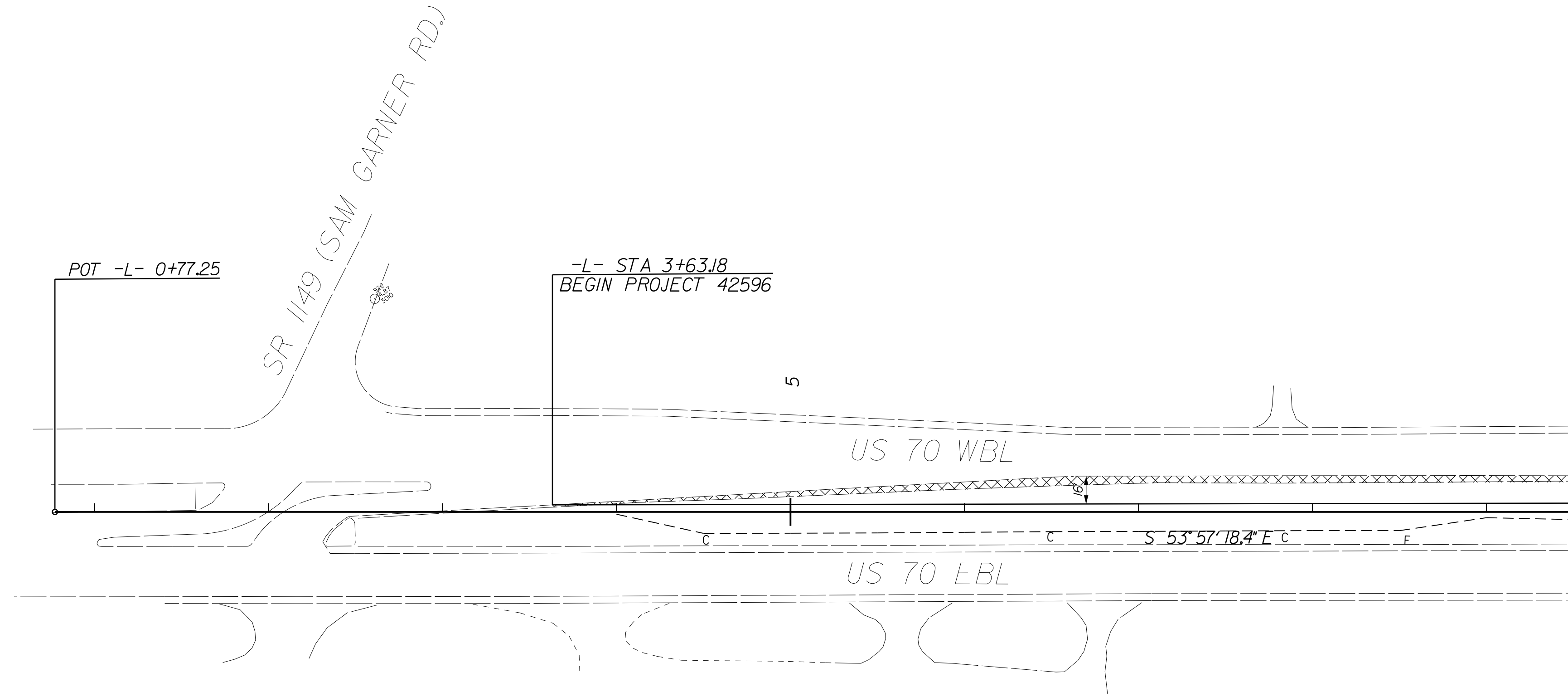

MATCHLINE \*\*\* SEE SHEET NO. 5 \*\*\*

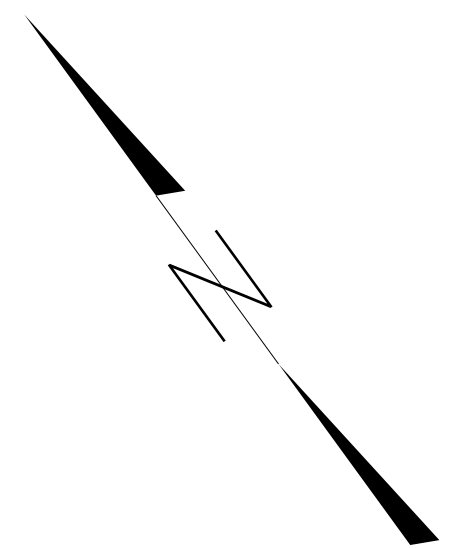

REVISIONS

05-SEP-2012 16:49 T:\PROJECTS\McCabe\70\mccabe\70\_dtb2\_psh\_5.dgn  
 08-NOV-2012 15:01 T:\PROJECTS\McCabe\70\mccabe\70\_dtb2\_psh\_5.dgn  
 01-DEC-2012 15:01 T:\PROJECTS\McCabe\70\mccabe\70\_dtb2\_psh\_5.dgn

MATCHLINE \*\*\* SEE SHEET NO. 4 \*\*\*

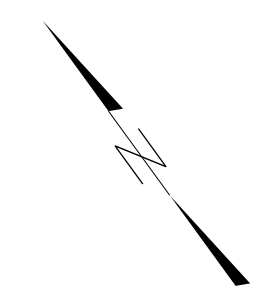
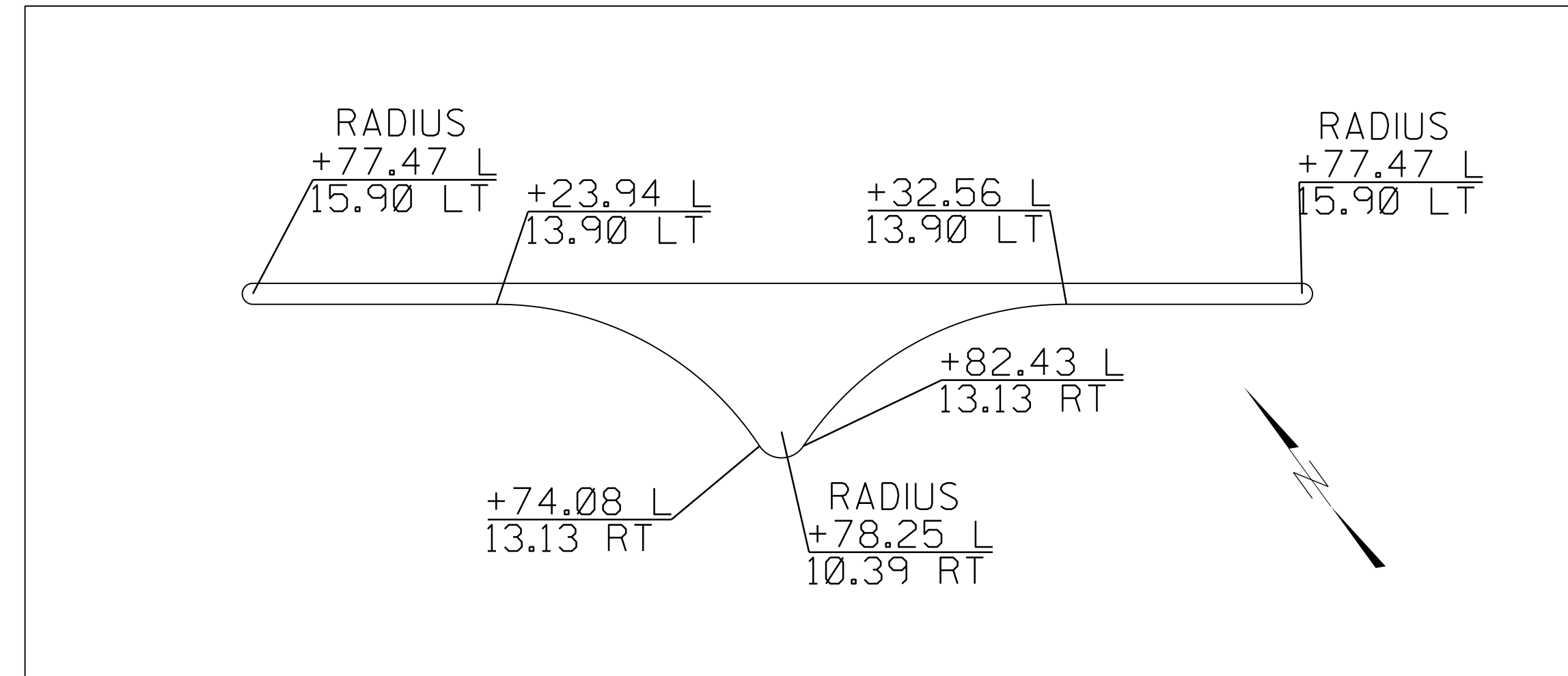
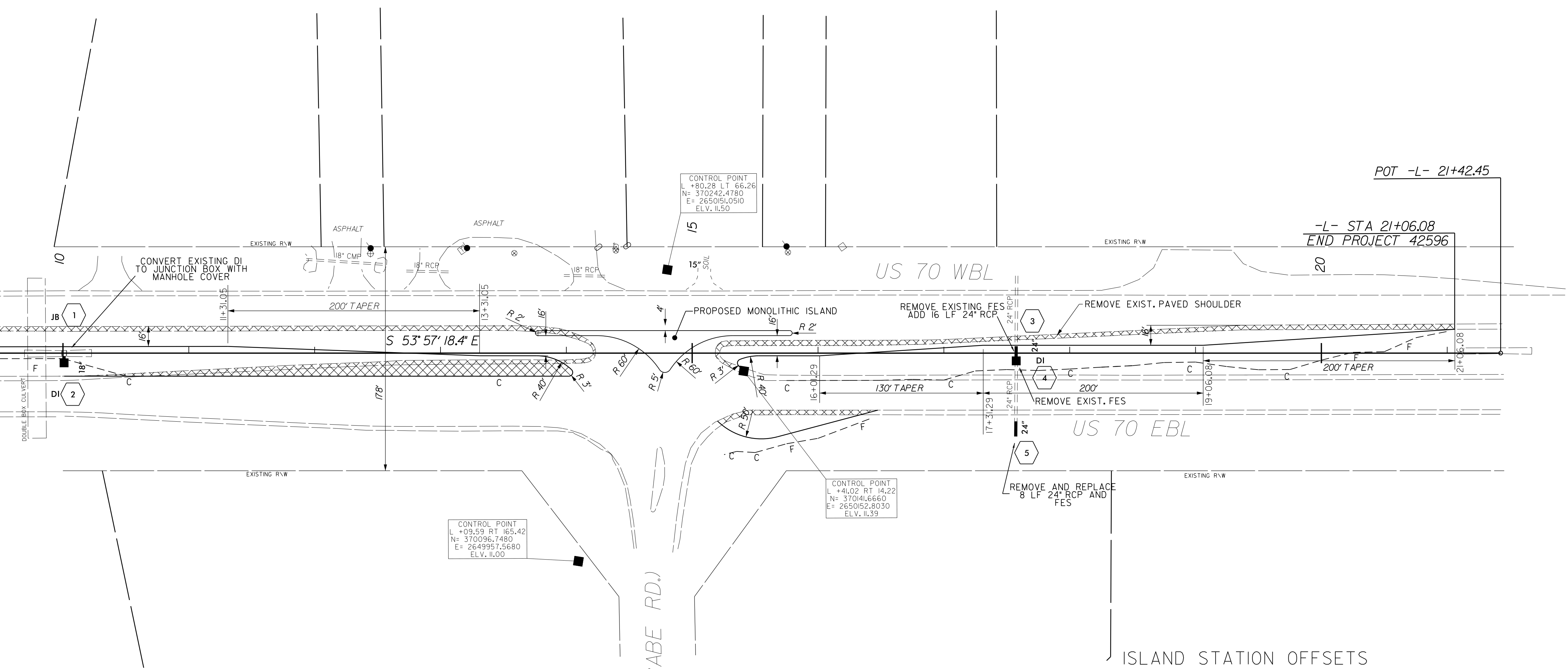



# WATTLE WITH POLYACRYLAMIDE DETAIL

**NOTES:**

- USE MINIMUM 12 IN. DIAMETER EXCELSIOR WATTLE.
- USE 2 FT. WOODEN STAKES WITH A 2 IN. BY 2 IN. CROSS SECTION.
- ONLY INSTALL WATTLE(S) TO A HEIGHT IN DITCH SO FLOW WILL NOT WASH AROUND WATTLE AND SCOUR DITCH SLOPES AND AS DIRECTED.
- INSTALL A MINIMUM OF 2 UPSLOPE STAKES AND 4 DOWNSLOPE STAKES AT AN ANGLE TO WEDGE WATTLE TO BOTTOM OF DITCH.
- PROVIDE STAPLES MADE OF 0.125 IN. DIAMETER STEEL WIRE FORMED INTO A U SHAPE NOT LESS THAN 12" IN LENGTH.
- INSTALL STAPLES APPROXIMATELY EVERY 1 LINEAR FOOT ON BOTH SIDES OF WATTLE AND AT EACH END TO SECURE IT TO THE SOIL.
- INSTALL MATTING IN ACCORDANCE WITH SECTION 1631 OF THE STANDARD SPECIFICATIONS.
- PRIOR TO POLYACRYLAMIDE (PAM) APPLICATION, OBTAIN A SOIL SAMPLE FROM PROJECT LOCATION, AND FROM OFFSITE MATERIAL, AND ANALYZE FOR APPROPRIATE PAM FLOCCULANT TO BE APPLIED TO EACH WATTLE.
- INITIALLY APPLY 3.5 OUNCES OF ANIONIC OR NEUTRALLY CHARGED POLYACRYLAMIDE (PAM) OVER WATTLE WHERE WATER WILL FLOW AND AFTER EVERY RAINFALL EVENT THAT IS EQUAL TO OR EXCEEDS 0.50 IN.

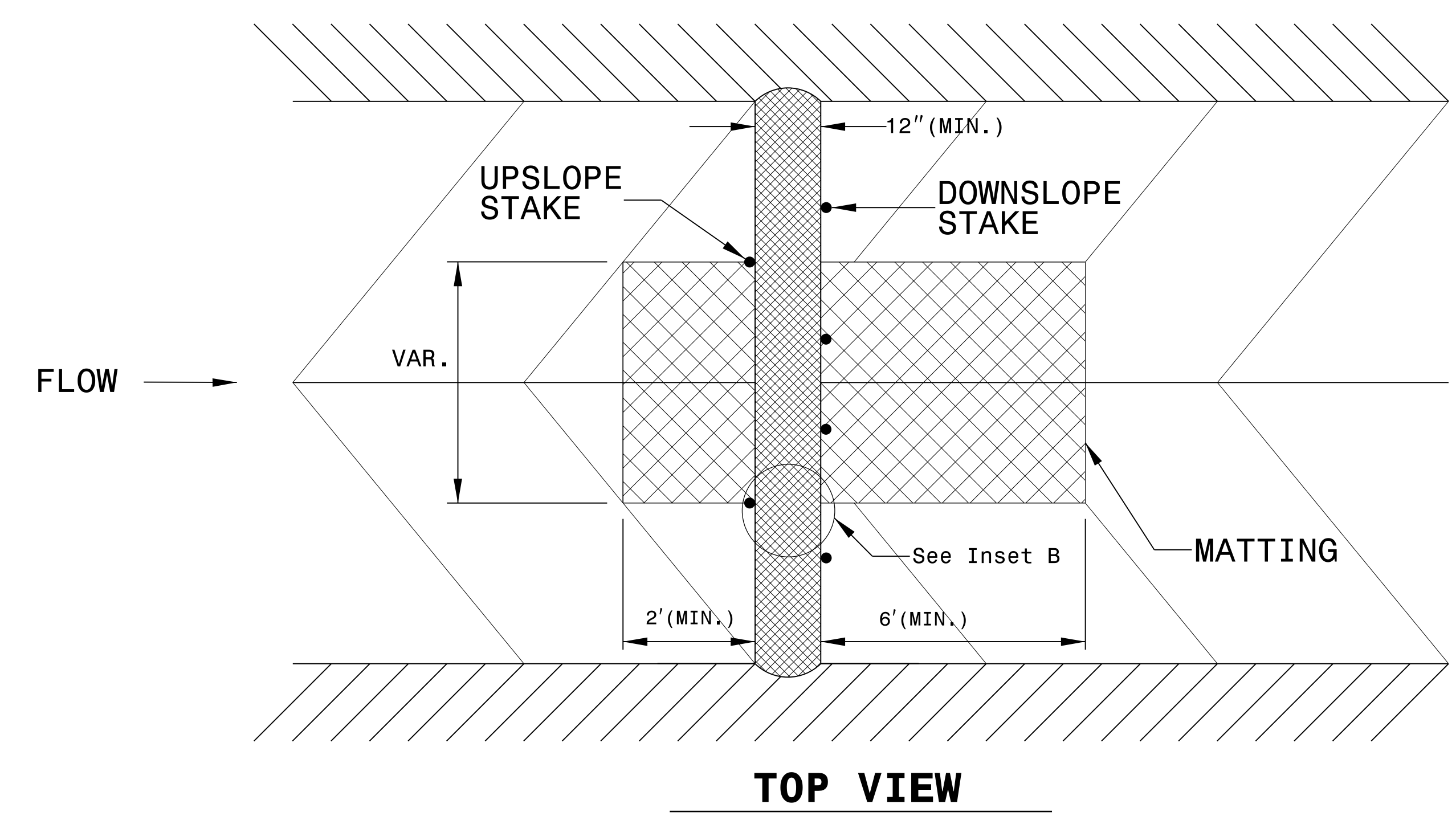
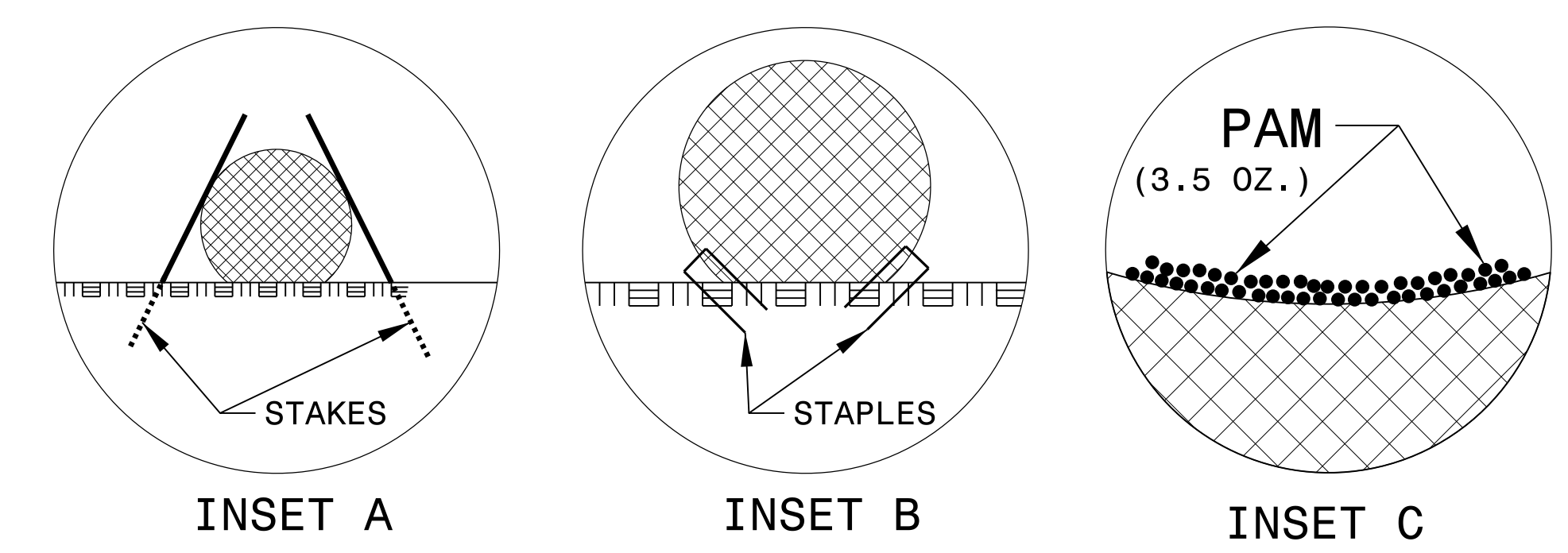
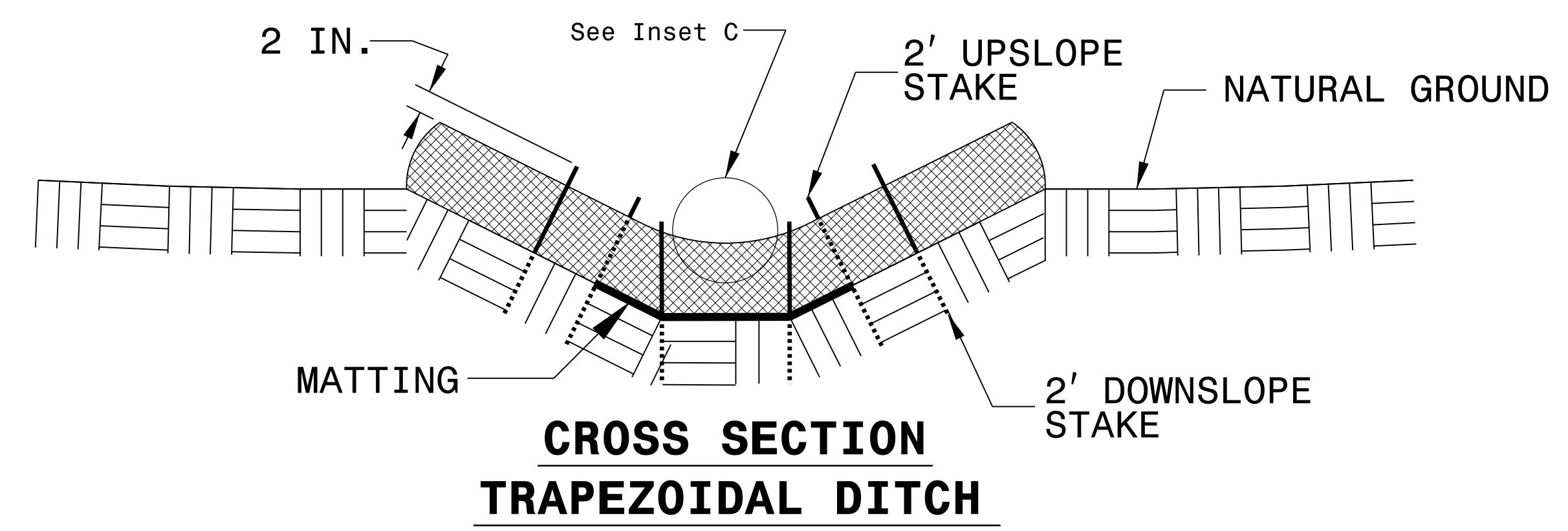
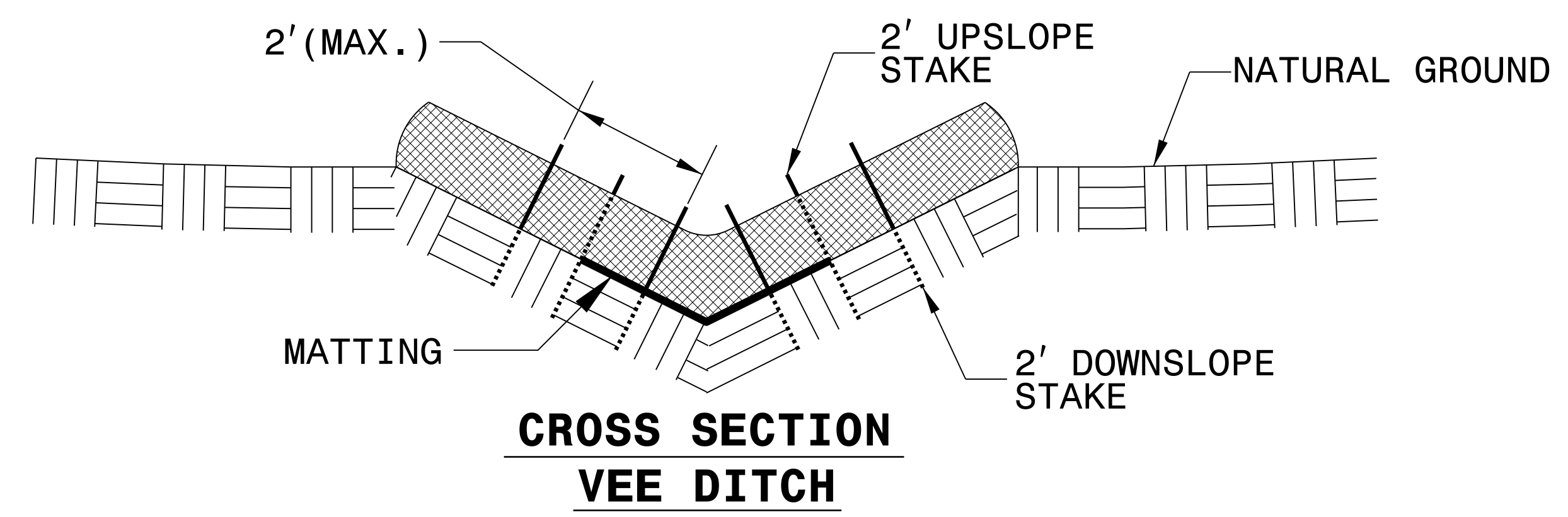
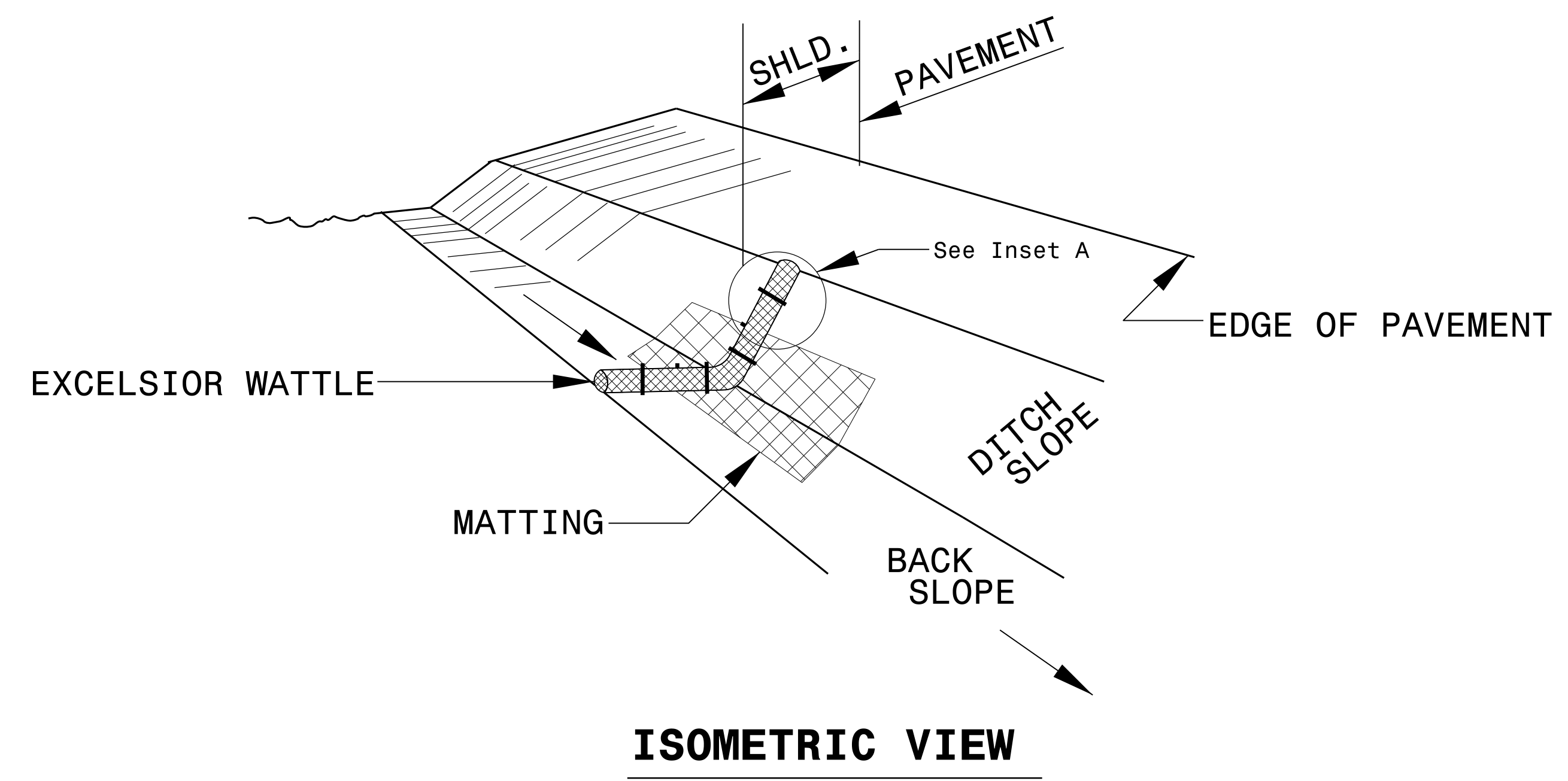

REVISIONS

05-SEP-2016 6:49 AM PROJECT: M:\C:\pbe\70\mccobe\70\d1c2.psh.ec1a.dgn  
 08-NOV-2016 10:12 AM PROJECT: M:\C:\pbe\70\mccobe\70\d1c2.psh.ec1a.dgn  
 08-NOV-2016 10:12 AM PROJECT: M:\C:\pbe\70\mccobe\70\d1c2.psh.ec1a.dgn

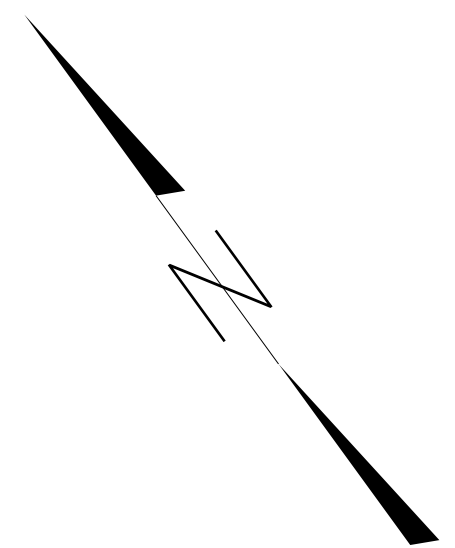

REVISIONS

8/17/99

05-SEP-2016 16:49  
 G:\PROJECTS\41127\DRAWINGS\EC2\EC2.dgn  
 M:\CADD\AT\127\DRAWINGS\EC2\EC2.dgn

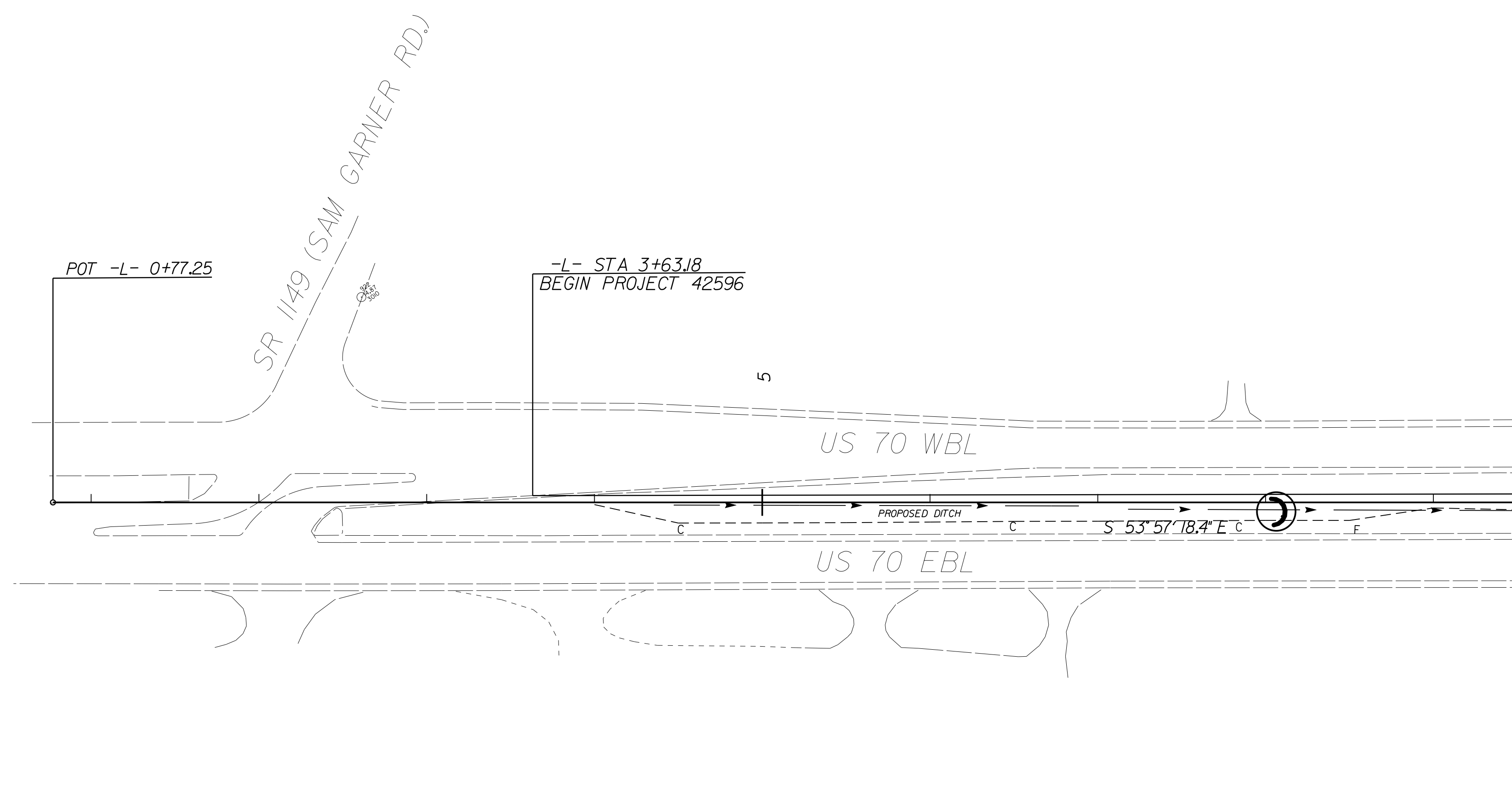

MATCHLINE \*\*\* SEE SHEET NO. EC-3 \*\*\*

NOTES: ANY DEVIATION FROM OPTIONS GIVEN WILL REQUIRE PRIOR APPROVAL BY ENGINEER.

ADDITIONAL EROSION CONTROL DEVICES MAY NEED TO BE INSTALLED AS DIRECTED BY THE ENGINEER.

**SOIL STABILIZATION TIMEFRAMES**

SITE DESCRIPTION	STABILIZATION TIME	TIMEFRAME EXCEPTIONS
PERIMETER DIKES, SWALES, DITCHES AND SLOPES	7 DAYS	NONE
HIGH QUALITY WATER (HOW) ZONES	7 DAYS	NONE
SLOPES STEEPER THAN 3:1	7 DAYS	IF SLOPES ARE 10' OR LESS IN LENGTH AND ARE NOT STEEPER THAN 2:1, 14 DAYS ARE ALLOWED.
SLOPES 3:1 OR FLATTER	14 DAYS	7 DAYS FOR SLOPES GREATER THAN 50' IN LENGTH.
ALL OTHER AREAS WITH SLOPES FLATTER THAN 4:1	14 DAYS	NONE, EXCEPT FOR PERIMETERS AND HOW ZONES.

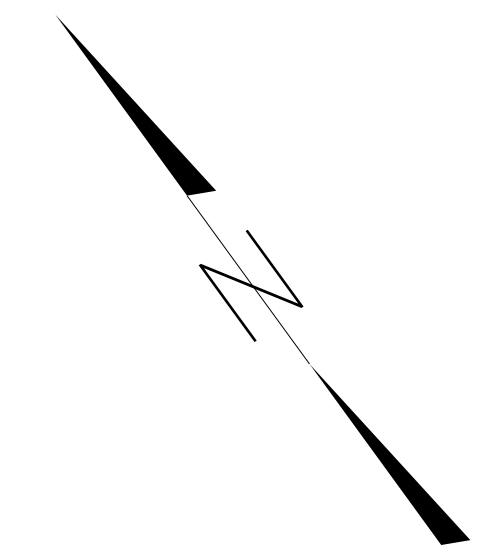

MATCHLINE \*\*\* SEE SHEET NO. EC-2 \*\*\*

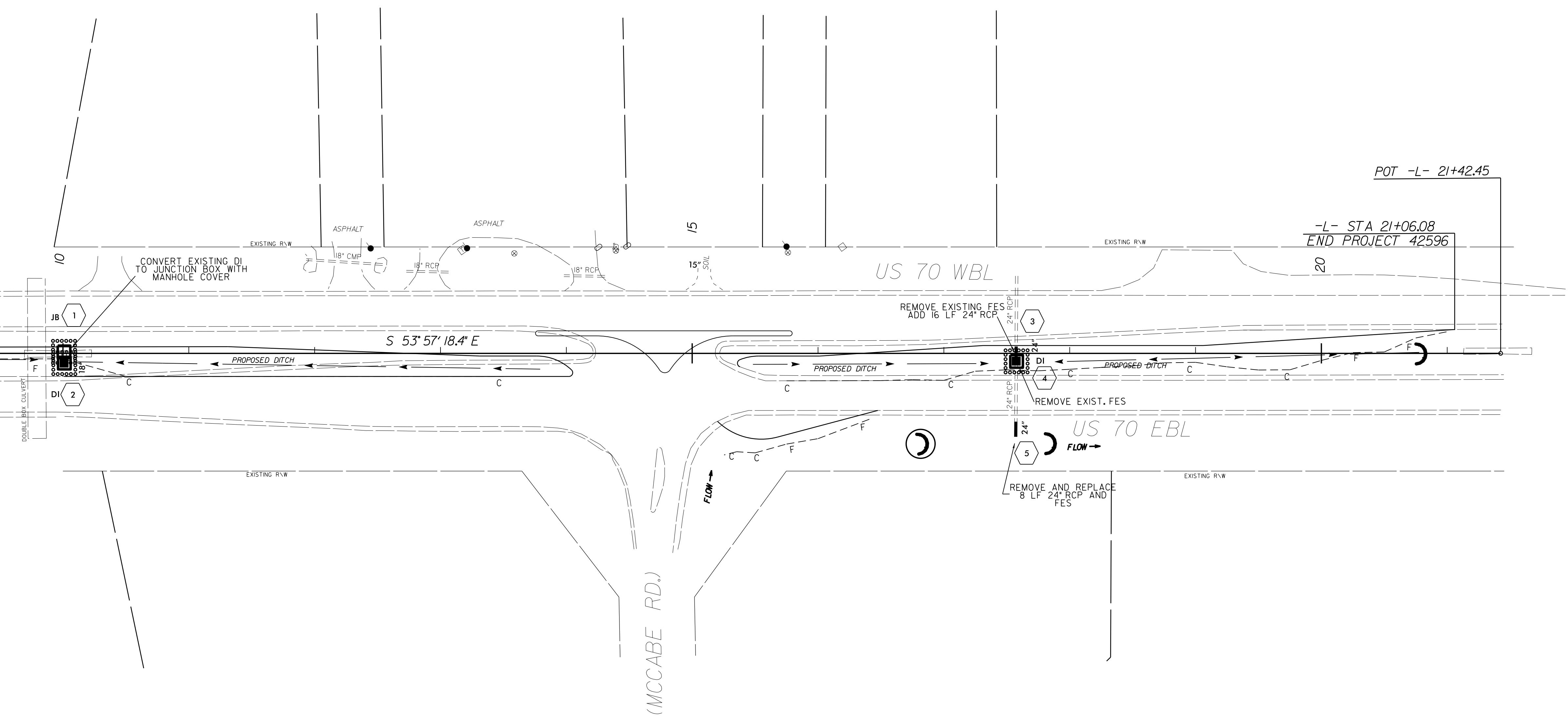

REVISIONS

8/17/99

05-SEP-2016 6:49 AM C:\PROJECTS\4141\TERRIT\MCC\cbbse70\mccbbe70\dlc2.psh.ec3.dgn

NOTES: ANY DEVIATION FROM OPTIONS GIVEN WILL REQUIRE PRIOR APPROVAL BY ENGINEER.

ADDITIONAL EROSION CONTROL DEVICES MAY NEED TO BE INSTALLED AS DIRECTED BY THE ENGINEER.

**SOIL STABILIZATION TIMEFRAMES**

SITE DESCRIPTION	STABILIZATION TIME	TIMEFRAME EXCEPTIONS
PERIMETER DIKES, SWALES, DITCHES AND SLOPES	7 DAYS	NONE
HIGH QUALITY WATER (HOW) ZONES	7 DAYS	NONE
SLOPES STEEPER THAN 3:1	7 DAYS	IF SLOPES ARE 10' OR LESS IN LENGTH AND ARE NOT STEEPER THAN 2:1, 14 DAYS ARE ALLOWED.
SLOPES 3:1 OR FLATTER	14 DAYS	7 DAYS FOR SLOPES GREATER THAN 50' IN LENGTH.
ALL OTHER AREAS WITH SLOPES FLATTER THAN 4:1	14 DAYS	NONE, EXCEPT FOR PERIMETERS AND HOW ZONES.

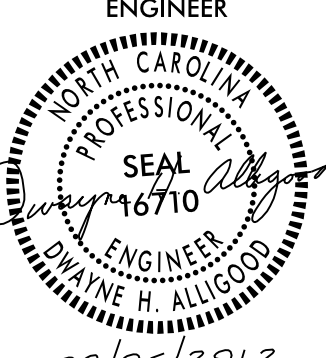
PROJECT REFERENCE NO. 42596	SHEET NO. PM-1
RW SHEET NO.	
ROADWAY DESIGN ENGINEER 	HYDRAULICS ENGINEER 

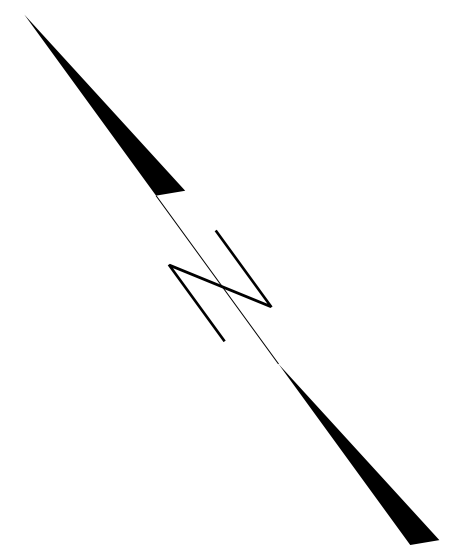

## PAVEMENT MARKING SCHEDULE

### PAVEMENT MARKING LINES

- |   |                              |
|---|------------------------------|
| AA - THERMOPLASTIC ( 6" WHITE, 120 MILS ) | 6' X 2' MINI SKIP ( 6' GAP ) |
| AB - THERMOPLASTIC ( 6" WHITE, 90 MILS )  | EDGE LINE                    |
| AC - THERMOPLASTIC ( 6" YELLOW, 90 MILS ) | EDGE LINE                    |
| AD - THERMOPLASTIC ( 6" WHITE, 120 MILS ) | SOLID LANE LINE              |

### PAVEMENT MARKING SYMBOLS

- BA - THERMOPLASTIC ( LEFT TURN ARROW, 90 MILS )

### NOTE

PAINT MARKINGS AND TRAFFIC CONTROL DEVICES SHALL BE IN ACCORDANCE WITH NCDOT STANDARD SPECIFICATIONS FOR ROADS AND STRUCTURES, NCDOT ROADWAY STANDARD DRAWINGS, AND THE CURRENT EDITION OF THE MANUAL OF UNIFORM TRAFFIC CONTROL DEVICES (MUTCD). QUANTITIES FOR THESE ITEMS HAVE BEEN ACCOUNTED FOR IN THE CONTRACT BID FORM.

REVISIONS

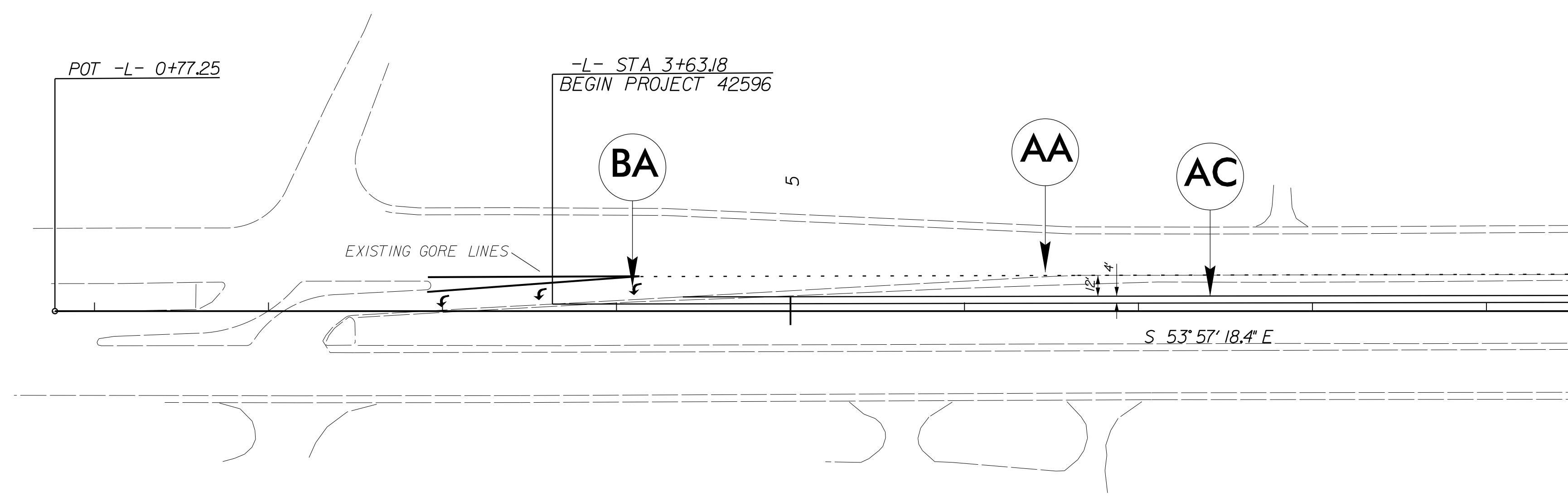

MATCHLINE \*\*\* SEE SHEET NO. PM-2 \*\*\*

8/17/99

05-SEP-2012 6:49 AM C:\PROJECTS\42596\REF\T.M.C.pbe\70\mccobe\70\ddc2.psh.pml.dgn

PROJECT REFERENCE NO. 42596	SHEET NO. PM-2
RW SHEET NO.	
ROADWAY DESIGN ENGINEER 	HYDRAULICS ENGINEER 

## PAVEMENT MARKING SCHEDULE

### PAVEMENT MARKING LINES

- |   |                              |
|---|------------------------------|
| AA - THERMOPLASTIC ( 6" WHITE, 120 MILS ) | 6' X 2' MINI SKIP ( 6' GAP ) |
| AB - THERMOPLASTIC ( 6" WHITE, 90 MILS )  | EDGE LINE                    |
| AC - THERMOPLASTIC ( 6" YELLOW, 90 MILS ) | EDGE LINE                    |
| AD - THERMOPLASTIC ( 6" WHITE, 120 MILS ) | SOLID LANE LINE              |
| AE - THERMOPLASTIC ( 6" WHITE, 120 MILS ) | 6' X 3' MINI SKIP ( 3' GAP ) |

### PAVEMENT MARKING SYMBOLS

- |   |
|---|
| BA - THERMOPLASTIC ( LEFT TURN ARROW, 90 MILS ) |
| BB - THERMOPLASTIC ( STRAIGHT ARROW, 90 MILS )  |

### NOTE

PAINT MARKINGS AND TRAFFIC CONTROL DEVICES SHALL BE IN ACCORDANCE WITH NCDOT STANDARD SPECIFICATIONS FOR ROADS AND STRUCTURES, NCDOT ROADWAY STANDARD DRAWINGS, AND THE CURRENT EDITION OF THE MANUAL OF UNIFORM TRAFFIC CONTROL DEVICES ( MUTCD ). QUANTITIES FOR THESE ITEMS HAVE BEEN ACCOUNTED FOR IN THE CONTRACT BID FORM.

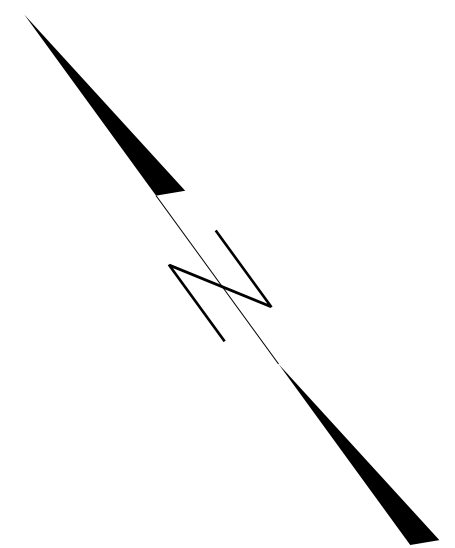

REVISIONS

8/17/99  
05-SEP-2012 6:49 AM  
D:\PROJECTS\4117\REF\T\MCC\pbse\70\mccbbe\70\ddc2.psh.pn2.dgn  
mccbbe

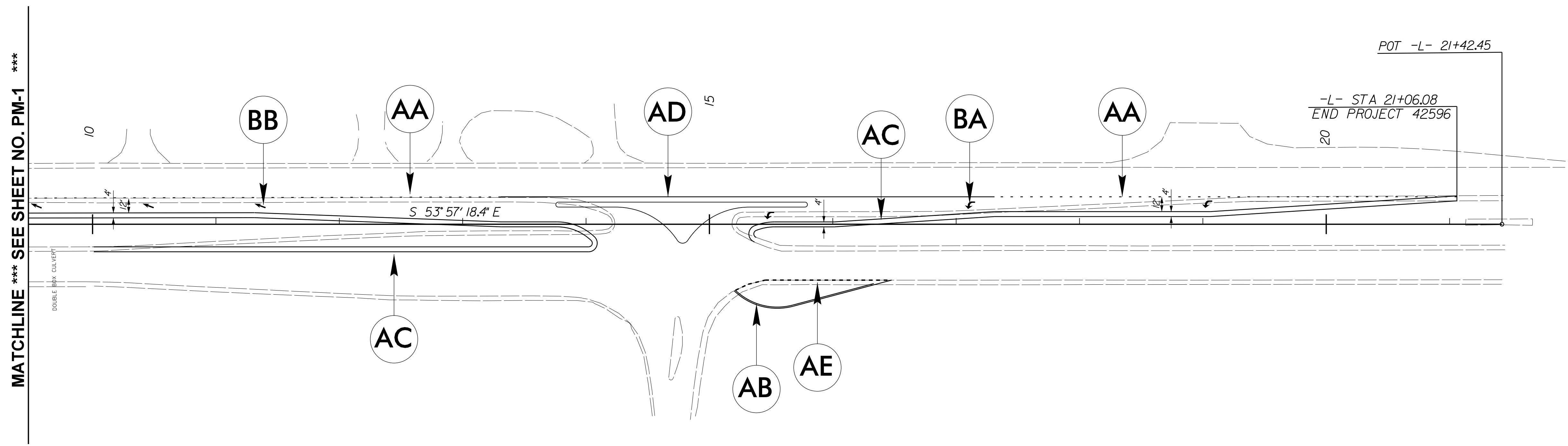

STATE OF NORTH CAROLINA  
DIVISION OF HIGHWAYS

STATE PROJECT REFERENCE NO.	SHEET NO.
42596	TCP-1

**PLAN FOR PROPOSED  
TRAFFIC CONTROL**

**CARTERET COUNTY**

LOCATION: INTERSECTION OF US 70 AND MCCABE RD.

TYPE OF WORK: GRADING, PAVING AND DRAINAGE.

**ROADWAY STANDARD DRAWINGS**

THE FOLLOWING ROADWAY STANDARDS AS APPEAR IN "ROADWAY STANDARD DRAWINGS"-  
HIGHWAY DESIGN BRANCH-N.C. DEPARTMENT OF TRANSPORTATION-RALEIGH, N.C.,  
DATED JANUARY 2012 ARE APPLICABLE TO THIS PROJECT AND BY REFERENCE HEREBY ARE  
CONSIDERED A PART OF THESE PLANS:

STD. NO.	TITLE
1101.02	TEMPORARY LANE CLOSURES
1101.11	TRAFFIC CONTROL DESIGN TABLES
1110.01	STATIONARY WORK ZONE SIGNS
1110.02	PORTABLE WORK ZONE SIGNS
1130.01	DRUM
1135.01	CONES
1150.01	FLAGGING DEVICES

**INDEX OF SHEETS**

SHEET NO.	TITLE
TCP-1	LIST OF APPLICABLE ROADWAY STANDARD DRAWINGS, LEGEND AND INDEX OF SHEETS
TCP-2	PROJECT NOTES

**LEGEND**

- GENERAL**
- DIRECTION OF TRAFFIC FLOW
  - NORTH ARROW
  - PROPOSED PVMT. EXIST. PVMT.
  - WORK AREA
  - REMOVAL OF EXISTING PAVEMENT
- TRAFFIC CONTROL DEVICES**
- TYPE I BARRICADE
  - TYPE II BARRICADE
  - TYPE III BARRICADE
  - CONE
  - DRUM SKINNY DRUM
  - FLASHING ARROW PANEL (TYPE C)
  - STATIONARY SIGN
  - PORTABLE SIGN
  - STATIONARY OR PORTABLE SIGN
  - CRASH CUSHION
  - CHANGEABLE MESSAGE SIGN
  - TRUCK MOUNTED IMPACT ATTENUATOR (TMIA)
  - POLICE
  - FLAGGER

**PROJECT: 42596**

05-SEP-2012 16:49  
G:\PROJECTS\CARTERET\McCabe@70\mccabe@70\_dcc2\_psh\_tcp1.dgn  
m.jackson AT D2CAD246301

APPROVED: <i>Dwayne H. Alligood</i> DATE: <i>09/05/2012</i>	PLAN PREPARED BY: N.C.D.O.T. DIVISION 2 DDC UNIT
SEAL 	D. H. ALLIGOOD, PE <b>TRAFFIC CONTROL ENGINEER</b>
	D. H. ALLIGOOD, PE <b>TRAFFIC CONTROL PROJECT ENGINEER</b>
	LANG JONES <b>TRAFFIC CONTROL PROJECT DESIGN ENGINEER</b>
	MIKE JACKSON <b>TRAFFIC CONTROL DESIGN ENGINEER / TECHNICIAN</b>

## GENERAL NOTES

CHANGES MAY BE REQUIRED WHEN PHYSICAL DIMENSIONS IN THE DETAIL DRAWINGS, STANDARD DETAILS AND ROADWAY DETAILS ARE NOT ATTAINABLE TO MEET FIELD CONDITIONS, OR RESULT IN DUPLICATE, OR UNDESIRED OVERLAPPING OF DEVICES. MODIFICATION MAY INCLUDE: MOVING, SUPPLEMENTING, COVERING OR REMOVAL OF DEVICES, AS DIRECTED BY THE ENGINEER.

THE FOLLOWING GENERAL NOTES APPLY AT ALL TIMES FOR THE DURATION OF THE CONSTRUCTION PROJECT, EXCEPT WHEN OTHERWISE NOTED IN THE PLAN, OR DIRECTED BY THE ENGINEER.

### LANE AND SHOULDER CLOSURE REQUIREMENTS

- A) WHEN PERSONNEL AND/OR EQUIPMENT ARE WORKING WITHIN A LANE OF TRAVEL OF AN UNDIVIDED OR DIVIDED FACILITY, CLOSE THE LANE ACCORDING TO THE TRAFFIC CONTROL PLANS, ROADWAY STANDARD DRAWINGS OR AS DIRECTED BY THE ENGINEER. CONDUCT THE WORK SO THAT ALL PERSONNEL AND/OR EQUIPMENT REMAIN WITHIN THE CLOSED TRAVEL LANE.

### TRAFFIC PATTERN ALTERATIONS

- B) NOTIFY THE ENGINEER TWENTY ONE (21) CALENDAR DAYS PRIOR TO ANY TRAFFIC PATTERN ALTERATION.

### SIGNING

- C) ENSURE ALL NECESSARY SIGNING IS IN PLACE PRIOR TO ALTERING ANY TRAFFIC PATTERN.

### TRAFFIC CONTROL DEVICES

- D) SPACE CHANNELIZING DEVICES IN WORK AREAS NO GREATER THAN TWICE THE POSTED SPEED LIMIT (MPH), EXCEPT 10 FT ON CENTER IN RADII, AND 3 FT OFF THE EDGE OF AN OPEN TRAVELWAY, WHEN LANE CLOSURES ARE NOT IN EFFECT. WHEN SKINNY DRUMS ARE ALLOWED, REFER TO SECTION 1160 OF STANDARD SPECIFICATIONS FOR RADS AND STRUCTURES OR AS SHOWN IN THE PLANS.

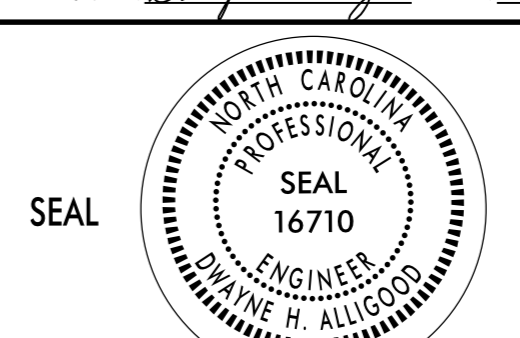
APPROVED: <i>Wayne H. Allgood</i> DATE: 10/05/2015		<b>PROJECT NOTES</b>									
	SCALE: NONE	<table border="1"> <thead> <tr> <th colspan="2">REVISIONS</th> </tr> </thead> <tbody> <tr> <td> </td> <td> </td> </tr> <tr> <td> </td> <td> </td> </tr> <tr> <td> </td> <td> </td> </tr> </tbody> </table>		REVISIONS							
	REVISIONS										
DATE: 10/15											
DWG. BY: MJ											
DESIGN BY: MJ											
REVIEWED BY: LJ	CADD FILE										

DIVISION OF HIGHWAYS  
STATE OF NORTH CAROLINA

**CROSS-SECTION SUMMARY**  
*IN CUBIC YARDS*

LOCATION (-L-)	UNCLASSIFIED EXCAVATION	UNDERCUT	EMBANKMENT
4+00.00	0		0
4+50.00	5		1
5+00.00	10		2
5+50.00	13		3
6+00.00	15		4
6+50.00	21		4
7+00.00	26		3
7+50.00	26		3
8+00.00	22		4
8+50.00	13		10
9+00.00	9		19
9+50.00	10		27
10+00.00	11		33
10+50.00	18		30
11+00.00	22		22
11+50.00	24		20
12+00.00	27		20
12+50.00	28		18
13+00.00	27		11
13+50.00	26		5
14+00.00	15		2
15+50.00	0		0
15+75.00	13		12
16+00.00	11		16

LOCATION (-L-)	UNCLASSIFIED EXCAVATION	UNDERCUT	EMBANKMENT
16+25.00	11		12
16+50.00	9		10
16+75.00	8		11
17+00.00	8		13
17+25.00	7		17
17+50.00	4		22
17+75.00	4		21
18+00.00	5		15
18+25.00	5		13
18+50.00	4		13
18+75.00	4		13
19+00.00	4		12
19+25.00	5		11
19+50.00	7		12
19+75.00	10		11
20+00.00	10		7
20+25.00	7		4
20+50.00	6		3
20+75.00	5		1
21+00.00	4		0

NOTE: Approximate quantities only. Unclassified excavation, Borrow Excavation, Fine Grading, Clearing and Grubbing, Removal of Existing Pavement and Breaking of Existing Pavement will be paid for at the contract Lump Sum price for "Grading".

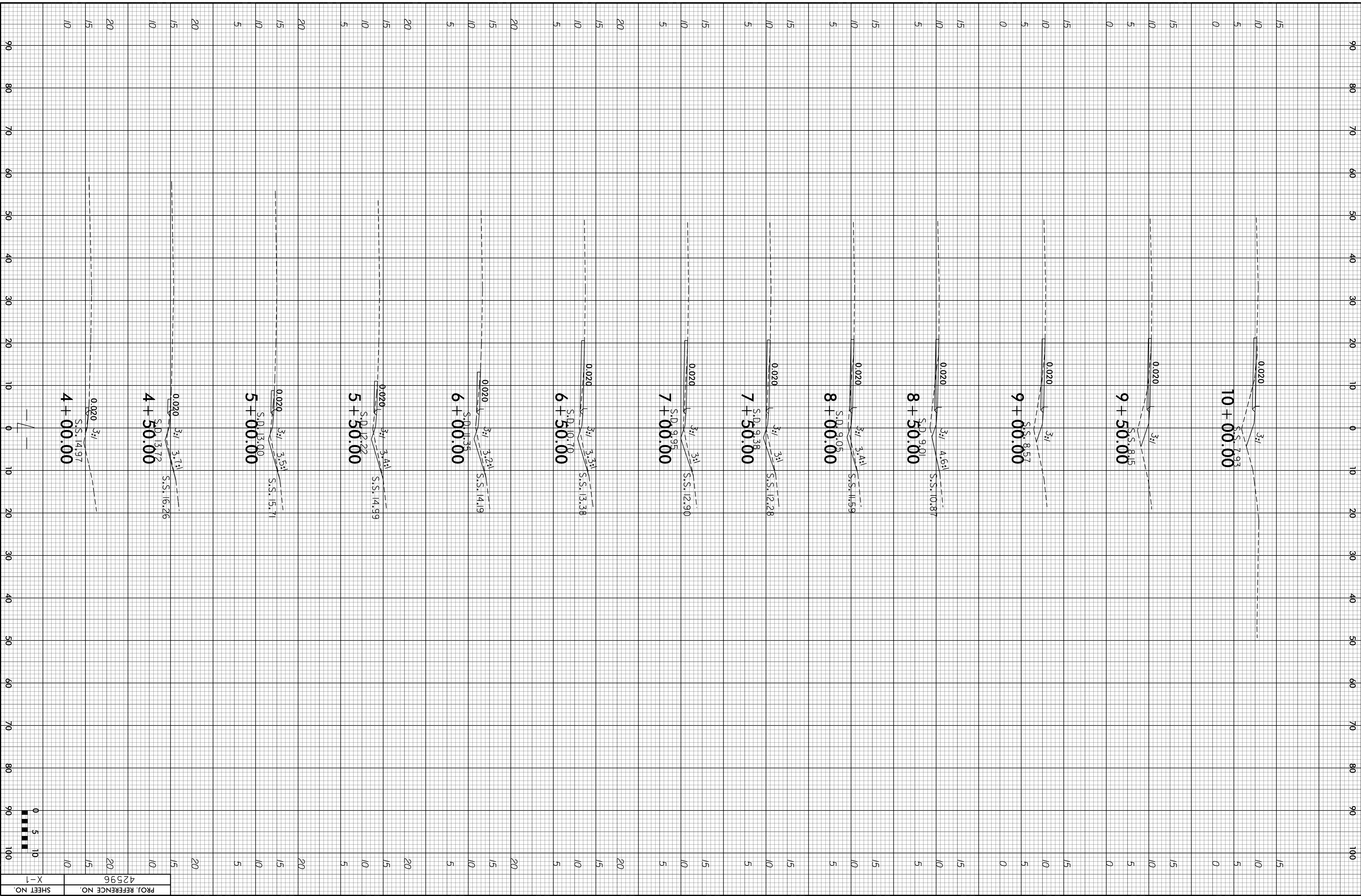

PROJ. REFERENCE NO. 42596  
SHEET NO. X-1

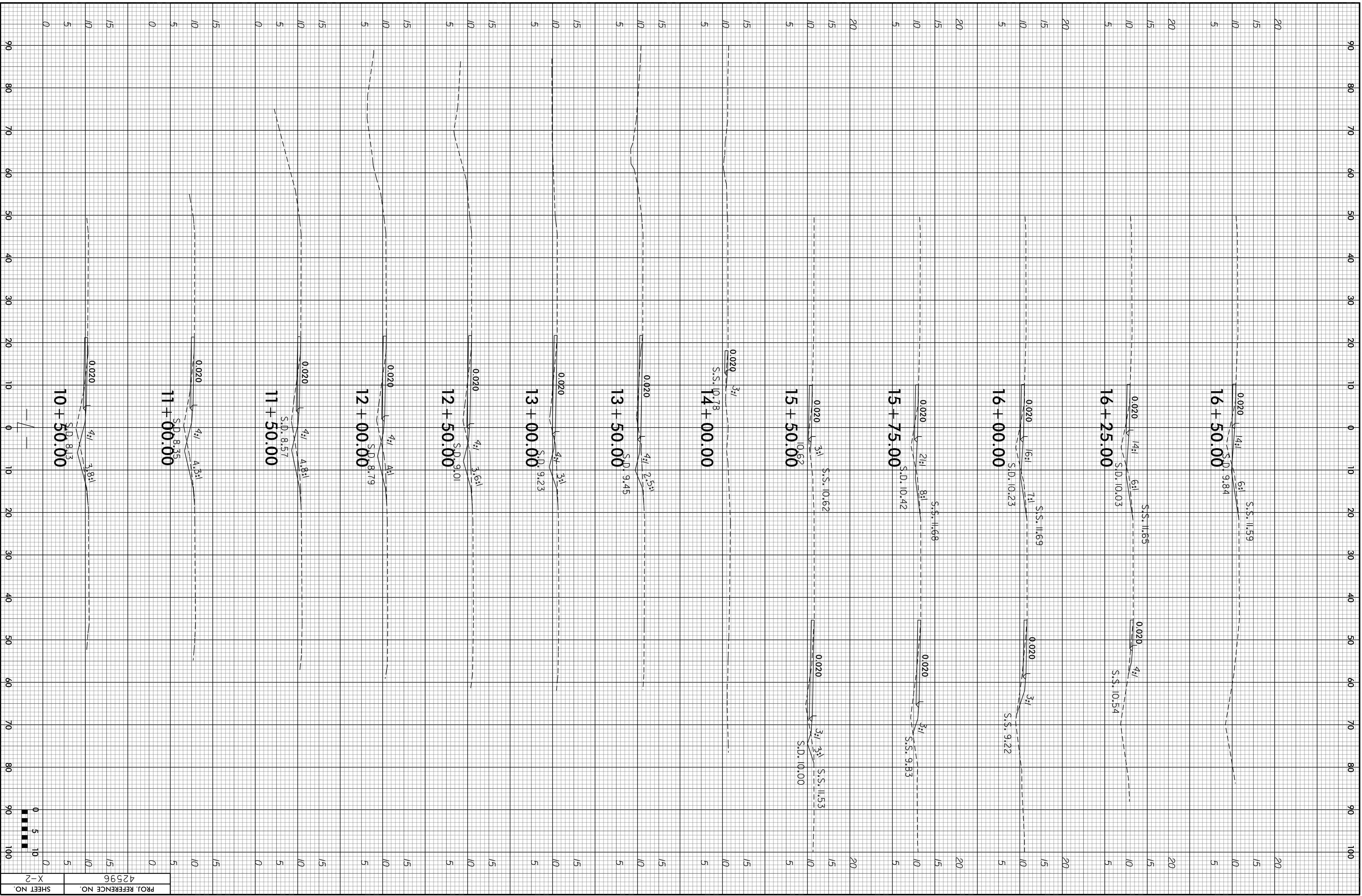

PROJ. REFERENCE NO. 42596  
SHEET NO. X-2

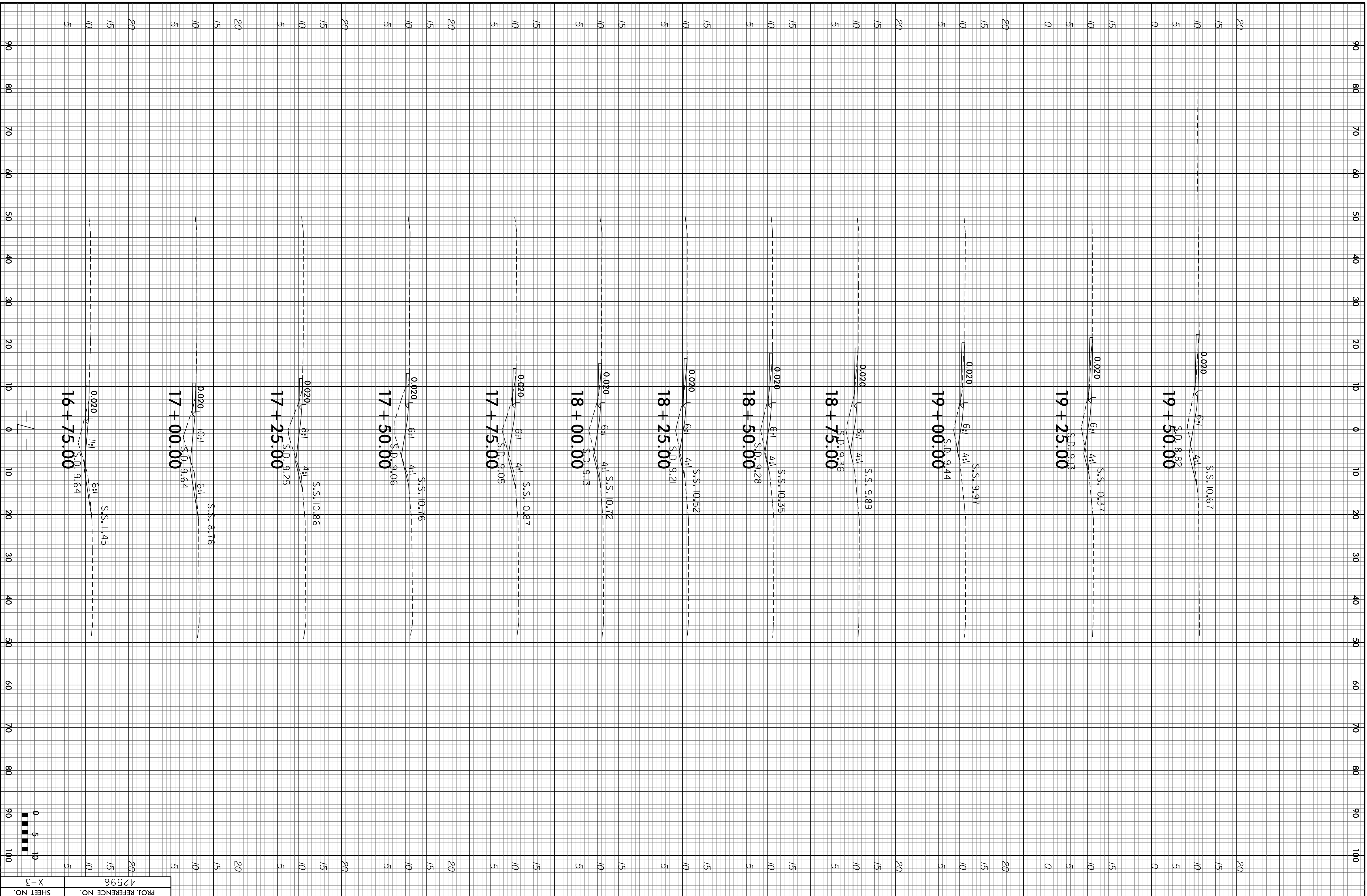

PROJ. REFERENCE NO. 42596  
 SHEET NO. X-3

