

09/05/19

**TIP PROJECT: BP2.R002**

STATE OF NORTH CAROLINA  
DIVISION OF HIGHWAYS

**PAMLICO COUNTY**

**LOCATION: BRIDGE NO. 28 ON SR 1005 (NEUSE ROAD) OVER  
FORK OF BEARD CREEK (CEDAR GUT)  
TYPE OF WORK: GRADING, DRAINAGE, PAVING, AND STRUCTURE**

STATE	STATE PROJECT REFERENCE NO.	SHEET NO.	TOTAL SHEETS
N.C.	BP2.R002	1	
STATE PROJ. NO.	F.A. PROJ. NO.	DESCRIPTION	
BP2.R002.1	N/A	PE	
BP2.R002.2	N/A	RW & UTILITIES	
BP2.R002.3	N/A	CONST.	

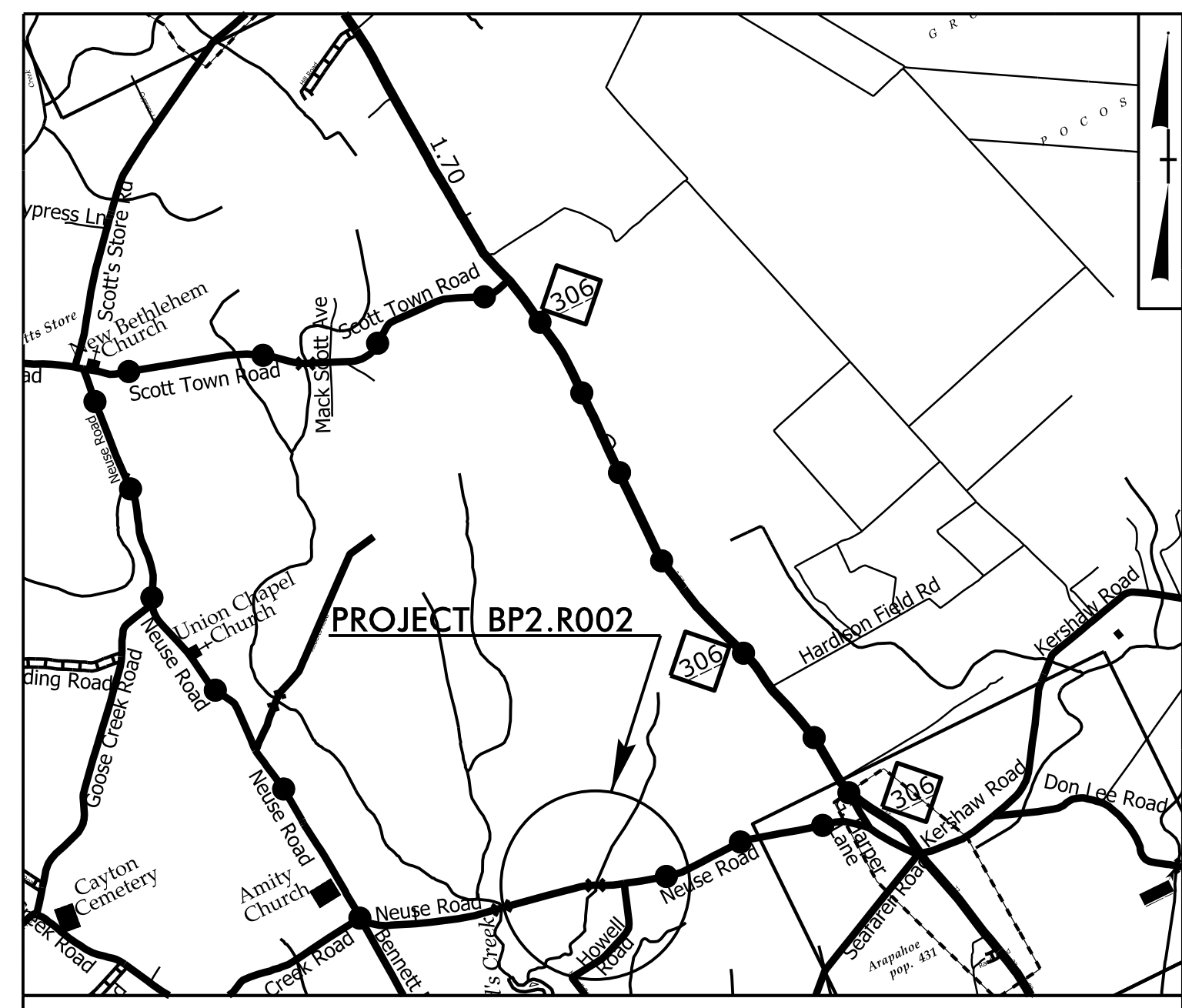

VICINITY MAP

● ● ● ● ● ● ● ● ● ●  
DETOUR ROUTE

**BUFFER IMPACTS PERMIT**  
**BUFFER DRAWING SHEET 1 OF 7**

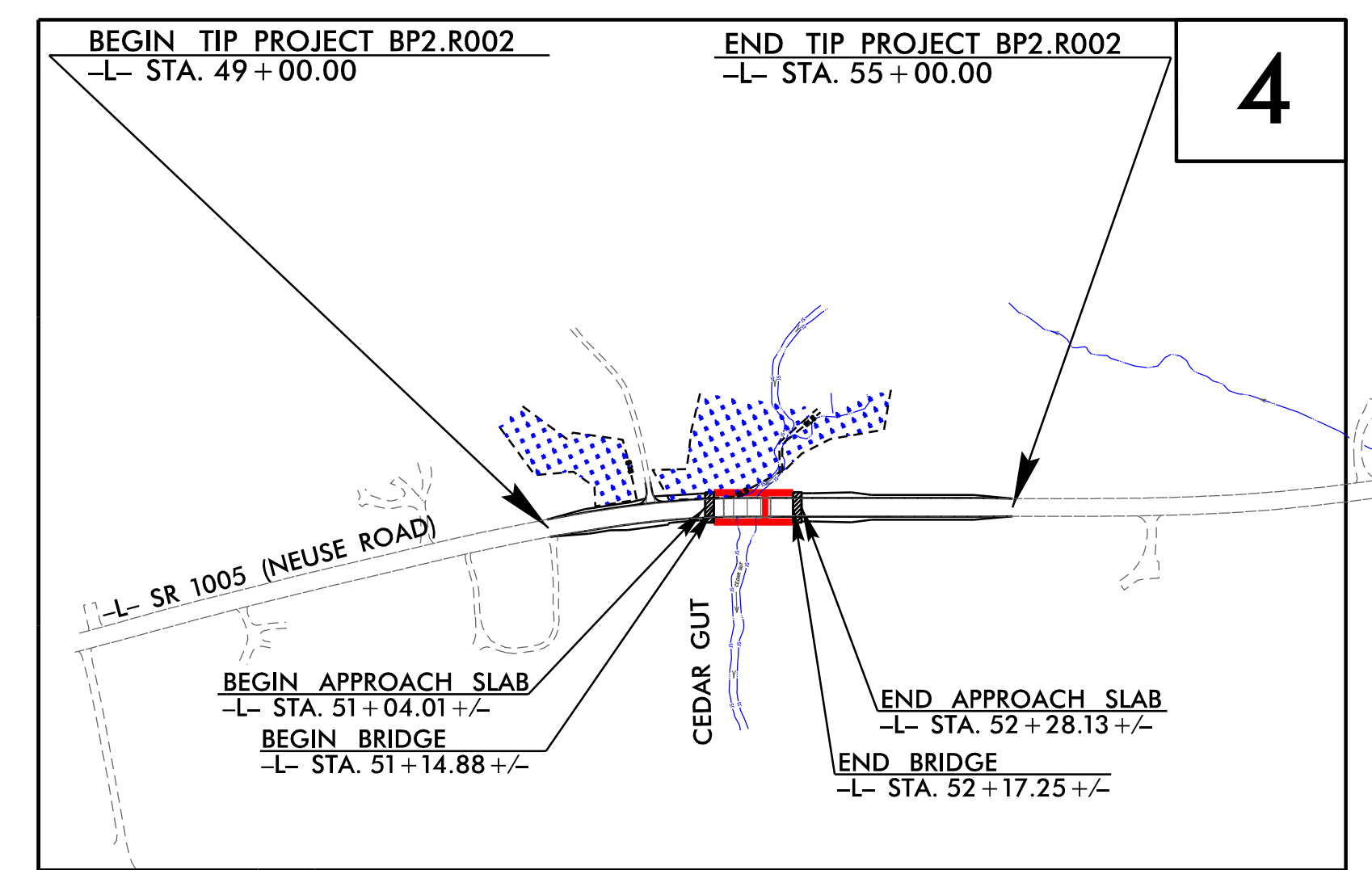
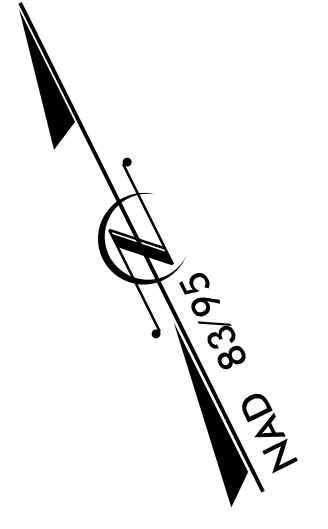

TO SR 1101  
(KENNELS BEACH ROAD)

TO NC 306

DESIGN EXCEPTION REQUIRED FOR SAG VERTICAL CURVE AND ASSOCIATED STOPPING SIGHT DISTANCE.  
THIS PROJECT IS NOT WITHIN ANY MUNICIPAL BOUNDARIES.  
CLEARING ON THIS PROJECT SHALL BE PERFORMED TO THE LIMITS ESTABLISHED BY METHOD II.

**INCOMPLETE PLANS**  
DO NOT USE FOR R/W ACQUISITION  
**DOCUMENT NOT CONSIDERED FINAL**  
UNLESS ALL SIGNATURES COMPLETED

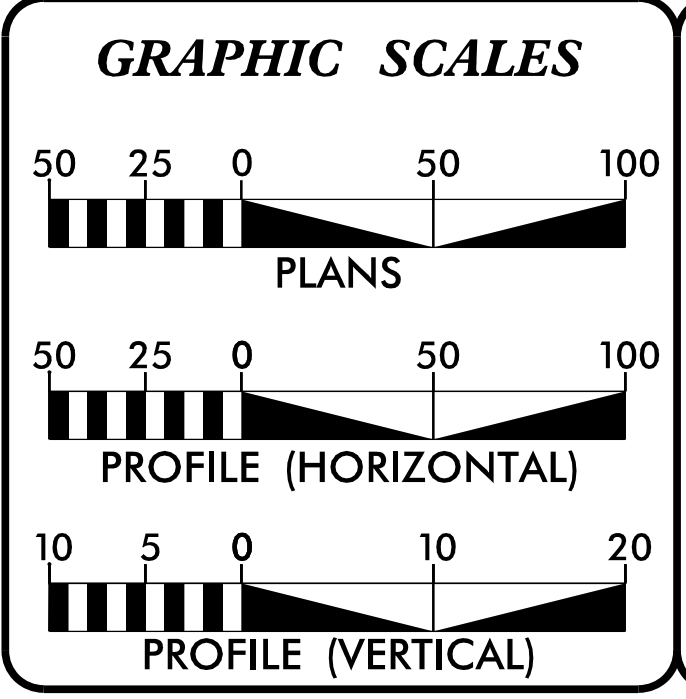

**DESIGN DATA**

ADT 2022 =	915
ADT 2040 =	1,600
K =	— %
D =	— %
T =	6 % *
V =	60 MPH
* TTST =	DUAL =
FUNC CLASS =	MINOR COLLECTOR
	"SUB-REGIONAL TIER"

**PROJECT LENGTH**

LENGTH ROADWAY TIP PROJECT BP2.R002 =	0.095 MILES
LENGTH STRUCTURE TIP PROJECT BP2.R002 =	0.019 MILES
TOTAL LENGTH TIP PROJECT BP2.R002 =	0.114 MILES

Prepared In the Office of:

**SEPI**  
A DIVISION OF TRANSYSTEMS

1 Glenwood Avenue  
Raleigh, NC 27603  
Tel: 919.789.9977  
Fax: 919.789.9591  
License: F-0463

2018 STANDARD SPECIFICATIONS

RIGHT OF WAY DATE:  
JUNE 21, 2022

LETTING DATE:  
FEBRUARY 22, 2023

RAJIT RAMKUMAR, PE  
PROJECT ENGINEER

DANIEL W. GARDNER, JR., PE  
PROJECT DESIGN ENGINEER

MICHAEL AMAN, PE  
NCDOT CONTACT

**HYDRAULICS ENGINEER**

SIGNATURE: \_\_\_\_\_ P.E.

**ROADWAY DESIGN ENGINEER**

SIGNATURE: \_\_\_\_\_ P.E.

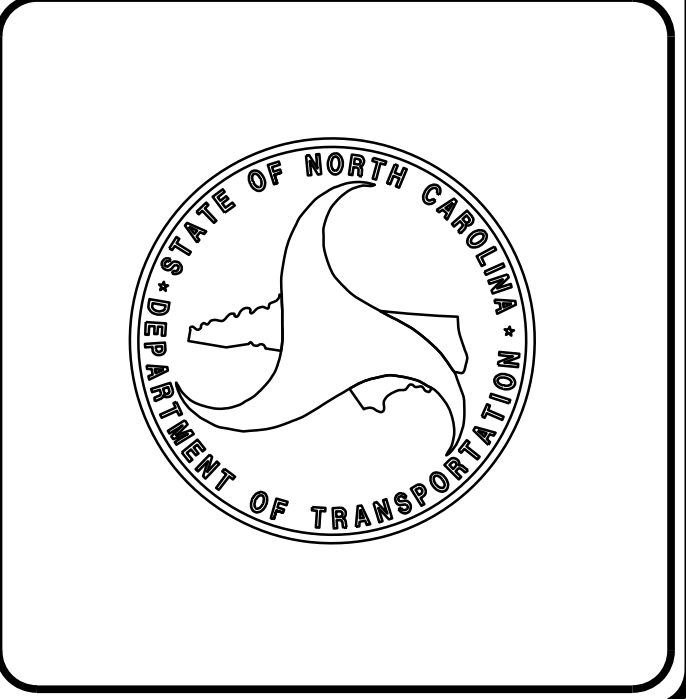

3/17/2022  
\\B-4596-Hyd-prm\_buf-t.sh.dgn  
USER:JTW

**CONTRACT:**



6/2/2023

5/11/2023 36\_Hyd\_prm\_buf\_psh4.dgn

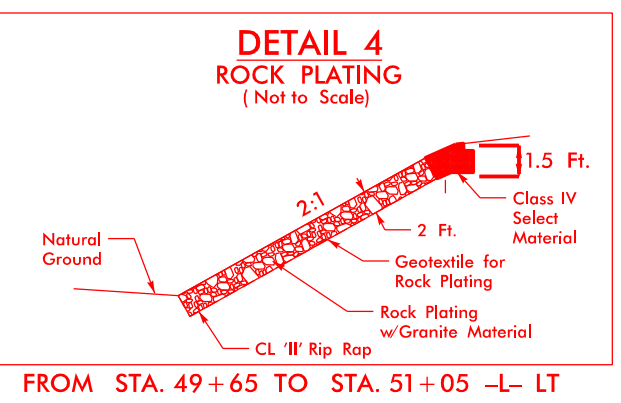

**DESIGN NOTE**  
TO REDUCE IMPACTS TO WETLANDS ADJACENT TO ROADWAY, FILL SLOPES BETWEEN STA. 49+65 AND 51+05 -L- LT ARE 2:1

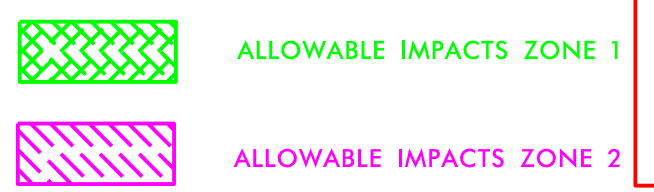

**PERMIT DRAWING  
SHEET 2 OF 7**



**SEPI**  
A Division of TranSystems

1 Glenwood Avenue  
Raleigh, NC 27603  
Tel: 919.789.9977  
Fax: 919.789.9561  
License: F-0453

PROJECT REFERENCE NO. <b>BP2.R002</b>	SHEET NO. <b>4</b>
ROADWAY DESIGN ENGINEER <i>[Signature]</i>	HYDRAULICS ENGINEER <i>[Signature]</i>
INCOMPLETE PLANS DO NOT USE FOR ACQUISITION 033871 ENGINEER W. WOODS	INCOMPLETE PLANS DO NOT USE FOR ACQUISITION 052573 ENGINEER D. WILKINS
<b>DOCUMENT NOT CONSIDERED FINAL UNLESS ALL SIGNATURES COMPLETED</b>	

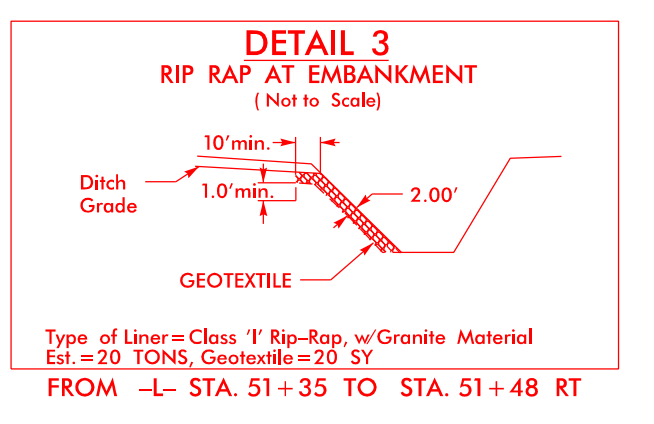
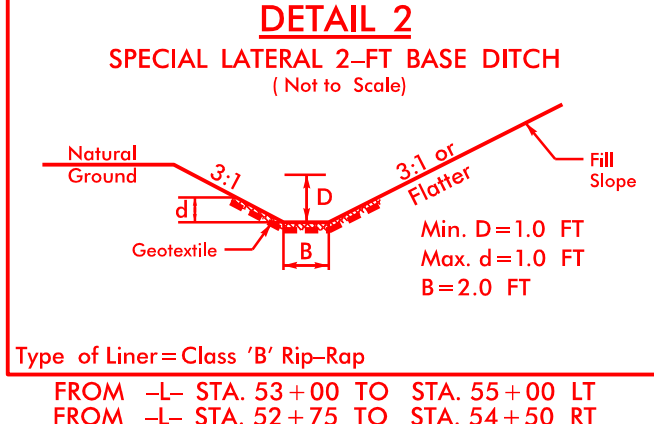
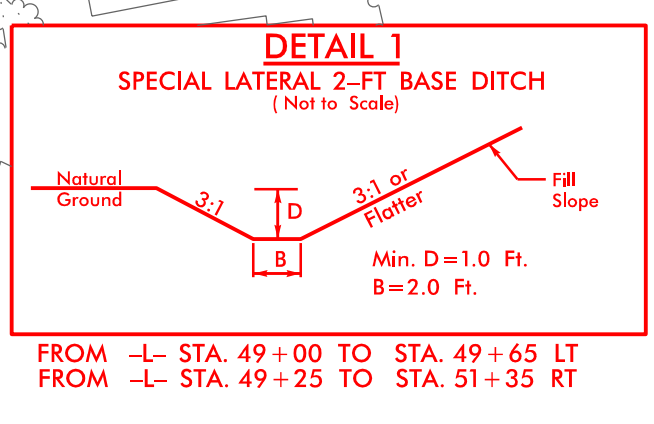
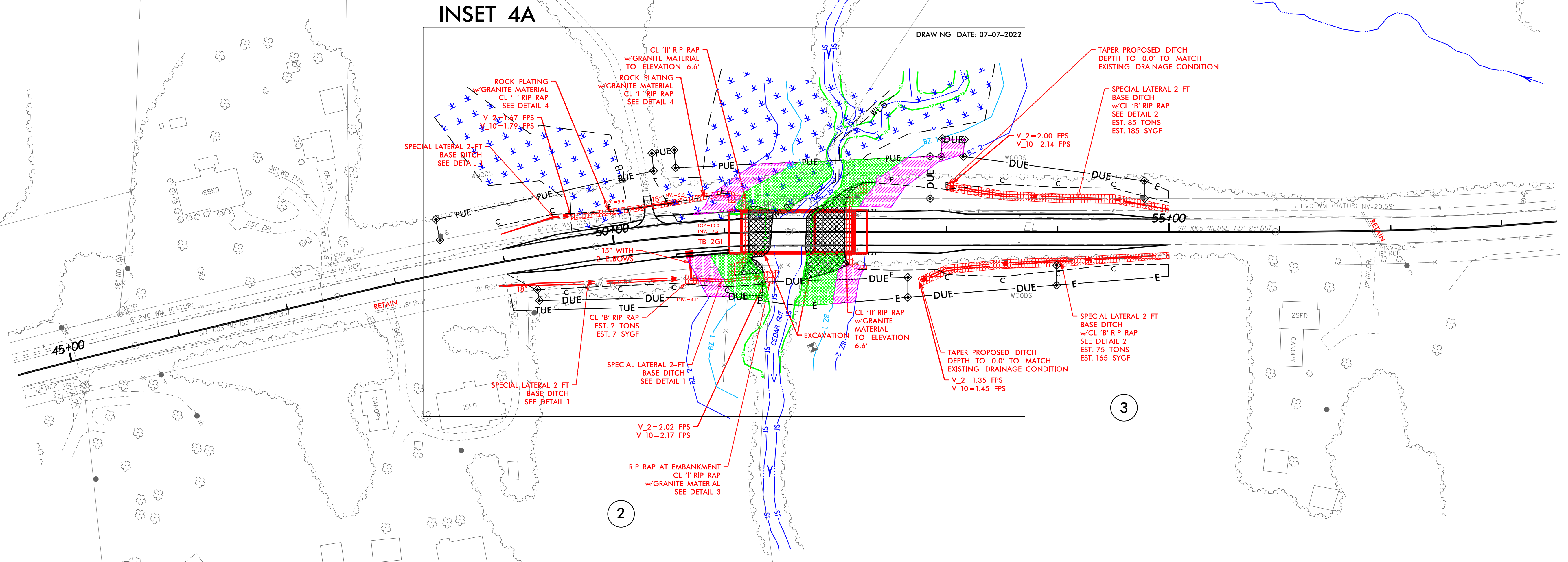
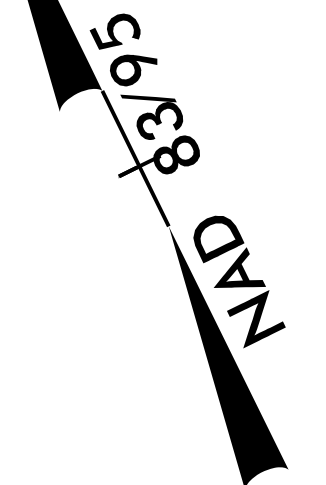

SEE SHEET 5 FOR -L- PROFILE  
SEE SHEETS S-1 THRU S-26 FOR STRUCTURE PLANS



6/2/2023

5/11/2023 6:36\_Hyd\_prm\_buf\_psh4\_contour.dgn

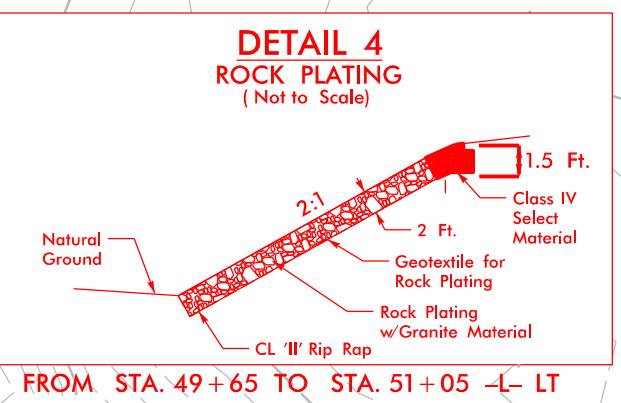

**DESIGN NOTE**  
TO REDUCE IMPACTS TO WETLANDS ADJACENT TO ROADWAY, FILL SLOPES BETWEEN STA. 49+65 AND 51+05 -L- LT ARE 2:1

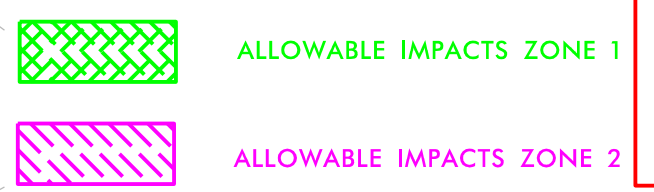

**PERMIT DRAWING  
SHEET 3 OF 7**



**SEPI**  
A Division of TranSystems

1 Glenwood Avenue  
Raleigh, NC 27603  
Tel: 919.789.9977  
Fax: 919.789.9591  
License: F-0453

PROJECT REFERENCE NO. <b>BP2.R002</b>	SHEET NO. <b>4</b>
ROADWAY DESIGN ENGINEER	HYDRAULICS ENGINEER
<i>(Signature)</i>	<i>(Signature)</i>
033871 ENGINEER	052573 ENGINEER
<b>DOCUMENT NOT CONSIDERED FINAL UNLESS ALL SIGNATURES COMPLETED</b>	

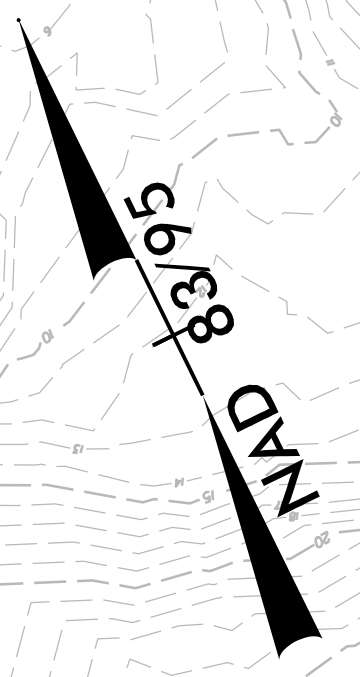

**INSET 4A**

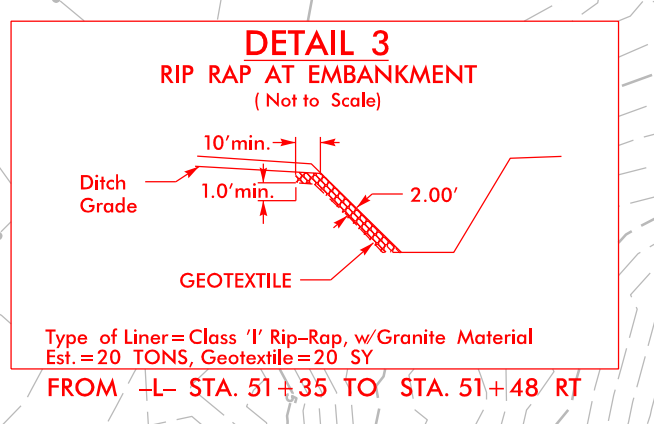
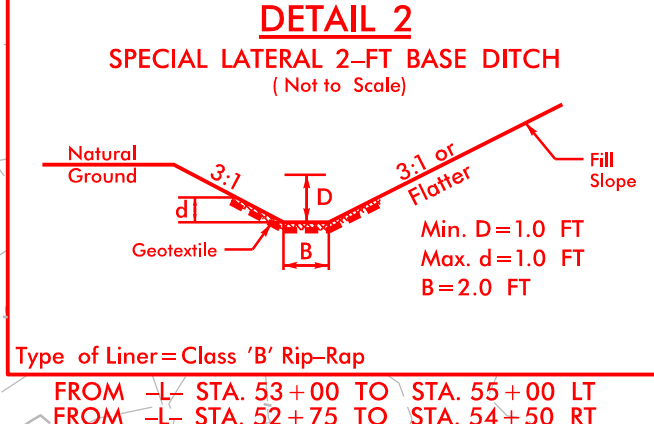
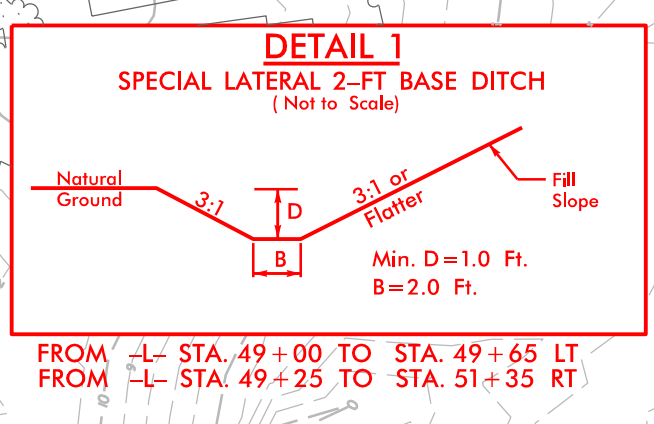
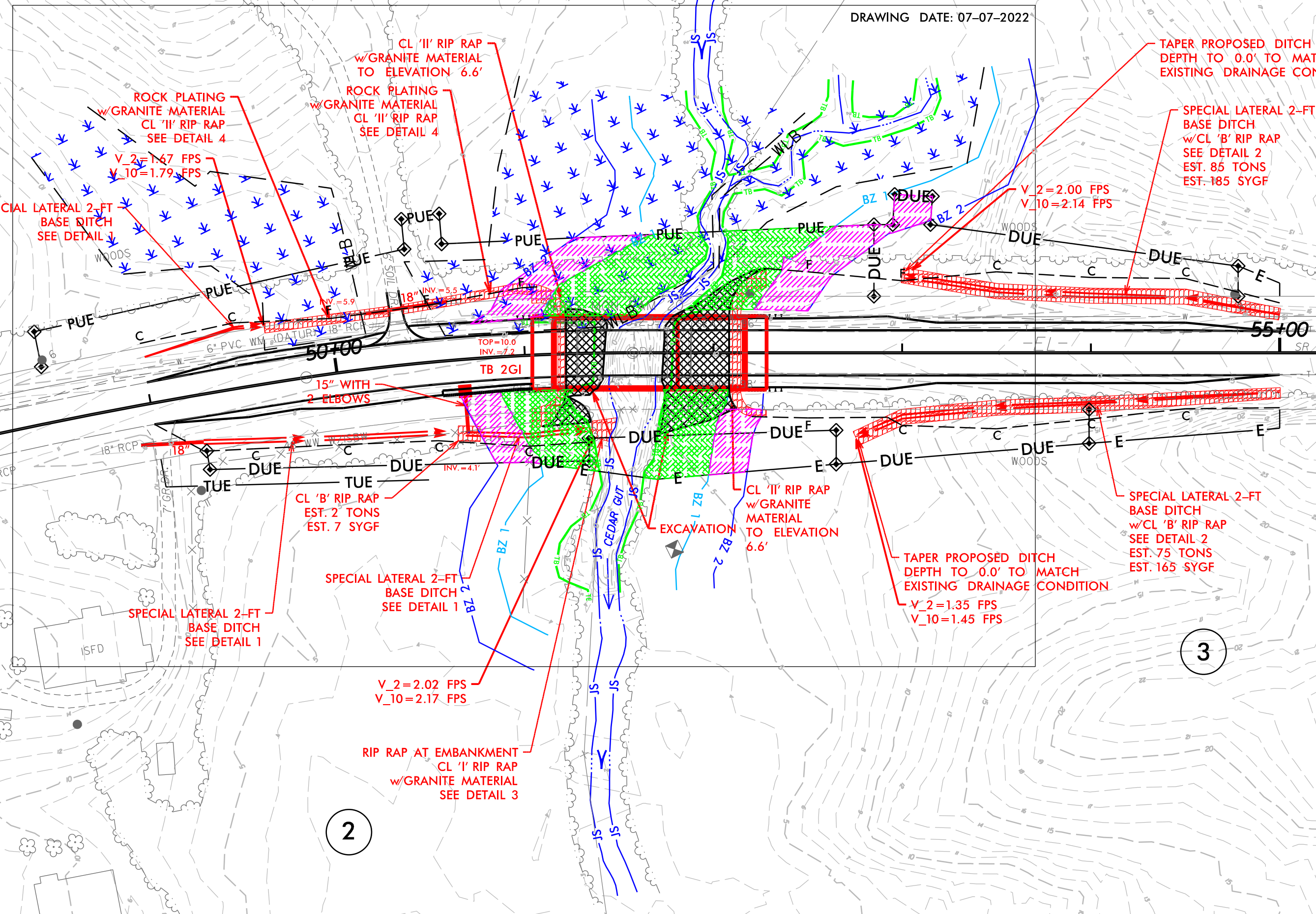

SEE SHEET 5 FOR -L- PROFILE  
SEE SHEETS S-1 THRU S-26 FOR STRUCTURE PLANS



6/2/2022

ALLOWABLE IMPACTS ZONE 1  
ALLOWABLE IMPACTS ZONE 2

# PERMIT DRAWING SHEET 4 OF 7

**SEPI**  
Engineering & Construction, Inc.  
1 Glenwood Avenue  
Raleigh, NC 27603  
Tel: 919.789.9977  
Fax: 919.789.9591  
License: C-2197

PROJECT REFERENCE NO. <b>BP2.R002</b>	SHEET NO. <b>4A</b>
ROADWAY DESIGN ENGINEER	PAVEMENT DESIGN ENGINEER
<b>INCOMPLETE PLANS</b> DO NOT USE FOR R/W ACQUISITION	
<b>DOCUMENT NOT CONSIDERED FINAL</b> UNLESS ALL SIGNATURES COMPLETED	

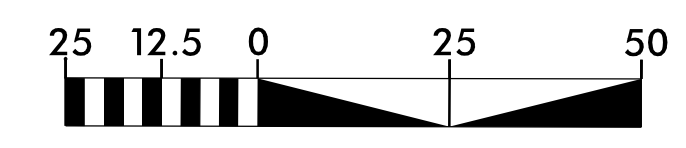

DRAWING DATE: 07-07-2022

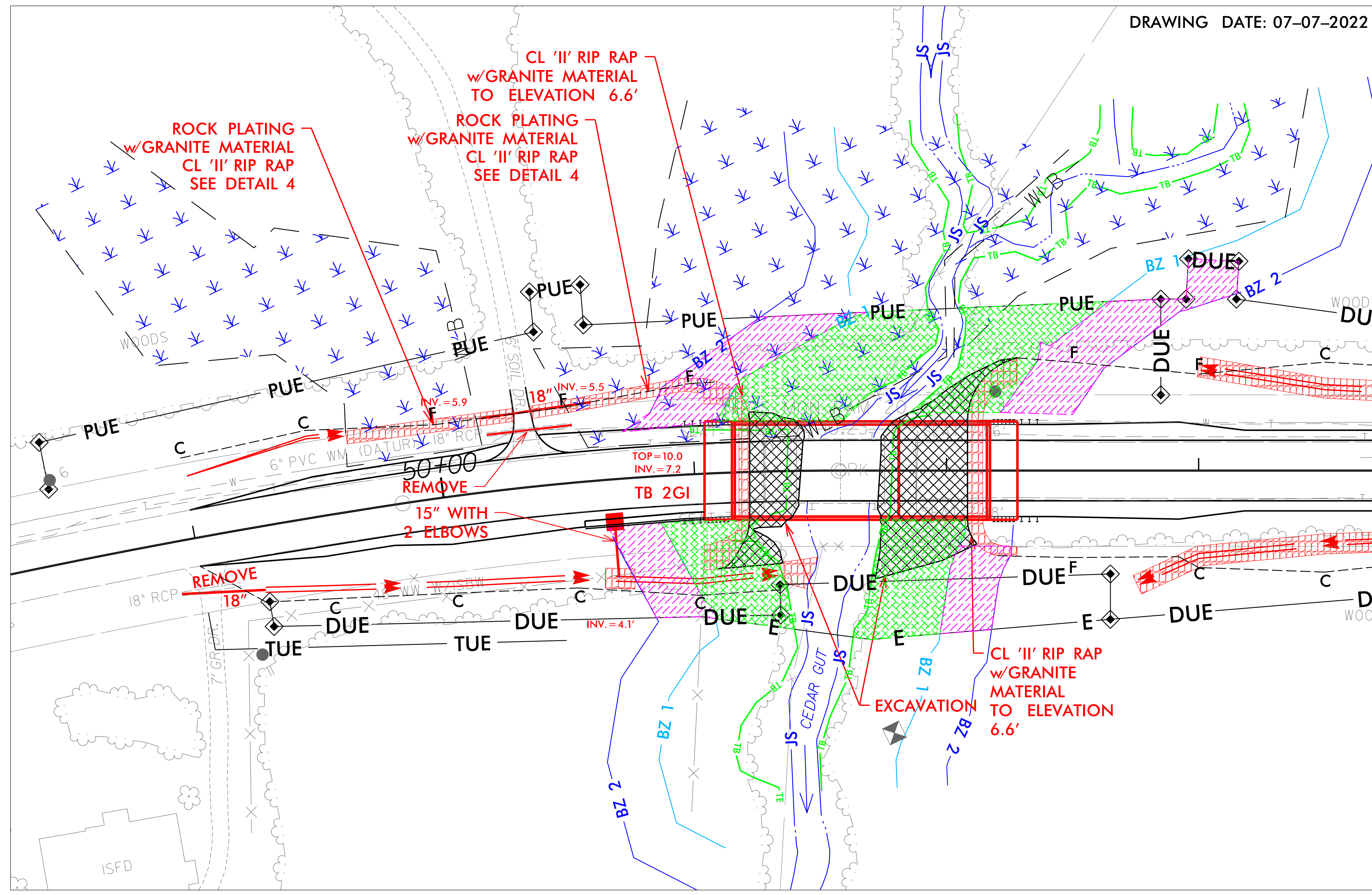

5/11/2023 5:46:36 PM 5/11/2023 5:46:36 PM 5/11/2023 5:46:36 PM  
5/11/2023 5:46:36 PM 5/11/2023 5:46:36 PM 5/11/2023 5:46:36 PM  
5/11/2023 5:46:36 PM 5/11/2023 5:46:36 PM 5/11/2023 5:46:36 PM



6/2/2022

5/11/2023 6:14:36 - Hyd\_prm\_buf\_psh44\_contours.dgn

ALLOWABLE IMPACTS ZONE 1  
ALLOWABLE IMPACTS ZONE 2

# PERMIT DRAWING SHEET 5 OF 7

**SEPI**  
Engineering & Construction, Inc.  
1 Glenwood Avenue  
Raleigh, NC 27603  
Tel: 919.789.9977  
Fax: 919.789.9591  
License: C-2197

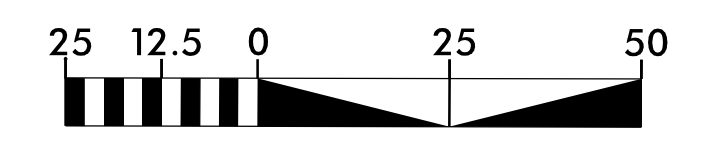

PROJECT REFERENCE NO. <b>BP2.R002</b>	SHEET NO. <b>4A</b>
ROADWAY DESIGN ENGINEER	PAVEMENT DESIGN ENGINEER
<b>INCOMPLETE PLANS</b> DO NOT USE FOR R/W ACQUISITION	
<b>DOCUMENT NOT CONSIDERED FINAL</b> UNLESS ALL SIGNATURES COMPLETED	

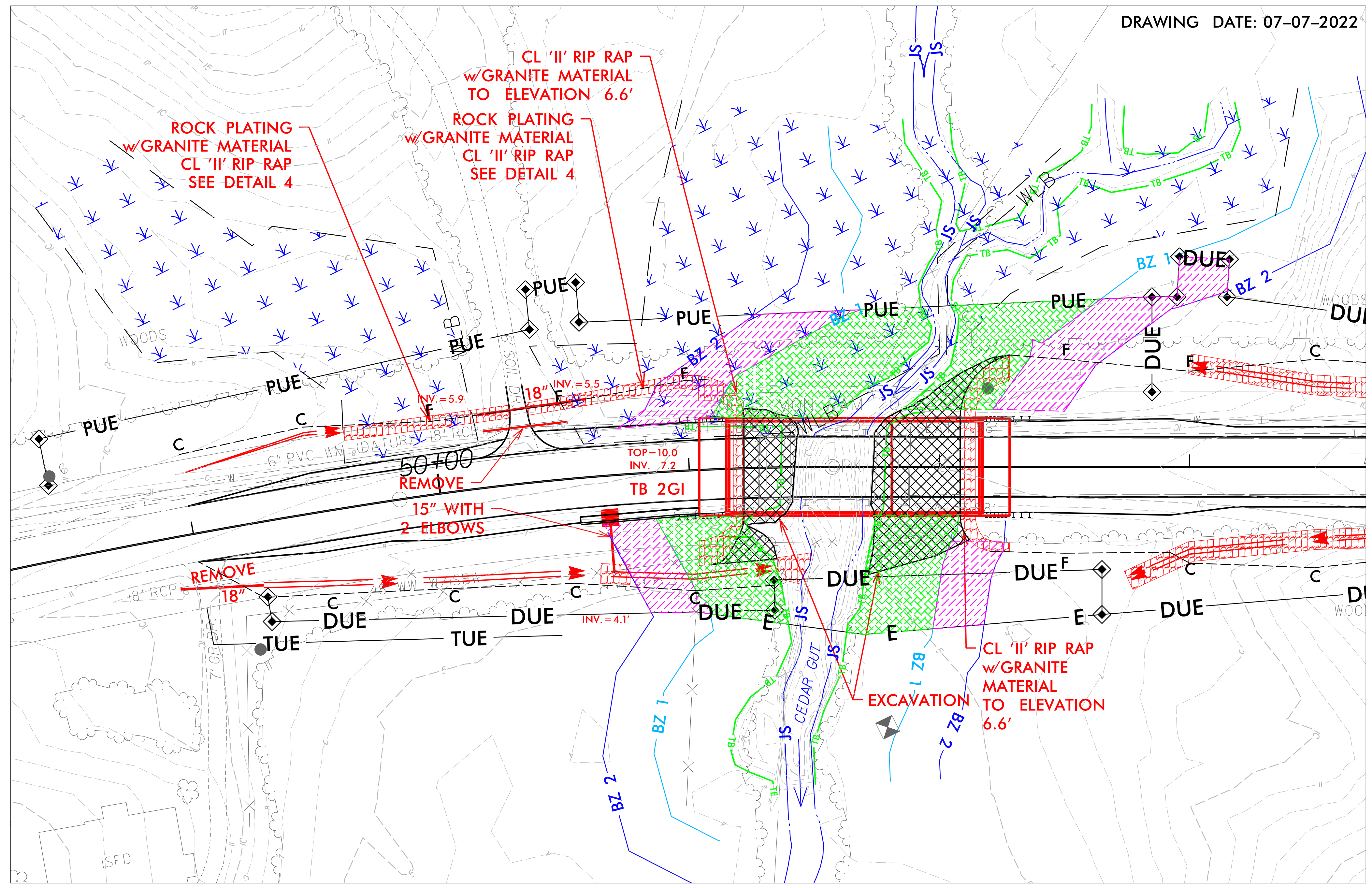

DRAWING DATE: 07-07-2022

**RIPARIAN BUFFER IMPACTS SUMMARY**

Site No.	Station (From/To)	Structure Size / Type	IMPACTS									BUFFER REPLACEMENT	
			TYPE			ALLOWABLE			MITIGABLE			ZONE 1 (ft <sup>2</sup> )	ZONE 2 (ft <sup>2</sup> )
			ROAD CROSSING	BRIDGE	PARALLEL IMPACT	ZONE 1 (ft <sup>2</sup> )	ZONE 2 (ft <sup>2</sup> )	TOTAL (ft <sup>2</sup> )	ZONE 1 (ft <sup>2</sup> )	ZONE 2 (ft <sup>2</sup> )	TOTAL (ft <sup>2</sup> )		
1	50+73/51+44	Roadway Fill & Toe Protection	X				1358	1358					
1	51+10/51+97	Bridge Construction		X		2223		2223					
1	52+22/52+80	Roadway Fill	X				1742	1742					
1	51+85/52+48	Bridge Construction		X		1568		1568					
1	50+64/51+06	Roadway Fill & Ditch	X				829	829					
1	50+86/51+39	Bridge Construction & Ditch		X		1416		1416					
1	51+97/52+26	Roadway Fill	X				703	703					
1	51+62/52+08	Bridge Construction		X		1473		1473					
<b>TOTALS*:</b>						<b>6680</b>	<b>4632</b>	<b>11312</b>	<b>0</b>	<b>0</b>	<b>0</b>	<b>0</b>	<b>0</b>

NOTES:

NC DEPARTMENT OF TRANSPORTATION  
 DIVISION OF HIGHWAYS  
 5/11/2023  
 Pamlico County  
 SF-680028  
 BP2.R002  
 SHEET 6 OF 7

Revised 2018 Feb

**WETLANDS IN BUFFER IMPACTS SUMMARY**

SITE NO.	STATION (FROM/TO)		WETLANDS IN BUFFERS	
			ZONE 1 (ft <sup>2</sup> )	ZONE 2 (ft <sup>2</sup> )
1	50+73/52+14	-L- LT	1804	911
<b>TOTAL:</b>			<b>1804</b>	<b>911</b>

NC DEPARTMENT OF TRANSPORTATION  
 DIVISION OF HIGHWAYS  
 5/11/2023  
 Pamlico County  
 SF-680028  
 BP2.R002  
 SHEET 7 OF 7

Revised 2018 Feb