

HIGHWAY LANDSCAPE DEVELOPMENT PROJECT

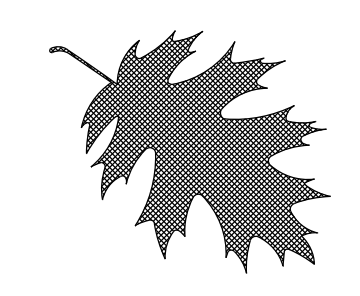

T.I.P. #	STATE PROJECT W.B.S. #	SHEET #	SHEET # TOTAL
R-2633BA(L)	34491.3.24	L 1	5
FED. PROJ. #	DESCRIPTION		DIVISION
-	LANDSCAPE		3

PROJECT: R-2633 BA(L), US 17 IN NAVASSA, NC

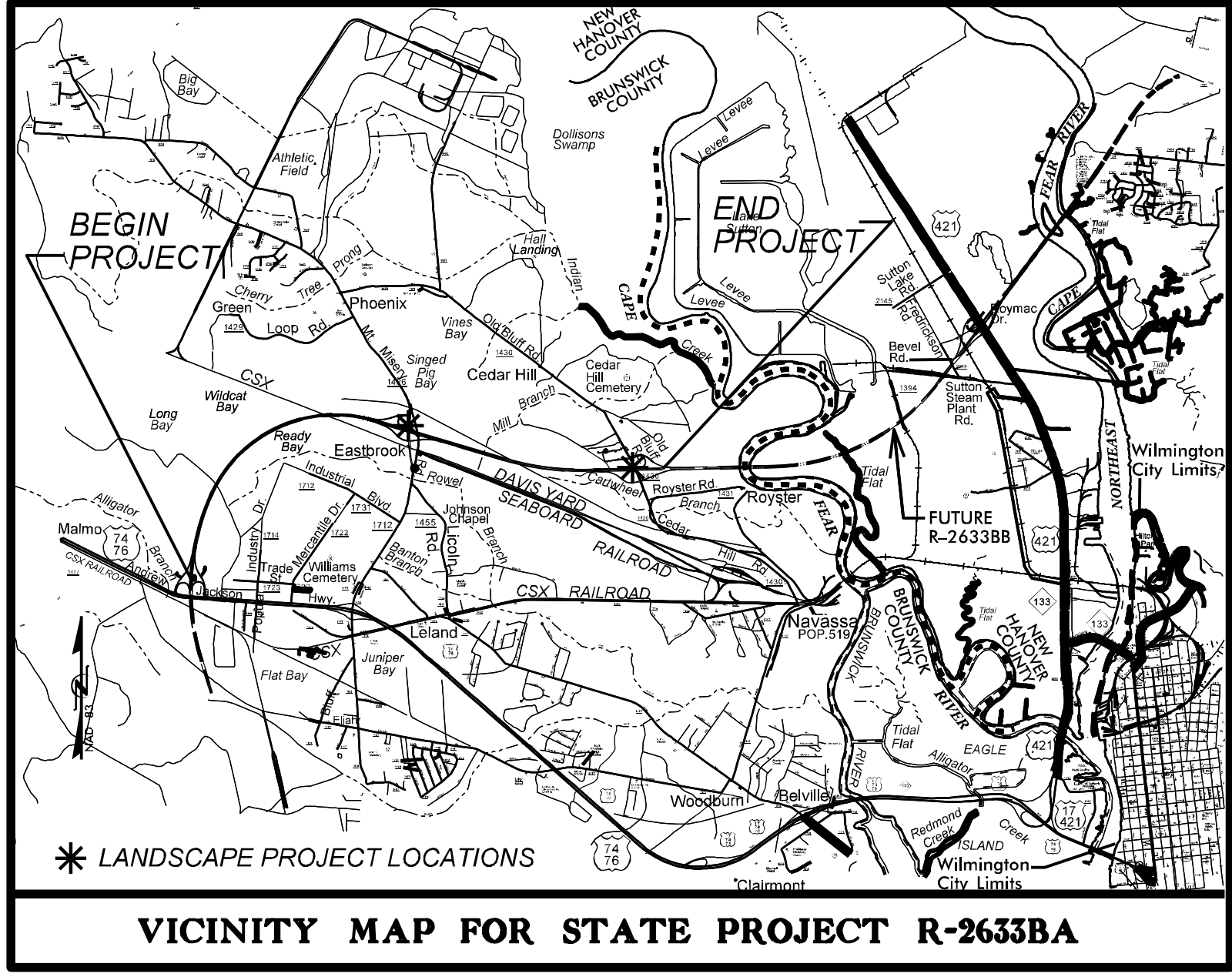

BRUNSWICK COUNTY LANDSCAPE ENHANCEMENT

LOCATION: US 17 (WILMINGTON BYPASS) FROM US 74-76 EAST OF MALMO TO SR 1430 (CEDAR HILL ROAD)
 TYPE OF WORK: LANDSCAPE PLANTING & CONSTRUCTION (AT CEDAR RD AND MT. MISERY RD.)

CONVENTIONAL SYMBOLS

County Line.....	- - - - -
City or Town Line.....	- - - - -
Exist. Right of Way Line Marker.....	- - - - -
Prop. Right of Way Line Marker (By Others).....	- - - - -
Prop Right of Way Line Marker (By Contract).....	- - - - -
Exist. Control of Access Line.....	- - - - -
Prop. Control of Access Line.....	- - - - -
Property Line.....	- - - - -
Easement Line.....	- - - - -
Slope Stake Line.....	- - - - -
Exist. Fence.....	- - - - -
Prop. Woven Wire Fence.....	- - - - -
Prop. Chain Link Fence.....	- - - - -
Exist. Road.....	- - - - -
Prop. Road.....	- - - - -
Guardrail.....	- - - - -
Survey Line.....	- - - - -
Denotes Line Equality.....	- - - - -
Bridge.....	- - - - -
Culvert.....	- - - - -
Railroad.....	- - - - -
Woods.....	- - - - -
Exist. Telephone Pole.....	- - - - -
Prop. Telephone Pole.....	- - - - -
Tower Pole and Line.....	- - - - -
Exist. Power Pole.....	- - - - -
Prop. Power Pole.....	- - - - -
Sanitary Sewer Line.....	- - - - -
Water Line.....	- - - - -
Gas Line.....	- - - - -
Picnic Shelter.....	- - - - -
Regeneration.....	- - - - -
Reforestation.....	- - - - -

SUMMARY OF QUANTITIES

Qty.	Unit	Botanical Name/ Item Description	Common Name	Size	Caliper	Furnish	Remarks
51	EA	Quercus palustris	Pin Oak	10-12'	Min. 1 1/2"	B&B	40' O.C.
13	EA	Viburnum awaki 'Chindo'	Chindo viburnum	24-36"		#7 Cont	full
50	CY	Mulch for Planting					
15	M/G	Water for Planting					
1	EA	Sign Structure A*	Stone				
1	EA	Sign Structure B*	Wood				
1	LS	Mobilization					

* Sign Provided by NCDOT (contractor is responsible for installation)

INDEX OF L SHEETS:

L1	TITLE, DESCRIPTION, LOCATION
L2	PLANTING DETAILS
L3	CEDAR HILL LANDSCAPE PLAN
L4	MT. MISERY LANDSCAPE PLAN
L5	SIGN DETAILS

PREPARED BY: BK DATE: 5/2020

REVISIONS

DATE	DESCRIPTION
9-28-20	FINISH PLANS & DETAILS
3-4-21	FINAL CHECK & REVISIONS
3-4-21	REPLACE STREET TREES

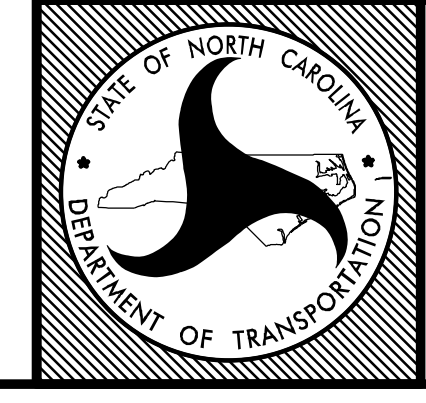

STATE OF
NORTH CAROLINA
DEPARTMENT OF TRANSPORTATION

LOCATION:	US 17, NAVASSA NC
TYPE OF WORK:	LANDSCAPE DEVELOPMENT
COUNTY:	BRUNSWICK COUNTY

2014 American Standard for Nursery Stock
 2018 NCDOT STANDARD SPECIFICATIONS
 PREPARED IN THE OFFICE OF:
 NCDOT- ROADSIDE ENVIRONMENTAL UNIT
 LANDSCAPE DESIGN & DEVELOPMENT SECTION
 1557 MAIL SERVICE CENTER
 RALEIGH NC 27699 919-707-2920

*****TIMES*****
*****DGN*****
*****USERNAMES*****

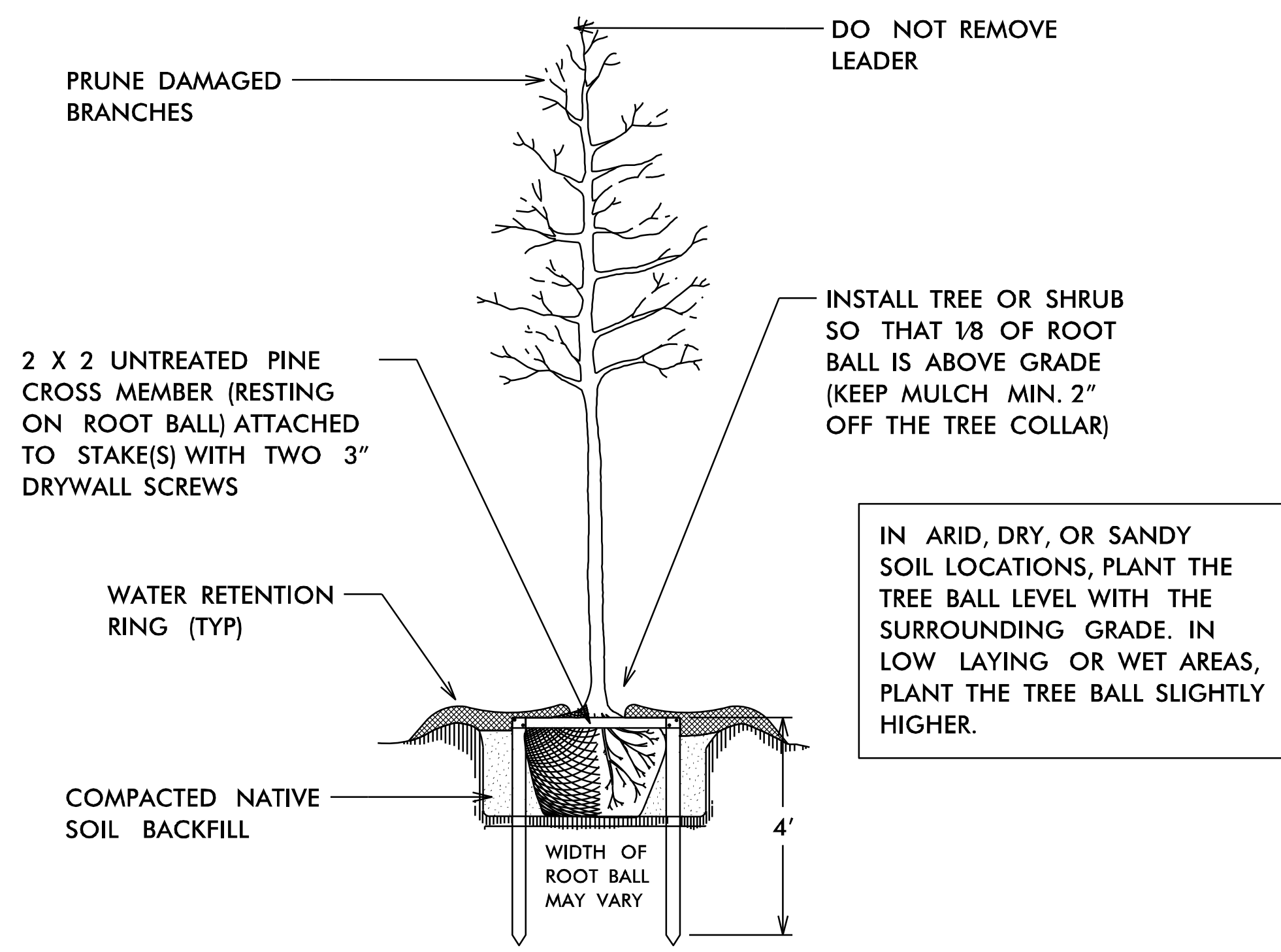

IN ARID, DRY, OR SANDY SOIL LOCATIONS, PLANT THE TREE BALL LEVEL WITH THE SURROUNDING GRADE. IN LOW LAYING OR WET AREAS, PLANT THE TREE BALL SLIGHTLY HIGHER.

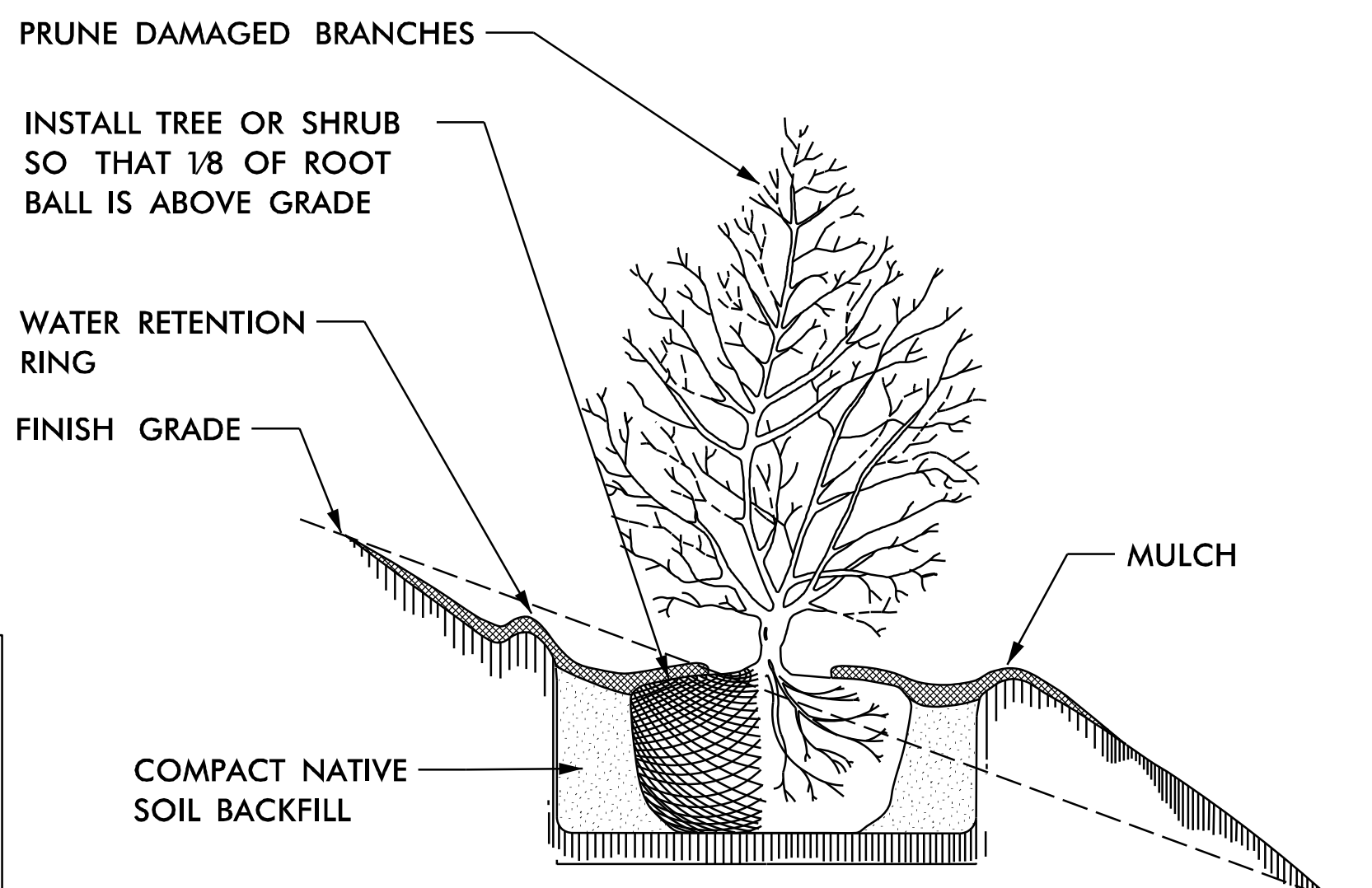

TREE OR SHRUB PLANTING DETAIL (SLOPING GROUND)

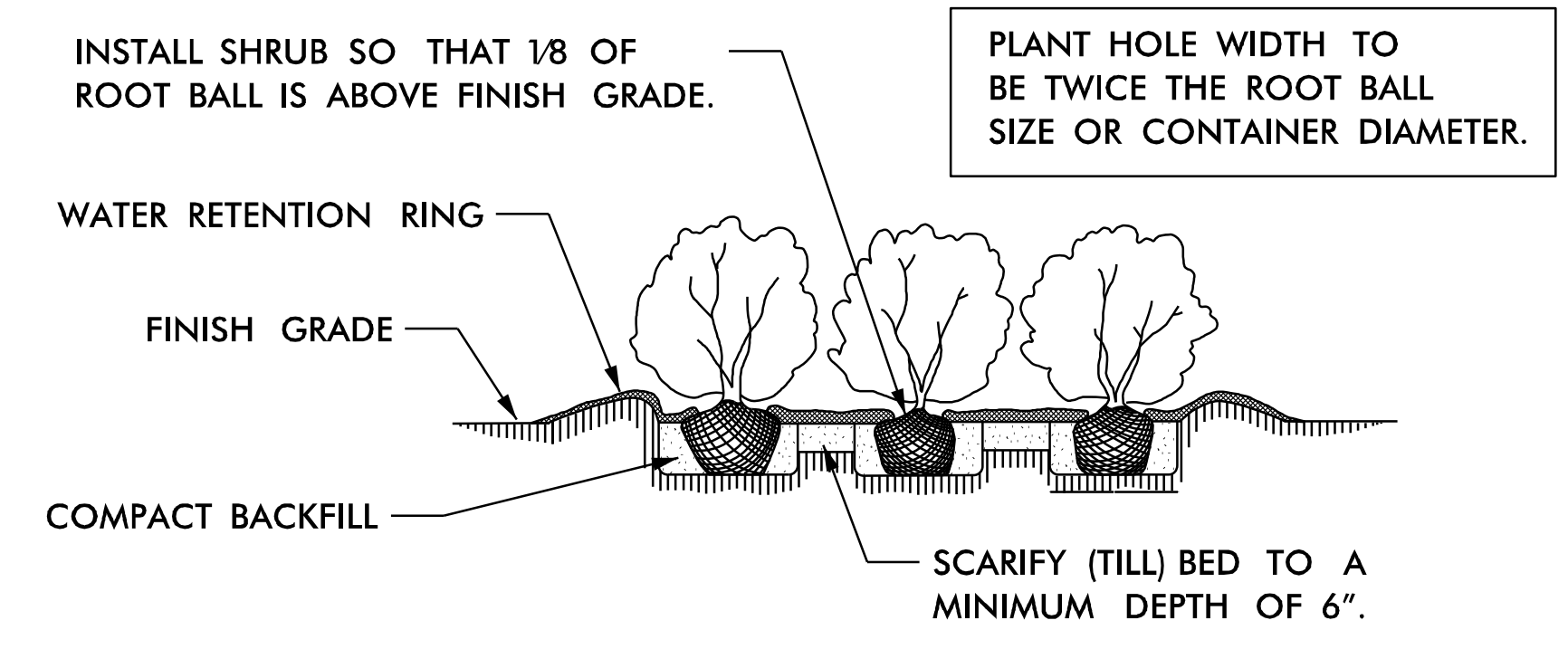

SHRUB BED PLANTING DETAIL

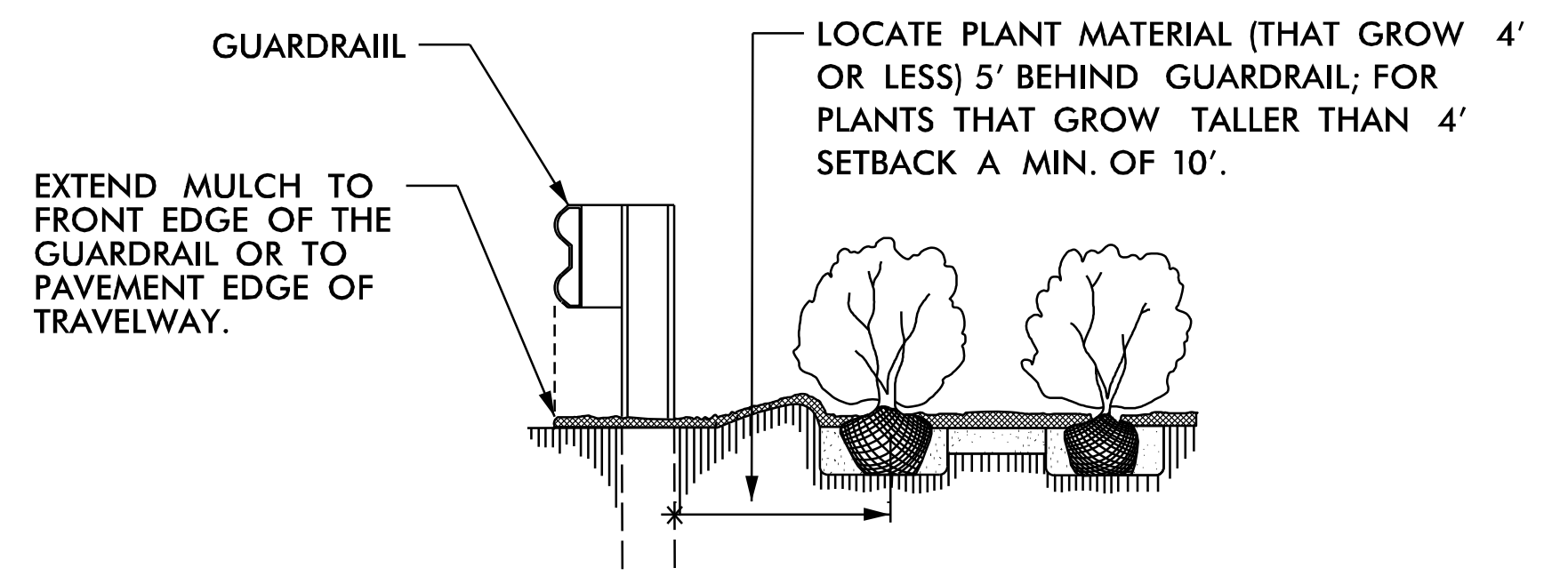

GUARDRAIL MULCHING DETAIL
USE AS DIRECTED BY FIELD ENGINEER

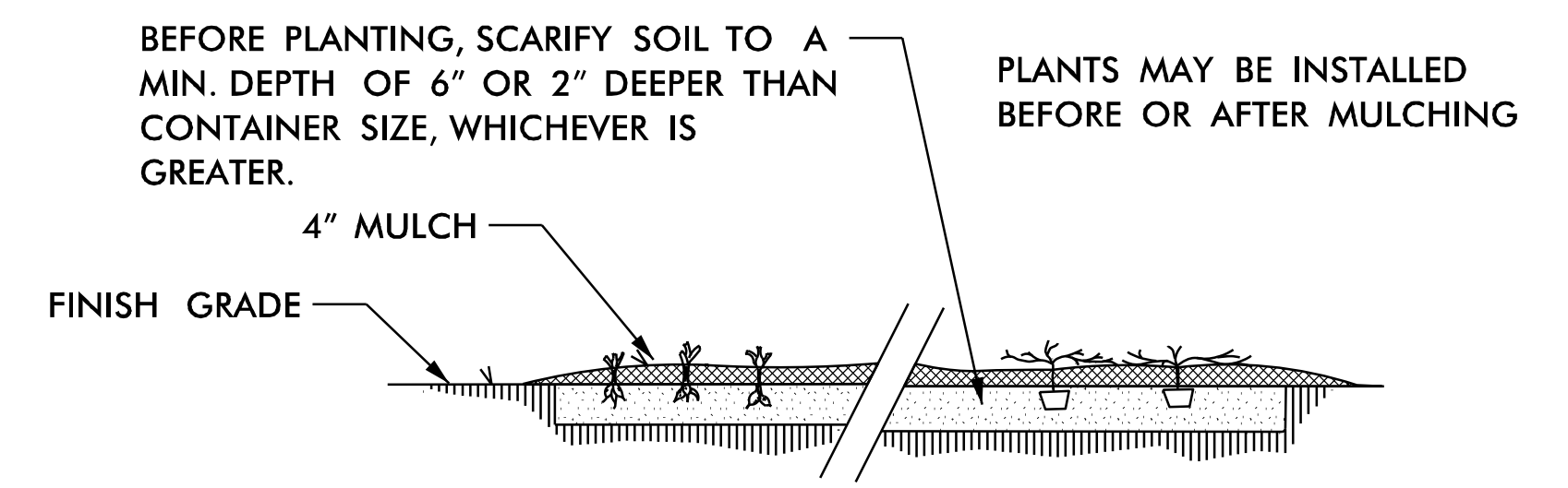

GROUND COVER/BEDDING PLANT DETAIL

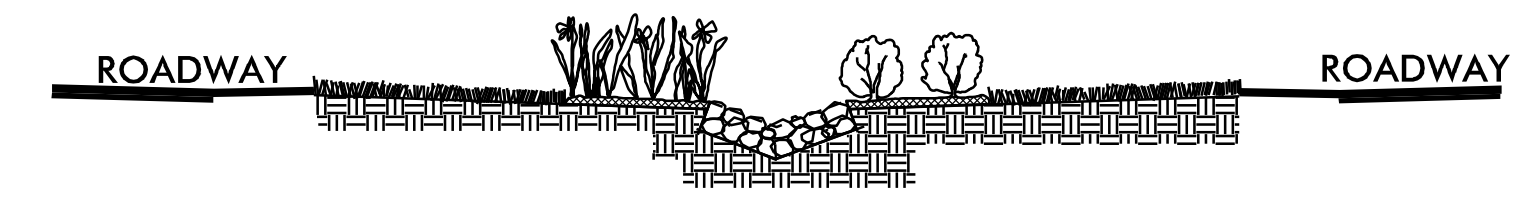

MIN. 12" DEEP CLASS "A" STONE ON FILTER FABRIC LINER IN DITCH. PLACE STONE FLUSH WITH DITCH GRADE FOR MAXIMUM WATER FLOW.

CLASS "A" STONE DITCH LINING DETAIL

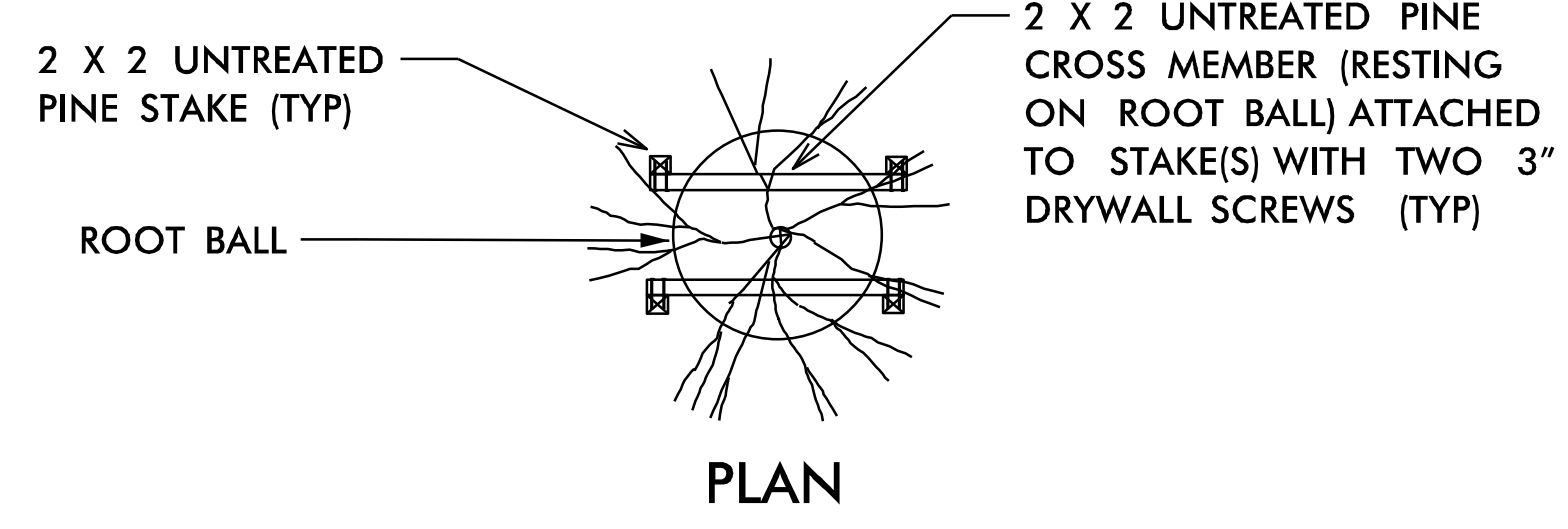

TREE PLANTING & ROOT BALL STAKING DETAIL (STAKE TREES 8' OR TALLER)

NOTES:

- PLANT HOLE WIDTH TO BE TWICE THE ROOT BALL SIZE OR CONTAINER DIAMETER.
- APPLY HERBICIDES A MIN. OF 7 DAYS PRIOR TO PLANTING, BY LABEL INSTRUCTIONS, OR AS DIRECTED BY THE NCDOT ENGINEER.
- APPLY FERTILIZER AT PLANTING TIME IN THE FORM OF A SLOW RELEASE PELLET OR TABLET. APPLY AT RATE RECOMMENDED BY MANUFACTURER. BOTH RATE AND FORMULATION MUST BE APPROVED BY FIELD ENGINEER PRIOR TO APPLICATION.
- ALL PRUNING TO FOLLOW STANDARD ARBORICULTURAL PRACTICES AS SPECIFIED BY INTERNATIONAL SOCIETY OF ARBORICULTURE.
- DO NOT ATTEMPT TO STRAIGHTEN A TREE THAT HAS BEEN PLANTED AT AN ANGLE WITH THE USE OF STAKING OR GUYING. DIG TREE AND REPLANT TO UPRIGHT POSITION.

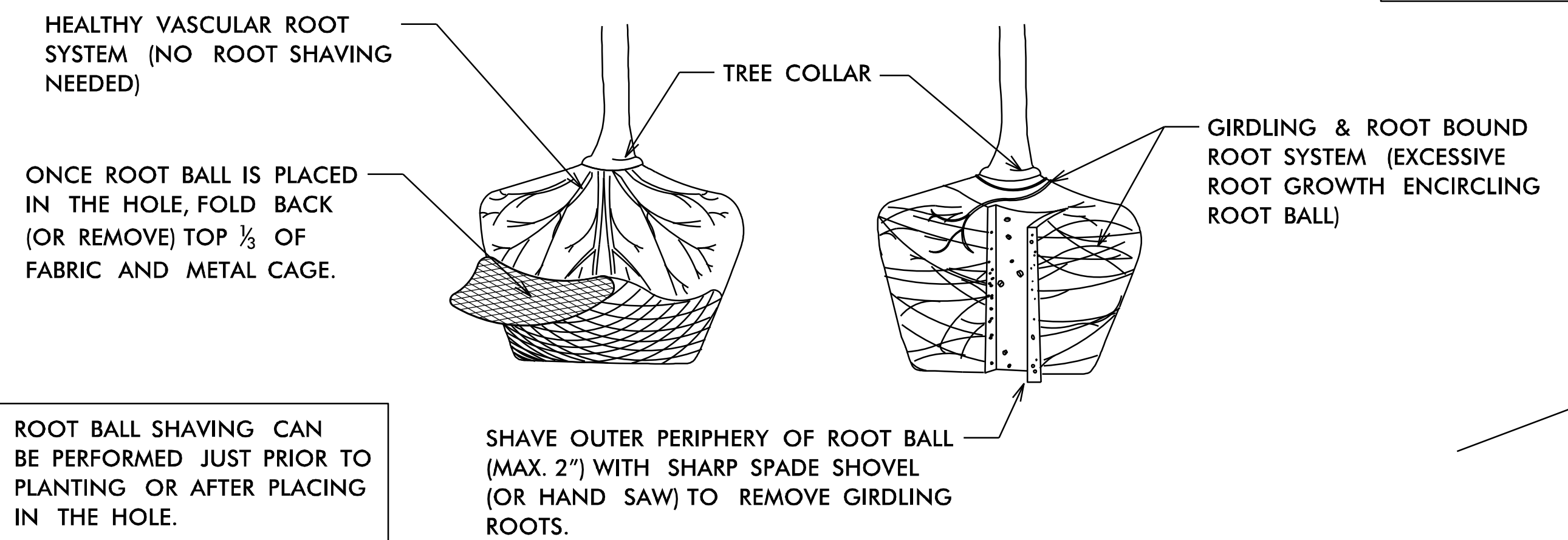

TREE PLANTING INSTRUCTIONS (FOR CONTAINER OR BALLED & BURLAPPED TREES)

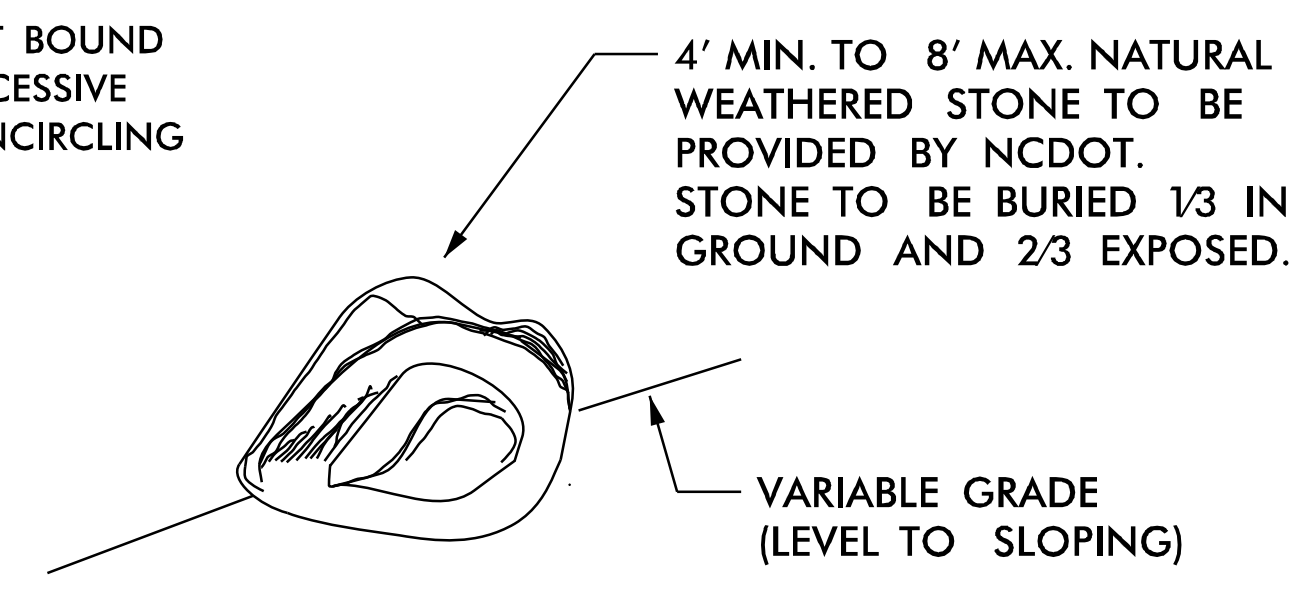

BOULDER PLACEMENT DETAIL TYPICAL

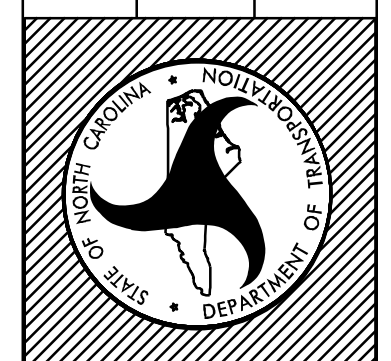

Plans Drawn By:	BK
Scale:	
Date:	9 / 13 / 2019
Sheet Description:	Planting Details
T.I.P. #:	R-2633BA (L)
Sheet #:	12

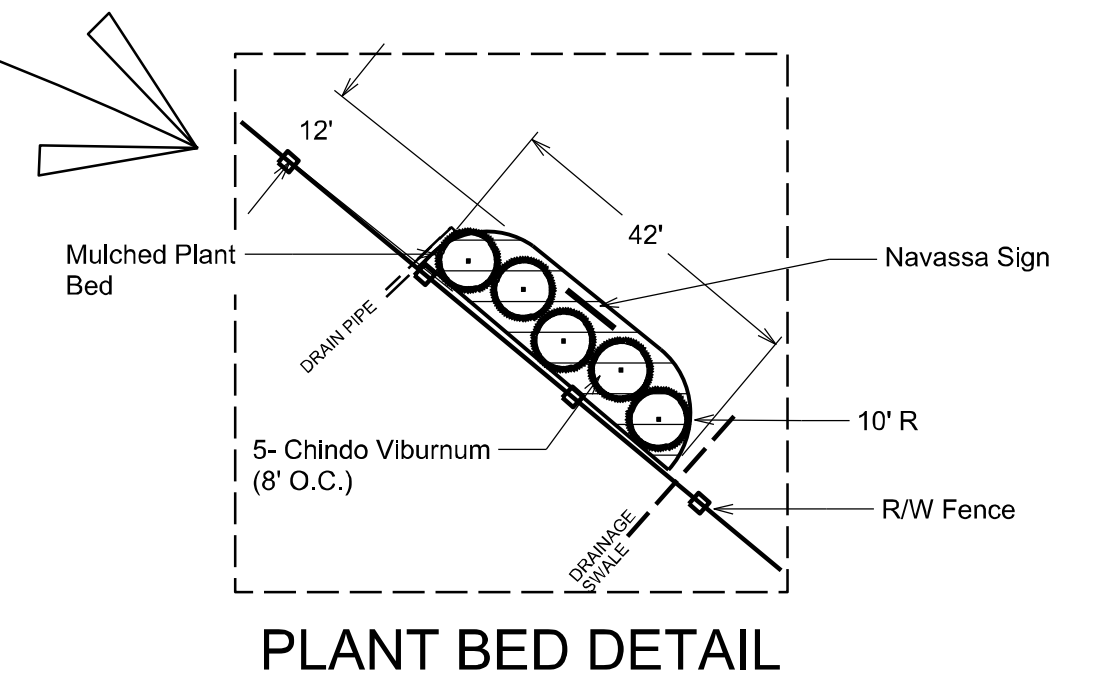
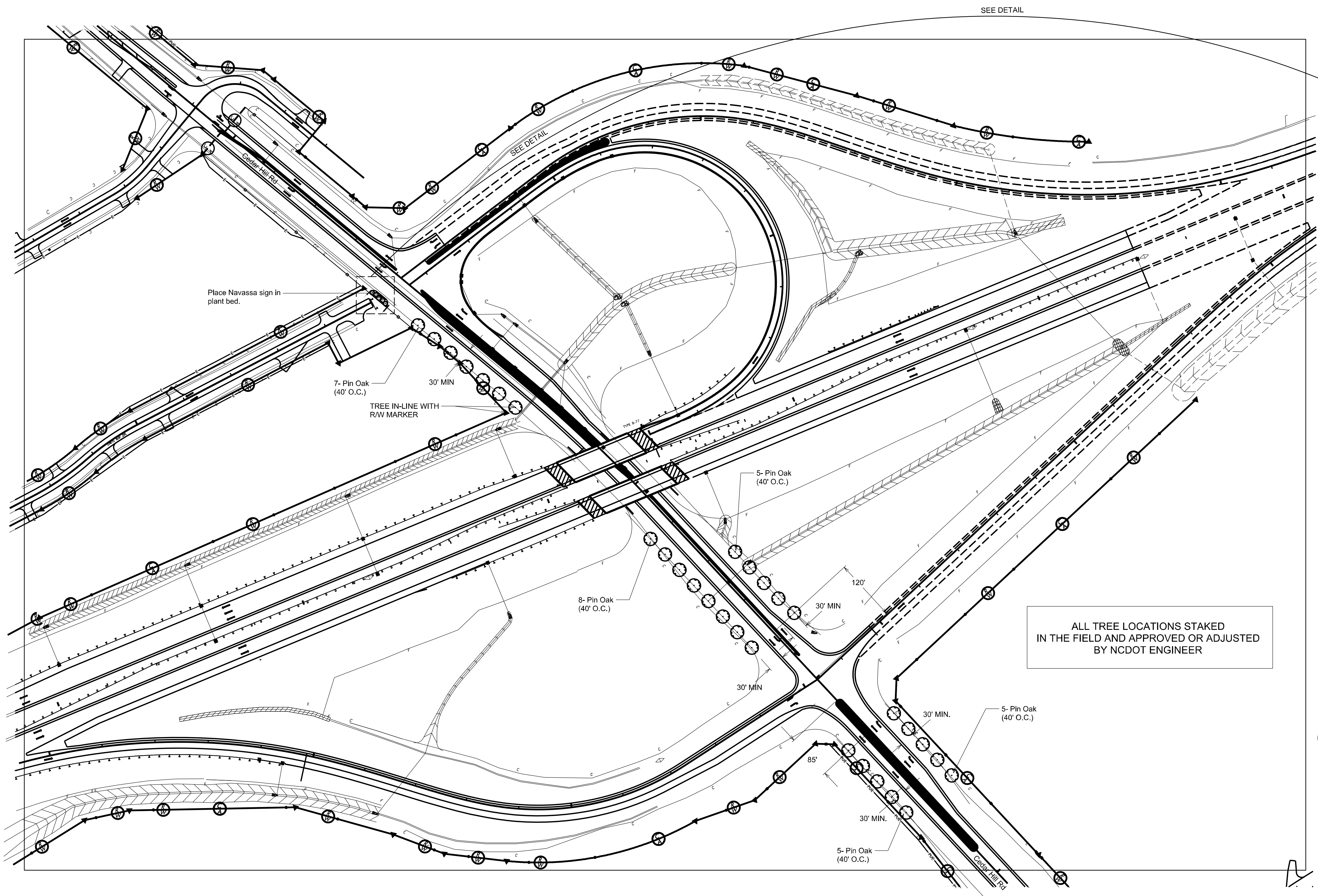

ALL TREE LOCATIONS STAKED IN THE FIELD AND APPROVED OR ADJUSTED BY NCDOT ENGINEER

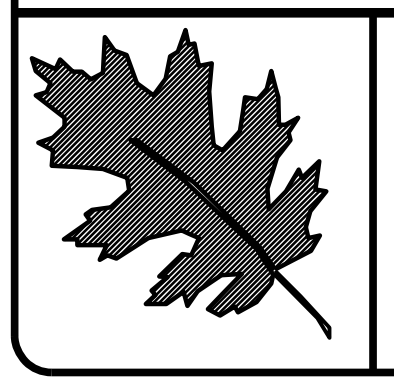
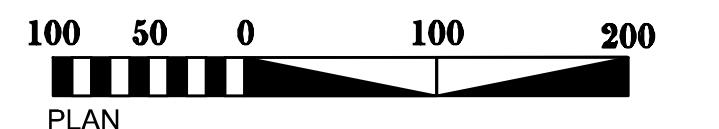

NCDOT - Roadside Environmental Unit
 Aesthetic Engineering Section
 1557 Mail Service Center Raleigh NC 27699-1557
 ph: 919-707-2920 fax: 919-715-2554
<https://www.ncdot.gov/initiatives-policies/environmental/roadside-beautification>

R-2633BA / US 17
 Landscape Development Plan
 Navassa NC

RN Kobetsky

prel. design date :	May/2020
checked by & date :	
final design date :	

Landscape Enhancement
Plan
Cedar Hill Road @ US 17

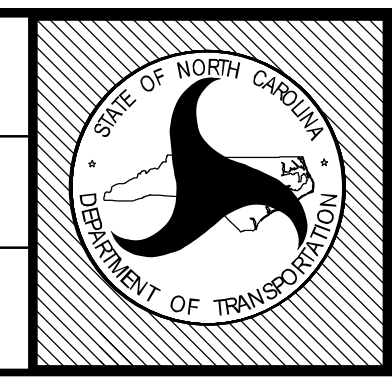

T.I.P. #	R-2633BA(L)
WBS #	34491.3.24
FED I.D. #	
sheet no :	total sheet no :
L3	5

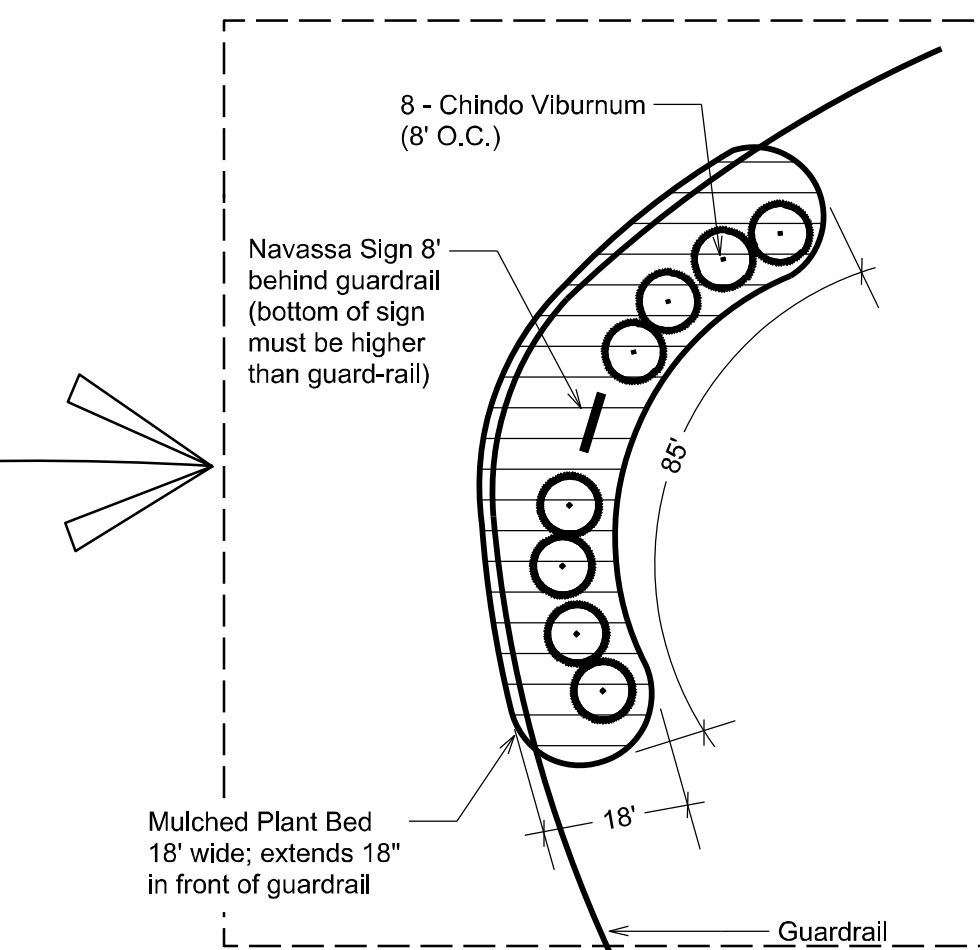
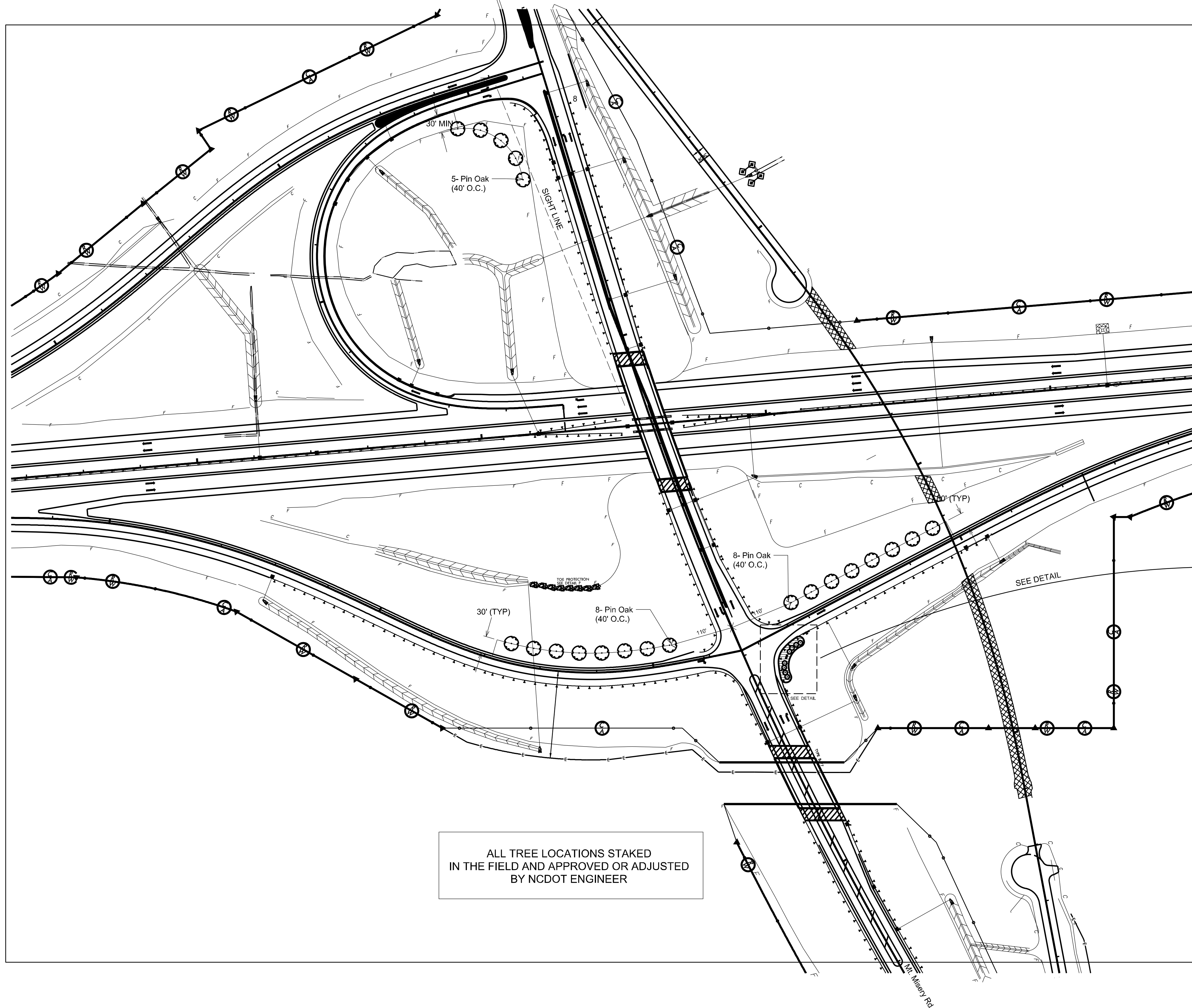

PLANT BED DETAIL

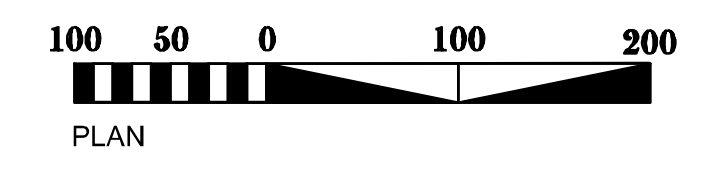

PLAN

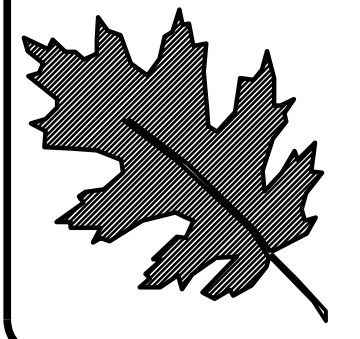

NCDOT - Roadside Environmental Unit
 Aesthetic Engineering Section
 1557 Mail Service Center Raleigh NC 27699-1557
 ph: 919-707-2920 fax: 919-715-2554
<https://www.ncdot.gov/initiatives-policies/environmental/roadside-beautification>

R-2633BA / US 17
 Landscape Development Plan
 Navassa NC

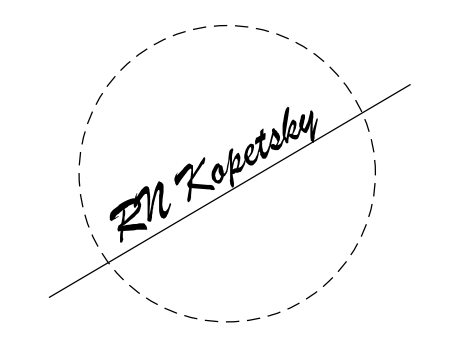

sheet description:	prel. design date : May/2020
	checked by & date :
	final design date :

Landscape Enhancement
 Plan
 Mt Misery Road @ US 17

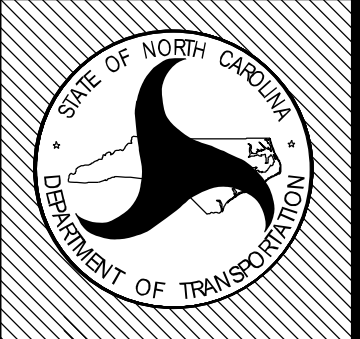

T.I.P. #	R - 2633BA (L)
WBS #	34491.3.24
FED I.D. #	
sheet no :	total sheet no :
L4	5

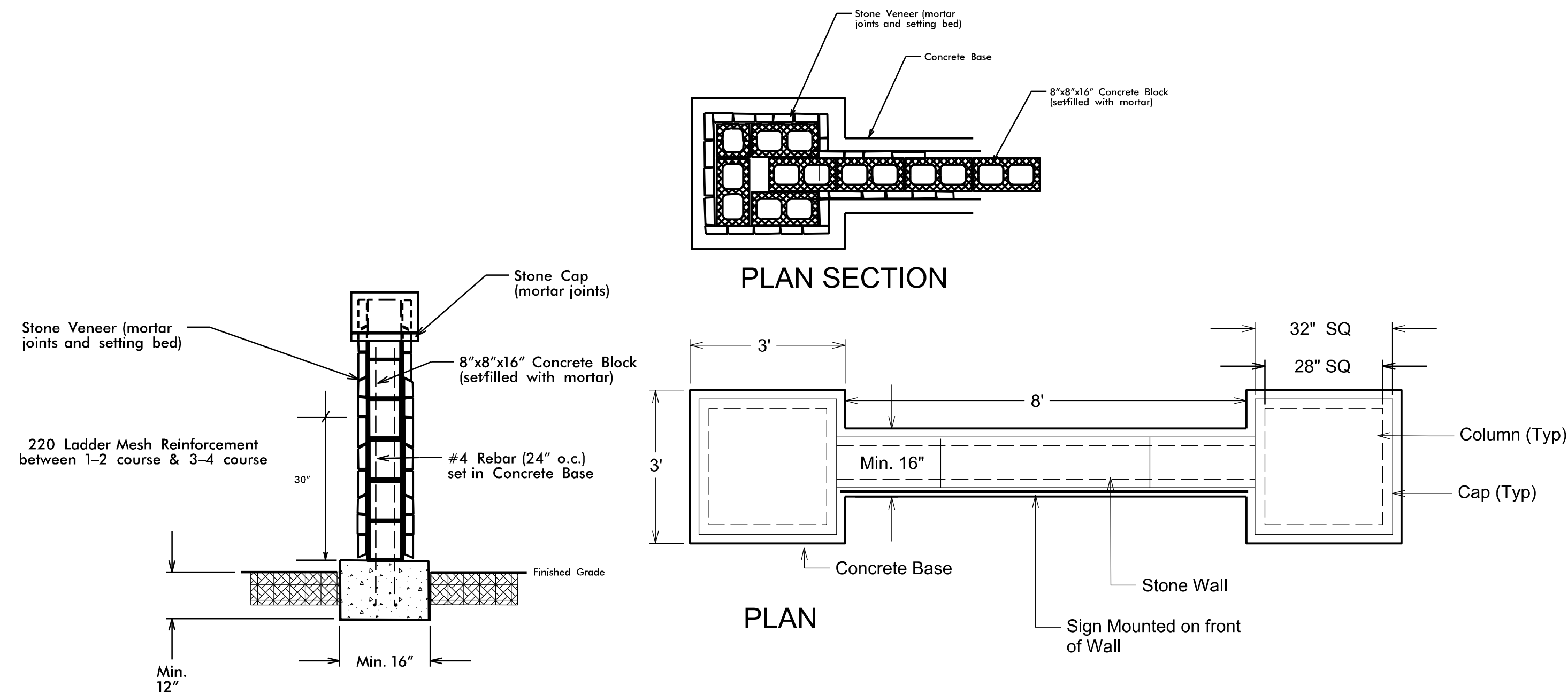

WALL SECTION

PLAN SECTION

PLAN

COLUMN SECTION

SIGN ELEVATION

A- CEDAR HILLS SIGN

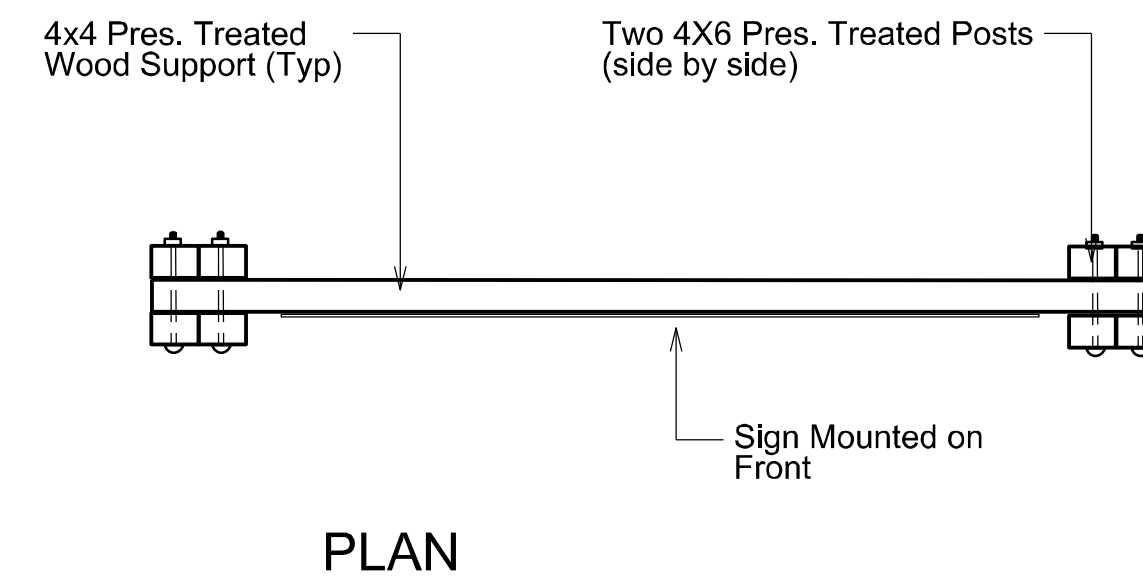

PLAN

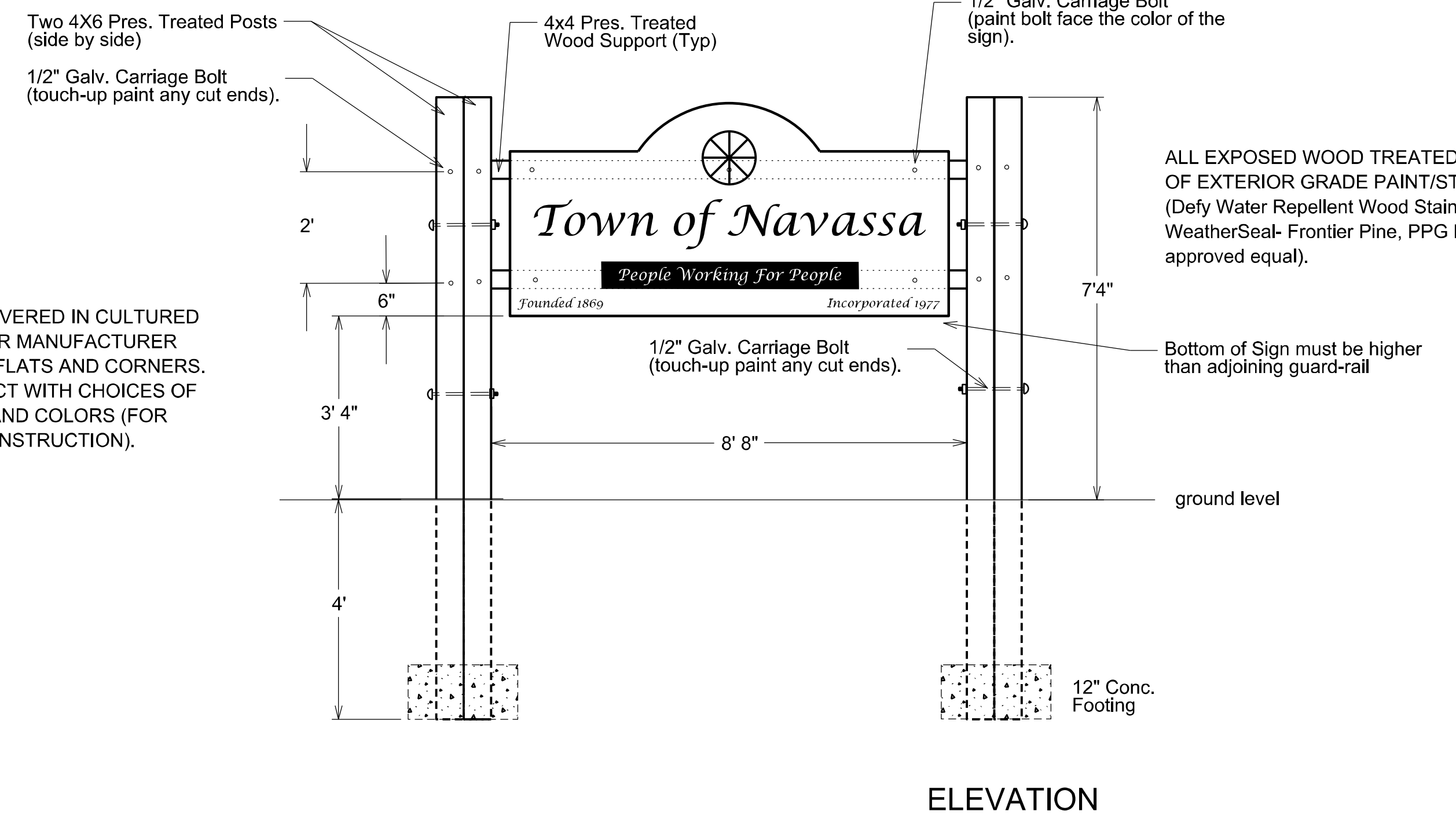

ELEVATION

B- MOUNT MISERY SIGN

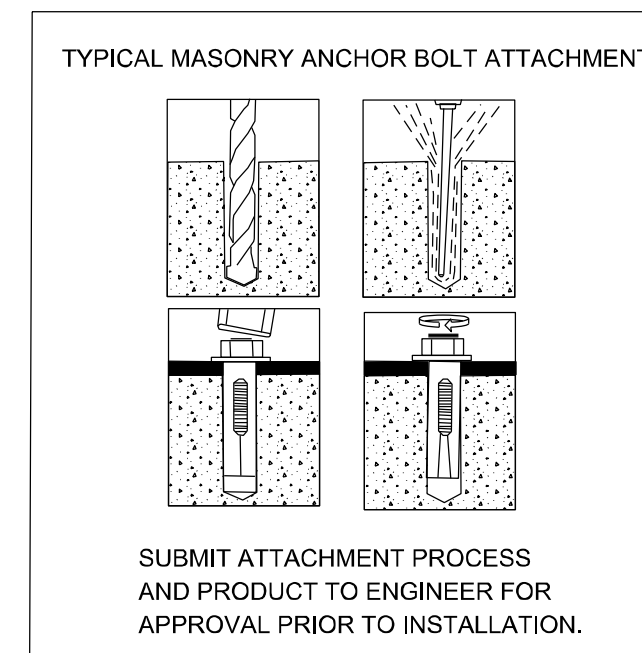

EXPOSED SURFACES COVERED IN CULTURED LEDGESTONE. APPLY PER MANUFACTURER INSTRUCTIONS; USE OF FLATS AND CORNERS. SUBMIT SAMPLE PRODUCT WITH CHOICES OF TEXTURES, PATTERNS, AND COLORS (FOR APPROVAL PRIOR TO CONSTRUCTION).

ALL EXPOSED WOOD TREATED WITH TWO COATS OF EXTERIOR GRADE PAINT/STAIN. (Defy Water Repellent Wood Stain- Sun Valley Pine, WeatherSeal- Frontier Pine, PPG ProLuxe- Cedar, or approved equal).

Bottom of Sign must be higher than adjoining guard-rail

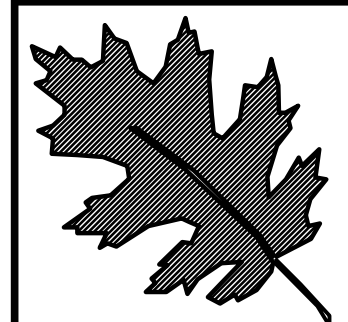

NCDOT - Roadside Environmental Unit
Aesthetic Engineering Section
1557 Mail Service Center Raleigh NC 27699-1557
ph: 919-707-2920 fax: 919-715-2554
<https://www.ncdot.gov/initiatives-policies/environmental/roadside-beautification>

R-2633BA / US 17
Landscape Development Plan
Navassa NC



prel. design date :	Sept/2020
checked by & date :	
final design date :	

sheet description:	Sign Details
--------------------	--------------

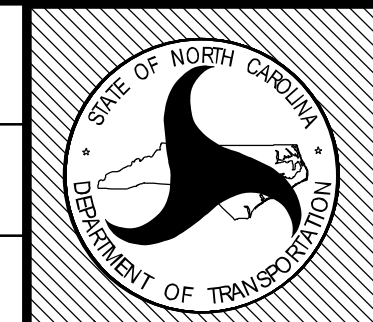

T.I.P. #	R-2633BA (L)
WBS #	34491.3.24
FED I.D. #	
sheet no :	L5
total sheet no :	5