

10/21/13

STATE OF NORTH CAROLINA
DIVISION OF HIGHWAYS

BRUNSWICK COUNTY

STATE	STATE PROJECT REFERENCE NO.	SHEET NO.	TOTAL SHEETS
N.C.	W-5203M	1	
STATE PROJ. NO.	F.A. PROJ. NO.	DESCRIPTION	
45333.1.13	HSIP-1300(14)		

LOCATION: SR 1300 (ASH-LITTLE RIVER ROAD) BEGINNING AT A POINT 406' SOUTH OF SR 1354 (FRIENDSHIP ROAD) TO THE INTERSECTION OF SR 1300 (ASH-LITTLE RIVER ROAD) AND NC 130.

TYPE OF WORK: SHOULDER RECONSTRUCTION, DRAINAGE, 2 FT. WIDENING FOR PAVED SHOULDERS AND PROFILED EDGE LINES, ETC.

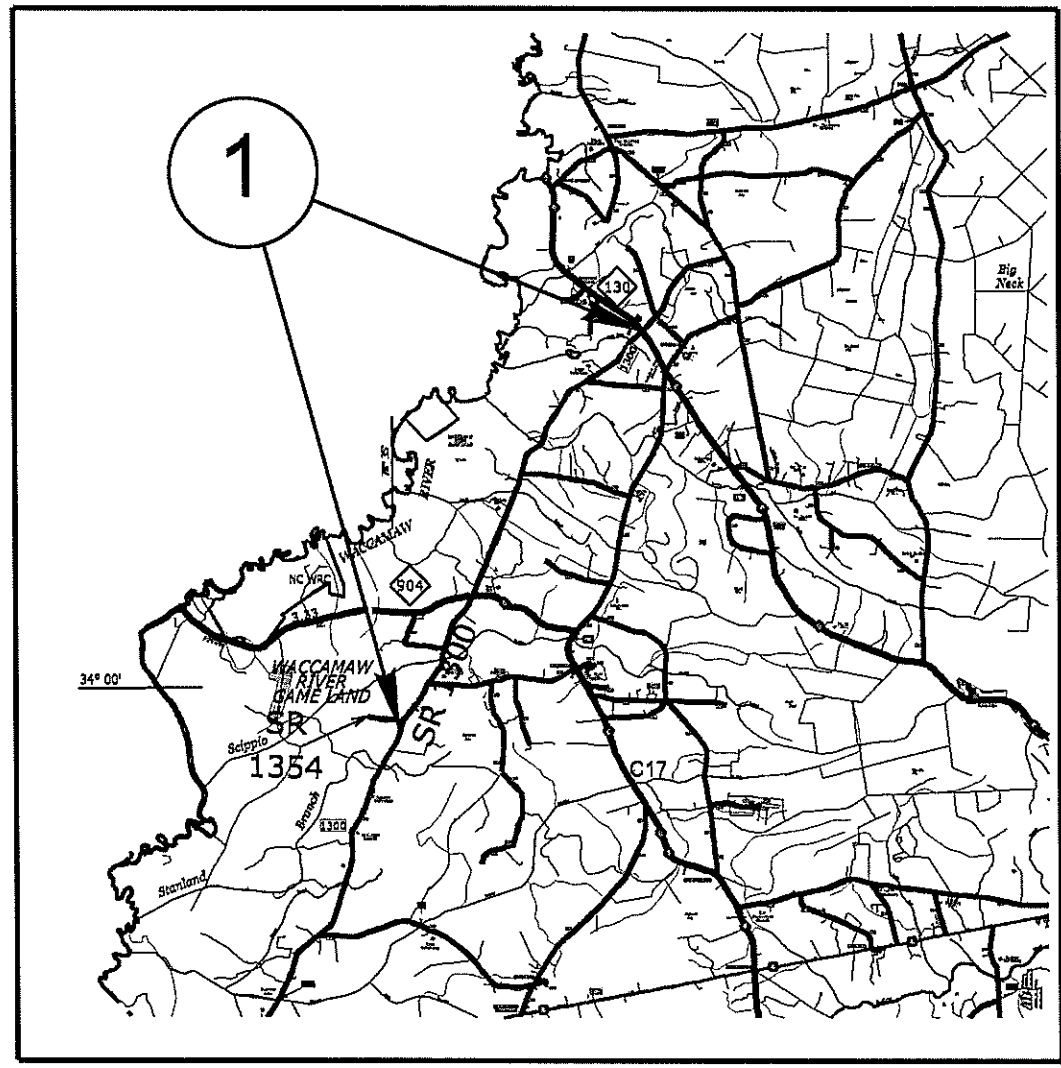

NOT TO SCALE

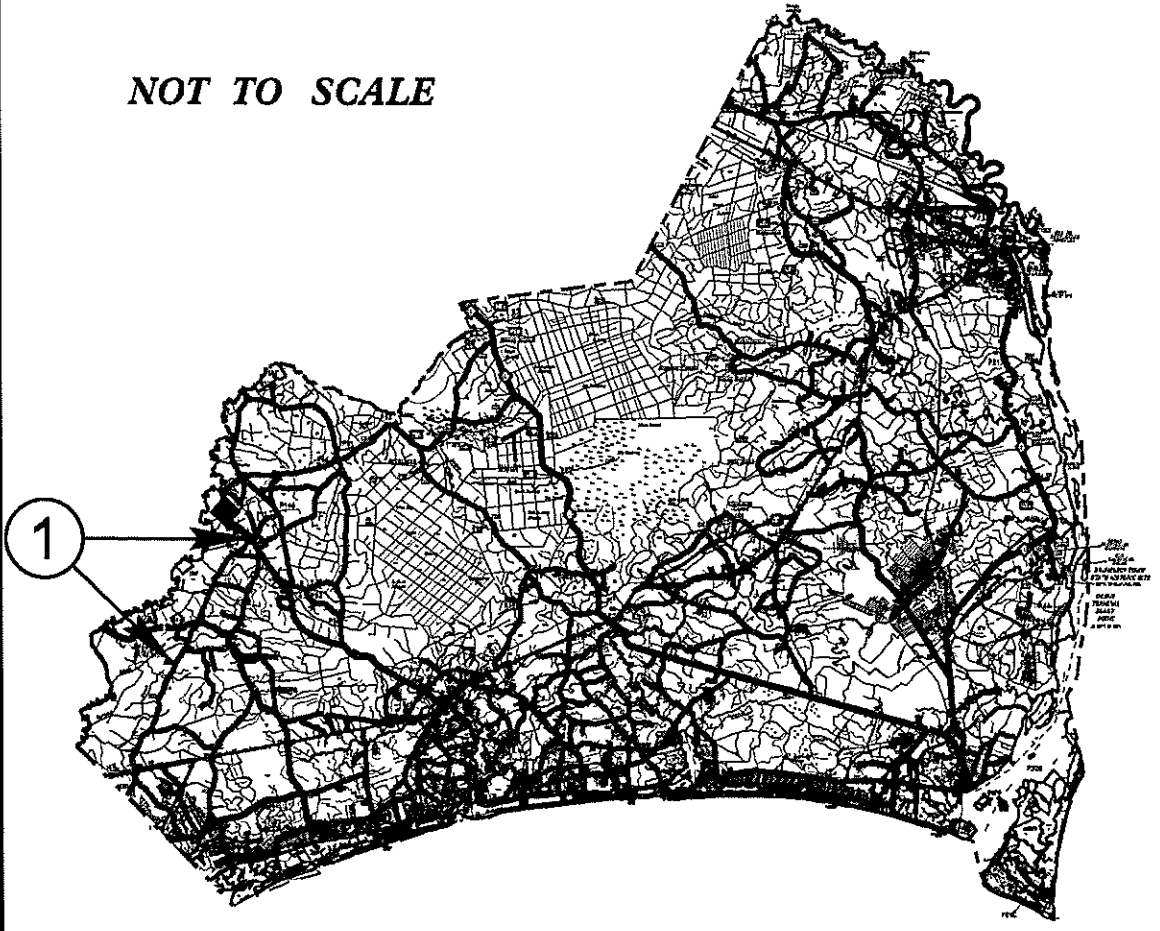

TIP PROJECT: W-5203M

COUNTY: BRUNSWICK

18-JAN-2014 16:16 C:\RDY\03\THREE BRUNSWICK\ASH-LITTLE RIVER ROAD\ROADWAY\Proj\W-5203M-Ash Little River_Rdy_tsh.dgn cr obbins AT DSCAD266703

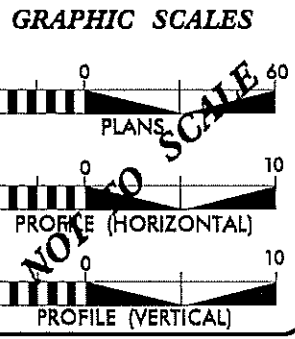

PROJECT LENGTH

TOTAL = 6.20 MI.

Prepared in the Office of:
DIVISION OF HIGHWAYS
5501 Barbados Blvd., Castle Hayne, NC 28429

2012 STANDARD SPECIFICATIONS

RIGHT OF WAY DATE: _____

LETTING DATE: Oct. 2014

SCOTT E. COOKE, PE
PROJECT ENGINEER

CDR
PROJECT DESIGN TECHNICIAN

DIVISION OF HIGHWAYS
STATE OF NORTH CAROLINA

8/17/99
 C:\HDY\07\FILEX\BRUNSWICK\Ash-Little River\Road\ROADWAY\Proj\W-5203M\Ash Little River.Rdy.tsh.dgn
 18-MAY-2014 17:59
 C:\HDY\07\FILEX\BRUNSWICK\Ash-Little River\Road\ROADWAY\Proj\W-5203M\Ash Little River.Rdy.tsh.dgn

GENERAL NOTES:

2012 SPECIFICATIONS
 EFFECTIVE: 01-17-12
 REVISED: 11/01/11

SIDE ROADS: THE CONTRACTOR WILL BE REQUIRED TO DO ALL NECESSARY WORK TO PROVIDE
 SUITABLE CONNECTIONS WITH ALL ROADS, STREETS AND DRIVES ENTERING THIS
 PROJECT. THIS WORK WILL BE PAID FOR AT THE CONTRACT UNIT PRICE FOR THE
 PARTICULAR ITEMS INVOLVED

SUBSURFACE PLANS: NO SUBSURFACE PLANS ARE AVAILABLE ON THIS PROJECT. THE CONTRACTOR
 SHOULD MAKE HIS OWN INVESTIGATION AS TO THE SUBSURFACE CONDITIONS.

UTILITIES: ANY RELOCATION OF EXISTING UTILITIES WILL BE ACCOMPLISHED BY OTHERS.

INDEX OF SHEETS

SHEET NUMBER	SHEET
1	TITLE SHEET, ALIGNMENT AND SHEET LAYOUT
1-A	INDEX OF SHEETS, GENERAL NOTES AND LIST OF STANDARD DRAWINGS
2 THRU 2-G	PAVEMENT SCHEDULE, TYPICAL SECTIONS AND PROJECT DETAILS
3 THRU 3-B	SUMMARY OF QUANTITIES AND DRAINAGE SUMMARY SHEET
4 THRU 7	SITE LOCATION MAPS

EFF. 01-17-2012
 REV. 10-30-2012

2012 ROADWAY ENGLISH STANDARD DRAWINGS

The following Roadway Standards as appear in "Roadway Standard Drawings" Highway Design Branch -
 N. C. Department of Transportation - Raleigh, N. C., Dated January, 2012 are applicable to this project
 and by reference hereby are considered a part of these plans:

STD.NO.	TITLE
DIVISION 3 - PIPE CULVERTS	
300.01	Method of Pipe Installation
DIVISION 8 - INCIDENTALS	
838.01	Concrete Endwall for Single and Double Pipe Culverts - 15" thru 48" Pipe 90 Skew
838.21	Reinforced Concrete Endwall - for Single 54" Pipe 90 Skew
838.45	Notes for Reinforced Concrete Endwall - Std. Dwg 838.21 thru 838.40
838.51	Reinforced Brick Endwall - for Single 54" Pipe 90 Skew
838.75	Notes for Reinforced Brick Endwall - Std. Dwg 838.51 thru 838.70

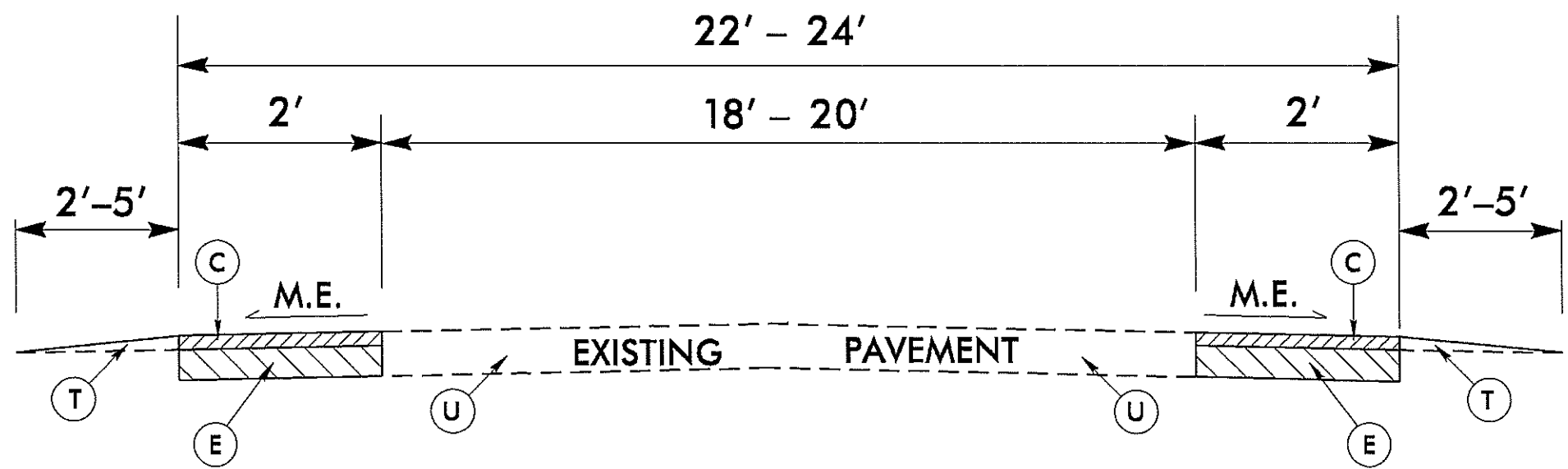

TYPICAL SECTION NO. 1
 MAP NO. 1
 SR 1300 (ASH-LITTLE RIVER RD.)
 MP 0.00 TO MP 6.20

PAVEMENT SCHEDULE	
C	PROP. APPROX. 1 1/2" DEPTH ASPHALT CONCRETE SURFACE COURSE, TYPE 99.5B, AT AN AVERAGE RATE OF 188 LBS. PER SQ.YD.
E	PROP. APPROX. 4 1/2" DEPTH ASPHALT CONCRETE BASE COURSE, TYPE B25.0B, AT AN AVERAGE RATE OF 513 LBS. PER SQ.YD.
T	EARTH MATERIAL (SHOULDER RECONSTRUCTION)
U	EXISTING PAVEMENT.

NOTE: PAVEMENT EDGE SLOPES ARE 1:1 UNLESS SHOWN OTHERWISE.
 SEE STD. DRAWING 1205.01, SHEET 2 OF 2, TABLE 1 FOR EDGE LINE OFFSETS.
 M.E. = MATCH EXISTING

NOT TO SCALE

REVISIONS

15-MAY-2014 14:26 BRUNSWICK\Ash-Little River Road\ROADWAY\Proj\W-5203M.ASH LITTLE RIVER.Rdy-tyr.dgn
 05-VROY\THREE AT 11:41:26

DETAILS OF REPAIRING EXISTING PAVEMENT PRIOR TO RESURFACING FOR FULL DEPTH AND MILLING

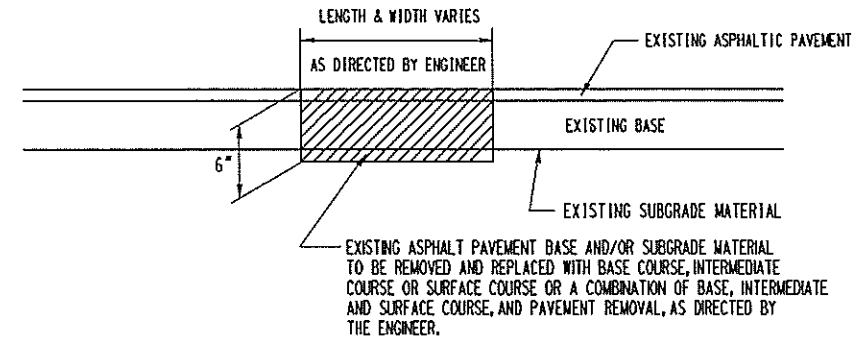

DETAIL NO. 1

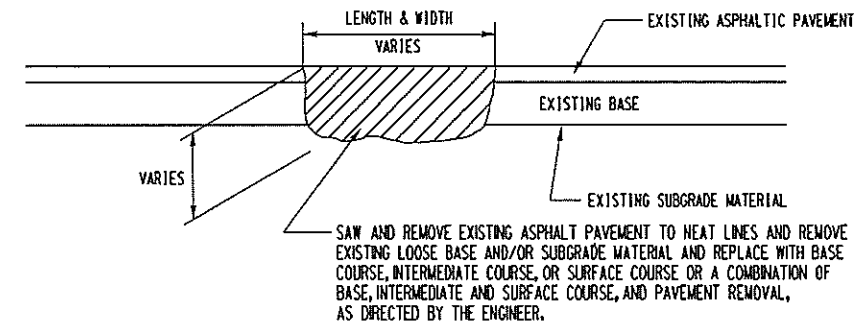

DETAIL NO. 2

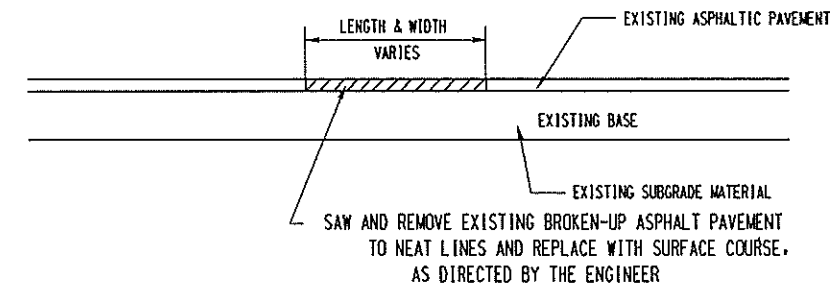

DETAIL NO. 3

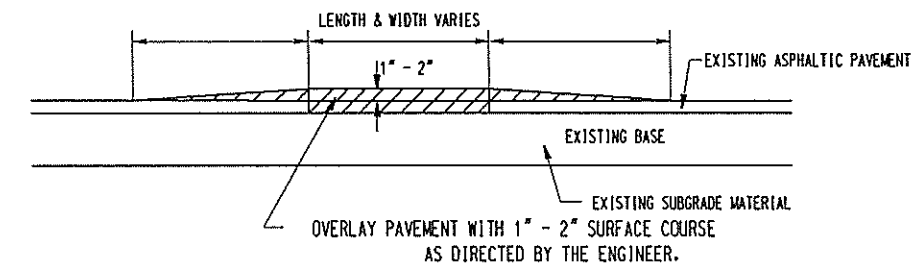

DETAIL NO. 4

DETAIL SHEET OF PIPE REPLACEMENT

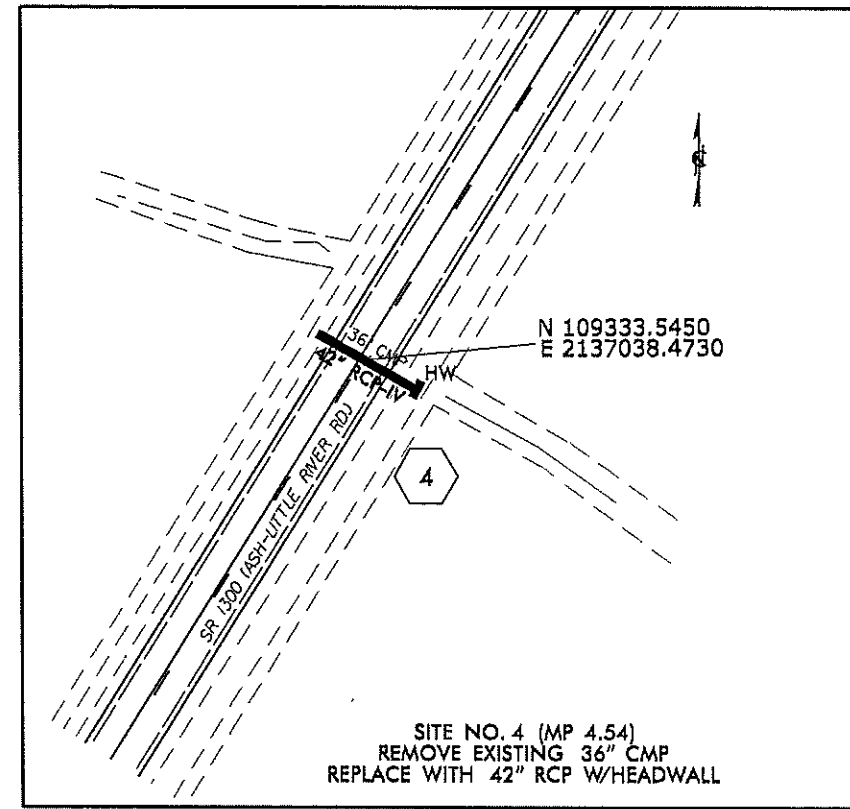
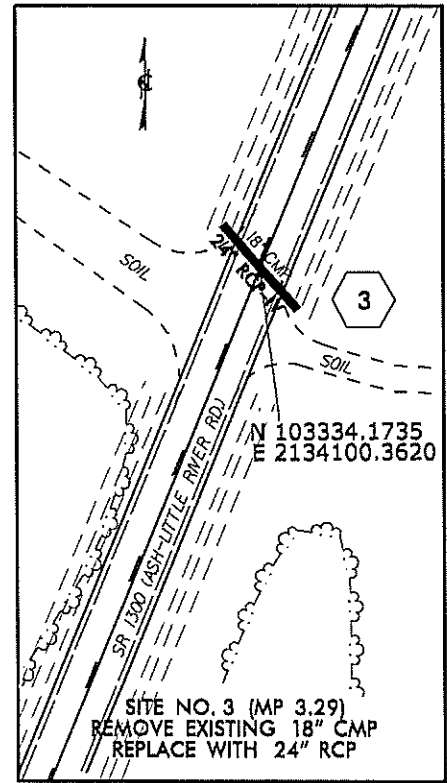
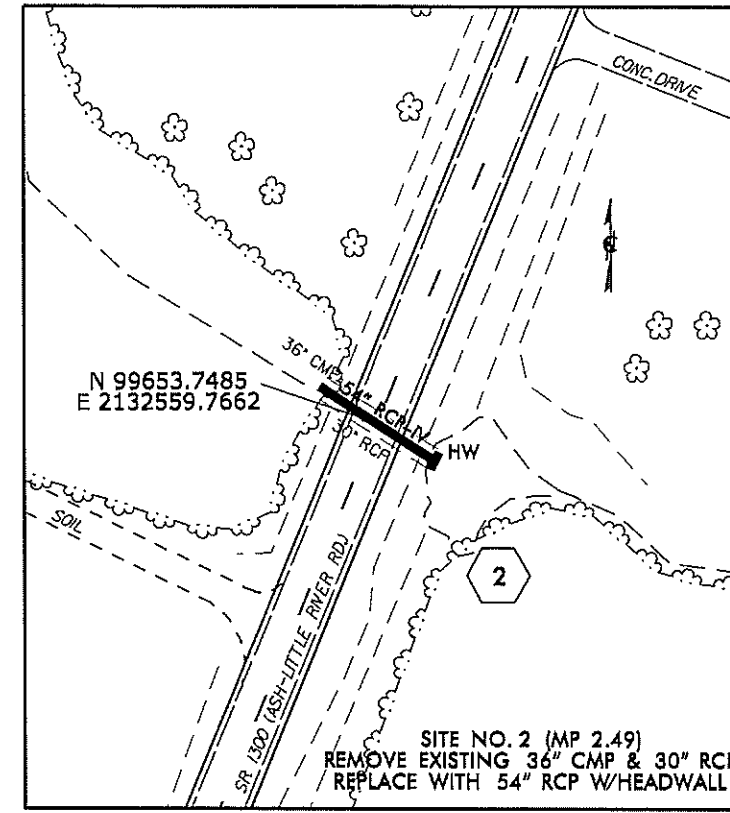
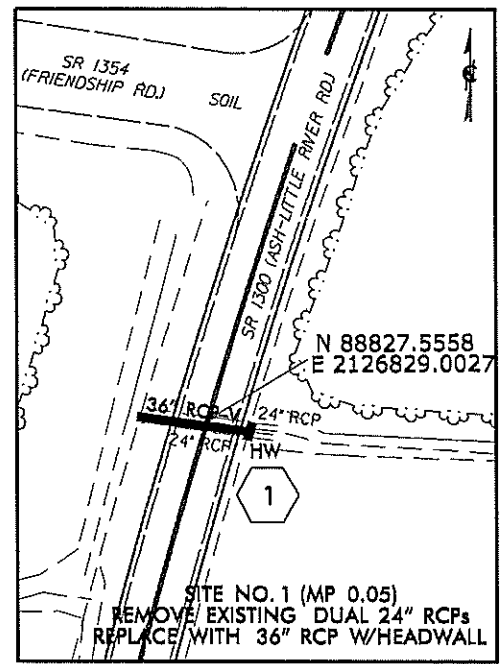

18-JAN-2014 10:51
 R:\Bentley\Bentley\Projects\Plan_Sheets\W-5203M_Rdy_PIPE_DETAILS_121913.dgn
 5/14/99

- NOTES:
 1) DETAIL DOES NOT APPLY TO OGAFD AND ULTRA-THIN BONDED WEARING COURSE.
 2) BACKFILL SHOULDER WITH APPROVED MATERIAL.
 3) THE SHOULDER WEDGE DEVICE MAY BE DISENGAGED AT PAVED DRIVEWAYS AND SIDE STREETS.

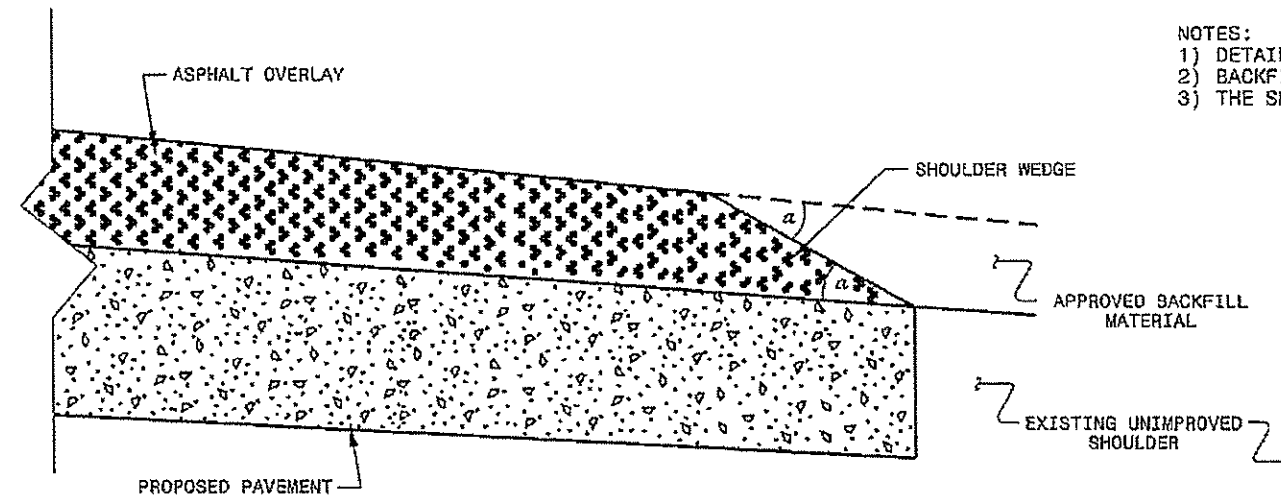

SHOULDER WEDGE DETAIL
 (Resurfacing Projects w/ Widening or
 with Existing Paved Shoulder having no dropoffs)

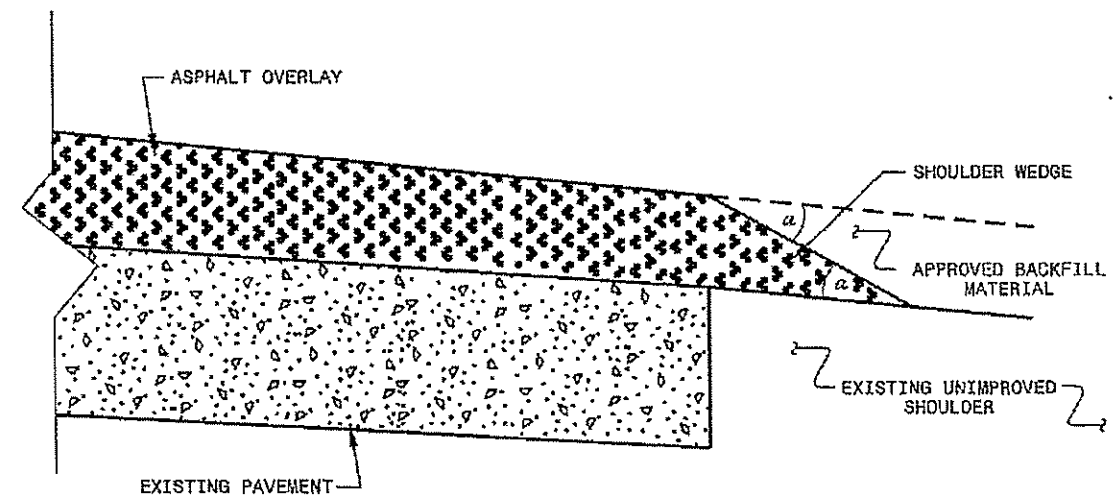

SHOULDER WEDGE DETAIL
 (Resurfacing Projects w/ NO Widening)

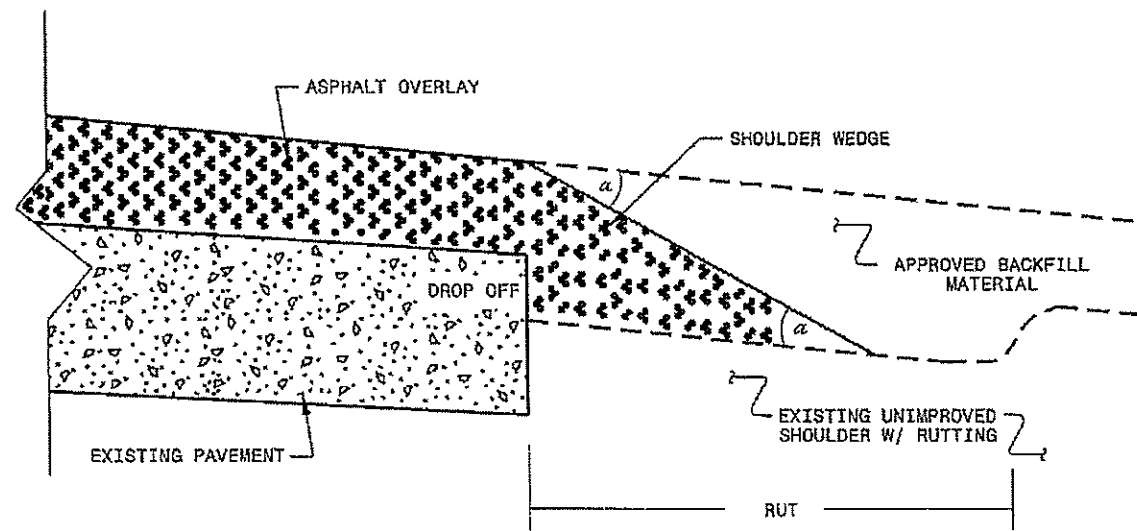

SHOULDER WEDGE DETAIL
 (Resurfacing Adjacent to
 Rutted Shoulder)

• SHOULDER WEDGE ANGLE = 30°

DIVISION OF HIGHWAYS
STATE OF NORTH CAROLINA

SOIL STABILIZATION TIMEFRAMES

<i>SITE DESCRIPTION</i>	<i>STABILIZATION TIME</i>	<i>TIMEFRAME EXCEPTIONS</i>
PERIMETER DIKES, SWALES, DITCHES AND SLOPES	7 DAYS	NONE
HIGH QUALITY WATER (HQW) ZONES	7 DAYS	NONE
SLOPES STEEPER THAN 3:1	7 DAYS	IF SLOPES ARE 10' OR LESS IN LENGTH AND ARE NOT STEEPER THAN 2:1, 14 DAYS ARE ALLOWED.
SLOPES 3:1 OR FLATTER	14 DAYS	7 DAYS FOR SLOPES GREATER THAN 50' IN LENGTH.
ALL OTHER AREAS WITH SLOPES FLATTER THAN 4:1	14 DAYS	NONE, EXCEPT FOR PERIMETERS AND HQW ZONES.

WATTLE DETAIL

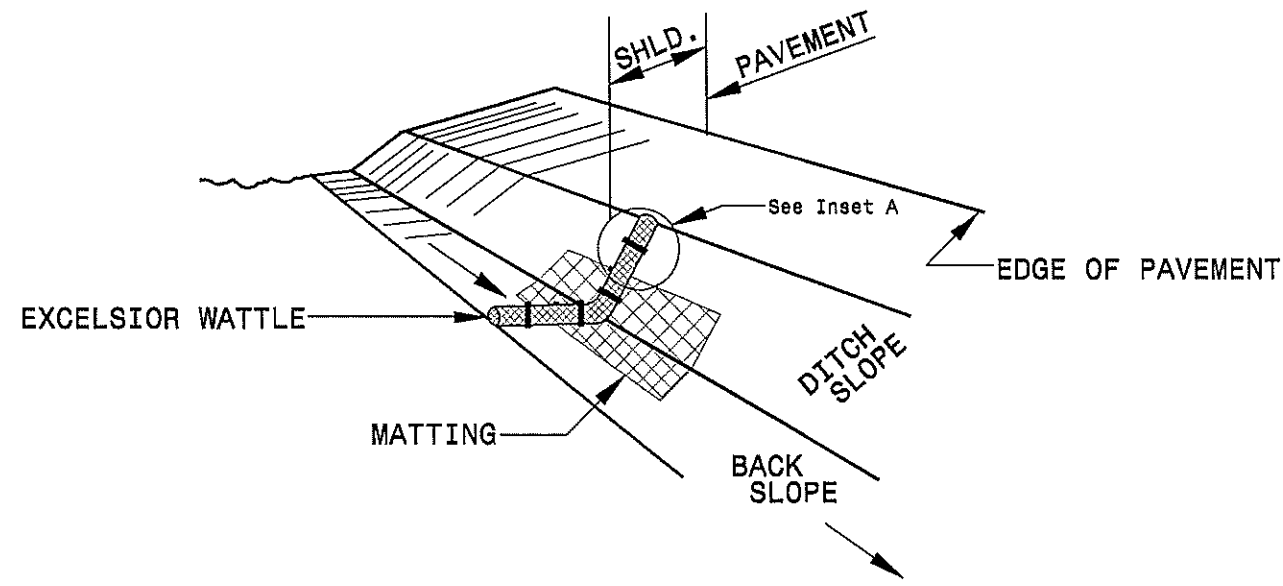

ISOMETRIC VIEW

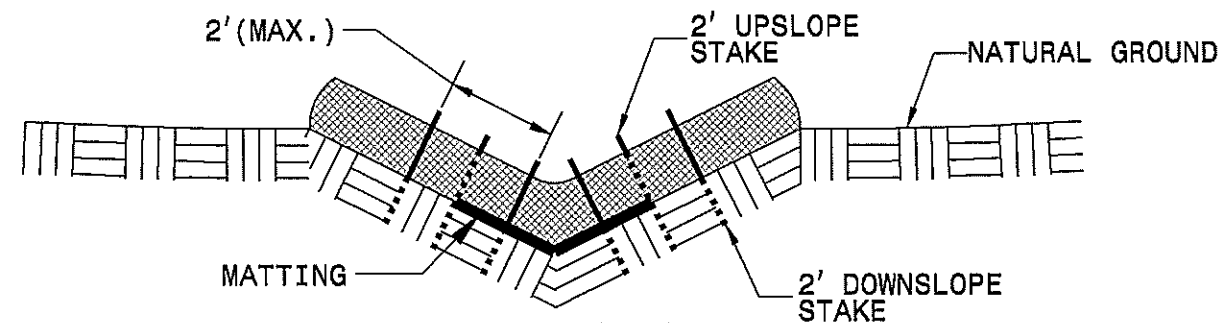

**CROSS SECTION
VEE DITCH**

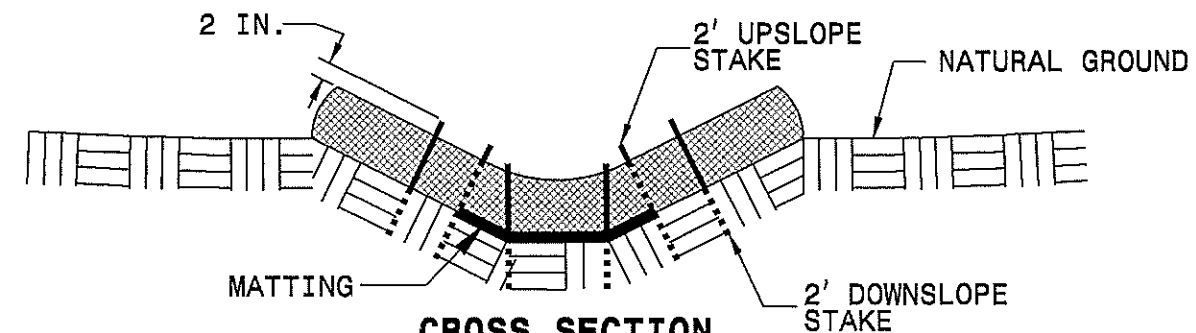

**CROSS SECTION
TRAPEZOIDAL DITCH**

NOTES:

USE MINIMUM 12 IN. DIAMETER EXCELSIOR WATTLE.

USE 2 FT. WOODEN STAKES WITH A 2 IN. BY 2 IN. NOMINAL CROSS SECTION.

ONLY INSTALL WATTLE(S) TO A HEIGHT IN DITCH SO FLOW WILL NOT WASH AROUND WATTLE AND SCOUR DITCH SLOPES AND AS DIRECTED.

INSTALL A MINIMUM OF 2 UPSLOPE STAKES AND 4 DOWNSLOPE STAKES AT AN ANGLE TO WEDGE WATTLE TO BOTTOM OF DITCH.

PROVIDE STAPLES MADE OF 0.125 IN. DIAMETER STEEL WIRE FORMED INTO A U SHAPE NOT LESS THAN 12" IN LENGTH.

INSTALL STAPLES APPROXIMATELY EVERY 1 LINEAR FOOT ON BOTH SIDES OF WATTLE AND AT EACH END TO SECURE IT TO THE SOIL.

INSTALL MATTING IN ACCORDANCE WITH SECTION 1631 OF THE STANDARD SPECIFICATIONS.

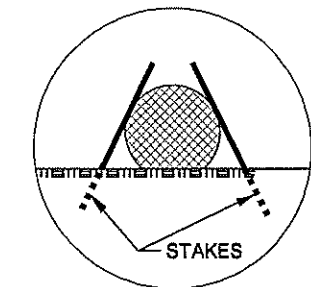

INSET A

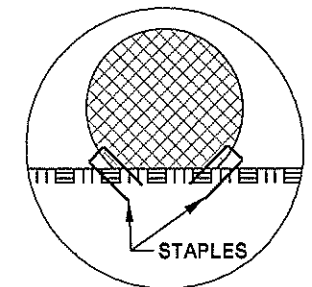

INSET B

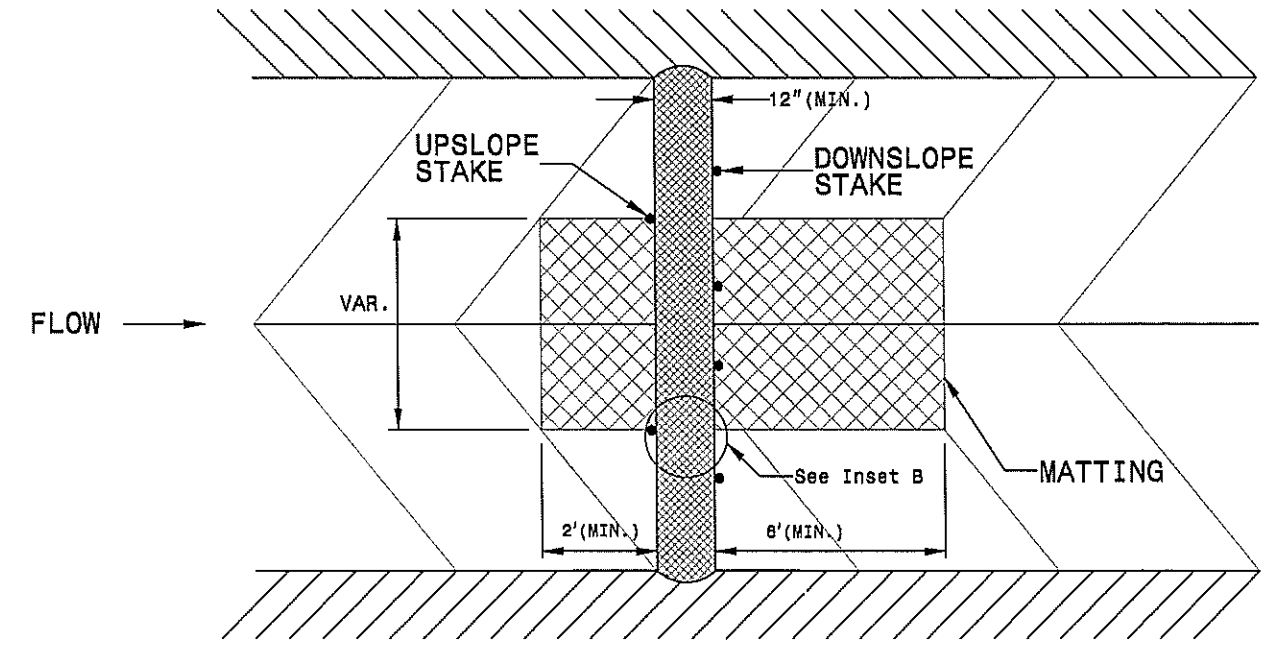

TOP VIEW

MATTING INSTALLATION DETAIL

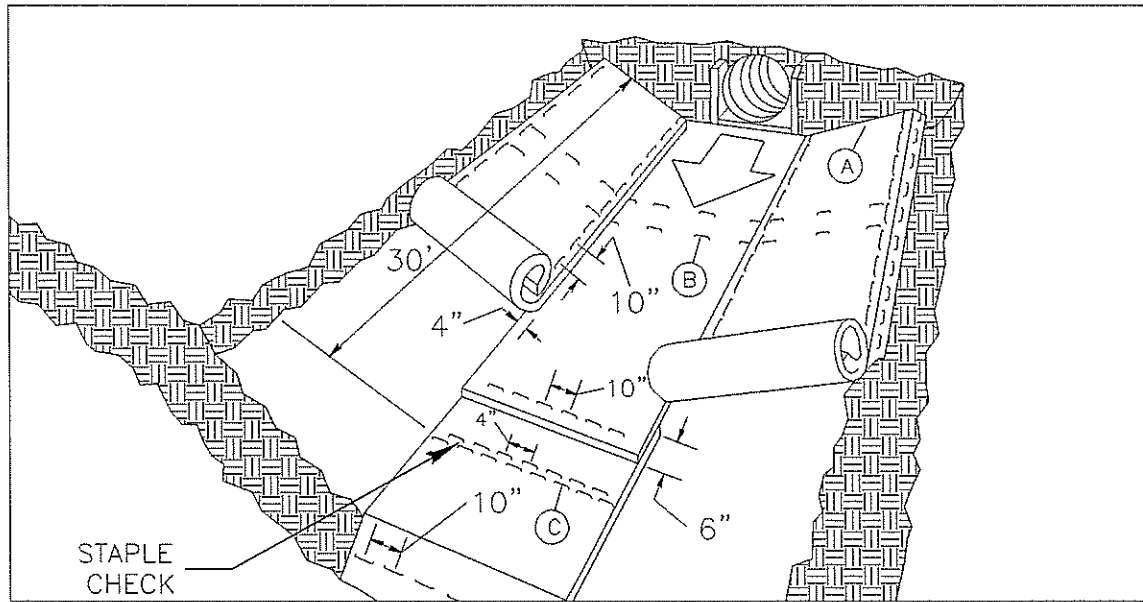

MATTING IN DITCHES

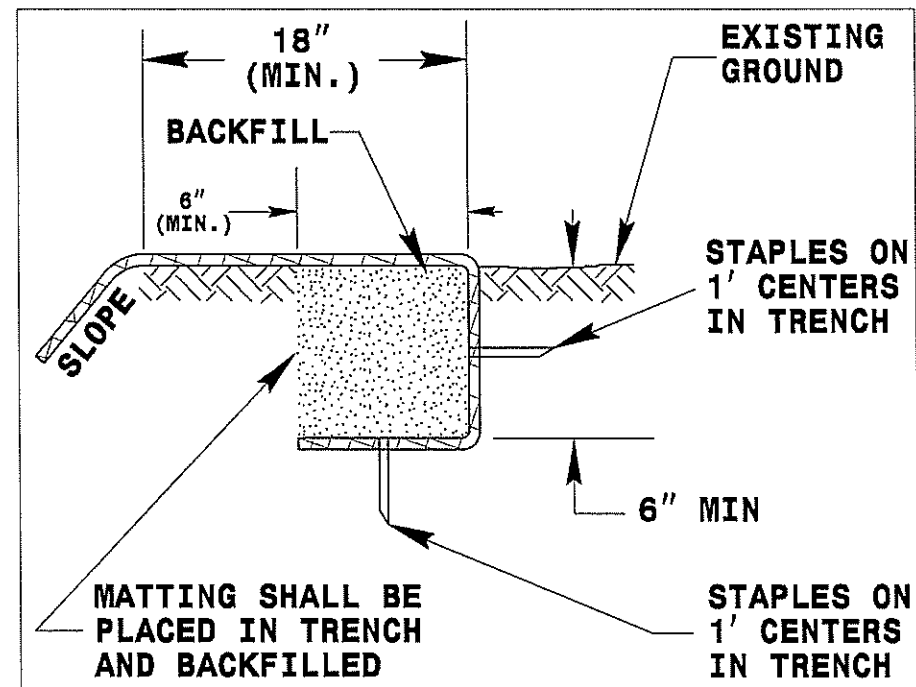
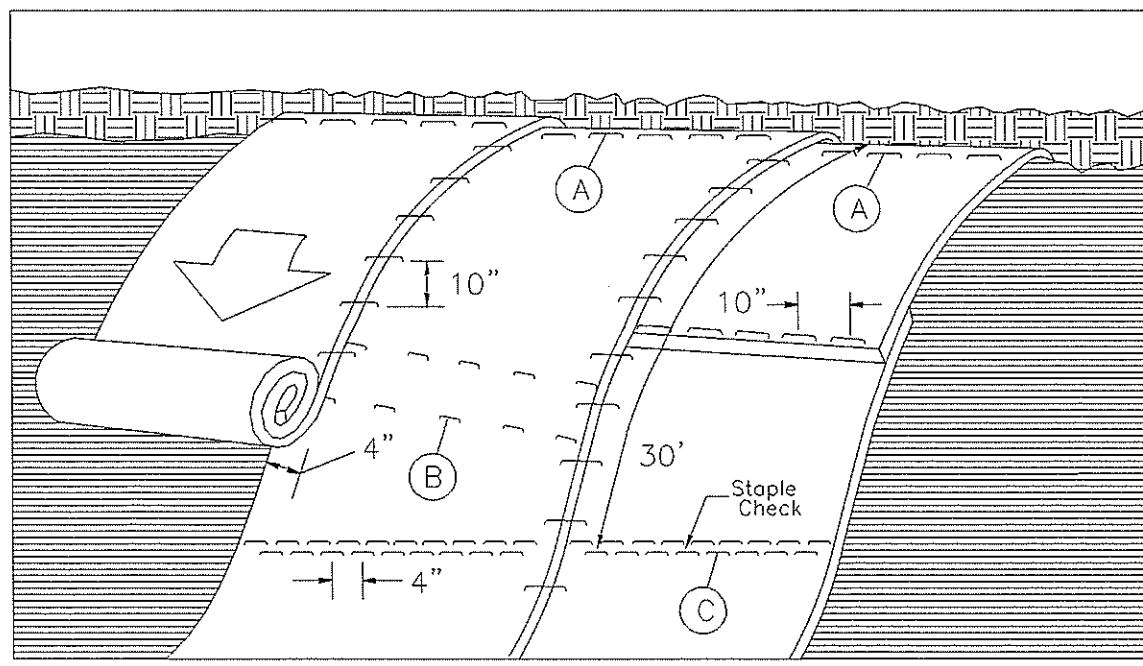

DIAGRAM (A)



MATTING ON SLOPES

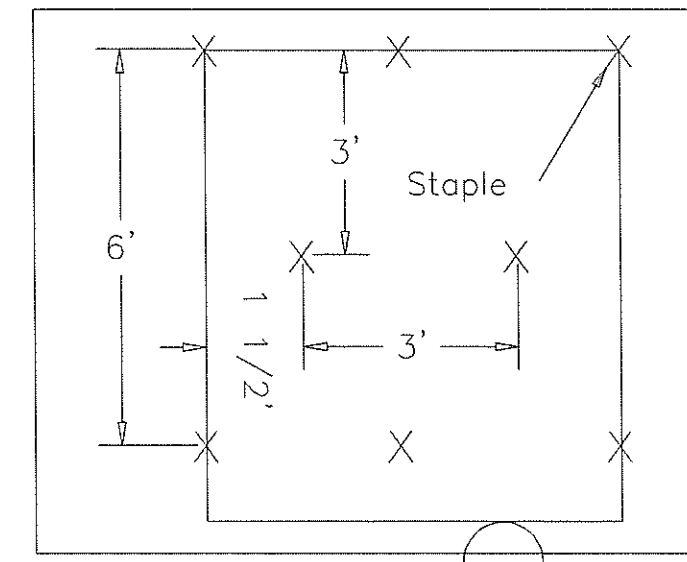

DIAGRAM B

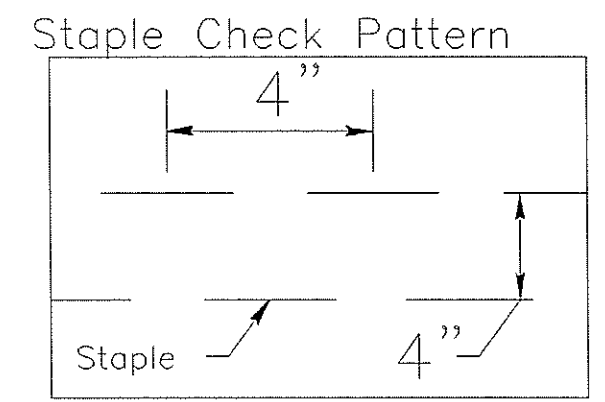

DIAGRAM (C)

NOTES:

THIS DETAIL APPLIES TO STRAW, EXCELSIOR, AND PERMANENT SOIL REINFORCEMENT MAT (PSRM) INSTALLATION.

STAPLES SHALL BE NO. 11 GAUGE STEEL WIRE FORMED INTO A "U" SHAPE WITH A MINIMUM THROAT WIDTH OF 1 INCH AND NOT LESS THAN 6 INCHES IN LENGTH.

NOT TO SCALE

NOTES: Less than 5' - 10' undisturbed buffer from ROW, ditchline, water feature, or drainage inlet, add BMP.

BMP Options: Wattle or Silt Fence

EROSION CONTROL DETAIL

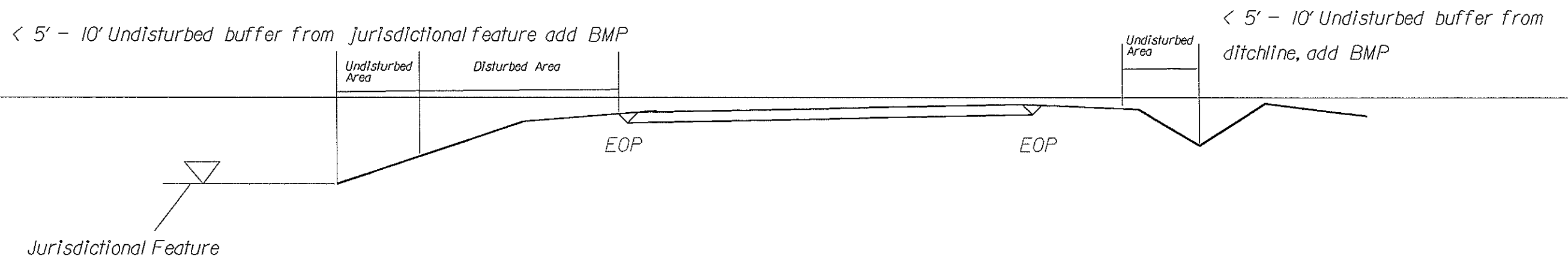
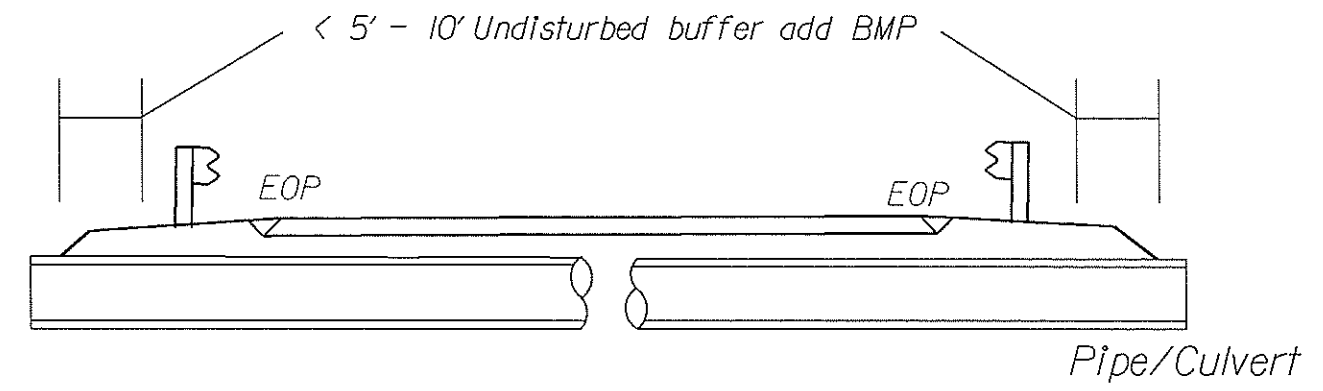

Use BMP's if shoulders and/or frontslopes and/or ditchline and/or backslopes are disturbed

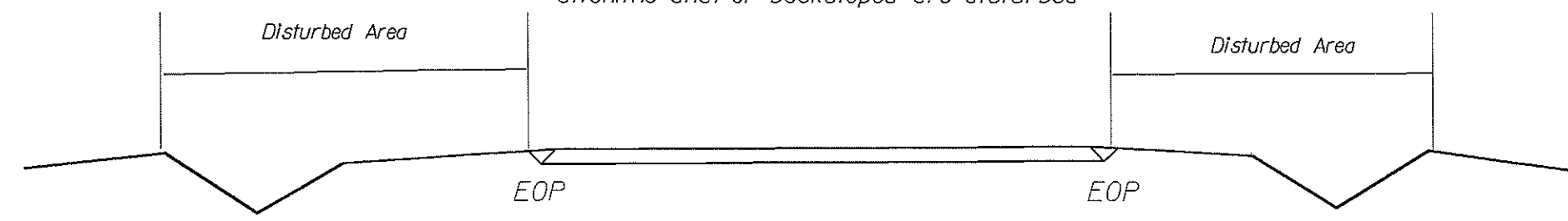

< 5' - 10' Undisturbed buffer from inlet, add wattle

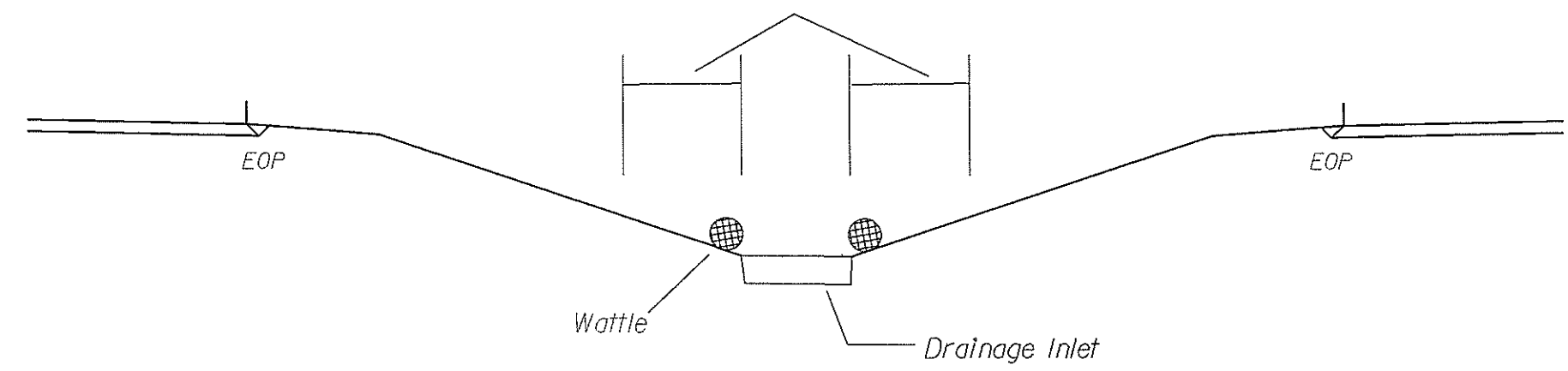

NOT TO SCALE

PROJECT NO.	SHEET NO.	TOTAL NO.
45333.1.13	3	

SUMMARY OF QUANTITIES

PROJECT NO	COUNTY	MAP NO	ROUTE	DESCRIPTION	TYP	LANES	LANE TYPE	FINAL SURFACE TESTING REQUIRED	WARM MIX ASPHALT REQUIRED	LENGTH MI	WIDTH FT	FOUNDATIO N CONDITIONI NG MATERIAL, MINOR STRS	FOUNDATIO N CONDITIONI NG GEOTEXTILE	36" RC PIPE CULVERTS, CLASS V	54" RC PIPE CULVERTS, CLASS V	42" RC PIPE CULVERTS, CLASS V	24" RC PIPE CULVERTS, CLASS IV	INCIDENTAL STONE BASE	SHOULDER RECONSTRU CTION	BASE COURSE, B25.0B	SURFACE COURSE, S9.5B	ASPHALT BINDER FOR PLANT MIX	AC PLANT MIX (REPAIR)	ENDWALLS	REINFORCE D ENDWALLS	INCIDENTAL CDNC	TEMPORAR Y SILT FENCE	STONE FOR EC CLASS B	SEDIMENT CONTROL STONE	TEMPORAR Y MULCHING	MATTING FOR EROSDN CONTROL	1/4" HARDWARE CLOTH	WATTLE	SEED & MULCHING	SEED FOR REPAIR SEEDING	FERTILIZER FOR REPAIR SEEDING	
NO		NO			NO					MI	FT	TON	SY	LF	LF	LF	LF	TONS	SMI	TONS	TONS	TON	TONS	CY	CY	SY	LF	TON	TON	ACR	SY	LF	LF	AC	LB	TON	
45333.1.13	Brunswick	1	SR 1300 MP 0.00-MP 6.2	FROM MP 0.0-MP 6.2 (START EXIST WIDEN)	1	2	2WD	NO	NO	6.13	22	20.00	60.00	40.00	48.00	40.00	40.00	470	12.26	4,237	1,371	269	50	7.9	5	48	613	154	154	6.13	40	307	100	7.50	307	1.53	
				NO WORK MP 1.10-MP 1.12, MP 4.30-MP 4.35	1	2	2WD	NO	NO	0.07	22																										
TOTAL FOR MAP NO. 1										6.2		20.00	60.00	40.00	48.00	40.00	40.00	470	12.26	4,237	1,371	269	50	7.9	5	48	613	154	154	6.13	40	307	100	7.50	307	1.53	
TOTAL FOR PROJ NO. 45333.1.13										6.2		20.00	60.00	40.00	48.00	40.00	40.00	470	12.26	4,237	1,371	269	50	7.9	5	48	613	154	154	6.13	40	307	100	7.50	307	1.53	
GRAND TOTAL										6.2		20.00	60.00	40.00	48.00	40.00	40.00	470	12.26	4,237	1,371	269	50	7.9	5	48	613	154	154	6.13	40	307	100	7.50	307	1.53	

PROJECT NO.	SHEET NO.	TOTAL NO.
45333.1.13	3-A	

THERMOPLASTIC AND PAINT QUANTITIES

PROJECT NO	COUNTY	MAP NO	ROUTE	DESCRIPTION	TYP	LANES	LANE TYPE	LENGTH	WIDTH	4399000000-N	4413000000-E	4686000000-E	4891000000-E	4905000000-N
										TEMPORARY TRAFFIC CONTROL	WORK ZONE ADVANCE/GENERAL WARNING SIGNING	4" X 120 M YELLOW THERMO	WHITE THERMO PROFILED PAVEMENT MARKING LINE, 4"	SNOW PLOWABLE MARKERS (Y/Y)
										LS	SF	LF	LF	EA
45333.1.13	Brunswick	1	SR 1300 MP 0.00-MP 6.2	FROM MP 0.0-MP 6.2 (START EXIST WIDEN)	1	2	2WD	6.13	22	1	695	100	65,959	4
		"	"	NO WORK MP 1.10-MP 1.12 , MP 4.30-MP 4.35	1	2	2WD	0.07	22					
TOTAL FOR MAP NO. 1										1	695	100	65,959	4
TOTAL FOR PROJ NO. 45333.1.13										1	695	100	65,959	4

NOTE: PROPERTY BOUNDRIES BY COUNTY TAX MAP.
NOT INTENDED AS A PROPERTY SURVEY.

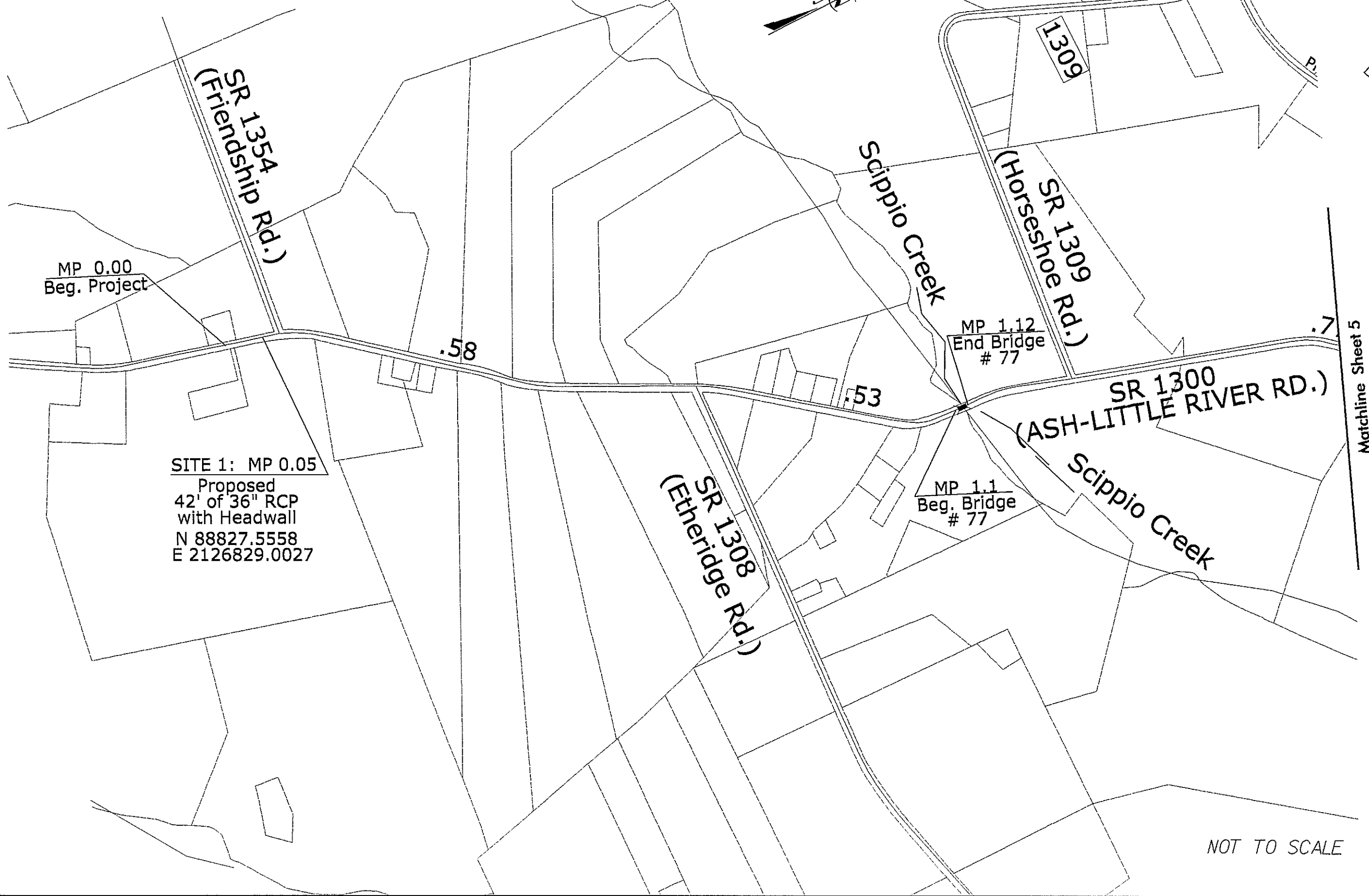
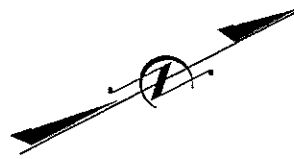

SITE 1: MP 0.05
Proposed
42' of 36" RCP
with Headwall
N 88827.5558
E 2126829.0027

MP 0.00
Beg. Project

MP 1.12
End Bridge
77

MP 1.1
Beg. Bridge
77

Matchline Sheet 5

NOT TO SCALE

REVISIONS

8/17/99
S:\MAY-2014\1441\BRUNSWICK\Ash-Little River Road\RDADWAY\Proj\Plan_Sheets\Ash Little River_PSH 4.dgn
BY: J. H. H. DATE: 08/17/99

8/17/99
 REVISIONS
 8-MAY-2014 14:44
 G:\V\RY-CO\THREE BRUNSWICK\Ash-Little River Road\ROADWAY\Proj\Plan_Sheets\Ash Little River_PSH 5.dgn
 AT 03:00:26:783
 acobbs

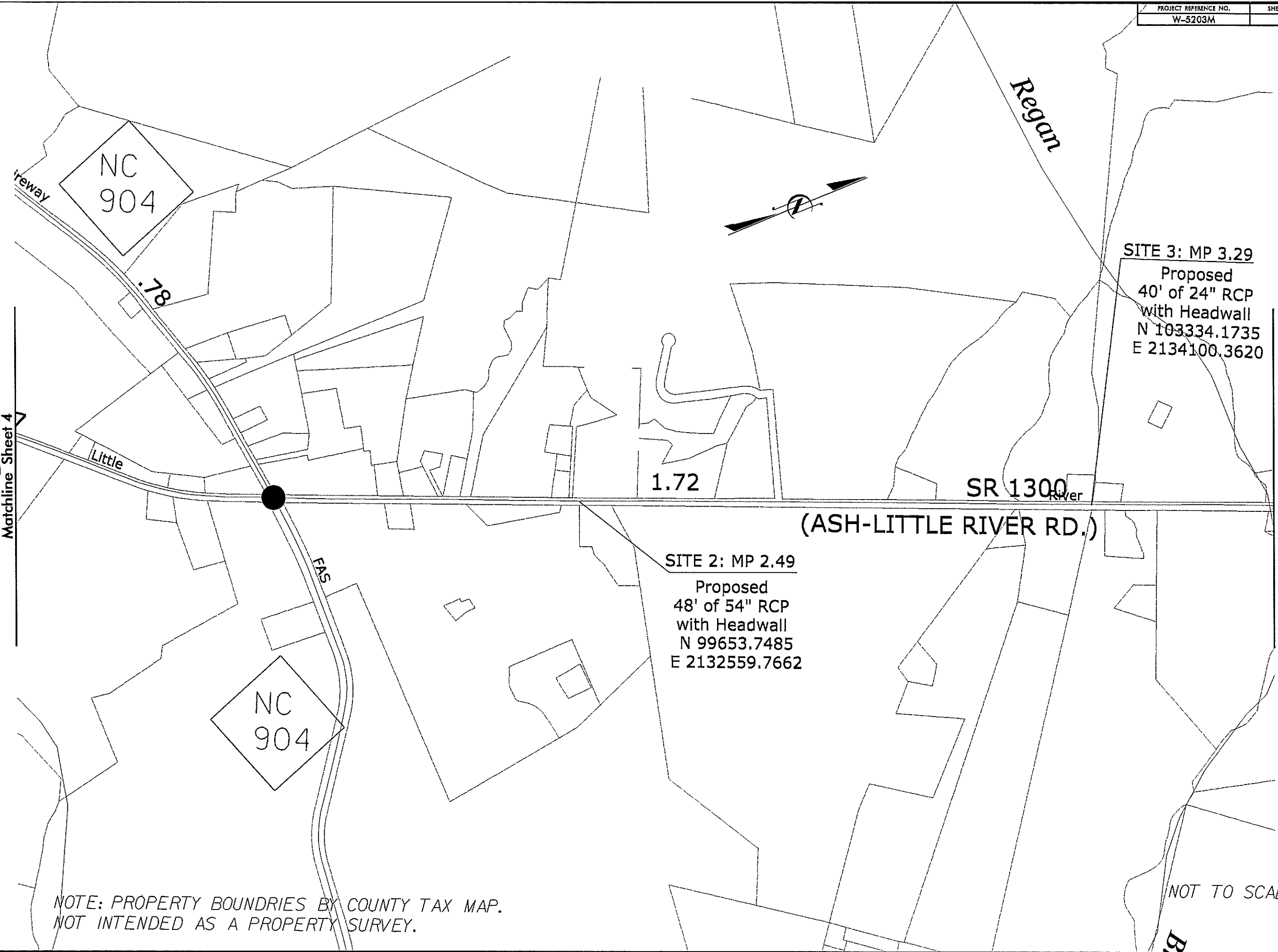

SITE 3: MP 3.29
 Proposed
 40' of 24" RCP
 with Headwall
 N 103334.1735
 E 2134100.3620

SITE 2: MP 2.49
 Proposed
 48' of 54" RCP
 with Headwall
 N 99653.7485
 E 2132559.7662

NOTE: PROPERTY BOUNDRIES BY COUNTY TAX MAP.
 NOT INTENDED AS A PROPERTY SURVEY.

NOT TO SCALE

8/17/99
REVISIONS
C:\VADY\2014\K&F\BRUNSMICK\Ash-Little River Road\ROADWAY\Proj\Plan_Sheets\Ash Little River_PSH 6.dgn

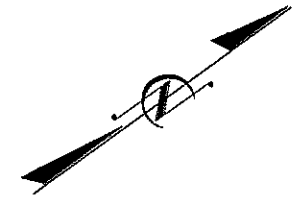

Matchline Sheet 5

Matchline Sheet 7

Wet

Ash

Ash

N 109333.5450
E 2137038.4730
SITE 4: MP 4.54

Proposed
40' of 42" RCP
with Headwall

MP 4.30
Beg. Bridge

1.51

SR 1300
(ASH-LITTLE RIVER RD.)

MP 4.35
End Bridge

SR 1324
(Long Rd.)

SR 1322
(Hughes - Smith Rd.)

(Long

NOTE: PROPERTY BOUNDRIES BY COUNTY TAX MAP
NOT INTENDED AS A PROPERTY SURVEY.

NOT TO SCALE

8/17/99
REVISIONS
SR 1300 (ASH-LITTLE RIVER ROAD) PROJECT PLAN - SHANNON ASH-LITTLE RIVER ROAD PSH 7.dgn
DATE: 2014.04.26 BY: BRUNS, JICK, YASH, LITTLE RIVER ROAD PROJECT PLAN - SHANNON ASH-LITTLE RIVER ROAD PSH 7.dgn
DATE: 2011.04.15 BY: JICK, YASH, LITTLE RIVER ROAD PROJECT PLAN - SHANNON ASH-LITTLE RIVER ROAD PSH 7.dgn

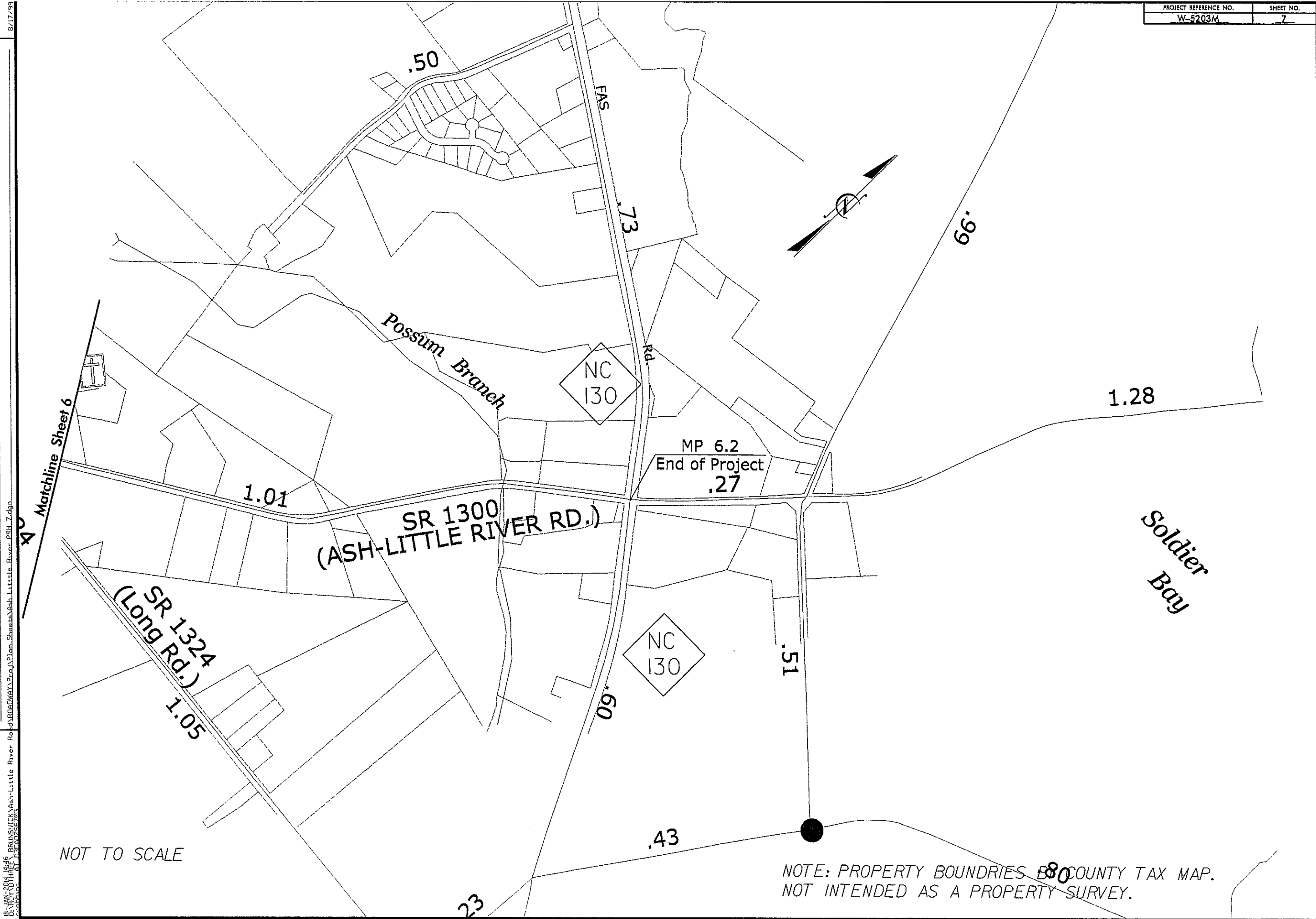

NOT TO SCALE

NOTE: PROPERTY BOUNDRIES FROM COUNTY TAX MAP. NOT INTENDED AS A PROPERTY SURVEY.