

HIGHWAY LANDSCAPE DEVELOPMENT PROJECT

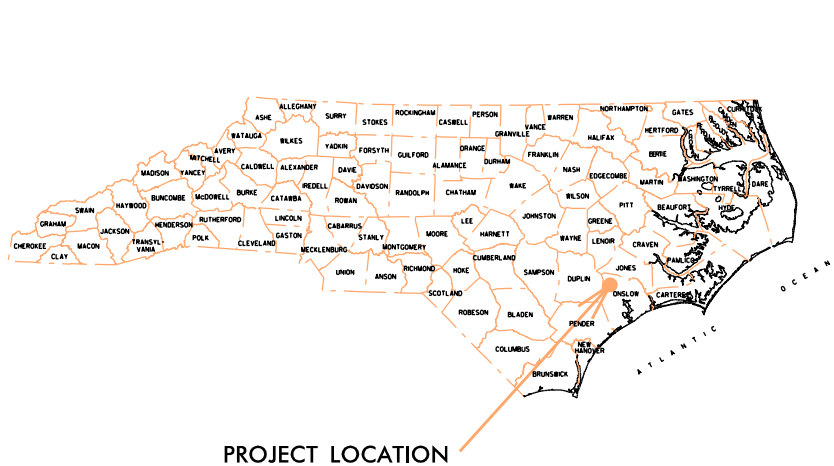
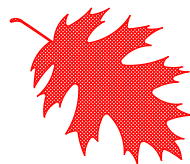

NC GRID  
NAD 83

ONSLOW COUNTY  
LANDSCAPE ENHANCEMENT

LOCATION: RICHLANDS NC

TYPE OF WORK: Gateway & Downtown Landscape Enhancement

SUMMARY OF QUANTITIES

Richlands' Enhancements				
TREES				
Quan	Unit	Common Name	Botanical Name	Notes
5	Ea	Green Giant Arborvitae	Thuja 'Green Giant'	8'-10' B&B
6	Ea	Nellie R Stevens Holly	Ilex x 'Nellie R Stevens'	8'-10' B&B
2	Ea	Eastern Redbud	Cercis canadensis	8'-10' B&B
SHRUBS				
Quan	Unit	Common Name	Botanical Name	Notes
25	Ea	Buxus sempervirens	American Boxwood	#3 Cont
8	Ea	August Beauty Gardenia	Gardenia jasminoides 'August Beauty'	#3 Cont
33	Ea	Crimson Fire Loropetalum	Loropetalun chinense 'Crimson Fire'	#3 Cont
6	Ea	Pocomoke Crape Myrtle	Lagerstroemia indica 'Pocomoke'	#3 Cont
13	Ea	Bugundy Loropetalum	Loropetalun chinense 'Burgundy'	#3 Cont
63	Ea	Firepower Nandina	Nandina domestica 'Fire Power'	#3 Cont
30	Ea	Stoke's Dwarf Yaupon Holly	Ilex vomitoria 'Stoke's Dwarf'	#3 Cont
GROUNDCOVERS & PERENNIALS				
Quan	Unit	Common Name	Botanical Name	Notes
5	Ea	Sargent's Juniper	Juniper chinensis 'Sargentii'	#1 Cont
53	Ea	Big Blue Liriope	Liriope muscari 'Big Blue'	#1 Cont
43	Ea	Pink Muhly Grass	Muhlenbergia capillaris	#1 Cont
13	Ea	Foxtrot Pennisetum	Pennisetum alopecuroides 'Foxtrot'	#1 Cont
32	Ea	Goldsturm Black-Eyed Susan	Rudbeckia fulgida 'Goldsturm'	#1 Cont
32	Ea	Purple Queen Setcreasea	Setcreasea pallida 'Purple Queen'	#1 Cont
52	CY	Mulch		
920	SY	Herbicides (pre & post)		
90	SF	Brick Walk (sub-base, edging)		
3	EA	Plant Bed Removal		
5	EA	Tree Removal		
3	LS	Sign Removal	BY OTHERS	
3	EA	Richlands Sign	(look into DOT providing)	
3	EA	Stone Foundation		
40	CY	Topsoil		

T.I.P. #	STATE PROJECT W.B.S. #	SHEET #	SHEET # TOTAL
-		L 1	6
FED. PROJ. #	DESCRIPTION		DIVISION
-	ENHANCEMENT		3

CONVENTIONAL SYMBOLS

County Line.....	-----
City or Town Line.....	-----
Exist. Right of Way Line Marker.....	-----▲-----
Prop. Right of Way Line Marker (By Others).....	-----▲-----
Prop Right of Way Line Marker (By Contract).....	-----▲-----
Exist. Control of Access Line.....	-----⊕-----
Prop. Control of Access Line.....	-----⊕-----
Property Line.....	-----
Basement Line.....	-----
Slope Stake Line.....	-----
Exist. Fence.....	-----+-----
Prop. Woven Wire Fence.....	-----+-----
Prop. Chain Link Fence.....	-----+-----
Exist. Road.....	=====
Prop. Road.....	=====
Guardrail.....	-----+-----
Survey Line.....	-----
Denotes Line Equality.....	-----⊕-----
Bridge.....	=====
Culvert.....	=====
Railroad.....	-----+-----
Woods.....	-----+-----
Exist. Telephone Pole.....	-----○-----
Prop. Telephone Pole.....	-----○-----
Tower Pole and Line.....	-----+-----
Exist. Power Pole.....	-----○-----
Prop. Power Pole.....	-----○-----
Sanitary Sewer Line.....	-----+-----
Water Line.....	-----+-----
Gas Line.....	-----+-----
Picnic Shelter.....	-----
Regeneration.....	-----
Reforestation.....	-----

INDEX OF L SHEETS:

L 1	... TITLE, DESCRIPTION, LOCATION
L 2	... PLANTING DETAILS
L 3	... DOWNTOWN LANDSCAPE PLAN
L 4 - L 5	... ENTRANCE SIGN LANDSCAPE PLANS
L 6	... SIGN DETAILS

PREPARED BY: BK DATE: 12/2016

REVISIONS

DATE	DESCRIPTION
5/15/17	ADD NOTES

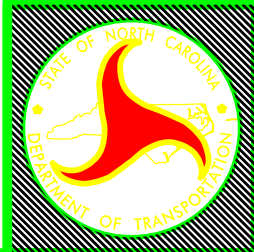

STATE OF  
NORTH CAROLINA  
DEPARTMENT OF TRANSPORTATION

LOCATION: RICHLANDS NC

TYPE of WORK: Gateway & Downtown Landscape Enhancement

COUNTY: ONSLOW COUNTY

2014 American Standard for Nursery Stock  
2012 NCDOT STANDARD SPECIFICATIONS  
PREPARED IN THE OFFICE OF:  
NCDOT- ROADSIDE ENVIRONMENTAL UNIT  
LANDSCAPE DESIGN & DEVELOPMENT SECTION  
1557 MAIL SERVICE CENTER  
RALEIGH NC 27699 919-707-2920

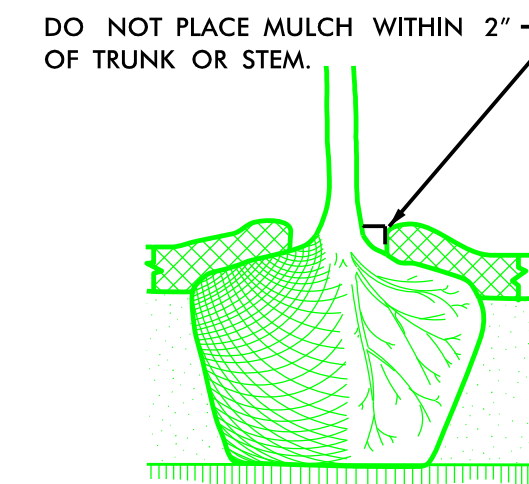
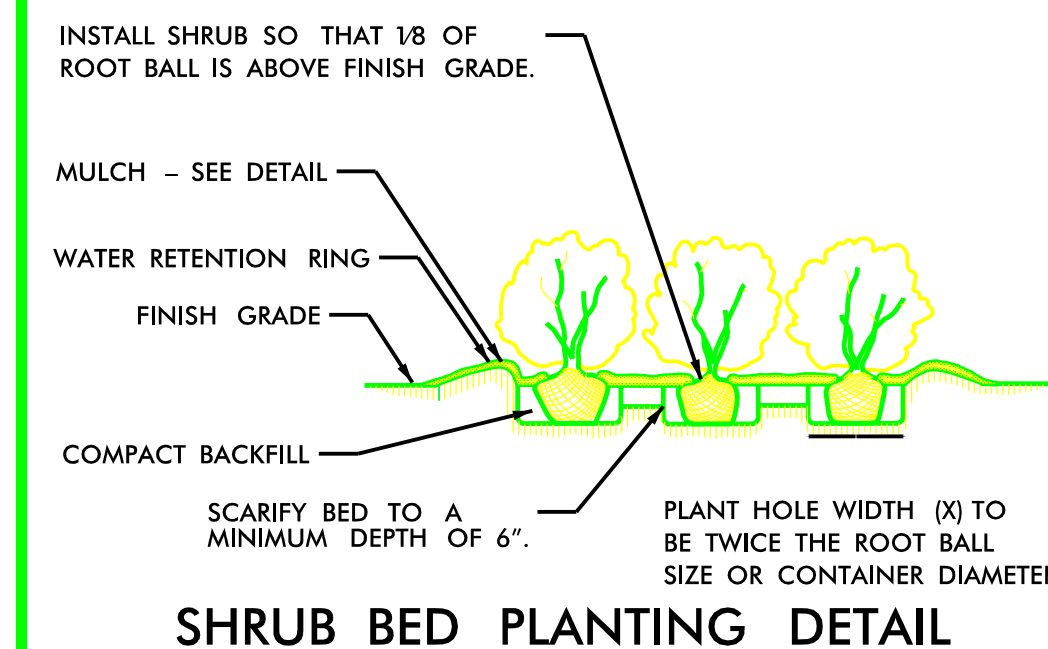
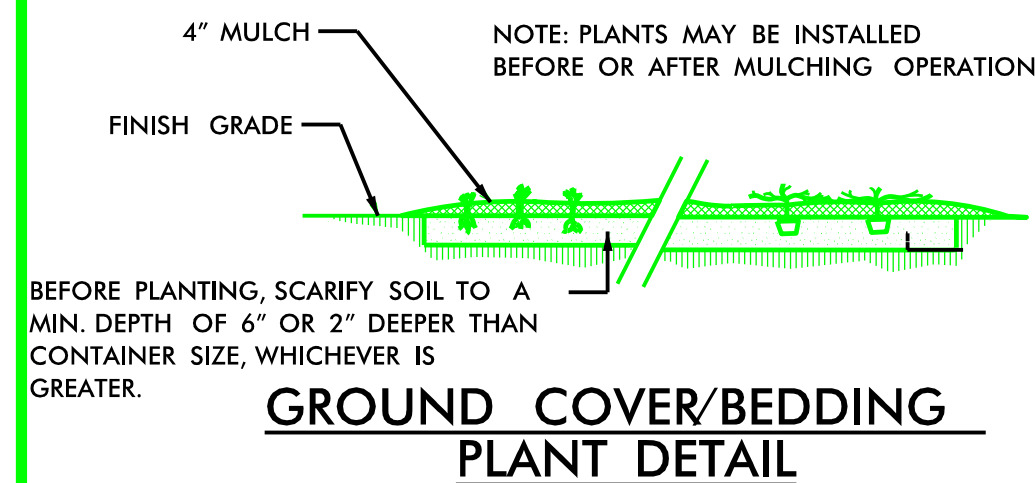
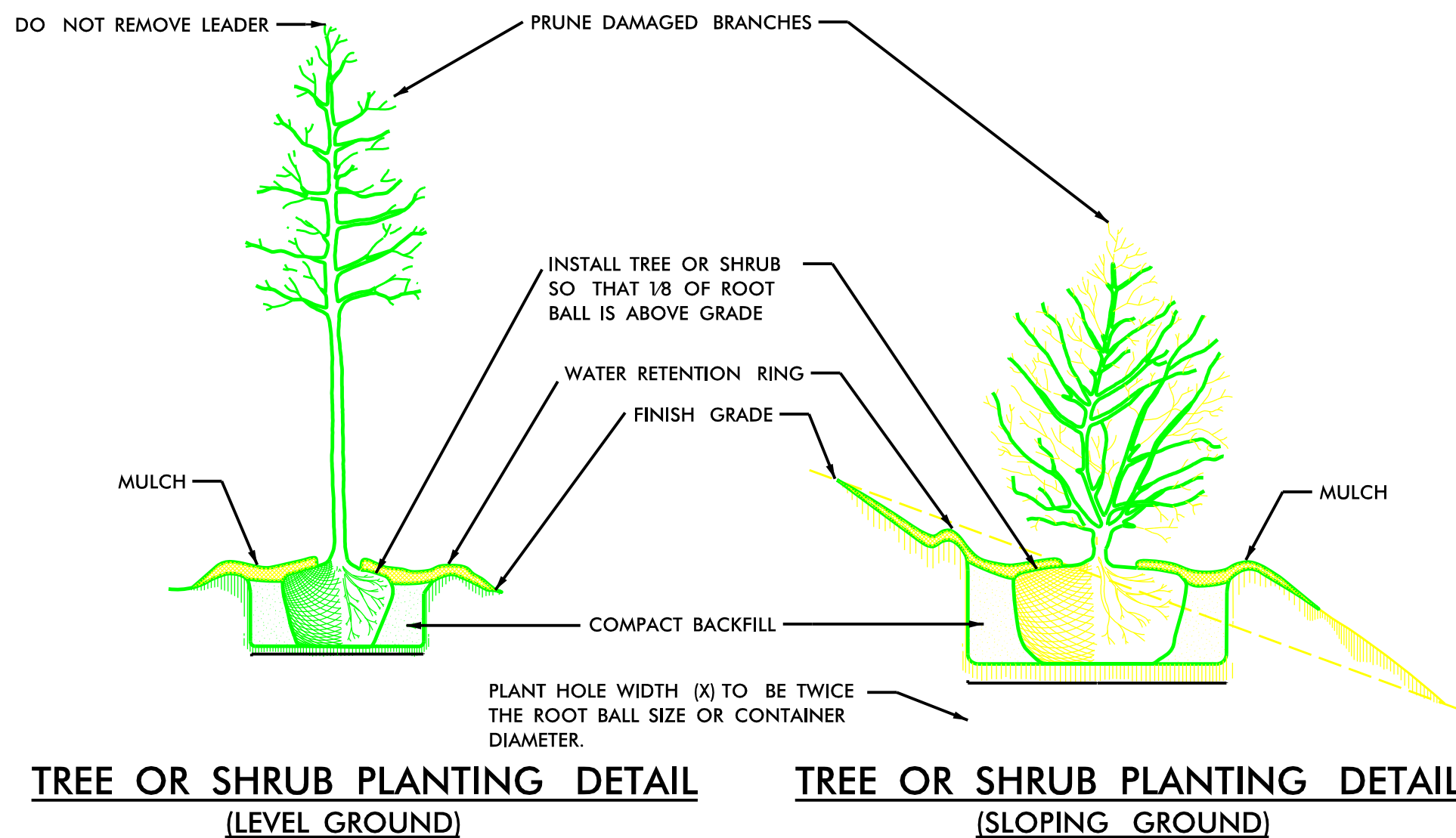

- NOTES:**
- SCHEDULE FOR PLANT HOLE SIZE: PLANT HOLE WIDTH (X) TO BE TWICE THE ROOT BALL SIZE OR CONTAINER DIAMETER.
  - SEE STANDARD SPECIFICATIONS FOR PLANT BED FUMIGATION AND HERBICIDAL TREATMENT.
  - APPLY FERTILIZER AT PLANTING TIME IN THE FORM OF A SLOW RELEASE PELLET OR TABLET. APPLY AT RATE RECOMMENDED BY MANUFACTURER. BOTH RATE AND FORMULATION MUST BE APPROVED BY FIELD ENGINEER PRIOR TO APPLICATION.
  - REMOVE WIRE BASKET AND FOLD BURLAP BACK FROM TOP OF ROOT BALL BEFORE BACKFILLING IS COMPLETE.
  - ALL PRUNING TO FOLLOW STANDARD ARBORICULTURAL PRACTICES AS SPECIFIED BY INTERNATIONAL SOCIETY OF ARBORICULTURE.
  - DO NOT ATTEMPT TO STRAIGHTEN A TREE THAT HAS BEEN PLANTED AT AN ANGLE WITH THE USE OF STAKING OR GUYING. DIG TREE AND REPLANT TO UPRIGHT POSITION.

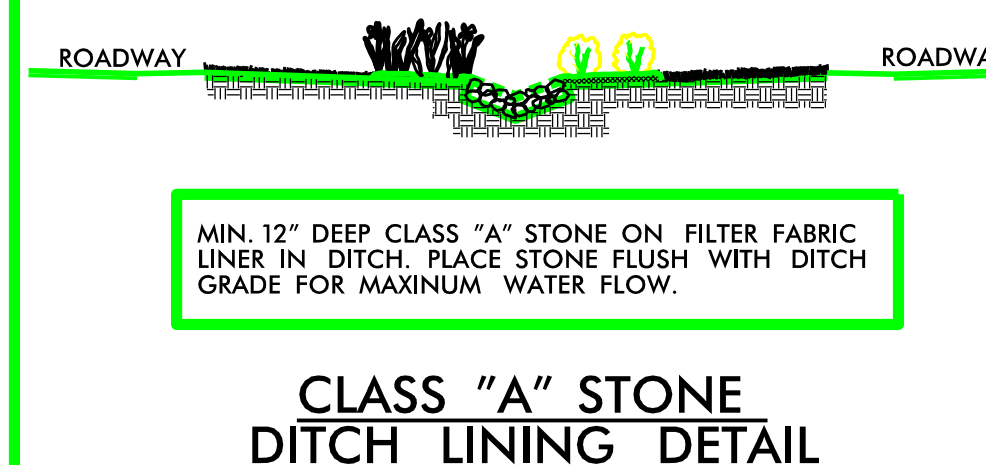
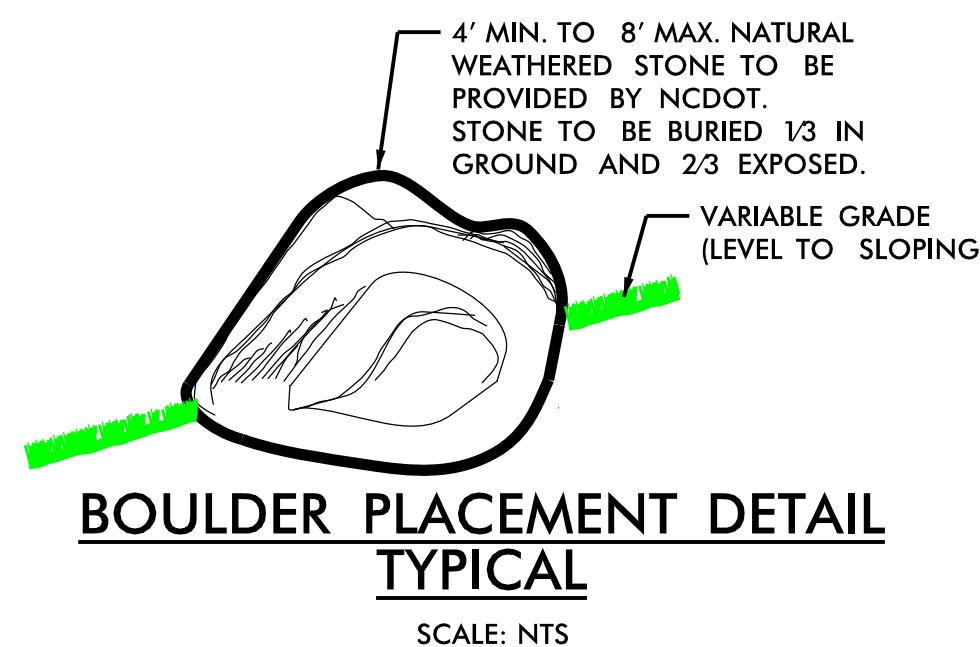
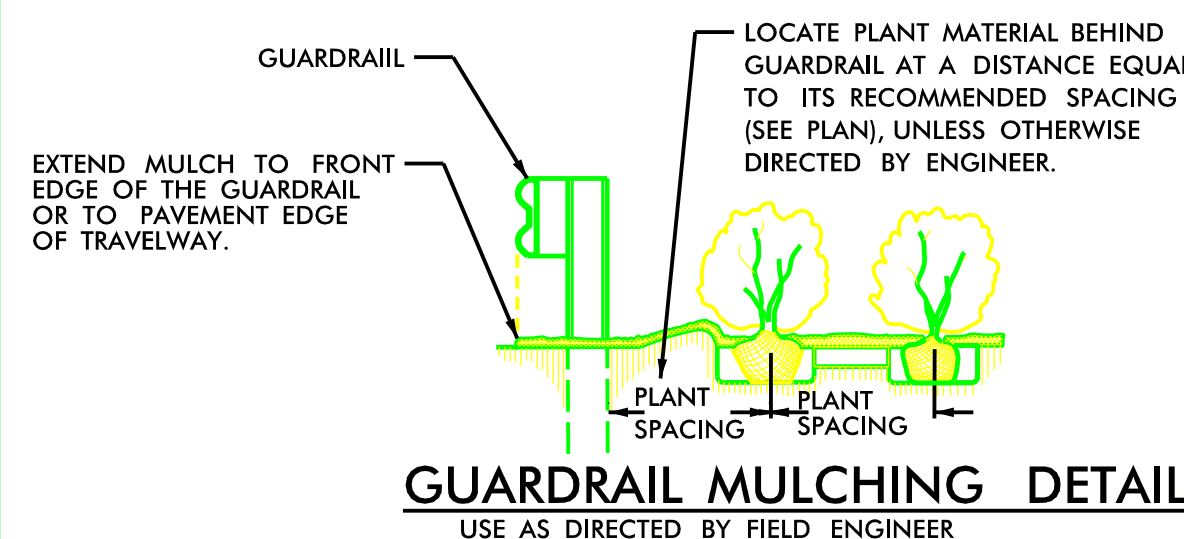
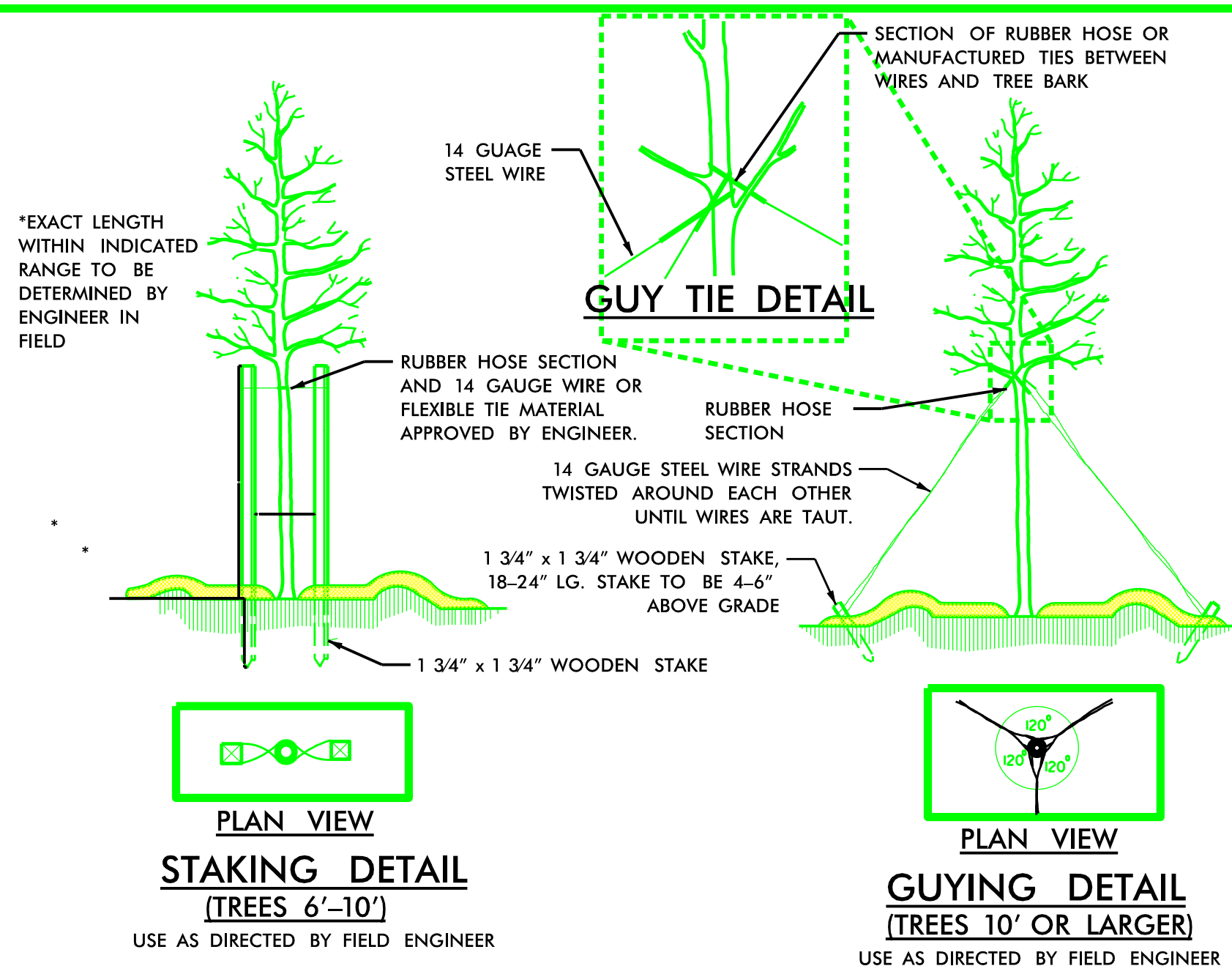





IN LOCATIONS OF PROPOSED PLANTINGS,  
REMOVE AND DISCARD EXISTING  
TURF AND 4" OF TOPSOIL (OR AS  
DIRECTED BY THE NCDOT ENGINEER).

COMMON NAME		NOTES
PLANT KEY	Purple Queen Setcreasea	#1 Cont.
	Goldsturm Black-eyed Susan	#1 Cont.
	Big Blue Lilko	#1 Cont.
	Pink Muhly Grass	#1 Cont.
	Firepower Nandina	#3 Cont., 18" - 24"
	Crimson Fire Loropetalum	#3 Cont., 24" - 30" tall/full
	August Beauty Gardenia	#3 Cont., 18" - 24"
Brick Walk	Potomoke Grape Myrtle	#7 Cont., 30" - 36" tall/full
	Brick Walk	Full Size (4x8) Brick Pavers set on aggregate base and contained by approved brick edging.

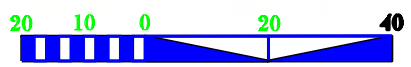

ncdot - Roadside environmental unit  
landscape design & Development  
1557 mail service center raleigh nc 27699-1557  
ph: 919-707-2920 fax: 919-715-2554  
[http://www.ncdot.org/doh/operations/dp\\_chief\\_eng/roadside/](http://www.ncdot.org/doh/operations/dp_chief_eng/roadside/)

## Landscape Development Plan Richlands, NC

RN Kopetsky

sheet description:

prel. design date : May/2016  
checked by & date :  
final design date :

Gateway & Downtown  
Enhancements



T.I.P. #	
WBS #	46305.3.24
FED I.D. #	
sheet no :	total sheet no :
3	6



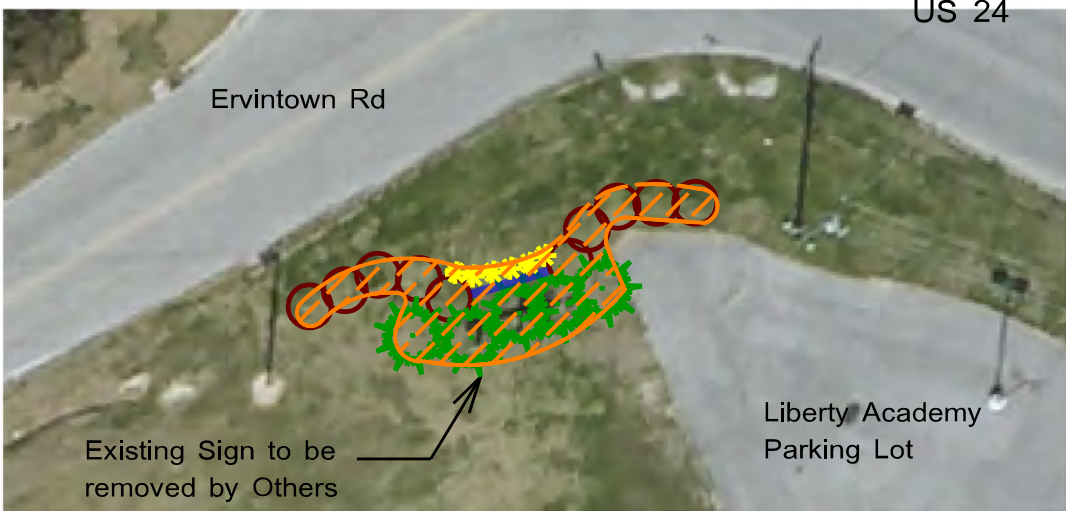

PLAN A - NORTH US 24

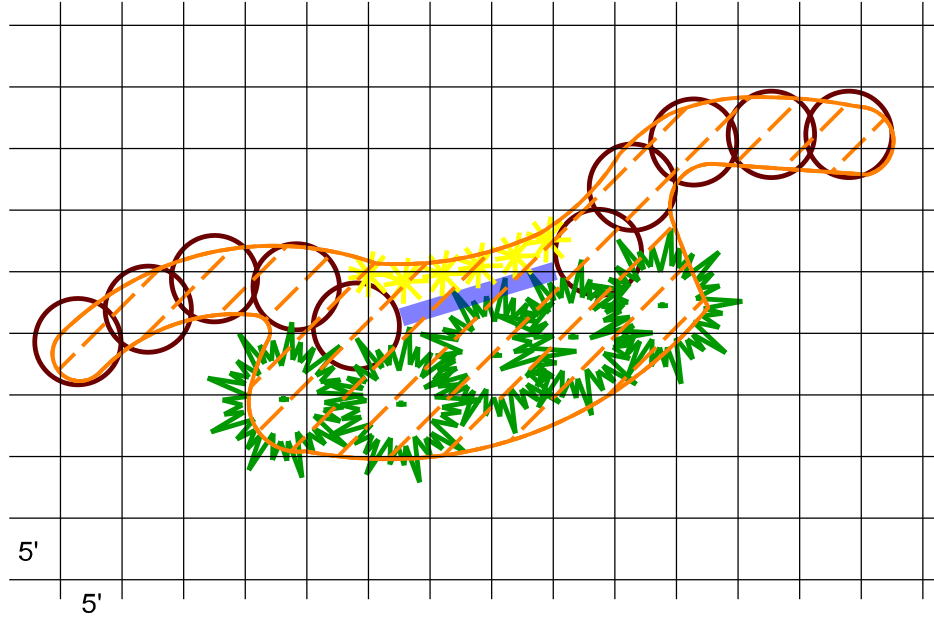

PLAN A DETAIL



PLAN B - SOUTH US 24

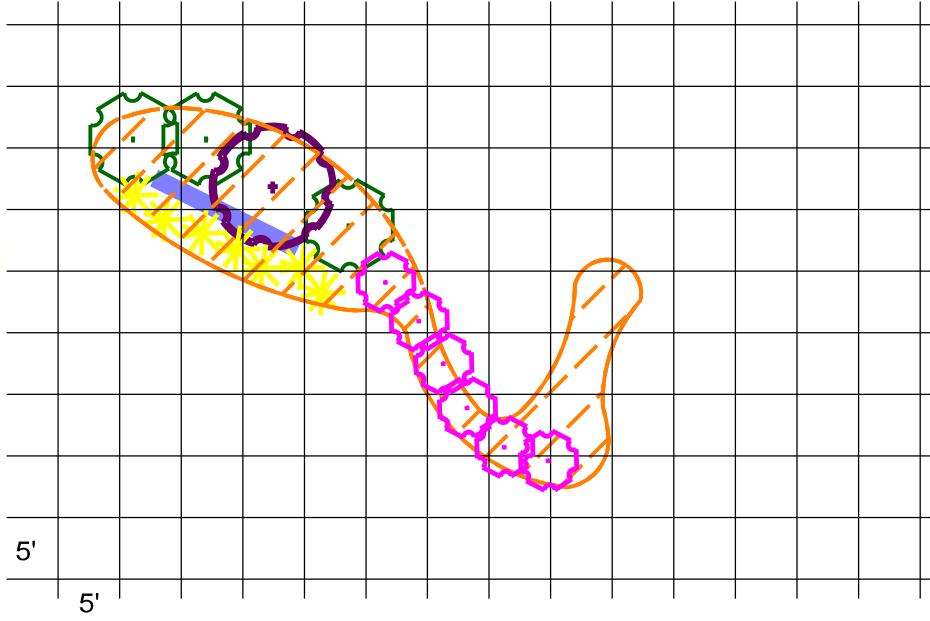

PLAN B DETAIL



SIGN IMAGE

PLANT KEY	COMMON NAME	NOTES
	Sargent Juniper	#1 Cont.
	Foxtrot Pennisetum	#1 Cont.
	Crimson Fire Loropetalum	#3 Cont. 18"- 24"
	Burgundy Loropetalum	#3 Cont. 18"- 24"
	Eastern Redbud	8-10', B & B
	Nellie R Stevens Holly	8-10', B & B
	Green Giant Arborvitae	8-10', B & B
	Plant Bed (mulch)	4" Depth, defined edge

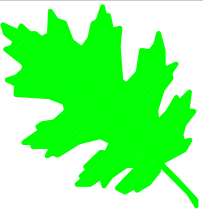
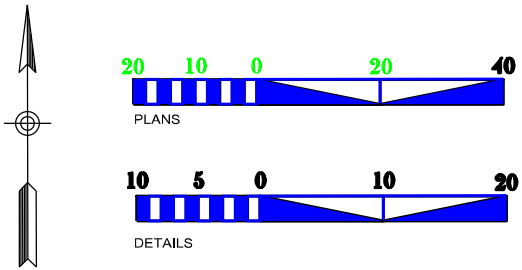

ncdot - Roadside environmental unit  
landscape design & Development  
1557 mail service center raleigh nc 27699-1557  
ph: 919-707-2920 fax: 919-715-2554  
[http://www.ncdot.org/doh/operations/dp\\_chief\\_eng/roadside/](http://www.ncdot.org/doh/operations/dp_chief_eng/roadside/)

Landscape Development Plan  
Richlands, NC

RN Kopetsky

sheet description:	prel. design date : May/2016
	checked by & date :
	final design date :

Gateway Sign Plantings  
Enhancements

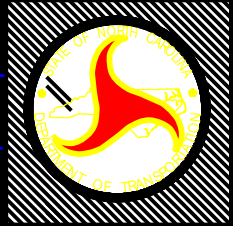

T.I.P. #	WBS # 46305.3.24
FED I.D. #	sheet no : total sheet no :
	4 6





PLAN C - SOUTH FRANCK ST



SIGN IMAGE

PLANT KEY	COMMON NAME	NOTES
	Sargent Juniper	#1 Cont.
	Foxtrot Pennisetum	#1 Cont.
	Crimson Fire Loropetalum	#3 Cont. 18"- 24"
	Burgundy Loropetalum	#3 Cont. 18"- 24"
	Eastern Redbud	8-10', B & B
	Nellie R Stevens Holly	8-10', B & B
	Green Giant Arborvitae	8-10', B & B
	American Boxwood	#3 Cont. 15"- 18"
	Plant Bed (mulch)	4" Depth, defined edge

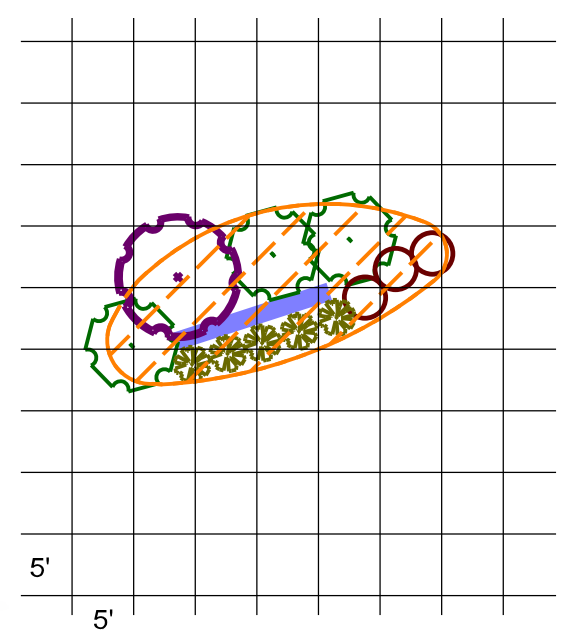

PLAN C DETAIL

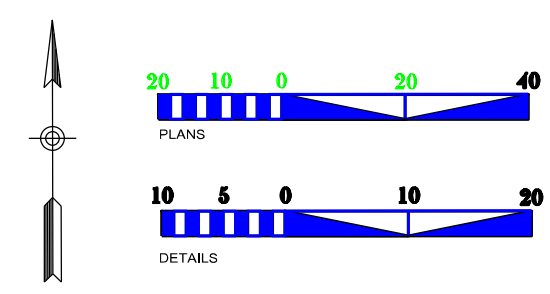

ncdot - Roadside environmental unit  
landscape design & Development  
1557 mail service center raleigh nc 27699-1557  
ph: 919-707-2920 fax: 919-715-2554  
[http://www.ncdot.org/doh/operations/dp\\_chief\\_eng/roadside/](http://www.ncdot.org/doh/operations/dp_chief_eng/roadside/)

Landscape Development Plan  
Richlands, NC

RN Kopetsky

sheet description:	prel. design date :	May/2016	Gateway Sign Plantings
	checked by & date :		Enhancements
	final design date :		

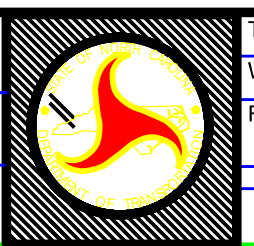

T.I.P. #	WBS #	46305.3.24
FED I.D. #	sheet no :	total sheet no :
	5	6



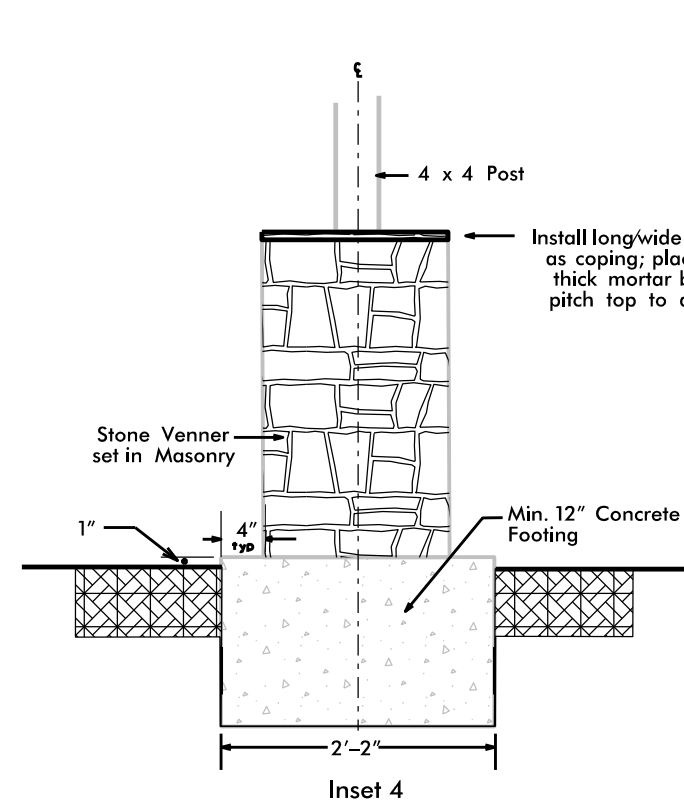

ELEVATION A - RICHLANDS ENTRANCE SIGN

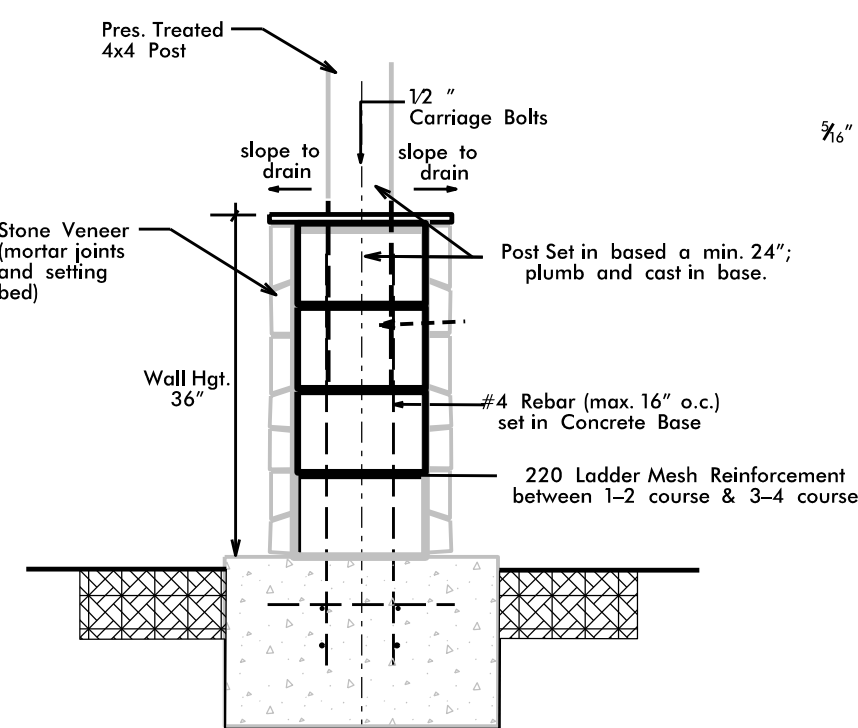

SECTION A - RICHLANDS ENTRANCE SIGN

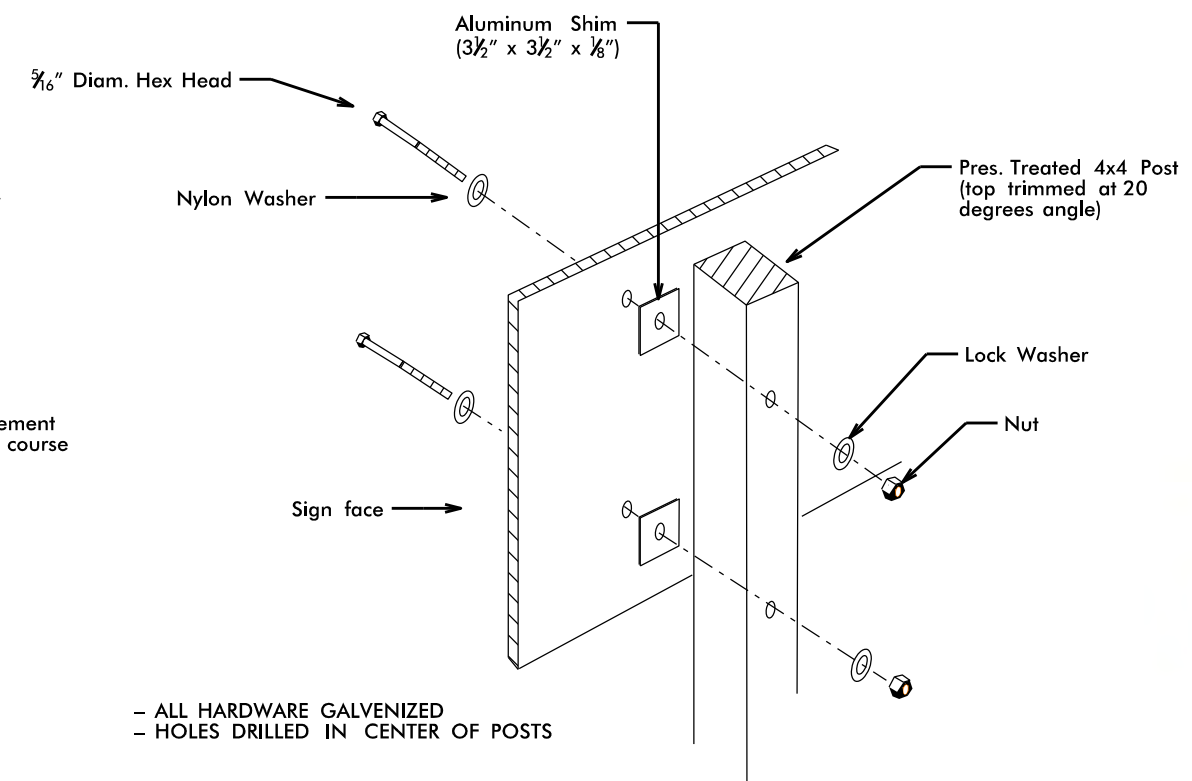

SIGN MOUNTING DETAIL



SIGN IMAGE

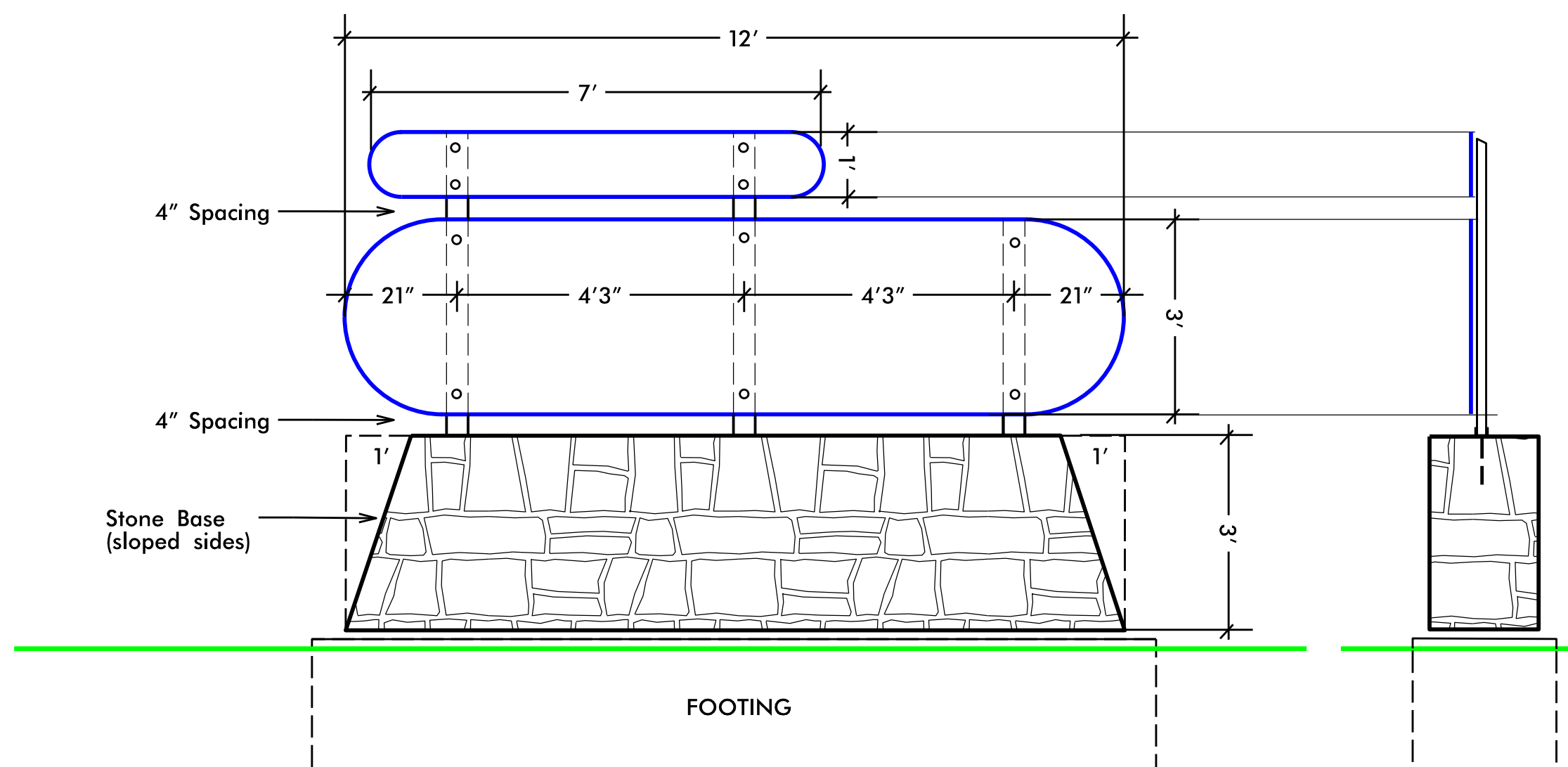

ELEVATION B - RICHLANDS ENTRANCE SIGN

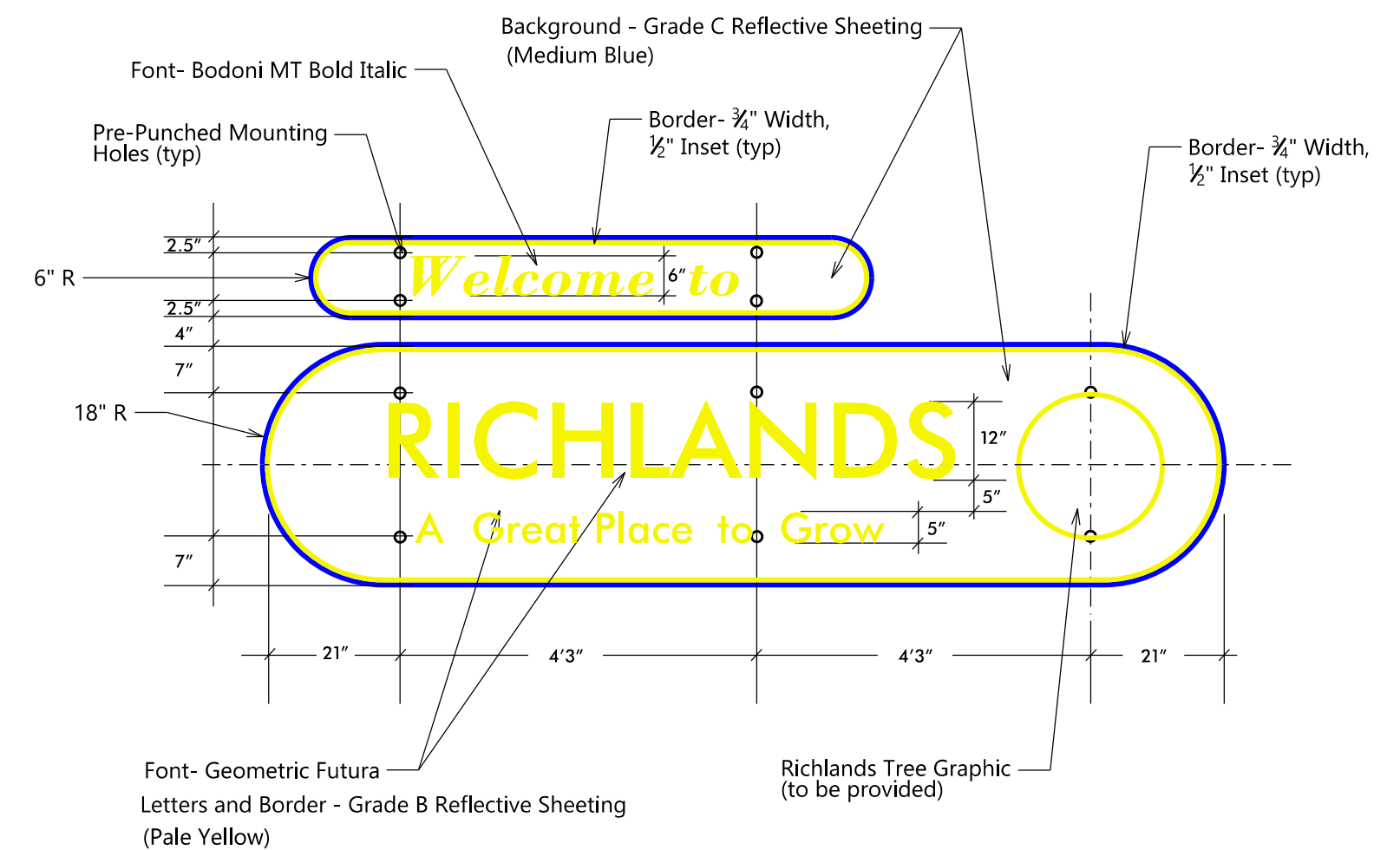

Sign Material - 0.125" (32 mm) Aluminum

SAMPLE SIGN GRAPHIC AND LAYOUT TO BE APPROVED BY ENGINEER PRIOR TO FABRICATION

SIGN LAYOUT DETAIL

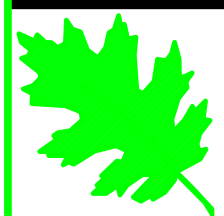

ncdot - Roadside environmental unit  
landscape design & Development  
1557 mail service center raleigh nc 27699-1557  
ph: 919-707-2920 fax: 919-715-2554  
[http://www.ncdot.org/doh/operations/dp\\_chief\\_eng/roadside/](http://www.ncdot.org/doh/operations/dp_chief_eng/roadside/)

Landscape Development Plan  
Richlands, NC

RN Kopetsky

prel. design date : May/2016  
checked by & date :  
final design date :

Gateway & Downtown  
Enhancements  
Sign Details



T.I.P. #  
WBS # 46305.3.24  
FED I.D. #  
sheet no : 6 total sheet no : 6