

PENDER COUNTY - CONT.

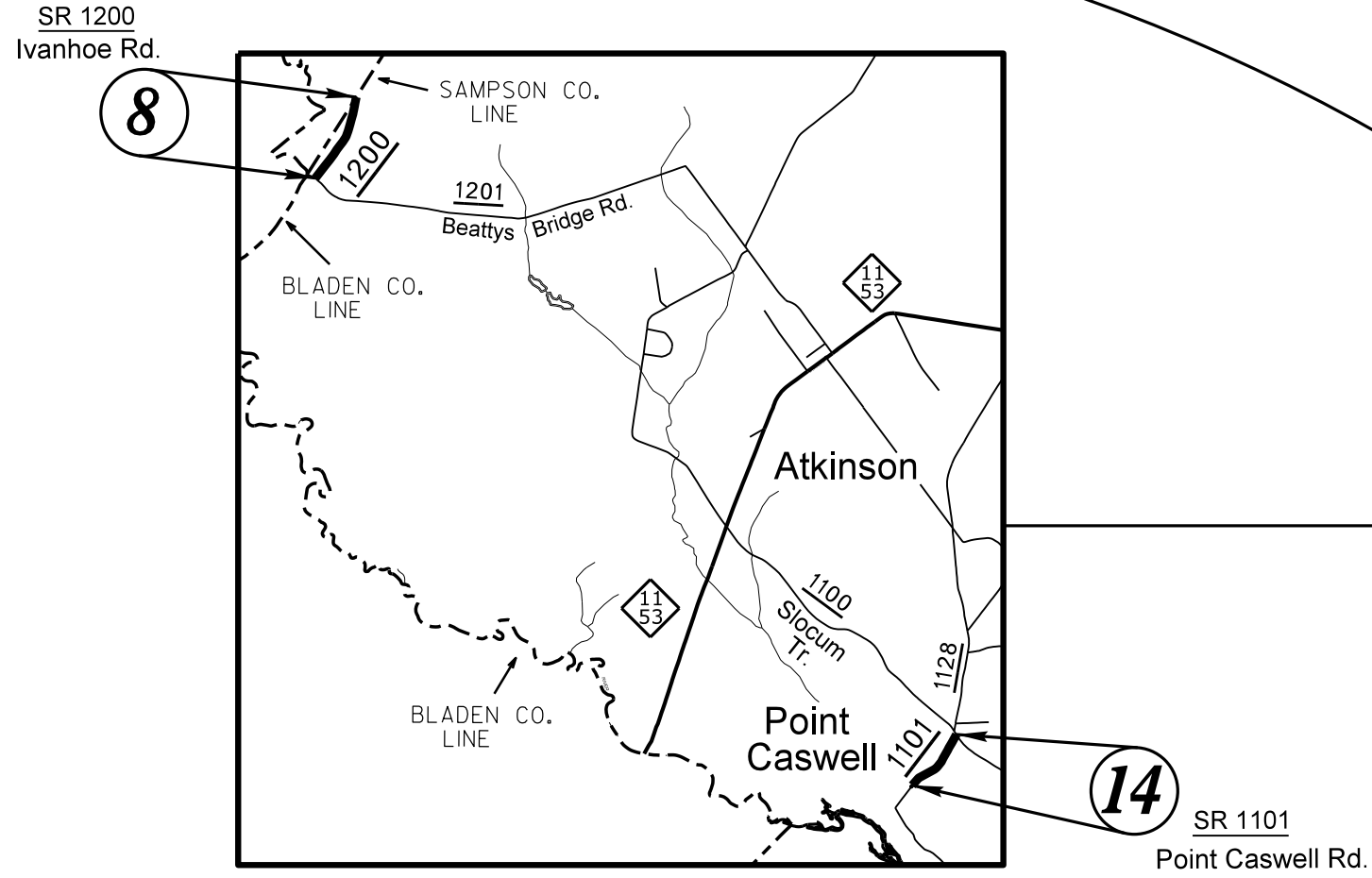
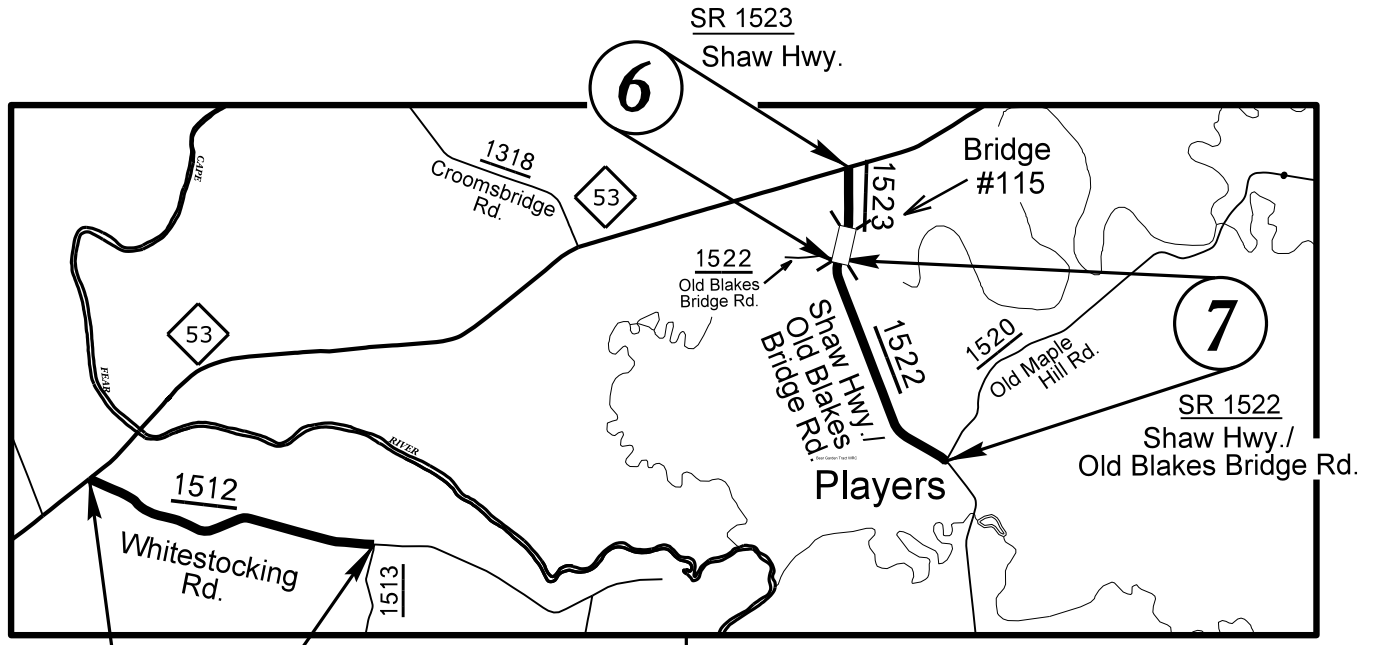
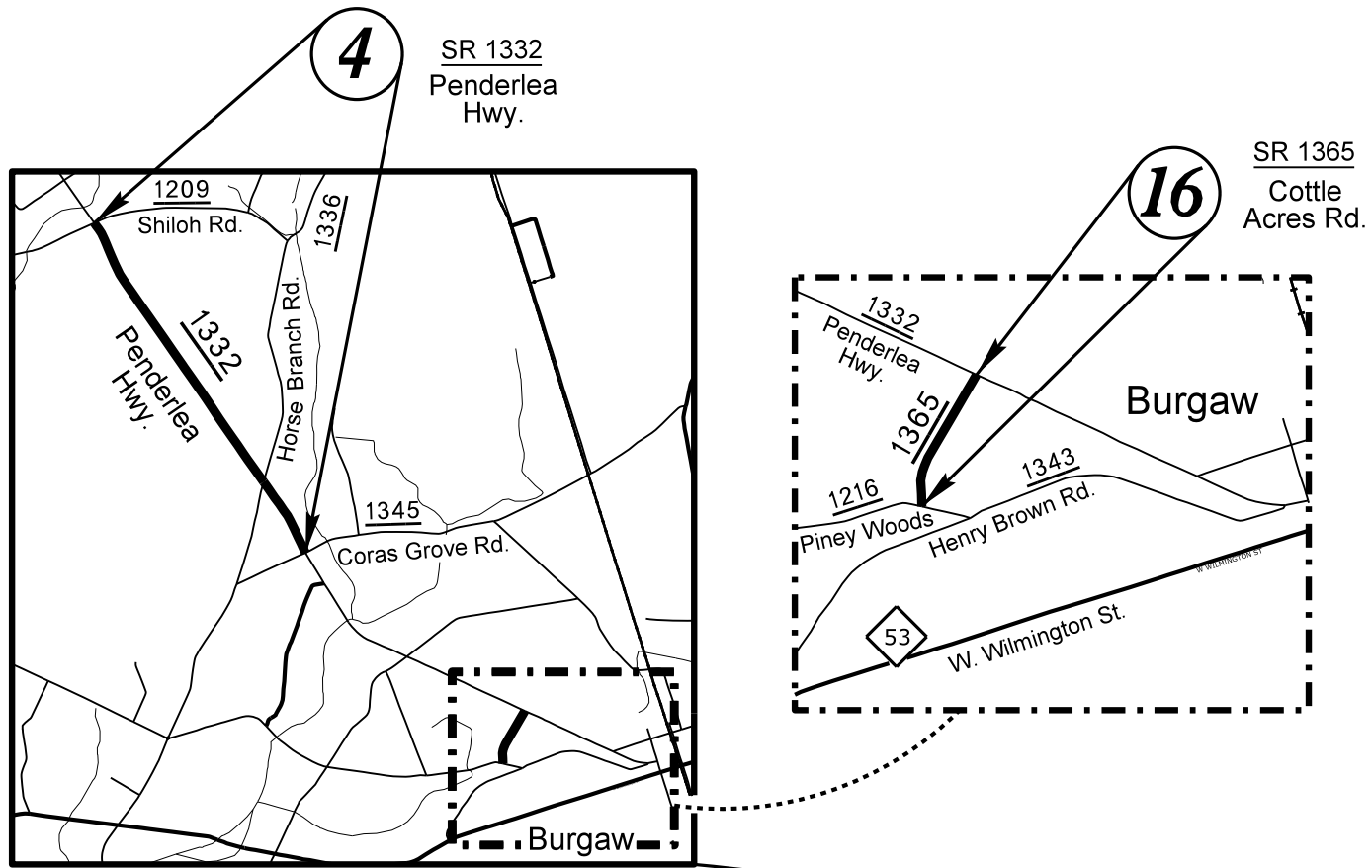

MAPS N.T.S.

REVISIONS

17-Jul-2018 14:57 S:\Division\Resurfacing\Resurfacing_Data\2019 - 2020 Resurfacing\Resurfacing\Resurfacing\2019CPT.03.11.20711, ETC\2019CPT.03.11.20711_rdy_tah.dgn

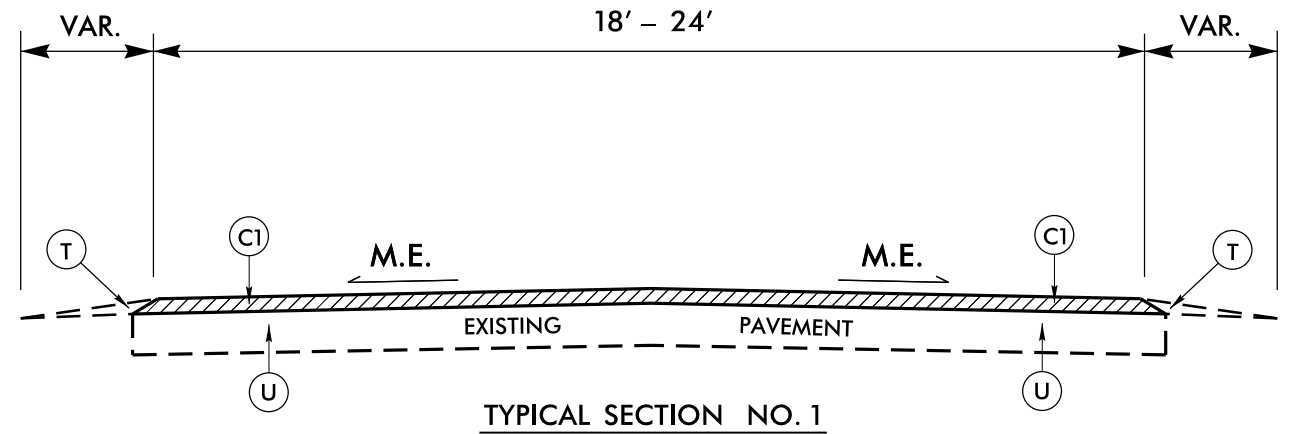

TYPICAL SECTION NO. 1

- | | | |
|---|---|--|
| MAP NO. 1
SR 1400 (HIGHSMITH RD.)
MP 0.00 – MP 4.39 | MAP NO. 5
SR 1592 (ST. JOHNS CHURCH RD.)
MP 0.00 – MP 0.67 | MAP NO. 8
SR 1200 (IVANHOE RD.)
MP 0.00 – MP 0.85 |
| MAP NO. 2
SR 1512 (WHITESTOCKING RD.)
MP 0.00 – MP 1.71 | MAP NO. 6
SR 1523 (SHAW HWY.)
MP 0.00 – MP 0.52
NO PAVING BRIDGE NO. 115 | MAP NO. 9
SR 1328 (GARDEN RD.)
MP 0.47 – MP 1.66 |
| MAP NO. 3
SR 1627 (MAPLE RD.)
MP 0.00 – MP 0.21 | MAP NO. 7
SR 1522 (SHAW HWY/
OLD BLAKES BRIDGE RD.)
MP 0.00 – MP 1.35 | MAP NO. 10
SR 1425 (BALCOMBRE RD.)
MP 0.00 – MP 0.99 |
| MAP NO. 4
SR 1332 (PENDERLEA HWY.)
MP 3.76 – MP 7.25 | | |

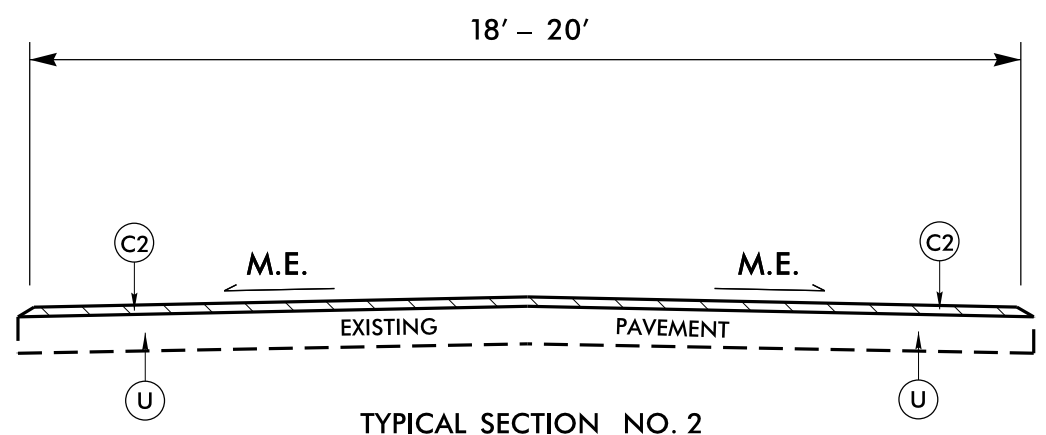

TYPICAL SECTION NO. 2

- | | | | | |
|--|--|--|---|---|
| MAP NO. 11
SR 1319 (PELHAM RD/
ELEANOR ROOSEVELT LN.)
MP 5.10 – MP 5.78 | MAP NO. 13
SR 1703 (LAFAYETTE ST.)
MP 0.00 – MP 0.29 | MAP NO. 15
SR 1326 (GIDDEONS POND RD.)
MP 0.00 – MP 0.47 | MAP NO. 17
SR 1355 (WEST WILLARLEA RD.)
MP 0.00 – MP 0.05 | MAP NO. 19
SR 1325 (SILL CREEK RD.)
MP 0.00 – MP 1.21
NO PAVING BRIDGE NO. 202 |
| MAP NO. 12
SR 1660 (OAKVALE RD.)
MP 0.00 – MP 0.15 | MAP NO. 14
SR 1101 (POINT CASWELL RD.)
MP 0.00 – MP 0.69 | MAP NO. 16
SR 1365 (COTTLE ACRES RD.)
MP 0.00 – MP 0.51 | MAP NO. 18
SR 1356 (EAST WILLARLEA RD.)
MP 0.00 – MP 0.05 | |

PAVEMENT SCHEDULE	
C1	PROP. APPROX. 1½" DEPTH ASPHALT CONCRETE SURFACE COURSE, TYPE S9.5B, AT AN AVERAGE RATE OF 168 LBS. PER SQ.YD.
C2	PROP. APPROX. ¾" DEPTH ASPHALT CONCRETE SURFACE COURSE, TYPE S4.75A, AT AN AVERAGE RATE OF 85 LBS. PER SQ.YD.
T	EARTH MATERIAL (SHOULDER RECONSTRUCTION)
U	EXISTING PAVEMENT

PAVEMENT EDGE SLOPES ARE 1:1, EXCEPT FINAL SURFACE COURSE. SEE SHOULDER WEDGE DETAIL.

EFF.01-16-2018
REV.

2018 ROADWAY ENGLISH STANDARD DRAWINGS

The following Roadway Standards as appear in "Roadway Standard Drawings" Highway Design Branch - N.C. Department of Transportation - Raleigh, N.C., Dated January, 2018 are applicable to this project and by reference hereby are considered a part of these plans:

STD.NO.	TITLE
DIVISION 8 - INCIDENTALS	
862.01	Guardrail Placement
862.02	Guardrail Installation
862.03	Structure Anchor Units

8/17/99
 - 2020_Resurfacing_Pender_2019CPT.03.11.10711_ETC_2019CPT.03.11.20711_rdy.txd.dgn
 17-Jul-2018 15:39
 S:\Division_Resurfacing\Resurfacing_Data\2019

- NOTES:
- 1) DETAIL DOES NOT APPLY TO OGAFB AND ULTRA-THIN BONDED WEARING COURSE.
 - 2) BACKFILL SHOULDER WITH APPROVED MATERIAL.
 - 3) THE SHOULDER WEDGE DEVICE MAY BE DISENGAGED AT PAVED DRIVEWAYS, SIDE STREETS, HIGH SHOULDERS, AND OTHER LOCATIONS NOT FEASIBLE TO CONSTRUCT AS APPROVED BY THE ENGINEER.

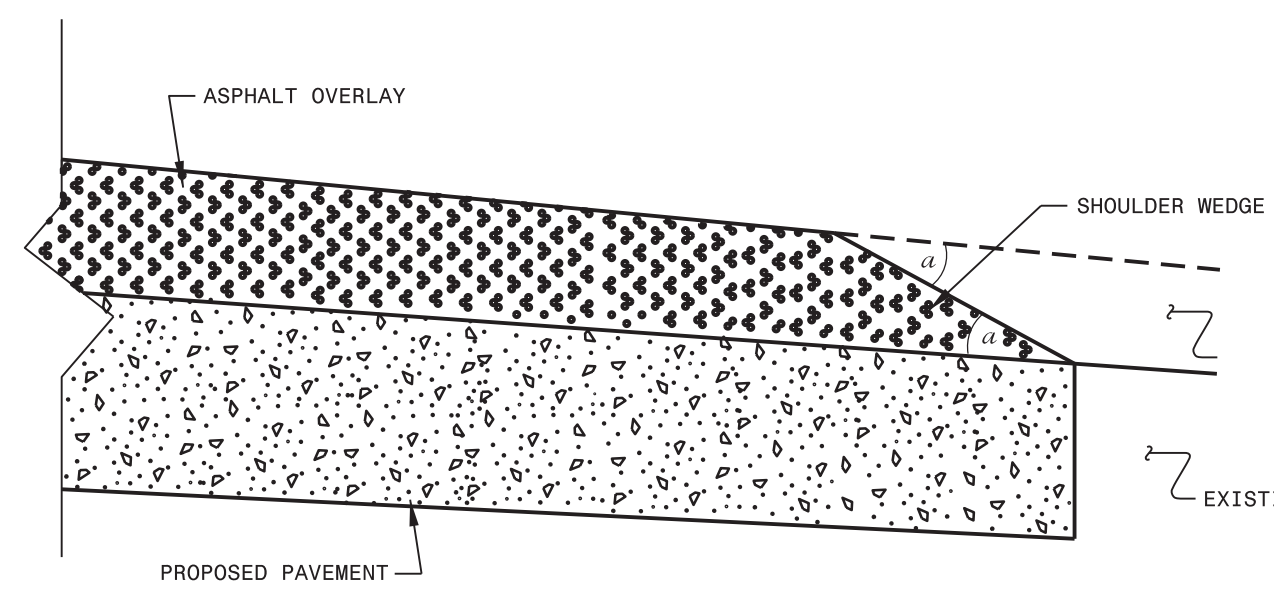

SHOULDER WEDGE DETAIL
 (Resurfacing Projects w/ Widening or
 with Existing Paved Shoulder having no dropoffs)

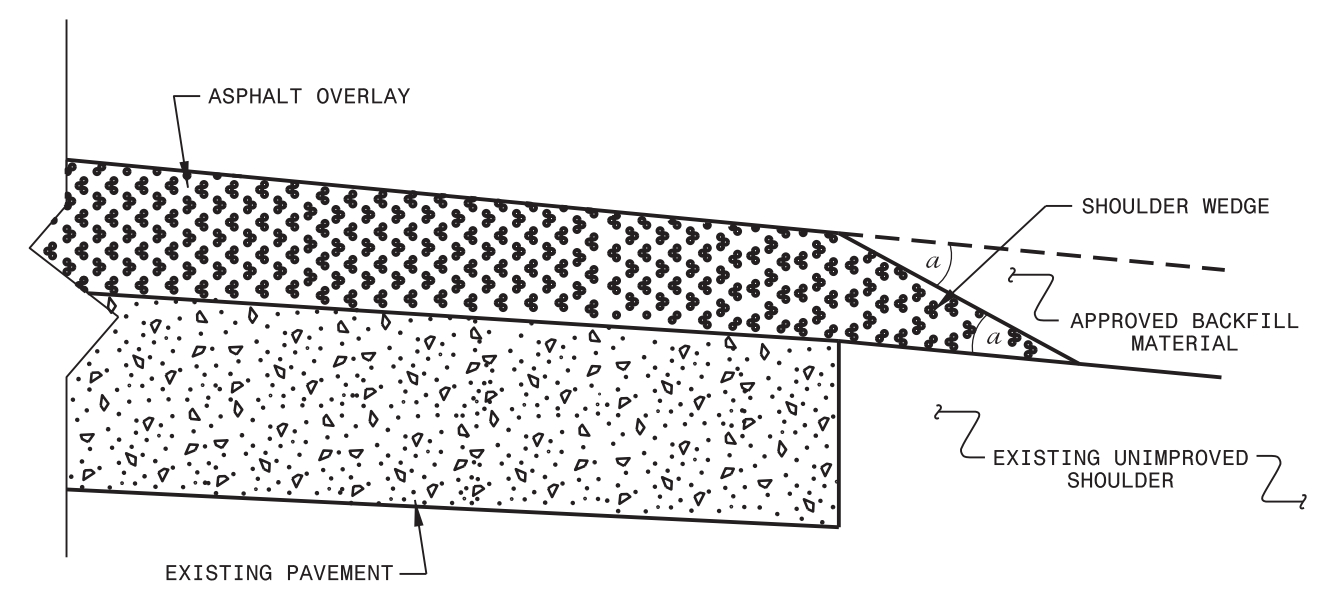

SHOULDER WEDGE DETAIL
 (Resurfacing Projects w/ NO Widening)

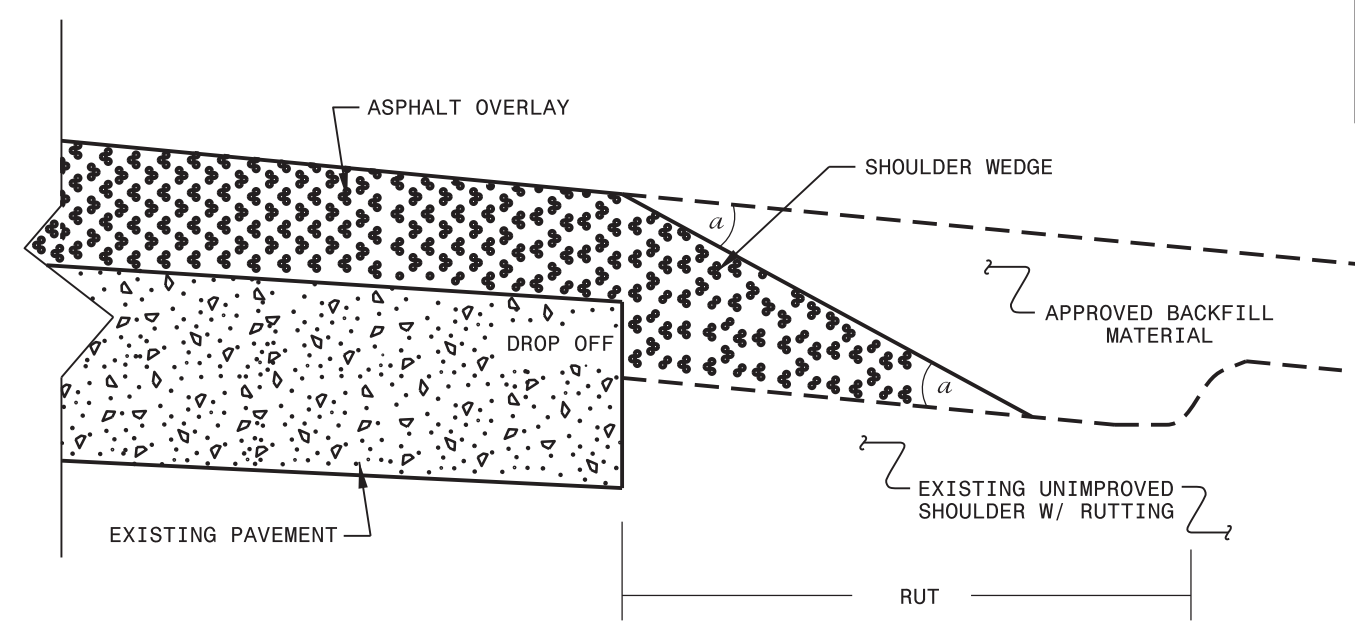

SHOULDER WEDGE DETAIL
 (Resurfacing Adjacent to
 Rutted Shoulder)

- SHOULDER WEDGE ANGLE = 30°

CONTRACT STANDARDS AND DEVELOPMENT UNIT			
Office 919-707-6950		FAX 919-250-4119	
SHOULDER WEDGE DETAILS			
ORIGINAL BY: T.SPELL	DATE: 7-19-11		
MODIFIED BY:	DATE: 2/2/16		
CHECKED BY:	DATE:		
FILE SPEC.: susr/details/stand/shoulderwedgedetail.dgn			

SYSTEMS DESIGN USER NAME

PROJECT NO.	SHEET NO.
2019CPT.03.11.20711, ETC.	8

SUMMARY OF QUANTITIES

PROJECT NO	COUNTY	MAP NO	ROUTE	DESCRIPTION	TYP NO	LANES	LANE TYPE	FINAL SURFACE TESTING REQUIRED	6012000000-E	6015000000-E	6018000000-E	6021000000-E	6036000000-E	6042000000-E	6071010000-E	6084000000-E	6090000000-E	6093000000-E	6117000000-N
									SEDIMENT CONTROL STONE	TEMPORARY MULCHING	SEED FOR TEMPORARY SEEDING	FERTILIZER FOR TEMPORARY SEEDING	MATTING FOR EROSION CONTROL	1/4" HARDWARE CLOTH	WATTLE	SEED & MULCHING	SEED FOR REPAIR SEEDING	FERTILIZER FOR REPAIR SEEDING	RESPONSE FOR EROSION CONTROL
									TON	ACR	LBS	TON	SY	LF	LF	AC	LB	TON	EA
2019CPT.03.11.20711	Pender	1	SR 1400 (HIGHSMITH RD)	FROM NC 210 TO SR 1401 [MP 0.00 - 4.39]	1	2	2WU	NO	110	4.39	220	1.10	30	220.0	70	2.13	220	1.10	1
TOTAL FOR MAP NO. 1									110	4.39	220	1.10	30	220.0	70	2.13	220	1.10	1
2019CPT.03.11.20711	Pender	2	SR 1512 (WHITESTOCKING RD)	FROM NC 53 TO SR 1513 [MP 0 - 1.71]	1	2	2WU	NO	43	1.71	86	0.43	20	86.0	30	0.83	86	0.43	1
TOTAL FOR MAP NO. 2									43	1.71	86	0.43	20	86.0	30	0.83	86	0.43	1
2019CPT.03.11.20711	Pender	3	SR 1627 (MAPLE RD)	FROM SR 1411 (OLD RIVER RD) TO DEAD END [MP 0.00 - 0.21]	1	2	2WU	NO	5	0.21	11	0.05	10	11.0	10	0.10	11	0.05	
TOTAL FOR MAP NO. 3									5	0.21	11	0.05	10	11.0	10	0.10	11	0.05	
2019CPT.03.11.20711	Pender	4	SR 1332 (PENDERLEA HWY)	FROM SR 1345 (CORA'S GROVE RD) TO SR 1209 (SHILOH RD) [MP 3.76 - 7.25]	1	2	2WU	NO	87	3.49	175	175.00	30	175.0	60	1.69	175	0.05	1
TOTAL FOR MAP NO. 4									87	3.49	175	175.00	30	175.0	60	1.69	175	0.05	1
2019CPT.03.11.20711	Pender	5	SR 1592 (ST JOHNS CHURCH RD)	BEGINNING OF PAVEMENT TO END MAINT. [MP 0.00 - 0.67]	1	2	2WU	NO	17	0.67	34	0.16	10	34.0	20	0.32	34	0.16	
TOTAL FOR MAP NO. 5									17	0.67	34	0.16	10	34.0	20	0.32	34	0.16	
2019CPT.03.11.20711	Pender	6	SR 1523 (SHAW HWY)	FROM SR 1522 (OLD BLAKES RD) TO NC 53 [MP 0.00 - 0.52]	1	2	2WU	NO	13	0.52	26	0.13	10	26.0	10	0.25	26	0.13	
TOTAL FOR MAP NO. 6									13	0.52	26	0.13	10	26.0	10	0.25	26	0.13	
2019CPT.03.11.20711	Pender	7	SR 1522 (SHAW HWY/OLD BLAKES BRIDGE RD)	FROM SR 1520 (OLD MAPLE HILL RD) TO SR 1523 (SHAW HWY) [MP 0.00 - 1.23]	1	2	2WU	NO	34	1.35	68	0.34	20	68.0	30	0.65	68	0.33	1
TOTAL FOR MAP NO. 7									34	1.35	68	0.34	20	68.0	30	0.65	68	0.33	1
2019CPT.03.11.20711	Pender	8	SR 1200 (IVANHOE RD)	FROM SR 1201 (BEATTY'S BRIDGE RD) TO SAMPSON CO [MP 0.00 TO 0.85]	1	2	2WU	NO	21	0.85	43	0.21	10	43.0	20	0.82	43	0.21	
TOTAL FOR MAP NO. 8									21	0.85	43	0.21	10	43.0	20	0.82	43	0.21	
2019CPT.03.11.20711	Pender	9	SR 1328 (GARDEN RD/RACCOON RD)	FROM NC 11 TO NC 11 [MP 0.47 - 1.66]	1	2	2WU	NO	30	1.19	60	0.30	10	59.5	20	0.87	60	0.30	1
TOTAL FOR MAP NO. 9									30	1.19	60	0.30	10	59.5	20	0.87	60	0.30	1
2019CPT.03.11.20711	Pender	10	SR 1425 (BALCOMBE RD)	FROM NC 210 TO END OF PAVEMENT [MP 0.00 - 0.99]	1	2	2WU	NO	25	0.99	50	0.25	10	49.5	20	0.72	50	0.25	
TOTAL FOR MAP NO. 10									25	0.99	50	0.25	10	49.5	20	0.72	50	0.25	
TOTAL FOR PROJ NO. 2019CPT.03.11.20711									385	15.37	773	177.97	160	772.0	290	8.38	773	3.01	5
2019CPT.03.11.20712	Pender	11	SR 1319 (PELHAM RD/ELEANOR ROOSEBELT LN)	FROM SR 1328 (GARDEN RD) TO SR 1328 (RACCOON RD) [MP 5.10 - 5.78]	2	2	2WU	NO											
TOTAL FOR MAP NO. 11																			
2019CPT.03.11.20712	Pender	12	SR 1660 (OAKVALE RD)	FROM SR 1571 (SCOTTS HILL LOOP RD) TO SR 1662 (LAFAYETTE ST) [MP 0.00 - 0.15]	2	2	2WU	NO											
TOTAL FOR MAP NO. 12																			
2019CPT.03.11.20712	Pender	13	SR 1703 (LAFAYETTE ST)	FROM SR 1621 (POPLAR GROVE RD) TO CUL-DE-SAC [MP 0.00 - 0.29]	2	2	2WU	NO											
TOTAL FOR MAP NO. 13																			
2019CPT.03.11.20712	Pender	14	SR 1101 (POINT CASWELL RD)	FROM SR 110 (SLOCUM TRAIL RD) TO END OF PAVEMENT [MP 0.00 - 0.69]	2	2	2WU	NO											
TOTAL FOR MAP NO. 14																			
2019CPT.03.11.20712	Pender	15	SR 1326 (GIDDEONS POND RD)	FROM NC 11 TO SR 1325 (SILL CREEK RD) [MP 0.00 - 0.47]	2	2	2WU	NO											
TOTAL FOR MAP NO. 15																			
2019CPT.03.11.20712	Pender	16	SR 1365 (COTTLE ACRES)	FROM SR 1216 (PINEY WOODS RD) TO SR 1332 (PENDERLEA HWY) [MP 0.00 - 0.51]	2	2	2WU	NO											
TOTAL FOR MAP NO. 16																			
2019CPT.03.11.20712	Pender	17	SR 1355 (WEST WILLARLEA RD)	FROM SR 1319 (ELEANOR ROOSEVELT LN) TO NC 11 [MP 0.00 - 0.05]	2	2	2WU	NO											
TOTAL FOR MAP NO. 17																			
2019CPT.03.11.20712	Pender	18	SR 1356 (EAST WILLARLEA RD)	FROM SR 1319 (ELEANOR ROOSEVELT LN) TO NC 11 [MP 0.00 - 0.05]	2	2	2WU	NO											
TOTAL FOR MAP NO. 18																			
2019CPT.03.11.20712	Pender	19	SR 1325 (SILL CREEK RD)	FROM SR 1328 (GARDEN RD/RACCOON RD) TO SR 1324 (CROOKED RUN RD) [MP 0.00 - 1.21]	2	2	2WU	NO											
TOTAL FOR MAP NO. 19																			
TOTAL FOR PROJ NO. 2019CPT.03.11.20712																			
GRAND TOTAL									385	15.37	773	177.97	160	772.0	290	8.38	773	3.01	5

THERMOPLASTIC AND PAINT QUANTITIES

PROJECT NO	COUNTY	MAP NO	ROUTE	DESCRIPTION	TYP NO	LANES	LANE TYPE	441300000-E		445700000-N		481000000-E		485000000-E		490000000-N	
								WORK ZONE ADVANCE/GENERAL WARNING SIGNING	TEMPORARY TRAFFIC CONTROL	4" WHITE PAINT	4" YELLOW PAINT	REMOVAL OF PAVEMENT MARKING LINES (4")	YELLOW & YELLOW MARKERS				
								MI	FT	SF	LS	LF	LF	LF	EA		
2019CPT.03.11.20711	Pender	1	SR 1400 (HIGHSMITH RD)	FROM NC 210 TO SR 1401 [MP 0.00 - 4.39]	1	2	2WU	4.39	20	496	0.22	94,622	57,948			290	
TOTAL FOR MAP NO. 1								4.39		496	0.22	94,622	57,948			290	
2019CPT.03.11.20711	Pender	2	SR 1512 (WHITESTOCKING RD)	FROM NC 53 TO SR 1513 [MP 0 - 1.71]	1	2	2WU	1.71	18	192	0.09	36,900	22,572			113	
TOTAL FOR MAP NO. 2								1.71		192	0.09	36,900	22,572			113	
2019CPT.03.11.20711	Pender	3	SR 1627 (MAPLE RD)	FROM SR 1411 (OLD RIVER RD) TO DEAD END [MP 0.00 - 0.21]	1	2	2WU	0.21	18	32	0.01	4,550	2,772			14	
TOTAL FOR MAP NO. 3								0.21		32	0.01	4,550	2,772			14	
2019CPT.03.11.20711	Pender	4	SR 1332 (PENDERLEA HWY)	FROM SR 1345 (CORA'S GROVE RD) TO SR 1209 (SHILOH RD) [MP 3.76 - 7.25]	1	2	2WU	3.49	20	400	0.18	75,390	46,068			231	
TOTAL FOR MAP NO. 4								3.49		400	0.18	75,390	46,068			231	
2019CPT.03.11.20711	Pender	5	SR 1592 (ST JOHNS CHURCH RD)	BEGINNING OF PAVEMENT TO END MAINT. [MP 0.00 - 0.67]	1	2	2WU	0.67	20	80	0.03	14,469	8,844			45	
TOTAL FOR MAP NO. 5								0.67		80	0.03	14,469	8,844			45	
2019CPT.03.11.20711	Pender	6	SR 1523 (SHAW HWY)	FROM SR 1522 (OLD BLAKES RD) TO NC 53 [MP 0.00 - 0.52]	1	2	2WU	0.52	24	64	0.04	11,322	6,864	836		35	
TOTAL FOR MAP NO. 6								0.52		64	0.04	11,322	6,864	836		35	
2019CPT.03.11.20711	Pender	7	SR 1522 (SHAW HWY/OLD BLAKES BRIDGE RD)	FROM SR 1520 (OLD MAPLE HILL RD) TO SR 1523 (SHAW HWY) [MP 0.00 - 1.23]	1	2	2WU	1.35	20	144	0.06	26,534	16,236			82	
TOTAL FOR MAP NO. 7								1.35		144	0.06	26,534	16,236			82	
2019CPT.03.11.20711	Pender	8	SR 1200 (IVANHOE RD)	FROM SR 1201 (BEATTY'S BRIDGE RD) TO SAMPSON CO [MP 0.00 TO 0.85]	1	2	2WU	0.85	18	96	0.04	18,365	11,220			55	
TOTAL FOR MAP NO. 8								0.85		96	0.04	18,365	11,220			55	
2019CPT.03.11.20711	Pender	9	SR 1328 (GARDEN RD/RACCOON RD)	FROM NC 11 TO NC 11 [MP 0.47 - 1.66]	1	2	2WU	1.19	20	144	0.06	25,819	15,708			79	
TOTAL FOR MAP NO. 9								1.19		144	0.06	25,819	15,708			79	
2019CPT.03.11.20711	Pender	10	SR 1425 (BALCOMBE RD)	FROM NC 210 TO END OF PAVEMENT [MP 0.00 - 0.99]	1	2	2WU	0.99	20	112	0.05	21,473	13,068			66	
TOTAL FOR MAP NO. 10								0.99		112	0.05	21,473	13,068			66	
TOTAL FOR PROJ NO. 2019CPT.03.11.20711								15.37		1,760	0.78	329,444	201,300	836		1,010	
												530,744					
2019CPT.03.11.20712	Pender	11	SR 1319 (PELHAM RD/ELEANOR ROOSEBELT LN)	FROM SR 1328 (GARDEN RD) TO SR 1328 (RACCOON RD) [MP 5.10 - 5.78]	2	2	2WU	0.68	20	80	0.03	14,634	9,186			45	
TOTAL FOR MAP NO. 11								0.68		80	0.03	14,634	9,186			45	
2019CPT.03.11.20712	Pender	12	SR 1660 (OAKVALE RD)	FROM SR 1571 (SCOTTS HILL LOOP RD) TO SR 1662 (LAFAYETTE ST) [MP 0.00 - 0.15]	2	2	2WU	0.15	20	32	0.01						
TOTAL FOR MAP NO. 12								0.15		32	0.01						
2019CPT.03.11.20712	Pender	13	SR 1703 (LAFAYETTE ST)	FROM SR 1621 (POPLAR GROVE RD) TO CUL-DE-SAC [MP 0.00 - 0.29]	2	2	2WU	0.29	18	48	0.01						
TOTAL FOR MAP NO. 13								0.29		48	0.01						
2019CPT.03.11.20712	Pender	14	SR 1101 (POINT CASWELL RD)	FROM SR 110 (SLOCUM TRAIL RD) TO END OF PAVEMENT [MP 0.00 - 0.69]	2	2	2WU	0.69	20	80	0.04	14,849	9,108			46	
TOTAL FOR MAP NO. 14								0.69		80	0.04	14,849	9,108			46	
2019CPT.03.11.20712	Pender	15	SR 1326 (GIDDEONS POND RD)	FROM NC 11 TO SR 1325 (SILL CREEK RD) [MP 0.00 - 0.47]	2	2	2WU	0.47	20	64	0.02	10,136	6,204			31	
TOTAL FOR MAP NO. 15								0.47		64	0.02	10,136	6,204			31	
2019CPT.03.11.20712	Pender	16	SR 1365 (COTTLE ACRES)	FROM SR 1216 (PINEY WOODS RD) TO SR 1332 (PENDERLEA HWY) [MP 0.00 - 0.51]	2	2	2WU	0.51	20	64	0.03	11,009	6,732			34	
TOTAL FOR MAP NO. 16								0.51		64	0.03	11,009	6,732			34	
2019CPT.03.11.20712	Pender	17	SR 1355 (WEST WILLARLEA RD)	FROM SR 1319 (ELEANOR ROOSEVELT LN) TO NC 11 [MP 0.00 - 0.05]	2	2	2WU	0.05	18	16	0.01	1,076	660			4	
TOTAL FOR MAP NO. 17								0.05		16	0.01	1,076	660			4	
2019CPT.03.11.20712	Pender	18	SR 1356 (EAST WILLARLEA RD)	FROM SR 1319 (ELEANOR ROOSEVELT LN) TO NC 11 [MP 0.00 - 0.05]	2	2	2WU	0.05	18	16	0.01	1,076	660			4	
TOTAL FOR MAP NO. 18								0.05		16	0.01	1,076	660			4	
2019CPT.03.11.20712	Pender	19	SR 1325 (SILL CREEK RD)	FROM SR 1328 (GARDEN RD/RACCOON RD) TO SR 1324 (CROOKED RUN RD) [MP 0.00 - 1.21]	2	2	2WU	1.21	18	144	0.06	26,151	15,972			80	
TOTAL FOR MAP NO. 19								1.21		144	0.06	26,151	15,972			80	
TOTAL FOR PROJ NO. 2019CPT.03.11.20712								4.1		544	0.22	78,931	48,522			244	
												127,453					
GRAND TOTAL								19.47		2,304	1	408,375	249,822	836		1,254	
												658,197					

DIVISION OF HIGHWAYS
STATE OF NORTH CAROLINA

SOIL STABILIZATION TIMEFRAMES

<i>SITE DESCRIPTION</i>	<i>STABILIZATION TIME</i>	<i>TIMEFRAME EXCEPTIONS</i>
PERIMETER DIKES, SWALES, DITCHES AND SLOPES	7 DAYS	NONE
HIGH QUALITY WATER (HQW) ZONES	7 DAYS	NONE
SLOPES STEEPER THAN 3:1	7 DAYS	IF SLOPES ARE 10' OR LESS IN LENGTH AND ARE NOT STEEPER THAN 2:1, 14 DAYS ARE ALLOWED.
SLOPES 3:1 OR FLATTER	14 DAYS	7 DAYS FOR SLOPES GREATER THAN 50' IN LENGTH.
ALL OTHER AREAS WITH SLOPES FLATTER THAN 4:1	14 DAYS	NONE, EXCEPT FOR PERIMETERS AND HQW ZONES.

NOTES: Less than 5' - 10' undisturbed buffer from ROW, ditchline, water feature, or drainage inlet, add BMP.

BMP Options: Wattle or Silt Fence

EROSION CONTROL DETAIL

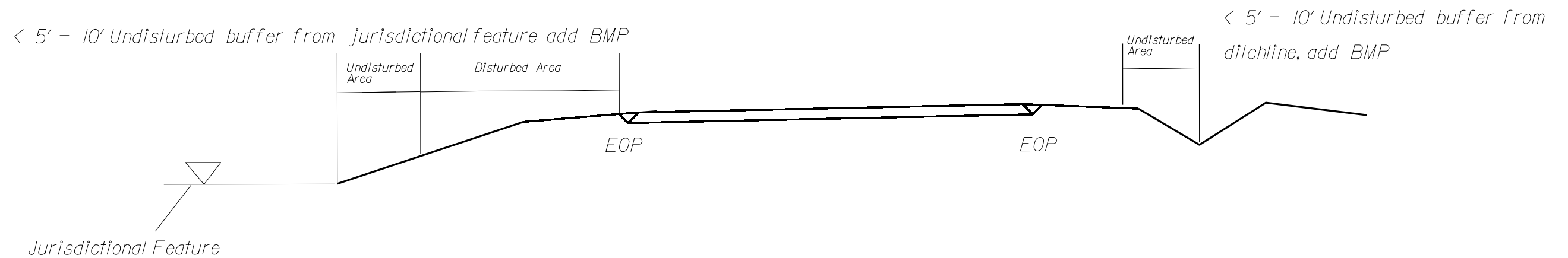
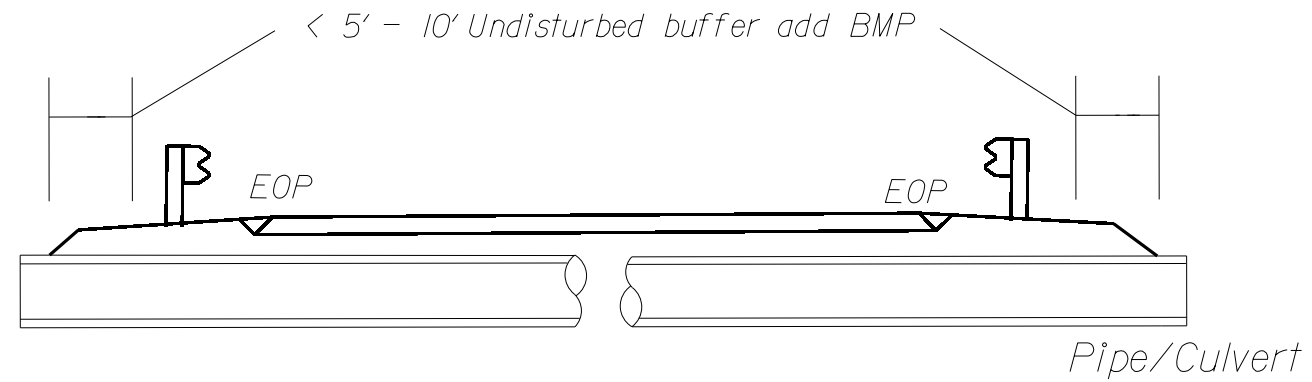

Use BMP's if shoulders and/or frontslopes and/or ditchline and/or backslopes are disturbed



< 5' - 10' Undisturbed buffer from inlet, add wattle

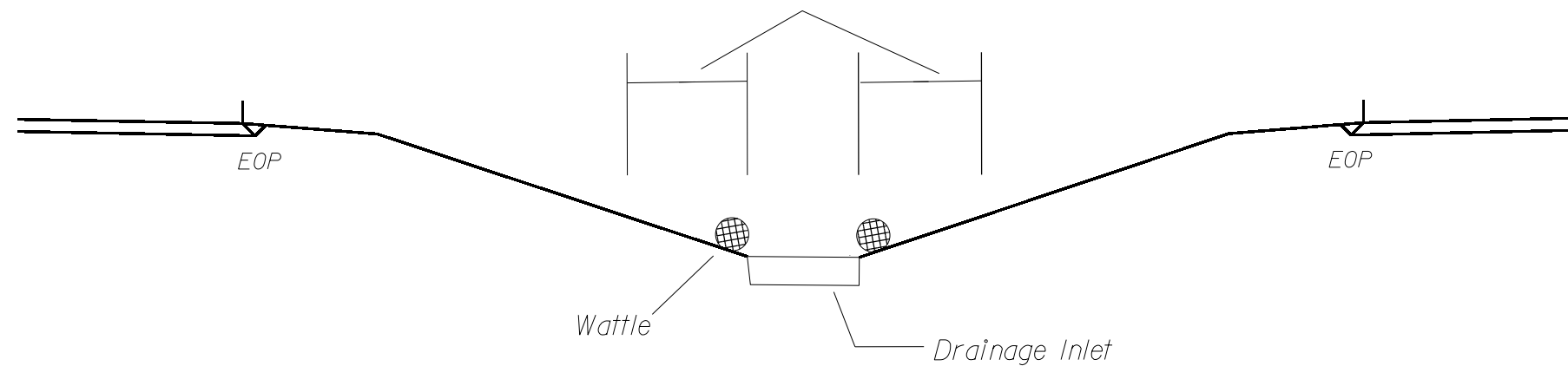

NOT TO SCALE

WATTLE DETAIL

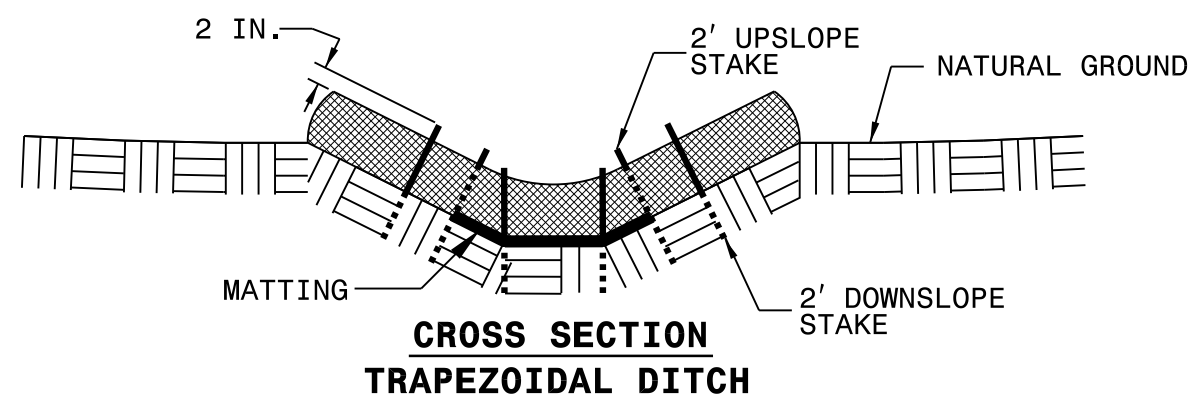
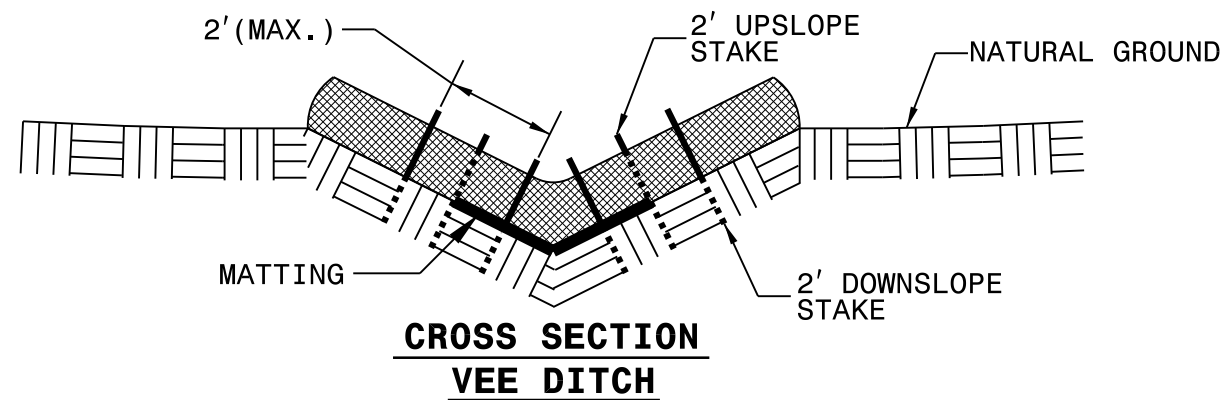
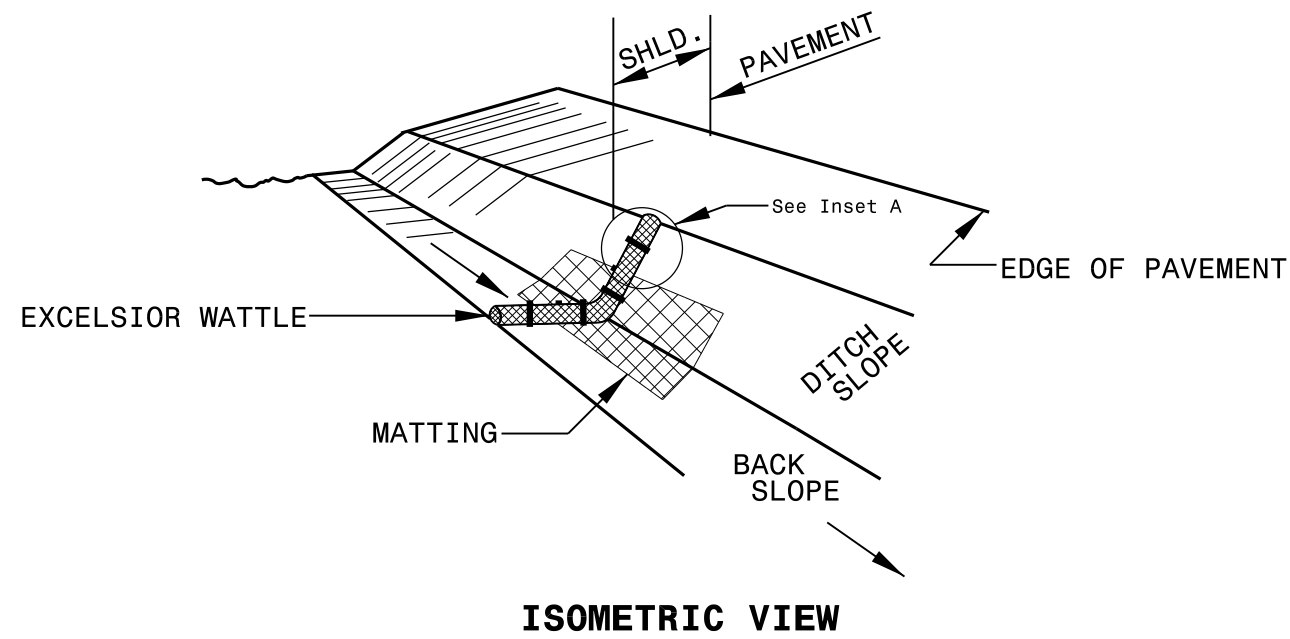

NOTES:

USE MINIMUM 12 IN. DIAMETER EXCELSIOR WATTLE.

USE 2 FT. WOODEN STAKES WITH A 2 IN. BY 2 IN. NOMINAL CROSS SECTION.

ONLY INSTALL WATTLE(S) TO A HEIGHT IN DITCH SO FLOW WILL NOT WASH AROUND WATTLE AND SCOUR DITCH SLOPES AND AS DIRECTED.

INSTALL A MINIMUM OF 2 UPSLOPE STAKES AND 4 DOWNSLOPE STAKES AT AN ANGLE TO WEDGE WATTLE TO BOTTOM OF DITCH.

PROVIDE STAPLES MADE OF 0.125 IN. DIAMETER STEEL WIRE FORMED INTO A U SHAPE NOT LESS THAN 12" IN LENGTH.

INSTALL STAPLES APPROXIMATELY EVERY 1 LINEAR FOOT ON BOTH SIDES OF WATTLE AND AT EACH END TO SECURE IT TO THE SOIL.

INSTALL MATTING IN ACCORDANCE WITH SECTION 1631 OF THE STANDARD SPECIFICATIONS.

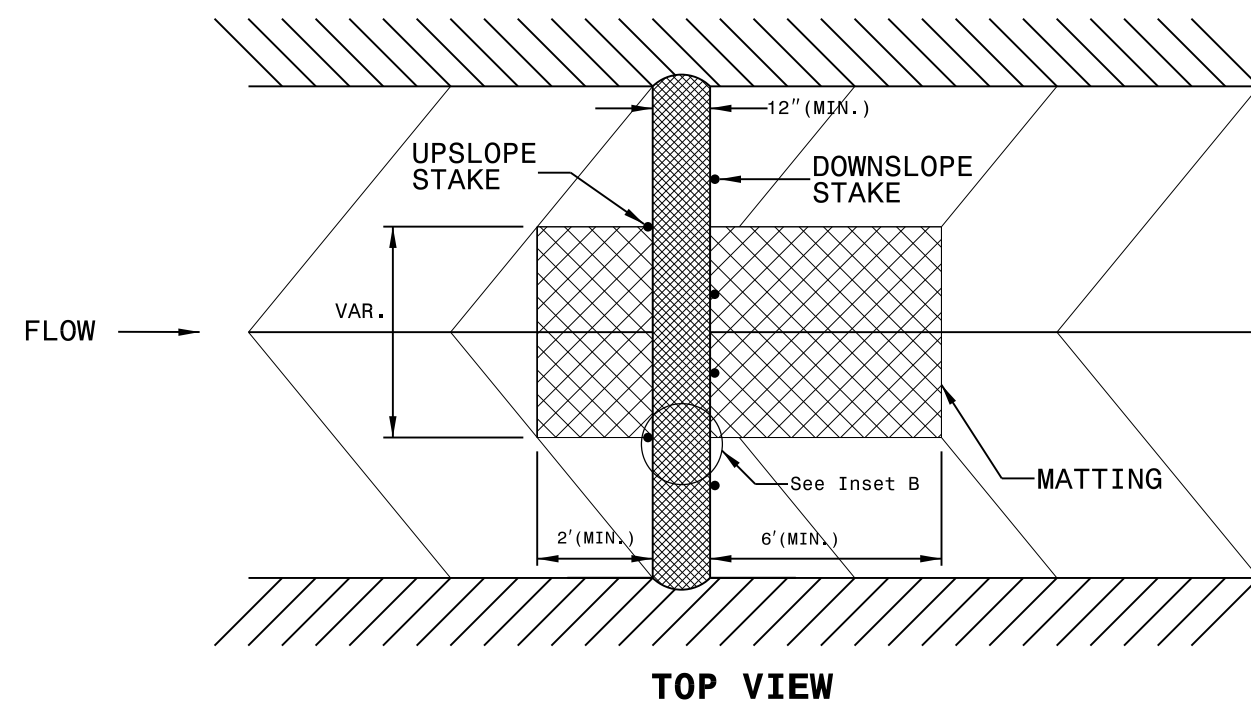
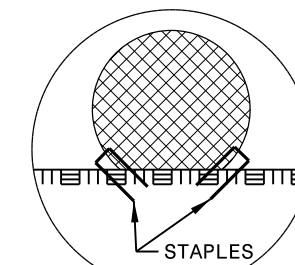
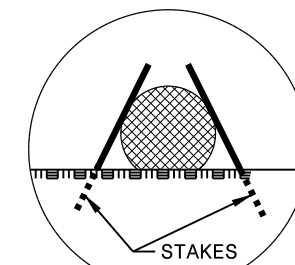

I:\FEB-2015 Iir41
 D:\Resurfacing\2015\Resurfacing\Pender County\Plan Sheets\3CR.20711.173. EC RESURF. 2015.dgn
 11/11/2015 10:41:10 AM

SIGNING FOR RESURFACING PROJECTS

LEGEND
 ┆ STATIONARY SIGN
 ← DIRECTION OF TRAFFIC FLOW

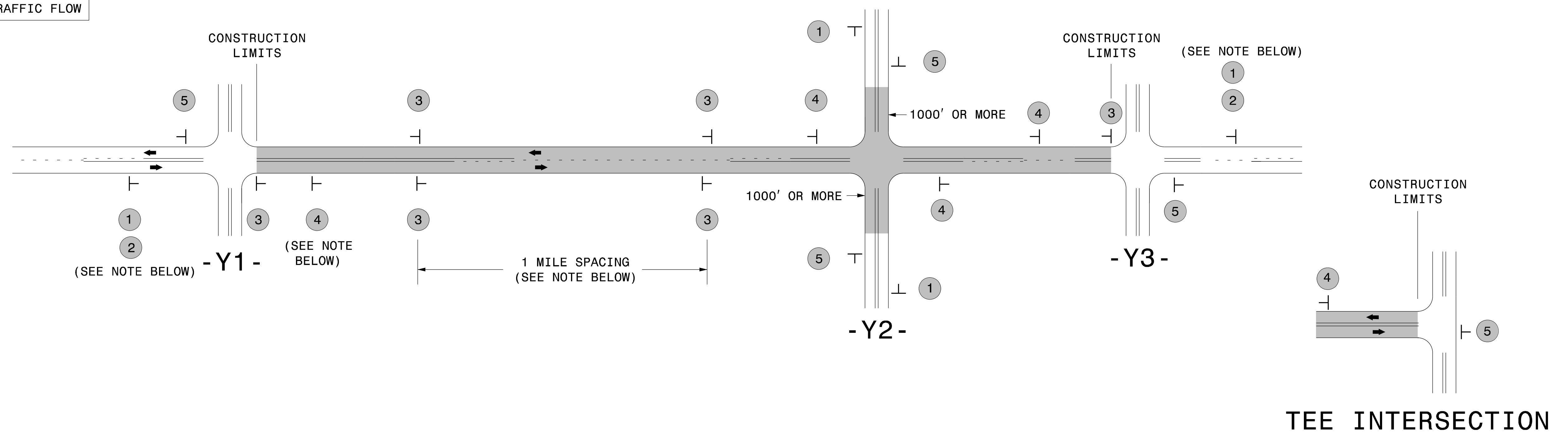

MAINLINE (-L-) SIGNING

-Y- LINE SIGNING

SIGNING NOTES AND PLACEMENT PER DIRECTION	1	 W20-1 48" X 48"	PLACE 1000' PRIOR TO BEGINNING OF CONSTRUCTION LIMITS. ONLY USED ON -Y- LINES IF RESURFACING LIMITS EXTEND 1000' ALONG -Y- LINE.	<p>NO REQUIRED STATIONARY SIGNING FOR THE FOLLOWING -Y- LINE CONDITIONS:</p> <ol style="list-style-type: none"> 1) LESS THAN 1000' OF RESURFACING ALONG -Y- LINE 2) SUBDIVISION ROADS 3) DEAD END ROADS <p>WHEN PAVING/CONSTRUCTION ACTIVITIES PROCEED ACROSS AN UNSIGNED -Y- LINE, PORTABLE ADVANCE WARNING SIGNS SHALL BE USED ALONG THE -Y- LINE AS SHOWN BELOW. REMOVE UPON COMPLETION OF WORK.</p> <div style="display: flex; justify-content: space-around;"> <div style="text-align: center;"> W20-1 48" X 48" PLACED 500' IN ADVANCE OF FLAGGER. </div> <div style="text-align: center;"> W20-7 A 48" X 48" PLACED 250' IN ADVANCE OF FLAGGER. </div> </div>
	2	 W7-3aP 24" X 18"	#2 SIGN ONLY USED WHEN CONSTRUCTION LIMITS ARE 2 OR MORE MILES IN LENGTH. ROUND UP TO NEXT WHOLE NUMBER. (NO FRACTIONAL OR DECIMAL NUMBERS)	
	3	 SP 13107 48" X 48"	<ul style="list-style-type: none"> - PLACE INITIALLY AT THE CONSTRUCTION LIMITS AND SPACE 1 MILE APART THEREAFTER. - AT TEE INTERSECTIONS INSTALL INITIALLY 1/2 MILE FROM INTERSECTION AND SPACE 1 MILE APART THEREAFTER. 	
	4	 SP 13106 48" X 48"	<ul style="list-style-type: none"> - THESE ARE FOR -Y- LINES THAT ARE "THROUGH" ROADWAYS. - DEAD END AND SUBDIVISION ROADS ARE NOT "THROUGH" ROADWAYS. - INSTALL 500' +/- FROM EACH -Y- LINE APPROACH AS SHOWN ABOVE. - FOR MULTIPLE -Y- LINES THAT ARE SEPARATED BY 0.25 MILES OR LESS, TREAT AS A SINGLE UNIT AND INSTALL WITHIN 500' OF EACH APPROACH. - A MAXIMUM OF 2 SIGN SETS PER MILE. DO NOT INSTALL WHEN -Y- LINES ARE WITHIN 0.5 MILES FROM "END ROAD WORK" SIGN. - FOR TEE INTERSECTIONS, INSTALL WITHIN 500' +/- OF THE INTERSECTION ALONG -L- LINE. 	
	5	 G20-2 A 48" X 24"	PLACE 500' FOLLOWING THE END OF CONSTRUCTION LIMITS OR AS SHOWN WHEN WORK ENDS AT A 3-WAY TEE INTERSECTION.	

THE ABOVE SIGNS ARE ALL THAT ARE REQUIRED FOR A CONTRACTOR TO BEGIN A RESURFACING CONTRACT. ANY ADDITIONAL SIGNS REQUESTED BY NCDOT DIVISIONS SHALL BE INSTALLED WITHIN 7 BUSINESS DAYS OF THE START OF CONTRACT WORK.

MAPS LESS THAN 2 MILES

FOR RESURFACING MAPS WITH CONSTRUCTION LIMITS LESS THAN 2 MILES IN LENGTH, NO STATIONARY SIGNS ARE REQUIRED. USE PORTABLE "ROAD UNDER CONSTRUCTION" OR "ROAD WORK AHEAD" SIGNS IN LIEU OF STATIONARY ADVANCE WARNINGS SIGNS.

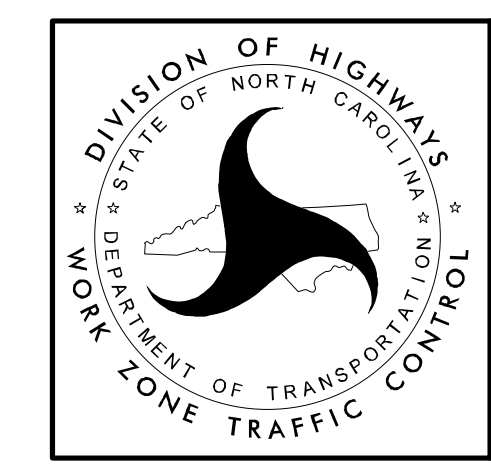

ADVANCE WARNING SIGNS FOR RURAL AND SUBURBAN 2-LANE ROADWAY RESURFACING

5/15/2017 S:\TMU\WZTC\Resurfacing\2L2W & AST Resurfacing Details\Resurfacing_AdvWarn_2Ln.dgn User:kadai